

**BENCH MARKS**

B.M. "A" Elev. 212.82  
 Railroad Spike in 30" Maple 24" S.E. of P.O.L. 1+05, P.I. "T-3" to P.I. "T-3A"

B.M. "1" Elev. 198.45  
 Railroad Spike in 12" Maple 61" Southeast of P.I. "T-6"

B.M. "2" Elev. 192.20  
 Railroad Spike in 24" White Oak 51" Southwest of P.I. "T-7"

TYPE OF BUILDING - DETENTION CENTER  
 NUMBER OF LOTS - 1  
 NUMBER OF WHC - N/A  
 NUMBER OF SHC - 2  
 DRAINAGE AREA - PATAPSCO

**VICINITY MAP**  
 Scale: 1"=600'

- GENERAL NOTES**
- The approximate locations of existing utilities are shown. The Contractor shall take all necessary precautions to protect the existing utilities and to maintain uninterrupted service. Any damage incurred due to the Contractor's operation shall be repaired immediately to the satisfaction of the Engineer at the Contractor's expense.
  - All horizontal controls are based on Maryland State Coordinates.
  - All vertical controls are based on U.S.G.S. Datum.
  - All pipe elevations shown are invert elevations.
  - All utilities shall be cleared by a minimum of 6' vertically. All utility poles shall be cleared by a minimum of 2' - 0" horizontally or tunnelled if required. Cost for tunneling or bracing poles shall be included in the unit prices bid for excavation and backfill for sewer mains.
  - For all standard details, see the standards bound in the specifications.
  - The Contractor shall locate existing utilities a minimum of two (2) weeks in advance of construction operations in the vicinity of proposed utilities.
  - Trees shall be protected from damage to the maximum extent. Trees located within construction strips shall not be removed or damaged by the Contractor.
  - The Contractor shall remove trees, stumps, and roots along the line of excavation as directed by the Engineer. The cost for such removal shall be included in the unit prices bid for excavation and backfill for sewer mains.
  - All sewer mains shall be C.S.P.X., V.C.P.X., or A.C.P. Class 2400 unless otherwise noted.
  - The Contractor shall provide a joint in all sewer mains within 2' - 0" of the manhole exterior walls.
  - All manholes shall be 4' - 0" inside diameter, unless otherwise noted.
  - The Contractor shall notify the following utilities or agencies at least five days before starting work shown on these plans:  
 Baltimore Gas and Electric Company  
 Underground Electric Distribution Engineering Damage Control - 234 - 5691  
 Underground Gas Distribution Engineering - 234 - 5621  
 Chesapeake and Potomac Telephone Company - 393 - 3648  
 Miss Utility - 1 - 559 - 0100  
 American Telephone and Telegraph - Cable Location Division 301 - 393 - 3553  
 Colonial Pipeline Company - 781 - 4641  
 Howard County Bureau of Utilities - 992 - 2366

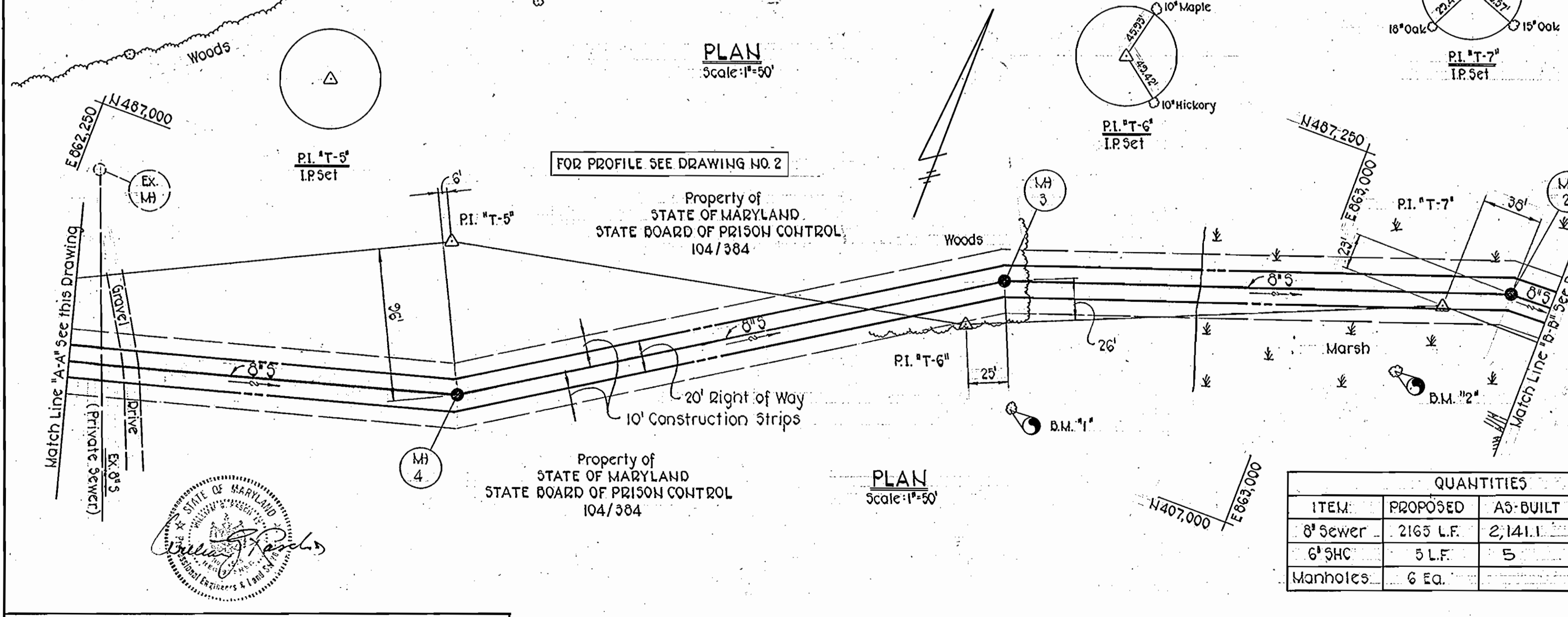

**QUANTITIES**

ITEM	PROPOSED	AS-BUILT	SUPPLIER
8" Sewer	2165 L.F.	2,141.1	PVC A&P Pipe
6" SHC	5 L.F.	5	PVC A&P Pipe
Manholes	6 Ea.		

DEPARTMENT OF PUBLIC WORKS  
 HOWARD COUNTY, MARYLAND  
 Director: F. N. [Signature] 8/11/80  
 Chief - Bureau of Engineering: [Signature] 8/11/80  
 Chief - Bureau of Utilities: [Signature] 8/11/80  
 Chief - Utility Division: [Signature]

PURDUM & JESCHKE  
 ENGINEERS  
 1023 N. CALVERT ST.  
 BALTIMORE, MARYLAND

CONTRACT NO. 10-0925-D  
 CAPITAL PROJECT NO. C-5-0123

PLAN FOR SEWER MAIN

HOWARD COUNTY DETENTION CENTER  
 SEWER MAIN EXTENSION  
 ELECTION DISTRICT NO. 1  
 HOWARD COUNTY, MARYLAND

DRAWING NO. 1 OF 2  
 SCALE AS SHOWN  
 Designed: REP  
 Drafted: ARZ  
 Checked: REP

WS 925 - S/1

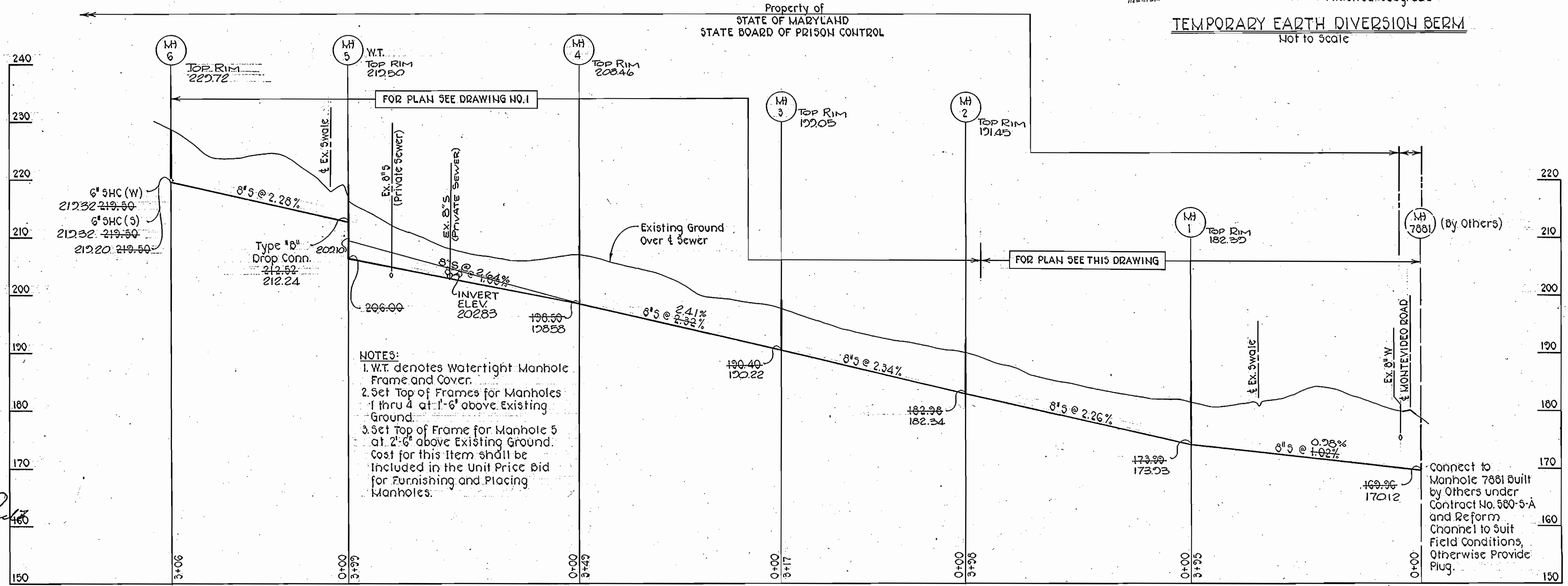
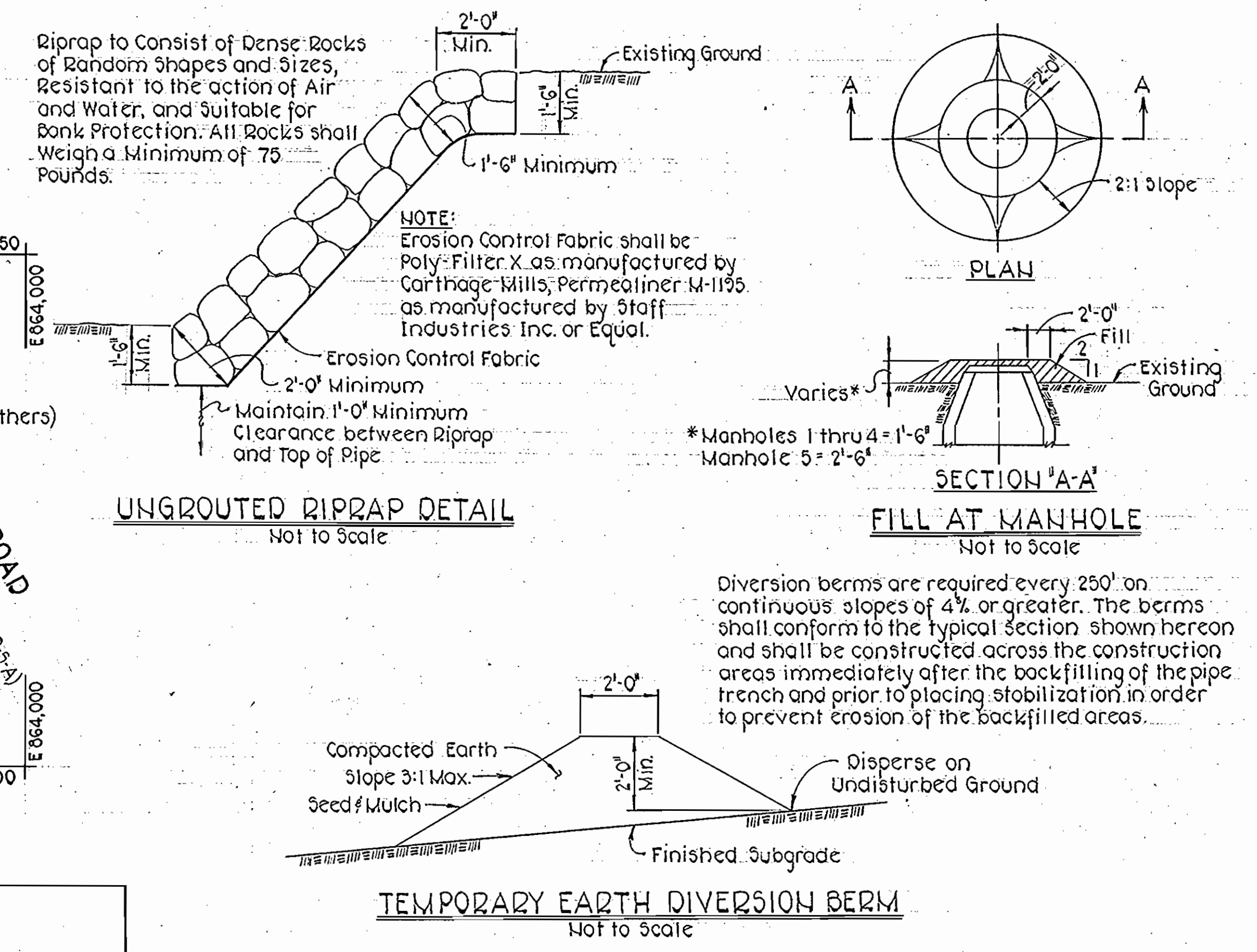
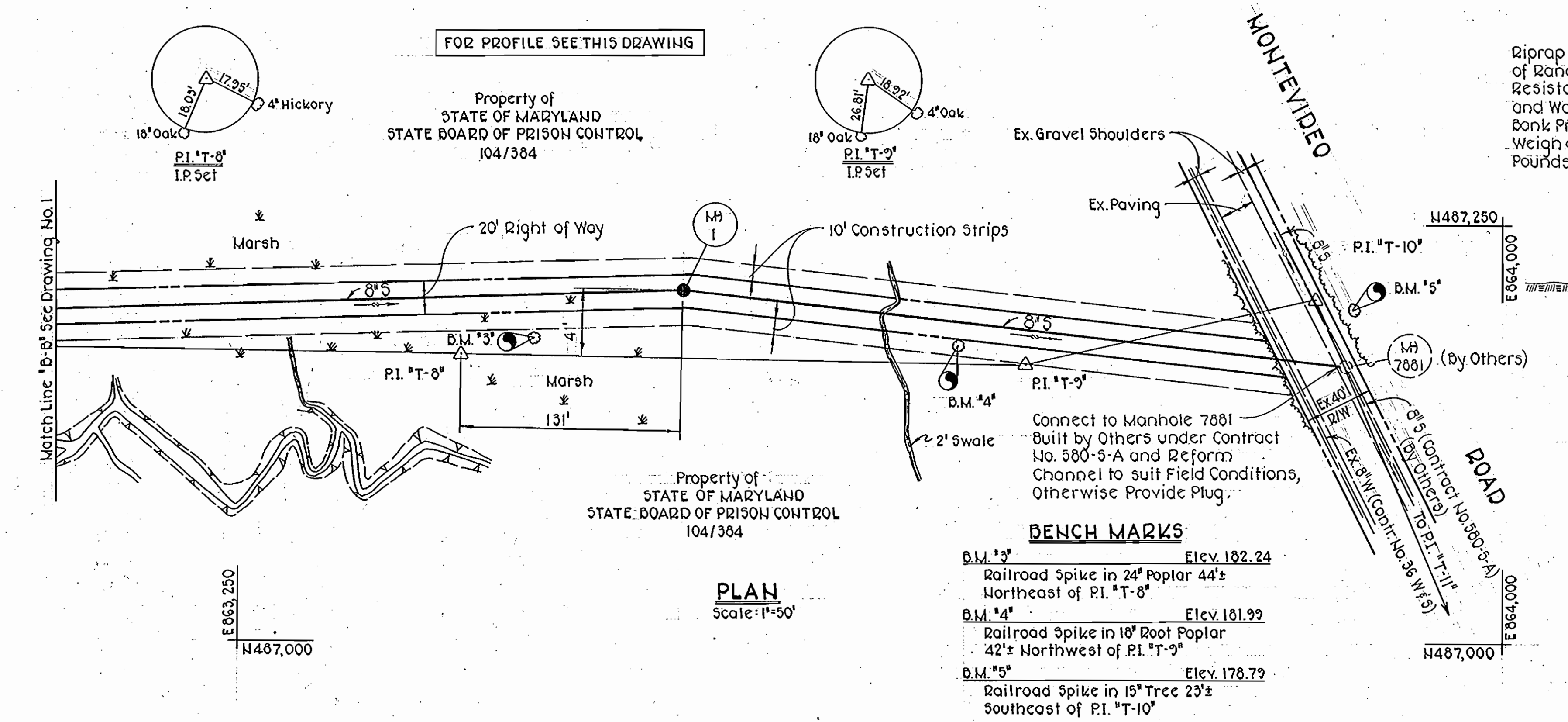

DEPARTMENT OF PUBLIC WORKS  
HOWARD COUNTY, MARYLAND

*James F. Nimmey* 8-11-80  
DIRECTOR OF PUBLIC WORKS DATE

*Richard E. Raley* 8-11-80  
CHIEF-BUREAU OF ENGINEERING DATE

*James L. Glick* 8/11/80  
CHIEF - BUREAU OF UTILITIES DATE

*James J. Adams* 8/11/80  
CHIEF - UTILITY DIVISION DATE

PURDUM & JESCHKE  
ENGINEERS  
1023 N. CALVERT ST.  
BALTIMORE, MARYLAND

CONTRACT NO. 10-0925-D  
CAPITAL PROJECT NO. C-5-0123

PLAN, PROFILE, AND DETAILS  
FOR SEWER MAIN

HOWARD COUNTY DETENTION CENTER  
SEWER MAIN EXTENSION  
ELECTION DISTRICT NO. 1  
HOWARD COUNTY, MARYLAND

DRAWING NO. 2 OF 2	SCALE AS SHOWN	Designed-REP Drafted-ARZ Checked-REP
--------------------	----------------	--

WS 925-5/2