

WATER & SEWER CODE
(COUNTY USE)
SEWER ZONE - 5870000
WATER ZONE - HCB

GENERAL NOTES

- APPROXIMATE LOCATIONS OF EXISTING MAINS ARE SHOWN. THE CONTRACTOR SHALL TAKE ALL NECESSARY PRECAUTIONS TO PROTECT THE EXISTING MAINS AND SERVICES AND MAINTAIN UNINTERRUPTED SERVICE. ANY DAMAGE INCURRED SHALL BE REPAIRED IMMEDIATELY.
- ALL PIPE ELEVATIONS SHOWN ARE INVERT ELEVATIONS.
- THE CONTRACTOR SHALL LOCATE EXISTING UTILITIES A MINIMUM OF TWO WEEKS IN ADVANCE OF CONSTRUCTION OPERATIONS IN VICINITY OF UTILITIES.
- FOR ALL STANDARD DETAILS, SEE STANDARDS BOUND IN SPECIFICATIONS.
- HOUSE CONNECTIONS SHALL BE CONSTRUCTED ONLY WHERE AND IF DIRECTED BY THE ENGINEER IN THE FIELD.
- ALL WATER MAINS TO BE C.I.P., D.I.P., OR ASBESTOS CEMENT AND HAVE A MINIMUM OF 3.5' OF COVER.
- BLOCK ALL FITTINGS WITH CONCRETE, SEE STANDARD DETAILS BOUND IN SPECIFICATIONS.
- ALL SEWER PIPE SHALL BE V.C.P.X., C.S.P.X., OR ASBESTOS CEMENT CLASS 2400 UNLESS OTHERWISE NOTED.
- BUILD ALL MANHOLES TO EXISTING GROUND, OR PAVING UNLESS OTHERWISE SHOWN OR DIRECTED BY THE ENGINEER.
- CLEAR ALL UTILITIES BY A MINIMUM OF 6" CLEAR ALL POLES BY 2'-0" MINIMUM OR TUNNEL AS REQUIRED.
- THE CONTRACTOR SHALL PROVIDE A JOINT IN ALL SEWER MAINS WITHIN 2'-0" OF EXTERIOR MANHOLE WALLS.
- ELEVATIONS ARE BASED UPON MARYLAND STATE DATUM. COORDINATE VALUES SHOWN ON DRAWINGS ARE IN THE MARYLAND STATE GRID SYSTEM.
- THE CONTRACTOR SHALL NOTIFY THE FOLLOWING UTILITIES OR AGENCIES AT LEAST FIVE (5) DAYS BEFORE STARTING WORK SHOWN ON THESE PLANS:
 - BALTIMORE GAS AND ELECTRIC COMPANY
 - UNDERGROUND ELECTRIC DISTRIBUTION ENGINEER, DAMAGE CONTROL 234-5651
 - UNDERGROUND GAS DISTRIBUTION ENGINEER 555-0100
 - C & P TELEPHONE COMPANY 727-2970
 - MISS UTILITY 399-9648

PLAN
SCALE: 1" = 50'

CONTRACT NO. 2759-D-W & S
PINEWICK ROAD
EXTENSIONS
DEPARTMENT OF PUBLIC WORKS HOWARD CO., MD.

QUANTITY SCHEDULE		AS BUILT	MATERIAL/SUPPLIER
ITEM	QUANTITY		
6"W	130 L.F.		
8"6	85 L.F.		

BENCH MARKS:
B.M. "D-10" ELEV. 411.74
DESCRIPTION: NAIL IN @
INTERSECTION PINEWICK RD.
& GATEWICK CT.

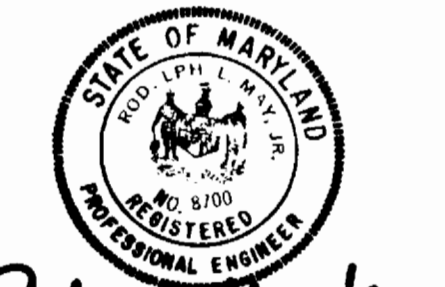

PINEWICK ROAD
WATER & SEWER EXTENSIONS
CONTR. NO. 2759-D-W&S

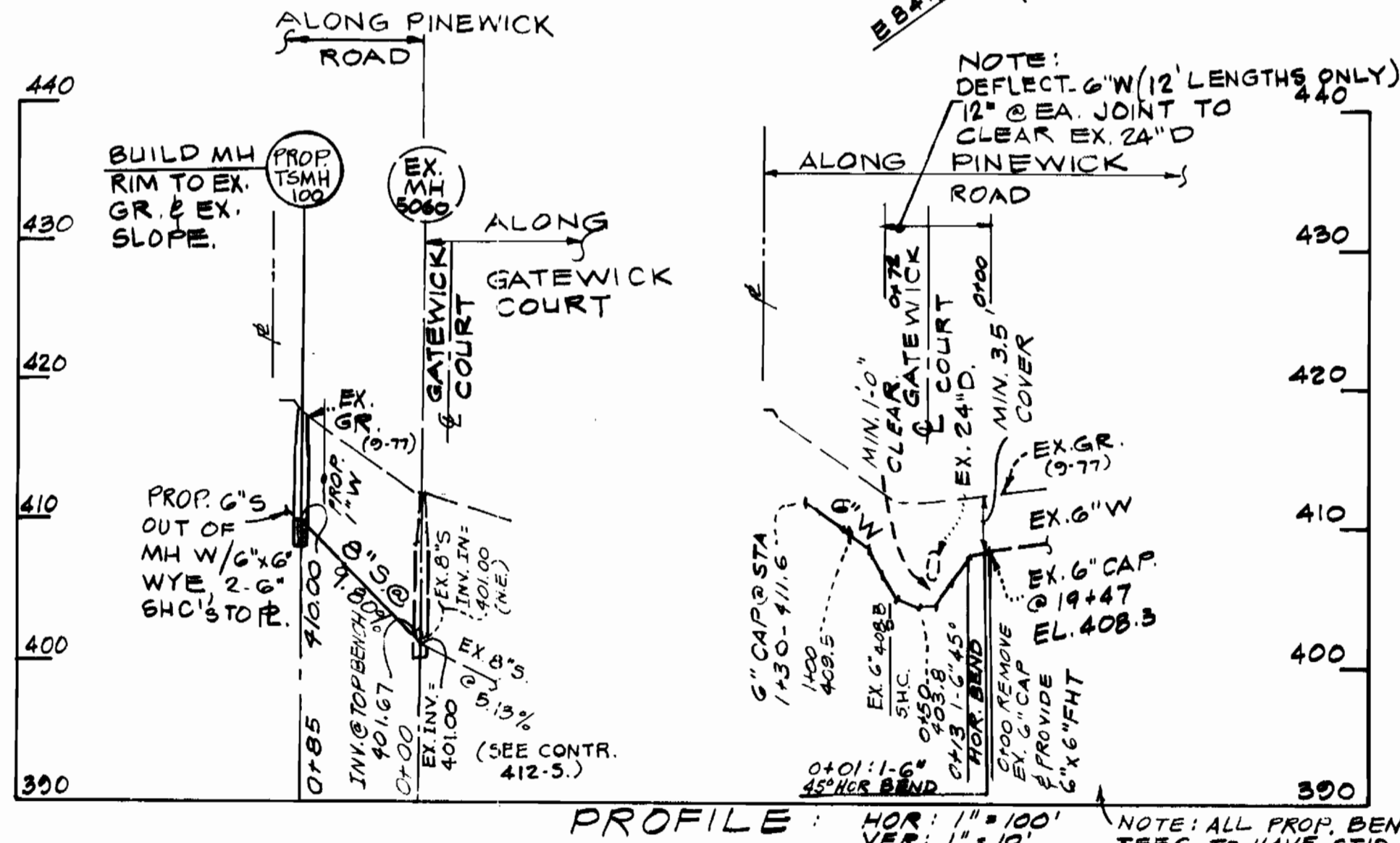

PROFILE
HOR: 1" = 100'
VER: 1" = 10'
NOTE: ALL PROP. BENDS & TEES TO HAVE ST'D CONC. BUTTRESSES.

BOENDER ASSOCIATES, INC.
ENGINEERS, PLANNERS, SURVEYORS
BALTIMORE, MD. 445-7777
SALISBURY, MD. 749-1286

DEPARTMENT OF PUBLIC WORKS
10-26-77
DIRECTOR OF PUBLIC WORKS - DATE

W. J. ...
10-26-77
CHIEF, BUREAU OF ENGINEERING - DATE

CONTRACT NO. 2759-D-W&S

PLAN AND PROFILE

PINEWICK ROAD - JOHN F. RETTALIATA PROPERTY
LOTS A, B, I, & II OF PARCELS 592 & 599
2 ND ELECTION DISTRICT

DRAWING NO. 1 OF 1
SCALE AS SHOWN
DES: RLM
DRW: WHN
CHK: RLM