

WS 703 - WS/1

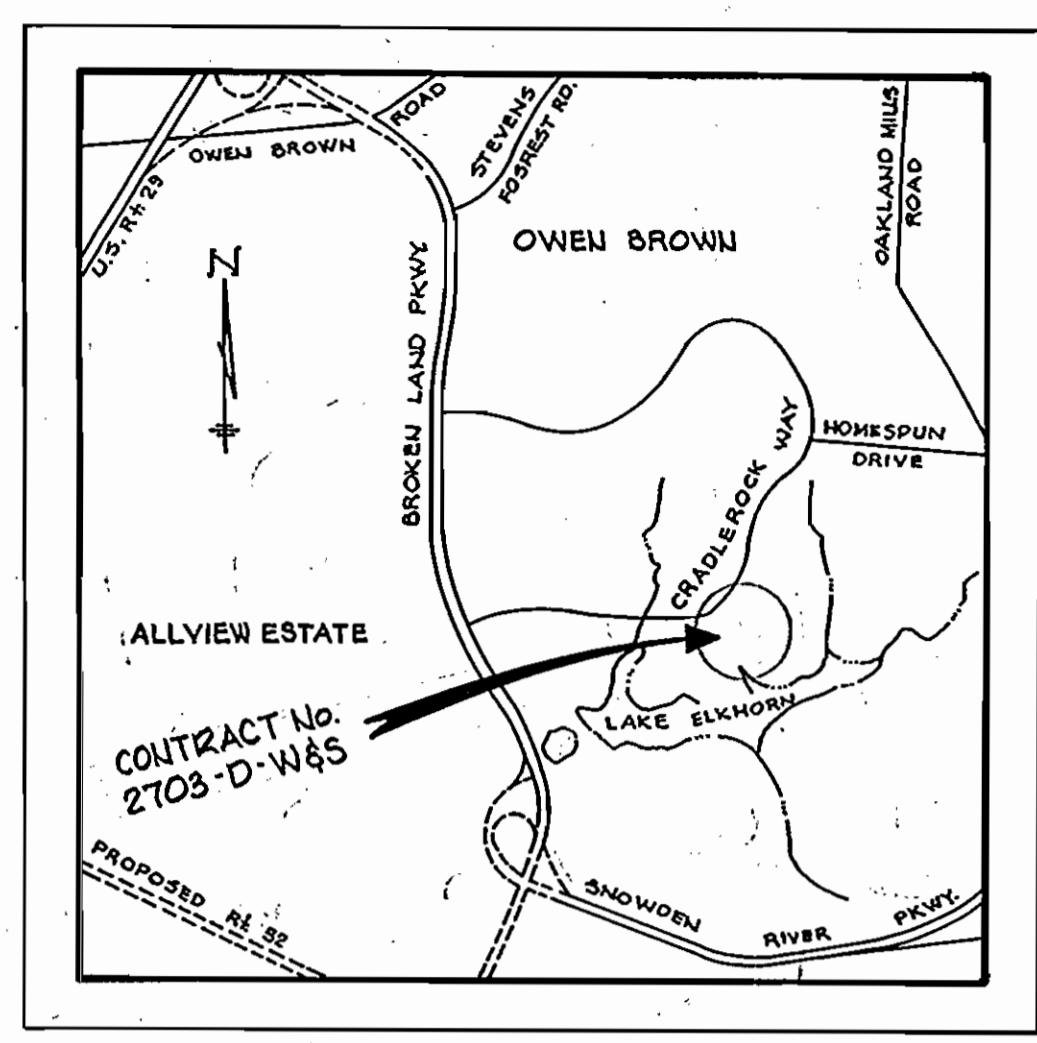
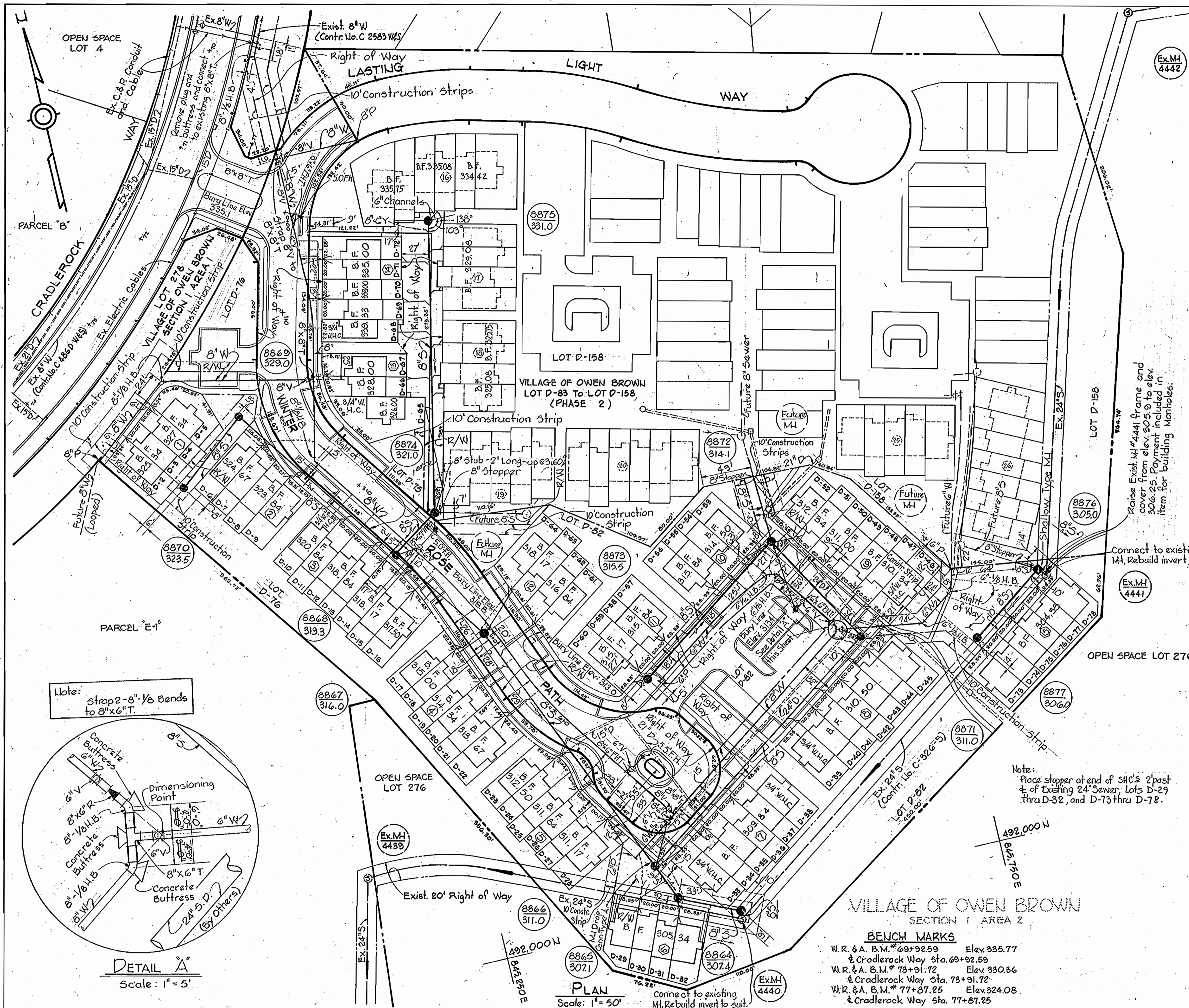

VICINITY MAP
Scale: 1"=2000'

GENERAL NOTES

1. Approximate location of existing mains are shown. The Contractor shall take all necessary precautions to protect existing mains and services and maintain uninterrupted supply. Any damage incurred shall be repaired immediately.
2. All pipe elevations shown are invert elevations.
3. The Contractor shall locate existing utilities a minimum of two weeks in advance of construction operations in vicinity of utilities.
4. Clear all utilities by a minimum of 6\"/>

Note: Strap 2-8" x 1/8 Bends to 8" x 6" T.

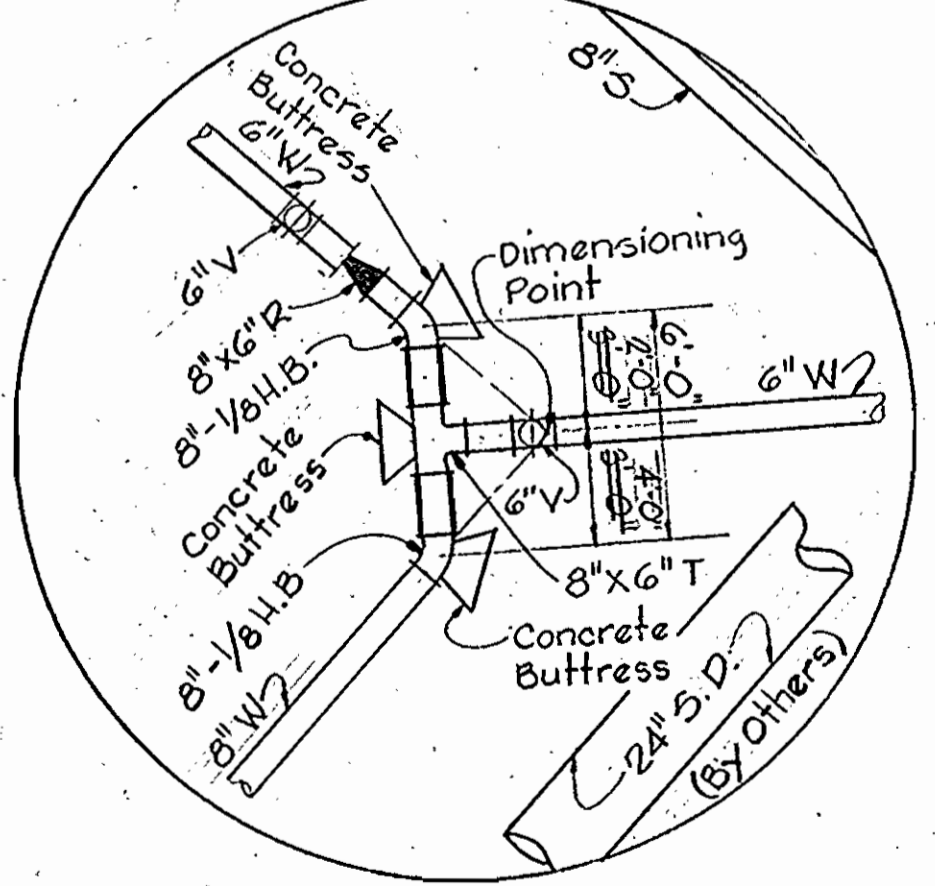

DETAIL A
Scale: 1"=5'

BENCH MARKS
 W.R. & A. B.M. #69+92.59 Elev. 335.77
 & Cradlerock Way Sta. 69+92.59
 W.R. & A. B.M. #73+91.72 Elev. 330.36
 & Cradlerock Way Sta. 73+91.72
 W.R. & A. B.M. #77+87.25 Elev. 324.08
 & Cradlerock Way Sta. 77+87.25

QUANTITIES	
ITEM	QUANTITY
8" Sewer	1,975 L.F.
8" Water	1,655 L.F.
6" Water	370-516 L.F.
Fire Hydrants	4

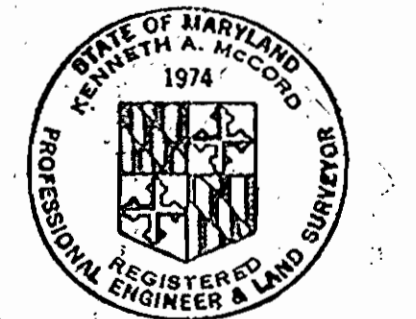

Village of Owen Brown
 Section 1, Area 2
 Parcel D-1, Phase 1
 Contract No. 2703-D-W85

WHITMAN, REQUARDT & ASSOCIATES ENGINEERS 1304 ST. PAUL ST. BALTIMORE, MARYLAND	DEPARTMENT OF PUBLIC WORKS HOWARD COUNTY, MARYLAND P. J. Reed 9-21-76 DIRECTOR OF PUBLIC WORKS - DATE	W. O. Lambert 9-21-76 CHIEF-BUREAU OF ENGINEERING - DATE	CONTRACT NO. 2703-D-W85 PLAN OF WATER & SEWER MAINS COLUMBIA VILLAGE OF OWEN BROWN ELECTION DISTRICT GUILFORD NO. 6	DRAWING NO. 1 OF 2 SCALE AS SHOWN
--	---	---	--	--

W. O. 2468

As Built Dimensions 1-6-76

SEPTEMBER 16, 1976

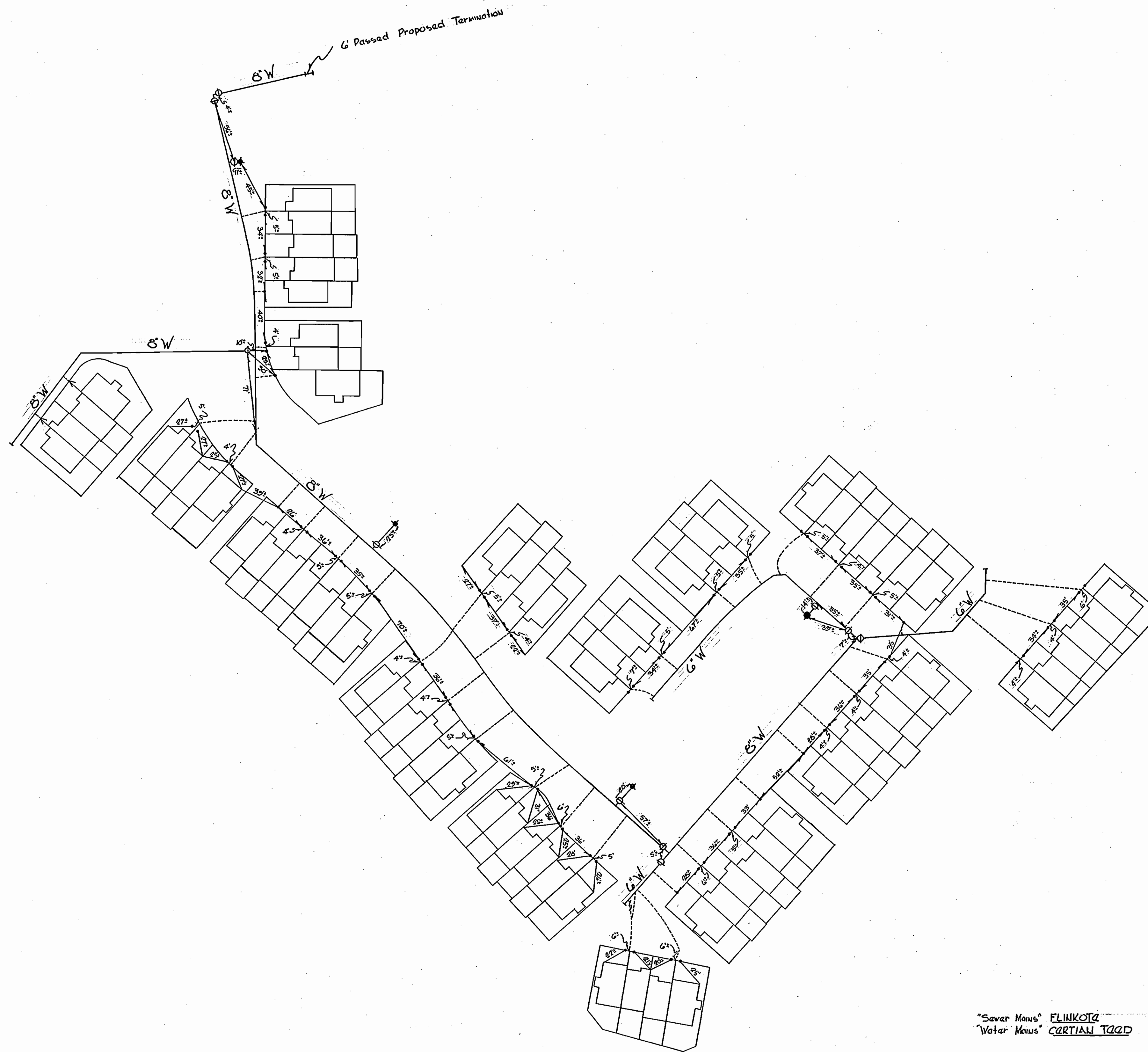

"Sewer Mains" FLINKOTA
 "Water Mains" CARTIAN TADD

DEPARTMENT OF PUBLIC WORKS
 HOWARD COUNTY, MARYLAND

CONTRACT NO. 2703-D-WBS

AS-BUILT DIMENSIONS
 FOR WATER MAINS

COLUMBIA
 VILLAGE OF OWEN BROWN
 ELECTION DISTRICT GUILFORD NO. 6

DRAWING
 NO. 1A
 OF 2

SCALE

AS-BUILT JANUARY 6, 1978

WS 703 - WS/1A

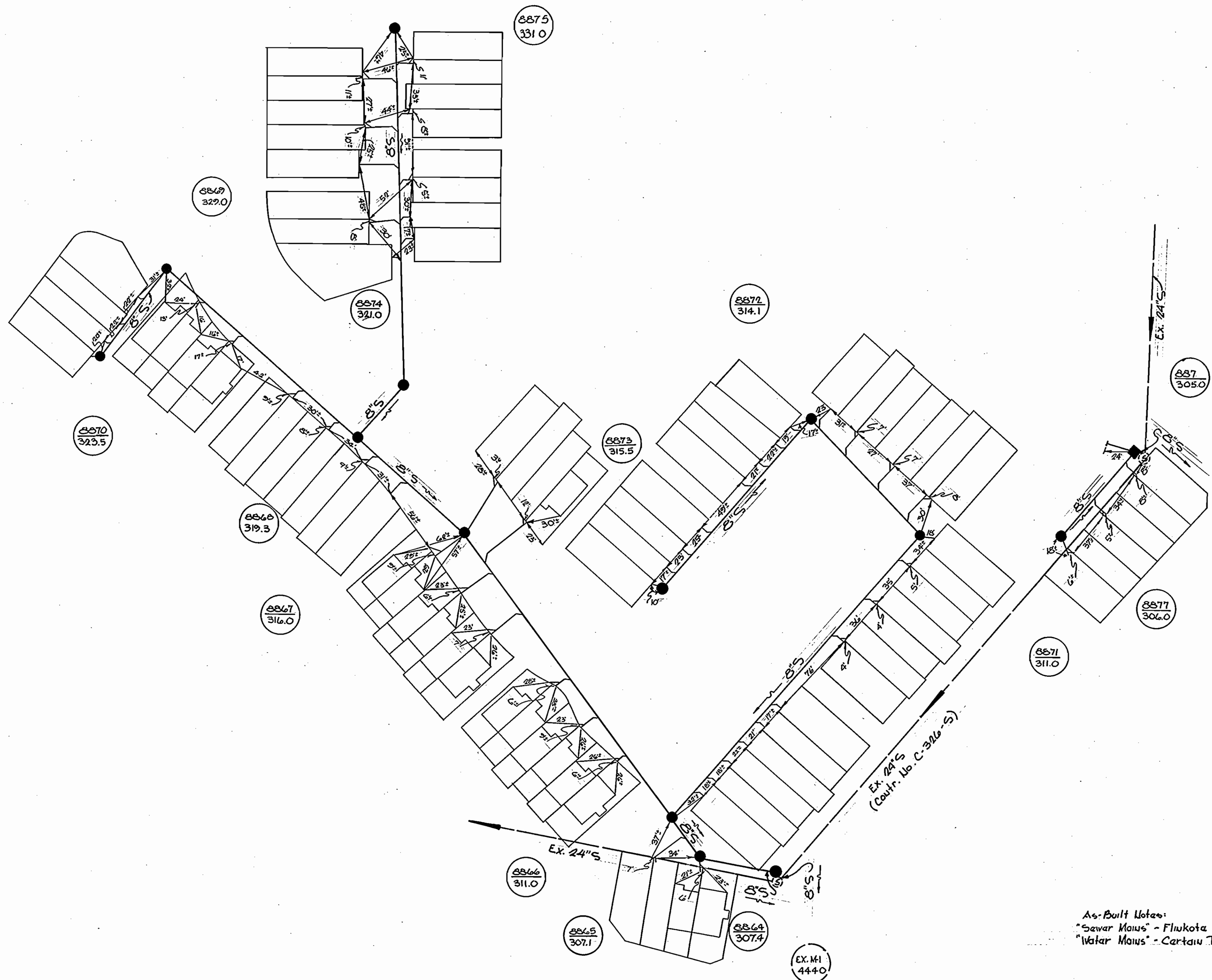

As-Built Notes:
 "Sewer Mains" - Fluokota
 "Water Mains" - Cartain Taad

WS 703 -WS/IB

Suspend

Suspend

	DEPARTMENT OF PUBLIC WORKS HOWARD COUNTY, MARYLAND DATE _____ CHIEF BUREAU OF WATER AND SEWER	CONTRACT NO. 2703-D-WaS	AS-BUILT DIMENSIONS FOR SEWER	COLUMBIA VILLAGE OF OWEN BROWN ELECTION DISTRICT GUILFORD NO. 6	DRAWING NO. 18 OF 2	SCALE
--	---	-------------------------	----------------------------------	---	---------------------------	---------------

As-Built January 6, 1978

WS 703 -WS/2

W. O. 2468

DATE

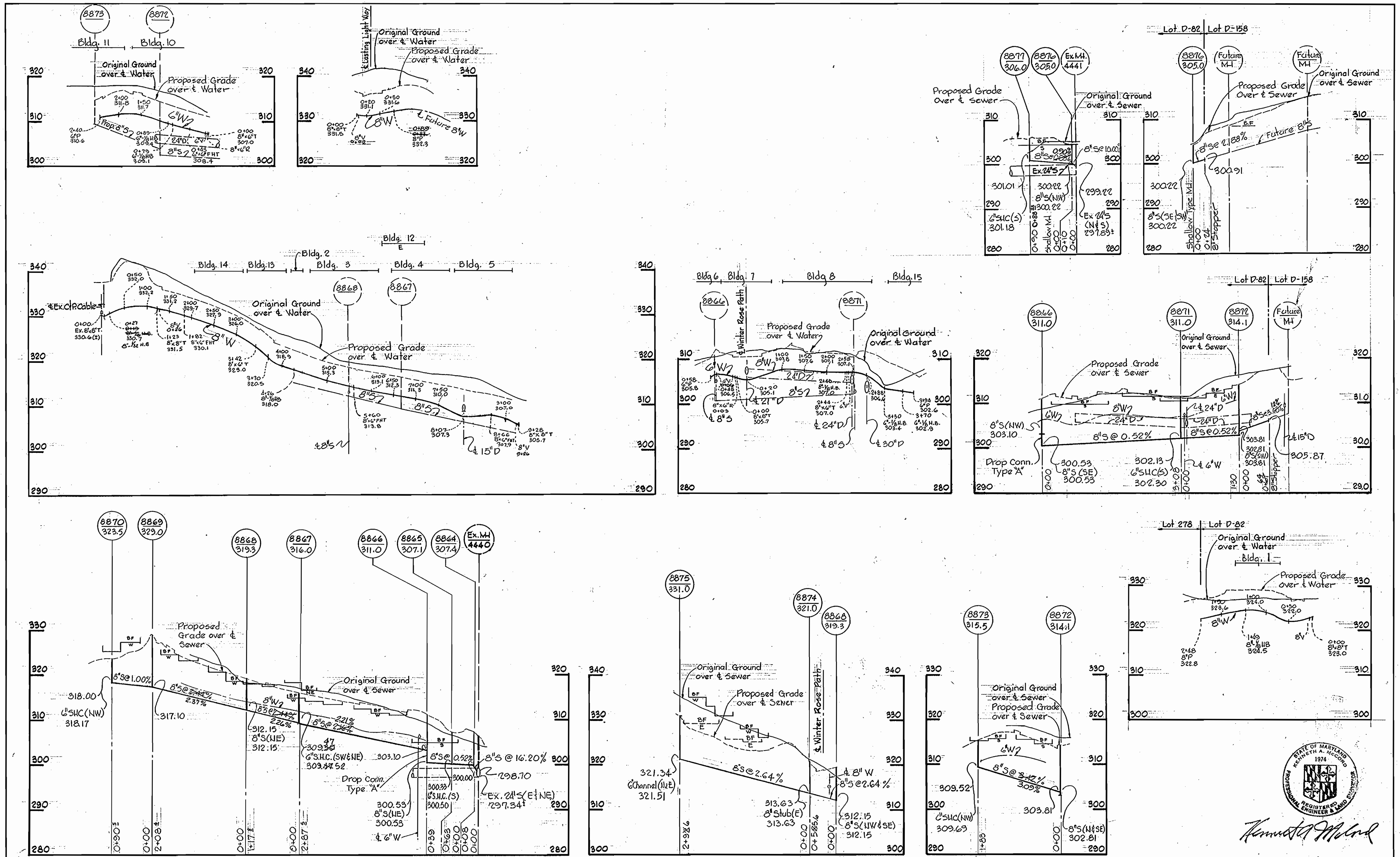

<p>WHITMAN, REQUARDT & ASSOCIATES ENGINEERS 1304 ST. PAUL ST. BALTIMORE, MARYLAND</p>	<p>DEPARTMENT OF PUBLIC WORKS HOWARD COUNTY, MARYLAND P. J. Reed 9-21-76 DIRECTOR OF PUBLIC WORKS - DATE</p> <p>W. O. Lind 9-21-76 CHIEF-BUREAU OF ENGINEERING - DATE</p>	<p>CONTRACT NO. 703-D-W8S</p>	<p>PROFILE OF WATER & SEWER MAINS</p>	<p>COLUMBIA VILLAGE OF OWEN BROWN ELECTION DISTRICT GUILFORD NO. 6</p>	<p>DRAWING NO. 2 OF 2 SCALE H:1"=100' V:1"=10' SEPTEMBER 16, 1976</p>
---	---	-------------------------------	---	--	---

W. O. 2468

As Built 1-6-78

SEPTEMBER 16, 1976