

QUANTITIES	
ITEM	QUANTITY
8" Sewer	924 L.F.

BENCH MARKS	
B.M. # 1	ELEV. 231.91
Spike In Gas Pole # 37475	
B.M. # 2	ELEV. 220.45
Flange Bolt On Fire Hydrant	



GENERAL NOTES

1. Approximate Location of Existing Mains Are Shown. The Contractor Shall Take All Necessary Precautions To Protect Existing Mains And Services And Maintain Uninterrupted Supply.
2. All Pipe Elevations Shown Are Invert Elevations.
3. The Contractor Shall Locate Existing Utilities Well In Advance Of Construction Operations In Vicinity Of Utilities.
4. For All Standard Details See Standards Bound In Specifications.
5. Clear All Utilities By A Minimum of 6'; Clear All Poles By A Minimum of 2'-0" Or Tunnel As Required.
6. The Contractor Shall Provide A Joint In All Sewer Mains Within 2'-0" Of Exterior Manhole Walls.
7. All Manholes To Be 4'-0" Inside Diameter.
8. All Horizontal And Vertical Controls Are Based On Maryland State Datum.
9. All Sewer Mains Shall Be C.S.P.X., V.C.P.X. Or A.C.P. Class 2400 Unless Otherwise Noted.
10. Contractor Shall Remove Trees, Stumps And Roots Along Line Of Excavation As Directed By The Engineer. Payment For Such Removal Shall Be Included In The Unit Price Bid For Excavation And Backfill For Sewer Mains.
11. Trees Are To Be Protected From Damage To Maximum Extent. Trees Located Within The Construction Strip Are Not To Be Removed Or Damaged By The Contractor.
12. Place Regulation "Men Working" And Warning Signs As Required To Comply With Maryland State Highway Administration Manual Of Traffic Control For Highways Construction And Maintenance Operations.

13. Contractor Shall Notify The Following Utilities Or Agencies At Least Five (5) Days Before Starting Work Shown On These Plans:
 State Highway Administration - 531-5533
 Baltimore Gas And Electric Company - Underground Electric Distribution Engineering - Damage Control - 234-5691
 Baltimore Gas And Electric Company - Underground Gas Distribution Engineering - 553-0100
 Chesapeake And Potomac Telephone Company - 725-9076
 American Telephone And Telegraph - Cable Location Division - 301-393-3553
 Colonial Pipeline Company - 781-4641

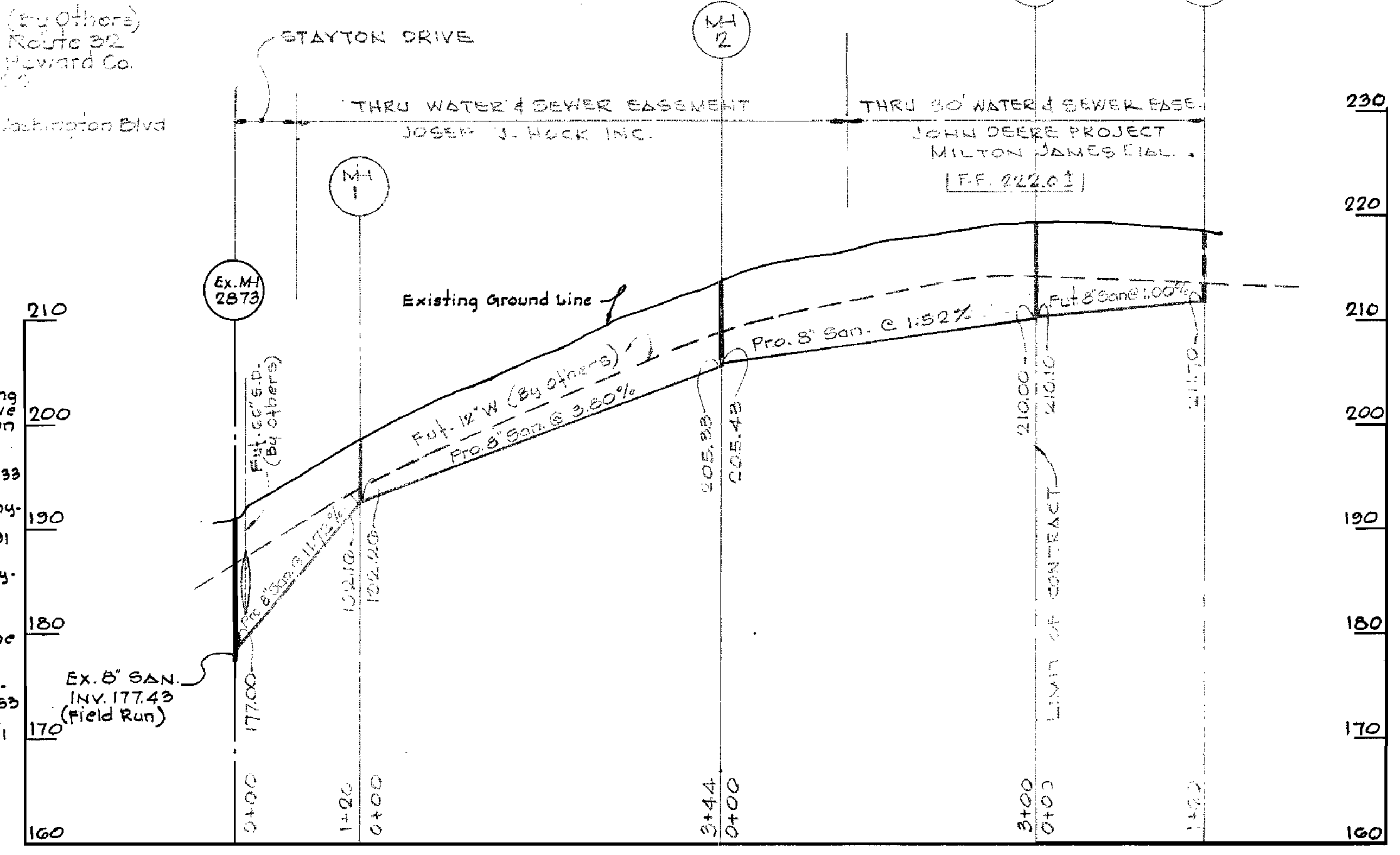

PROFILE



George W. Holdefer #3087

John Deere Project
Md. Route #32
Contract # 2658-D-5

WS 658 S/1

EVANS HAGAN & HOLDEFER INC. SURVEYORS & CIVIL ENGINEERS 8013 BELAIR ROAD BALTIMORE MARYLAND 21236	DEPARTMENT OF PUBLIC WORKS HOWARD COUNTY, MARYLAND <i>William A. Altman</i> 12/10/75 DIRECTOR OF PUBLIC WORKS, DATE	CONTRACT NO. 2658-D-5	PLAN & PROFILE AND LOCATION MAP OF SEWER MAIN EXTENSION	PATUXENT SUB-DISTRICT 6TH ELECTION DISTRICT HOWARD COUNTY, MD.	DRAWING NO. 1	SCALE AS SHOWN
					OF 1	