

GENERAL NOTES

1. Approximate locations of existing utilities are shown. The Contractor shall take all necessary precautions to protect the existing utilities and to maintain uninterrupted service. Any damage incurred due to the Contractor's operation shall be repaired immediately at the Contractor's expense.
2. All pipe elevations shown are invert elevations.
3. The Contractor shall locate existing utilities well in advance of construction activities.
4. See standard details bound in specifications.
5. Clear all utilities by a minimum of 6 inches. Clear all utility poles by 2'-0" minimum or tunnel as required. Any costs incurred to the Contractor for tunneling or bracing poles shall be included in unit prices bid for excavation.
6. The Contractor shall provide a pipe joint in all sewer mains within 2'-0" of exterior manhole walls.
7. All manholes shall be 4'-0" inside diameter, unless otherwise noted.
8. All horizontal and vertical controls are based on the Maryland State Grid System.

BENCH MARKS

P & J BM 3	Elev. 217.52
RR spike in 12" walnut, 10'± S.W. of P.I. "R-3"	
P & J BM 4	Elev. 193.51
RR spike in 15" oak, 19'± E. of P.I. "R-4"	
P & J BM 5	Elev. 177.63
RR spike in 20" oak, 20'± S.E. of P.I. "R-5"	
P & J BM 6	Elev. 194.27
RR spike in 8" poplar, 17'± N.E. of P.I. "R-6"	
P & J BM 7	Elev. 195.48
RR spike in 8" poplar, 5'± N.W. of P.I. "R-7"	

G-P-74-51

HOWARD SOIL CONSERVATION DISTRICT

This development has been approved for soil erosion and sediment control by the HOWARD SOIL CONSERVATION DISTRICT.

APPROVED Robert W. Ziehm 5-29-74
Howard Soil Conservation District Date

Reviewed for Howard Soil Conservation District and meets Technical Requirements

J. Conrad McNeil 5-29-74
U.S. Soil Conservation Service Date

VICINITY MAP

SCALE: 1" = 200'

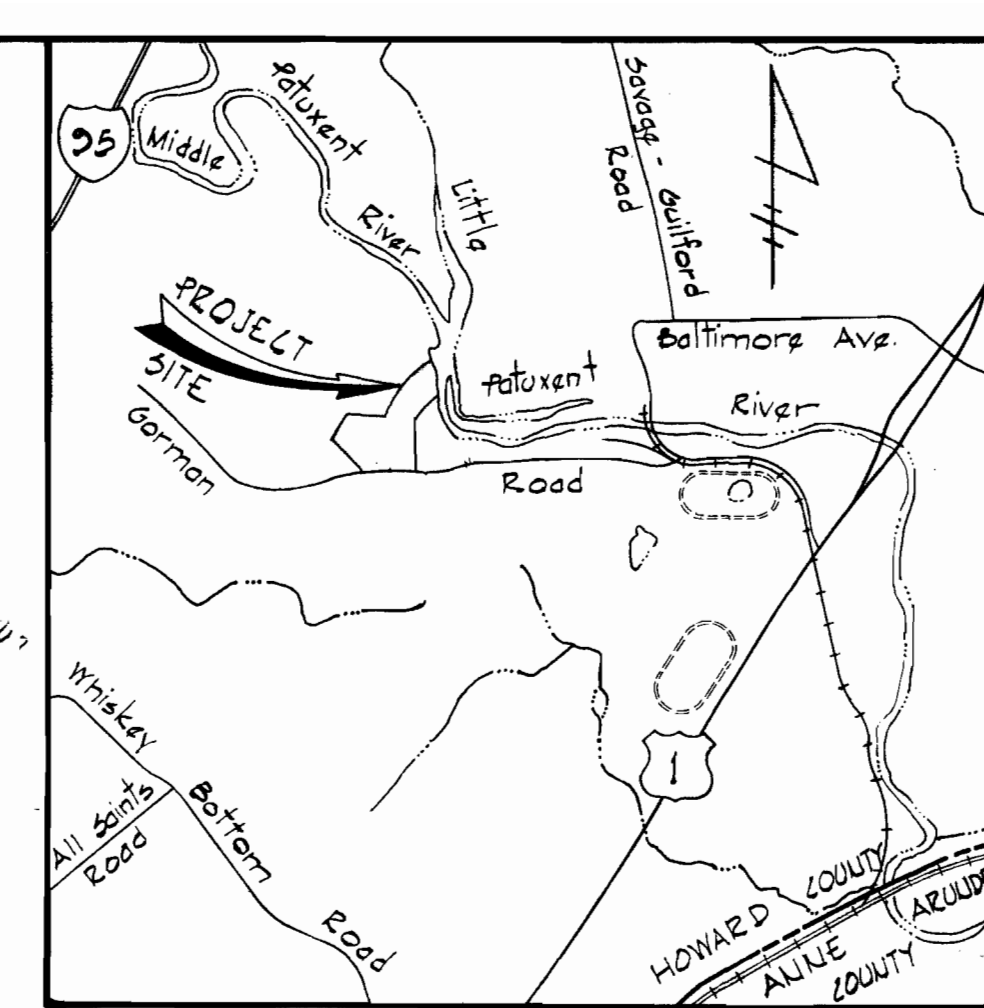

Property of THE ARUDEL CORPORATION 250/583

Property of HOWARD COUNTY, MARYLAND 527/54

NOTE: Contractor shall set top of Manholes 1'-6" above existing ground

NOTE: Contractor shall form channel in Manhole and provide 8" diameter sewer stub up @ 4% and plug

PROFESSIONAL ENGINEER
"I certify that this plan for Erosion and Sediment Control represents a practical and workable plan based upon my personal knowledge of the site condition and that it was prepared in accordance with the requirements of the Howard Soil Conservation District."



Robert W. Ziehm
Reg. No. 3407

QUANTITIES	AS BUILT QUANTITIES
8" SEWER	565 LF 551 LF
8" SEWER	60 LF 60 LF
MANHOLES	37 V.F. 35.65 V.F.

OWNER
I certify that all development and/or construction will be done according to the plan of development and the plan of soil erosion and sediment control.
W O Filbert 5-16-74
Signature Date

CONTRACT NO 2576-5
EV-MAR MOBILE HOME PARK-SAVAGE
SEWER MAIN EXTENSIONS

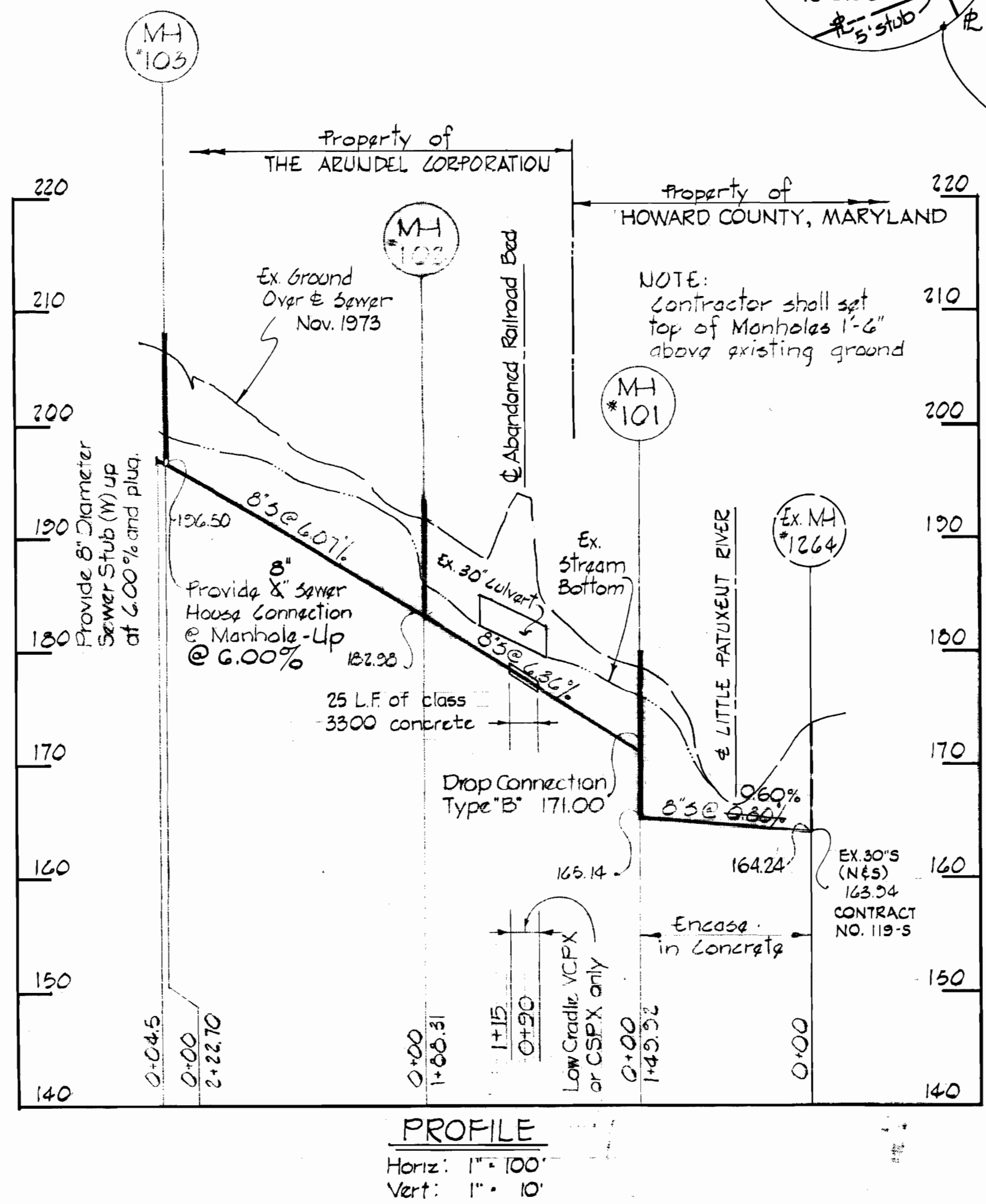

PROFILE
Horiz: 1" = 100'
Vert: 1" = 10'

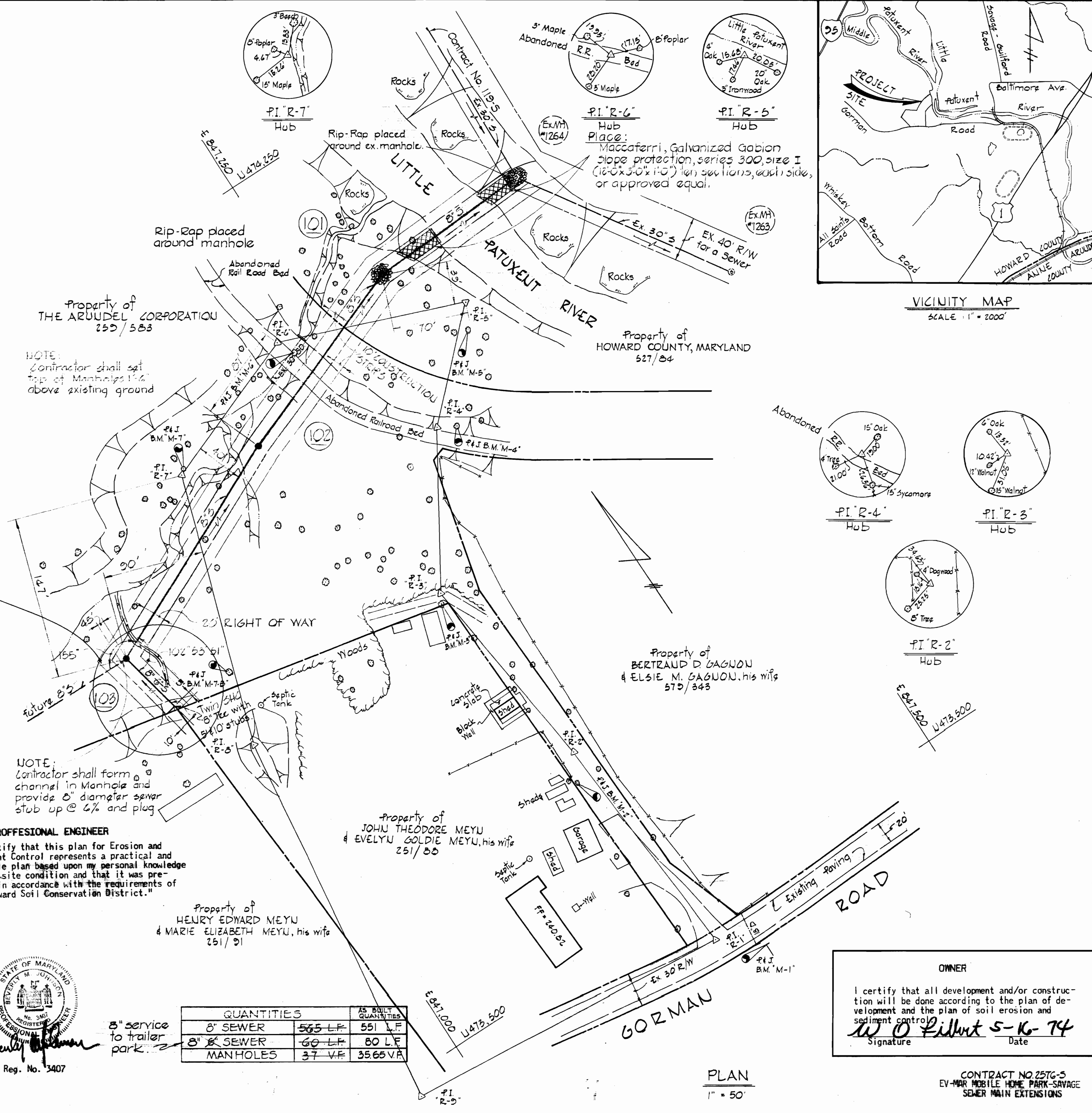

PLAN
1" = 50'

PURDUM & JESCHKE
ENGINEERS
1023 N. CALVERT ST.
BALTIMORE, MARYLAND

DEPARTMENT OF PUBLIC WORKS
HOWARD COUNTY, MARYLAND
5-16-74
W O Filbert
DATE CHIEF-BUREAU OF ENGINEERING

CONTRACT NO. 2576-5

SEWER MAINS
PLAN AND PROFILE

EV-MAR MOBILE HOME PARK-SAVAGE
ELECTION DISTRICT NO. 6 - GUILFORD
HOWARD COUNTY, MARYLAND

DRAWING
NO. 1
OF 1
SCALE
AS SHOWN
Designed: RBW
Drafted: MMW
Checked: TAF