

VICINITY MAP
SCALE 1" = 2,000'

GENERAL NOTES

- 1 APPROXIMATE LOCATION OF EXISTING MAINS ARE SHOWN THE CONTRACTOR SHALL TAKE ALL NECESSARY PRECAUTIONS TO PROTECT EXISTING MAINS AND SERVICES AND MAINTAIN UNINTERRUPTED SUPPLY. ANY DAMAGE INCURRED SHALL BE REPAIRED IMMEDIATELY
- 2 ALL PIPE ELEVATIONS SHOWN ARE INVERT ELEVATIONS
- 3 THE CONTRACTOR SHALL LOCATE EXISTING UTILITIES A MINIMUM OF TWO WEEKS IN ADVANCE OF CONSTRUCTION OPERATIONS IN VICINITY OF UTILITIES
- 4 FOR ALL STANDARD DETAILS SEE STANDARDS BOUND IN SPECIFICATIONS
- 5 CLEAR ALL UTILITIES BY A MINIMUM OF 6" CLEAR ALL POLES BY 2'-0" MINIMUM OR TUNNEL AS REQUIRED.
- 6 THE CONTRACTOR SHALL PROVIDE A JOINT IN ALL SEWER MAINS WITHIN 2'-0" OF EXTERIOR MANHOLE WALLS
- 7 ALL MANHOLES SHALL BE 4'-0" INSIDE DIAMETER
- 8 ALL WATER MAINS TO HAVE A MINIMUM OF 3'-0" COVER UNLESS OTHERWISE NOTED
- 9 BLOCK ALL FITTINGS WITH CONCRETE, SEE STANDARDS BOUND IN SPECIFICATIONS
- 10 BURY LINE ELEVATIONS ON FIRE HYDRANTS SHALL BE SET TO THE ELEVATIONS SHOWN ON THE DRAWINGS.
- 11 ALL FIRE HYDRANTS SHALL BE "TRAPPED TO THE TEE AND SHALL BE BUTTRESSED WITH CONCRETE IN ACCORDANCE WITH STANDARD DETAILS
- 12 PERMANENT BENCHMARK SQUARE CUT IN TOP OF CURB IN CENTER OF SOUTH SIDE OF ENTRANCE CURB TO SCHOOL ON EAST SIDE OF NORTH LAUREL ROAD BM ELEVATION 235.92.

CONSTRUCTION B.M. - TRAVERSE STA 403 TOP OF STAKE ELEV 215.75 (CONT NO 491-D-W&S) (SEE NOTE 12)

NOTES - WATER LINE
 (2) Existing 8" Water Line was 4'-0" To the Left

NOTES - SEWER LINE
 (1) Placed 39 of 6" 2400 ACP in order to clear Flood Rain Also placed CL I Rip Rap for protection

CONNECT TO EXISTING MH SEE NOTE BELOW

CONSTRUCTION B.M. - TRAVERSE STA 506 TOP OF STAKE ELEV 217.54 (CONT NO 491-D-W&S) (SEE NOTE 12)

CONSTRUCTION B.M. - TRAVERSE STA 500 TOP OF STAKE ELEV 217.40 (CONT NO 491-D-W&S) (SEE NOTE 12)

QUANTITIES	
6" W	1105 LF
8" S	236 82 LF
F H	3 EA
6" SHC	224 LF

NOTE FOR EXISTING MANHOLES SEE CONTRACT NO 491-D-W&S, DWG 1 OF 4 PREPARED BY JEROME J NORRIS & ASSOCIATES (APPROVED BY HOWARD COUNTY DRW ON 7/27/72)

FOR INFO SEE FIELD BOOK No 53

PLAN SCALE 1" = 50'

REVISIONS	
7-24-73	Rev Quantities
7-24-73	Add Perm B.M.
7-24-73	Change 8" W to 6" W
7-24-73	Relocated F.H.
6-25-73	Relocated MH # 12
6-25-73	Material Added
6-25-73	Relocated F.H.

DEPARTMENT OF PUBLIC WORKS HOWARD COUNTY, MARYLAND 8-6-73 DATE	W.D. Gilbert CHIEF BUREAU OF ENGINEERING	CONTRACT NO. 582-D-W&S	PLAN OF WATER AND SEWER MAINS	SECTION 2, AREA 2 WHISKEY BOTTOM APARTMENTS 6TH ELECTION DISTRICT, HOWARD COUNTY, MD	DRAWING NO. 1 OF 2	SCALE AS SHOWN	DES R.J.L. DRN R.J.L. CKD I.F.J.
---	---	------------------------	----------------------------------	--	--------------------	----------------	--

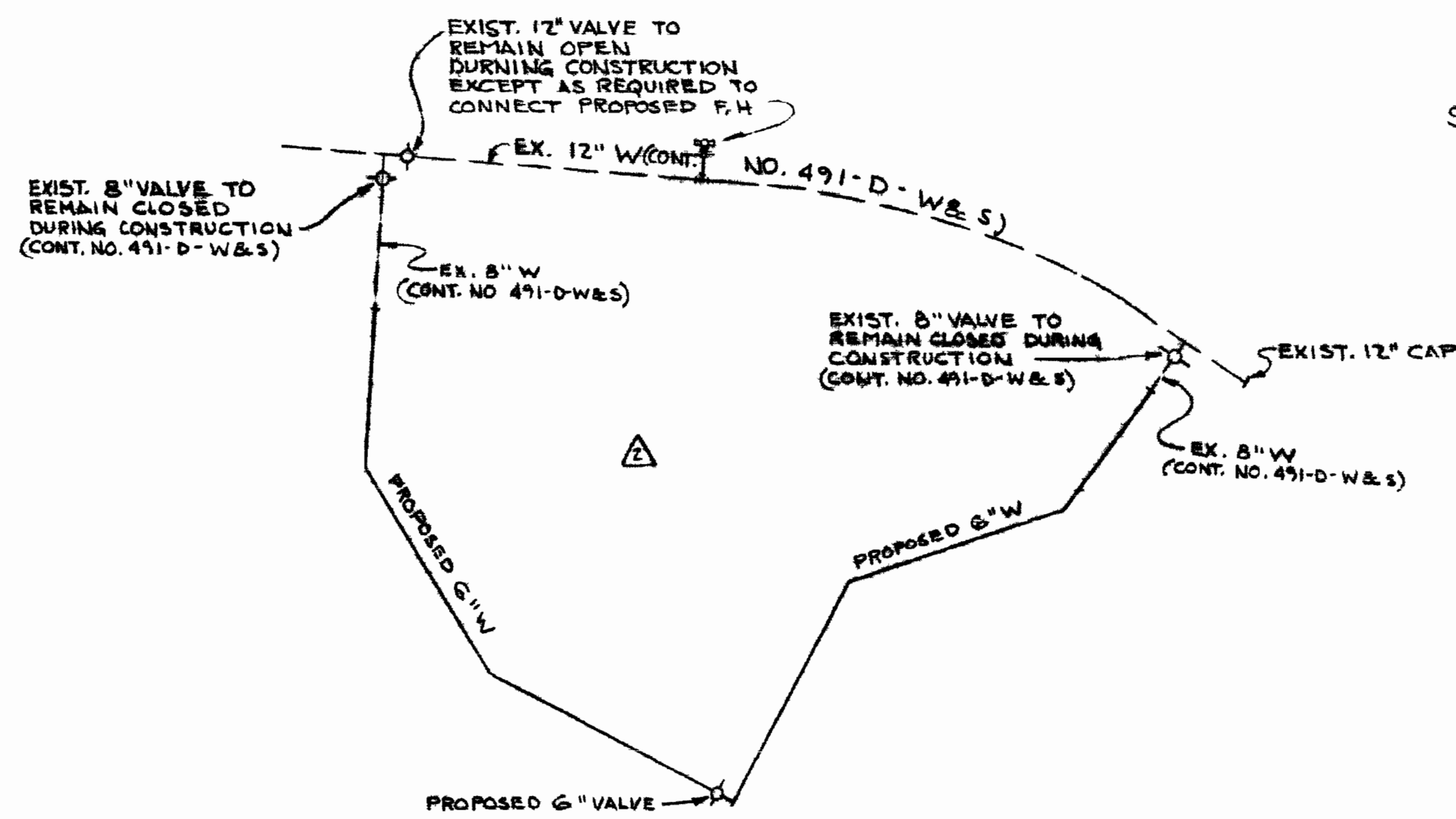
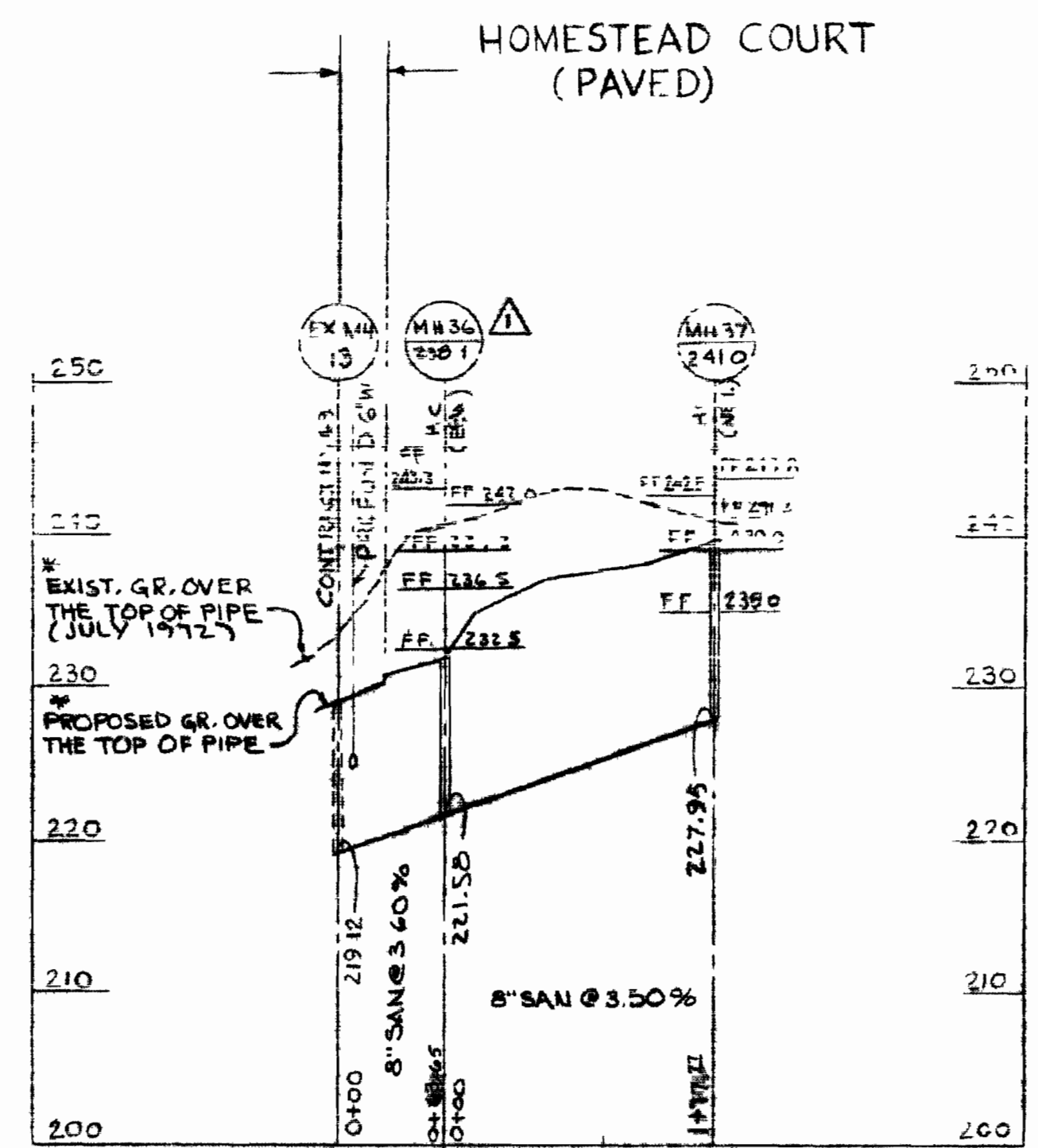
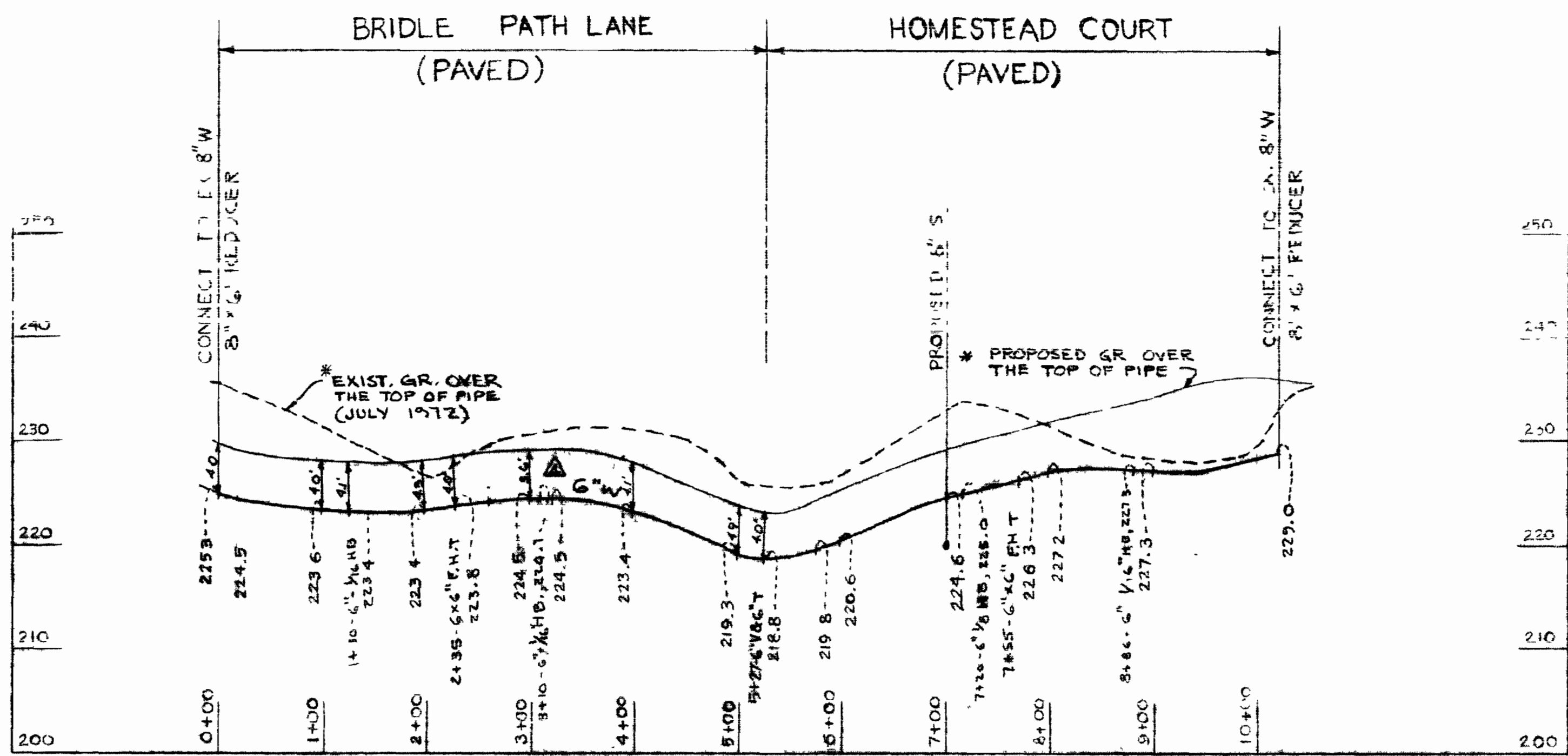

SCALE HORIZ 1"=100'
VERT 1"=10'

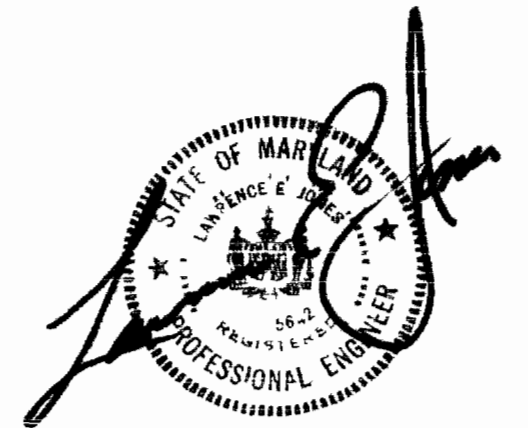
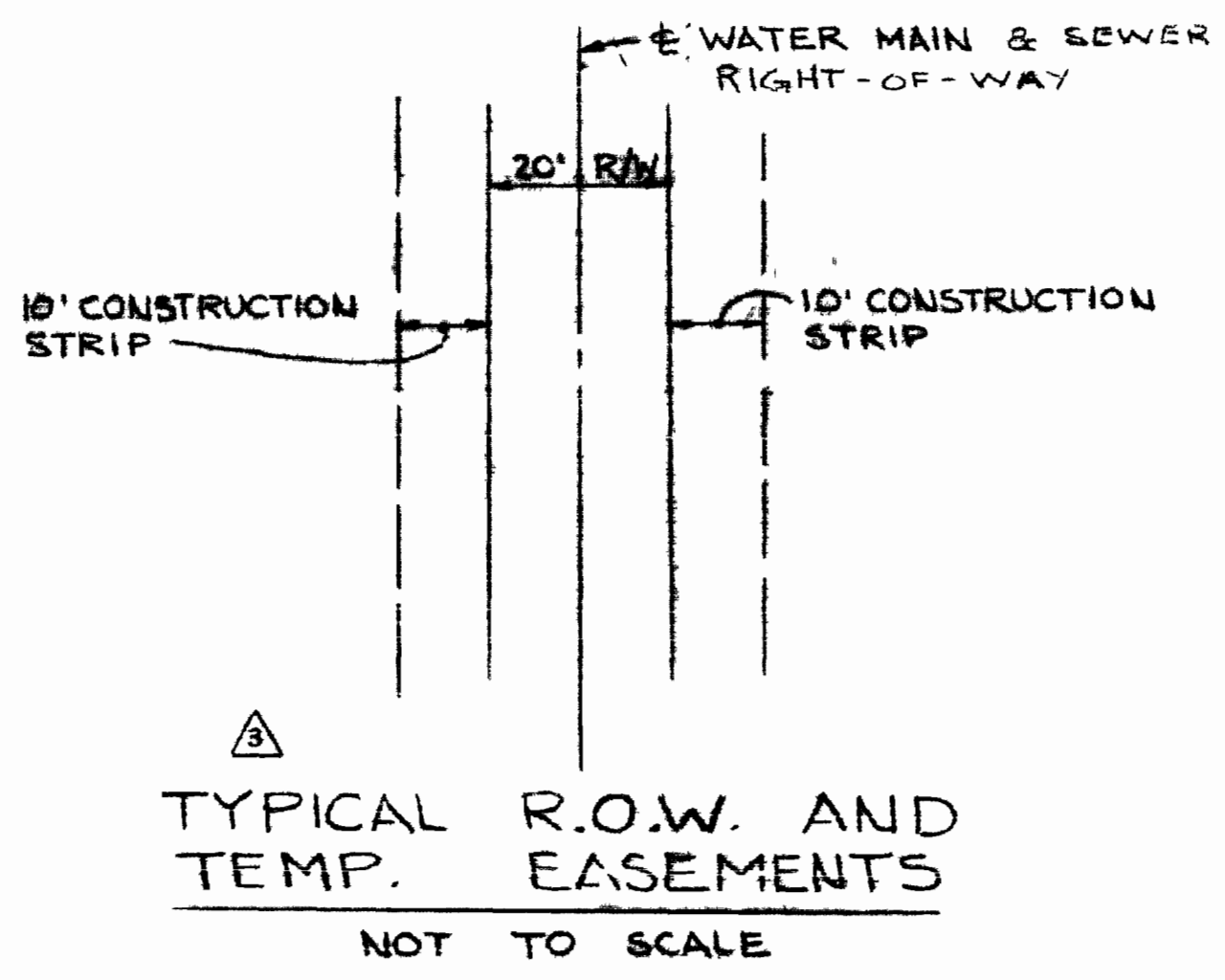

* EXISTING & PROPOSED GRADES ARE TAKEN FROM "SITE AND GRADING PLAN" DATED JULY 3, 1972, DRAWING NO S-3 OF 12, (CONTRACT NO 49) PREPARED BY JEROME J. NORRIS & ASSOCIATES

SKETCH SHOWING WATER VALVES TO BE CLOSED DURING CONSTRUCTION
NOT TO SCALE

REVISIONS	
▲	7-24-73 Change 8" W to 6" W
▲	6-25-73 Easement Detail Added
▲	6-25-73 Schematic Added
▲	6-25-73 Relocated MH 56

WHISKEY BOTTOM APARTMENTS
CONTRACT NO. 562-D-W&S

DEPARTMENT OF PUBLIC WORKS HOWARD COUNTY, MARYLAND 8-6-73 DATE	 W. O. Ballard CHIEF BUREAU OF ENGINEERING	CONTRACT NO. 562-D-W&S	WATER MAINS - SANITARY SEWERS PROFILES	SECTION 2, AREA 2 WHISKEY BOTTOM APARTMENTS 6TH. ELECTION DISTRICT, HOWARD COUNTY, MD.	DRAWING NO. 2 OF 2	SCALE AS SHOWN	DES. R.J.T. DRW. A.G. CHD. L.E.J.
					DATE 5-10-73 REV. 6-25-73 & 7-24-73		