

VICINITY MAP
Scale: 1"=800'

GENERAL NOTES

1. Approximate location of existing mains are shown. The Contractor shall take all necessary precautions to protect existing mains and services and maintain uninterrupted supply. Any damage incurred shall be repaired immediately.
2. All pipe elevations shown are invert elevations.
3. The Contractor shall locate existing utilities a minimum of two weeks in advance of construction operations in vicinity of utilities.
4. For all standard details see standards bound in Specifications.
5. All horizontal and vertical controls are based on Maryland State Datum.
6. Clear all utilities by a minimum of 6'; Clear all poles by a minimum of 8' or tunnel as required.
7. All water mains to be C.I.P. or D.I.P. and have a minimum of 3/4' cover.
8. Block all fittings with concrete, see standards bound in Specifications.
9. All fire hydrants shall be strapped and buttressed in accordance with Standard Details.
10. Cost of strapping fire hydrants and valves to trees to be included in unit price bid for furnishing and laying of water mains.
11. Bury Line elevations on fire hydrants shall be set to elevations shown on drawings or as directed by the Engineer in the field.
12. All W.L.C. to be 1" diameter unless otherwise noted.
13. All sewer pipe to be V.C.P.X., C.S.P.X. or A.C.P. Class 2400 unless otherwise noted.
14. All manholes shall be 4' inside diameter.
15. The Contractor shall provide a joint in all sewer mains within 2' of exterior manhole walls.

QUANTITIES	
8" Sewer	2430
8" Water	500
6" Water	1500
12" Water	140
Fire Hydrants	2

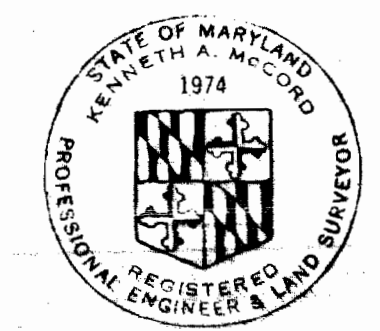

Kenneth A. McLeod

Stakeout and Diary in FB.# 4670
A.C.P. used for sewer
C.I.P. used for water
Note: 5" V opening on FH's used

Village of Oakland Mills
Section 2, Area 4
Howard Homes III
Contract No. C-377 W&S

WHITMAN, REQUARDT & ASSOCIATES ENGINEERS 1304 ST. PAUL ST. BALTIMORE, MARYLAND	DEPARTMENT OF PUBLIC WORKS HOWARD COUNTY, MARYLAND 6-24-70 DATE <i>W. O. Fallick</i> CHIEF-BUREAU OF WATER AND SEWER	CONTRACT NO. C-377 W&S	PLAN OF WATER & SEWER MAINS	COLUMBIA VILLAGE OF OAKLAND MILLS ELECTION DISTRICT GUILFORD No. 6	DRAWING NO. 1 OF 2 SCALE 1"=50'
--	--	-----------------------------------	--	---	--

WS 377-W&S/2

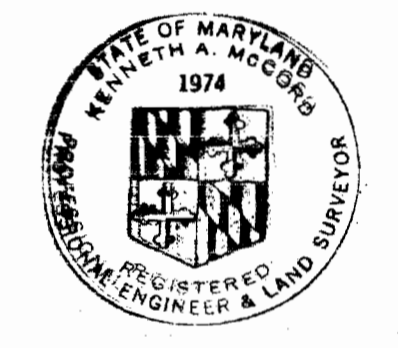
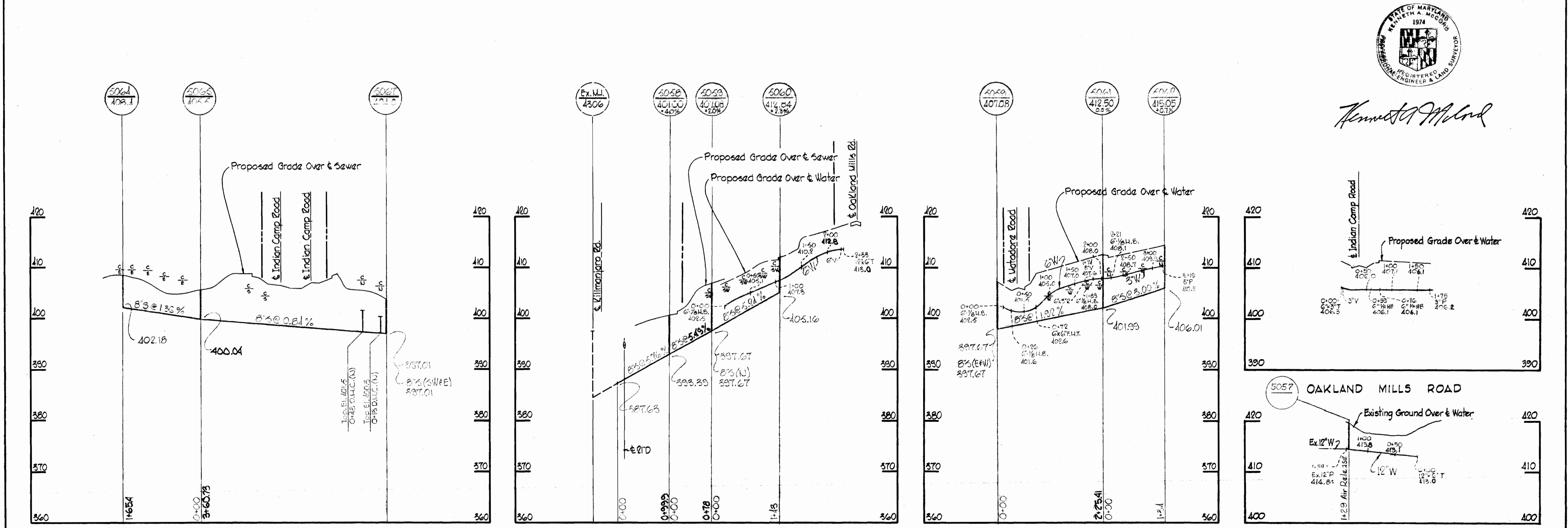
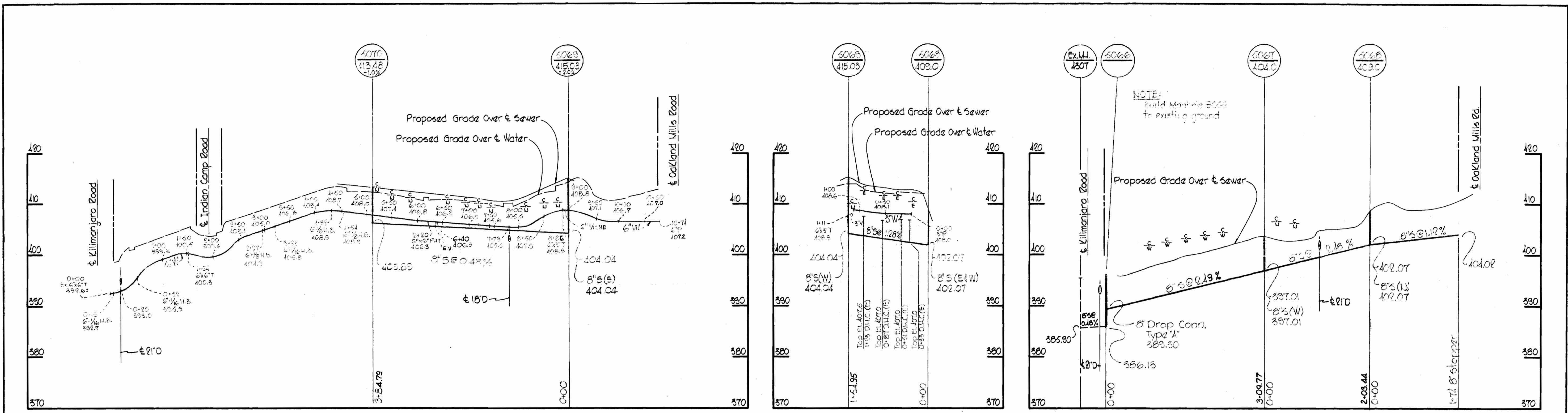

Kenneth A. McLeod

WHITMAN, REQUARDT & ASSOCIATES
ENGINEERS
1304 ST. PAUL ST.
BALTIMORE, MARYLAND

DEPARTMENT OF PUBLIC WORKS
HOWARD COUNTY, MARYLAND
6-24-70
DATE
W. O. Fallick
CHIEF - BUREAU OF WATER AND SEWER

CONTRACT NO. C-377 W&S

PROFILES OF
WATER & SEWER MAINS

COLUMBIA
VILLAGE OF OAKLAND MILLS
ELECTION DISTRICT GUILFORD No. 6

DRAWING
NO. 2
OF 2
SCALE
H: 1"=100'
V: 1"=10'

Village of Oakland Mills
Section 2, Area 1
Howard Home III
Contract No. C-377-W&S