

**GENERAL NOTES**

1. Approximate location of existing mains are shown. The Contractor shall take all necessary precautions to protect existing mains and services and maintain uninterrupted supply. Any damage incurred shall be repaired immediately.
2. All pipe elevations shown are invert elevations.
3. The Contractor shall locate existing utilities a minimum of two weeks in advance of construction operations in vicinity of utilities.
4. For all standard details see standards bound in Specifications.
5. All water mains to be C.I.P. or D.I.R. and have a minimum of 3 1/2' cover.
6. Block all fittings with concrete, see standard details bound in Specifications.
7. Buryline elevations on fire hydrants shall be set to elevations shown on drawings.
8. All fire hydrants shall be strapped to the tee and shall be buttressed with concrete in accordance with Standard Details.
9. Clear all utilities by a minimum of 6', clear all poles by 2'-0" minimum or tunnel as required.
10. The Contractor shall provide a joint in all sewer mains within 2'-0" of exterior manhole walls.
11. All sewer pipe shall be VCPX, CSPX, or ACP Class 2400.
12. All Water Service Connections shall be 1" dia. unless otherwise noted.

NOTE:  
 Rim Elevations and Bury Line Elevations were developed from Proposed Contours shown on "Purdum & Jeschke - Grading Plan for Townhouse Apartments - Resubdivision of Lots 94 & 95 - Section 5 - Faulkner, Ridge, Dated July 11, 1968."

Note: All dimension for Lot 94 for sewer are from the party wall or face of building

QUANTITIES	
6" Water Main	1820'
8" Sewer Main	2000'
3" Water Main	400'

MATERIALS TO BE FURNISHED BY THE COMMISSION	
ITEM	QUANTITY
6" V	1
FH	2
12"x6" T.S. IV	2
3" V	3

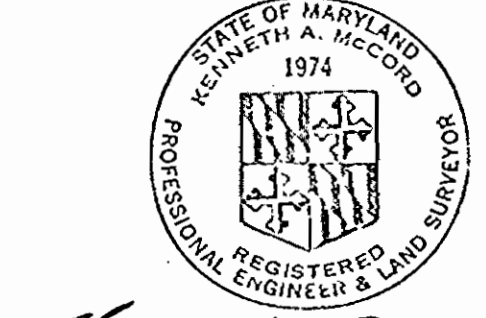

*Kenneth A. Maland*  
 Faulkner Station  
 Contract No. C-273-W15

WHITMAN, REQUARDT & ASSOCIATES ENGINEERS 1304 ST. PAUL ST. BALTIMORE, MARYLAND	HOWARD COUNTY METROPOLITAN COMMISSION 11-4-69 DATE	CONTRACT NO. C-273 W8S CHIEF ENGINEER	PLAN OF WATER & SEWER MAINS COLUMBIA VILLAGE OF WILDE LAKE ELECTION DISTRICT CLARKSVILLE No.5	DRAWING NO. 1 OF 2 SCALE 1" = 50'
---	--	--	---	--------------------------------------

WS 273-WS/1



FAULKNER RIDGE CIRCLE

MINI BUS ROUTE

JASON LAKE

Note: Cost for furnishing and placing erosion checks & friction blocks shall be included in the appropriate unit prices bid for excavation and backfill.

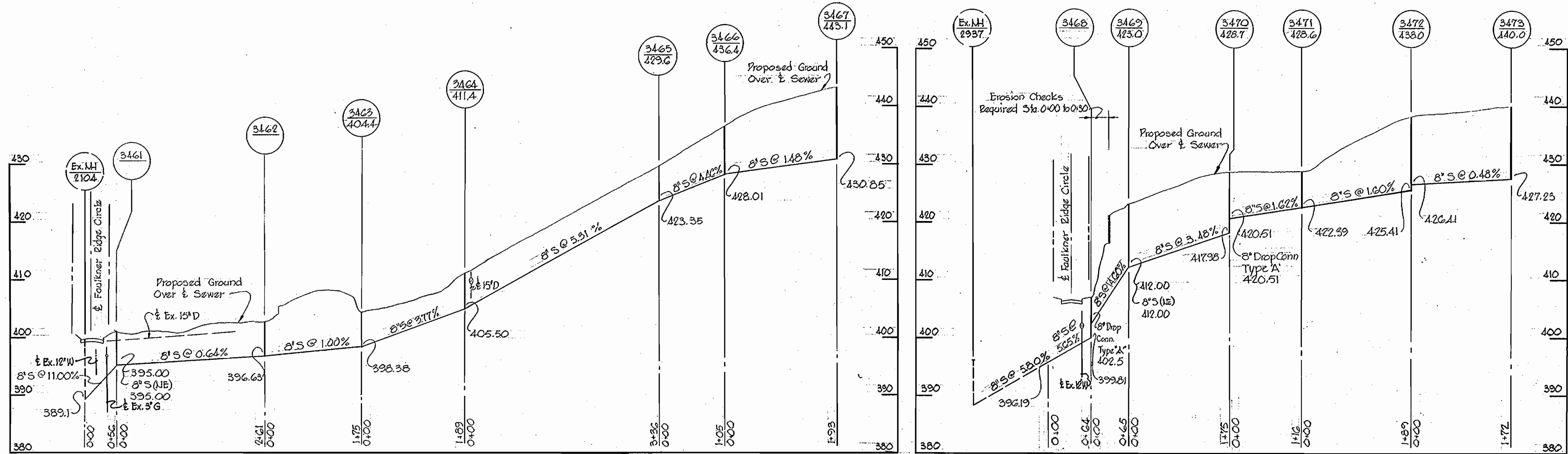

JASON LAKE

TOLLING CLOCK WLY

JASON LAKE

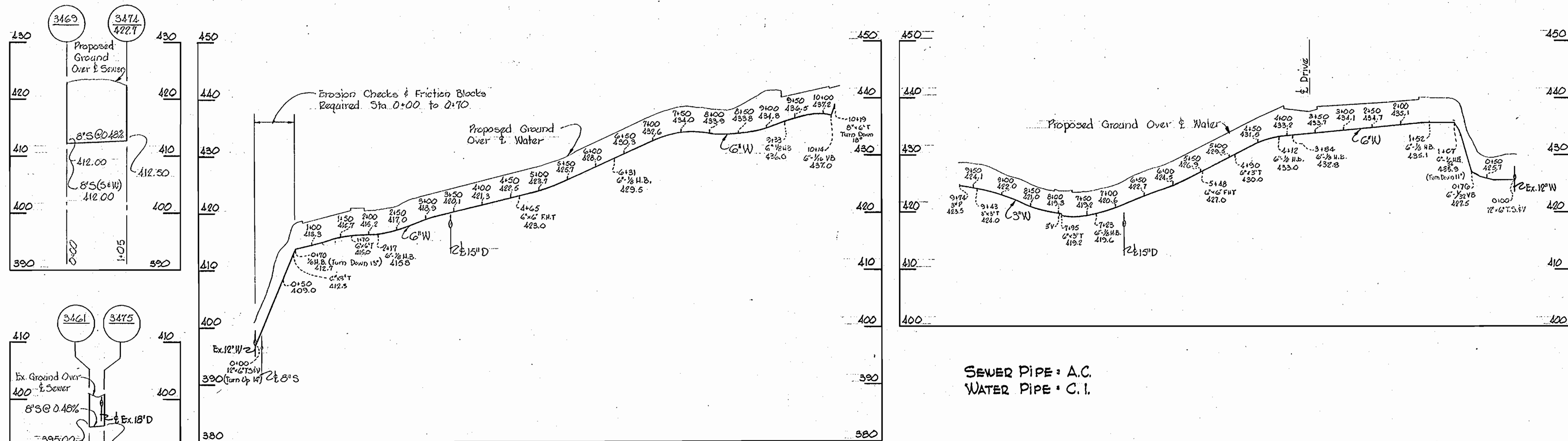

SEWER PIPE - A.C.  
WATER PIPE - C.I.



Kenneth A. McLeod

WHITMAN, REQUARDT & ASSOCIATES  
ENGINEERS  
1304 ST. PAUL ST.  
BALTIMORE, MARYLAND

HOWARD COUNTY METROPOLITAN COMMISSION

11-4-68 W O Fulbert  
DATE CHIEF ENGINEER

CONTRACT NO. C-273 W&S

PROFILES OF  
WATER & SEWER MAINS

COLUMBIA  
VILLAGE OF WILDE LAKE  
ELECTION DISTRICT CLARKSVILLE No.5

DRAWING NO. 2 OF 2  
SCALE H:V = 1:100  
V:1" = 10'

W. O. 6023-2

JANUARY 28, 1969  
AS BUILT

WS 273-WS/2