

VICINITY MAP  
Scale: 1" = 1/2 mile

**BENCH MARKS**

W.R. & A. B.M. #13-A Elev. 431.35  
R.R. Spike in C.&P. Pole #226247  
in front of house #440 Mount  
Hebron Drive.

W.R. & A. B.M. #13-Z Elev. 478.55  
R.R. Spike in base of C.&P. Pole  
#125 at intersection of Route 99  
and Mount Hebron Drive.

PLAN  
Scale: 1" = 50'

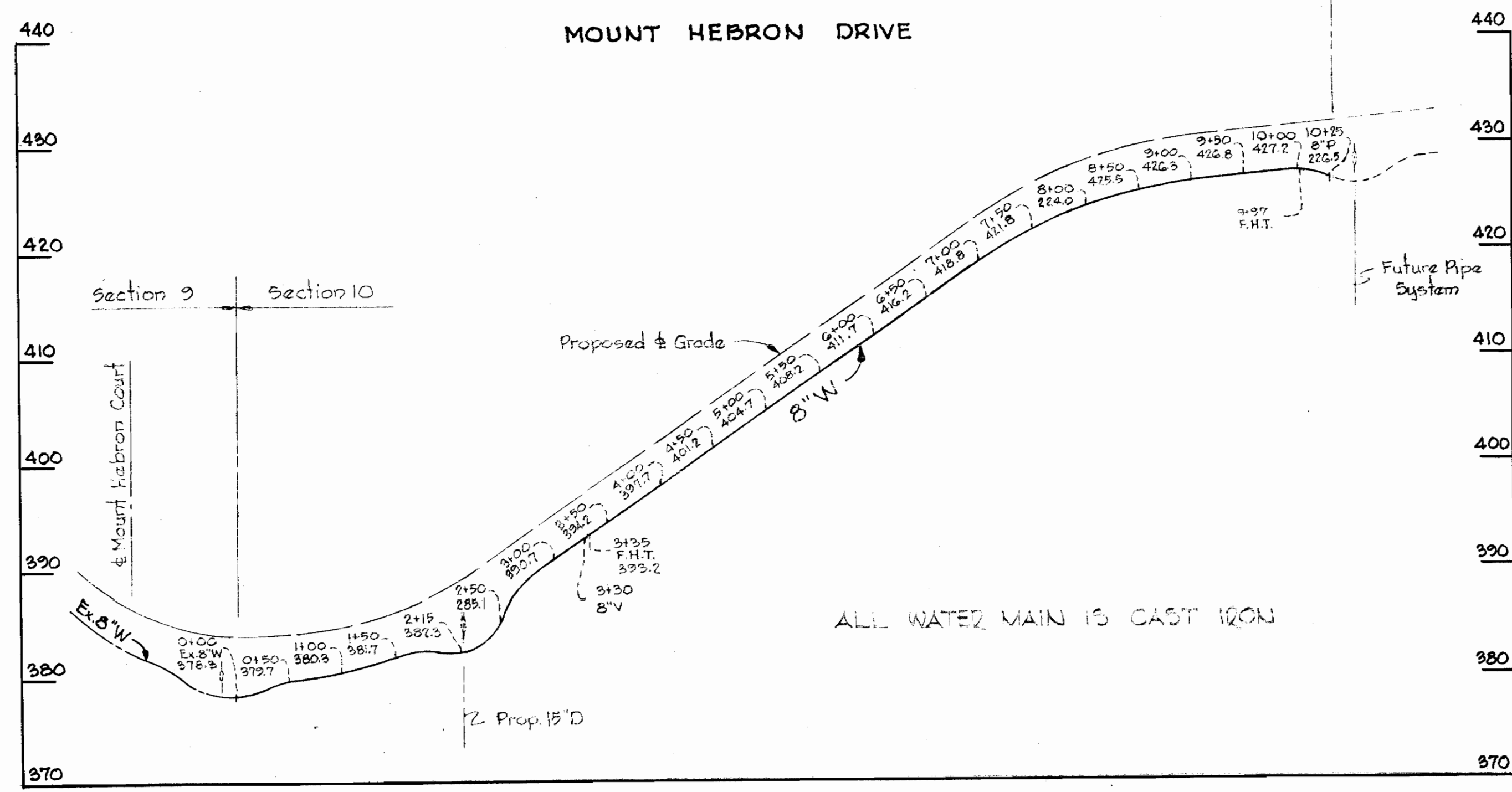

PROFILE  
Scale: Hor. 1" = 100'  
Vert. 1" = 10'

**GENERAL NOTES**

1. Approximate locations of existing mains are shown. The Contractor shall take all necessary precautions to protect existing mains and services and maintain uninterrupted service. Any damage incurred shall be repaired immediately.
2. All pipe elevations shown are invert elevations.
3. The Contractor shall locate existing utilities a minimum of two weeks in advance of construction operations in vicinity of utilities.
4. For all standard details see standards bound in Specifications.
5. All water mains to be C.I.P. or D.I.P. and have a minimum of 3 1/2' cover.
6. Block all fittings with concrete, see standard details bound in Specifications.
7. Bury Line elevation on fire hydrants shall be set to the elevations shown on the drawings.
8. All Fire Hydrants shall be buttressed with concrete in accordance with Standard Detail W-4.
9. Clear all utilities by a minimum of 6'; clear all poles by 2'-0" minimum or tunnel as required.

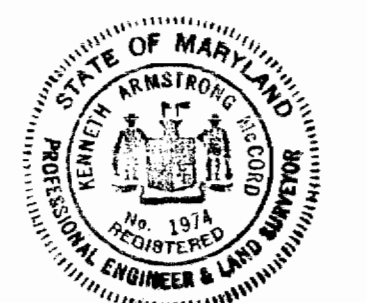

*Kenneth A. McLeod*

Mount Hebron Section No. 10  
Contract 233-W

WHITMAN, REQUARDT & ASSOCIATES  
ENGINEERS  
1304 ST. PAUL ST.  
BALTIMORE, MARYLAND

HOWARD COUNTY METROPOLITAN COMMISSION  
2-29-68  
DATE  
*W. O. Filler*  
CHIEF ENGINEER

CONTRACT NO. 233-W

PLAN AND PROFILE OF  
WATER MAINS

ELECTION DISTRICT  
ELLCOTT CITY NO. 2

DRAWING NO. 1 OF 1  
SCALE AS SHOWN

5 NW 41  
4 NW 41

233 W/1