

- ### GENERAL NOTES
1. Approximate location of existing mains are shown. The Contractor shall take all necessary precautions to protect existing mains and services and maintain uninterrupted supply. Any damage incurred shall be repaired immediately.
  2. All pipe elevations shown are invert elevations.
  3. The Contractor shall locate existing utilities a minimum of two weeks in advance of construction operation in vicinity of utilities.
  4. For all standard details see standards bound in Specifications.
  5. All water mains to be C.I.P. or D.I.P. and have a minimum of 3 1/2' cover.
  6. Block all fittings with concrete, see standard details bound in Specifications.
  7. Bury line elevations on Fire Hydrants shall be set to the elevations shown on drawings.
  8. All Fire Hydrants to be buttressed with concrete in accordance with Standard Detail W-4.
  9. Clear all utilities by a minimum of 6", clear all poles by 2'-0" minimum or tunnel as required.
  10. The Contractor shall provide a joint in all sewer mains within 2'-0" of exterior manhole walls.
  11. All manholes shall be 4'-0" inside diameter.

### BENCH MARKS

WR.F.A. BM# 51C-4 Elev. 417.46  
RR spike in root of 40' oak 225' S of intersection of Chatham Road & Dunloggin Road on west side of Chatham Road.

WR.F.A. BM# 51C-2 Elev. 393.89  
RR spike in base of Gt E pole #185714, 2' left of sta. 0+20 between Pl.'s 5 & 6.

WR.F.A. BM# 41 Elev. 336.309  
RR spike on side of 24" Twin Oak, 23' South of Existing Sewer M#1476.

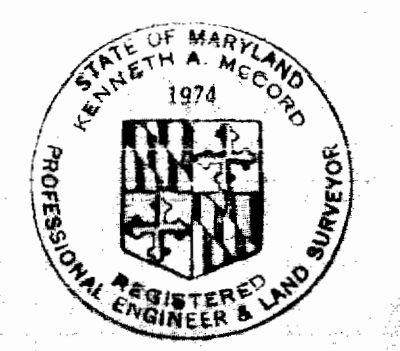

*Kenneth A. Whitman*

Dunloggin II Section I  
Contract 229 W&S

<b>WHITMAN, REQUARDT &amp; ASSOCIATES</b> ENGINEERS 1304 ST. PAUL ST. BALTIMORE, MARYLAND	<b>HOWARD COUNTY METROPOLITAN COMMISSION</b> DATE: 2-15-68 <i>W. O. G. 24-2</i> CHIEF ENGINEER	<b>CONTRACT NO. 229-W&amp;S</b>	<b>PLAN OF WATER &amp; SEWER MAINS</b>	<b>ELECTION DISTRICT ELLICOTT CITY NO. 2</b>	<table border="1"> <tr> <td><b>DRAWING NO. 1 OF 2</b></td> <td><b>SCALE AS SHOWN</b></td> </tr> </table>	<b>DRAWING NO. 1 OF 2</b>	<b>SCALE AS SHOWN</b>
<b>DRAWING NO. 1 OF 2</b>	<b>SCALE AS SHOWN</b>						

1/5W-477 CM

MEADOW HILL ROAD

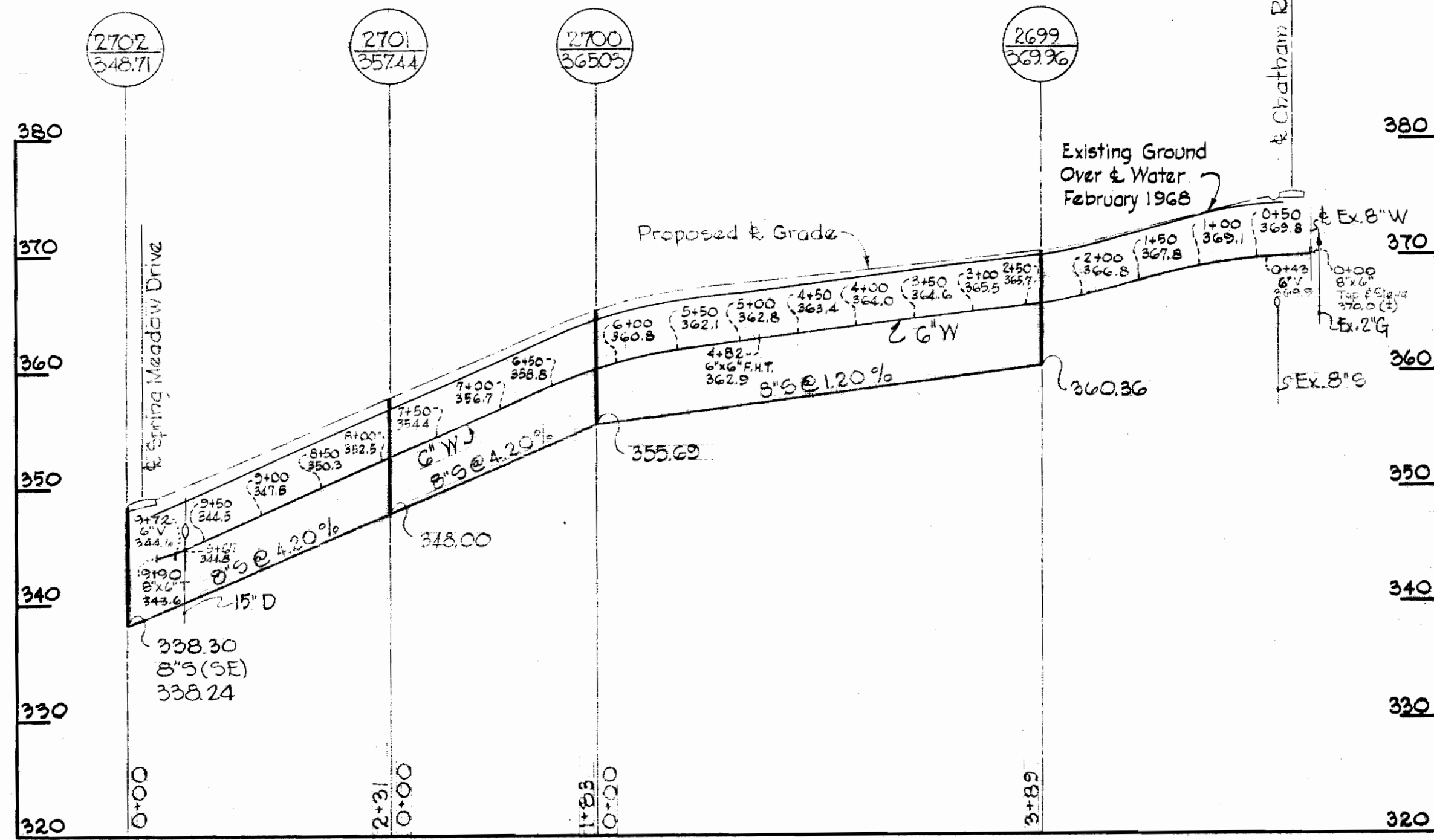

SPRING MEADOW DRIVE

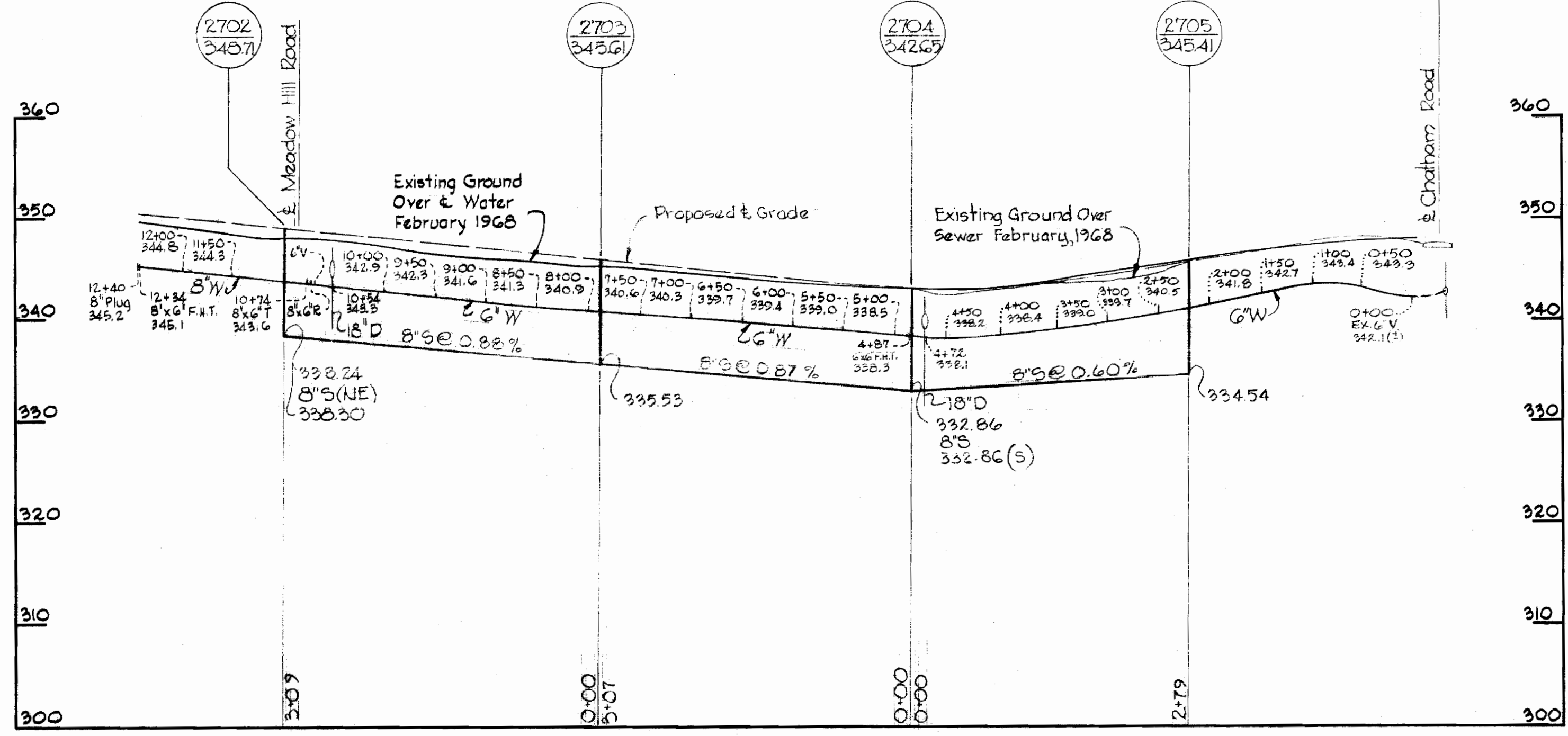

OUTFALL THRU LOT 6

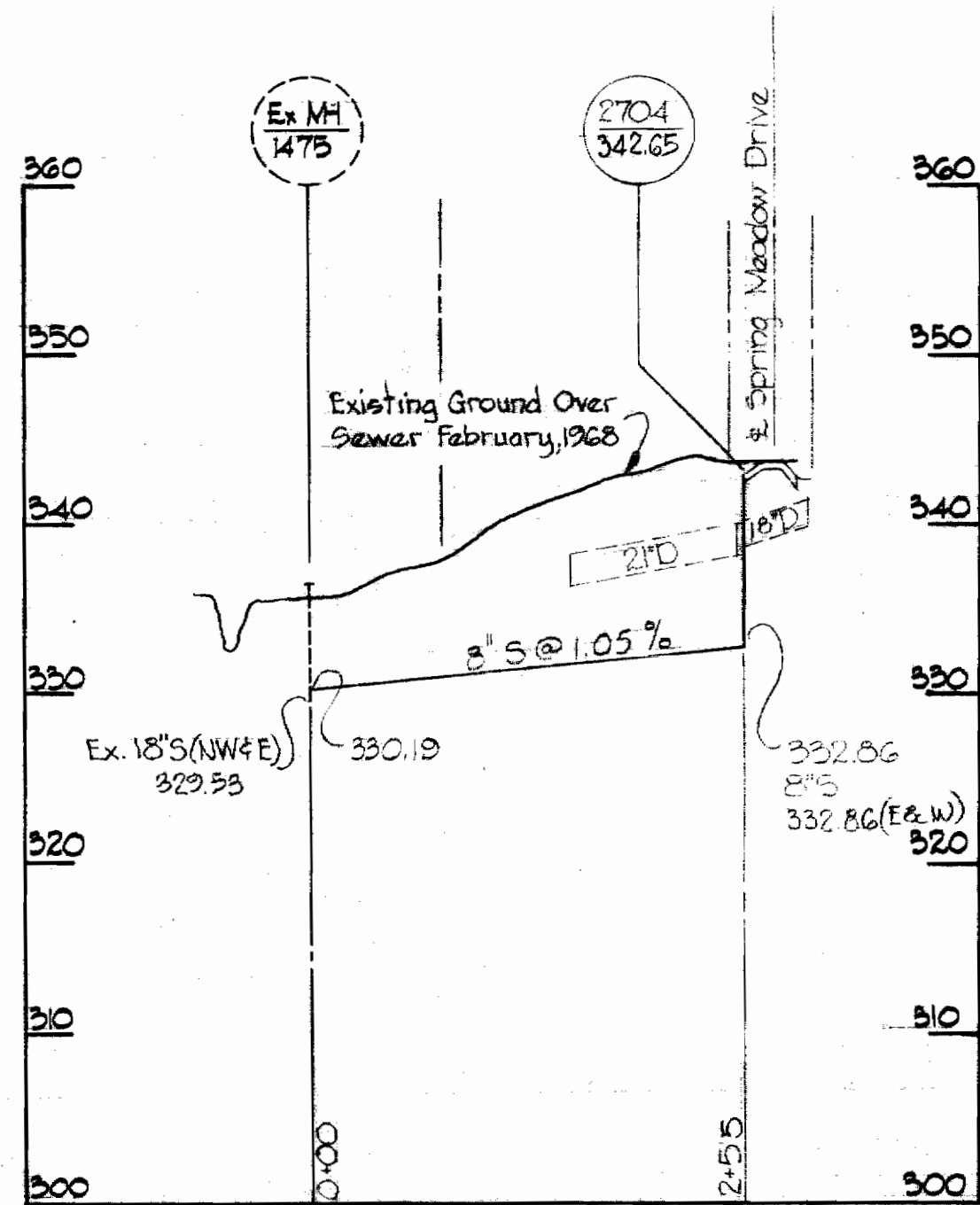

CHATHAM ROAD

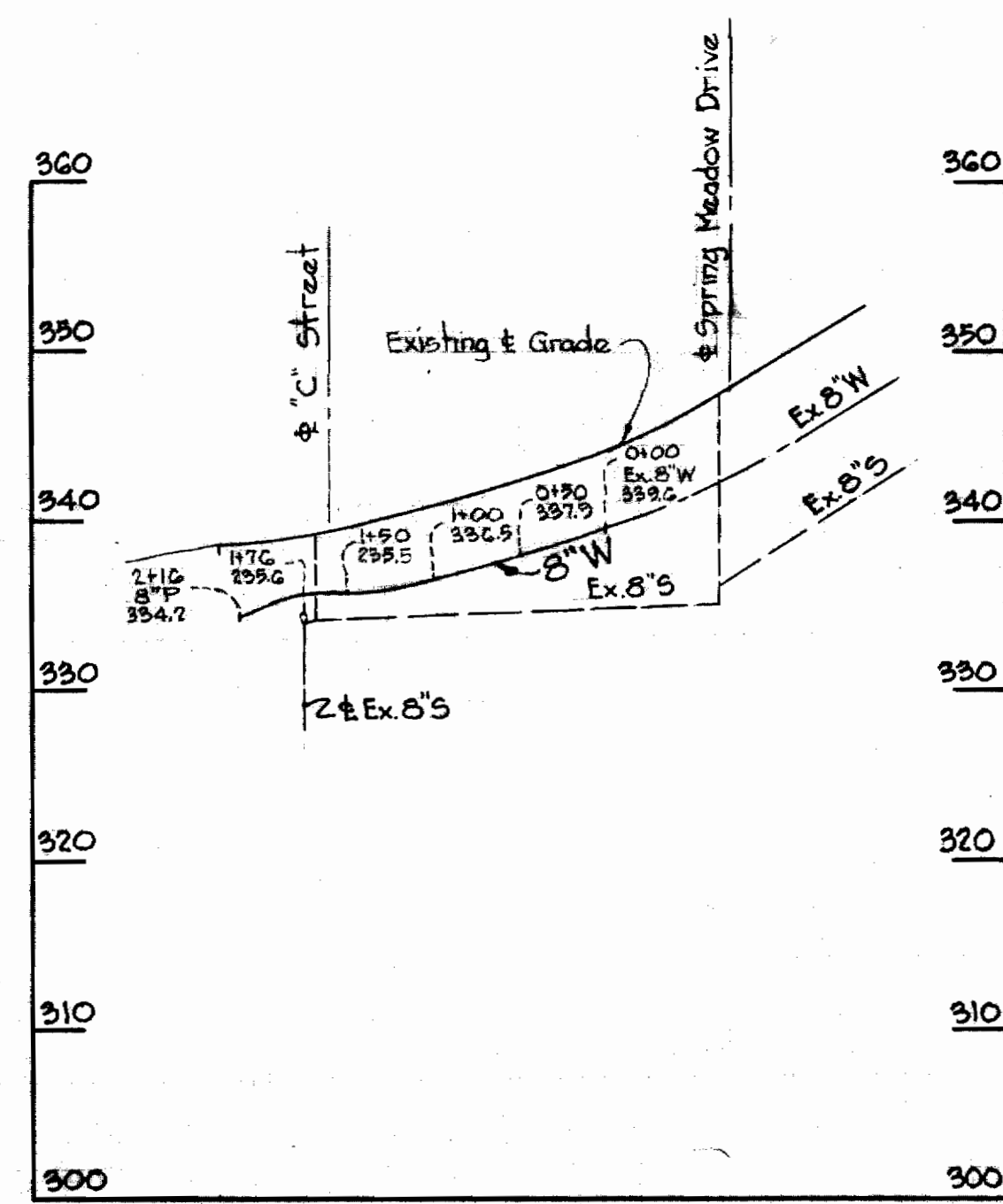

Note: All sewer pipe A.C. All water pipe C.I.  
Stakeout & Diary in #B. 410B.



*Kenneth A. McCord*

Dunloggin II Section I  
Contract 229 W&S

WHITMAN, REQUARDT & ASSOCIATES  
ENGINEERS  
1304 ST. PAUL ST.  
BALTIMORE, MARYLAND

HOWARD COUNTY METROPOLITAN COMMISSION  
2-15-68  
DATE  
*W. O. Pickett*  
CHIEF ENGINEER

CONTRACT NO. 229 W&S

PROFILES OF  
WATER & SEWER MAINS

ELECTION DISTRICT  
ELLCOTT CITY NO. 2

DRAWING  
NO. 2  
OF 2  
SCALE  
H-1"=100'  
V-1"=10'

AS BUILT JUNE 24, 1968

WS 229-WS/2