

VICINITY MAP
Scale: 1" = 1/2 mile

QUANTITIES	
ITEM	QUANTITIES
8" Sewer	5738'

WREA B.M.#8 Elev. 377.56'
P.U.T.T. in top stone headwall 2.75'
between P.I. AB-13 + P.I. AB-14 23' Lt.

NOTE:
The Contractor shall notify the Colonial Pipeline Company 72 hours in advance of excavation in the vicinity of the Colonial Pipeline R/W by calling: Colonial Division Office, Richmond, Va. Area Code 703, 282 9771; or Mr. S.H. Crumlich, Area Supervisor, Baltimore, Md. 787-2295

WREA B.M.#7 Elev. 397.09'
SW cor. stone culvert entrance SW side of Diamondback Rd. 1400' between P.I. AB-12 and 5-106, 25' Lt.

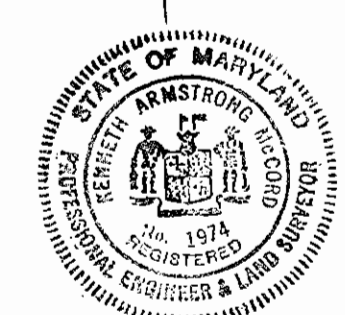
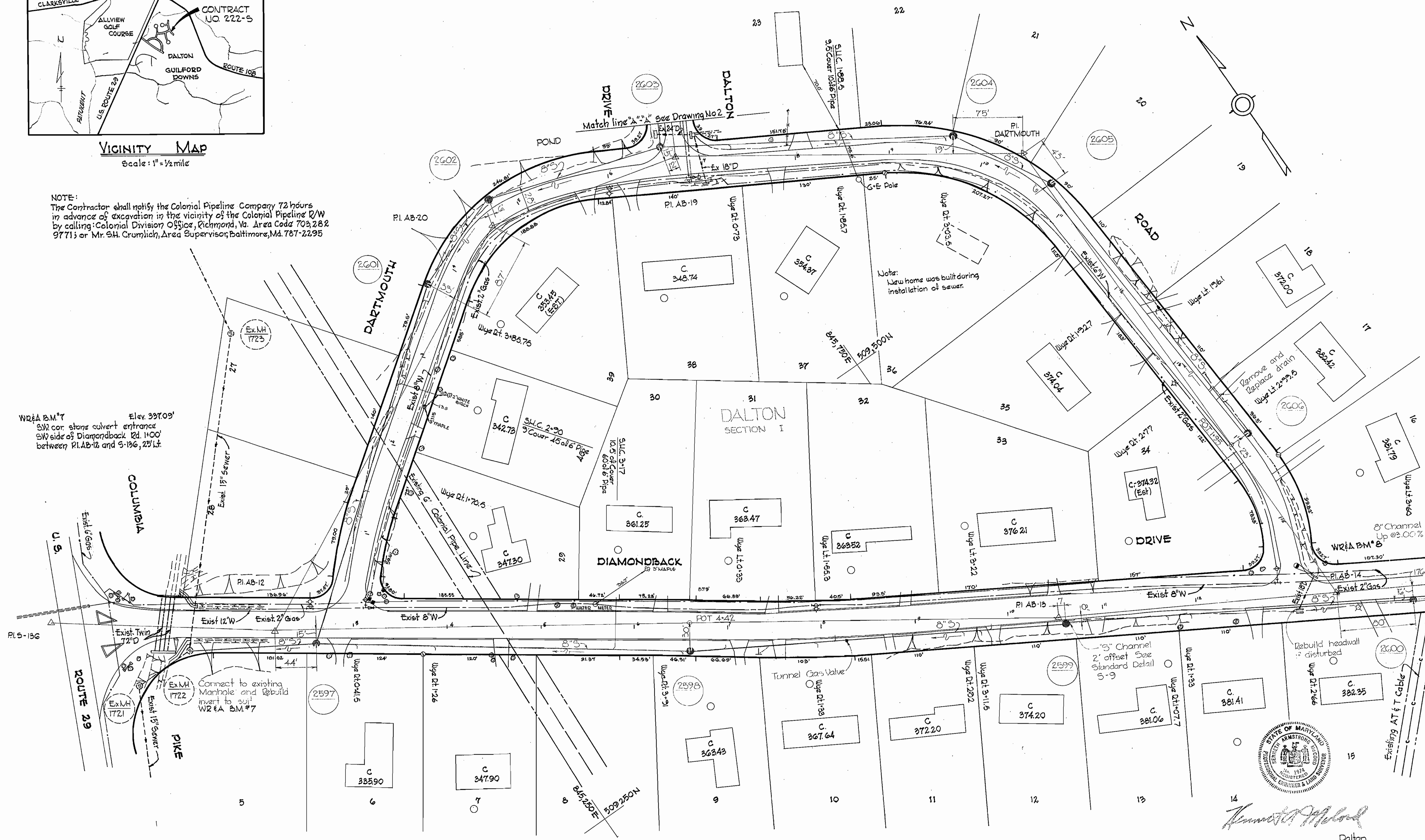

Howard W. O. G. 2021-2

Dalton Contract No. 222-S

WHITMAN, REQUARDT & ASSOCIATES ENGINEERS 1304 ST. PAUL ST. BALTIMORE, MARYLAND	HOWARD COUNTY METROPOLITAN COMMISSION 2-1-68 <i>W O G</i> DATE CHIEF ENGINEER	CONTRACT NO. 222-S	PLAN OF SEWER MAINS	ELECTION DISTRICT GUILFORD NO. 6	DRAWING NO. 1 OF 4	SCALE 1"=50'
---	---	--------------------	---------------------	----------------------------------	--------------------	--------------

W. O. G. 2021-2

OCT. 16, 1968 FB 2621

AS BUILT

WS 222-5/1

GENERAL NOTES

1. Approximate location of existing mains are shown. The Contractor shall take all necessary precautions to protect mains and services and maintain uninterrupted supply. Any damage incurred shall be repaired immediately.
2. All pipe elevations shown are invert elevations.
3. The Contractor shall locate existing utilities a minimum of two weeks in advance of construction operations in vicinity of utilities.
4. For all standard details see standards bound in Specifications.
5. Clear all utilities by a minimum of 6', clear all poles by 2'0" minimum or tunnel as required.
6. The Contractor shall provide a joint in all sewer mains within 2'0" of exterior manhole walls.
7. All manholes shall be 4'0" inside diameter.

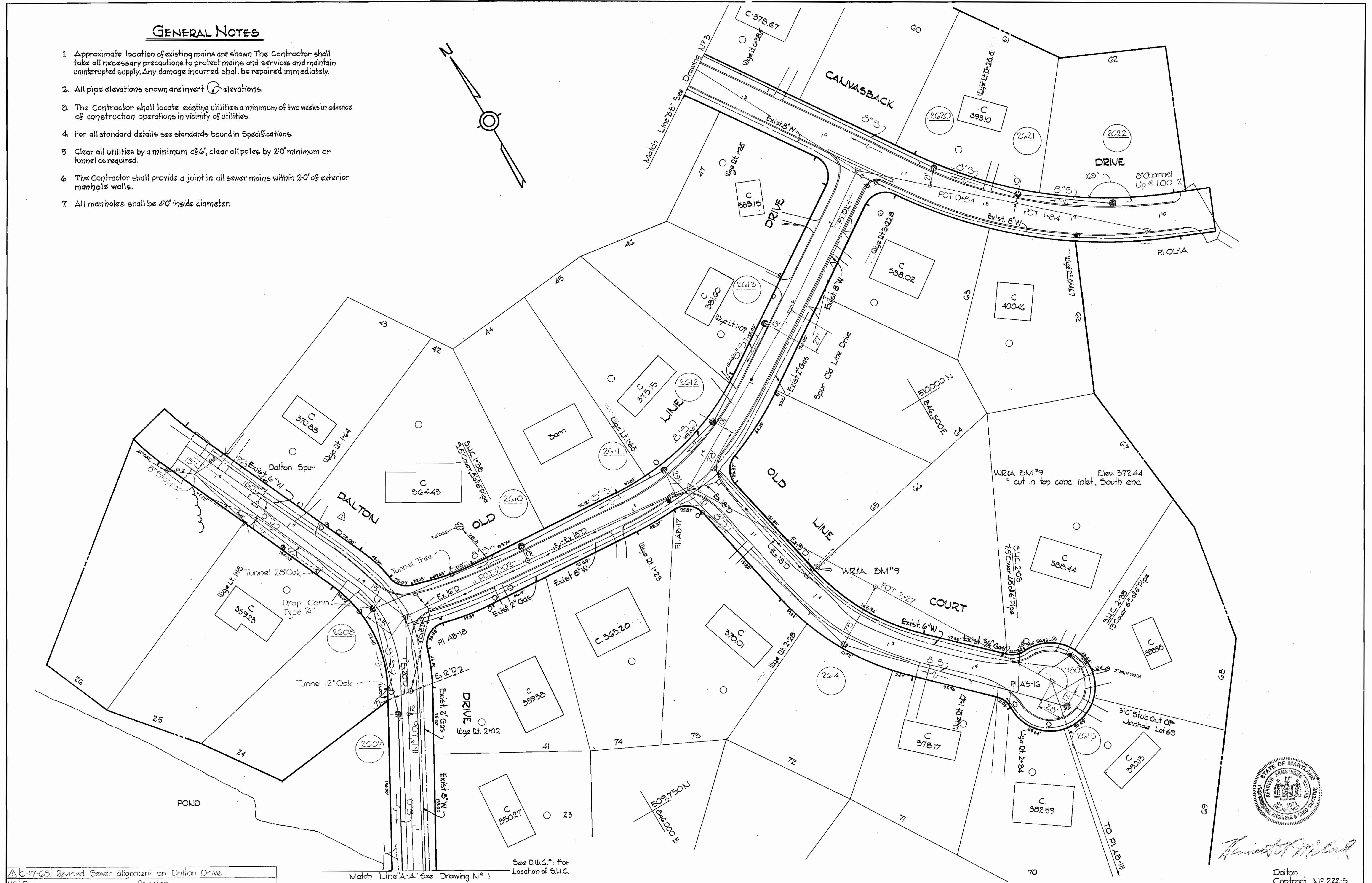
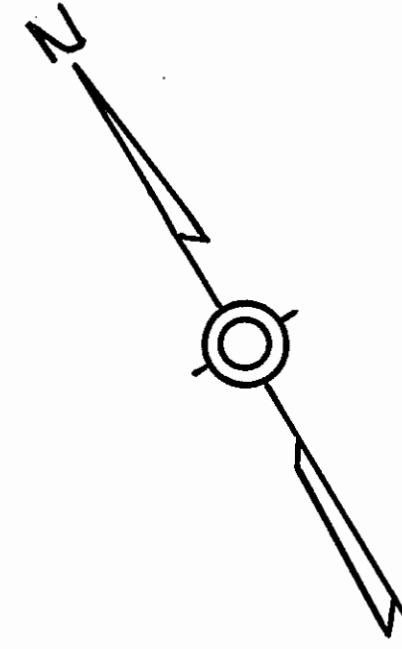

Handwritten signature

Dalton Contract No 222-S

6-17-68 Revised Sewer alignment on Dalton Drive
 W# Date Revision

WHITMAN, REQUARDT & ASSOCIATES
 ENGINEERS
 1304 ST. PAUL ST.
 BALTIMORE, MARYLAND

HOWARD COUNTY METROPOLITAN COMMISSION
 2-1-68 *W O Gilbert*
 DATE CHIEF ENGINEER

CONTRACT NO. 222-S

PLAN OF
 SEWER MAINS

ELECTION DISTRICT
 GUILFORD NO. 6

DRAWING NO. 2 OF 4
 SCALE 1" = 50'

WS 222-5/12

WS 222-5/4

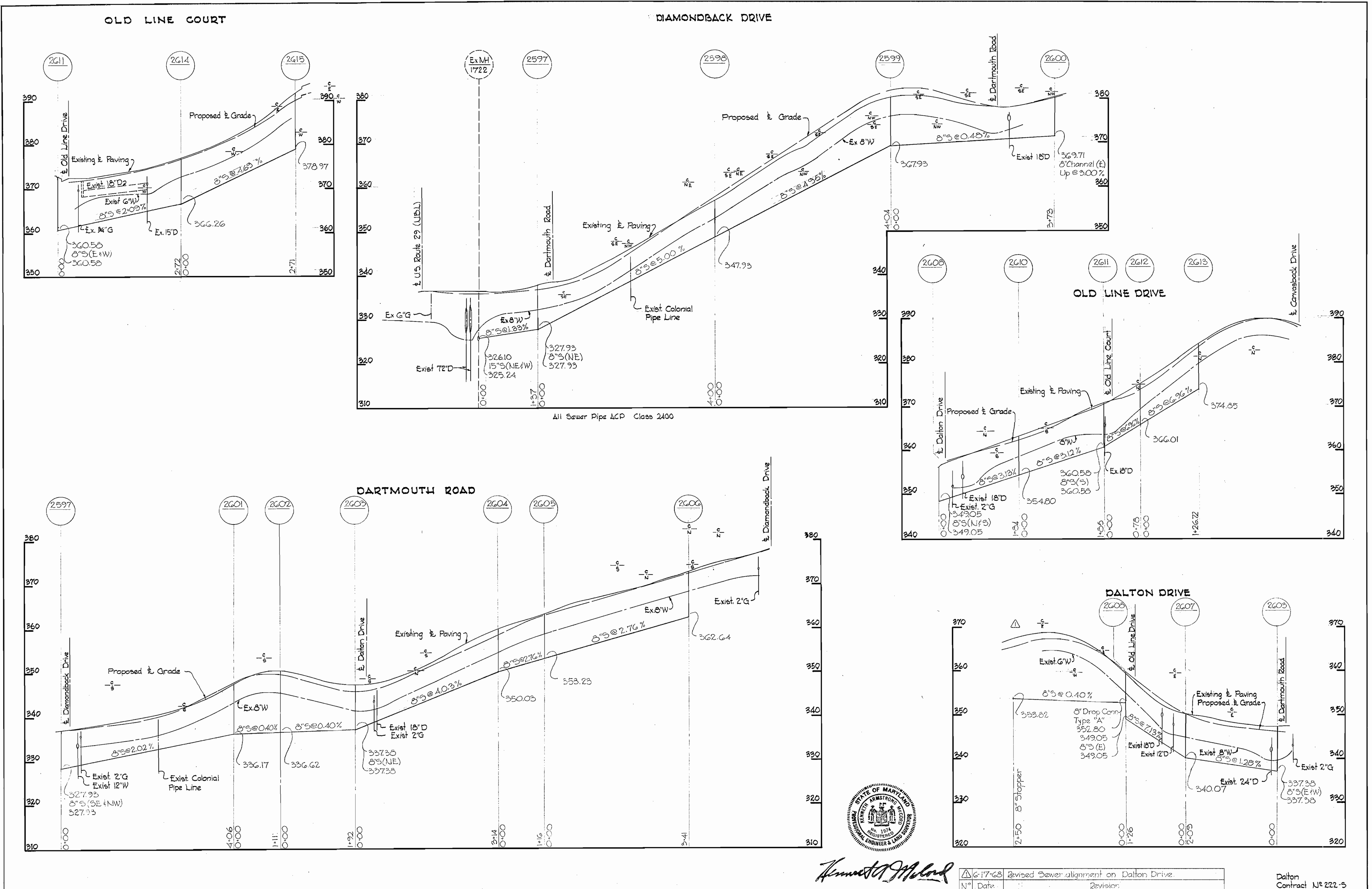

James M. Meland

6-17-68 Revised Sewer alignment on Dalton Drive.
 N° Date: Revision:

Dalton Contract N° 222-5

WHITMAN, REQUARDT & ASSOCIATES ENGINEERS 1304 ST. PAUL ST. BALTIMORE, MARYLAND	HOWARD COUNTY METROPOLITAN COMMISSION 2-1-68 DATE	CONTRACT NO. 222-S W. O. G. 21-2 CHIEF ENGINEER	PROFILES OF SEWER MAINS	ELECTION DISTRICT GUILFORD NO. 6	DRAWING NO. 4 OF 4 SCALE H-1"=100' V-1"=10' OCT 16 1968 AS BUILT
---	---	---	-------------------------	----------------------------------	--

W. O. G. 21-2