

PLAN

Scale: 1"=50'

W.R.I.A. BM*1 Elev. 414.64
Flange bolt of fire hydrant, roadside
bolt, at intersection of lots 4 & 5

FOX DEN ROAD

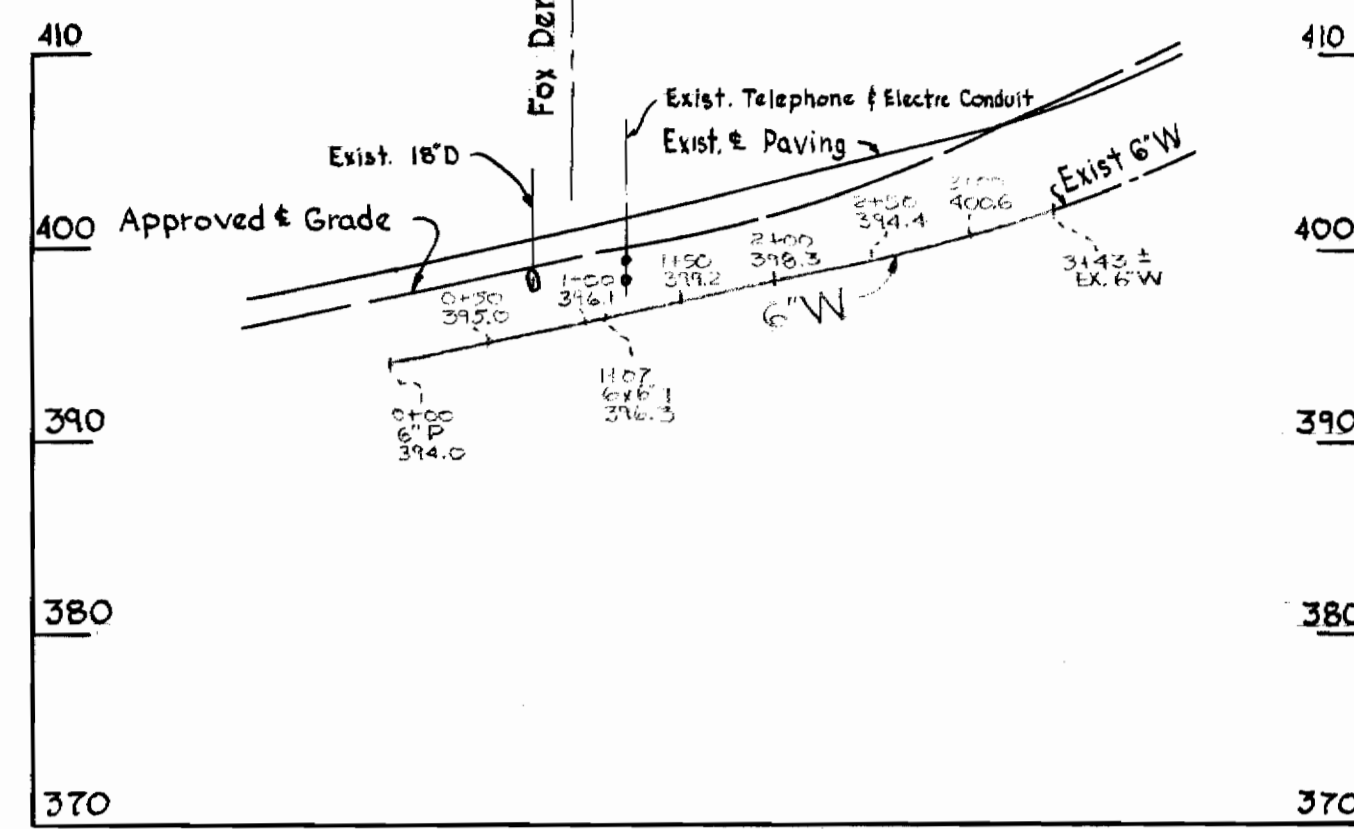

FOX DEN COURT

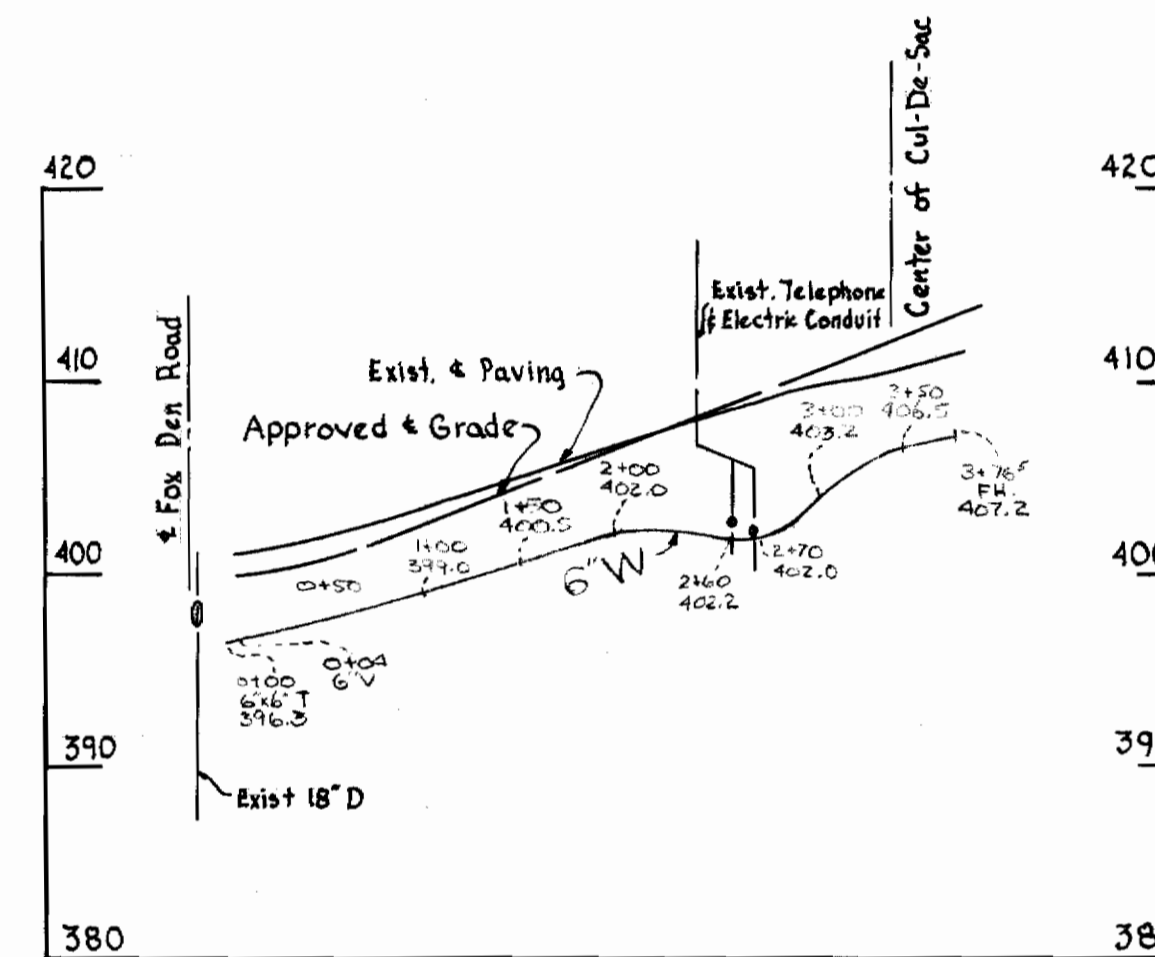

PROFILE

Scale: Hor. - 1"=100'
Vert. - 1"=10'

GENERAL NOTES

1. Approximate location of existing mains are shown. The Contractor shall take all necessary precautions to protect existing mains and services and maintain uninterrupted supply. Any damage incurred shall be repaired immediately.
2. All pipe elevations shown are invert elevations.
3. The Contractor shall locate existing utilities a minimum of two weeks in advance of construction operation in vicinity of utilities.
4. For all standard details see Standard bound in Specifications.
5. All water mains to be C.I.P. Class 22 and have a minimum of 3 1/2 cover.
6. Block all fittings with Concrete, see standard details bound in specifications.
7. Bury line elevation on fire hydrant shall be set the same as edge of paving or as directed by the Engineer in the field.
8. Buttress fire hydrant with concrete; provide copper pipe at weep holes as required for positive drainage. For Buttress dimensions see standard detail W.B. Buttress for Caps.
9. Clear all poles by 2'0" minimum or tunnel as required. Clear all existing utilities by 6" minimum.
10. Before digging pipe, pushing or doing other work near Telephone Cables call collect any time Lexington 9-9900 Ext. 553, 554, or 555, Baltimore, Maryland.

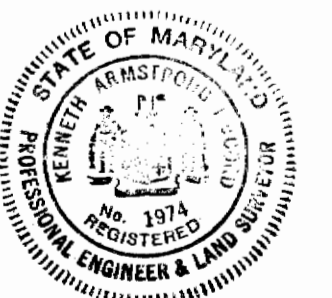

Robert M. Wood
Bethany Manor Section 2
Contract No. 113-W

WHITMAN, REQUARDT & ASSOCIATES
ENGINEERS
1304 ST. PAUL ST.
BALTIMORE, MARYLAND

HOWARD COUNTY METROPOLITAN COMMISSION
10-22-65 *W.O. Libbert*
DATE CHIEF ENGINEER

CONTRACT NO. 113-W

PLAN AND PROFILE OF
WATER MAINS

ELLCOTT CITY SUB-DISTRICT

DRAWING NO. 1 OF 1
SCALE AS SHOWN

WS 113W/1