

W.R. & A. D.M. #15-A Elev. 415.28
 R.R. spike in E. side of C&P pole #4
 on S. side of Willow Lane 250± W.
 of Montclair Drive.

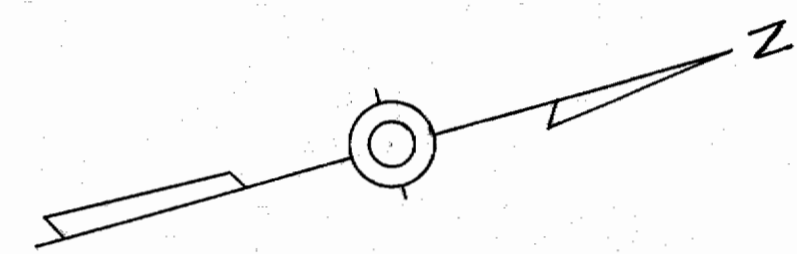

PLAN
 Scale: 1" = 30'

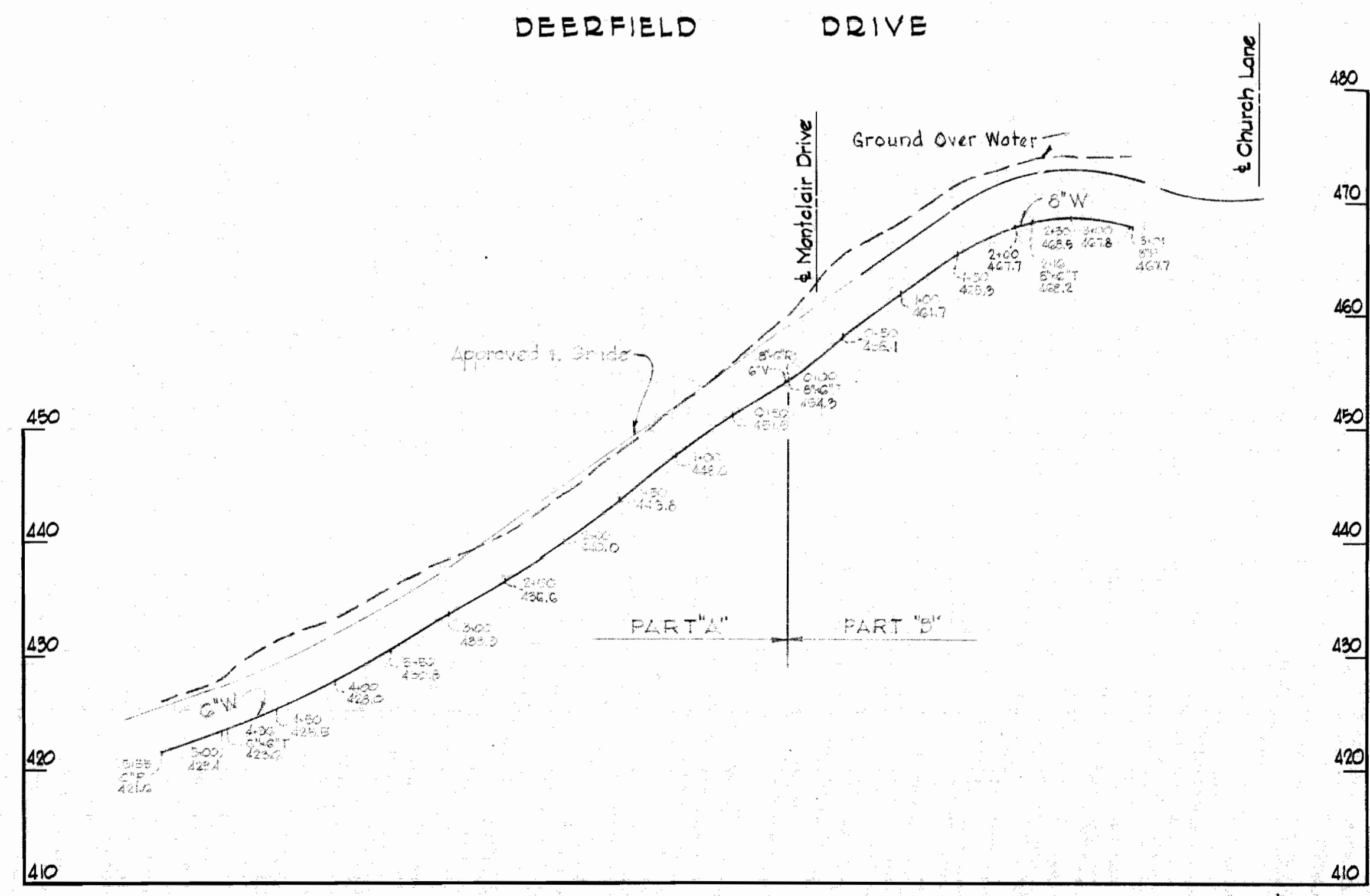

PROFILE
 Scale: Hor. 1" = 100'
 Vert. 1" = 10'

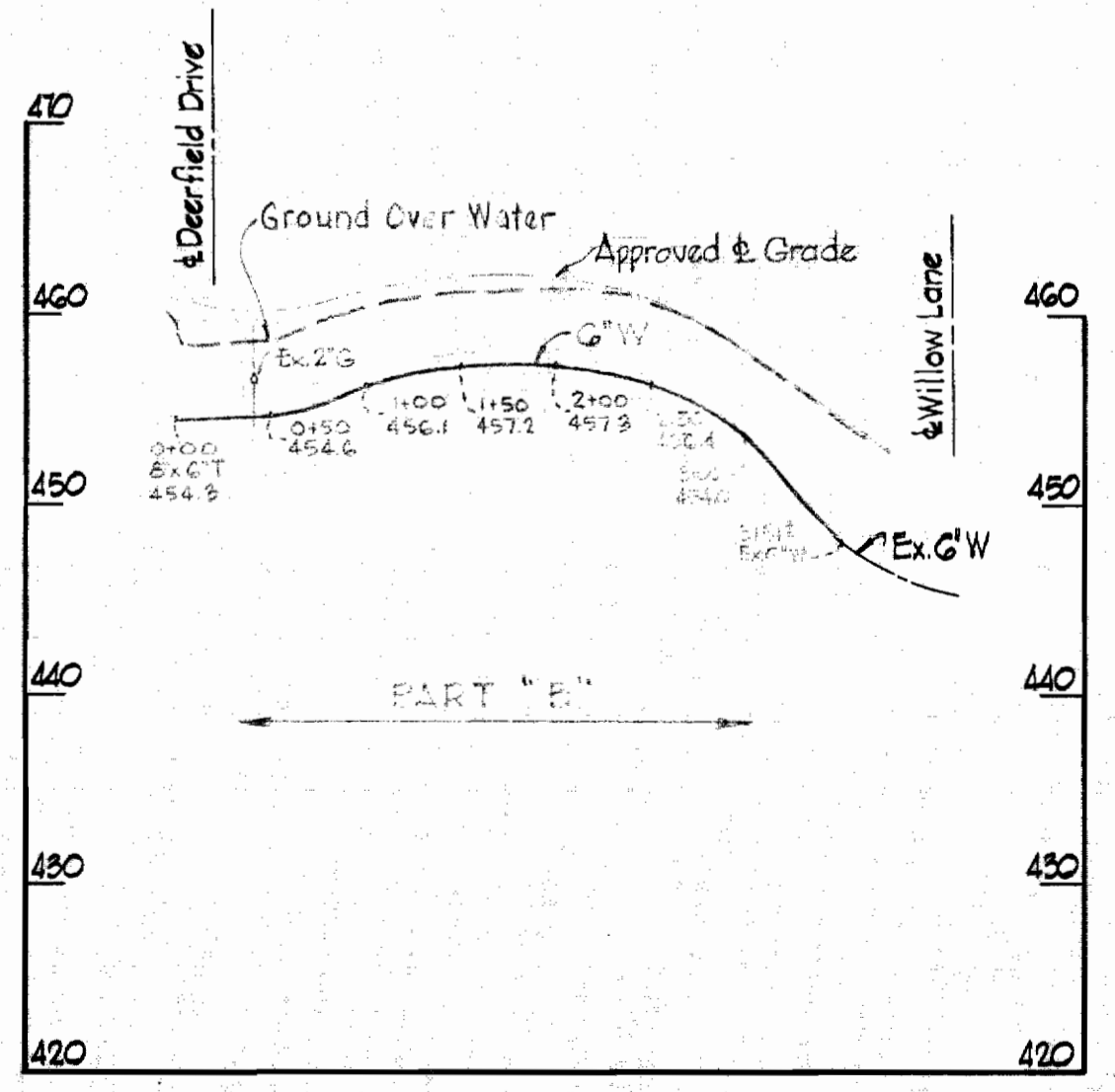

GENERAL NOTES

1. Approximate location of existing mains are shown. The Contractor shall take all necessary precautions to protect the existing mains and services and maintain uninterrupted supply. Any damage incurred shall be repaired immediately.
2. All pipe elevations shown are invert elevations.
3. The Contractor shall locate existing utilities a minimum of two weeks in advance of construction operations in vicinity of utilities.
4. For all standard details see Standards bound in Specifications.
5. All water mains to be C.I.P. Class 22 and have a minimum of 3 1/2' cover.
6. Block all fittings with concrete, see standard details bound in specifications.
7. Bury line elevation on fire hydrant shall be set the same as edge of paving or as directed by the Engineer in the field.

Contract 46-W

WHITMAN, REQUARDT & ASSOCIATES ENGINEERS 1304 ST. PAUL ST. BALTIMORE, MARYLAND	HOWARD COUNTY METROPOLITAN COMMISSION Oct. 15, 1962 DATE CHIEF ENGINEER	CONTRACT NO. 46-W	PLAN & PROFILE OF WATER MAIN	ELLICOTT CITY SUB-DISTRICT	DRAWING NO. 1 OF 1	SCALE AS SHOWN
---	--	-------------------	---------------------------------	----------------------------	--------------------------	----------------------

WS 46W/1