

PROPERTY LINE TABLE

A	N 07° 21' 05" W	50.76
B	N 08° 26' 12" W	24.02
C	R=29.00' L=40.51' CB=N 24° 45' 26" E	37.29
D	N 00° 34' 03" W	99.15
E	N 18° 29' 04" E	10.61
F	N 22° 07' 49" W	28.90
G	N 67° 13' 52" E	36.72
H	S 00° 05' 12" E	19.20
I	S 00° 30' 24" E	20.04
J	S 01° 14' 26" E	12.19
K	S 84° 18' 55" E	1.36
L	S 06° 14' 40" E	5.26
M	N 89° 23' 14" E	5.73
N	S 00° 50' 07" E	91.35
O	S 89° 10' 58" W	5.06
P	S 00° 54' 55" E	104.84
Q	S 05° 05' 58" E	0.50
R	S 82° 45' 22" W	13.02
S	S 02° 45' 07" W	24.34

COORDINATE TABLE

192	N 522186.937	E 857946.412
193	N 522237.280	E 857939.917
195	N 522261.042	E 857936.392
273	N 522294.908	E 857952.010
274	N 522394.053	E 857951.028
275	N 522404.116	E 857954.392
276	N 522430.887	E 857943.505
370	N 522445.098	E 857977.364
343	N 522425.903	E 857977.393
342	N 522405.862	E 857977.570
341	N 522393.680	E 857977.834
340	N 522393.545	E 857979.184
337	N 522388.317	E 857979.756
358	N 522388.378	E 857985.482
332	N 522297.042	E 857986.814
351	N 522296.970	E 857981.753
325	N 522192.143	E 857983.428
369	N 522191.649	E 857983.472
272	N 522190.007	E 857970.554

AREA TABULATION

FEE SIMPLE ACQUISITION 9,074.207 SQUARE FEET
0.208 ACRES MORE OR LESS

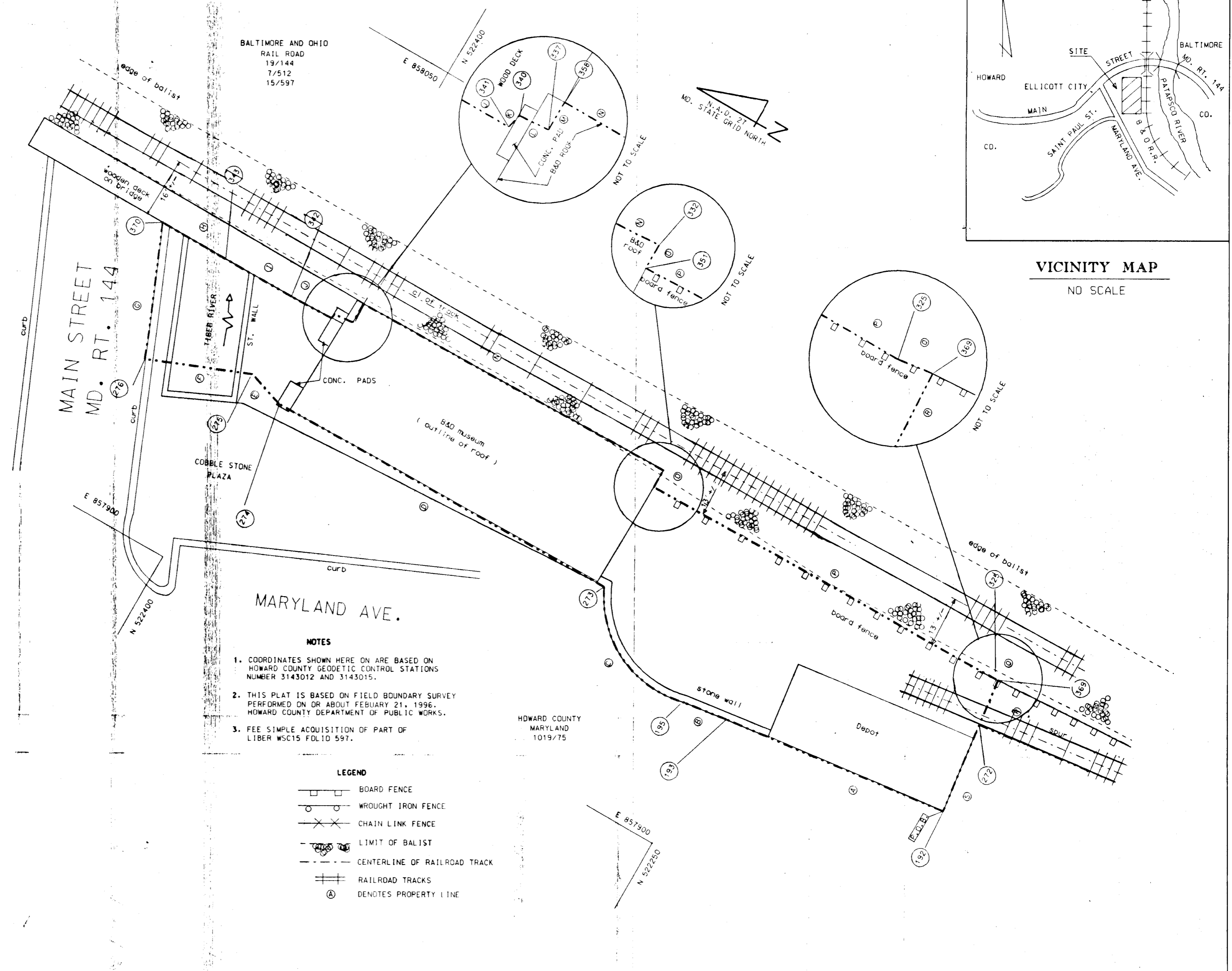

BALTIMORE AND OHIO
RAIL ROAD
19/144
7/512
15/597

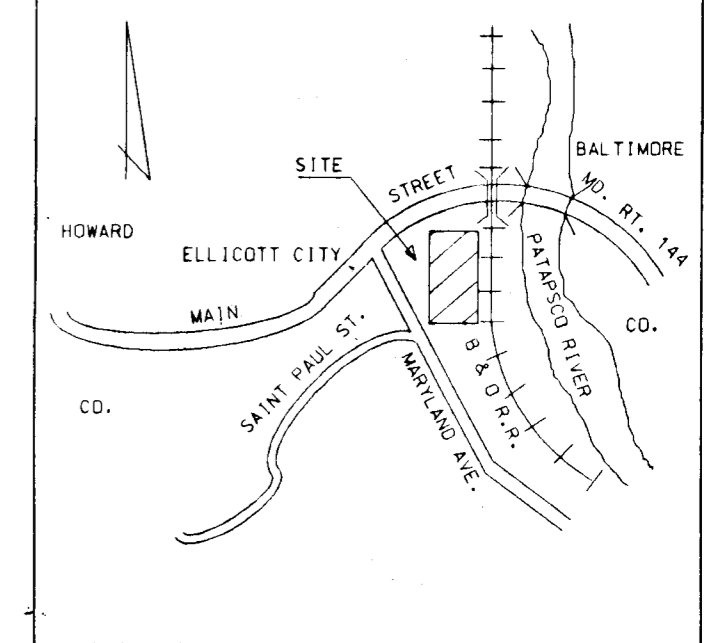
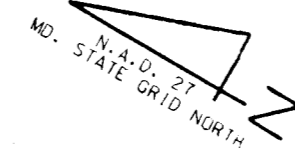

VICINITY MAP
NO SCALE

NOTES

- COORDINATES SHOWN HERE ON ARE BASED ON HOWARD COUNTY GEODETIC CONTROL STATIONS NUMBER 3143012 AND 3143015.
- THIS PLAT IS BASED ON FIELD BOUNDARY SURVEY PERFORMED ON OR ABOUT FEBRUARY 21, 1996. HOWARD COUNTY DEPARTMENT OF PUBLIC WORKS.
- FEE SIMPLE ACQUISITION OF PART OF LIBER WSC15 FOLIO 597.

LEGEND

- BOARD FENCE
- WROUGHT IRON FENCE
- CHAIN LINK FENCE
- LIMIT OF BALIST
- CENTERLINE OF RAILROAD TRACK
- RAILROAD TRACKS
- DENOTES PROPERTY LINE

LINE REFERENCE TABLE

LINE	DEED REFERENCE
S	11th and 10th line liber 1019 folio 75
A	9th line liber 1019 folio 75
B	8th line liber 1019 folio 75
C	7th line liber 1019 folio 75
D	6th line liber 1019 folio 75

APPROVED : DIVISION OF REAL ESTATE SERVICES
CHIEF: DIVISION OF REAL ESTATE SERVICES
DATE



Jefferson Davis Hobbs II
4-9-96
JEFFERSON DAVIS HOBBS II DATE
PROPERTY LINE SURVEYOR, MARYLAND REG. NO. 362

RECORDED AS PLAT NUMBER _____ ON _____
AMONG THE LAND RECORDS OF HOWARD COUNTY, MARYLAND.

HOWARD COUNTY
DEPARTMENT OF PUBLIC WORKS
FEE SIMPLE ACQUISITION
CSX TRANSPORTATION INC.
TO HOWARD COUNTY, MARYLAND
TAX MAP : PARCEL :
FIFTH ELECTION DISTRICT HOWARD COUNTY, MARYLAND.

PREPARED BY :
SURVEY / DRAFTING DIVISION
D.P.W. / BUREAU OF ENGINEERING
HOWARD COUNTY, MARYLAND.

SCALE : 1"=20'
COMPUTED :
DRAWN : B.A.C.
CHECKED :
DATE : 3/1/96

SHEET 1
OF 1
PLAT NO. C-0231-1