

Maryland State Archives  
350 Rowe Boulevard  
Annapolis, MD 21401  
(410) 974-3862 FAX (410) 974-2525  
Maryland Toll Free 800-235-4045

R\*STARS - Financial Agency: D60  
PCA: 42700  
TC: 410  
Agency Object: 7653

RECORD REQUEST: SL 99 1062-958

Code: M      Type: C

Jefferson Hobbs  
Howard County DPW, Survey Division  
3450 Courthouse Drive  
Ellicott City, MD 21043

Receipt No.: M 08767  
Amt Received:    10.00  
Charge: N  
Amount Due:     0.00

410-313-2417

Date Answered: 07/30/98

\*\*\*\*\*

Thank you for your inquiry received on 07/29/98 concerning the  
record cited below.

MSA No.

SPECIAL COLLECTIONS  
(Maps)  
Plat of "Rebecca's Lot"  
B5/10/3

These records are reproduced for you as part of the "Archives of  
Maryland Series".

Number of Pages: 1

Prepared by: Emily Murphy  
Archivist III

SP 54-001



Part of the Tract called  
Rebecca's Lot 14 1/2 acres

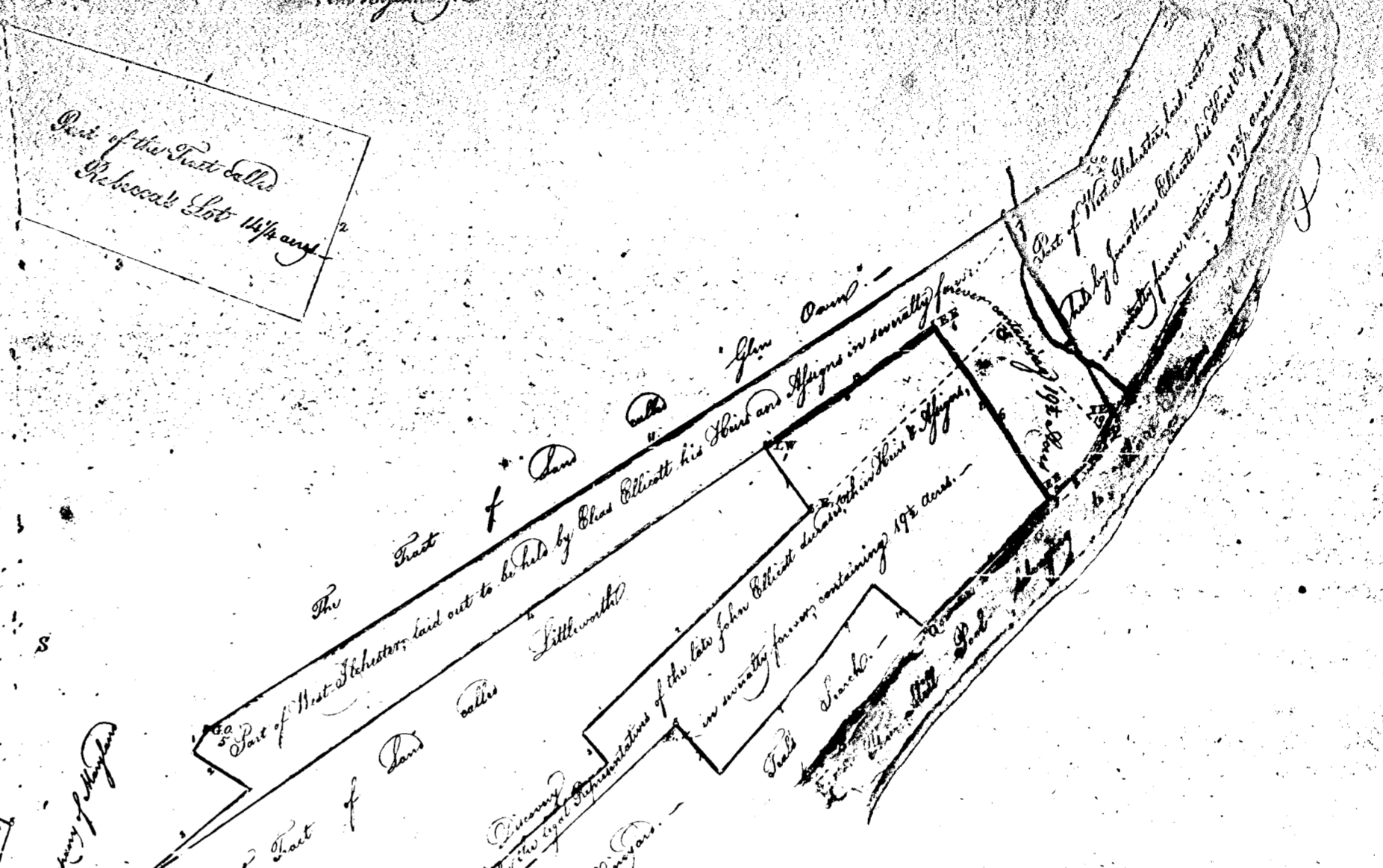

— Explanation —  
The Division according to the agreement and how attested with their broken lines from the stone marks with the letter T, and the number 12, that is from P, 12, on the Plat about 10 feet from there to P, is that which remaining the Division, the Western half as should have been, would have had only about four perches front on the Falls, to wit from P to S, whereas the Eastern half should have had about fifty perches in front from Q to P. By this amended Division the front of the former is increased to twenty perches, which a part of thirty four perches is still retained to the latter.

I Elias Elliott of the City of Baltimore on behalf of myself my Heirs and Assigns do hereby ratify and confirm the amended Division, above explained, agreeably as the laws were surveyed, marked and bounded under the superintendance and direction of the late John Elliott, deceased, and agreeably to the course and Distances which accompany this Plat. In Testimony whereof I have hereunto set my hand and affixed my Seal this twenty fourth day of April one thousand eight hundred and twenty three

Elias Elliott

Owing to my recent Survey having been made of any of the lines of either Timber Lane, Diamond Square, or Magnets, no Plat has been made of either of these Tracts. — in of the Plat of Rebecca's Lot at a part for John Elliott.

Wm. M. M. M.  
24 April 1823

By a Scale of 20 perches in Inches.

SPA-004

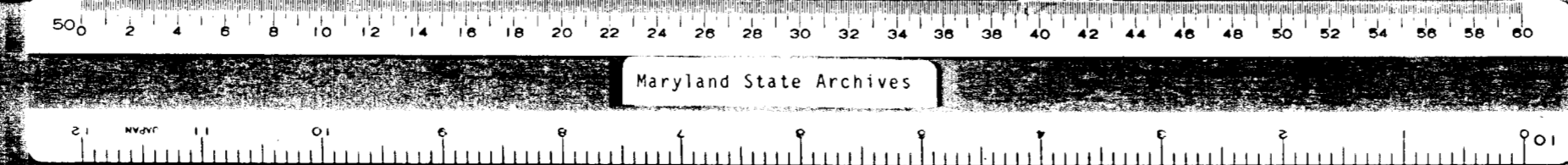





Part of the tract of Land called Rebecca's Lot set apart by an Agreement among the parties therein  
 being as divided by George Elliott his Heir and assigns in severalty forever being the parcel of  
 Land Southly divided among the houses and Distances here with art shown  
 & the Beginning

Part of the tract called  
 Rebecca's Lot 144 acres

— Explanation —  
 The division according to the Agreement which have articles with the broken line from the  
 above marks with the letter T, on the North, that is from T, 11, on the West above to O  
 came from there to V, so that with standing the Division, the Western half, as shaded green, would  
 while have had only about four perches front on the Hill, to wit from P to S, whereas the  
 Eastern half shaded red, would have extended fifty perches in front from Q to P. By the  
 amended Division the front of the former is increased to twenty perches, while a front of  
 thirty four perches is still retained to the latter.

I Elias Elliott of the City of Baltimore on behalf of myself my Heir and  
 assigns do hereby ratify and confirm the amended Division, above explained, equally  
 as the lines were surveyed, marked and bounded under the superintendance and direction  
 of the late John Elliott, deceased, and assent to the courses and Distances which  
 accompany this Plan. In Testimony whereof I have hereunto set my hand and  
 affix my Seal, this twenty fourth day of April one thousand eight hundred and  
 twenty three

Elias Elliott

Being to my recent Survey having been made of any other  
 lines of either Timber Land, Wooded Space, or Height,  
 on the Hill has been made of either of these tracts, or of the  
 Part of Rebecca's Lot set apart for George Elliott.  
 Wm. H. [Signature]  
 24 April 1823

SP 51-  
 1182

By a Scale of 20  
 perches in Inch.

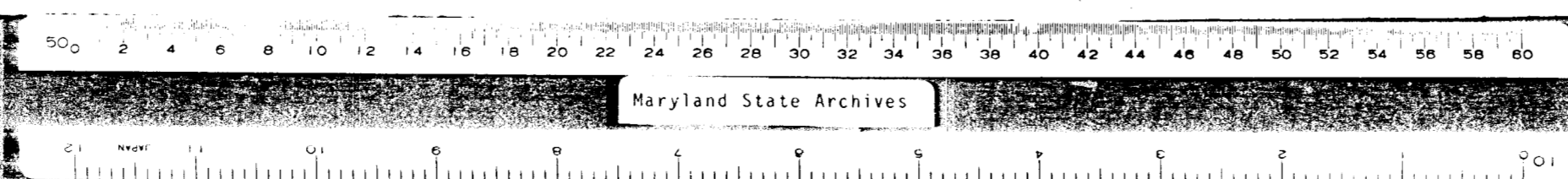



50-A

Part of the Part of Land called Rebecca's Lot set apart by our By-laws and actually divided into  
Writing, is divided by George Elliott his Heir and Assigns in severalty forever, being the parcel of  
Land, Truly divided, among the houses and Distances here with retainer,  
at the Beginning.

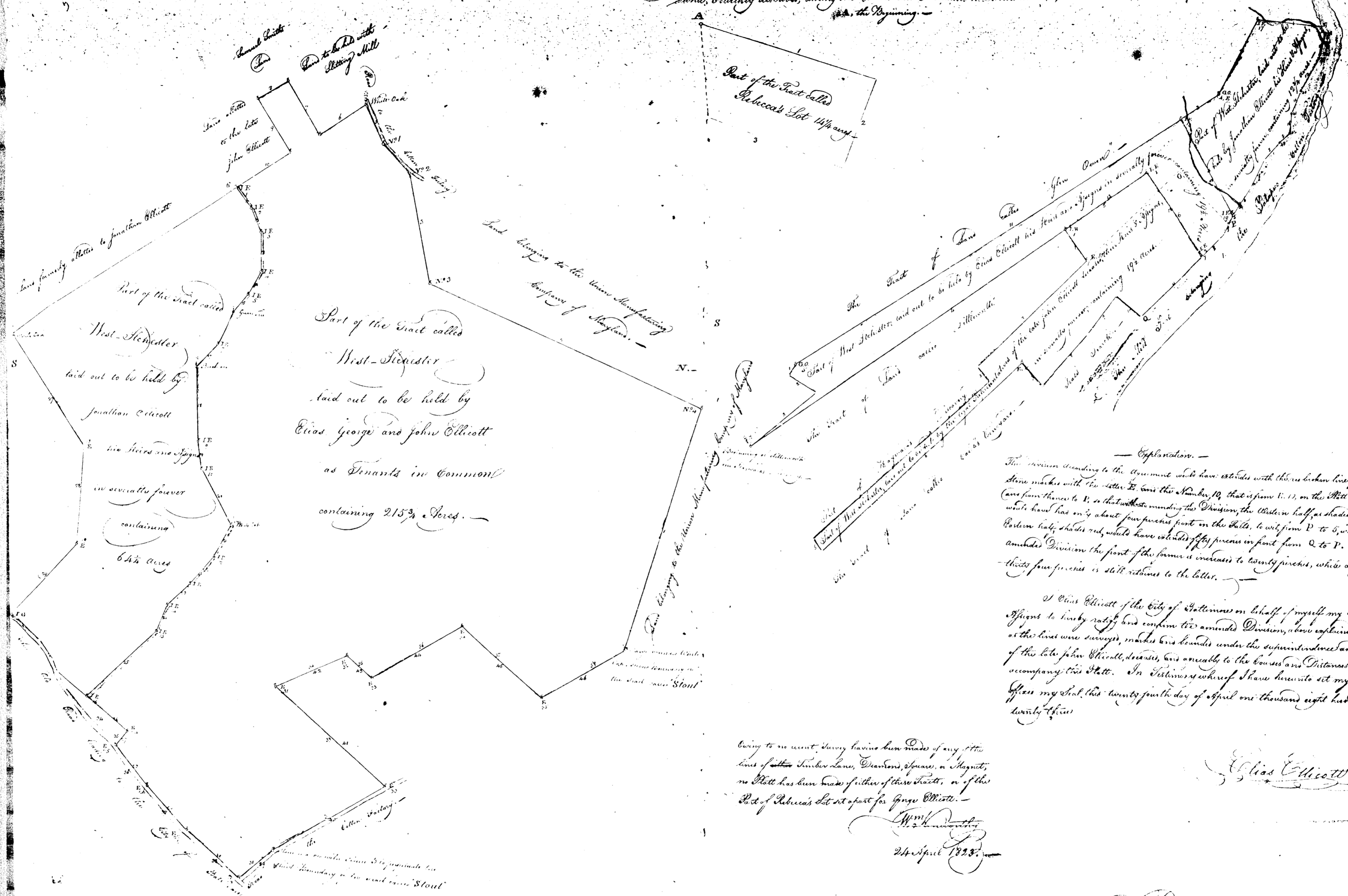

— Explanation. —  
 The Division according to the Agreement which have estates with the broken line from the  
 stone marks with the letter B, and the Number 10, that is from P. 11, on the Staff above, to O  
 (and from thence to P, is that without minding the Division, the Western half of said ground  
 would have had only about four paces front on the Falls, to wit from P. to S, whereas the  
 Eastern half, should have contained fifty paces in front from Q. to P. By the  
 amended Division the front of the former is increased to twenty paces, which a front of  
 thirty four paces is still retained to the latter.

I Elias Elliott of the City of Baltimore on behalf of myself my Heirs and  
 Assigns do hereby ratify and confirm the amended Division, above explained, equally  
 as the last one surveyed, marked and bounded under the superintendance and direction  
 of the late John Elliott, deceased, and according to the courses and Distances which  
 accompany this Plat. In Witness whereof I have hereunto set my hand and  
 Affix my Seal this twenty fourth day of April one thousand eight hundred and  
 twenty three.

Elias Elliott

Being to no use, Survey having been made of any of the  
 lines of the Timber Lane, Drankers, Square, or Maguets,  
 no Plat has been made of either of these tracts, or of the  
 Part of Rebecca's Lot set apart for George Elliott.

Wm. H. ...  
 24 April 1823

By a Scale of 20  
 paces in Inch.

SP 54.008

