

- NOTES:**
1. ZONING: NEW TOWN
 2. TOTAL AREA: 72.7 AC. (PARCEL AREA=57.4 AC./OPEN SPACE AREA=9.3 AC./R/W AREA=6.0 AC.)
 3. TOTAL NUMBER OF PARCELS AND LOTS: 2 (1 COMMERCIAL, 1 OPEN SPACE)
 4. PUBLIC WATER AND SEWER TO BE UTILIZED.
 5. TOPOGRAPHY SHOWN HEREON IS AERIAL TAKEN FROM MAPS PREPARED BY HOWARD COUNTY IN 1994. BOUNDARY BY DAFT, MCCUNE & WALKER ON 12-6-92.
 6. MINIMUM BUILDING SETBACK RESTRICTIONS FROM PROPERTY LINES & RIGHT-OF-WAY OF ANY PUBLIC ROAD WILL BE IN ACCORDANCE WITH THE FINAL DEVELOPMENT PLAN CRITERIA, PHASE 226
 7. FOREST STAND DELINEATION NOT REQUIRED PER SECTION 16.1200 SUBDIVISION REGULATIONS.
 8. THIS PROPERTY IS WITHIN THE HOWARD COUNTY METROPOLITAN DISTRICT.
 9. THIS PROJECT IS IN CONFORMANCE WITH THE LATEST HOWARD COUNTY STANDARDS UNLESS WAIVERS HAVE BEEN APPROVED.
 10. HORIZONTAL AND VERTICAL DATUM IS BASED ON HOWARD COUNTY CONTROL STATIONS NAD 83.
 11. STREET TREES WILL BE PROVIDED PER SUBDIVISION REGULATIONS ALONG WITH FINAL PLANS
 12. SEDIMENT & EROSION CONTROL MEASURES WILL BE INCLUDED WITH FINAL PLANS AND SITE DEVELOPMENT PLANS
 13. LANDSCAPING WILL BE PROVIDED WITH THE SITE DEVELOPMENT PLANS UNDER ALTERNATIVE COMPLIANCE SECTION OF THE LANDSCAPE MANUAL.
 14. NO PREVIOUS D.P.# 2 FILE NUMBERS
 15. SEE CONCEPTUAL GRADING PLAN FOR SWM LOCATIONS.
 16. 100-YR FLOODPLAIN IS BE AT SHALVEEN RIVER PKWY IS PER E-500-95 FLOODPLAIN REGULATION IN 22 ALL SHALVEEN RIVER PKWY IS PER E-500-95
 17. WETLANDS DELINEATION WAS PERFORMED BY RICHARD C. PIAS ON MAY 30, 1995
 18. TRAFFIC STUDY IS BY WELLS & ASSOC., DATED MARCH 19, 1995
 19. UTILITIES WERE TAKEN FROM AVAILABLE RECORDS.
 20. THE CEMETARY INVENTORY MAPS DO NOT SHOW ANY CEMETARIES WITHIN THIS PROJECT
 21. THE SCENIC ROAD MAP DOES NOT SHOW ANY SCENIC ROADS WITHIN OR ADJACENT TO THE PROJECT
 22. ALL PROPOSED EGRESS TO RELOCATED DOBBIN ROAD WILL MEET THE REQUIREMENTS OF MD-CR DESIGN MANUAL.

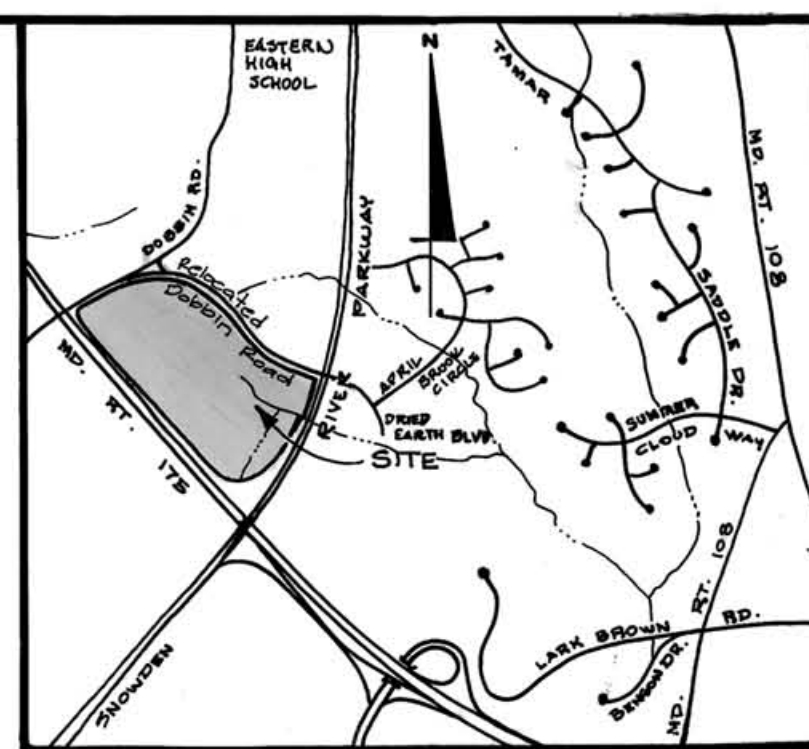

VICINITY MAP
SCALE: 1" = 2000'

Coordinates

PT. NO.	North	East
181	550,047	1,304,105
182	551,911	1,304,077
183	550,721	1,304,787
272	550,495	1,305,020
248	550,401	1,305,076
198	550,106	1,305,530
195	550,150	1,305,059
193	550,151	1,305,717
190	550,150	1,305,019
189	550,429	1,300,228
187	550,556	1,300,202
747	550,545	1,300,514

Additional coordinate values along Relocated Dobbin Road and the Connector to Old Dobbin Road will be set along with Final Plan preparation.

ENGINEERS:
GUTSCHICK, LITTLE & WEBER, P.A.
CIVIL ENGINEERS, SURVEYORS, PLANNERS,
LANDSCAPE ARCHITECTS
3909 NATIONAL DRIVE
SUITE #250
BURTONSVILLE, MARYLAND 20806

OWNER & DEVELOPER:
THE HOWARD RESEARCH & DEVELOPMENT CORPORATION
THE ROUSE BUILDING
10275 LITTLE PATUXENT PARKWAY
COLUMBIA, MARYLAND 21044

APPROVED
PLANNING BOARD
OF HOWARD COUNTY

DATE: 8/3/95
T.C.

SURVEYOR:
H. RICHARD MOALE
PROPERTY LINE SURVEYOR NO. 71
THE ROUSE COMPANY
10275 LITTLE PATUXENT PARKWAY
COLUMBIA, MARYLAND 21044

TENTATIVELY APPROVED
DEPT. OF PLANNING AND
ZONING OF
HOWARD COUNTY

PLANNING DIRECTOR
DATE: 9/16/95

TABULATION OF LAND USE	
LAND USE	ACRES
COMMERCIAL ROADWAY	63.4
OPEN SPACE CREDITED	9.3
TOTAL	72.7 Ac. ±

- LEGEND**
- WETLANDS
 - WETLANDS BUFFER (25')
 - CONTOUR INTERVAL IS 5'
 - 100 YEAR FLOOD PLAIN
 - WETLAND STREAM BUFFER (50')

- SOILS CHART:**
- AdB2: Aldino silt loam, 3 to 8% slopes, moderately eroded.
 - BrB2: Brandywine loam, 3 to 8% slopes, moderately eroded.
 - BrC3: Brandywine loam, 8 to 15% slopes, severely eroded.
 - CnB2: Chillum fair-fine loams, 1 to 5% slopes, moderately eroded.
 - CnB3: Chillum fair-fine loams, 5 to 15% slopes, severely eroded.
 - EnB2: Evesboro loam, 3 to 8% slopes, moderately eroded.
 - EvB: Evesboro loamy sand, 1 to 5% slopes.
 - GnB2: Glenville silt loam, 3 to 8% slopes, moderately eroded.
 - Ha: Harbor silt loam.
 - Ka: Kinkora silt loam.
 - LgC3: Lagore silty clay loam, 8 to 15% slopes, severely eroded.
 - Mo: Mixed alluvial land.
 - MrE: Montalto and Relay soils, 15 to 45% slopes.
 - NeB2: Neshaminy silt loam, 3 to 8% slopes, moderately eroded.
 - NeC2: Neshaminy silt loam, 8 to 15% slopes, moderately eroded.
 - SIB2: Sassafras loam, 1 to 5% slopes, moderately eroded.
 - SI DZ: Sassafras loam, 10 to 15% slopes, moderately eroded.
 - WaB: Washong silt loam, 3 to 8% slopes.

**COMPREHENSIVE SKETCH PLAN
SUBDIVISION PRELIMINARY EQUIVALENT
SKETCH PLAN & SOILS MAP FOR COLUMBIA
CHALICE SECTION I AREA I
PHASE 226
TAX MAP 36 GRID 18 PARCEL 50
6TH ELECTION DISTRICT OF HOWARD COUNTY, MARYLAND**

SCALE: 1" = 100' DATE: MARCH 1995

TENTATIVELY APPROVED
DEPT. OF PLANNING AND
ZONING OF
HOWARD COUNTY

PLANNING DIRECTOR DATE
TC 9/15/95

APPROVED
PLANNING BOARD
of HOWARD COUNTY

DATE 8/3/95
A.C.

NOTE: WAIVER PETITION WP-95-54 TO SECTION 16.116 (A) (1) AND 16.116 (A) (2) (1) TO PERMIT DISTURBANCE OF THE WETLAND BUFFER AND STREAM BUFFER, WAS GRANTED BY THE PLANNING DIRECTOR ON 4/7/95. JOINT PERMIT NUMBERS MUST BE REFERENCED ON FUTURE SUBMITTALS.

LEGEND

- WETLANDS
- WETLANDS BUFFER (25') OR STREAM BUFFER (50')
- CONTOUR INTERVAL 15'
- 100 YEAR FLOOD PLAIN
- STEEP SLOPES 15% - 25%
- STEEP SLOPES GREATER THAN 25%

SOILS CHART

- AaB2: Amino silt loam, 3 to 8% slopes, moderately eroded.
- BrC2: Brandywine loam, 3 to 8% slopes, moderately eroded.
- BrC3: Brandywine loam, 8 to 15% slopes, severely eroded.
- CnB2: Calicum Fairfax loam, 1 to 5% slopes, moderately eroded.
- CnB3: Calicum Fairfax loam, 5 to 15% slopes, severely eroded.
- EvB2: Evesboro loamy sand, 3 to 8% slopes, moderately eroded.
- EvB3: Evesboro loamy sand, 1 to 5% slopes, severely eroded.
- Ha: Harboro silt loam, 3 to 8% slopes, moderately eroded.
- Hka: Kinkora silt loam, 3 to 8% slopes, moderately eroded.
- LqC3: Legett silt clay loam, 8 to 15% slopes, severely eroded.
- Mk: Mixed alluvial land
- MrE: Marshall and Relay silt, 15 to 45% slopes.
- NeB2: Neshaminy silt loam, 3 to 5% slopes, moderately eroded.
- NeC2: Neshaminy silt loam, 2 to 15% slopes, moderately eroded.
- SiB2: Sassafras loam, 1 to 5% slopes, moderately eroded.
- SiB3: Sassafras loam, 10 to 15% slopes, moderately eroded.
- WaB: Watking silt loam, 3 to 8% slopes, moderately eroded.

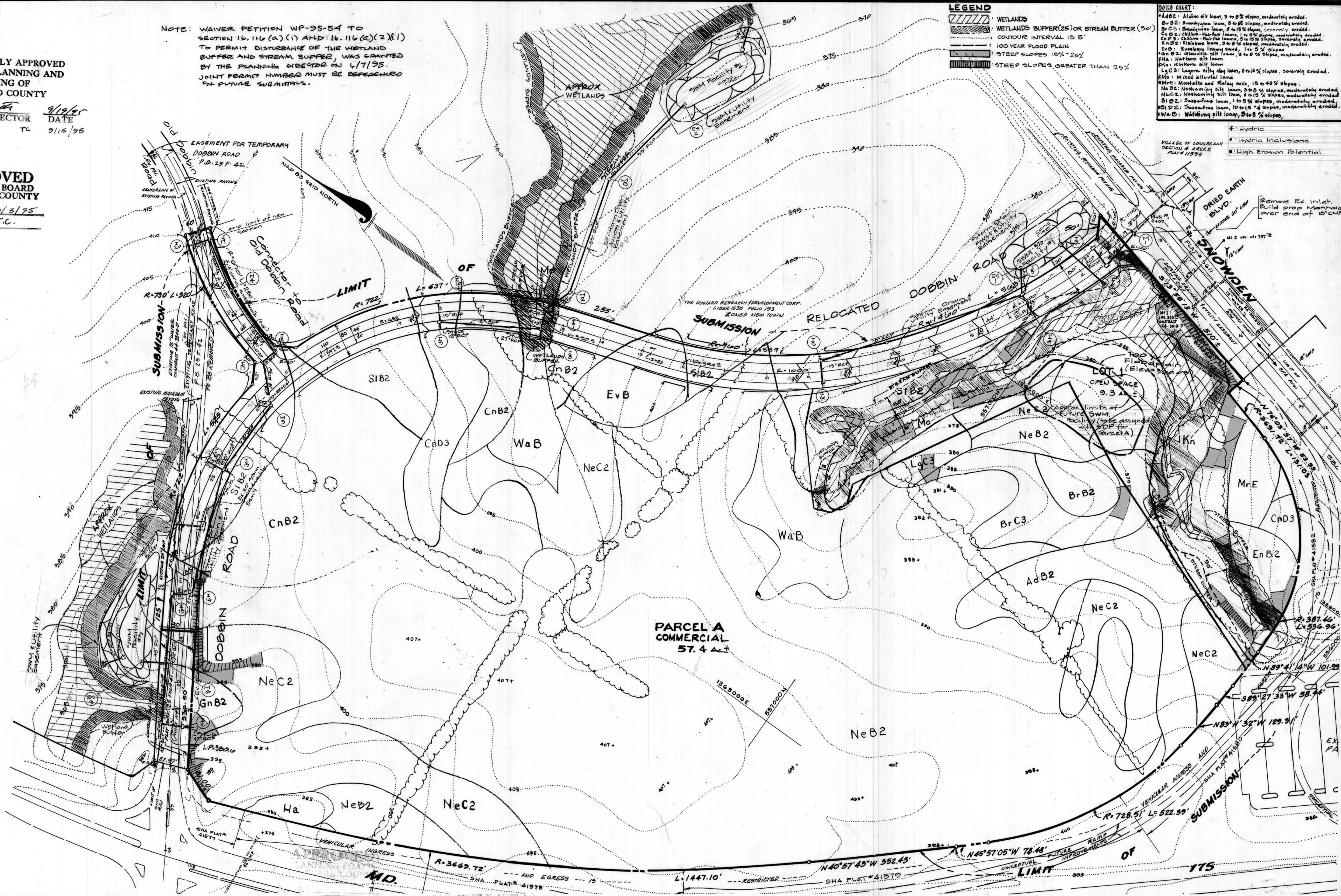

GLW GUTSCHICK LITTLE & WEBER, P.A.
CIVIL ENGINEERS, SURVEYORS, PLANNERS, LANDSCAPE ARCHITECTS
3909 NATIONAL DRIVE - SUITE 250 - BURTONSVILLE OFFICE PARK - BURTONSVILLE, MD 20866
TELEPHONE: (301)421-4024 NO. VA. (301)989-2524 BALTO. (301)880-1820 FAX (301)421-4186

DATE	REVISION	BY	APP'R.

PREPARED FOR:
The Howard Research & Development Corporation
The Rouse Building
10275 Little Patuxent Pkwy.
Columbia, Maryland 21044

CONCEPTUAL GRADING PLAN / SOILS MAP / STEEP SLOPES
Chalice
Section I Area I
Phase 2a
4th Election District
Howard County, Maryland

DES.: CLKG	SCALE: 1" = 100'	ZONING: NT	G.L.W. FILE No.: 95-003
DRN.: MCF	DATE: March 1995	TAX MAP No.: 30	SHEET: 2 of 2
CHK.: CLKG			

SP-95-08