

LEGEND:

- 1. Contour Interval: 2 Ft.
- 2. Existing Contour: (dashed line)

GENERAL NOTES:

1. Topography was compiled from aerial topography.
2. The area included in this submission is located on Tax Map #30, Pk. 224.
3. Installation of Traffic Control Devices shall be in accordance with the latest edition of the Manual of Uniform Control Devices.
4. Public Water and Sewer to be Utilized.
5. Sediment and Erosion Control Measures to be provided with the submission of the site development plans.
6. All utilities shown as existing were compiled from available records and field survey.
7. See Soils Map #19.
8. Minimum building setback restrictions from property lines and rights-of-way of any public road and street to be in accordance with the Final Development Plan - Phase 131.
9. Storm Water Management is to be provided by a Central Facility.
10. Recording Reference: Plot # 6530.
11. Plan Subject to VP-86-82.

SITE ANALYSIS:

1. Zoning: New Town Apts.
2. Unit Type Proposed: 4.5, 6.8 & Plex Condominium Townhouses
3. Number of Units Permitted: 120
4. Number of Units Proposed: 110
5. Parking Spaces Required: 220
6. Parking Spaces Provided:
 - Private Parking (2/Unit)*: 220*
 - Guest Parking Areas: 73
 - Total: 293
7. Area Tabulation:
 - Total area of Parcel: 12.138 Ac.
 - Public Roadway Dedication: 0
 - Private Drives & Parking: ±1.78 Ac.
8. Building Coverage Permitted: 30%
 - Proposed: 18%

* One on driveway and one in integral garage.



VICINITY MAP
SCALE: 1"=2000'

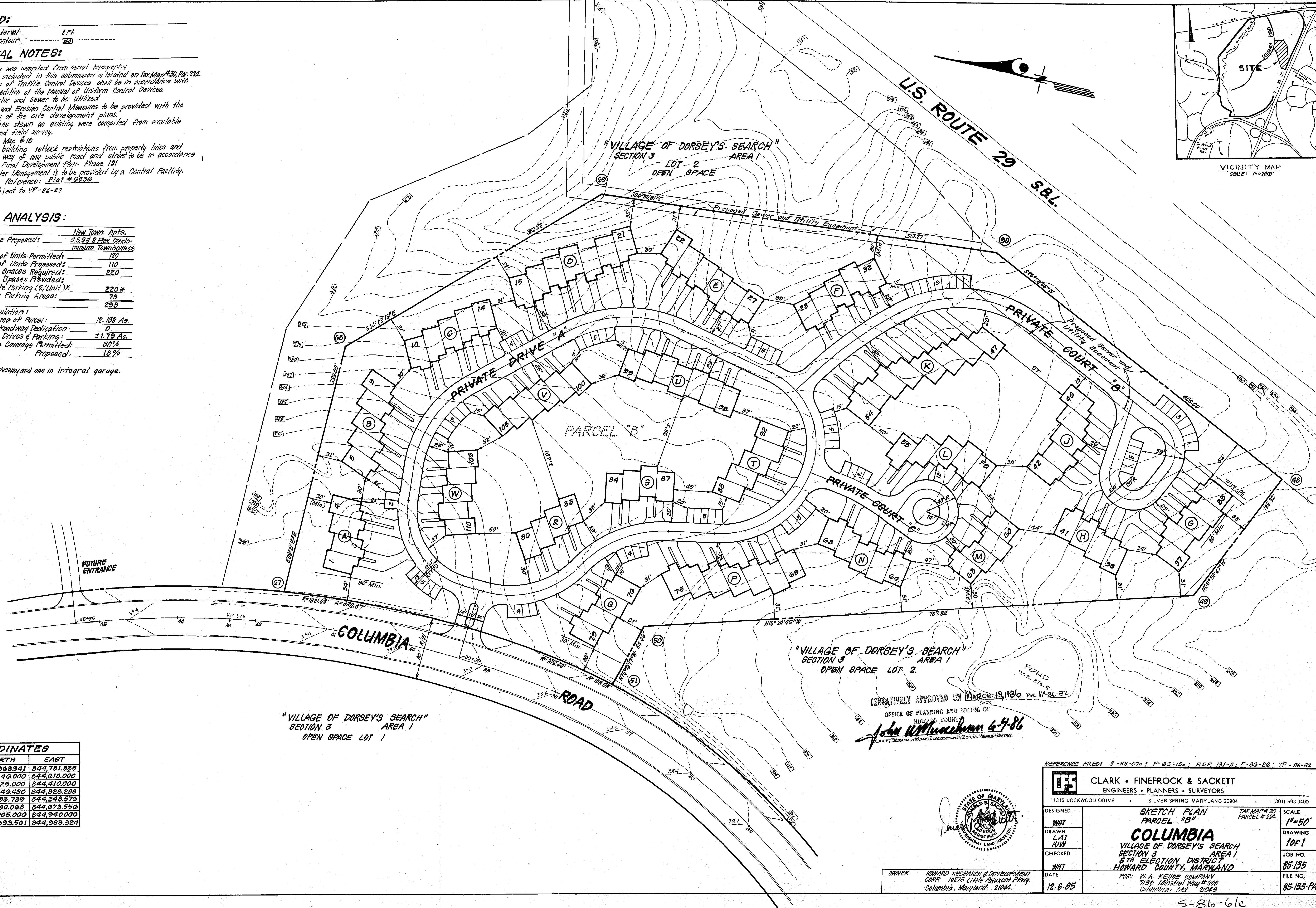

PT. NO.	NORTH	EAST
48	509,968.941	844,781.835
49	510,040.000	844,610.000
50	510,725.000	844,410.000
51	510,746.430	844,328.288
67	511,183.739	844,348.576
68	511,180.068	844,673.596
69	510,905.000	844,940.000
70	510,393.561	844,983.324

TEMPORARILY APPROVED ON MARCH 19 1986 PER VP-86-82
 OFFICE OF PLANNING AND ZONING OF HOWARD COUNTY
John W. MacEachron 6-4-86
 CLERK, DIVISION OF LAND DEVELOPMENT & ZONING ADMINISTRATION



REFERENCE FILES: 3-85-07c; P-85-13c; F.R.P. 191-A; F-86-26; VP-86-82

CLARK • FINEPROCK & SACKETT
 ENGINEERS • PLANNERS • SURVEYORS
 11315 LOCKWOOD DRIVE SILVER SPRING, MARYLAND 20904 (301) 593-3400

DESIGNED WHT	SKETCH PLAN PARCEL 15" COLUMBIA VILLAGE OF DORSEY'S SEARCH SECTION 3 AREA 1 5TH ELECTION DISTRICT HOWARD COUNTY, MARYLAND	TAX MAP #30 PARCEL # 224	SCALE 1"=50'
DRAWN LAI RW		JOS NO. 85-135	
CHECKED WHT		FILE NO. 85-135-PA	
DATE 12-6-85		FOR: W. A. KEHAE COMPANY 7130 Minstrel Way # 200 Columbia, Md. 21045	