

VICINITY MAP
SCALE: 1"=2000'

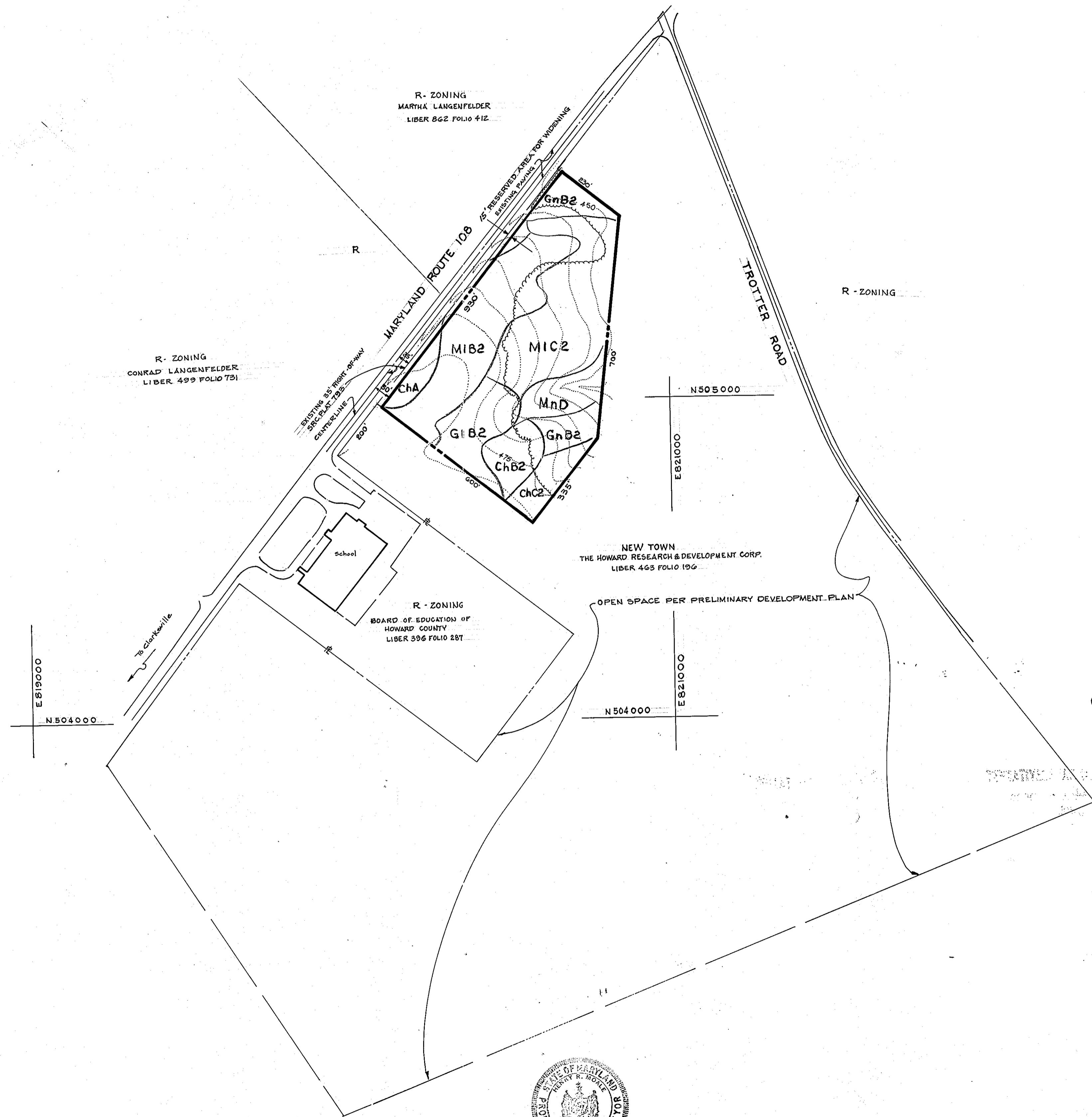

GENERAL NOTES:

1. ZONING: NEW TOWN
2. PROPOSED LAND USE: OPEN SPACE - CREDITED
3. TOTAL AREA: 10.3 AC. ±
4. TOTAL NUMBER OF LOTS: 1
5. SOILS MAP NUMBER
6. TOPOGRAPHY SHOWN HEREON IS FROM AERIAL MAPS FLOWN IN 1975 AND PREPARED FOR HOWARD COUNTY UNDER PROJECT C-4-0119.
7. SEDIMENT AND EROSION CONTROL MEASURES TO BE DETERMINED WITH THE SUBMISSION OF SITE DEVELOPMENT DRAWINGS.
8. MINIMUM BUILDING SETBACK RESTRICTIONS FROM PROPERTY LINES & RIGHT-OF-WAY OF ANY PUBLIC ROAD WILL BE IN ACCORDANCE WITH THE FINAL DEVELOPMENT PLAN CRITERIA PHASE 188.
9. PRIVATE WATER AND PRIVATE SEWERAGE SYSTEM WILL BE UTILIZED UNTIL SUCH TIME AS PUBLIC UTILITIES ARE EXTENDED TO SERVE THIS AREA.
10. ANY PLANS SUBMITTED IN CONJUNCTION WITH THIS SITE ARE SUBJECT TO VP-83-76.

TENTATIVELY APPROVED ON JAN 31, 1983
DATE

OFFICE OF PLANNING AND ZONING OF
HOWARD COUNTY

[Signature]
CLERK, DIVISION OF LAND DEVELOPMENT & ZONING ADMINISTRATION

**COMPREHENSIVE SKETCH PLAN
SUBDIVISION SKETCH PLAN
AND SOILS MAP**

**COLUMBIA
CEMETERY SITE
SECTION 1 AREA 1
LOT 1**

SHEET 1 OF 1

TAX MAP 35 PART OF PARCEL 3
5TH ELECTION DISTRICT OF HOWARD COUNTY

SCALE: 1"=200' DATE: DEC. 6, 1982

SURVEYOR
H. RICHARD MOALE
PROPERTY LINE SURVEYOR NO. 77
THE ROUSE CO.
10275 LITTLE PATUXENT PARKWAY
COLUMBIA, MARYLAND 21044

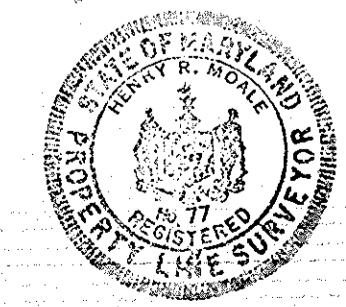

[Signature]

OWNER & DEVELOPER
THE HOWARD RESEARCH & DEVELOPMENT CORP.
THE ROUSE BUILDING
10275 LITTLE PATUXENT PARKWAY
COLUMBIA, MARYLAND 21044