

PHASE AND SEQUENCE DIAGRAM	SIGNAL HEADS	
	1-5	6-9
	(R) 12"	(R) 12"
	(Y) 12"	(Y) 12"
	(G) 12"	(G) 12"
PHASE 2+6	G	R
PHASE 2+6 CLEAR	Y	R
PHASE 4+8	R	G
PHASE 4+8 CLEAR	R	Y
FLASH	FL/Y	FL/R

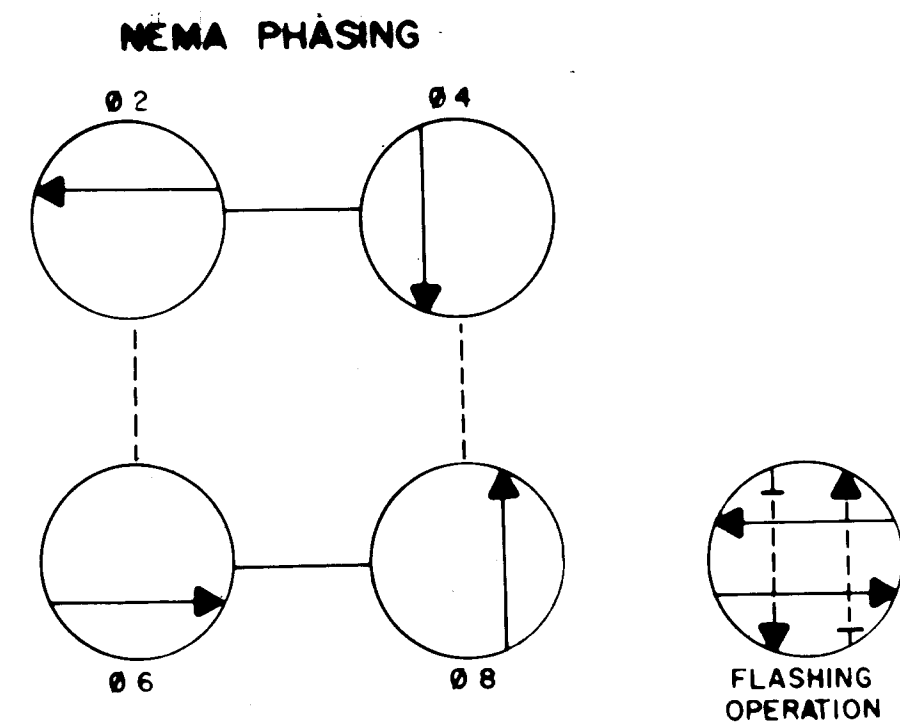

PHASING NOTES:  
 1. PHASES ASSOCIATED BY A SOLID LINE WILL NOT OPERATE CONCURRENTLY.  
 2. PHASES ASSOCIATED BY A DASHED LINE WILL OPERATE CONCURRENTLY.

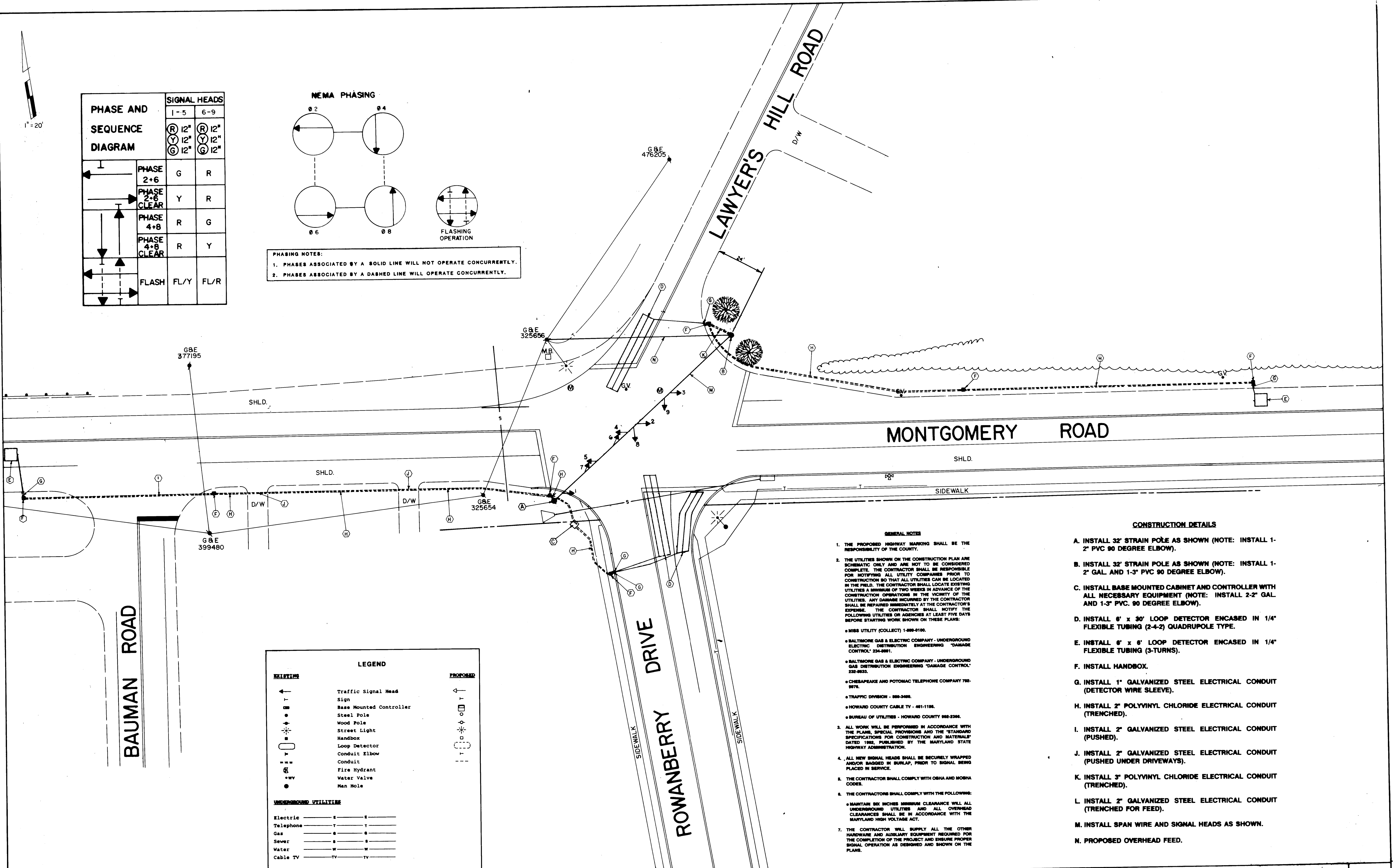

- GENERAL NOTES**
- THE PROPOSED HIGHWAY MARKING SHALL BE THE RESPONSIBILITY OF THE COUNTY.
  - THE UTILITIES SHOWN ON THE CONSTRUCTION PLAN ARE SCHEMATIC ONLY AND ARE NOT TO BE CONSIDERED COMPLETE. THE CONTRACTOR SHALL BE RESPONSIBLE FOR NOTIFYING ALL UTILITY COMPANIES PRIOR TO CONSTRUCTION SO THAT ALL UTILITIES CAN BE LOCATED IN THE FIELD. THE CONTRACTOR SHALL LOCATE EXISTING UTILITIES A MINIMUM OF TWO WEEKS IN ADVANCE OF THE CONSTRUCTION OPERATIONS IN THE VICINITY OF THE UTILITIES. ANY DAMAGE INCURRED BY THE CONTRACTOR SHALL BE REPAIRED IMMEDIATELY AT THE CONTRACTOR'S EXPENSE. THE CONTRACTOR SHALL NOTIFY THE FOLLOWING UTILITIES OR AGENCIES AT LEAST FIVE DAYS BEFORE STARTING WORK SHOWN ON THESE PLANS:
    - MIBS UTILITY (COLLECT) 1-888-9100.
    - BALTIMORE GAS & ELECTRIC COMPANY - UNDERGROUND ELECTRIC DISTRIBUTION ENGINEERING "DAMAGE CONTROL" 224-2691.
    - BALTIMORE GAS & ELECTRIC COMPANY - UNDERGROUND GAS DISTRIBUTION ENGINEERING "DAMAGE CONTROL" 232-8533.
    - CHEESAPEAKE AND POTOMAC TELEPHONE COMPANY 782-9876.
    - TRAFFIC DIVISION - 888-3488.
    - HOWARD COUNTY CABLE TV - 481-1184.
    - BUREAU OF UTILITIES - HOWARD COUNTY 988-2348.
  - ALL WORK WILL BE PERFORMED IN ACCORDANCE WITH THE PLANS, SPECIAL PROVISIONS AND THE "STANDARD SPECIFICATIONS FOR CONSTRUCTION AND MATERIALS" DATED 1982, PUBLISHED BY THE MARYLAND STATE HIGHWAY ADMINISTRATION.
  - ALL NEW SIGNAL HEADS SHALL BE SECURELY WRAPPED AND/OR BAGGED IN BURLAP, PRIOR TO SIGNAL BEING PLACED IN SERVICE.
  - THE CONTRACTOR SHALL COMPLY WITH OHSA AND MORMA CODES.
  - THE CONTRACTORS SHALL COMPLY WITH THE FOLLOWING:
    - MAINTAIN 36 INCHES MINIMUM CLEARANCE WILL ALL UNDERGROUND UTILITIES AND ALL OVERHEAD CLEARANCES SHALL BE IN ACCORDANCE WITH THE MARYLAND HIGH VOLTAGE ACT.
  - THE CONTRACTOR WILL SUPPLY ALL THE OTHER HARDWARE AND AUXILIARY EQUIPMENT REQUIRED FOR THE COMPLETION OF THE PROJECT AND ENSURE PROPER SIGNAL OPERATION AS DESIGNED AND SHOWN ON THE PLANS.

- CONSTRUCTION DETAILS**
- INSTALL 32' STRAIN POLE AS SHOWN (NOTE: INSTALL 1-2" PVC 90 DEGREE ELBOW).
  - INSTALL 32' STRAIN POLE AS SHOWN (NOTE: INSTALL 1-2" GAL AND 1-3" PVC 90 DEGREE ELBOW).
  - INSTALL BASE MOUNTED CABINET AND CONTROLLER WITH ALL NECESSARY EQUIPMENT (NOTE: INSTALL 2-2" GAL AND 1-3" PVC, 90 DEGREE ELBOW).
  - INSTALL 6' x 30' LOOP DETECTOR ENCASED IN 1/4" FLEXIBLE TUBING (2-4-2) QUADRUPOLE TYPE.
  - INSTALL 6' x 6' LOOP DETECTOR ENCASED IN 1/4" FLEXIBLE TUBING (3-TURNS).
  - INSTALL HANDBOX.
  - INSTALL 1" GALVANIZED STEEL ELECTRICAL CONDUIT (DETECTOR WIRE SLEEVE).
  - INSTALL 2" POLYVINYL CHLORIDE ELECTRICAL CONDUIT (TRENCHED).
  - INSTALL 2" GALVANIZED STEEL ELECTRICAL CONDUIT (PUSHED).
  - INSTALL 2" GALVANIZED STEEL ELECTRICAL CONDUIT (PUSHED UNDER DRIVEWAYS).
  - INSTALL 3" POLYVINYL CHLORIDE ELECTRICAL CONDUIT (TRENCHED).
  - INSTALL 2" GALVANIZED STEEL ELECTRICAL CONDUIT (TRENCHED FOR FEED).
  - INSTALL SPAN WIRE AND SIGNAL HEADS AS SHOWN.
  - PROPOSED OVERHEAD FEED.

**LEGEND**

EXISTING		PROPOSED
	Traffic Signal Head	
	Sign	
	Base Mounted Controller	
	Steel Pole	
	Wood Pole	
	Street Light	
	Handbox	
	Loop Detector	
	Conduit Elbow	
	Conduit	
	Fire Hydrant	
	Water Valve	
	Man Hole	
<b>UNDERGROUND UTILITIES</b>		
	Electric	
	Telephone	
	Gas	
	Sewer	
	Water	
	Cable TV	

746

DEPARTMENT OF PUBLIC WORKS  
 HOWARD COUNTY, MARYLAND

*[Signature]* 4/6/90  
 DIRECTOR OF PUBLIC WORKS DATE

*[Signature]* 4-6-90  
 CHIEF, BUREAU OF ENGINEERING DATE

A/E GROUP, INC.  
 CONSULTING ENGINEERS-PLANNERS

11408 CROWN HILL DRIVE  
 P.O. BOX 789  
 OWINGS MILLS, MD. 21117  
 301-363-1908  
 FAX 301-363-1263

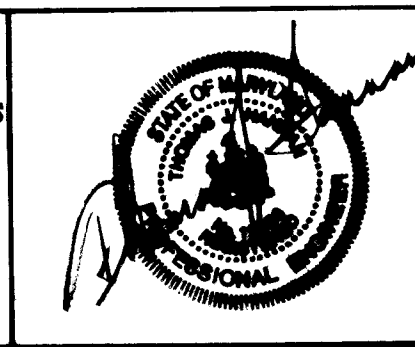

DES: TMZ	EFJ	AS DUCT	3/7/91
DRN: TMZ			
CHK: EGS			
DATE:	BY	NO.	REVISION

TRAFFIC SIGNAL PLAN  
 MONTGOMERY RD. + ROWANBERRY DR.  
**T-7050 EE**

SCALE AS SHOWN  
 SHEET 1 OF 1

AS-BUILT 7-7-91 MONT ROWA