

PHASE AND SEQUENCE DIAGRAM

TRAFFIC SIGNAL HEADS #	TRAFFIC SIGNAL HEADS #	
	1,2,3,4	5,6,7,8
(R) 12"	(R)	(R)
(A) 12"	(A)	(A)
(G) 12"	(G)	(G)
PHASE A	G	R
PHASE A CLEARANCE	A	R
PHASE B	R	G
PHASE B CLEARANCE	R	A
FLASH (F)	F/A	F/R

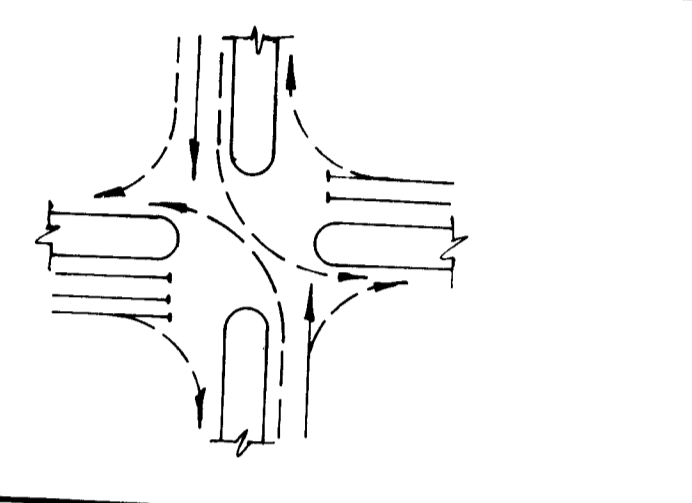
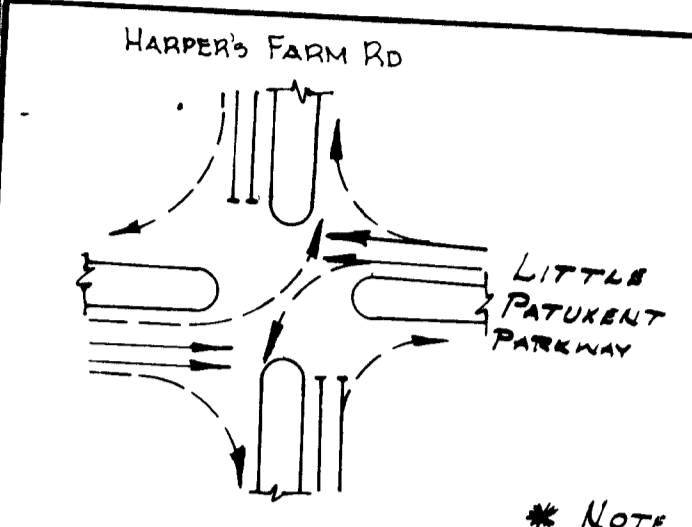

* FREE MOVEMENT
 - - - YIELD PRIOR TO MOVEMENT

GENERAL NOTES

- The Contractor is Not Responsible For Providing The Following:
 A Island Enlargement B Lane Marking
- The Timing of The Signal System Shall Be Furnished By The Traffic Engineer
- The location of all underground utilities shown are approximate and the Contractor must verify the locations by calling Miss Utility at 559-0100
- The underground conduit will be of sufficient size to accommodate future left turn phase detector and signal wiring. Pole foundations Nos 3 & 4 shall have additional conduit stubs to provide for future left turn detectors and signal wiring

EQUIPMENT LIST

A CONTROLLER

- Fully Actuated Two (2) Phase Solid State Controller Expandable to three (3) Phase fully Actuated
- Memory - Recall For Each Phase
- Standard Police Panel with Manual - Override Option
- All Red Clearance Interval for Each Phase
- Conflict Monitor With Solid State Signal Loading Switches
- Six (6) Loop Detector Amplifiers (Loop 12", 3x4 wired in parallel)
- Minimum Acceptable Adjustment Range:
 - a) Major - Minor Street Initial Period and Unit Extension: 2-30 sec
 - b) Major - Minor Street Extension: 10-60 "
 - c) Vehicle Clearance Interval - All Red Clearance Interval: up to 10 "
- Base Mounted Control Cabinet Large Enough to Accommodate the Ultimate Four Phases. The cabinet shall be finished bronze

B DETECTORS - Location in Accordance With Plan

Phase	Detector No (See Plan)	Dimensions
A	1 & 4	6 x 6
A	2 & 3	6 x 20
B	5 & 6	6 x 20
A	7 & 8	6 x 20

C SIGNAL HEADS

No (See Plan)	Size of Indications
1,2,3,4	12" Red, 12" Amber, 12" Green
5,6,7,8	12" Red, 8" Amber, 8" Green

Standard Visors (CANS) on All Indications

D LANE USE SIGNS - See MUTCD *

- Quantity - 2
- Location in Accordance With Plan
- The Signs Shall Be Tilted



E GUARDRAIL - BEAM

- End #1 & 2 Are to Be Anchored in Accordance With State of Maryland - State Roads Commission Specifications Standard No 6602 of Entitled Guardrail With Beam End Flare
- End #3 & 4 Are to Be Anchored in Accordance With Standard No 6602 of Same Specifications

* Manual on Uniform Traffic Control Devices

F POLES - MAST ARM

- Quantity - 4
- Location in accordance with Plan
- Finish - Bronze with manufacturer's primer
- Dimensions:
 - No 1 - 40 ft span
 - No 2 - 32 ft span
 - No 3 - 30 ft span
 - No 4 - 30 ft span
- All mast arms are to be oriented perpendicular to the travel lanes
- Design style and appearance equivalent to Union Metal Design 30300

SYMBOLS

- → Signal Head
- = Vehicle - Loop Detector
- = Hand Box (Junction Box)
- = Meter Box
- = Control Cabinet
- ⊙ = Proposed Street Pole

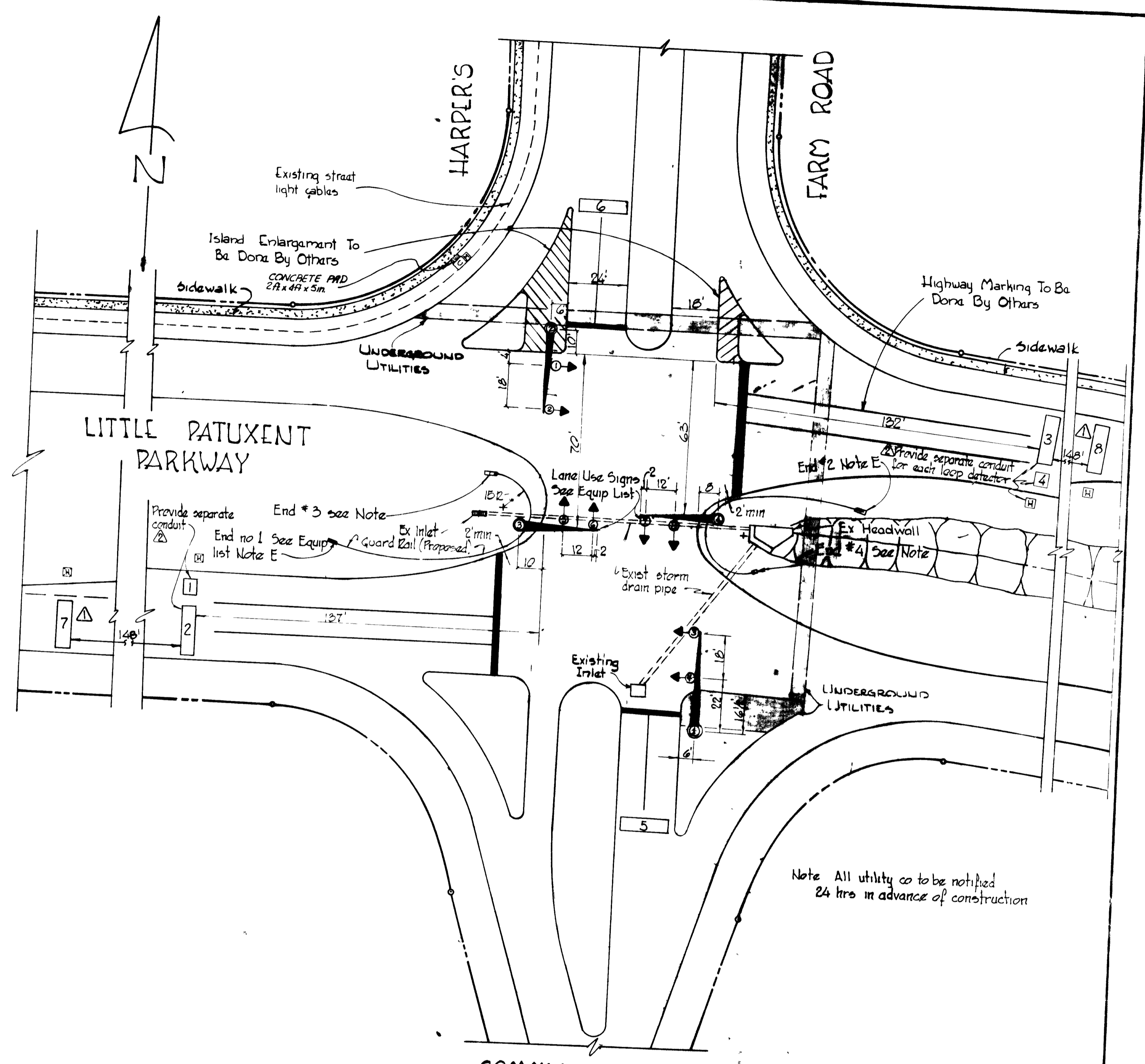
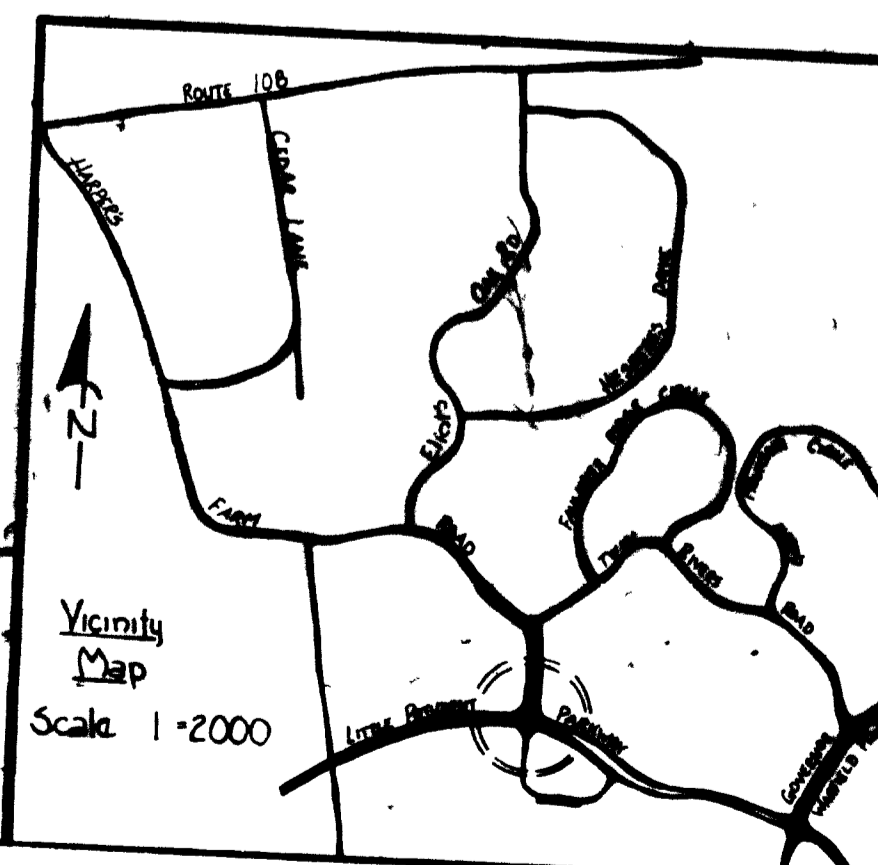

COMMUNITY COLLEGE ENTRANCE PLAN

Scale 1"=30'

STATE HIGHWAY ADMINISTRATION
 CONTRACT NO. MD 523 431 717
 FEDERAL AID
 PROJECT NO. M 3142(1)

APPROVED:	10/1/75	DATE	Aug. 17, 1977
APPROVED:	9/19/75	DATE	June 6, 1977
APPROVED:	9-20-75	DATE	Nov. 1, 1976
APPROVED:	9-7-75	DATE	

DEPARTMENT OF PUBLIC WORKS
 DIVISION OF ENGINEERING
 TRAFFIC SIGNAL CONSTRUCTION
 EQUIPMENT LIST
 PROJECT NO. TG-7002-1
 HARPER'S FARM ROAD

Des. K. Porazo
 Drum. H. Harper
 Chkd. M. Wilhelm
 Apprv. J. Riddle