

PHASE AND SEQUENCE DIAGRAM	SIGNAL HEADS					
	1-2	3	4	5-6	7-8	9
(R) (Y) (G)	(R) (Y) (G)	(R) (Y) (G)	(R) (Y) (G)	(R) (Y) (G)	(R) (Y) (G)	(R) (Y) (G)
PHASE 2+5	R	G	G	R	R	R
PHASE 2+5 CHANGE	R	G	G	R	R	R
PHASE 2+6	G	G	G	R	R	G
PHASE 2+6 CHANGE	Y	Y	Y	R	R	Y
PHASE 4+8	R	R	R	G	G	R
PHASE 4+8 CHANGE	R	R	R	Y	Y	R
FLASH	FL/Y	FL/Y	FL/Y	FL/R	FL/R	FL/Y

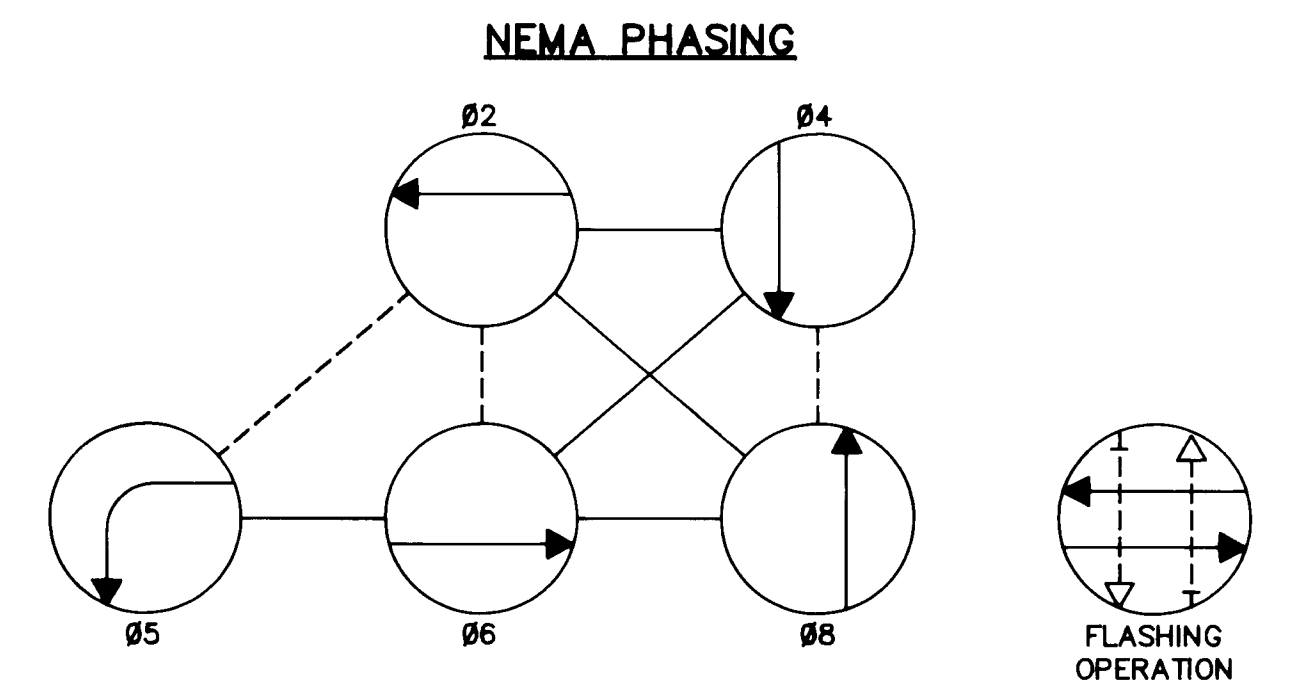

**PHASING NOTES:**

- PHASES ASSOCIATED BY A SOLID LINE WILL NOT OPERATE CONCURRENTLY.
- PHASES ASSOCIATED BY A DASHED LINE WILL OPERATE CONCURRENTLY.

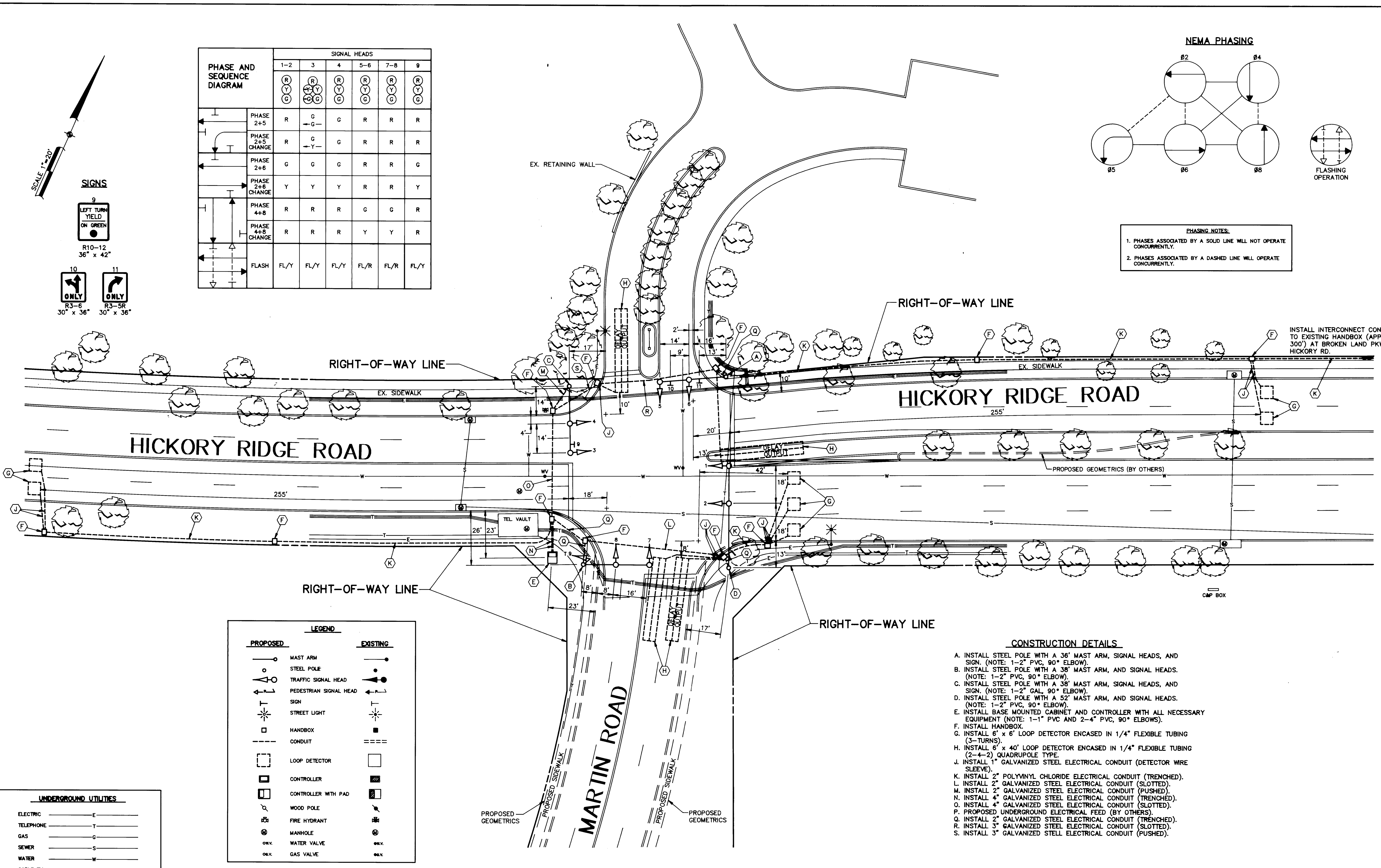

**LEGEND**

PROPOSED	EXISTING
MAST ARM	MAST ARM
STEEL POLE	STEEL POLE
TRAFFIC SIGNAL HEAD	TRAFFIC SIGNAL HEAD
PEDESTRIAN SIGNAL HEAD	PEDESTRIAN SIGNAL HEAD
SIGN	SIGN
STREET LIGHT	STREET LIGHT
HANDBOX	HANDBOX
CONDUIT	CONDUIT
LOOP DETECTOR	LOOP DETECTOR
CONTROLLER	CONTROLLER
CONTROLLER WITH PAD	CONTROLLER WITH PAD
WOOD POLE	WOOD POLE
FIRE HYDRANT	FIRE HYDRANT
MANHOLE	MANHOLE
WATER VALVE	WATER VALVE
GAS VALVE	GAS VALVE

**UNDERGROUND UTILITIES**

ELECTRIC	E
TELEPHONE	T
GAS	G
SEWER	S
WATER	W
CABLE TV	TV

- CONSTRUCTION DETAILS**
- INSTALL STEEL POLE WITH A 36" MAST ARM, SIGNAL HEADS, AND SIGN. (NOTE: 1-2" PVC, 90° ELBOW).
  - INSTALL STEEL POLE WITH A 38" MAST ARM, AND SIGNAL HEADS. (NOTE: 1-2" PVC, 90° ELBOW).
  - INSTALL STEEL POLE WITH A 38" MAST ARM, SIGNAL HEADS, AND SIGN. (NOTE: 1-2" GAL, 90° ELBOW).
  - INSTALL STEEL POLE WITH A 52" MAST ARM, AND SIGNAL HEADS. (NOTE: 1-2" PVC, 90° ELBOW).
  - INSTALL BASE MOUNTED CABINET AND CONTROLLER WITH ALL NECESSARY EQUIPMENT (NOTE: 1-1" PVC AND 2-4" PVC, 90° ELBOWS).
  - INSTALL HANDBOX.
  - INSTALL 6" x 6" LOOP DETECTOR ENCASED IN 1/4" FLEXIBLE TUBING (3-TURNS).
  - INSTALL 6" x 40" LOOP DETECTOR ENCASED IN 1/4" FLEXIBLE TUBING (2-4-2) QUADRUPOLE TYPE.
  - INSTALL 1" GALVANIZED STEEL ELECTRICAL CONDUIT (DETECTOR WIRE SLEEVE).
  - INSTALL 2" POLYVINYL CHLORIDE ELECTRICAL CONDUIT (TRENCHED).
  - INSTALL 2" GALVANIZED STEEL ELECTRICAL CONDUIT (SLOTTED).
  - INSTALL 2" GALVANIZED STEEL ELECTRICAL CONDUIT (PUSHED).
  - INSTALL 4" GALVANIZED STEEL ELECTRICAL CONDUIT (TRENCHED).
  - INSTALL 4" GALVANIZED STEEL ELECTRICAL CONDUIT (SLOTTED).
  - PROPOSED UNDERGROUND ELECTRICAL FEED (BY OTHERS).
  - INSTALL 2" GALVANIZED STEEL ELECTRICAL CONDUIT (TRENCHED).
  - INSTALL 3" GALVANIZED STEEL ELECTRICAL CONDUIT (SLOTTED).
  - INSTALL 3" GALVANIZED STEEL ELECTRICAL CONDUIT (PUSHED).

746

DEPARTMENT OF PUBLIC WORKS  
HOWARD COUNTY, MARYLAND

DATE: 6/17/92  
DATE: 6/18/92

CHIEF, BUREAU OF ENGINEERING

**A/E GROUP, INC.**  
CONSULTING ENGINEERS/PLANNERS  
11409 CROWN HILL DRIVE  
OWINGS MILLS, MD. 21117  
301-363-1908

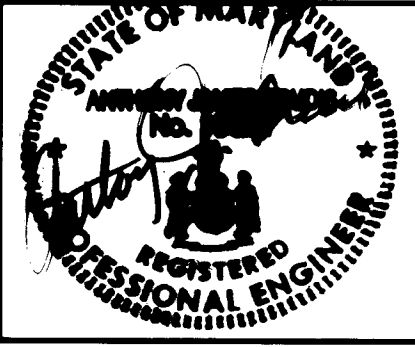

DES: TMZ			
DRN: JNV (CADD)			
CHK: TB			
DATE: 8/9/91	BY: ND	REVISION	DATE: 600' SCALE MAP NO. _____ DATE: _____

T-7047 GG

TRAFFIC SIGNAL PLAN  
**HICKORY RIDGE ROAD • MARTIN ROAD**

SHEET 1 OF 1

HICKMART