

PAVING SYMBOLS

EXISTING	PROPOSED

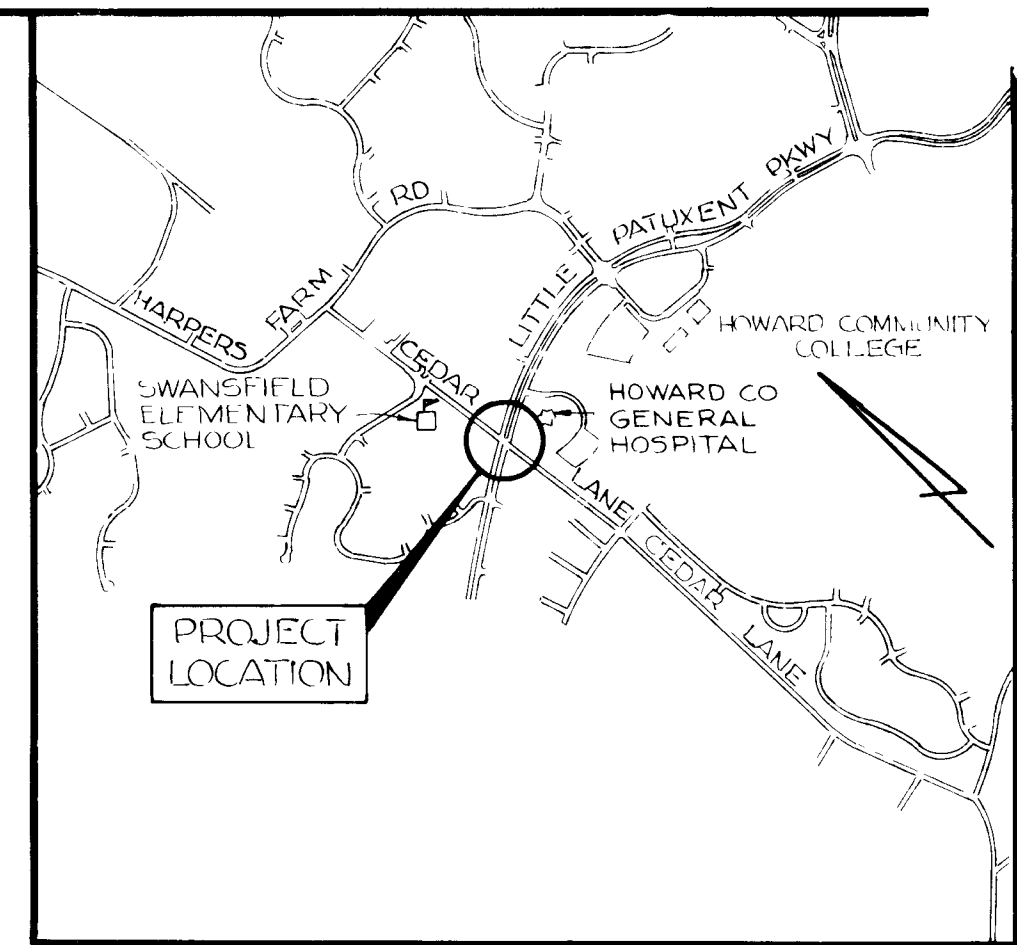

VICINITY MAP
SCALE 1"=2000'

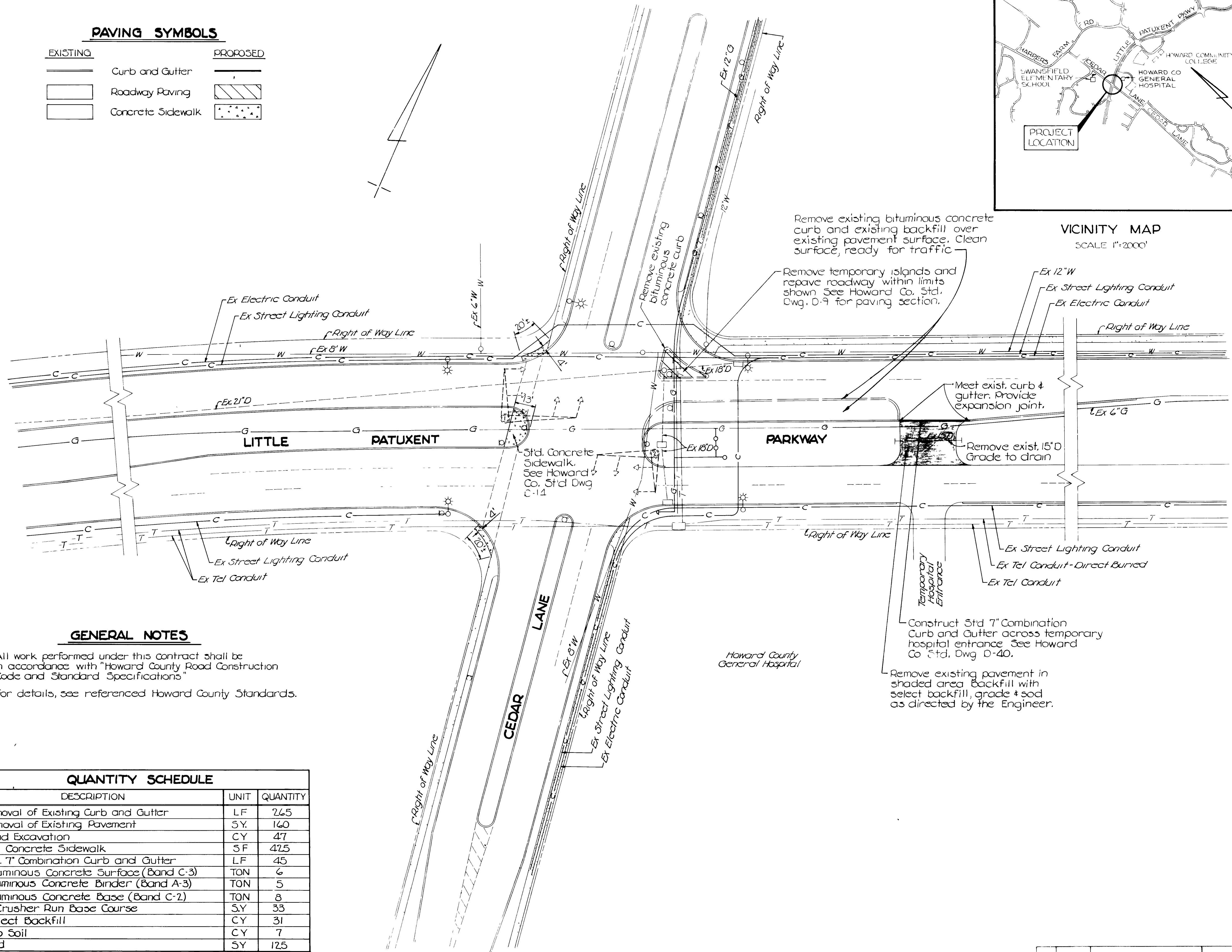

GENERAL NOTES

- All work performed under this contract shall be in accordance with "Howard County Road Construction Code and Standard Specifications"
- For details, see referenced Howard County Standards.

QUANTITY SCHEDULE		
DESCRIPTION	UNIT	QUANTITY
Removal of Existing Curb and Gutter	LF	265
Removal of Existing Pavement	SY	160
Road Excavation	CY	47
Std Concrete Sidewalk	SF	475
Std 7" Combination Curb and Gutter	LF	45
Bituminous Concrete Surface (Band C-3)	TON	6
Bituminous Concrete Binder (Band A-3)	TON	5
Bituminous Concrete Base (Band C-2)	TON	8
7" Crusher Run Base Course	SY	33
Select Backfill	CY	31
Top Soil	CY	7
Sod	SY	125

DEPARTMENT OF PUBLIC WORKS
HOWARD COUNTY, MARYLAND

Director of Public Works: *John E. Nunn* 11-19-90
 Chief - Bureau of Engineering: *William S. Rely* 11-19-90
 Chief - Division of Roads, Bridges and Storm Drainage: *Charles Anderson* 11/18/90
 Chief - Traffic Division: *James E. ...* 11/18/90

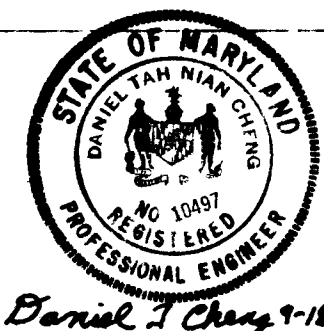

PLAN INTERSECTION GEOMETRIC MODIFICATIONS

LITTLE PATUXENT PARKWAY / CEDAR LANE

CAPITAL PROJECT NO T-0-7011
ELECTION DISTRICT NO 5
HOWARD COUNTY, MARYLAND

DRAWING	SCALE	D.T.C.
NO 1 OF 1	1"=30'	DESIGNED BY: RWS DRAFTED BY: KLE CHECKED BY: