

- Notes:**
1. Maximum sidewalk cross-slope is 2% (1:50).
  2. A 5'x5' minimum level (2%) landing is required at the top and bottom of all ramps. Ramps and slopes greater than 5%.
  3. Maximum slope in any direction of the handicap accessible parking is 2%.

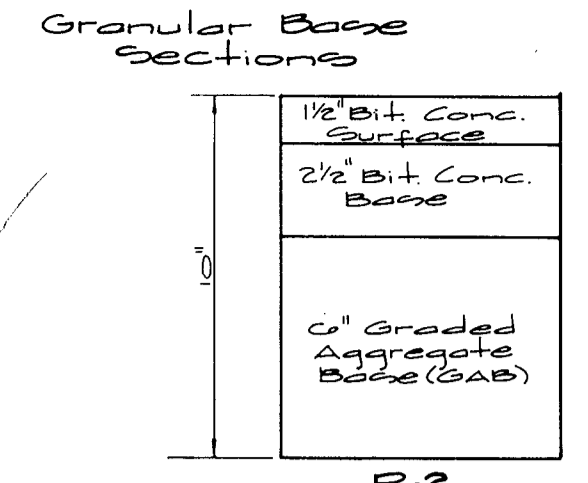

Note: Paving sections indicated are Howard Co. Std. sections and are nominal. Actual paving sections may vary due to subgrade conditions.

Full Depth Bit. Conc. Alternate

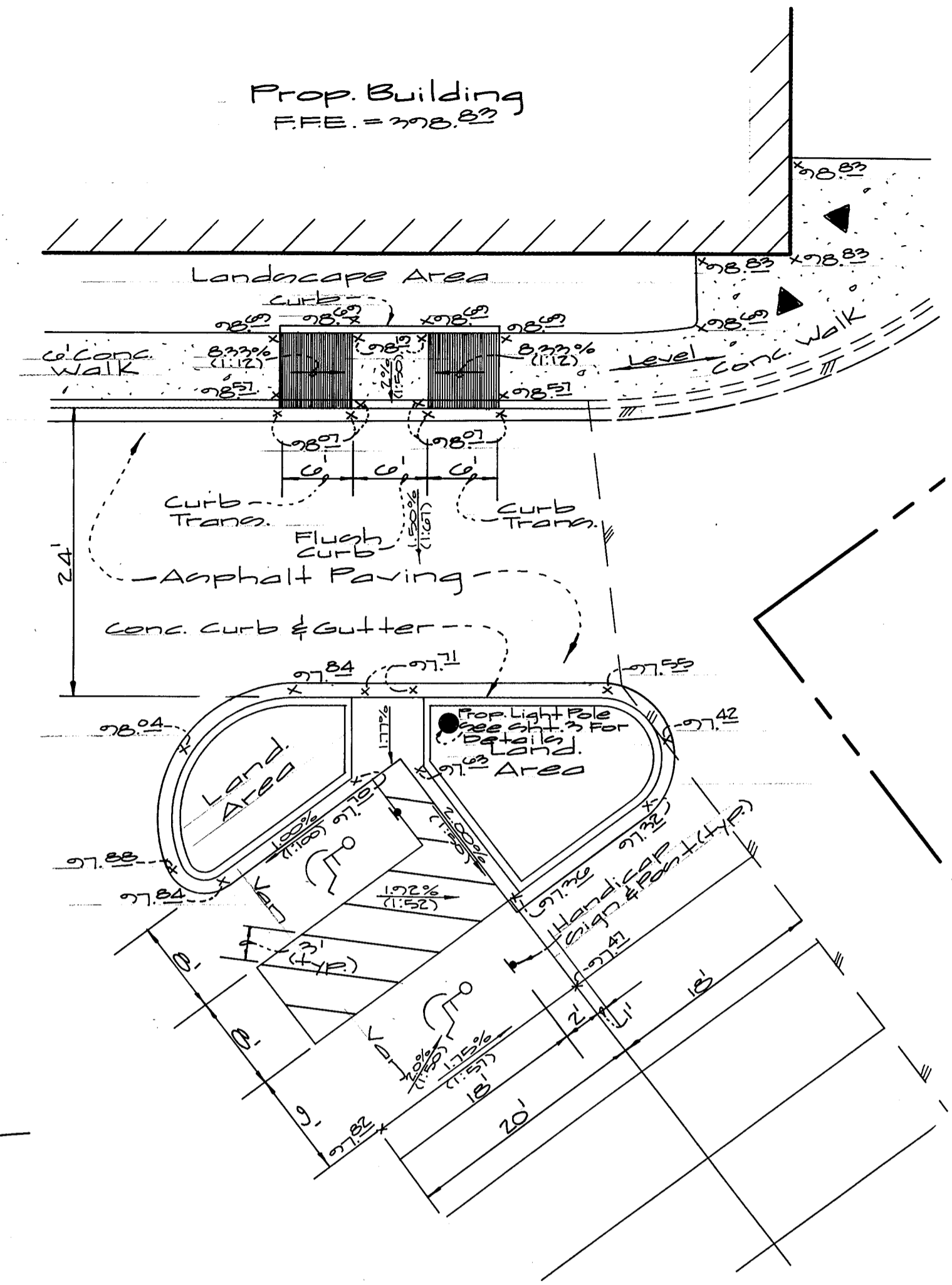
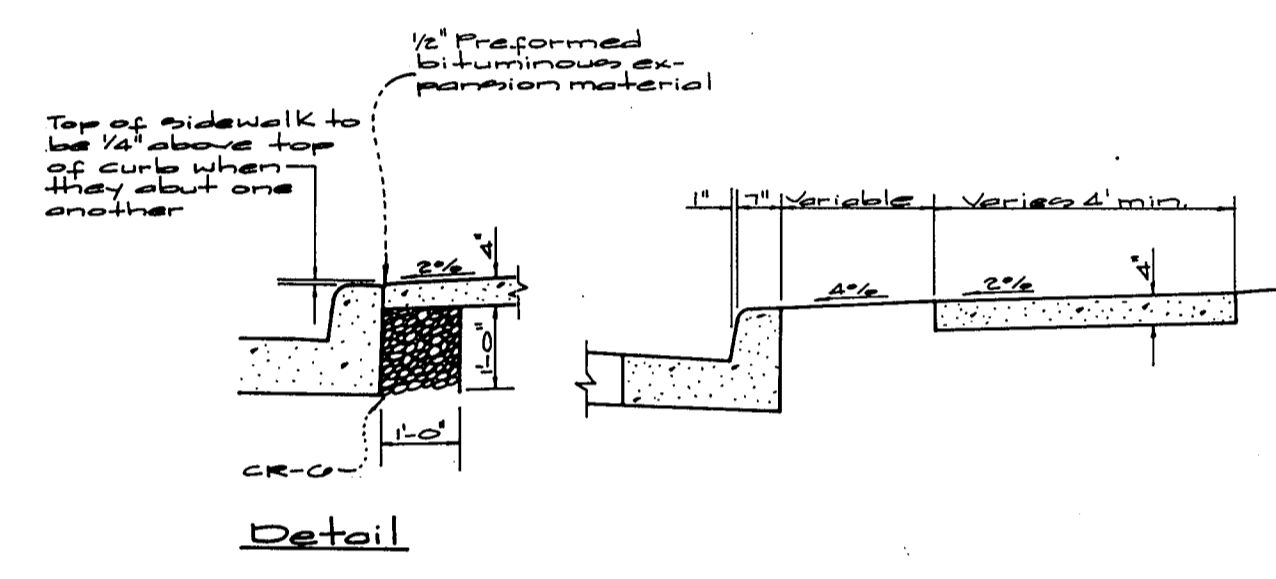
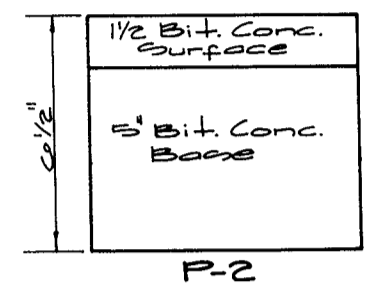

- Notes:**
1. Sidewalk to be scribed in 5' maximum squares.
  2. Expansion joints across the sidewalk not to be more than 15' apart.
  3. 1/2" prepared bituminous expansion material in expansion joints to be kept 1/2" below surface of sidewalk.
  4. Concrete to be mix No. 2.
  5. When sidewalk abuts curb, walk shall be 1/2" above curb with prepared bituminous expansion material between sidewalk and curb and resting on a compacted crushed stone base. See detail A this sheet.
  6. On longitudinal sidewalk grades of 5% or greater, a concrete header, 6" thick and 6" deep below the normal 4" sidewalk thickness shall be constructed for the full width of the sidewalk at intervals of 40'. The headers shall be placed at expansion joint locations and shall be monolithic with the sidewalk.

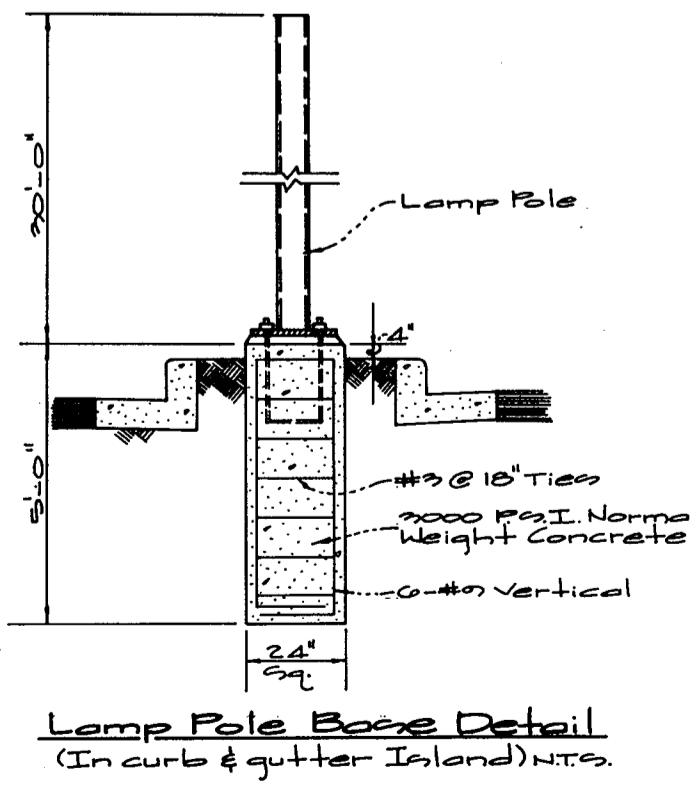
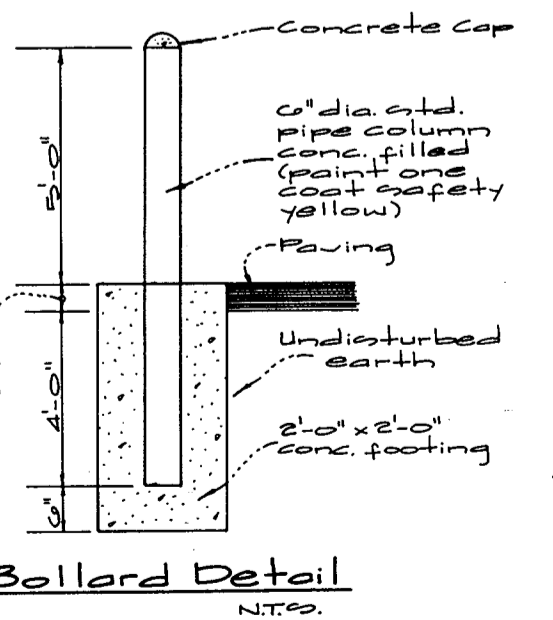
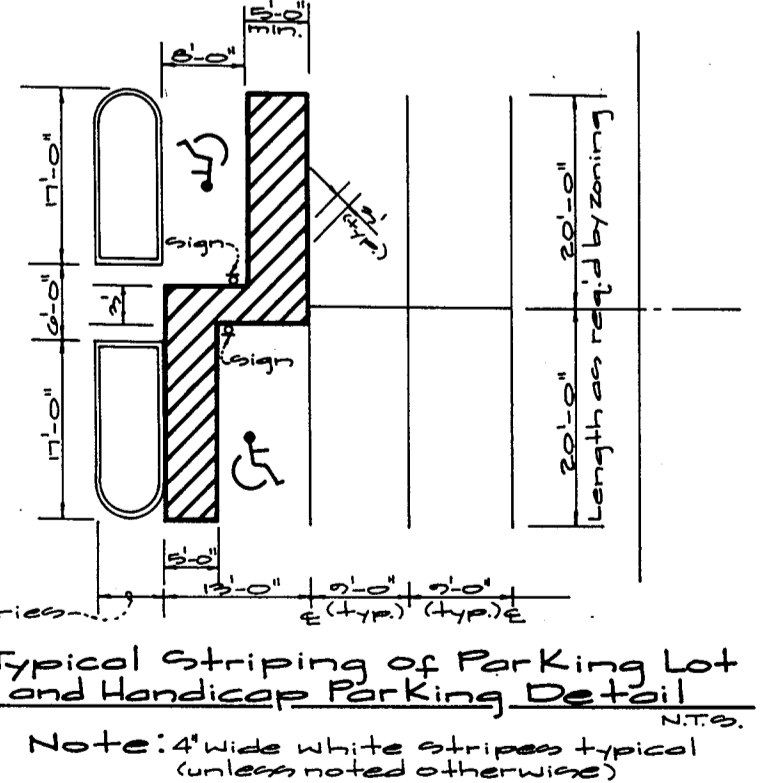
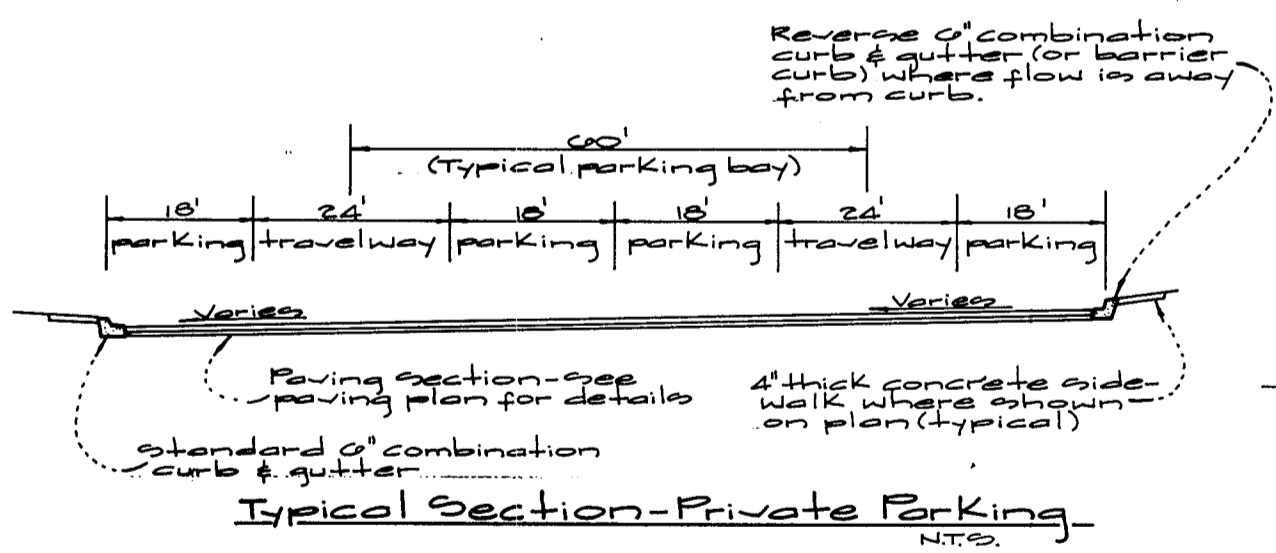
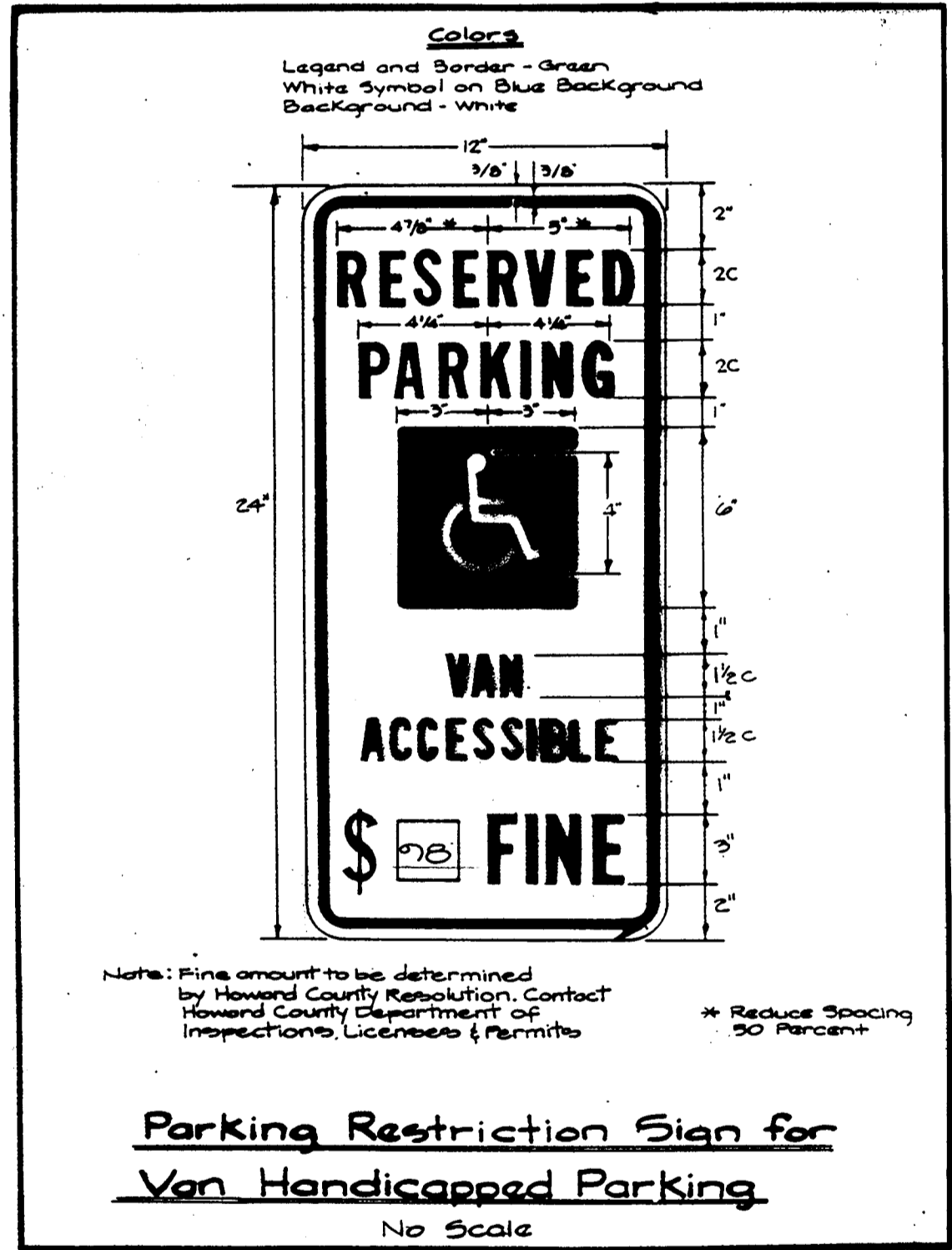
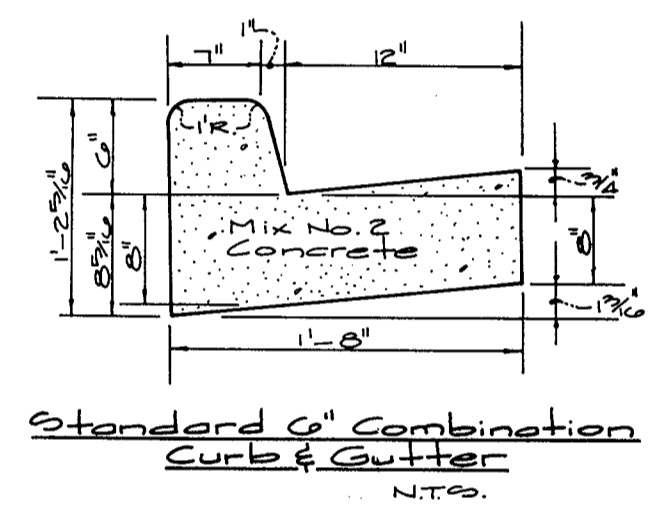
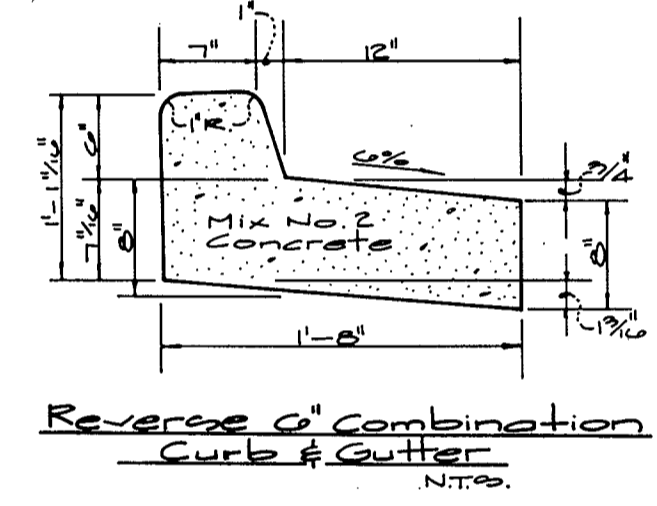

**Owner:**  
The Howard Research & Development Corporation  
10215 Little Pasture Pkwy.  
Columbia, Maryland 21044  
Phone: (410) 792-4027  
Attn: Al Edwards



Approved: For Public water & sewerage systems, Howard Co. Health Dept.  
*James M. Boyd* 9/26/97  
County Health Officer Date

Approved: Howard County Department of Planning & Zoning  
*Angel T. Yalla* 9/29/97  
Director Date

*Candy Hamilton* 9/29/97  
Chief, Division of Land Development Date

*Charles D. ...* 9/29/97  
Chief, Development Engineering Div. Date

**APPROVED**  
PLANNING BOARD  
of HOWARD COUNTY  
DATE: 7/16/97

**GLW GUTSCHICK LITTLE & WEBER, P.A.**  
CIVIL ENGINEERS, SURVEYORS, PLANNERS, LANDSCAPE ARCHITECTS  
3909 NATIONAL DRIVE - SUITE 250 - BURTONSVILLE OFFICE PARK - BURTONSVILLE, MD. 20866  
TELEPHONE: (301) 421-4024 NO. VA. (301) 989-2524 BALTO. (301) 880-1820 FAX (301) 421-4186

| DATE | REVISION | BY | APP'R. |
|------|----------|----|--------|
|      |          |    |        |
|      |          |    |        |
|      |          |    |        |

PREPARED FOR/  
Developer:  
Chicken Out, Inc.  
15992 Shady Grove Road  
Gaithersburg, Maryland 20877

**Handicap Accessibility and Site Details**  
**Route 175 Commercial Parcel "R"**  
Guilford Election District No. 6  
Howard County, Maryland

| DES.   | SCALE     | ZONING        | G.L.W. FILE NO. |
|--------|-----------|---------------|-----------------|
| W.S.J. | As shown  | NT Commercial | 97-056          |
| DRN.   | DATE      | TAX MAP NO.   | SHEET           |
| W.S.J. | May, 1997 | 70            | 2 of 6          |
| CHK.   | DATE      | TAX MAP NO.   | SHEET           |
| W.S.J. | May, 1997 | 70            | 2 of 6          |

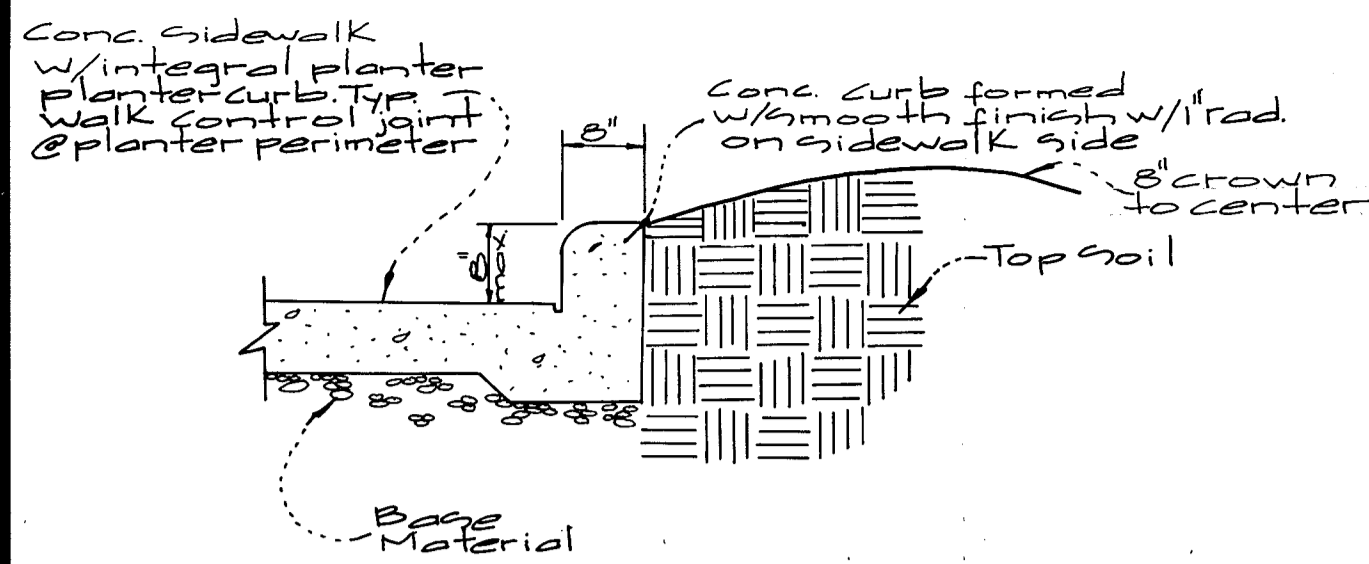

PROPERTY OF  
 THE HOWARD RESEARCH AND DEVELOPMENT CORPORATION  
 L 1535 F. 103  
 ZONED NT

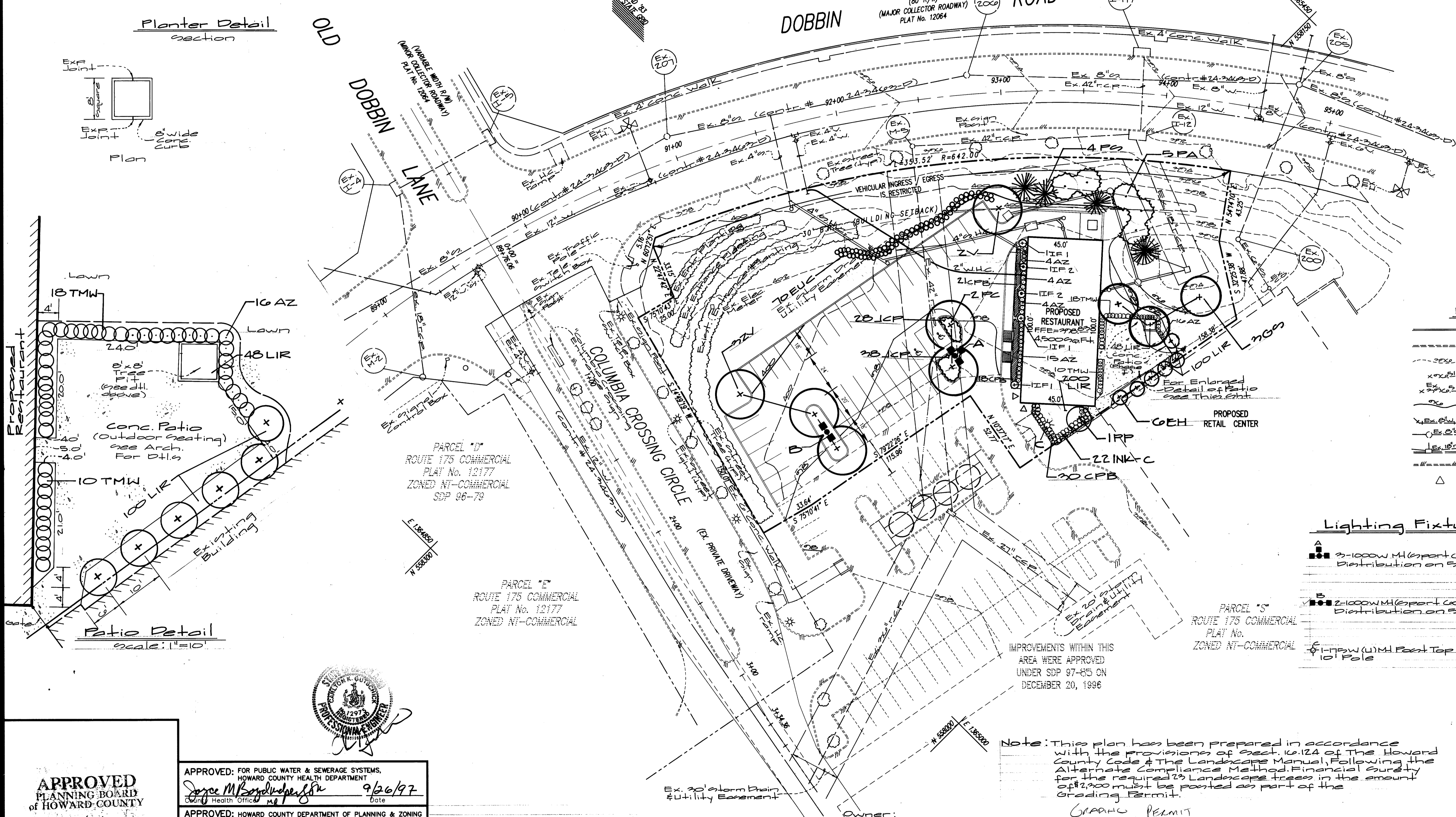
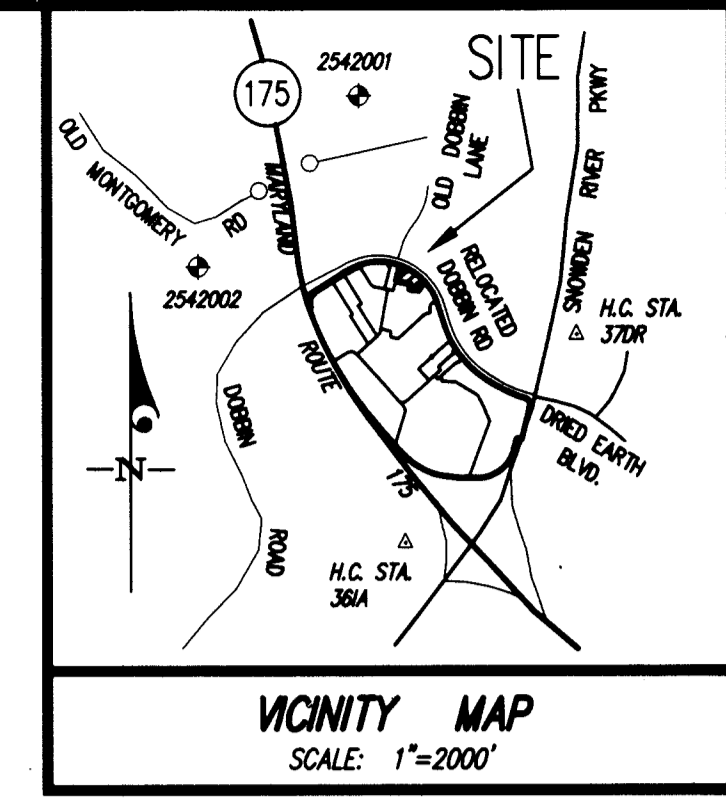

- Legend**
- Prop Curb
  - ==== Exist Curb
  - Exist Contour
  - x=2.00' Prop spot Elevation
  - x=2.00' Exist spot Elevation
  - Prop Contour
  - Exist Water
  - Exist Sewer
  - Exist Storm Drain
  - Exist Paving
  - △ Patron Access

- Lighting Fixture Types**
- A 2-1000W MH (Sport 60) Type III EMC#ECA-292-3H-1000MH  
 Distribution on 50' Pole Pole: KW Industries #KTSF50-110-7-BRZ DM 2100
  - B 2-1000W MH (Sport 60) Type III EMC#ECA-292-3H-1000MH  
 Distribution on 50' Pole Pole: KW Industries #KTSF50-110-7-BRZ DM 2100
  - C 1-1500W (UM) Post Top on 10' Pole LUMEC#TMS-M-CAND2-CRR-480-1 VR214-APR4F-10

IMPROVEMENTS WITHIN THIS AREA WERE APPROVED UNDER SDP 97-85 ON DECEMBER 20, 1996

Note: This plan has been prepared in accordance with the provisions of Sect. 10.124 of The Howard County Code & The Landscape Manual. Following the Alternate Compliance Method, Financial Surety for the required 23 Landscape trees in the amount of \$2,200 must be posted as part of the Grading Permit.

GRAPHIC PERMIT

Owner:  
 The Howard Research & Development Corporation  
 10275 Little Patuxent Pkwy.  
 Columbia, Maryland 21044  
 Phone: (410) 992-0027  
 Attn: Al Edwards

APPROVED: FOR PUBLIC WATER & SEWERAGE SYSTEMS, HOWARD COUNTY HEALTH DEPARTMENT  
 Director: *George M. B...* Date: 9/26/97

APPROVED: HOWARD COUNTY DEPARTMENT OF PLANNING & ZONING  
 Director: *James R...* Date: 9/29/97  
 Chief, Division of Land Development and Research: *Andy Hamilton* Date: 9/29/97  
 Chief, Development Engineering Division: *Mark...* Date: 9/29/97

APPROVED PLANNING BOARD OF HOWARD COUNTY  
 DATE: 7/16/97

**GLW GUTSCHICK LITTLE & WEBER, P.A.**  
 CIVIL ENGINEERS, SURVEYORS, PLANNERS, LANDSCAPE ARCHITECTS  
 3009 NATIONAL DRIVE - SUITE 250 - BURTONSVILLE OFFICE PARK - BURTONSVILLE, MARYLAND 20866

| REVISION | DATE    | BY   | APPR. |
|----------|---------|--|-------|
| 1        | 9/29/97 | Remove Phase II Plan, Ex. Planter etc. & Parking lot plant bed | WSJ   |

Prepared For:  
 Developer:  
 Chicken Out, Inc.  
 15722 Shady Grove Road  
 Gaithersburg, Maryland 20878

**Landscape/ Lighting Plan**  
**ROUTE 175 COMMERCIAL**  
**PARCEL "R"**

|                  |                           |                            |
|------------------|---------------------------|----------------------------|
| SCALE<br>1"=30'  | ZONING<br>NT - COMMERCIAL | G. L. W. FILE No.<br>97056 |
| DATE<br>MAY 1997 | TAX MAP No.<br>36         | SHEET<br>3 OF 6            |

PLANT MATERIALS AND PLANTING METHODS

A. Plant Materials

The landscape contractor shall furnish and install and/or dig, ball, burlap and transplant all of the plant materials called for on drawings and/or listed in the Plant Schedule.

1. Plant Names

Plant names used in the Plant Schedule shall conform with "Standardized Plant Names," latest edition.

2. Plant Standards

All plant material shall be equal to or better than the requirements of the "USA Standard for Nursery Stock" latest edition, as published by the American Association of Nurserymen (hereafter referred to as AAN Standards). All plants shall be typical of their species and variety, shall have a normal habit of growth and shall be first quality, sound, vigorous, well-branched and with healthy, well-furnished root systems. They shall be free of disease, insect pests and mechanical injuries.

All plants shall be nursery grown and shall have been grown under the same climate conditions as the location of this project for at least two years before planting. Neither heeled-in plants nor plants from cold storage will be accepted.

3. Plant Measurements

All plants shall conform to the measurements specified in the Plant Schedule as approved by the ARC.

- a. Caliper measurements shall be taken six inches (6") above grade for trees under four-inch (4") caliper and twelve (12") above grade for trees four inches (4") in caliper and over.
- b. Minimum branching height for all trees shall be six feet (6'), maximum eight feet (8').
- c. Minimum size for planting shade trees shall be 3-3 1/2" caliper, 14'-16' in height.
- d. Minimum size for planting minor or intermediate focus trees (pines, crabapples, etc.) shall be 3"-3 1/2" caliper, 10'-12' in height.
- e. Minimum size for planting shrubs shall be 18" - 24" spread unless noted otherwise.
- f. Caliper, height, spread and size of ball shall be generally as follows:

| CALIPER     | HEIGHT  | SPREAD  | SIZE OF BALL |
|-------------|---------|---------|--------------|
| 3" - 3 1/2" | 14'-16' | 6'-8'   | 32" diameter |
| 3 1/2" - 4" | 14'-16' | 8'-10'  | 36" diameter |
| 4" - 4 1/2" | 16'-18' | 8'-10'  | 40" diameter |
| 4 1/2" - 5" | 16'-17' | 10'-12' | 44" diameter |
| 5" - 5 1/2" | 16'-20' | 10'-12' | 48" diameter |
| 5 1/2" - 6" | 18'-20' | 12'-14' | 52" diameter |

All plant material shall generally average the median for the size ranges indicated above as indicated in the "AAN Standards".

4. Plant Identification

Legible labels shall be attached to all shade trees, minor trees, specimen shrubs and bundles or boxes of other plant material giving the botanical and common names, size and quantity of each. Each shipment of plants shall bear certificates of inspection as required by Federal, State and County authorities.

5. Plant Inspection

The ARC may, upon request by the builder or developer, at least ten (10) days prior to the installation of any proposed plant material, inspect all proposed plant material at the source of origin.

B. Planting Methods

All proposed plant materials that meet the specifications in Section A are to be planted in accordance with the following methods during the proper planting seasons as described in the following:

1. Planting Seasons

The planting of deciduous trees, shrubs and vines shall be from March 1st to June 15th and from September 15th to December 15th. Planting of deciduous material may be continued during the winter months providing there is no frost in the ground and frost-free topsoil planting mixtures are used.

The planting of evergreen material shall be from March 15th to June 15th and from August 15th to December 1st. No planting shall be done when ground is frozen or excessively moist. No frozen or wet soil shall be used at any time.

2. Digging

All plant material shall be dug, balled and burlapped (B+B) in accordance with the "AAN Standards".

3. Excavation of Plant Pits

The landscaping contractor shall excavate all plant pits, vine pits, hedge trenches and shrub beds in accordance with the following schedule:

- a. Locations of all proposed plant material shall be staked and approved in the field by the landscape architect before any of the proposed plant material is installed by the landscape contractor.
- b. All pits shall be generally circular in outline, vertical sides; depth shall not be less than 6" deeper than the root ball, diameter shall not be less than two times the diameter of the root ball as set forth in the following schedule.
- c. If areas are designated as shrub beds or hedge trenches, they shall be excavated to at least 18" depth minimum. Areas designated for ground covers and vines shall be excavated to at least 12" in depth minimum.
- d. Diameter and depth of tree pits shall generally be as follows:

| PLANT SIZE       | ROOT BALL | DIAMETER | PIT DEPTH |
|------------------|-----------|----------|-----------|
| 3" - 3 1/2" cal. | 32"       | 64"      | 28"       |
| 3 1/2" - 4" cal. | 36"       | 72"      | 32"       |
| 4" - 4 1/2" cal. | 40"       | 80"      | 36"       |
| 4 1/2" - 5" cal. | 44"       | 88"      | 40"       |
| 5" - 5 1/2" cal. | 48"       | 96"      | 44"       |
| 5 1/2" - 6" cal. | 52"       | 104"     | 48"       |

A 20% compaction figure of the soil to be removed is assumed and will be allowed in calculation of extra topsoil. The tabulated pit sizes are for purposes of uniform calculation and shall not override the specified depths below the bottoms of the root balls.

4. Staking, Guying and Wrapping

All plant material shall be staked or guyed, and wrapped in accordance with the following specifications:

- a. Stakes: Shall be sound wood 2" x 2" rough sawn oak or similar durable woods, or lengths, minimum 7'-0" for major trees and 5'-0" minimum for minor trees.
- b. Wire and Cable: Wire shall be #10 ga. galvanized or bethanized annealed steel wire. For trees over 3" caliper, provide 5/16" turn buckles, eye and eye with 4" take-up. For trees over 5" caliper, provide 3/16", 7 strand cable cadmium plated steel, with galvanized "eye" thimbles of wire and hose on trees up to 3" in caliper.
- c. Hose: Shall be new, 2 ply reinforced rubber hose, minimum 1/2" I.D. "Plastic Lock Ties" or "Paul's Trees Braces" may be used in place of wire and hose on trees up to 3" in caliper.
- d. All trees under 3" in caliper are to be planted and staked in accordance with the attached "Typical Tree Staking Detail". All trees over 3" in caliper are to be planted and guyed in accordance with the attached "Typical Tree Guying Detail".

Owner:  
The Howard Research & Development Corporation  
1073 Little Patuxent Pkwy.  
Columbia, Maryland 21044  
Phone: (410) 972-0027  
Attn: Al Edwards

5. Plant Pruning, Edging and Mulching

- a. Each tree, shrub or vine shall be pruned in an appropriate manner to its particular requirements, in accordance with accepted standard practice. Broken or bruised branches shall be removed with clean cuts flush with the adjacent trunk or branches. All cuts over 1" in diameter shall be painted with an approved antiseptic tree wound dressing.
- b. All trenches and shrub beds shall be edged and cultivated to the lines shown on the drawing. The areas around isolated plants shall be edged and cultivated to the full diameter of the pit. Sod which has been removed and stacked shall be used to trim the edges of all excavated areas to the neat lines of the plant pit saucers, the edges of shrub areas, hedge trenches and vine pockets.
- c. After cultivation, all plant materials shall be mulched with a 2" layer of fine, shredded pine bark, peat moss, or another approved material over the entire area of the bed or saucer.

6. Plant Inspection and Acceptance

The ARC shall be responsible for inspecting all planting projects on a periodic basis to assure that all work is proceeding in accordance with the approved plans and specifications.

7. Plant Guarantee

All plant material shall be guaranteed for the duration of one full growing season, after final inspection and acceptance of the work in the planting project. Plants shall be alive and in satisfactory growing condition at the end of the guarantee period.

- a. For this purpose, the "growing season" shall be that period between the end of the "Spring" planting season, and the commencement of the "Fall" planting season.
- b. Guarantee for planting performed after the specified end of the "Spring" planting season, shall be extended through the end of the next following "Spring" planting season.

Sodding

All sodding shall be in accordance to the "Landscape Specification Guidelines for Baltimore-Washington Metropolitan Areas" - latest edition, approved by the Landscape Contractors Association of Metropolitan Washington and the American Society of Landscape Architects.

All sod shall be strongly rooted sod, not less than two years old and free of weeds and undesirable native grasses. Provide only sod capable of growth development when planted and in strips not more than 18" wide x 4" long. Provide sod composed principally of improved strain Kentucky bluegrass, such as, Columbia, Victa, or Escort.

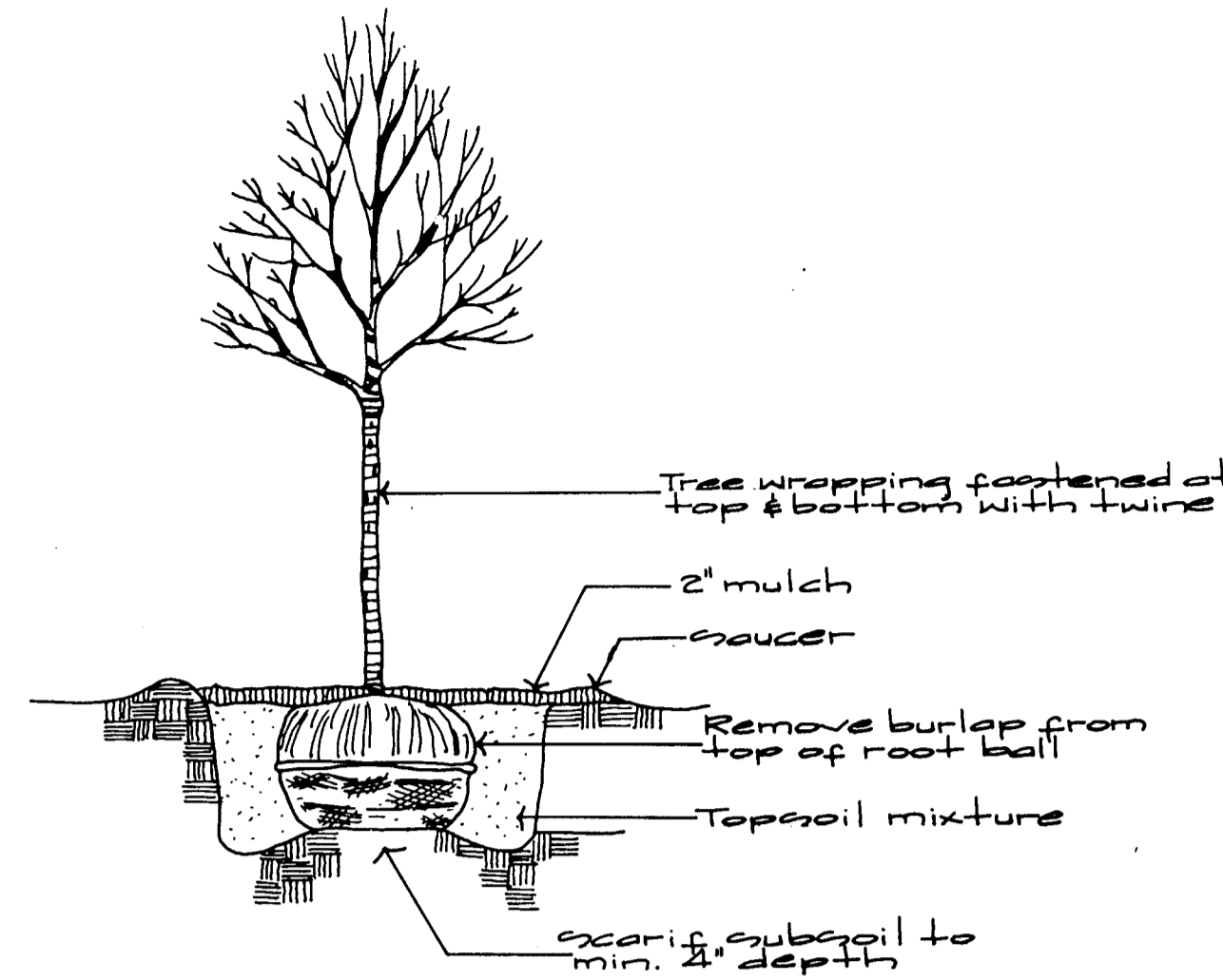

Typical Deciduous Tree Planting

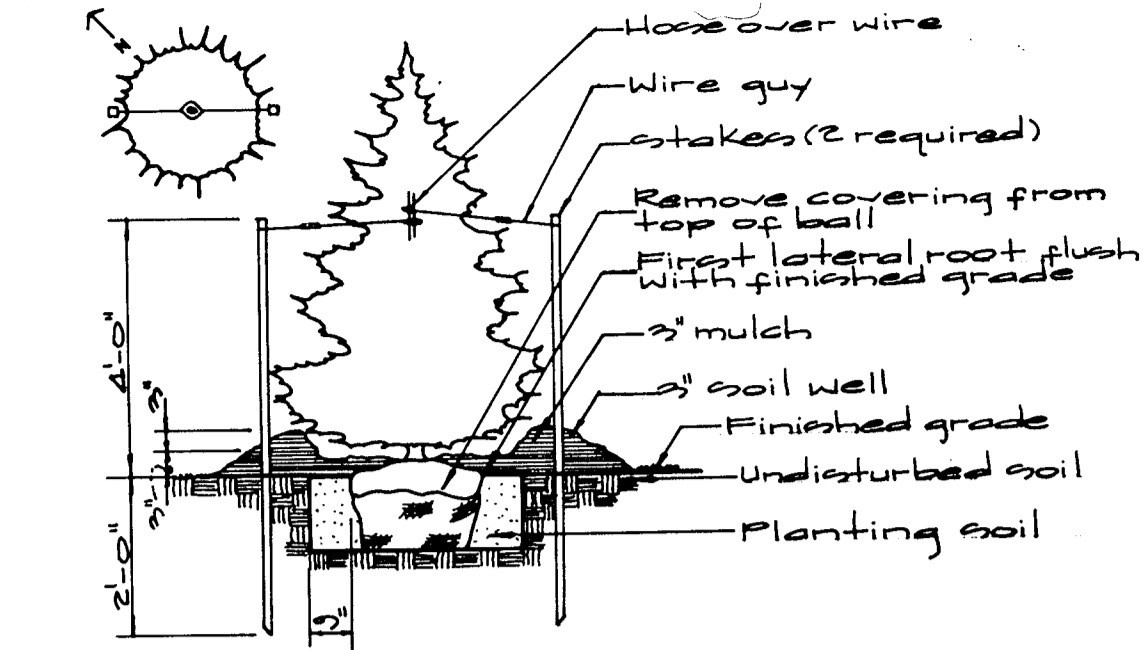
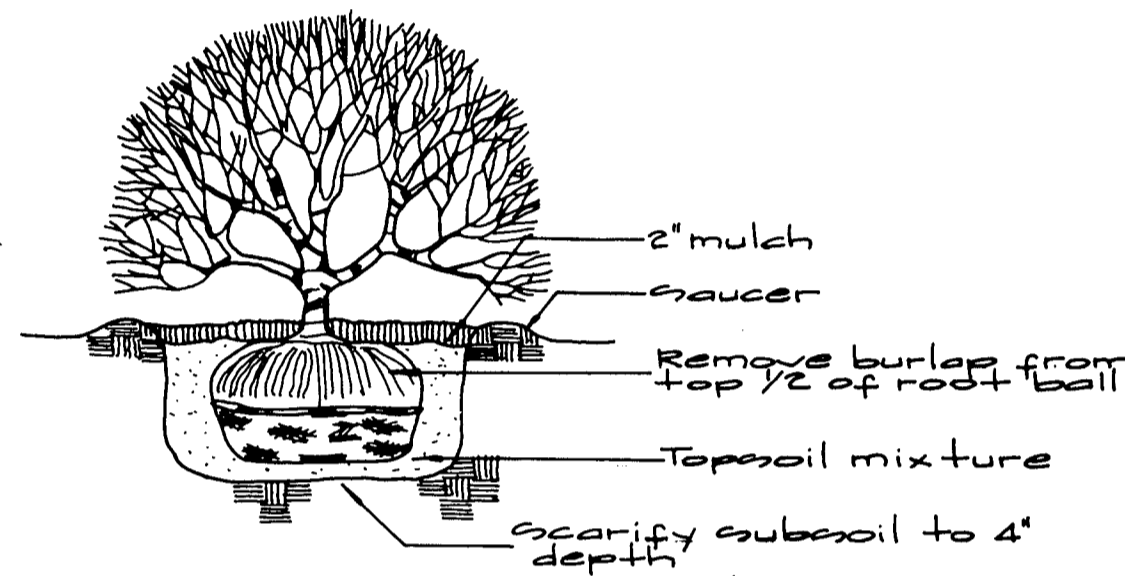

Typical Tree Guying Detail

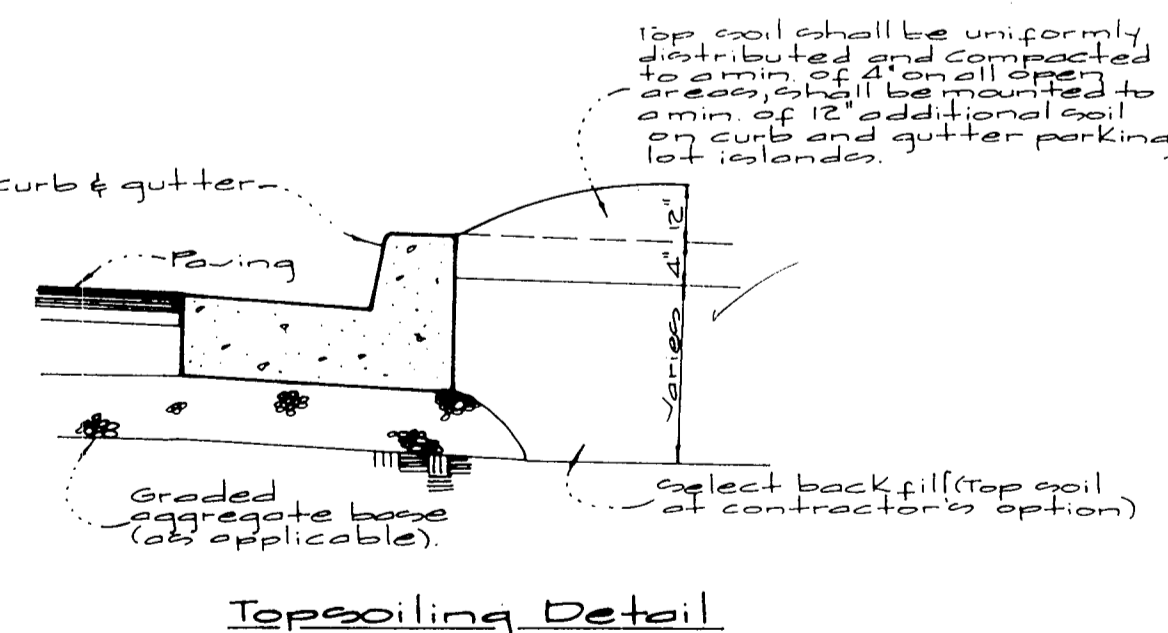

Materials:

Top soil shall be a loam, sandy loam, clay loam, silt loam, sandy clay loam, loamy sand or other soil as approved by an Agronomist or soil scientist. It shall not have a mixture of contrasting textured subsoil and contain no more than 5 percent by volume of cinders, stones, slag, coarse fragments, gravel, sticks, roots, trash or other extraneous materials larger than 1/2" in dia. Top soil must be free of plants or plant parts of bermuda grass, quack grass, johnson grass, nuttall's ragweed, poison ivy, thistle, or others as specified. All top soil shall be tested by a recognized laboratory for organic matter content, pH and soluble salts. 20% of 0 to 75 and an organic content of not less than 1% percent by weight is required. If pH value is less than 6.0, lime shall be applied and incorporated with the top soil to adjust the pH to 6.5 or higher. Top soil containing soluble salts greater than 500 ppm shall not be used.

| Qty   | Quant | Item  | Description                 | Remarks                  |
|-------|-------|---|-----------------------------|--------------------------|
| ZV    | 4     | Zelkova serrata 'Village Green' / 'Village Green' Zelkova   | 3 - 3 1/2" cal. 14-16' hgt. | B&B                      |
| PC    | 2     | Pyrus calleryana 'Cleveland Select' / Cleveland Select Pear | 3 - 3 1/2" cal. 12-14' hgt. | B&B                      |
| PP    | 1     | Prunus cerasifera 'Thundercloud' / Purpleleaf Plum          | 2 1/2 - 3" cal. 10-12' hgt. | B&B                      |
| EH    | 6     | Carpinus betulus 'Fastigata' / Pyr. European Hornbeam       | 3 - 3 1/2" cal. 12-14' hgt. | B&B treeform             |
| INK-C | 22    | Ilex glabra 'Compacta' / Compact Inkberry                   | 18 - 24"                    | plant 30" o.c. staggered |
| JCP   | 66    | Juniperus chinensis 'Parsoni' / Parsons Juniper             | 18 - 24"                    | plant 30" o.c.           |
| CPB   | 60    | Berberis thunbergii atropurpurea / 'Crimson Pygmy' Barberry | 18 - 24" sprd.              | plant 2' o.c.            |
| AZ    | 43    | Rhododendron kurume x traditional / Tradition Azalea        | 18 - 24"                    | plant 30" o.c.           |
| PA    | 5     | Picea abies / Norway Spruce                                 | 8-10' hgt.                  | B&B                      |
| PS    | 4     | Pinus strobus / White Pine                                  | 8-10' hgt.                  | B&B                      |
| LIR   | 248   | Liriope muscari / Big Blue Liriope                          | #1 cont. pest pots          | plant 12" o.c.           |
| EUC   | 70    | Buonymus alatus compacta / Dwarf Winged Euonymus            | 24 - 30"                    | plant 36" o.c. staggered |
| TMW   | 28    | Taxus media 'Wardii' / Wood Yew                             | 18-24"                      | 20% (min)                |
| GO    | 3     | Gleditsia triacanthoides 'Honey Locust' / Honey Locust      | 3 - 3 1/2" cal. 14-16' hgt. | B&B                      |
| IF1   | 3     | Ilex x attenuata 'Fosteri' / Fostera American Holly         | 5-6' hgt.                   | B&B                      |
| IF2   | 2     | Ilex x attenuata 'Fosteri' / Fostera American Holly         | 2 1/2 - 3' hgt.             | B&B                      |

**APPROVED PLANNING BOARD of HOWARD COUNTY**

DATE: 7/16/97

Approved for Public Water & Sewerage Systems, Howard Co. Health Dept. by Joyce M. Boyd, Health Officer, 9/26/97

Approved by Howard County Department of Planning & Zoning by [Signature], Director, 9/29/97

Approved by Chief of Land Development by Cindy Hamilton, 9/29/97

Approved by Chief Development Engineering by [Signature], 9/29/97

**GLW GUTSCHICK LITTLE & WEBER, P.A.**

CIVIL ENGINEERS, SURVEYORS, PLANNERS, LANDSCAPE ARCHITECTS

3909 NATIONAL DRIVE - SUITE 250 - BURTONSVILLE OFFICE PARK - BURTONSVILLE, MD 20866

TELEPHONE: (301) 421-4024 NO. VA. (301) 989-2524 BALTO. (301) 880-1820 FAX (301) 421-4186

| DATE | REVISION | BY | APP'R. |
|------|----------|----|--------|
|      |          |    |        |
|      |          |    |        |

PREPARED FOR: Developer / Chicken Out, Inc. 15932 Shady Grove Road Gaithersburg, Maryland 20878

**Landscaping Notes & Details**

**Route 175 Commercial Parcel "R"**

DES: [Signature] SCALE: As Shown ZONING: NT-Commercial G.L.W. FILE NO.: 97-0560

DRN: [Signature] DATE: May 1997 TAX MAP NO.: 20 SHEET: 4 of 6

CHK: [Signature]

Gulford Election District No. 6 Howard County, Maryland

**SEDIMENT CONTROL NOTES**

- A minimum of 24 hours notice must be given to the Howard County Office of Inspection and Permits prior to the start of any construction. (410) 131-1880
- All vegetative and structural practices are to be installed according to the provisions of this plan and are to be in conformance with the 1994 MARYLAND STANDARDS AND SPECIFICATIONS FOR SOIL EROSION AND SEDIMENT CONTROL.
- Following initial soil disturbance or redistribution, permanent or temporary stabilization shall be completed within: a) 7 calendar days for all perimeter sediment control structures, dikes and perimeter slopes and all slopes greater than 3:1, b) 14 days to all other disturbed or graded areas on the project site.
- All sediment traps/basins shown must be fenced and warning signs posted around their perimeter in accordance with Vol. 1, Chapter 12, of the HOWARD COUNTY DESIGN MANUAL, Storm Drainage.
- All disturbed areas must be stabilized within the time period specified above in accordance with the 1994 MARYLAND STANDARDS AND SPECIFICATIONS FOR SOIL EROSION AND SEDIMENT CONTROL for permanent seedings (Sec. 51), sod (Sec. 54), temporary seedings (Sec. 50) and mulching (Sec. 52). Temporary stabilization, with mulch alone, can only be done when recommended seeding dates do not allow for proper germination and establishment of grasses.
- All sediment control structures are to remain in place and are to be maintained in operative condition until permission for their removal has been obtained from the Howard County Sediment Control Inspector.
- Site Analysis:  
Total Area of Site: 1.22 Acres  
Area Disturbed: 0.80 Acres  
Area to be roofed or paved: 0.46 Acres  
Area to be vegetatively stabilized: 0.74 Acres  
Total Cut: 0.00 Cu. Yds.  
Total Fill: 0.00 Cu. Yds.  
Off-site waste/borrow area location: N.A.
- Any sediment control practice which is disturbed by grading activity for placement of utilities must be repaired on the same day of disturbance.
- Additional sediment control must be provided, if deemed necessary by the Howard County DPW Sediment Control Inspector.
- On all sites with disturbed areas in excess of 2 acres, approval of the inspection agency shall be requested upon completion of installation of perimeter erosion and sediment controls, but before proceeding with any other earth disturbance or grading. Other building or grading inspection approvals may not be authorized until this initial approval by the inspection agency is made.

**PERMANENT SEEDING NOTES**

Apply to graded or cleared area not subject to immediate further disturbance where a permanent long-lived vegetative cover is needed.

Seedbed Preparation: Loosen upper three inches of soil by raking, discing or other acceptable means before seeding (unless previously loosened).

Soil Amendments: In lieu of soil test recommendations, use one of the following schedules:

- Preferred - Apply 2 tons per acre dolomitic limestone (92 lbs/1000 square feet) and 600 lbs per acre 10-10-10 fertilizer (14 lbs/1000 sq ft) before seeding. Harrow or disc into upper three inches of soil. At time of seeding, apply 400 lbs per acre 30-0-0 ureaformal fertilizer (9 lbs/1000 sq ft).
- Acceptable - Apply 2 tons per acre dolomitic limestone (92 lbs/1000 sq ft) and 1000 lbs per acre 10-10-10 fertilizer (23 lbs/1000 sq ft) before seeding. Harrow or disc into upper three inches of soil.

Seeding: For the periods March 1 thru April 30, and August 1 thru October 15, seed with 60 lbs per acre (14 lbs/1000 sq ft) of Kentucky 31 Tall Fescue. For the period May 1 thru July 31, seed with 60 lbs Kentucky 31 Tall Fescue per acre and 2 lbs per acre (.05 lbs/1000 sq ft) of weeping lovegrass. During the period of October 16 thru February 28, protect site by Option (1) 2 tons per acre of well anchored straw mulch and seed as soon as possible in the spring. Option (2) Use sod. Option (3) Seed with 60 lbs/acre Kentucky 31 Tall Fescue and mulch with 2 tons/acre well anchored straw.

Mulching: Apply 1-1/2 to 2 tons per acre (70 to 90 lbs/1000 sq ft) of unrattled small grain straw immediately after seeding. Anchor mulch immediately after application using mulch anchoring tool or 218 gal per acre (5 gal/1000 sq ft) of emulsified asphalt on flat areas. On slopes 8 feet or higher, use 348 gal per acre (8 gal/1000 sq ft) for anchoring.

Maintenance: Inspect all seeded areas and make needed repairs, replacements and reseedings.

**Drainage Area Tabulation**

| Area    | A <sub>1</sub> | A <sub>2</sub> | A <sub>3</sub> | C    |
|---------|----------------|----------------|----------------|------|
| Ex. 101 | 0.71 AC.       | 0.20 AC.       | 0.41 AC.       | 0.69 |
| Ex. 52  | 0.23 AC.       | 0.23 AC.       | 0.0 AC.        | 0.25 |
| 100A    | 0.10 AC.       | 0.0 AC.        | 0.10 AC.       | 0.70 |
| 100     | 0.12 AC.       | 0.04 AC.       | 0.08 AC.       | 0.68 |

**TEMPORARY SEEDING NOTES**

Apply to graded or cleared areas likely to be redistributed where a short-term vegetative cover is needed.

Seedbed Preparation: Loosen upper three inches of soil by raking, discing or other acceptable means before seeding (unless previously loosened).

Soil Amendments: Apply 600 lbs per acre 10-10-10 fertilizer (14 lbs/1000 sq ft).

Seeding: For periods March 1 thru April 30 and from August 15 thru November 15, seed with 2-1/2 bushels per acre of annual ryegrass (3.2 lbs./1000 sq ft.). For the period May 1 thru July 31, seed with 3 lbs per acre of weeping lovegrass (.07 lbs/1000 sq ft.). For the period November 16 thru February 28, protect site by applying 2 tons per acre of well anchored straw mulch and seed as soon as possible in the spring, or use sod.

Mulching: Apply 1-1/2 to 2 tons per acre (70 to 90 lbs/1000 sq ft) of unrattled small grain straw immediately after seeding. Anchor mulch immediately after application using mulch anchoring tool or 218 gal per acre (5 gal/1000 sq ft) of emulsified asphalt on flat areas. On slopes 8 feet or higher, use 348 gal per acre (8 gal/1000 sq ft) for anchoring.

Refer to the 1994 MARYLAND STANDARDS AND SPECIFICATIONS FOR SOIL EROSION AND SEDIMENT CONTROL for rate and methods not covered.

| CURVE TABLE |         |         |         |               |           |
|-------------|---------|---------|---------|---------------|-----------|
| RADIUS      | LENGTH  | TANGENT | CHORD   | BEARING       | DELTA     |
| 3689.72'    | 265.81' | 132.96' | 265.79' | N 38.46 30' W | 04.09 00' |

APPROVED FOR PUBLIC WATER & SEWERAGE SYSTEMS, HOWARD COUNTY HEALTH DEPARTMENT  
 Approved: *[Signature]* 9/26/97  
 Health Officer

APPROVED: HOWARD COUNTY DEPARTMENT OF PLANNING & ZONING  
 Approved: *[Signature]* 9/29/97  
 Director

Approved: *[Signature]* 9/29/97  
 Chief, Planning and Development and Research

Approved: *[Signature]* 9/29/97  
 Chief, Development Engineering Division

Signature of Developer/Builder: *[Signature]* 5/27/97  
 Date

**ENGINEER'S CERTIFICATE**

I certify that this plan for erosion and sediment control represents a practical and workable plan based on my personal knowledge of the site conditions and that it was prepared in accordance with the requirements of the Howard Soil Conservation District.

Signature: *[Signature]* 5/27/97  
 Date

These plans have been reviewed for the Howard Soil Conservation District and meet the technical requirements.

Signature: *[Signature]* 9/15/97  
 Date

Signature: *[Signature]* 9/15/97  
 Date

PROPERTY OF THE HOWARD RESEARCH AND DEVELOPMENT CORPORATION  
 L. 1535 F. 183  
 ZONED NT

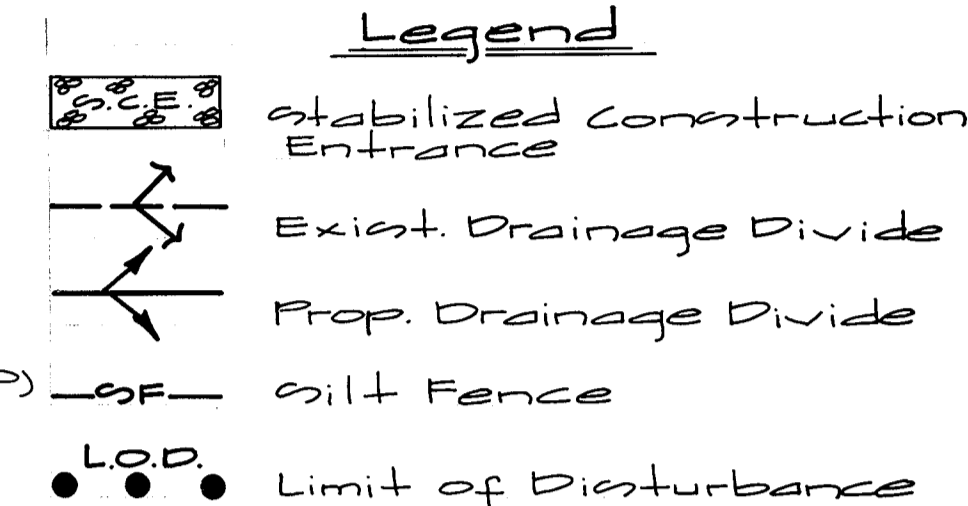
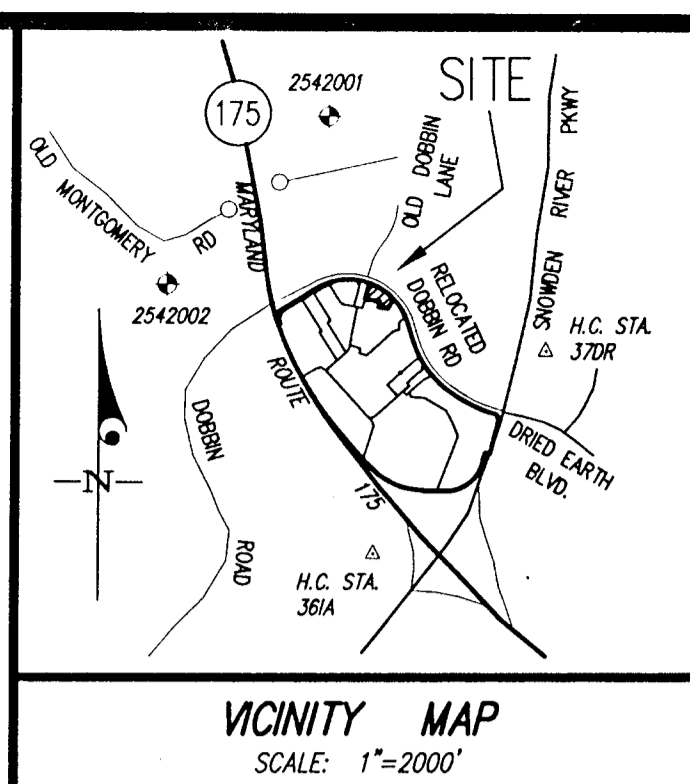
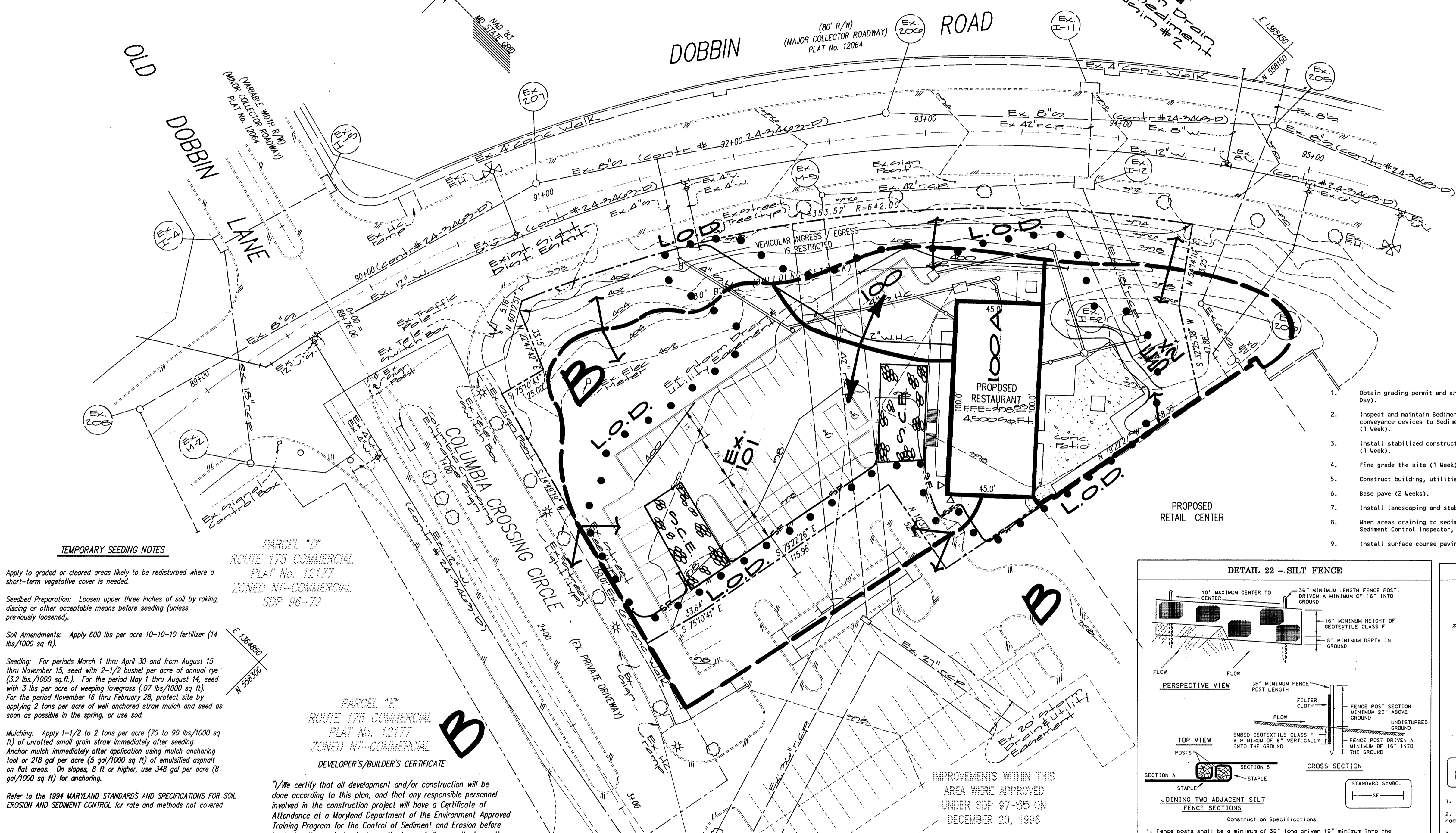

- SEQUENCE OF CONSTRUCTION**
- Obtain grading permit and arrange for pre-construction meeting with the Sediment Control Inspector (1 Day).
  - Inspect and maintain Sediment Basin No. 2, as required. Inspect other existing sediment controls and conveyance devices to Sediment Basin No. 2 and maintain as required (1 Week).
  - Install stabilized construction entrances and silt fence (1 Week).
  - Fine grade the site (1 Week).
  - Construct building, utilities, curb and gutter and sidewalks (6 Months).
  - Base pave (2 Weeks).
  - Install landscaping and stabilize remaining areas with sod or grass seed and mulch (1 Week).
  - When areas draining to sediment controls have been stabilized and permission has been granted by the Sediment Control Inspector, remove silt fence.
  - Install surface course paving.

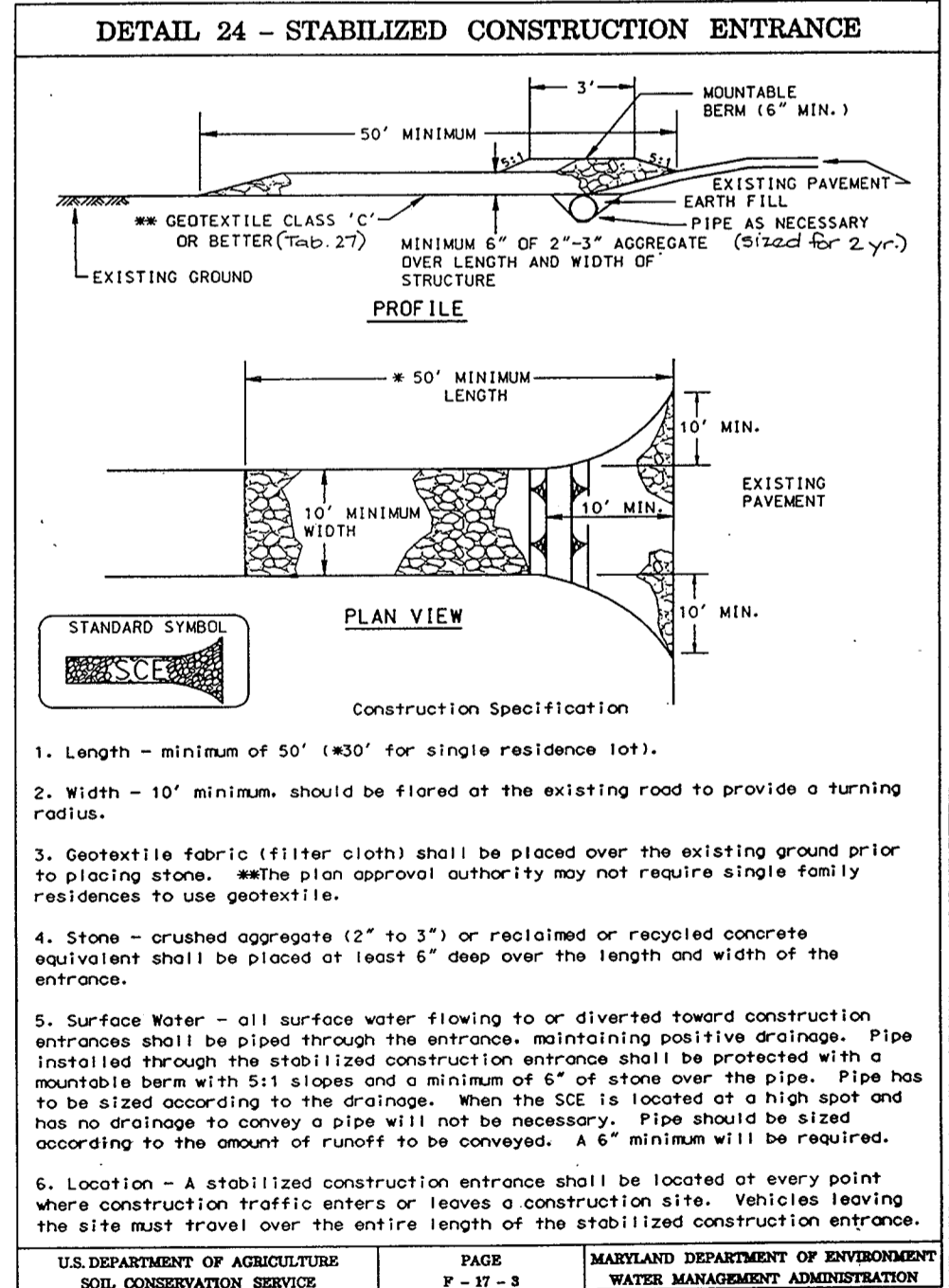
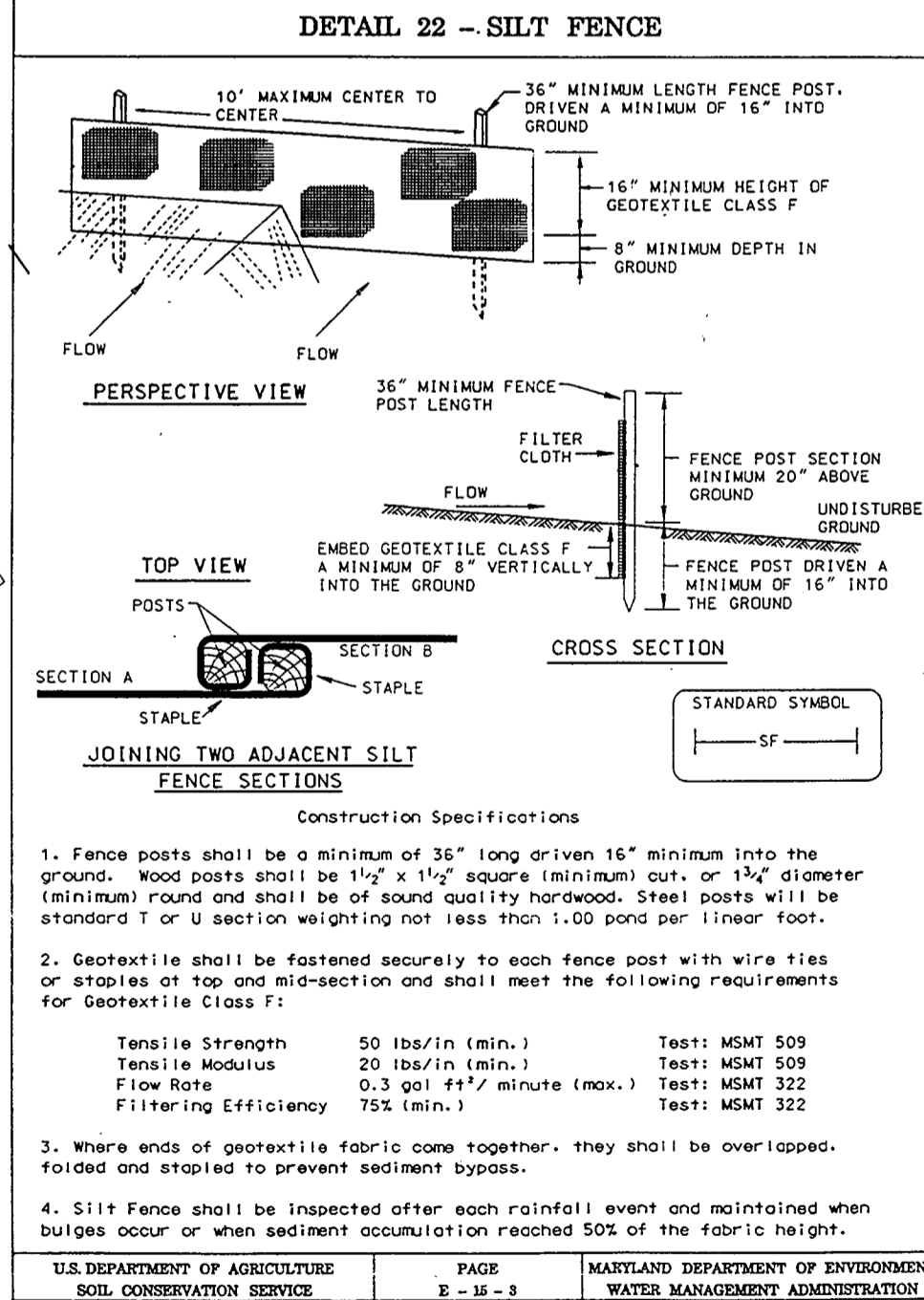

**GUTSCHICK LITTLE & WEBER, P.A.**  
 CIVIL ENGINEERS, SURVEYORS, PLANNERS, LANDSCAPE ARCHITECTS  
 3909 NATIONAL DRIVE - SUITE 250 - BURTONSVILLE OFFICE PARK - BURTONSVILLE, MARYLAND 20866  
 TEL: (301) 421-4024 NO. VA.; (301) 989-2524 BALT.; (410) 880-1820 FAX; (301) 421-4186

Prepared For: Developer  
 Chicken Out, Inc.  
 15992 Gladys Grove Road  
 Gaithersburg, Maryland 20877

Sediment Control Plan, Notes & Details / D.A. Map  
**ROUTE 175 COMMERCIAL PARCEL "R"**

|                |                         |                          |
|----------------|-------------------------|--------------------------|
| SCALE: 1"=30'  | ZONING: NT - COMMERCIAL | G. L. W. FILE NO.: 97056 |
| DATE: MAY 1997 | TAX MAP NO.: 36         | SHEET: 5 OF 6            |

HOWARD COUNTY, MARYLAND  
 SDP-97-148

| Structure Schedule |           |           |                 |                  |             |
|--------------------|-----------|-----------|-----------------|------------------|-------------|
| No.                | Type      | Top Elev. | Inv. Elev. (in) | Inv. Elev. (out) | Std. Detail |
| I-100              | A-P Inlet | 778.14    | —               | 772.63           | 218 4.40    |
| M-100              | Manhole   | 778.37    | 771.44          | 768.71           | G.5.12      |
| M-101              | Manhole   | 400.00    | 772.07          | 771.97           | G.5.12      |

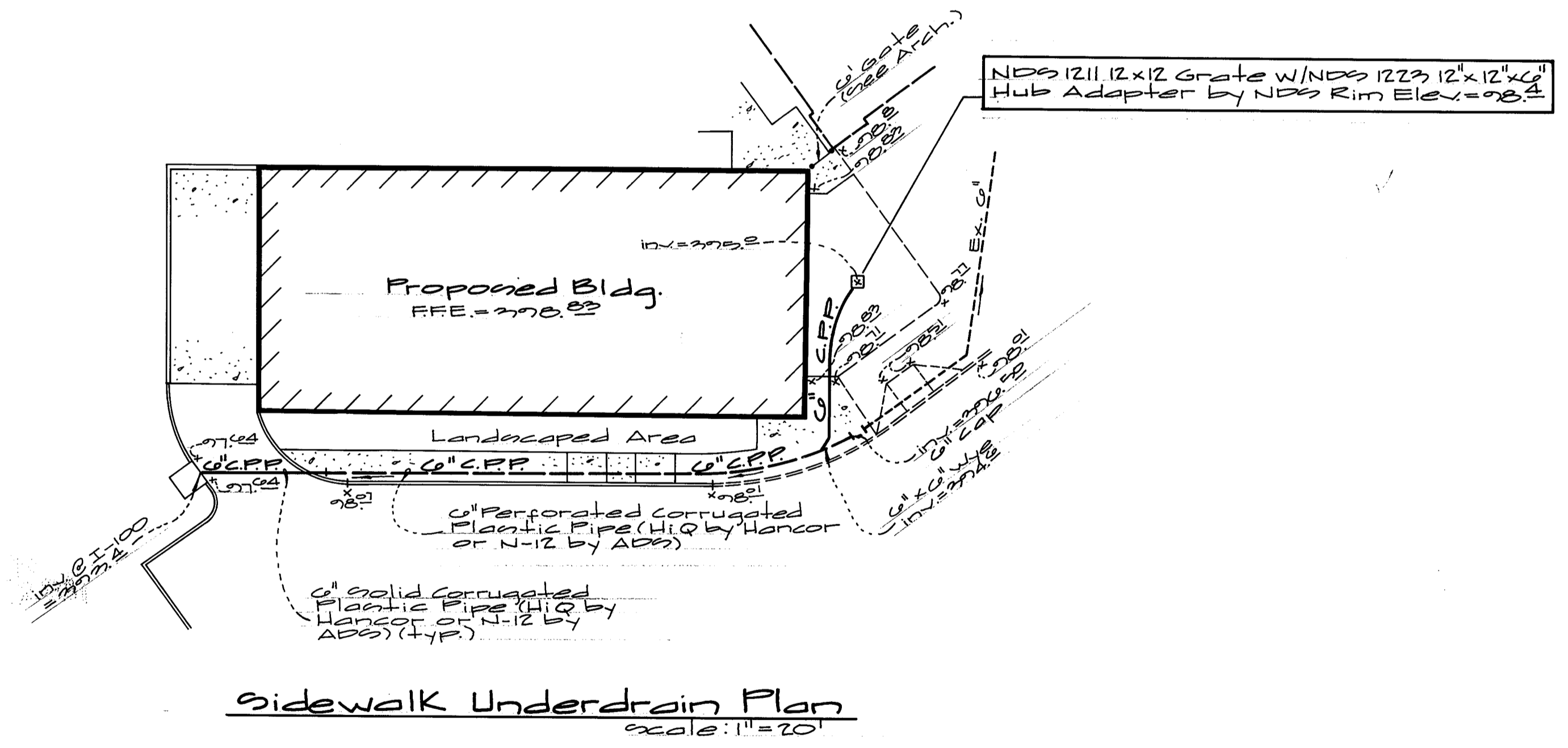
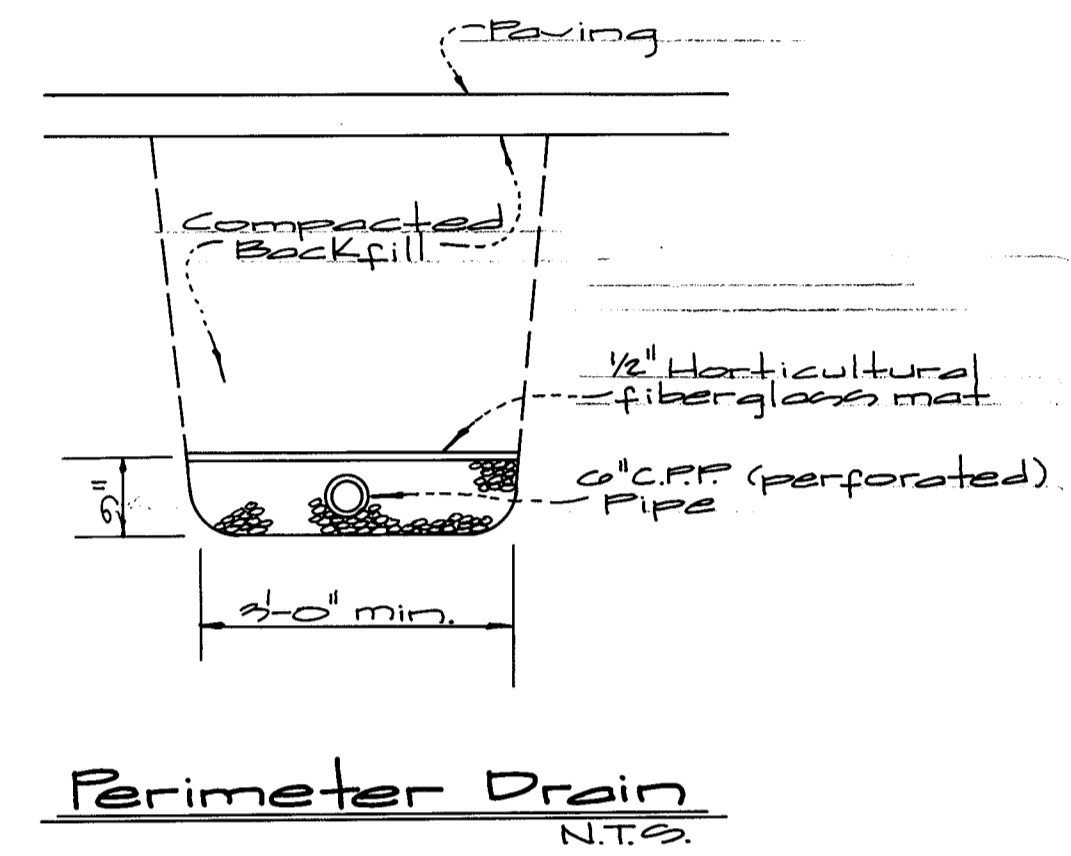
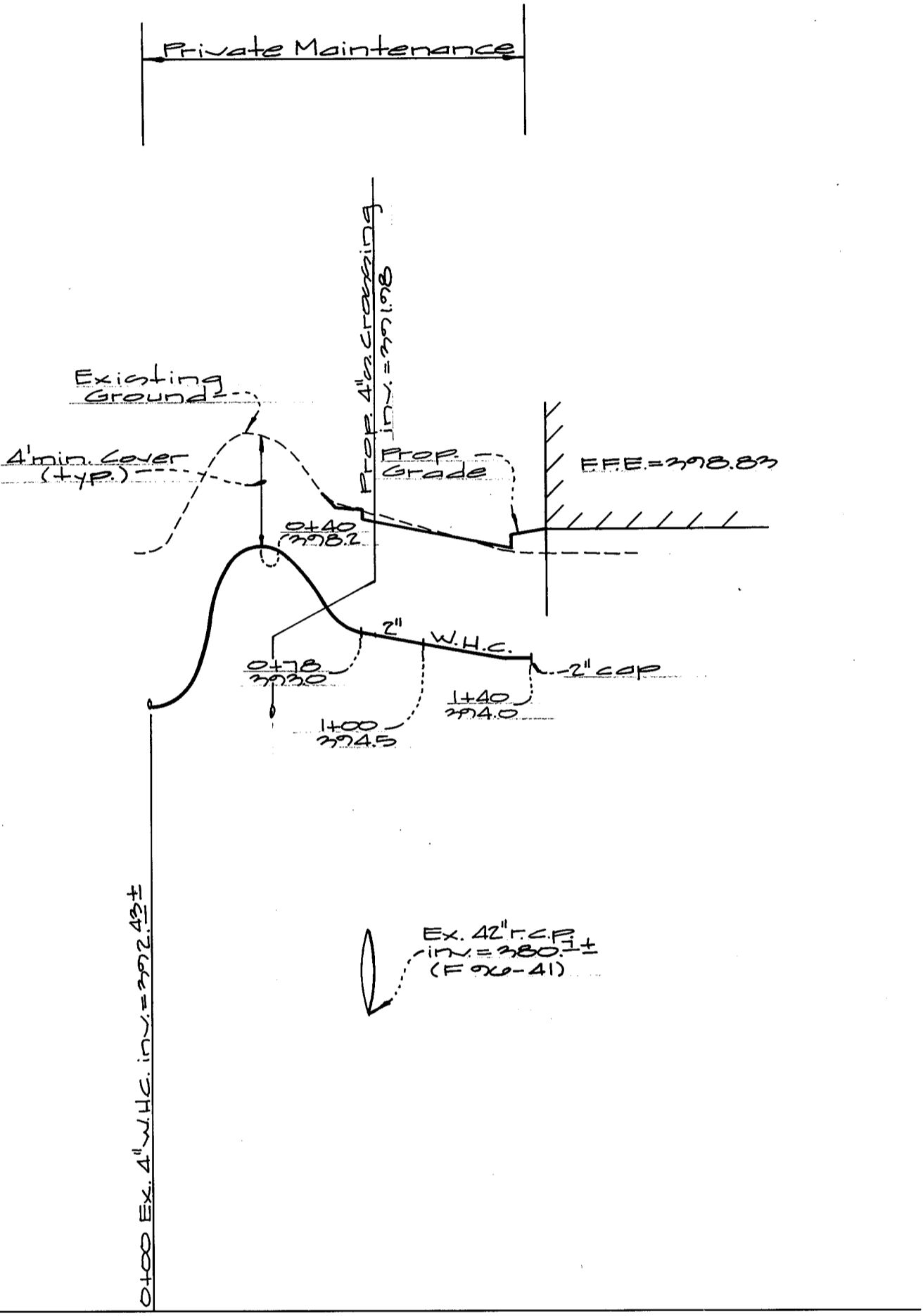
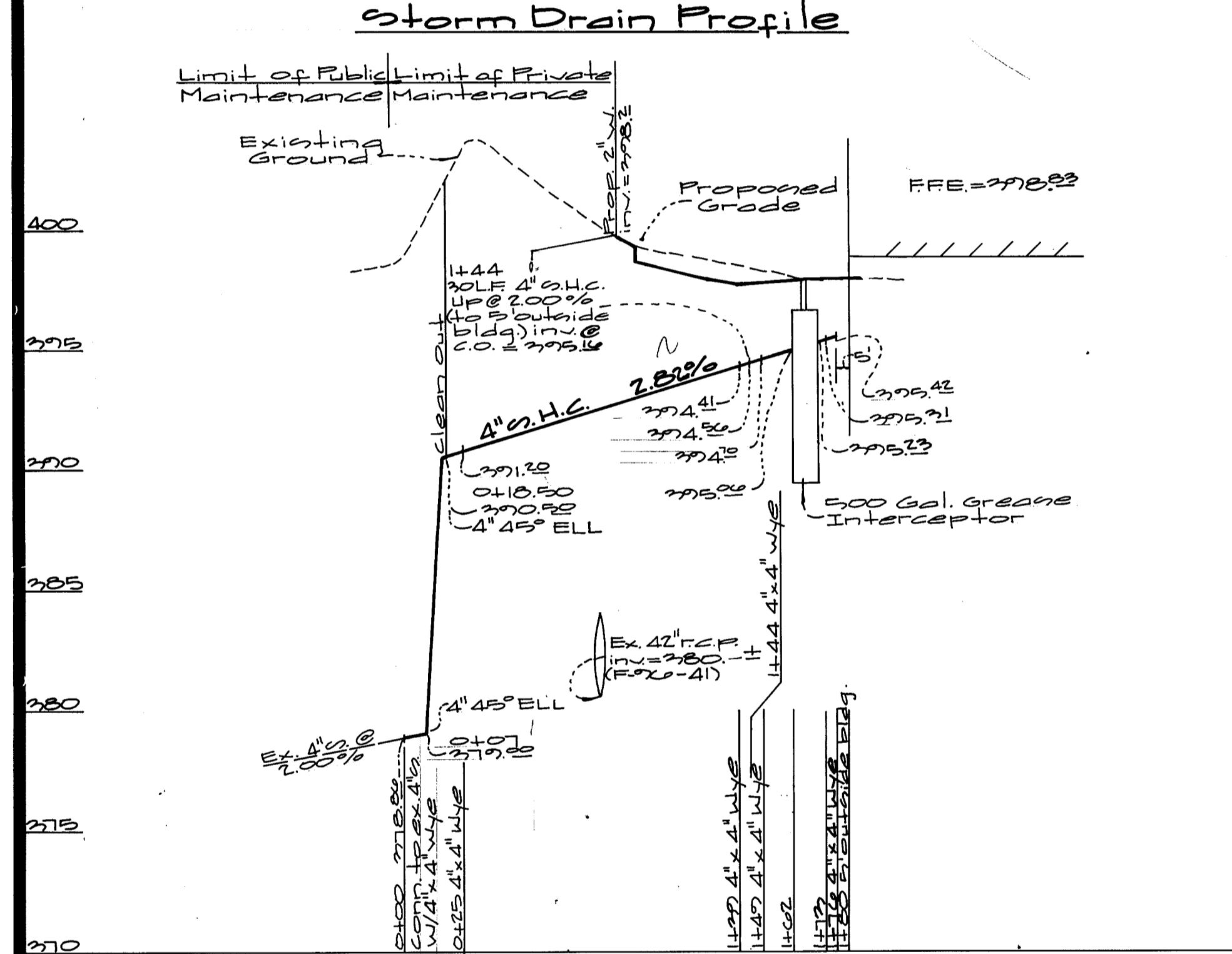
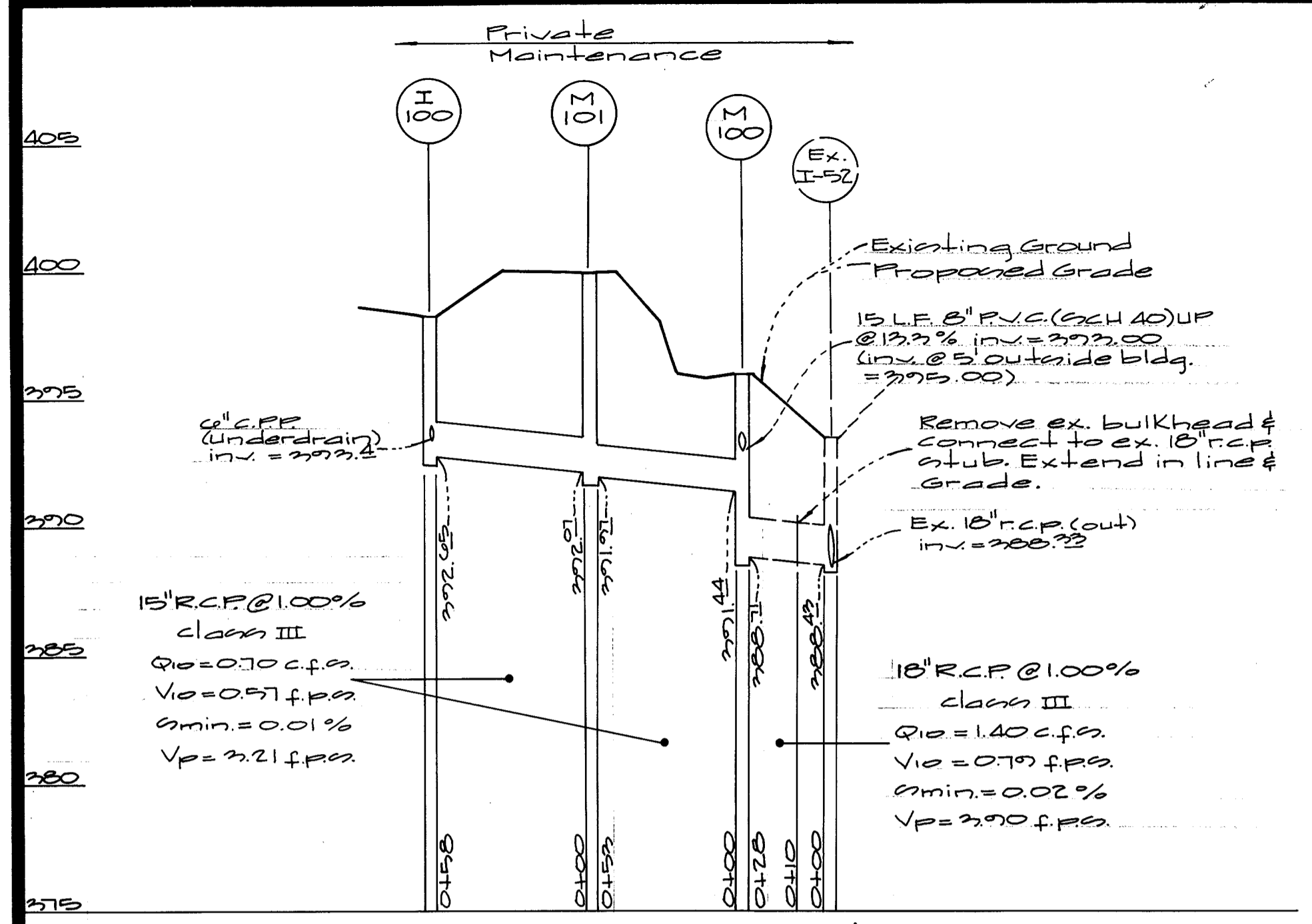

Scales:  
 Horizontal: 1" = 50'  
 Vertical: 1" = 5'

APPROVED  
 PLANNING BOARD  
 of HOWARD COUNTY  
 DATE 7/16/97

Approved For Public water & sewerage systems, Howard Co. Health Dept.  
 [Signature] 9/26/97  
 Health Officer  
 Approved: Howard County Department of Planning & Zoning  
 [Signature] 9/29/97  
 Director  
 Approved: Division of Land Development  
 [Signature] 9/29/97  
 Chief, Development Engineering Div.  
 MK



Owner:  
 The Howard Research & Development Corporation  
 10215 Little Patuxent Pkwy.  
 Columbia, Maryland 21044  
 Phone: (410) 792-6027  
 Attn: Al Edwards

**GLW** GUTSCHICK LITTLE & WEBER, P.A.  
 CIVIL ENGINEERS, SURVEYORS, PLANNERS, LANDSCAPE ARCHITECTS  
 3909 NATIONAL DRIVE - SUITE 250 - BURTONSVILLE OFFICE PARK - BURTONSVILLE, MD. 20866  
 TELEPHONE: (301) 421-4024 NO. VA. (301) 989-2524 BALTO. (301) 880-1820 FAX (301) 421-4186

| DATE | REVISION | BY | APP'R. |
|------|----------|----|--------|
|      |          |    |        |
|      |          |    |        |

PREPARED FOR:  
 Developer/  
 Chicken Out, Inc.  
 15092 Shady Grove Road  
 Gaithersburg, Maryland 20878

Utility Profiles & Details  
**Route 175 Commercial Parcel "R"**  
 Guilford Election District No. 6  
 Howard County, Maryland

| DES.:  | SCALE    | ZONING        | G.L.W. FILE No. |
|--------|----------|---------------|-----------------|
| mt     | As shown | NT Commercial | 97-050          |
| DRN.:  | DATE     | TAX MAP No.   | SHEET           |
| W.S.J. | May 1997 | 70            | 6 of 6          |
| CHK.:  | mt       |               |                 |

SDP-97-148