

MINIMUM LOT SIZE CHART						
Lot No.	Gross Lot Area	Pipesstem Area	Floodplain Area	Minimum Lot Size	Area of Ex. Steep Slopes	Net Lot Area
11	20,754 SF	2779 SF	N/A	17,975 SF	225 SF	17,750 SF
8	17,391 SF	2222 SF	N/A	15,169 SF	195 SF	14,974 SF

ADDRESS CHART	
Lot No.	Street Address
8	4840 Ellicott Woods Lane
9	4844 " " "
11	4852 " " "

BM 1 Concrete monument @ surface
18' E x 12' N of twin 12" apple tree
70' E S of gravel drive across
power line from intersection of
Round Hill Rd and Rolling Rd
Elev = 494.83

BM 2 Concrete monument @ surface
Elev = 491.13

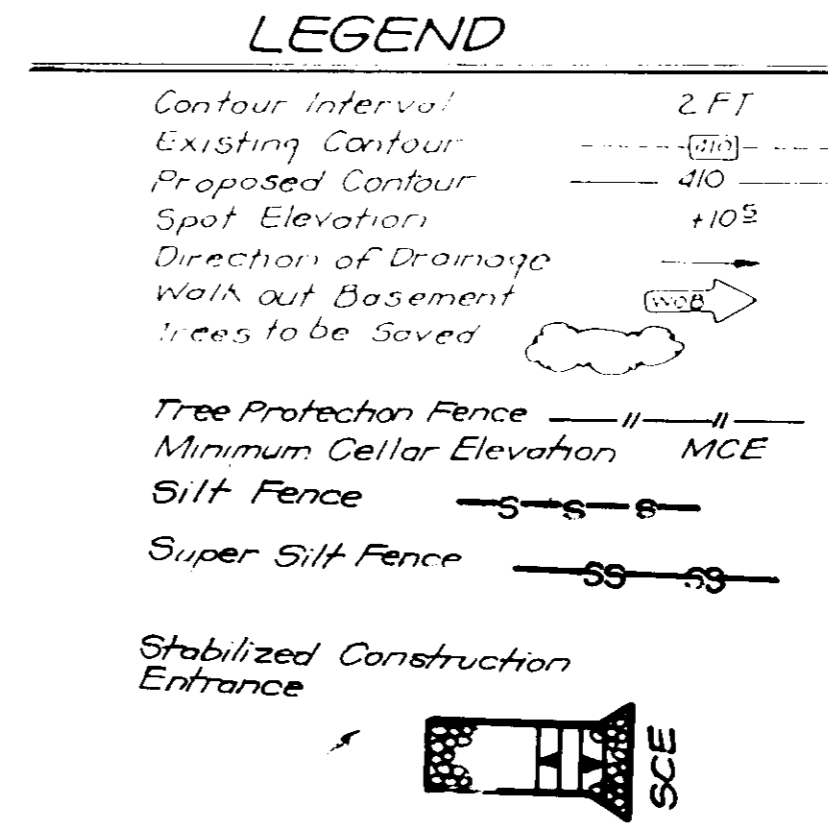
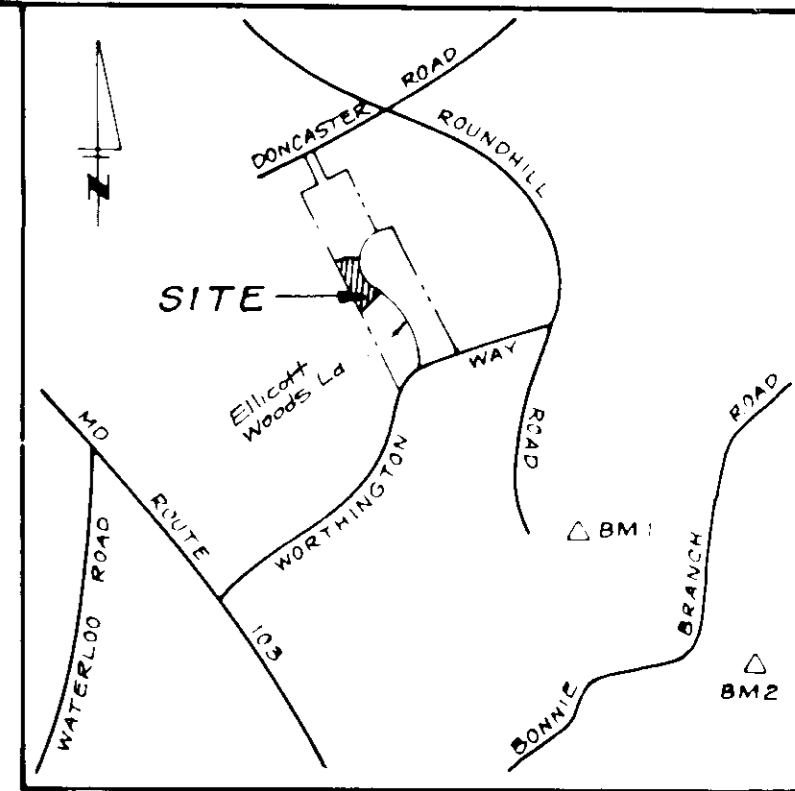

- GENERAL NOTES:**
- Subject property is zoned: **R-20** per 10-18-93 Comprehensive Zoning Plan.
 - The total area included in this submission is: **1.1989 Ac.** The total area of the project is: **7.4555 Ac.**
 - The total number of lots included in this submission is: **3**. The total number of buildable lots in this project is: **18**.
 - Improvement to property: **Single Family Detached Units**.
 - Department of Planning and Zoning reference file numbers are: **WP 89-83, WP 90-137, WP 92-21, S-89-54, F-90 86, F-93 77**.
 - Utilities shown as existing are taken from approved Water and Sewer plan Contract # **14-3018-D**, approved Road Construction plans **F-90-88**, and actual field survey.
 - Any damage to county owned rights-of-way shall be corrected at the developer's expense.
 - All roadways are public and existing.
 - The existing topography was taken from Road Construction plans **F-90-88** prepared by **Downberry and Davis**.
 - The coordinates shown hereon are based upon the Howard County Geodetic Control which is based upon the Maryland State Plane Coordinate System - Howard County Monument Nos. **2844001** and **2844002**.
 - The contractor shall notify the Department of Public Works/Division of Construction Inspection at (410) 313-1880 at least twenty-four (24) hours prior to the start of work.
 - The contractor shall notify "Miss Utility" at 1-800-257-7777 at least 48 hours prior to any excavation work.
 - For driveway entrance details, refer to Ho. Co. Design manual Volume IV "Site" Detail R-6.01.
 - In accordance with Sections 128A.1.b and .c of the Zoning Regulations, bay windows or chimneys not more than 10 feet in width may project not more than 4 feet into any setbacks; porches and decks may project not more than 10 feet into the front or rear setbacks.
 - Stormwater Management is provided per: **F-90 88** Stormwater Management Quality Control provided by an stream, Detention Facility Water Quality Control provided by sediment forebay.

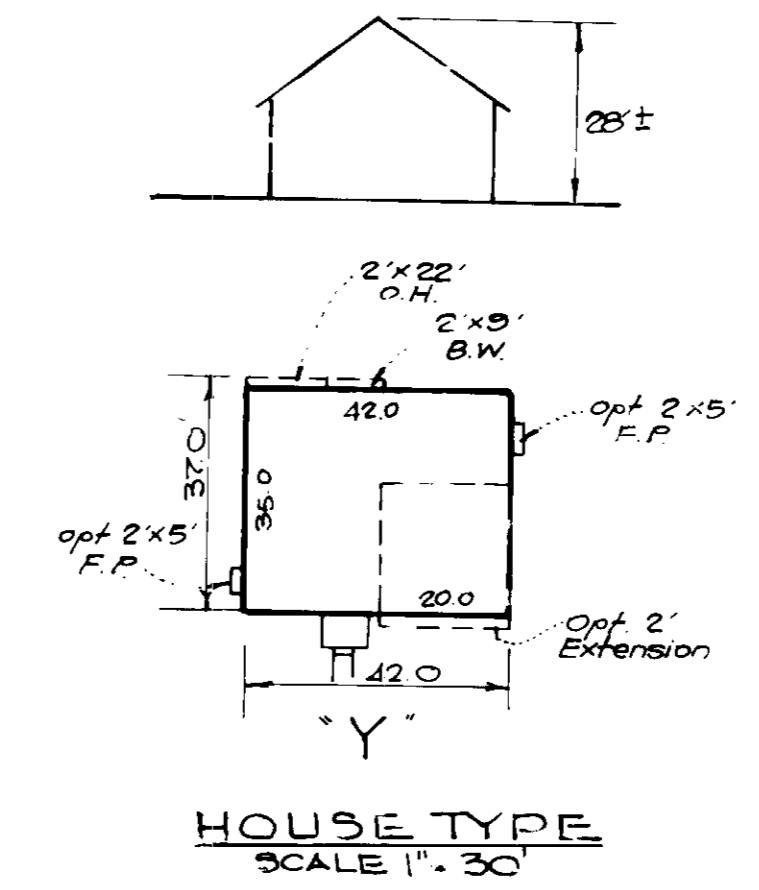

OWNER / DEVELOPER
HOWARD RESNICK
4645 New Cut Road
Ellicott City, Md. 21043

SHEET INDEX
Sheet 1 - Silt Development, Sediment and Erosion Control Plan
Sheet 2 - Sediment and Erosion Control Plan

SPECIAL NOTES:
This plan is for house siting and lot grading only. Improvements shown within the rights-of-way on this S.D.P. are not to be used for construction. For construction, see approved Road Construction Plans **F-90-88** and/or approved Water and Sewer Plans Contract # **14-3018-D**.

NOTE: Basement on Lot 11 Will Not Sewer By Gravity

NOTE: PROPOSED HOUSE NOT COVERED BY THIS EDE

HAMPTON
NOT TO SCALE

TYPICAL FOOTPRINT

TYPICAL PROFILE

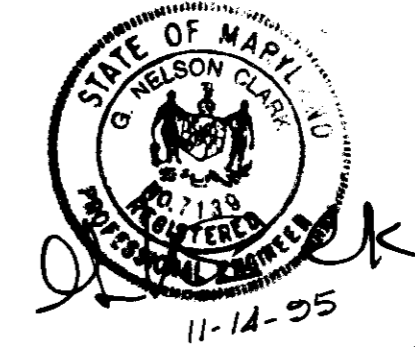

I hereby certify that the proposed Erosion and Sediment Control represents the actual and working plan based on my personal knowledge of the site conditions and that it was prepared in accordance with the requirements of the Howard County Conservation District.

G. NELSON CLARK
DATE: 11-14-95

DATE	NO.	DESCRIPTION
6-19-97	2	Revised per lot 11
12/27/96	1	REV. WPT 1 030 ON LOT D

APPROVED: DEPARTMENT OF PLANNING AND ZONING

John P. Dutton 11/22/95
Chief, Development Engineering Division

John P. Dutton 12/14/95
Chief, Division of Land Development and Research

John P. Dutton 12/14/95
Director

HOWARD
Patricia Engly 11/22/95
S. National

DEVELOPER'S/BUYER'S SIGNATURE

John P. Dutton 11/22/95
F.W. KUYKLE

CLARK • FINEFROCK & SACKETT, INC.
ENGINEERS • PLANNERS • SURVEYORS
7135 MISTREL WAY • COLUMBIA, MD 21045 • (301) 381-7500 - BALTO • (301) 621-8100 - WASH

DESIGNED JME	SITE DEVELOPMENT, SEDIMENT AND EROSION CONTROL PLAN LOTS 8, 9 and 11 ELLICOTT WOODS 2ND ELECTION DISTRICT HOWARD COUNTY, MARYLAND	SCALE 1" = 30'
DRAWN BAL		DRAWING 1 OF 2
CHECKED JMS		JOB NO. 92-033
DATE 11-14-95		FILE NO. 92-033x

For: PATRIOT HOMES, INC.
P.O. Box 1018
Columbia, Md. 21043
SDP-92-14

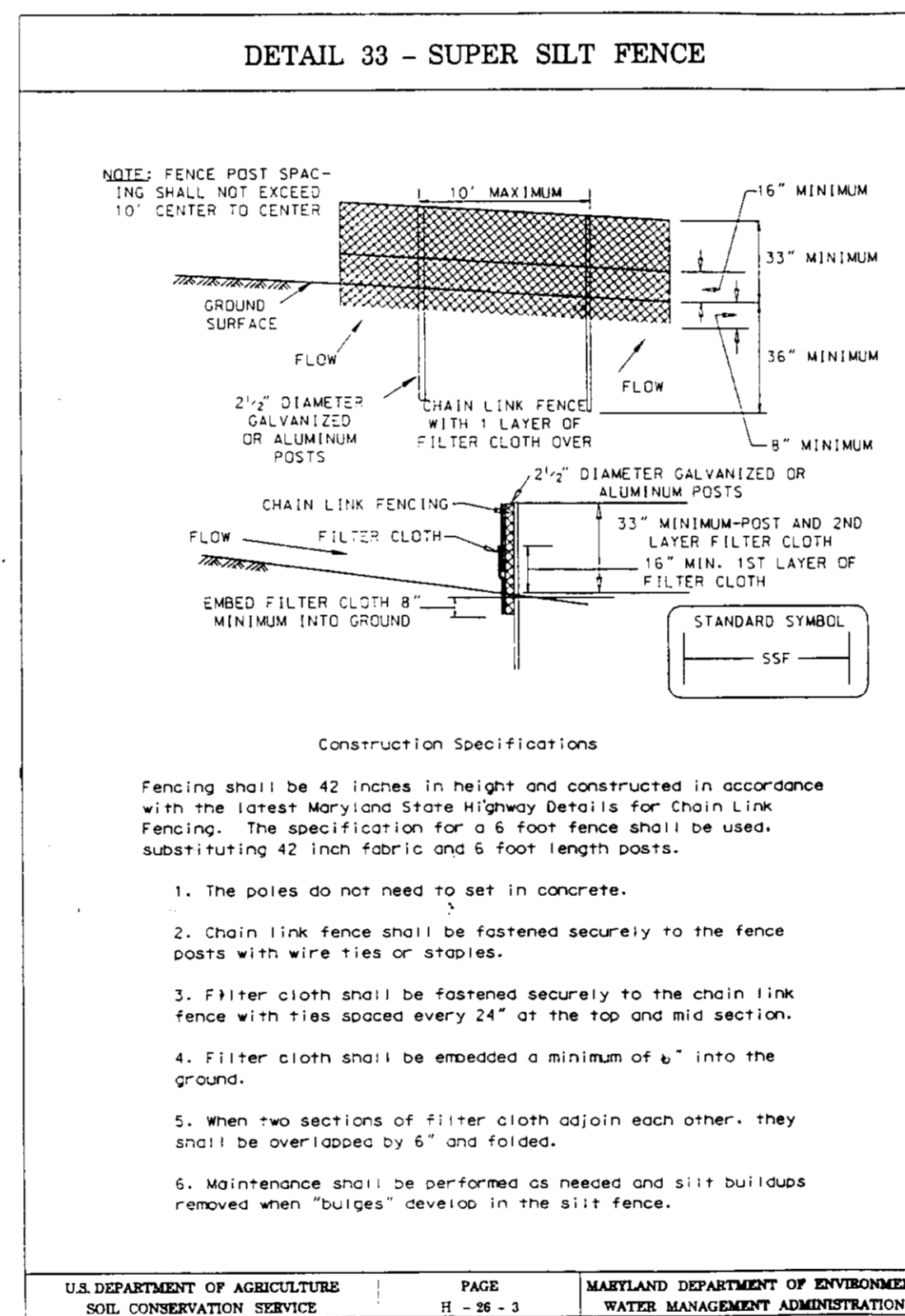
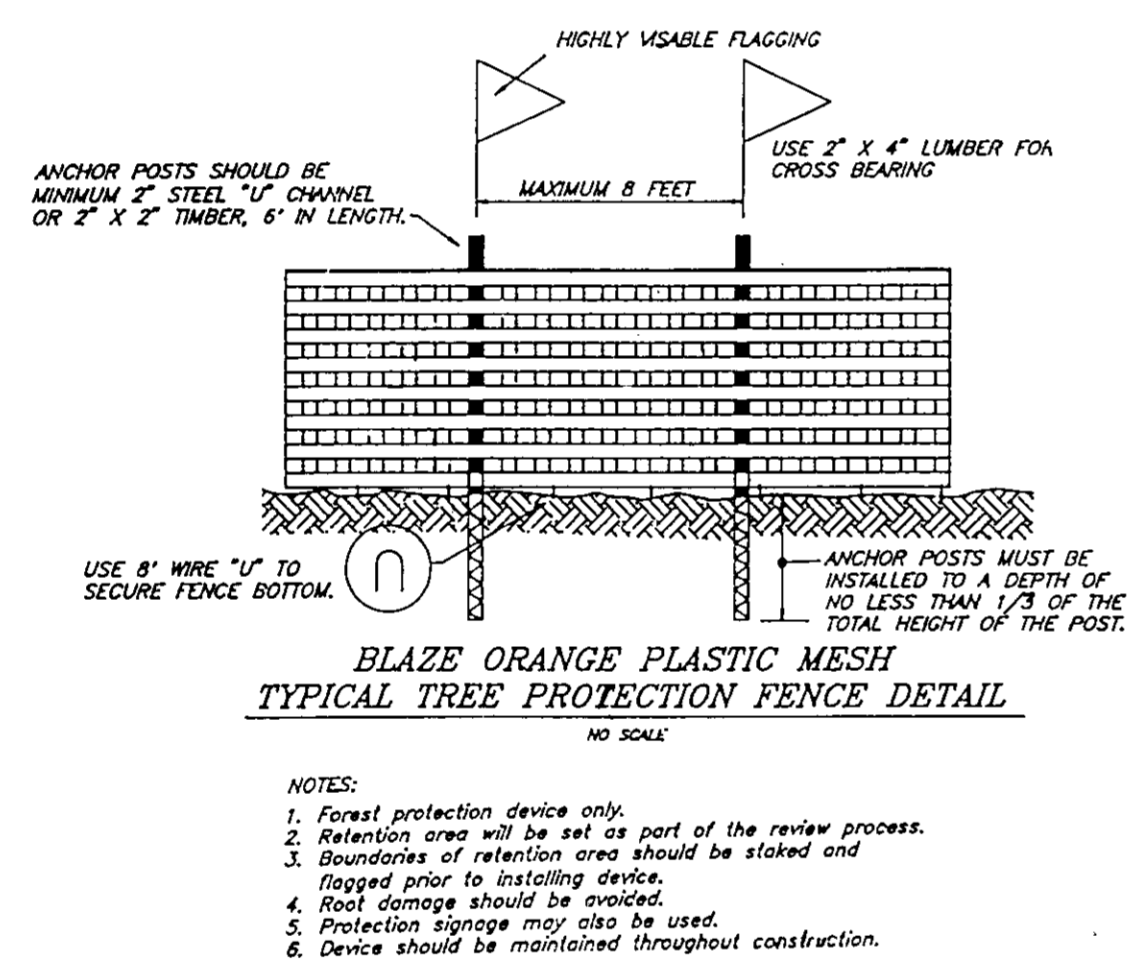
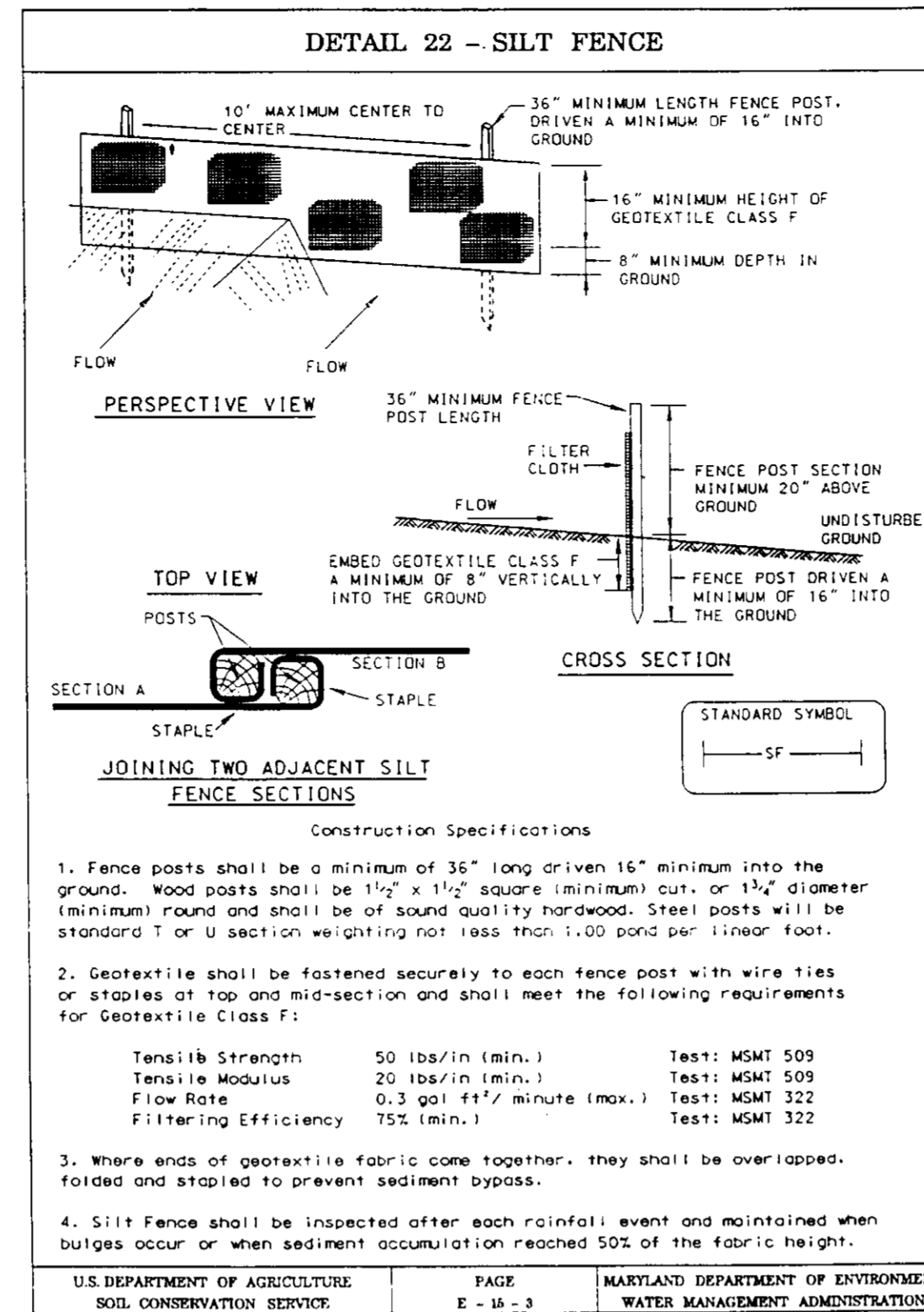
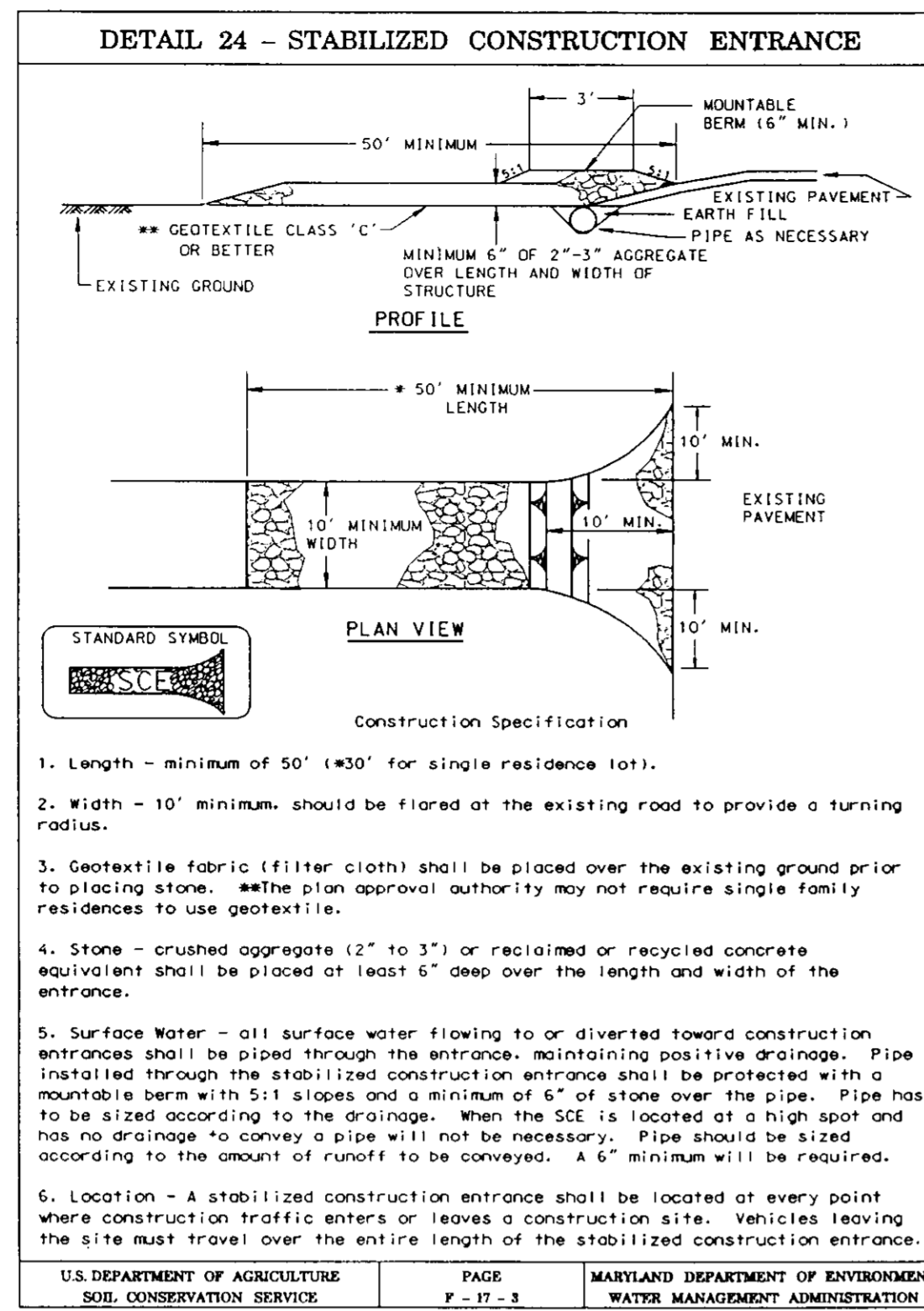

PERMANENT SEEDING NOTES

APPLY TO GRADED OR CLEARED AREAS NOT SUBJECT TO IMMEDIATE FURTHER DISTURBANCE WHERE A PERMANENT LONG-LIVED VEGETATIVE COVER IS NEEDED.

SEEDBED PREPARATION: Loosen upper three inches of soil by raking, discing or other acceptable means before seeding, if not previously loosened.

SOIL AMENDMENTS: In lieu of soil test recommendations, use one of the following schedules:

- Preferred - Apply 2 tons per acre dolomitic limestone (92 lbs./1000 sq.ft.) and 600 lbs per acre 10-10-10 fertilizer (14 lbs./1000 sq.ft.) before seeding. Harrow or disc into upper three inches of soil. At the time of seeding, apply 400 lbs. per acre 30-0-0 ureaform fertilizer (9 lbs./1000 sq.ft.)
- Acceptable - Apply 2 tons per acre dolomitic limestone (92 lbs./1000 sq.ft.) and apply 1000 lbs. per acre 10-10-10 fertilizer (23 lbs./1000 sq.ft.) before seeding. Harrow or disc into upper three inches of soil.

SEEDING: For the periods March 1 thru April 30, and August 1 thru October 15, seed with 60 lbs. per acre (1.4 lbs./1000 sq.ft.) of Kentucky 31 Tall Fescue. For the period May 1 thru July 31, seed with 60 lbs. Kentucky 31 Tall Fescue per acre and 2 lbs. per acre (.05 lbs./1000 sq.ft.) of weeping lovegrass. During the period of October 16 thru February 28, protect site by Option (1) 2 tons per acre well anchored straw mulch and seed as soon as possible in the spring. Option (2) Use sod. Option (3) Seed with 60 lbs./acre Kentucky 31 Tall Fescue and mulch with 2 tons/acre well anchored straw.

MULCHING: Apply 1 1/2 to 2 tons per acre (70 to 90 lbs./1000 sq. ft.) of unrotted small grain straw immediately after seeding. Anchor mulch immediately after application using mulch anchoring tool or 218 gallons per acre (5 gal/1000 sq.ft.) of emulsified asphalt on flat areas. On slopes 8 feet or higher, use 348 gallons per acre (8 gal/1000 sq.ft.) for anchoring.

MAINTENANCE: Inspect all seeded areas and make needed repairs, replacements and reseedings.

TEMPORARY SEEDING NOTES

SEEDBED PREPARATION: Loosen upper three inches of soil by raking, discing or other acceptable means before seeding, if not previously loosened.

SOIL AMENDMENTS: Apply 600 lbs. per acre 10-10-10 fertilizer (14 lbs./1000 sq.ft.).

SEEDING: For periods March 1 thru April 30 and from August 15 thru November 15, seed with 2 1/2 bushel per acre of annual rye (3.2 lbs./1000 sq.ft.) For the period May 1 thru August 14, seed with 3 lbs. per acre of weeping lovegrass (0.7 lbs./1000 sq.ft.). For the period November 1 thru February 28, protect site by applying 2 tons per acre of well anchored straw mulch and seed as soon as possible in the spring, or use sod.

MULCHING: Apply 1 1/2 to 2 tons per acre (70 to 90 lbs./1000 sq.ft.) of unrotted small grain straw immediately after seeding. Anchor mulch immediately after application using mulch anchoring tool or 218 gallons per acre (5 gal/1000 sq.ft.) of emulsified asphalt on flat areas. On slopes 8 feet or higher, use 348 gallons per acre (8 gal/1000 sq.ft.) for anchoring.

REFER TO THE 1983 MARYLAND STANDARDS AND SPECIFICATIONS FOR SOIL EROSION AND SEDIMENT CONTROL FOR RATE AND METHODS NOT COVERED.

SEDIMENT AND EROSION CONTROL NOTES

- A minimum of 24 hours notice must be given to the Howard County Office of Inspection and Permits prior to the start of any construction. (313-1855).
 - All vegetative and structural practices are to be installed according to the provisions of this plan and are to be in conformance with the 1983 MARYLAND STANDARDS AND SPECS. FOR SOIL EROSION AND SEDIMENT CONTROL.
 - Following initial soil disturbance or redistribution, permanent or temporary stabilization shall be completed within:
 - 7 calendar days for all perimeter sediment control structures, dikes, perimeter slopes and all slopes greater than 3:1
 - 14 days as to all other disturbed or graded areas on the project site.
 - All sediment traps/basins shown must be fenced and warning signs posted around their perimeters in accordance with Vol.1, Chapter 12, of the HOWARD COUNTY DESIGN MANUAL, Storm Drainage.
 - All disturbed areas must be stabilized within the time period specified above, in accordance with the 1983 MARYLAND STANDARDS AND SPECIFICATIONS FOR SOIL EROSION AND SEDIMENT CONTROL for permanent seedings (Sec. 51), sod (Sec. 54), temporary seedings (Sec. 50) and mulching (Sec. 52). Temporary stabilization with mulch alone can only be done when recommended seeding dates do not allow for proper germination and establishment of grasses.
 - All sediment control structures are to remain in place and are to be maintained in operative condition until permission for their removal has been obtained from the Howard County Sediment Control Inspector.
 - SITE ANALYSIS:

Total Area of Site:	1.99 Ac
Area Disturbed:	1.08 Ac
Area to be roofed or paved:	0.68 Ac
Area to be vegetatively stabilized:	0.91 Ac
Total Cut:	717 CY
Total Fill:	1288 CY
Offsite Waste/Borrow Area Location:	*
 - Any sediment control practice which is disturbed by grading activity for placement of utilities must be repaired on the same day of disturbance.
 - Additional sediment control must be provided, if deemed necessary by the Howard County DFW Sediment Control Inspector.
 - On all sites with disturbed areas in excess of 2 acres, approval of the inspection agency shall be requested upon completion of installation of perimeter erosion and sediment controls, but before proceeding with any other earth disturbance or grading. Other building or grading inspection approvals may not be authorized until this initial approval by the inspection agency is made.
 - The total amount of silt fence = **625 LF**
Total amount of Super Silt Fence = **100 LF**
- * It is the responsibility of the contractor to identify the spoil/borrow site and notify and gain approval from the sediment control inspector of the site and it's grading permit number at the time of construction.

CONSTRUCTION SEQUENCE:

	NO. OF DAYS
1. Obtain grading permit.	7
2. Install tree protection fence.	7
3. Install sediment and erosion control devices and stabilize.	14
4. Excavate for foundations, rough grade and temporarily stabilize.	30
5. Construct structures, sidewalks and driveways.	60
6. Final grade and stabilize in accordance with Stds. and Specs.	14
7. Upon approval of the sediment control inspector, remove sediment and erosion control devices and stabilize.	7

APPROVED: DEPARTMENT OF PLANNING AND ZONING
 Chief, Development Engineering Division 11/20/95
 Chief, Division of Land Development and Research 12/14/95
 Director 12/14/95

Reviewed for HOWARD S.C.D.
 and meets Technical Requirements
 Patricia Engle 11/22/95
 Signature Date
 Natural Resources Conservation Service

THIS DEVELOPMENT PLAN IS APPROVED FOR SOIL EROSION AND SEDIMENT CONTROL BY THE HOWARD SOIL CONSERVATION DISTRICT.

John P. Robertson 11/22/95
 Approved

DEVELOPER'S/BUILDER'S CERTIFICATE

"I/We certify that all development and construction will be done according to this plan of development and plan for sediment and erosion control and that all responsible personnel involved in the construction project will have a Certificate of Attendance at a Department of the Environment Approved Training Program for the Control of Sediment and Erosion before beginning the project. I also authorize periodic on-site inspection by the Howard Soil Conservation District or their authorized agents, as are deemed necessary."

G. W. Kunkle 7-25-95
 F.W. KUNKLE DATE

ENGINEER'S CERTIFICATE

I hereby certify that this plan for Sediment and Erosion Control represents a practical and workable plan based on my personal knowledge of the site conditions and that it was prepared in accordance with the requirements of the Howard Soil Conservation District.

G. Nelson Clark 11-14-95
 G. NELSON CLARK DATE



CLARK • FINEFROCK & SACKETT, INC.
 ENGINEERS • PLANNERS • SURVEYORS
 7135 MINSTREL WAY • COLUMBIA, MD 21045 • (301) 381-7500 - BALTO. • (301) 621-8100 - WASH.

DESIGNED ZAL	SEDIMENT & EROSION CONTROL PLAN LOTS 8, 9 and 11 ELLCOTT WOODS 2ND ELECTION DISTRICT HOWARD COUNTY, MARYLAND For: PATRIOT HOMES, INC. P.O. Box 1018 Columbia, Md. 21043	SCALE As Shown
DRAWN BAL		DRAWING 2 OF 2
CHECKED YJS		JOB NO. 92-033
DATE 11-14-95		FILE NO. 92-033
		SDP-96-14