

INDEX OF SHEETS	
NO.	TITLE
1	COVER SHEET
2	PLAN VIEW
3	PLAN VIEW, DRAINAGE AREA MAP
4	PLAN VIEW
5	SEDIMENT CONTROL DETAILS, DRAINAGE AREA MAP
6	STORMWATER MGMT. DETAILS

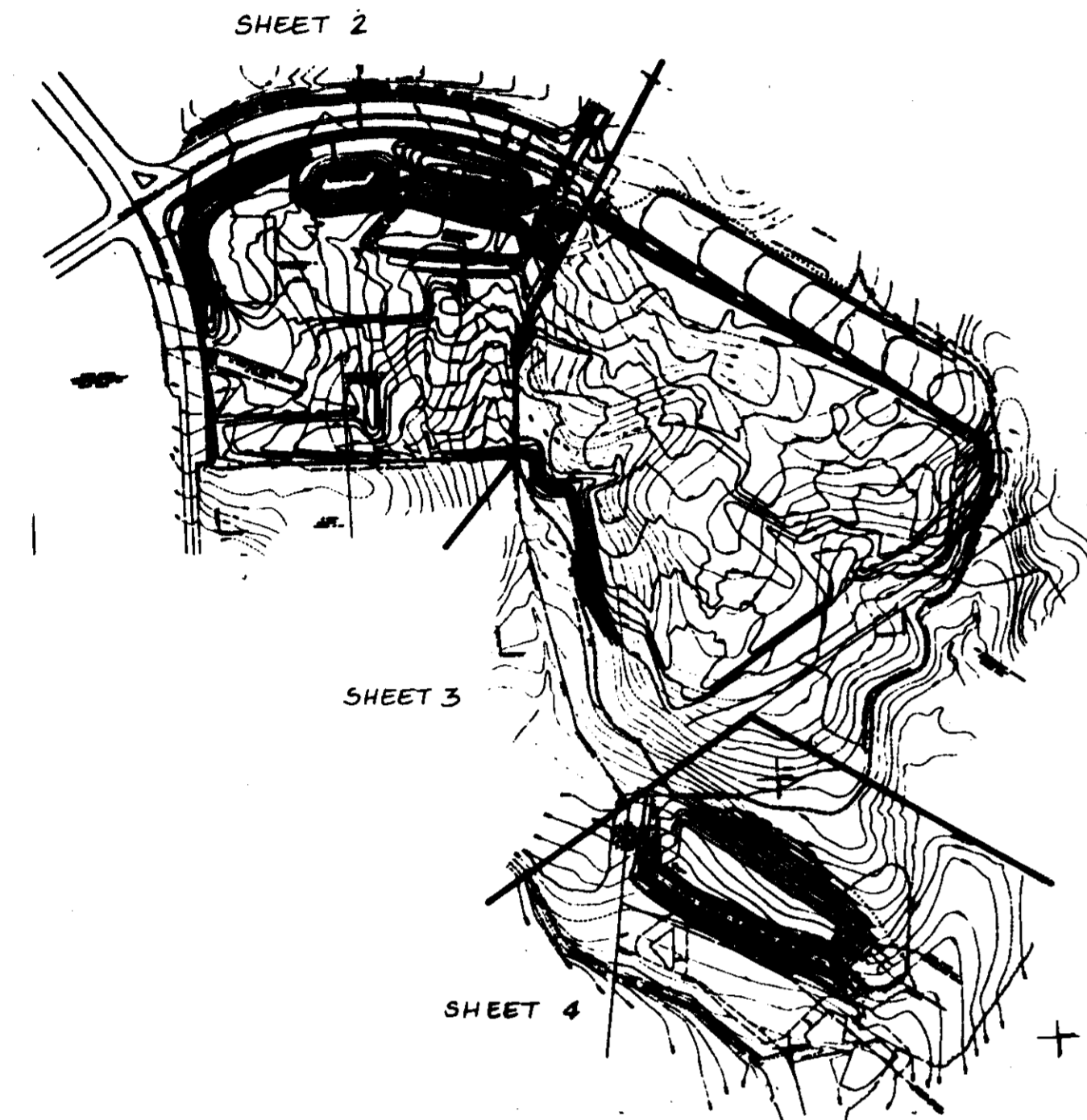

SHEET INDEX
SCALE: 1" = 300'

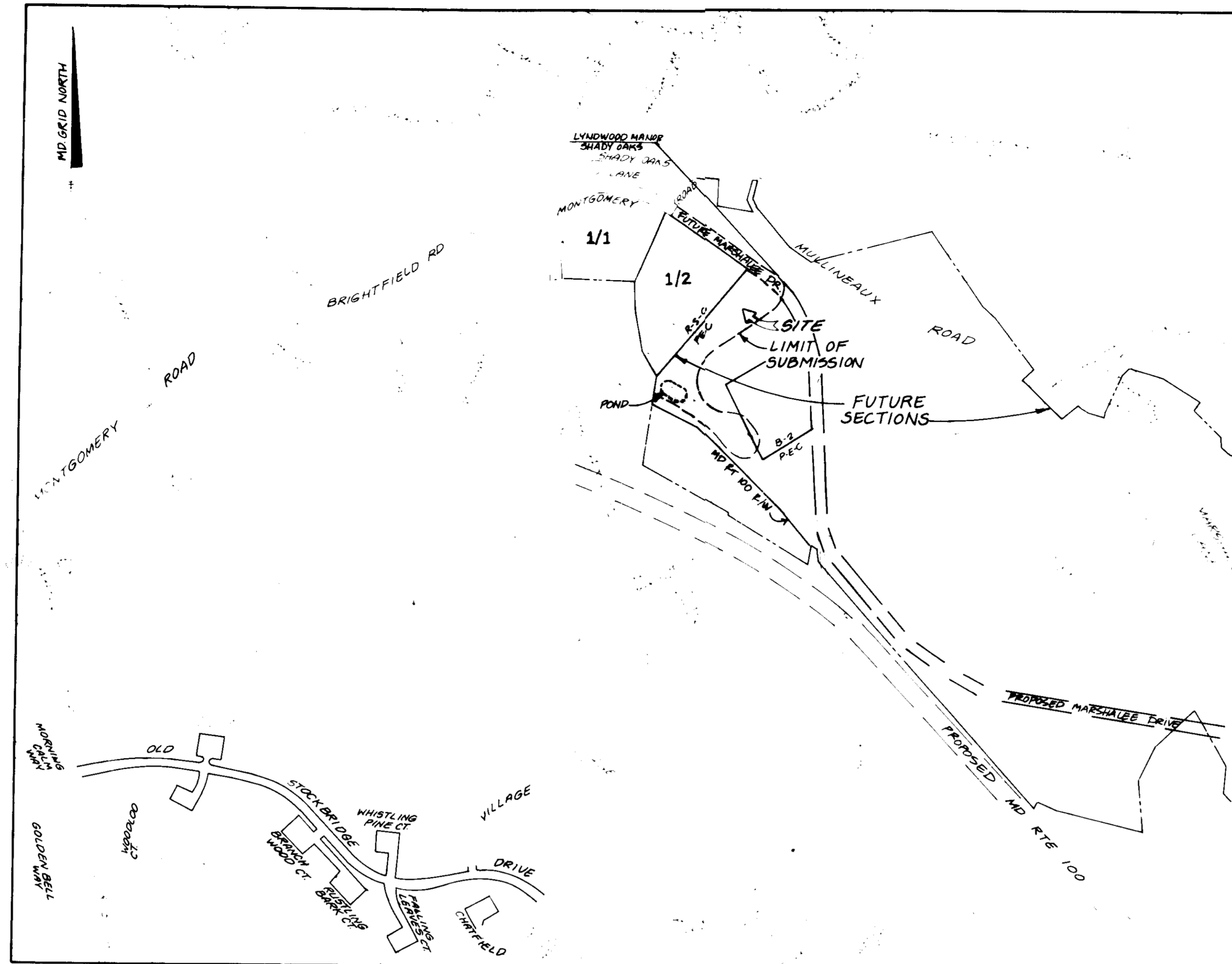

LOCATION MAP

SITE DEVELOPMENT PLANS SHADY OAKS SECTION ONE AREAS 1 & 2

1st ELECTION DISTRICT HOWARD COUNTY, MARYLAND

BENCHMARK

Ho Co Mon # 264400A El. 402.135
Ho Co Mon # 2644005 El. 416.981

DESCRIPTION
Ho Co Mon # 2644005 El. 416.981
Concrete Monument .2' Below Surface
South Side Montgomery Road East
of Meadow Ridge Road.

Ho Co Mon # 2644004 El. 402.135
Concrete Monument .1' Below Surface
SW corner of Intersection Rte. 103 and
Old Montgomery Road.

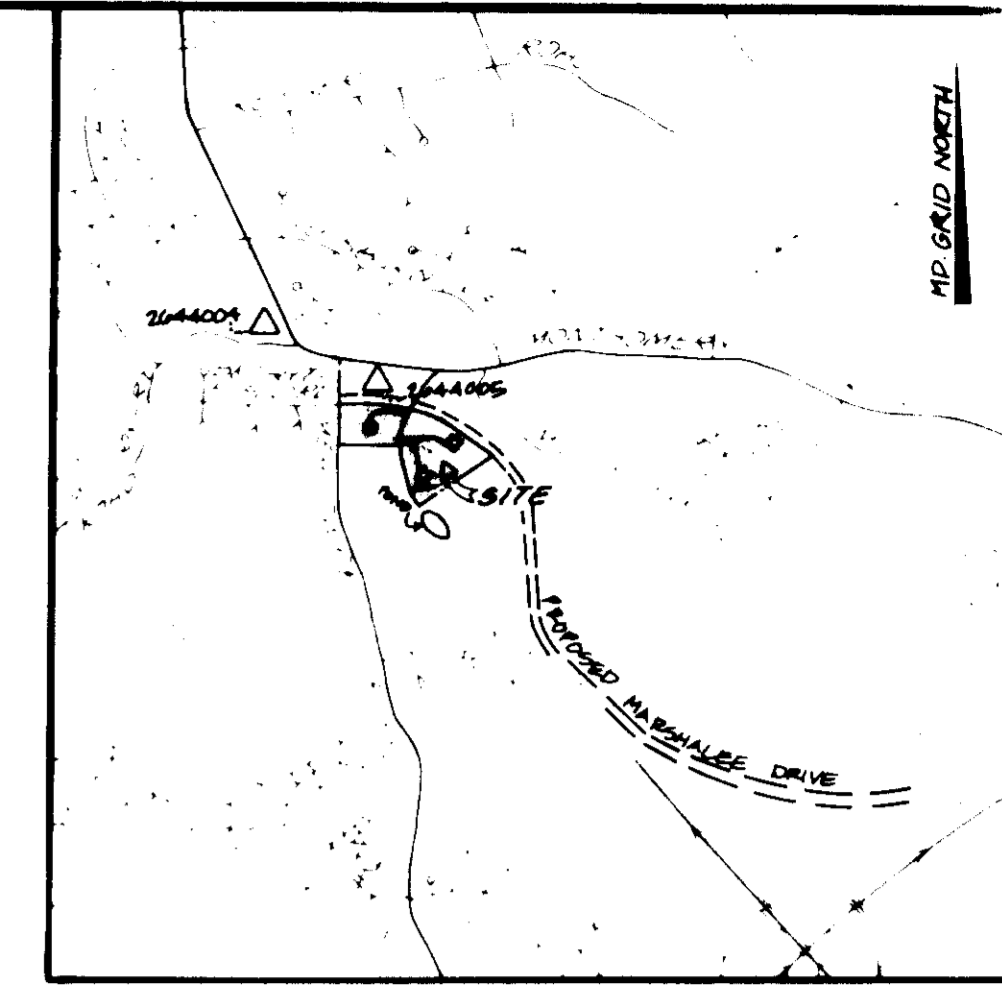

VICINITY MAP

NOTES:

- All construction shall be in accordance with the latest standards and specifications of Howard County, Volume III, PLUS MSHA standards and specifications if applicable.
- The contractor shall notify the Bureau of Engineering/Construction Inspection Division at (410) 313-1990 at least 24 hours prior to the start of work.
- The contractor shall notify "Miss Utility" at 1-800-257-7777 at least forty-eight (48) hours prior to any excavation work.
- Project Background:**
Location: Elkrige, Tax Map: 37, Parcel: 38, 529, 542, 640, 643, Liber: 1549 Folio: 07E
Zoning: RSC, PEC (ZB 877M)
Previous submittals: S-93-02, P-93-11
Site Area: 351.6 Ac. Limit of Submissions: 27.6 Ac. ±
Preliminary Plan approved December 31, 1993 - P-93-11, S-93-02
- Traffic control devices, markings, and signing shall be in accordance with the latest edition of the Manual on Uniform Traffic Control Devices (MUTCD). All street and regulatory signs shall be in place prior to the placement of any asphalt.
- Topography compiled from aerial survey by Air Survey and Design, Inc., and Photogrammetric Services, Inc., 1988, and field run surveys by Land Design Engineering, Inc. and Clark, Finetrock & Sackett, 1992 and 1993. Contour interval shown = 2'. Aerial compiled at 1' interval.
- Floodplains analyzed by Land Design Engineering, Inc., February, 1993, based on field run data from 1992. See Howard County file P-93-11. Approved: 12/31/93.
- Temporary stormwater management is provided by detention. Permanent stormwater management plans is provided by retention.
- Wetlands delineation by Exploration Research, Inc. dated 1992, approved by U.S.A.C.E. June 3, 1992.
- Existing utilities were located by information on available plans, records, and field surveys for surface features. Photogrammetric aerial survey provided by Land Design Engineering, Inc. June, 1992.
- The horizontal and vertical datums are related to the Maryland State Plane Coordinate System as projected from Howard County control stations No. 2644004 and 2644005 (NAD 27). Benchmark is 2644004 elev. 402.135.
- Public water and sewer will be available to the site by means of future extensions. Water: Contract No. 14-93-14-D
Sewer: Contract No. 14-93-14-D
- Limit of disturbance is the limit of submission.
- Per P-93-11, landscaped edges along the project boundary will be a requirement of the developer. Future final plan submissions for this project will contain specific landscape plans for the areas of buffer which are shown on this plan.
- In an area where excavation is needed within the road right-of-way, excavation must be made no closer than one (1) foot of the final subgrade. See F-94-27, F-94-28, and F-94-28 for road profiles.
- Where fill is proposed within the road right-of-way, the fill shall be a minimum of two (2) feet below the final road sub-grade. See F-94-27, F-94-28, and F-94-28 for road profiles.
- Limit of subdivision area for each zoning district is 24.2 acres RSC zone and 3.4 acres PEC zone.
- Waiver Petition WP-93-29 for roads to exceed 1200', Section 16.113(c)(10), approved 12-23-92. Waiver Request 93-86 to waive Section 16.115(b)(2) to provide 20' minimum frontage for lot areas under 40,000 square feet; to waive Section 16.115B to front lots on a public or private road not exceeding 200'; Section 16.115C, that no more than two pipestem lots may have adjoining driveways; Section 16.116C, grading adjacent to wetlands shall not be permitted, approved March 18, 1993.

10. WP-94-118, Waiver Request of 16.123 A(1) and 16.155 A(2). Grading shall be performed in accordance with plans 1200', approved as part of the final subdivision plat or a site development plan. A site development plan, approved by the Department of Planning and Zoning is required prior to issuance of grading permits for residential development. Dated 7/23/94.

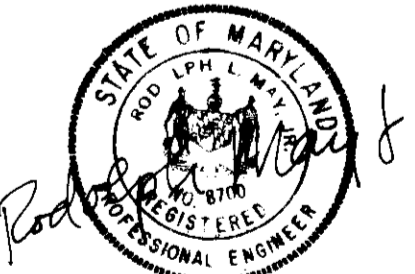

ENGINEER'S CERTIFICATE
I hereby certify that this plan for Erosion and Sediment Control represents a practical and workable plan based on personal knowledge of the site conditions and that it was prepared in accordance with the requirements of the Howard Soil Conservation District.

Robert W. Zickler 7/23/94
Signature of Engineer Date

DEVELOPER'S CERTIFICATE
I, we certify that all development and construction will be done according to these plans, and that any responsible person involved in the construction project will adhere to the conditions of the Submittal approved training program for the control of sediment and erosion before beginning the project. Aerial photographs on-site inspection by the Howard Soil Conservation District.

Howard Besnek 7/23/94
Signature of Developer Date

Reviewed for Howard County Soil Conservation District and meets technical requirements.

Robert W. Zickler 8/12/94
U.S. Soil Conservation Service Date

This development plan is approved for Soil Erosion and Sediment Control by the Howard Soil Conservation District.

APPROVED

APPROVED FOR PUBLIC WATER AND PUBLIC SEWERAGE SYSTEMS
HOWARD COUNTY HEALTH DEPARTMENT

COUNTY HEALTH OFFICER: *N/A* DATE: *N/A*

APPROVED: HOWARD COUNTY DEPT. OF PLANNING & ZONING
Director: *Robert W. Zickler* DATE: 8/12/94
Director: *Robert W. Zickler* DATE: 8/12/94

APPROVED FOR PUBLIC WATER AND PUBLIC SEWERAGE, STORM DRAINAGE SYSTEMS AND PUBLIC WORKS
HOWARD COUNTY DEPARTMENT OF PUBLIC WORKS
Director: *Robert W. Zickler* DATE: 8/12/94
Director: *Robert W. Zickler* DATE: 8/12/94

REVISIONS		
NO.	Date	Description
1	7-7-94	Revised S-2 and Pond Bottom.

Property of	Section	Area	Parcel No.
100 INVESTMENT LTD PARTNERSHIP	N/A	N/A	P10 P 643
Plot No.	Block No.	Zone	Tax Zone
N/A	10.11	RSC/PEC	MAP 97
Water Code	Sewer Code	El. Dist.	Census
N/A	N/A	1ST	6011.02

LAND DESIGN ENGINEERING, INC.
8835-N COLUMBIA 100 PARKWAY • COLUMBIA • MARYLAND 21046
(301) 506-3424 (Voice) (410) 715-1070 (Baltimore) (410) 715-2681 (Fax)

Designed by: *TO*
Drawn by: *KBW*
Checked by: *R.C.M.*
Date: July 1994

COVER SHEET
SHADY OAKS
AND CENTRE 0500
SITE DEVELOPMENT PLAN
FOR NASS GRADING
Tax Map 37 Part of Parcel 643
1st Election District Howard County, MD
Previous Submittals: ZB 877 REM, WP 93-33, F 94-125,
Council Res 127, S 93-02, PB 284, P 93-11

Owner/Developer:
100 INVESTMENT LIMITED PARTNERSHIP
8835-P Columbia 100 Parkway
Columbia Maryland 21046 (410) 730-0810

Scale: As Shown
Drawing: 1 of 6
Job No: 92-176-1
File No: ✓

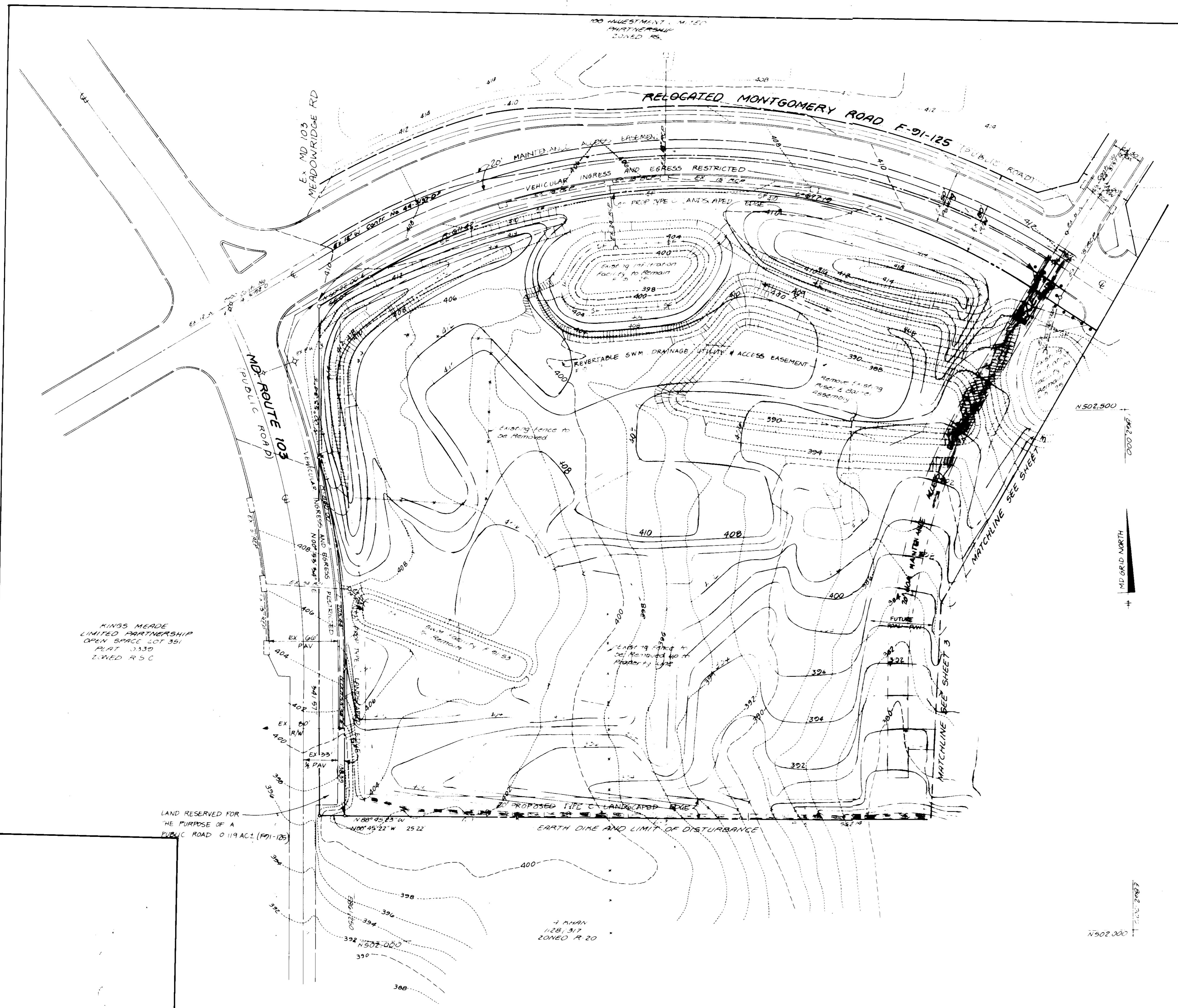

- LEGEND**
- 342 --- EXISTING CONTOUR (2' INTERVAL)
 - 342 --- PROPOSED CONTOUR (2' INTERVAL)
 - [SCE] STABILIZED CONSTRUCTION ENTRANCE
 - LIMIT OF DISTURBANCE
 - SF- SILT FENCE
 - [EARTH DIKE] EARTH DIKE (STABILIZATION METHOD)
 - [TPF] TREE PROTECTION FENCE
 - [W] NON-IDEAL WETLANDS
 - [WOODS] EXISTING WOODS TO BE REMOVED
 - [WOODS] EXISTING WOODS TO REMAIN UNDISTURBED
 - [SLOPE 25%] 25% OR GREATER SLOPES
 - [SLOPE 15-24%] 15% - 24% SLOPES

MINNS MERDE LIMITED PARTNERSHIP
 OPEN SPACE LOT 351
 PLAT 3330
 L.W.E.D. R.S.C.

LAND RESERVED FOR THE PURPOSE OF A PUBLIC ROAD 0.119 AC (F91-125)

4 Acre
 129.917
 ZONED R 20

DEVELOPER'S CERTIFICATE

I certify that all development and/or construction will be done according to these plans and that any responsible personnel involved in the construction of these plans will have a Certificate of Attendance at a Department of the Environment Approved Training Program for the control of sediment and erosion before beginning the project. I also authorize the local on-site inspection by the Howard Soil Conservation District.

W.R.N.
 Signature of Developer
 Howard Resneck

7/29/94
 Date

ENGINEER'S CERTIFICATE

I certify that this plan for erosion and sediment control represents a practical and workable plan based on my personal knowledge of the site conditions and that it was prepared in accordance with requirements of the Howard Soil Conservation District.

Rodolph May Jr.
 Signature of Engineer
 Rodolph L. May Jr.

7/29/94
 Date

These plans have been reviewed for Howard Soil Conservation District and meet the technical requirements.

Patricia Engler 8/17/94
 U.S. Soil Conservation Service Date

This development plan is approved for soil erosion and sediment control by Howard Soil Conservation District.

Robert W. Zickler 8/17/94
 Howard Soil Conservation District Date

APPROVED FOR PUBLIC WATER AND PUBLIC SEWERAGE SYSTEMS
 HOWARD COUNTY HEALTH DEPARTMENT

COUNTY HEALTH OFFICER: N/A DATE: _____
 APPROVED: HOWARD COUNTY DEPT. OF PLANNING & ZONING
James Smith 8/18/94
 DIRECTOR DATE
Anna Summary 8/18/94
 CHIEF DIVISION OF LAND DEVELOPMENT AND RESEARCH DATE

APPROVED FOR PUBLIC WATER AND PUBLIC SEWERAGE, STORM DRAINAGE SYSTEMS AND PUBLIC ROADS
 HOWARD COUNTY DEPARTMENT OF PUBLIC WORKS

Robert Egan 8/17/94
 DIRECTOR DATE
Robert Egan 8/17/94
 CHIEF BUREAU OF ENGINEERING DATE

LAND DESIGN ENGINEERING, INC.

8835 N. COLUMBIA 100 PARKWAY • COLUMBIA, MARYLAND 21045
 (301) 596-3424 (WASH.) (410) 715-1070 (BALTO.) (410) 715-3681 (FAX)

Designed TO	GRADING AND SEDIMENT CONTROL PLAN	Scale	1" = 5'
Drawn BY	SHADY OAKS	Sheet	2 of 6
Checked BY	AND CENTER 19500 SITE DEVELOPMENT PLAN FOR MASS GRADING Tax Map 37 Part of Parcel 643	LOE Job No	92-176
Date	1st Election District Howard County, MD Previous Submittals 28877 REM, WPD 33, F 91125, Council Res. 187, 93-02, PB 284, P93-11	File No	
	Owner / Developer: 100 INVESTMENT LIMITED PARTNERSHIP 8835 N. Columbia 100 Parkway Columbia, Maryland 21045 301.750.0810		



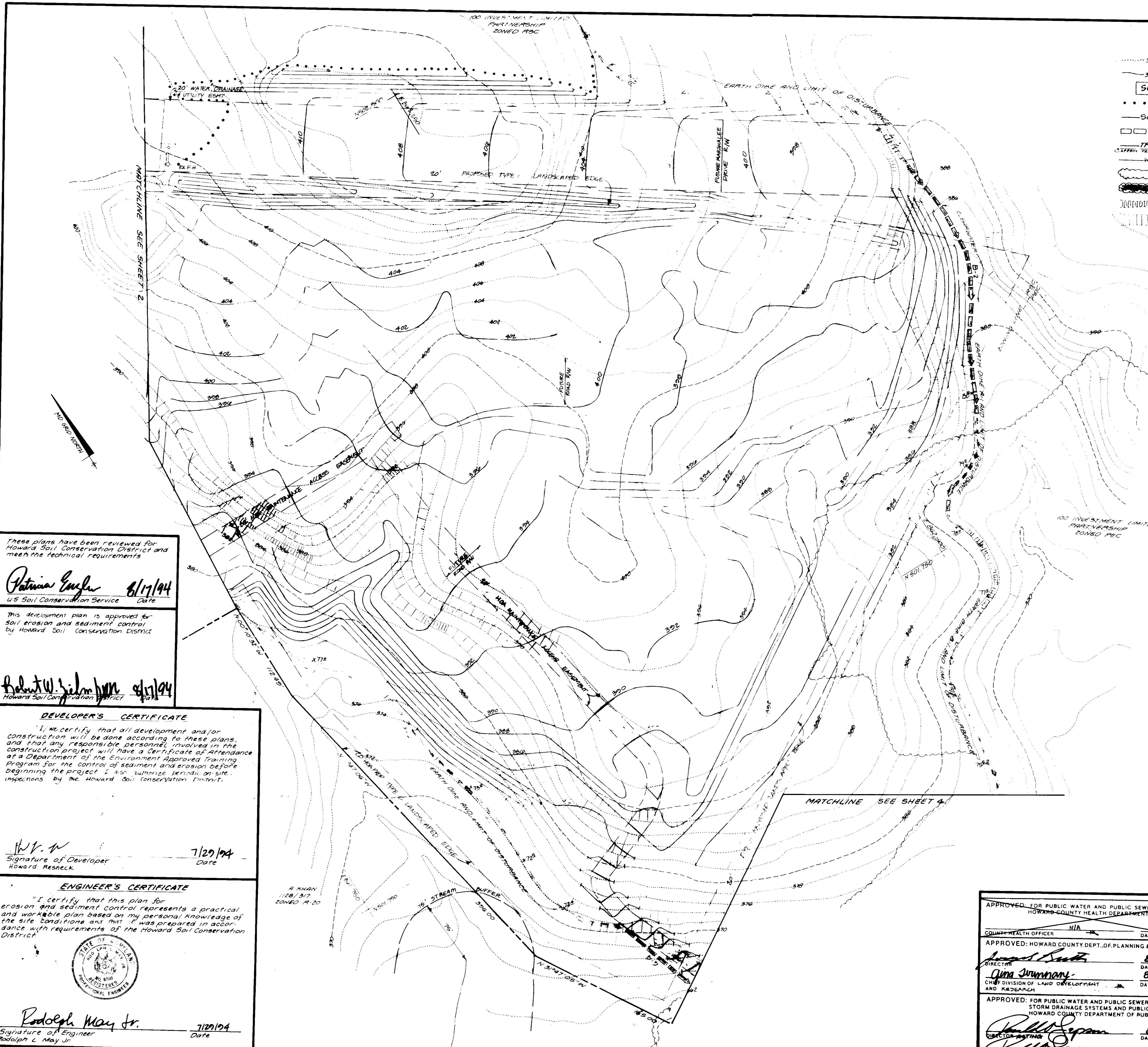

- LEGEND**
- 342 --- EXISTING CONTOUR (2' INTERVAL)
 - 342 --- PROPOSED CONTOUR (2' INTERVAL)
 - [SCE] STABILIZED CONSTRUCTION ENTRANCE
 - LIMIT OF DISTURBANCE
 - SF --- SILT FENCE
 - [EARTH DIKE] EARTH DIKE (STABILIZATION METHOD)
 - [TPF] TREE PROTECTION FENCE
 - W --- NON-TIARAL WETLANDS
 - [WOODS] EXISTING WOODS TO BE REMOVED
 - [WOODS] EXISTING WOODS TO REMAIN UNDISTURBED
 - [SLOPE 1] 25% OR GREATER SLOPES
 - [SLOPE 2] 15% - 24.9% SLOPES

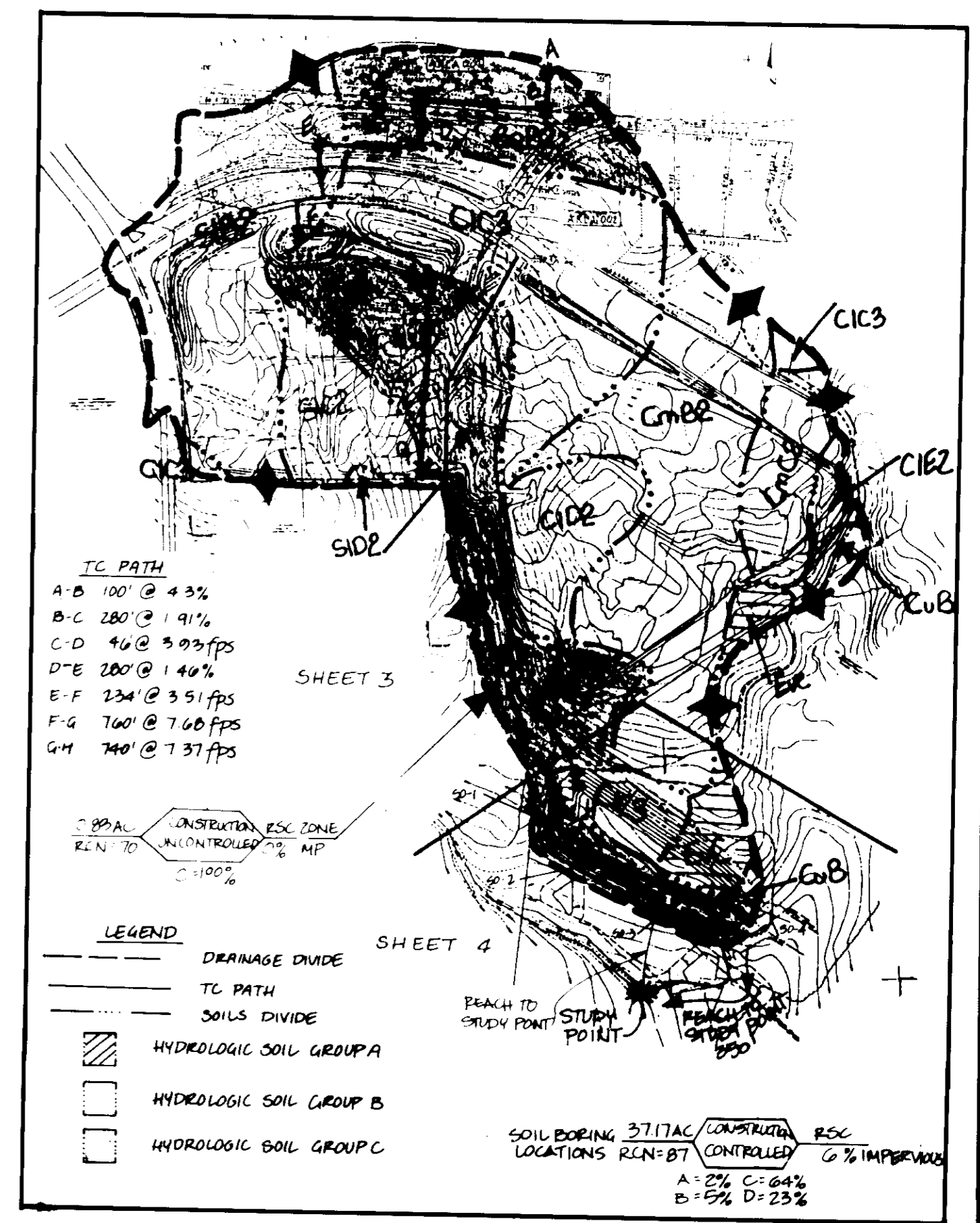

These plans have been reviewed for Howard Soil Conservation District and meet the technical requirements

Patricia Engler 8/17/94
 US Soil Conservation Service Date

This development plan is approved for soil erosion and sediment control by Howard Soil Conservation District

Robert W. Wilson 8/17/94
 Howard Soil Conservation District Date

DEVELOPER'S CERTIFICATE

"I, we certify that all development and/or construction will be done according to these plans, and that any responsible personnel involved in the construction project will have a Certificate of Attendance at a Department of the Environment Approved Training Program for the control of sediment and erosion before beginning the project. I also authorize periodic on-site inspections by the Howard Soil Conservation District.

H.R. Resneck 7/29/94
 Signature of Developer Date
 Howard Resneck

ENGINEER'S CERTIFICATE

"I certify that this plan for erosion and sediment control represents a practical and workable plan based on my personal knowledge of the site conditions and that it was prepared in accordance with requirements of the Howard Soil Conservation District.

Rodolph May Jr. 7/29/94
 Signature of Engineer Date
 Rodolph L. May Jr.

APPROVED FOR PUBLIC WATER AND PUBLIC SEWERAGE SYSTEMS. HOWARD COUNTY HEALTH DEPARTMENT COUNTY HEALTH OFFICER: N/A DATE: _____		LAND DESIGN ENGINEERING, INC. 8835 N. COLUMBIA 100 PARKWAY, COLUMBIA, MARYLAND 21085 (301) 596-3424 (WASH.) (410) 715-1070 (BALTO) (410) 715-0881 (FAX)	
APPROVED: HOWARD COUNTY DEPT. OF PLANNING & ZONING DIRECTOR: <i>Joseph Smith</i> 8/18/94 DATE: 8/18/94 CHIEF DIVISION OF LAND DEVELOPMENT AND RESEARCH: <i>Quia Summors</i> 8/18/94 DATE: 8/18/94		Designed: BOB Drawn: K&W Checked: BOB Date: July 1994	GRADING AND SEDIMENT CONTROL PLAN SHADY OAKS AND CENTRE 8500 SITE DEVELOPMENT PLAN FOR MASS GRADING Tax Map 37 Part of Parcel G43 1st Election District Howard County, MD Previous Submittals: 28877 R/W, WP91-33, F01-125, G04001 R/W 181, 593-DE, PB 286, P23-11 Owner/Developer: 100 INVESTMENT LIMITED PARTNERSHIP 8555 P. Columbia, MD 21046 Columbia Maryland 21045 (410) 730-0800
APPROVED: FOR PUBLIC WATER AND PUBLIC SEWERAGE, STORM DRAINAGE SYSTEMS AND PUBLIC ROADS HOWARD COUNTY DEPARTMENT OF PUBLIC WORKS DIRECTOR: <i>Paul J. Seaman</i> 8/19/94 DATE: 8/19/94 CHIEF BUREAU OF ENGINEERING: <i>Paul J. Seaman</i> 8/19/94 DATE: 8/19/94		Scale: 1"=50' Sheet: 3 of 6 LDE Job No: 28-176.1 File No: _____	

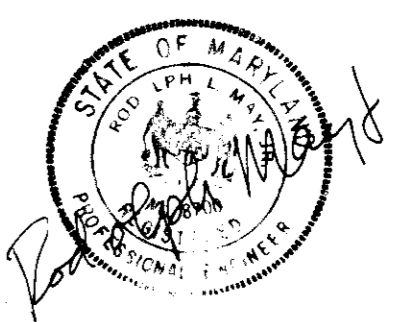

SUMMARY TABLE

Drainage Area = 33 Acres
 Top of Facility @ Elev 361.50
 Invert of Facility @ Elev 351.00

		SWM Facility		
		2 YEAR	10 YEAR	100 YEAR
Acceptable Release	(cfs)	10.50	46.30	106.40
Computed Inflow	(cfs)	58.80	118.60	187.30
Facility Discharge	(cfs)	10.50	46.30	106.40
Elevation at Discharge		357.28	358.71	359.98
Storage at Elevation (ACFT)		1.91	3.34	4.75

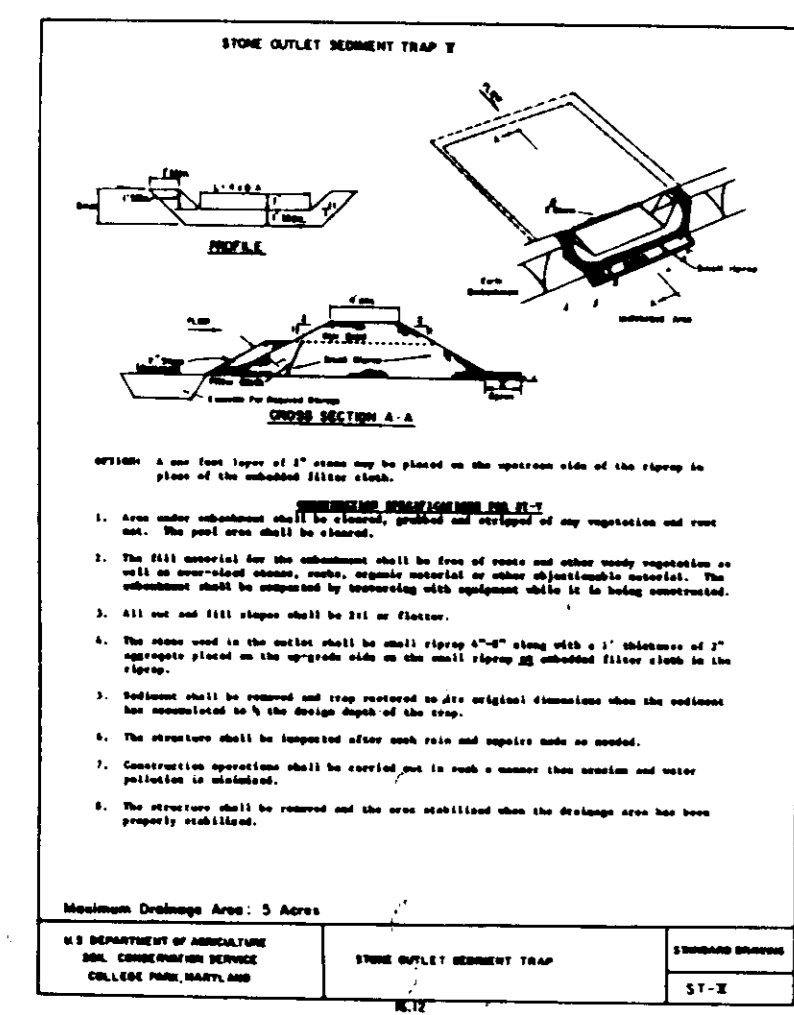
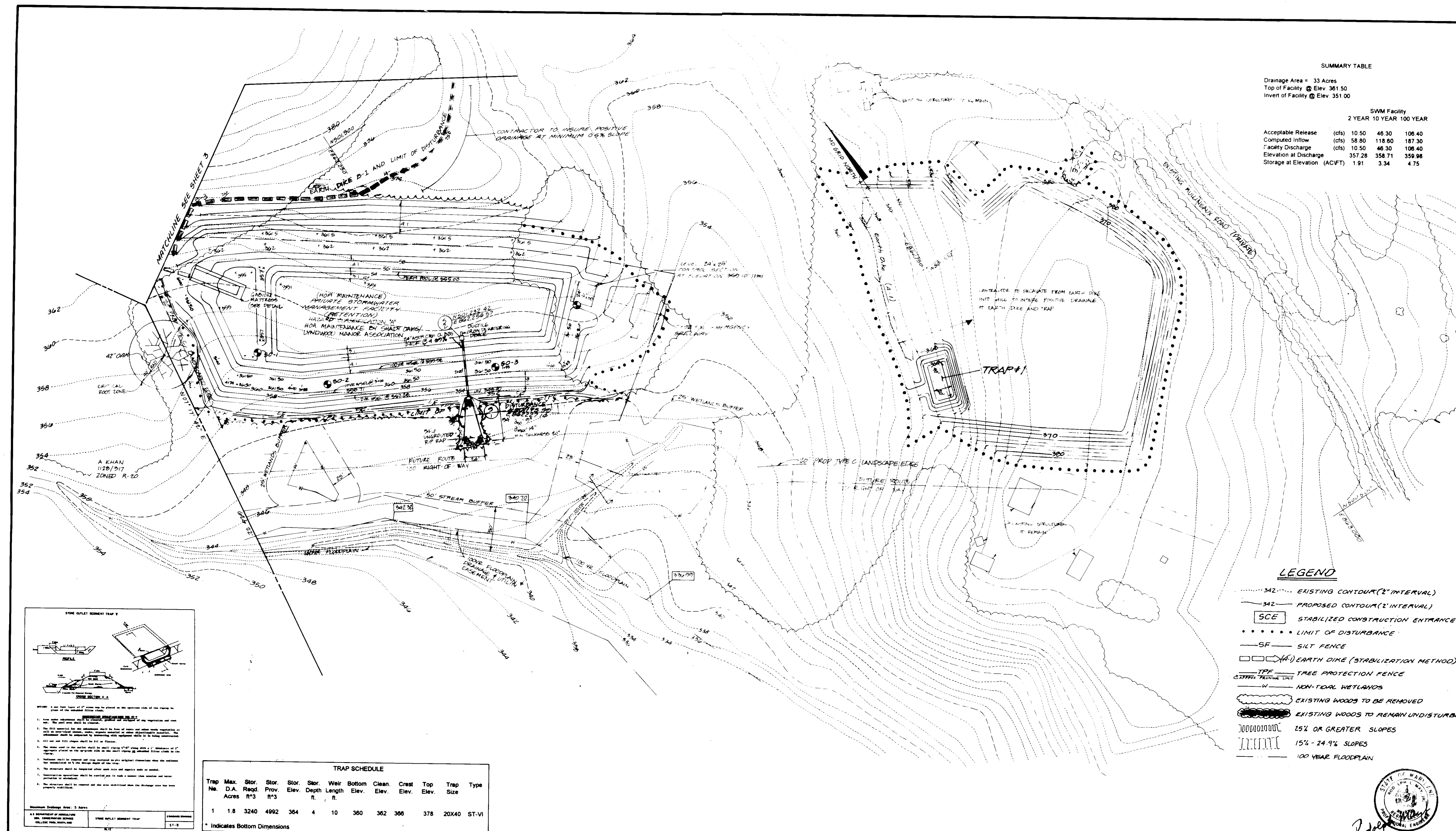

TRAP SCHEDULE

Trap No.	Max. Stor. Acres	Stor. Stor. ft³	Stor. Elev. ft.	Stor. Depth ft.	Weir Length ft.	Bottom Elev. ft.	Crest Elev. ft.	Top Elev. ft.	Trap Size	Trap Type
1	1.8	3240	4992	364	4	10	360	362	366	20X40 ST-VI

* Indicates Bottom Dimensions

DEVELOPER'S CERTIFICATE

"I certify that all development and/or construction will be done according to these plans and that any responsible personnel involved in the construction project will have a Certificate of Attendance at a Department of the Environment and erosion before beginning the project. I shall engage a registered professional engineer to supervise pond construction and provide the Howard Soil Conservation District with an as-built plan of the pond within 30 days of completion. I also authorize periodic on-site inspections by the Howard Soil Conservation District."

Signature of Developer: Howard Resneck
 Date: 7/29/94

ENGINEER'S CERTIFICATE

"I certify that this plan for pond construction erosion and sediment control represents a practical and workable plan based on my personal knowledge of the site conditions. This plan was prepared in accordance with requirements of the Howard Soil Conservation District. I have notified the developer that he/she must engage a registered professional engineer to supervise pond construction and provide the Howard Soil Conservation District with an as-built plan of the pond within 30 days of completion."

Signature of Engineer: Rodolph May Jr.
 Date: 7/29/94

These plans have been reviewed for the Howard Soil Conservation District and meet the technical requirements for small pond construction, soil erosion and sediment control.

Signature: Patricia Engler a.s.
 Date: 8/17/94
 U.S. Soil Conservation Service

These plans for small pond construction, soil erosion and sediment control meet the requirements of the Howard Soil Conservation District.

Signature: Robert W. Zickler
 Date: 8/17/94
 Howard Soil Conservation District

APPROVED FOR PUBLIC WATER AND PUBLIC SEWERAGE SYSTEMS
 HOWARD COUNTY HEALTH DEPARTMENT

COUNTY HEALTH OFFICER: N/A
 DATE: N/A

APPROVED: HOWARD COUNTY DEPT. OF PLANNING & ZONING
 DIRECTOR: [Signature]
 DATE: 8/18/94

APPROVED: DIVISION OF LAND DEVELOPMENT AND RESEARCH
 CHIEF: [Signature]
 DATE: 8/18/94

APPROVED FOR PUBLIC WATER AND PUBLIC SEWERAGE, STORM DRAINAGE SYSTEMS AND PUBLIC ROADS
 HOWARD COUNTY DEPARTMENT OF PUBLIC WORKS

DIRECTOR ACTING: [Signature]
 DATE: 8/19/94

CHIEF BUREAU OF ENGINEERING: [Signature]
 DATE: 8/19/94

LAND DESIGN ENGINEERING, INC.

8835-V COLUMBIA 100 PARKWAY COLUMBIA, MARYLAND 21045
 (301) 506-3424 (WASH.) (410) 715-1070 (BALTO.) (410) 715-0881 (FAX.)

Designed E.S.	GRADING AND SEDIMENT CONTROL PLAN SHADY OAKS AND CENTRE 9500 SITE DEVELOPMENT PLAN FOR MASS GRADING Tax Map 37 Part of Parcel G43 1st Election District Howard County, MD Previous Submittals 28877 R.M. WSP-33 F3/125 Council Res 187, 8-9-26, P3-804, P3-11	Scale 1"=50'
Drawn K.B.W.		Sheet 4 of 6
Checked A.M.		LDE Job No. 28-176-1
Date July 1994		File No.
		DUTY DEVELOPER 100 INVESTMENT LIMITED PARTNERSHIP 8835-V COLUMBIA 100 PARKWAY COLUMBIA, MARYLAND 21045 (401) 506-0810

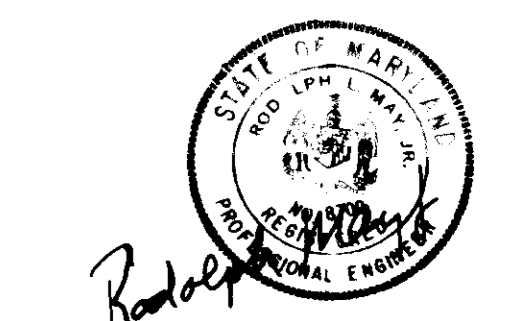

HOWARD SOIL CONSERVATION DISTRICT PERMANENT SEEDING NOTES

Apply to graded or cleared areas not subject to immediate further disturbance where a permanent long-term vegetative cover is needed.
Soil Preparation - Loosen upper three inches of soil by raking, diskage or other acceptable means before seeding, if not previously loosened.
Soil Ammendments - In lieu of soil test recommendations, use one of the following schedules:
1) Preferred - Apply 2 tons per acre of fertilizer (14 lbs/1000 sq. ft.)...

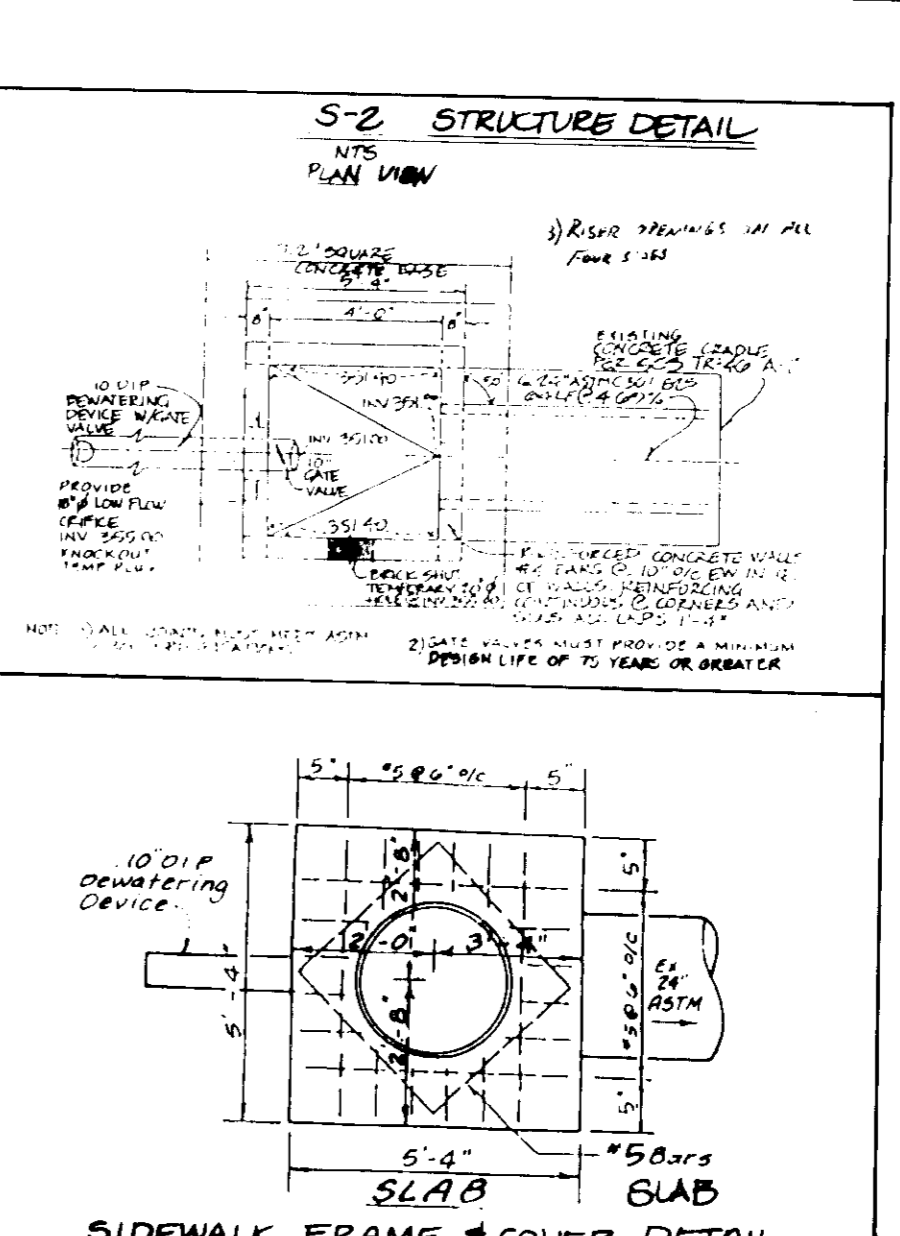
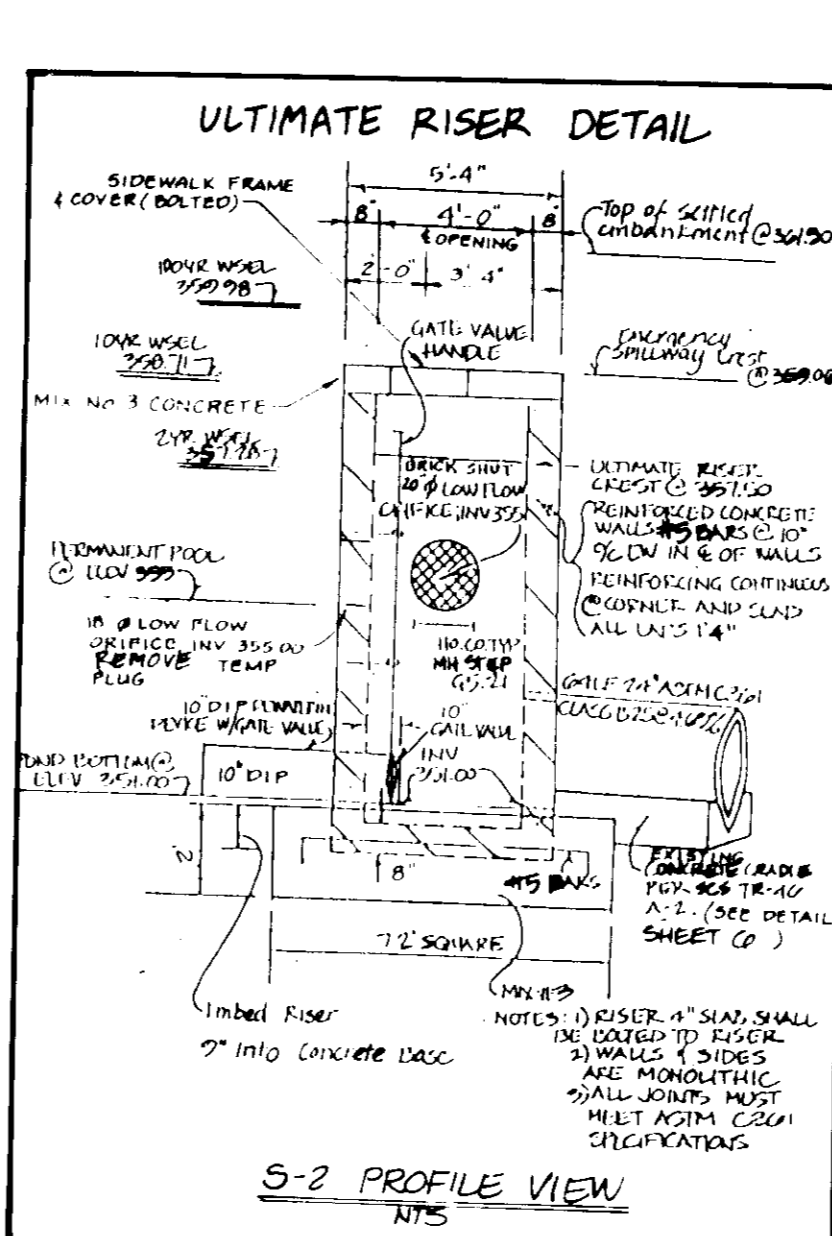
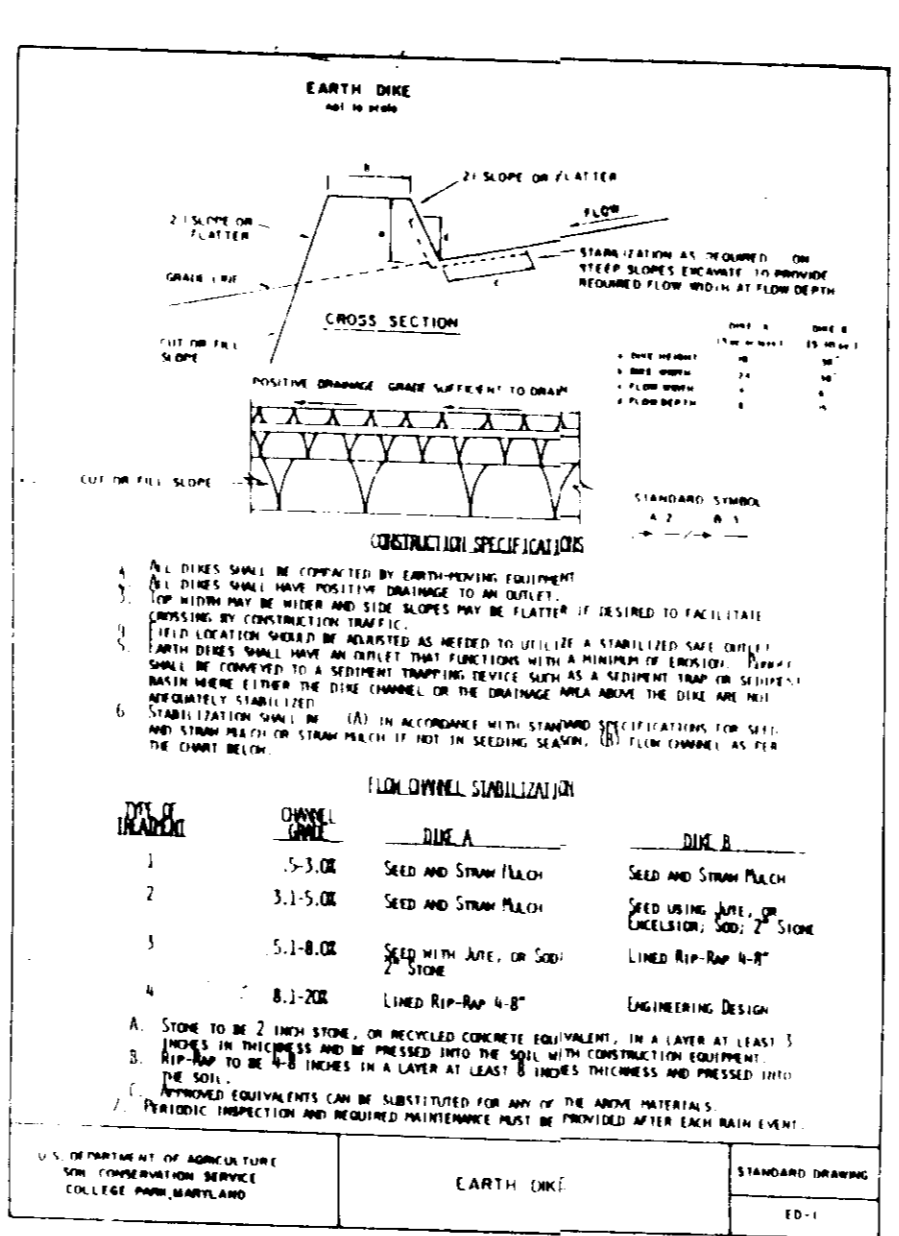
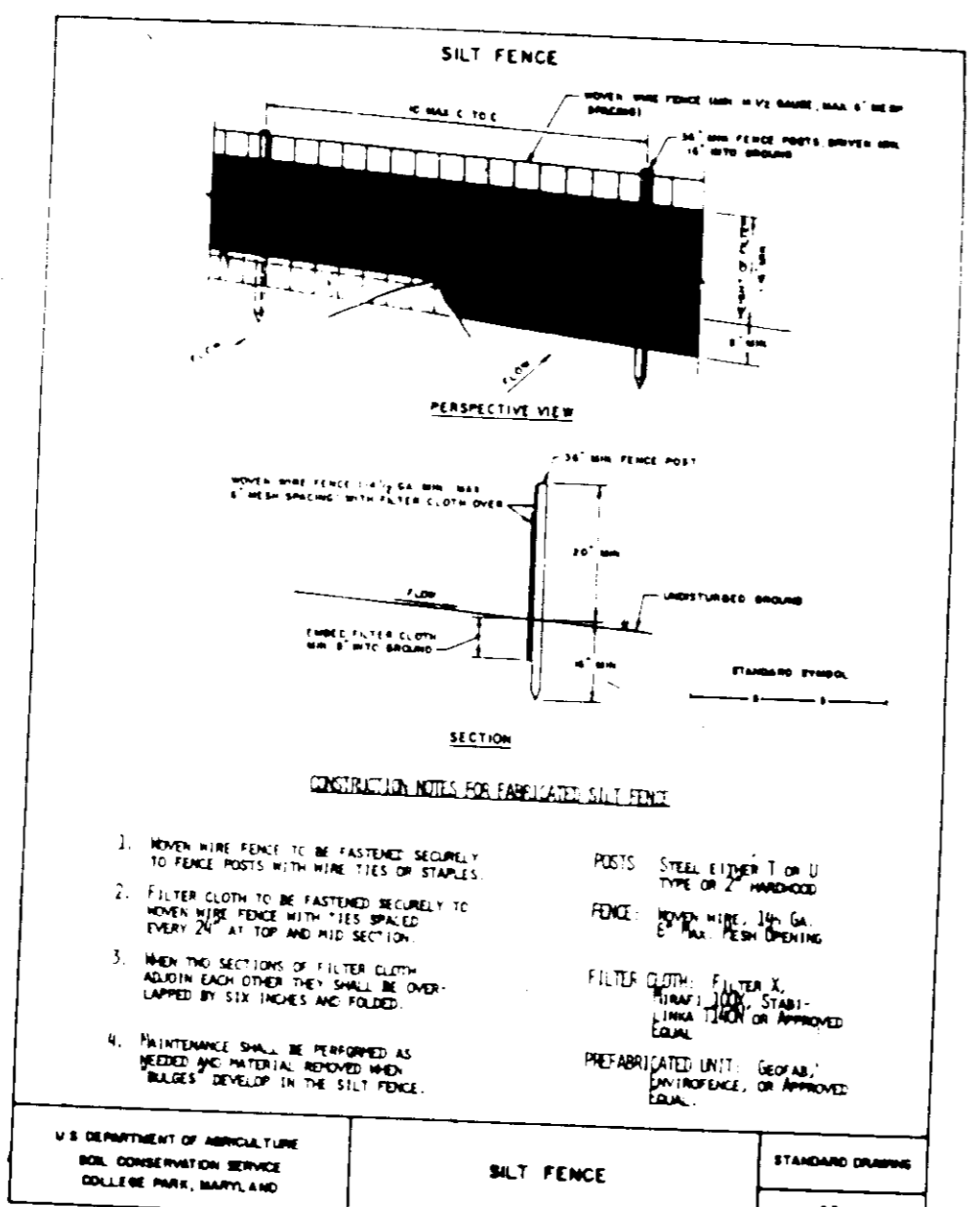

- 1. Obtain grading permits 1 day
2. Hold pre-construction meeting to include educational site presentation on tree preservation measures to be employed 1 day
3. Location of material storage, equipment access, loading, construction parking and concrete washouts to be developed on a construction strategy plan for tree protection prior to start up 1 day
4. Clearing limits are to be field adjusted by the contractor for tree preservation prior to any site work 1 day
5. No site preparation work shall begin in areas where tree treatment and preservation measures have not been completed and approved
6. The sequence of tree treatment and preservation measures shall be:
a. Stake out all limits of disturbance
b. Protective pruning and chemical treatment of significant trees to be affected by construction
c. Tree protection fencing
d. Tree protection signage installation 5 days
7. Tree protection fencing shall be maintained and repaired by the contractor during construction
8. Install SCS Series 1000 streambank management of basins 1 day
9. Construct stormwater management facility 2 weeks
a. Evaluate basin bottom to elevation 352.00
b. Construct inlet to sediment pond locations
c. 20' low flow outlet to elevation 353.00 (downstream of pond)
d. 35' low flow outlet to elevation 353.00 (downstream of pond)
e. 35' low flow outlet to elevation 353.00 (downstream of pond)
f. 35' low flow outlet to elevation 353.00 (downstream of pond)
10. Install sediment control on remainder of site - install all sediment control facilities as shown 3 days
11. Clear and grub site 1 week
12. Grub site 3 weeks
13. Stabilize site 1 week
14. Perimeter control and basin to remain in place until approved by the local road construction plans for this site F-94-27
15. Conversion of structure S-2 and final excavation to the pond's ultimate bottom below 351.00 will take place at the completion of F-94-27

Apply to graded or cleared areas likely to be re-disturbed where a short-term vegetative cover is needed.
Soil Preparation - Loosen upper three inches of soil by raking, diskage or other acceptable means before seeding, if not previously loosened.
Soil Ammendments - Apply 600 lbs per acre 10-10-10 fertilizer (14 lbs/1000 sq. ft.)...
Refer to the 1993 MARYLAND STANDARDS AND SPECIFICATIONS FOR SOIL EROSION AND SEDIMENT CONTROL for additional rates and methods not covered.
REV 1/91

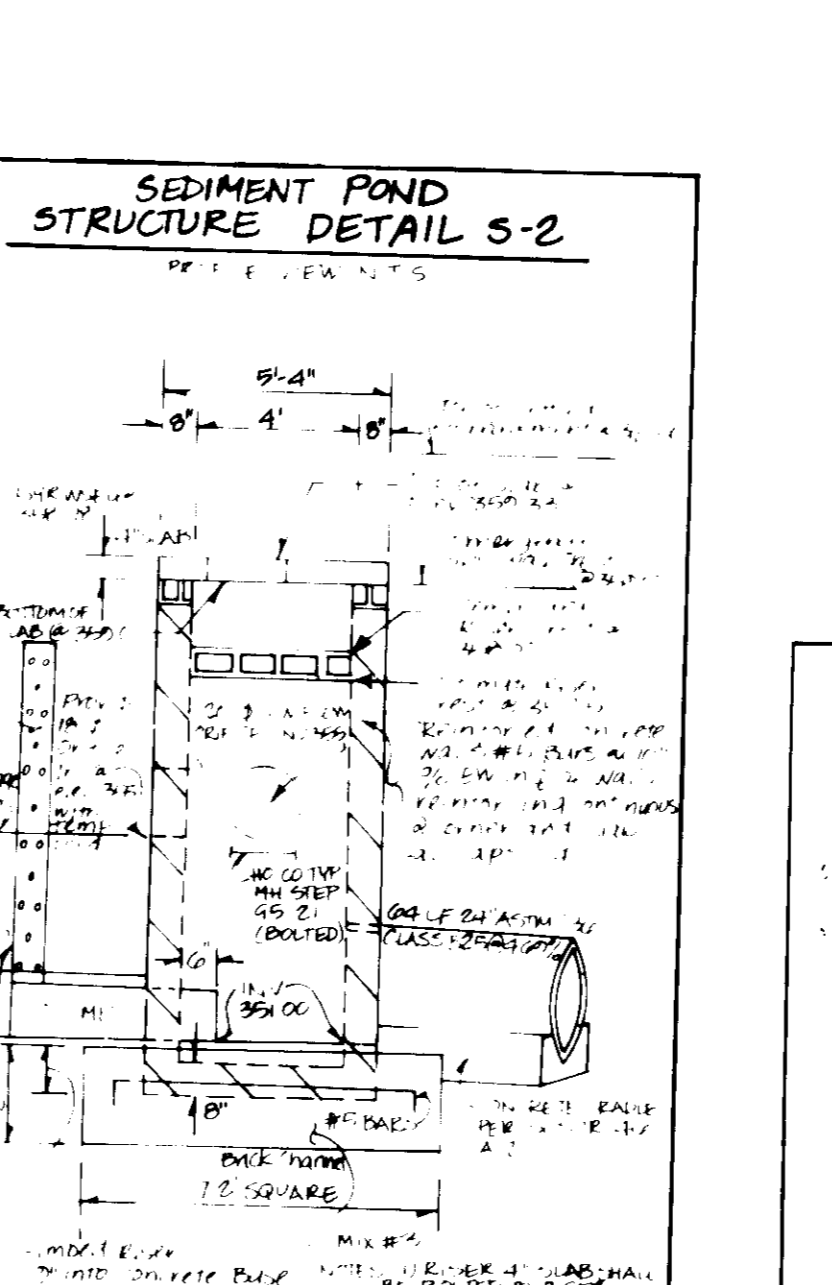
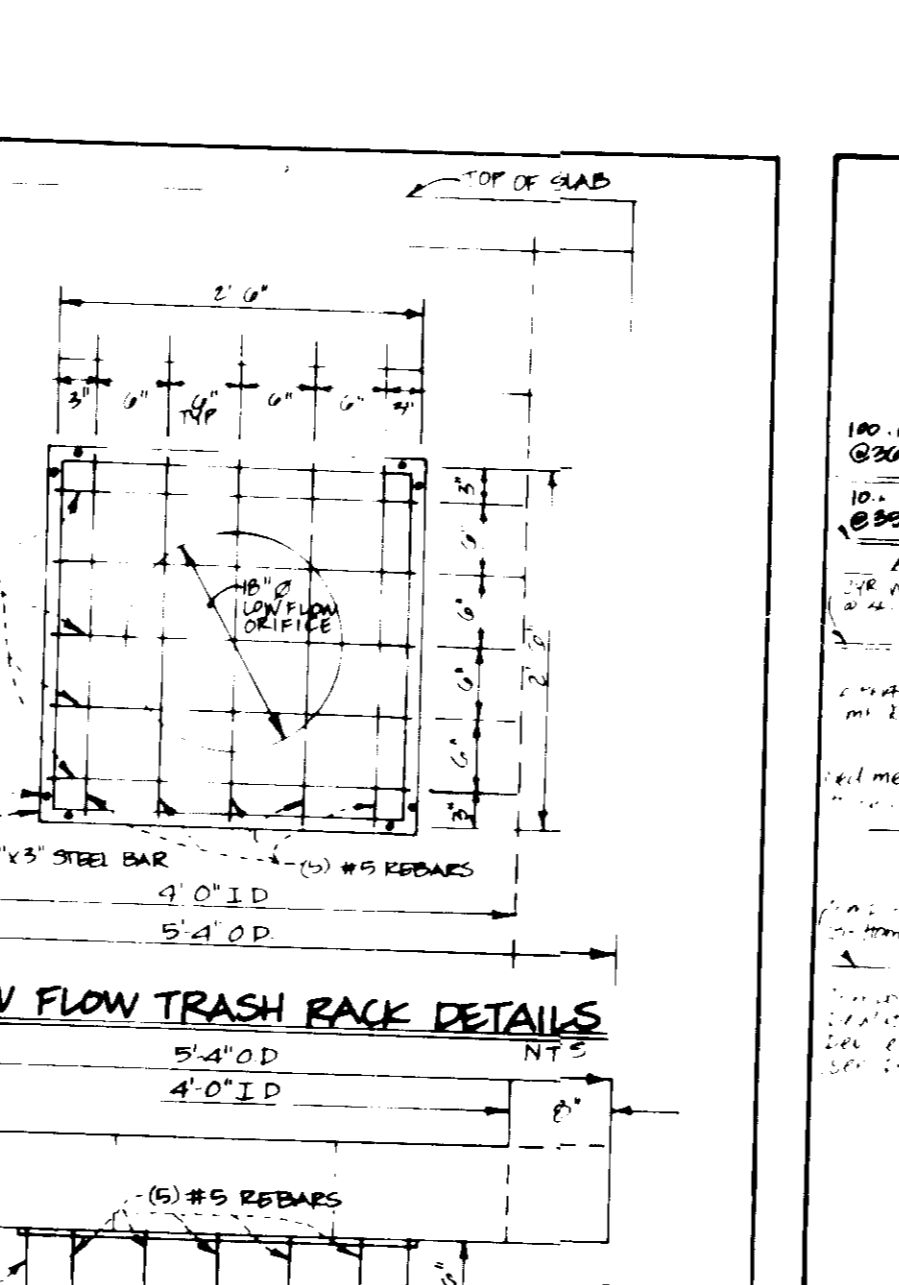
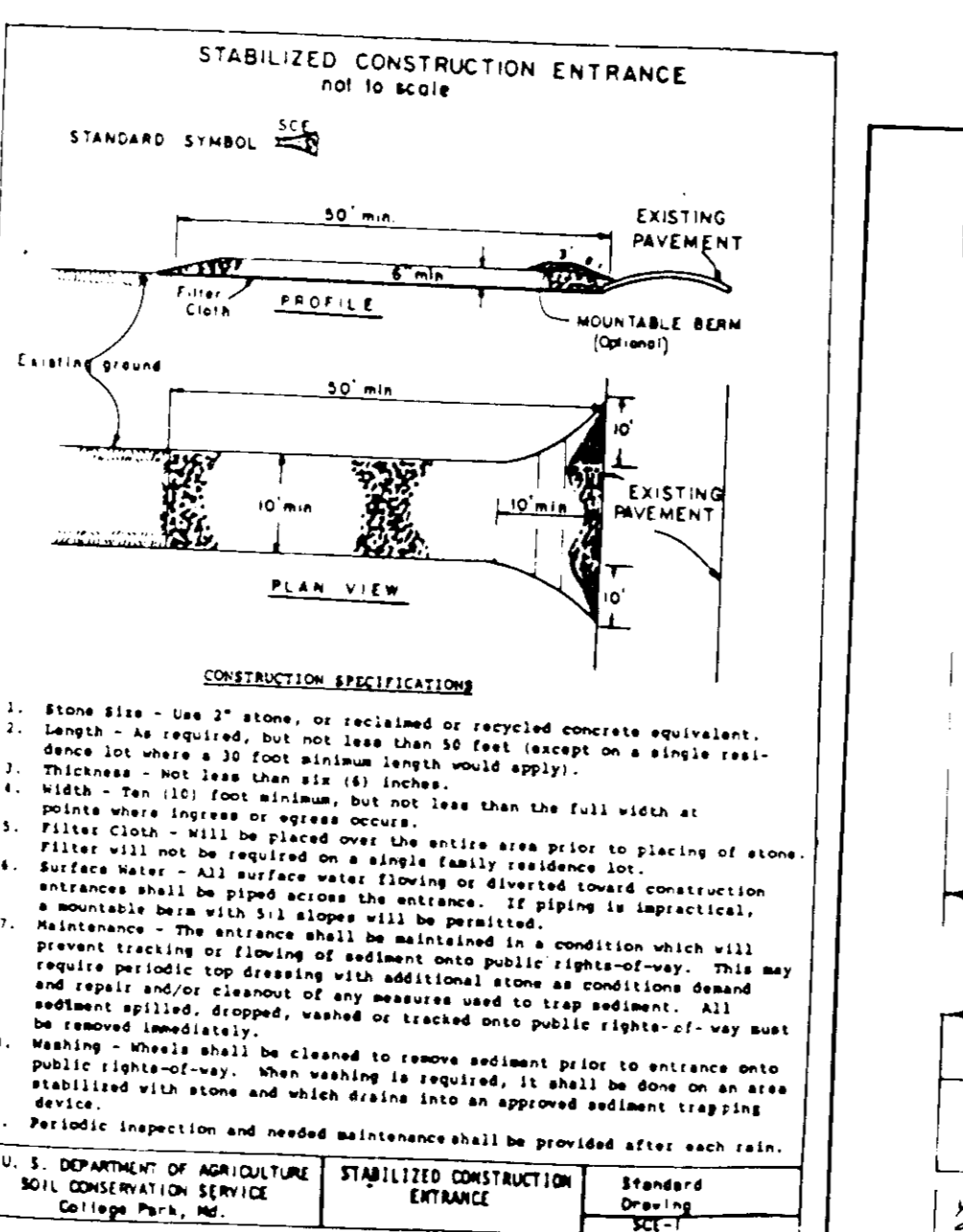

- Maintenance
1. Repair all damages caused by soil erosion and construction equipment at or before the end of each working day.
2. Sediment shall be removed from the basin when it reaches the specified distance below the top of the riser. This sediment shall be placed in such a manner that it will not erode from the site. The sediment shall not be deposited downstream from the embankment, adjacent to a stream or flood plain.

- HOWARD SOIL CONSERVATION DISTRICT SEDIMENTATION CONTROL NOTES
1. A minimum of 40 trees per acre must be preserved to the Howard County Department of Inspection, Licensing and Permits, Sediment Control Division prior to the start of any construction.
2. All vegetative and structural practices are to be installed according to the provisions of this plan and are to be in accordance with the most current "MATERIAL STANDARDS AND SPECIFICATIONS FOR SOIL EROSION AND SEDIMENT CONTROL" and revisions thereto.
3. Following initial soil disturbance or re-disturbance, permanent or temporary stabilization shall be completed within: a) 7 calendar days for all permanent sediment control structures, dikes, terraces, slopes and all slopes greater than 1:1; b) 14 days for all other disturbed or graded areas on the project site.
4. All sediment trapping structures shall be fenced and warning signs posted around their perimeter in accordance with Section 12, Chapter 12, of the HOWARD COUNTY DESIGN MANUAL, Storm Drainage.
5. All disturbed areas must be stabilized within the time period specified above in accordance with the 1993 MARYLAND STANDARDS AND SPECIFICATIONS FOR SOIL EROSION AND SEDIMENT CONTROL, Section 5.1, and (Sec. 5.1), Temporary Sealing (Sec. 5.1) and Sealing (Sec. 5.2). Temporary stabilization with mulch shall allow only to be used when recommended seeding rates do not allow for proper germination and establishment of grasses.
6. All sediment control structures are to remain in place and are to be maintained in operating condition until permission for their removal has been obtained from the Howard County Sediment Control Inspector.
7. Site Analysis:
Total Area of Site: 30.6 Acres
Area Disturbed: 30.2 Acres
Area to be roofed or paved: 0.0 Acres
Area to be vegetatively stabilized: 30.2 Acres
Total Cut: 122,782 Cu. Yds.
Total Fill: 122,782 Cu. Yds.
Off-site waste/hazard area location: F-94-27
8. Any sediment control practice which is disturbed by grading activity for placement of utilities must be repaired on the same day of disturbance.
9. Additional sediment control must be provided, if deemed necessary by the Howard County Sediment Control Inspector.
10. Small sites with disturbed areas in excess of 2 acres, approval of the project engineer shall be requested upon completion of installation of perimeter erosion and sediment controls, but before proceeding with any other earth disturbance or grading. After building or grading inspection approvals may not be authorized until this initial approval by the inspection agency is made.
*Reference for the construction of the 10' x 10' x 10' concrete structure can be found in the 1993 MARYLAND STANDARDS AND SPECIFICATIONS FOR SOIL EROSION AND SEDIMENT CONTROL, Section 5.1, and (Sec. 5.1), Temporary Sealing (Sec. 5.1) and Sealing (Sec. 5.2).

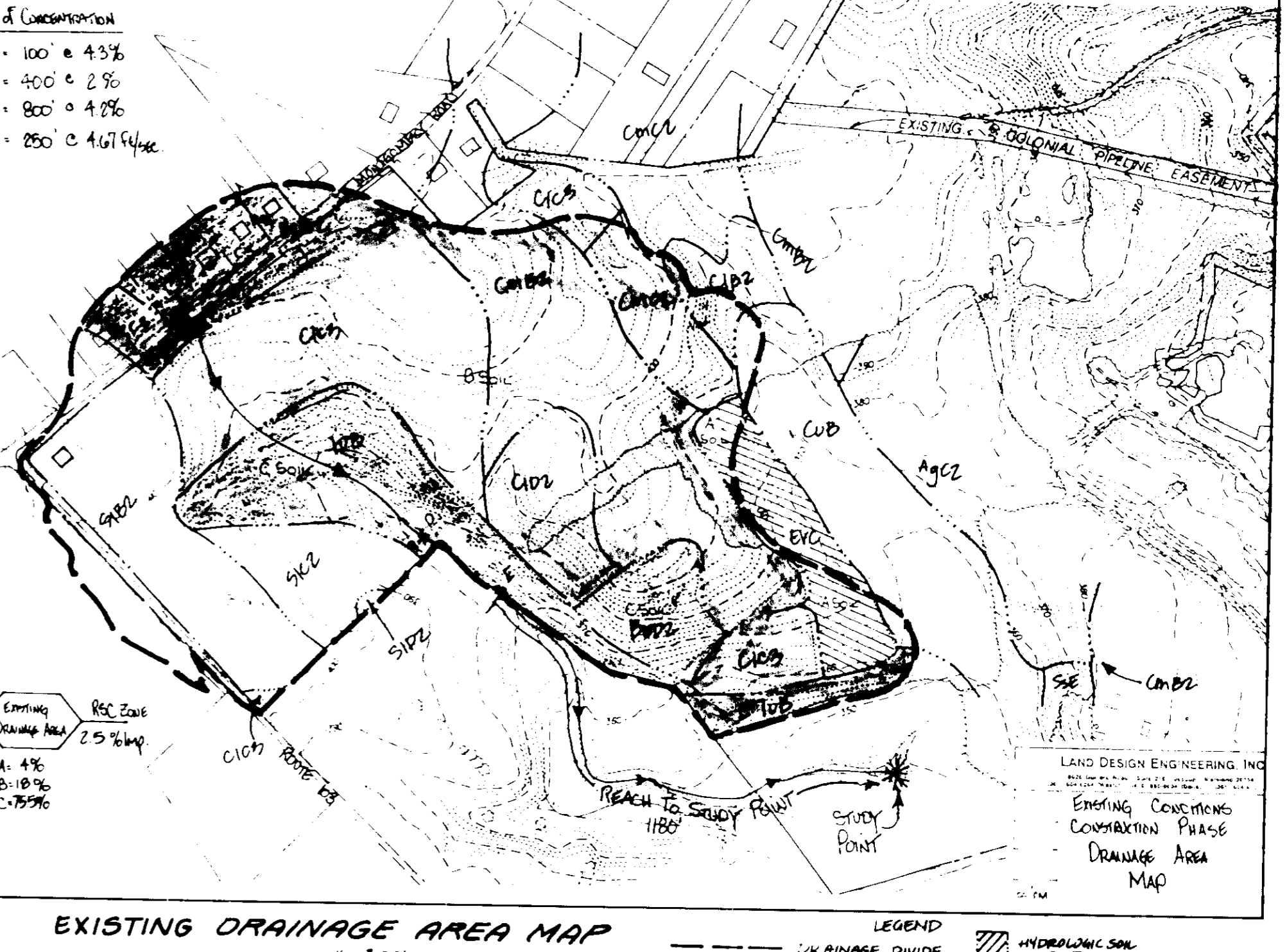
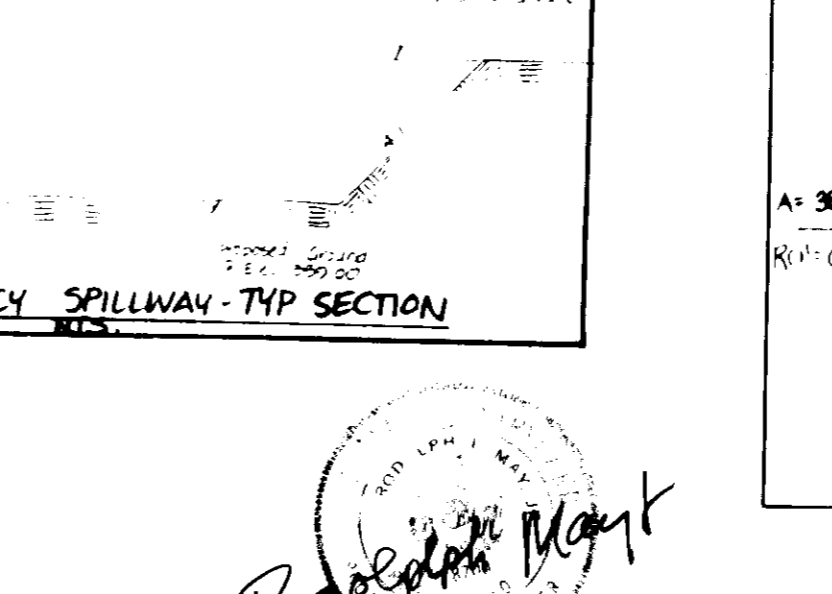
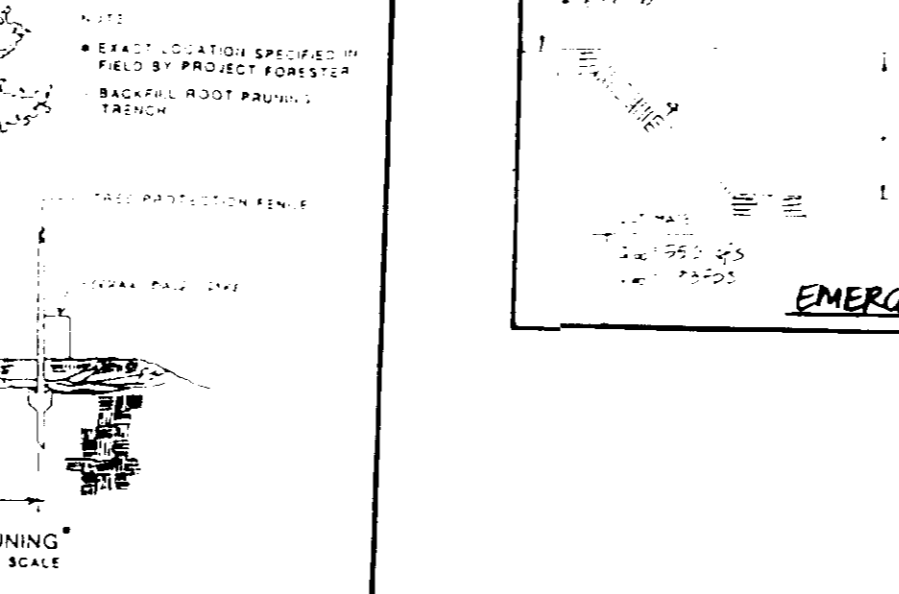
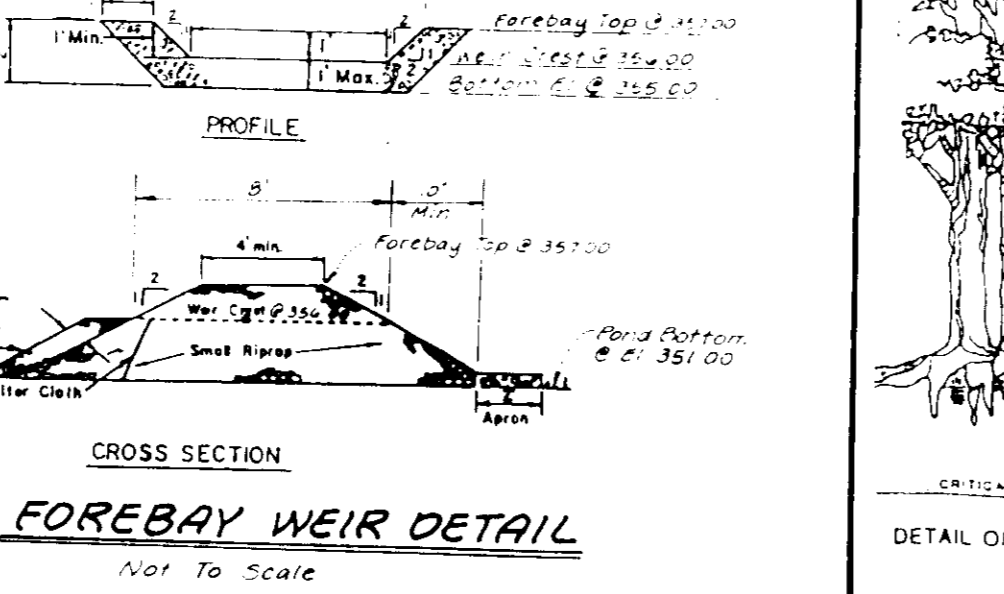

DEVELOPER'S CERTIFICATE
I certify that all development and/or construction will be done according to these plans and that any contractor or subcontractor involved in the construction project will have a Certificate of Attendance or a Certificate of the Environmental Approval Training Program for the control of sediment and erosion before beginning the project. I shall engage a registered professional engineer to supervise pond construction and provide the Howard Soil Conservation District with an "as-built" plan of the pond within 30 days of completion. I also authorize the on-site inspections by the Howard Soil Conservation District.
Signature of Developer: Howard Resneck
Date: 7/29/94

ENGINEER'S CERTIFICATE
I certify that this plan for pond construction, erosion and sediment control represents a practical and workable plan based on my personal knowledge of the site conditions. This plan was prepared in accordance with requirements of the Howard Soil Conservation District. I have notified the developer that he/she must engage a registered professional engineer to supervise pond construction and provide the Howard Soil Conservation District with an "as-built" plan within 30 days of completion.
Signature of Engineer: Rodolph E. May Jr.
Date: 7/29/94

These plans have been reviewed for the Howard Soil Conservation District and meet the technical requirements for sediment control, erosion and sediment control.
Signature of Inspector: Patricia Andrews
Date: 8/17/94

APPROVED FOR PUBLIC WATER AND PUBLIC SEWERAGE SYSTEMS.
HOWARD COUNTY HEALTH DEPARTMENT
COUNTY HEALTH OFFICER: N/A
DATE:
APPROVED: HOWARD COUNTY DEPT. OF PLANNING AND ZONING
Signature of Planning and Zoning: [Signature]
DATE: 8/18/94
Signature of Planning and Zoning: [Signature]
DATE: 8/18/94
APPROVED FOR PUBLIC WATER AND PUBLIC SEWERAGE.
STORM DRAINAGE SYSTEMS AND PUBLIC ROADS
HOWARD COUNTY DEPARTMENT OF PUBLIC WORKS
Signature of Public Works: [Signature]
DATE: 8/19/94
Signature of Public Works: [Signature]
DATE: 8/19/94

LAND DESIGN ENGINEERING, INC.
3010 W. WISCONSIN AVE. • COLUMBIA, MARYLAND 21045
(301) 506-3424 (WASH.) (410) 715-1070 (BALTS.) (410) 715-0881 (FAX)
SEEDING CONTROL DETAILS
SHADY OAKS
AND CENTRE 9500
SITE DEVELOPMENT PLAN
FOR MASS GRADING
Tax Map 37 Part of Parcel 643
1st Election District Howard County, MD
Previous Submittals 23877 REM, W93-33, F91-15, Council Res 18, 593-02, PB 204, P93-11
DMC / DEVELOPER:
100 INVESTMENT LIMITED PARTNERSHIP
8535 P. Columbia 100 Parkway
Columbia Maryland 21045 410-730-0800
Scale: No Scale
Sheet: 5 of 6
LOE Job No: 98-176-1
File No: SDP-93-105