

GENERAL NOTES: DEMOLITION PLAN

- OBTAIN GRADING PERMIT.
- INSTALL SEDIMENT AND EROSION CONTROL DEVICES AS SHOWN ON SHEET 3.
- ALL STRUCTURES ON SITE SHALL BE RAZED OR REMOVED.
- FOUNDATIONS OF EXISTING STRUCTURES, LOCATED WITHIN SEWERAGE DISPOSAL EASEMENT SHALL BE REMOVED AND OR BACKFILL AS DIRECTED BY THE HOWARD COUNTY HEALTH DEPARTMENT.
- EACH FOUNDATION SHALL BE BACKFILL WITH SELECT MATERIAL I.E., NO ROCK, NO CONSTRUCTION MATERIAL WASTE, NO TREES OR TREE STUMPS.
- ALL EXISTING PRIVATE SEWERAGE DISPOSAL SYSTEMS SHALL BE REMOVED AND OR COLLAPSED AND BACKFILLED WITH SELECT MATERIAL AS DIRECTED BY HOWARD COUNTY HEALTH DEPARTMENT.
- ALL EXISTING WELLS ARE TO BE BACKFILLED, REMOVED, COLLAPSED AND OR CAPPED AS DIRECTED BY HOWARD COUNTY HEALTH DEPARTMENT.
- ALL PAVED AREAS ARE TO BE REMOVED.
- ALL UNDERGROUND LINES FOR WATER, SEWERAGE AND HEATING OIL SHALL BE REMOVED.
- ALL ELECTRIC AND TELEPHONE LINES SHALL BE CUT BACK TO THE UTILITY POLES.

MATCH LINE THIS SHEET

MATCH LINE THIS SHEET

FISHER, COLLINS & CARTER, INC.
 CIVIL ENGINEERS & LAND SURVEYORS
 SUITE 100, 9171 BALTIMORE NATIONAL PIKE
 ELLICOTT CITY, MARYLAND 21043
 (301) 461-2855

ENGINEER'S CERTIFICATE
 I HEREBY CERTIFY THAT THIS PLAN FOR EROSION AND SEDIMENT CONTROL REPRESENTS A PRACTICAL AND WORKABLE PLAN BASED ON MY PERSONAL KNOWLEDGE OF THE SITE CONDITIONS AND THAT IT WAS PREPARED IN ACCORDANCE WITH THE REQUIREMENTS OF THE HOWARD SOIL CONSERVATION DISTRICT.

[Signature]
 SIGNATURE OF ENGINEER
 10/17/91
 DATE

DEVELOPER'S CERTIFICATE
 I/WE CERTIFY THAT ALL DEVELOPMENT AND CONSTRUCTION WILL BE DONE ACCORDING TO THIS PLAN OF DEVELOPMENT AND PLAN FOR EROSION AND SEDIMENT CONTROL AND THAT ALL RESPONSIBLE PERSONNEL INVOLVED IN THE CONSTRUCTION PROJECT WILL HAVE A CERTIFICATE OF ATTENDANCE AT A DEPARTMENT OF THE ENVIRONMENT APPROVED TRAINING PROGRAM FOR THE CONTROL OF SEDIMENT AND EROSION BEFORE BEGINNING THE PROJECT. I ALSO AUTHORIZE PERIODIC ON-SITE INSPECTION BY THE HOWARD SOIL CONSERVATION DISTRICT OR THEIR AUTHORIZED AGENTS, AS ARE DEEMED NECESSARY.

[Signature]
 SIGNATURE OF DEVELOPER
 9-19-91
 DATE

REVIEWED FOR HOWARD SOIL CONSERVATION DISTRICT AND MEETS TECHNICAL REQUIREMENTS!

U.S. SOIL CONSERVATION SERVICE DATE _____

THIS DEVELOPMENT IS APPROVED FOR EROSION AND SEDIMENT CONTROL BY THE HOWARD SOIL CONSERVATION DISTRICT.

APPROVED: _____ DATE _____

DISTRICT: HOWARD SOIL CONSERVATION DISTRICT

APPROVED: DEPT. OF PLANNING AND ZONING

PLANNING DIRECTOR: *[Signature]* 1/31/92 DATE
 CHIEF, DIVISION OF COMMUNITY PLANNING AND LAND DEVELOPMENT: *[Signature]* 1/30/92 DATE
 HEALTH OFFICER: *[Signature]* 1-23-92 DATE

APPROVED: DEPARTMENT OF PUBLIC WORKS FOR PRIVATE WATER & SEWER AND STORM DRAINAGE SYSTEMS AND ROADS.

DIRECTOR, PUBLIC WORKS: *[Signature]* 10/20/91 DATE
 CHIEF, BUREAU OF ENGINEERING: *[Signature]* 4/24/92 DATE

PROPERTY/SUBDIVISION: INWOOD VILLAGE CENTER SECTION/AREA: _____ PARCEL: A
 PLAT NO. 2006 BLOCK NO. 11 ZONE B-1 TAX/ZONE 14 ELEC. DIST. 4 CENSUS TR. 6040
 WATER CODE _____ SEWER CODE _____

SITE DEVELOPMENT PLAN
 EXISTING IMPROVEMENTS AND DEMOLITION PLAN
INWOOD VILLAGE CENTER
 RETAIL STORES

FOURTH ELECTION DISTRICT
 HOWARD COUNTY MARYLAND
 TAX MAP 14 BLOCK 11 PARCEL A
 DATE: OCTOBER 17, 1991

SHEET 1 OF 7



OWNER AND DEVELOPER
J.R. ENTERPRISES, INC.
 TRIADDELPHIA AND TEN OAKS ROAD
 P.O. BOX 239
 GLENELG, MARYLAND 21737

NOTES:

- THIS AREA DESIGNATES A PRIVATE SEWAGE EASEMENT AS REQUIRED BY THE MARYLAND STATE DEPT. OF HEALTH AND MENTAL HYGIENE FOR INDIVIDUAL SEWAGE DISPOSAL. IMPROVEMENTS OF ANY NATURE IN THIS AREA ARE RESTRICTED UNTIL PUBLIC SEWAGE IS AVAILABLE. THIS EASEMENT SHALL BECOME NULL AND VOID UPON CONNECTION TO A PUBLIC SEWAGE SYSTEM. THE COUNTY HEALTH OFFICER SHALL HAVE THE AUTHORITY TO GRANT VARIANCES FOR ENCROACHMENTS INTO A PRIVATE SEWAGE EASEMENT. RECORDATION OF MODIFIED SEWAGE EASEMENT SHALL NOT BE NECESSARY.
- WELLS WILL BE ABANDONED BY A CERTIFIED WELL DRILLER PRIOR TO THE INSTALLATION OF THE PROPOSED SEPTIC SYSTEM.
- ALL EXISTING WELLS AND SEPTIC SYSTEMS ON THE SUBJECT PROPERTY AND WITHIN 100 FEET OF SUBJECT PROPERTY BOUNDARIES HAVE BEEN SHOWN.
- MAX. SEWAGE DESIGN FLOW ALLOCATION IS 3750 GALLONS PER DAY. SEE APPROVED PERC CERTIFICATION SIGNED BY COUNTY HEALTH OFFICER APRIL 2, 1991.

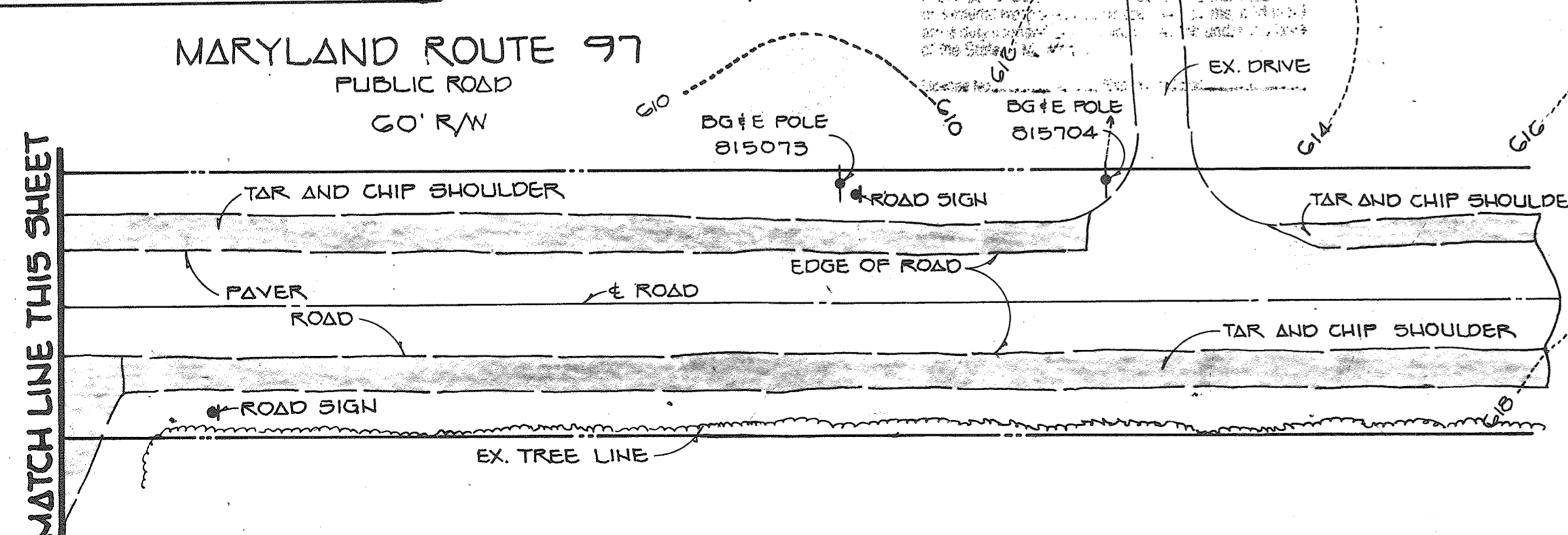
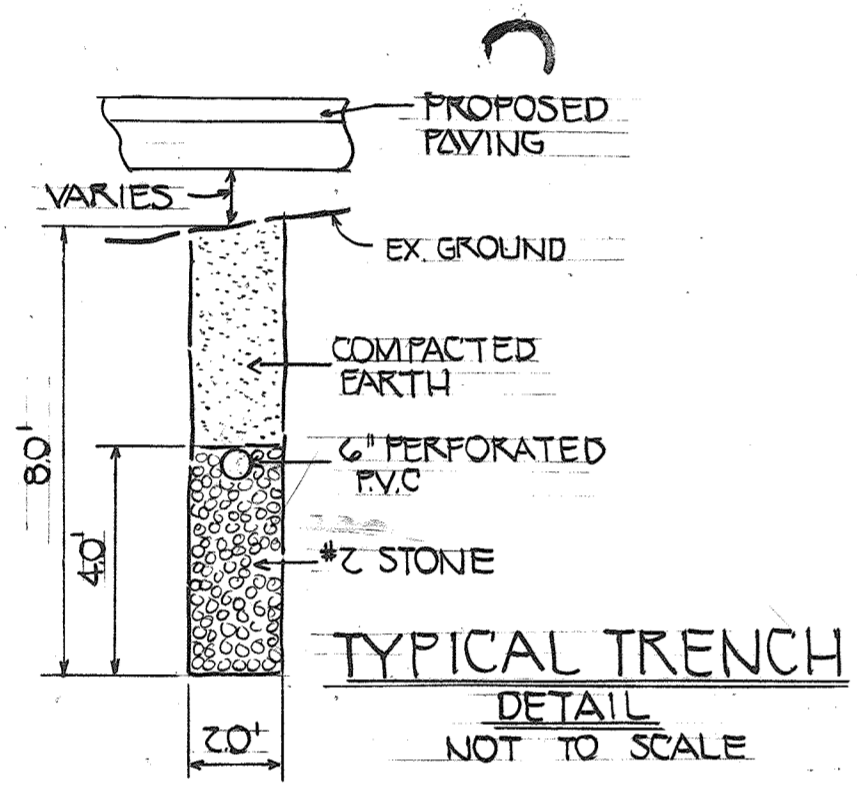
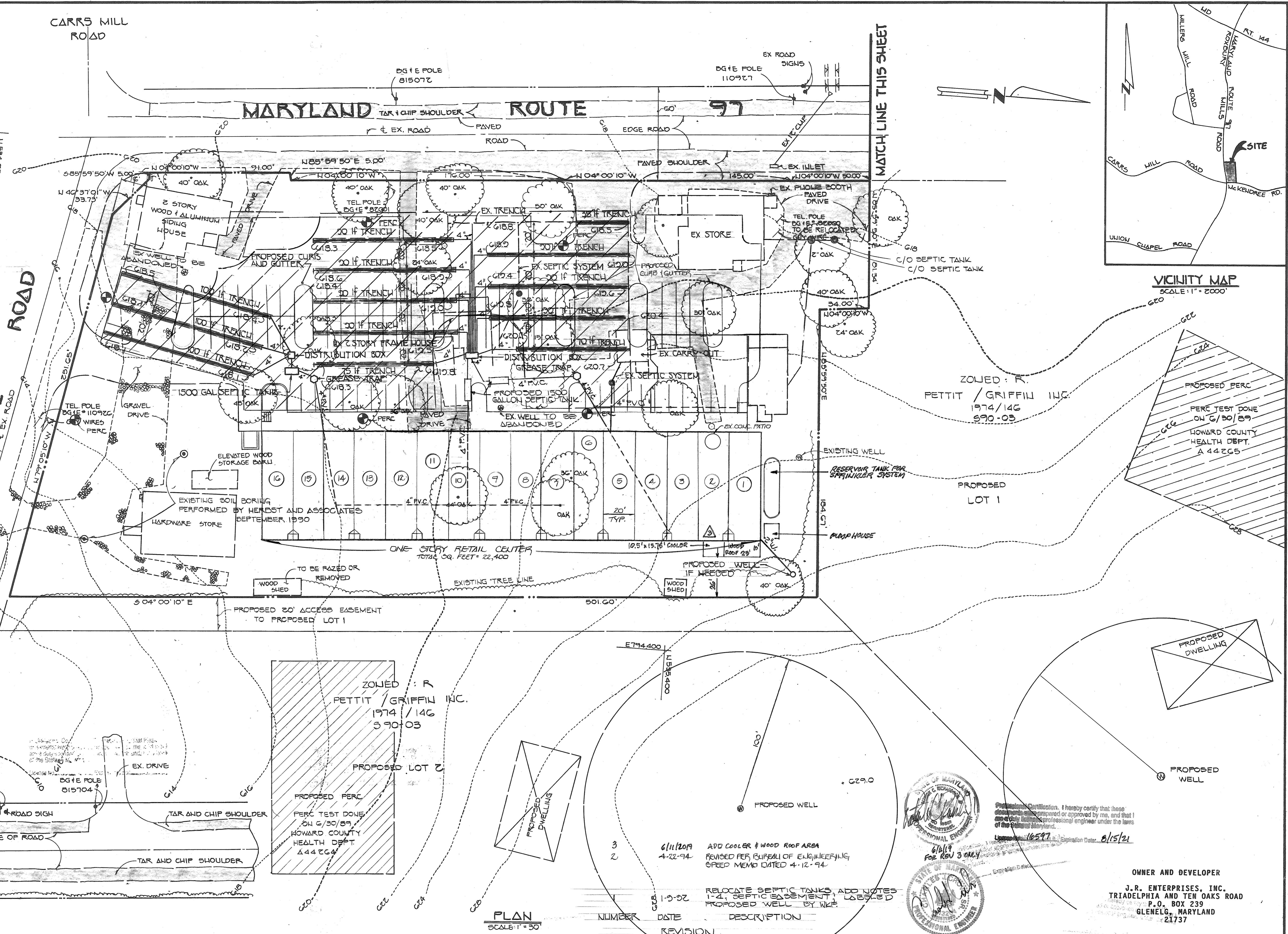

ZONED: R
 PETTIT / GRIFFIN INC.
 1974 / 146
 590-03

PROPOSED PERC
 PERC TEST DONE
 ON 6/30/89
 HOWARD COUNTY
 HEALTH DEPT.
 44264

PLAN SCALE: 1" = 30'

NUMBER	DATE	REVISION	DESCRIPTION
3	6/11/2019		ADD COOLER & WOOD ROOF AREA
2	4-22-94		REVISED PER BUREAU OF ENGINEERING SPEED MEMO DATED 4-12-94
1	1-9-92		RELOCATE SEPTIC TANKS, ADD NOTES 1-21, SEPTIC EASEMENT, LEGS, PROPOSED WELL BY WLF

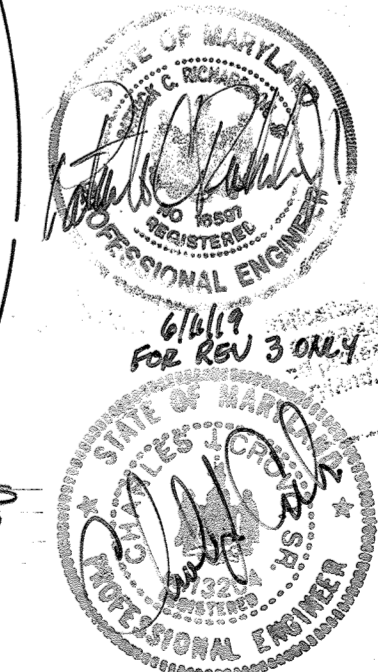

Professional Certification. I hereby certify that these documents were prepared or approved by me, and that I am a duly licensed professional engineer under the laws of the State of Maryland.
 License No. 16597, Expiration Date: 8/15/21
 6/1/19 For Rev 3 only

OWNER AND DEVELOPER
 J.R. ENTERPRISES, INC.
 TRIADELPHIA AND TEN OAKS ROAD
 P.O. BOX 239
 GLENELG, MARYLAND
 21737

FISHER, COLLINS & CARTER, INC.
 CIVIL ENGINEERS & LAND SURVEYORS
 SUITE 100, 9171 BALTIMORE NATIONAL PIKE
 ELLICOTT CITY, MARYLAND 21043
 (301) 461-2855

ENGINEER'S CERTIFICATE
 I HEREBY CERTIFY THAT THIS PLAN FOR EROSION AND SEDIMENT CONTROL REPRESENTS A PRACTICAL AND WORKABLE PLAN BASED ON MY PERSONAL KNOWLEDGE OF THE SITE CONDITIONS AND THAT IT WAS PREPARED IN ACCORDANCE WITH THE REQUIREMENTS OF THE HOWARD SOIL CONSERVATION DISTRICT.

Signature: *Chad Carter*
 Date: 10/17/91

DEVELOPER'S CERTIFICATE
 I/WE CERTIFY THAT ALL DEVELOPMENT AND CONSTRUCTION WILL BE DONE ACCORDING TO THIS PLAN OF DEVELOPMENT AND PLAN FOR EROSION AND SEDIMENT CONTROL AND THAT ALL RESPONSIBLE PERSONNEL INVOLVED IN THE CONSTRUCTION PROJECT WILL HAVE A CERTIFICATE OF ATTENDANCE AT A DEPARTMENT OF THE ENVIRONMENT APPROVED TRAINING PROGRAM FOR THE CONTROL OF SEDIMENT AND EROSION BEFORE BEGINNING THE PROJECT. I ALSO AUTHORIZE PERIODIC ONSITE INSPECTION BY THE HOWARD SOIL CONSERVATION DISTRICT OR THEIR AUTHORIZED AGENTS, AS ARE DEEMED NECESSARY.

Signature: *Ronald Z. Egan*
 Date: 9-19-91

REVIEWED FOR HOWARD SOIL CONSERVATION DISTRICT AND MEETS TECHNICAL REQUIREMENTS

U.S. SOIL CONSERVATION SERVICE DATE: _____

THIS DEVELOPMENT IS APPROVED FOR EROSION AND SEDIMENT CONTROL BY THE HOWARD SOIL CONSERVATION DISTRICT.
 APPROVED: _____ DATE: _____

APPROVED: DEPT. OF PLANNING AND ZONING

PLANNING DIRECTOR: *Amma Helms* DATE: 1/31/92
 CHIEF, DIVISION OF COMMUNITY PLANNING AND LAND DEVELOPMENT DATE: 3/1/90

APPROVED: HOWARD COUNTY HEALTH DEPARTMENT FOR PRIVATE WATER AND SEWERAGE SYSTEMS
 HEALTH OFFICER: *James Gordon* DATE: 1-23-92

APPROVED: DEPARTMENT OF PUBLIC WORKS FOR PRIVATE WATER & SEWER AND STORM DRAINAGE SYSTEMS AND ROADS.

DIRECTOR, PUBLIC WORKS: *James P. ...* DATE: 10/30/91
 CHIEF, BUREAU OF ENGINEERING: *Stephen A. ...* DATE: 1/24/92

PROPERTY/SUBDIVISION: INWOOD VILLAGE CENTER SECTION/AREA: A PARCEL: A
 PLAT NO. 3206 BLOCK NO. 11 ZONE TAX/ZONE B-1 14 ELEC. DIST. 4 CENSUS TR. 6040
 WATER CODE _____ SEWER CODE _____

SEPTIC SYSTEM LAYOUT NOTES AND DETAILS

INWOOD VILLAGE CENTER RETAIL STORES

FOURTH ELECTION DISTRICT
 HOWARD COUNTY MARYLAND
 TAX MAP 14 BLOCK 11 PARCEL A
 DATE: OCTOBER 17, 1991

SHEET 2 OF 7

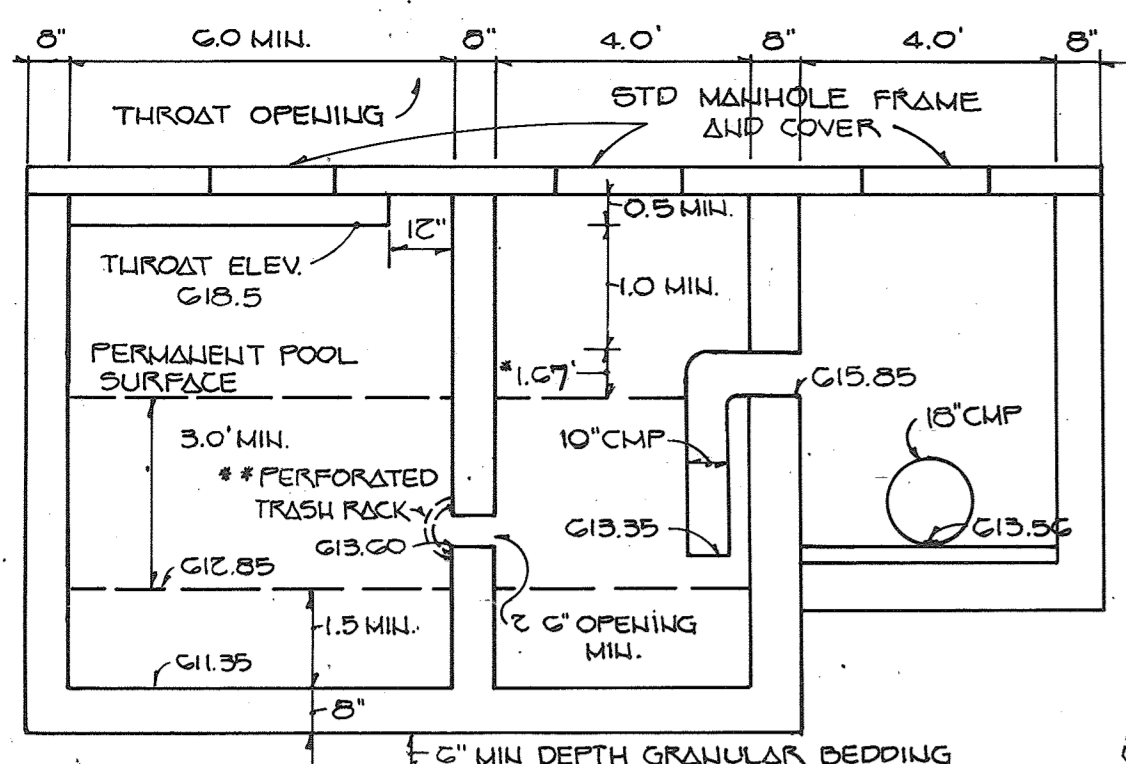

WATER QUALITY STRUCTURE
 SCALE HOR. 1" = 3'
 VERT. 1" = 3' (I-2)

MAINTENANCE NOTES (WATER QUALITY STRUCTURE WASTE)

- Water Quality Structures will require periodical cleaning. Owners of these facilities will have to clean them as needed or on a frequency that the County determines is appropriate. Owners of water quality structures will be notified by the County of the frequency of maintenance.
- Maintenance of these facilities will consist of cleaning out the separator and disposal of the waste and the repair of the facility as needed. Periodic inspections of these facilities will be made by the County Stormwater Management group.
- The disposal of the liquid and solid matter should be as follows:
 - All liquid material in the separator inlet shall be pumped into a suitable tank truck and disposed of at an approved sanitary district discharge manhole or be taken to an approved sewage treatment plant for discharge.
 - The solid material shall be landfilled in an approved sanitary landfill.
- The inlet pipes, trash racks, grates, and structural parts shall be repaired as needed.

- CONSTRUCTION NOTES:**
- Silt and debris shall not be allowed to enter the structures until contributing drainage areas have been permanently stabilized.
 - All openings to structures shall be protected with the appropriate sediment control measures during construction.

NOTE: THIS WATER QUALITY INLET IS TO BE CONSTRUCTED PER HOWARD COUNTY VOLUME IV STD. DETAIL 907.4.4.2

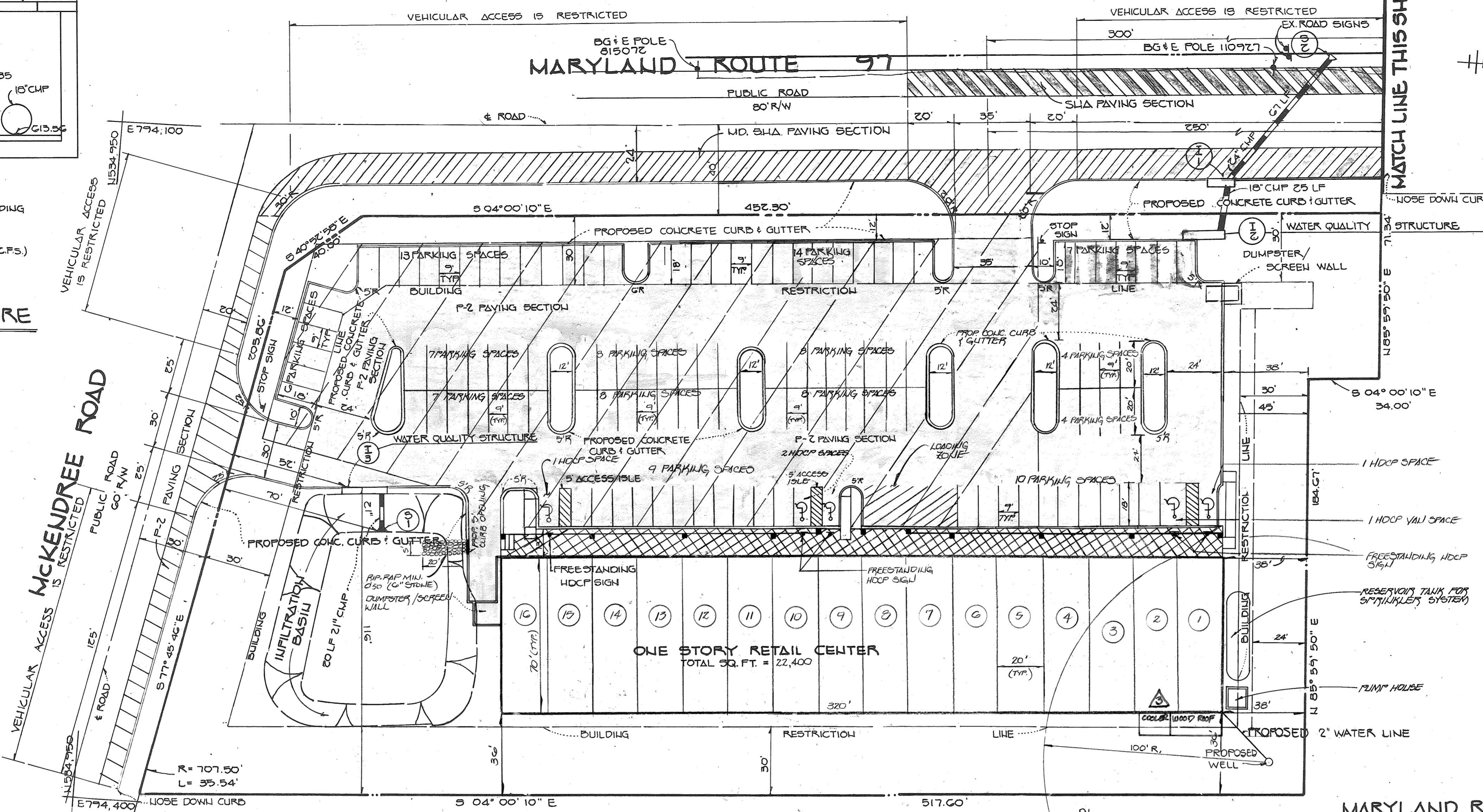

PLAN
 SCALE: 1" = 30'

- GENERAL NOTES**
- EXISTING ZONING IS B-1 BUSINESS LOCAL.
 - PROPERTY IS RECORDED AS PLAT NO. 2300.
 - TOTAL AREA OF SITE IS 2.9 AC.±.
 - BUILDING COVERAGE (50% PERCENT MAX) IS 17%.
 - AREA OF PARKING LOT 0.97 AC.± (INCLUDES ACCESS ISLES SERVING PARKING SPACES), AREA OF LANDSCAPED ISLANDS REQUIRED (5% MIN) 0.05 AC.±. AREA OF LANDSCAPED ISLANDS PROVIDED (23%) 0.22 AC.±.
 - PROPOSED BUILDING USE IS RETAIL STORES. (22,400 SQ. FT.)
 - PARKING DATA:
 - RETAIL STORES = 22,400
 - 22,400 @ 1 SPACE / 200 SQ. FT. = 112 PARKING SPACES REQUIRED.
 - 115 STANDARD PARKING SPACES
 - 5 HANDICAPPED SPACES
 - A LEVEL TEXTURED SURFACE NOT LESS THAN THE WIDTH OF EACH ENTRANCE AND EXTENDED FIVE FEET OUT FROM EACH ENTRANCE SHALL BE INLAIN IN THE SIDEWALK FOR THE PURPOSE OF IDENTIFICATION BY HANDICAPPED PERSONS.
 - ALL EXTERIOR LAMPS SHALL BE DIRECTED OR REFLECTED AWAY FROM ALL ADJACENT ROADS AND RESIDENTIAL AREAS.
 - CONTRACTORS SHALL VERIFY THE HORIZONTAL AND VERTICAL LOCATION OF ALL UTILITIES BEFORE STARTING ANY CONSTRUCTION.
 - THE CONTRACTOR OR DEVELOPER SHALL CONTACT THE CONSTRUCTION/INSPECTION/SURVEY DEPT. OF HOWARD COUNTY, MARYLAND 24 HOURS IN ADVANCE OF COMMENCEMENT OF WORK AT 313-1820.
 - THE CONTRACTOR SHALL NOTIFY THE C&P TELEPHONE COMPANY AND THE GAS AND ELECTRIC COMPANY FIVE DAYS PRIOR TO STARTING WORK SHOWN ON THESE PLANS BY CALLING MISS UTILITY AT 1-559-0100 (COLLECT).
 - THE CONTRACTOR SHALL NOTIFY THE HOWARD COUNTY HEALTH DEPT., 24 HOURS ADVANCE OF COMMENCEMENT OF WORK IN OR AROUND THE PRIVATE SEWERAGE DISPOSAL EASEMENT 461-9933.
 - THIS PLAN IS SUBJECT TO WATER OF SUBDIVISION AND LAND DEVELOPMENT REGULATIONS SECTION 16.119, 16.120 AND 16.115 C.4. DATED DEC. 31, 1990 W-91-60. WAIVER FOR REQUIRED SKETCH AND PRELIMINARY PLAN AND DIRECT ACCESS TO A MINOR ARTERIAL ROAD. THIS PLAN IS SUBJECT TO F 91-75.
 - THIS PLAN IS SUBJECT TO K.L.P. 94-08 APPROVED 28TH OF MARCH, 1994. APPROVAL TO WAIVE SECTION 16.150 TO PERMIT A ONE YEAR EXTENSION TO APPLY FOR A BUILDING PERMIT FOR SDP 91-60.

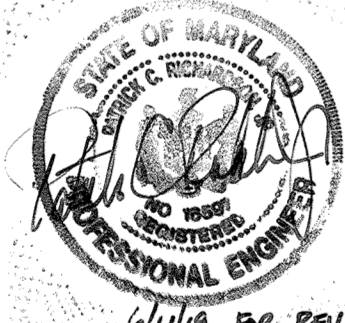

Professional Certification. I hereby certify that these documents were prepared or approved by me, and that I am a duly licensed professional engineer under the laws of the State of Maryland.
 License No. 16597, Expiration Date: 8/15/21

NO.	DATE	REVISIONS
3	6/11/2019	ADD COOLER & ROOF AREA
2	3-2-75	REVISED PARKING LAYOUT INCREASED SPACES
1	4-22-94	REVISED PER BUREAU OF ENGINEERING SPEED MEMO DATED 4-12-94

TYPICAL BUILDING PROFILE
 NOT TO SCALE

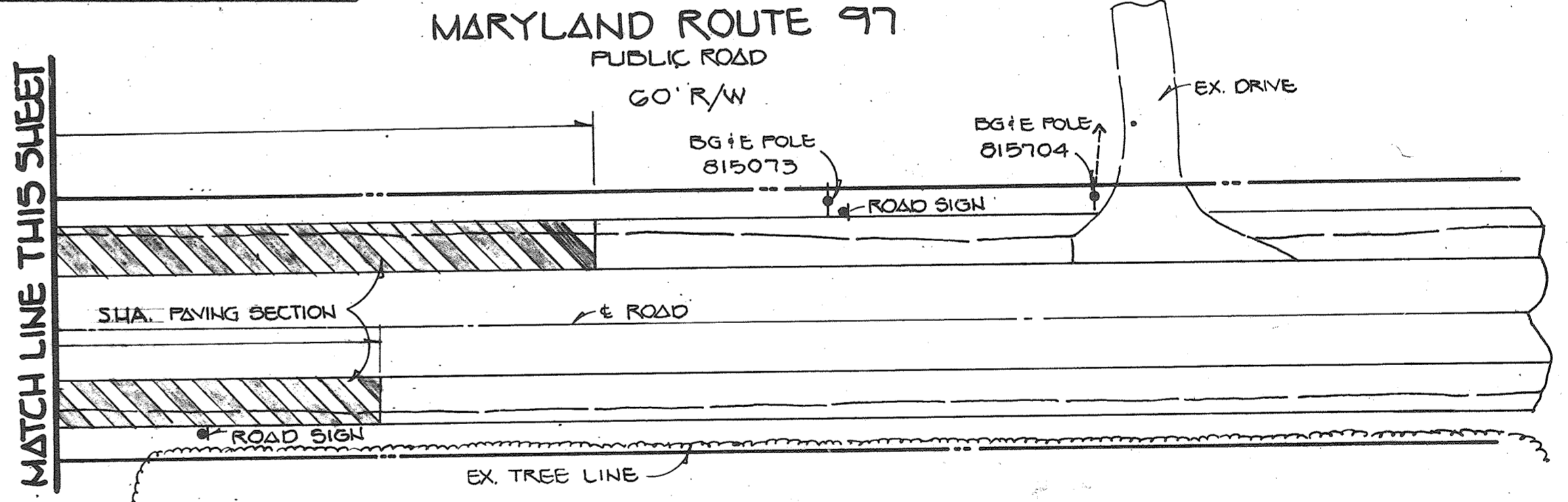

DUMPSTER PAD ENCLOSURE DETAIL
 NOT TO SCALE

OWNER AND DEVELOPER
 J.R. ENTERPRISES, INC.
 TRIADAPLHA AND TEN OAKS ROAD
 P.O. BOX 239
 GLENELG, MARYLAND 21737

LOT NO.	STREET ADDRESS
	ADDRESS CHART

FISHER, COLLINS & CARTER, INC.
 CIVIL ENGINEERS & LAND SURVEYORS
 SUITE 100, 9171 BALTIMORE NATIONAL PIKE
 ELLICOTT CITY, MARYLAND 21043
 (301) 461-2855

ENGINEER'S CERTIFICATE
 I HEREBY CERTIFY THAT THIS PLAN FOR EROSION AND SEDIMENT CONTROL REPRESENTS A PRACTICAL AND WORKABLE PLAN BASED ON MY PERSONAL KNOWLEDGE OF THE SITE CONDITIONS AND THAT IT WAS PREPARED IN ACCORDANCE WITH THE REQUIREMENTS OF THE HOWARD SOIL CONSERVATION DISTRICT.
 SIGNATURE OF ENGINEER: [Signature] DATE: 10/17/91

DEVELOPER'S CERTIFICATE
 I/WE CERTIFY THAT ALL DEVELOPMENT AND CONSTRUCTION WILL BE DONE ACCORDING TO THIS PLAN OF DEVELOPMENT AND PLAN FOR EROSION AND SEDIMENT CONTROL AND THAT ALL RESPONSIBLE PERSONNEL INVOLVED IN THE CONSTRUCTION PROJECT WILL HAVE A CERTIFICATE OF ATTENDANCE AT A DEPARTMENT OF THE ENVIRONMENT APPROVED TRAINING PROGRAM FOR THE CONTROL OF SEDIMENT AND EROSION BEFORE BEGINNING THE PROJECT. I ALSO AUTHORIZE PERIODIC ONSITE INSPECTION BY THE HOWARD SOIL CONSERVATION DISTRICT OR THEIR AUTHORIZED AGENTS, AS ARE DEEMED NECESSARY.
 SIGNATURE OF DEVELOPER: Ronald Z. Egan DATE: 9-19-91

REVIEWED FOR HOWARD SOIL CONSERVATION DISTRICT AND MEETS TECHNICAL REQUIREMENTS.
 U.S. SOIL CONSERVATION SERVICE DATE: 10/20/91
 THIS DEVELOPMENT IS APPROVED FOR EROSION AND SEDIMENT CONTROL BY THE HOWARD SOIL CONSERVATION DISTRICT.
 APPROVED: [Signature] DATE: 10/20/91
 HOWARD SOIL CONSERVATION DISTRICT

APPROVED: DEPT OF PLANNING AND ZONING
 PLANNING DIRECTOR: [Signature] DATE: 1/31/92
 CHIEF, DIVISION OF COMMUNITY PLANNING AND LAND DEVELOPMENT DATE: 1/30/92

APPROVED: DEPARTMENT OF PUBLIC WORKS FOR PRIVATE WATER & SEWER AND STORM DRAINAGE SYSTEMS AND ROADS.
 DIRECTOR, PUBLIC WORKS: [Signature] DATE: 10/20/91
 CHIEF, BUREAU OF ENGINEERING: [Signature] DATE: 1/24/92

APPROVED: HOWARD COUNTY HEALTH DEPARTMENT FOR PRIVATE WATER AND SEWERAGE SYSTEMS
 HEALTH OFFICER: [Signature] DATE: 1-23-92

SITE DEVELOPMENT PLAN
 SITE IMPROVEMENT
INWOOD VILLAGE CENTER
 RETAIL STORES
 FOURTH ELECTION DISTRICT
 HOWARD COUNTY MARYLAND
 TAX MAP 14 BLOCK 11 PARCEL A
 DATE: OCTOBER 17, 1991
 SHEET 3 OF 7

TRAP DATA NO. 1

1. TYPE = STONE OUTLET
2. DRAINAGE AREA = 1.6 AC.±
3. VOLUME REQUIRED = 107 CU.YD.
4. VOLUME PROVIDED = 253 CU.YD.
5. TOP DIM. = 80' X 99'
6. BOTTOM DIM. = 66' X 87'
7. WEIR CREST ELEVATION = 613.9
8. BOTTOM ELEVATION = 612.0
9. CLEANOUT ELEVATION = 612.70
10. DEPTH = 1.39'
11. 'L' = 20'

TRAP DATA NO. 2

1. TYPE = STORM INLET SEDIMENT TRAP
2. DRAINAGE AREA = 1.2 AC.±
3. VOLUME REQUIRED = 80 CU.YD.
4. VOLUME PROVIDED = 108 CU.YD.
5. TOP DIM. = 60' X 20'
6. BOTTOM DIM. = 54' X 14'
7. WEIR CREST ELEVATION = 618.0
8. BOTTOM ELEVATION = 615.0
9. CLEANOUT ELEVATION = 616.5
10. DEPTH = 3.0'
11. 'L' DIM = 5'

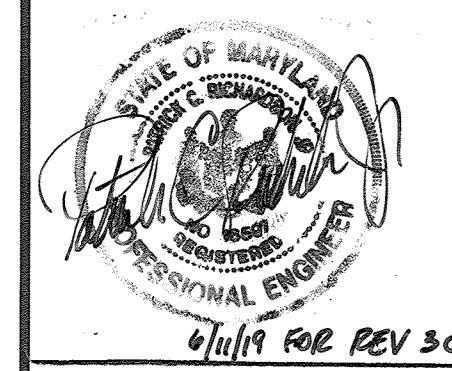
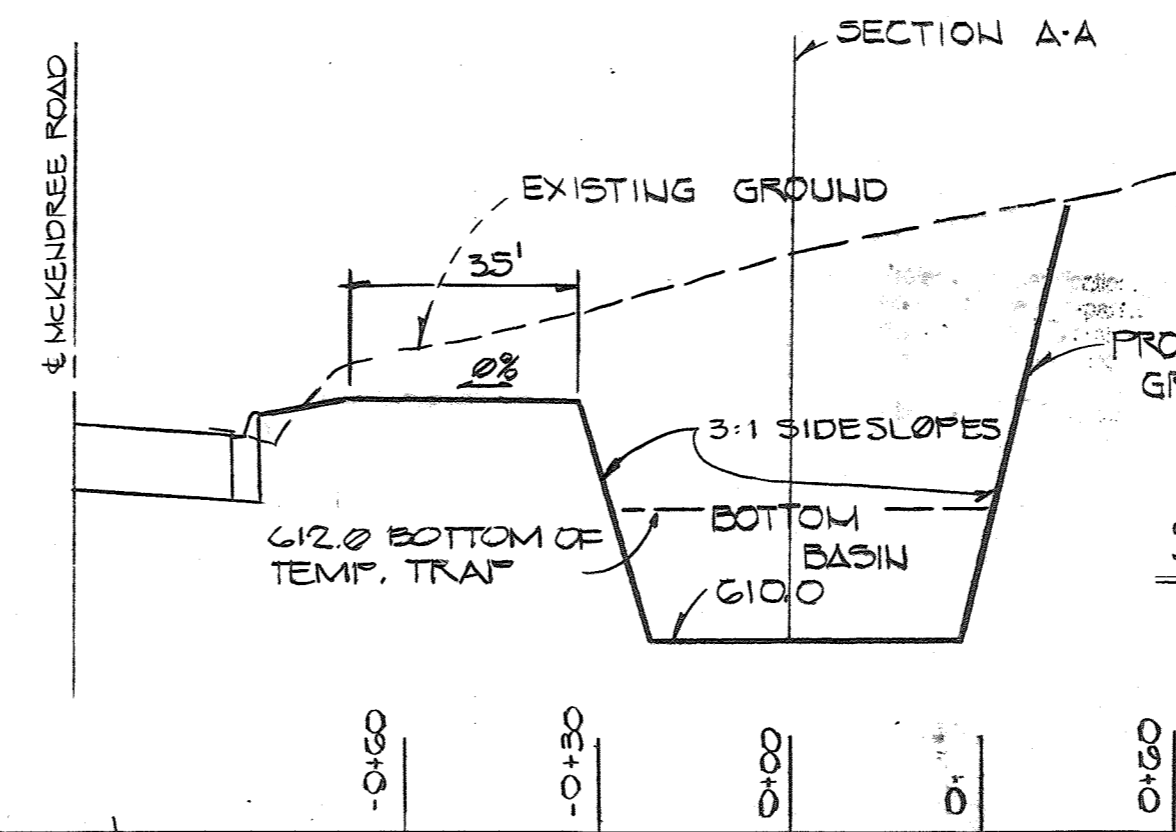
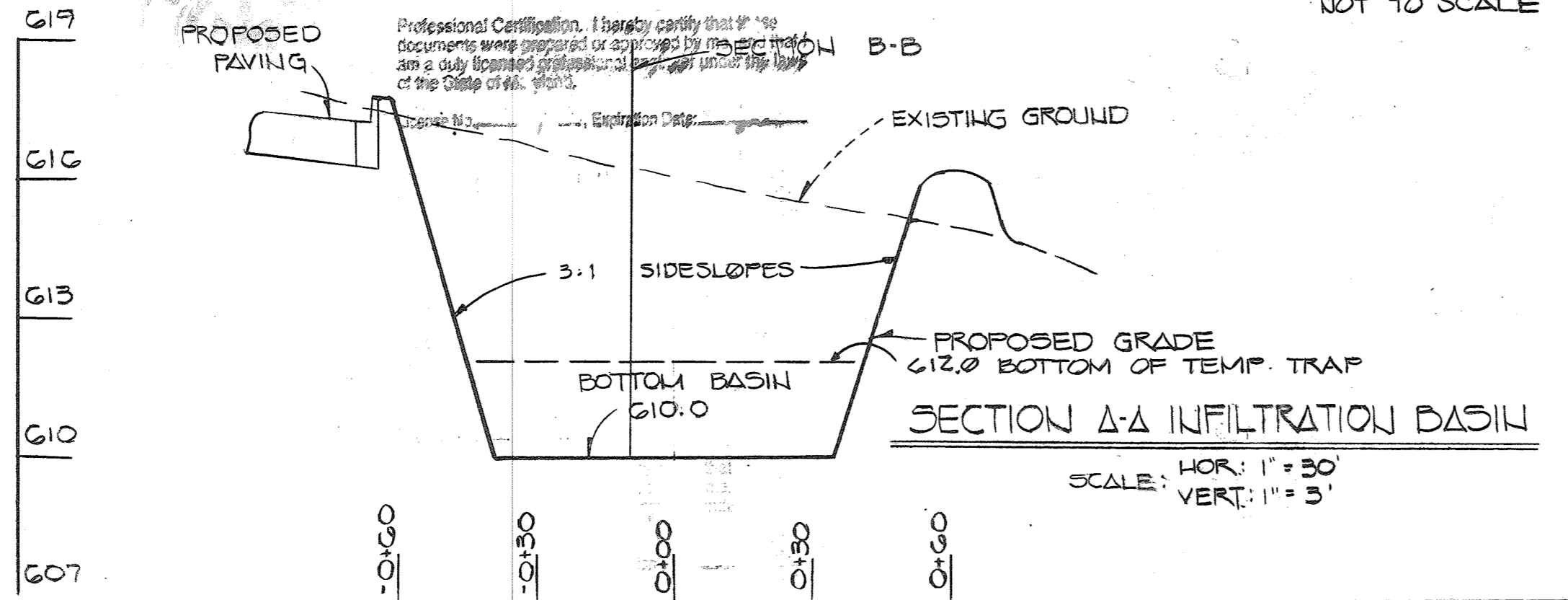
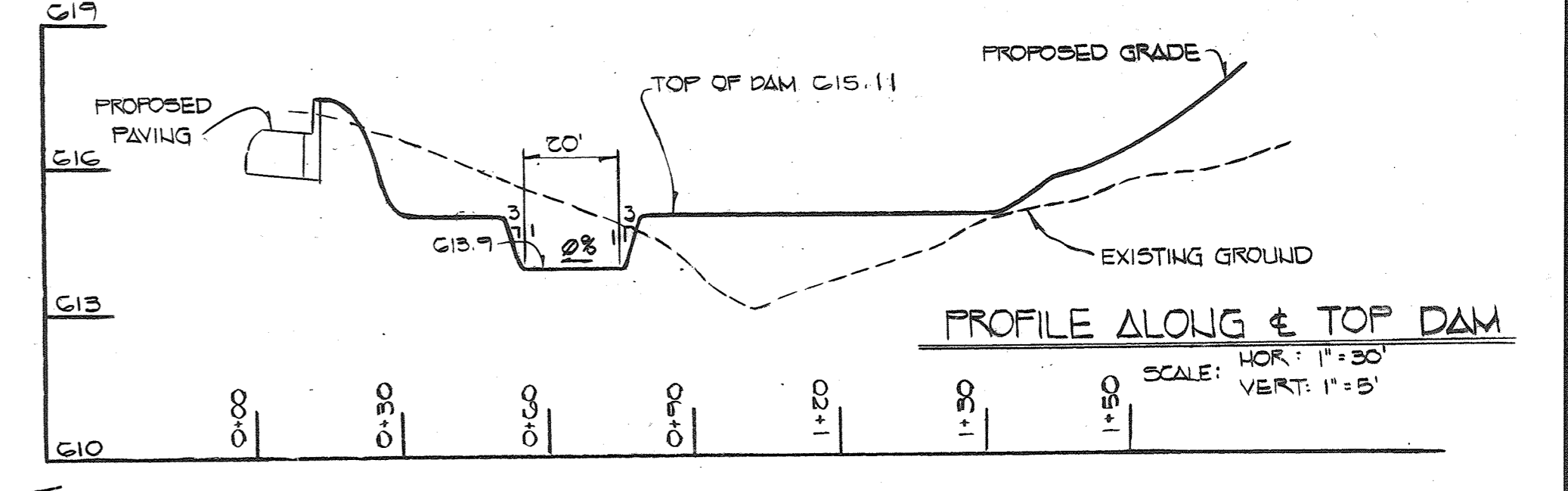
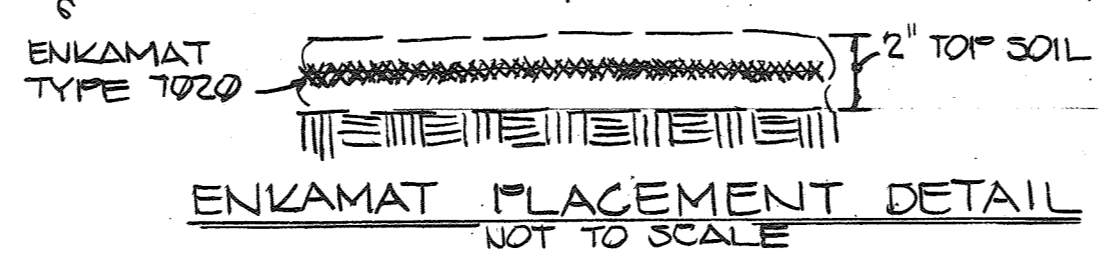
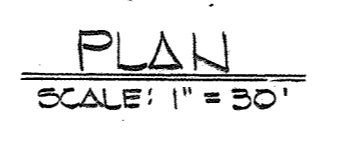
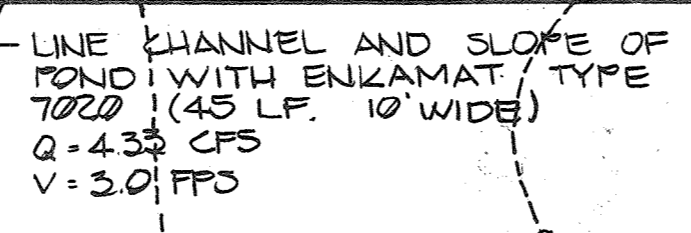
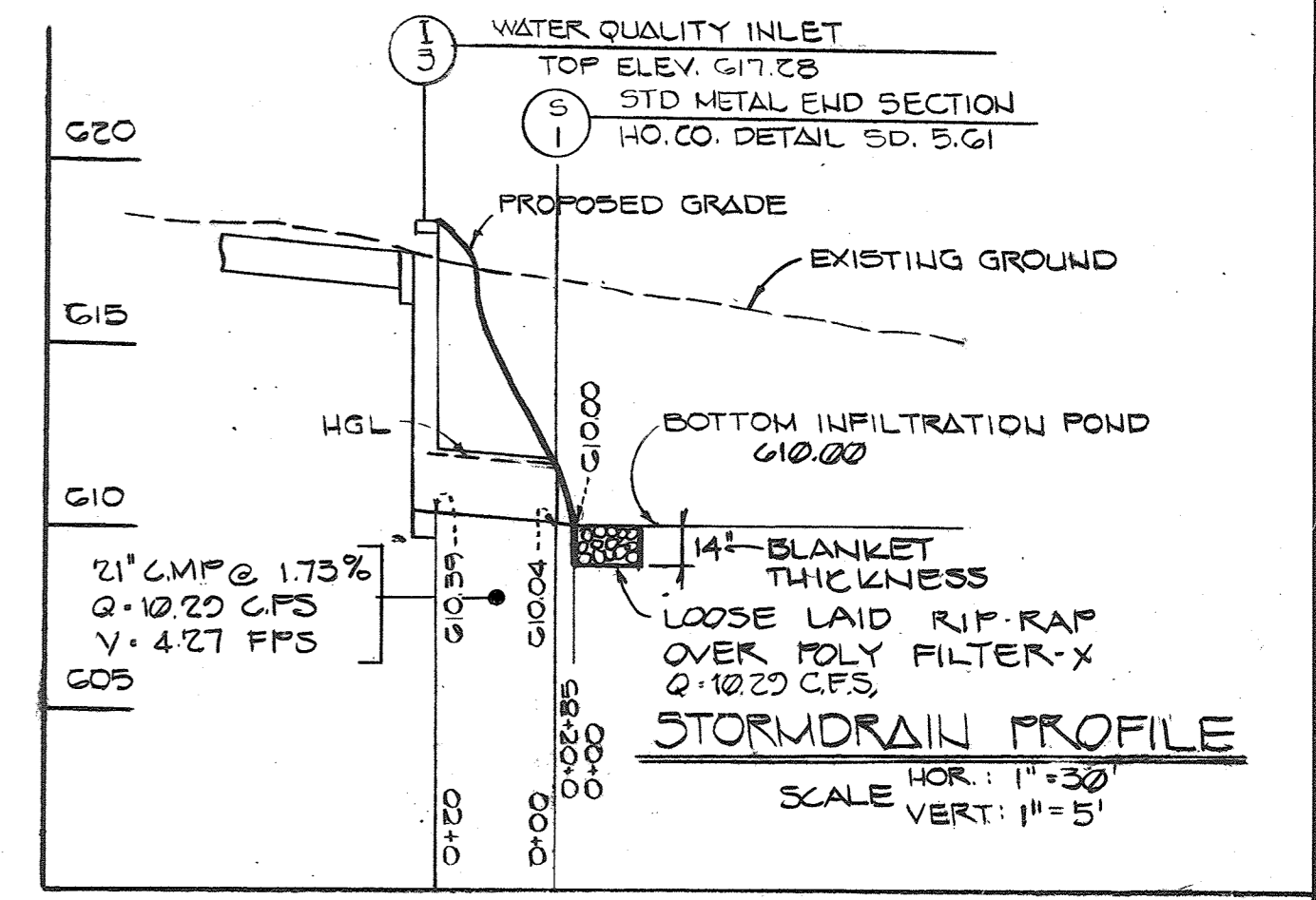
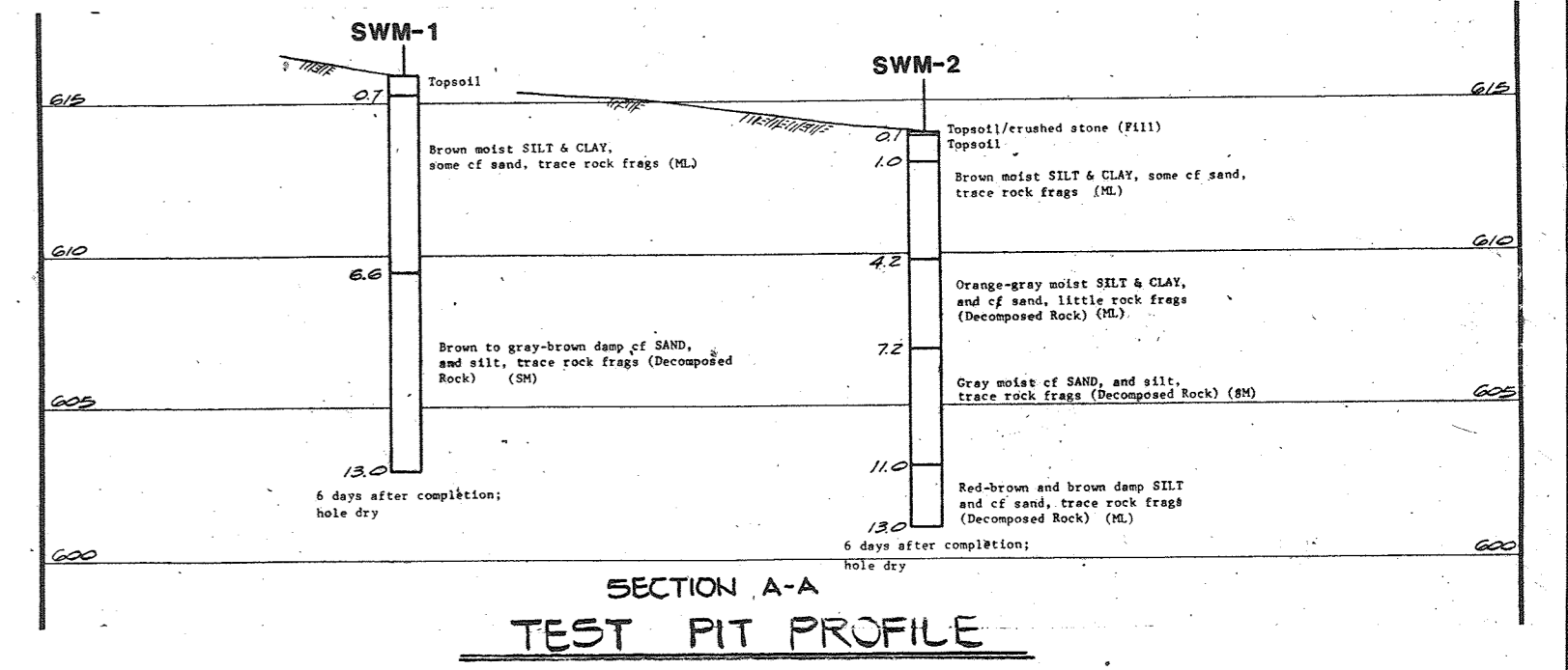
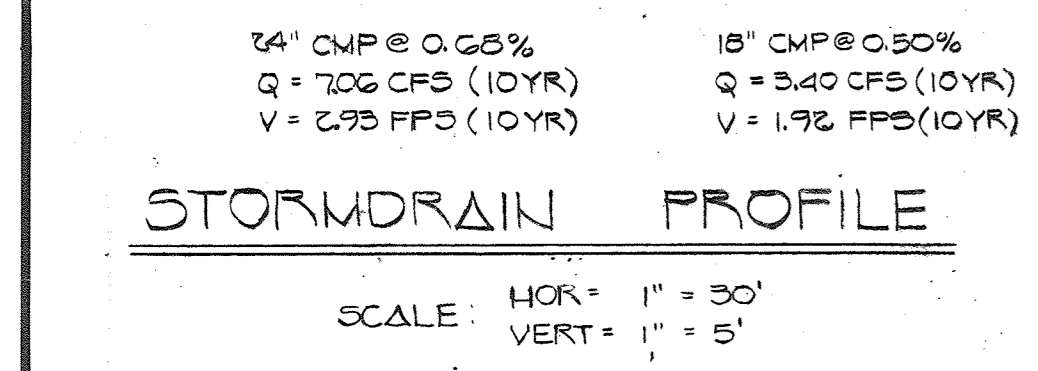
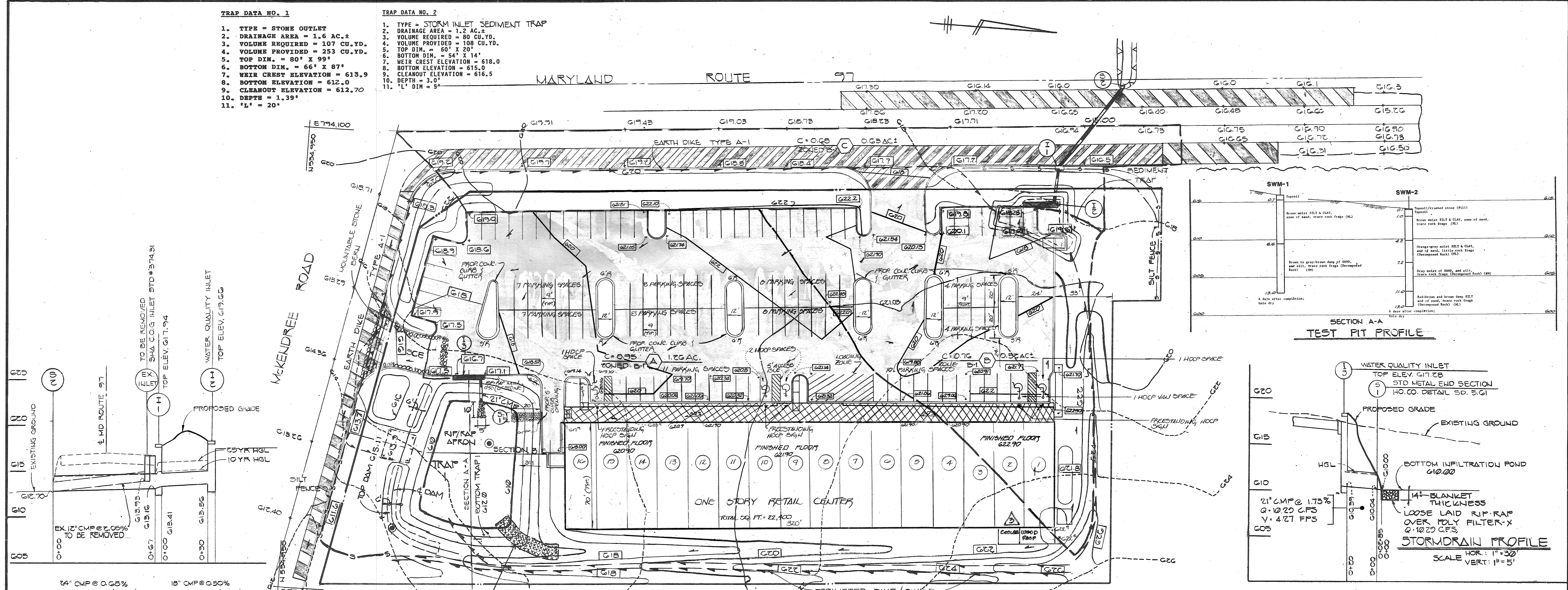

NUMBER	DATE	DESCRIPTION
3	6/11/99	ADD COVER & SAND TRAP
2	3-6-95	REVISE PAVING LOT SPACES AND PROP. GRADE
1	4-22-94	REVISED PER BUREAU OF ENGINEERING SPEED HIGHWAY DATED 4-22-94

ENGINEER'S CERTIFICATE
I HEREBY CERTIFY THAT THIS PLAN FOR EROSION AND SEDIMENT CONTROL REPRESENTS A PRACTICAL AND WORKABLE PLAN BASED ON MY PERSONAL KNOWLEDGE OF THE SITE CONDITIONS AND THAT IT WAS PREPARED IN ACCORDANCE WITH THE REQUIREMENTS OF THE HOWARD SOIL CONSERVATION DISTRICT.

Signature: *Cliff Collins*
DATE: 10/17/91

DEVELOPER'S CERTIFICATE
I HEREBY CERTIFY THAT ALL DEVELOPMENT AND CONSTRUCTION WILL BE DONE ACCORDING TO THIS PLAN OF DEVELOPMENT AND PLAN FOR EROSION AND SEDIMENT CONTROL AND THAT ALL RESPONSIBLE PERSONNEL INVOLVED IN THE CONSTRUCTION PROJECT WILL HAVE A CERTIFICATE OF ATTENDANCE AT A DEPARTMENT OF THE ENVIRONMENT APPROVED TRAINING PROGRAM FOR THE CONTROL OF SEDIMENT AND EROSION BEFORE BEGINNING THE PROJECT. I ALSO AUTHORIZE PERIODIC ONSITE INSPECTION BY THE HOWARD SOIL CONSERVATION DISTRICT OR THEIR AUTHORIZED AGENTS, AS ARE DEEMED NECESSARY.

Signature: *Ronald L. Egan*
DATE: 9-19-91

REVIEWED FOR HOWARD SOIL CONSERVATION DISTRICT AND METS TECHNICAL REQUIREMENTS
Signature: *James M. Dalton*
DATE: 10/28/91
S. SOIL CONSERVATION SERVICE

THIS DEVELOPMENT IS APPROVED FOR EROSION AND SEDIMENT CONTROL BY THE HOWARD SOIL CONSERVATION DISTRICT.
Signature: *Keith W. Holby*
DATE: 10/28/91
HOWARD SOIL CONSERVATION DISTRICT

APPROVED: DEPT OF PLANNING AND ZONING
Signature: *James R. Smith*
DATE: 1/31/92
PLANNING DIRECTOR

Signature: *Anna J. Holman*
DATE: 1/30/92
CHIEF, DIVISION OF COMMUNITY PLANNING AND LAND DEVELOPMENT

APPROVED: HOWARD COUNTY HEALTH DEPARTMENT FOR PRIVATE WATER AND SEWERAGE SYSTEMS
Signature: *James R. Smith*
DATE: 1-23-92
HEALTH OFFICER

APPROVED: DEPARTMENT OF PUBLIC WORKS FOR PRIVATE WATER & SEWER AND STORM DRAINAGE SYSTEMS AND ROADS.
Signature: *James R. Smith*
DATE: 1/24/92
DIRECTOR, PUBLIC WORKS

Signature: *Elizabeth Q. Calver*
DATE: 1/24/92
CHIEF, BUREAU OF ENGINEERING

PROPERTY	SECTION/AREA	PARCEL
INWOOD VILLAGE CENTER	A	
PLAT NO. 2206	ZONE B-1	TAX/ZONE 14
WATER CODE	ELEC. DIST. 4	CENSUS TR. 6040
	SEWER CODE	

OWNER AND DEVELOPER
J.R. ENTERPRISES, INC.
TRIADPHILIA AND TEN OAKS ROAD
P.O. BOX 239
GLENELG, MARYLAND 21737

SEDIMENT AND EROSION CONTROL GRADING PLAN SECTIONS AND PROFILES
INWOOD VILLAGE CENTER
RETAIL STORES

FOURTH ELECTION DISTRICT
HOWARD COUNTY MARYLAND
TAX MAP 14 BLOCK 11 PARCEL A
DATE: OCTOBER 17, 1991

SHEET 4 OF 7
SDP 91-60

PERMANENT SEEDING NOTES:
 APPLY TO GRADED OR CLEARED AREA NOT SUBJECT TO IMMEDIATE FURTHER DISTURBANCE WHERE A PERMANENT LONG-LEVED VEGETATIVE COVER IS NEEDED.

SEEDER PREPARATION: LOOSEN UPPER THREE-INCHES OF SOIL BY RAKING, DISCING OR OTHER ACCEPTABLE MEANS BEFORE SEEDING. IF NOT PREVIOUSLY LOOSENED, SOIL AMENDMENTS: IN LIEU OF SOIL TEST RECOMMENDATIONS, USE ONE OF THE FOLLOWING SCHEDULES:

- PREFERRED: APPLY 2 TONS PER ACRE DOLOMITIC LIMESTONE (92 LBS/1000 SQ. FT.) AND 600 LBS PER ACRE 10-10-10 FERTILIZER (14 LBS/1000 SQ. FT.) BEFORE SEEDING.
- ALTERNATE: APPLY 2 TONS PER ACRE DOLOMITIC LIMESTONE (92 LBS/1000 SQ. FT.) AND 1000 LBS PER ACRE 10-10-10 FERTILIZER (23 LBS/1000 SQ. FT.) BEFORE SEEDING.

SEEDING: FOR PERIODS MARCH 1 THRU APRIL 30 AND AUGUST 1 THRU OCTOBER 15, SEED WITH 60 LBS. PER ACRE (1.4 LBS/1000 SQ. FT.) OF KENTUCKY 31 TALL FESCUE. FOR PERIOD MAY 1 THRU JULY 31, SEED WITH 60 LBS. KENTUCKY 31 TALL FESCUE PER ACRE AND 2 LBS. PER ACRE (0.05 LBS/1000 SQ. FT.) OF WEEPING LOVEGRASS. DURING PERIOD OF OCTOBER 16 THRU FEBRUARY 28, PROJECT SITE BY OPTION (1) 2 TONS PER ACRE OF WELL ANCHORED STRAW MULCH AND SEED AS SOON AS POSSIBLE IN THE SPRING. OPTION (2) USE SOIL. OPTION (3) SEED WITH 60 LBS/ACRE KENTUCKY 31 TALL FESCUE AND MULCH WITH 2 TONS/ACRE WELL ANCHORED STRAW MULCH.

MULCHING: APPLY 1 1/2 TO 2 TONS PER ACRE (70 TO 90 LBS/1000 SQ. FT.) OF UNROTATED SMALL STRAIN STRAW IMMEDIATELY AFTER SEEDING. ANCHOR MULCH IMMEDIATELY AFTER APPLICATION USING MULCH ANCHORING TOOL OR 218 GALLONS PER ACRE (5 GAL/1000 SQ. FT.) OF EMULSIFIED ASPHALT ON FLAT AREAS, ON SLOPES, 8 FT. OR HIGHER, USE 348 GAL PER ACRE (8 GAL/1000 SQ. FT.) FOR ANCHORING.

TEMPORARY SEEDING NOTES:
 APPLY TO GRADED OR CLEARED AREAS TO BE RESTORED WHERE A SHORT-TERM VEGETATIVE COVER IS NEEDED.

SEEDER PREPARATION: LOOSEN UPPER THREE-INCHES OF SOIL BY RAKING, DISCING OR OTHER ACCEPTABLE MEANS BEFORE SEEDING. IF NOT PREVIOUSLY LOOSENED, SOIL AMENDMENTS: APPLY 600 LBS PER ACRE 10-10-10 FERTILIZER (14 LBS/1000 SQ. FT.).

SEEDING: FOR PERIODS MARCH 1 THRU APRIL 30 AND FROM AUGUST 15 THRU NOVEMBER 15, SEED WITH 1 1/2 BUSHEL PER ACRE OF ANNUAL RYE (3.7 LBS/1000 SQ. FT.).

MULCHING: APPLY 1 1/2 TO 2 TONS PER ACRE (70 TO 90 LBS/1000 SQ. FT.) OF UNROTATED SMALL STRAIN STRAW IMMEDIATELY AFTER SEEDING. ANCHOR MULCH IMMEDIATELY AFTER APPLICATION USING MULCH ANCHORING TOOL OR 218 GAL PER ACRE (5 GAL/1000 SQ. FT.) OF EMULSIFIED ASPHALT ON FLAT AREAS, ON SLOPES, 8 FT. OR HIGHER, USE 348 GAL PER ACRE (8 GAL/1000 SQ. FT.) FOR ANCHORING.

REFER TO THE 1983 MARYLAND STANDARDS AND SPECIFICATIONS FOR SOIL EROSION AND SEDIMENT CONTROL FOR RATE AND METHODS NOT COVERED.

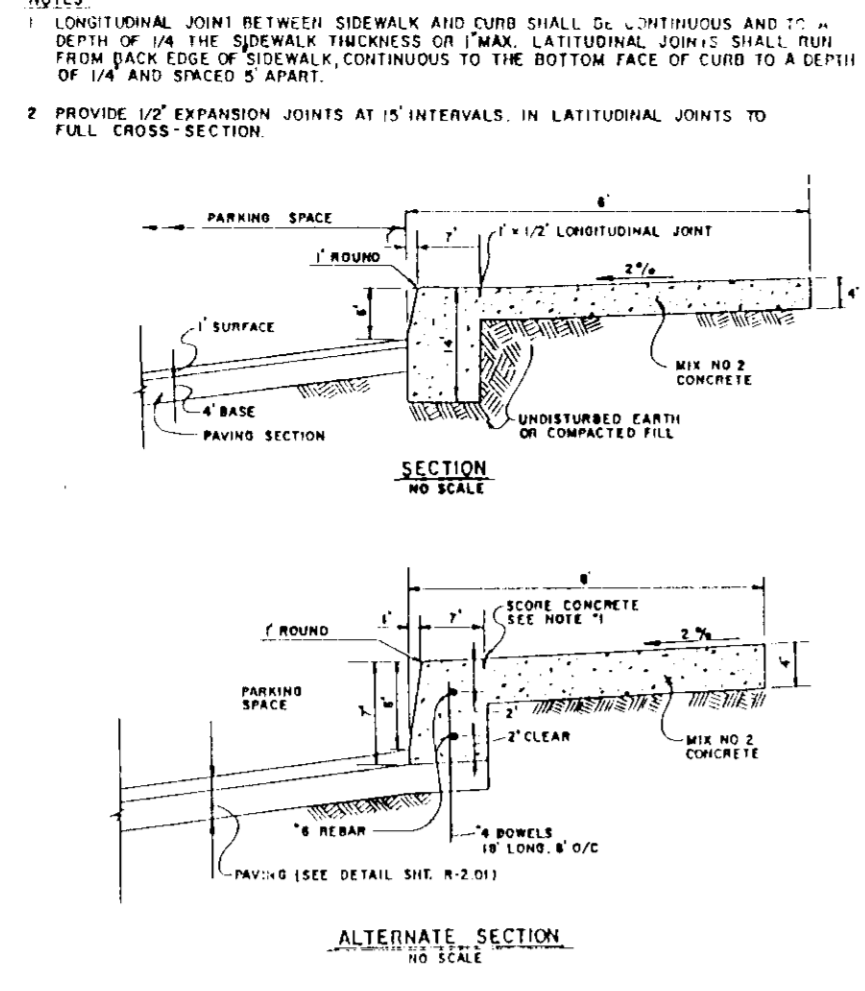

MONOLITHIC CURB AND SIDEWALK DETAIL
 NOT TO SCALE

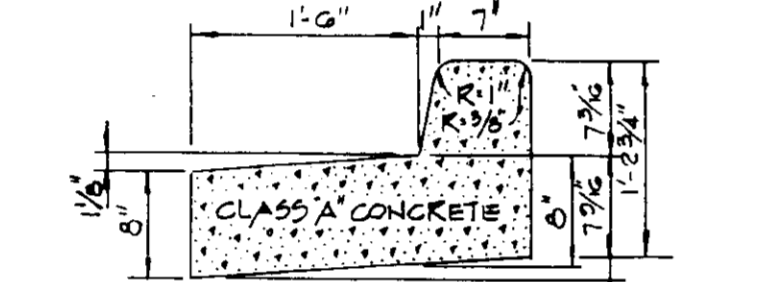
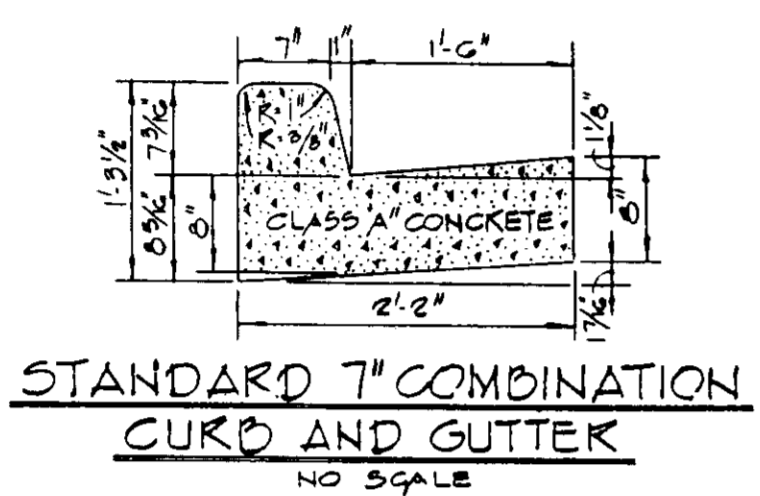

REVERSE 7\"/>

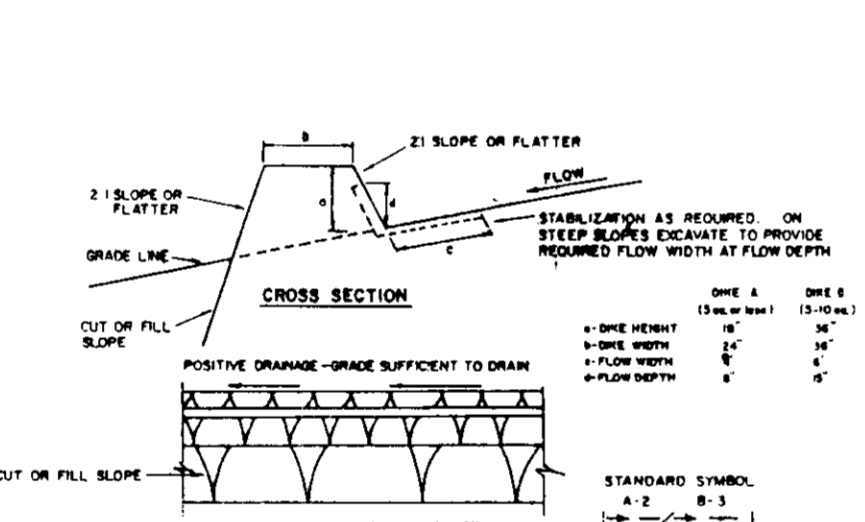

CONSTRUCTION SPECIFICATIONS FOR FLOW CHANNEL STABILIZATION
 NOT TO SCALE

TYPE OF CHANNEL	CHANNEL	DIV. A	DIV. B
1	5.5-10.0	SEED AND STRAW MULCH	SEED AND STRAW MULCH
2	3.15-5.0	SEED AND STRAW MULCH	SEED USING JET OF EXCELLENCE SOIL 2 STONE
3	1.5-3.0	SEED WITH JET, OR SOIL	LINED RIP-RAP 4-8\"/>
4	8.1-20.0	LINED RIP-RAP 4-8\"/>	ENGINEERING DESIGN

A. STONE TO BE 2 INCH STONE, OR RECYCLED CONCRETE EQUIVALENT, IN A LAYER AT LEAST 3 INCHES THICKNESS AND BE PREPARED INTO THE WALL WITH CONSTRUCTION EQUIPMENT. RIP-RAP TO BE 3/4 INCH TO 1 1/2 INCH IN SIZE AND 3 INCH THICKNESS AND PREPARED INTO THE WALL.

C. APPROVED EQUIVALENTS CAN BE SUBSTITUTED FOR ANY OF THE ABOVE MATERIALS. STABILIZATION SHALL BE IN ACCORDANCE WITH FURNISHED SPECIFICATIONS FOR SEED AND STRAW MULCH OR STRAW MULCH IF NOT IN SEEDING SEASON. (B) FLOW CHANNEL AS PER THE CHART BELOW.

EARTH DIKE
 NOT TO SCALE

POSTING OF FIRE LINES ON COMMERCIAL PRIVATE PROPERTY

MARKING - METHOD 1

Where a curb exists along a designated Fire Lane, a red curb with "NO PARKING - FIRE LANE" painted on the entire top and vertical surface of the curb. The painted surface will extend from the full length of the designated Fire Lane. This type of paint is readily obtainable from the Baltimore Paint and Chemical Company or any similar source specializing in fire lane paint. Paint may be applied by roller brush or spray application. Roll-on applications are not recommended.

At each end of the Fire Lane, within the red painted area, the legend, "NO PARKING - FIRE LANE" will be painted in white letters no less than three inches (3") high on top of the curb. This legend will also be repeated along the entire length of the curb at a separation distance of twenty feet (20'). This legend shall also be placed on the vertical face of the curb on 20 foot centers offset by 10 feet vertically. However, in no event, shall there be less than two such markings on the top of curb and one on vertical face.

To aid in the "first time" placement of the "NO PARKING - FIRE LANE" legend on the curb, the Department of Public Works will make stencils available for use by the contractor. A returnable deposit of \$10.00 will be required when stencil is received.

DEPARTMENT OF PUBLIC WORKS
TRAFFIC DIVISION
 GEORGE HOWARD BUILDING
 2430 COURT HOUSE DRIVE
 ELLICOTT CITY, MARYLAND 21043

NOTE:

- Deposits will be held for a maximum of three (3) months.
- Since the painting and stenciling will require annual renewal and since the Department cannot make stencils available for the entire project, it is recommended that Marking Method 2 be used to ensure the presence of adequate full time Public Signs.
- Because of past experiences in obtaining timely annual renewal of the depositing of Fire Lane curbs and therefore effective enforcement, it is strongly recommended that Marking Method 2 be used to ensure the presence of adequate full time Public Signs.

MARKING - METHOD 2

Unless specifically detected by the Fire Administrator, the erection of Fire Lane signs and Tow Away Zone signs shall be at the option of the property owner. When the erection of signs is advised to arrange for the acquisition of their own permanent use stencils.

A. SPECIFICATIONS

- Fire Lane Signs
 - Size - 12" wide x 18" high
 - Alternate when specified:
 - 48" high
 - 24" high
 - Thickness - .080"
 - Material - Aluminum
 - Color - Reflective red letters and border on a reflective white background
 - Lettering - "NO PARKING - FIRE LANE" (1 1/2")

NOTE: The use of international symbol type signs is prohibited.

- Tow Away Zone Signs
 - The authorized sign is designated RT-201 in the Manual on Uniform Traffic Control Devices
 - Size - 12" wide x 6" high
 - Material type and thickness to be same as Fire Lane Signs
 - Color - White letters and border on reflective white background
 - Lettering - "TOW AWAY" (2")

B. PLACEMENT OF SIGNS

- Limits of zones - The enforceable limits of any Fire Lane shall be delineated by the placement of Fire Lane signs at both termination points. If signs are installed, all Fire Lane will require a minimum of two signs.

a) Short Zones (200 feet or less)

Fire Lane signs shall be placed at each end of the marked lane with opposing arrows.

b) Long Zones (in excess of 200 feet)

Fire Lane signs should be spaced approximately 100-150 feet apart but in no case will they be spaced more than a distance of 200 feet apart. All long zones will require a minimum of three signs. When signing "Long Zones", it is recommended that a minimum of double pointing arrow on the middle sign (S) and a single pointing arrow on the end signs indicating the limits of the regulation.

c) Tow Away Zone Sign

The "Tow Away Zone" sign shall be mounted immediately below each Fire Lane sign on the same support. The "Tow Away" sign is necessary to ensure maintaining a clear fire lane.

C. POSITIONING OF SIGNS

- Mounting Techniques
 - It is recommended that Fire Lane and Tow Away signs be mounted on new posts approximately one (1) foot back of curb for best effectiveness. Where applicable, mounting may also be on posts installed in grass areas beyond a sidewalk where such sidewalk does not exceed four (4) feet in width and adjoins the curb. The mounting of signs on the face of buildings is specifically discouraged as being ineffective from an enforcement standpoint and shall not be used in the absence of stenciled curbs.

2. All signs shall be mounted parallel to the Fire Lane curb unless ordered to the contrary.

CONCRETE

Concrete shall be placed from the Office of Fire Administration observing special circumstances which require alternative marking.

Mounting Height

Fire Lane signs shall be mounted at the height of 7 feet on the bottom of the sign. However, slightly lower mounting height may be approved if existing construction conditions so require. No Fire Lane signs shall be mounted so as to interfere with pedestrian movement.

Tow Away Zone Signs

Tow Away Zone signs shall be mounted directly below the Fire Lane sign such that the height is 4 1/2 feet to the bottom of the sign.

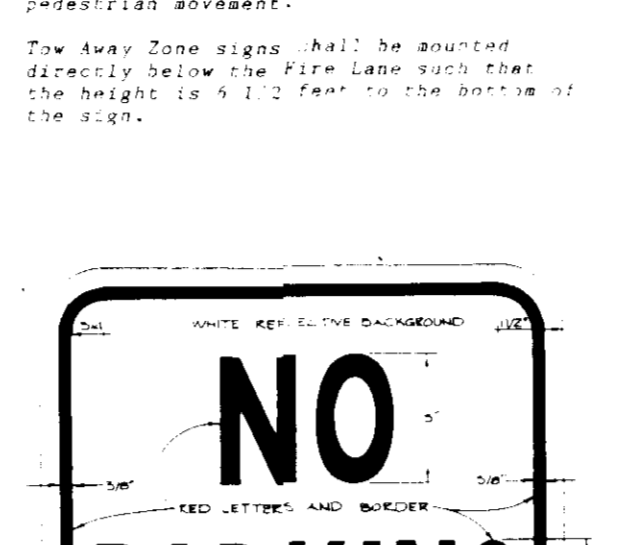

NO PARKING FIRE LANE SIGN DETAIL
 NOT TO SCALE

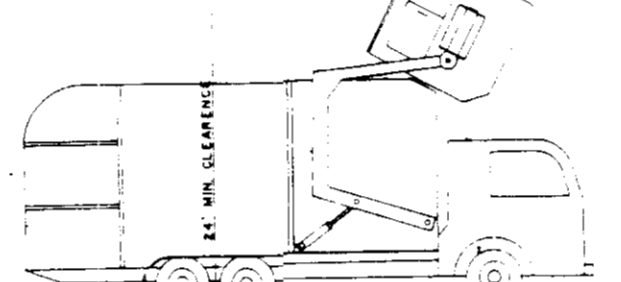

TOW AWAY ZONE SIGN DETAIL
 NOT TO SCALE

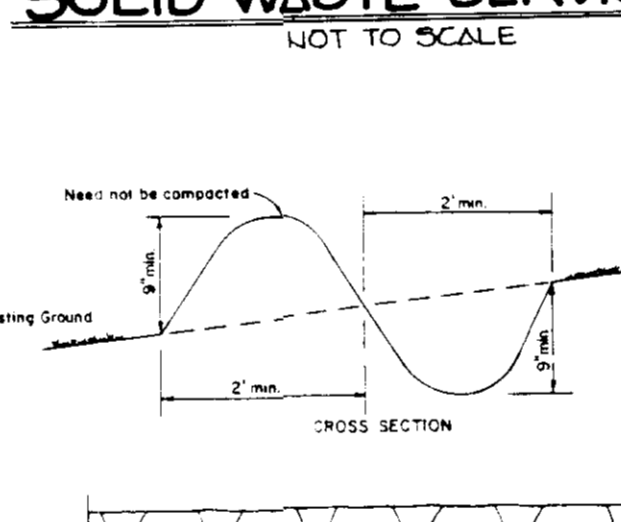

SOLID WASTE SERVICE PAD SIGN DETAIL
 NOT TO SCALE

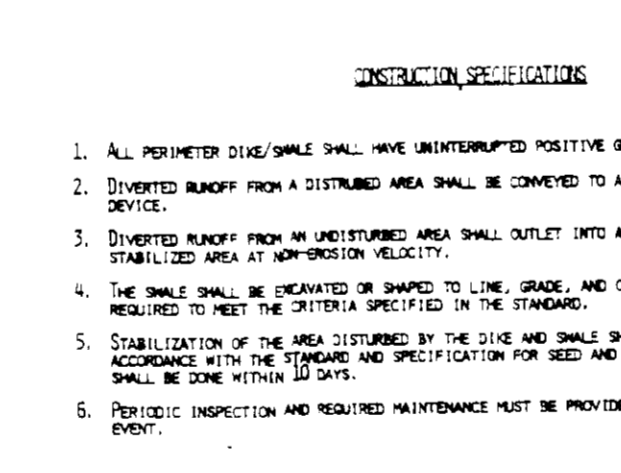

PERIMETER DIKE / SWALE
 NOT TO SCALE

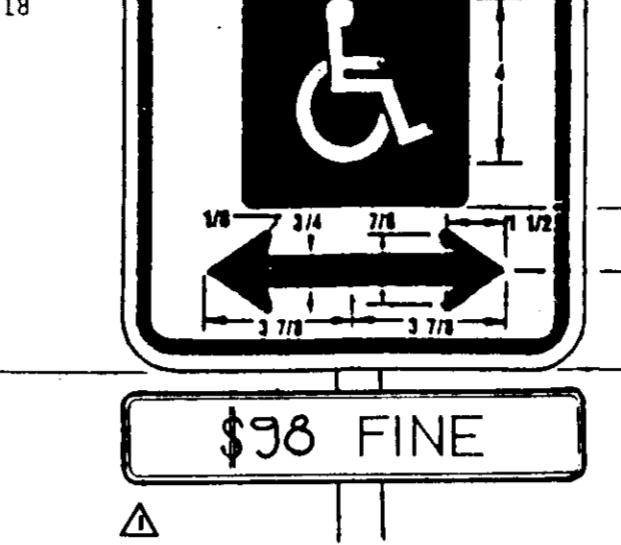
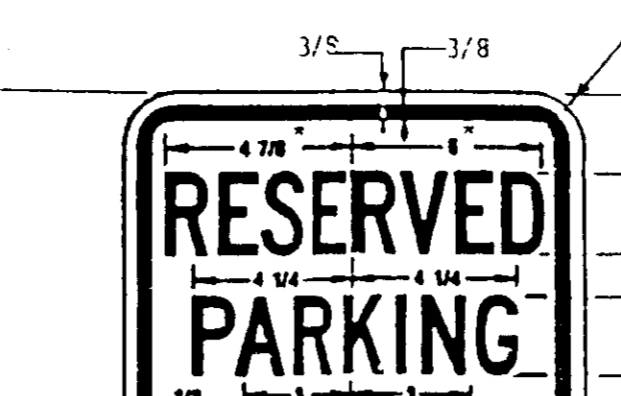

HANDICAPPED PARKING SIGN DETAIL
 NOT TO SCALE

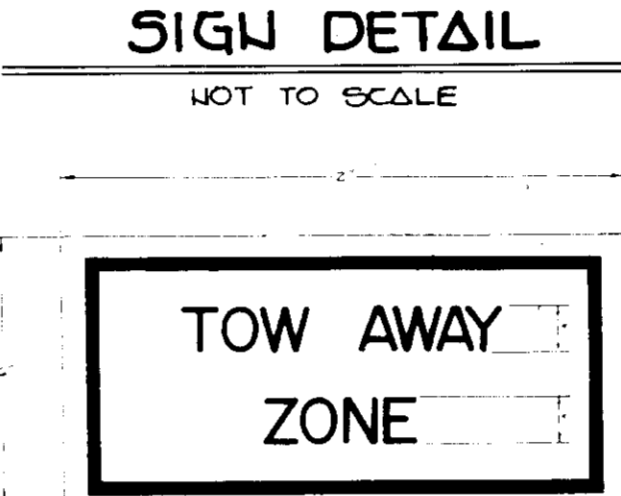

TOW AWAY ZONE SIGN DETAIL
 NOT TO SCALE



SOLID WASTE SERVICE PAD SIGN DETAIL
 NOT TO SCALE

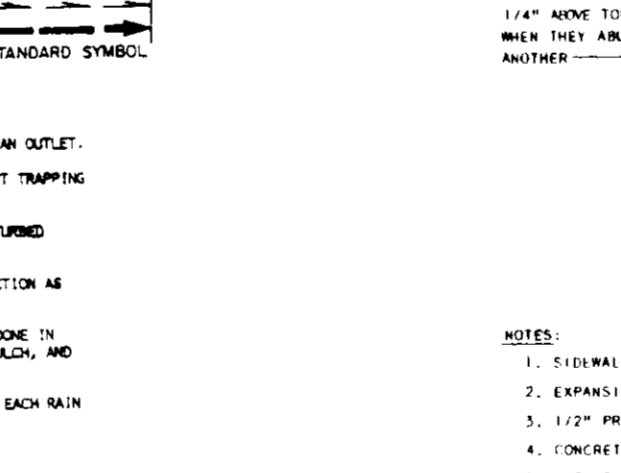

PERIMETER DIKE / SWALE
 NOT TO SCALE

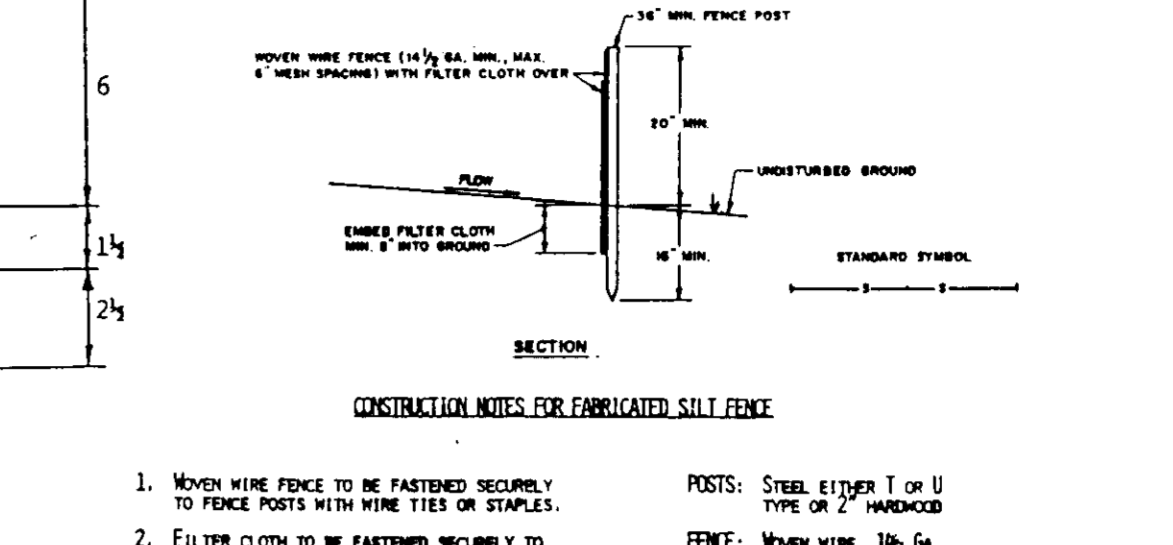
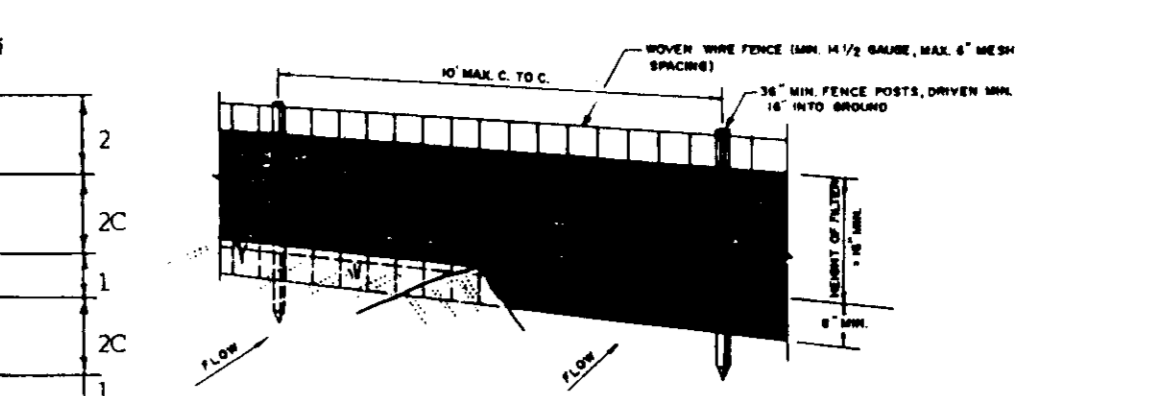

INFILTRATION BASIN CONSTRUCTION SPECIFICATION
 NOT TO SCALE

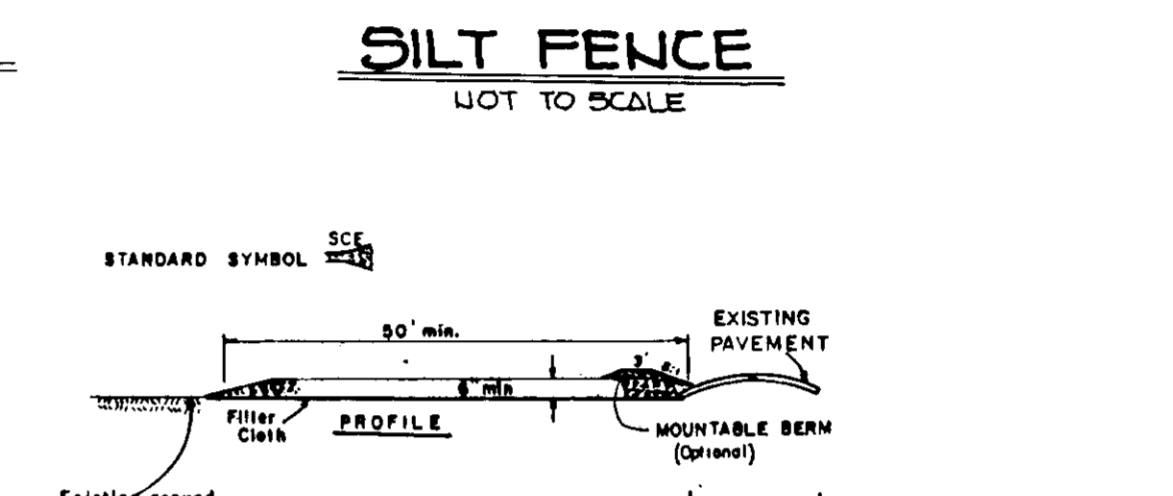

SILT FENCE CONSTRUCTION SPECIFICATION
 NOT TO SCALE

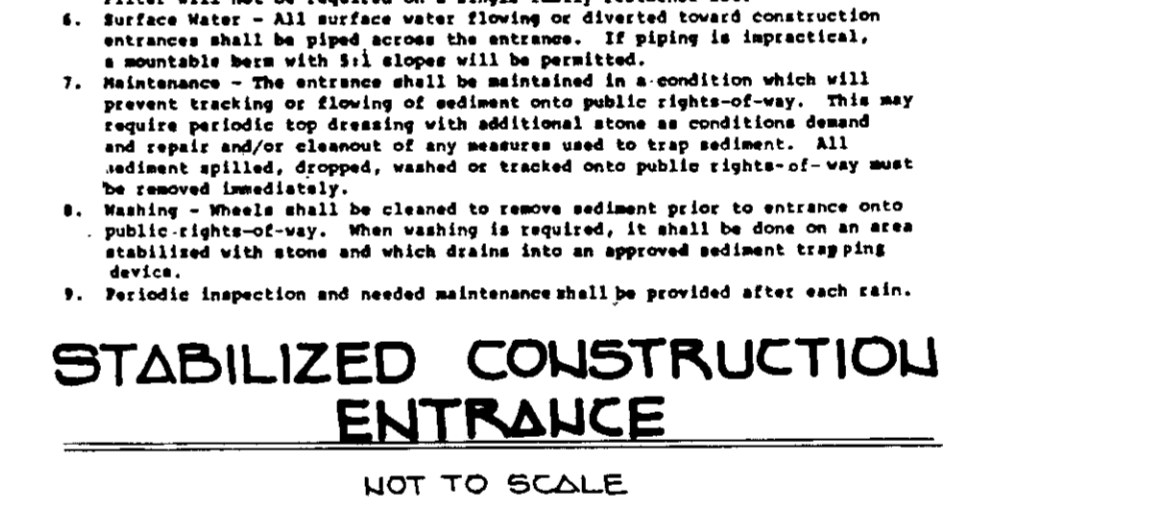

STABILIZED CONSTRUCTION ENTRANCE CONSTRUCTION SPECIFICATION
 NOT TO SCALE

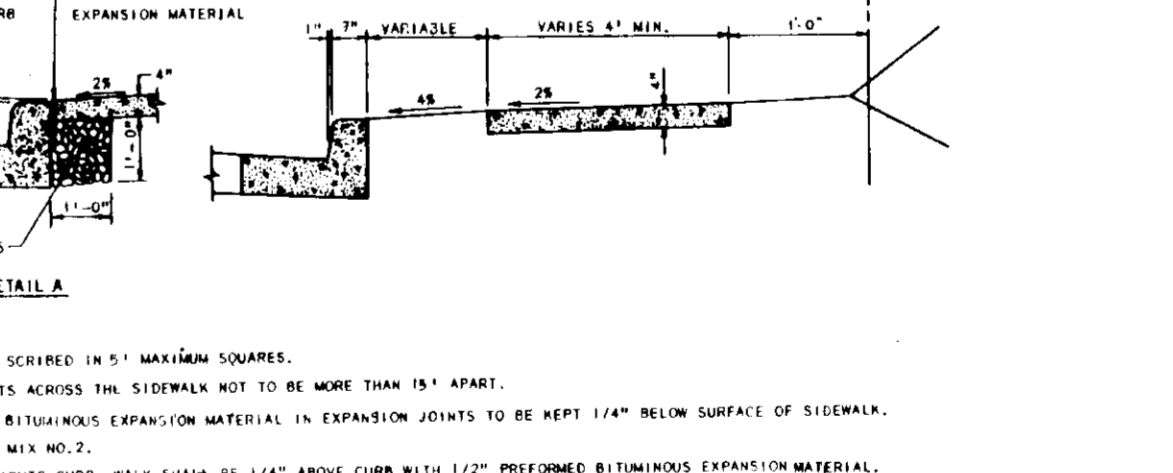

CONCRETE SIDEWALK CONSTRUCTION SPECIFICATION
 NOT TO SCALE

INFILTRATION BASIN CONSTRUCTION SPECIFICATION

The construction of all infiltration basins shall comply with the criteria set forth in the Maryland SCS Standards and Specifications 176-Fonda dated July, 1981 or subsequent revisions and the additional criteria provided below.

Schedule

The sequence of various phases of basin construction shall be coordinated with the overall project construction schedule. A program shall schedule through excavation of the basin floor to the finished grade should be permitted use of the material as fill in another area. The partially excavated basin shall serve as a sedimentation basin in order to assist in erosion and sediment control during construction. However, basins near final stages of excavation should never be used practically for runoff drainage. Drainage from untreated, freshly compacted soil and the weathered area of the newly formed basin with a heavy concentration of fine sediment. This could seriously impact the natural infiltration characteristics of the basin floor. Final grade of an infiltration basin shall not be attained until after the use as a sediment control basin is completed.

Specifications for basin construction should state: (1) the earliest point in progress when storm drainage may be directed to the basin, and (2) the means by which this delay in use is to be accomplished. Due to the wide variety of conditions encountered among projects, each should be separately evaluated in order to propose use as long as it is reasonably possible.

Excavation

Initial basin excavation should be carried to within 1 foot of the final elevation of the basin floor. Final excavation to the finished grade should be deferred until all disturbed areas on the watershed have been stabilized or protected. The final phase excavation should remove all accumulated sediment. Relatively light tracked equipment is recommended for this operation to avoid compaction of the basin floor. After the final grading is completed, the basin floor should be evenly tilled by the use of rotary tillage or disc harrow to provide a well-graded, highly porous surface texture.

Lining Material

Infiltration basins may be lined with a 6- to 12-inch layer of filter material such as coarse sand to help prevent the buildup of objectionable deposits on the soil surface. The filter layer may be replaced or cleaned when it becomes clogged with sediment. The filter material is recommended to be specified for disking (such as hula, leaves, stems, etc.) or applying into the basin floor to increase the permeability of the soil. The basin floor should be seeded or mulched for a brief period, then allowed to decay subsequent to this operation. This induces the organic material to decay rapidly, loosening the upper soil layer.

Establishing dense vegetation on the basin side slopes and floor is recommended. A dense vegetative stand will not only prevent erosion and sloughing, but will also provide a natural means of maintaining relatively high infiltration rates. Erosion protection and sediment control materials should also be provided. Removal of accumulated sediment is a problem only at the basin floor. Little maintenance is normally required to maintain the infiltration capacity of slope areas.

Maintenance

Selection of suitable vegetative materials for the side slope and all other areas to be stabilized with vegetation and application of required fertilizer and mulches shall be done in accordance with the Maryland Standards and Specifications for Soil Erosion and Sediment Control. Local Extension Agencies should also be consulted.

Inspection Schedule

Drainage systems must be inspected on a routine basis to ensure that they are functioning properly. Inspections can be on a semi-annual basis but should always be conducted following major storms.

Sediment Control Effect on Vegetated Basins

Cleanout frequency of infiltration basins will depend on whether they are vegetated or nonvegetated and will be a function of their storage capacity, storage characteristics, inflow, and sediment load. Vegetated basins should be inspected at least once a year. Sedimentation basins and traps may require more frequent inspection and cleanout.

Sediment Removal from Nonvegetated Basins

Grass bottoms on infiltration basins seldom need replacement since grass serves as good filter material. It is particularly true of Kentucky 31 Tall Fescue, which is extremely hardy and can withstand several days of submergence. If silty water is allowed to trickle through the curb, most of the suspended material is retained until it reaches the basin floor. Well established turf on a basin floor will grow up through sediment deposits, forming a porous turf and preventing the formation of an impermeable barrier. Grass filtration will work well with long, narrow, shoulder-type (tweezer-like) depressions where highway runoff flows down a grassy slope between the roadway and the basin. Kentucky 31 Tall Fescue demands very little attention and looks attractive when trimmed. Grass planted on basin side slopes will also prevent erosion.

Inspection Schedule

(a) **Technique:** Sediment removal should be done on the basin floor is completely dry, and the silt layer has subsided and separated from the basin floor. Equipment maneuverability and precise blade control are essential in small areas and can greatly reduce the quantity of material to be removed.

(b) **Frequency:** All sediment must be removed prior to tilling operations. An tilling is required periodically and at least once annually. The frequency of sediment removal will be reduced to meet operation on a regular basis.

Tilling of Nonvegetated Basin Floor

In all cases, tilling must be preceded by thorough removal of surface sediment as previously above.

(a) **Purpose:** It is necessary to restore the natural infiltration capacity by overcoming the effects of surface compaction, and to control weed growth on the Basin Floor.

(b) **Technique:** Rotary tillers or disc harrow will normally serve this purpose. Light tractors should be employed for these operations. In the event that heavy equipment has caused deeper than normal compaction of the surface, these operations should be preceded by deep plowing. In the final condition after tilling, the basin floor should be level, smooth, and free of ridges and furrows to ease future removal of sediment and mulch. The material to be removed during future cleaning operations. A leveling drag, towed behind the equipment on the last pass, will accomplish this.

(c) **Frequency:** In the spring, the basin surface is usually quite porous due to the effects of frost and subsequent thawing. The infiltration capacity diminishes rapidly thereafter. To enhance infiltration capacity, tilling should be thorough each season, from late June through September. To control weed growth, an additional tilling may be desirable during the growing season. Precautions must be observed, however, to avoid any possibility of soil erosion. Sediment removal should be done on a regular basis.

Side Slope Maintenance

(a) **Purpose:** To promote a dense turf with extensive root growth, thereby reducing infiltration through the slope surface and prevent weeds from gradually taking over the slope areas.

(b) **Frequency:** Grasses of the fescue family are recommended for seeding primarily due to their adaptability to dry sandy soils, drought resistance, hardiness, and ability to withstand brief inundations. The use of fescues will also permit long intervals between mowings. This is important due to the relatively steep slopes which make mowing difficult. Mowing once a year, once in June and again in September, is sufficient to maintain adequate light cultivation for the purpose of weed control. It is therefore advised again that any cultivation or tilling operation be preceded in all cases by careful sediment removal.

SEQUENCE OF CONSTRUCTION

- OBTAIN GRADING PERMIT.
- INSTALL TEMPORARY ERECTION AT 1-2, INSTALL STORM DRAIN SYSTEM BETWEEN 1-2 TO 3-2, INSTALL TRAP 2.
- INSTALL STABILIZED CONSTRUCTION ENTRANCE, SILT FENCE, PERIMETER DIKE/SWALE AND BAYTS DICE.
- BASED OR REMOVE ALL STRUCTURES ON SITE.
- BACKFILL OR REMOVE ALL EXISTING FOUNDATIONS.
- BACKFILL OR REMOVE ALL PRIVATE SEWERAGE DISPOSAL SYSTEMS.
- COLLAPSE BACKFILL AND CAP ALL PRIVATE WELLS.
- CLEAR AND GRUB SITE.
- CONSTRUCT PRIVATE STORM DRAIN.
- CONSTRUCT BUILDING.
- CONSTRUCT CURB, SIDEWALK AND GUTTER.
- REMOVE STABILIZED CONSTRUCTION ENTRANCE AND INSTALL BARE COURSE.
- INSTALL LANDSCAPING.
- PERFORM SITE AND PERMANENTLY STABILIZE ALL UPLAND AREAS. COMPLETE STABILIZATION OF ALL DISTURBED UPLAND AREAS WILL BE DONE PRIOR TO COMPLETION OF PERMIT TRAPS TO EITHER INFILTRATION BASIN OR PERMANENT STORMDRAIN SYSTEMS.
- CLEAR BARE COURSE AND APPLY FACE COAT, LAY SURFACE COURSE.
- CONVERT TRAP 2 AND TEMPORARY TRAP TO WATER QUALITY STRUCTURE I-2 AFTER PERMISSION IS GRANTED BY SEDIMENT CONTROL INSPECTOR.
- CONVERT TRAP 1 TO PERMANENT INFILTRATION BASIN (BOTTOM ELEVATION 610.0) AFTER PERMISSION IS GRANTED BY SEDIMENT CONTROL INSPECTOR.
- REMOVE ALL OTHER SEDIMENT CONTROL DEVICES AFTER PERMISSION IS GRANTED BY SEDIMENT CONTROL INSPECTOR.

NO.	DATE	REVISION
1	3-2-95	REVISE HIGHWAY #90 TO #70

ENGINEER'S CERTIFICATE

I HEREBY CERTIFY THAT THIS PLAN FOR EROSION AND SEDIMENT CONTROL REPRESENTS A PRACTICAL AND WORKABLE PLAN BASED ON MY PERSONAL KNOWLEDGE OF THE SITE CONDITIONS AND THAT IT WAS PREPARED IN ACCORDANCE WITH THE REQUIREMENTS OF THE HOWARD SOIL CONSERVATION DISTRICT.

FISHER, COLLINS & CARTER, INC.
 CIVIL ENGINEERS & LAND SURVEYORS
 SUITE 100, 9171 BALTIMORE NATIONAL PIKE
 ELLICOTT CITY, MARYLAND 21043
 (301) 461-2855

Signature of Engineer: *Chad Carter*
 Date: 10/17/91

DEVELOPER'S CERTIFICATE

I/WE CERTIFY THAT ALL DEVELOPMENT AND CONSTRUCTION WILL BE DONE ACCORDING TO THIS PLAN OF DEVELOPMENT AND PLAN FOR EROSION AND SEDIMENT CONTROL AND THAT ALL RESPONSIBLE PERSONNEL INVOLVED IN THE CONSTRUCTION PROJECT HAVE A CERTIFICATE OF ATTENDANCE AT A DEPARTMENT OF THE ENVIRONMENT APPROVED TRAINING PROGRAM FOR THE CONTROL OF SEDIMENT AND EROSION BEFORE BEGINNING THE PROJECT. I ALSO AUTHORIZE PERIODIC CONSTRUCTION INSPECTIONS BY HOWARD SOIL CONSERVATION DISTRICT OR THEIR AUTHORIZED AGENTS, AS ARE DEEMED NECESSARY.

Signature of Developer: *Ronald E. Egan*
 Date: 9-19-91

APPROVED FOR HOWARD SOIL CONSERVATION DISTRICT AND MEETS TECHNICAL REQUIREMENTS

Signature: *James H. Hester*
 Date: 10/26/91

Signature: *Clifford W. Hill*
 Date: 10/28/91

APPROVED: DEPT. OF PLANNING AND ZONING

Signature: *James Hester*
 Date: 1/31/92

Signature: *Anna Hester*
 Date: 1/30/92

Signature: *James Hester*
 Date: 8/30

APPROVED: HOWARD COUNTY HEALTH DEPARTMENT FOR PRIVATE WATER AND SEWERAGE SYSTEMS

Signature: *James Hester*
 Date: 1-23-92

APPROVED: DEPARTMENT OF PUBLIC WORKS FOR PRIVATE WATER & SEWER AND STORM DRAINAGE SYSTEMS AND ROADS.

Signature: *Elizabeth A. Galca*
 Date: 1/29/92

PROPERTY/SUBDIVISION: INWOOD VILLAGE CENTER

SECTION/AREA: A

PARCEL: A

PLAT NO: 0006

BLOCK NO: 11

ZONE: D-1

ELEC. DIST.: 14

CENSUS TR.: G040

WATER CODE:

SEWER CODE:

SITE DEVELOPMENT PLAN

NOTES AND DETAILS

INWOOD VILLAGE CENTER

RETAIL STORES

FOURTH ELECTION DISTRICT
 HOWARD COUNTY MARYLAND
 TAX MAP 14 BLOCK 11 PARCEL A
 DATE: OCTOBER 17, 1991

SHEET 5 OF 7

OWNER AND DEVELOPER
 J.R. ENTERPRISES, INC.
 TRIADELPHIA AND TEN OAKS ROAD
 P.O. BOX 239
 GLENELG, MARYLAND
 21737

Professional Engineer Seal for Elizabeth A. Galca, State of Maryland, License No. 10313.

Professional Engineer Seal for James Hester, State of Maryland, License No. 10313.

Professional Engineer Seal for Clifford W. Hill, State of Maryland, License No. 10313.

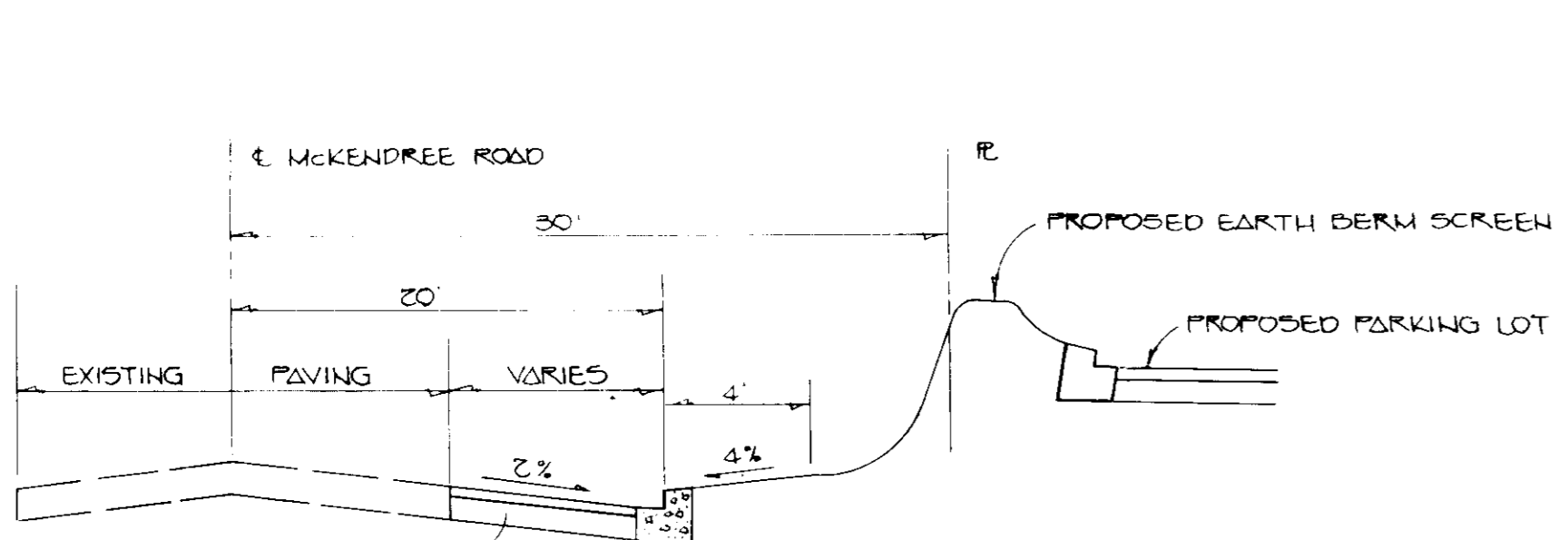

TYPICAL WIDENING SECTION ALONG
MCKENDREE ROAD
NOT TO SCALE

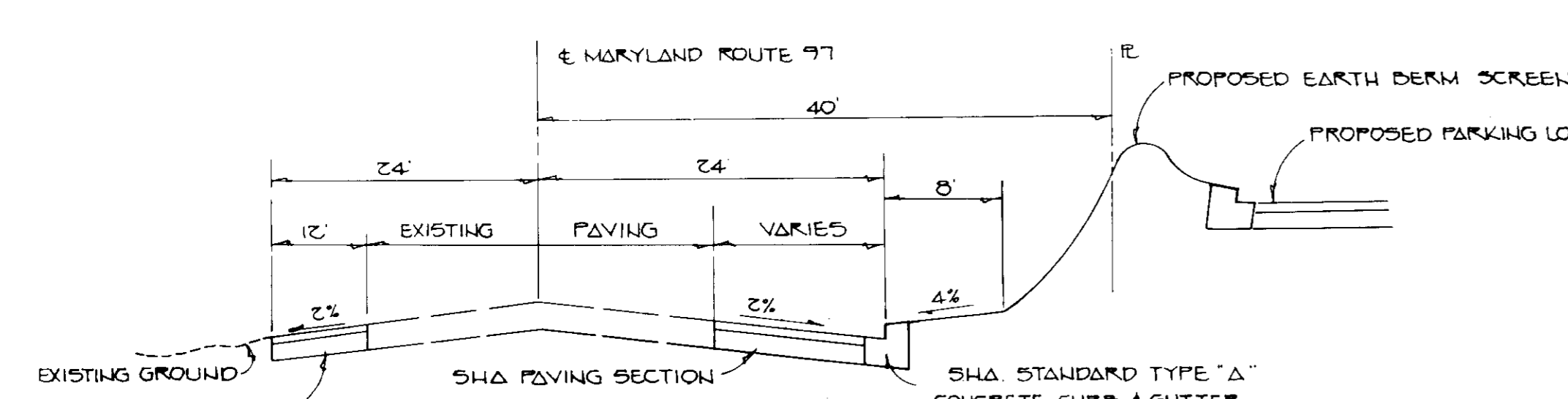

TYPICAL WIDENING SECTION ALONG
MARYLAND ROUTE 97
NOT TO SCALE

S.H.A.
TYPICAL PAVING SECTION
3" BITUMINOUS CONCRETE SURFACE
(2 1/2" COURSES)
4" BITUMINOUS CONCRETE BASE
6" BASE COURSE USING GRADED AGGREGATE
GA BASE

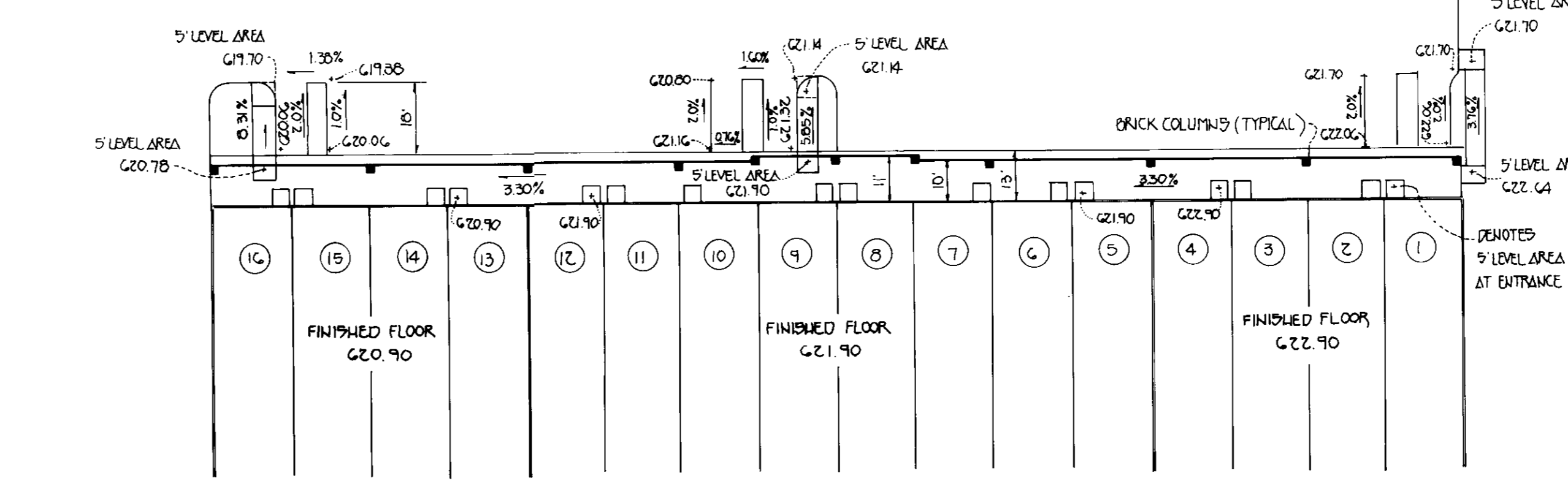

PLAN
SCALE: 1" = 30'
SIDEWALK DETAIL
INWOOD VILLAGE CENTER

- STANDARD SEDIMENT CONTROL NOTES:
- A MINIMUM OF 24 HOURS NOTICE MUST BE GIVEN TO THE HOWARD COUNTY OFFICE OF INSPECTIONS AND PERMITS PRIOR TO THE START OR COMPLETION OF ANY CONSTRUCTION (892-2437).
 - ALL VEGETATIVE AND STRUCTURAL PRACTICES ARE TO BE INSTALLED ACCORDING TO THE PROVISIONS OF THIS PLAN AND ARE TO BE IN CONFORMANCE WITH THE 1983 MARYLAND STANDARDS AND SPECIFICATIONS FOR SOIL EROSION AND SEDIMENT CONTROL.
 - FOLLOWING INITIAL SOIL DISTURBANCE OR RESTORATION, PERMANENT OR TEMPORARY STABILIZATION SHALL BE COMPLETED WITHIN: a) 7 CALENDAR DAYS FOR ALL PERIMETER SEDIMENT CONTROL STRUCTURES, DIKES, PERIMETER SLOPES AND ALL SLOPES GREATER THAN 3:1; b) 14 DAYS AS TO ALL OTHER DISTURBED OR GRADED AREAS ON THE PROJECT SITE.
 - ALL SEDIMENT TRAPS/BASINS SHOWN MUST BE FENCED AND WARNING SIGNS POSTED AROUND THEIR PERIMETER IN ACCORDANCE WITH VOL. 1, CHAPTER 12, OF THE HOWARD COUNTY DESIGN MANUAL, STORM DRAINAGE. ALL DISTURBED AREAS MUST BE STABILIZED WITHIN THE TIME PERIOD SPECIFIED ABOVE IN ACCORDANCE WITH THE 1983 MARYLAND STANDARDS AND SPECIFICATIONS FOR SOIL EROSION AND SEDIMENT CONTROL FOR PERMANENT SEEDINGS (SEC. 51) SOIL (SEC. 54), TEMPORARY SEEDING (SEC. 50) AND MULCHING (SEC. 52). TEMPORARY STABILIZATION WITH MULCH ALONE CAN ONLY BE DONE WHEN RECOMMENDED SEEDING DATES DO NOT ALLOW FOR PROPER GERMINATION AND ESTABLISHMENT OF GRASSES.
 - ALL SEDIMENT CONTROL STRUCTURES ARE TO REMAIN IN PLACE AND ARE TO BE MAINTAINED IN OPERATIVE CONDITION UNTIL PERMISSSION FOR THEIR REMOVAL HAS BEEN OBTAINED FROM THE HOWARD COUNTY SEDIMENT CONTROL INSPECTOR.
 - SITE ANALYSIS:

TOTAL AREA OF SITE	2.70 ACRES
AREA TO BE ROOFED OR PAVED	1.00 ACRES
AREA TO BE VEGETATIVELY STABILIZED	1.70 ACRES
TOTAL CUT	2000 CU. YDS.
TOTAL FILL	2000 CU. YDS.
OFFSITE WASTE/BORROW AREA LOCATION	CU. YDS.
 - ANY SEDIMENT CONTROL PRACTICE WHICH IS DISTURBED BY GRADING ACTIVITY FOR PLACEMENT OF UTILITIES MUST BE REPAIRED ON THE SAME DAY OF DISTURBANCE.
 - ADDITIONAL SEDIMENT CONTROLS MUST BE PROVIDED, IF DEEMED NECESSARY BY THE HOWARD COUNTY DPM SEDIMENT CONTROL INSPECTOR, ON ANY SITES WITH DISTURBED AREAS IN EXCESS OF 2 ACRES. APPROVAL OF THE INSPECTION AGENCY SHALL BE REQUESTED UPON COMPLETION OF PERIMETER EROSION AND SEDIMENT CONTROL STRUCTURES, BUT BEFORE PROCEEDING WITH ANY OTHER EARTH DISTURBANCE OR GRADING. OTHER BUILDING OR GRADING INSPECTION APPROVALS MAY NOT BE AUTHORIZED UNTIL THIS INITIAL APPROVAL BY THE INSPECTION AGENCY IS MADE.
 - THE CONTRACTOR SHALL INSPECT AND PROVIDE NECESSARY MAINTENANCE ON THE SEDIMENT AND EROSION CONTROL STRUCTURES SHOWN HEREON, AFTER EACH RAINFALL AND ON A DAILY BASIS.

STORM WATER MANAGEMENT POND CERTIFICATION AND APPROVAL

DEVELOPER'S CERTIFICATE
"I HEREBY CERTIFY THAT ALL DEVELOPMENT AND/OR CONSTRUCTION WILL BE DONE ACCORDING TO THESE PLANS, AND THAT ANY RESPONSIBLE PERSONNEL INVOLVED IN THE CONSTRUCTION OF THE PROJECT HAVE A CERTIFICATE OF ATTENDANCE AT A DEPARTMENT OF NATURAL RESOURCES APPROVED TRAINING PROGRAM FOR THE CONTROL OF SEDIMENT AND EROSION. I HAVE NOTIFIED THE HOWARD COUNTY SOIL CONSERVATION DISTRICT WITH AN AS-BUILT PLAN OF THE POND WITHIN 30 DAYS OF COMPLETION."
Signature: *Ronald E. Egan* DATE: 9-19-91

ENGINEER'S CERTIFICATE
"I CERTIFY THAT THIS PLAN FOR POND CONSTRUCTION, EROSION AND SEDIMENT CONTROL REPRESENTS A PRACTICAL AND WORKABLE PLAN BASED ON MY PERSONAL KNOWLEDGE OF THE SITE CONDITIONS. THIS PLAN IS IN ACCORDANCE WITH THE REQUIREMENTS OF THE HOWARD COUNTY SOIL CONSERVATION DISTRICT. I HAVE NOTIFIED THE DEVELOPER THAT HE MUST PROVIDE THE HOWARD COUNTY SOIL CONSERVATION DISTRICT WITH AN AS-BUILT PLAN OF THE POND WITHIN 30 DAYS OF COMPLETION."
Signature: *James M. Nelson* DATE: 10/19/91

SOIL CONSERVATION SERVICE
"THESE PLANS HAVE BEEN REVIEWED FOR THE HOWARD COUNTY SOIL CONSERVATION DISTRICT AND MEET THE TECHNICAL REQUIREMENTS FOR SMALL POND CONSTRUCTION, SOIL EROSION AND SEDIMENT CONTROL."
Signature: *James M. Nelson* DATE: 10/28/91

HOWARD COUNTY SOIL CONSERVATION DISTRICT
"THESE PLANS FOR SMALL POND CONSTRUCTION, SOIL EROSION AND SEDIMENT CONTROL MEET THE REQUIREMENTS OF THE HOWARD COUNTY SOIL CONSERVATION DISTRICT."
Signature: *Robert L. Egan* DATE: 10/28/91

POND CONSTRUCTION CERTIFICATION
"I CERTIFY THAT UPON COMPLETION OF CONSTRUCTION I WILL BE RESPONSIBLE FOR THE OPERATION AND MAINTENANCE (O&M) OF THE SMALL POND. O&M WILL BE PERFORMED BY ME IN ACCORDANCE WITH THE SPECIFICATIONS ON THIS PLAN. I ALSO AUTHORIZE PERIODIC ON-SITE INSPECTIONS OF THE POND BY SITE AND LOCAL AGENCIES."
Signature: *Ronald E. Egan* DATE: 9-19-91

NOTES AND DETAILS
INWOOD VILLAGE CENTER
RETAIL STORES
FOURTH ELECTION DISTRICT
HOWARD COUNTY MARYLAND
TAX MAP 14 BLOCK 11 PARCEL A
DATE: OCTOBER 17, 1991
SHEET 2 OF 7

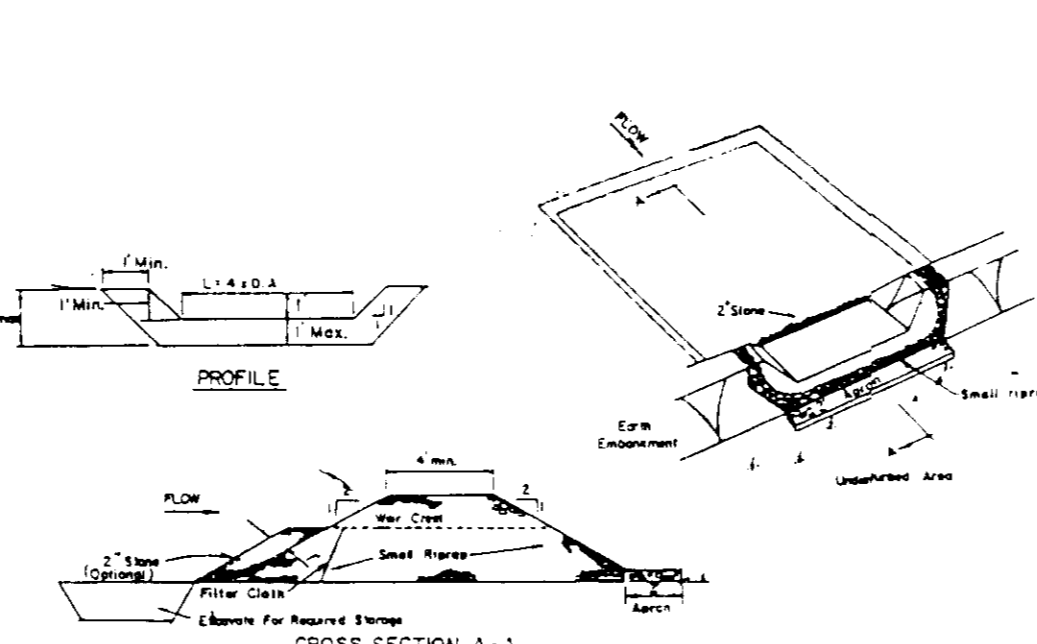

STONE OUTLET SEDIMENT TRAP
NOT TO SCALE

- CONSTRUCTION SPECIFICATIONS FOR ST-III
- Area under embankment shall be cleared, graded and stripped of any vegetation and top soil. The pool area shall be cleared.
 - The fill material for the embankment shall be free of rocks and other woody vegetation as well as over-sized stones, rocks, organic material or other objectionable material. The embankment shall be compacted by tamping with equipment while it is being constructed.
 - All cut and fill slopes shall be 1:1 or flatter.
 - The stone used in the outlet shall be small riprap 1/2" to 1" thick with a 1" thickness of 1/2" aggregate placed on the upstream side of the small riprap 2" embedded filter cloth in the riprap.
 - Sediment shall be removed and trap restored to its original dimensions when the sediment has accumulated to 1/2 the design depth of the trap.
 - The structure shall be inspected after each rain and repairs made as needed.
 - Construction operations shall be carried out in such a manner that erosion and water pollution is minimized.
 - The structure shall be removed and the area stabilized when the drainage area has been properly stabilized.
 - All cut slopes shall be 1:1 or flatter.

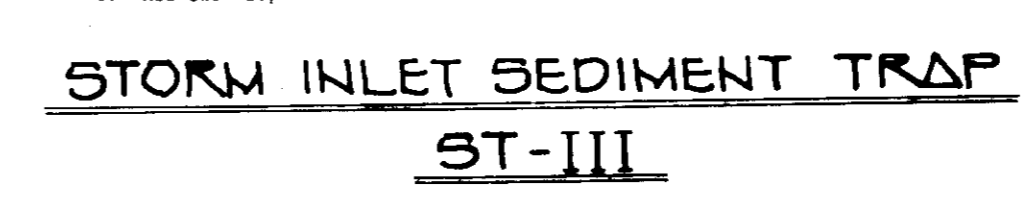

STORM INLET SEDIMENT TRAP
ST-III
NOT TO SCALE

- CONSTRUCTION SPECIFICATIONS FOR ST-III
- Sediment shall be removed and the trap restored to its original dimensions when the sediment has accumulated to the design depth of the trap. Removed sediment shall be deposited in a suitable area and in such a manner that it will not erode.
 - The volume of sediment storage shall be 1800 cubic feet per acre of contributory drainage.
 - The structure shall be inspected after each rain and repairs made as needed.
 - Construction operations shall be carried out in such a manner that erosion and water pollution shall be minimized.
 - The sediment trap shall be removed and the area stabilized when the contributory drainage area has been properly stabilized.
 - All cut slopes shall be 1:1 or flatter.

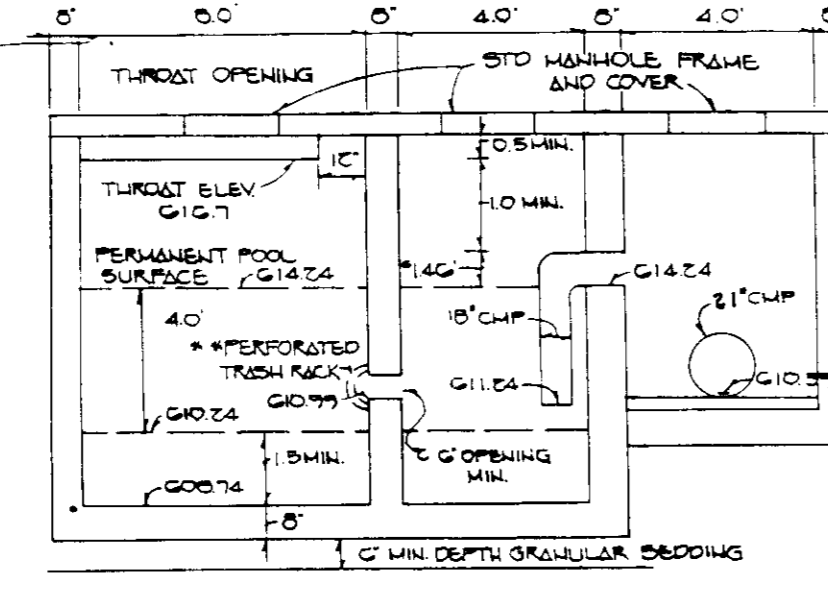

WATER QUALITY STRUCTURE
NOT TO SCALE

- SPECIFICATIONS
STORMWATER MANAGEMENT POND
- THESE SPECIFICATIONS ARE APPROPRIATE TO ALL PONDS WITHIN THE SCOPE OF THE STANDARD FOR PRACTICE 90-374. ALL REFERENCES TO ASTM AND AASHTO SPECIFICATIONS APPLY TO THE MOST RECENT VERSION.
- SITE PREPARATION
- AREAS DESIGNATED FOR BORROW AREAS, EMBANKMENT, AND STRUCTURAL WORKS SHALL BE CLEARED, GRUBBED AND STRIPPED OF TOPSOIL. ALL TREES, VEGETATION, ROOTS AND OTHER OBJECTIONABLE MATERIALS SHALL BE REMOVED. CHANNEL BANKS AND SHARP BREAKS SHALL BE SLOPED TO NO STREPER THAN 1:1.
- AREAS TO BE COVERED BY THE RESERVOIR WILL BE CLEARED OF ALL TREES, BRUSH, LOGS, FENCES, RUBBER AND OTHER OBJECTIONABLE MATERIAL UNLESS OTHERWISE DESIGNATED ON THE PLANS. TREES, BRUSH AND STUMPS SHALL BE CUT APPROXIMATELY LEVEL WITH THE GROUND SURFACE. ALL STUMP REMAINS SHALL BE REMOVED. A MINIMUM OF A 50 FOOT RADIUS AROUND THE INLET STRUCTURE SHALL BE CLEARED.
- ALL CLEARED AND GRUBBED MATERIAL SHALL BE DISPOSED OF OUTSIDE AND BELOW THE LIMITS OF THE DAM AND RESERVOIR AS DIRECTED BY THE OWNER OR HIS REPRESENTATIVE. WHEN SPECIFIED A SUFFICIENT QUANTITY OF TOPSOIL WILL BE STOCKPILED IN A SUITABLE LOCATION FOR USE ON THE EMBANKMENT AND OTHER DESIGNATED AREAS.
- EARTH FILL
- MATERIAL: THE FILL MATERIAL SHALL BE TAKEN FROM APPROVED DESIGNATED BORROW AREAS. IT SHALL BE FREE OF ROOTS, STUMPS, WOOD, RUBBER, STONES GREATER THAN 6", FROZEN OR OTHER OBJECTIONABLE MATERIALS. FILL MATERIAL FOR THE CENTER OF THE EMBANKMENT AND CUT OFF TRENCH SHALL CONFORM TO UNIFIED SOIL CLASSIFICATION (SC) OR, OR CU. CONSTRUCTION MAY BE GIVEN TO THE USE OF OTHER MATERIALS IN THE EMBANKMENT IF DESIGN AND CONSTRUCTION ARE SUPERVISED BY A GEOTECHNICAL ENGINEER.
- PLACEMENT: AREAS ON WHICH FILL IS TO BE PLACED SHALL BE SCARIFIED PRIOR TO PLACEMENT OF FILL. FILL MATERIALS SHALL BE PLACED IN MAXIMUM 8-INCH THICK (BEFORE COMPACTION) LAYERS WHICH ARE TO BE CONTINUOUS OVER THE ENTIRE LENGTH OF THE FILL. THE MOST PERMEABLE BORROW MATERIAL SHALL BE PLACED IN THE DOWNSTREAM PORTIONS OF THE EMBANKMENT. THE PRINCIPAL SPILLWAY MUST BE INSTALLED CONCURRENTLY WITH FILL PLACEMENT AND NOT ESCAVATED INTO THE EMBANKMENT.
- COMPACTION: THE MOVEMENT OF THE HAULING AND SPREADING EQUIPMENT OVER THE FILL SHALL BE CONTROLLED SO THAT THE

STRUCTURE	SCHEDULE	REMARKS
I-1	54.4	STATE HIGHWAY ADMIN INLET
I-2	WATER QUALITY	WATER QUALITY INLET SEE DETAIL SHEET 2 OF 6
I-3	WATER QUALITY	WATER QUALITY INLET SEE DETAIL SHEET 2 OF 6
D-1	12.0	12.0
D-2	12.0	12.0

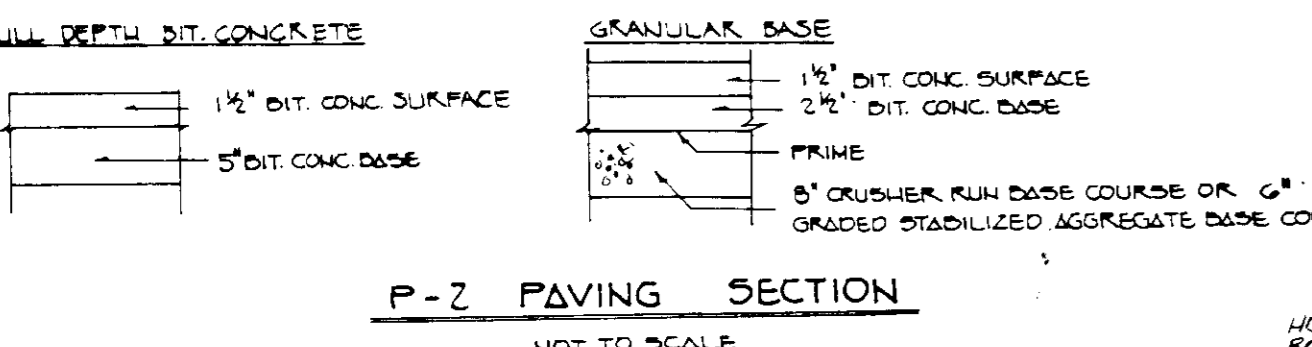

P-2 PAVING SECTION
NOT TO SCALE

NO.	DATE	REVISIONS	DESCRIPTION
1	4-22-91	REVISED PER BUREAU OF ENGINEERING SPEED MEMO DATED 4-12-91	
2	3-02-95	REVISED SPOT ELEV. ON CURB DETAILS.	

FISHER, COLLINS & CARTER, INC.
CIVIL ENGINEERS & LAND SURVEYORS
SUITE 100, 9171 BALTIMORE NATIONAL PIKE
ELLICOTT CITY, MARYLAND 21043
(301) 461-2855

ENGINEER'S CERTIFICATE
"I HEREBY CERTIFY THAT THIS PLAN FOR EROSION AND SEDIMENT CONTROL REPRESENTS A PRACTICAL AND WORKABLE PLAN BASED ON MY PERSONAL KNOWLEDGE OF THE SITE CONDITIONS AND THAT IT WAS PREPARED IN ACCORDANCE WITH THE REQUIREMENTS OF THE HOWARD COUNTY SOIL CONSERVATION DISTRICT."
Signature: *James M. Nelson* DATE: 10/17/91

DEVELOPER'S CERTIFICATE
"I/WE CERTIFY THAT ALL DEVELOPMENT AND CONSTRUCTION WILL BE DONE ACCORDING TO THIS PLAN OF DEVELOPMENT AND PLAN FOR EROSION AND SEDIMENT CONTROL, AND THAT ALL RESPONSIBLE PERSONNEL INVOLVED IN THE CONSTRUCTION PROJECT WILL HAVE A CERTIFICATE OF ATTENDANCE AT A DEPARTMENT OF THE ENVIRONMENT APPROVED TRAINING PROGRAM FOR THE CONTROL OF SEDIMENT AND EROSION BEFORE BEGINNING THE PROJECT. I ALSO AUTHORIZE PERIODIC ON-SITE INSPECTION BY THE HOWARD COUNTY SOIL CONSERVATION DISTRICT OR THEIR AUTHORIZED AGENTS, AS ARE DEEMED NECESSARY."
Signature: *Ronald E. Egan* DATE: 9-19-91

APPROVED: DEPT. OF PLANNING AND ZONING
Signature: *James M. Nelson* DATE: 10/28/91
Signature: *James M. Nelson* DATE: 11/31/92
Signature: *James M. Nelson* DATE: 1/31/94
Signature: *James M. Nelson* DATE: 6/1/90
Signature: *James M. Nelson* DATE: 1-23-92

APPROVED: DEPARTMENT OF PUBLIC WORKS FOR PRIVATE WATER & SEWER AND STORM DRAINAGE SYSTEMS AND ROADS.
Signature: *James M. Nelson* DATE: 10/28/91
Signature: *James M. Nelson* DATE: 1/24/92
Signature: *James M. Nelson* DATE: 1-23-92

NOTES AND DETAILS
INWOOD VILLAGE CENTER
RETAIL STORES
FOURTH ELECTION DISTRICT
HOWARD COUNTY MARYLAND
TAX MAP 14 BLOCK 11 PARCEL A
DATE: OCTOBER 17, 1991
SHEET 2 OF 7
SDP 91-60