

ADDRESS CHART	
BUILDING #	STREET ADDRESS
A-18	8930 STANFORD BOULEVARD
SUBDIVISION NAME	SECT./AREA LOT/PARCEL #
COLUMBIA CORPORATE PARK	A-18
PLAT # OR L/F	BLOCK # ZONE TAX/ZONE MAP
9553	1B F-24 NT 36
WATER CODE	ELECT. DIST. CENSUS TRACT
E 06	6
SEWER CODE	6665.02
6333000	

NOTE: FREQUENCY OF USE FOR THIS ENTRANCE AVERAGES 4-TIMES/MONTH

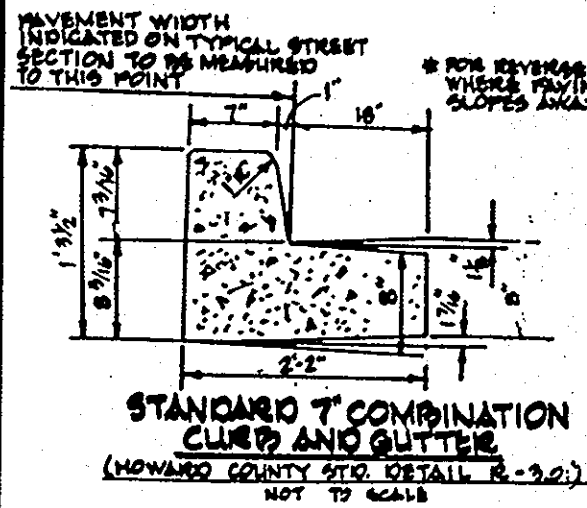

* SEE SHEET #2 FOR SITE DATA AND GENERAL NOTES.
 ** STORM WATER MANAGEMENT IS PROVIDED BY A REGIONAL POND - SEE SDP 87-193.
 *** PRELIMINARY PLAN FOR COLUMBIA CORP. PARK APPROVED AUGUST 19, 1987. (P87-42)

ENVIRONMENTAL NOTES

- EXISTING SLOPES BETWEEN 15-25% AND GREATER THAN 25% HAVE BEEN LOCATED. ACCORDING TO PAR. 10.1.1 OF THE ANNOTATED TO GRADE SLOPES IS NOT NECESSARY SINCE THE LIMITS OF DISTURBANCE ARE CONSISTANT WITH THE APPROVED PRELIMINARY PLAN FOR THE SITE. IN ADDITION THE SLOPE IS AGRICULTURAL MADE FIRST BY THE GRADING OF DOBBIN RD.
- NO NON TIDAL WETLANDS OR LAKE FLOORPLAIN EXIST ON THIS SITE TO THE BEST OF OUR KNOWLEDGE.
- ORIGINAL SLOPES HAVE BEEN ALTERED BY THE ABOVE REFERENCED GRADING AND GRADING ASSOCIATED WITH SDP 87-193. SEE PRELIMINARY PLAN FOR ORIGINAL SLOPES.
- EXISTING VEGETATION IS SECONDARY GROWTH WITH NO SIGNIFICANT TREES.

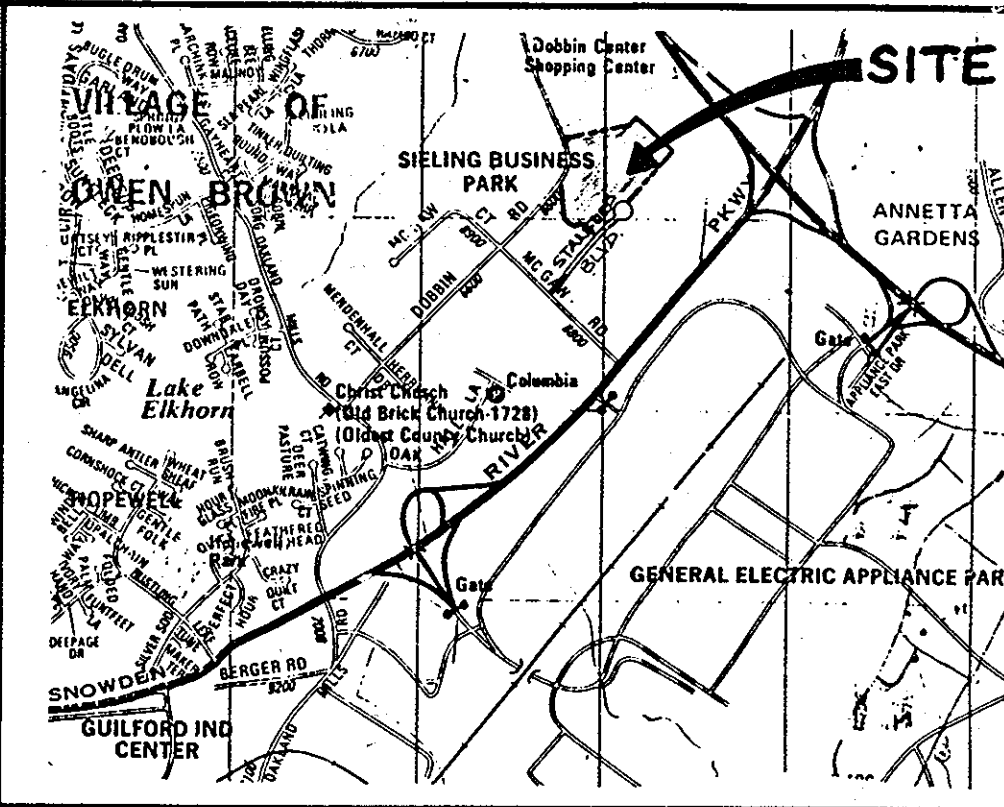
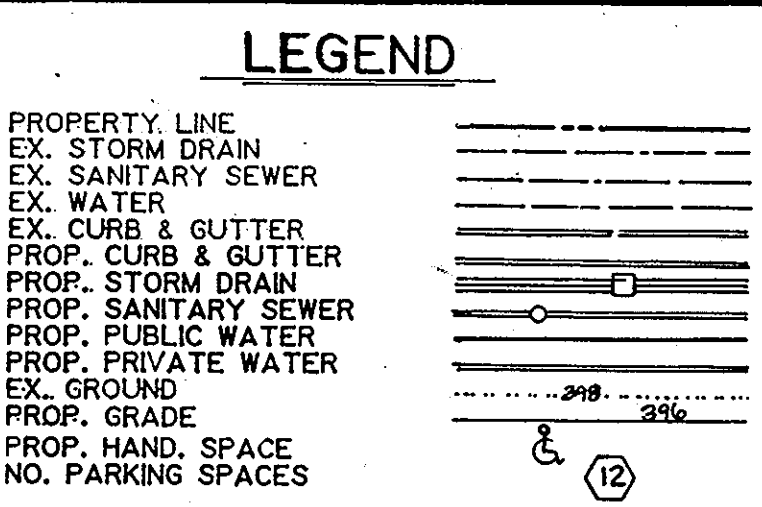

VICINITY MAP
 SCALE: 1" = 200'

BENCHMARKS:
 BM # 234401 ELEVATION: 307.49
 STANDARD CONCRETE MONUMENT SET FLUSH WITH SURFACE
 NORTH 491333.018 EAST 958206.723
 BM # 2343001 ELEVATION: 298.24
 34" R.B. SET 0.3 FT BELOW THE SURFACE
 NORTH 492140.801 EAST 857226.671

APPROVED PLANNING BOARD OF HOWARD COUNTY
 DATE: 8-14-90
 J.B.

THESE PLANS HAVE BEEN REVIEWED FOR THE HOWARD SOIL CONSERVATION DISTRICT & MEET THE TECHNICAL REQUIREMENTS FOR SMALL POND CONSTRUCTION, SOIL EROSION AND SEDIMENT CONTROL.

APPROVED: *[Signature]* 9/5/90
 SOIL CONSERVATION SERVICE

APPROVED: *[Signature]* 9/5/90
 HOWARD SOIL CONSERVATION DISTRICT

PLAN NUMBER

APPROVED: FOR PUBLIC WATER AND PUBLIC SEWERAGE SYSTEMS
 HOWARD COUNTY HEALTH DEPARTMENT.

[Signature] 9-20-90
 COUNTY HEALTH OFFICER

APPROVED: HOWARD COUNTY DEPT. OF PLANNING & ZONING.

[Signature] 10-29-90
 DIRECTOR

[Signature] 9/24/90
 CHIEF DIVISION OF TECHNICAL PLANNING & LAND DEVELOPMENT

APPROVED: FOR PUBLIC WATER AND PUBLIC SEWERAGE STORM DRAINAGE SYSTEMS AND PUBLIC ROADS HOWARD COUNTY DEPARTMENT OF PUBLIC WORKS.

[Signature] 9/20/90
 DIRECTOR

[Signature] 9-12-90
 CHIEF BUREAU OF ENGINEERING

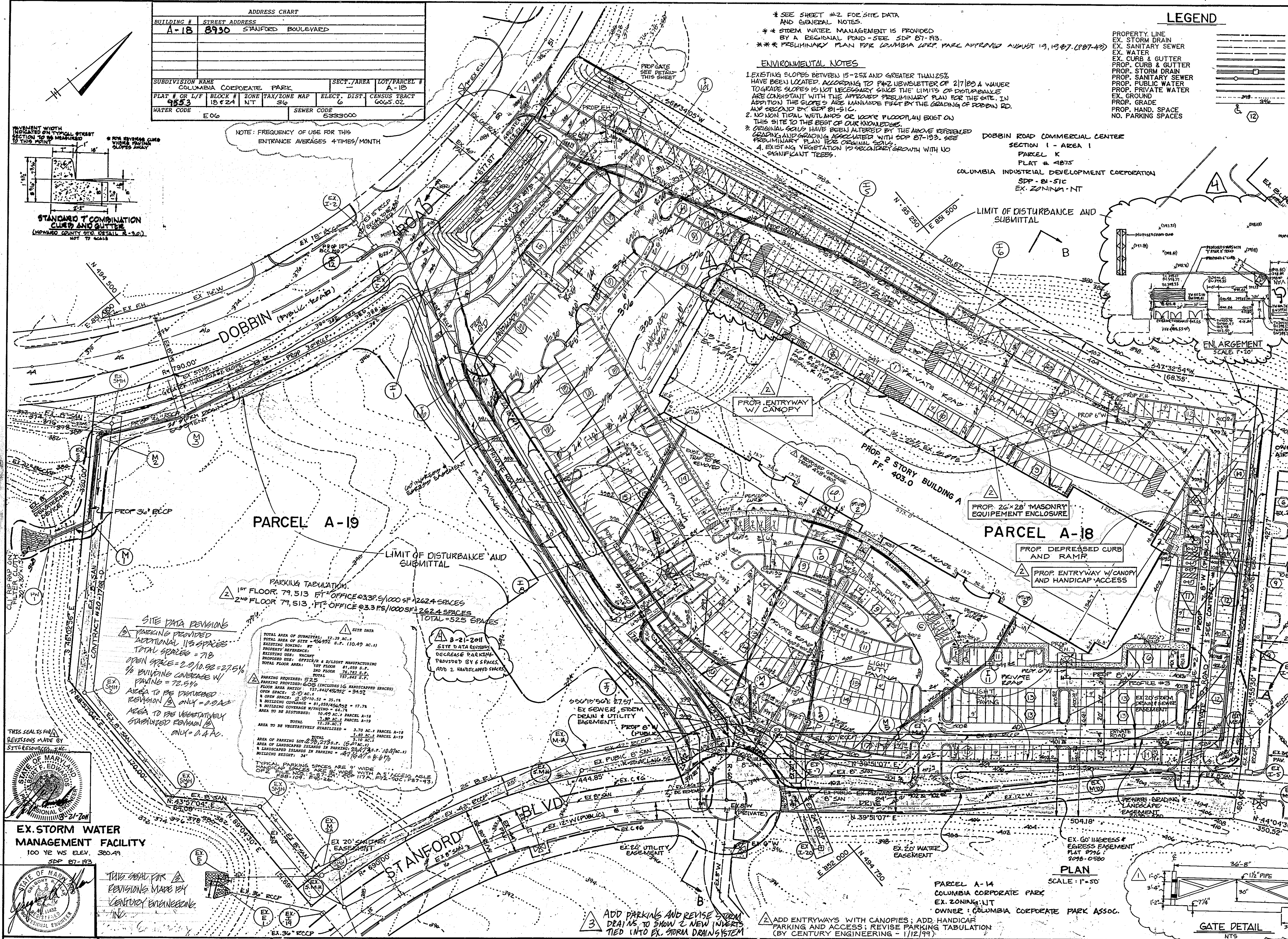

PARKING TABULATION

1ST FLOOR 79,513 FT² OFFICE @ 33 SF/1000 SF = 262.4 SPACES
 2ND FLOOR 79,513 FT² OFFICE @ 33 SF/1000 SF = 262.4 SPACES
 TOTAL = 524.8 SPACES

SITE DATA REVISIONS

REVISIONS MADE BY: *[Signature]*

REVISIONS MADE BY: *[Signature]*

EX. STORM WATER MANAGEMENT FACILITY
 100 YD WS ELEV. 380.49
 SDP 87-193

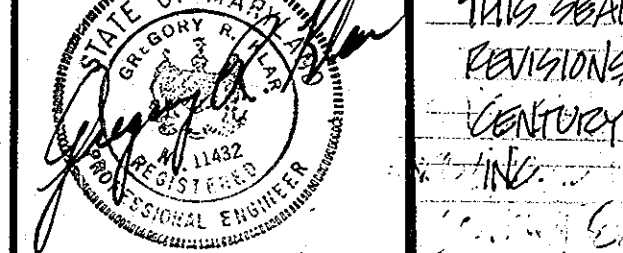

PLAN
 SCALE: 1" = 50'

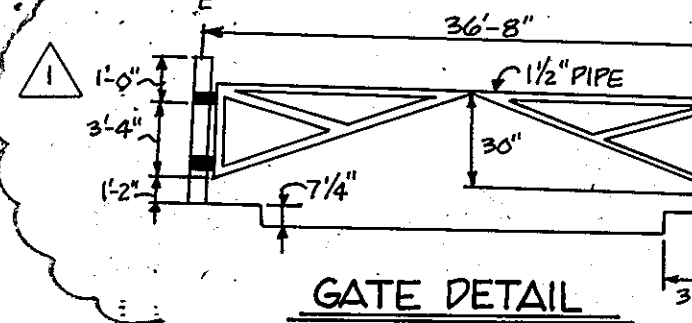

GEORGE WILLIAM STEPHENS, JR. AND ASSOCIATES, INC.
 CIVIL ENGINEERS & LAND SURVEYORS
 658 KENILWORTH DRIVE, SUITE 100
 TOWSON, MARYLAND 21284
 (301) 825-8120

ENGINEER'S CERTIFICATE

I CERTIFY THAT THIS PLAN FOR CONSTRUCTION, EROSION AND SEDIMENT CONTROL REPRESENTS A PRACTICAL AND WORKABLE PLAN BASED ON MY PERSONAL KNOWLEDGE OF THE SITE CONDITIONS. THIS PLAN WAS PREPARED IN ACCORDANCE WITH THE REQUIREMENTS OF THE SITES CONDITIONS. THIS PLAN WAS PREPARED IN ACCORDANCE WITH THE REQUIREMENTS OF THE HOWARD SOIL CONSERVATION DISTRICT.

[Signature] 8930
 ENGINEER
 TAPOBRATA CHAKRABARTI

OWNER / DEVELOPER PARCEL A-18 & A-19

8930 STANFORD BOULEVARD LLC
 C/O AMERIX CORPORATION
 8930 STANFORD BLVD.
 COLUMBIA, MD 21045-5805

DEVELOPER'S CERTIFICATE

I CERTIFY THAT ALL DEVELOPMENT AND/OR CONSTRUCTION WILL BE DONE ACCORDING TO THESE PLANS AND THAT ANY RESPONSIBLE PERSONNEL INVOLVED IN THE CONSTRUCTION PROJECT WILL HAVE A CERTIFICATE OF ATTENDANCE AT A DEPT. OF ENVIRONMENTAL APPROVED TRAINING PROGRAM FOR THE CONTROL OF SEDIMENT AND EROSION BEFORE BEGINNING THE PROJECT. I ALSO AUTHORIZE PERIODIC ON-SITE INSPECTION BY THE HOWARD SOIL CONSERVATION DISTRICT OR THE AUTHORIZED AGENCIES AS ARE DETERMINED NECESSARY FROM THE PLAN ROLL. I WILL BE RESPONSIBLE UNLESS AUTHORIZED BY THE HOWARD SOIL CONSERVATION DISTRICT.

[Signature]
 DEVELOPER
 DATE: 8/1/90

DESIGNED: N.B.
 DRAWN: A.D.
 CHECKED:
 APPROVED: GEARGE TRAP
 REVISIONS: ENTRANCE & ADDED
 4' X 6' PARKING SPACES,
 ADDED GATE DETAIL
 9/20/91
 PN 6415.

SITE PLAN FOR COLUMBIA CORPORATE PARK PARCEL A-18 (A RESUBDIVISION OF PARCEL A-16)

TAX MAP 36 PARCEL 356
 6TH ELECTION DISTRICT
 HOWARD COUNTY, MD.

CAPITAL PROJECT # C-0264
 MAY 1, 1990
 SHEET 1 OF 7

SDP 90-198

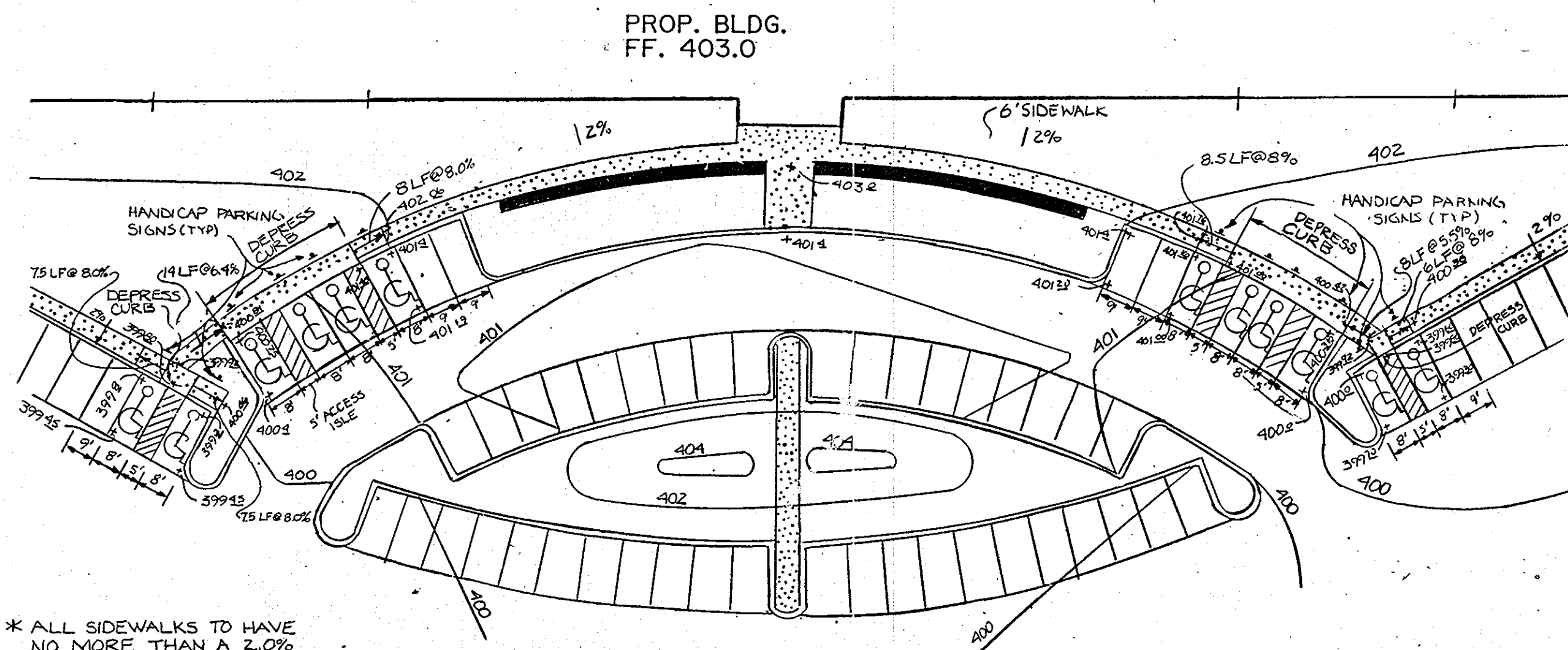

PROP. BLDG.
FF. 403.0

HANDICAP DETAIL
SCALE: 1" = 30'

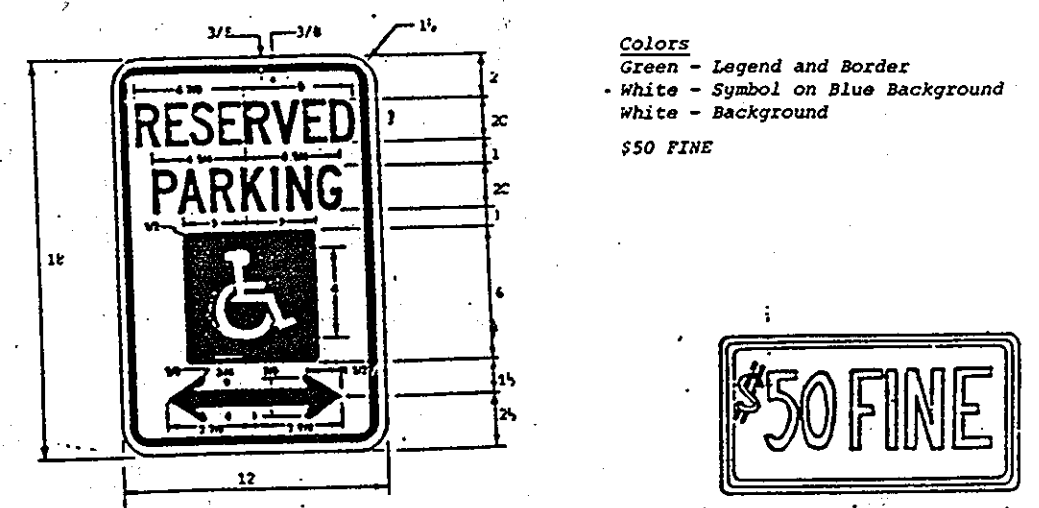

Colors
Green - Legend and Border
White - Symbol on Blue Background
White - Background

550 FINE SIGN
Sign to utilize an aluminum blank 6" x 12" x 0.080 inch thick with two single post mounting holes.
The text and border shall be standard green to match that on R7-9 and the background shall be reflective white. Text shall be in 1" characters.
Sign shall be mounted directly below the standard R7-9 Reserved Parking for Handicapped sign. Its bottom edge shall be no less than 7 feet above ground. If the sign is placed against a building, structure, or other location where vehicle or pedestrian traffic is not obstructed the bottom edge of sign shall be at least 6 feet but not more than 10 feet above ground.

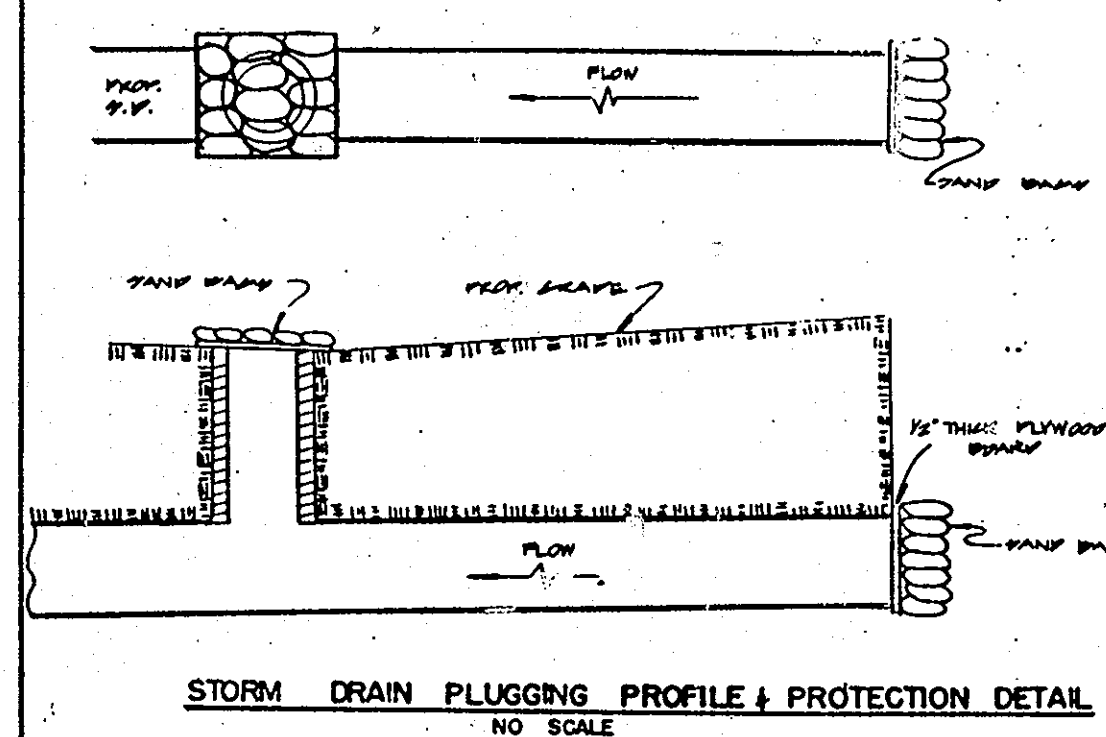

STORM DRAIN PLUGGING PROFILE & PROTECTION DETAIL
NO SCALE

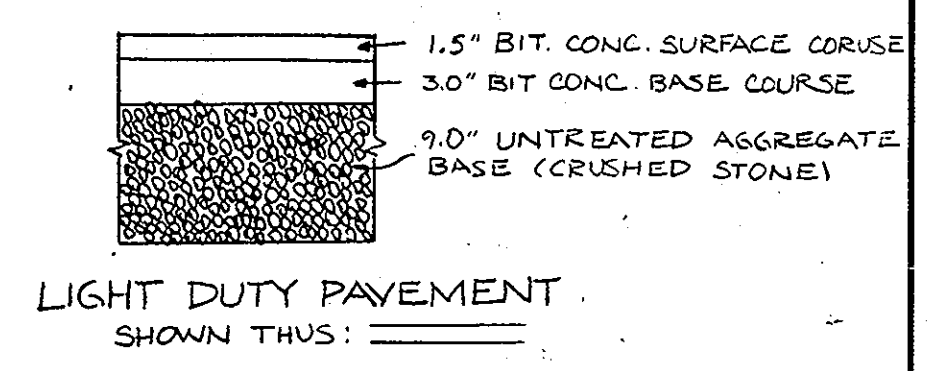

LIGHT DUTY PAVEMENT
SHOWN THUS: [Symbol]

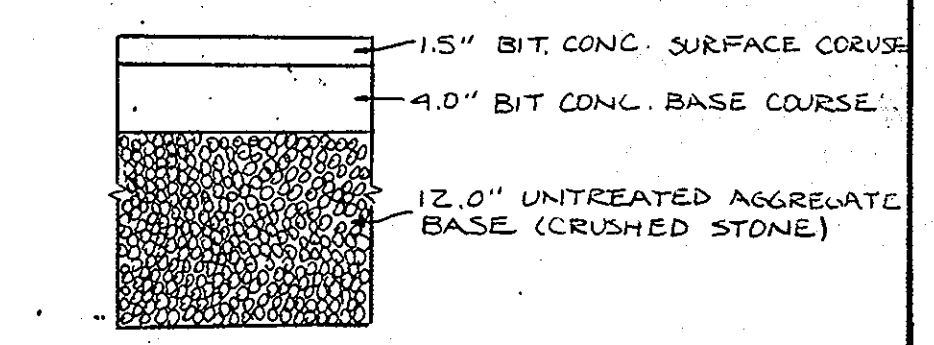

HEAVY DUTY PAVEMENT
SHOWN THUS: [Symbol]

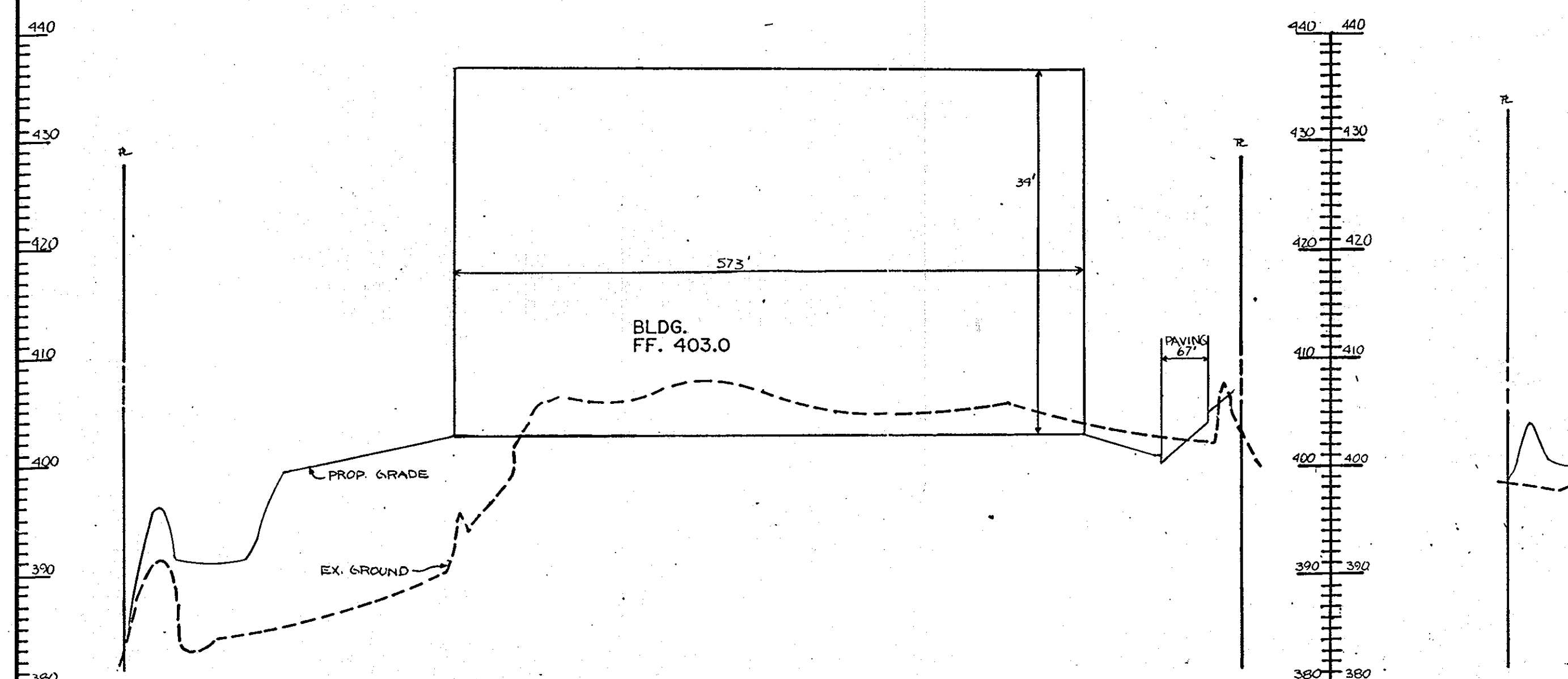

SECTION A-A
SCALE: HORIZ. 1" = 100', VERT. 1" = 10'

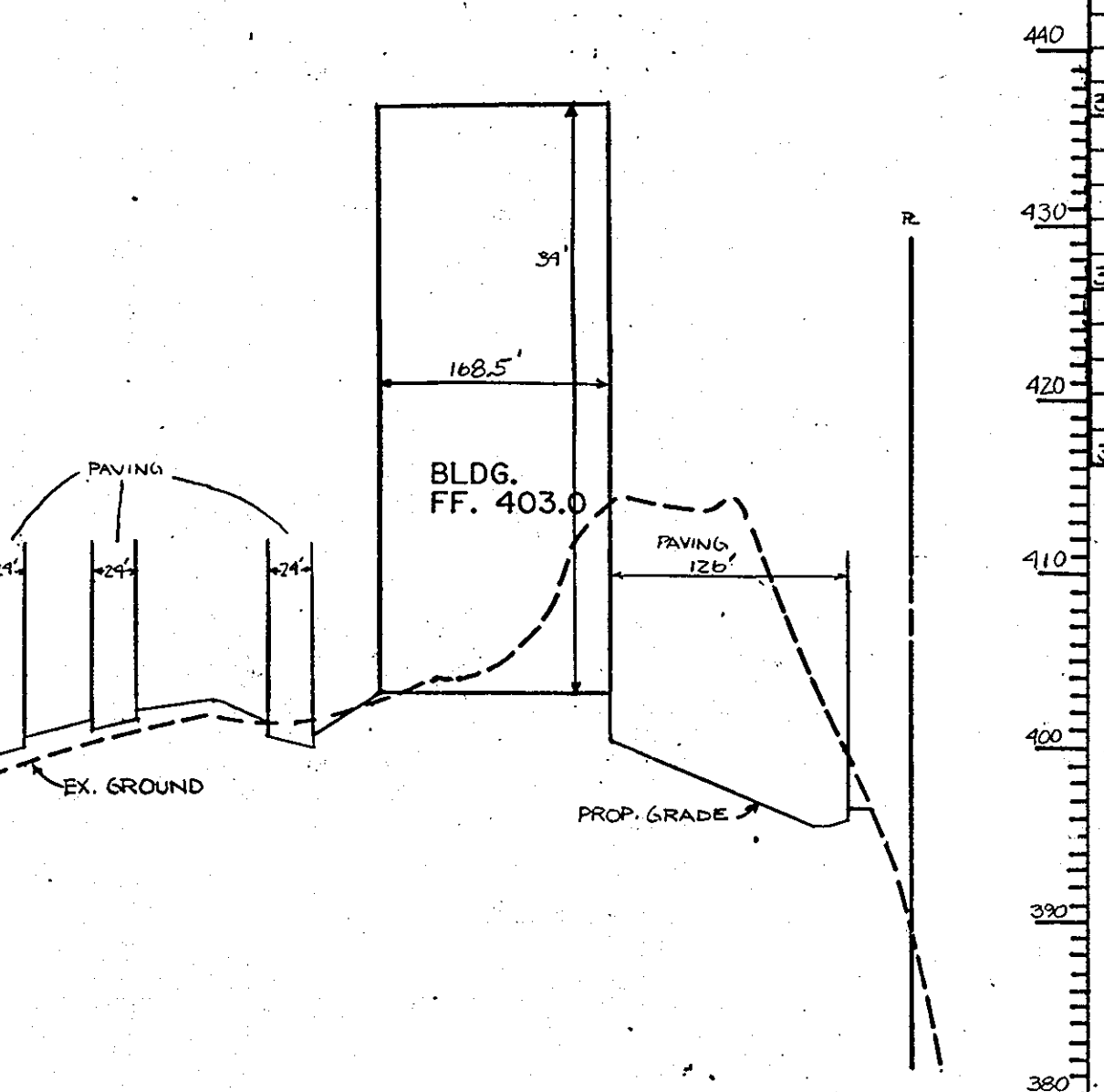

SECTION B-B
SCALE: HORIZ. 1" = 100', VERT. 1" = 10'

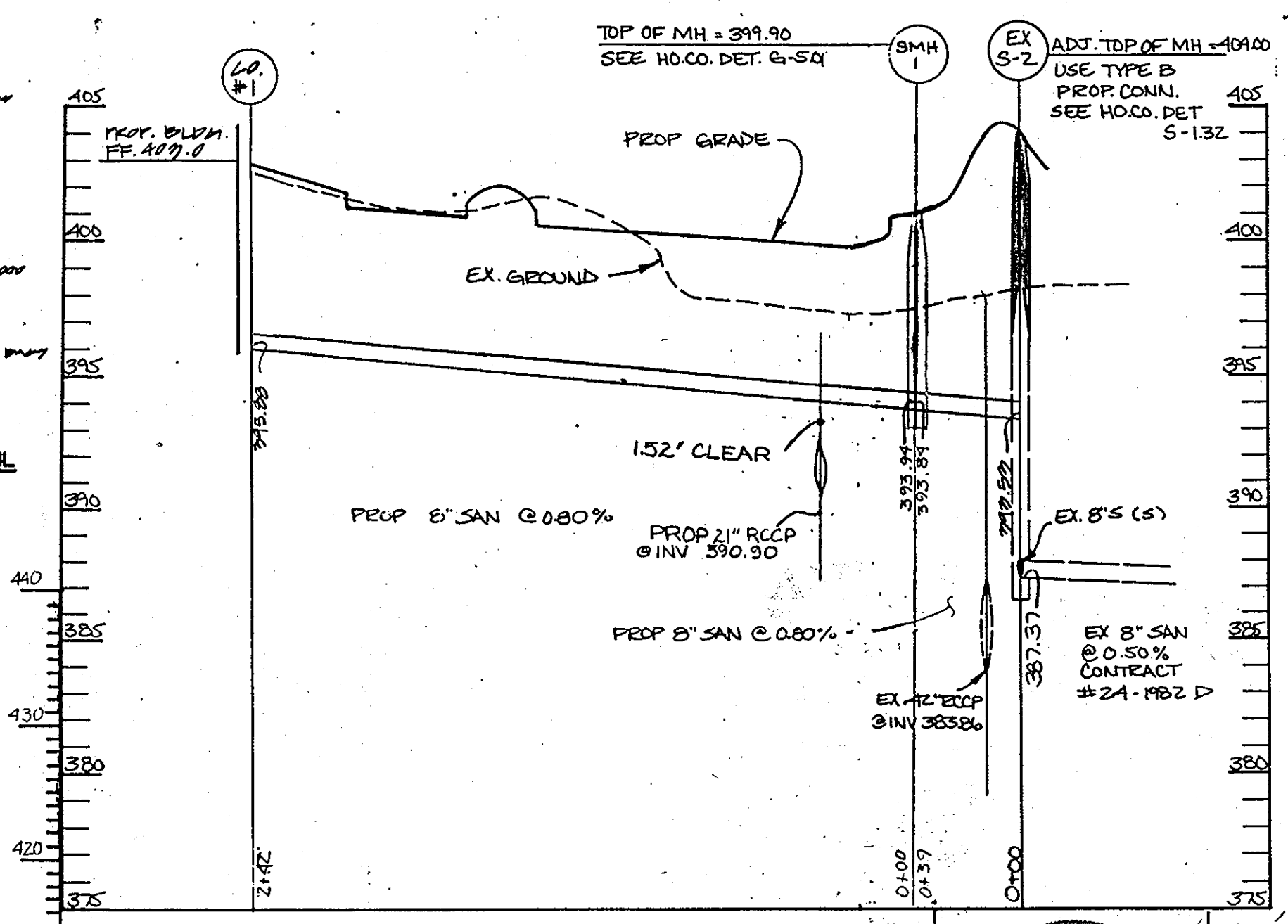

SANITARY SEWER PROFILE
SCALE: HORIZ. 1" = 50', VERT. 1" = 5'

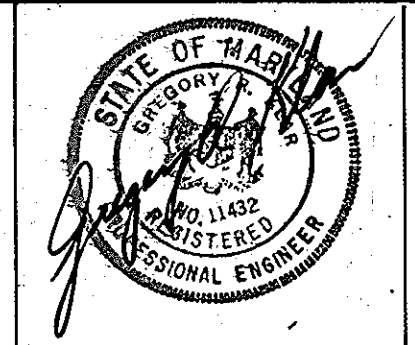

THIS SEAL FOR REMAIN IN PLACE BY CENTURY ENGINEERING INC. SEE SHEET 6 OF 7 FOR DRAINAGE AREA MAP.

REVISED PROFILE, DRAINAGE AREA DATA AND INLET SCHEDULE (BY CENTURY ENGINEERING 2/10/90)

APPROVED PLANNING BOARD OF HOWARD COUNTY
DATE: 8-14-90

- GENERAL NOTES
- Maximum building height - 50'.
 - All areas not being paved or receiving building coverage shall be stabilized in accordance with the plans approved by Howard Soil Conservation District.
 - Any damage to public rights-of-way and/or adjacent properties shall be repaired immediately at the contractor's expense.
 - The contractor shall maintain at least a 2" level bench behind all curb and gutter in fill areas.
 - The contractor shall verify all existing utilities to his own satisfaction before starting construction.
 - All slopes shall be 2:1 or flatter.
 - All work shall be done in accordance with Howard County Standard Specification and Details for Construction, or as shown on these plans.
 - The contractor shall notify the C & P Telephone Co. and the Gas and Electric Company five days prior to starting work shown on these plans by calling "Miss Utility". Call collect 1-559-0100.
 - For details of ramps and signs for the handicapped, see the Maryland Building Code for the Handicapped and Aged and as shown hereon. See Sheet of
 - The contractor shall maintain a minimum of 4' cover over all proposed water lines.

- All rip-rap shall be placed on filter cloth.
- The contractor or developer shall contact the Construction Inspection/Survey Division 24 hours in advance of commencement of work at 992-2417 or 792-7272.
- The contractor shall remove all existing paving, curb and gutter, etc. that may interfere with proposed construction.
- All utilities installed shall receive full trench compaction.
- All water main tees, bends, caps, etc. shall be buttressed in accordance with Howard County Design requirements.
- All sidewalks will be 6' wide (see architectural plans for details).
- The owner shall provide a separate and independent sewer connection for each tenant or occupant of any building, shown on this site development plan who will discharge non-domestic waste to the public sewerage system if this waste is regulated under Section 18.122A of the Howard County Code. Each separate and independent sewer connection shall include a standard manhole and other waste treatment devices as required and approved by Howard County. Waste lines on the interior of the building shall be designed, constructed or modified such that non-domestic waste will be discharged to the separate and independent sewer connection. No tenant or occupant of any building shown on this site development plan shall discharge regulated non-domestic waste to the public sewerage system prior to installation of the separate and independent sewer connection and related interior waste lines. The above requirements shall apply to all initial and future occupants or tenants.

#	TYPE	TOP	INV. IN	INV. OUT	R/C/S	HO.CO. DET.
I-100	A-B	302.00	-	305.70	3.00	SD-4.21
I-101	A-B	301.00	-	306.00	2.15	SD-4.21

INLET SCHEDULE						
#	TYPE	TOP	INV. IN	INV. OUT	R/C/S	HO.CO. DET.
I-1	DBL 5'	304.60	374.25	378.82	2.88	SD-4.34
I-2	DBL 5'	308.50	383.70	378.03	2.21	SD-4.34
I-3	DBL 5'	307.70	380.36	380.18	3.34	SD-4.34
I-4	DBL 5'	308.50	383.26	382.82	4.60	SD-4.23
I-5	DBL 5'	395.00	390.04	391.84	4.51	"
I-6	DBL 5'	395.00	-	391.00	4.73	"
I-7	DBL 5'	397.30	392.00	391.75	2.74	"
I-8	DBL 5'	397.30	393.35	393.10	6.16	"
I-9	DBL 5'	398.00	393.5	391.75	5.09	"
I-10	DBL 5'	399.40	395.00	394.80	2.43	"
I-11	DBL 5'	399.20	395.15	394.90	7.37	"
I-12	A-10	378.20	-	374.45	2.69	SD-4.02**

** TOP OF CURB ELEVATION
** USE INLET DEFLECTORS - HO.CO. DET SD-4.23

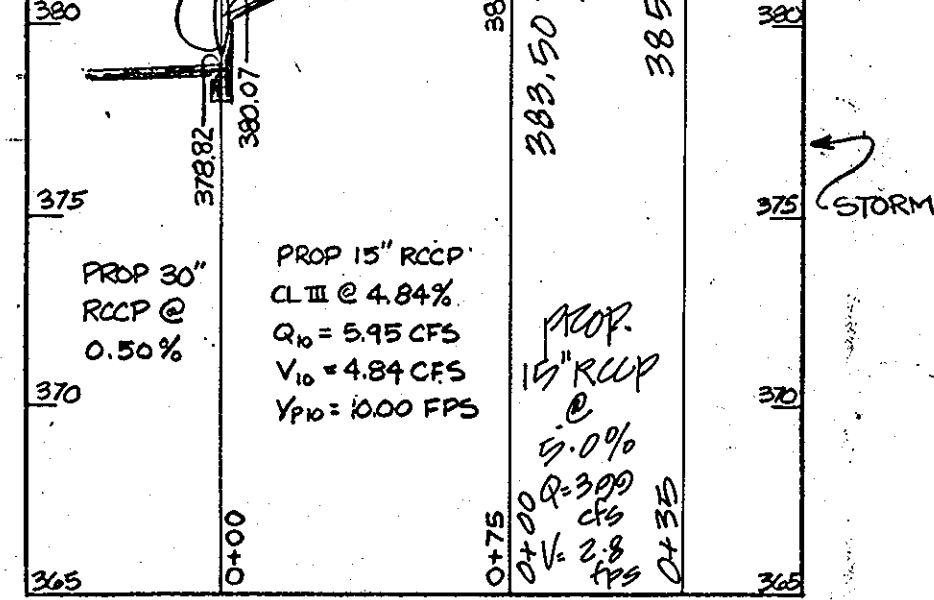

STORM DRAIN PROFILE

STRUCTURE SCHEDULE						
#	TYPE	TOP	INV. IN	INV. OUT	HO.CO. DET.	
M-1	5' BRICK MH	383.00	376.86	368.12	E-5.02	
M-2	5' BRICK MH	381.90	376.65	373.65	E-5.0	
M-3	5' BRICK MH	386.00	377.39	377.15	E-5.02	
M-4	4' BRICK MH	400.10	390.70	390.50	G-5.01	
M-5	5' BRICK MH	399.90	393.20	387.51	G-5.02	
HW-1	1" HEADWALL	-	368.00	368.00	SD-5.11	

AREA	ACRES	C FACTOR
A	0.71	0.95
B	1.23	0.79
C	0.71	0.95
D	0.43	0.74
E	0.84	0.80
F	0.78	0.95
G	1.09	0.74
H	0.45	0.74
I	1.69	0.76
J	0.60	0.88
K	0.60	0.70
L	0.31	0.64
M	0.51	0.67
N	0.46	0.95
O	0.40	0.65
P	2.73	0.82
Q	0.60	0.63

AREA ACRES C FACTOR

GEORGE WILLIAM STEPHENS, JR. AND ASSOCIATES, INC.
CIVIL ENGINEERS & LAND SURVEYORS
658 KENILWORTH DRIVE, SUITE 100
TOWSON, MARYLAND 21204
(301) 825-8120

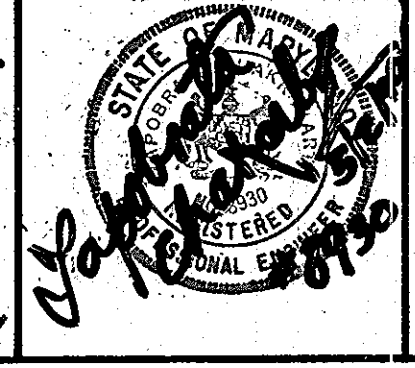

ENGINEER'S CERTIFICATE
I CERTIFY THAT THIS PLAN FOR CONSTRUCTION, EROSION AND SEDIMENT CONTROL REPRESENTS A PRACTICAL AND WORKABLE PLAN BASED ON MY PERSONAL KNOWLEDGE OF THE SITE CONDITIONS. THIS PLAN WAS PREPARED IN ACCORDANCE WITH THE REQUIREMENTS OF THE HOWARD SOIL CONSERVATION DISTRICT.
Tapobrata Chakrabarti 8920 5/2/90
ENGINEER REG. NO. DATE

OWNER / DEVELOPER PARCEL A-18 & A-19
8930 STANFORD BOULEVARD LLC
C/O AMERIX CORPORATION
8930 STANFORD BLVD.
COLUMBIA, MD 21045-5805

DEVELOPER'S CERTIFICATE
I CERTIFY THAT ALL DEVELOPMENT AND/OR CONSTRUCTION WILL BE DONE ACCORDING TO THESE PLANS AND THAT ANY RESPONSIBLE PERSONNEL INVOLVED IN THIS CONSTRUCTION PROJECT WILL HAVE A CERTIFICATE OF ATTENDANCE AT A DEPT. OF ENVIRONMENTAL MGMT. APPROVED TRAINING PROGRAM FOR THE CONTROL OF SEDIMENT AND EROSION BEFORE BEGINNING THE PROJECT. I ALSO AUTHORIZE PERIODIC ON-SITE INSPECTION BY THE HOWARD SOIL CONSERVATION DISTRICT ON THEIR AUTHORIZED AGENTS AS DEEMED NECESSARY. ANY ACTION TAKEN FROM THESE PLANS WILL NOT BE MADE UNLESS AUTHORIZED BY THE HOWARD SOIL CONSERVATION DISTRICT.
James P. Hahn 5/1/90
DATE

PROFILES AND DETAILS FOR COLUMBIA CORPORATE PARK PARCEL A-18 (A RESUBDIVISION OF PARCEL A-16)
TAX MAP 36 PARCEL 356 CAPITAL PROJECT #C-2264
6TH ELECTION DISTRICT MAY 1, 1990
HOWARD COUNTY, MD. SHEET 2 OF 7

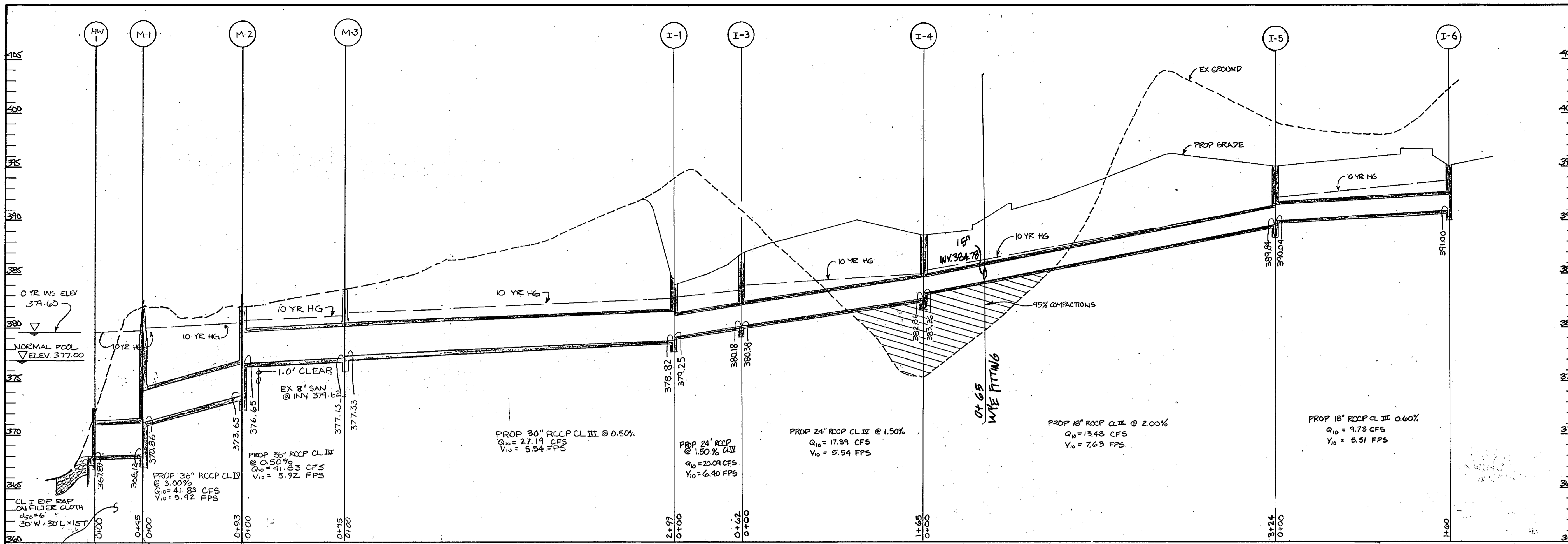

STORM DRAIN PROFILES
SCALE: HORZ. 1" = 50', VERT. 1" = 5'

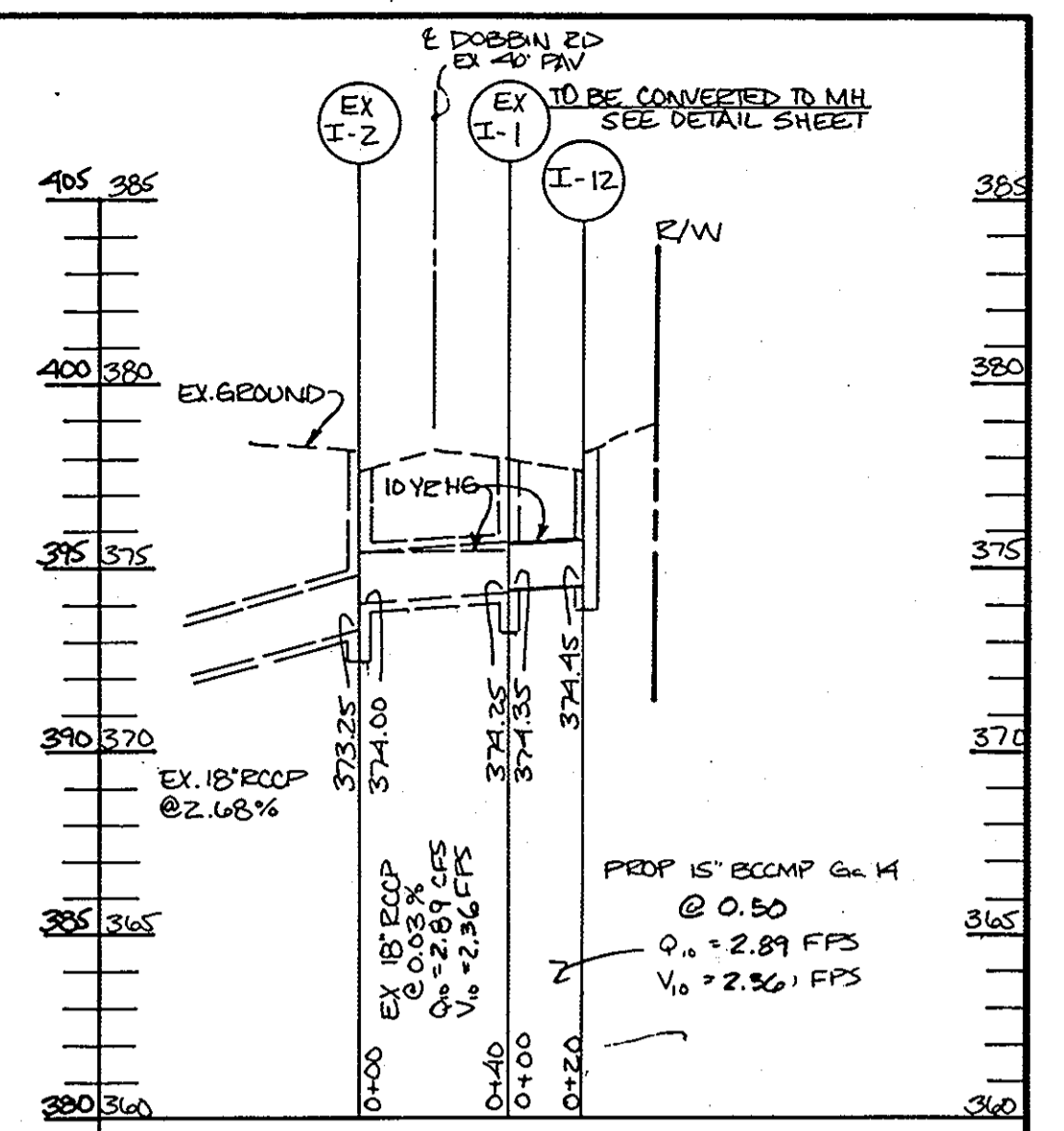

REVISED PROFILES
BY CENTURY ENGINEERING INC.
2-10-90

APPROVED
PLANNING BOARD
OF HOWARD COUNTY
DATE 8-14-90

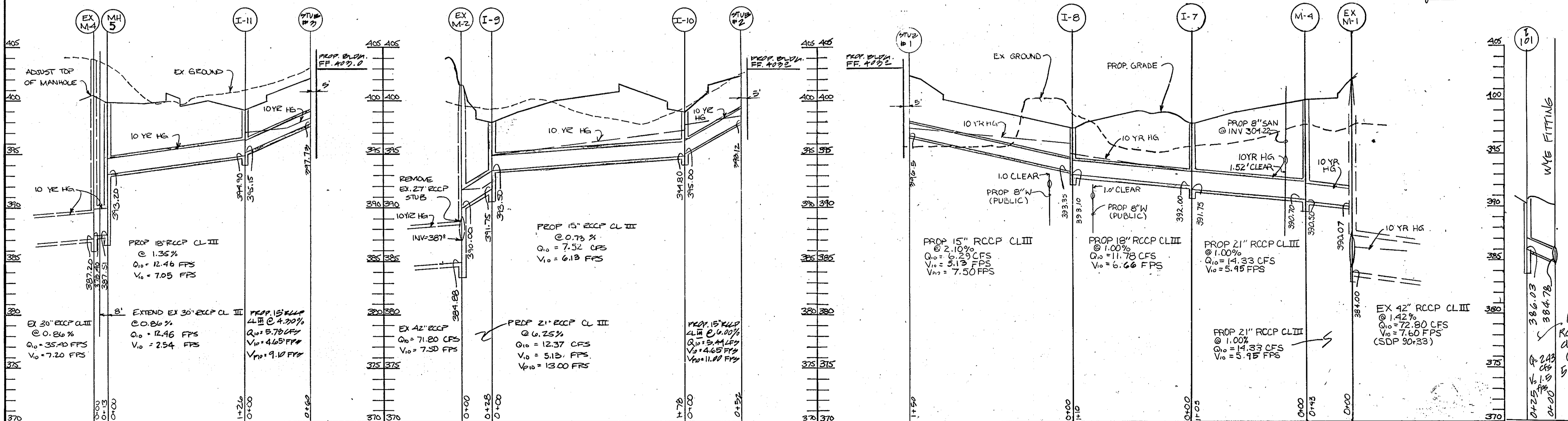

STORM DRAIN PROFILES
SCALE: HORZ. 1" = 50', VERT. 1" = 5'

THESE PLANS HAVE BEEN REVIEWED FOR THE HOWARD SOIL CONSERVATION DISTRICT & MEET THE TECHNICAL REQUIREMENTS FOR SMALL POND CONSTRUCTION SOIL EROSION AND SEDIMENT CONTROL.

James M. Hala 9/15/90
U.S. SOIL CONSERVATION SERVICE DATE

APPROVED: *[Signature]* 9/15/90
HOWARD SOIL CONSERVATION DISTRICT DATE

APPROVED: FOR PUBLIC WATER AND PUBLIC SEWERAGE SYSTEMS
HOWARD COUNTY HEALTH DEPARTMENT.

James P. [Signature] 9-21-90
COUNTY HEALTH OFFICER DATE

APPROVED: HOWARD COUNTY DEPT. OF PLANNING & ZONING.

[Signature] 10-3-90
DIRECTOR DATE

James M. Hala 9/24/90
CHIEF DIVISION OF COMMUNITY PLANNING & LAND DEVELOPMENT

APPROVED: FOR PUBLIC WATER AND PUBLIC SEWERAGE STORM DRAINAGE SYSTEMS AND PUBLIC ROADS HOWARD COUNTY DEPARTMENT OF PUBLIC WORKS.

James P. [Signature] 9/24/90
DIRECTOR DATE

[Signature] 9-12-90
CHIEF BUREAU OF ENGINEERING DATE

GEORGE WILLIAM STEPHENS, JR. AND ASSOCIATES, INC.
CIVIL ENGINEERS & LAND SURVEYORS
658 KENILWORTH DRIVE, SUITE 100
TOWSON, MARYLAND 21204
(301) 825-8120

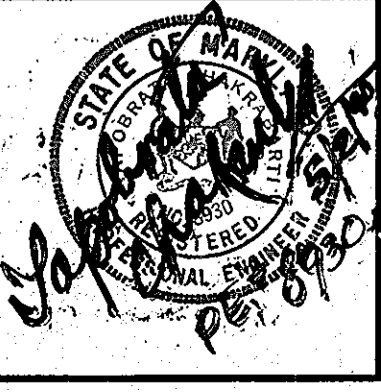

ENGINEER'S CERTIFICATE
I CERTIFY THAT THIS PLAN FOR CONSTRUCTION, EROSION AND SEDIMENT CONTROL REPRESENTS A PRACTICAL AND WORKABLE PLAN BASED ON MY PERSONAL KNOWLEDGE OF THE SITE CONDITIONS. THIS PLAN WAS PREPARED IN ACCORDANCE WITH THE REQUIREMENTS OF THE SITE CONDITIONS. THIS PLAN WAS PREPARED IN ACCORDANCE WITH THE REQUIREMENTS OF THE HOWARD SOIL CONSERVATION DISTRICT.

Tapobrata Chakradarti 8930 5/3/90
ENGINEER REG. NO. DATE
TAPOBRATA CHAKRADARTI

OWNER / DEVELOPER PARCEL A-18 & A-17
8930 STANFORD BOULEVARD LLC
C/O AMERIX CORPORATION
8930 STANFORD BLVD.
COLUMBIA, MD 21045-5805

DEVELOPER'S CERTIFICATE
I CERTIFY THAT ALL DEVELOPMENT AND/OR CONSTRUCTION WILL BE DONE ACCORDING TO THESE PLANS AND THAT ANY RESPONSIBLE PERSONNEL INVOLVED IN THIS CONSTRUCTION PROJECT WILL HAVE A CERTIFICATE OF ATTENDANCE AT A DEPT. OF NATURAL RESOURCES APPROVED TRAINING PROGRAM FOR THE CONTROL OF SEDIMENT AND EROSION BEFORE BEGINNING THE PROJECT. I ALSO AUTHORIZE PERIODIC ON-SITE INSPECTION BY THE HOWARD SOIL CONSERVATION DISTRICT OR THEIR AUTHORIZED AGENTS AS ARE DEEMED NECESSARY. DEVIATION FROM THIS PLAN WILL NOT BE MADE UNLESS AUTHORIZED BY THE HOWARD SOIL CONSERVATION DISTRICT.

DEVELOPER: *[Signature]* DATE: 5/3/90

DESIGNED: N.B.
DRAWN: A.D.
CHECKED: N.B.
PN 6415.

STORM DRAIN PROFILES
COLUMBIA CORPORATE PARK
PARCEL A-18
(A RESUBDIVISION OF PARCEL A-16)
TAX MAP 36 PARCEL 356 CAPITAL PROJECT N C-0264
6TH ELECTION DISTRICT MAY 1, 1990
HOWARD COUNTY, MD. SHEET 3 OF 7

ADDRESS CHART						
BUILDING #	STREET ADDRESS					
	STANFORD BOULEVARD					
SUBDIVISION NAME						
COLUMBIA CORPORATE PARK						
SEWER AREA	LOT/PARCEL #					
	A-18					
PLAT # OR L/F	BLOCK #	ZONE	TAX/ZONE MAP	ELECT. DIST.	CENSUS TRACT	
	1872A	NT	36	G	605.02	
WATER CODE			SEWER CODE			
E06			5533000			

NOTE: THE CONTRACTOR IS RESPONSIBLE FOR THE CLEANOUT AND ANY DAMAGE TO THE EXISTING STORM WATER MANAGEMENT FACILITY DUE TO HIS CONSTRUCTION.

* SEE SHEET #2 FOR SITE DATA AND GENERAL NOTES.
 ** STORM WATER MANAGEMENT IS PROVIDED BY A REGIONAL FOND - SEE SDP 87-193.
 *** PRELIMINARY PLAN FOR COLUMBIA CORP. PARK APPROVED AUGUST 19, 1987 (P87-42)

LEGEND

LEGEND

STONE OUTLET SEDIMENT TRAP #2 S17	
EX. DRAINAGE AREA	-3.96 AC
STORAGE REQUIRED	-71.28 FT ³
STORAGE PROVIDED	-14.15 FT ³
BOTTOM ELEV.	-57.0
WEIR CREST	-57.5
TOP OF EMBANKMENT	-57.8
CLEANOUT ELEV.	-57.8
BOTTOM DIMENSIONS	-55'x60'
SIDE SLOPES	-2:1
LENGTH OF WEIR	-16'

- PROPERTY LINE
- EX. STORM DRAIN
- EX. SANITARY SEWER
- EX. WATER
- EX. CURB & GUTTER
- PROP. CURB & GUTTER
- PROP. STORM DRAIN
- PROP. SANITARY SEWER
- PROP. PUBLIC WATER
- PROP. PRIVATE WATER
- EX. GROUND
- PROP. GRADE
- PROP. HAND SPACE
- NO. PARKING SPACES

DOBBIN ROAD COMMERCIAL CENTER
 SECTION 1 - AREA 1
 PARCEL K
 PLAT # 4875
 COLUMBIA INDUSTRIAL DEVELOPMENT CORPORATION
 SDP - 81-51C
 EX. ZONING - NT

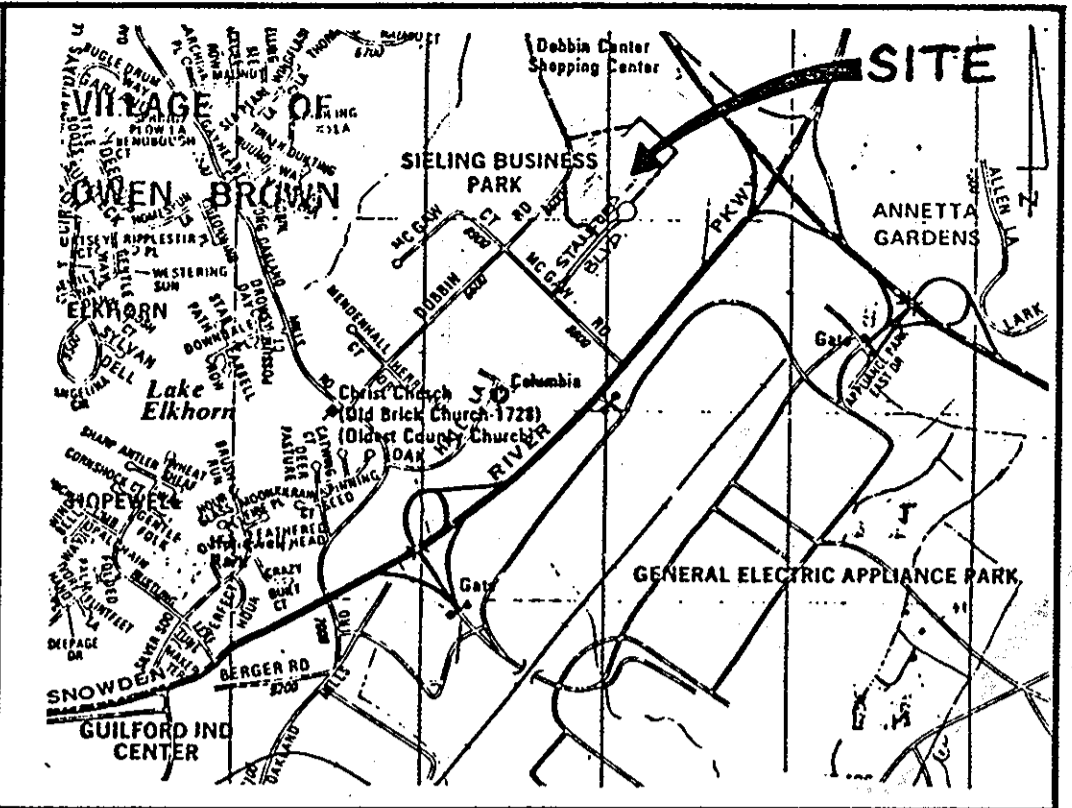

VICINITY MAP

SCALE: 1" = 2000'
 BENCHMARKS:
 BM# 234401 ELEVATION: 307.49
 STANDARD CONCRETE MONUMENT
 SET FLUSH WITH SURFACE
 NORTH 491333.018 EAST 858206.723
 BM# 2343001 ELEVATION: 288.74
 34" R.B. SET 0.3 FT BELOW THE SURFACE
 NORTH 492140.801 EAST 857226.671

PLANNING BOARD
 OF HOWARD COUNTY
 DATE: 8-14-90

THESE PLANS HAVE BEEN REVIEWED FOR THE HOWARD SOIL CONSERVATION DISTRICT & MEET THE TECHNICAL REQUIREMENTS FOR SMALL-POND CONSTRUCTION EROSION AND SEDIMENT CONTROL.

John M. Hester 9-5-90
 SOIL CONSERVATION SERVICE DATE

THESE PLANS FOR SMALL-POND CONSTRUCTION SOIL EROSION AND SEDIMENT CONTROL MEET THE REQUIREMENTS OF HOWARD SOIL CONSERVATION DISTRICT.

APPROVED: *[Signature]* 2/5/90
 HOWARD SOIL CONSERVATION DISTRICT DATE

APPROVED: FOR PUBLIC WATER AND PUBLIC SEWERAGE SYSTEMS
 HOWARD COUNTY HEALTH DEPARTMENT.

John E. Byler 9-25-90
 COUNTY HEALTH OFFICER DATE

APPROVED: HOWARD COUNTY DEPT. OF PLANNING & ZONING.

[Signature] 10.3.90
 DIRECTOR DATE

[Signature] 9/24/90
 CHIEF DIVISION OF COMMUNITY PLANNING & LAND DEVELOPMENT

APPROVED: FOR PUBLIC WATER AND PUBLIC SEWERAGE STORM DRAINAGE SYSTEMS AND PUBLIC ROADS HOWARD COUNTY DEPARTMENT OF PUBLIC WORKS.

[Signature] 9/24/90
 DIRECTOR DATE

[Signature] 9/24/90
 CHIEF BUREAU OF ENGINEERING DATE

THIS PLAN FOR EROSION & SEDIMENT CONTROL BY CENTURY ENGINEERING, INC. (BY CENTURY ENGINEERING 11/23/92)

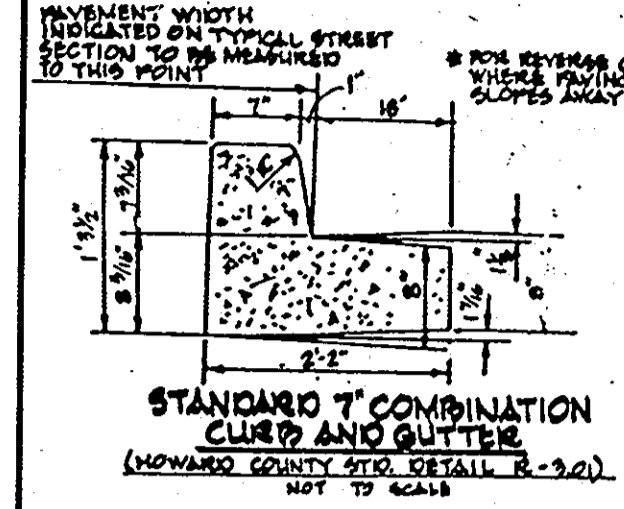

STANDARD T COMBINATION CURB AND GUTTER (HOWARD COUNTY STD. DETAIL R-3-2) NOT TO SCALE

AS SOON AS PROPOSED GRADES ARE REACHED AND PHASE 1 CONTROLS STILL IN PLACE DRAIN THE EXISTING SWM POND BY OPENING THE 12" VALVE INSIDE EX-5-2. INSTALL THE SILT FENCE WHERE THE RIP-RAP APRON IS TO BE INSTALLED DURING A 3 DAY DRY WEATHER FORECAST. INSTALL HW-1 TO MH-1 WHEN HW-1 TO MH-1 IS COMPLETE CLOSE THE 8" VALVE IN EX-5-2 AND REMOVE SILT FENCE FROM INSIDE THE EX. POND. INSTALL THE REMAINDER OF THE STORM DRAIN SYSTEM WORKING FROM DOWNSTREAM TO UPSTREAM. AFTER EACH DAY PLUG THE UNFINISHED EX. END OF THE STORM DRAIN (SEE EX-SHW DETAIL SHEET 2 OF 7)

RIP-RAP OUTLET SEDIMENT TRAP #1	
EX. DRAINAGE AREA	-7.35 AC
STORAGE REQUIRED	-143.07 FT ³
STORAGE PROVIDED	-13.07 FT ³
BOTTOM ELEV.	-56.3
WEIR CREST	-56.7
TOP OF EMBANKMENT	-57.2
CLEANOUT ELEV.	-57.2
BOTTOM DIMENSION	-52'x37'
SIDE SLOPES	-2:1

TOTAL AREA OF SUBMITTALS: 12.39 AC. ±
 TOTAL AREA OF SITE: 414.240 T.I. (10,530 AC. ±)
 EXISTING BUILDING: 87
 PROPOSED USES: OFFICE & BULKHEAD MANUFACTURING
 TOTAL FLOOR AREA: 200 FLOOR 127,733 S.F.
 200 FLOOR 127,733 S.F.
 TOTAL 255,466 S.F.
 PARKING REQUIRED: 2 9.4, 71000 S.F. ± 316 P.A.S.
 PARKING PROVIDED: 579 (INCLUDING 13 LANDSCAPED SPACES)
 TOTAL 579 P.A.S.
 FLOOR AREA RATIO: 157,142/454,240 = .344
 TOTAL 37.70 AC. ±
 BUILDING COVERAGE: 81,059/454,240 = 17.7%
 LANDSCAPED ISLANDS IN PARKING: 19 AC. ±
 AREA TO BE DISTURBED: 10.52 AC. ± PARCELS A-18
 1.25 AC. ± PARCELS A-19
 TOTAL 11.77 AC. ±
 AREA TO BE POSITIVELY STABILIZED: 3.70 AC. ± PARCELS A-18
 3.10 AC. ± PARCELS A-19
 TOTAL 6.80 AC. ±
 AREA OF PARKING LOT: TOTAL 3.10 AC. ±
 AREA OF LANDSCAPED ISLANDS IN PARKING: 19 AC. ±
 LANDSCAPED ISLANDS IN PARKING: 19 AC. ±, 1.44 AC. ±
 BUILDING HEIGHT: 34'

EX. STORM WATER MANAGEMENT FACILITY
 100 YR WS ELEV. 380.41
 SDP 87-193

GEORGE WILLIAM STEPHENS, JR. AND ASSOCIATES, INC.
 CIVIL ENGINEERS & LAND SURVEYORS
 658 KENILWORTH DRIVE, SUITE 100
 TOWSON, MARYLAND 21204
 (301) 825-8120

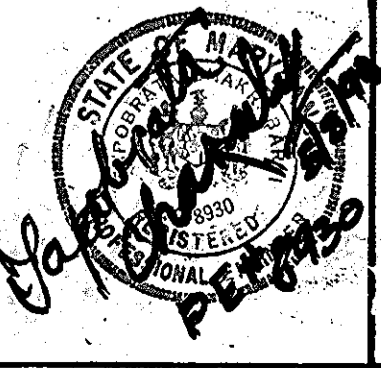

ENGINEER'S CERTIFICATE
 I CERTIFY THAT THIS PLAN FOR CONSTRUCTION, EROSION AND SEDIMENT CONTROL REPRESENTS A PRACTICAL AND WORKABLE PLAN BASED ON MY PERSONAL KNOWLEDGE OF THE SITE CONDITIONS. THIS PLAN WAS PREPARED IN ACCORDANCE WITH THE REQUIREMENTS OF THE SITE CONDITIONS. THIS PLAN WAS PREPARED IN ACCORDANCE WITH THE REQUIREMENTS OF THE HOWARD SOIL CONSERVATION DISTRICT.

[Signature] 5/6/90
 DATE

[Signature] 5/6/90
 DATE

OWNER / DEVELOPER PARCEL A-18 & A-19
 8930 STANFORD BOULEVARD LLC
 C/O AMERIC CORPORATION
 8930 STANFORD BLVD.
 COLUMBIA, MD 21046-8805

DEVELOPER'S CERTIFICATE
 I CERTIFY THAT ALL DEVELOPMENT AND/OR CONSTRUCTION WILL BE DONE ACCORDING TO THESE PLANS AND THAT ANY RESPONSIBLE PERSONNEL INVOLVED IN THIS CONSTRUCTION PROJECT WILL HAVE A CERTIFICATE OF ATTENDANCE AT A DEPT. OF ENVIRONMENT APPROVED TRAINING PROGRAM FOR THE CONTROL OF SEDIMENT AND EROSION BEFORE BEGINNING THE PROJECT. I ALSO AUTHORIZE PERIODIC ON-SITE INSPECTION BY THE HOWARD SOIL CONSERVATION DISTRICT OR THEIR AUTHORIZED AGENTS AS ARE DETERMINED NECESSARY FROM THIS PLAN WILL NOT BE MADE UNLESS AUTHORIZED BY THE HOWARD SOIL CONSERVATION DISTRICT.

[Signature] 5/1/90
 DATE

DESIGNED: N.B.
 DRAWN: A.D.
 CHECKED:

PHASE I SEDIMENT & EROSION CONTROL PLAN FOR
COLUMBIA CORPORATE PARK
 PARCEL A-18
 (A RESUBDIVISION OF PARCEL A-16)
 TAX MAP 36 PARCEL 356 CAPITAL PROJECT #C-0264
 6TH ELECTION DISTRICT MAY 1, 1990
 HOWARD COUNTY, MD SHEET 4 OF 7

ADDRESS CHART	
BUILDING / STREET ADDRESS	STANFORD BOULEVARD
SUBDIVISION NAME	COLUMBIA CORPORATE PARK
PLAT # OR L/E / BLOCK #	10424
WATER CODE	E06
SEWER CODE	6333000

* SEE SHEET #2 FOR SITE DATA AND GENERAL NOTES.
 ** STEM WATER MANAGEMENT IS PROVIDED BY A REGIONAL FOND - SEE SDP 87-193.
 *** PRELIMINARY PLAN FOR COLUMBIA CORP. PARK APPROVED AUGUST 19, 1987. (P87-47)

LEGEND

- PROPERTY LINE
- EX. STORM DRAIN
- EX. SANITARY SEWER
- EX. WATER
- EX. CURB & GUTTER
- PROP. CURB & GUTTER
- PROP. STORM DRAIN
- PROP. SANITARY SEWER
- PROP. PUBLIC WATER
- PROP. PRIVATE WATER
- EX. GROUND
- PROP. GRADE
- PROP. HAZ. SPACE
- NO. PARKING SPACES

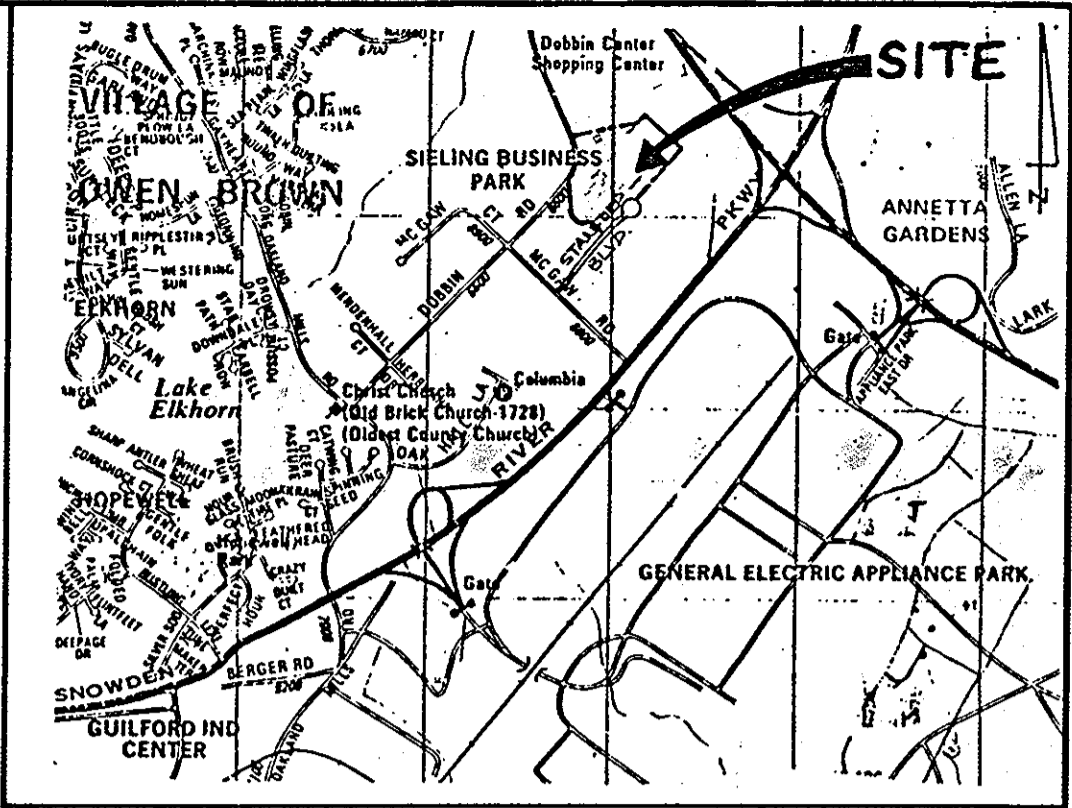

VICINITY MAP

SCALE: 1" = 2000'
 BENCHMARKS:
 BM # 234401 ELEVATION: 307.49
 STANDARD CONCRETE MONUMENT SET FLUSH WITH SURFACE
 NORTH 491333.018 EAST 858206.723
 BM # 2343001 ELEVATION: 288.21
 34" R.B. SET 0.3FT BELOW THE SURFACE
 NORTH 492140.801 EAST 857226.671

APPROVED PLANNING BOARD OF HOWARD COUNTY

DATE: 8-14-90

J.B.

THESE PLANS HAVE BEEN REVIEWED FOR THE HOWARD SOIL CONSERVATION DISTRICT & MEET THE TECHNICAL REQUIREMENTS FOR SMALL-POND-CONSTRUCTION SOIL EROSION AND SEDIMENT CONTROL.

James M. Attie 9-5-90
 U.S. SOIL CONSERVATION SERVICE DATE

THESE PLANS FOR SMALL-POND-CONSTRUCTION SOIL EROSION AND SEDIMENT CONTROL MEET THE REQUIREMENTS OF HOWARD SOIL CONSERVATION DISTRICT.

APPROVED: *John H. Hays* 9/5/90
 HOWARD SOIL CONSERVATION DISTRICT DATE

PLAN NUMBER

APPROVED: FOR PUBLIC WATER AND PUBLIC SEWERAGE SYSTEMS
 HOWARD COUNTY HEALTH DEPARTMENT.

Joan Berlin 9-25-90
 COUNTY HEALTH OFFICER DATE

APPROVED: HOWARD COUNTY DEPT. OF PLANNING & ZONING.

Arks 10-3-90
 DIRECTOR DATE

Paul J. Wampler 9/24/90
 CHIEF DIVISION OF COMMUNITY PLANNING & LAND DEVELOPMENT DATE

APPROVED: FOR PUBLIC WATER AND PUBLIC SEWERAGE STORM DRAINAGE SYSTEMS AND PUBLIC WORKS HOWARD COUNTY DEPARTMENT OF PUBLIC WORKS.

James J. ... 9/20/90
 DIRECTOR DATE

... 9-18-90
 CHIEF BUREAU OF ENGINEERING DATE

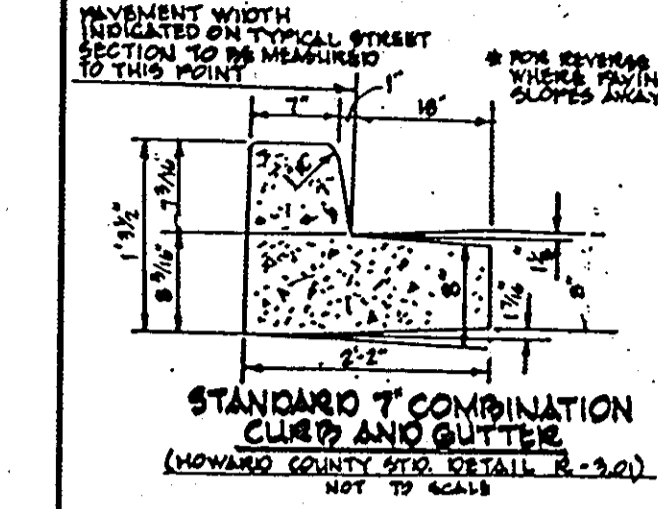

LEGEND

- LIMIT OF DISTURBANCE
- BAKED DIRT
- SILT FENCE
- INLET PROTECTION
- STABILIZED ENTRANCE
- ENTRANCE
- MOUNTAINOUS BERM

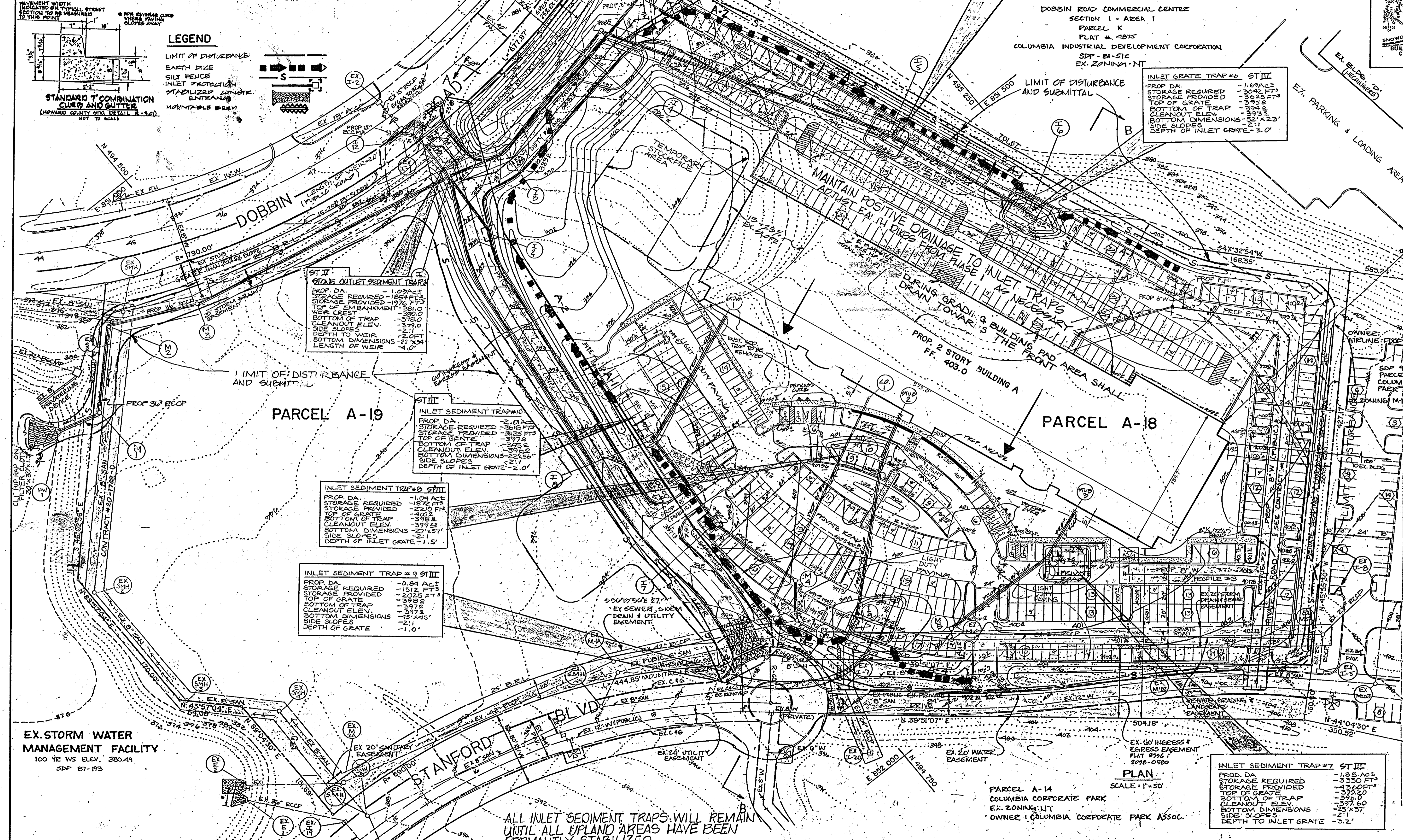

INLET SEDIMENT TRAP #4 ST III

PROP. DA.	-1.76 AC
STORAGE REQUIRED	-238 FT ³
STORAGE PROVIDED	-3788 FT ³
TOP OF GRATE	-388.2
BOTTOM OF TRAP	-387.2
CLEANOUT ELEV.	-387.2
BOTTOM DIMENSION	-17'6"
SIDE SLOPES	-2:1
DEPTH OF INLET GRATE	-1.5'

INLET SEDIMENT TRAP #5 ST III

PROP. DA.	-0.66 AC
STORAGE REQUIRED	-1188 FT ³
STORAGE PROVIDED	-349 FT ³
TOP OF GRATE	-395.8
BOTTOM OF TRAP	-394.8
CLEANOUT ELEV.	-394.8
BOTTOM DIMENSIONS	-10'x30'
SIDE SLOPES	-2:1
DEPTH OF INLET GRATE	-1.0'

INLET GRATE TRAP #6 ST III

PROP. DA.	-1.62 AC
STORAGE REQUIRED	-3042 FT ³
STORAGE PROVIDED	-3625 FT ³
TOP OF GRATE	-394.8
BOTTOM OF TRAP	-393.8
CLEANOUT ELEV.	-393.8
BOTTOM DIMENSIONS	-12'x23'
SIDE SLOPES	-2:1
DEPTH OF INLET GRATE	-3.0'

ST IV GRADE OUTLET SEDIMENT TRAP

PROP. DA.	-1.02 AC
STORAGE REQUIRED	-1854 FT ³
STORAGE PROVIDED	-1974 FT ³
TOP OF EMBANKMENT	-381.0
TOP OF GRATE	-380.0
BOTTOM OF TRAP	-379.0
CLEANOUT ELEV.	-379.0
DEPTH TO WEIR	-2.0 FT
BOTTOM DIMENSIONS	-22'x34'
LEAK OF WEIR	-4.0'

ST III INLET SEDIMENT TRAP #10

PROP. DA.	-2.04 AC
STORAGE REQUIRED	-3616 FT ³
STORAGE PROVIDED	-3716 FT ³
TOP OF GRATE	-397.8
BOTTOM OF TRAP	-397.8
CLEANOUT ELEV.	-397.8
BOTTOM DIMENSIONS	-22'x56'
SIDE SLOPES	-2:1
DEPTH OF INLET GRATE	-2.0'

INLET SEDIMENT TRAP #8 ST III

PROP. DA.	-1.01 AC
STORAGE REQUIRED	-1870 FT ³
STORAGE PROVIDED	-2210 FT ³
TOP OF GRATE	-398.8
BOTTOM OF TRAP	-397.8
CLEANOUT ELEV.	-397.8
BOTTOM DIMENSIONS	-21'x51'
SIDE SLOPES	-2:1
DEPTH OF INLET GRATE	-1.5'

INLET SEDIMENT TRAP #9 ST III

PROP. DA.	-0.84 AC
STORAGE REQUIRED	-1512 FT ³
STORAGE PROVIDED	-2025 FT ³
TOP OF GRATE	-397.8
BOTTOM OF TRAP	-397.2
CLEANOUT ELEV.	-397.2
BOTTOM DIMENSIONS	-21'x51'
SIDE SLOPES	-2:1
DEPTH OF GRATE	-1.0'

INLET SEDIMENT TRAP #7 ST III

PROP. DA.	-1.65 AC
STORAGE REQUIRED	-3330 FT ³
STORAGE PROVIDED	-4350 FT ³
TOP OF GRATE	-396.0
BOTTOM OF TRAP	-396.0
CLEANOUT ELEV.	-396.0
BOTTOM DIMENSIONS	-25'x45'
SIDE SLOPES	-2:1
DEPTH TO INLET GRATE	-3.2'

ALL INLET SEDIMENT TRAPS WILL REMAIN UNTIL ALL UPLAND AREAS HAVE BEEN PERMANENTLY STABILIZED.

GEORGE WILLIAM STEPHENS, JR. AND ASSOCIATES, INC.
 CIVIL ENGINEERS & LAND SURVEYORS
 658 KENILWORTH DRIVE, SUITE 100
 TOWSON, MARYLAND 21204
 (301) 825-8120

ENGINEER'S CERTIFICATE
 I CERTIFY THAT THIS PLAN FOR CONSTRUCTION, EROSION AND SEDIMENT CONTROL REPRESENTS A PRACTICAL AND WORKABLE PLAN BASED ON MY PERSONAL KNOWLEDGE OF THE SITE CONDITIONS. THIS PLAN WAS PREPARED IN ACCORDANCE WITH THE REQUIREMENTS OF THE SITE CONDITIONS. THIS PLAN WAS PREPARED IN ACCORDANCE WITH THE REQUIREMENTS OF THE HOWARD SOIL CONSERVATION DISTRICT.
Tapodraja Chakrabarti 5/2/90
 REG. NO. DATE

OWNER / DEVELOPER PARCEL A-18 & A-19
 8930 STANFORD BOULEVARD LLC
 C/O AMERIX CORPORATION
 8930 STANFORD BLVD.
 COLUMBIA, MD 21045-3805

DEVELOPER'S CERTIFICATE
 I CERTIFY THAT ALL DEVELOPMENT AND/OR CONSTRUCTION WILL BE DONE ACCORDING TO THESE PLANS AND THAT ANY RESPONSIBLE PERSONNEL INVOLVED IN THIS CONSTRUCTION PROJECT WILL HAVE A CERTIFICATE OF ATTENDANCE AT A DEPT. OF ENVIRONMENT APPROVED TRAINING PROGRAM FOR THE CONTROL OF SEDIMENT AND EROSION BEFORE BEGINNING THE PROJECT. I ALSO AUTHORIZE PERIODIC ON-SITE INSPECTION BY THE HOWARD SOIL CONSERVATION DISTRICT OR THEIR AUTHORIZED AGENTS AS AND WHEN NECESSARY. NO DEVIATION FROM THE PLANS WILL BE MADE UNLESS AUTHORIZED BY THE HOWARD SOIL CONSERVATION DISTRICT.
steph
 DEVELOPER: DATE

DESIGNED: N.B.
 DRAWN: A.D.
 CHECKED:

PHASE II SEDIMENT AND EROSION CONTROL PLAN
 FOR
COLUMBIA CORPORATE PARK
 PARCEL A-18
 (A RESUBDIVISION OF PARCEL A-16)
 TAX MAP 36 PARCEL 356 CAPITAL PROJECT #C-0264
 6TH ELECTION DISTRICT MAY 1, 1990
 HOWARD COUNTY, MD. SHEET 5 OF 7

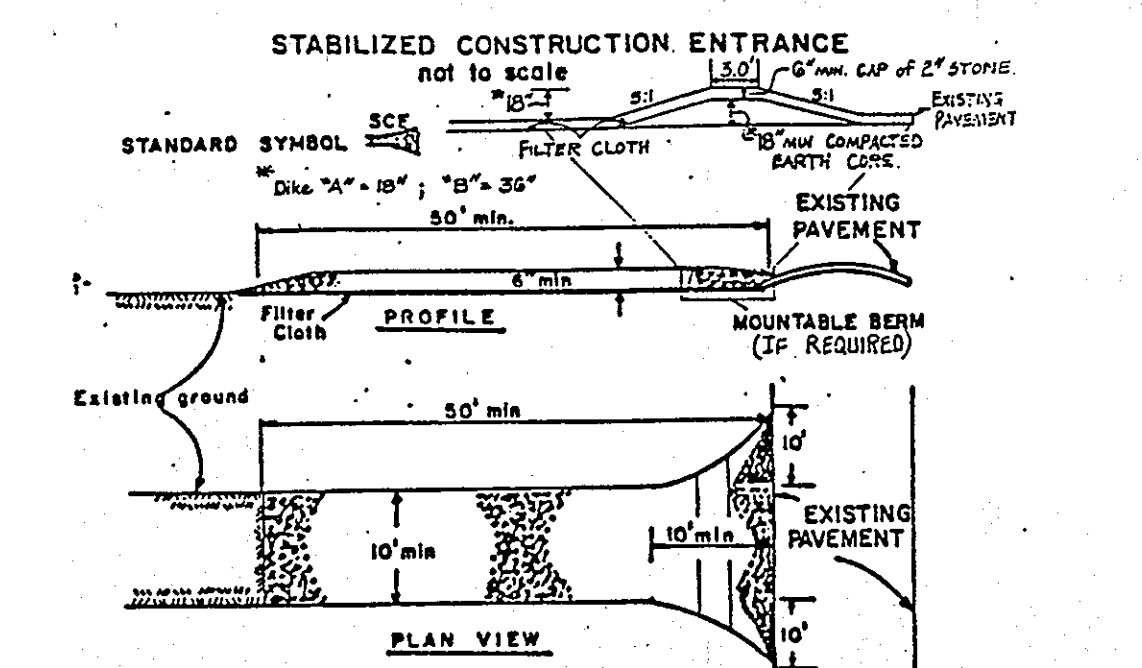
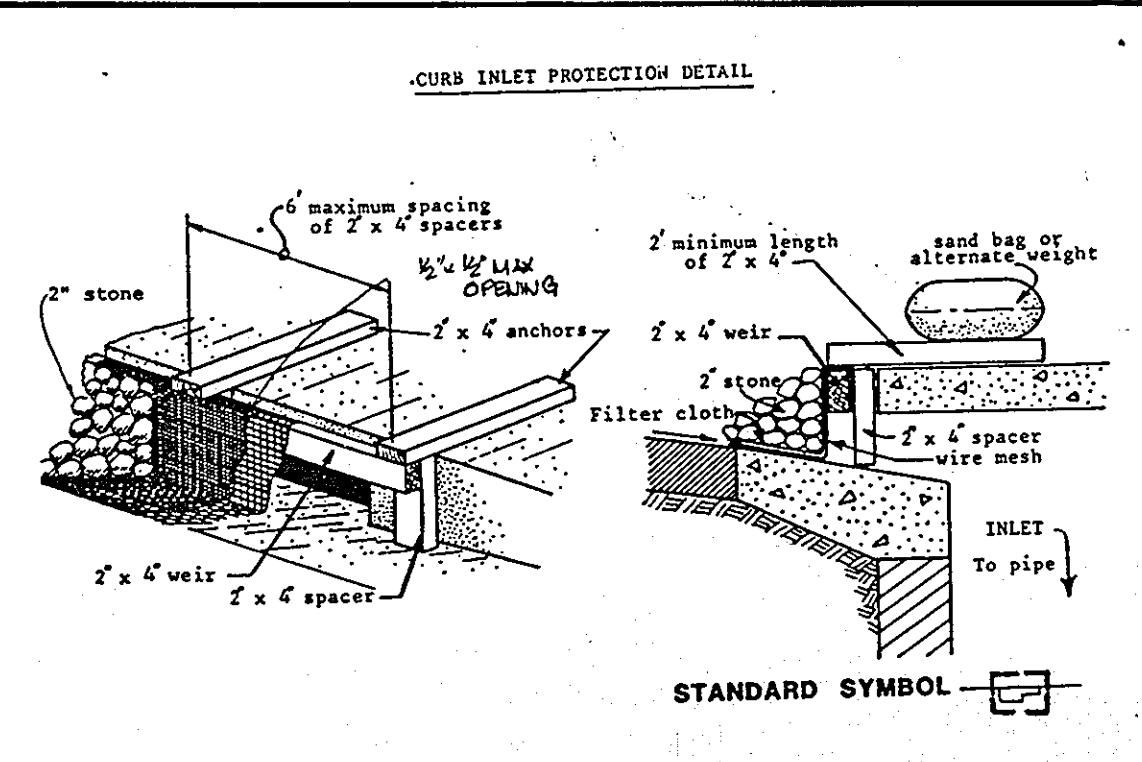

CONSTRUCTION SPECIFICATIONS

- Stone Size - Use 2" stone, or recycled or recycled concrete equivalent.
- Length - As required, but not less than 50 ft. (except on a single residence lot where a 30 ft. minimum length would apply).
- Thickness - Not less than six (6) inches.
- Width - Ten (10) ft. minimum, but not less than the full width at points where ingress or egress occurs.
- Filter Cloth - Will be placed over the entire area prior to placing of stone. Filter will not be required on a single family residence lot.
- Surface Water - All surface water flowing or diverted toward construction entrances shall be piped across the entrance. If piping is impractical, a mounded berm with 5:1 slopes will be permitted.
- Maintenance - The entrance shall be maintained in a condition which will prevent tracking or dragging of sediment on public right-of-way. This may require periodic top dressing with additional stone as conditions demand and repair and/or cleaning of any measures used to trap sediment. All sediment spilled, dropped, washed or tracked onto public right-of-way must be removed immediately.
- Washing - Wheels shall be cleaned to remove sediment prior to entrance onto public right-of-way. When washing is required, it shall be done on an area stabilized with stone and which drains into an approved sediment trapping device.
- Periodic inspection and needed maintenance shall be provided after each rain.

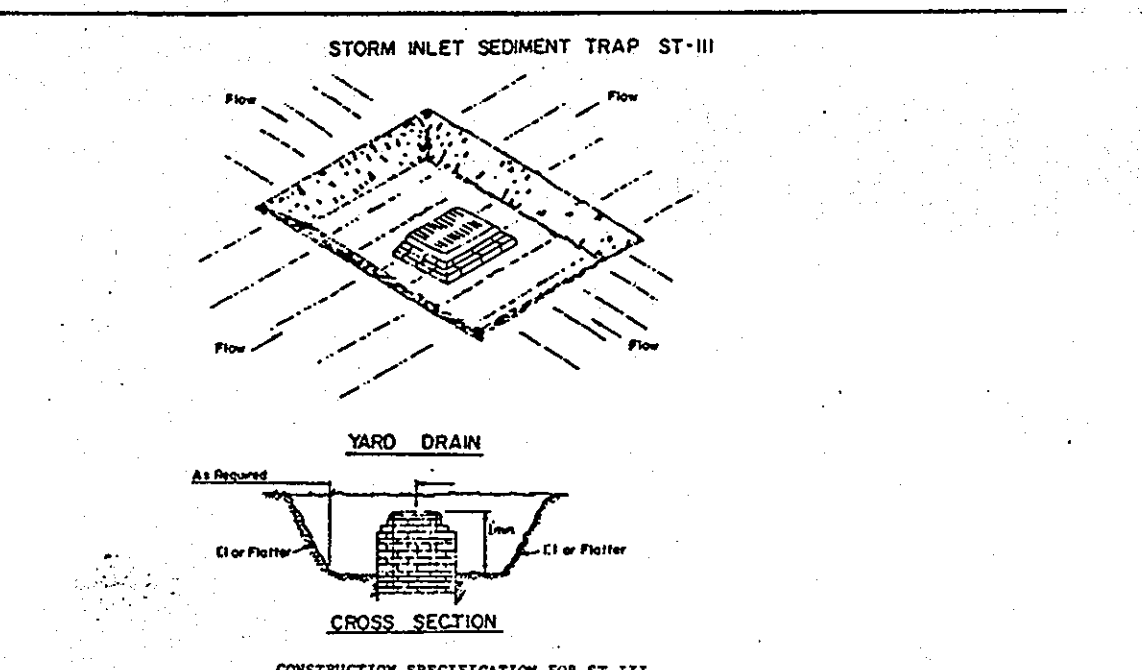

CONSTRUCTION SPECIFICATION FOR ST-III

- Sediment shall be removed and the trap returned to its original dimensions when the sediment has accumulated to 1/2 the design depth of the trap. Removed sediment shall be deposited in a suitable area and in such a manner that it will not erode.
- The volume of sediment storage shall be 1000 cubic feet per acre of contributory drainage.
- The structure shall be inspected after each rain and repairs made as needed.
- Construction operations shall be carried out in such a manner that erosion and water pollution will be minimized.
- The sediment trap shall be removed and the area stabilized when the construction drainage area has been properly stabilized.
- All cut slopes shall be 1:1 or flatter.

Maximum Drainage Area: 3 Acres

SEQUENCE OF OPERATION

- OBTAIN GRADING PERMIT.
- NOTIFY HOWARD COUNTY DEPARTMENT OF INSPECTIONS, PERMIT INSPECTOR 48 HOURS PRIOR TO BEGINNING WORK. (2 DAYS)
- INSTALL STABILIZED CONSTRUCTION ENTRANCE #1 AND #2. (1 DAY)
- CLEAN AND GRUB FOR SEDIMENT CONTROL DEVICES. (1 DAY)
- INSTALL BERM & SEDIMENT CONTROL DEVICES. (3 DAYS)
- WITH THE APPROVAL OF THE INSPECTOR BEGIN GRADING. MAINTAIN CONSTRUCTION ENTRANCES TOWARD BERM SEDIMENT TRAPS. (21 DAYS)
- AS SOON AS PROPOSED GRADES ARE APPROXIMATELY INSTALLED UTILITIES, THE STORM WATER MANAGEMENT POOL SHALL BE GRADED BY OPENING THE 12" GATE VALVE AT THE BOTTOM OF THE EXISTING S-2. S-1 TO S-1 SHOULD BE INSTALLED DURING A THREE DAY DRY WEATHER FORECAST. AS SOON AS THIS IS COMPLETE REMOVE ANY SLICE FENCE FROM THE EXISTING STORM WATER MANAGEMENT POOL AND STABILIZE THE SLOPE. CLOSE THE 8" GATE VALVE INSIDE EXISTING S-2. CONTINUE INSTALLATION OF THE STORM DRAIN SYSTEM FOLLOWS THE TOP OF THE PIPE AT THE END OF EACH DAY (SEE DETAIL SHEET 2 OF 7). ALL TRAILS AND HANDLES MUST BE PROTECTED AS PER CONSTRUCTION PROGRESS THROUGH PHASE 1. (21 DAYS)
- ONCE THE STORM DRAIN IS COMPLETE INSTALL SEDIMENT TRAP 1 THROUGH TRAP 10 ACCORDING TO THE PHASE 3 PLAN. THE SEDIMENT CONTROL INSPECTOR MUST BE NOTIFIED BEFORE ANY PHASE 1 SEDIMENT CONTROL DEVICES ARE REMOVED OR CHANGED. AUTOMATICALLY REMOVE STABILIZED AREAS AS SHOWN ON THE PHASE 3 PLAN. THE PHASE 3 PLAN. INSTALL AND MAINTAIN SEDIMENT CONTROL DEVICES AS SHOWN ON THE PHASE 3 PLAN. WITH THE APPROVAL OF THE INSPECTOR TRAPS 1 AND 2 CAN BE REMOVED ALONG WITH THE EXISTING DRAIN TO POINT 1. STABILIZED CONSTRUCTION ENTRANCE #2 MUST ALSO BE REMOVED TO ALLOW CONSTRUCTION OF STORM OUTLET SEDIMENT TRAP #2. (3 DAYS)
- FINISH GRADING AND REMAINING AREAS. STABILIZE AREAS NOT RECEIVING DRAINAGE. (5 DAYS)
- REMOVE BUILDING FOUNDATION. (21 DAYS)
- INSTALL CURB AND GUTTER. (14 DAYS)
- INSTALL SURFACE IN ACCORD TO BE MAINTAINED. (14 DAYS)
- ONCE ALL AREAS HAVE BEEN STABILIZED AND WITH PERMISSION FROM THE INSPECTOR ALL SEDIMENT CONTROL DEVICES MAY BE REMOVED. INSTALL STORM DRAINAGE IN REMAINING AREAS. COMPLETE DRAINAGE OPERATIONS. (6 DAYS)

GEORGE WILLIAM STEPHENS, JR. AND ASSOCIATES, INC.
 CIVIL ENGINEERS & LAND SURVEYORS
 658 KENILWORTH DRIVE, SUITE 100
 TOWSON, MARYLAND 21204
 (301) 825-8120

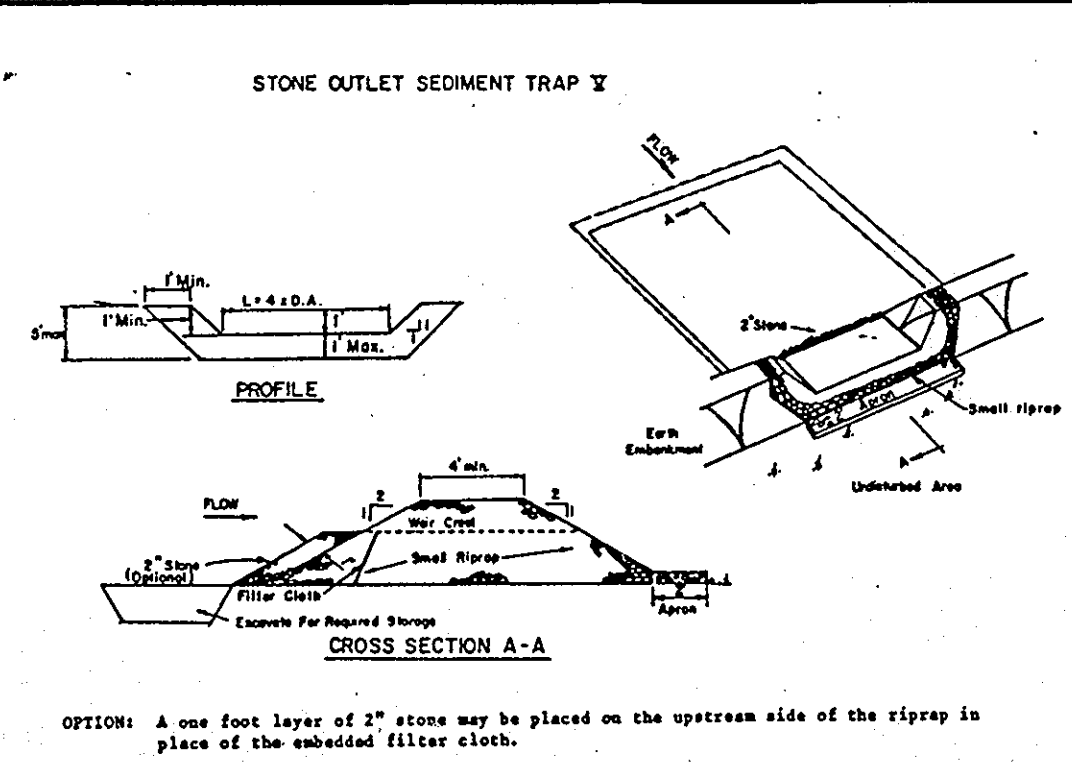

CONSTRUCTION SPECIFICATIONS FOR ST-V

- Area under embankment shall be cleared, grubbed and stripped of any vegetation and root mat. The pool area shall be cleared.
- The fill material for the embankment shall be free of roots and other woody vegetation as well as over-sized stones, rocks, organic material or other objectionable material. The embankment shall be compacted by treading with equipment while it is being constructed.
- All cut and fill slopes shall be 2:1 or flatter.
- The stone used in the outlet shall be either two (2) inch or 1 1/2 inch thickness of 2" aggregate placed on the upstream side on the small riprap or embedded filter cloth in the riprap.
- Sediment shall be removed and trap returned to its original dimensions when the sediment has accumulated to 1/2 the design depth of the trap.
- The structure shall be inspected after each rain and repairs made as needed.
- Construction operations shall be carried out in such a manner that erosion and water pollution is minimized.
- The structure shall be removed and the area stabilized when the drainage area has been properly stabilized.

Maximum Drainage Area: 5 Acres

SEDIMENT CONTROL NOTES

- A minimum of 24 hours notice must be given to the Howard County Office of Inspection and Permits prior to the start of any construction. (992-2427).
- All vegetative and structural practices are to be maintained according to the provisions of this plan and are to be in conformance with the 1983 MARYLAND STANDARDS AND SPECIFICATIONS FOR SOIL EROSION AND SEDIMENT CONTROL.
- Following initial soil disturbance or disturbance, permanent or temporary stabilization shall be completed within: a) 7 calendar days for all perimeter sediment control structures, ditches, perimeter slopes and all slopes greater than 3:1, b) 14 days as to all other disturbed or graded areas on the project site.
- All sediment traps/basins shall be fenced and warning signs posted around their perimeter in accordance with Item 11, Chapter 13 of the HOWARD COUNTY DESIGN MANUAL, Storm Drainage.
- All disturbed areas must be stabilized within the time period specified above in accordance with the 1983 MARYLAND STANDARDS AND SPECIFICATIONS FOR SOIL EROSION AND SEDIMENT CONTROL for permanent seedings (Sec. 31) and (Sec. 32), temporary seedings (Sec. 30) and mulching (Sec. 32). Temporary stabilization with mulch alone can only be done when recommended seeding dates do not allow for proper germination and establishment of grasses.
- All sediment control structures are to remain in place and are to be maintained in operative condition until permission for their removal has been obtained from the Howard County Sediment Control Inspector.
- Site Analysis:
 Total Area of Site: 10.52 Acres
 Area Disturbed: 2.05 Acres
 Area to be roofed or paved: 0.50 Acres
 Area to be vegetatively stabilized: 8.00 Acres
 Total Cut: 2.05 Acres
 Total Fill: 0.50 Acres
 Office space/burrow area: 0.07 Acres
- Any sediment control practice which is disturbed by grading activity for placement of utilities must be repaired on the same day of disturbance.
- Additional sediment controls must be provided, if deemed necessary by the Howard County DWS sediment control inspector.
- On all sites with disturbed areas in excess of 2 acres, approval of the inspection agency shall be requested upon completion of installation of perimeter erosion and sediment controls, but before proceeding with any other earth disturbance or grading. Other building or grading inspection approvals may be withheld until this initial approval by the inspection agency is made.

PERMANENT SEEDING NOTES

Apply to graded or cleared areas not subject to immediate further disturbance where a permanent long-lived vegetative cover is needed.

Seedbed Preparation: Loosen upper three inches of soil by raking, disking or other acceptable means before seeding, if not previously loosened.

Soil Amendment: In lieu of soil test recommendations, use one of the following schedules:

- Preferred** - Apply 2 tons per acre dolomitic limestone (92 lb/1000 sq ft) and 600 lb per acre 10-10-10 fertilizer (14 lb/1000 sq ft) before seeding. Harrow or disk into upper three inches of soil. At time of seeding, apply 400 lb per acre 10-0-0 urethane fertilizer (9 lb/1000 sq ft).
- Acceptable** - Apply 2 tons per acre dolomitic limestone (92 lb/1000 sq ft) and 1000 lb per acre 10-10-10 fertilizer (23 lb/1000 sq ft) before seeding. Harrow or disk into upper three inches of soil.

Seeding - For the periods March 1 thru April 30, and August 1 thru October 15, seed with 60 lb per acre (1.4 lb/1000 sq ft) of Kentucky 31 Tall Fescue. For the period May 1 thru July 31, seed with 60 lb Kentucky 31 Tall Fescue per acre and 2 lb per acre (0.5 lb/1000 sq ft) of weeping lovegrass. During the period of October 16 thru February 29, plant site by Option (a) 2 tons per acre of well anchored straw mulch and seed as soon as possible in the spring. Option (b) Seed with 60 lb/acre Kentucky 31 Tall Fescue and mulch with 2 tons/acre well anchored straw.

Mulching - Apply 1-1/2 to 2 tons per acre (70 to 90 lb/1000 sq ft) of untreated small grain straw immediately after seeding. Anchor mulch immediately after application using such anchoring tool of 218 gallons per acre (5 gal/1000 sq ft) of emulsified asphalt on flat areas. On slopes 2 feet or higher, use 348 gallons per acre (9 gal/1000 sq ft) for anchoring.

Maintenance - Inspect all seeded areas and make needed repairs, replacements and touchings.

TEMPORARY SEEDING NOTES

Apply to graded or cleared areas likely to be redistributed where a short-term vegetative cover is needed.

Seedbed Preparation: Loosen upper three inches of soil by raking, disking or other acceptable means before seeding, if not previously loosened.

Soil Amendment: - Apply 60 lb per acre 10-10-10 fertilizer (14 lb/1000 sq ft) and 2 1/2 bushels per acre of annual soy (3.2 lb/1000 sq ft). For the period May 1 thru August 31, seed with 1 lb per acre of weeping lovegrass (0.7 lb/1000 sq ft). For the period November 16 thru February 29, protect site by applying 2 tons per acre of well anchored straw mulch and seed as soon as possible in the spring, or use sod.

Mulching - Apply 1-1/2 to 2 tons per acre (70 to 90 lb/1000 sq ft) of untreated small grain straw immediately after seeding. Anchor mulch immediately after application using such anchoring tool of 218 gal per acre (5 gal/1000 sq ft) of emulsified asphalt on flat areas. On slopes 2 ft or higher, use 348 gal per acre (9 gal/1000 sq ft) for anchoring.

Refer to the 1983 MARYLAND STANDARDS AND SPECIFICATIONS FOR SOIL EROSION AND SEDIMENT CONTROL for rate and methods not covered.

ENGINEER'S CERTIFICATE
 I CERTIFY THAT THIS PLAN FOR CONSTRUCTION, EROSION AND SEDIMENT CONTROL REPRESENTS A PRACTICAL AND WORKABLE PLAN BASED ON MY PERSONAL KNOWLEDGE OF THE SITE CONDITIONS. THIS PLAN WAS PREPARED IN ACCORDANCE WITH THE REQUIREMENTS OF THE SIZT CONDITIONS. THIS PLAN WAS PREPARED IN ACCORDANCE WITH THE REQUIREMENTS OF THE HOWARD SOIL CONSERVATION DISTRICT.
 George William Stephens, Jr.
 CIVIL ENGINEER
 REG. NO. 2930
 DATE: 5/14/90

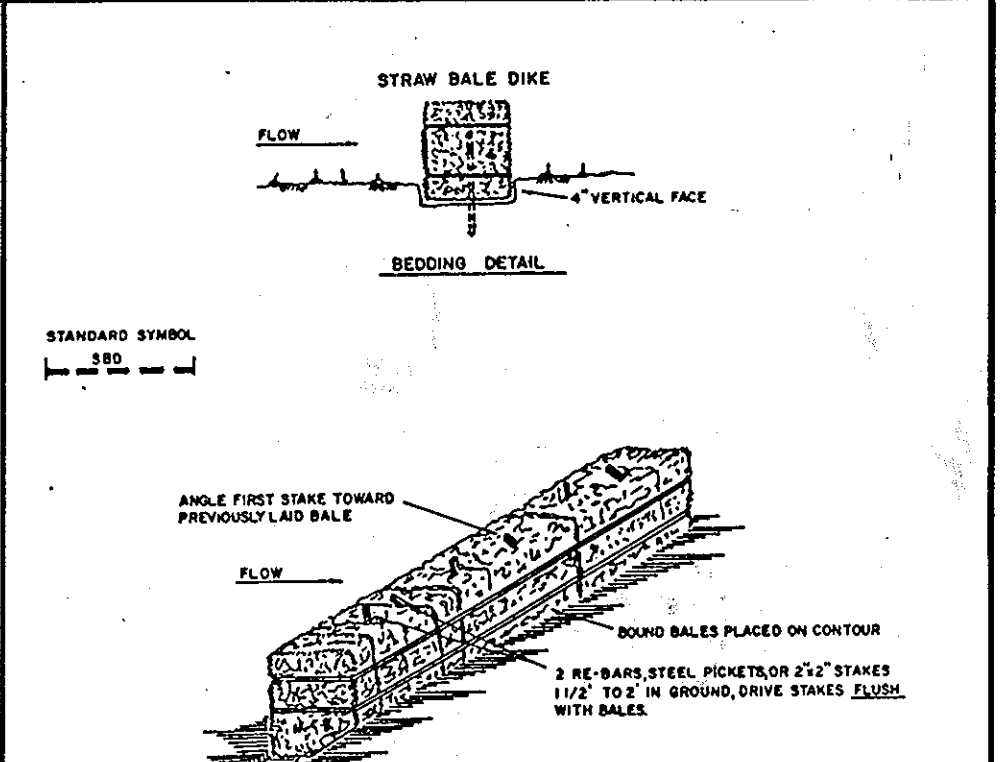

CONSTRUCTION SPECIFICATIONS FOR ST-VI

- Bales shall be placed at the toe of a slope or on the contour and in a row with ends tightly abutting the adjacent bales. Bales may be flatter if desired to facilitate processing by construction traffic.
- Each bale shall be perpendicular in the soil a minimum of (6) inches, and placed so the bindings are horizontal.
- Bales shall be securely anchored in place by either two (2) stakes or 16-gauge driven through the bales. The first stake in each row shall be driven toward the perimeter and the second stake in each row shall be driven toward the center of the dike. Stakes shall be driven flush with the bales.
- Inspection shall be frequent and repair replacement shall be made promptly as needed.
- Bales shall be removed when they have served their usefulness so as not to block or impede storm flow or drainage.

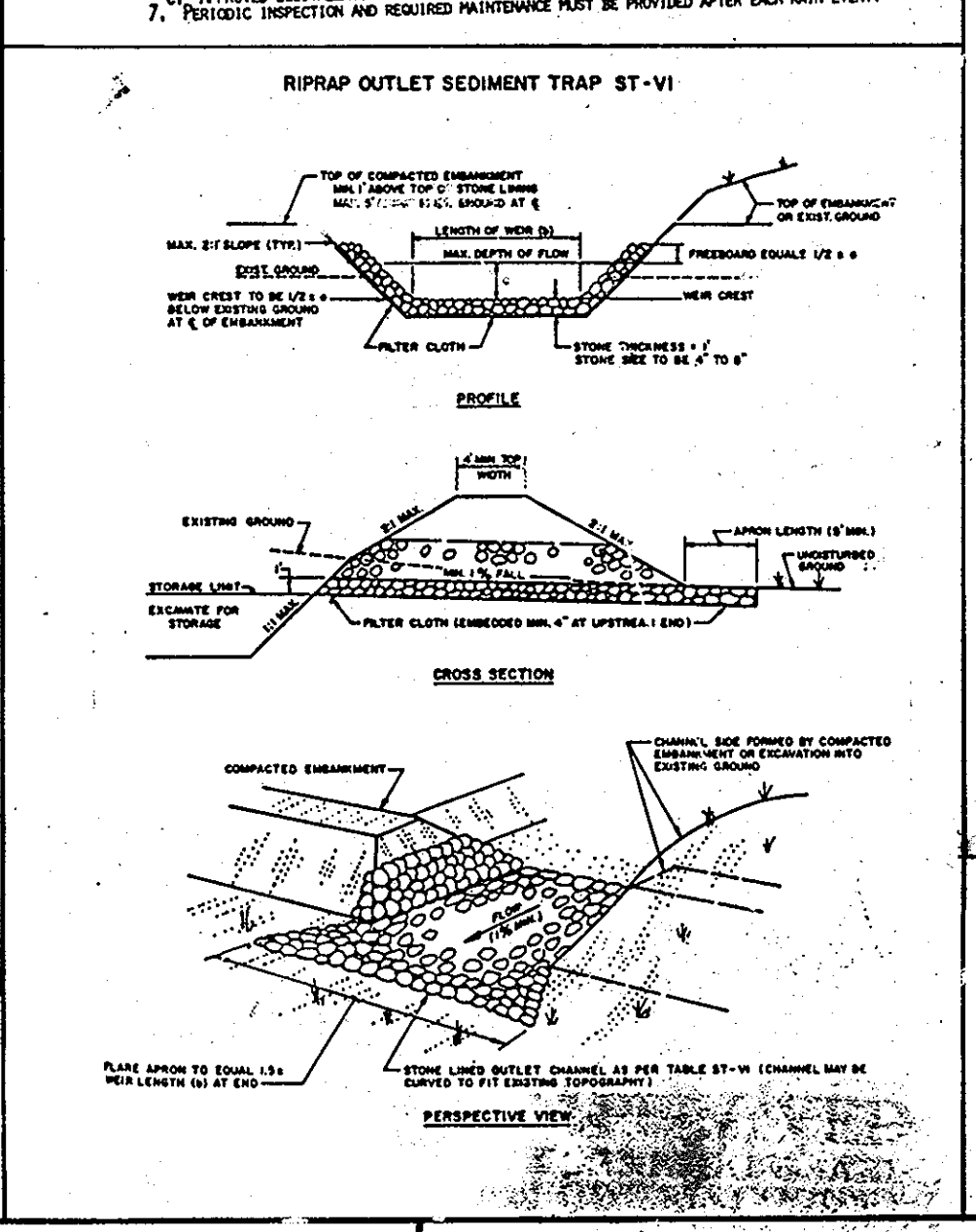
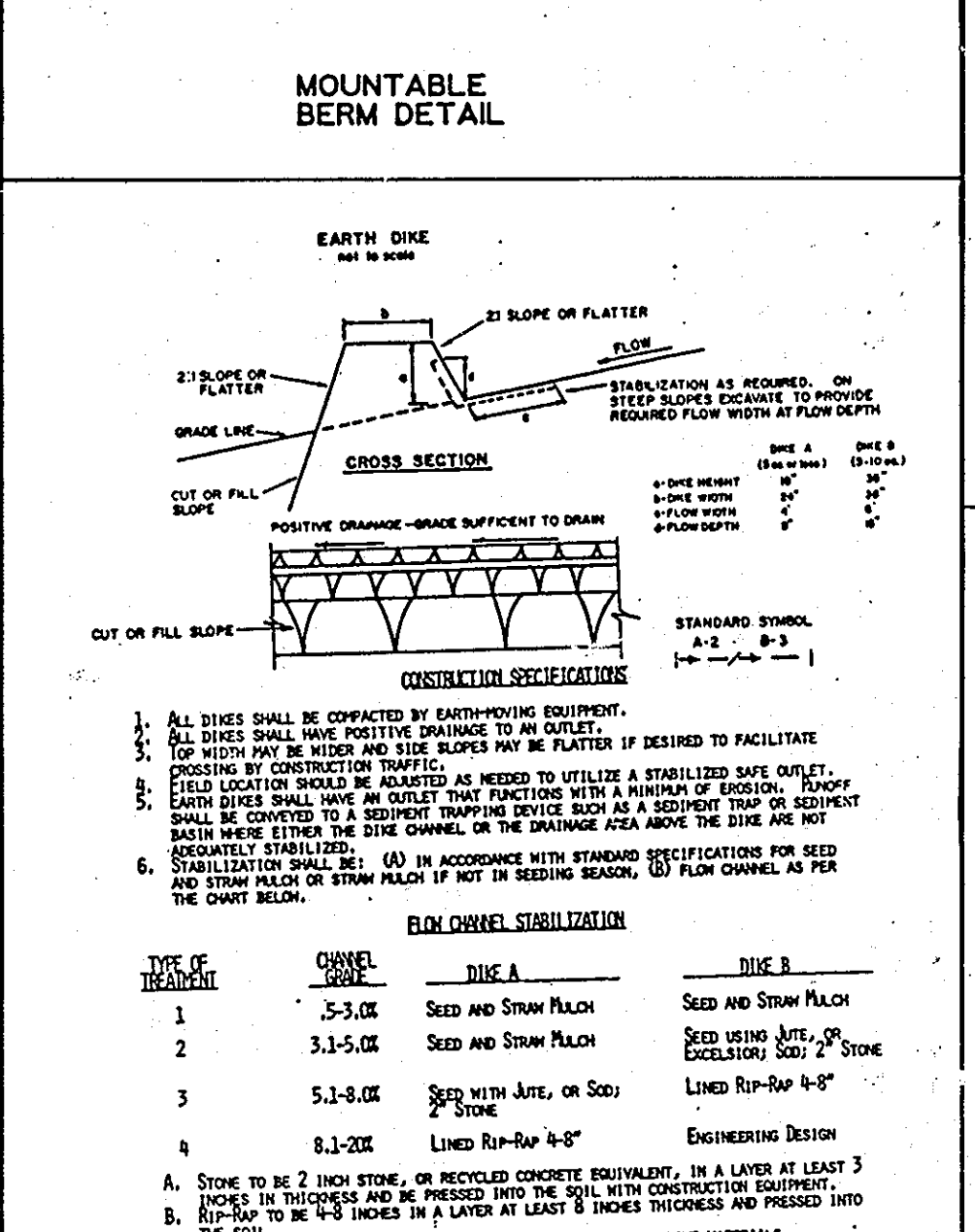

OWNER / DEVELOPER - PARCEL A-18 & A-19
 8430 STANFORD BOULEVARD LLC
 C/O AMERIX CORPORATION
 8130 STANFORD BLVD
 COLUMBIA, MD 21045-5805

CONSTRUCTION SPECIFICATIONS FOR ST-VII

- The area under embankment shall be cleared, grubbed and stripped of any vegetation and root mat. The pool area shall be cleared.
- The fill material for the embankment shall be free of roots or other woody vegetation as well as over-sized stones, rocks, organic material or other objectionable material. The embankment shall be compacted by treading with equipment while it is being constructed. Maximum height of embankment shall be five (5) feet, measured at centerline of embankment.
- All fill slopes shall be 2:1 or flatter; cut slopes 1:1 or flatter.
- Elevation of the top of any dike directing water into trap must equal or exceed the height of embankment.
- Storage area provided shall be figured by computing the volume available behind the outlet channel up to an elevation of one (1) foot below the level of the crest.
- Filter cloth shall be placed over the bottom and sides of the outlet channel below placement of stone. Sections of fabric must overlap at least one (1) foot with section nearest the entrance placed on top. Fabric shall be embedded at least six (6) inches into existing ground at entrance of outlet channel.
- Stone used in the outlet channel shall be four (4) to eight (8) inches (riprap). To provide a filtering effect, a layer of filter cloth shall be embedded one (1) foot back into the upstream face of the outlet stone or a one (1) foot thick layer of two (2) inch or finer aggregate shall be placed on the upstream face of the outlet.
- Sediment shall be removed and trap returned to its original dimensions when the sediment has accumulated to 1/2 the design depth of the trap. Removed sediment shall be deposited in a suitable area and in such a manner that it will not erode.
- The structure shall be inspected after each rain and repairs made as needed.
- Construction operations shall be carried out in such a manner that erosion and water pollution are minimized.
- The structure shall be removed and the area stabilized when the drainage area has been properly stabilized.
- Drainage area for this practice is limited to 15 acres or less.

APPROVED PLANNING BOARD OF HOWARD COUNTY
 DATE: 8-14-90
 J.B.

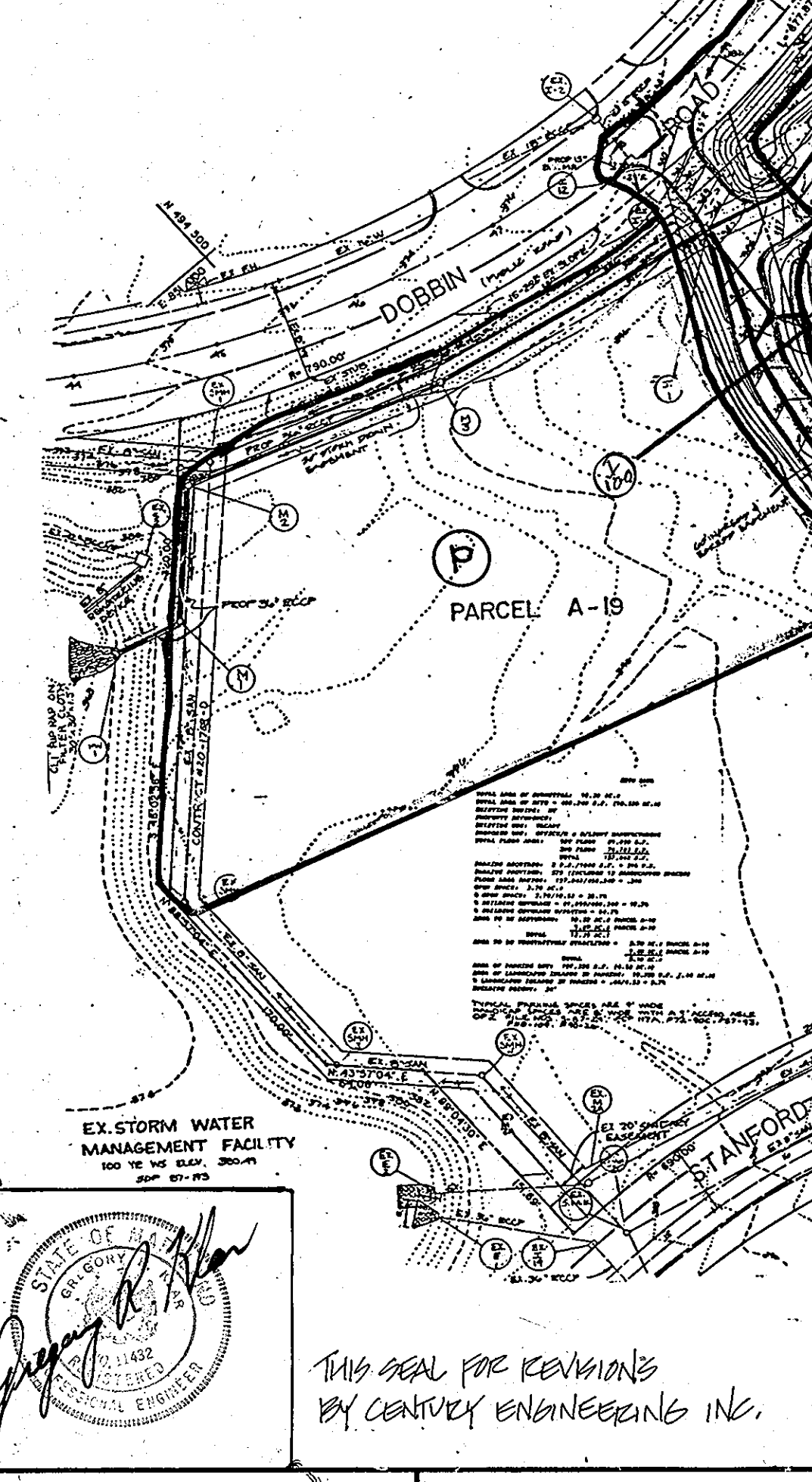

DEVELOPER'S CERTIFICATE
 I CERTIFY THAT ALL DEVELOPMENT AND/OR CONSTRUCTION WILL BE DONE ACCORDING TO THESE PLANS AND THAT AN ACCEPTABLE PERSONNEL INVOLVED IN THIS CONSTRUCTION PROJECT WILL HAVE A CERTIFICATE OF ATTENDANCE AT A DEPT. OF ENVIRONMENTAL APPROVED TRAINING PROGRAM FOR THE CONTROL OF SEDIMENT AND EROSION BEFORE BEGINNING THE PROJECT. I ALSO AUTHORIZE PERSONNEL ON-SITE INSPECTION BY THE HOWARD SOIL CONSERVATION DISTRICT OR THEIR AUTHORIZED AGENTS ARE DEEMED NECESSARY TO VERIFY THAT ALL WORK WILL NOT BE MADE UNLESS AUTHORIZED BY THE HOWARD SOIL CONSERVATION DISTRICT.
 DEVELOPER: [Signature]
 DATE: 9/2/90

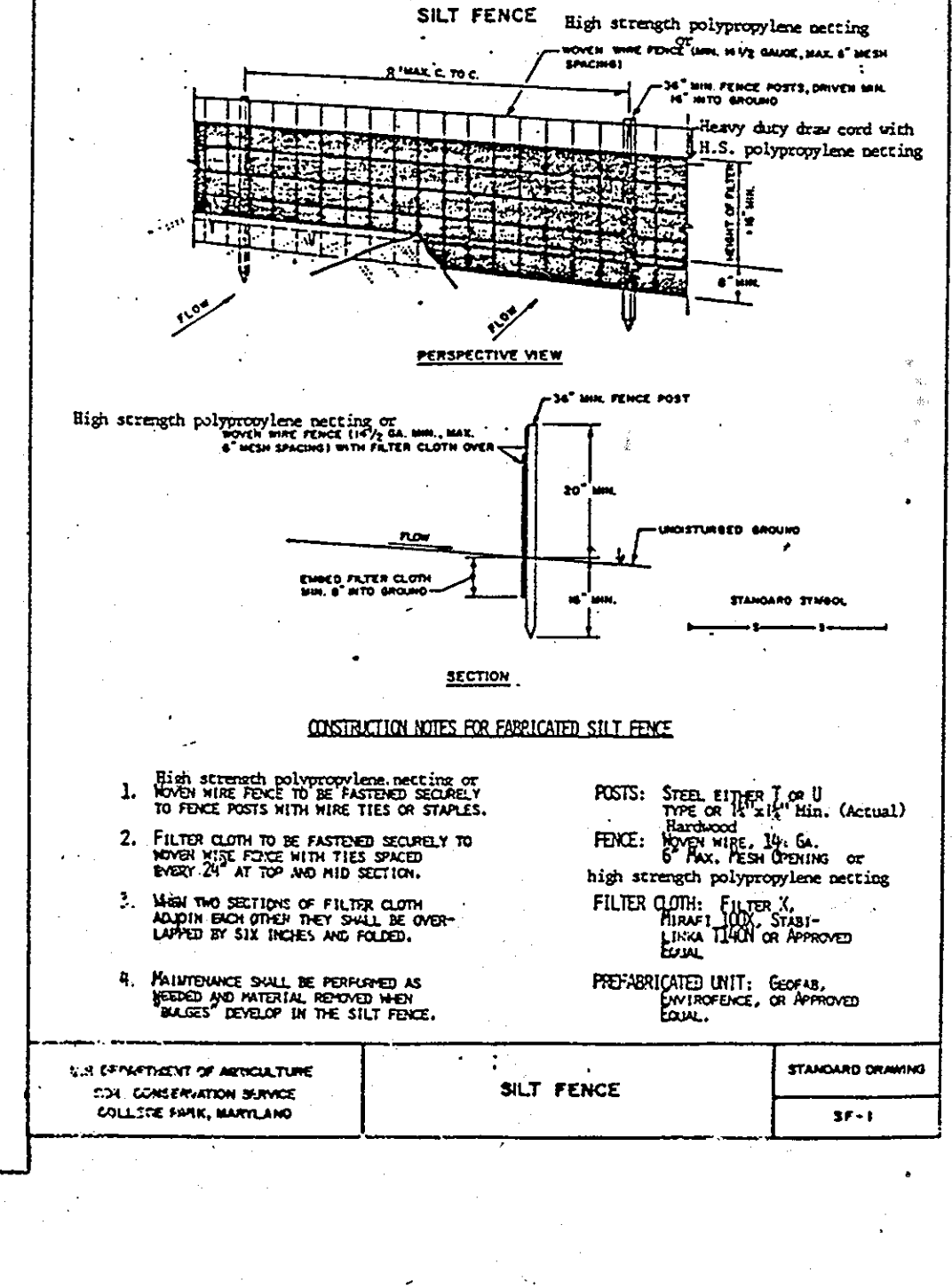

CONSTRUCTION NOTES FOR FABRICATED SILT FENCE

- High strength polypropylene netting or woven wire fence to be fastened securely to fence posts with wire ties or staples.
- FILTER CLOTH TO BE FASTENED SECURELY TO WOVEN WIRE FENCE WITH TIES SPACED EVERY 4" AT TOP AND MID SECTION.
- WEAVE TOP SECTION OF FILTER CLOTH ALONG EACH OTHER THEY SHALL BE OVERLAPPED BY SIX INCHES AND STAPLED.
- MAINTENANCE SHALL BE PERFORMED AS PERMANENT AND REMOVED WHEN BALE'S DEVELOP IN THE SILT FENCE.

POSTS: STEEL STAKES 1" OR U TYPE OF 1/2" DIA. (Actual)
 FENCE: WOVEN WIRE, 16 GA. 2" X 4" PLYM. FENCE OPENING OR HIGH STRENGTH POLYPROPYLENE NETTING
 FILTER CLOTH: FILTER CLOTH, 100% POLYPROPYLENE NETTING, 100% POLYPROPYLENE NETTING
 PREPARED UNIT: GEOTEX, CONFERENCE, OR APPROVED EQUAL.

DRAINAGE AREA MAP
 SCALE: 1" = 100'

NOTES AND DETAILS
 FOR COLUMBIA CORPORATE PARK PARCEL A-8 (A RESUBDIVISION OF PARCEL A-16)
 TAX MAP 36 PARCEL 356 CAPITAL PROJECT # C-0214
 6TH ELECTION DISTRICT MAY 1, 1990
 HOWARD COUNTY, MD. SHEET 6 OF 7

THESE PLANS HAVE BEEN REVIEWED FOR THE HOWARD SOIL CONSERVATION DISTRICT & MEET THE TECHNICAL REQUIREMENTS FOR SMALL FARM CONSERVATION PROGRAM, FOR EROSION AND SEDIMENT CONTROL.

APPROVED: [Signature] 9-5-90
 SOIL CONSERVATION SERVICE DATE

APPROVED: [Signature] 9/5/90
 HOWARD SOIL CONSERVATION DISTRICT DATE

APPROVED: [Signature] 9-25-90
 COUNTY HEALTH OFFICER DATE

APPROVED: [Signature] 10-7-90
 DIRECTOR DATE

APPROVED: [Signature] 9/24/90
 CHIEF DIVISION OF COMMUNITY PLANNING & LAND DEVELOPMENT DATE

APPROVED: [Signature] 9/20/90
 DIRECTOR DATE

APPROVED: [Signature] 9-12-90
 CHIEF BUREAU OF ENGINEERING DATE

DRAINAGE AREA MAP REVISED TO SHOW NEW DRAINAGE AREAS AND REVISED DRAINAGE AREAS A-18 & A-19

NOTES AND DETAILS
 FOR COLUMBIA CORPORATE PARK PARCEL A-8 (A RESUBDIVISION OF PARCEL A-16)
 TAX MAP 36 PARCEL 356 CAPITAL PROJECT # C-0214
 6TH ELECTION DISTRICT MAY 1, 1990
 HOWARD COUNTY, MD. SHEET 6 OF 7

SDP 70-198

PLANTING DETAILS

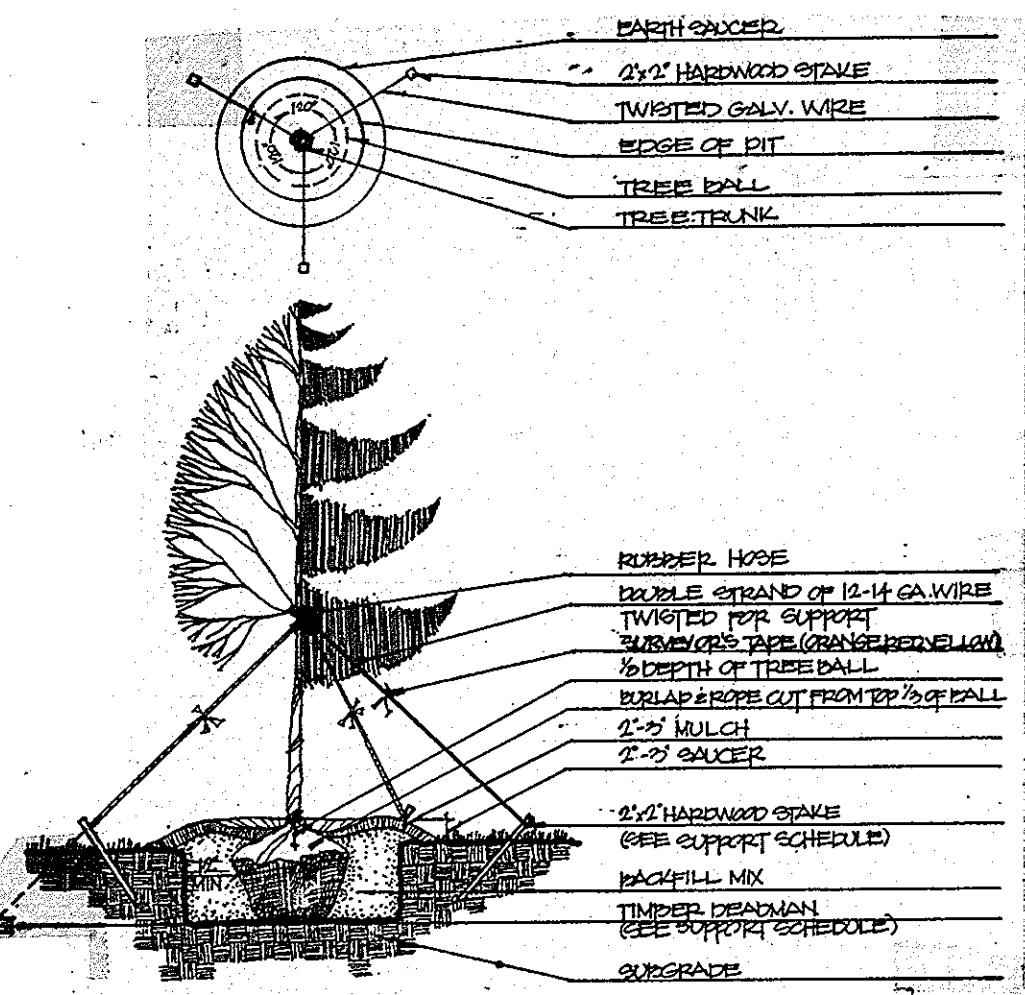

TREES OVER 2 1/2" CAL. & EVERGREEN TREES

TREE SIZE	SCHEDULE	SUPPORT
12" - 18" CAL.	2 STAKE 2 REQUIRED 12 GA. WIRE	2" X 4" POST
18" - 24" CAL.	2 STAKE 2 REQUIRED 12 GA. WIRE	2" X 4" POST
24" - 30" CAL.	2 STAKE 2 REQUIRED 12 GA. WIRE	2" X 4" POST
30" - 36" CAL.	2 STAKE 2 REQUIRED 12 GA. WIRE	2" X 4" POST
36" - 42" CAL.	2 STAKE 2 REQUIRED 12 GA. WIRE	2" X 4" POST
42" - 48" CAL.	2 STAKE 2 REQUIRED 12 GA. WIRE	2" X 4" POST

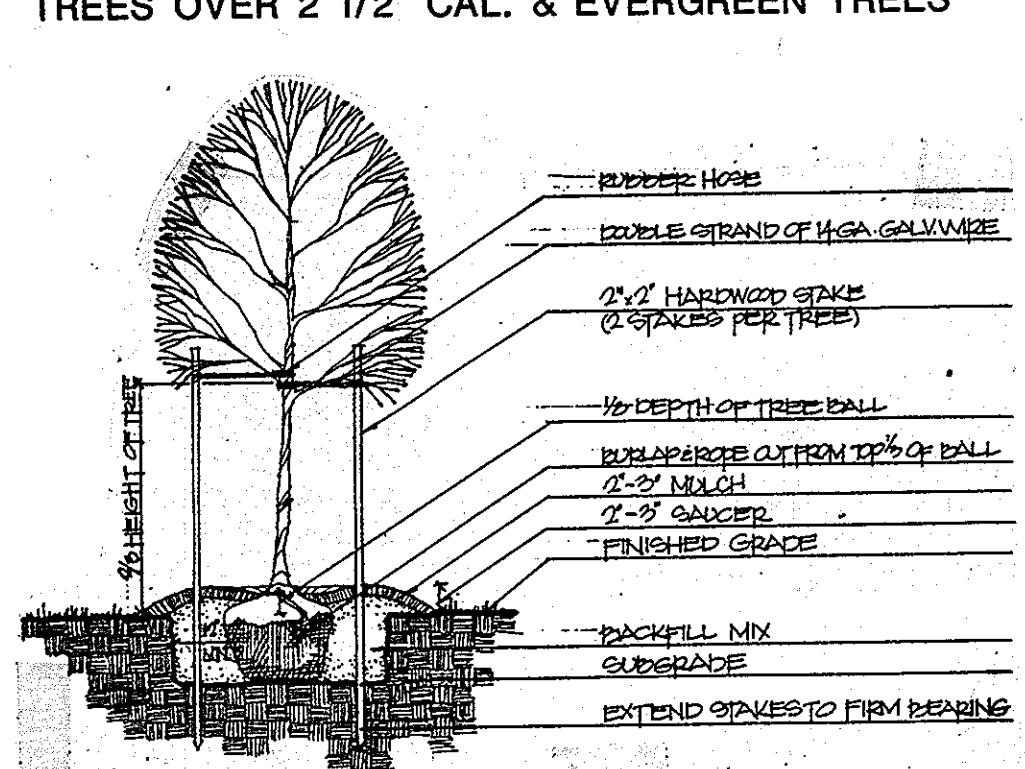

TREES UNDER 2 1/2" CAL.

PLANT LIST

KEY	QUANTITY	BOTANICAL/COMMON NAME	SIZE	ROOT	COMMENTS/ACCEPT. SUBST.
EVERGREEN TREES					
PS	25	Pinus strobus/Eastern White Pine	6' - 8' ht.	BB	
DECIDUOUS TREES					
CP	58	Crataegus phanopyrum/Washington Hawthorne	2" - 2-1/2" cal.	BB	Tree form, full crown, central leader
PB	30	Platanus x acerifolia 'Bloodgood' / Bloodgood London Plane	2-1/2" - 3" cal.	BB	Full crown, straight trunk
ZS	25	Zelkova serrata 'Village Green' / Village Green Japanese Zelkova	2-1/2" - 3" cal.	BB	Full crown
SHRUBS					
PC	372	Pyracantha coccinea 'Lombay' / Lombay Firethorn	18" - 24" sp.	BB/CG	
PF	20	Photinia x fraseri / Frasers Photinia	2-1/2" - 3" ht.	BB/CG	
GROUND COVER/VINES					
HH	4226	Hedera helix/English Ivy	3" pot	8" o.c.	
PERENNIALS AND BULBS					
H2	130	Hemerocallis 'Theresa Hall' / Theresa Hall Daylily	1 gal.	CG	18" o.c.
RF	184	Rubus idaeus 'Goldstrum' / Goldstrum Black-eyed Susan	1 gal.	CG	
SS	50	Solanum elaeagnifolium 'Autumn Joy' / Autumn Joy Sedum	1 gal.	CG	18" o.c.

PLANT LIST FOR ACCESS DRIVE

KEY	QUANTITY	BOTANICAL/COMMON NAME	SIZE	ROOT	COMMENTS/ACCEPT. SUBST.
EVERGREEN TREES					
PS	8	Pinus strobus/Eastern White Pine	6' - 8' ht.	BB	
DECIDUOUS TREES					
CP	12	Crataegus phanopyrum/Washington Hawthorne	2" - 2-1/2" cal.	BB	Tree form, full crown, central leader
ZS	6	Zelkova serrata 'Village Green' / Village Green Japanese Zelkova	2-1/2" - 3" cal.	BB	Full crown

PLANTING REQUIREMENTS

Industrial Area:	10.5 acres.
Required Planting:	10+ acres, 12 shade trees per acre. Required substitution of two flowering trees or two evergreen trees for 25% to 50% of the required number of shade trees.
Planting Spacing:	10.5 x 12 = 126 shade trees required.
Planting Spacing:	63 shade trees, 50 flowering trees and 75 evergreen trees.
60' Right-of-way Planting Access Drive:	
Planting Spacing:	0.5 acre area requires 18 shade trees per acre.
Planting Spacing:	12 x 18 = 16 shade trees.
Planting Spacing:	6 shade trees, 0 evergreen trees and 12 flowering trees.

No.	REVISION	DATE
1	Planting islands added w/trees	2/10/90

PLANTING NOTES

- All plants to be nursery grown and furnished in accordance with ANSI "American Standards for Nursery Stock" ANSI Z60.1.
- All trees to branch symmetrically around central leader. No forked leader stock will be accepted.
- Plant material types and sizes may vary due to market availability at time of construction. Any substitutions are to be of equivalent type and size, and must be approved in writing by the landscape architect. Considered shrub stock may be substituted for shrub stock if approved in writing by the landscape architect.
- All shrub beds shall be mulched with bark mulch in their entirety. All individual trees shall receive a 4" diameter circle of bark mulch.
- The contractor shall notify all utility companies five (5) days prior to beginning work.
- Any damage to the existing utilities, buildings, paving, curbs, walls, and vegetation not so designated for removal on these plans shall be repaired to previous condition or replaced by the contractor at his expense.
- All areas disturbed during construction are to be seeded unless noted otherwise.
- Installation of pines and oaks shall be during spring planting season only. No fall planting.
- Consult civil engineering plans for establishment of final grades. This is to be not intended for any use other than that of landscape material installation.
- In the event of a discrepancy between the quantities of plants on the plant list and on the drawings, the greater quantity shall apply.

NOTES:
 1. FINANCIAL SURETY FOR THE REQUIRED 6 SHADE TREES IN THE AMOUNT OF \$1000.00 WILL BE POSTED AS PART OF THE DEVELOPER'S OWNERS GRADING PERMIT APPLICATION.
 2. NEW LANDSCAPING IS PROVIDED BY NEW TOWN ALTERNATIVE COMPLIANCE IN ACCORDANCE WITH SECTION 16.124 OF THE HOWARD COUNTY CODE AND LANDSCAPE MANUAL.

APPROVED PLANNING BOARD OF HOWARD COUNTY
 DATE: 3-14-90

STATE OF MARYLAND
 LINDA J. MARYLAND
 LANDSCAPE ARCHITECT

PARCEL A-14
 COLUMBIA CORPORATE PARK
 EX. ZONING: M-1
 OWNER: COLUMBIA CORPORATE PARK ASSOC.

DEVELOPER'S CERTIFICATE
 I CERTIFY THAT ALL DEVELOPMENT AND/OR CONSTRUCTION WILL BE DONE ACCORDING TO THESE PLANS AND THAT ALL RESPONSIBLE PERSONNEL INVOLVED IN THIS CONSTRUCTION PROJECT WILL HAVE A CERTIFICATE OF ATTENDANCE BY A DEPT. OF NATURAL RESOURCES APPROVED TRAINING PROGRAM FOR THE CONTROL OF SEDIMENT AND EROSION BEFORE BEGINNING THE PROJECT. I ALSO AUTHORIZE PERIODIC ON-SITE INSPECTION BY THE HOWARD COUNTY DEPARTMENT OF PUBLIC WORKS AGENTS AS REQUIRED BY THE DEPARTMENT. SIGNATURE WILL NOT BE MADE UNLESS APPROVED BY THE DEPARTMENT OF PUBLIC WORKS.
 DEVELOPER: [Signature] DATE: 3/10/90

APPROVED FOR PUBLIC WATER, PUBLIC SEWERAGE AND STORM DRAINAGE SYSTEMS AND ROADS
 HOWARD COUNTY DEPARTMENT OF PUBLIC WORKS
 [Signature] DIRECTOR 3/20/90
 [Signature] CHIEF, BUREAU OF ENGINEERING 3-17-90

APPROVED FOR PUBLIC/PRIVATE WATER AND PUBLIC/PRIVATE SEWERAGE SYSTEMS
 HOWARD COUNTY HEALTH DEPARTMENT
 [Signature] CHIEF, BUREAU OF PUBLIC HEALTH 3-25-90

APPROVED FOR PLANNING AND ZONING
 HOWARD COUNTY DEPT. OF PLANNING AND ZONING
 [Signature] PLANNING DIRECTOR 3-27-90
 [Signature] CHIEF, DIVISION OF LAND DEVELOPMENT AND ZONING ADMINISTRATION 3-18-90

COLUMBIA CORPORATE PARK - PARCEL A-18

DATE: 3/15/90
 REVISIONS:
 1. NEW ROAD ALIGNMENT & ADDITIONAL PLANTING 3/15/90
 2. NEW PARKING LOT, ADDITIONAL PLANTING 4/22/90

COLUMBIA DESIGN COLLECTIVE
 Architects, Planners, Landscape Architects
 8130 STANFORD BOULEVARD, SUITE 200
 COLUMBIA, MARYLAND 21046
 BALTIMORE 301.595.6655
 WASHINGTON 301.921.8118

COLUMBIA CORPORATE PARK - PARCEL A-18
 8130 STANFORD BOULEVARD, LLC c/o AMERITY CORPORATION
 8130 STANFORD BLVD.
 COLUMBIA, MD 21045

Drawn By: [Signature]
 Checked By: [Signature]
 Date: 3/15/90

LANDSCAPE PLAN

Sheet Number: 7 of 7
 L1-1
 119-90 A

SDP 90-198