

NO.	REVISION	DATE
1	Rev. House & grade Lot 30 from Tidewater 8 to Salisbury.	7-3-91
2	Rev. hse & grd. lot 31, Add hse. typical	3-19-93
3	Rev. hse & grd. lot 29, Add hse. typical	4-27-93
4	Rev. hse & grd. lot 31, Add hse. typical	9-16-93
5	REV HSE & GRD LOT 30 ADD HSE TYPICAL	4-6-98

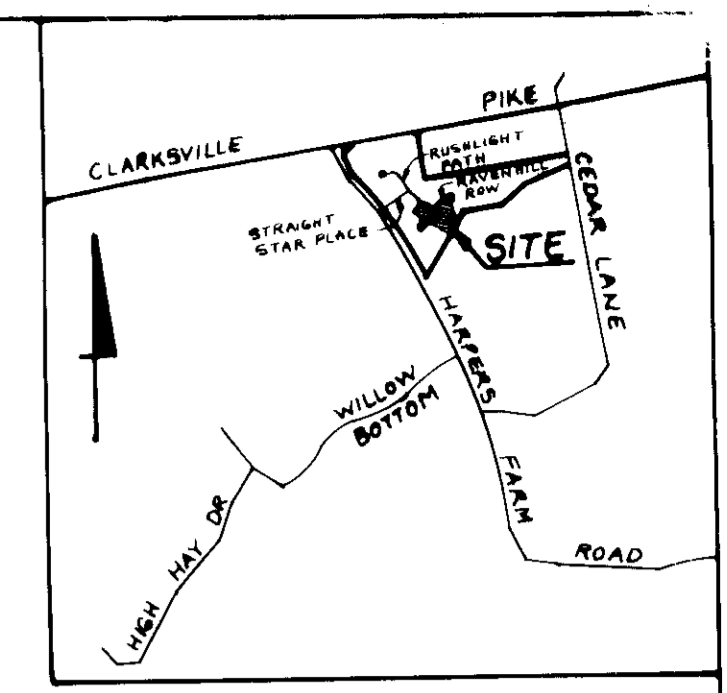

LEGEND

Contour Interval	2 FT
Existing Contour	---(30)---
Proposed Contour	---(40)---
Spot Elevation	+10.8
Direction of Drainage	→
Walk out Basement	---(00)---
Trees to be Saved	⊕

GENERAL NOTES

- Horizontal and Vertical control shown hereon is based upon Howard County Geodetic Control Stations: 4388888
- Subject property zoned N.T.S.F.L.D. per 8-2-85 comprehensive zoning plan and F.D.P. 204.
- The S.W.M. requirements for the subject property have been waived as per D.P.W. action dated Sept 6, 1988.
- OPZ File nos. approved Sept 29, 1988, are: S-83-101, P-83-45, WP-83-141789-201
- Total number of lots: 5
- Total area of lots: 1,805 Acres
- Lot coverage is 30% maximum.
- Topography taken from Road Construction drawings: F-89-201
- Any damage to county owned right of ways to be corrected at the developer's expense.
- The Contractor or Developer shall contact the construction/inspection survey division 24 hours in advance of commencement of work at 792-2630.
- Improvement of property: Single Family Density Units.

SPECIAL NOTES

- All Road Construction, Storm Drainage facilities and Public Water and Sewer are shown for reference only.
- Use approved Ho Co. plans for all phases of construction.

ADDRESS CHART

Lot	Street Address
29	5000 Ravenhill Row
30	5056 Ruslight Path
31	5060
32	5095
33	5091

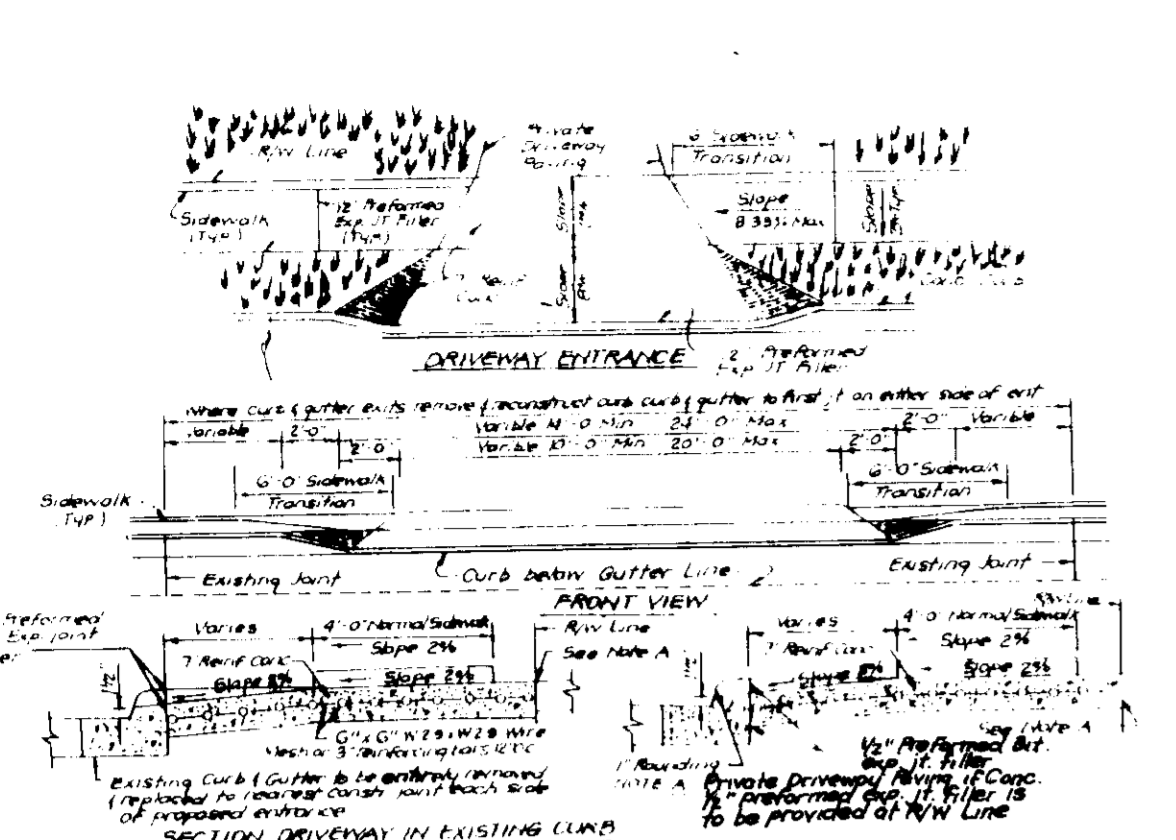

DRIVEWAY ABUTTING CLOSED SECTION WITH MODIFIED COMB CURB & GUTTER & SIDEWALK

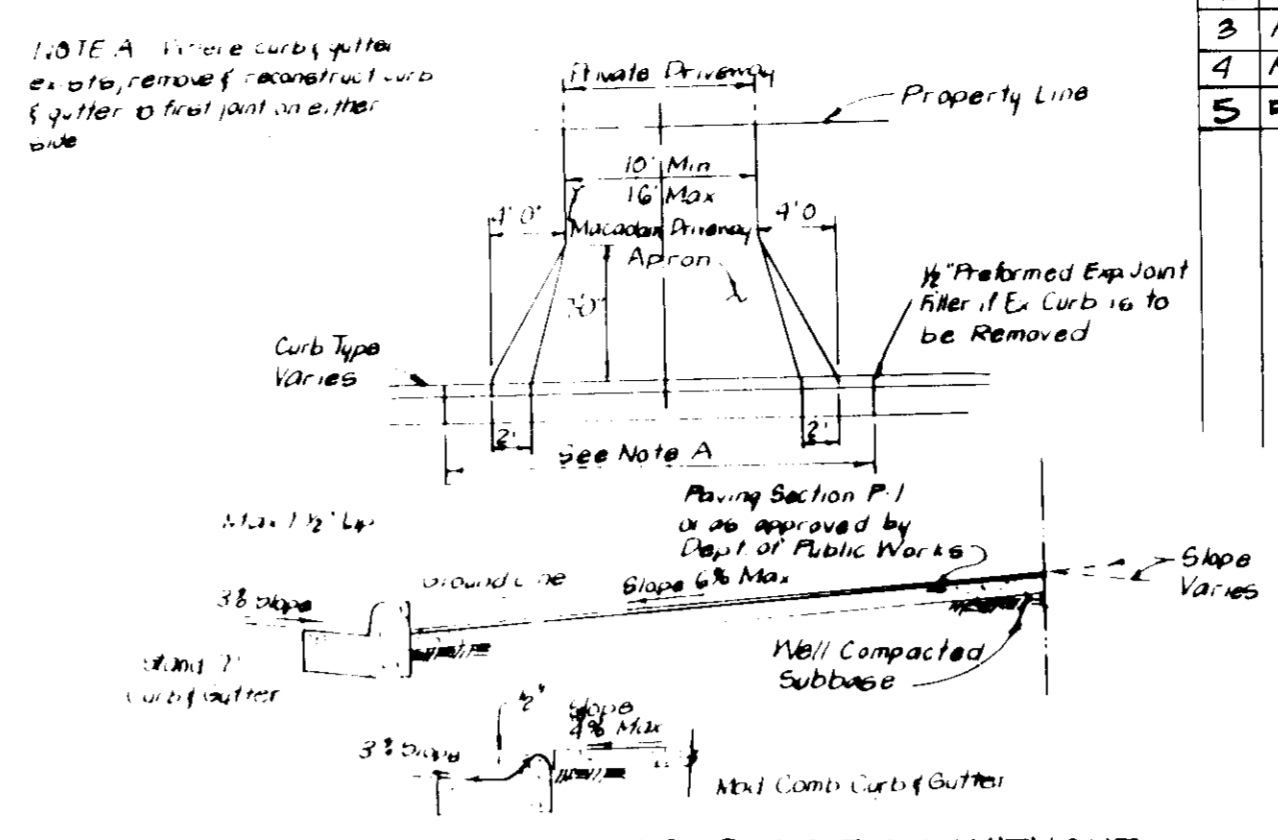

DRIVEWAY ABUTTING CLOSED SECTION WITHOUT CONCRETE SIDEWALK

TYPICAL HOUSE

Scale: 1" = 50'

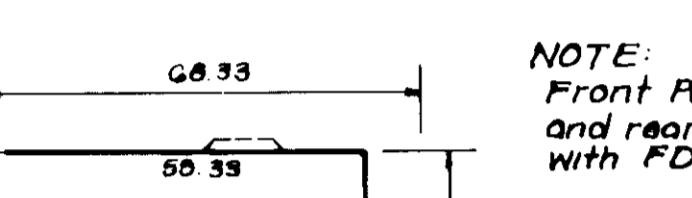

NOTE: All units have 1' reef leaves, front & rear.

TIDEWATER 8

w/2 car garage, & porch
 2021.87 = 8750.50 #
 0.3 Min. Lot Size

NOTE: Wetland buffer indicated on this site Development Plan does not effect the initial construction of a residential unit on any lot. It does prohibit subsequent clearing, grading or construction in the buffer area. Maintenance or residences, landscaping, and utilities are permitted.

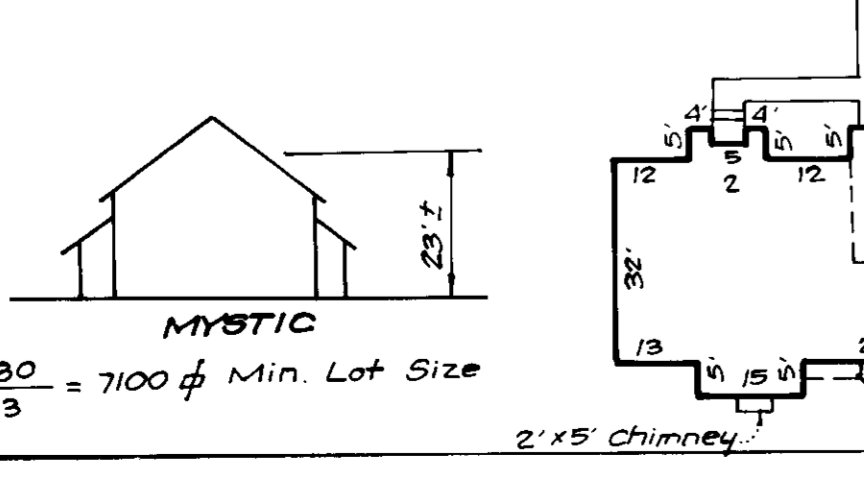

2130 = 7100 # Min. Lot Size
 0.3

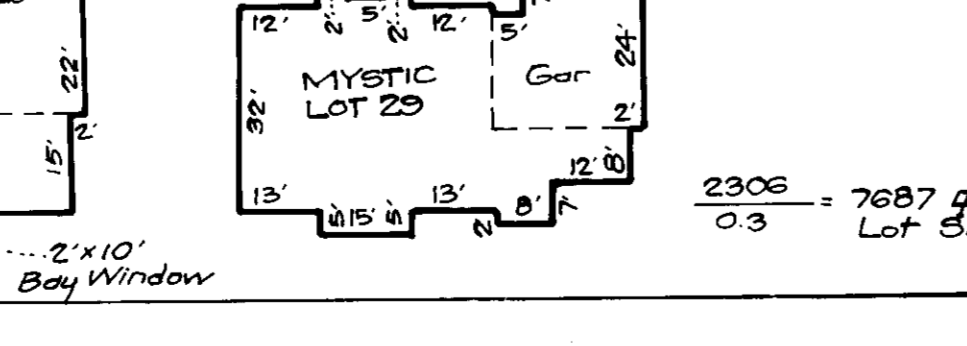

2306 = 7687 # Min. Lot Size
 0.3

APPROVED
 DIVISION OF COMMUNITY PLANNING & LAND DEVELOPMENT
 DATE: 2-11-90
 COUNTY HEALTH OFFICER: [Signature]
 APPROVED: [Signature] DATE: 3-7-90
 COUNTY DEPT. OF PLANNING & ZONING
 CHIEF DIVISION OF COMMUNITY PLANNING AND LAND DEVELOPMENT
 APPROVED: [Signature] DATE: 2-16-91
 CHIEF DIVISION OF PUBLIC WATER AND PUBLIC SEWERAGE, STORM DRAINAGE SYSTEMS AND PUBLIC ROADS
 HOWARD COUNTY DEPARTMENT OF PUBLIC WORKS
 APPROVED: [Signature] DATE: 2-7-90
 CHIEF BUREAU OF ENGINEERING

APPROVED FOR PUBLIC WATER AND PUBLIC SEWERAGE SYSTEMS
 HOWARD COUNTY HEALTH DEPARTMENT
 APPROVED: [Signature] DATE: 2-11-90
 COUNTY HEALTH OFFICER
APPROVED
 COUNTY DEPT. OF PLANNING & ZONING
 DATE: 3-7-90
APPROVED
 CHIEF DIVISION OF PUBLIC WATER AND PUBLIC SEWERAGE, STORM DRAINAGE SYSTEMS AND PUBLIC ROADS
 HOWARD COUNTY DEPARTMENT OF PUBLIC WORKS
 APPROVED: [Signature] DATE: 2-7-90
 CHIEF BUREAU OF ENGINEERING

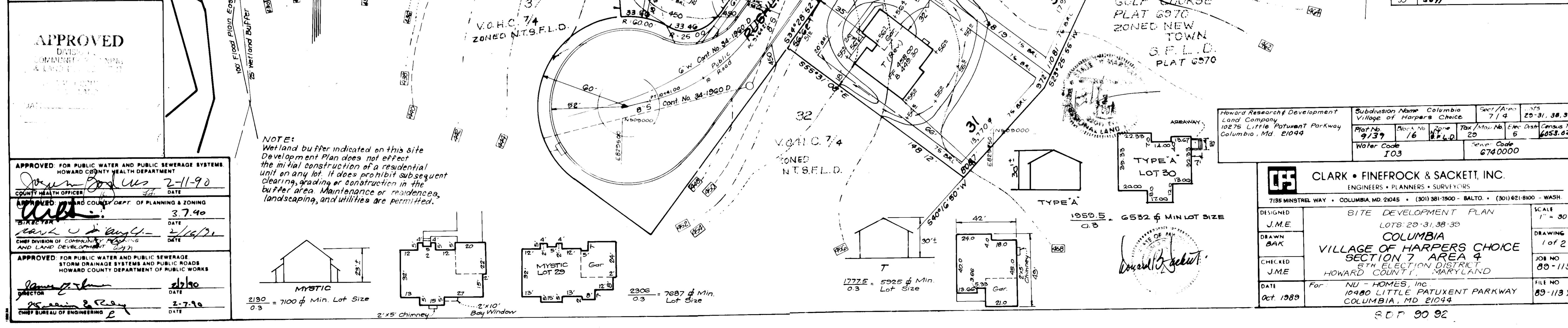

Howard Research & Development Land Company 10275 Little Patuxent Parkway Columbia, Md. 21044	Subdivision Name: Columbia Village of Harpers Choice Plat No.: 9/37 Block No.: 16 Water Code: 103	Sheet/Arms: 7/4 Lots: 29-31, 38, 39 Tax Map No.: 20 Elec. Dist. Code: 6053.02 Phone Code: 6740000
--	--	---

CLARK • FINEFROCK & SACKETT, INC.
 ENGINEERS • PLANNERS • SURVEYORS
 7135 MINISTREL WAY • COLUMBIA, MD. 21045 • (301) 381-7500 - BALTO. • (301) 621-8100 - WASH.
 SCALE: 1" = 30'
 DRAWING: 1 of 2
 JOB NO: 89-113
 FILE NO: 89-113 X
 S.D.P. 90 92

PERMANENT SEEDING NOTES

Apply to graded or cleared areas not subject to immediate further disturbance where a permanent long-lived vegetative cover is needed.

Seedbed Preparation: Loosen upper three inches of soil by raking, disking or other acceptable means before seeding, if not previously loosened.

Soil Amendments: In lieu of soil test recommendations, use one of the following schedules

- 1) Preferred - Apply 2 tons per acre dolomitic limestone (92 lbs/1000 sq ft) and 600 lbs per acre 10-10-10 fertilizer (14 lbs/1000 sq ft) before seeding. Narrow or disc into upper three inches of soil. At time of seeding, apply 400 lbs per acre 30-0-0 ureaform fertilizer (9 lbs/1000 sq ft).
- 2) Acceptable - Apply 2 tons per acre dolomitic limestone (92 lbs/1000 sq ft) and 1000 lbs per acre 10-10-10 fertilizer (23 lbs/1000 sq ft) before seeding. Narrow or disc into upper three inches of soil.

Seeding: For the periods March 1 thru April 30, and August 1 thru October 15, seed with 50 lbs per acre (1.4 lbs/1000 sq ft) of Kentucky 31 Tall Fescue. For the period May 1 thru July 31, seed with 60 lbs Kentucky 31 Tall Fescue per acre and 2 lbs per acre (.05 lbs/1000 sq ft) of weeping lovegrass. During the period of October 16 thru February 28, protect site by: Option (1) 2 tons per acre of well anchored straw mulch and seed as soon as possible in the spring. Option (2) Seed with 60 lbs/acre Kentucky 31 Tall Fescue and mulch with 2 tons/acre well anchored straw.

Mulching: Apply 1 1/2 to 2 tons per acre (70 to 90 lbs/1000 sq ft) of unrotted small grain straw immediately after seeding. Anchor mulch immediately after application using mulch anchoring tool or 218 gallons per acre (5 gal/1000 sq ft) of emulsified asphalt on flat areas. On slopes 8 ft or higher, use 348 gallons per acre (8 gal/1000 sq ft) for anchoring.

Maintenance: Inspect all seeded areas and make needed repairs, replacements and reseedings.

TEMPORARY SEEDING NOTES

Apply to graded or cleared areas likely to be redisturbed where a short-term vegetative cover is needed.

Seedbed Preparation: Loosen upper three inches of soil by raking, disking or other acceptable means before seeding, if not previously loosened.

Soil Amendments: Apply 600 lbs per acre 10-10-10 fertilizer (14 lbs/1000 sq ft)

Seeding: For periods March 1 thru April 30 and from August 15 thru November 15, seed with 25 bushel per acre of annual ryegrass (3.2 lbs/1000 sq ft). For the period May 1 thru August 14, seed with 3 lbs per acre of weeping lovegrass (.07 lbs/1000 sq ft). For the period November 16 thru February 28, protect site by applying 2 tons per acre of well anchored straw mulch and seed as soon as possible in the spring, or use sod.

Mulching: Apply 1 1/2 to 2 tons per acre (70 to 90 lbs/1000 sq ft) of unrotted small grain straw immediately after seeding. Anchor mulch immediately after application using mulch anchoring tool or 218 gallons per acre (5 gal/1000 sq ft) of emulsified asphalt on flat areas. On slopes, 8 ft or higher, use 348 gal per acre (8 gal/1000 sq ft) for anchoring.

Refer to the 1981 MARYLAND STANDARDS AND SPECIFICATIONS FOR SOIL EROSION AND SEDIMENT CONTROL FOR rates and methods not covered.

CONSTRUCTION SEQUENCE:

No. of Days	Description
7	A. Obtain Grading Permit and Install Sediment and Erosion Control Devices and Stabilize.
30	B. Excavate for foundations and Rough Grade & Temporarily Stabilize.
120	C. Construct Structures, Sidewalks and Driveways.
30	D. Final Grade and stabilize in accordance with Stds. & Specs.
	E. Upon approval of the sediment control inspector, remove sediment and erosion controls and stabilize.

SEDIMENT CONTROL NOTES

- 1) A minimum of 24 hours notice must be given to the Howard County Office of Inspection and Permitting prior to the start of any construction. (992-2437)
- 2) All vegetative and structural practices are to be installed according to the provisions of this plan and are to be in conformance with the 1983 MARYLAND STANDARDS AND SPECIFICATIONS FOR SOIL EROSION AND SEDIMENT CONTROL.
- 3) Following initial soil disturbance or redisturbance, permanent or temporary stabilization shall be completed within a) 7 calendar days for all perimeter sediment control structures, dikes, perimeter slopes and all slopes greater than 3:1, b) 14 days as to all other disturbed or graded areas on the project site.
- 4) All sediment traps/basins shown must be fenced and warning signs posted around their perimeter in accordance with Vol. 1, Chapter 12, of the HOWARD COUNTY DESIGN MANUAL, Storm Drainage.
- 5) All disturbed areas must be stabilized within the time period specified above in accordance with the 1983 MARYLAND STANDARDS AND SPECIFICATIONS FOR SOIL EROSION AND SEDIMENT CONTROL for permanent seedings (Sec. 51) and (Sec. 52), temporary seedings (Sec. 50) and mulching (Sec. 52). Temporary stabilization with mulch alone can only be done when recommended seeding dates do not allow for proper germination and establishment of grasses.
- 6) All sediment control structures are to remain in place and are to be maintained in operative condition until permission for their removal has been obtained from the Howard County Sediment Control Inspector.
- 7) Site Analysis:

Total Area of Site	1.80 Acres
Area Disturbed	1.52 Acres
Area to be roofed or paved	0.92 Acres
Area to be vegetatively stabilized	1.70 Acres
Total Cut	1652 Cu. yds
Total Fill	1652 Cu. yds
Offsite waste/borrow area location	undetermined
- 8) Any sediment control practice which is disturbed by grading activity for placement of utilities must be repaired on the same day of disturbance.
- 9) Additional sediment control must be provided, if deemed necessary by the Howard County sediment control inspector.
- 10) On all sites with disturbed areas in excess of 2 acres, approval of the inspection agency shall be requested upon completion of installation of perimeter erosion and sediment controls, but before proceeding with any other earth disturbance or grading. Other building or grading inspection approvals may not be authorized until this initial approval by the inspection agency is made.
- 11) If basins are to be constructed on an "As-Built" basis, at no time, through the lifetime of the control, shall they be implemented.
- 12) All pipes to be blocked at the end of each day (see detail 100).
- 13) The total amount of site materials shall be stored in accordance with the following:

886	L.F.
-----	------

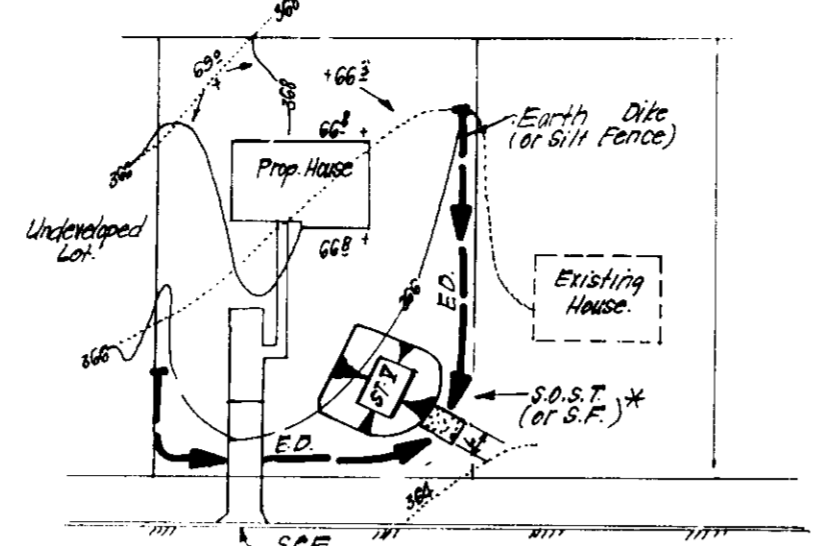
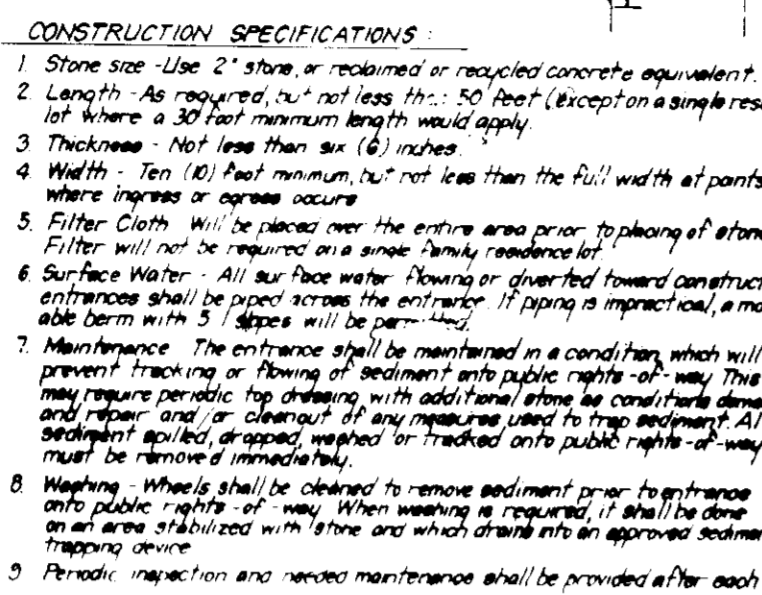
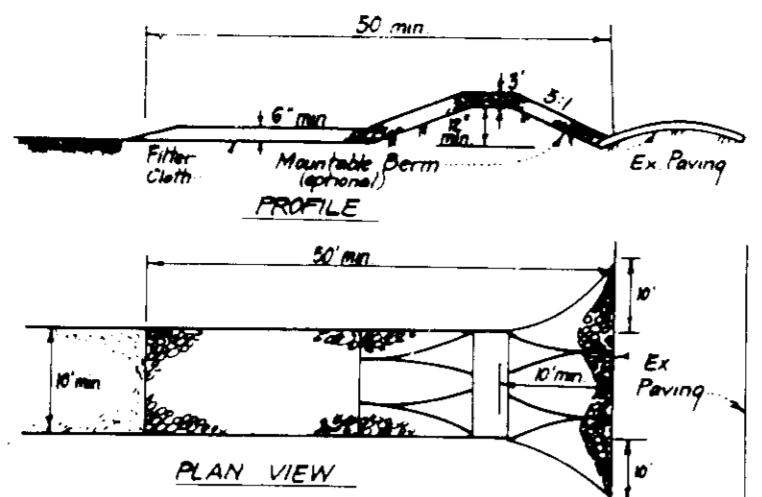

NO.	DESCRIPTION	AREA	PERCENT
1	Grass	1.70	94.44
2	Grass	0.10	5.56
3	Grass	0.00	0.00
4	Grass	0.00	0.00
5	Grass	0.00	0.00
6	Grass	0.00	0.00
7	Grass	0.00	0.00
8	Grass	0.00	0.00
9	Grass	0.00	0.00
10	Grass	0.00	0.00
11	Grass	0.00	0.00
12	Grass	0.00	0.00
13	Grass	0.00	0.00
14	Grass	0.00	0.00
15	Grass	0.00	0.00
16	Grass	0.00	0.00
17	Grass	0.00	0.00
18	Grass	0.00	0.00
19	Grass	0.00	0.00
20	Grass	0.00	0.00

SINGLE LOT SEDIMENT CONTROL PLAN
NO SCALE

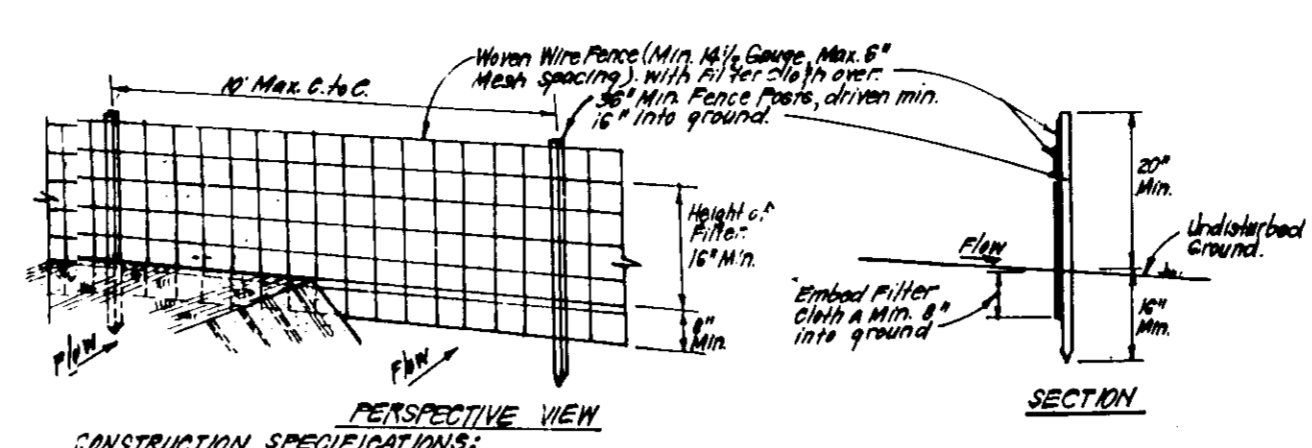

- CONSTRUCTION SPECIFICATIONS:**
1. Woven wire fence to be fastened securely to fence posts with wire 1/2\"/>
 2. Filter cloth to be fastened securely to woven wire fence with ties spaced every 30\"/>
 3. When 2 sections of filter cloth section each other they shall be overlapped by 6\"/>
 4. Maintenance shall be performed as needed and material retained when 50% of slope is in silt fence.

SILT FENCE DETAIL (3)
NO SCALE

STABILIZED CONSTRUCTION ENTRANCE (SCE)

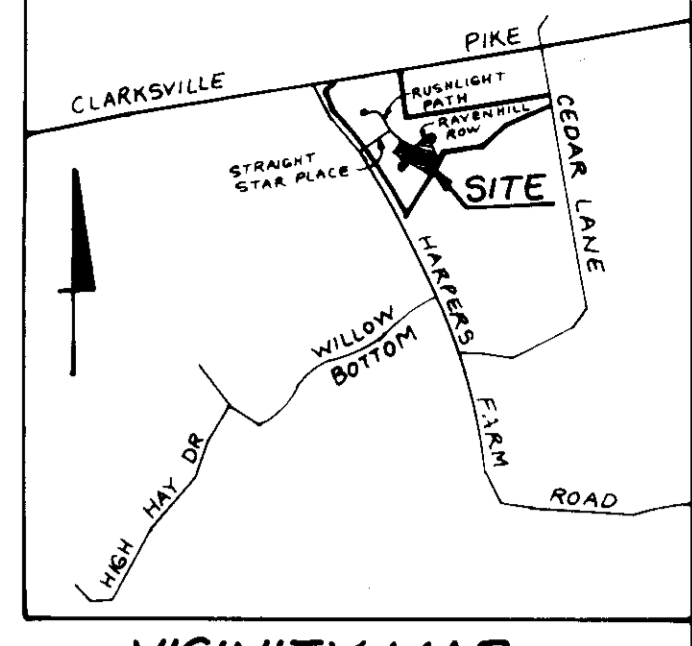
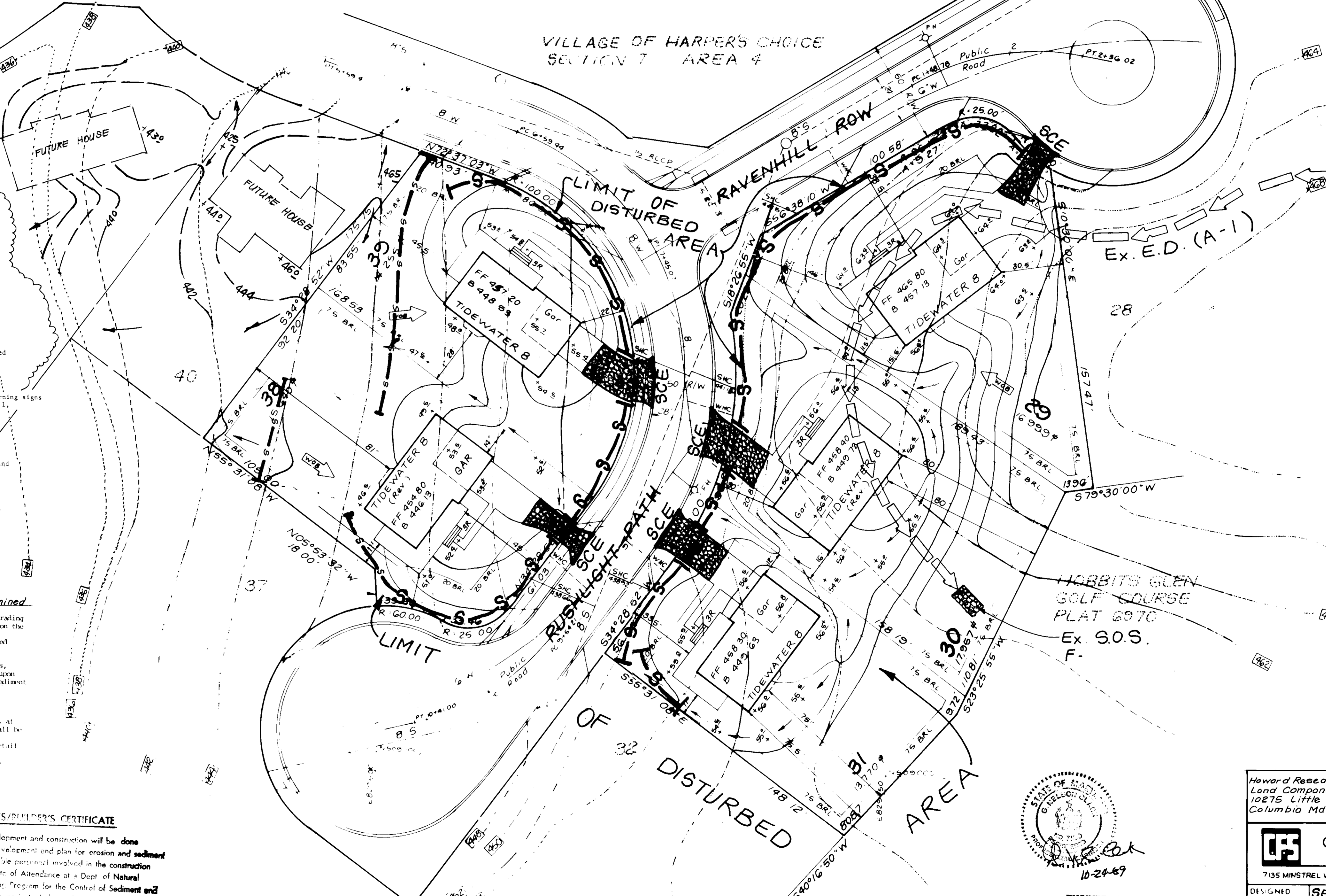

VICINITY MAP
Scale 1" = 2000'

LEGEND

- Contour Interval 2 FT
- Existing Contour (dashed line)
- Proposed Contour (solid line)
- Spot Elevation (+10%)
- Direction of Drainage (arrow)
- Walk out Basement (dashed line)
- Trees to be Saved (tree symbol)
- Stabilized Construction Entrance (hatched area)
- Silt Fence (line with 'SCE' label)
- Existing Earth Dike (line with 'Ex. E.D. (A-1)' label)

APPROVED
DIVISION of COMMUNITY PLANNING & LAND DEVELOPMENT
HOWARD COUNTY, MARYLAND
DATE _____

APPROVED FOR PUBLIC WATER AND PUBLIC SEWERAGE SYSTEMS
HOWARD COUNTY HEALTH DEPARTMENT
DATE 2-11-90

APPROVED FOR HOWARD COUNTY DEPT. OF PLANNING & ZONING
DATE 2-7-90

APPROVED FOR PUBLIC WATER AND PUBLIC SEWERAGE STORM DRAINAGE SYSTEMS AND PUBLIC ROADS
HOWARD COUNTY DEPARTMENT OF PUBLIC WORKS
DATE 2-7-90

DEVELOPER'S/BUILDER'S CERTIFICATE

"I/We certify that all development and construction will be done according to the plan of development and plan for erosion and sediment control and that all responsible personnel involved in the construction project will have a Certificate of Attendance at a Dept. of Natural Resources Approved Training Program for the Control of Sediment and Erosion before beginning the project. I also authorize periodic on-site inspection by the Howard Soil Conservation District or their authorized agents, as are deemed necessary."

Harvey A. Bousie 10-24-89
Signature of Developer/Builder Date

ENGINEER'S CERTIFICATE

I hereby certify that this plan for Erosion and Sediment Control is in accordance with the requirements of the Howard Soil Conservation District.

G. Nelson Clark 10-24-89
Date

Reviewed for HOWARD S.C.D. and meets Technical Requirements
James M. Helm 2/2/90
Soil Conservation District
U.S. Soil Conservation Service

THIS DEVELOPMENT PLAN IS APPROVED FOR SOIL EROSION AND SEDIMENT CONTROL BY THE HOWARD SOIL CONSERVATION DISTRICT.
John A. Robinson 2/2/90
Approved Date

Howard Research & Development Land Company
10275 Little Patuxent Parkway
Columbia Md. 21044

CLARK • FINEFROCK • SACKETT, INC.
ENGINEERS • ARCHITECTS • SURVEYORS
7135 MINSTREL WAY • COLUMBIA MD 21045 • (301) 381-7500 BALTO • (301) 621-8100 WASH

DESIGNED KIWM	SCALE 1" = 30'
DRAWN BAK	SEDIMENT AND EROSION CONTROL PLAN COLUMBIA VILLAGE OF HARPERS CHOICE SECTION 7 AREA 4 8TH ELECTION DISTRICT HOWARD COUNTY, MARYLAND
CHECKED KIWM	DRAWING 2 of 2
DATE Oct 1989	JOB NO 89-113
	FILE NO 89-1136E

For: NU - HOMES, Inc.
10480 LITTLE PATUXENT PARKWAY
COLUMBIA, MD 21044

S.D.P. 90-92