

APPROVED: FOR PUBLIC WATER AND PUBLIC SEWERAGE STORM DRAINAGE SYSTEMS AND PUBLIC ROADS HOWARD COUNTY DEPARTMENT PUBLIC WORKS

DIRECTOR: *[Signature]* DATE: 12/14/87

CHIEF, BUREAU OF ENGINEERING: *[Signature]* DATE: 12-14-87

APPROVED: FOR PUBLIC WATER AND PUBLIC SEWERAGE SYSTEMS HOWARD COUNTY HEALTH DEPARTMENT

[Signature] DATE: 12-15-87

APPROVED: HOWARD COUNTY THE DEPARTMENT OF PLANNING AND ZONING

PLANNING DIRECTOR: *[Signature]* DATE: 12/14/87

CHIEF, DIVISION OF COMMUNITY PLANNING AND LAND DEVELOPMENT: *[Signature]* DATE: 12/14/87

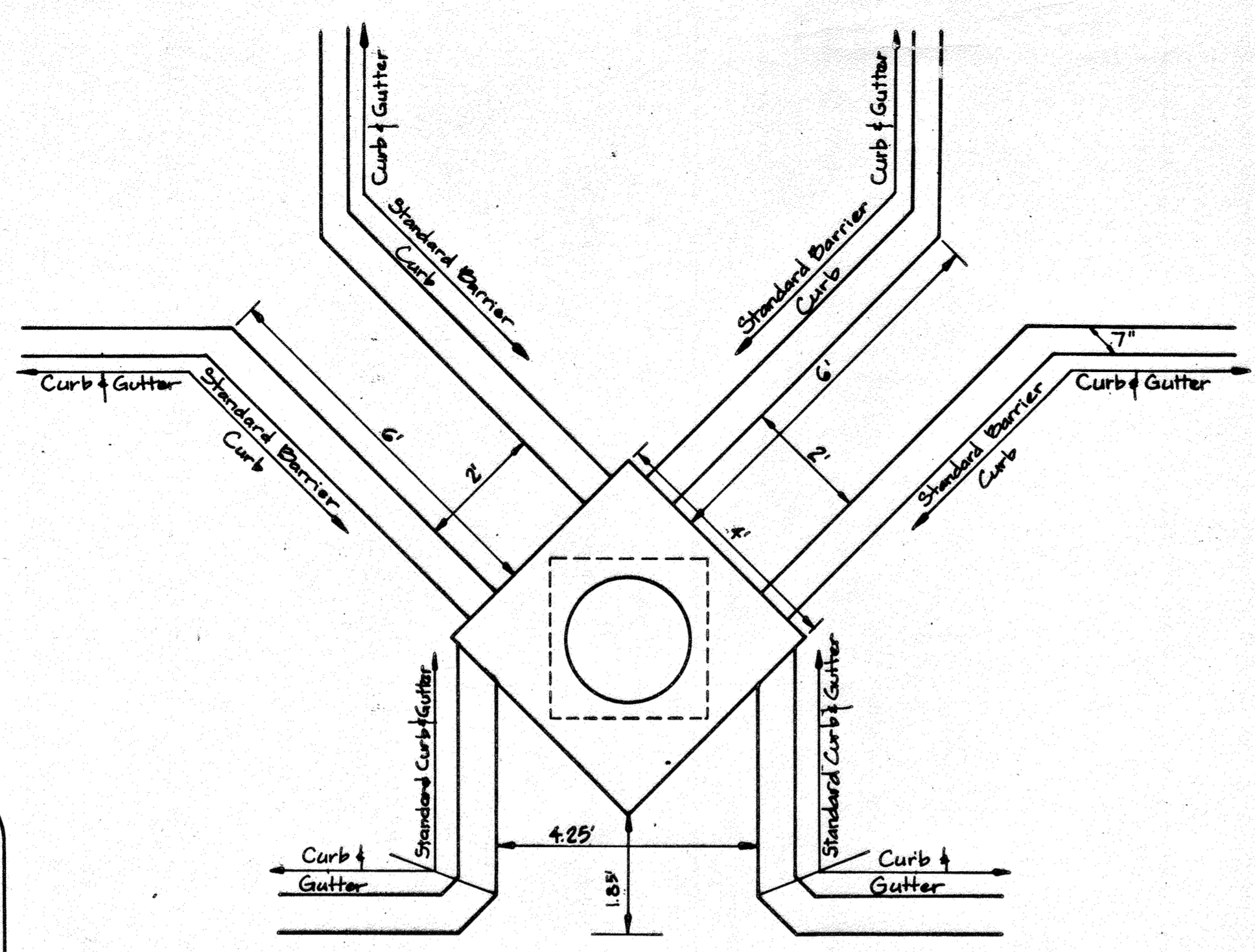

CURB OPENINGS FOR TYPE 'D' INLET WITH DIMENSIONS
Scale: 1"=2'

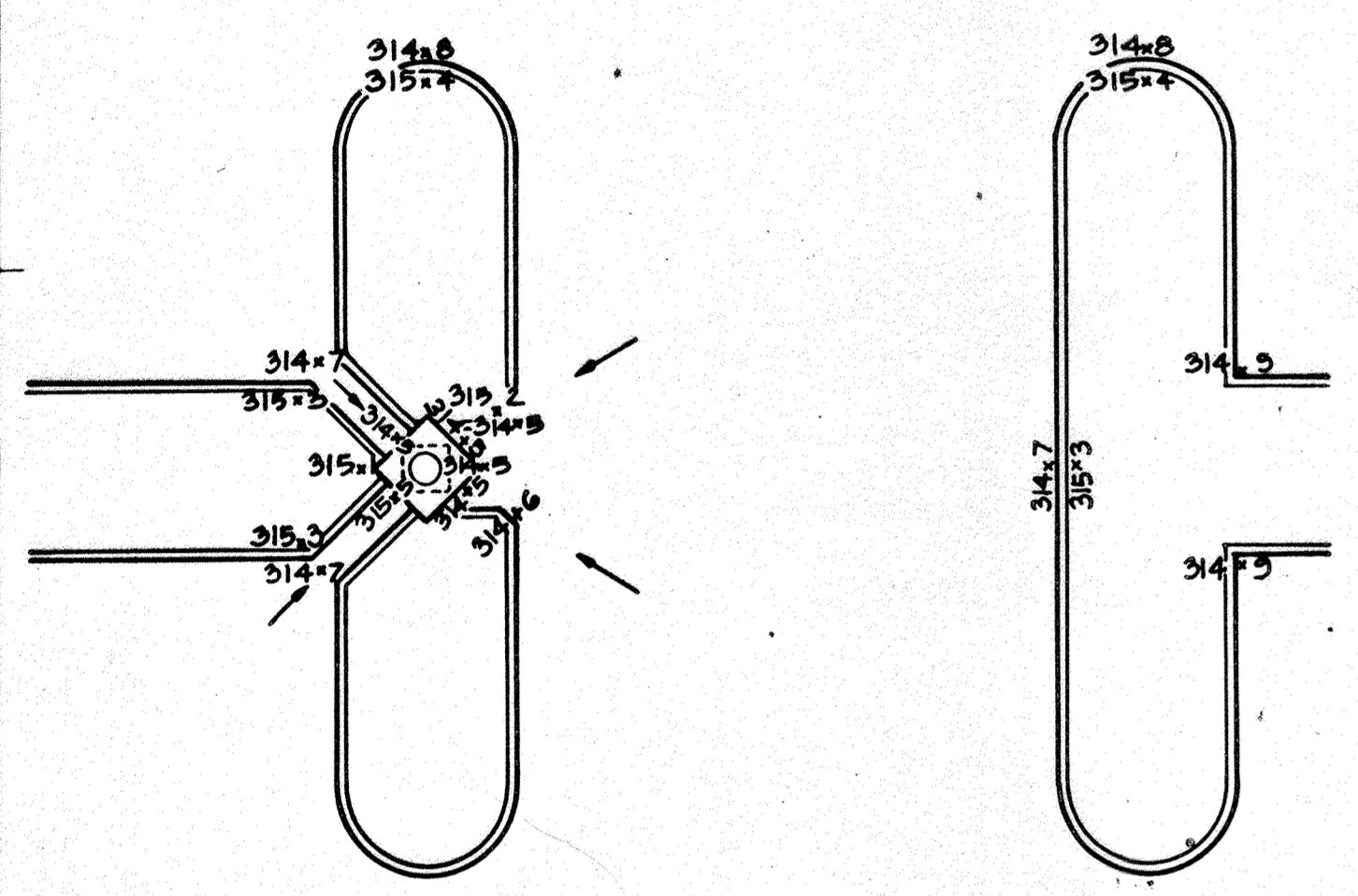

CURB OPENINGS FOR TYPE 'D' INLET WITH SPOT ELEVATIONS
Scale: 1"=10'

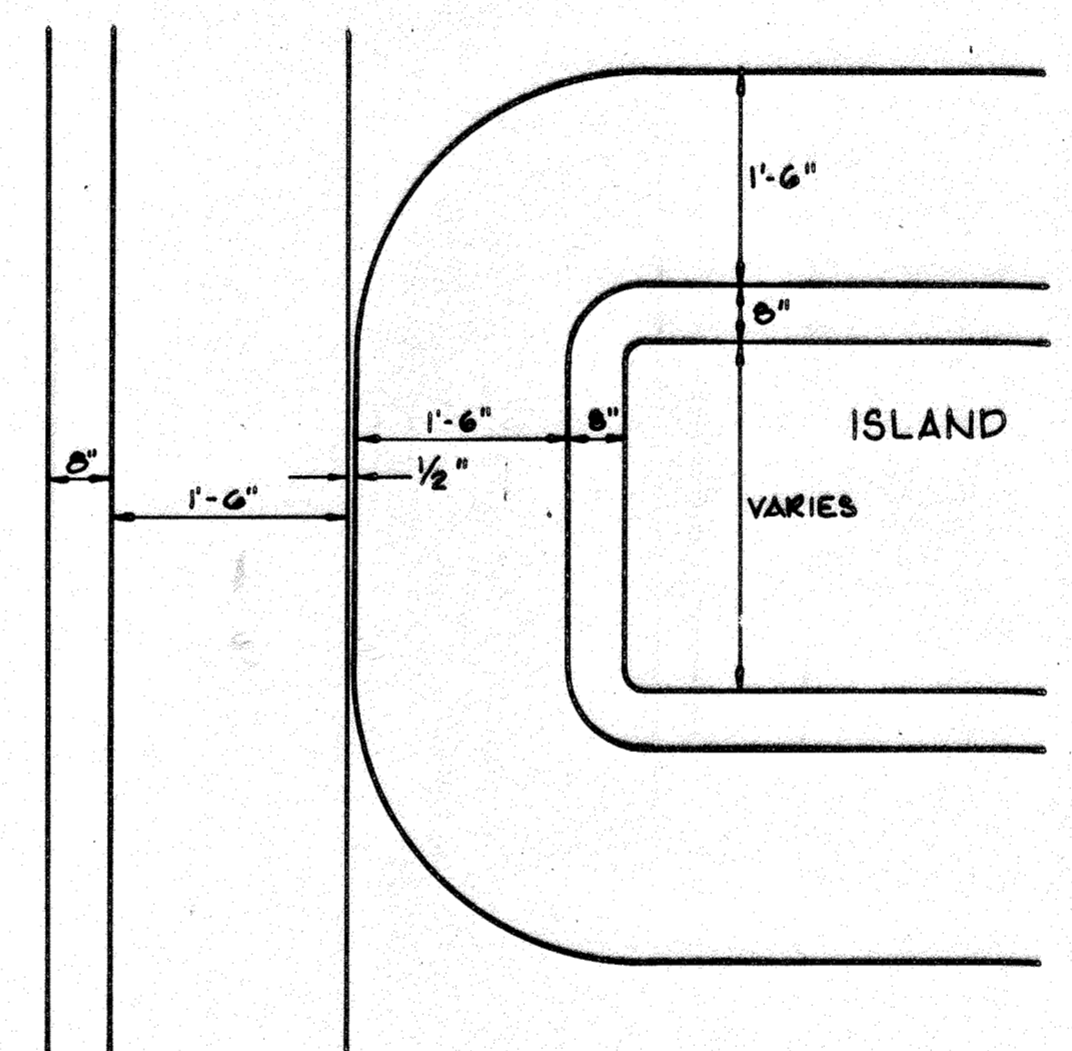

PLAN VIEW OF CURB OPENING REVERSE CURB & GUTTER
NO SCALE

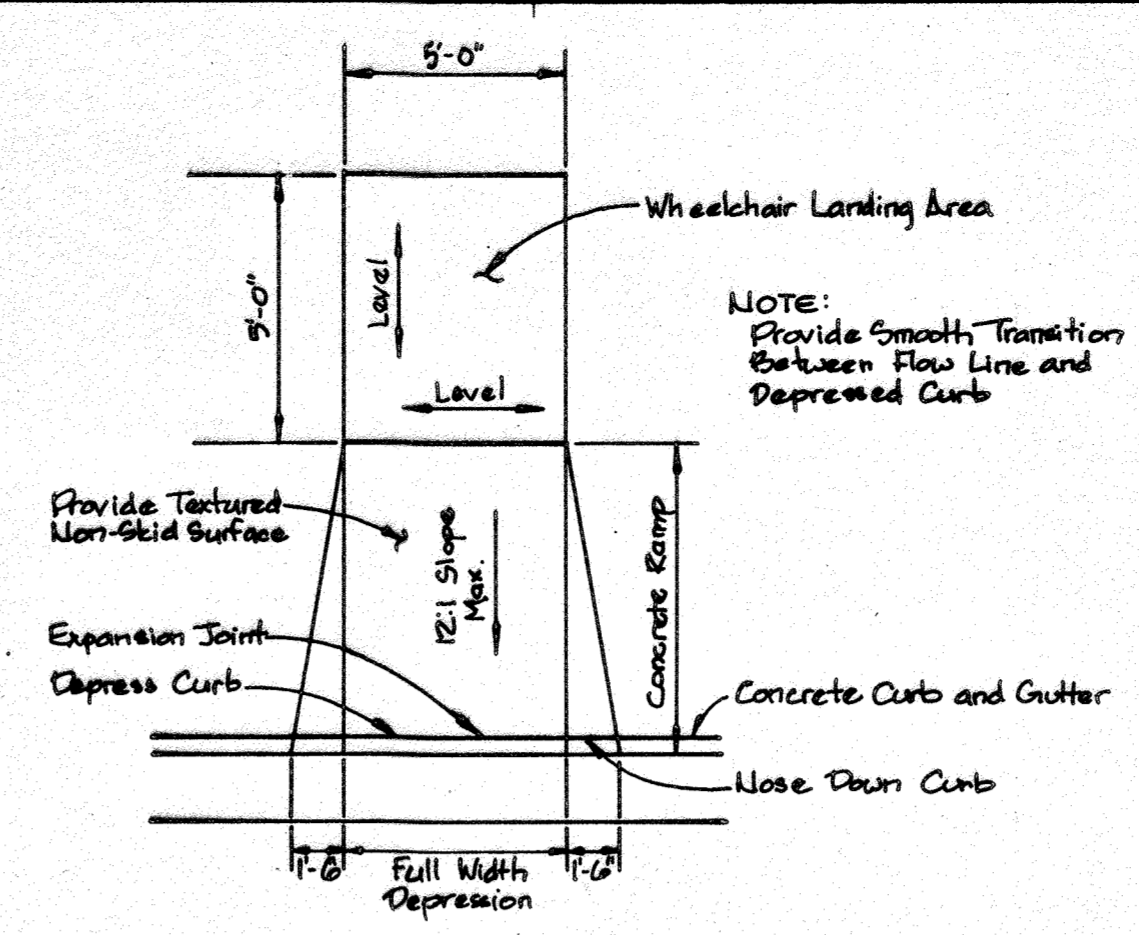

STANDARD

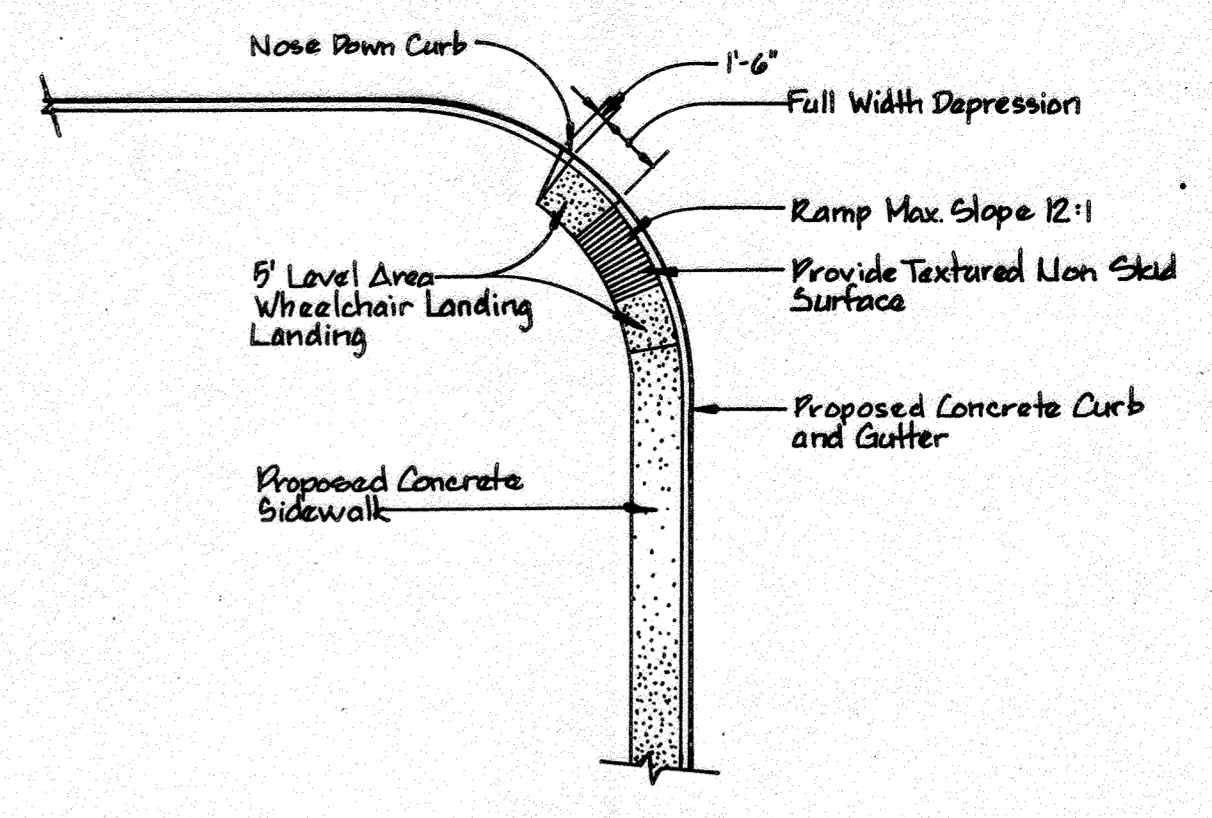

MODIFIED

HANDICAPPED RAMP DETAILS
No Scale

NOTE: Provide Expansion Joint Whenever Sidewalk Abuts Curbs, Buildings, Stairs and Intersections of Walks.

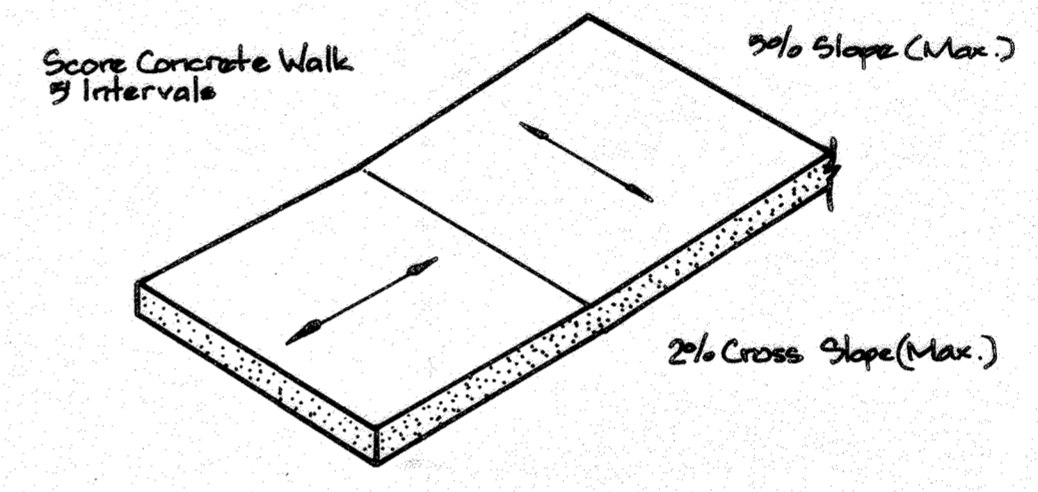

TYPICAL SIDEWALK DETAIL
No Scale

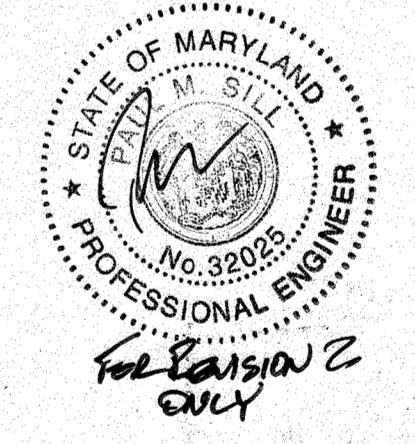
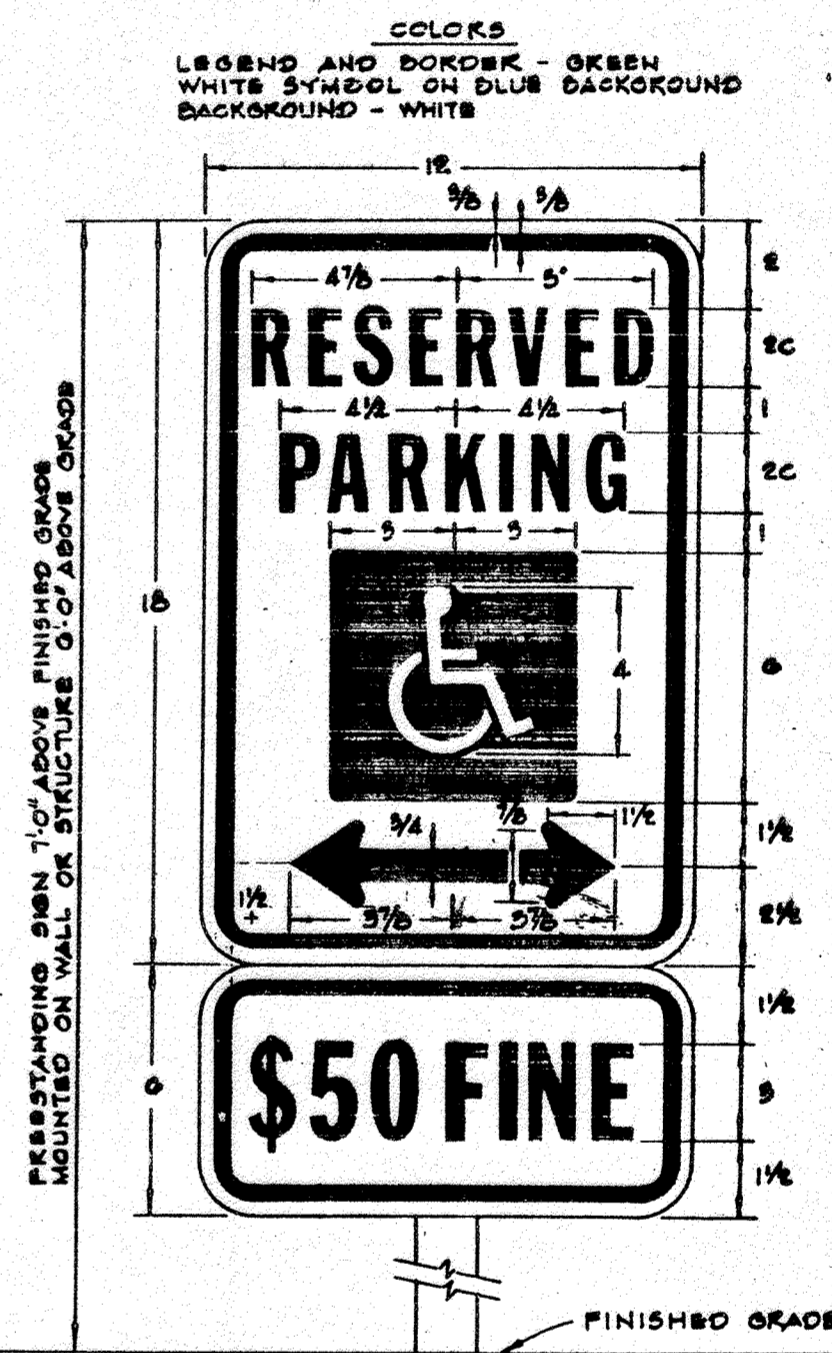

TYPICAL PAVING SECTIONS
NO SCALE

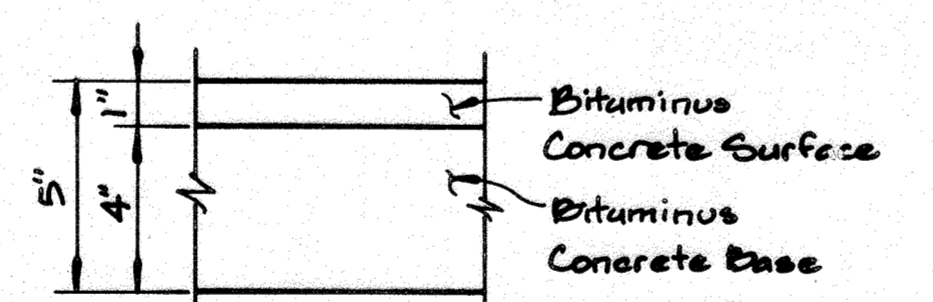

P-1 FULL DEPTH BITUMINOUS CONCRETE

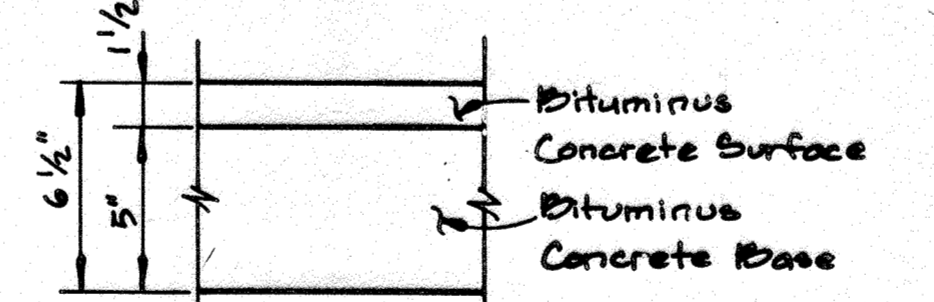

P-2 FULL DEPTH BITUMINOUS CONCRETE

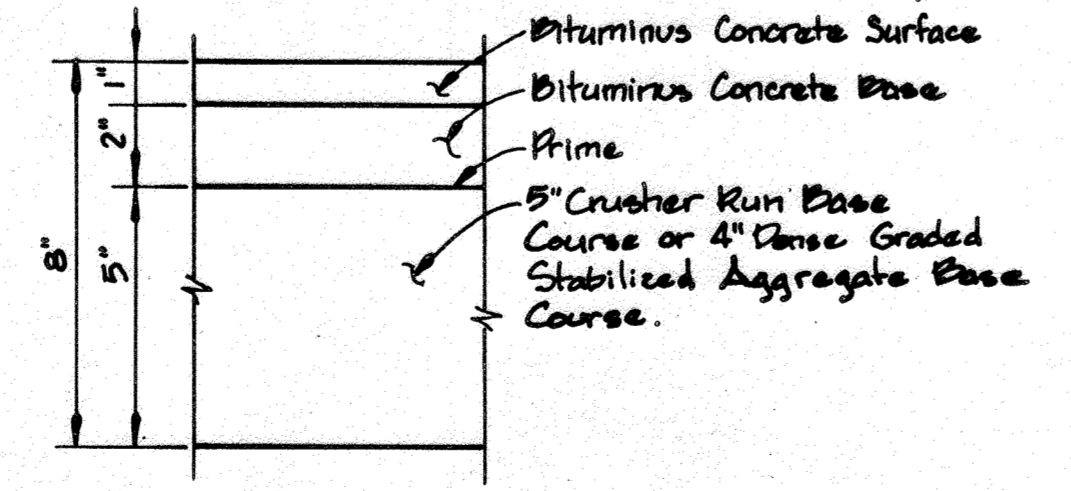

P-1 GRANULAR BASE (ALTERNATE)

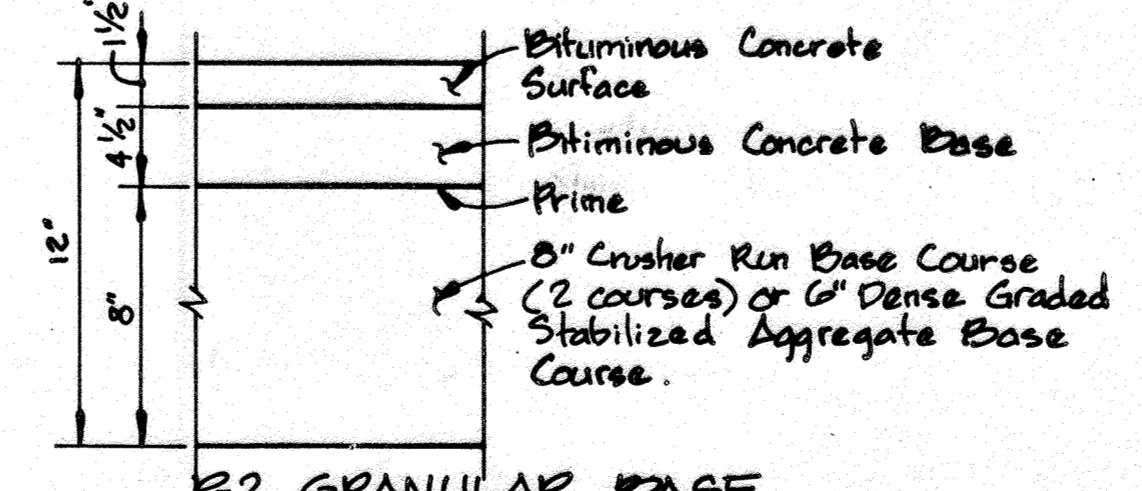

P-2 GRANULAR BASE (ALTERNATE)

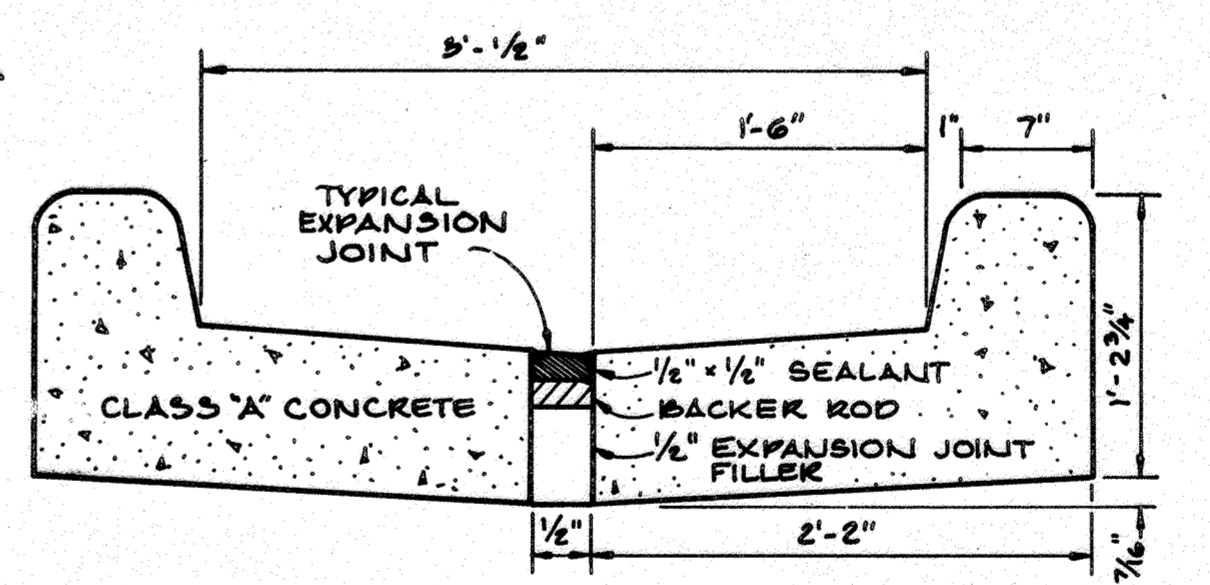

CURB OPENING USING REVERSE CURB & GUTTER
NO SCALE

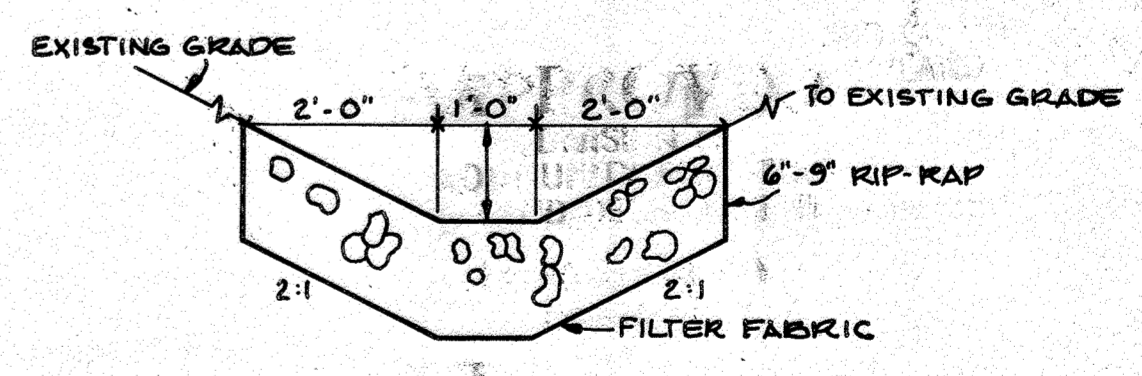

RIP-RAP CHANNEL TYPICAL SECTION
NO SCALE

APPROVED
DIVISION OF COMMUNITY PLANNING & LAND DEVELOPMENT
HOWARD COUNTY, MARYLAND
DATE: 8-27-89
[Signature]

DEVELOPER
CUMMS CG LLC
1540 SMITH AVENUE SUITE 200
BALTIMORE, MARYLAND 21209
WALTERS/SEA/P/N
443-941-3901

OWNER:
UNIVERSITY OF MARYLAND MEDICAL SYSTEM
1060 COLUMBIA GATEWAY DRIVE
COLUMBIA, MD 21046

STANDARD 7" COMBINATION CURB AND GUTTER
NO SCALE

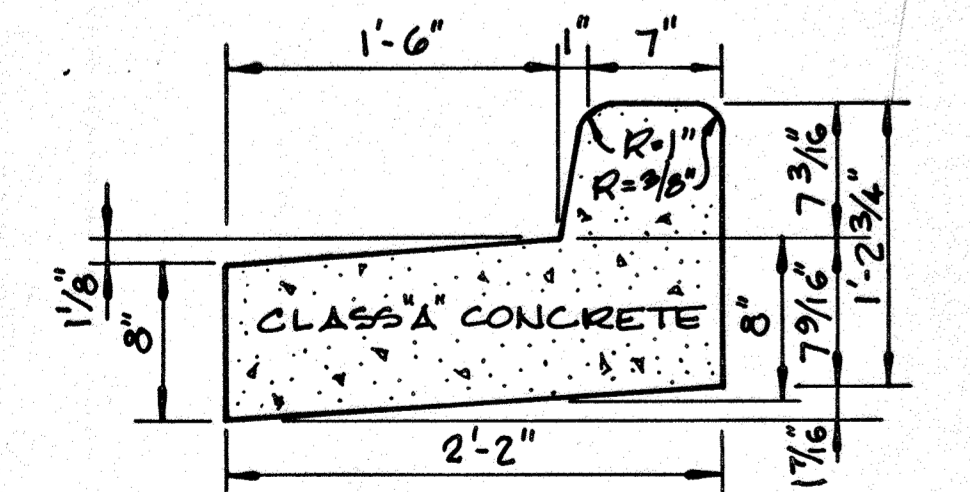

REVERSE 7" COMBINATION CURB AND GUTTER
NO SCALE

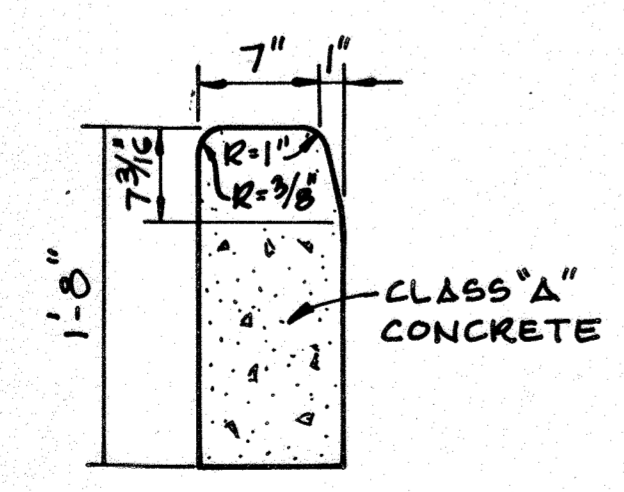

STANDARD BARRIER CURB
NO SCALE

WHITMAN, REQUARDT AND ASSOCIATES ENGINEERS
2315 SAINT PAUL ST.
BALTIMORE, MARYLAND 21218

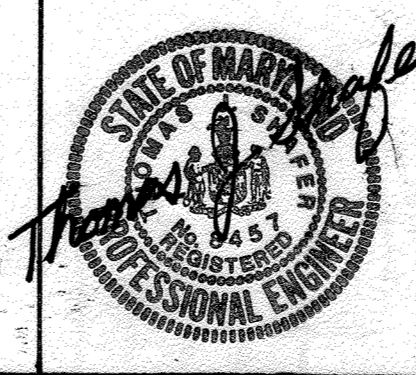

ELECTION DISTRICT NO. 6
TAX MAP NO. 43

SITE DEVELOPMENT PLAN
UNIVERSITY OF MARYLAND MEDICAL SYSTEM
COLUMBIA, GATEWAY
COLUMBIA, MARYLAND

HOWARD COUNTY
PARCEL S-2

Richter Cornbrooks Gribble, Inc.
Architects/Planners
2120 North Charles Street
Baltimore, Maryland 21218

No.	Description	Date

Revisions

Scale as Shown

Project No. 40555

Date 9/11/89

Drawing No. C-4 of 9

APPROVED: FOR PUBLIC WATER AND PUBLIC SEWERAGE
STORM DRAINAGE SYSTEMS AND PUBLIC ROADS
HOWARD COUNTY DEPARTMENT PUBLIC WORKS

DIRECTOR: *[Signature]* DATE: 12/15/89

CHIEF, BUREAU OF
ENGINEERING: *[Signature]* DATE: 12-14-89

APPROVED: FOR PUBLIC WATER AND PUBLIC SEWERAGE SYSTEMS
HOWARD COUNTY HEALTH DEPARTMENT

COUNTY HEALTH OFFICER: *[Signature]* DATE: 12-19-89

APPROVED: HOWARD COUNTY THE DEPARTMENT
OF PLANNING AND ZONING

PLANNING DIRECTOR: *[Signature]* DATE: 12/24/89

CHIEF DIVISION
OF COMMUNITY PLANNING
AND LAND DEVELOPMENT: *[Signature]* DATE: 1/2/90

**Richter
Cornbrooks
Gribble, Inc.**

Architects/Planners
2120 North Charles Street
Baltimore, Maryland 21218

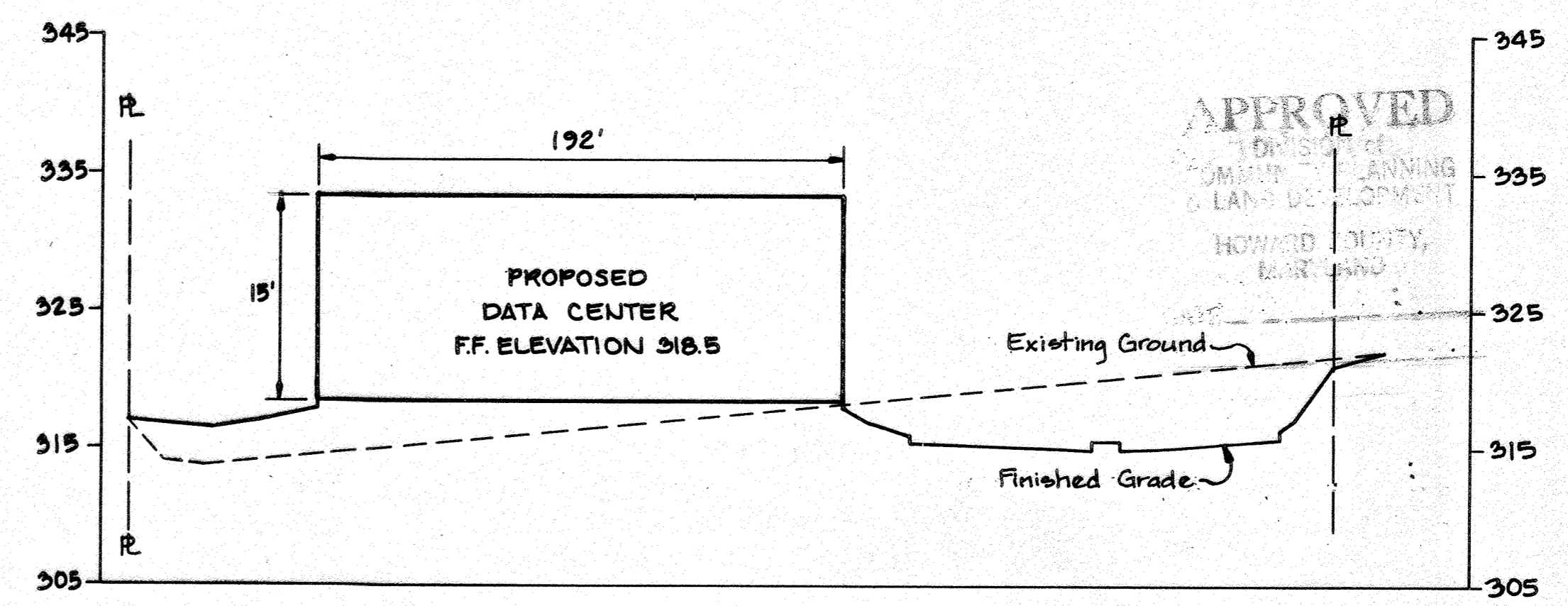
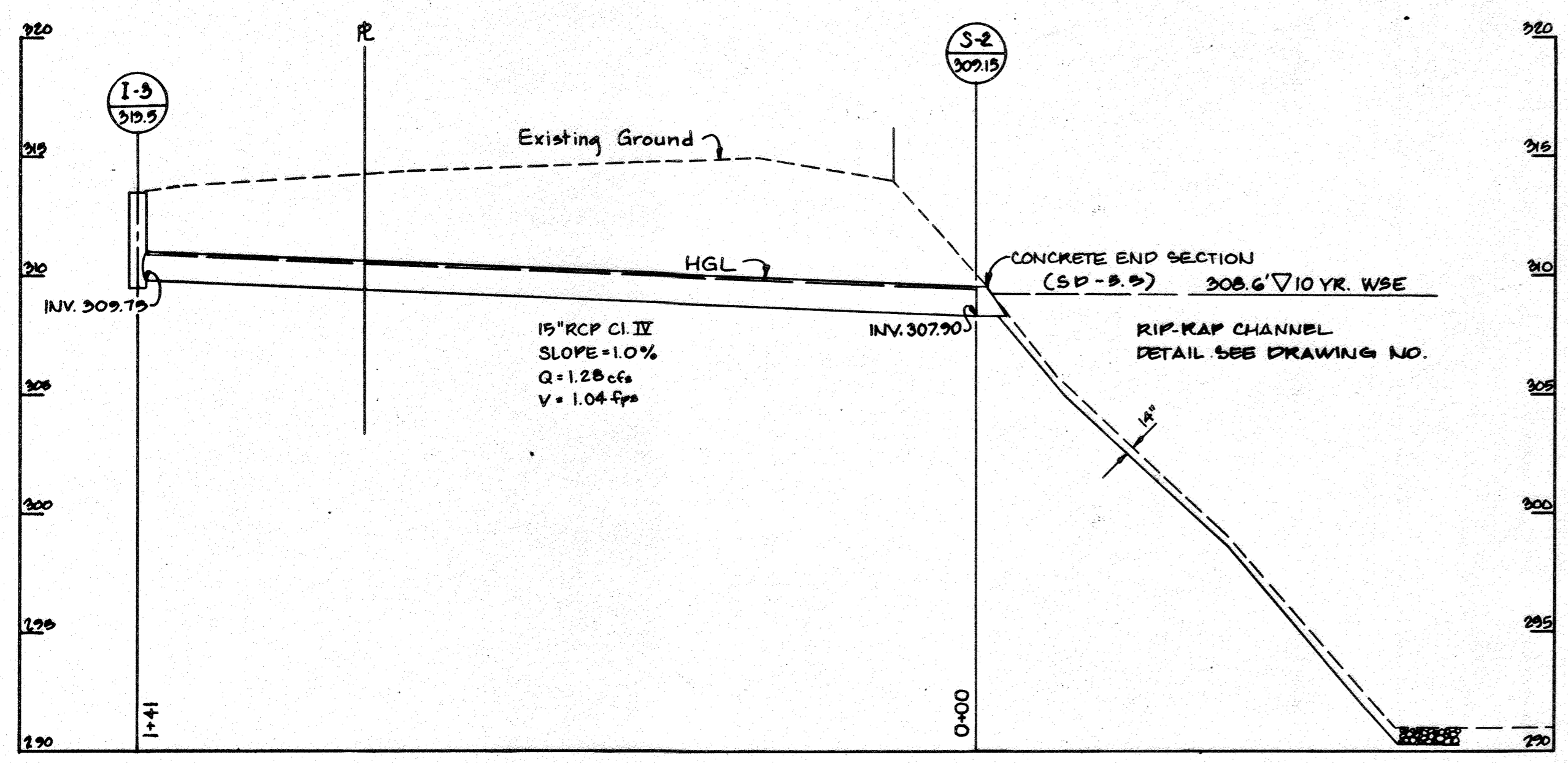

CROSS SECTION 'A-A'
Scale: Hor. 1"=20'
Ver. 1"=10'

PROFILES
SCALE:
HORIZONTAL: 1"=20'
VERTICAL: 1"=5'

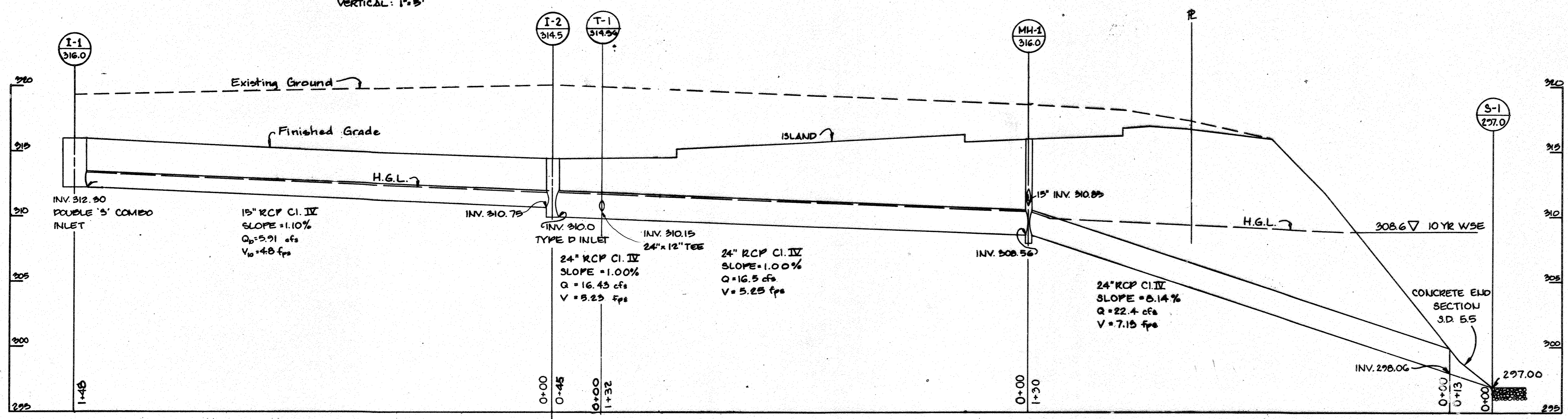

STORM DRAIN PROFILES
SCALE:
HORIZONTAL: 1"=20'
VERTICAL: 1"=5'

APPROVED

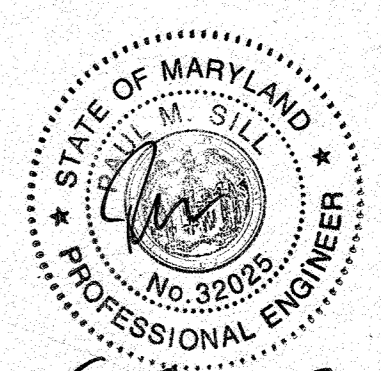

APPROVED
DIVISION of
COMMUNITY PLANNING
& LAND DEVELOPMENT
HOWARD COUNTY,
MARYLAND
DATE: 8-27-89
J.A.

DEVELOPER
CLUMMS CG LLC
13405 SMITH AVE. SUITE 200
BALTIMORE, MARYLAND 21209
WALTER SKRAFFIN
443-961-5901

OWNER
UNIVERSITY OF MARYLAND
MEDICAL SYSTEM
1060 COLUMBIA GATEWAY DRIVE
COLUMBIA, MD. 21046

WHITMAN, REQUARDT
AND ASSOCIATES
ENGINEERS
2315 SAINT PAUL ST.
BALTIMORE, MARYLAND

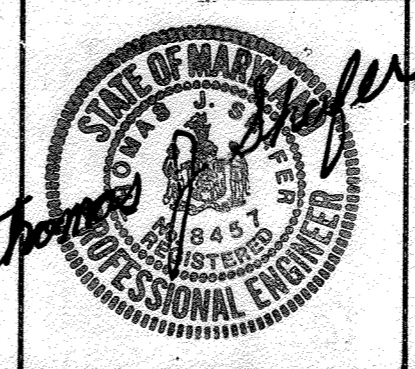

ELECTION DISTRICT NO. 6
TAX MAP NO. 43

SITE DEVELOPMENT PLAN
UNIVERSITY OF MARYLAND MEDICAL SYSTEM
COLUMBIA, GATEWAY
COLUMBIA, MARYLAND

HOWARD COUNTY
PARCEL S-2

No.	Description	Date

PROFILES

Scale as Shown
Project No. 40555

Date 9/11/89

Drawing No.

C-5 OF 9

SDP 87-252

APPROVED: FOR PUBLIC WATER AND PUBLIC SEWERAGE STORM DRAINAGE SYSTEMS AND PUBLIC ROADS HOWARD COUNTY DEPARTMENT PUBLIC WORKS
 DIRECTOR: *James J. ...* DATE: 12/16/89
 CHIEF, BUREAU OF ENGINEERING *James J. ...* DATE: 12-14-89
 APPROVED: FOR PUBLIC WATER AND PUBLIC SEWERAGE SYSTEMS HOWARD COUNTY HEALTH DEPARTMENT
 COUNTY HEALTH OFFICER *John ...* DATE: 12-19-89
 APPROVED: HOWARD COUNTY THE DEPARTMENT OF PLANNING AND ZONING
 PLANNING DIRECTOR: *Joseph ...* DATE: 12/26/89
 CHIEF, DIVISION OF COMMUNITY PLANNING AND LAND DEVELOPMENT *Frank S. ...* DATE: 12/26/89

Richter Cornbrooks Gribble, Inc.
 Architects/Planners
 2120 North Charles Street
 Baltimore, Maryland 21218

PARCEL M-6
 PLAT 7470
 HOWARD RESEARCH & DEVELOPMENT LAND CO.

PARCEL S-6
 PLAT 8805
 HOWARD RESEARCH & DEVELOPMENT LAND CO.

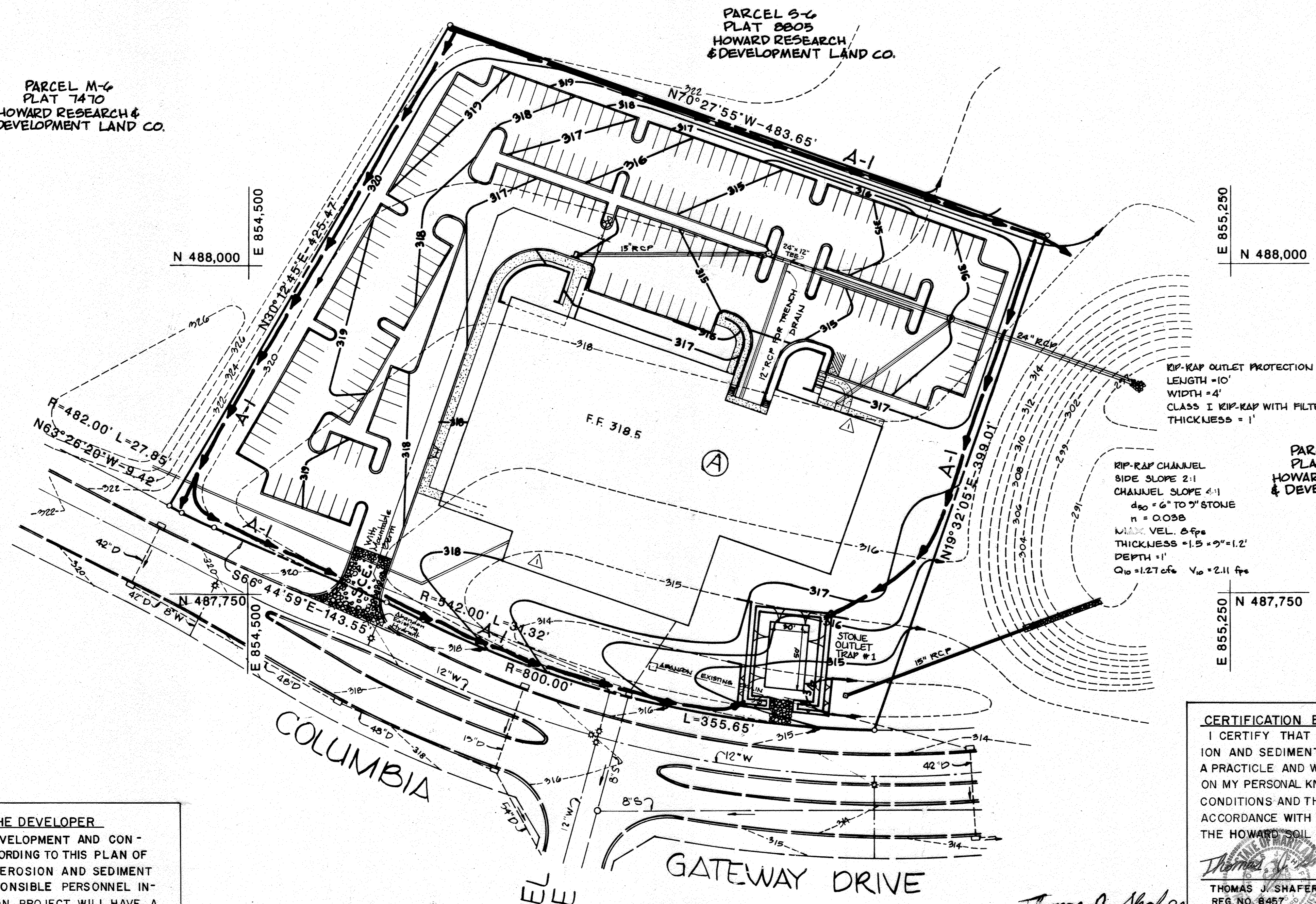

APPROVED
 DIVISION OF COMMUNITY PLANNING & LAND DEVELOPMENT
 HOWARD COUNTY, MARYLAND
 DATE 8-27-89
J.B.

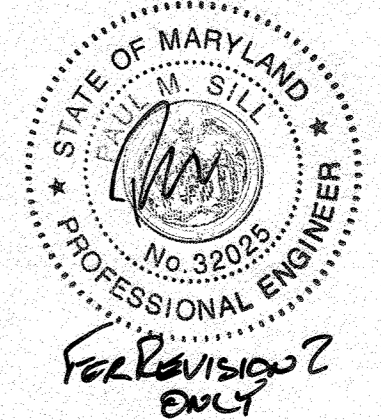

STONE OUTLET TRAP # 1 SUMMARY TABLE

EXISTING DRAINAGE AREA	4.82 ACRES
PROPOSED DRAINAGE AREA	4.82 ACRES
STORAGE REQUIRED	8676 FT
STORAGE PROVIDED	8816 FT
BOTTOM	30'x50'
SLOPE	2:1
BOTTOM ELEVATION	310
OUTLET ELEVATION	314
CLEANOUT ELEVATION	312
EMBANKMENT ELEVATION	315
WEIR LENGTH	20'

RIP-RAP OUTLET PROTECTION
 LENGTH = 10'
 WIDTH = 4'
 CLASS I RIP-RAP WITH FILTER FABRIC
 THICKNESS = 1'

RIP-RAP CHANNEL
 SIDE SLOPE 2:1
 CHANNEL SLOPE 4:1
 d₅₀ = 6" TO 9" STONE
 n = 0.038
 MAX. VEL. 5 fpm
 THICKNESS = 1.5' x 9" = 1.2'
 DEPTH = 1'
 C₁₀ = 1.27 cfs V₁₀ = 2.11 fpm

PARCEL S-1
 PLAT 8805
 HOWARD RESEARCH & DEVELOPMENT LAND CO.

DEVELOPER
 CIUMMS CG LLC
 1340 SMITH AVENUE, SUITE 200
 BALTIMORE, MARYLAND 21209
 WALTER BERKATIN
 443-461-5901

OWNER
 UNIVERSITY OF MARYLAND
 MEDICAL SYSTEM
 7060 COLUMBIA GATEWAY DRIVE
 COLUMBIA, MD. 21046

CERTIFICATION BY THE ENGINEER
 I CERTIFY THAT THIS PLAN FOR EROSION AND SEDIMENT CONTROL REPRESENTS A PRACTICABLE AND WORKABLE PLAN BASED ON MY PERSONAL KNOWLEDGE OF THE SITE CONDITIONS AND THAT IT WAS PREPARED IN ACCORDANCE WITH THE REQUIREMENTS OF THE HOWARD SOIL CONSERVATION DISTRICT"
 THOMAS J. SHAFER
 REG. NO. 8457
 DATE 10/04/89

THIS DEVELOPMENT PLAN IS APPROVED FOR SOIL EROSION AND SEDIMENT CONTROL BY THE HOWARD SOIL CONSERVATION DISTRICT.
 APPROVED: *John ...* DATE 12/11/89
 HOWARD S.C.D.
 REVIEWED FOR HOWARD S.C.D. AND MEETS TECHNICAL REQUIREMENTS.
 SIGNATURE: *Thomas J. Shafer* DATE 12/11/89
 S.S. SOIL CONSERVATION SERVICE

CERTIFICATION BY THE DEVELOPER
 "I/WE CERTIFY THAT ALL DEVELOPMENT AND CONSTRUCTION WILL BE DONE ACCORDING TO THIS PLAN OF DEVELOPMENT AND PLAN FOR EROSION AND SEDIMENT CONTROL AND THAT ALL RESPONSIBLE PERSONNEL INVOLVED IN THE CONSTRUCTION PROJECT WILL HAVE A CERTIFICATE OF ATTENDANCE AT A DEPARTMENT OF NATURAL RESOURCES APPROVED TRAINING PROGRAM FOR THE CONTROL OF SEDIMENT AND EROSION BEFORE BEGINNING THE PROJECT. I ALSO AUTHORIZE PERIODIC ON-SITE INSPECTION BY THE HOWARD SOIL CONSERVATION DISTRICT OR THEIR AUTHORIZED AGENTS, AS ARE DEEMED NECESSARY."
 SIGNATURE: *Paul H. ...* DATE 12/23/89

WHITMAN, REQUARDT AND ASSOCIATES ENGINEERS
 2315 SAINT PAUL ST.
 BALTIMORE, MARYLAND 21218



ELECTION DISTRICT NO. 6
 TAX-MAP 43

SITE DEVELOPMENT PLAN
 UNIVERSITY OF MARYLAND MEDICAL SYSTEM
 COLUMBIA, GATEWAY
 COLUMBIA, MARYLAND

HOWARD COUNTY
 PARCEL S-2

No.	Description	Date
1	UPDATED OWNER/DEVELOPER	2/28/89
2	ADDED SIDEWALK @ REAR AND DUCT BANK @ FRONT	12/19/89

Revisions

SEDIMENT CONTROL PLAN

Scale: 1" = 50'

Project No. 40555

Date 9/11/89

Drawing No. C-6 of 9

APPROVED: FOR PUBLIC WATER AND PUBLIC SEWERAGE STORM DRAINAGE SYSTEMS AND PUBLIC ROADS HOWARD COUNTY DEPARTMENT PUBLIC WORKS

DIRECTOR: *James G. [Signature]* DATE: 12/16/89

CHIEF BUREAU OF ENGINEERING: *William S. [Signature]* DATE: 12-14-89

APPROVED: FOR PUBLIC WATER AND PUBLIC SEWERAGE SYSTEMS HOWARD COUNTY HEALTH DEPARTMENT

John Boyda 12-19-89
COUNTY HEALTH OFFICER DATE

APPROVED: HOWARD COUNTY THE DEPARTMENT OF PLANNING AND ZONING

PLANNING DIRECTOR: *James [Signature]* DATE: 12/20/89

CHIEF DIVISION OF COMMUNITY PLANNING AND LAND DEVELOPMENT: *Frank J. [Signature]* DATE: 12/20/89

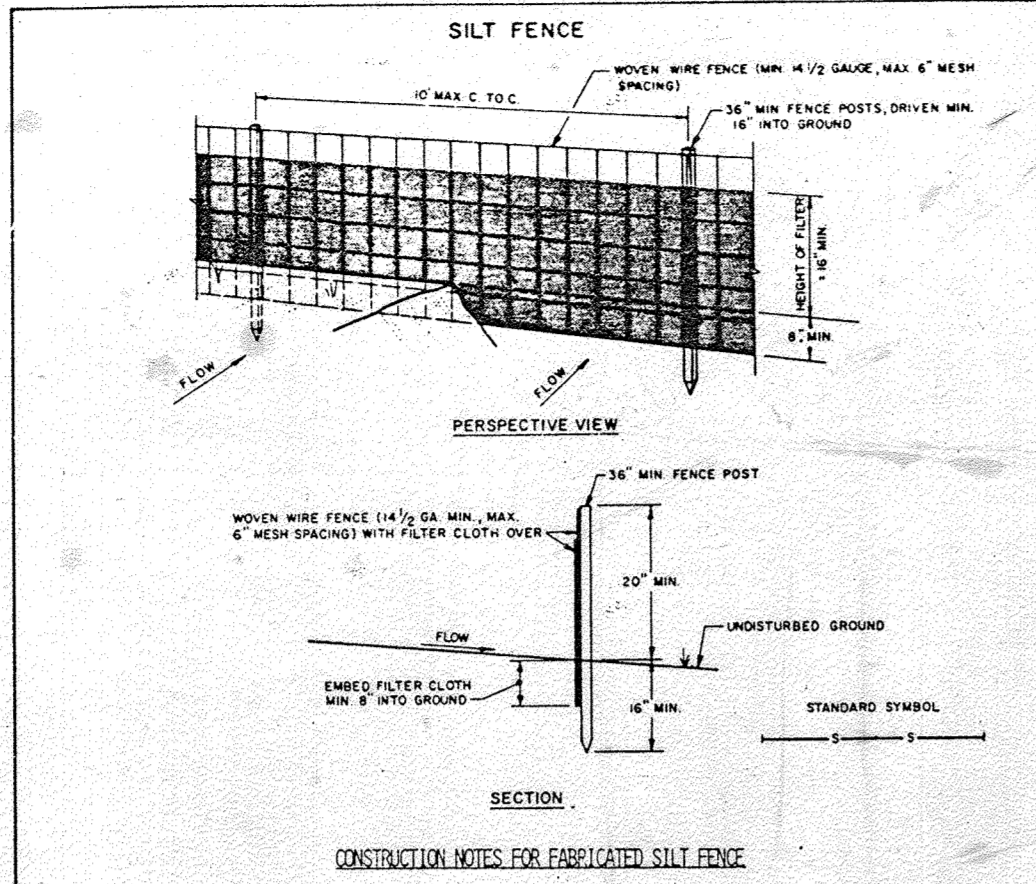

U.S. DEPARTMENT OF AGRICULTURE SOIL CONSERVATION SERVICE COLLEGE PARK, MARYLAND	SILT FENCE	STANDARD DRAWING SF-1
---	------------	--------------------------

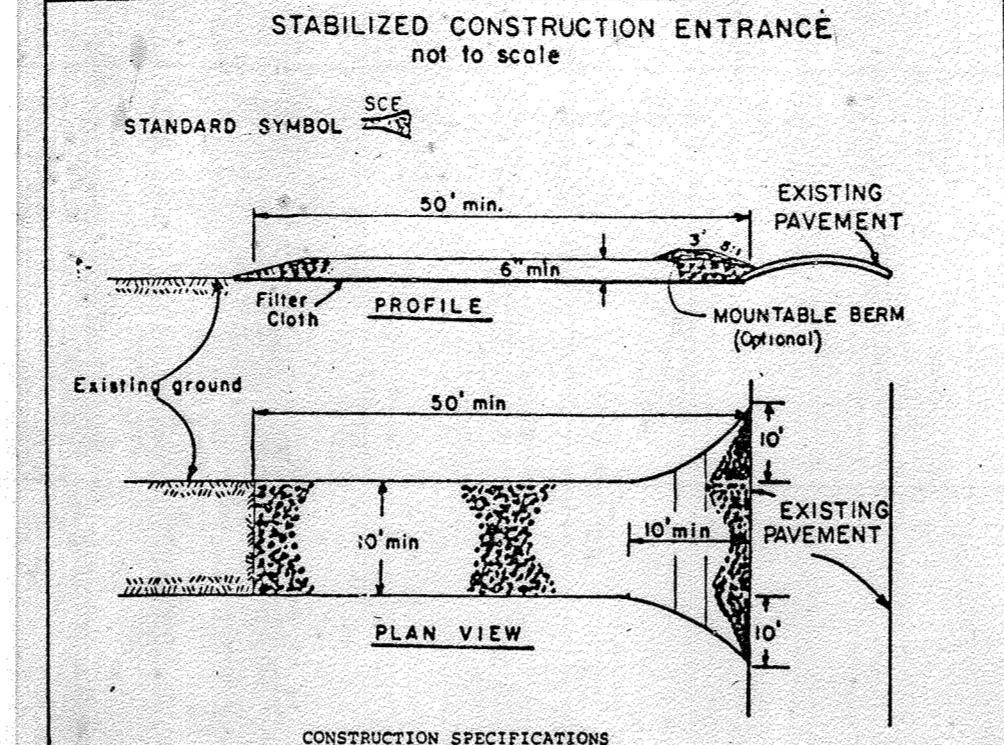

U.S. DEPARTMENT OF AGRICULTURE SOIL CONSERVATION SERVICE College Park, Md.	STABILIZED CONSTRUCTION ENTRANCE	Standard Drawing SC-1
--	----------------------------------	--------------------------

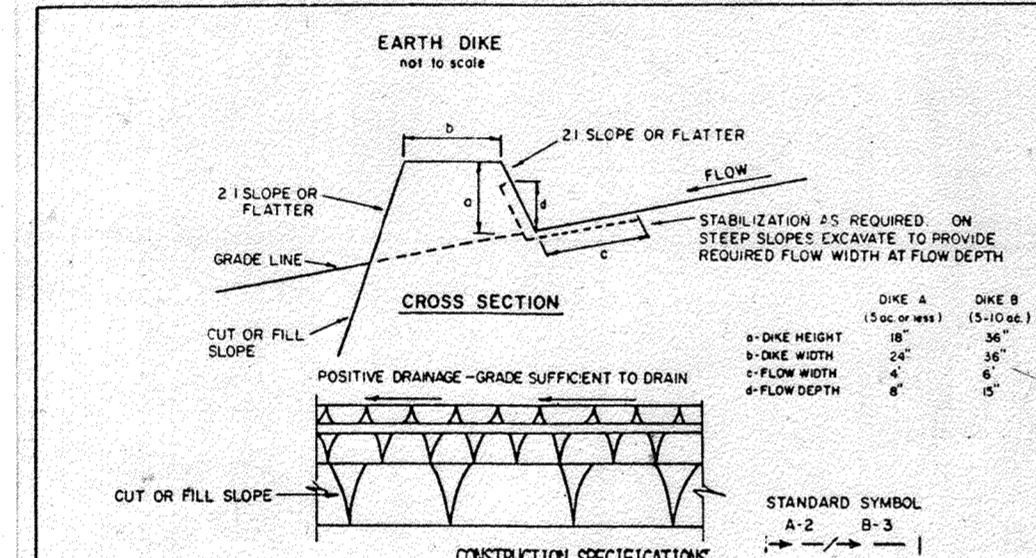

TYPE OF TREATMENT	CHANNEL	DIKE A	DIKE B
1	5-3.0%	SEED AND STRAW MULCH	SEED AND STRAW MULCH
2	3.1-5.0%	SEED AND STRAW MULCH	SEED USING LIME, OR EXCESSIVE SOIL, OR STONE
3	5.1-8.0%	SEED WITH LIME, OR SOIL, OR STONE	LINED RIP-RAP 4-8"
4	8.1-20%	LINED RIP-RAP 4-8"	ENGINEERING DESIGN

A. Stone to be 2 inch stone, or recycled concrete equivalent, in a layer at least 3 inches in thickness and be pressed into the soil with construction equipment.
B. Rip-rap to be 4-8 inches in a layer at least 8 inches thickness and pressed into the soil.
C. APPROVED EQUIVALENTS CAN BE SUBSTITUTED FOR ANY OF THE ABOVE MATERIALS.
7. PERIODIC INSPECTION AND REQUIRED MAINTENANCE MUST BE PROVIDED AFTER EACH RAIN EVENT.

U.S. DEPARTMENT OF AGRICULTURE SOIL CONSERVATION SERVICE COLLEGE PARK, MARYLAND	EARTH DIKE	STANDARD DRAWING ED-1
---	------------	--------------------------

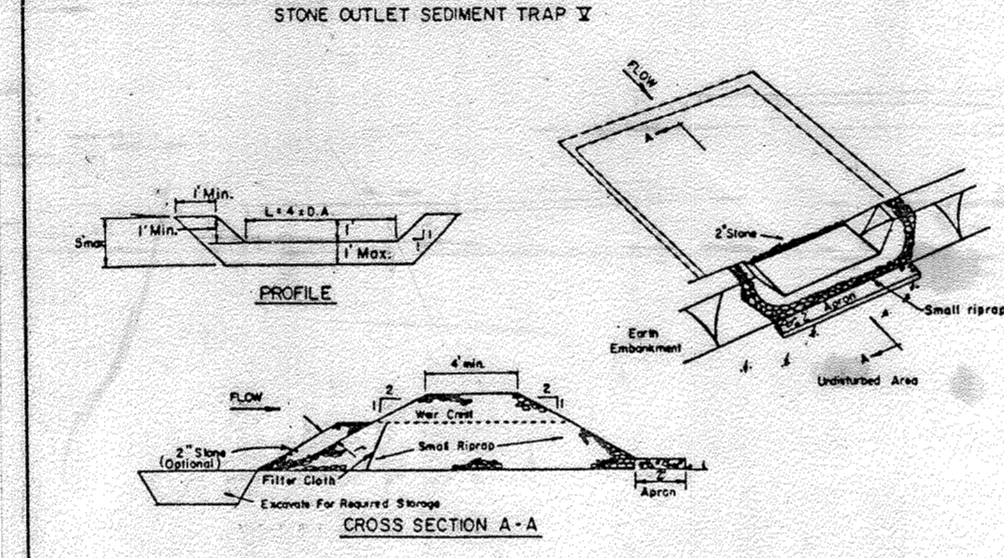

U.S. DEPARTMENT OF AGRICULTURE SOIL CONSERVATION SERVICE COLLEGE PARK, MARYLAND	STONE OUTLET SEDIMENT TRAP	STANDARD DRAWING ST-X
---	----------------------------	--------------------------

SEDIMENT CONTROL NOTES:

- 1) A minimum of 24 hours notice must be given to the Howard County Office of Inspection and Permits prior to the start of any construction. (892-2437)
- 2) All vegetative and structural practices are to be installed according to the provisions of this plan and are to be in conformance with the 1983 MARYLAND STANDARDS AND SPECIFICATIONS FOR SOIL EROSION AND SEDIMENT CONTROL.
- 3) Following initial soil disturbance or redistribution, permanent or temporary stabilization shall be completed within: a) 7 calendar days for all perimeter sediment control structures, dikes, perimeter slopes and all slopes greater than 3:1, b) 14 days as to all other disturbed or graded areas on the project site.
- 4) All sediment traps/basins shown must be fenced and warning signs posted around their perimeter in accordance with Vol. 1, Chapter 12, of the HOWARD COUNTY DESIGN MANUAL, Storm Drainage.
- 5) All disturbed areas must be stabilized within the time period specified above in accordance with the 1983 MARYLAND STANDARDS AND SPECIFICATIONS FOR SOIL EROSION AND SEDIMENT CONTROL for permanent seedings (Sec. 51) and (Sec. 54), temporary seeding (Sec. 50) and mulching (Sec. 52). Temporary stabilization with mulch alone can only be done when recommended seeding dates do not allow for proper germination and establishment of grasses.
- 6) All sediment control structures are to remain in place and are to be maintained in operative condition until permission for their removal has been obtained from the Howard County Sediment Control Inspector.
- 7) Site Analysis:
 - Total Area of Site: 6.154 Acres
 - Area Disturbed: 4.8 Acres
 - Area to be roofed or paved: 2.0 Acres
 - Area to be vegetatively stabilized: 1.6 Acres
 - Total Cut: 10,000 Cu. yds
 - Total Fill: 10,000 Cu. yds
 - Offsite waste/borrow area location: N/A
- 8) Any sediment control practice which is disturbed by grading activity for placement of utilities must be repaired on the same day of disturbance.
- 9) Additional sediment controls must be provided, if deemed necessary by the Howard County DEP sediment control inspector.
- 10) On all sites with disturbed areas in excess of 2 acres, approval of the inspection agency shall be requested upon completion of installation of perimeter erosion and sediment controls, but before proceeding with any other earth disturbance or grading. Other building or grading inspection approvals may not be authorized until this initial approval by the inspection agency is made.

PERMANENT SEEDING NOTES:

Apply to graded or cleared area not subject to immediate further disturbance where a permanent long-lived vegetative cover is needed.

Seedbed Preparation: Loosen upper three inches of soil by raking, disking or other acceptable means before seeding, if not previously indicated.

Soil Amendments: In lieu of soil test recommendations, use one of the following schedules:

- 1) Preferred - Apply 2 tons per acre dolomitic limestone (92 lbs/1000 square ft) and 600 lbs per acre 10-10-10 fertilizer (14 lbs/1000 sq ft) before seeding. Harrow or disc into upper three inches of soil. At time of seeding, apply 400 lbs per acre 30-0-0 ureaform fertilizer (9 lbs/1000 sq ft).
- 2) Acceptable - Apply 2 tons per acre dolomitic limestone (92 lbs/1000 sq ft) and 1000 lbs per acre 10-10-10 fertilizer (23 lbs/1000 sq ft) before seeding. Harrow or disc into upper three inches of soil.

Seeding - For the periods March 1 thru April 30, and August 1 thru October 15, seed with 60 lbs per acre (1.4 lbs/1000 sq ft) of Kentucky 31 Tall Fescue. For the period May 1 thru July 31, seed with 60 lbs Kentucky 31 Tall Fescue per acre and 2 lbs per acre (.05 lbs/1000 sq ft) of weeping lovegrass. During the period of October 16 thru February 28, protect site by: Option (1) 2 tons per acre of well anchored straw mulch and seed as soon as possible in the spring. Option (2) Use sod. Option (3) Seed with 60 lbs/acre Kentucky 31 Tall Fescue and mulch with 2 tons/acre well anchored straw.

Mulching - Apply 1 1/2 to 2 tons per acre (70 to 90 lbs/1000 sq ft) of unrotted small grain straw immediately after seeding. Anchor mulch immediately after application using mulch anchoring tool or 218 gallons per acre (5 gal/1000 sq ft) of emulsified asphalt on flat areas. On slopes 8 feet or higher, use 348 gallons per acre (8 gal/1000 sq ft) for anchoring.

Maintenance - Inspect all seeded areas and make needed repairs, replacements and reseedings.

TEMPORARY SEEDING NOTES:

Apply to graded or cleared areas likely to be redistributed where a short-term vegetative cover is needed.

Seedbed Preparation: Loosen upper three inches of soil by raking, disking or other acceptable means before seeding, if not previously indicated.

Soil Amendments: Apply 60 lbs per acre 10-10-10 fertilizer (14 lbs/1000 sq ft).

Seeding: For periods March 1 thru April 30 and from August 15 thru November 15, seed with 25 bushels per acre of annual rye (3.2 lbs/1000 sq ft). For the period May 1 thru August 14, seed with 3 lbs per acre of weeping lovegrass (.07 lbs/1000 sq ft). For the period November 16 thru February 28, protect site by applying 2 tons per acre of well anchored straw mulch and seed as soon as possible in the spring, or use sod.

Mulching: Apply 1 1/2 to 2 tons per acre (70 to 90 lbs/1000 sq ft) of unrotted small grain straw immediately after seeding. Anchor mulch immediately after application using mulch anchoring tool or 218 gal per acre (5 gal/1000 sq ft) of emulsified asphalt on flat areas. On slopes 8 ft or higher, use 348 gal per acre (8 gal/1000 sq ft) for anchoring.

Refer to the 1983 MARYLAND STANDARDS AND SPECIFICATIONS FOR SOIL EROSION AND SEDIMENT CONTROL for rate and methods not covered.

CERTIFICATION BY THE DEVELOPER

"I/WE CERTIFY THAT ALL DEVELOPMENT AND CONSTRUCTION WILL BE DONE ACCORDING TO THIS PLAN OF DEVELOPMENT AND PLAN FOR EROSION AND SEDIMENT CONTROL AND THAT ALL RESPONSIBLE PERSONNEL INVOLVED IN THE CONSTRUCTION PROJECT WILL HAVE A CERTIFICATE OF ATTENDANCE AT A DEPARTMENT OF NATURAL RESOURCES APPROVED TRAINING PROGRAM FOR THE CONTROL OF SEDIMENT AND EROSION BEFORE BEGINNING THE PROJECT. I ALSO AUTHORIZE PERIODIC ON-SITE INSPECTION BY THE HOWARD SOIL CONSERVATION DISTRICT OR THEIR AUTHORIZED AGENTS, AS ARE DEEMED NECESSARY."

Thomas J. Shafer 9/11/89
SIGNATURE DATE

CERTIFICATION BY THE ENGINEER

"I CERTIFY THAT THIS PLAN FOR EROSION AND SEDIMENT CONTROL REPRESENTS A PRACTICAL AND WORKABLE PLAN BASED ON MY PERSONAL KNOWLEDGE OF THE SITE CONDITIONS AND THAT IT WAS PREPARED IN ACCORDANCE WITH THE REQUIREMENTS OF THE HOWARD SOIL CONSERVATION DISTRICT."

Thomas J. Shafer 10/04/89
THOMAS J. SHAFER DATE
REG. NO. 8437

THIS DEVELOPMENT PLAN IS APPROVED FOR SOIL EROSION AND SEDIMENT CONTROL BY THE HOWARD SOIL CONSERVATION DISTRICT.

APPROVED: *John P. [Signature]* 12/1/89
HOWARD S.C.D. DATE

REVIEWED FOR HOWARD S.C.D. AND MEETS TECHNICAL REQUIREMENTS.

SIGNATURE: *Thomas J. Shafer* 12/11/89
U.S. SOIL CONSERVATION SERVICE DATE

WHITMAN, REQUARDT AND ASSOCIATES ENGINEERS
2315 SAINT PAUL ST.
BALTIMORE, MARYLAND 21218

SITE DEVELOPMENT PLAN
UNIVERSITY OF MARYLAND MEDICAL SYSTEM
COLUMBIA, GATEWAY
COLUMBIA, MARYLAND

HOWARD COUNTY
PARCEL S-2

ELECTION DISTRICT NO. 6
TAX MAP NO. 43

Richter Cornbrooks Gribble, Inc.
Architects/Planners
2120 North Charles Street
Baltimore, Maryland 21218

UPDATED OWNER/DEVELOPER	2-20-24
Description	Date
Revisions	
SEDIMENT CONTROL DETAILS	
Scale as Shown	40555
Date	9/11/89
Drawing No.	C-7 of 9

SDP 89-252

APPROVED: FOR PUBLIC WATER AND PUBLIC SEWERAGE STORM DRAINAGE SYSTEMS AND PUBLIC ROADS HOWARD COUNTY DEPARTMENT PUBLIC WORKS

DIRECTOR: *James J. St...* DATE: *12/14/89*

CHIEF, BUREAU OF ENGINEERING: *William B. Ray* DATE: *12-14-89*

APPROVED: FOR PUBLIC WATER AND PUBLIC SEWERAGE SYSTEMS HOWARD COUNTY HEALTH DEPARTMENT

John B... DATE: *12-19-89*

COUNTY HEALTH OFFICER: *JF* DATE

APPROVED HOWARD COUNTY DEPARTMENT OF PLANNING AND ZONING

PLANNING DIRECTOR: *Joseph R...* DATE: *12/26/89*

CHIEF DIVISION OF COMMUNITY PLANNING AND LAND DEVELOPMENT: *Paul J. ...* DATE: *12/26/89*

- PLANTING NOTES**
- Plant locations may be field adjusted to avoid final utility placements.
 - All trees and shrubs shall be mulched to a minimum of 18" beyond the edge of the root ball.
 - All shrub masses shall be planted in continuous mulch beds.
 - All wire and non-biodegradable plastic ball ties shall be removed.

PLANTING STANDARDS

All nursery stock shall be planted in accordance with the American Association of Nurserymen, Inc., "American Standards for Nursery Stock," latest edition. Bare-root shall not be allowed for any tree defined as major deciduous, minor deciduous or evergreen.

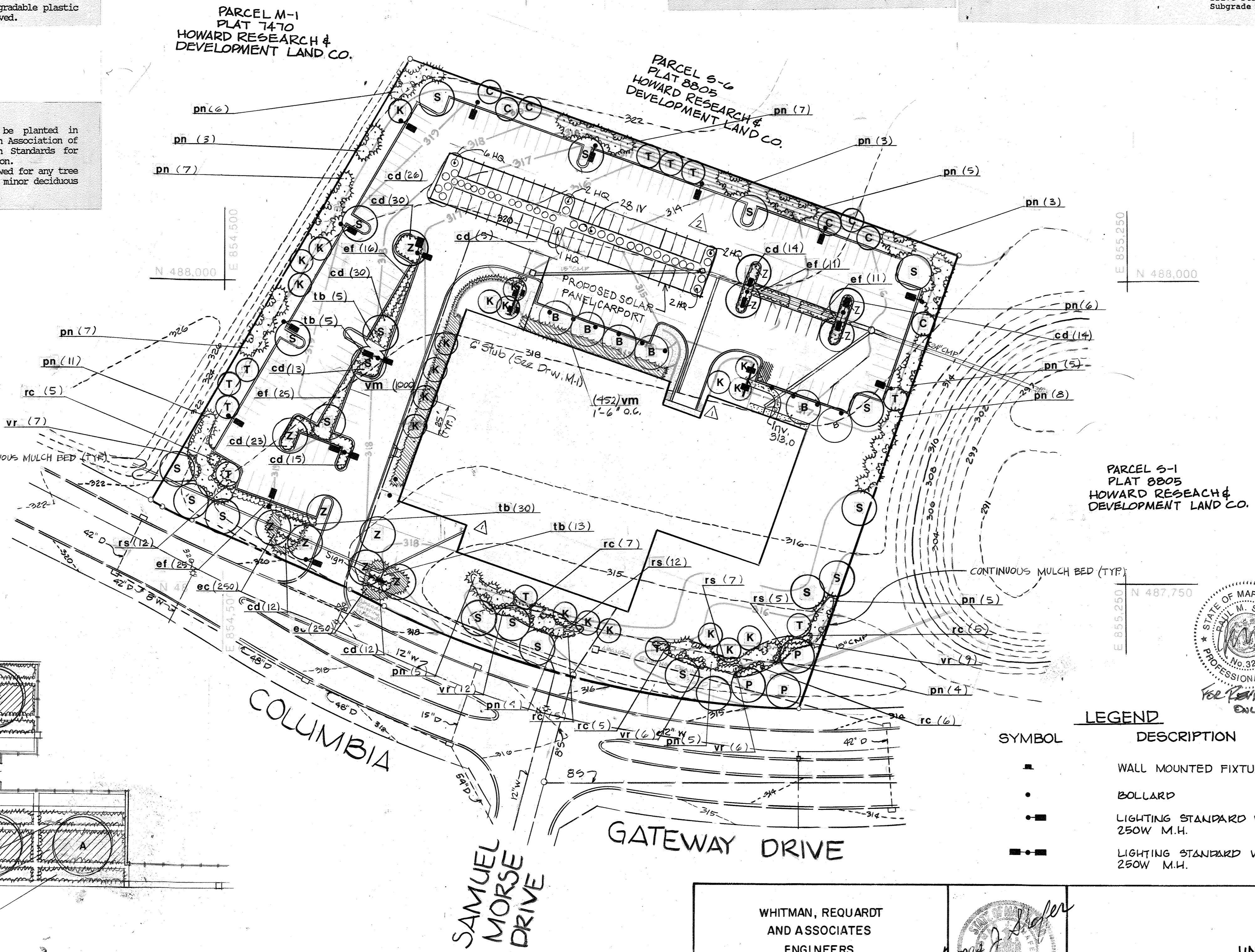
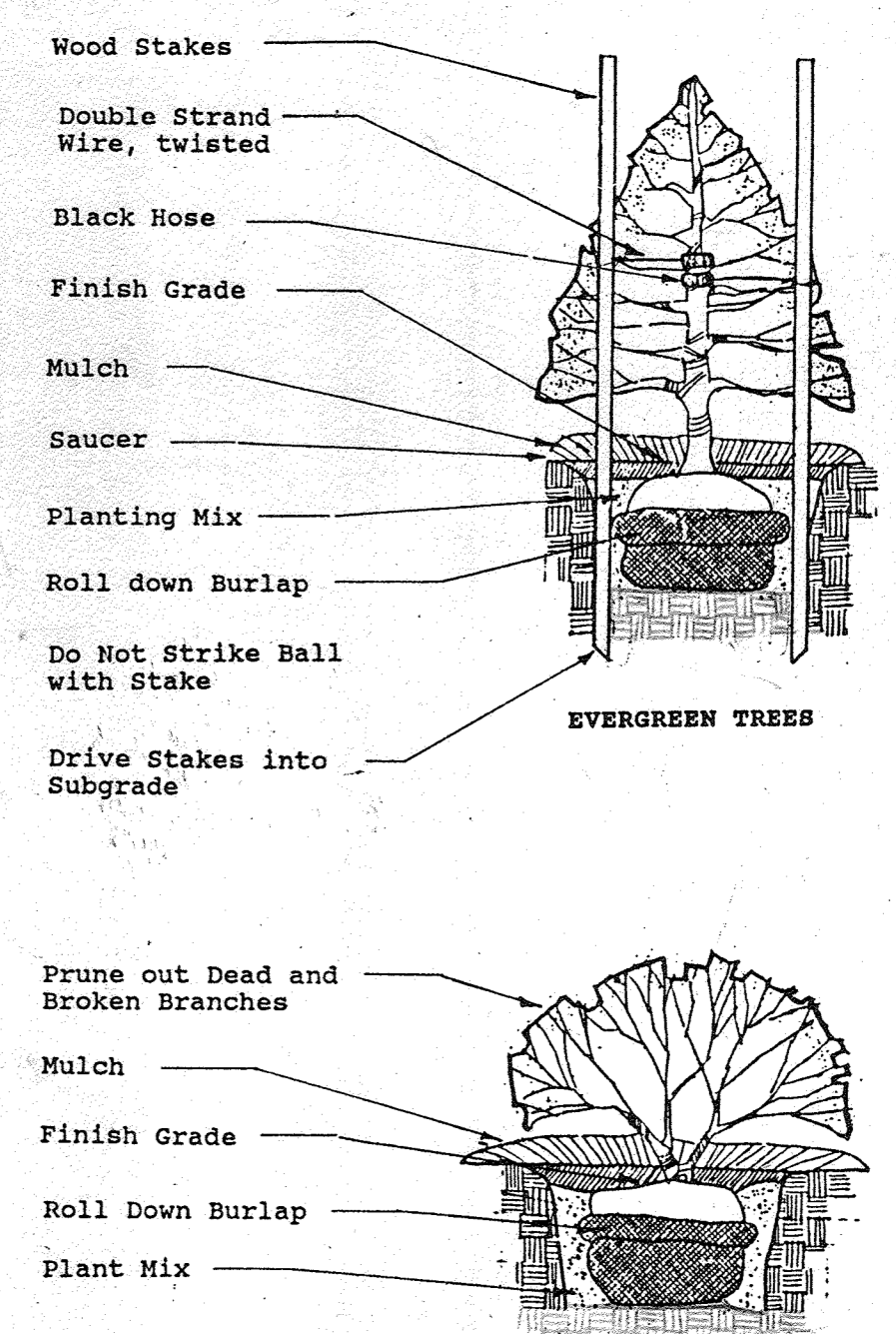
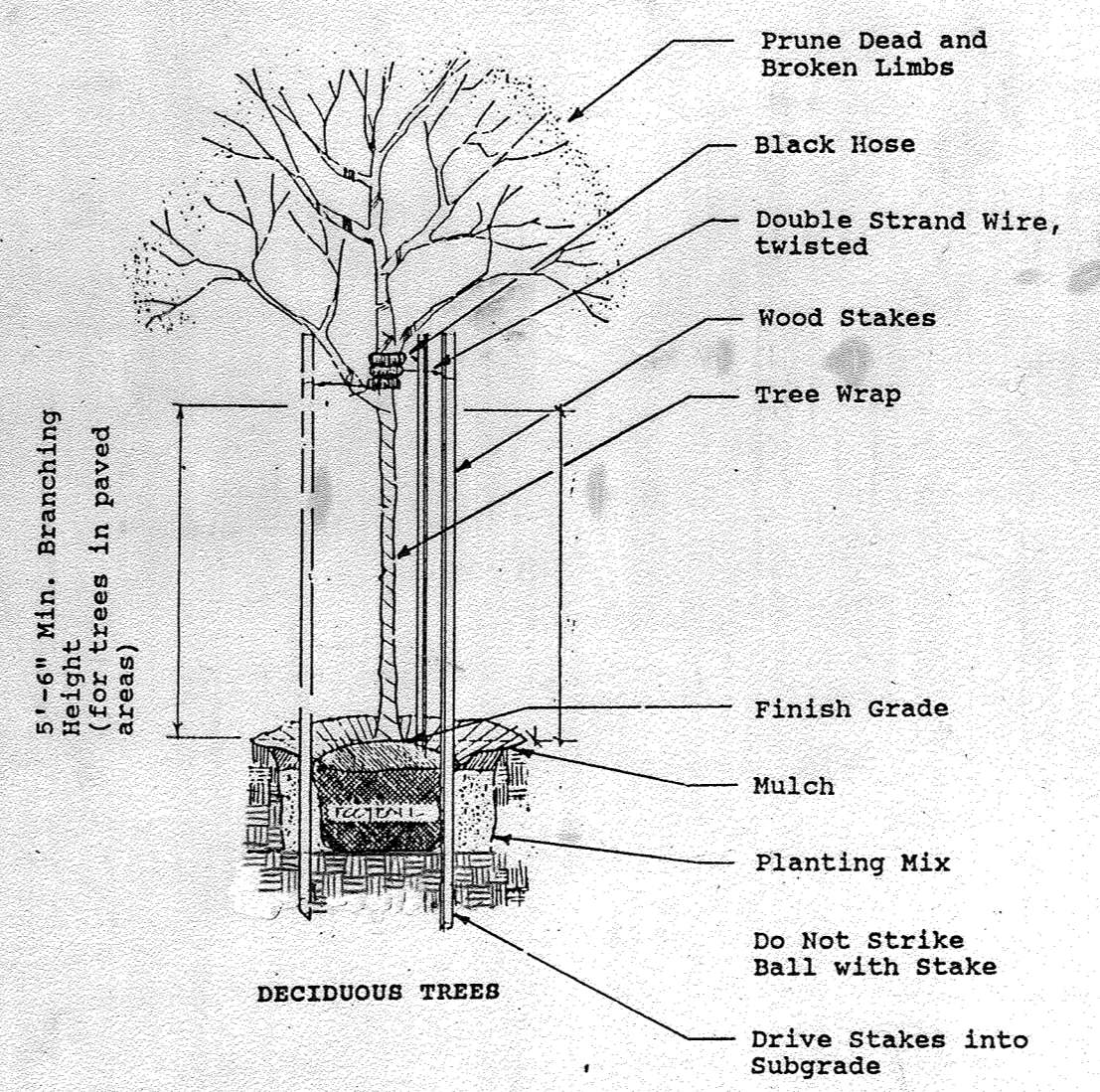
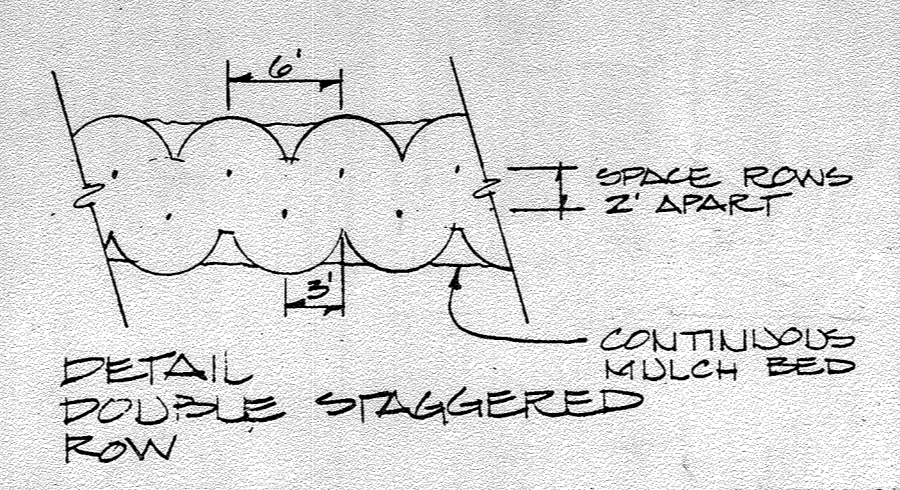
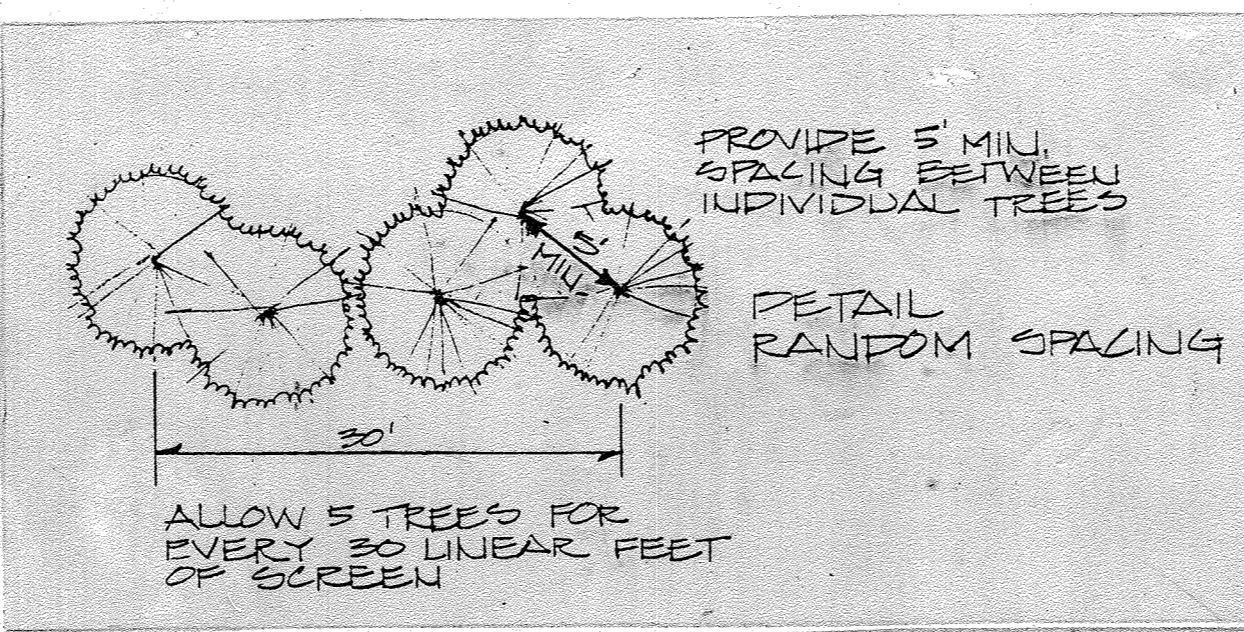

PLANT LIST

KEY	QUAN	BOTANICAL NAME/COMMON NAME	SIZE/COND.	SPACING
Major Trees				
P	4	Platanus acerifolia London Plane "Bloodgood"	2 1/2-3" Cal. 30' o.c. 888	
B	6	Pyrus calleryana "Bradford"	2 1/2-3" Cal. 30' o.c. 888	
S	2410	Sophora japonica "Regent"	2 1/2-3" Cal. 30' o.c. 888	
Z	3812	Zelkova serrata "Green Vase"	2 1/2-3" Cal. 25' o.c. 888	
Minor Trees				
A	3	Acer griseum Paperbark Maple	2 1/2-3" Cal. A.S. 888 Specimen	
C	7	Crataegus phanopyrum Washington Hawthorne	2-2 1/2" Cal. 18' o.c. 888	
K	20	Prunus serrulata "Kwanzan"	2-2 1/2" Cal. 18' o.c. 888	
T	11	Prunus cerasifera "Thundercloud"	2-2 1/2" Cal. 18' o.c. 888	
Evergreen Trees				
pn	94	Pinus thunbergii Japanese Black Pine	6-8' 888	10' o.c.
Shrubs				
cd	213	Cotoneaster dameri "Skogholm"	18-24" 888	3' o.c.
ef	154	Euonymus fortunei vegetus "Sarcocoe"	2-2 1/2' 888 (dbl. stag. row)	4' o.c.
rc	33	Rhododendron catawbiense Catawba Rhododendron	2-2 1/2' 888	4' o.c.
rs	36	Rhododendron "Snow"	18-24" 888	3' o.c.
tb	53	Taxus baccata repandens English Yew	18-24" 888	3' o.c.
vr	40	Viburnum rhytidophyllum Leatherleaf Viburnum	2-2 1/2' 888	4' o.c.
iv	18	Viburnum acerifolium Oxleaf Viburnum	2 1/2' o.c. 888	
ec	1,340	Euonymus fortunei "coloratus"	2 1/2" pots 888	1' o.c.
vm	2,124	Purpleleaved Wintercreeper Vinca minor Periwinkle	2 1/2" pots 888	1' o.c.

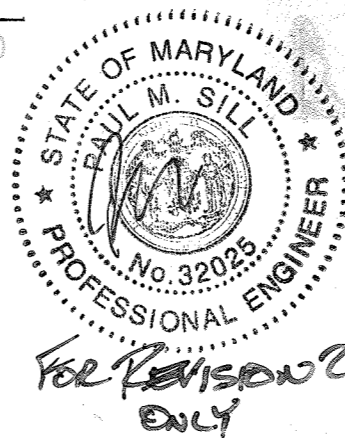

LEGEND

SYMBOL	DESCRIPTION
■	WALL MOUNTED FIXTURE
●	BOLLARD
⊙	LIGHTING STANDARD WITH 1 HEAD 250W M.H.
⊕	LIGHTING STANDARD WITH 2 HEADS 250W M.H.

DEVELOPER

CIUMMS CG LLC
1340 SOUTH AVENUE, SUITE 200
BALTIMORE, MARYLAND 21209
WALTER SEYAFIN
443-401-9901

APPROVED

DIVISION OF COMMUNITY PLANNING & LAND DEVELOPMENT

HOWARD COUNTY, MARYLAND

DATE: **8-27-89**

J.B.

OWNER

UNIVERSITY OF MARYLAND MEDICAL SYSTEM
7000 COLUMBIA GATEWAY DRIVE
COLUMBIA, MD. 21046

Richter Cornbrooks Gribble, Inc.

Architects/Planners

2120 North Charles Street
Baltimore, Maryland 21218

WFK WILLIAM F. KIRWIN, INC.

Land Planning/Landscape Architecture

28 E. Southanna Avenue
Towson, MD 21286
Phone 301/232-6841

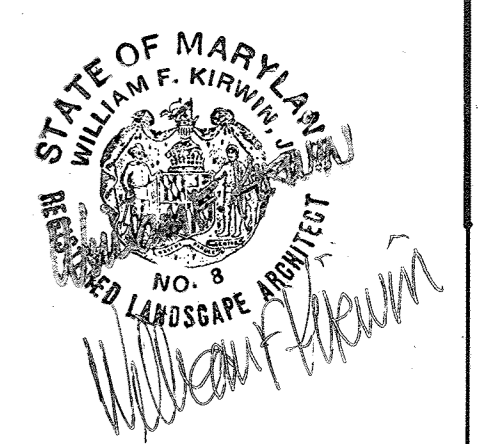

2-20-89 ADDED SOLAR CARPORT & NEW PLANTING OPERATIONS

ADDED SIDEWALK @ REAR

1-19-89 AND DUCT BANK @ FRONT

No.	Description	Date
1	Revisions	8/28/89 WFK

LANDSCAPING PLAN

Scale as Shown

Project No. 40555

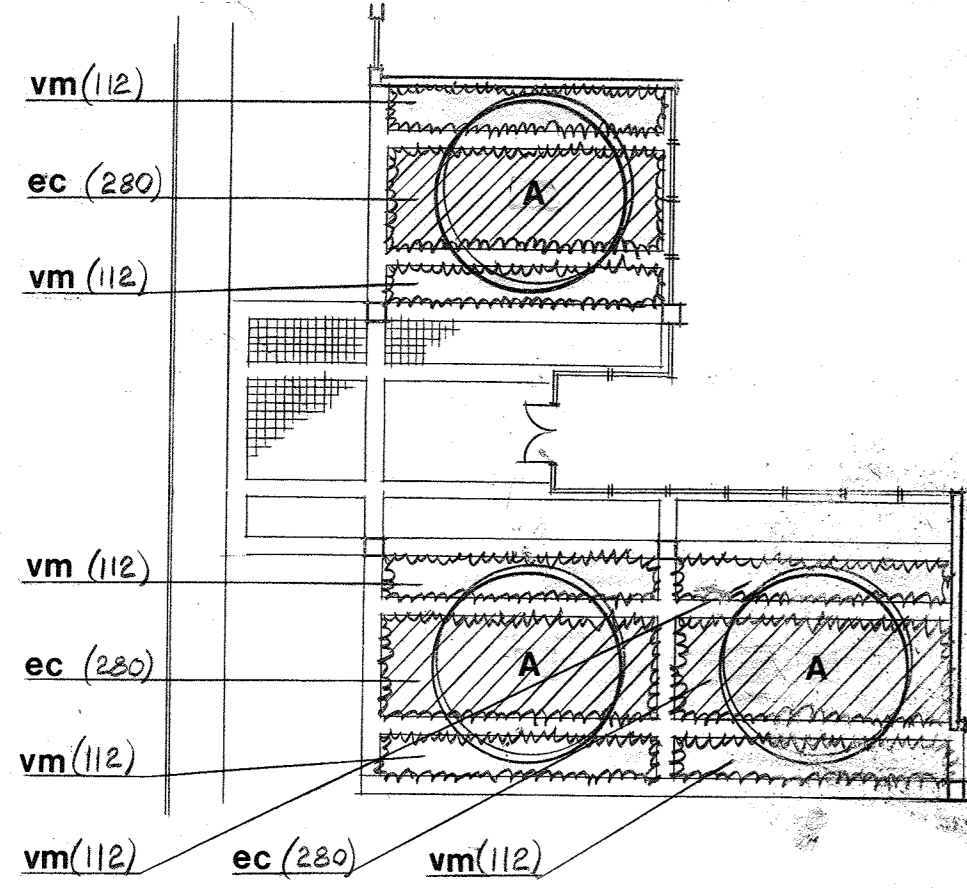

ENTRY DETAIL

SCALE: 1" = 20'

WHITMAN, REQUARDT AND ASSOCIATES ENGINEERS

2315 SAINT PAUL ST
BALTIMORE, MARYLAND

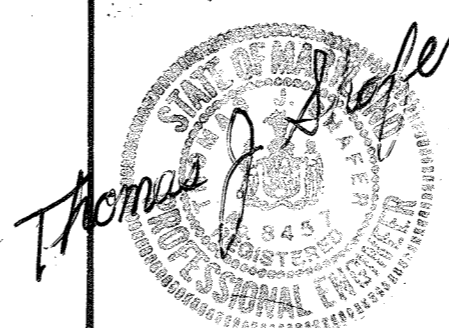

ELECTION DISTRICT NO. 6
TAX MAP 43

UNIVERSITY OF MARYLAND MEDICAL SYSTEM

COLUMBIA, GATEWAY
COLUMBIA, MARYLAND

HOWARD COUNTY
PARCEL S-2

Date 9/12/89

Drawing No.

C-8 of 9

SDP 89-252

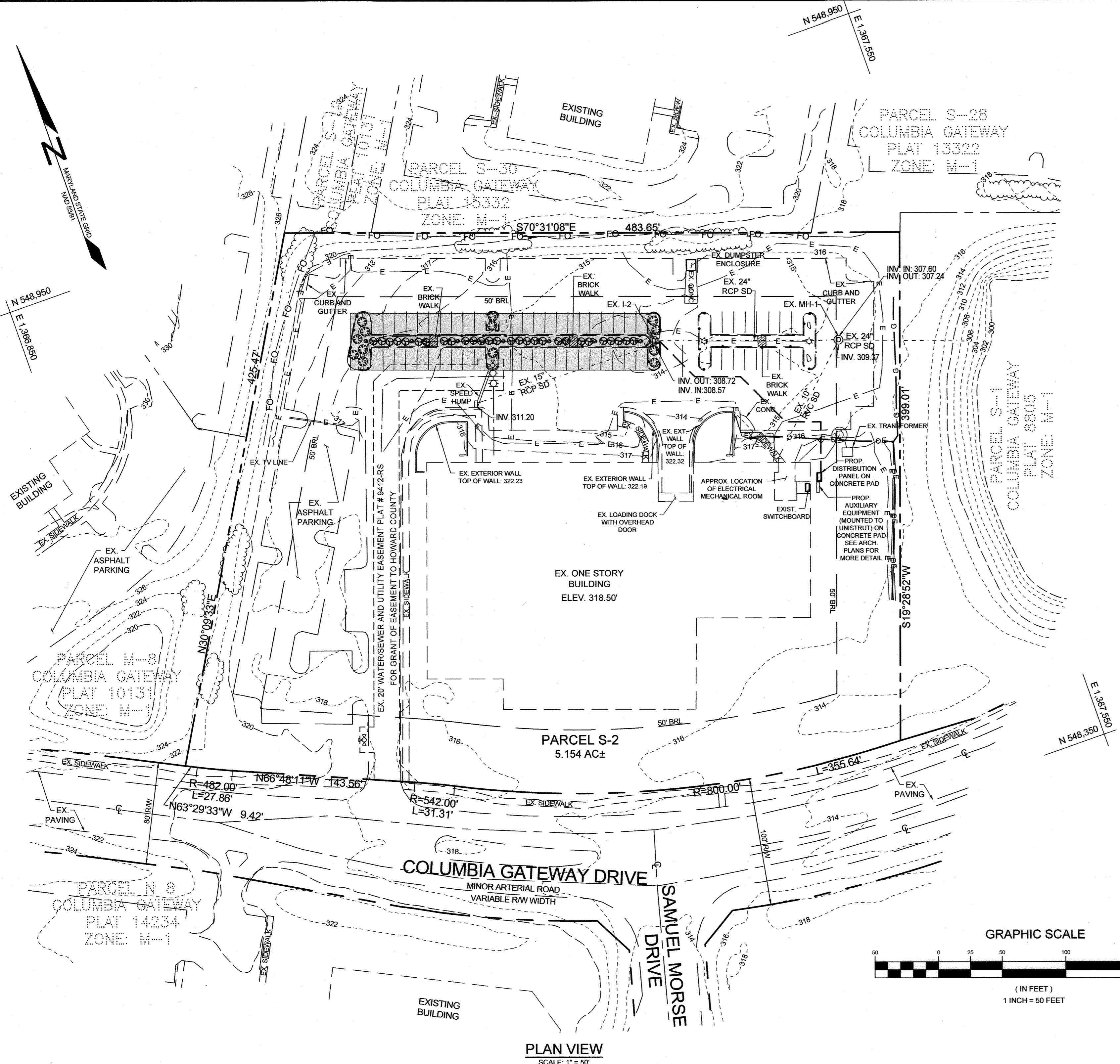

PLAN VIEW
SCALE: 1" = 50'

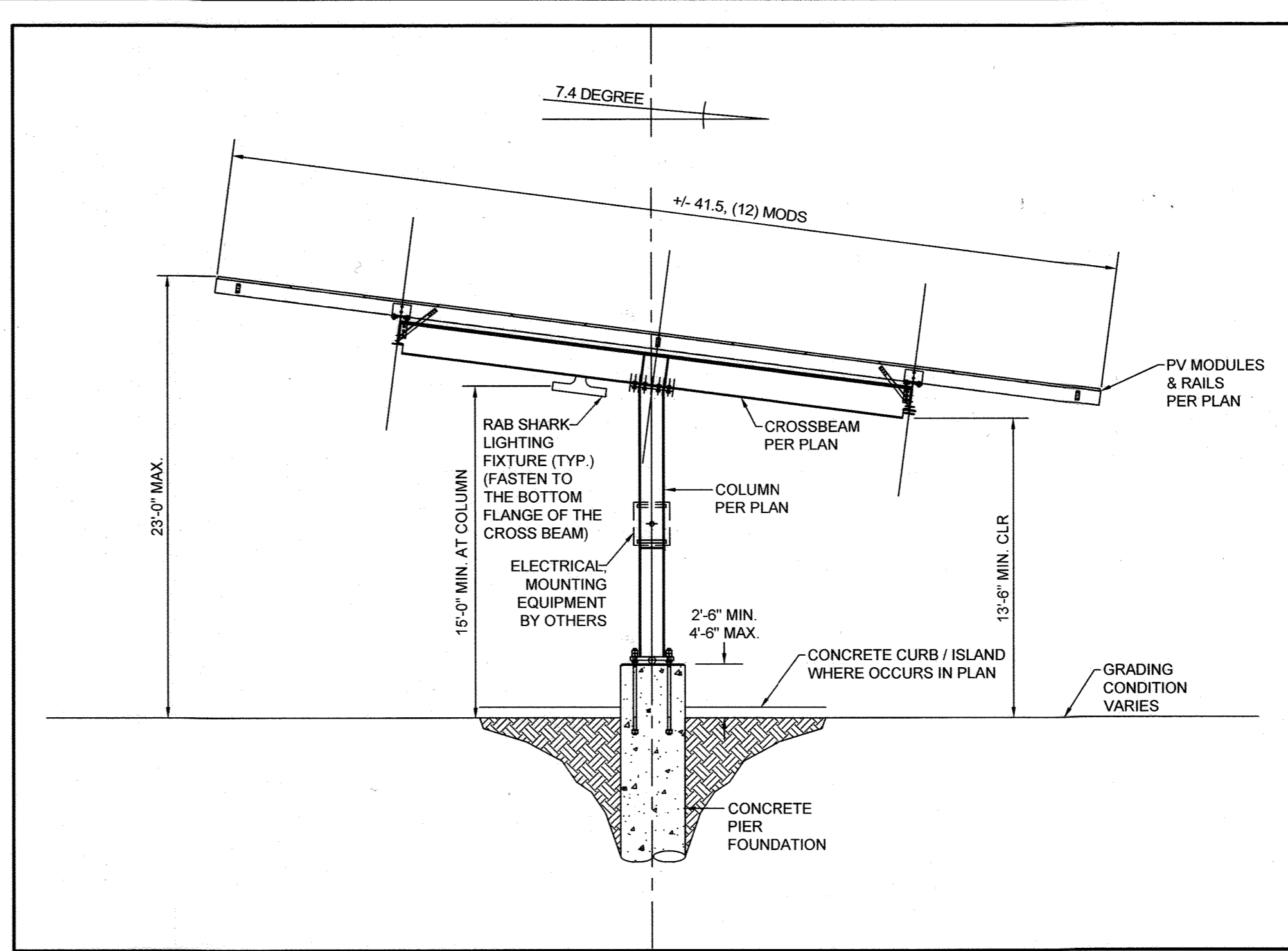

SOLAR CARPORT DETAIL
NOT TO SCALE

LEGEND

- EXISTING FIELD RUN TOPOGRAPHY ----- 382
- EXISTING GIS TOPOGRAPHY ----- 382
- EXISTING TREELINE -----
- EXISTING CENTERLINE -----
- EXISTING STORM DRAIN -----
- EXISTING GAS LINE -----
- EXISTING UNDERGROUND ELECTRIC ----- E ----- E -----
- EXISTING LIGHT POLES ☆
- EXISTING SPRINKLER HEAD ●
- EXISTING STORM DRAIN MANHOLE ⊙
- EXISTING SEWER MANHOLE ⊙
- EXISTING WATER VALVE ⊕
- EXISTING FIRE HYDRANT ⊕
- EXISTING BRICK WALK [Hatched Box]
- PROPOSED SOLAR ARRAY PANELS [Shaded Box]
- PROPOSED ELECTRICAL CONDUIT -----

- NOTES:**
- EXISTING LIGHT POLES TO BE REMOVED AND REPLACED WITH LIGHTING UNDER THE PANELS.
 - EXISTING TREES UNDER PROPOSED CARPORTS ARE TO BE REMOVED.
 - ELECTRICAL DESIGNED BY PARASOL.
 - THE EXISTING SPRINKLER WILL BE UTILIZED FOR THE NEW PLANTINGS. ADDITIONALLY, THE PANELS DO PROVIDE RAINWATER TO GET BELOW THE PANELS.
 - THIS PROJECT IS EXEMPT FROM FOREST CONSERVATION REQUIREMENTS PER SECTION 16.1202(b)(1)(iii) AN ACTIVITY ON A PREVIOUSLY DEVELOPED AREA COVERED BY AN IMPERVIOUS SURFACE LOCATED IN THE PRIORITY FUNDING AREA.

LANDSCAPE PLANT LIST

KEY	QUANTITY	BOTANICAL NAME	COMMON NAME	SIZE	NOTE
SHRUBS					
⊙	13	HYDRANGEA QUERCIFOLIA	OAK LEAF HYDRANGEA	B & B	FULL
⊙	28	ITEA VIRGINICA	VIRGINIA SWEETSPIRE	2-1/2 HGT.	FULL

NOTE: IF THERE IS A CONFLICT BETWEEN THE PLANT LIST AND THE PLANS, THE LARGER NUMBER PREVAILS.

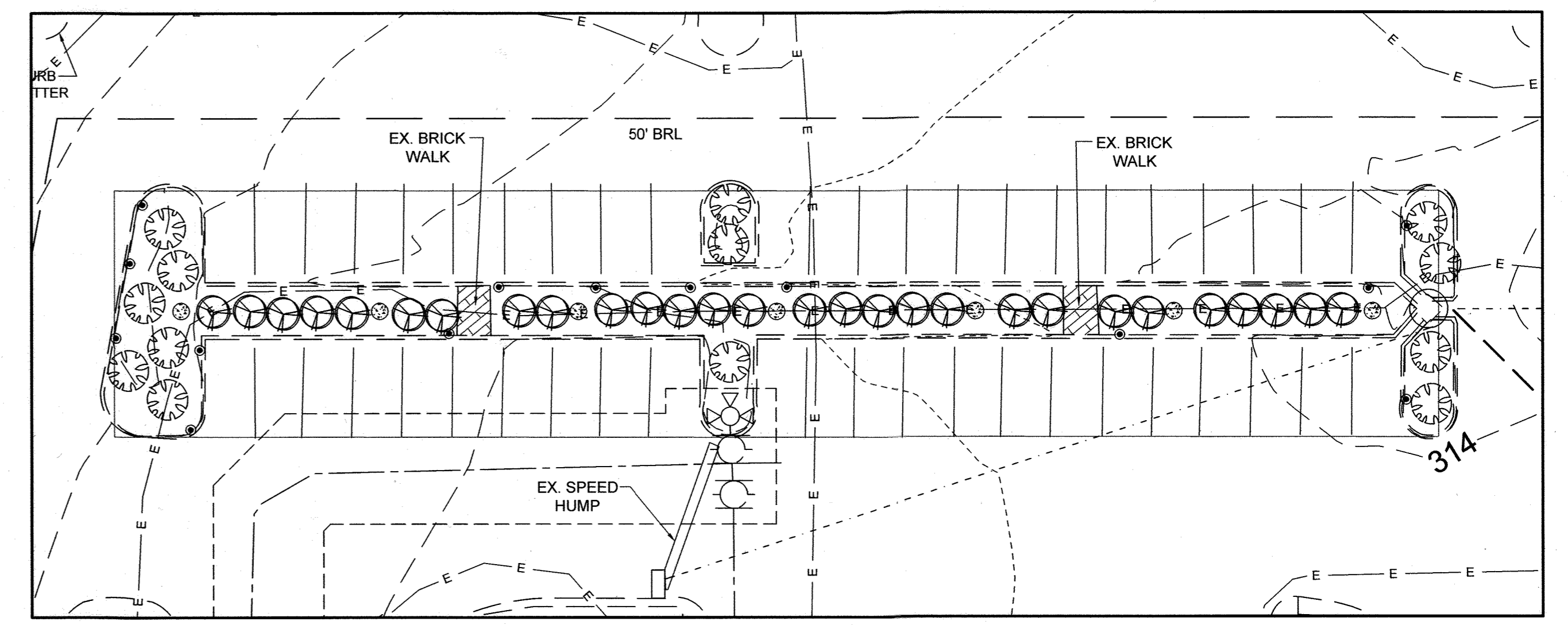

SOLAR CARPORT PROPOSED PLANTING PLAN VIEW
SCALE: 1" = 20'

NOTE: SEE SHEET 8 OF THIS SET FOR EXISTING LANDSCAPE PLAN. PLANTS ARE SHOWN HERE FOR CLARITY WITH THE PROPOSED SOLAR PANEL INSTALLATION AND THE CURRENT CONDITIONS OF THE SITE.

THE PURPOSE OF THE SITE PLAN IS TO ADD SOLAR CARPORT PANELS IN THE EXISTING PARKING LOT

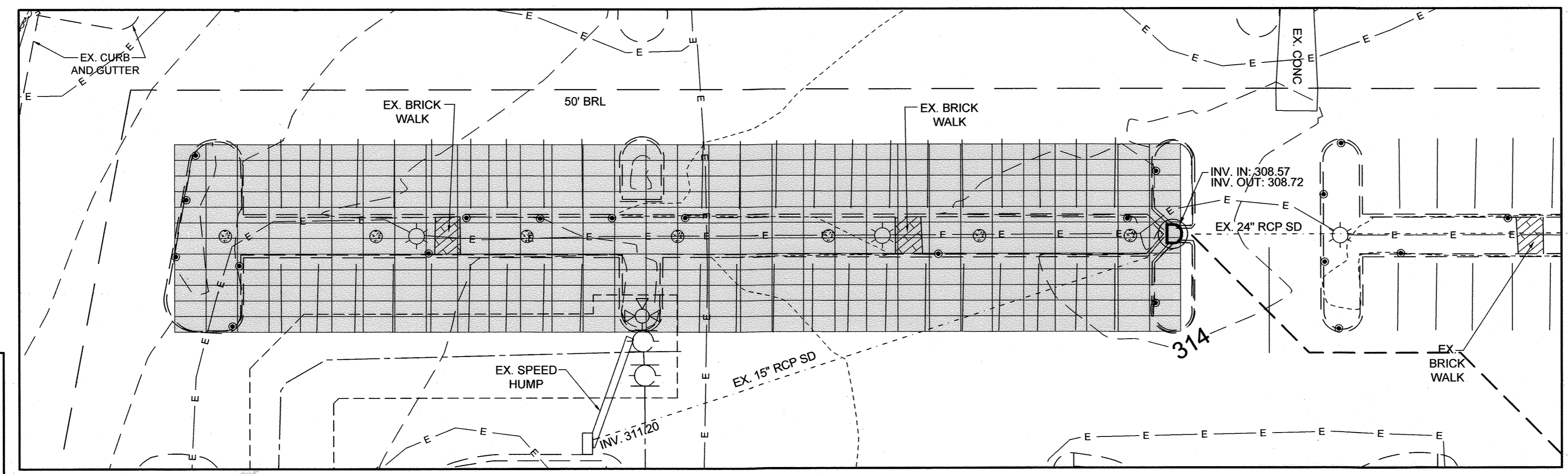

SOLAR CARPORT DETAILED PLAN VIEW
SCALE: 1" = 20'

APPROVED: HOWARD COUNTY DEPARTMENT OF PLANNING AND ZONING
CHIEF, DEVELOPMENT ENGINEERING DIVISION
DATE: 3/13/24
CHIEF, DIVISION OF LAND DEVELOPMENT
DATE: 3/12/24
DIRECTOR
DATE: 3/21/24

OWNER
UNIVERSITY OF MARYLAND
MEDICAL CENTER
7060 COLUMBIA GATEWAY DRIVE
COLUMBIA, MD 21046
RICHE STEVER
410-328-7283
RSTEVE@UMM.EDU

DEVELOPER
CI UMMS CG LLC
1340 SMITH AVENUE, SUITE 200
BALTIMORE, MARYLAND 21209
WALTER SERAFYN
443-461-5901
WALTER.SERAFYN@CRENEW.COM

REVISED SITE DEVELOPMENT PLAN
UNIVERSITY OF MARYLAND MEDICAL SYSTEM
7060 COLUMBIA GATEWAY DRIVE
TAX MAP 43 GRID 1
3RD ELECTION DISTRICT
PARCEL 0671
HOWARD COUNTY, MARYLAND

DESIGN BY: PS
DRAWN BY: JC
CHECKED BY: PS
SCALE: AS SHOWN
DATE: FEBRUARY 20, 2024
PROJECT #: 22-077
SHEET #: 9 of 9

SILL ENGINEERING GROUP, LLC
16005 Frederick Road, 2nd Floor
Woodbine, Maryland 21797
Phone: 443.325.5076
Fax: 410.696.2022
Email: info@sillengineering.com
Civil Engineering and Surveying for Land Development

PROFESSIONAL CERTIFICATION: I HEREBY CERTIFY THAT THESE DOCUMENTS WERE PREPARED OR APPROVED BY ME, AND THAT I AM A DULY LICENSED PROFESSIONAL ENGINEER UNDER THE LAWS OF THE STATE OF MARYLAND, LICENSE NO. 32028, EXPIRATION DATE JUNE 20, 2025

NO.	DESCRIPTION	DATE