



SITE ANALYSIS

ZONING	R5C
UNIT TYPE	SFD
NO. OF UNITS	28
MAXIMUM BUILDING COVERAGE ALLOWED	40%
TOTAL AREA OF LOTS	4.23 AC.

MINIMUM LOT SIZE CHART

LOTS	GROSS AREA	25% STEEP SLOPES	NET AREA
331	6154.89	108.0	6046.89
332	6154.89		6154.89
333	6097.77		6097.77
335	9339.16	24.0	9315.16
362	6300.00	56.0	6244.00
363	6255.11		6255.11
364	6000.75		6000.75
365	6000.00		6000.00
366	6000.00		6000.00
367	6000.00		6000.00
368	6000.00		6000.00
369	6000.00		6000.00
370	6039.67		6039.67
371	6983.50		6983.50
372	6048.00	105	5943.00
373	6048.00	96	5952.00
374	6036.96	78	5958.96
375	7611.51	143	7468.51
376	7408.54	217.0	7191.54
377	6261.85	70.0	6191.85
378	7058.20	117.0	6941.20
379	6076.78	228.0	5848.78
400	6355.99	140.0	6215.99
401	6300.00	117.0	6183.00
402	6300.00	82.0	6218.00
403	6300.00	64.0	6236.00
404	7287.95	625.0	6662.95

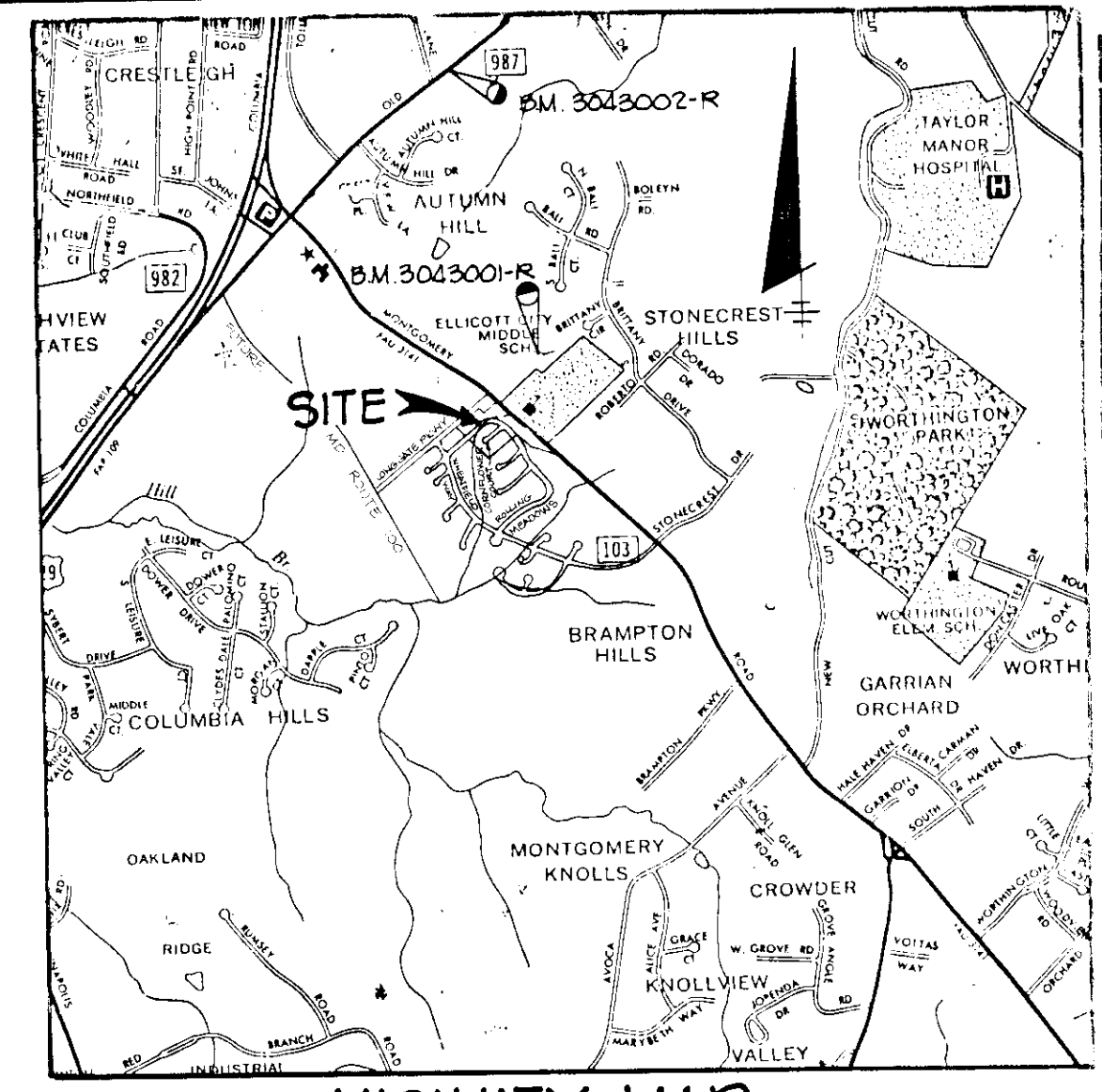

BENCH MARKS

- 3043001-R CONCRETE MONUMENT AT \angle IN TRANSMISSION LINES, BACK OF SCHOOL. EL. 437.02
- 3043002-R CONCRETE MONUMENT AT 05' BELOW SURFACE 1/2 S HW & OLD COLUMBIA PIKE 175' N.E. OF COOKS LANE. EL. 377.50

REVISION

1.	Rev. hse & ord. Lot 384. Add hse typical by Clark, Firebeck & Sackett, Inc.	6-7-83
----	---	--------

ADDRESS CHART

LOT NO.	STREET NAMES	LOT NO.	STREET NAMES
301	4500	301	4500
302	4500	302	4500
303	4500	303	4500
304	4500	304	4500
305	4500	305	4500
306	4500	306	4500
307	4500	307	4500
308	4500	308	4500
309	4500	309	4500
310	4500	310	4500
311	4500	311	4500
312	4500	312	4500
313	4500	313	4500
314	4500	314	4500
315	4500	315	4500
316	4500	316	4500
317	4500	317	4500
318	4500	318	4500
319	4500	319	4500
320	4500	320	4500
321	4500	321	4500
322	4500	322	4500
323	4500	323	4500
324	4500	324	4500
325	4500	325	4500
326	4500	326	4500
327	4500	327	4500
328	4500	328	4500
329	4500	329	4500
330	4500	330	4500

APPROVED: FOR PUBLIC WATER AND PUBLIC SEWERAGE SYSTEMS, HOWARD COUNTY HEALTH DEPARTMENT

[Signature] COUNTY HEALTH OFFICER DATE: 10-14-83

APPROVED: FOR PUBLIC WATER, PUBLIC SEWERAGE, STORM DRAINAGE SYSTEMS AND PUBLIC ROADS, HOWARD COUNTY DEPARTMENT OF PUBLIC WORKS

[Signature] DIRECTOR DATE: 10-18-83

APPROVED: HOWARD COUNTY DEPARTMENT OF PLANNING AND ZONING

[Signature] PLANNING DIRECTOR DATE: 10-24-83

[Signature] CHIEF, DIVISION OF COMMUNITY PLANNING AND LAND DEVELOPMENT DATE: 10-25-83

TRACY, SCHULTE & ASSOCIATES INC.
 planning • architecture • engineering
 8480 Baltimore National Pike • Ellicott City, Maryland 21043 • (301) 465-6105

OWNER SECURITY DEVELOPMENT CORP. PO BOX 417 ELLICOTT CITY, MARYLAND 21043 (301) 465-4244	PROJECT LONG GATE SECTION 3, AREA 1 & SECTION 3, AREA 2 LOTS 331 THRU 335 & 382 THRU 404
DEVELOPER GYC BUILDERS INC. PO BOX 1710 ELLICOTT CITY, MARYLAND 21043 (301) 730-0554	LOCATION TAX MAP NO 30 ZONING MAP NO 30 PARCEL NO 18 2 ND ELECTION DISTRICT HOWARD COUNTY, MARYLAND
DES 5JB	DRN CDT/KUN
DATE JUNE 1, 1982 OCTOBER 13, 1983	TITLE SITE DEVELOPMENT PLAN
SCALE AS SHOWN	PROJECT NO 0194 SDF
DRAWING 1 OF 3	REVISION

- GENERAL NOTES**
- ALL ROADWAYS ARE PUBLIC AND EXISTING.
 - ANY DAMAGE TO COUNTY OWNED RIGHT-OF-WAY SHALL BE CORRECTED AT THE DEVELOPER'S EXPENSE.
 - THE CONTRACTOR OR DEVELOPER SHALL CONTACT THE CONSTRUCTION INSPECTION SURVEY DIVISION 24 HOURS IN ADVANCE OF COMMENCEMENT OF WORK AT 932-2417.
 - THE MAXIMUM LOT COVERAGE IS 40% PER LOT.
 - STORM WATER MANAGEMENT FOR LONG GATE 3/1 AND 3/2 IS PROVIDED UNDER 1-21-1977 DETENTION TYPE.
 - TURNS TAKEN FROM AERIAL PHOTOGRAMMETRY BY HAPPING ASSOCIATES FROM AUGUST, 1984.
 - PUBLIC WATER AND SEWER SHOWN FOR REFERENCE ONLY. FOR MORE DETAILED INFORMATION, SEE WATER AND SEWER PLANS CONTRACT NO. 14-1855.
 - DELAY CONSTRUCTION ON LOTS 384-386 AND 398 UNTIL PERMISSION TO REMOVE SEDIMENT TRAPS IS GRANTED BY THE SEDIMENT CONTROL INSPECTOR.
 - W.D.S. INDICATES WALKOUT BASEMENT.
 - RAY WINDOWS AND FIREPLACES EXTEND INTO THE REQUIRED BUILDING RESTRICTION LINE BASED ON SECTION 128 HOWARD COUNTY ZONING REGULATION.
 - THE CHECKING OF FOUNDATIONS PRIOR TO CONSTRUCTION TO ASSURE COMPLIANCE WITH THE REGULATORY BUILDING RESTRICTION LINES IS RECOMMENDED.
 - PORCHES OR DECKS, OPEN OR ENCLOSED, MAY PROJECT NOT MORE THAN 10 FEET INTO THE FRONT OR REAR YARD/SECTION 128-A-11(C) OF THE ZONING REGULATIONS.

PLAN
SCALE 1"=30'

SUBDIVISION NAME	SECTION/AREA	PARCEL / LOT NOS.			
LONG GATE	3/1 & 3/2	18 / 331-335 & 382-404			
PLAT # / L.F.	BLOCK	ZONE	TAX / ZONE MAP	ELEC. DIST	CENSUS TR.
2815 2598-4 88-7	6	R5C	30	2	60103
WATER CODE	SEWER CODE				
FO-3/602	5750698				

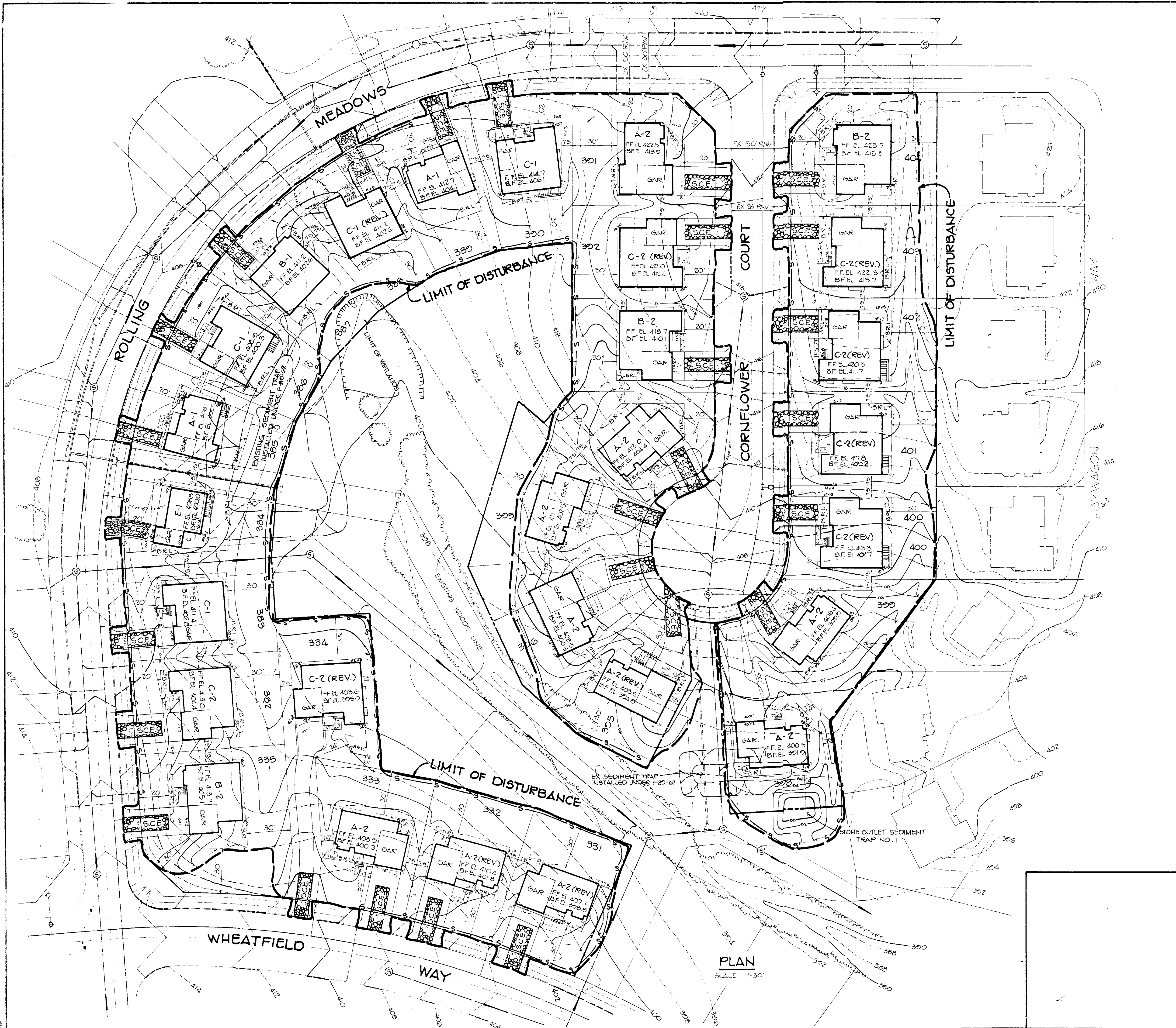

SEDIMENT TRAP NO. 1	
DRAINAGE AREA	0.92 AC.
STORAGE:	
REQUIRED	1,056 c.f.
PROVIDED	1,002 c.f.
CREST ELEVATION	494.00
BOTTOM ELEVATION	490.00
CLEANOUT ELEVATION	491.50
TRAP BOTTOM DIMENSIONS	20' x 15'

BY THE ENGINEER:	
"I CERTIFY THAT THIS PLAN FOR EROSION AND SEDIMENT CONTROL REPRESENTS A PRACTICAL AND WORKABLE PLAN BASED ON MY PERSONAL KNOWLEDGE OF THE SITE CONDITIONS AND THAT IT WAS PREPARED IN ACCORDANCE WITH THE REQUIREMENTS OF THE HOWARD SOIL CONSERVATION DISTRICT."	
<i>James K. Tracy</i> ENGINEER: JAMES K. TRACY, P.E.	10/13/89 DATE
BY THE DEVELOPER:	
"I/WE CERTIFY THAT ALL DEVELOPMENT AND CONSTRUCTION WILL BE DONE ACCORDING TO THIS PLAN, AND THAT ANY RESPONSIBLE PERSONNEL INVOLVED IN THE CONSTRUCTION PROJECT WILL HAVE A CERTIFICATE OF ATTENDANCE AT A DEPARTMENT OF NATURAL RESOURCES APPROVED TRAINING PROGRAM FOR THE CONTROL OF SEDIMENT AND EROSION BEFORE BEGINNING THE PROJECT. I ALSO AUTHORIZE PERIODIC ON-SITE INSPECTION BY THE HOWARD SOIL CONSERVATION DISTRICT."	
<i>Garnett Y. Clark</i> DEVELOPER: GARNETT Y. CLARK	10/13/89 DATE
REVIEWED FOR HOWARD SOIL CONSERVATION DISTRICT AND MEETS TECHNICAL REQUIREMENTS	
<i>James K. Tracy</i> U.S. SOIL CONSERVATION SERVICE	10/16/89 DATE
THIS DEVELOPMENT PLAN IS APPROVED FOR SOIL EROSION AND SEDIMENT CONTROL BY THE HOWARD SOIL CONSERVATION DISTRICT	
<i>John R. Blanton</i> HOWARD S.C.D.	10/16/89 DATE
APPROVED: FOR PUBLIC WATER AND PUBLIC SEWERAGE SYSTEMS, HOWARD COUNTY HEALTH DEPARTMENT	
<i>John R. Blanton</i> COUNTY HEALTH OFFICER	10/19/89 DATE
APPROVED: FOR PUBLIC WATER, PUBLIC SEWERAGE, STORM DRAINAGE SYSTEMS AND PUBLIC ROADS. HOWARD COUNTY DEPARTMENT OF PUBLIC WORKS	
<i>James K. Tracy</i> DIRECTOR	10/18/89 DATE
<i>James K. Tracy</i> CHIEF, BUREAU OF ENGINEERING	10/18/89 DATE
APPROVED: HOWARD COUNTY OFFICE OF PLANNING AND ZONING.	
<i>James K. Tracy</i> PLANNING DIRECTOR	10/24/89 DATE
<i>James K. Tracy</i> CHIEF, DIVISION OF COMMUNITY PLANNING AND LAND DEVELOPMENT	10/20/89 DATE
NO. DATE	REVISION

TRACY, SCHULTE & ASSOCIATES INC. planning • architecture • engineering	
8480 Baltimore National Pike • Ellicott City, Maryland 21043 • (301) 465-6105	
<i>James K. Tracy</i>	
OWNER SECURITY DEVELOPMENT CORP PO BOX 417 ELLCOTT CITY, MARYLAND 21043 (301) 465-4244	PROJECT LONG GATE SECTION 3, AREA 1 & SECTION 3, AREA 2 LOTS 391, 392 & 393 THRU 404
DEVELOPER BYC BUILDERS INC PO BOX 1710 ELLCOTT CITY, MARYLAND 21043 (301) 465-	LOCATION TAX MAP NO 30 ZONING MAP NO 30 PARCEL NO 13 2 ND ELECTION DISTRICT HOWARD COUNTY MARYLAND
TITLE GRADING AND SEDIMENT CONTROL PLAN	DATE JUNE 1, 1988 OCTOBER 5, 1989
DES 538	DRN CDT, KVN
SCALE AS SHOWN	PROJECT NO 0104 SDP
DRAWING 2 OF 3	

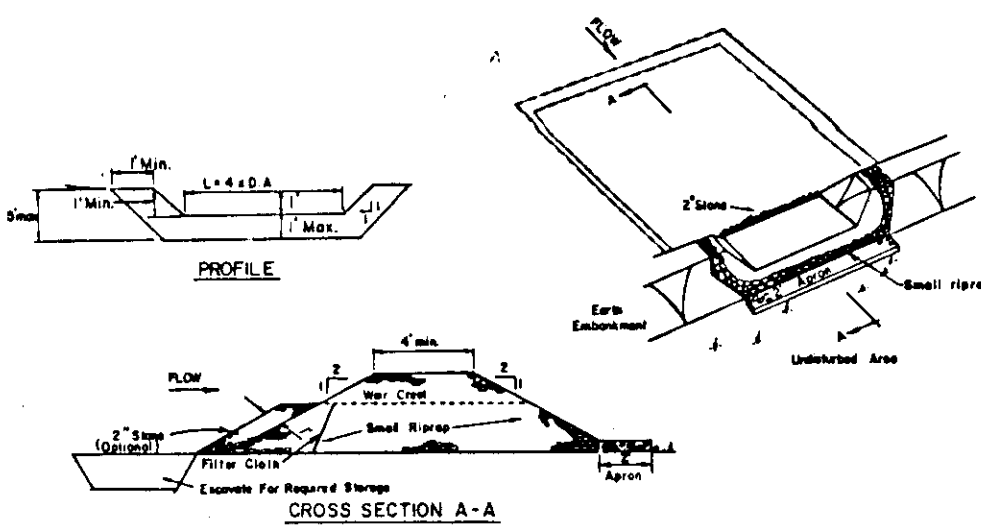

STONE OUTLET SEDIMENT TRAP
NO SCALE

- OPTION:** A one foot layer of 2" stone may be placed on the upstream side of the riprap in place of the sediment filter cloth.
- CONSTRUCTION SPECIFICATIONS FOR ST-2**
- Area under sediment trap to be cleared, graded and stripped of any vegetation and root mat. The pool area shall be cleared.
 - The fill material for the embankment shall be free of roots and other woody vegetation as well as over-sized stones, rocks, organic material or other objectionable material. The embankment shall be compacted by straddling with equipment while it is being constructed.
 - All cut and fill slopes shall be 2:1 or flatter.
 - The stone used in the outlet shall be small riprap 4"-8" along with a 1" thickness of 2" aggregate placed on the upstream side of the small riprap 2" embedded filter cloth in the riprap.
 - Sediment shall be removed and trap restored to its original dimensions when the sediment has accumulated to 1/2 the design depth of the trap.
 - The structure shall be inspected after each rain and repairs made as needed.
 - Construction operations shall be carried out in such a manner that erosion and water pollution is minimized.
 - The structure shall be removed and the area stabilized when the drainage area has been properly stabilized.

STONE OUTLET SEDIMENT TRAP
NO SCALE

SEQUENCE OF CONSTRUCTION

- | | |
|-------------|--|
| DAY 1 | 1. OBTAIN A GRADING PERMIT. |
| DAY 2-8 | 2. INSTALL SEDIMENT TRAPS AND SEDIMENT CONTROL DEVICES. |
| DAY 9-20 | 3. GRADE SITE AND STABILIZE ALL SLOPES IN ACCORDANCE WITH PERMANENT SEEDING NOTES. |
| DAY 21-201 | 4. COMPLETE CONSTRUCTION ON ALL LOTS, EXCEPT LOTS 384-386 AND 398 UNTIL SEDIMENT TRAPS ARE REMOVED UNDER F-87-197. |
| DAY 202-204 | 5. UPON APPROVAL OF THE SEDIMENT CONTROL INSPECTOR, REMOVE SEDIMENT TRAPS AND ALL REMAINING SEDIMENT CONTROL DEVICES AND STABILIZE IN ACCORDANCE WITH PERMANENT SEEDING NOTES. |
| DAY 205-265 | 6. INSTALL SILT FENCE AT REAR AND SIDES OF LOTS 384-386 AND 398. COMPLETE CONSTRUCTION ON THIS LOT AND STABILIZE IN ACCORDANCE WITH PERMANENT SEEDING NOTES. |
| DAY 265-267 | 7. UPON APPROVAL OF THE SEDIMENT CONTROL INSPECTOR, REMOVE ALL REMAINING SEDIMENT CONTROL DEVICES AND STABILIZE IN ACCORDANCE WITH PERMANENT SEEDING NOTES. |
- NOTE: STORM WATER MANAGEMENT FOR THIS SITE IS PROVIDED UNDER LONG GATE SECTION 2, AREA 2, F-87-197.

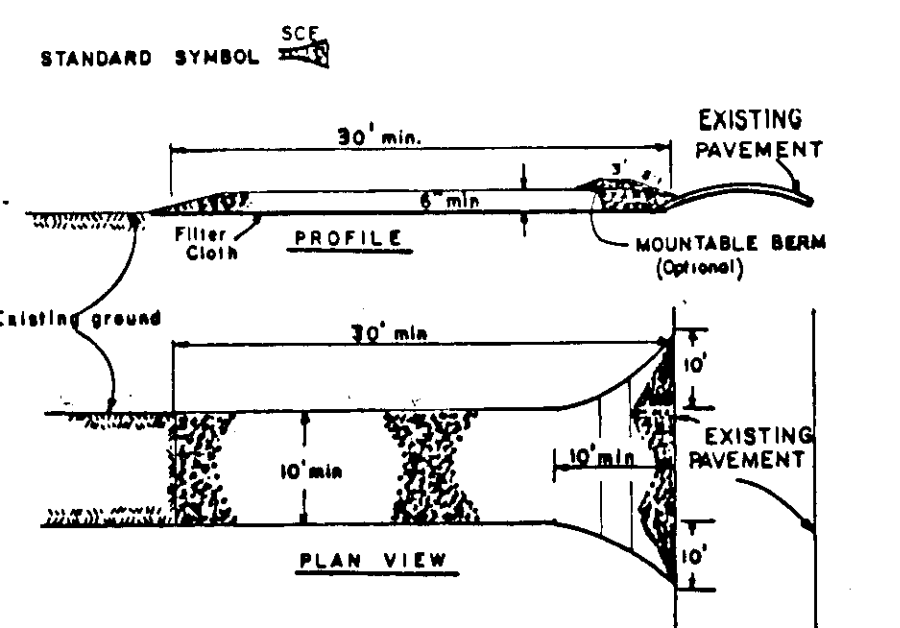

STABILIZED CONSTRUCTION ENTRANCE
NO SCALE

- CONSTRUCTION SPECIFICATIONS**
- Stone Size - Use 2" stone, or recycled or recycled concrete equivalent.
 - Length - As required, but not less than 30 feet (except on a single residence lot where a 30 foot minimum length would apply).
 - Thickness - Not less than 30" (8" inches).
 - Width - Two (2) foot minimum, but not less than the full width at points where ingress or egress occurs.
 - Filter Cloth - Will be placed over the entire area prior to placing of stone. Filter will not be required on a single family residence lot.
 - Surface Water - All surface water flowing or diverted toward construction entrances shall be piped across the entrance. If piping is impractical, a mountable beam with 1:1 slopes will be permitted.
 - Maintenance - This entrance shall be maintained in a condition which will prevent tracking or flowing of sediment onto public rights-of-way. This may require periodic top dressing with additional stone as conditions demand and repair and/or cleaning of any measures used for trap sediment. All sediment applied, dropped, washed or tracked onto public rights-of-way must be removed immediately.
 - Washing - Wheels shall be cleaned to remove sediment prior to entrance onto public rights-of-way. When washing is required, it shall be done on an area established with stone and which drains into an approved sediment trapping device.
 - Periodic inspection and needed maintenance shall be provided after each rain.

STABILIZED CONSTRUCTION ENTRANCE
NO SCALE

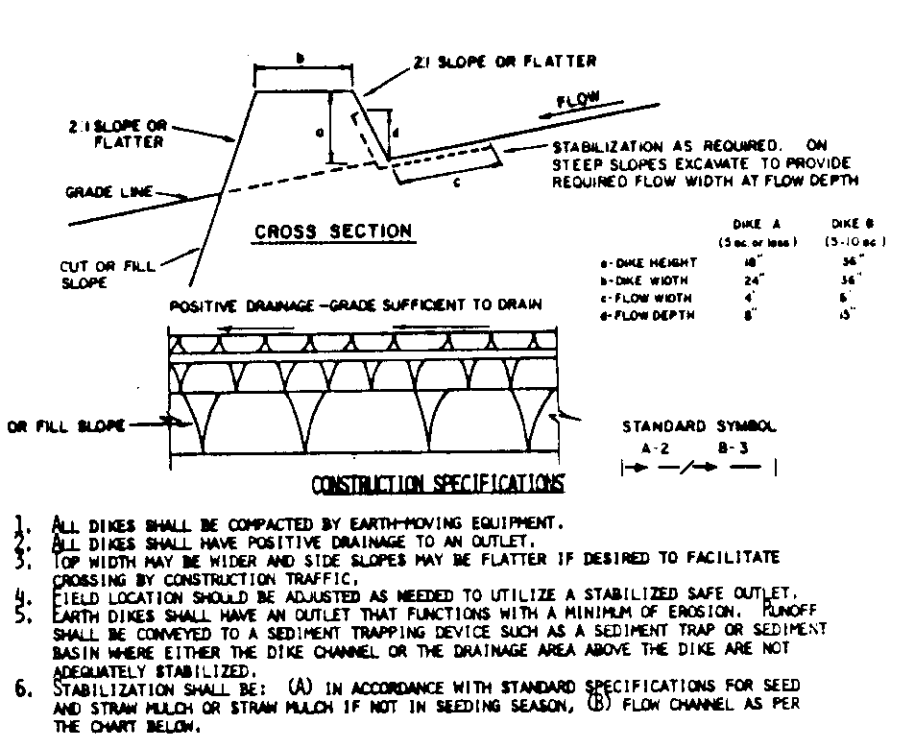

EARTH DIKE
NO SCALE

- CONSTRUCTION NOTES FOR FABRICATED SILT FENCE**
- MONUMENTS SHALL BE PLACED REGULARLY TO FACE POSTS WITH WIRE TIES OF STAPLES.
 - FILTER CLOTH TO BE PATTERNOED REGULARLY TO COVER FACE WITH TIES SPACED EVERY 4' AT TOP AND MID SECTION.
 - WASH THE SECTIONS OF FILTER CLOTH BEFORE EACH OTHER THEY SHALL BE OVERLAPPED BY SIX INCHES AND POLAR.
 - MAINTENANCE SHALL BE PROVIDED AS REQUIRED AND NECESSARY. WHEN NECESSARY, SILT FENCE SHALL BE REPAIRED OR REPLACED.

SILT FENCE
NO SCALE

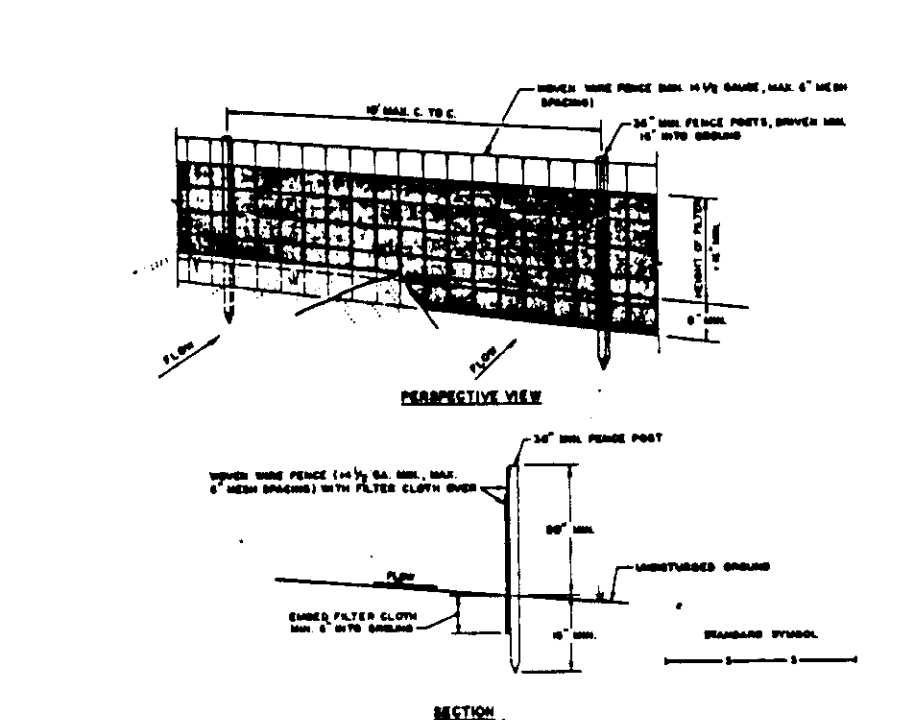

DRIVEWAY ENTRANCE
NO SCALE

- CONSTRUCTION NOTES FOR FABRICATED SILT FENCE**
- MONUMENTS SHALL BE PLACED REGULARLY TO FACE POSTS WITH WIRE TIES OF STAPLES.
 - FILTER CLOTH TO BE PATTERNOED REGULARLY TO COVER FACE WITH TIES SPACED EVERY 4' AT TOP AND MID SECTION.
 - WASH THE SECTIONS OF FILTER CLOTH BEFORE EACH OTHER THEY SHALL BE OVERLAPPED BY SIX INCHES AND POLAR.
 - MAINTENANCE SHALL BE PROVIDED AS REQUIRED AND NECESSARY. WHEN NECESSARY, SILT FENCE SHALL BE REPAIRED OR REPLACED.

SILT FENCE
NO SCALE

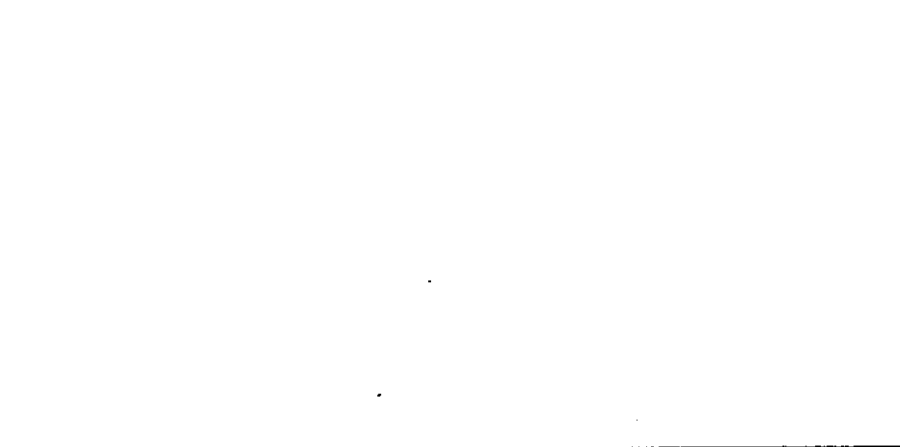

TYPICAL HOUSES
SCALE: 1" = 30'

SEDIMENT CONTROL NOTES

- A MINIMUM OF 24 HOURS NOTICE MUST BE GIVEN TO THE HOWARD COUNTY OFFICE OF INSPECTIONS AND PERMITS PRIOR TO THE START OF ANY CONSTRUCTION (992-2437).
- ALL VEGETATIVE AND STRUCTURAL PRACTICES ARE TO BE INSTALLED ACCORDING TO THE PROVISIONS OF THIS PLAN AND ARE TO BE IN CONFORMANCE WITH THE 1983 MARYLAND STANDARDS AND SPECIFICATIONS FOR SOIL EROSION AND SEDIMENT CONTROL.
- FOLLOWING INITIAL SOIL DISTURBANCE OR REDISTURBANCE, PERMANENT OR TEMPORARY STABILIZATION SHALL BE COMPLETED WITHIN: a) 7 CALENDAR DAYS FOR ALL PERMANENT SEDIMENT CONTROL STRUCTURES, SIGNS, PERIMETER SLOPES AND ALL SLOPES GREATER THAN 3:1; b) 14 DAYS AS TO ALL OTHER DISTURBED OR GRADED AREAS ON THE PROJECT SITE.
- ALL SEDIMENT TRAPS/BASINS SHOWN MUST BE FENCED AND WARNING SIGNS POSTED AROUND THEIR PERIMETER IN ACCORDANCE WITH VOL. 1, CHAPTER 12, OF THE HOWARD COUNTY DESIGN MANUAL, STORM DRAINAGE.
- ALL DISTURBED AREAS MUST BE STABILIZED WITHIN THE TIME PERIOD SPECIFIED ABOVE IN ACCORDANCE WITH THE 1983 MARYLAND STANDARDS AND SPECIFICATIONS FOR SOIL EROSION AND SEDIMENT CONTROL FOR PERMANENT SEEDINGS (Sec. 51) 500 (Sec. 54), TEMPORARY SEEDING (Sec. 50) AND MULCHING (Sec. 52). TEMPORARY STABILIZATION WITH MULCH ALONE CAN ONLY BE DONE WHEN RECOMMENDED SEEDING DATES DO NOT ALLOW FOR PROPER GERMINATION AND ESTABLISHMENT OF GRASSES.
- ALL SEDIMENT CONTROL STRUCTURES ARE TO REMAIN IN PLACE AND ARE TO BE MAINTAINED IN OPERATIVE CONDITION UNTIL PERMISSION FOR THEIR REMOVAL HAS BEEN OBTAINED FROM THE HOWARD COUNTY SEDIMENT CONTROL INSPECTOR.
- SITE ANALYSIS:**
TOTAL AREA OF SITE: 4.25 ACRES
AREA DISTURBED: 4.15 ACRES
AREA TO BE ROOFED OR PAVED: 3.15 ACRES
AREA TO BE VEGETATIVELY STABILIZED: 3.05 ACRES
TOTAL CUT: 10.17 CU. YDS.
TOTAL FILL: 3.10 CU. YDS.
OPPOSITE WASTE/BORROW AREA LOCATION: 85-20-21
- ANY SEDIMENT CONTROL PRACTICE WHICH IS DISTURBED BY GRADING ACTIVITY FOR PLACEMENT OF UTILITIES MUST BE REPAIRED ON THE SAME DAY OF DISTURBANCE.
- ADDITIONAL SEDIMENT CONTROLS MUST BE PROVIDED, IF DEEMED NECESSARY BY THE HOWARD COUNTY DEPT. OF SEDIMENT CONTROL INSPECTOR.
- ALL SEDIMENT TRAPS SHOWN MUST BE FENCED AND WARNING SIGNS POSTED AROUND THEIR PERIMETER IN ACCORDANCE WITH VOL. 1, CHAPTER 12, OF THE HOWARD COUNTY DESIGN MANUAL, STORM DRAINAGE.

- PERMANENT SEEDBED PREPARATION**
- SEEDBED PREPARATION: LOOSEN UPPER THREE INCHES OF SOIL BY RAKING, DISCING OR OTHER ACCEPTABLE MEANS BEFORE SEEDING, IF NOT PREVIOUSLY LOOSENED.
- SOIL AMENDMENTS: IN LIEU OF SOIL TEST RECOMMENDATIONS, USE ONE OF THE FOLLOWING SCHEDULES:
- PREFERRED - APPLY 2 TONS PER ACRE BOLLMATIC LIMESTONE (92 105/1000 sq ft) AND 600 LBS PER ACRE 10-10-10 FERTILIZER (14 105/1000 sq ft) BEFORE SEEDING. HARROW OR DISC INTO UPPER THREE INCHES OF SOIL. AT TIME OF SEEDING, APPLY 400 LBS PER ACRE 30-0-0 UREAFORM FERTILIZER (9 105/1000 sq ft).
 - ACCEPTABLE - APPLY 2 TONS PER ACRE BOLLMATIC LIMESTONE (92 105/1000 sq ft) AND 1000 LBS PER ACRE 10-10-10 FERTILIZER (23 105/1000 sq ft) BEFORE SEEDING. HARROW OR DISC INTO UPPER THREE INCHES OF SOIL.
- SEEDING: FOR THE PERIODS MARCH 1 THRU APRIL 30 AND AUGUST 1 THRU OCTOBER 15, SEED WITH 60 LBS PER ACRE (1.4 105/1000 sq ft) OF KENTUCKY 31 TALL FESCUE. FOR THE PERIOD MAY 1 THRU JULY 31, SEED WITH 60 LBS OF KENTUCKY 31 TALL FESCUE PER ACRE AND 2 LBS PER ACRE (1.05 105/1000 sq ft) OF WEEPING LOVEGRASS. DURING THE PERIOD OF OCTOBER 16 THRU FEBRUARY 28, PROTECT SITE BY: OPTION (1) 2 TONS PER ACRE OF WELL ANCHORED STRAW MULCH AND SEED AS SOON AS POSSIBLE IN THE SPRING. OPTION (2) USE 500. OPTION (3) SEED WITH 60 LBS PER ACRE OF KENTUCKY 31 TALL FESCUE AND MULCH WITH 2 TONS PER ACRE OF WELL ANCHORED STRAW.
- MULCHING: APPLY 1-1/2 TO 2 TONS PER ACRE (70 TO 90 105/1000 sq ft) OF UNROTTEED SMALL GRAIN STRAW IMMEDIATELY AFTER SEEDING. ANCHOR MULCH IMMEDIATELY AFTER APPLICATION USING MULCH ANCHORING TOOL OR 218 GALLONS PER ACRE (5 94/1000 sq ft) OF EMULSIFIED ASPHALT ON FLAT AREAS. ON SLOPES 8 FEET OR HIGHER, USE 348 GALLONS PER ACRE (8 94/1000 sq ft) FOR ANCHORING.
- MAINTENANCE: INSPECT ALL SEEDED AREAS AND MAKE NEEDED REPAIRS, REPLACEMENTS AND RESEEDINGS.
- TEMPORARY SEEDBED PREPARATION**
- APPLY TO GRADED OR CLEARED AREAS LIKELY TO BE REDISTURBED WHERE A SHORT-TERM VEGETATIVE COVER IS NEEDED.
- SEEDBED PREPARATION: LOOSEN UPPER THREE INCHES OF SOIL BY RAKING, DISCING OR OTHER ACCEPTABLE MEANS BEFORE SEEDING, IF NOT PREVIOUSLY LOOSENED.
- SOIL AMENDMENTS: APPLY 600 LBS PER ACRE 10-10-10 FERTILIZER (14 105/1000 sq ft).
- SEEDING: FOR PERIODS MARCH 1 THRU APRIL 30 AND FROM AUGUST 15 THRU NOVEMBER 15, SEED WITH 2-1/2 BUSHELS PER ACRE OF ANNUAL RYE (3.2 105/1000 sq ft). FOR THE PERIOD MAY 1 THRU AUGUST 14, SEED WITH 3 LBS PER ACRE OF WEEPING LOVEGRASS (.07 105/1000 sq ft). FOR THE PERIOD NOVEMBER 16 THRU FEBRUARY 28, PROTECT SITE BY APPLYING 2 TONS PER ACRE OF WELL ANCHORED STRAW MULCH AND SEED AS SOON AS POSSIBLE IN THE SPRING, OR USE 500.
- MULCHING: APPLY 1-1/2 TO 2 TONS PER ACRE (70 TO 90 105/1000 sq ft) OF UNROTTEED SMALL GRAIN STRAW IMMEDIATELY AFTER SEEDING. ANCHOR MULCH IMMEDIATELY AFTER APPLICATION USING MULCH ANCHORING TOOL OR 218 GALLONS PER ACRE (5 94/1000 sq ft) OF EMULSIFIED ASPHALT ON FLAT AREAS. ON SLOPES 8 FT. OR HIGHER, USE 348 GALLONS PER ACRE (8 94/1000 sq ft) FOR ANCHORING.
- REFER TO THE 1983 MARYLAND STANDARDS AND SPECIFICATIONS FOR SOIL EROSION AND SEDIMENT CONTROL FOR RATE AND METHODS NOT COVERED.

PERMANENT SEEDBED PREPARATION

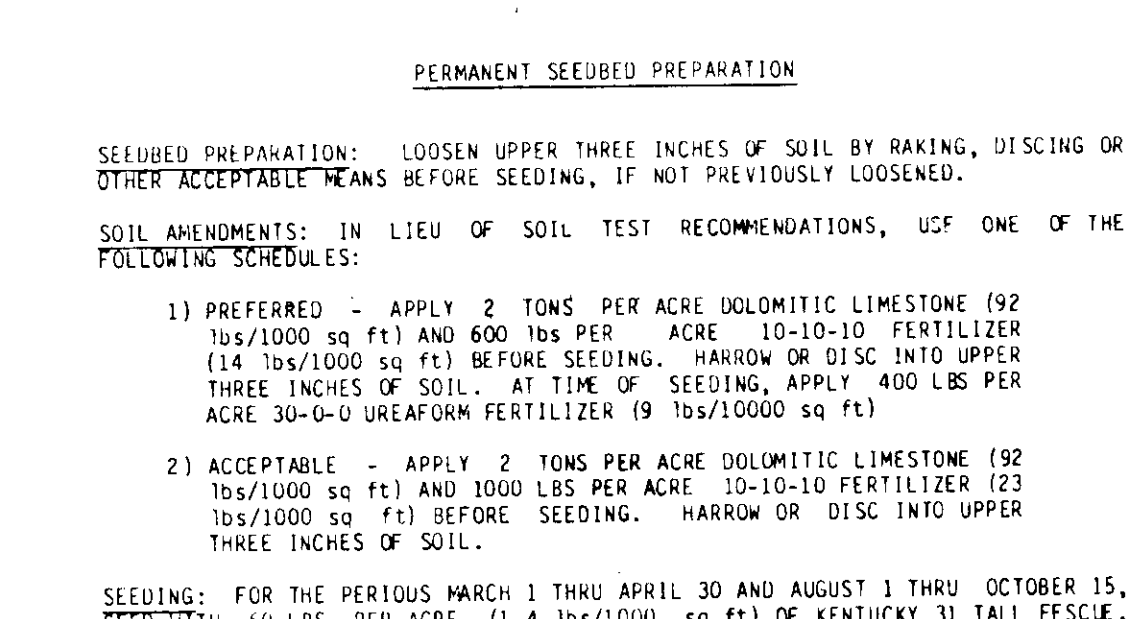

DRIVEWAY ENTRANCE
NO SCALE

- TEMPORARY SEEDBED PREPARATION**
- APPLY TO GRADED OR CLEARED AREAS LIKELY TO BE REDISTURBED WHERE A SHORT-TERM VEGETATIVE COVER IS NEEDED.
- SEEDBED PREPARATION: LOOSEN UPPER THREE INCHES OF SOIL BY RAKING, DISCING OR OTHER ACCEPTABLE MEANS BEFORE SEEDING, IF NOT PREVIOUSLY LOOSENED.
- SOIL AMENDMENTS: APPLY 600 LBS PER ACRE 10-10-10 FERTILIZER (14 105/1000 sq ft).
- SEEDING: FOR PERIODS MARCH 1 THRU APRIL 30 AND FROM AUGUST 15 THRU NOVEMBER 15, SEED WITH 2-1/2 BUSHELS PER ACRE OF ANNUAL RYE (3.2 105/1000 sq ft). FOR THE PERIOD MAY 1 THRU AUGUST 14, SEED WITH 3 LBS PER ACRE OF WEEPING LOVEGRASS (.07 105/1000 sq ft). FOR THE PERIOD NOVEMBER 16 THRU FEBRUARY 28, PROTECT SITE BY APPLYING 2 TONS PER ACRE OF WELL ANCHORED STRAW MULCH AND SEED AS SOON AS POSSIBLE IN THE SPRING, OR USE 500.
- MULCHING: APPLY 1-1/2 TO 2 TONS PER ACRE (70 TO 90 105/1000 sq ft) OF UNROTTEED SMALL GRAIN STRAW IMMEDIATELY AFTER SEEDING. ANCHOR MULCH IMMEDIATELY AFTER APPLICATION USING MULCH ANCHORING TOOL OR 218 GALLONS PER ACRE (5 94/1000 sq ft) OF EMULSIFIED ASPHALT ON FLAT AREAS. ON SLOPES 8 FT. OR HIGHER, USE 348 GALLONS PER ACRE (8 94/1000 sq ft) FOR ANCHORING.
- REFER TO THE 1983 MARYLAND STANDARDS AND SPECIFICATIONS FOR SOIL EROSION AND SEDIMENT CONTROL FOR RATE AND METHODS NOT COVERED.

TEMPORARY SEEDBED PREPARATION

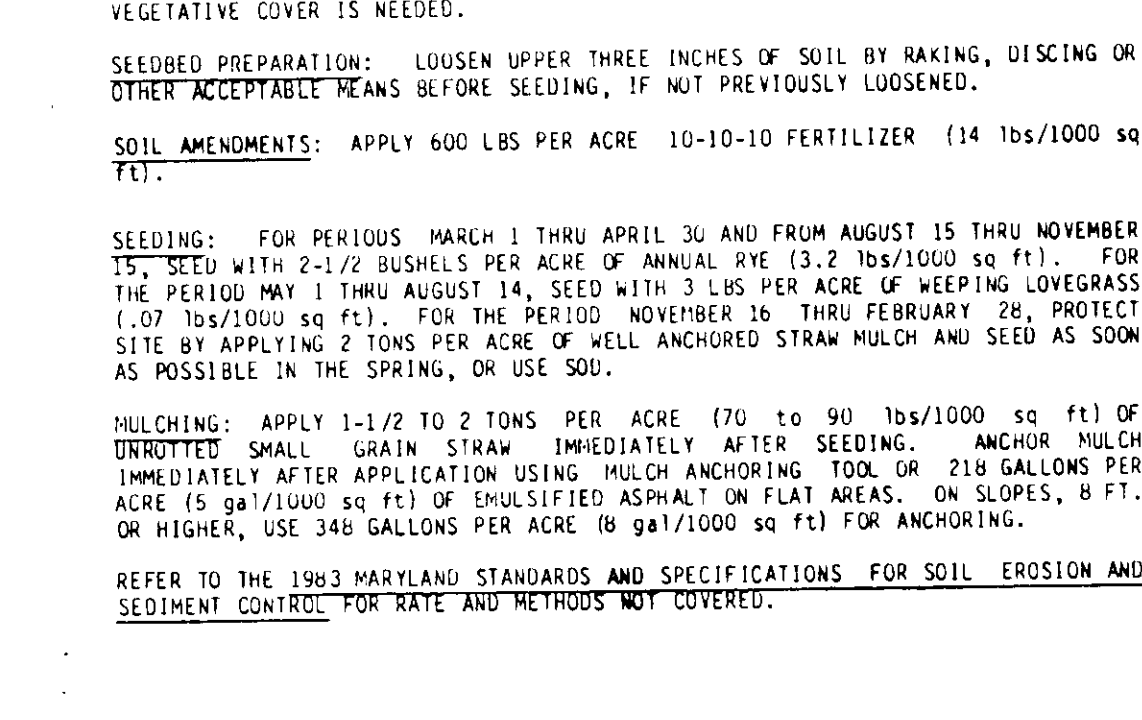

DRIVEWAY ENTRANCE
NO SCALE

- CONSTRUCTION NOTES FOR FABRICATED SILT FENCE**
- MONUMENTS SHALL BE PLACED REGULARLY TO FACE POSTS WITH WIRE TIES OF STAPLES.
 - FILTER CLOTH TO BE PATTERNOED REGULARLY TO COVER FACE WITH TIES SPACED EVERY 4' AT TOP AND MID SECTION.
 - WASH THE SECTIONS OF FILTER CLOTH BEFORE EACH OTHER THEY SHALL BE OVERLAPPED BY SIX INCHES AND POLAR.
 - MAINTENANCE SHALL BE PROVIDED AS REQUIRED AND NECESSARY. WHEN NECESSARY, SILT FENCE SHALL BE REPAIRED OR REPLACED.

SILT FENCE
NO SCALE

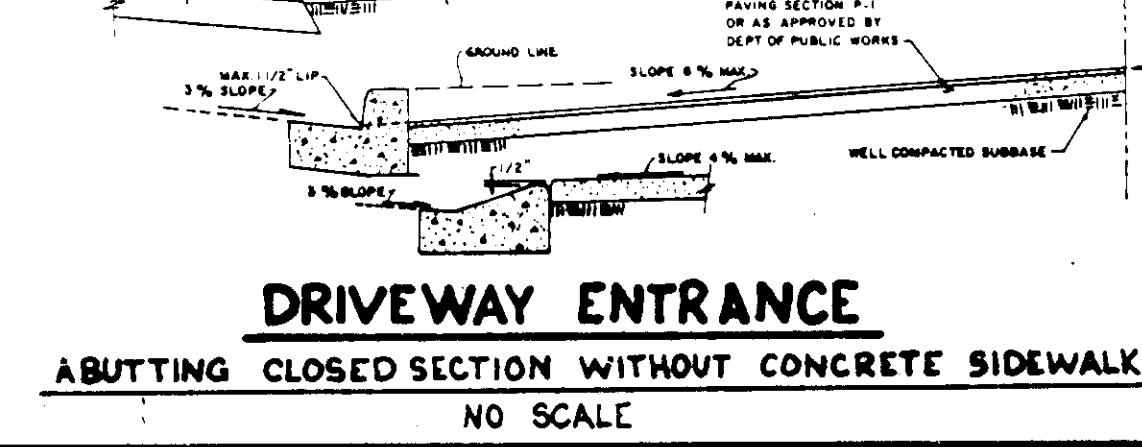

DRIVEWAY ENTRANCE
NO SCALE

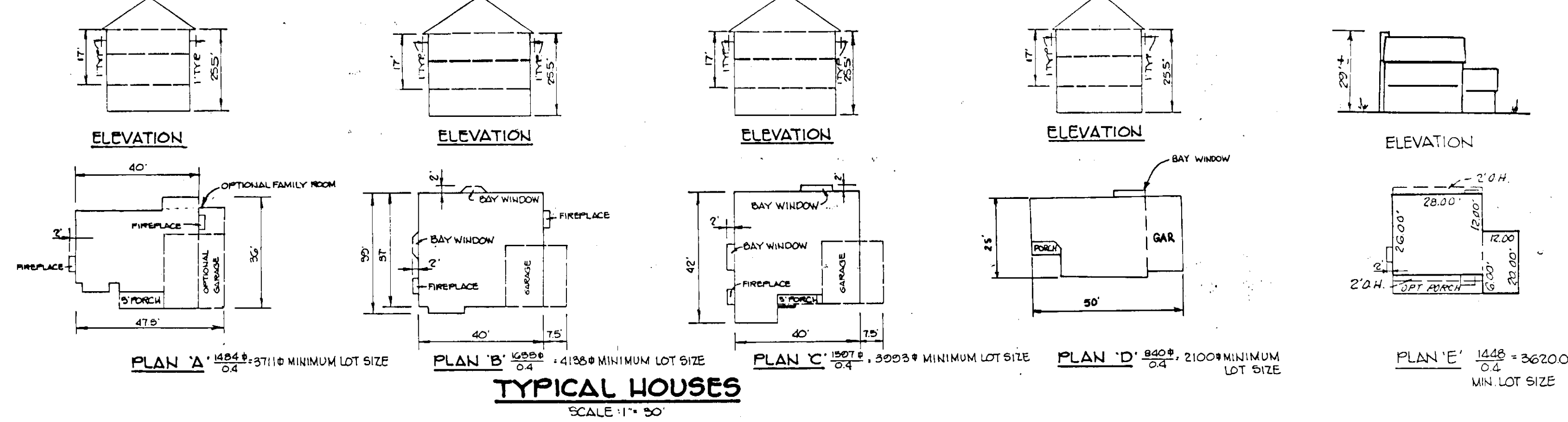

TYPICAL HOUSES
SCALE: 1" = 30'

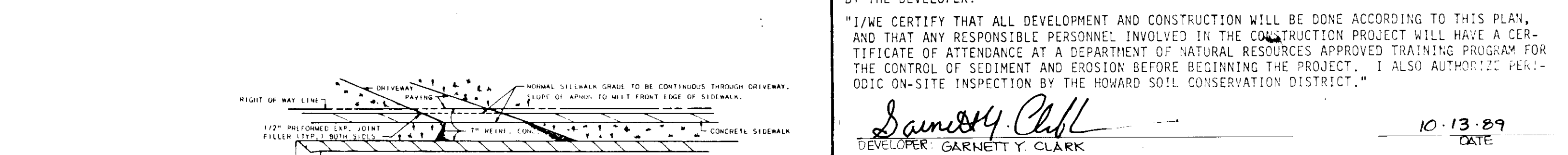

DRIVEWAY ENTRANCE
NO SCALE

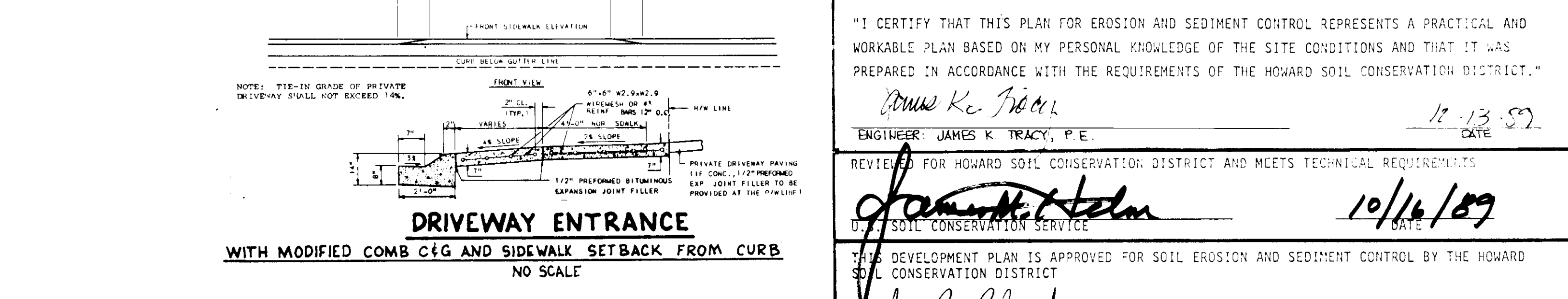

DRIVEWAY ENTRANCE
NO SCALE

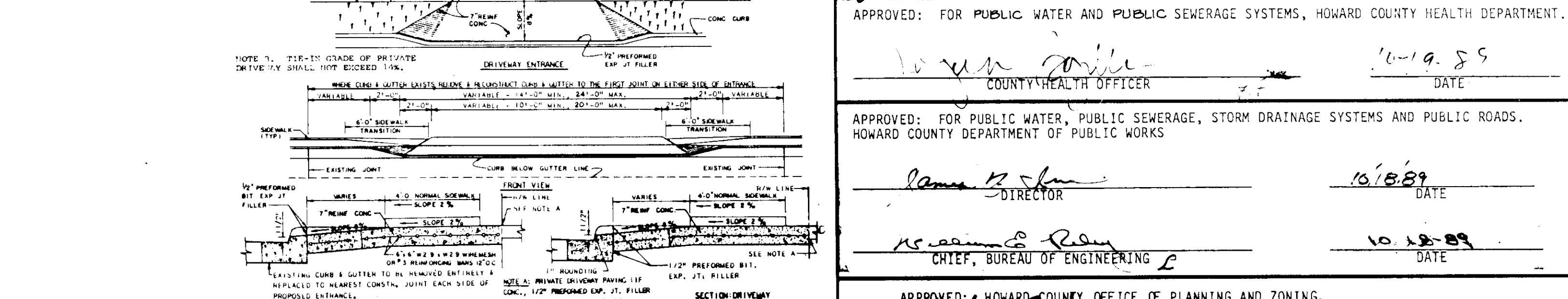

DRIVEWAY ENTRANCE
NO SCALE

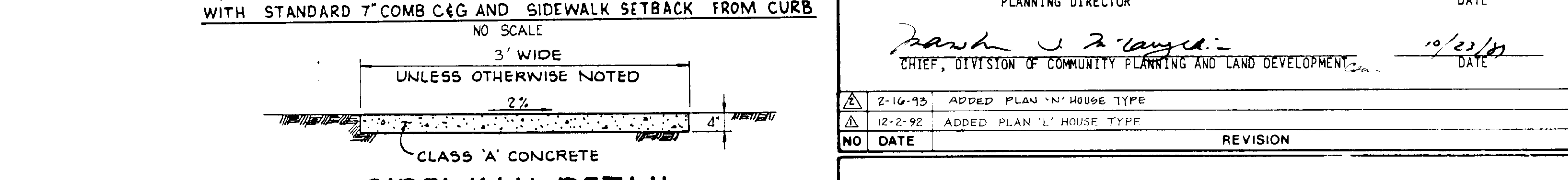

SIDEWALK DETAIL
NO SCALE

CLASS 'A' CONCRETE

3' WIDE UNLESS OTHERWISE NOTED

2% SLOPE

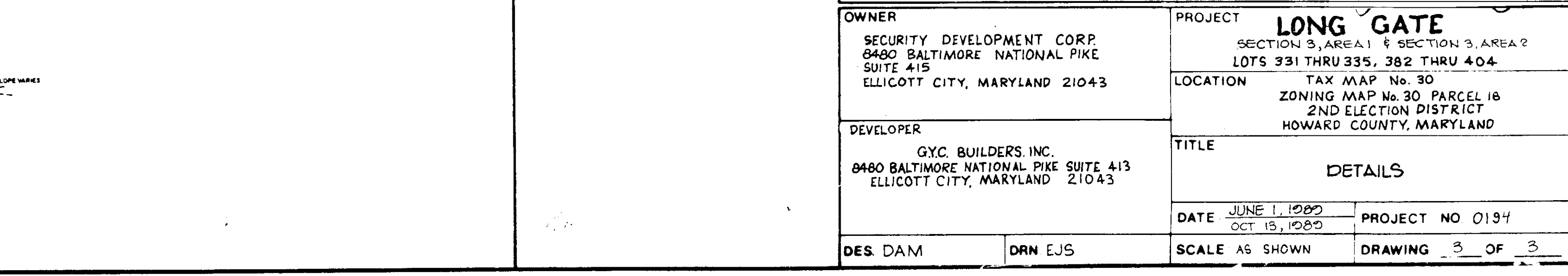

DRIVEWAY ENTRANCE
NO SCALE

BY THE DEVELOPER:
"I/WE CERTIFY THAT ALL DEVELOPMENT AND CONSTRUCTION WILL BE DONE ACCORDING TO THIS PLAN, AND THAT ANY RESPONSIBLE PERSONNEL INVOLVED IN THE CONSTRUCTION PROJECT WILL HAVE A CERTIFICATE OF ATTENDANCE AT A DEPARTMENT OF NATURAL RESOURCES APPROVED TRAINING PROGRAM FOR THE CONTROL OF SEDIMENT AND EROSION BEFORE BEGINNING THE PROJECT. I ALSO AUTHORIZE PERIODIC ON-SITE INSPECTION BY THE HOWARD SOIL CONSERVATION DISTRICT."
Garnett Y. Clark
DEVELOPER: GARNETT Y. CLARK
10-13-89 DATE

BY THE ENGINEER:
"I CERTIFY THAT THIS PLAN FOR EROSION AND SEDIMENT CONTROL REPRESENTS A PRACTICAL AND WORKABLE PLAN BASED ON MY PERSONAL KNOWLEDGE OF THE SITE CONDITIONS AND THAT IT WAS PREPARED IN ACCORDANCE WITH THE REQUIREMENTS OF THE HOWARD SOIL CONSERVATION DISTRICT."
James K. Tracy
ENGINEER: JAMES K. TRACY, P.E.
10-13-89 DATE

REVIEWED FOR HOWARD SOIL CONSERVATION DISTRICT AND MEETS TECHNICAL REQUIREMENTS
Garnett Y. Clark
D. J. SOIL CONSERVATION SERVICE
10/16/89 DATE

THIS DEVELOPMENT PLAN IS APPROVED FOR SOIL EROSION AND SEDIMENT CONTROL BY THE HOWARD SOIL CONSERVATION DISTRICT
Howard S. C.D.
10-13-89 DATE

APPROVED: FOR PUBLIC WATER AND PUBLIC SEWERAGE SYSTEMS, HOWARD COUNTY HEALTH DEPARTMENT.
James K. Tracy
DIRECTOR
10-13-89 DATE

APPROVED: FOR PUBLIC WATER, PUBLIC SEWERAGE, STORM DRAINAGE SYSTEMS AND PUBLIC ROADS, HOWARD COUNTY DEPARTMENT OF PUBLIC WORKS
James K. Tracy
10-13-89 DATE

APPROVED: HOWARD COUNTY OFFICE OF PLANNING AND ZONING.
James K. Tracy
PLANNING DIRECTOR
10-24-89 DATE

Mark J. Taylor
CHIEF, DIVISION OF COMMUNITY PLANNING AND LAND DEVELOPMENT
10-24-89 DATE

2-16-93	ADDED PLAN 'M' HOUSE TYPE	
12-2-92	ADDED PLAN 'L' HOUSE TYPE	
NO DATE		REVISION

TRACY, SCHULTE & ASSOCIATES INC.
planning • architecture • engineering
8480 Baltimore National Pike • Ellicott City, Maryland 21043 • (301) 465-6105

OWNER SECURITY DEVELOPMENT CORP 8480 BALTIMORE NATIONAL PIKE SUITE 415 ELICOTT CITY, MARYLAND 21043	PROJECT LONG GATE SECTION 3, AREA 1 & SECTION 3, AREA 2 LOTS 331 THRU 335, 382 THRU 404
	LOCATION TAX MAP No. 30 ZONING MAP No. 30 PARCEL 16 2ND ELECTION DISTRICT HOWARD COUNTY, MARYLAND
DEVELOPER GYC BUILDERS INC. 8480 BALTIMORE NATIONAL PIKE SUITE 413 ELICOTT CITY, MARYLAND 21043	TITLE DETAILS
DATE JUNE 1, 1989 OCT 15, 1989	PROJECT NO 0194
DES. DAM DRN EJS	SCALE AS SHOWN DRAWING 3 OF 3