

CONTENTS INDEX	
NO	DESCRIPTION
1	COVER SHEET
2	SITE DEVELOPMENT PLAN
3	DETAILS
4	ROADWAY PROFILES
5	DRAINAGE AREA MAP & ROADWAY PROFILES
6	GRADING & SEDIMENT CONTROL PLAN
7	SEDIMENT CONTROL NOTES & DETAILS
8	PROFILES OF DRAINAGE SWALES AND SEWER PROFILES
9	PLANTING PLAN

# SITE DEVELOPMENT PLAN

# NOTTINGHAM VILLAGE

## PHASE 2

## 1ST ELECTION DISTRICT

## HOWARD COUNTY, MARYLAND

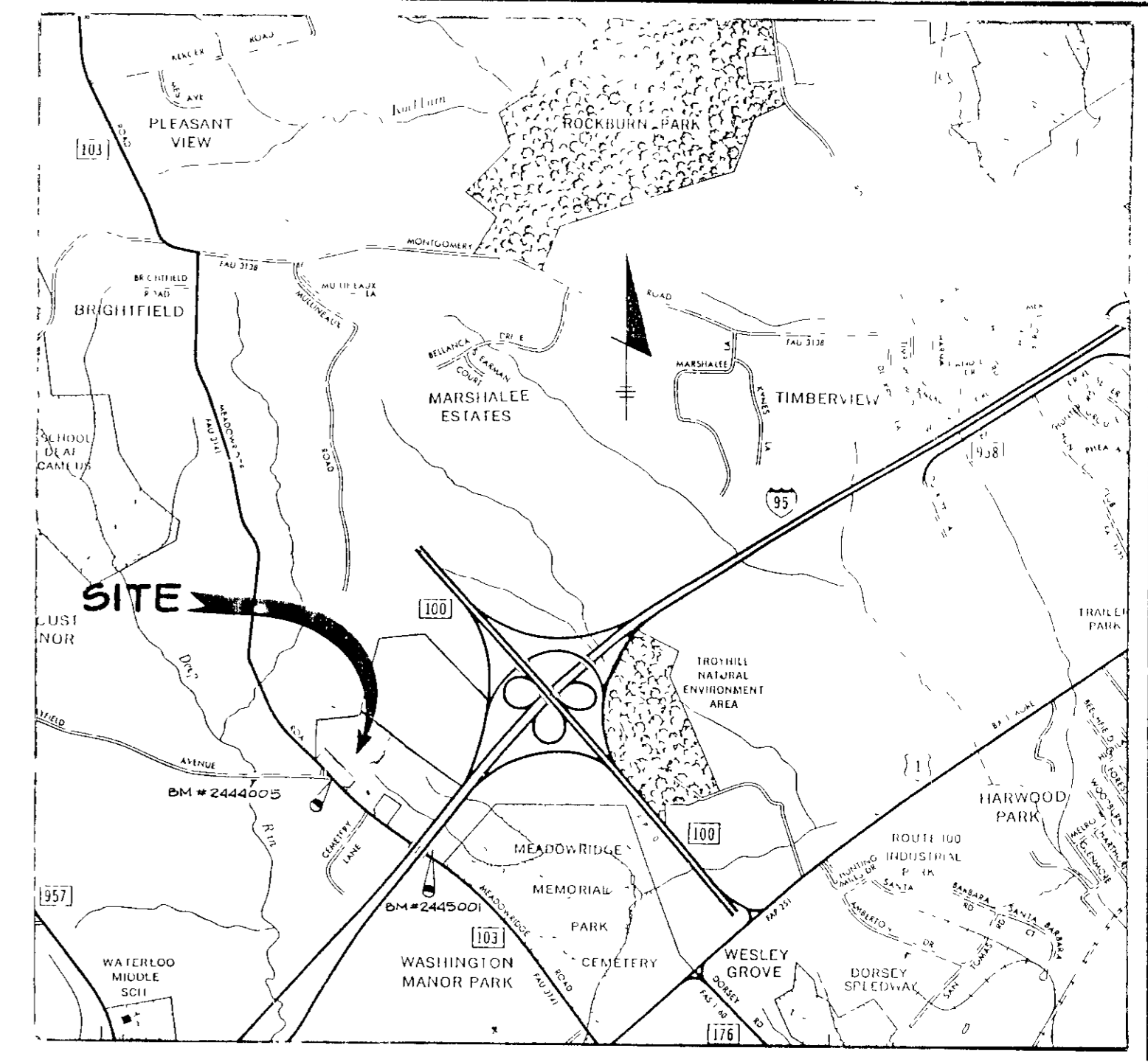

**VICINITY MAP**  
SCALE 1"=2000'

**BENCH MARK DESCRIPTIONS**

HC-BM #2444005 ELEV 271249  
CONCRETE MONUMENT 05' BELOW SURFACE

HC-BM #2445001 ELEV 245095  
CONCRETE MONUMENT 01' BELOW SURFACE

- GENERAL NOTES**
- ALL WATER LINES SHALL BE CONSTRUCTED A MINIMUM OF 42" COVER BELOW FINISHED GRADE
  - CORRUGATED STEEL PIPE SECTIONS WILL BE JOINED WITH A SINGLE OR TWO PIECE CORRUGATED BAND WITH A WATERTIGHT NEOPRENE GASKET. DIMPLED BAND CONNECTORS WILL NOT BE PERMITTED
  - ALL WORK SHALL BE PERFORMED IN ACCORDANCE WITH THE HOWARD COUNTY DESIGN MANUAL, VOLUME IV, I.E., STANDARD SPECIFICATIONS AND DETAILS FOR CONSTRUCTION
  - APPROXIMATE LOCATION OF EXISTING UTILITIES ARE SHOWN. THE CONTRACTOR SHALL TAKE ALL NECESSARY PRECAUTIONS TO PROTECT THE EXISTING UTILITIES AND MAINTAIN UNINTERRUPTED SERVICE. ANY DAMAGE INCURRED DUE TO CONTRACTOR'S OPERATION SHALL BE REPAIRED IMMEDIATELY AT THE CONTRACTOR'S EXPENSE
  - THE CONTRACTOR SHALL TEST PIT EXISTING UTILITIES, WHERE DIRECTED BY THE ENGINEER, A MINIMUM OF TWO WEEKS IN ADVANCE OF CONSTRUCTION OPERATIONS
  - CONTRACTOR TO NOTIFY THE FOLLOWING UTILITIES OR AGENCIES AT LEAST FIVE DAYS BEFORE STARTING WORK SHOWN ON THIS/ THESE DRAWINGS.
 

C & P TELEPHONE COMPANY	725-9976
HOWARD COUNTY BUREAU OF UTILITIES	992-2366
AT&T CABLE LOCATION DIVISION	393-3553
BALTIMORE GAS AND ELECTRIC COMPANY	685-0123
STATE HIGHWAY ADMINISTRATION	531-5533
HOWARD COUNTY CONSTRUCTION/INSPECTION SURVEY DIVISION	992-2417/2418
  - ALL INLETS SHALL BE CONSTRUCTED IN ACCORDANCE WITH HOWARD COUNTY STANDARDS
  - ALL PIPE ALLIATIONS SHOWN ARE INVERT *Or* ELEVATIONS
  - THE CONTRACTOR SHALL PROVIDE A JOINT IN ALL SEWER MAINS WITH 2'-0" OF EXTERIOR MANHOLE WALLS
  - PROFILE SETTINGS SHALL BE ADJUSTED AS NECESSARY TO CONFORM TO PLAN DIMENSIONS
  - NO P.F.P.E. SHALL BE LAID UNTIL LINES OF EXCAVATION HAVE BEEN BROUGHT TO SUBGRADE
  - TOPD TAKEN FROM AERIAL SURVEY BY MAPPING ASSOCIATES DATED APRIL, 1986.
  - STORM WATER MANAGEMENT FOR THIS SITE IS PROVIDED UNDER NOTTINGHAM VILLAGE PHASE 1, SDP-86-234.

**SITE TABULATION**

GRASS AREA OF SITE PHASE II	15.83 AC. (654737.57 sq. ft.)
PRESENT ZONING	RM-II
TOTAL NUMBER MOBILE HOMES ALLOWED	128
TOTAL NUMBER MOBILE HOMES PROPOSED	58
PARKING	
REQUIRED 2 SPACES/D.U. PROVIDE	116
OPEN SPACE TO REMAIN ON SITE NET AREA OF PHASE I	8.18 AC. (54%) 23.91 AC.

ADDRESS CHART	
LOT NOS	STREET ADDRESS
119	7703 TOUCHSTONE WAY
120	7708 "
121	7712 "
122	7714 "
123	6426 OLD HIGHGATE ROAD
124	6422 "
125	6418 "
126	6414 "
127	6410 "
128	6406 "
129	7975 MERRYMAKER WAY
130	7981 "
131	7985 "
132	7989 "
133	7984 "
134	7980 "
135	7976 "
136	7972 "
137	7968 "
138	7964 "
139	7960 "
140	7956 "
141	6294 WOODLAND FOREST DRIVE
142	6290 "
143	6286 "
144	6282 "
145	6278 "
146	6274 "
147	6270 "
148	6266 "
149	6262 "
150	6258 "
151	6254 "
152	6250 "
153	6246 "
154	7926 MERRYMAKER WAY

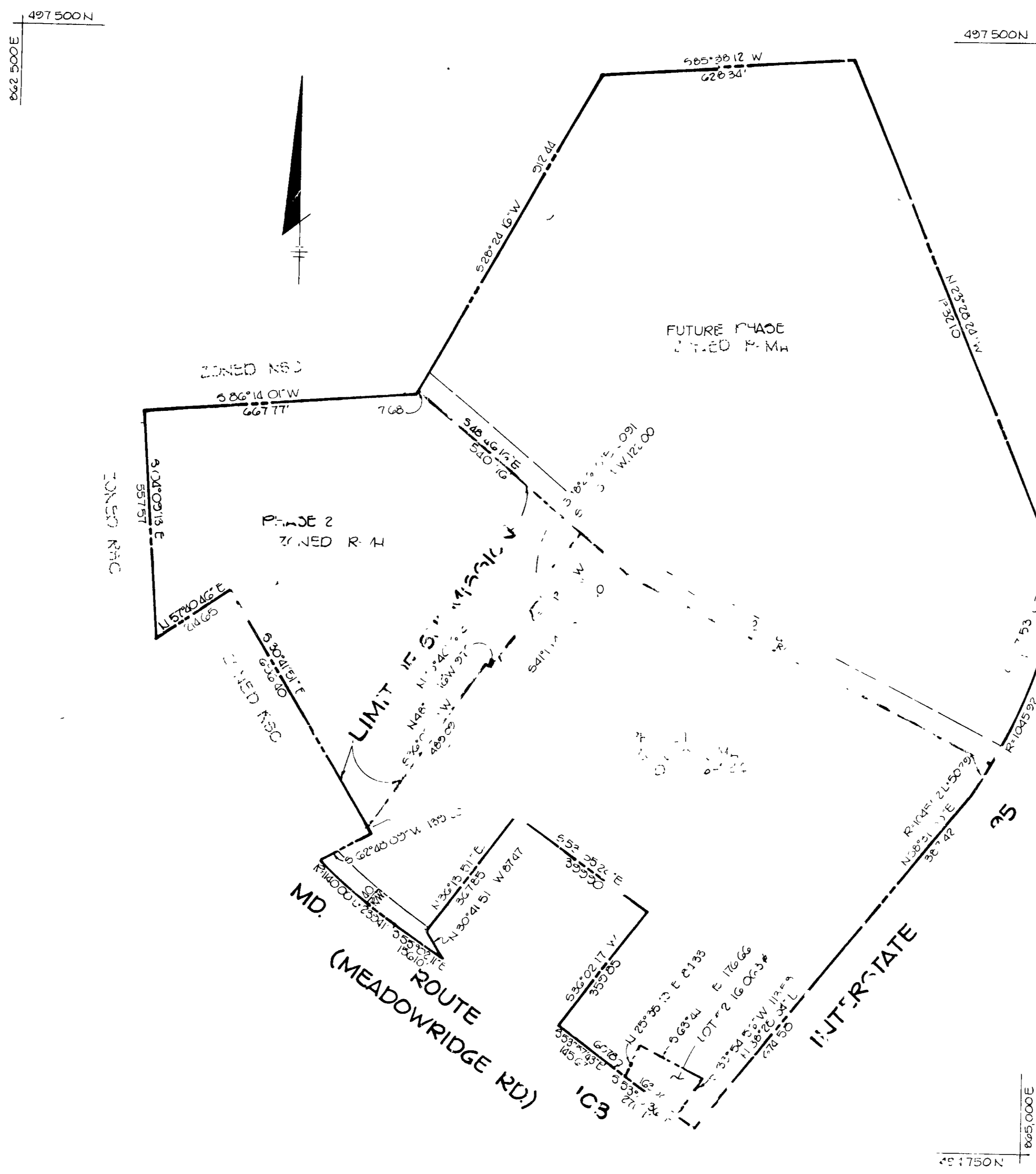

**CERTIFICATION**

I CERTIFY THAT ALL LOTS FOR MOBILE HOME LOCATION IN NOTTINGHAM VILLAGE, PHASE 2 MEET THE HOWARD COUNTY ZONING REGULATIONS RMH III C.2 b AND RMH III C.2 c THESE REQUIREMENTS INCLUDE:

- 4000 SF MINIMUM LOT SIZE
- 45' AVERAGE WIDTH OF LOT AT THE MOBILE HOME LOCATION
- BUILDING/MOBILE HOME SETBACKS
  - 30' FROM THE INTERNAL PRIVATE STREET
  - 5' FROM SIDE LOT LINE
  - 10' FROM REAR LOT LINE
  - 50' FROM DIFFERENTLY ZONED DISTRICT
  - 20' FROM ANOTHER BUILDING/MOBILE HOME
- 20% OPEN SPACE

*James K. Tracy* 6-20-88  
JAMES K. TRACY DATE

**LOT AREA CHART**

LOT NO	AREA SF	LOT NO	AREA SF
119	7900	148	4790
120	4980	149	4580
121	4950	150	4500
122	4770	151	5865
123	5049	152	7225
124	4750	153	4770
125	4900	154	5108
126	4650	155	6125
127	4580	156	6171
128	4500	157	4850
129	5066	158	4850
130	4580	159	4850
131	4500	160	4850
132	6585	161	4800
133	6780	162	4875
134	4500	163	4850
135	4500	164	4800
136	4580	165	4800
137	4580	166	4800
138	4580	167	4800
139	4580	168	4800
140	4580	169	5814
141	4580	170	6120
142	5825	171	4850
143	4580	172	4800
144	4580	173	4800
145	4580	174	4800
146	6700	175	4800
147	4800	176	4800

11-3-88

**PLAN**  
SCALE 1"=200'

PREVIOUS RELATED HOWARD COUNTY ENGINEERING NUMBER: SDP-7-155, F-87-155 AND SDP-25-114 NC 111-1-1 VILLAGE PHASE I

APPROVED FOR PUBLIC WATER AND PUBLIC SEWERAGE SYSTEMS, HOWARD COUNTY HEALTH DEPARTMENT

*James M. Boardman* 12/25/89  
COUNTY HEALTH OFFICER DATE

APPROVED FOR PUBLIC WATER, PUBLIC SEWERAGE, STORM DRAINAGE SYSTEMS AND PUBLIC ROADS

HOWARD COUNTY DEPARTMENT OF PUBLIC WORKS

*James J. Smith* 10/25/89  
DIRECTOR DATE

*James J. Smith* 10-25-89  
DATE

APPROVED CHIEF, BUREAU OF ENGINEERING

HOWARD COUNTY DEPT. OF PLANNING AND ZONING

*James J. Smith* 11/13/89  
DIRECTOR DATE

*James J. Smith* 11/13/89  
CHIEF, DIVISION OF COMMUNITY PLANNING AND LAND DEVELOPMENT DATE

NO	DATE	REVISION

TRACY, SCHULTE & ASSOCIATES INC.  
planning • architecture • engineering

8180 Baltimore National Pike • Ellicott City, Maryland 21043 • (301) 465-6105

OWNER: SECURITY DEVELOPMENT CORP  
8480 BALTIMORE NATIONAL PIKE SUITE 411  
ELLICOTT CITY MARYLAND 21043

PROJECT: NOTTINGHAM VILLAGE - PHASE 2  
LOTS 119 THRU 176

LOCATION: TAX MAP NO 37 L 14271, F 284  
ZONING MAP NO 37 PARCEL NOS 133 & 201  
1ST ELECTION DISTRICT  
HOWARD COUNTY MARYLAND

DEVELOPER: SECURITY DEVELOPMENT CORP  
8480 BALTIMORE NATIONAL PIKE SUITE 411  
ELLICOTT CITY MARYLAND 21043

TITLE: TITLE SHEET (MOBILE HOME PARK)

DATE: JUNE 30 1988  
SEPT 7 1989

PROJECT NO: 0049

DES: DAM DYN: CDT

SCALE: AS SHOWN

DRAWING: 1 OF 2

NO.	LOCATION
101	7 RT STA 10+31 OLD HIGHGATE ROAD
102	7 RT STA 12+66 OLD HIGHGATE ROAD
103	7 LT STA 12+08 WOODLAND FOREST DRIVE
104	7 RT STA 6+25 MERRYMAKER WAY
105	7 RT STA 0+58 OLD HIGHGATE ROAD

CURVE DATA		CURVE DATA	
WOODLAND FOREST DRIVE FROM STA 12+74.55 TO STA 15+02.18		WOODLAND FOREST DRIVE FROM STA 13+02.18 TO STA 15+15.04	
Δ	05° 16' 37"	Δ	40° 30' 13"
R	300.00	R	300.00
L	276.3	L	212.86
T	13.82	T	11.13
D	10° 05' 55"	D	10° 05' 55"
CHORD	N 51° 24' 34" W 276.2	CHORD	N 74° 22' 29" W 208.42
CURVE DATA		CURVE DATA	
MERRYMAKER WAY FROM STA 3+62.35 TO STA 4+22.49		TOUCHSTONE WAY FROM STA 1+20.11 TO STA 1+55.04	
Δ	07° 39' 35"	Δ	11° 26' 06"
R	450.00	R	175.00
L	60.14	L	34.93
T	30.11	T	17.52
D	12° 49' 57"	D	32° 44' 26"
CHORD	N 32° 12' 58" E 60.09	CHORD	N 26° 24' 54" W 34.87
CURVE DATA		CURVE DATA	
TOUCHSTONE WAY FROM STA 2+13.27 TO STA 2+71.51			
Δ	66° 44' 31"		
R	50.00		
L	58.24		
T	32.93		
D	114.35		
CHORD	N 02° 40' 25" E 55.01		



- THE WETLANDS/BUFFERS INDICATED ON THIS PLAN DOES NOT AFFECT THE INITIAL CONSTRUCTION OF A RESIDENTIAL UNIT ON A LOT IT DOES PROHIBIT SUBSEQUENT CLEARING, GRADING OR CONSTRUCTION IN THE BUFFER AREA MAINTENANCE OF RESIDENCES, LANDSCAPING AND UTILITIES IS PERMITTED
  - ON SITE PUBLIC WATER MAINS AND PUBLIC SEWER MAINS SHALL BE CONSTRUCTED UNDER HOWARD COUNTY CONTRACT NO. 14-1650-D. ON SITE PRIVATE SANITARY SEWER SHALL BE CONSTRUCTED IN ACCORDANCE WITH THESE PLANS
  - FOR TYPICAL STORAGE SHED LOCATION SEE TYPICAL PLAN SHEET NO. 3
- THIS SITE SHALL HAVE PRIVATE REFUSE COLLECTION

APPROVED FOR PUBLIC WATER AND PUBLIC SEWERAGE SYSTEMS, HOWARD COUNTY HEALTH DEPARTMENT	<i>Carol M. Borne</i>	06/25/89
COUNTY HEALTH OFFICER		DATE
APPROVED FOR PUBLIC WATER, PUBLIC SEWERAGE, STORM DRAINAGE SYSTEMS AND PUBLIC ROADS	<i>James J. ...</i>	10/26/89
HOWARD COUNTY DEPARTMENT OF PUBLIC WORKS	DIRECTOR	DATE
APPROVED HOWARD COUNTY DEPT OF PLANNING AND ZONING	<i>Joseph R. ...</i>	11/13/89
CHIEF DIVISION OF COMMUNITY PLANNING AND LAND DEVELOPMENT	DIRECTOR	DATE
NO. DATE	REVISION	

**TRACY, SCHULTE & ASSOCIATES INC.**  
 planning • architecture • engineering  
 8130 Baltimore National Pike • Ellicott City, Maryland 21043 • (301) 463-6105

OWNER	PROJECT
SECURITY DEVELOPMENT CORP 8480 BALTIMORE NATIONAL PIKE SUITE 211 ELlicOTT CITY, MARYLAND 21043	<b>NOTTINGHAM VILLAGE</b> PHASE 2, LOTS 119 THROUGH 128 LOCATION TAX MAP NO 37 L 1327 E 284 ZONING MAP NO 37 PARCEL NO 153 (201) 1 <sup>ST</sup> ELECTION DISTRICT HOWARD COUNTY MARYLAND
DEVELOPER	TITLE
SECURITY DEVELOPMENT CORP 8480 BALTIMORE NATIONAL PIKE SUITE 211 ELlicOTT CITY, MARYLAND 21043	<b>SITE DEVELOPMENT PLAN</b> (MOBILE HOME PARK)
DATE	PROJECT NO
JUNE 29 1989 DEPT 7 1989	0049
DRAWN	SCALE
CON/SAB	1"=50'
	DRAWING NO. 2 OF 9

11-3-88

**SDP-88-255**

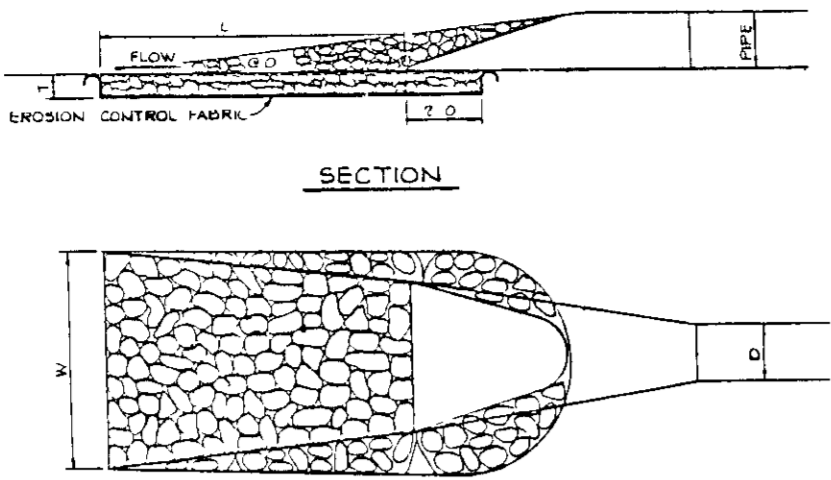

STRUCTURE	d - 90	LENGTH	WIDTH	THICKNESS
E-1	0.5'	12'	14"	1.18

**OUTLET PROTECTION DETAIL**  
NO SCALE

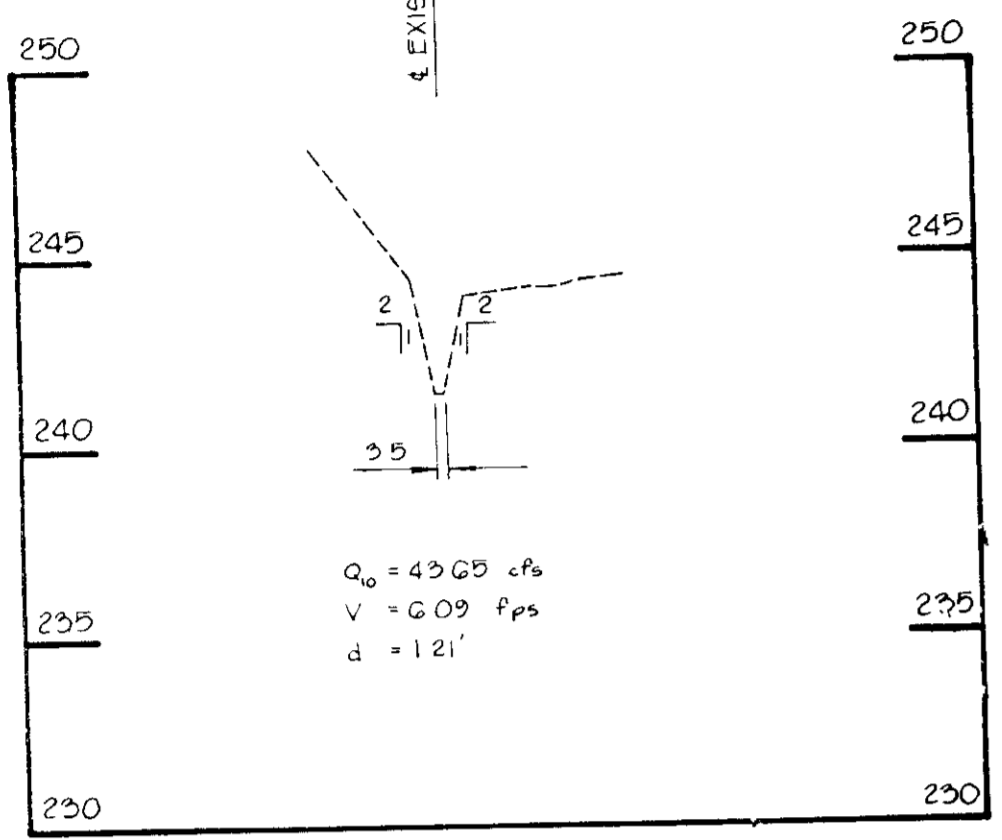

**SECTION 'C-C'**

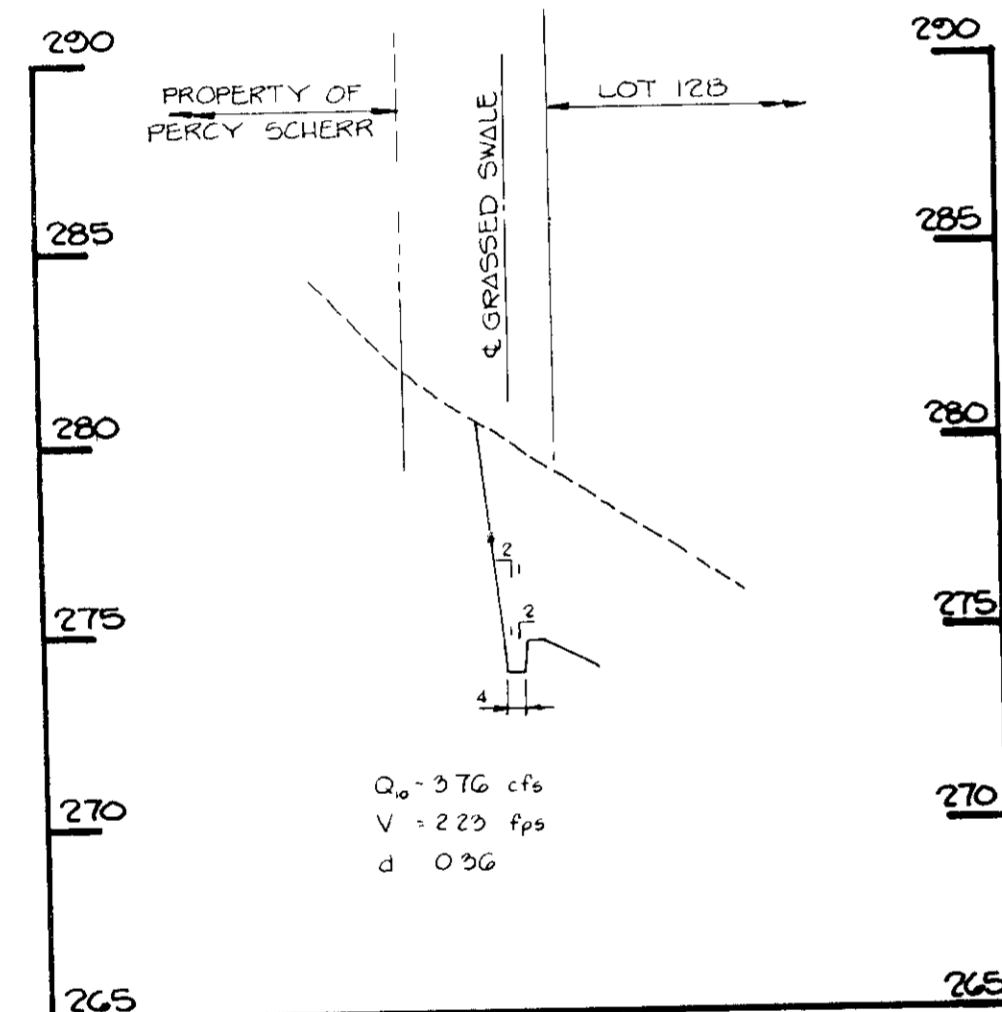

**SECTION 'A-A'**

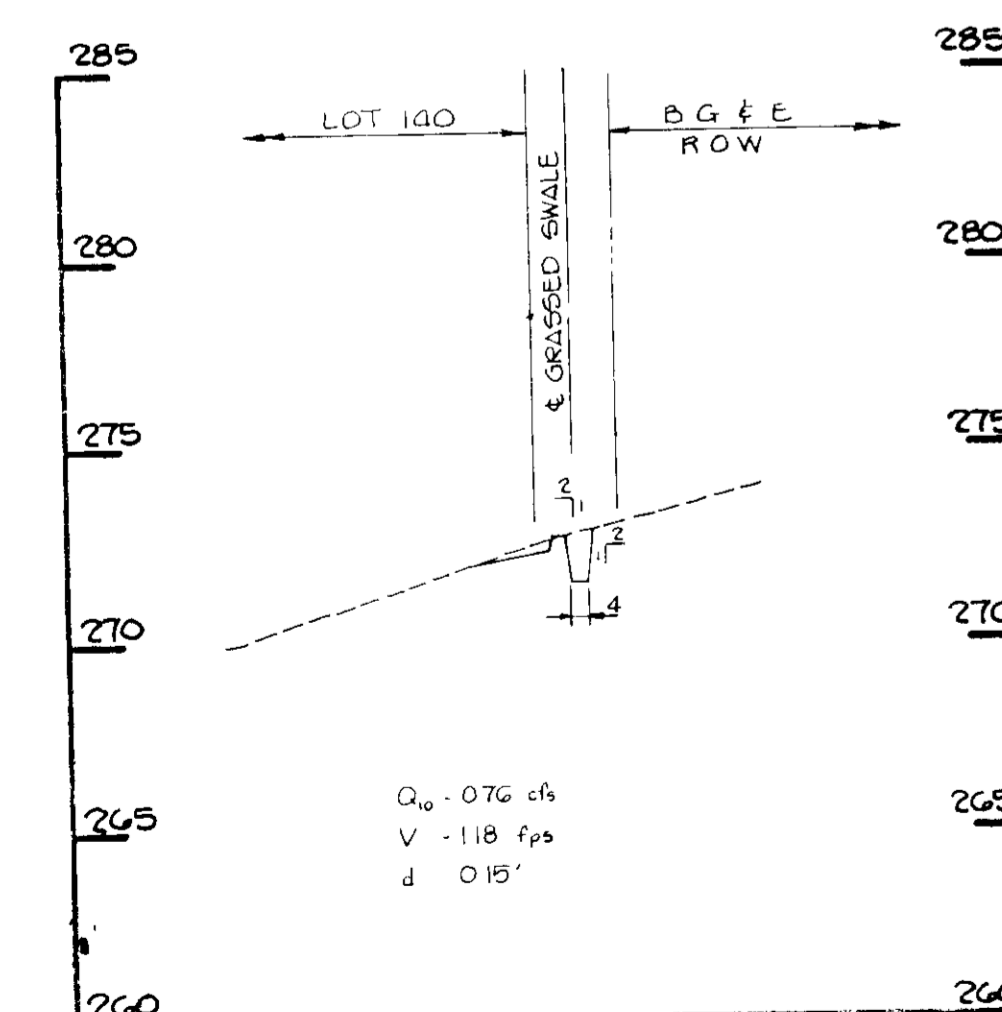

**SECTION 'B-B'**  
**CROSS SECTIONS OF GRASSED SWALES**

SCALE HORIZ 1"=50'  
VERT 1"=5'

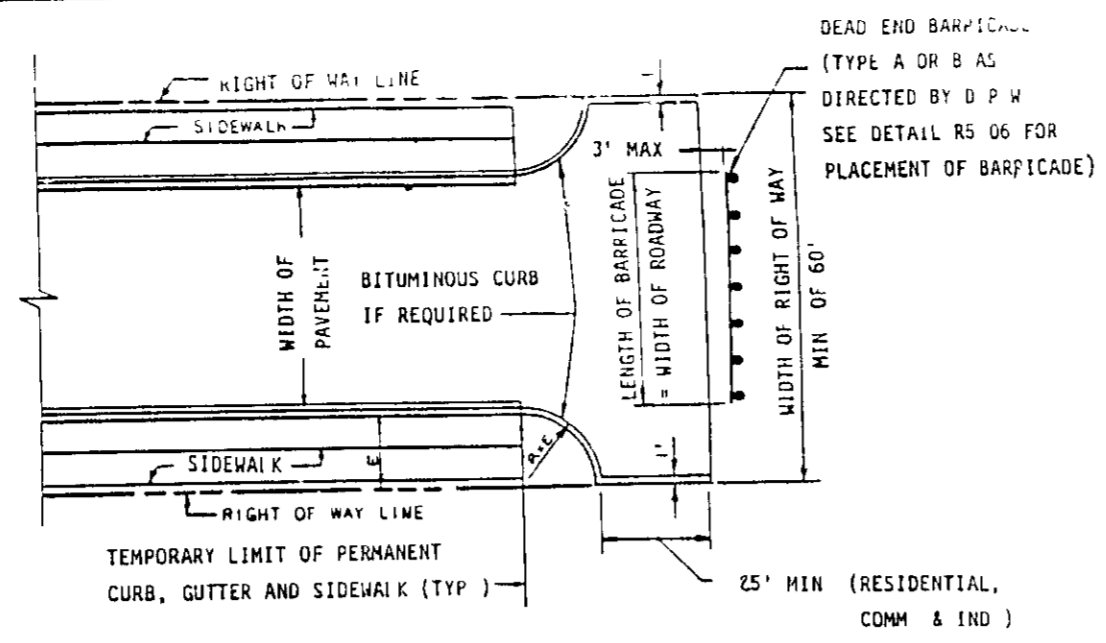

- NOTES**
1. A TEE TURN-AROUND SHALL BE USED IN LIEU OF A CUL-DE-SAC ONLY IF THE STREET IS TO BE EXTENDED IN THE FUTURE
  2. BITUMINOUS CURB SHALL EXTEND AROUND THE TEE TURN-AROUND IF AND AS REQUIRED TO CONTROL CURB DRAINAGE FROM THE ROADWAY SECTION
  3. REFER TO STANDARD R-5 06 FOR TYPICAL ROADWAY PROFILE OF TEMPORARY LIMIT OF PAVING
  4. FOR LOCAL ROADS, PROVIDE 5' REVERTIBLE EASEMENT EACH END OF THE TEE
  5. PROVIDE EASEMENTS AS REQUIRED FOR PLACEMENT OF BARRIERS AND ANY NECESSARY GRADING (SEE DETAIL R5 06)

**TEMPORARY TEE TURN-AROUND**

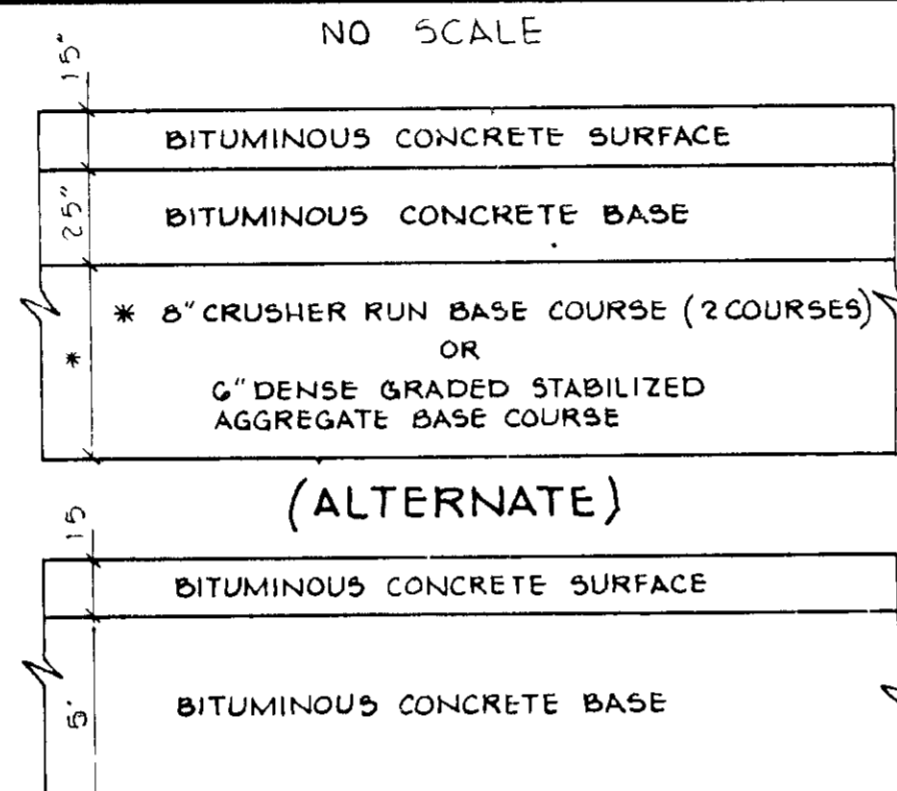

HOWARD COUNTY DESIGN MANUAL VOLUME IV  
STANDARD SPECIFICATIONS AND DETAILS FOR CONSTRUCTION (DRAWING R 201)

**6 1/2" PAVING, P-2**

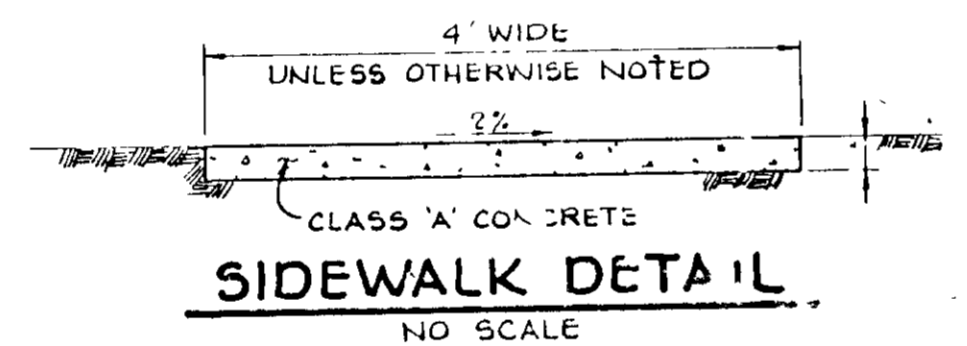

NOTE: TO BE USED FOR ALL BUILDING ENTRANCES EXCEPT THOSE THAT ARE EXCLUSIVELY FIRE EXITS

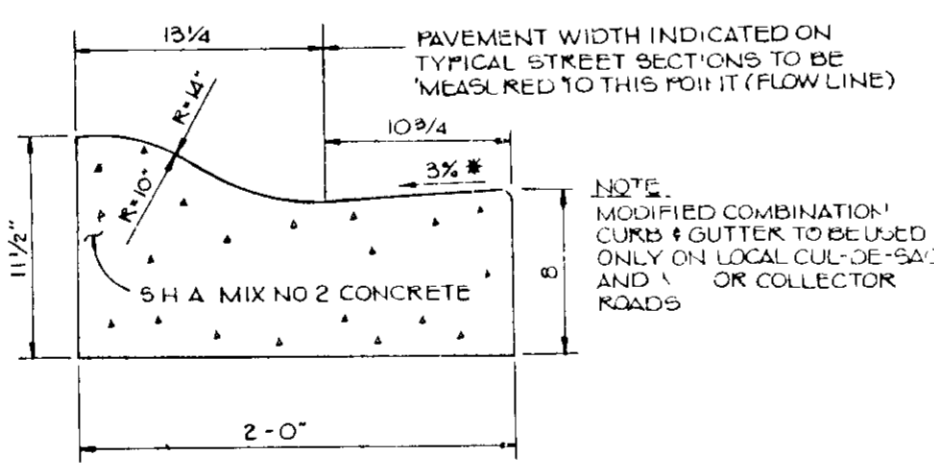

\* GUTTER PAN AT THE MEDIAN EDGE OF INTERMEDIATE ARTERIALS OR THE HIGH SIDE OF SUPERELEVATED SECTIONS SHALL BE SLOPED AT THE SAME RATE AND IN THE SAME DIRECTION AS THE PAVEMENT WHICH PAVEMENT CROSS SLOPE WHEN CURB IS LOCATED ON LOW SIDE OF SUPERELEVATED SECTION AND THE RATE OF SUPERELEVATION IS GREATER THAN 3% FOR MODIFIED CURB AND GUTTER

**MODIFIED COMBINATION CURB AND GUTTER**

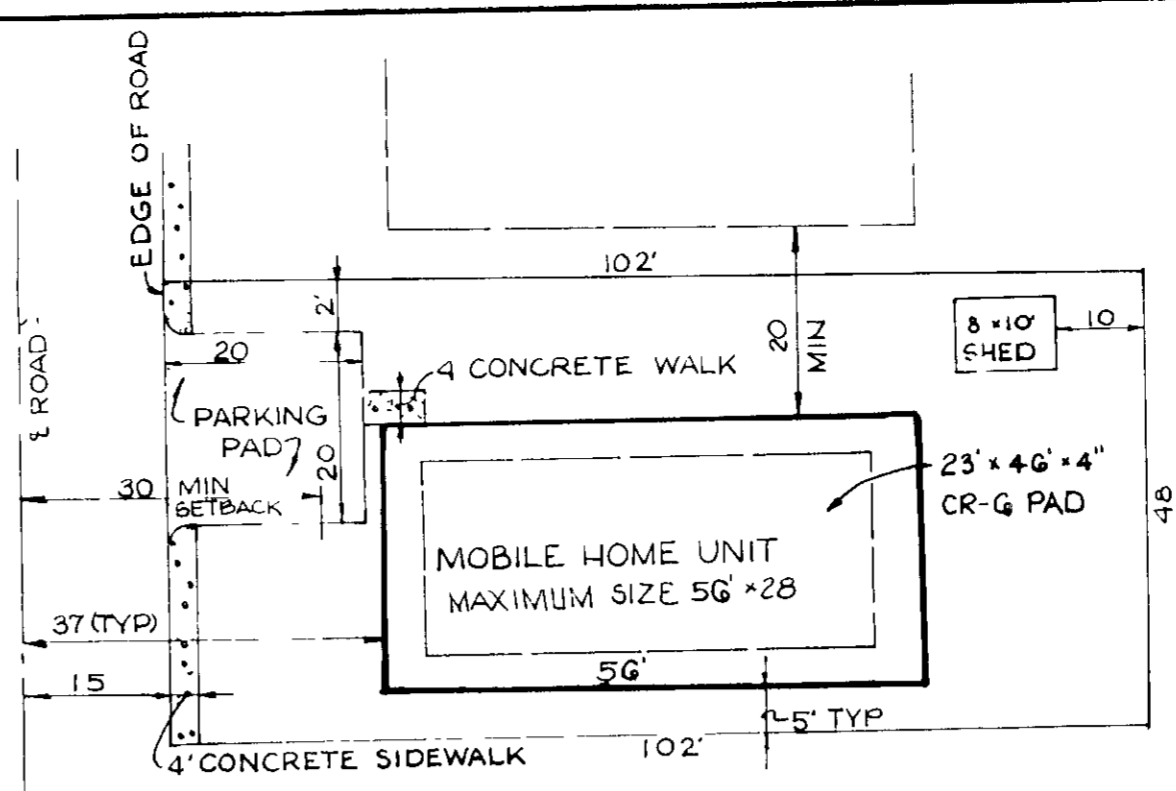
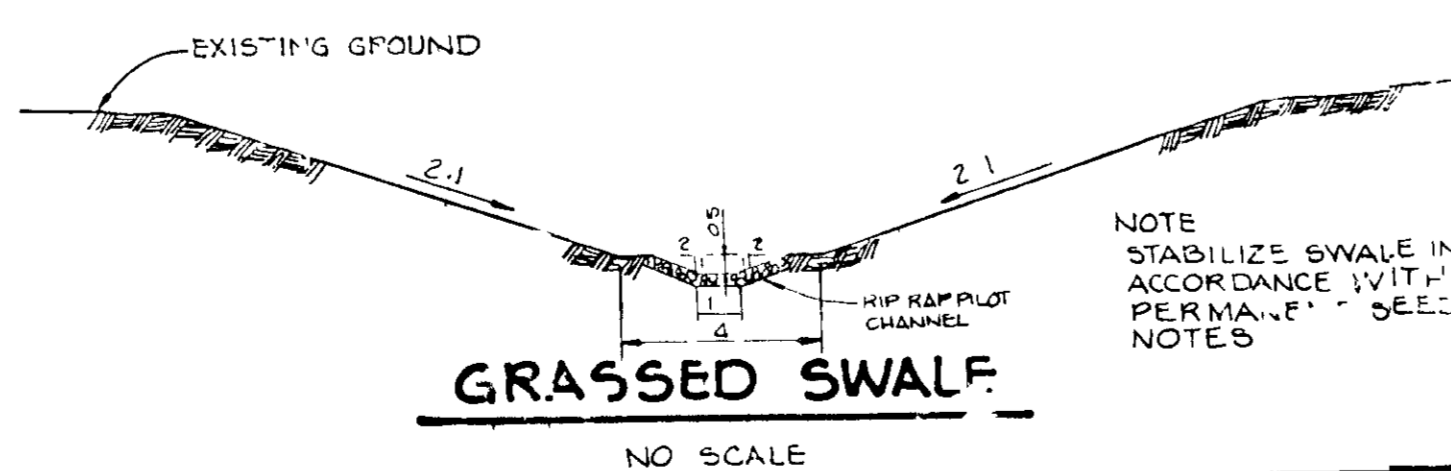

**TYPICAL LOT LAYOUT DOUBLE MOBILE HOME**  
NO SCALE

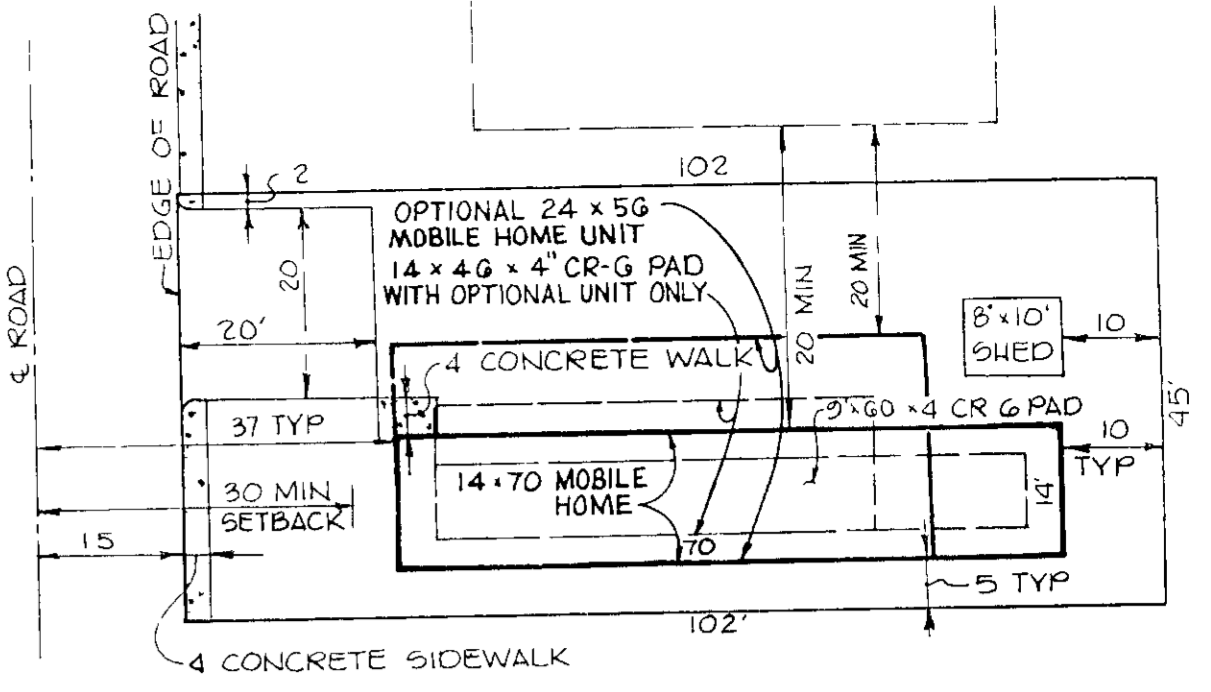

**TYPICAL LOT LAY-OUT**  
SCALE 1"=20'

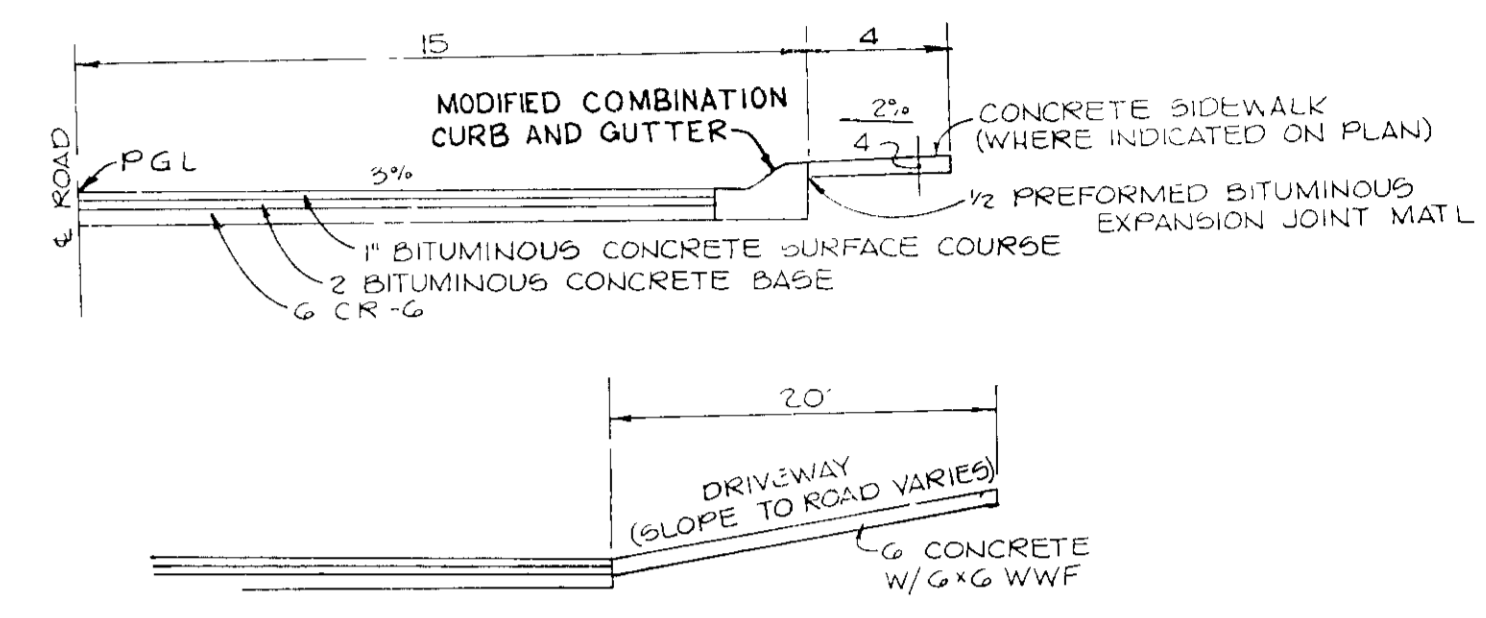

**STANDARD PAVING SECTION AT DRIVEWAY**

- NOTES**
1. A TACK COAT WILL BE REQUIRED IN ACCORDANCE WITH SECTION 31-4 OF THE HOWARD COUNTY CONSTRUCTION CODE AND SPECIFICATIONS
  2. BASE WILL BE PRIMED IN ACCORDANCE WITH SECTION C-30-3 OF THE HOWARD COUNTY CONSTRUCTION CODE AND SPECIFICATIONS

**STANDARD PAVING SECTION**

SCALE 1/4"=10'

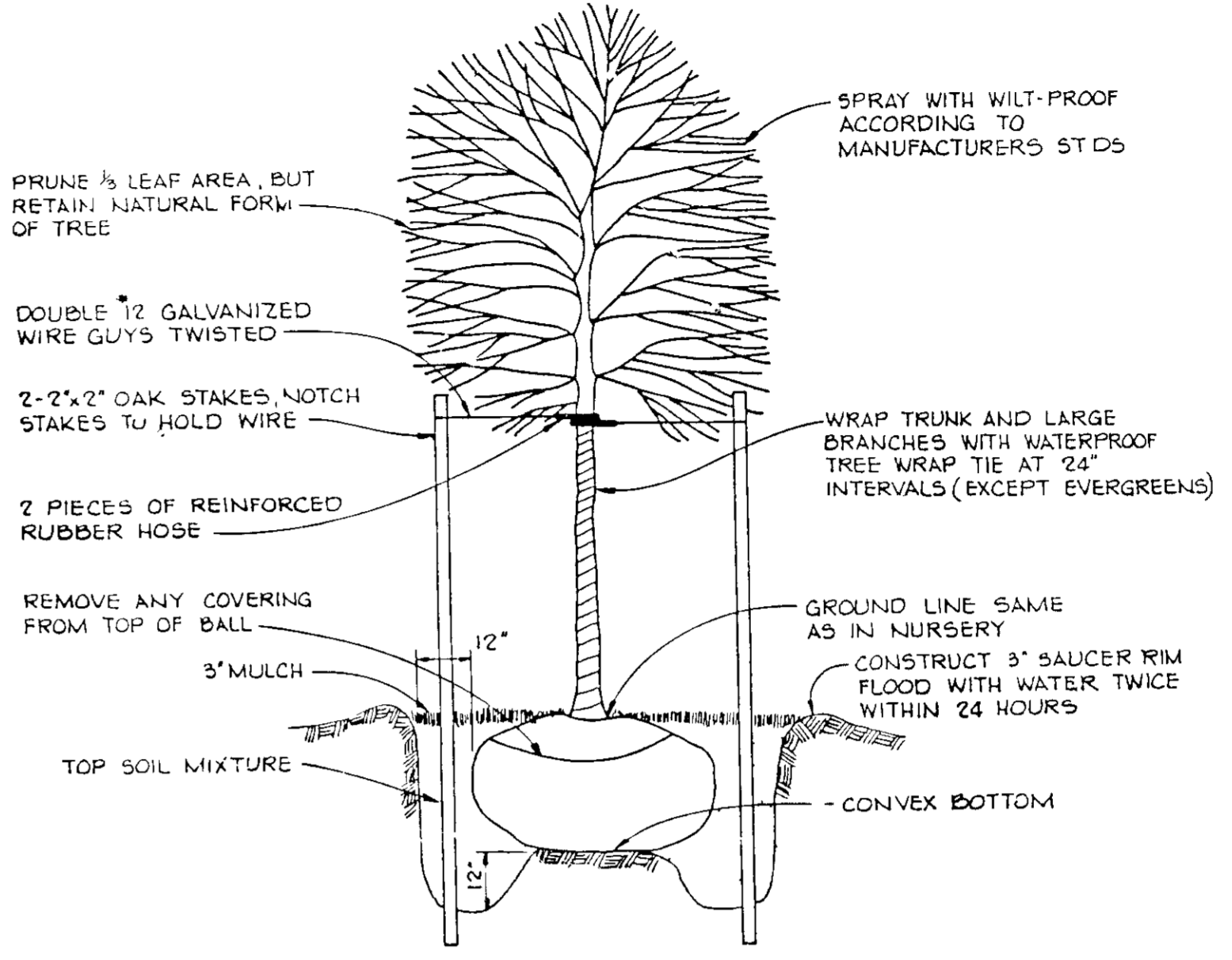

**TREE PLANTING DETAIL**

NO SCALE

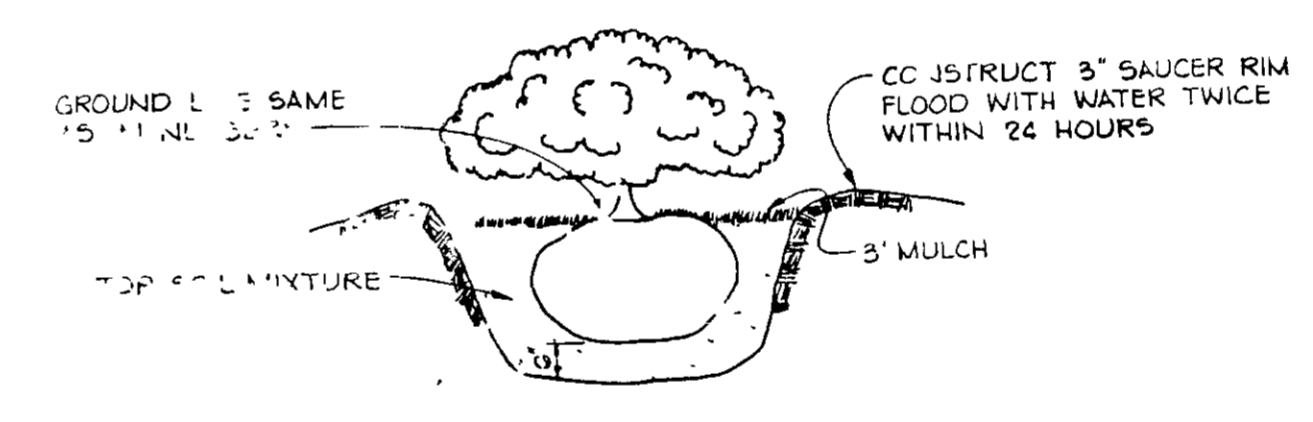

**SHRUB PLANTING DETAIL**

NO SCALE

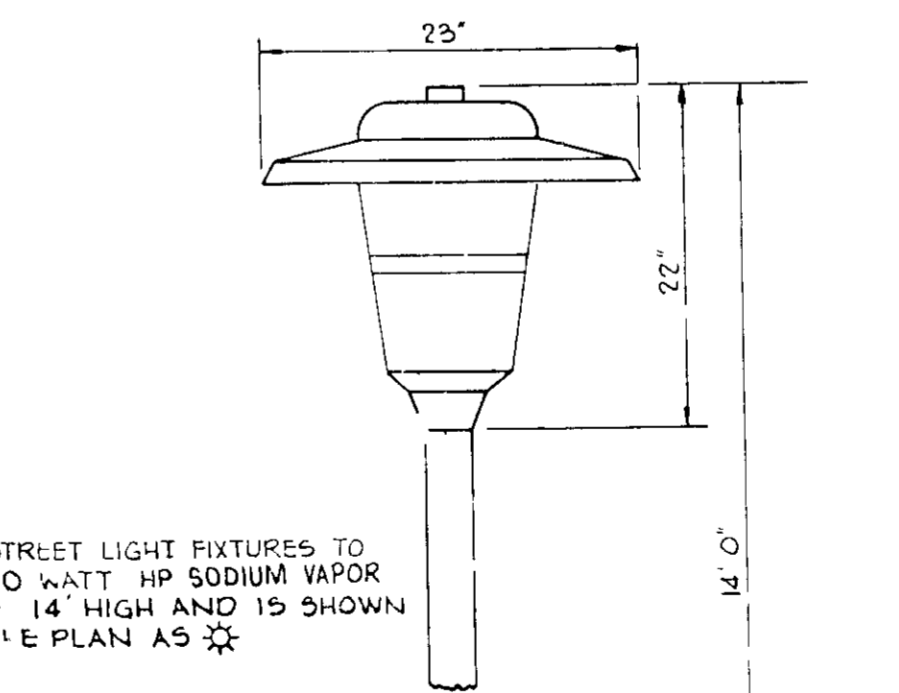

**DETAIL - LIGHTING FIXTURE**

NO SCALE

APPROVED FOR PUBLIC WATER AND PUBLIC SEWERAGE SYSTEMS, HOWARD COUNTY HEALTH DEPARTMENT

*George M. Boyd* COUNTY HEALTH OFFICER 10/25/89 DATE

APPROVED FOR PUBLIC WATER, PUBLIC SEWERAGE, STORM DRAINAGE SYSTEMS AND PUBLIC ROADS

HOWARD COUNTY DEPARTMENT OF PUBLIC WORKS

*James J. Scherr* DIRECTOR 10/25/89 DATE

*John J. Scherr* CHIEF, BUREAU OF ENGINEERING 10-25-89 DATE

APPROVED HOWARD COUNTY DEPT OF PLANNING AND ZONING

*Joseph J. Heath* DIRECTOR 11/13/89 DATE

*Frank S. Z. Conroy* CHIEF, DIVISION OF COMMUNITY PLANNING AND LAND DEVELOPMENT 11/13/89 DATE

NO.	DATE	REVISION

FRACY, SCHULTE & ASSOCIATES INC.  
planning • architecture • engineering

800 Madison National Pike • Poolesville, Maryland 21041 • (301) 433-0105

*James J. Scherr*

OWNER	PROJECT
SECURITY DEVELOPMENT CORP 8480 BALTIMORE NATIONAL PIKE SUITE 411 ELLICOTT CITY MARYLAND 21043	<b>NOTTINGHAM VILLAGE</b> PHASE 2 LOTS 119 THRU 170 LOCATION TAX MAP NO 37 U1427, F284 ZONING MAP NO 37 PARCEL NOS 133, 201 1ST ELECTION DISTRICT HOWARD COUNTY MARYLAND
DEVELOPER	TITLE
SECURITY DEVELOPMENT CORP 8480 BALTIMORE NATIONAL PIKE SUITE 411 ELLICOTT CITY MARYLAND 21043	DETAILS (MOBILE HOME PARK)
DATE: JUNE 30, 1988 SEPT 7, 1989	PROJECT NO: 0049
DES: D A M	SCALE AS SHOWN
DWN: CDT/JCA	DRAWING: 2 OF 2

11-3-88

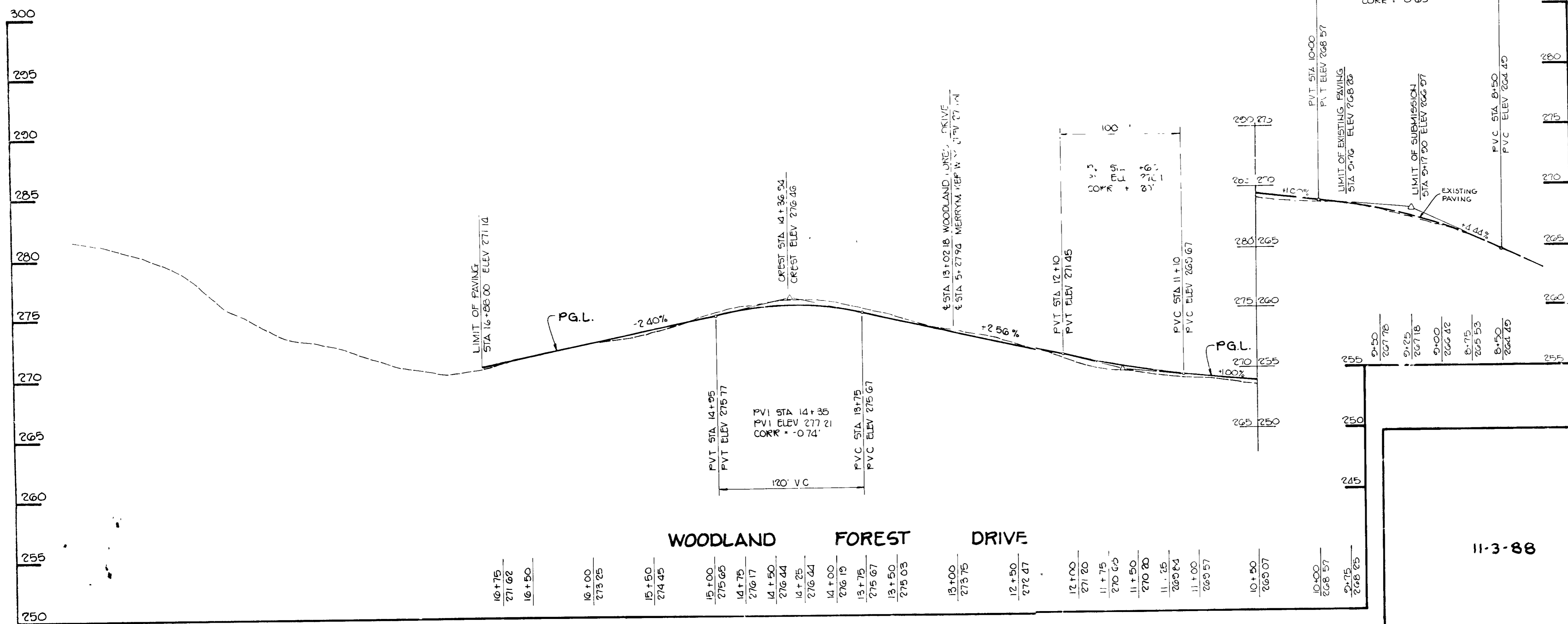
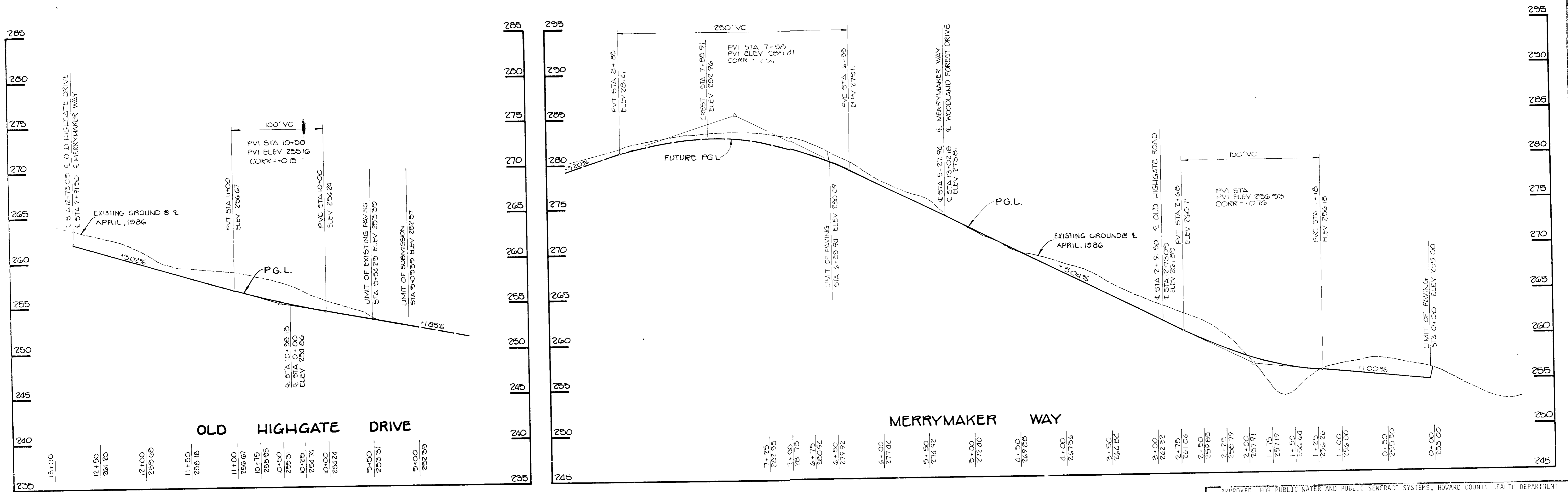

APPROVED FOR PUBLIC WATER AND PUBLIC SEWERAGE SYSTEMS, HOWARD COUNTY HEALTH DEPARTMENT

*George M. Boyce* 10/25/89  
COUNTY HEALTH OFFICER DATE

APPROVED FOR PUBLIC WATER, PUBLIC SEWERAGE, STORM DRAINAGE SYSTEMS AND PUBLIC ROADS  
HOWARD COUNTY DEPARTMENT OF PUBLIC WORKS

*James J. ...* 10/25/89  
DIRECTOR DATE

*...* 10/25/89  
CHIEF, BUREAU OF ENGINEERING DATE

APPROVED HOWARD COUNTY DEPT. OF PLANNING AND ZONING

*Joseph ...* 11/13/87  
DIRECTOR DATE

*Paul ...* 1/6/89  
CHIEF, DIVISION OF COMMUNITY PLANNING AND LAND DEVELOPMENT DATE

TRACY, SCHULTE & ASSOCIATES INC  
planning • architecture • engineering  
5011 Hamilton National Pike • Ellicott City, Maryland 21043 • (301) 441-1105

11-3-88

OWNER: SECURITY DEVELOPMENT CORP  
8480 BALTIMORE NATIONAL PIKE  
ELLCOTT CITY MARYLAND 21043

PROJECT: NOTTINGHAM VILLAGE  
PHASE 2, LOTS 119 THROUGH 176  
LOCATION: TAX MAP NO. 37, L1427, F204  
ZONING MAP NO. 37, PARCEL NOS 133 & 201  
1ST ELECTION DISTRICT  
HOWARD COUNTY, MARYLAND

DEVELOPER: SECURITY DEVELOPMENT CORP  
8480 BALTIMORE NATIONAL PIKE  
ELLCOTT CITY MARYLAND 21043

TITLE: ROADWAY PROFILES  
(MOBILE HOME PARK)

DATE: JUNE 30, 1988  
SEPT 7, 1989 PROJECT NO 0049

DES: D&M DRN: KMN/JCA SCALE: HORIZ 1"=50' VERT 1"=5' DRAWING 4 OF 9

SDP-88-255

STRUCTURE		SCHEDULE		TOP ELEV	REMARKS
NO	TYPE	LOCATION	INV IN		
E-1	END SECTION	24 RT STA 1+55	---	251.70	NO GO STD SD SGI
E-2	END SECTION	22 LT STA 1+55	252.76	---	NO GO STD SD SGI

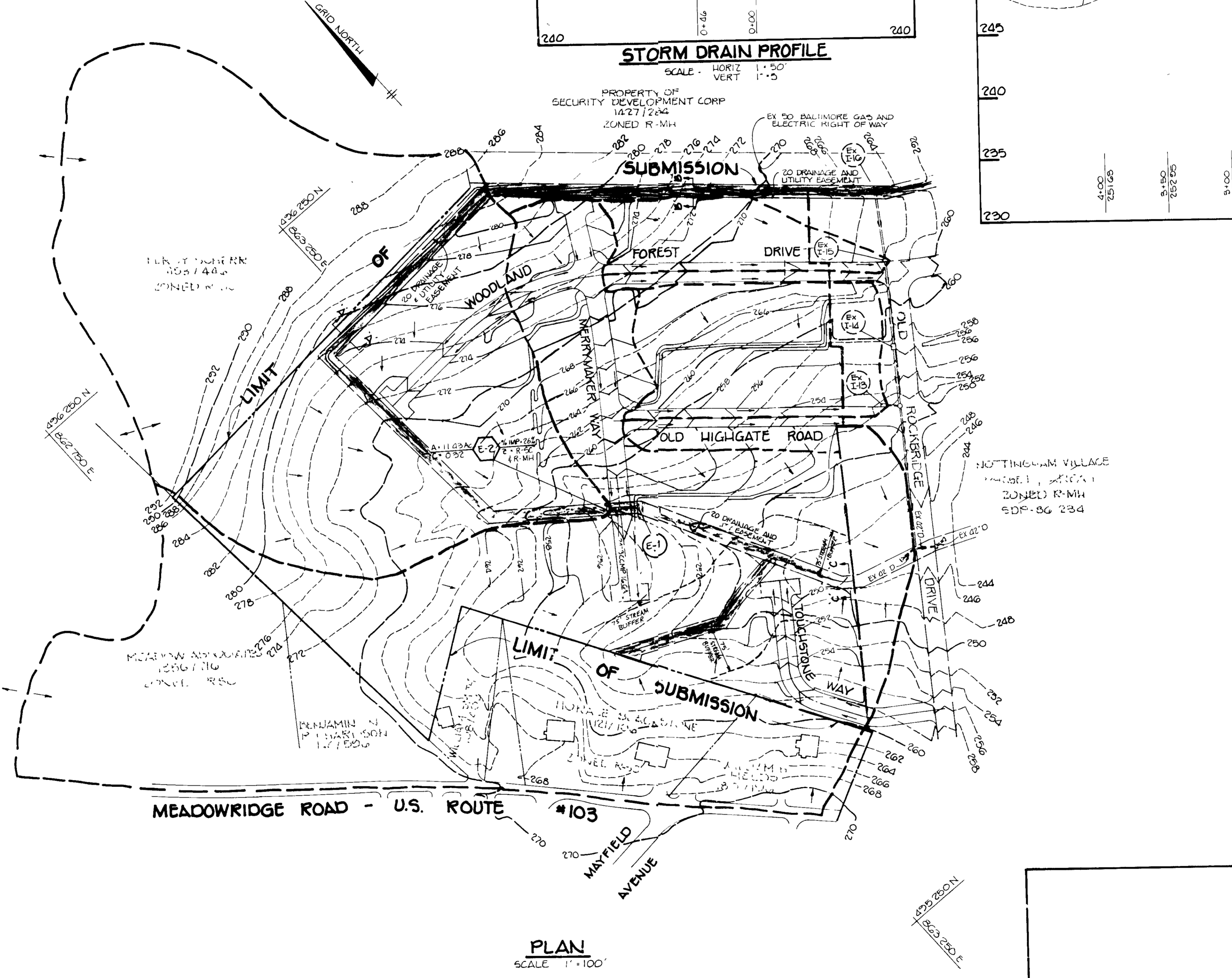
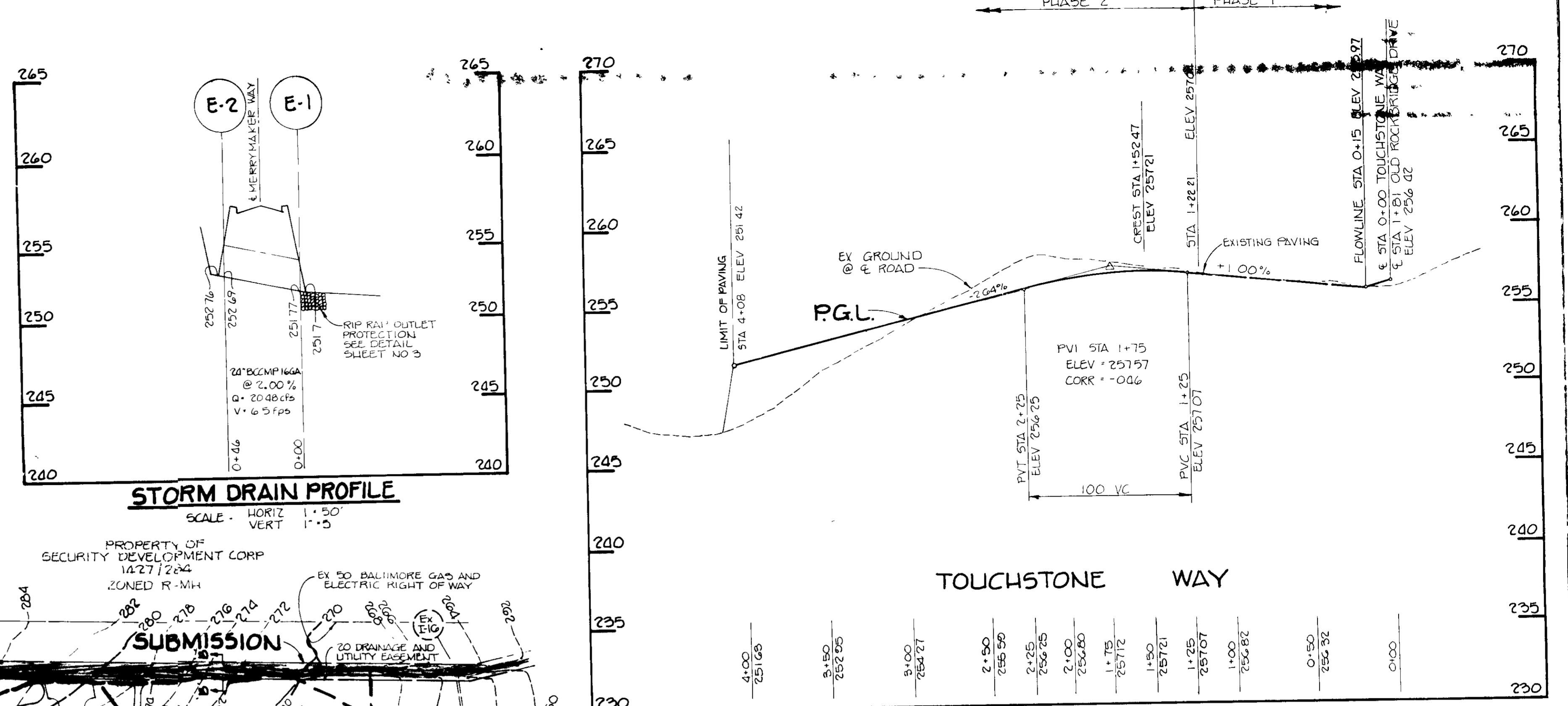

APPROVED FOR PUBLIC WATER AND PUBLIC SEWERAGE SYSTEMS, HOWARD COUNTY HEALTH DEPARTMENT

*Wayne M. Boydman* per *J. E. ...* 10/25/89  
 COUNTY HEALTH OFFICER DATE

APPROVED FOR PUBLIC WATER, PUBLIC SEWERAGE, STORM DRAINAGE SYSTEMS AND PUBLIC ROADS  
 HOWARD COUNTY DEPARTMENT OF PUBLIC WORKS

*James ...* 10/26/89  
 DIRECTOR DATE

*William B. Ray* 10-25-89  
 CHIEF, BUREAU OF ENGINEERING DATE

APPROVED HOWARD COUNTY DEPT OF PLANNING AND ZONING

*Joseph ...* 11/13/89  
 DIRECTOR DATE

*Daniel ...* 11/13/89  
 CHIEF, DIVISION OF COMMUNITY PLANNING AND LAND DEVELOPMENT DATE

NO. DATE REVISION

TRACY, SCHULTE & ASSOCIATES INC.  
 planning - architecture - engineering  
 800 Baltimore National Pike • Lilloret City Maryland 21043 • (301) 463-6105

*Shirley K. Jiles*

OWNER SECURITY DEVELOPMENT CORP  
 8400 BALTIMORE NATIONAL PIKE SUITE 211  
 ELLICOTT CITY, MARYLAND 21043

PROJECT NOTTINGHAM VILLAGE  
 PHASE 2, LOTS 119 THRU 176  
 LOCATION TAX MAP NO 37 L 1427 F 284  
 ZONING MAP NO 37 PARCEL NOS 153 & 201  
 1ST ELECTION DISTRICT  
 HOWARD COUNTY, MARYLAND

DEVELOPER SECURITY DEVELOPMENT CORP  
 8400 BALTIMORE NATIONAL PIKE SUITE 211  
 ELLICOTT CITY, MARYLAND 21043

TITLE DRAINAGE AREA MAP  
 AND ROAD PROFILES  
 (MOBILE HOME PARK)

DATE JUNE 30, 1988 PROJECT NO 0049  
 SEPT 7, 1989

DES D&M DRN KMN SCALE AS SHOWN DRAWING 5 OF 9

11-3-88

SDP-86-255



BY THE DEVELOPER  
 I HEREBY CERTIFY THAT ALL DEVELOPMENT AND CONSTRUCTION WILL BE DONE ACCORDING TO THIS PLAN, AND THAT MY RESPONSIBLE PERSONNEL WILL BE IN CHARGE OF THE CONSTRUCTION PROJECT. I WILL HAVE A CERTIFICATE OF PERFORMANCE AT A DEPARTMENT OF ENVIRONMENTAL RESOURCES APPROVED TRAINING PROGRAM FOR THE CONTROL OF SEDIMENT AND EROSION. I AM AUTHORIZED TO SIGN THIS PROJECT. I ALSO AUTHORIZE REPRESENTATIVE INSPECTION BY THE HOWARD COUNTY CONSERVATION DISTRICT.  
 JAMES M. BOYLAND  
 SECURITY DEVELOPMENT CORPORATION, PROJECTS  
 DATE 6-30-88

BY THE ENGINEER  
 I HEREBY CERTIFY THAT THIS PLAN FOR EROSION AND SEDIMENT CONTROL REPRESENTS A FEASIBLE AND WORKABLE PLAN BASED ON MY PERSONAL KNOWLEDGE OF THE SITE CONDITIONS AND THAT IT WAS PREPARED IN ACCORDANCE WITH THE REQUIREMENTS OF THE HOWARD COUNTY CONSERVATION DISTRICT.  
 JAMES K. JERRY  
 DATE 6-30-88

REVIEWED FOR HOWARD COUNTY CONSERVATION DISTRICT AND MEETS TECHNICAL REQUIREMENTS  
 JAMES M. HEDIN  
 HOWARD COUNTY CONSERVATION SERVICE  
 DATE 9/27/89  
 THIS DEVELOPMENT PLAN IS APPROVED FOR SOIL EROSION AND SEDIMENT CONTROL BY THE HOWARD COUNTY CONSERVATION DISTRICT.  
 JOHN R. ROBERTSON  
 HOWARD COUNTY  
 DATE 9/28/89

SEDIMENT TRAP DATA					
	TRAP NO 1	TRAP NO 2	TRAP NO 3	TRAP NO 4	TRAP NO 5
DRAINAGE AREA	1.37 AC	1.15 AC	3.0 AC	6.95 AC	1.65 AC
VOLUME REQUIRED	2466 Cu.Ft.	2070 Cu.Ft.	5400 Cu.Ft.	12510 Cu.Ft.	2970 Cu.Ft.
VOLUME PROVIDED	2752 Cu.Ft.	2080 Cu.Ft.	5472 Cu.Ft.	12750 Cu.Ft.	3000 Cu.Ft.
BOTTOM ELEV.	244.0	250.0	256.0	247.0	265.0
TOP ELEVATION	248.0	254.0	260.0	252.0	269.0
CREST ELEVATION	247.0	253.0	259.0	251.0	268.0
CLEANOUT ELEV.	245.0	251.0	257.0	248.5	266.0
BOTTOM DIMENSION	64'x16'	60'x12'	64'x36'	IRREGULAR	24'x49'

NOTE: THE WETLAND BUFFERS INDICATED ON THIS PLAN DOES NOT EFFECT THE INITIAL CONSTRUCTION OF RESIDENTIAL UNITS ON A LOT IT DOES PROHIBIT SUBSEQUENT CLEARING, GRADING OR CONSTRUCTION IN THE BUFFER AREA. MAINTENANCE OF RESIDENCES, LANDSCAPING AND UTILITIES IS PERMITTED.

APPROVED FOR PUBLIC WATER AND PUBLIC SEWERAGE SYSTEMS, HOWARD COUNTY HEALTH DEPARTMENT  
 JAMES M. BOYLAND PER 88  
 COUNTY HEALTH OFFICER  
 DATE 10/25/89

APPROVED FOR PUBLIC WATER, PUBLIC SEWERAGE, STORM DRAINAGE SYSTEMS AND PUBLIC ROADS  
 HOWARD COUNTY DEPARTMENT OF PUBLIC WORKS  
 JAMES J. JERRY  
 DIRECTOR  
 DATE 10/25/89  
 J. C. COLEMAN & SONS  
 CHIEF, BUREAU OF ENGINEERING  
 DATE 10-25-89

APPROVED HOWARD COUNTY DEPT OF PLANNING AND ZONING  
 JAMES J. JERRY  
 PLANNING DIRECTOR  
 DATE 11/13/89  
 DANIEL S. BOYLAND  
 CHIEF, DIVISION OF COMMUNITY PLANNING AND LAND DEVELOPMENT  
 DATE 10/25/89

NO.	DATE	REVISION

TRACY, SCHULTE & ASSOCIATES INC.  
 planning • architecture • engineering  
 8480 Baltimore National Pike • Ellicott City, Maryland 21041 • (301) 465-6105  
 JAMES K. JERRY

OWNER  
 SECURITY DEVELOPMENT CORP  
 8480 BALTIMORE NATIONAL PIKE SUITE 211  
 ELICOTT CITY, MARYLAND 21043  
 PROJECT  
**NOTTINGHAM VILLAGE**  
 PHASE 2  
 LOTS 119 THRU 176  
 LOCATION TAX MAP NO 37 L 1427 F 284  
 ZONING MAP NO 37 PARCEL NOS 133 & 201  
 1<sup>ST</sup> ELECTION DISTRICT  
 HOWARD COUNTY MARYLAND  
 DEVELOPER  
 SECURITY DEVELOPMENT CORP  
 8480 BALTIMORE NATIONAL PIKE SUITE 211  
 ELICOTT CITY, MARYLAND 21043  
 TITLE  
**GRADING AND SEDIMENT CONTROL PLAN**  
 (MOBILE HOME PARK)  
 DATE JUNE 30, 1988  
 SEPT 7, 1989  
 PROJECT NO 0049  
 SCALE 1"=50'  
 DRAWING 6 OF 9  
 11-3-88



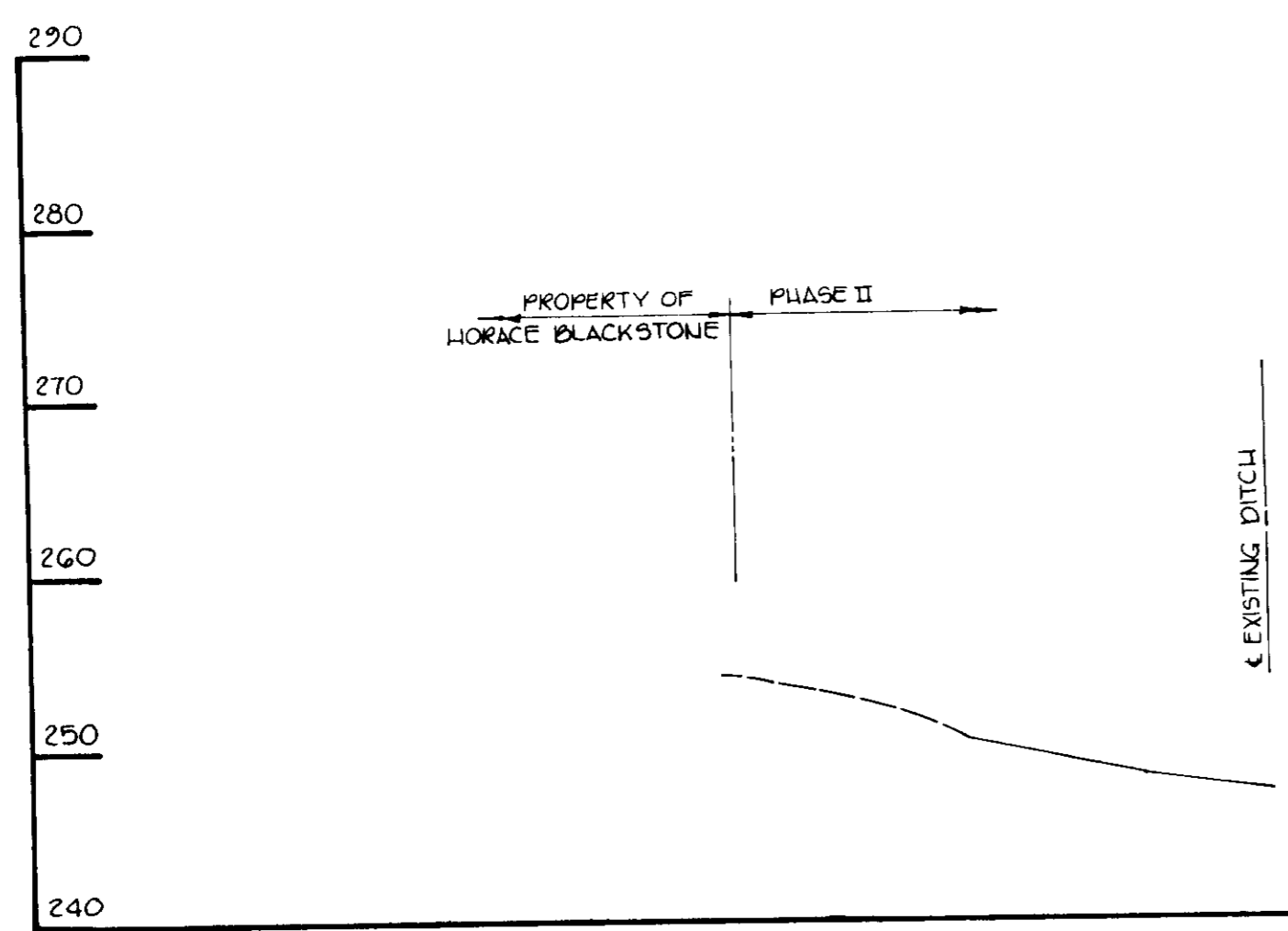

PROFILE ALONG & DRAINAGE SWALE  
SCALE HORIZ 1"=100  
VERT 1"=10

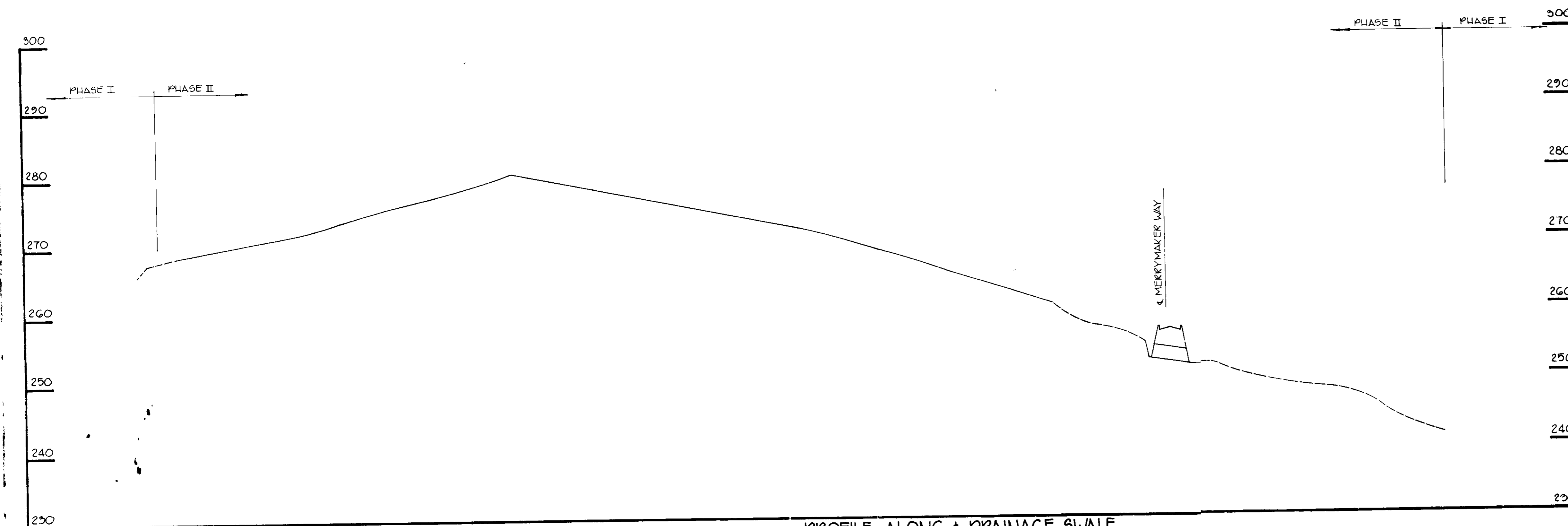
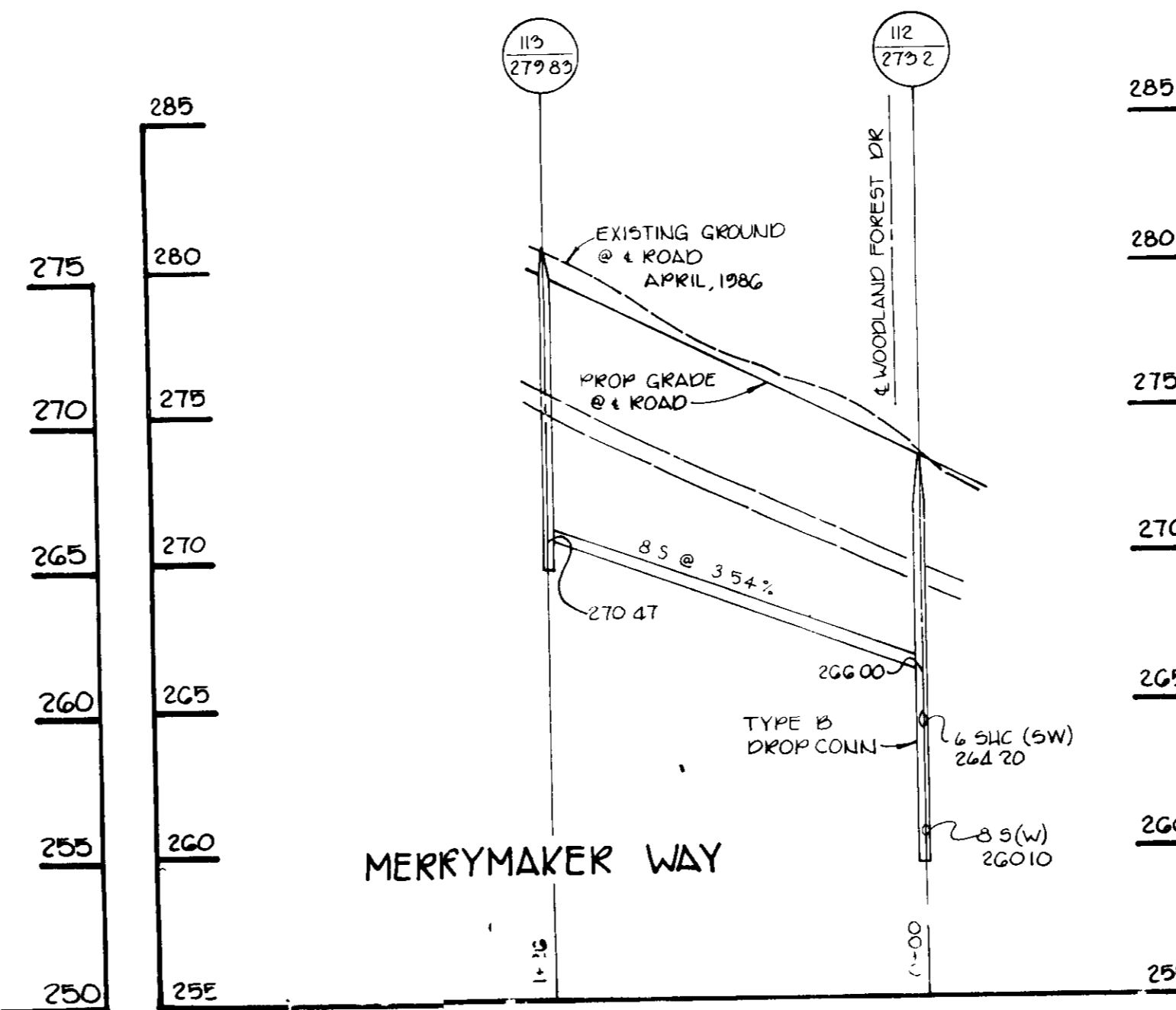
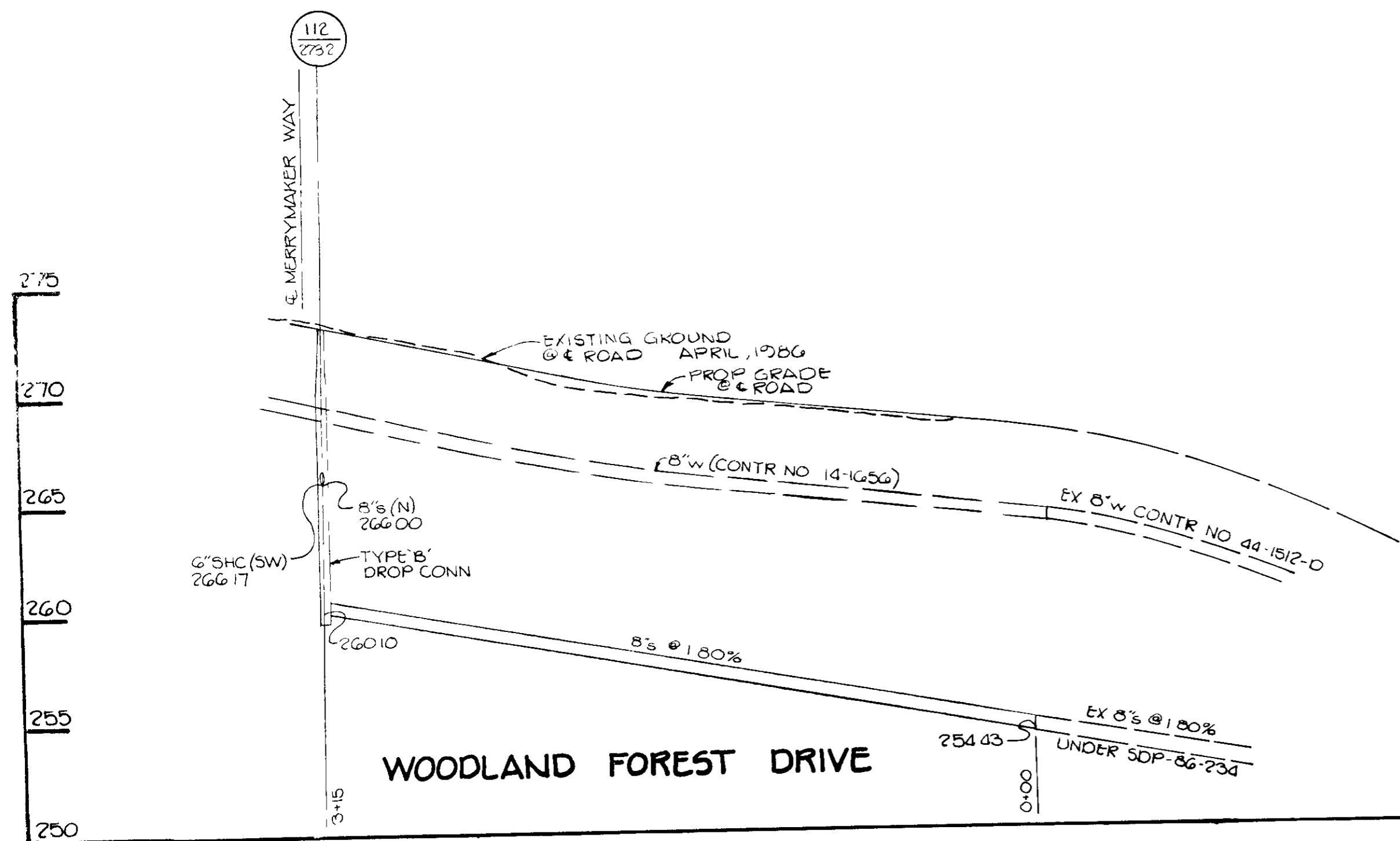
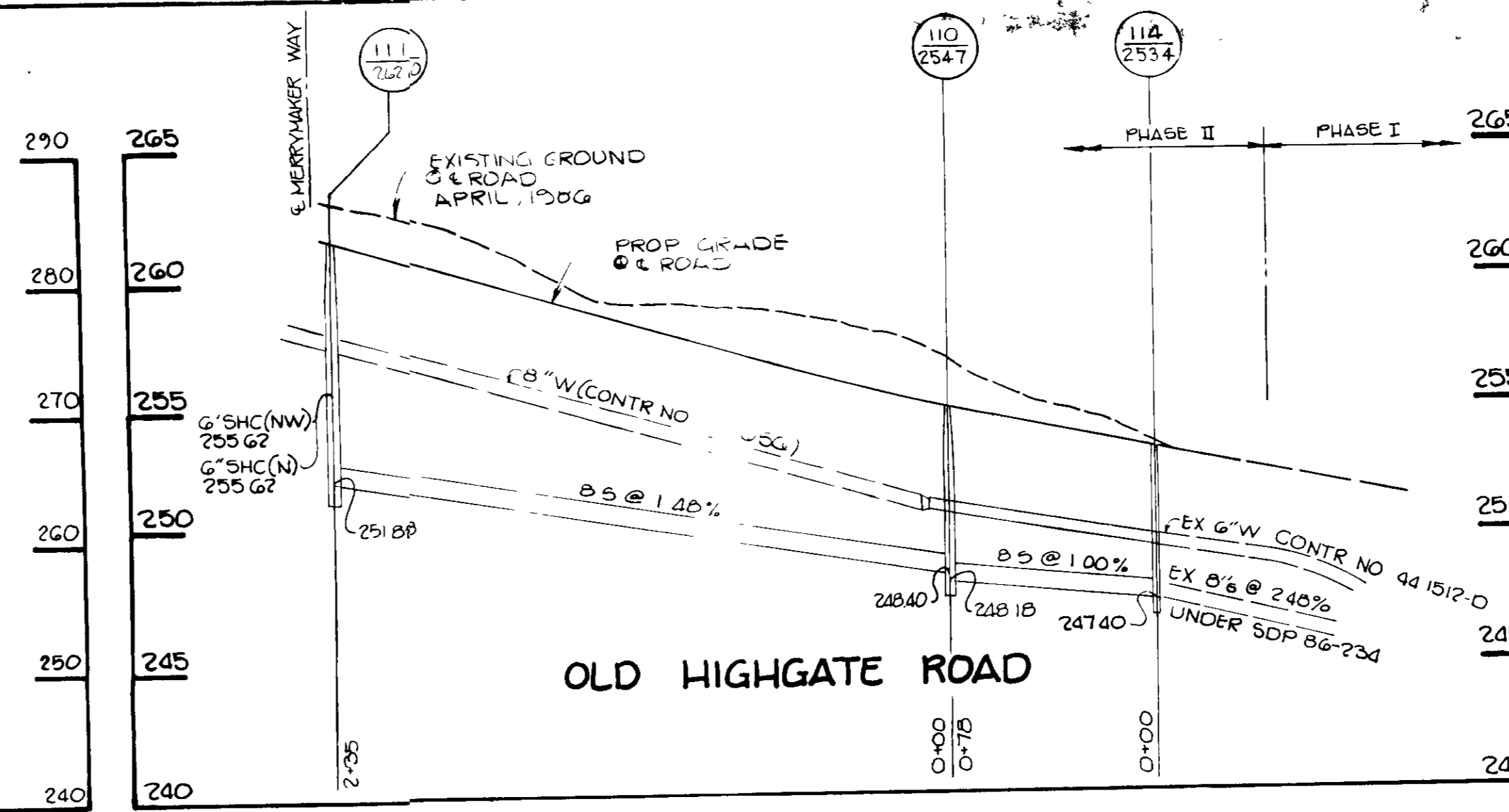

PROFILE ALONG & DRAINAGE SWALE  
SCALE HORIZ 1"=100  
VERT 1"=10

APPROVED FOR PUBLIC WATER AND PUBLIC SEWERAGE SYSTEMS, HOWARD COUNTY HEALTH DEPARTMENT

*Joyce M. Boydland per [Signature]* 10/25/89  
COUNTY HEALTH OFFICER DATE

APPROVED FOR PUBLIC WATER, PUBLIC SEWERAGE, STORM DRAINAGE SYSTEMS AND PUBLIC ROADS

HOWARD COUNTY DEPARTMENT OF PUBLIC WORKS  
OFFICE OF PLANNING AND ZONING

*[Signature]* 10/25/89  
DIRECTOR DATE

*[Signature]* 10-25-89  
CHIEF, BUREAU OF ENGINEERING DATE

APPROVED HOWARD COUNTY DEPT OF PLANNING AND ZONING

*[Signature]* 11/18/89  
DIRECTOR DATE

*[Signature]* [Signature]  
CHIEF, DIVISION OF COMMUNITY PLANNING AND LAND DEVELOPMENT DATE

NO DATE REVISION

FRACY, SCHULTE & ASSOCIATES INC.  
planning • architecture • engineering

8400 Baltimore National Pike • Luthers Bay Maryland 21043 • (410) 281-1100

*[Signature]*

OWNER: SECURITY DEVELOPMENT CORP  
8400 BALTIMORE NATIONAL PIKE SUITE 211  
ELLICOTT CITY, MARYLAND 21043

DEVELOPER: SECURITY DEVELOPMENT CORP  
8400 BALTIMORE NATIONAL PIKE SUITE 211  
ELLICOTT CITY, MARYLAND 21043

PROJECT: NOTTINGHAM VILLAGE  
PHASE 2 LOTS 113 THRU 116  
TAX MAP NO 37 L1427, F 204  
ZONING MAP NO 37 PARCEL NOS 1304201  
1ST ELECTION DISTRICT  
HOWARD COUNTY, MARYLAND

TITLE: PROFILES OF DRAINAGE SWALES  
AND SEWER PROFILES  
(MOBILE HOME PARK)

DATE: JUNE 30 1988  
SEPT 7 1989

DESIGN: DRN JCA

SCALE: HORIZ 1"=50'  
VERT 1"=5'

PROJECT NO: 0049

DR. [ ] OF [ ]

11-3-88

SOP-88-255





PLANT LIST			
SYMBOL	QUAN	NAME	REMARKS
(Circle with dot)	37	ACER RUBRUM RED MAPLE	2 1/2 MIN CAL B & B FULL HEAD
(Sunburst symbol)	21	PINUS STROBUS EASTERN WHITE PINE	5-6' H B & B UNSHARPED
(Circle with dot)	20	PLATANUS ACERIFOLIA LONDON PLANETREE	2 1/2 MIN CAL B & B FULL HEAD

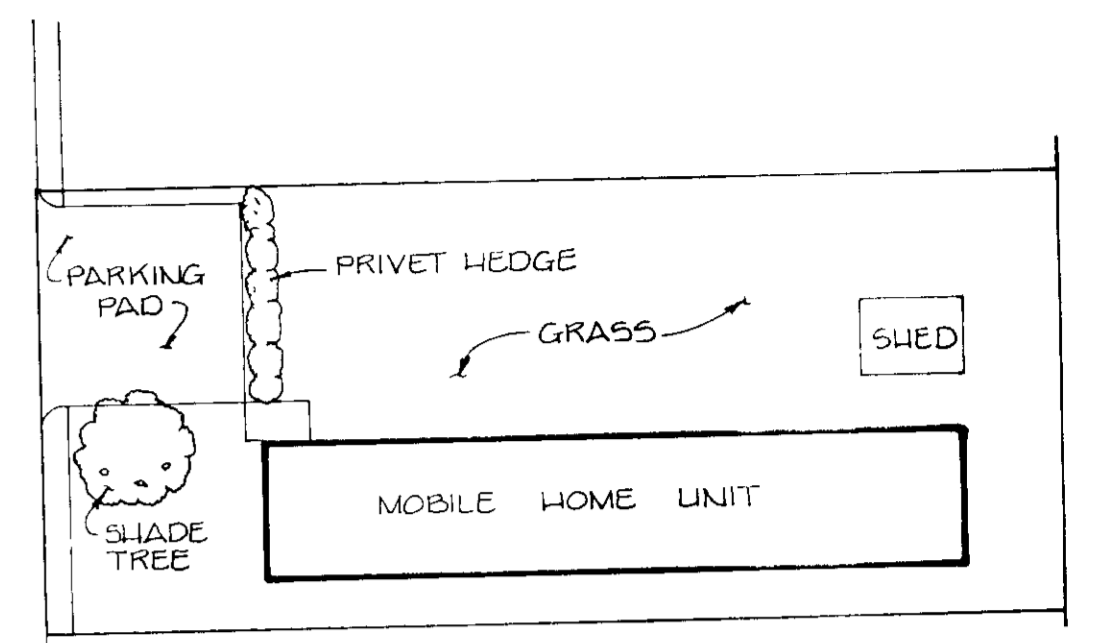

TYPICAL LANDSCAPING PLAN  
SCALE 1" = 20'

APPROVED FOR PUBLIC WORKS AND PUBLIC SERVICE DEPARTMENT	HOWARD COUNTY DEPARTMENT	DATE
<i>Joyce M. Berglund per effm</i>		10/25/89
APPROVED FOR PUBLIC WATER, PUBLIC SEWERAGE, STORM DRAINAGE SYSTEM, AND ROADS	HOWARD COUNTY DEPARTMENT OF PUBLIC WORKS	DATE
<i>James P. ...</i>	DIRECTOR	10/25/89
APPROVED FOR HOWARD COUNTY DEPT. OF PLANNING AND LAND DEVELOPMENT		DATE
<i>Joseph ...</i>	DIRECTOR	11/13/89
<i>David S. ...</i>	CHIEF, DIVISION OF COMMUNITY PLANNING AND LAND DEVELOPMENT	DATE
<i>David S. ...</i>		10/13/89
GRACE SCHULTZ & ASSOCIATES INC. planning • architecture • engineering 8400 BALTIMORE NATIONAL PIKE SUITE 211 ELLICOTT CITY, MARYLAND 21043		
OWNER	PROJECT	
SECURITY DEVELOPMENT CORP. 8400 BALTIMORE NATIONAL PIKE SUITE 211 ELLICOTT CITY, MARYLAND 21043	NOTTINGHAM VILLAGE PHASE 2 119 THRU 176	
DEVELOPER	TITLE	
SECURITY DEVELOPMENT CORP. 8400 BALTIMORE NATIONAL PIKE SUITE 211 ELLICOTT CITY, MARYLAND 21043	PLANTING PLAN (MOBILE HOME PARK)	
DESIGNER	DATE	
DRN: JPT/SAB	JUNE 30, 1988 SEPT 7, 1989	NO 0049
SCALE	DATE	
1" = 20'	11-3-88	9 OF 9