

- TENNIS COURT REPAIR - CONSTRUCTION SEQUENCE:**
- ALL CRACKS SHALL BE CLEANED OF ALL SOIL, DEBRIS AND MISCELLANEOUS LOOSE MATERIAL.
 - FILL ALL CRACKS AND EXISTING UNDERLYING VOIDS WITH PATCHING MIX (CHEVRON OR APPROVED EQUAL) ACCORDING TO MANUFACTURER'S RECOMMENDATIONS.
 - SPRAY ALL REPAIR AREAS WITH EITHER PRE-EMERGENT HERBICIDE CHIPS BONSTAR G AT A RATE 4 LB. PER 100 SQUARE FEET OR SURFLAN LIQUID AT A RATE 4 QUARTS PER ACRE OR 3.00" PER 1000 SQUARE FEET (OR APPROVED EQUAL).
 - REMOVE LOOSE DIRT ON OILY MATERIALS AND CLEAN ENTIRE SURFACE OF TENNIS COURT. PLACE A ONE INCH THICK (MAKE PROPER ALLOWANCE FOR THE EXISTING DEPRESSIONS) BITUMINOUS CONCRETE LEVELING COURSE (BAND ST OR ST) OVER THE ENTIRE TENNIS COURT SURFACE IN ACCORDANCE WITH MSHA REQUIREMENTS. CROSS SLOPE TO BE 1.0%.
 - PLACE A 1 1/2" THICK LAYER OF BITUMINOUS CONCRETE SURFACE COURSE (BAND ST) OVER THE ENTIRE COURT IN ACCORDANCE WITH MSHA REQUIREMENTS.
 - APPLY MULTIPLE APPLICATIONS OF COLOR COAT (CHEVRON OR APPROVED EQUAL) FOR TWO-TONE DESIGN FOR FOUR (4) COURTS ACCORDING TO MANUFACTURER'S RECOMMENDATIONS. CENTER COURTS ON EXISTING NET POSTS LOCATIONS. COLORS OF TWO-TONE DESIGN SHALL BE AS DIRECTED BY OWNER.
 - STRIP WHITE PLAYING LINES 2" WIDE FOR FOUR (4) COURTS (CHEVRON OR APPROVED EQUAL) ACCORDING TO MANUFACTURER'S RECOMMENDATIONS.

- GENERAL NOTES:**
- ELEVATIONS OF EXISTING TENNIS AND BASKETBALL COURTS ARE BASED ON SURVEY PREPARED BY ASSOCIATED ENGINEERS, INC., SILVER SPRING, MARYLAND IN JULY, 1986. BENCHMARK USED: FLOOR ELEVATION OF SCHOOL. ELEV. 336.00.
 - TENNIS COURT PAVING REPAIR RECOMMENDATIONS ARE BASED ON REPORT DATED 1/15/87 AND PREPARED BY ATEC ASSOCIATES, INC., COLUMBIA, MD.
 - CONTRACTOR SHALL VISIT THE JOB SITE AND INFORM HIMSELF FULLY AS TO THE EXTENT OF WORK AND CONDITIONS UNDER WHICH WORK IS TO BE DONE. FAILURE TO INSPECT SITE WILL NOT BELIEVE SUCCESSFUL EITHER OF HIS OBLIGATION TO FURNISH MATERIAL AND LABOR NECESSARY TO CARRY OUT PROVISIONS OF CONTRACT DOCUMENTS AND TO COMPLETE THE WORK.
 - CONTRACTOR SHALL REFERENCE EXISTING STRIPING PRIOR TO STARTING OF CLEAN-UP OPERATIONS.
 - ALL DISTURBED, UNPAVED AREAS SHALL BE TOPSOILED, FERTILIZED, LIMED AND SEEDED. TOPSOIL DEPTH SHALL BE MINIMUM 4 INCHES COMPACTED.
 - ALL SEDIMENT AND EROSION CONTROL FEATURES SHALL BE INSTALLED IN ACCORDANCE WITH THE "MARYLAND STANDARDS AND SPECIFICATIONS FOR SOIL EROSION AND SEDIMENT CONTROL," 1985 EDITION.
 - ALL CONSTRUCTION AND MATERIALS SHALL BE IN ACCORDANCE WITH THE HOWARD COUNTY ROAD CONSTRUCTION CODE AND REGULATIONS AND THE APPLICABLE PROVISIONS OF THE MARYLAND STATE HIGHWAYS ADMINISTRATION STANDARD SPECIFICATIONS FOR CONSTRUCTION AND MATERIALS.
 - A PREFIX OF 3 MAY HAVE TO BE ADDED TO ALL GRADES.
 - ALL UNSUITABLE AND EXCESS FILL MATERIAL SHALL BE CONTRACTOR'S RESPONSIBILITY. LOCATION OF DISPOSAL AREA SHALL BE THE CONTRACTOR'S RESPONSIBILITY.
 - CONTACT "MISS UTILITY" AT LEAST 48 HOURS PRIOR TO COMMENCING CONSTRUCTION.
 - LOCATION OF EXISTING UTILITIES IS BASED ON AVAILABLE RECORDS AND WAS FIELD-CHECKED WHERE POSSIBLE. CONTRACTOR MUST DIG TEST PITS BY HAND AT UTILITY CROSSINGS AND CONNECTION POINTS TO VERIFY EXACT LOCATION AND DEPTHS WELL IN ADVANCE OF CONSTRUCTION. IF CONNECTIONS ARE NOT AS SHOWN OR IF CONFLICT IS ANTICIPATED, OWNER SHALL BE NOTIFIED BEFORE PROCEEDING WITH TRENCHING.
 - CONTRACTOR SHALL CLEAN UP THE WORK AREA AT THE COMPLETION OF THE PROJECT. ALL AREAS DISTURBED DURING THE CONSTRUCTION ACTIVITY SHALL BE REPAIRED TO THE SATISFACTION OF THE OWNER'S REPRESENTATIVE.
 - THE CONTRACTOR SHALL CONTACT THE CONSTRUCTION INSPECTION DIVISION OF THE DEPARTMENT OF PUBLIC WORKS 24 HOURS IN ADVANCE OF START OF WORK. TELEPHONE 301-792-2630.

- SEDIMENT CONTROL NOTES:**
- A MINIMUM OF 24 HOURS NOTICE MUST BE GIVEN TO THE HOWARD COUNTY OFFICE OF INSPECTION AND PERMITS PRIOR TO THE START OF ANY CONSTRUCTION (922-2437).
 - ALL VEGETATIVE AND STRUCTURAL PRACTICES ARE TO BE INSTALLED ACCORDING TO THE PROVISIONS OF THIS PLAN AND ARE TO BE IN CONFORMANCE WITH THE 1983 "MARYLAND STANDARDS AND SPECIFICATIONS FOR SOIL EROSION AND SEDIMENT CONTROL."
 - FOLLOWING INITIAL SOIL DISTURBANCE OR REDISTURBANCE, PERMANENT OR TEMPORARY STABILIZATION SHALL BE COMPLETED WITHIN: A) 7 CALENDAR DAYS FOR ALL PERIMETER SEDIMENT CONTROL STRUCTURES, DICES, PERIMETER SLOPES AND ALL SLOPES GREATER THAN 2:1; B) 14 DAYS AS TO ALL OTHER DISTURBED OR GRADED AREAS ON THE PROJECT SITE. (A); N/A)
 - ALL SEDIMENT TRAPS/BASINS SHOWN MUST BE FENCED AND WARNING SIGNS POSTED AROUND THEIR PERIMETER IN ACCORDANCE WITH VOL. 1, CHAPTER 12 OF THE HOWARD COUNTY DESIGN MANUAL, "STORM DRAINAGE." (N/A)
 - ALL DISTURBED AREAS MUST BE STABILIZED WITHIN THE TIME PERIOD SPECIFIED ABOVE IN ACCORDANCE WITH THE 1983 "MARYLAND STANDARDS AND SPECIFICATIONS FOR SOIL EROSION AND SEDIMENT CONTROL" FOR PERMANENT SEEDINGS (SEC. 51) SOD (SEC. 54); TEMPORARY SEEDING (SEC. 50) AND MULCHING (SEC. 52), AND AS SPECIFIED HEREIN:
 - TOPSOIL SHALL MEET ALL APPLICABLE REQUIREMENTS OF THE SPECIFICATIONS FOR MATERIALS, HIGHWAYS, BRIDGES AND INCIDENTAL STRUCTURES OF THE MARYLAND STATE HIGHWAYS ADMINISTRATION. TOPSOIL SHALL BE 4 INCHES THICK (COMPACTED).
 - LIME SHALL BE SPREAD AT A RATE OF ONE (1) TON PER ACRE.
 - FERTILIZER 5-10-10 OR EQUIVALENT SHALL BE APPLIED AT A RATE OF 1700 LB. PER ACRE. BOTH LIME AND FERTILIZER SHALL BE UNIFORMLY APPLIED TO THE LOOSEST TOPSOIL AND SHALL BE BROADCAST PRIOR TO SEEDING.
 - SEED SHALL BE "KENTUCKY 31" TALL FESCUE APPLIED AT A RATE OF 2 LB. PER 1,000 SQ. FT. STRAW MULCH SHALL BE UNIFORMLY APPLIED AT THE RATE OF 10 TO 20 LB. PER 1,000 SQ. FT.
 - SOD SHALL BE A CLASS OF TURF GRASS SOD AND SHALL BE MARYLAND STATE CERTIFIED.
 TEMPORARY STABILIZATION WITH MULCH ALONE CAN ONLY BE DONE WHEN RECOMMENDED SEEDING DATES DO NOT ALLOW FOR PROPER GERMINATION AND ESTABLISHMENT OF GRASSES.
 - ALL SEDIMENT CONTROL STRUCTURES ARE TO REMAIN IN PLACE AND ARE TO BE MAINTAINED IN OPERATIVE CONDITION UNTIL PERMISSION FOR THEIR REMOVAL HAS BEEN OBTAINED FROM THE HOWARD COUNTY SEDIMENT CONTROL INSPECTOR.
 - SITE ANALYSIS:**
 - ZONING: NEWTOWN - OPEN SPACE, FDP - 15B
 - TOTAL AREA OF SITE: 32.6 ACRES
 - AREA DISTURBED: 0.11 ACRES
 - AREA TO BE PAVED AND REPAIRED: 1360 SQ. FT. OR 0.03 ACRE
 - AREA TO BE VEGETATIVELY STABILIZED: 0.08 ACRE
 - TOTAL CUT: N/A. ONLY PAVING REPAIR AND UTILITY WORK TOTAL FILL.
 - ANY SEDIMENT CONTROL PRACTICE WHICH IS DISTURBED BY GRADING ACTIVITY FOR PLACEMENT OF UTILITIES MUST BE REPAIRED ON THE SAME DAY OF DISTURBANCE.
 - ADDITIONAL SEDIMENT CONTROL MUST BE PROVIDED, IF DEEMED NECESSARY BY THE HOWARD COUNTY DPW SEDIMENT CONTROL INSPECTOR.

- SEDIMENT CONTROL SEQUENCE:**
- OBTAIN CONSTRUCTION PERMIT.
 - INSTALL SILT FENCE.
 - DEMOLISH EXISTING PAVING.
 - INSTALL STORM DRAINAGE PIPES AND STRUCTURES.
 - REMOVE EXISTING RIPRAP AND REBUILD OUTFALL PROTECTION.
 - CONSTRUCT CONCRETE CURB AND SWALE.
 - INSTALL INLET PROTECTIONS.
 - STABILIZE DISTURBED AREAS.
 - REPAIR AND RESURFACE TENNIS COURTS.
 - REMOVE SEDIMENT CONTROL FEATURES AND STABILIZE REMAINING DISTURBED AREAS.
 - CLEAN UP SITE AND BEGIN MAINTENANCE.

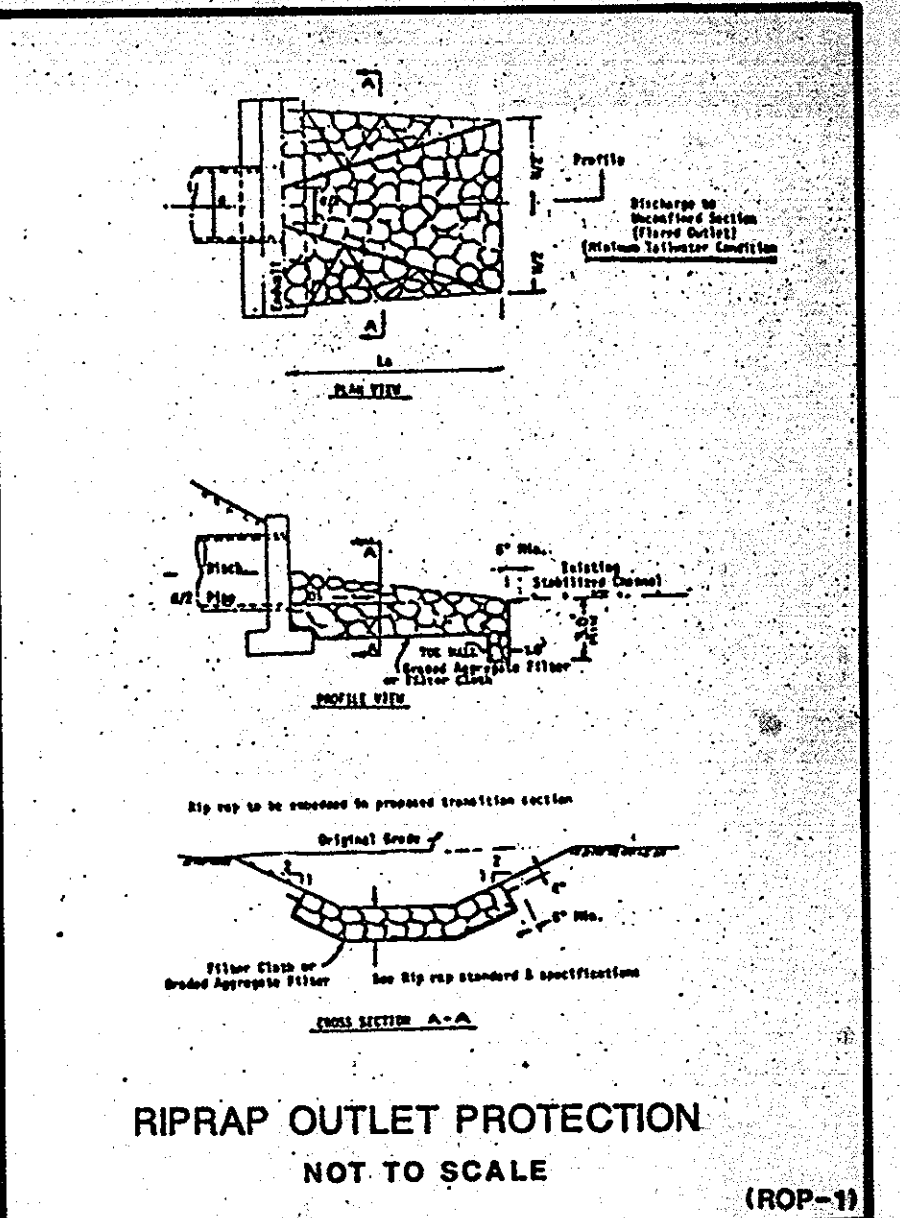

STRUCTURE TABLE					
NO.	TYPE	TOP ELEV.	INV. IN	INV. OUT	REMARKS
I-1	S INLET W/RETICULAR GRATE AND FRAME	333.6	329.28	329.00	DPW STD SD-4-22
I-2	S INLET W/RETICULAR GRATE AND FRAME	334.2	329.85	329.60	DPW STD SD-4-22
I-3	S INLET W/RETICULAR GRATE AND FRAME	334.2	330.78	330.53	DPW STD SD-4-22
I-4	S INLET W/RETICULAR GRATE AND FRAME	334.2	---	331.40	DPW STD SD-4-22
MH1	EXISTING MANHOLE	---	329.58(S) 330.00(S) REC.	328.13	CONNECT NEW PIPE AND REPAIR STRUCTURE AS NECESSARY

Reticular Grate for Type "S" Inlet DPW-4.93

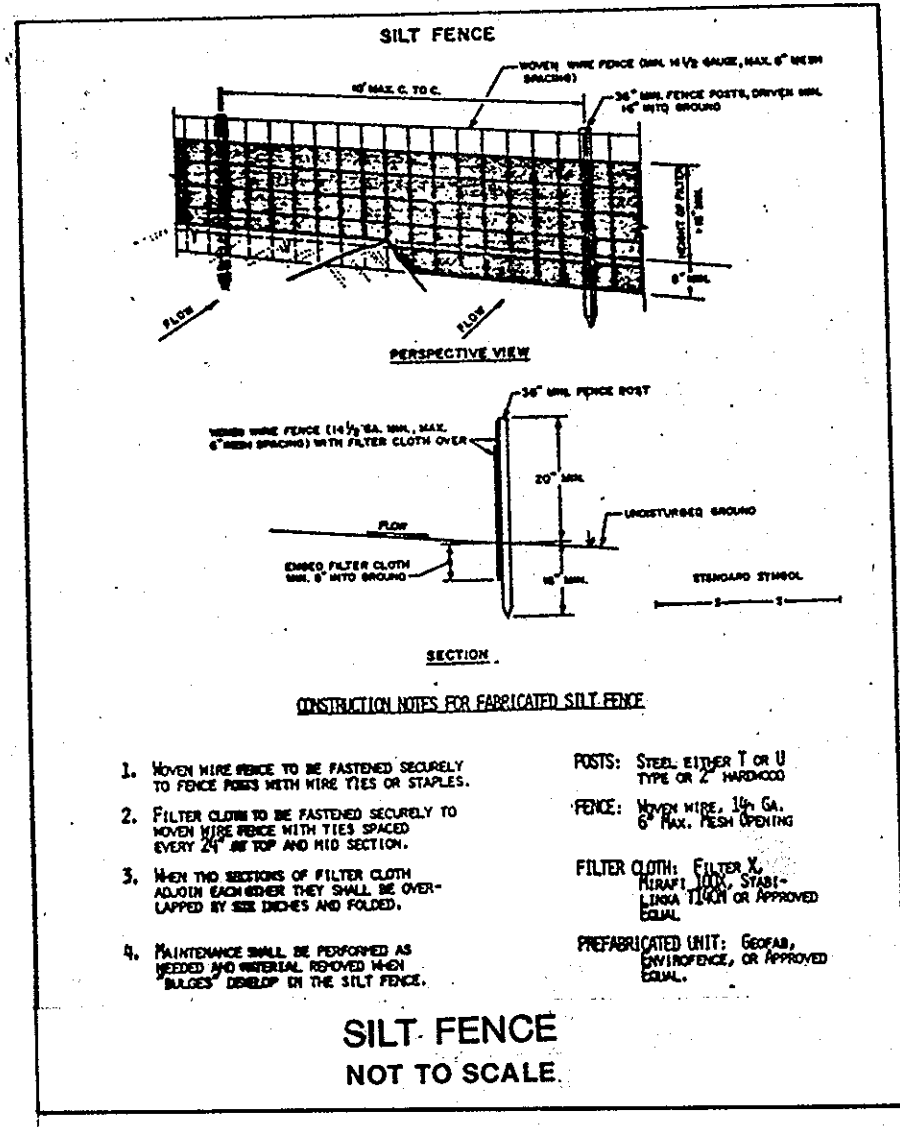

- CONSTRUCTION NOTES FOR FABRICATED SILT FENCE:**
- WOOD PILES MUST BE SET AT LEAST 10 FEET APART TO PREVENT THE FENCE FROM COLLAPSE.
 - FILTER CLOTH TO BE FASTENED SECURELY TO PILES WITH 1/2" GALV. WIRE. CHECK EVERY 20' TO TOP AND MID SECTION.
 - WOOD PILES MUST BE SET AT LEAST 10 FEET APART TO PREVENT THE FENCE FROM COLLAPSE.
 - MAINTENANCE SHALL BE PERFORMED AS REQUIRED TO PREVENT FENCE FROM COLLAPSE.

APPROVED: FOR PUBLIC WATER AND PUBLIC SEWERAGE SYSTEMS, HOWARD COUNTY HEALTH DEPARTMENT
 COUNTY HEALTH OFFICER: [Signature] DATE: 4/1/87
 APPROVED: HOWARD COUNTY OFFICE OF PLANNING & ZONING
 DIRECTOR: [Signature] DATE: 4-6-87
 CHIEF DIVISION OF LAND DEVELOPMENT AND ZONING ADMINISTRATION
 APPROVED: FOR PUBLIC WATER AND PUBLIC SEWERAGE, STORM DRAINAGE SYSTEMS AND PUBLIC ROADS HOWARD COUNTY DEPARTMENT OF PUBLIC WORKS
 DIRECTOR: [Signature] DATE: 4-2-87
 CHIEF BUREAU OF ENGINEERING: [Signature] DATE: 4-2-87

APPROVED
 DIVISION OF LAND DEVELOPMENT & ZONING ADMINISTRATION
 HOWARD COUNTY, MARYLAND
 DATE: 3-13-87
 [Signature]



SDP-87-147C

ADDRESS CHART	
OPEN SPACE LOT NUMBER	STREET ADDRESS
1	8800 GULFORD ROAD

SUBDIVISION NAME (HAMMOND HIGH)	SECT./AREA	LOT #	OPEN SPACE
VILLAGE OF KINGS CONTRIVANCE	2/1	42	6062

PLAT BOOK 30	LOCK 4	ZONE	TAX/ZONE PRP	ELEC. DIST.	CENSUS TR.
PAGE 25	8	N.T.-O.S.	42	6	6062

WATER CODE	SEWER CODE
E 16	5290000

STORM DRAIN ADDITION TO SDP - 75-13

PROJECT NAME	ASSOCIATED ENGINEERS, INC.	JOB NO.
HAMMOND HIGH SCHOOL HOWARD COUNTY BOARD OF EDUCATION	8555 SIXTEENTH STREET SILVER SPRING, MARYLAND 20910 TEL. 301-589-7311	2857

DRAWING TITLE	SCALE	DATE	REVISED
TENNIS COURT REPAIR & DRAINAGE IMPROVEMENTS	1"=30'	2-6-87	3/23/87

6th Election District	Howard Co., Md.	SHEET NO.
		SP-1

1 OF 2

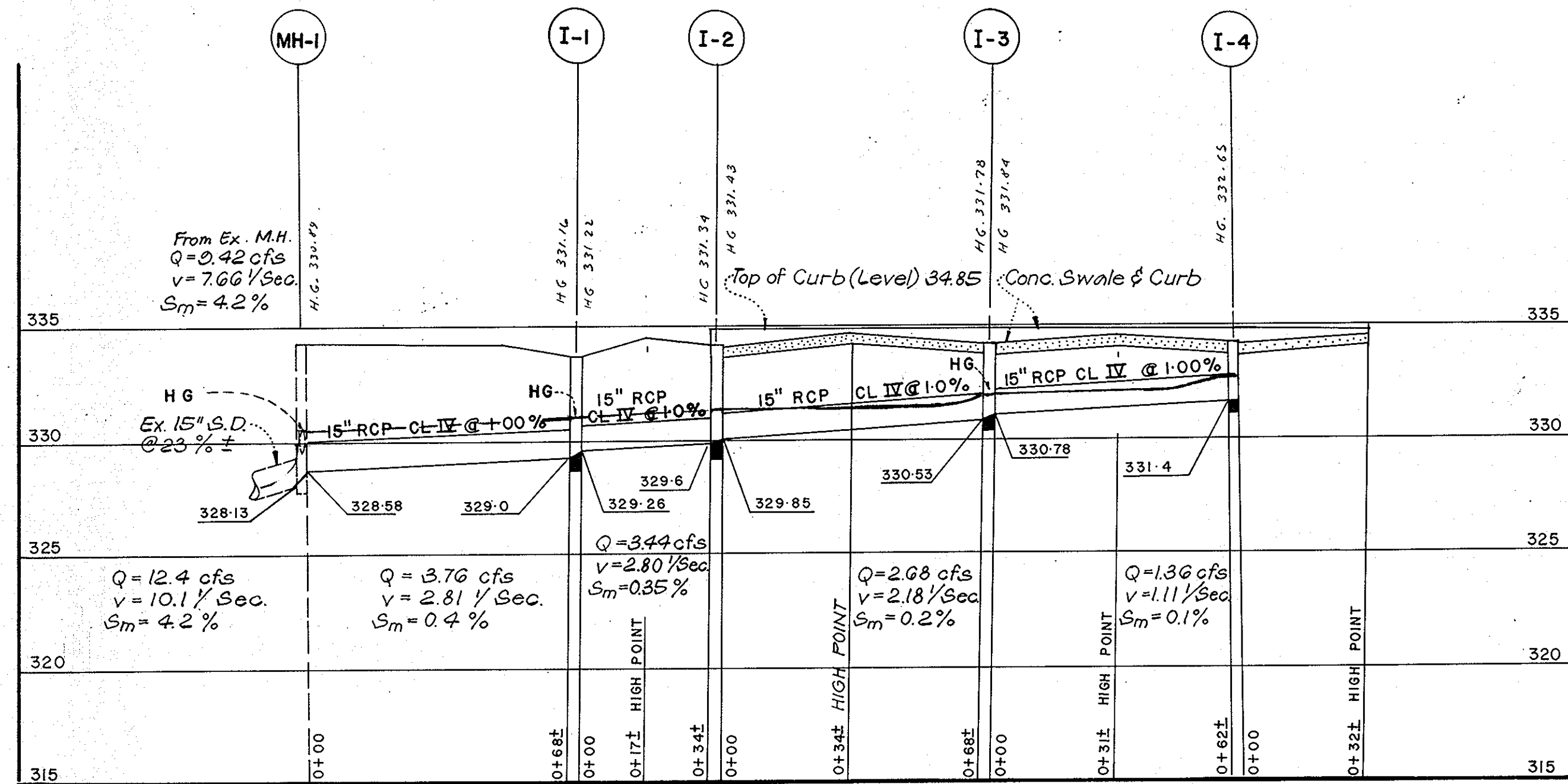

STORM DRAIN PROFILE
SCALE: Hor. 1"=30' Ver. 1"=5'

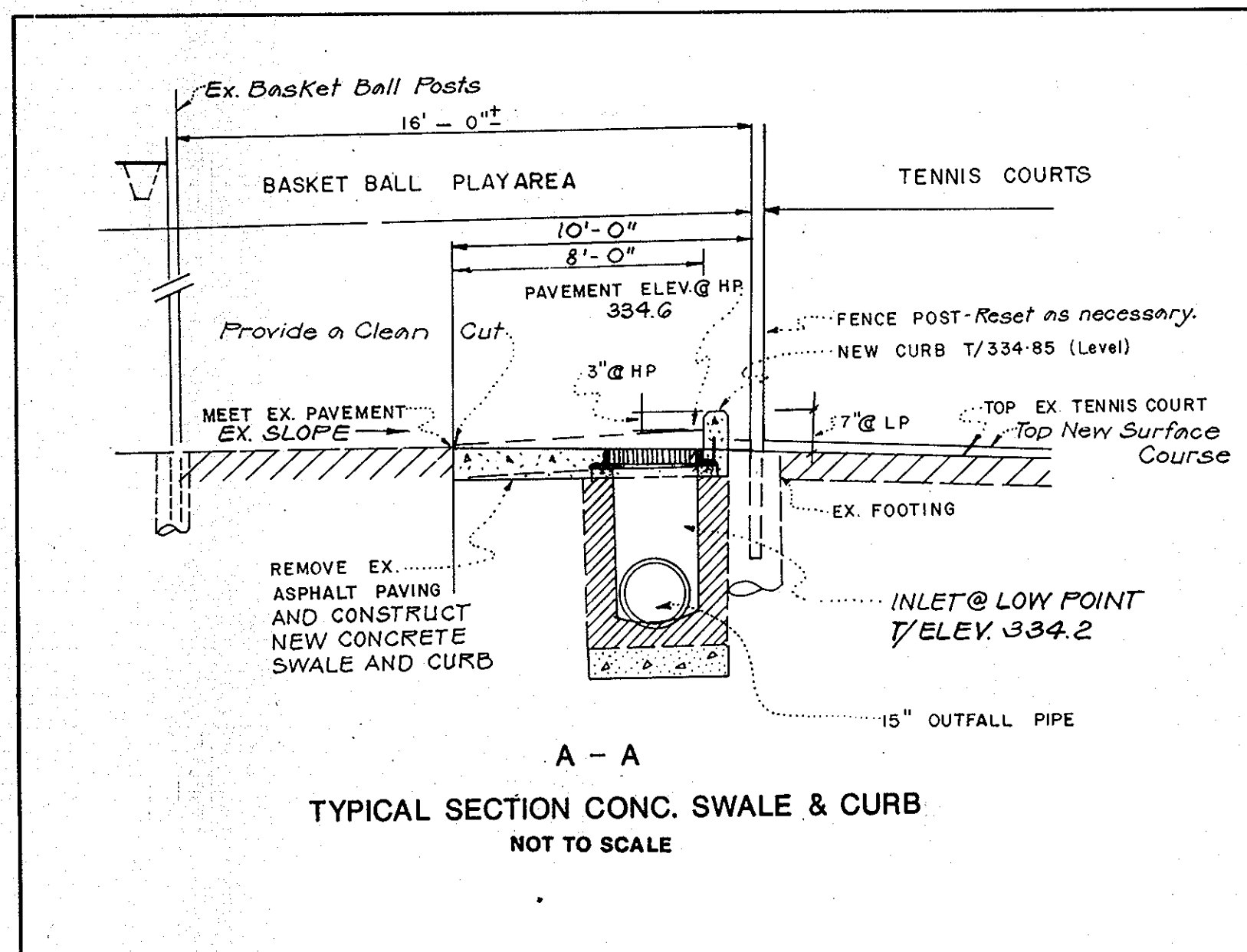

A - A
TYPICAL SECTION CONC. SWALE & CURB
NOT TO SCALE

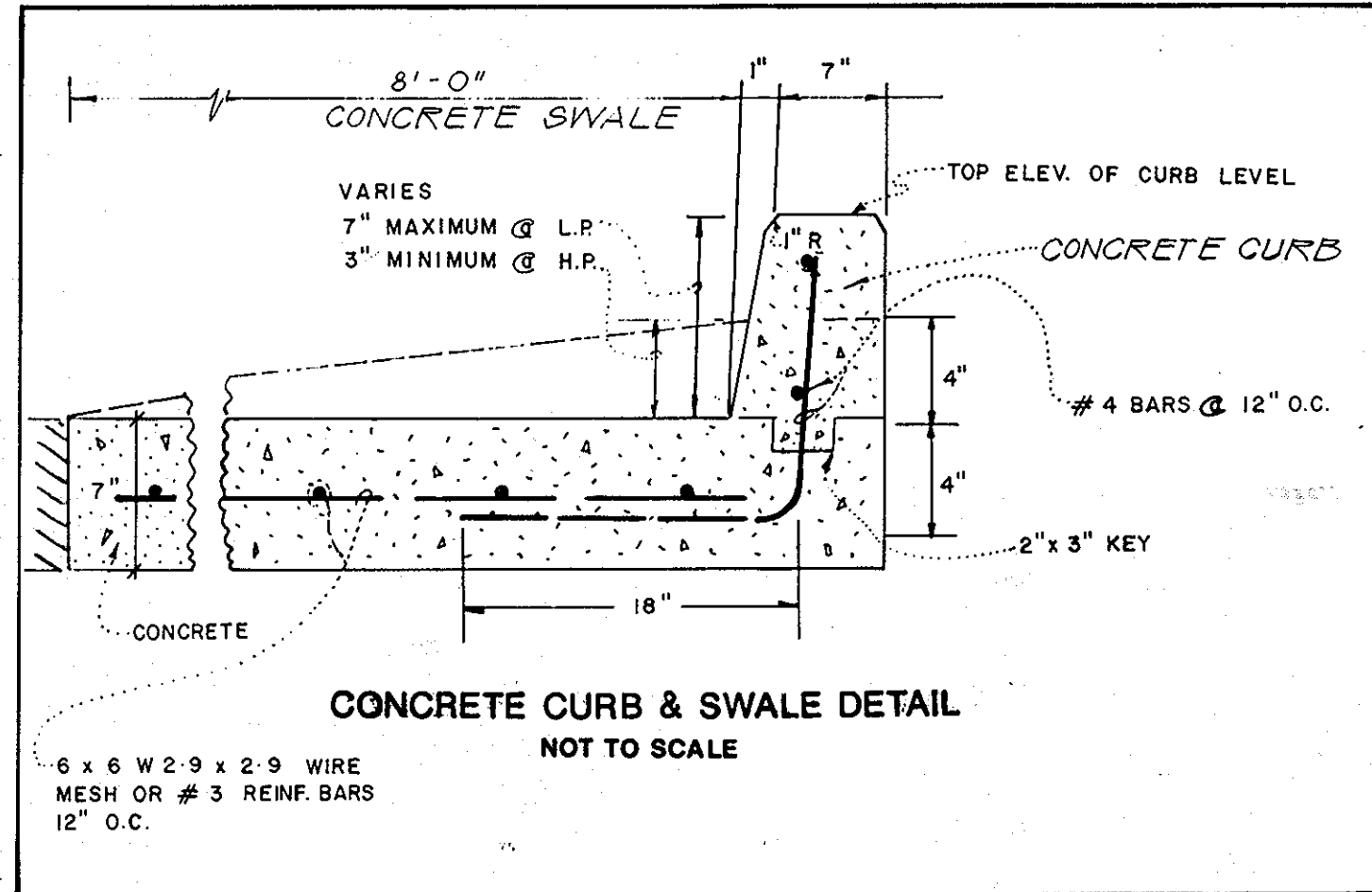

CONCRETE CURB & SWALE DETAIL
NOT TO SCALE

() Reviewed for HOWARD S.C.D. and meet Technical Requirements
Date 3/21/87
Stephen L. Fisher
Howard S.C.D.

() THIS DEVELOPMENT PLAN IS APPROVED FOR SOIL EROSION AND SEDIMENT CONTROL BY THE HOWARD SOIL CONSERVATION DISTRICT
Date 3/21/87
Stephen L. Fisher
Howard S.C.D.

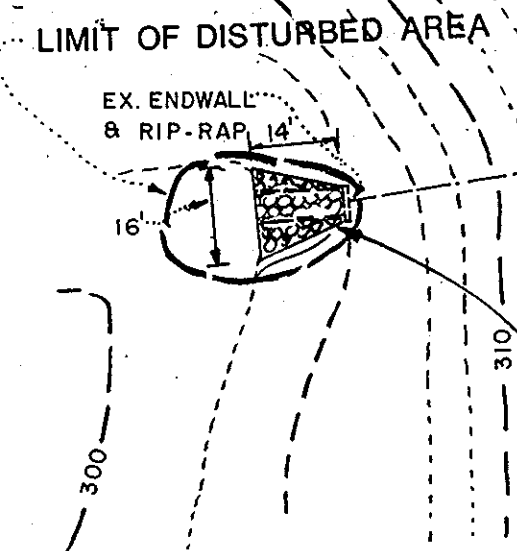

PERMANENT NEW RIPRAP OUTLET PROTECTION (ROP-1) REMOVE EXISTING RIPRAP; REGRADE AND PLACE FILTER FABRIC; CONSTRUCT NEW RIPRAP: STONE SIZE 6\"/>

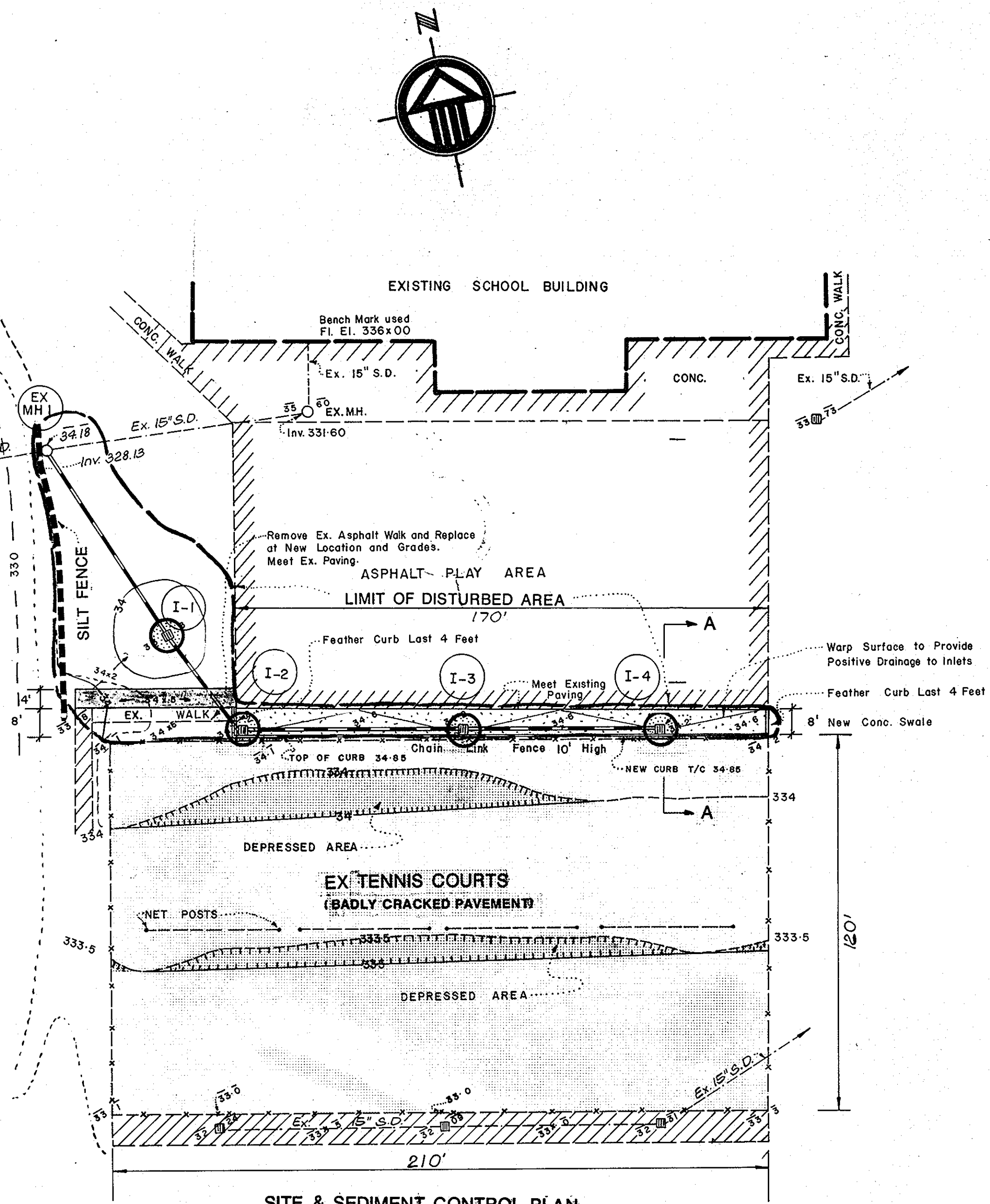

SITE & SEDIMENT CONTROL PLAN
SCALE: 1"=30'

APPROVED
DIVISION OF LAND DEVELOPMENT & ZONING ADMINISTRATION
HOWARD COUNTY, MARYLAND
DATE 3-13-87

DEVELOPER'S CERTIFICATION
I CERTIFY THAT ALL DEVELOPMENT AND CONSTRUCTION WILL BE DONE ACCORDING TO THIS PLAN, AND THAT ANY RESPONSIBLE PERSONNEL INVOLVED IN THE CONSTRUCTION PROJECT WILL HAVE A CERTIFICATE OF ATTENDANCE AT A DEPARTMENT OF NATURAL RESOURCES APPROVED TRAINING PROGRAM FOR THE CONTROL OF SEDIMENT AND EROSION BEFORE BEGINNING THE PROJECT. I ALSO AUTHORIZE PERIODIC ON-SITE INSPECTION BY THE HOWARD SOIL CONSERVATION DISTRICT.
Signature: [Signature]
Date: 3-24-87

DESIGN CERTIFICATION
I CERTIFY THAT THIS PLAN FOR EROSION AND SEDIMENT CONTROL REPRESENTS A PRACTICAL AND WORKABLE PLAN BASED ON MY PERSONAL KNOWLEDGE OF THE SITE CONDITIONS AND THAT IT WAS PREPARED IN ACCORDANCE WITH THE REQUIREMENTS OF THE HOWARD SOIL CONSERVATION DISTRICT.
Signature: Eva [Signature]
Date: 3/24/87

LEGEND

EXISTING SPOT GRADES	35.00
DESIGN GRADES	34.6
EXISTING CONTOURS	33.4
DESIGN CONTOURS	34, 33.5
EXISTING PAVING TO REMAIN	[Hatched Pattern]
EXISTING PAVING TO BE REPAIRED AND RESURFACED	[Dotted Pattern]
NEW CONCRETE SWALE AND CURB	[Stippled Pattern]
NEW ASPHALT WALK	[Cross-hatched Pattern]
EXISTING STORM DRAIN	[Dashed Line]
NEW STORM DRAIN PIPE AND STRUCTURE	[Solid Line]
TEMPORARY SILT FENCE	[Dashed Line with Circles]
TEMPORARY YARD INLET PROTECTION	[Circle]
LIMIT OF DISTURBED AREA	[Dashed Line]

APPROVED: FOR PUBLIC WATER AND PUBLIC SEWERAGE SYSTEMS, HOWARD COUNTY HEALTH DEPARTMENT
Signature: [Signature]
Date: 4/3/87

APPROVED: HOWARD COUNTY OFFICE OF PLANNING & ZONING
Signature: [Signature]
Date: 4-6-87

APPROVED: FOR PUBLIC WATER AND PUBLIC SEWERAGE, STORM DRAINAGE SYSTEMS AND PUBLIC ROADS, HOWARD COUNTY DEPARTMENT OF PUBLIC WORKS
Signature: [Signature]
Date: 4-2-87

SDP-87-147c

PROJECT NAME HAMMOND HIGH SCHOOL HOWARD COUNTY BOARD OF EDUCATION 6TH ELECTION DISTRICT, HOWARD CO., MD.	ASSOCIATED ENGINEERS, INC. 8555 SIXTEENTH STREET SILVER SPRING, MARYLAND 20910 TEL. 301-589-7311	JOB NO. 2857
DRAWING TITLE TENNIS COURT DRAINAGE IMPROVEMENT AND REPAIR	SCALE AS SHOWN DATE 2-6-87 REVISED 3/23/87	SHEET NO. SP-2

STORM DRAIN ADDITION TO SDP - 75-13

SDP-87-147c

