

LEGEND

1. Contour Interval
2. Existing Contour
3. Proposed Contour
4. Spot Elevation
5. Direction of Drainage
6. Proposed Storm Drain
7. Proposed Sewer Main
8. Existing Trees to be Saved

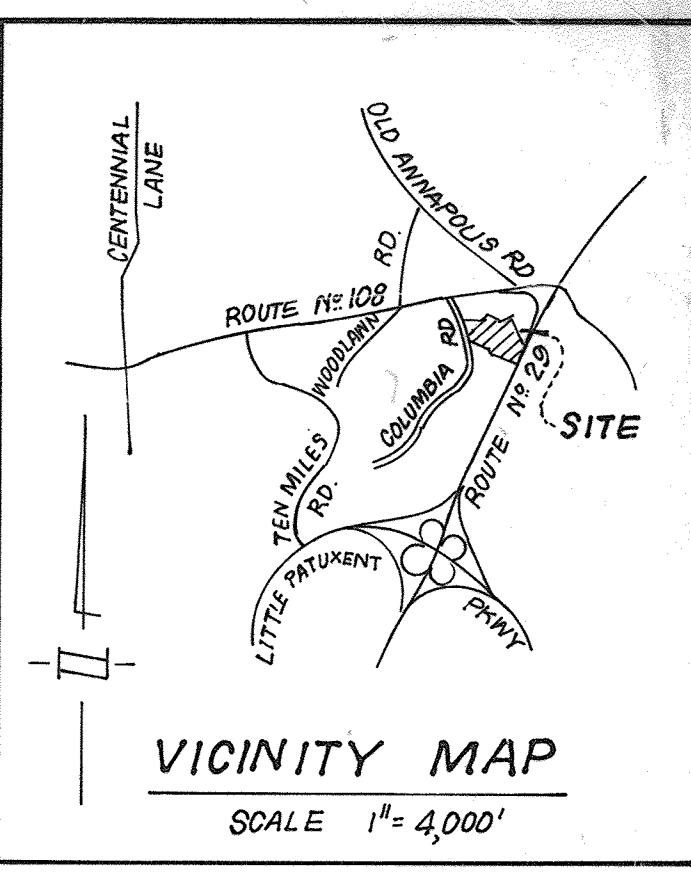
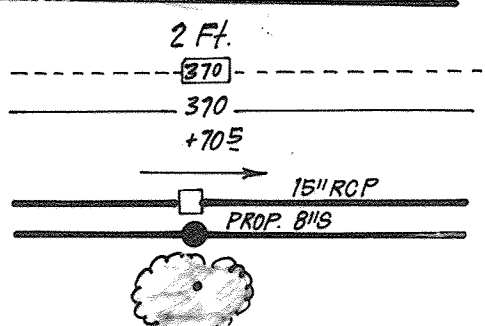

GENERAL NOTES

1. All materials and construction to be in accordance with Howard County Road Construction Code and Specifications.
2. This plan is covered by Final Development Plan Phase 191-A.
3. Any damage to county owned rights-of-way to be corrected at the developer's expense.
4. Installation of traffic control devices shall be in accordance with the latest edition of the "Manual of Uniform Traffic Control."
5. Topography was compiled from actual field survey.
6. The area shown is located on Tax Map 30 Parcel 224.
7. All drive ways and parking to be privately owned and maintained.
8. All coordinates are based on Howard County Geodetic Control Survey traverse which is based on the Maryland State Plane Coordinate System.
9. Trench bedding for storm drainage shall be in accordance with Howard County Std. SD G2.01.
10. Information concerning underground utilities was obtained from available records, but the contractor must determine the exact location by digging test pits, by hand, at all utility crossings, well in advance of construction.
11. The contractor or developer shall contact the Construction Inspection, Survey Division 24 hrs. in advance of work 982-2417 or 192-7272.
12. All downspout drains shall be handled by one of these methods:
 - A. Downspout to splash blocks and discharged to ground having good percolation.
 - B. Downspout in front of units piped to curb.
 - C. Downspout connected to storm drain.
13. The developer agrees to work with the Dept. of Licenses & Inspection to resolve any problems caused by roof water discharge.
14. Handicap Parking Details shall be in accordance with the "Maryland Building Code for the Handicapped," Sect. 5.01-7.05 and details sh. 2.
15. All setbacks requirements and criteria as shown in F.D.P. 191-A.
16. Storm Water Management Provided by previously approved plans F-86-26 & F-86-226.
17. A minimum of 288 parking spaces including carports must be available for resident parking use at all times.
18. ON APRIL 4, 2019, UNDER ASSESSMENT, THE HOWARD COUNTY PLANNING BOARD APPROVED A REDUCTION IN THE SIDE YARD SETBACK FOR A PORTION OF BUILDING 'H' FROM THE REQUIRED 40 FOOT SIDE YARD SETBACK TO 37.5'. SEE DETAIL THIS SHEET FOR WINDOW OR DOOR CRITERION & NOT MORE THAN 10 FT. WITH CAN ENCROACH NO MORE THAN 4 FT. INTO SETBACK.

SITE ANALYSIS

1. Zoning: New Town Apartments (FDP-Phase 191-A)
2. Area of Site: 11.85 Acres
3. Number of Units Permitted: 182
4. Number of Units Proposed: 191 ± 1 OFFICE
5. Number of Parking Spaces Required: (1.5/Unit) = 288
6. Number of Parking Spaces Proposed: (inc. 8 HC) 301 (Includes 35 Carports)
7. Building Coverage Permitted: 30%
8. Building Coverage Proposed: (±1.09 Ac) 9.05%



FOR REV. # 1 ONLY
5/3/19

15-3-19 ADJUSTED SIDE SETBACK PER HO. CO. PLANNING BOARD. FSH

APPROVED: FOR PUBLIC WATER AND PUBLIC SEWERAGE SYSTEMS, HOWARD COUNTY HEALTH DEPARTMENT

APPROVED: HOWARD COUNTY OFFICE OF PLANNING AND ZONING

APPROVED: FOR PUBLIC WATER AND PUBLIC SEWERAGE, STORM DRAINAGE SYSTEMS AND PUBLIC ROADS, HOWARD COUNTY DEPARTMENT OF PUBLIC WORKS

APPROVED
PLANNING BOARD
OF HOWARD COUNTY

DATE: 11-12-86

UNIT TYPE / AREA SCHEDULE				
BLDG. #	1 B.R.	2 B.R.	3 B.R.	TOTALS
A	5+1 OFFICE	10+2 HC	5+1 HC	23+1 OFF
B	6	14	8	28
C	6	14	8	28
D	6	14	8	28
E	6	10	4	20
F	16+2 HC	-	-	5+1 HC 24
G	5+1 HC	9+1 HC	-	4 20
H	6	10	4	20
TOTALS	59+1 OFFICE	84	38	10 181+1 OFF.

NOTE: HANDICAP UNITS (HC) PROVIDED.

Reviewed for... HOWARD COUNTY... S.C.D.

Name and meets Technical Requirements

Signature: [Signature] Date: 1-9-87

U.S. Soil Conservation Service

THIS DEVELOPMENT PLAN IS APPROVED FOR SOIL EROSION AND SEDIMENT CONTROL BY THE HOWARD SOIL CONSERVATION DISTRICT.

Signature: [Signature] Date: 1/9/87

DEVELOPER'S/BUILDER'S CERTIFICATE

"I/we certify that all development and construction will be done according to this plan of development and plan for erosion and sediment control and that all responsible personnel involved in the construction project will have a Certificate of Attendance at a Dept. of Natural Resources Approved Training Program for the Control of Sediment and Erosion before beginning the project. I also authorize periodic on-site inspection by the Howard Soil Conservation District or their authorized agents, as are deemed necessary."

Signature: [Signature] Date: 1-7-87

ENGINEER'S CERTIFICATE

I hereby certify that this plan for Erosion and Sediment Control represents a practical and workable plan based on my personal knowledge of the site conditions and that it was prepared in accordance with the requirements of the Howard Soil Conservation District.

Signature: [Signature] Date: 1-8-87

BLDG. #	STREET ADDRESS
A	5029/5025 Columbia Road
B	5021/5017 " "
C	5013/5009 " "
D	5005/5001 " "
E	4997/4993 " "
F	4989/4985 " "
G	4481/4977 " "
H	4979/4969 " "

OWNER: The Howard Research & Development Corporation 10215 Little Patuxent Pkwy Columbia, Md. 21044	SUBDIVISION NAME: COLUMBIA Village of Dorsey's Search PLAT # 6235 BLOCK # 9+10 ZONE APT.	SECT./AREA 3/1 TAX/ZONE MAP/ELEC. DIST. 30 5	LOT/PARCEL # PARCEL A-2 CENSUS TR. 6052.02
WATER CODE E-01	SEWER CODE 630000		

CLARK · FINEFROCK & SACKETT
ENGINEERS · PLANNERS · SURVEYORS

11315 LOCKWOOD DRIVE • SILVER SPRING, MARYLAND 20904 • (301) 593-3400

DESIGNED: WHT
DRAWN: R/W, JTR
CHECKED: JLS, WHT
DATE: 10-7-86

SITE DEVELOPMENT PLAN
PARCEL A-2

COLUMBIA
VILLAGE OF DORSEY'S SEARCH
SECTION 3
ELECTION DISTRICT
HOWARD COUNTY, MARYLAND

FOR: SHELTER DEVELOPMENT CORP.
Suite 500 Park Charles Bldg. 210 N. Charles St.
Baltimore, Maryland 21201

SCALE: 1" = 30'
DRAWING: 10-F-9
JOB NO.: 85-139
FILE NO.: 85-139 X

SDP-87-76c

S.B. RAMP
ROUTE No 108
 MSHA PLAT # 34870 & 34871

U.S. ROUTE 29 S.B.L.

Reviewed for... Howard... SGB
 Name and meets Technical Requirements
 Signature Date
 U.S. Soil Conservation Service
 THIS DEVELOPMENT PLAN IS APPROVED
 FOR SOIL EROSION AND SEDIMENT
 CONTROL BY THE HOWARD SOIL
 CONSERVATION DISTRICT.
 Approved 1/15/87
 DATE

APPROVED
 PLANNING BOARD
 OF HOWARD COUNTY
 DATE 11-12-86

APPROVED: FOR PUBLIC WATER AND PUBLIC SEWERAGE SYSTEMS,
 HOWARD COUNTY HEALTH DEPARTMENT
 COUNTY HEALTH OFFICER 1-14-87
 APPROVED: HOWARD COUNTY OFFICE OF PLANNING & ZONING
 PLANNING DIRECTOR 1-14-87
 CHIEF DIVISION OF LAND DEVELOPMENT
 AND ZONING ADMINISTRATION 1-14-87
 APPROVED: FOR PUBLIC WATER AND PUBLIC SEWERAGE,
 STORM DRAINAGE SYSTEMS AND PUBLIC ROADS
 HOWARD COUNTY DEPARTMENT OF PUBLIC WORKS
 DIRECTOR 1-13-87
 CHIEF BUREAU OF ENGINEERING 1-13-87

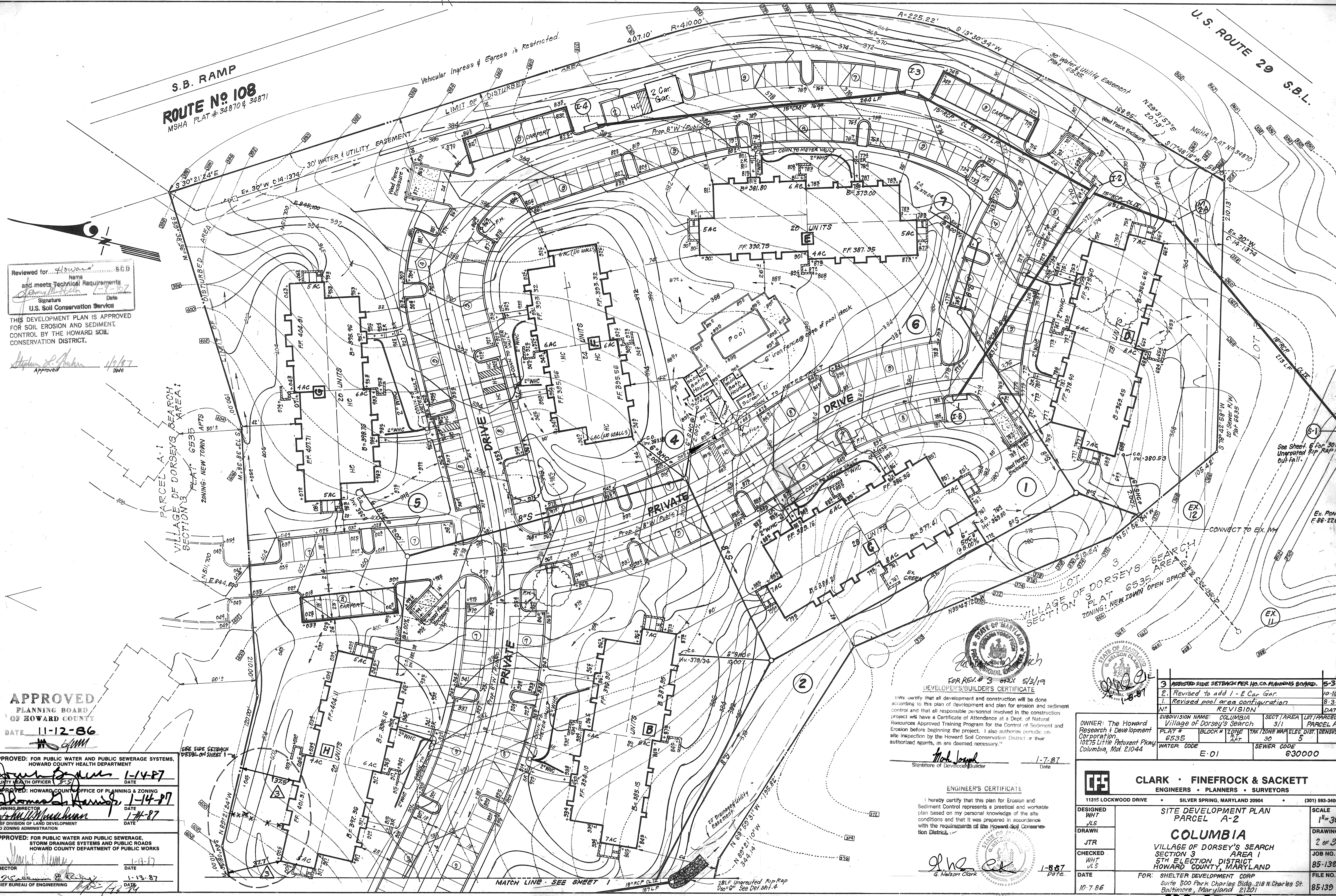

FOR REV. 3 ONLY 5/2/87
DEVELOPER'S/BUILDER'S CERTIFICATE
 I/we certify that all development and construction will be done according to this plan of development and plan for erosion and sediment control and that all responsible personnel involved in the construction project will have a Certificate of Attendance at a Dept. of Natural Resources Approved Training Program for the Control of Sediment and Erosion before beginning the project. I also authorize periodic on-site inspection by the Howard Soil Conservation District or their authorized agents, as are deemed necessary.
 Signature of Developer/Builder: *Mark Joseph*
 Date: 1-7-87

ENGINEER'S CERTIFICATE
 I hereby certify that this plan for Erosion and Sediment Control represents a practical and workable plan based on my personal knowledge of the site conditions and that it was prepared in accordance with the requirements of the Howard Soil Conservation District.
 Signature of Engineer: *g. Nelson Clark*
 Date: 1-8-87

3	ADJUSTED SIDE SETBACK PER HO. CO. PLANNING BOARD.	5-3-19
2	Revised to add 1-2 Car Gar.	10-16-86
1	Revised pool area configuration	8-3-87
REVISION		
NO.	REVISION	DATE
SUBDIVISION NAME: COLUMBIA		
Village of Dorsey's Search		
SECT./AREA	LOT/PARCEL #	
3/1	PARCEL A-2	
OWNER: The Howard Research & Development Corporation		
10275 Little Patuxent Pkwy Columbia, Md. 21044		
WATER CODE	E-01	SEWER CODE 630000

CLARK • FINEFROCK & SACKETT
 ENGINEERS • PLANNERS • SURVEYORS
 11315 LOCKWOOD DRIVE • SILVER SPRING, MARYLAND 20904 • (301) 593-3400

DESIGNED	WHT	SCALE	1"=30'
DRAWN	JLS	DRAWING	2 of 9
CHECKED	JTR	JOB NO.	85-139
DATE	10-7-86	FILE NO.	85-139 X

SITE DEVELOPMENT PLAN
PARCEL A-2
COLUMBIA
 VILLAGE OF DORSEY'S SEARCH
 SECTION 3 AREA 1
 5TH ELECTION DISTRICT
 HOWARD COUNTY, MARYLAND
 FOR: SHELTER DEVELOPMENT CORP
 Suite 500 Park Charles Bldg. 218 N. Charles St.
 Baltimore, Maryland 21201

SDP-87-76

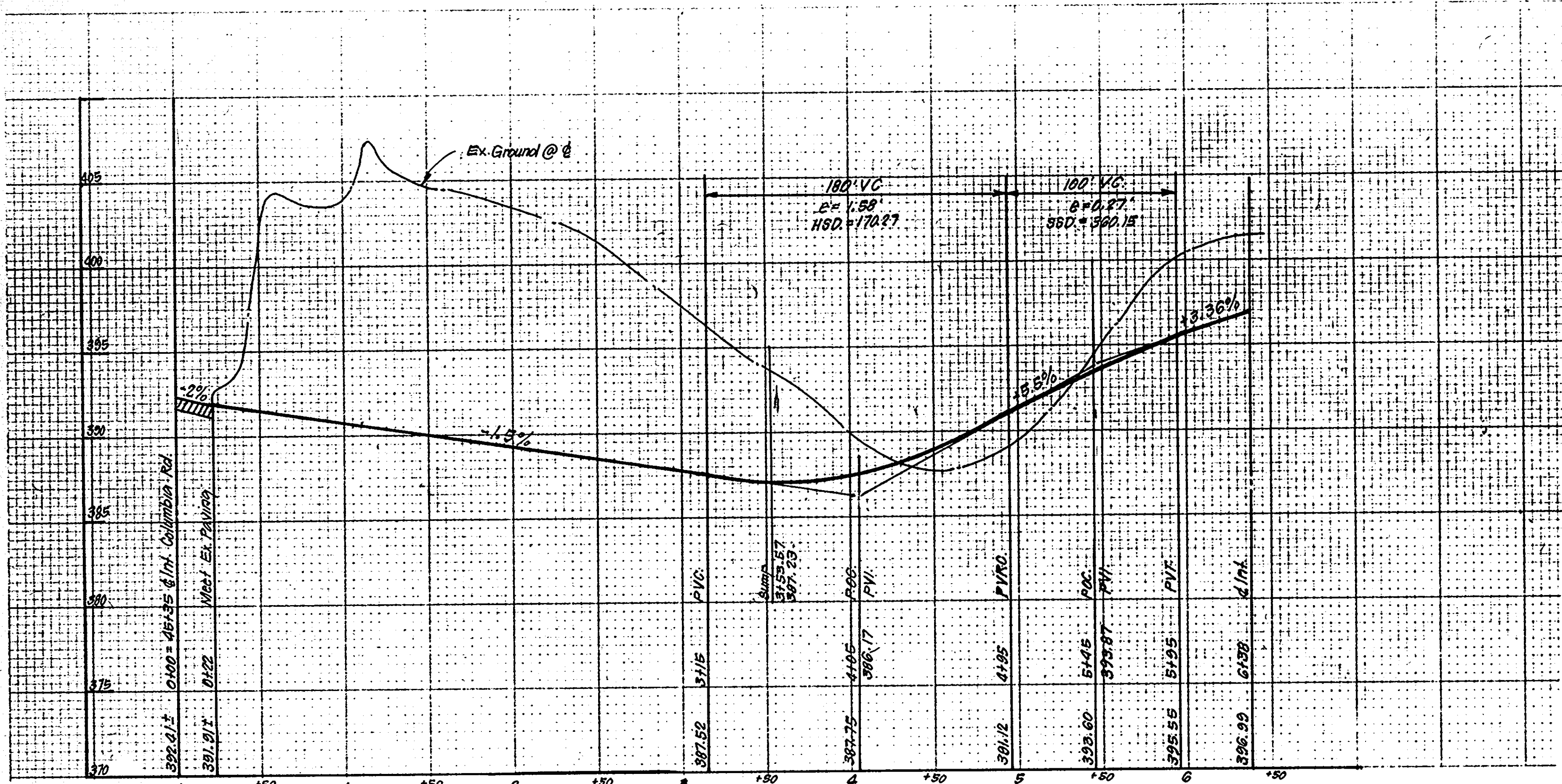

PROFILE
 SCALES: HORIZ. 1"=50'
 VERT. 1"=5'

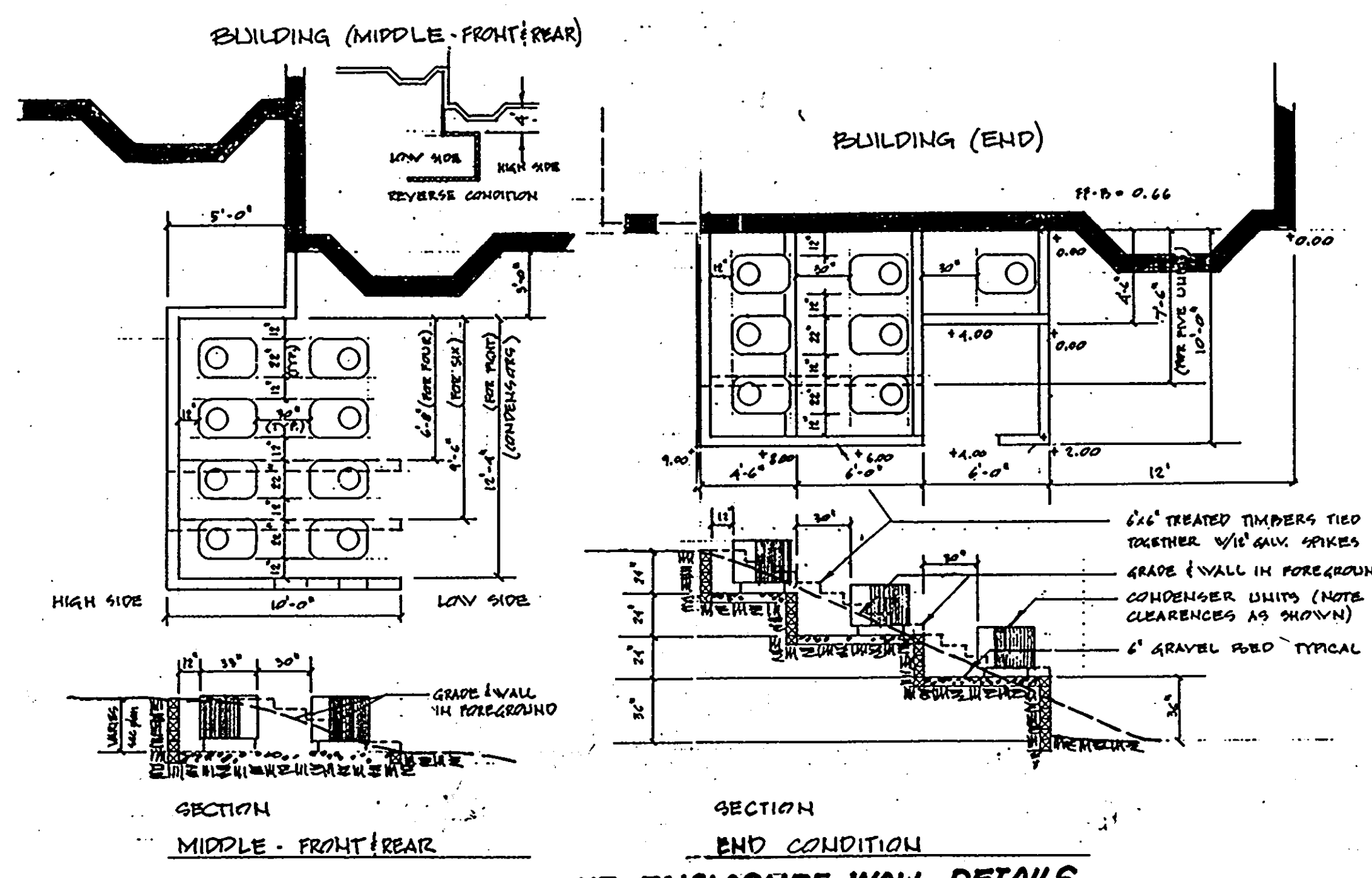
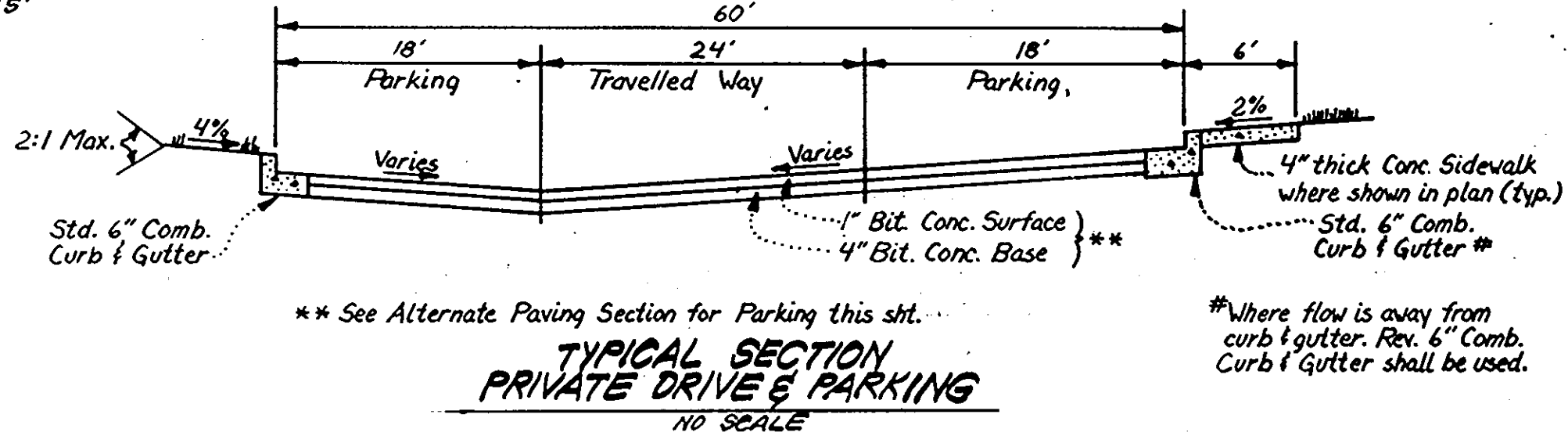
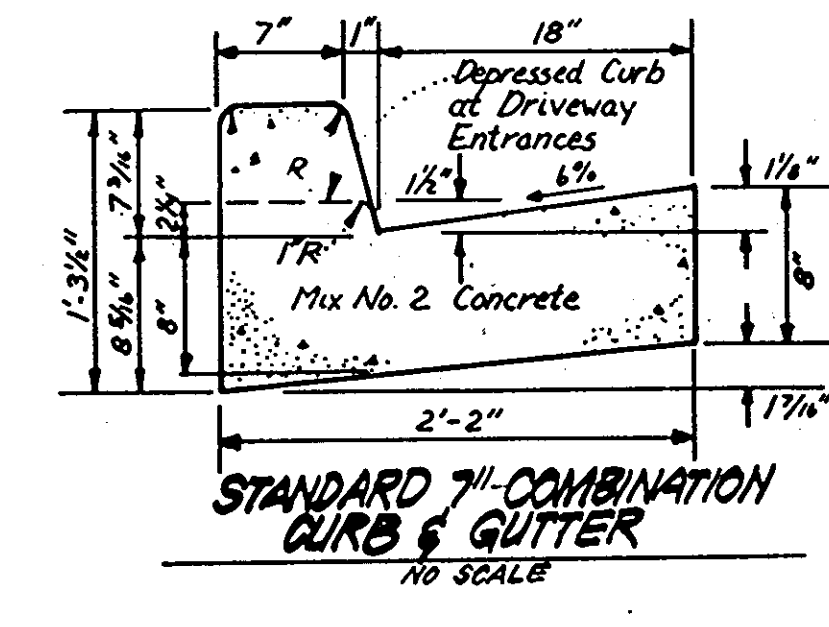
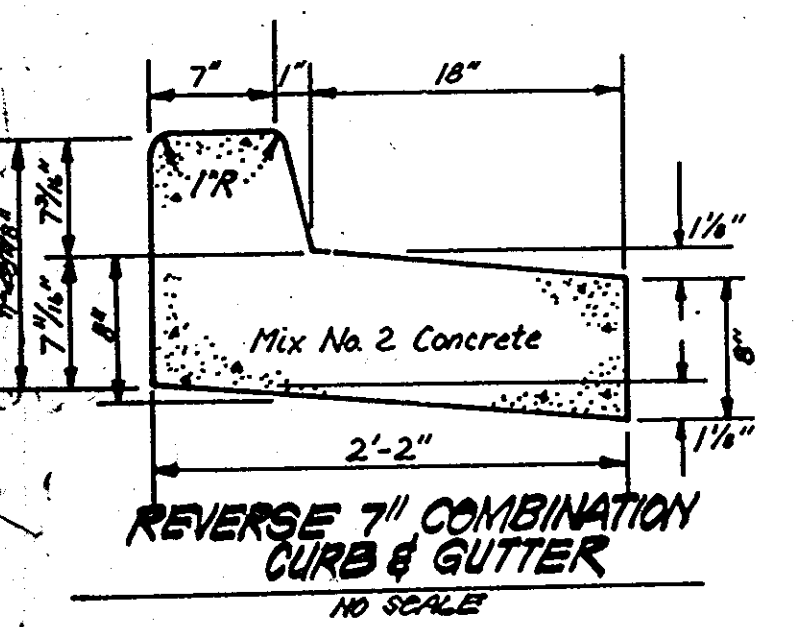
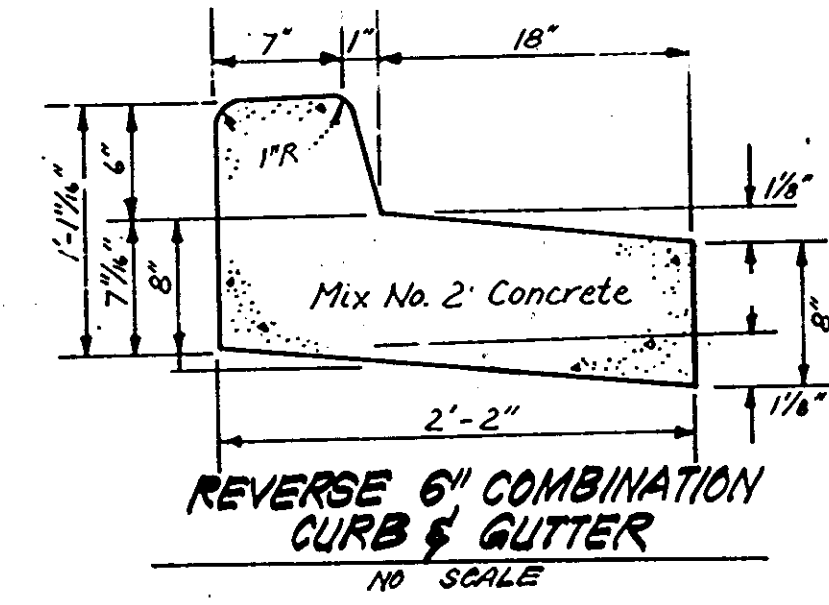
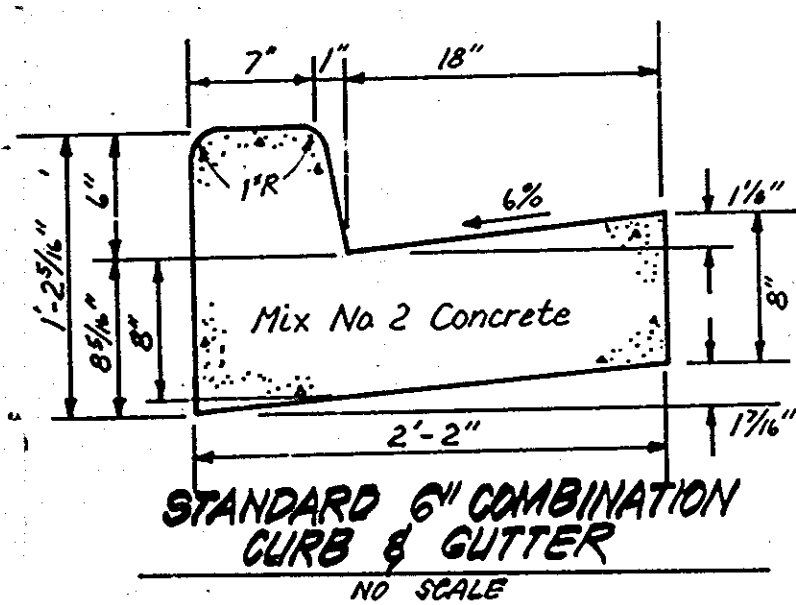

Notes:
 1. Longitudinal joint between sidewalk & curb shall be continuous and to a depth of 1/4 the thickness of the sidewalk or 1/4 inch longitudinal joints shall run from back edge of sidewalk continuous to the bottom face of curb to a depth of 1/4 inch and spaced 5' apart.
 2. Provide 1/2 inch expansion joints at 15' intervals. In longitudinal joints to full cross-section.

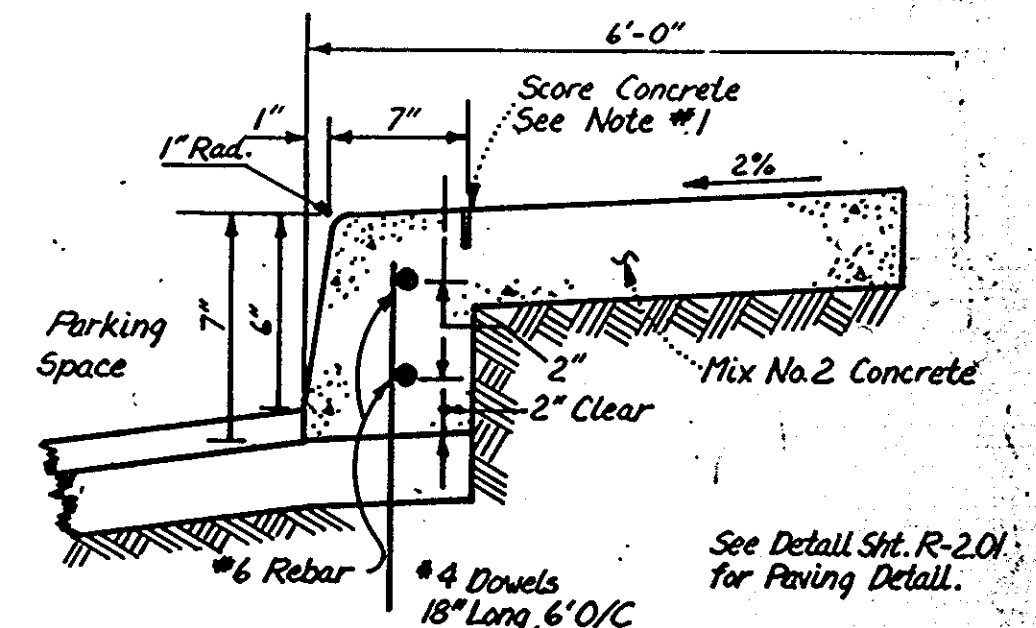
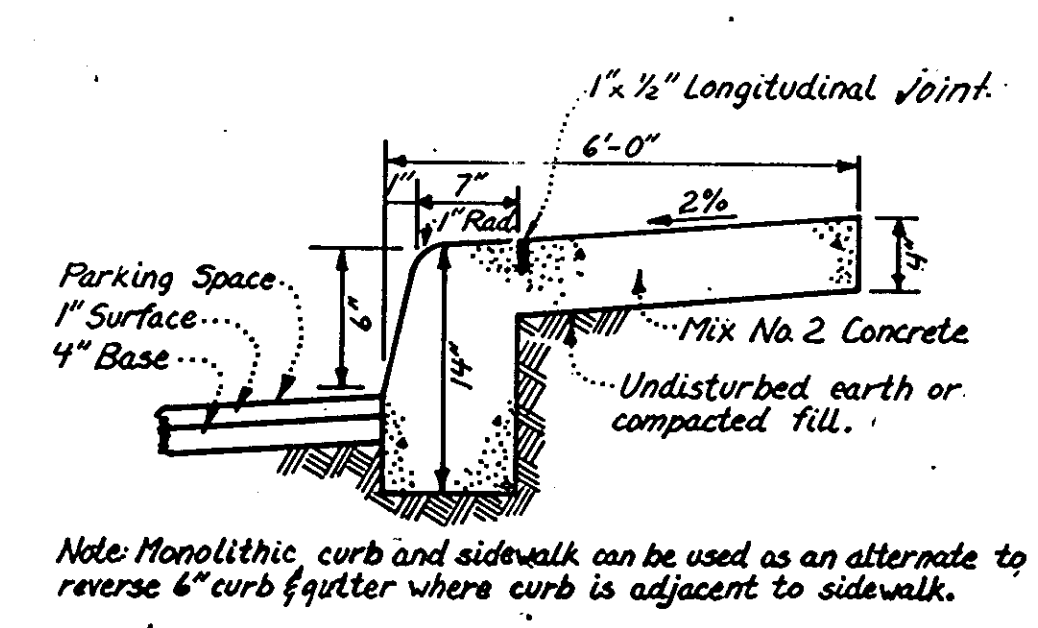

MONOLITHIC CURB & SIDEWALK - PRIVATE PARKING AREA
 NO SCALE

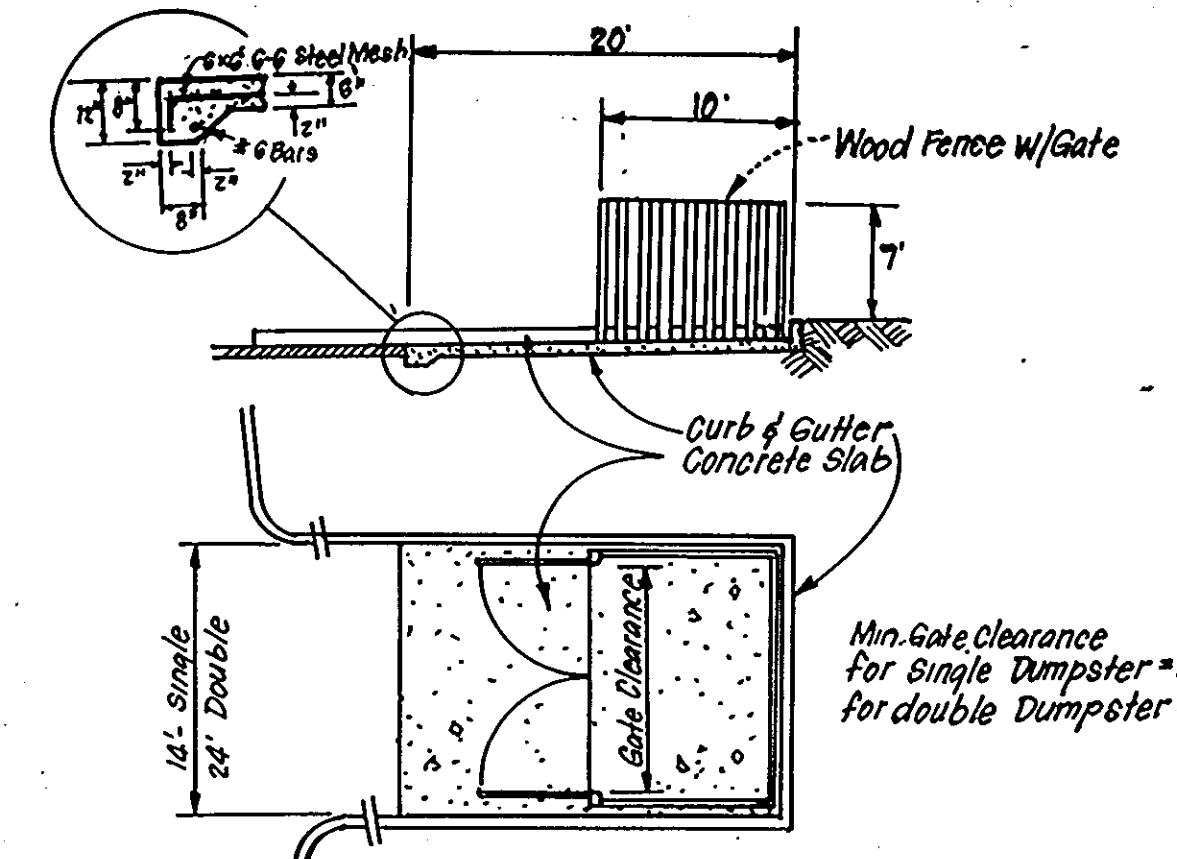

DUMPSTER PAD & ENCLOSURE
 NO SCALE

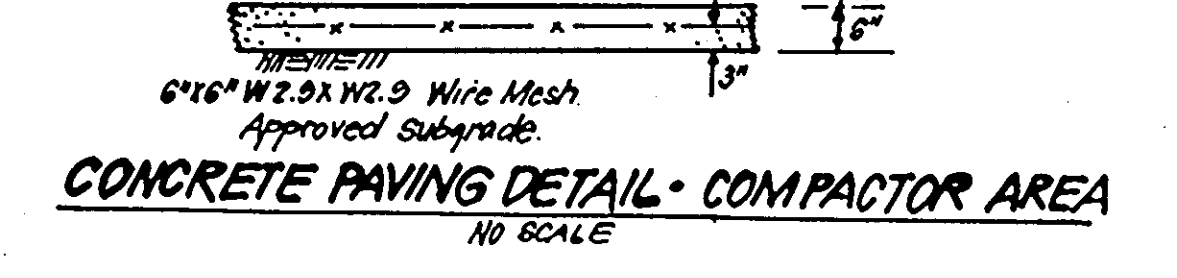

CONCRETE PAVING DETAIL - COMPACTOR AREA
 NO SCALE

ALTERNATE PAVING SECTION FOR MAJOR & MINOR COLLECTOR (SECTION P-3)

Bituminous Conc. Surface	1 1/2"
Bituminous Conc. Base	4 1/2"
Prime	1"
6" Crusher Run Base (Placed in 1 Course)	6"
4" Dense Graded Stabilized Aggregate Base Course	4 1/2"

ALTERNATE PAVING SECTION FOR PARKING AREAS (SECTION P-1)

Bituminous Conc. Surface	1"
Bituminous Conc. Base	2"
Prime	1"
5" Crusher Run Base Course	5"
4" Dense Graded Stabilized Aggregate Base Course	4"

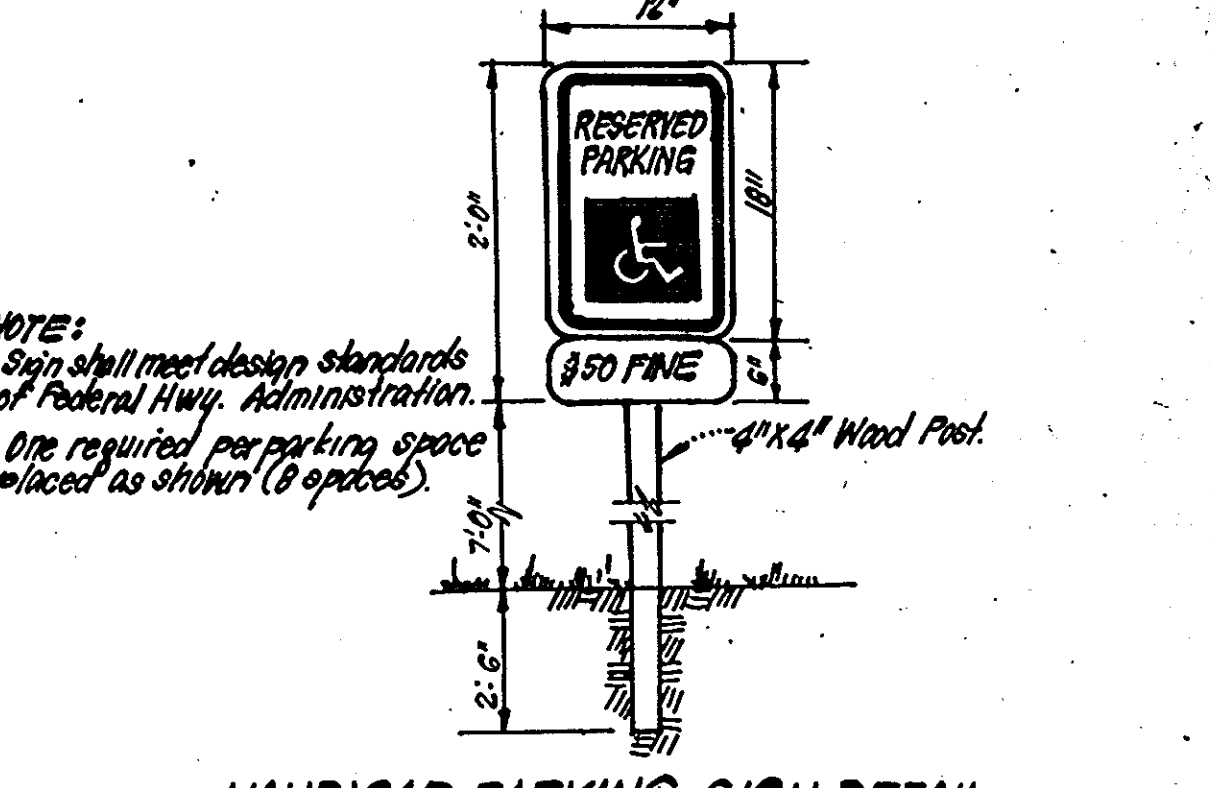
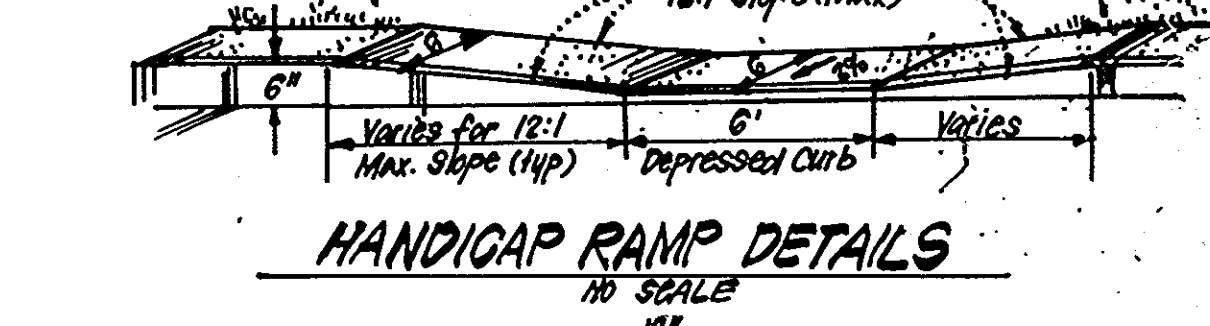
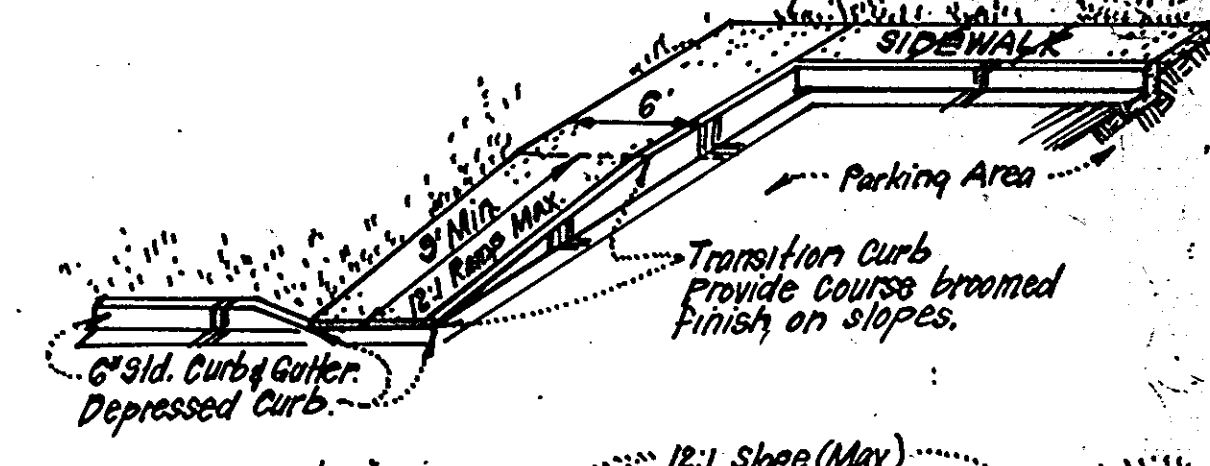

TYPICAL PARKING
 NO SCALE

APPROVED: FOR PUBLIC WATER AND PUBLIC SEWERAGE SYSTEMS, HOWARD COUNTY HEALTH DEPARTMENT
 DATE: 1-14-87
 APPROVED: HOWARD COUNTY OFFICE OF PLANNING & ZONING
 DATE: 1-14-87
 APPROVED: FOR PUBLIC WATER AND PUBLIC SEWERAGE, STORM DRAINAGE SYSTEMS AND PUBLIC ROADS, HOWARD COUNTY DEPARTMENT OF PUBLIC WORKS
 DATE: 1-13-87

APPROVED
 PLANNING BOARD
 OF HOWARD COUNTY
 DATE: 11-12-86

CLARK • FINEFROCK • SACKETT, INC.
 ENGINEERS • PLANNERS • SURVEYORS
 11315 LOCKWOOD DRIVE SILVER SPRING, MARYLAND 20904 (301) 593-3400

SITE DEVELOPMENT PLAN
 PARCEL A-2
 PAVING DETAILS
COLUMBIA
 VILLAGE OF DORSEY'S SEARCH
 SECTION 3 AREA 1
 5TH ELECTION DISTRICT
 HOWARD COUNTY, MARYLAND

FOR: SHELTER DEVELOPMENT CORP.
 Suite 500 Park Charles Bldg. 218 N. Charles St.
 Baltimore, Maryland 21201
SDP-87-76c

OWNER: The Howard Research & Development Corporation, 10275 Little Patuxent Pkwy, Columbia, Md. 21044

DESIGNED: JLS SCALE: As Shown
 DRAWN: KIW DRAWING: 3 OF 9
 CHECKED: JLS JOB NO.: 85-139
 DATE: 10-7-86 FILE NO.: 85-139-X

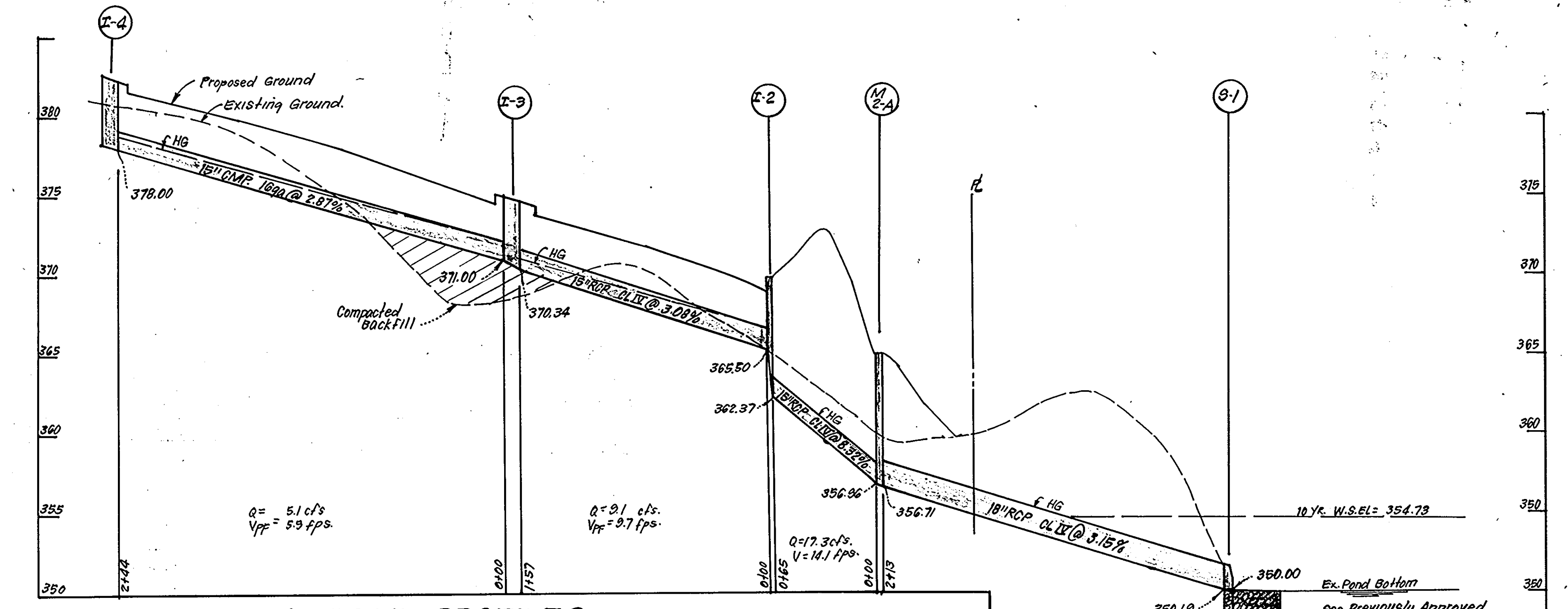
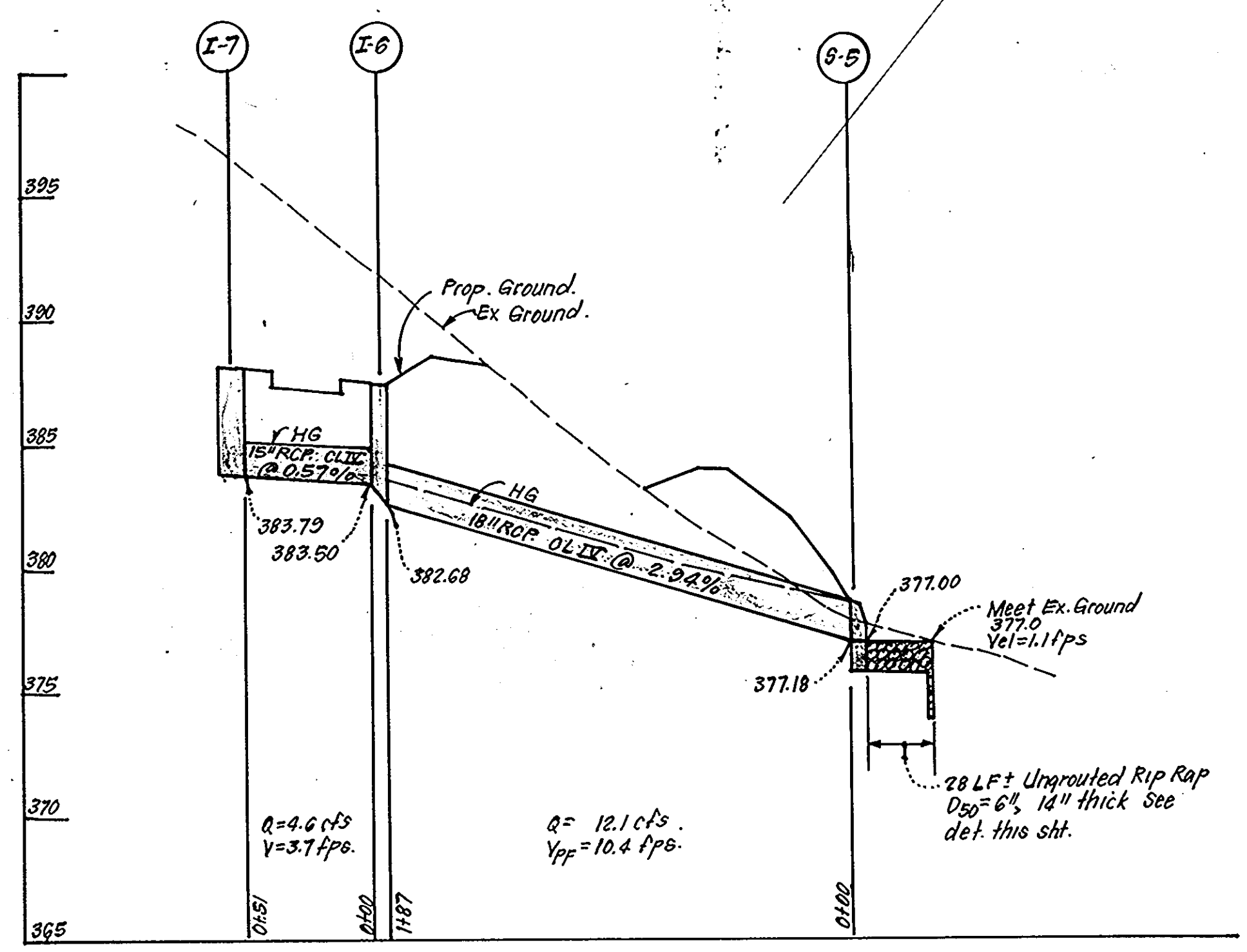

STORM DRAIN PROFILES

SCALES: HORIZ. 1"=50'
VERT. 1"=5'

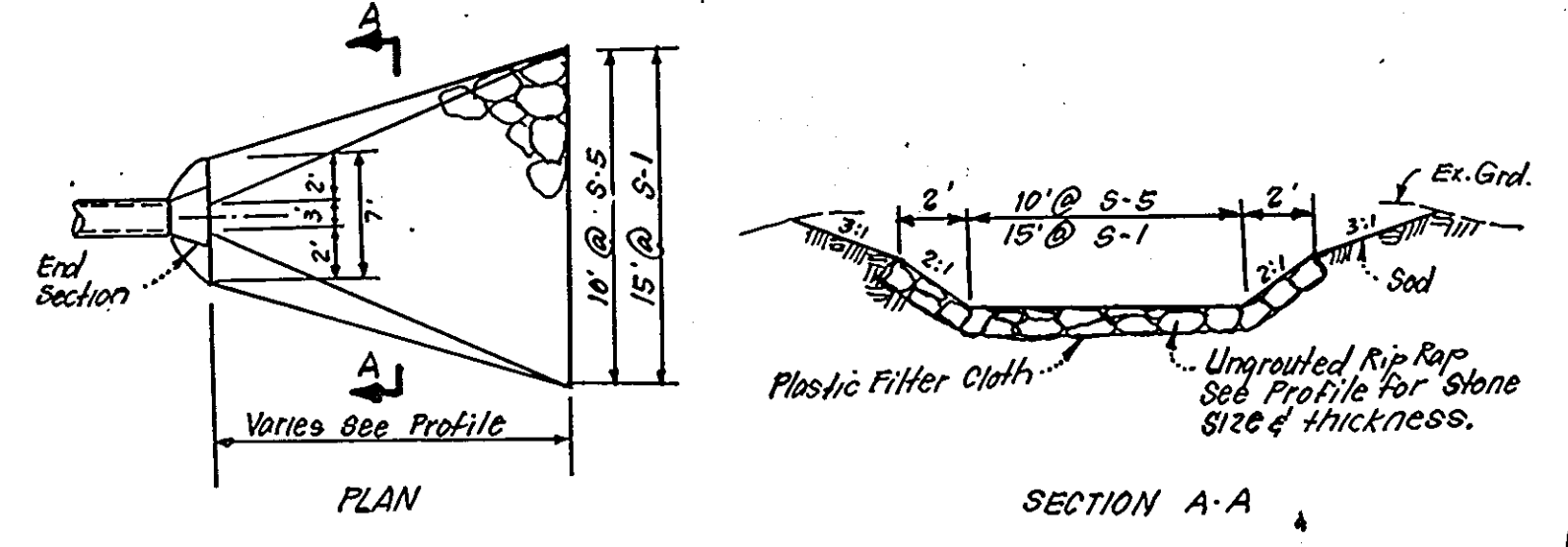

OUTLET DITCH DETAIL

NO SCALE

STRUCTURE SCHEDULE

No.	TYPE	INV. IN		TOP ELEVATION		REMARKS	LOCATION
				UPPER	LOWER		
S-1	Conc. End Section	350.10	350.00			Ho. Co. Std. SD. E-51	See Plan
M-2A	Brick Manhole	356.96	356.71	365.00		Ho. Co. Std. G-5.01	48" Rd. "
I-2	A-10 Inlet	365.50	362.37	370.00	369.50	" " SD 4.02	W=4'6" "
I-3	A-10 Inlet w/Deflectors	365.00	370.34	374.98	374.65	" " SD 4.02	W=2'6" "
I-4	A-10 Inlet w/Deflectors	371.00	378.10	382.65	382.32	" " SD 4.02	W=2'6" "
S-5	Conc. End Section	377.18	377.00			" " SD. E-51	18" Dia. "
I-6	A-10 Inlet	383.50	382.68	387.40		" " SD 4.02	W=2'6" "
I-7	A-10 Inlet		383.79	388.11	388.00	" " SD 4.02	W=2'6" "
I-8	A-10 Inlet w/Deflectors		378.50	378.38	378.05	" " SD 4.02	W=2'6" "

Δ All Inverts to be fully developed.
* See Ho. Co. Std. 4.83 for Inlet Deflectors.

PIPE SCHEDULE

SIZE	TYPE	LENGTH
15"	RCP CL. IX	273 LF
15"	CMP 16ga.	427 LF
18"	RCP CL. IX	400 LF

* 2 1/2" x 1/2" Corrugations.

- WATER AND SEWER NOTES:**
- All sewer mains shall be PVC, C.S.P.X., V.C.P.X. or A.C.P. Class 2400 except where otherwise noted.
 - All construction methods and materials for on-site private water and sewer systems shall follow the current edition of the Howard County Std. Details and Specifications where necessary.
 - All water mains to have a minimum of 3.5 ft. of cover.
 - Sewer House Connections shall be built to within 5 ft. of buildings at a slope of 2.00%, unless otherwise shown on plan or profile.

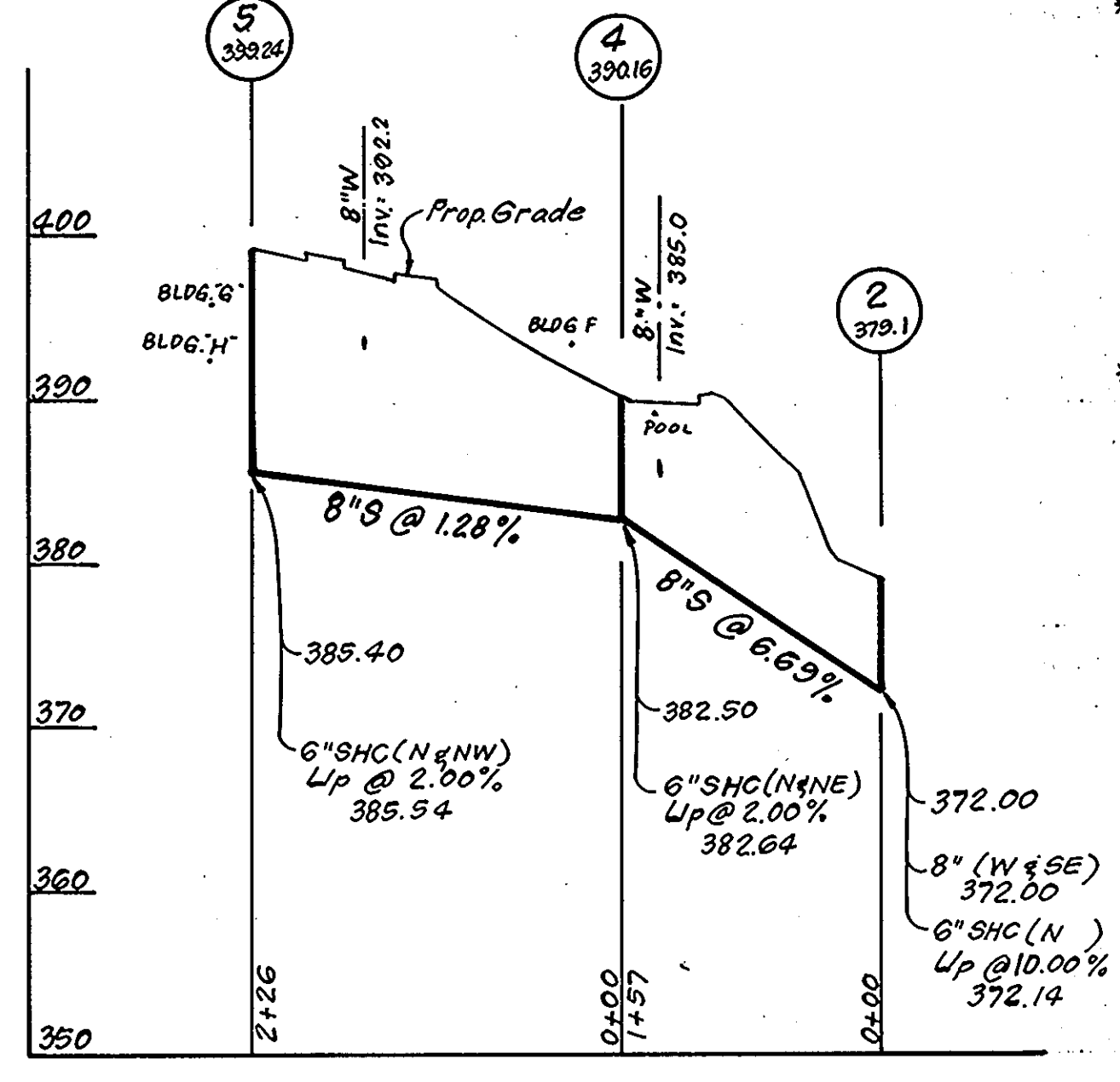

SEWER PROFILES

SCALES: HORIZ. 1"=100'
VERT. 1"=10'

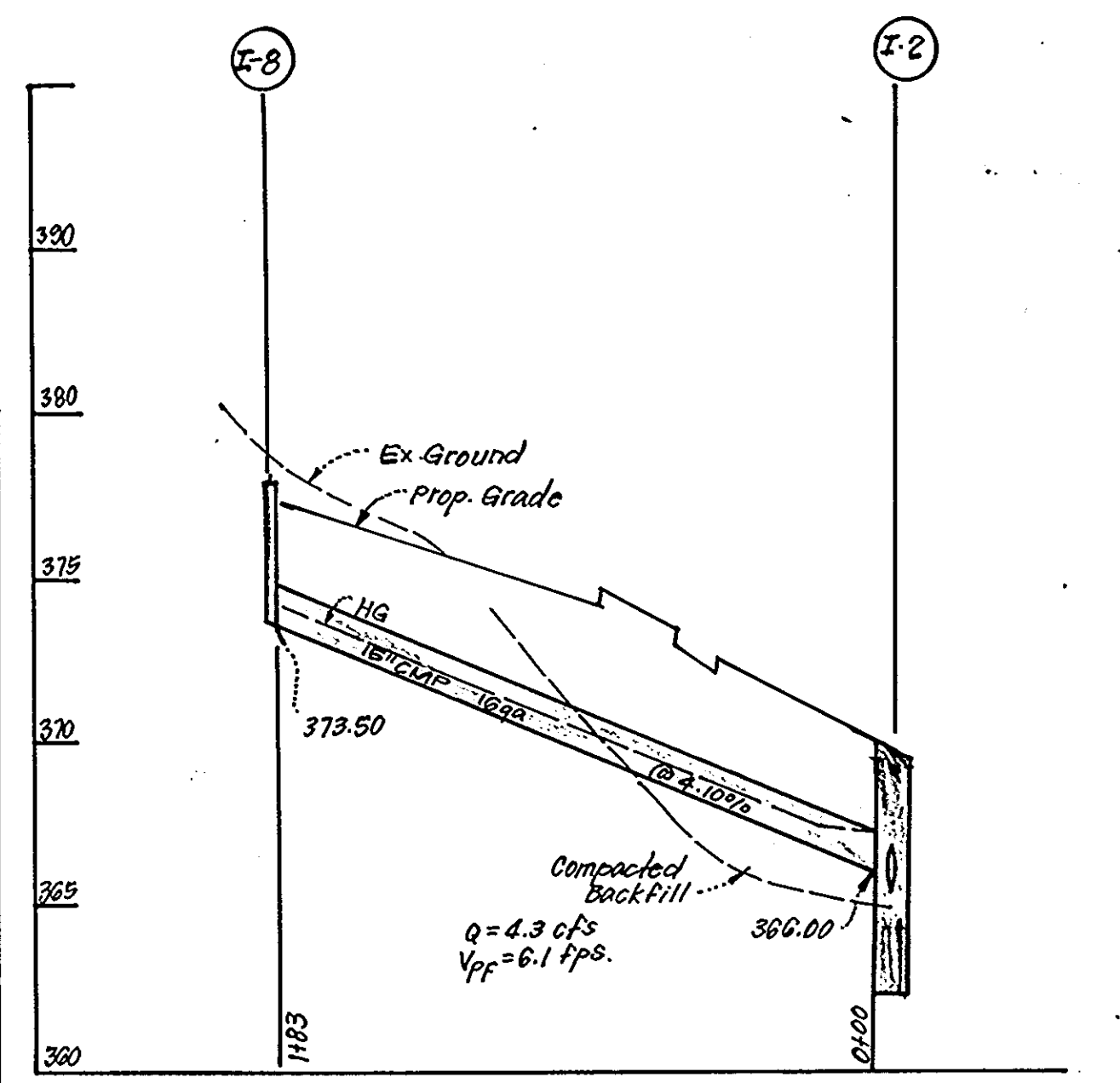
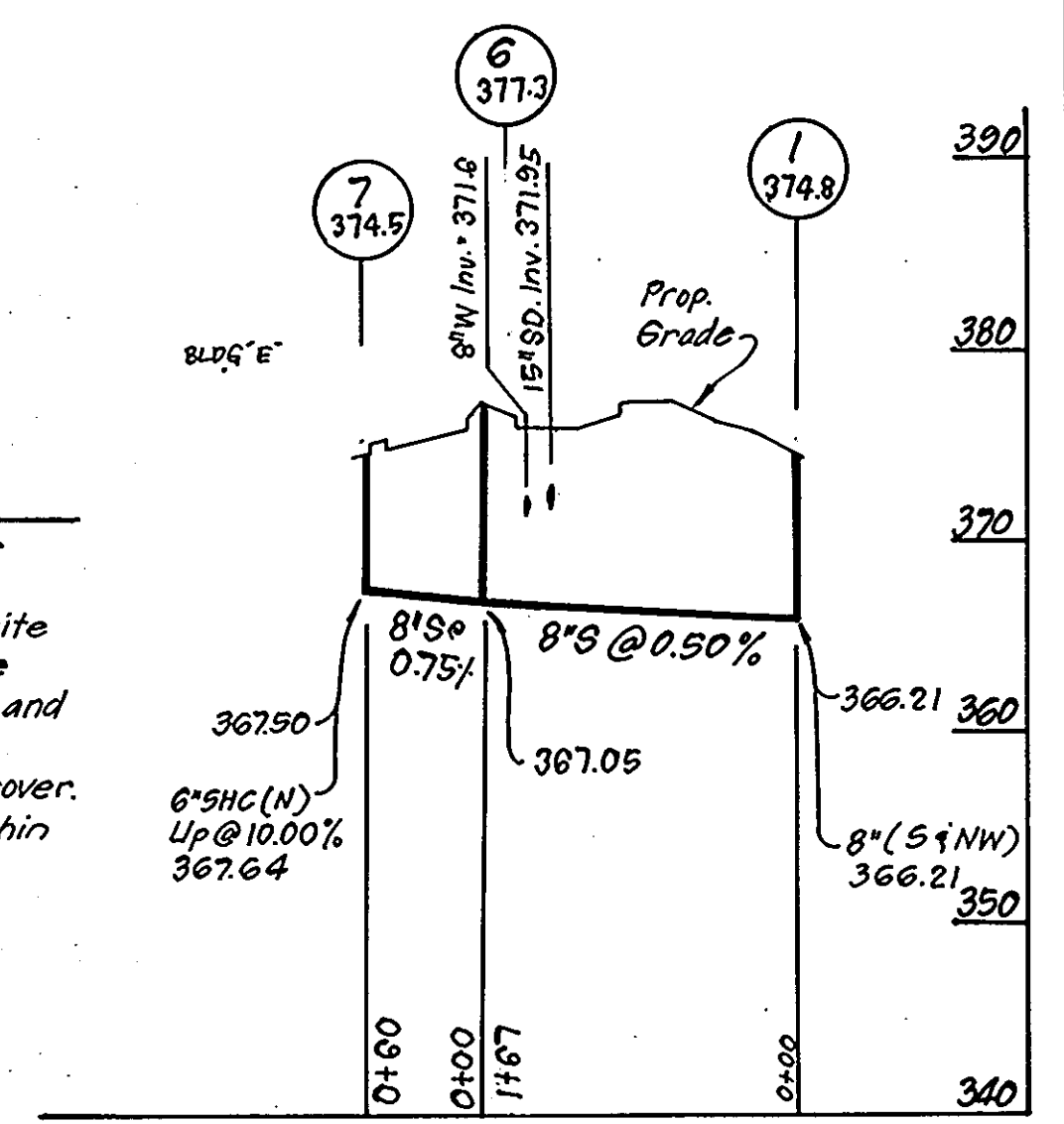

APPROVED: FOR PUBLIC WATER AND PUBLIC SEWERAGE SYSTEMS, HOWARD COUNTY HEALTH DEPARTMENT

APPROVED: HOWARD COUNTY OFFICE OF PLANNING & ZONING

APPROVED: FOR PUBLIC WATER AND PUBLIC SEWERAGE SYSTEMS AND PUBLIC ROADS, HOWARD COUNTY DEPARTMENT OF PUBLIC WORKS

APPROVED: PLANNING BOARD OF HOWARD COUNTY

DATE: 11-12-86

Reviewed for... *Howard* S.C.D. Name

and meets Technical Requirements

Signature: *Stephen L. Audu* Date: 1-9-87

U.S. Soil Conservation Service

THIS DEVELOPMENT PLAN IS APPROVED FOR SOIL EROSION AND SEDIMENT CONTROL BY THE HOWARD COUNTY CONSERVATION DISTRICT.

DEVELOPER'S/BUILDER'S CERTIFICATE

I/we certify that all development and construction will be done according to this plan of development and plan for erosion and sediment control and that all responsible personnel involved in the construction project will have a Certificate of Attendance at a Dept. of Natural Resources Approved Training Program for the Control of Sediment and Erosion before beginning the project. I also authorize periodic on-site inspection by the Howard Soil Conservation District or its authorized agents, as are deemed necessary.

Signature of Developer/Builder: *Mark Jones* Date: 1-7-87

ENGINEER'S CERTIFICATE

I hereby certify that this plan for Erosion and Sediment Control represents a practical and workable plan based on my personal knowledge of the site conditions and that it was prepared in accordance with the requirements of the Howard Soil Conservation District.

Signature: *G. Nelson Clark* Date: 1-8-87

CLARK • FINEFROCK • SACKETT, INC.

ENGINEERS • PLANNERS • SURVEYORS

11315 LOCKWOOD DRIVE SILVER SPRING, MARYLAND 20904 (301) 593-3400

DESIGNED: JLS
DRAWN: KIW
CHECKED: JLS
DATE: 10-7-86

SITE DEVELOPMENT PLAN
PARCEL A-2
STORM DRAIN PROFILES
COLUMBIA
VILLAGE OF DORSEY'S SEARCH
SECTION 3 AREA 1
5TH ELECTION DISTRICT
HOWARD COUNTY, MARYLAND

FOR: SHELTER DEVELOPMENT CORP.
Suite 1500 Park Charles Bldg. 218 N. Charles St.
Baltimore, Maryland 21201

SCALE: As Shown
DRAWING: 40F-9
JOB NO.: 85-130
FILE NO.: 85-130-X

SDP-87-76

OWNER: The Howard Research & Development Corporation
10275 Little Patuxent Pkwy
Columbia, Md. 21044

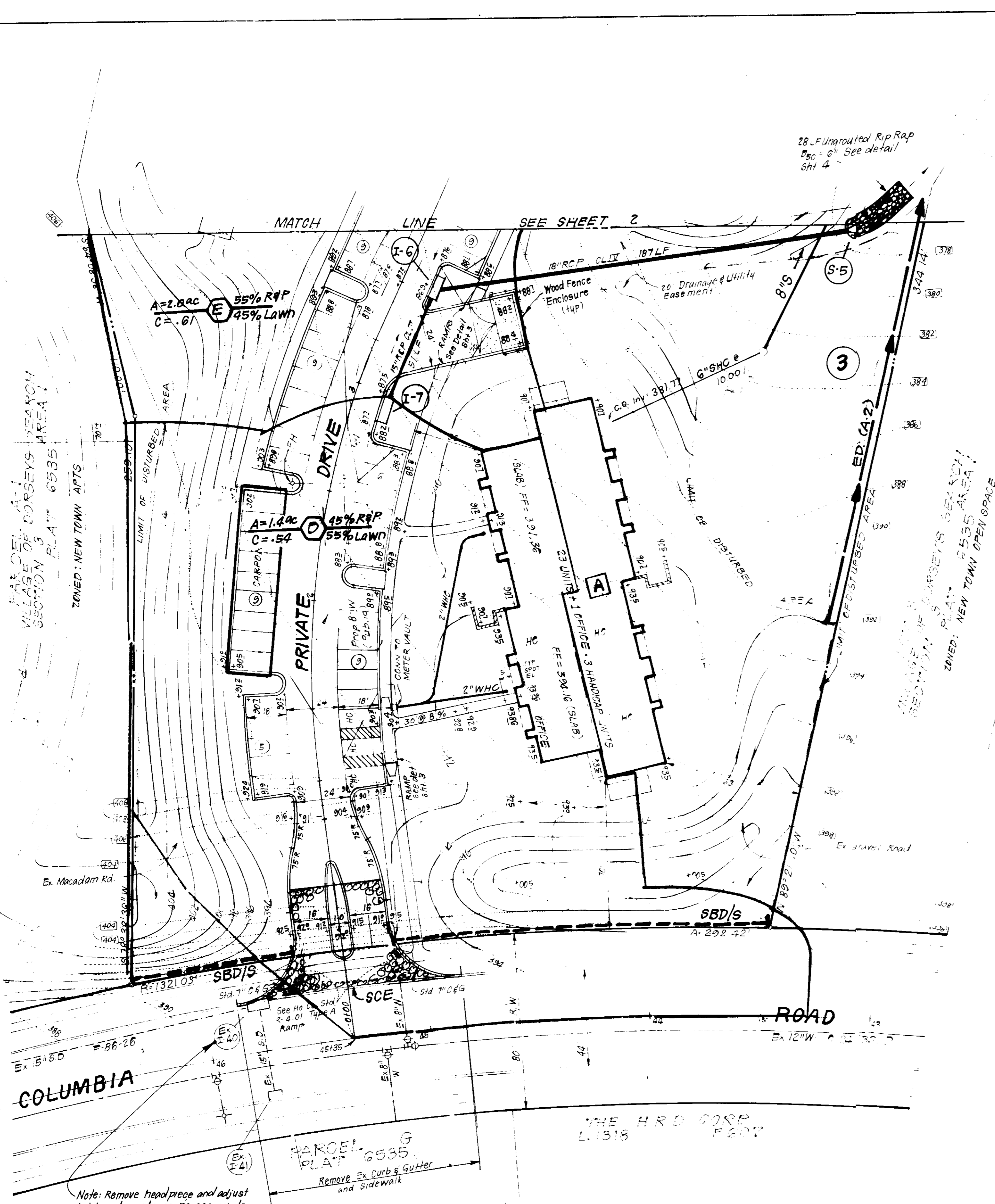
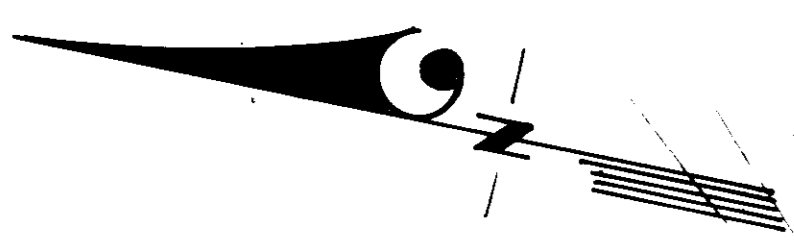

LEGEND

- 1. Contour Interval 2 Ft.
- 2. Existing Contour
- 3. Proposed Contour
- 4. Spot Elevation
- 5. Direction of Drainage
- 6. Proposed Storm Drain
- 7. Proposed Sewer Main
- 8. Existing Trees to be Saved
- 9. Earth Dike
- 10. Straw Bale Dike or Silt Fence
- 11. Stabilized Construction Entrance

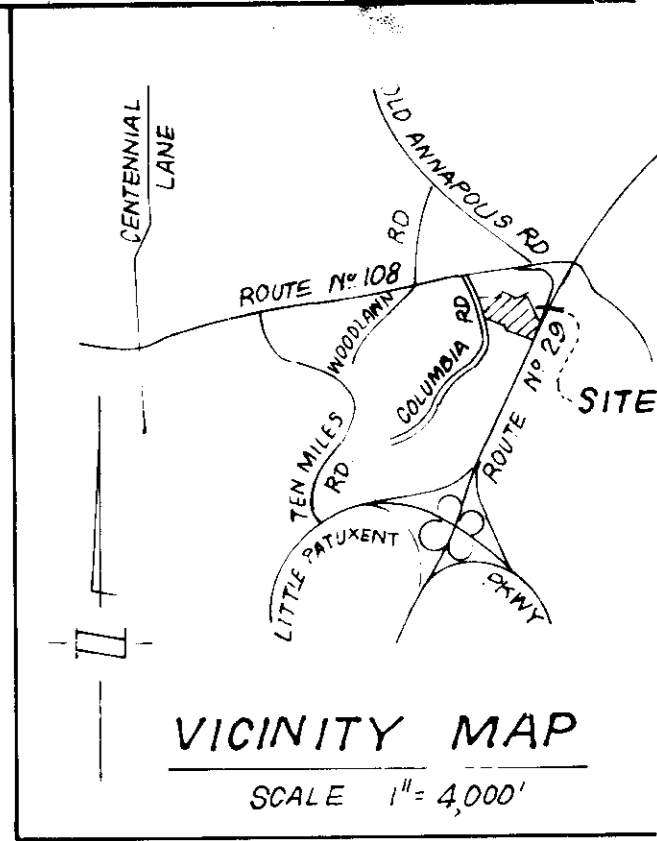

APPROVED: FOR PUBLIC WATER AND PUBLIC SEWERAGE SYSTEMS.
HOWARD COUNTY HEALTH DEPARTMENT

John Balun 1-14-87
COUNTY HEALTH OFFICER DATE

APPROVED: HOWARD COUNTY OFFICE OF PLANNING & ZONING

Thomas H. Harris 1-14-87
PLANNING DIRECTOR DATE

John M. Muddiman 1-14-87
CHIEF DIVISION OF LAND DEVELOPMENT AND ZONING ADMINISTRATION DATE

APPROVED: FOR PUBLIC WATER AND PUBLIC SEWERAGE.
STORM DRAINAGE SYSTEMS AND PUBLIC ROADS
HOWARD COUNTY DEPARTMENT OF PUBLIC WORKS

John F. ... 1-17-87
DIRECTOR DATE

... 1-12-87
CHIEF BUREAU OF ENGINEERING DATE

APPROVED
PLANNING BOARD
OF HOWARD COUNTY

DATE 11-12-86
M. J. ...

Reviewed for *...* SCD
and meets Technical Requirements

Stephen ... Date
Signature Date
U.S. Soil Conservation Service

THIS DEVELOPMENT PLAN IS APPROVED
FOR SOIL EROSION AND SEDIMENT
CONTROL BY THE HOWARD SOIL
CONSERVATION DISTRICT.

Stephen ... 12/86
Approved Date

ENGINEER'S CERTIFICATE

I hereby certify that all development and construction will be done in accordance with the approved plan for erosion and sediment control and that all responsible personnel involved in the construction of this project will receive a Certificate of Attendance at a Dept. of Natural Resources Approved Training Program for the Control of Sediment and Erosion before beginning the project. I also authorize periodic on-site inspection by the Howard Soil Conservation District or their authorized agents, as are deemed necessary.

Mark ... 10-7-86
Signature Date
Engineer/Builder

ENGINEER'S CERTIFICATE

I hereby certify that this plan for Erosion and Sediment Control represents a practical and workable plan based on my personal knowledge of the site conditions and that it was prepared in accordance with the requirements of the Howard Soil Conservation District.

John Nelson Clark 12-5-86
Signature Date
6 Nelson Clark

OWNER: The Howard Research & Development Corporation
10275 Little Patuxent Pkwy
Columbia, Md 21044

CLARK · FINEFROCK & SACKETT
ENGINEERS · PLANNERS · SURVEYORS

11317 LOCKWOOD DRIVE SILVER SPRING, MARYLAND 20904 (301) 593-3400

DESIGNED WHT	SEDIMENT & EROSION CONTROL PLAN AND DRAINAGE AREA MAP PARCEL A-2 COLUMBIA VILLAGE OF DORSEY'S SEARCH SECTION 3 AREA 1 5TH ELECTION DISTRICT HOWARD COUNTY, MARYLAND	SCALE 1" = 30'
DRAWN JTR		DRAWING 5069
CHECKED JLS WHT	FOR: SHELTER DEVELOPMENT CORP Suite 500 Park Charles Bldg., 218 N. Charles St Baltimore, Maryland 21201	JOB NO. 85-139
DATE 10-7-86		FILE NO. 85-139 SE

SDP-87-76c

SEDIMENT TRAP TABLE

TYPE OF TRAP	DRAINAGE AREA	STORAGE REQUIRED	STORAGE PROVIDED	DEPTH	TOP OF CREST	TOP OF BERM	BOTTOM ELEV.	CLEANOUT ELEV.	BOTTOM DIMENSIONS
#1 ROBT. ST. VI	5.6 AC.	10080 CF	10080 CF	5'	569.0	372.25	363.0	365.5	31'x51' 1/2"
#2 ROBT. ST. VII	6.5 AC.	11700 CF	11700 CF	5'	359.0	362.25	353.0	355.5	35'x34' 1/2"

Note: Grade as necessary to provide 0.5% Min. fall on E.D. in this area.

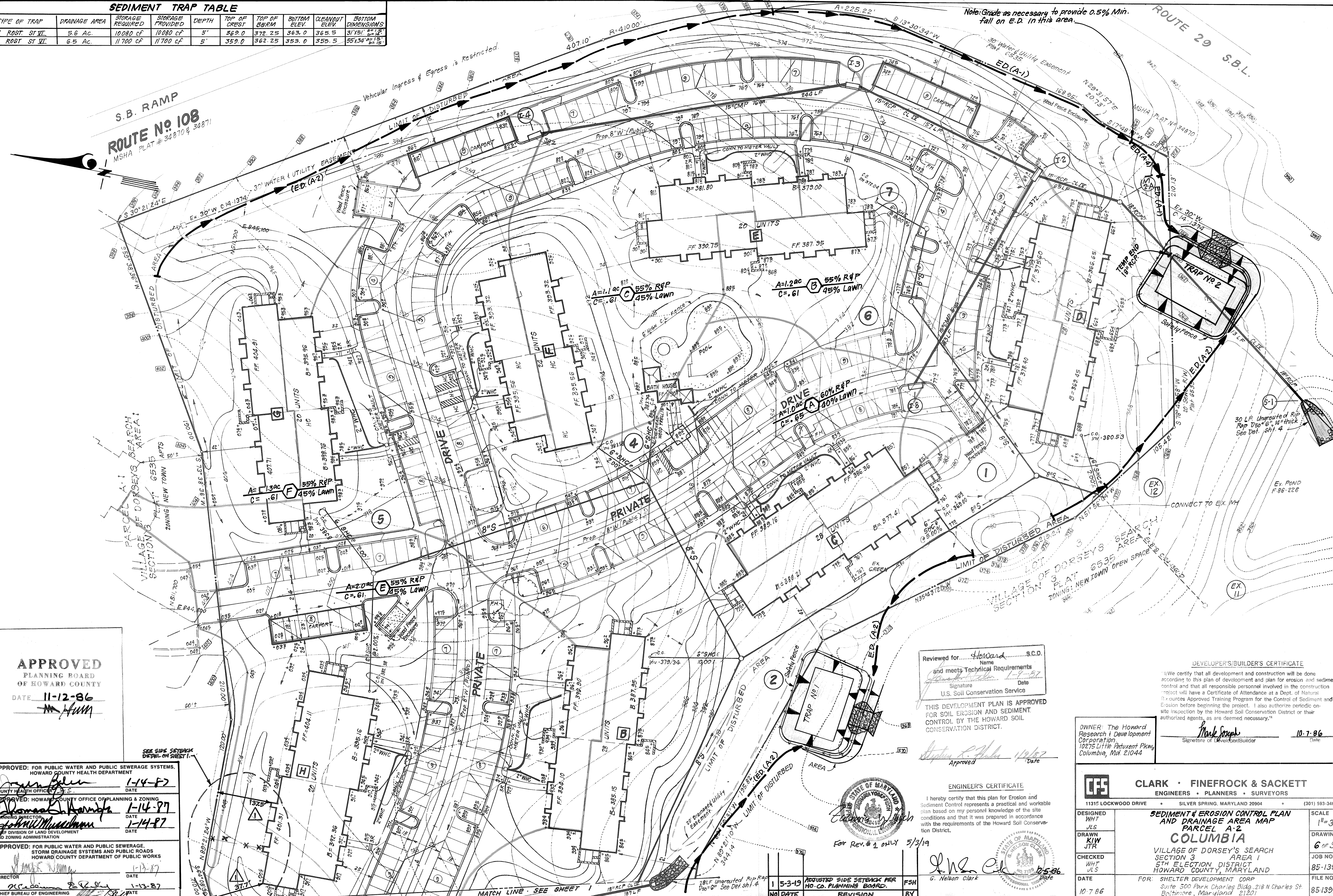

APPROVED
PLANNING BOARD
OF HOWARD COUNTY
DATE 11-12-86
[Signature]

APPROVED: FOR PUBLIC WATER AND PUBLIC SEWERAGE SYSTEMS,
HOWARD COUNTY HEALTH DEPARTMENT
[Signature] DATE 1-14-87
APPROVED: HOWARD COUNTY OFFICE OF PLANNING & ZONING
[Signature] DATE 1-14-87
PLANNING DIRECTOR
[Signature] DATE 1-14-87
CHIEF DIVISION OF LAND DEVELOPMENT
AND ZONING ADMINISTRATION
APPROVED: FOR PUBLIC WATER AND PUBLIC SEWERAGE,
STORM DRAINAGE SYSTEMS AND PUBLIC ROADS
HOWARD COUNTY DEPARTMENT OF PUBLIC WORKS
[Signature] DATE 1-13-87
DIRECTOR
[Signature] DATE 1-13-87
CHIEF BUREAU OF ENGINEERING

Reviewed for Howard S.C.D.
Name and meets Technical Requirements
[Signature] Date 1-9-87
U.S. Soil Conservation Service

THIS DEVELOPMENT PLAN IS APPROVED
FOR SOIL EROSION AND SEDIMENT
CONTROL BY THE HOWARD SOIL
CONSERVATION DISTRICT.
[Signature] Date 1/9/87
Approved



ENGINEER'S CERTIFICATE
I hereby certify that this plan for Erosion and
Sediment Control represents a practical and workable
plan based on my personal knowledge of the site
conditions and that it was prepared in accordance
with the requirements of the Howard Soil Conservation
District.
For Rev. # 1 ONLY 5/3/19
[Signature]
G. Nelson Clark

DEVELOPER'S/BUILDER'S CERTIFICATE
"I/We certify that all development and construction will be done
according to this plan of development and plan for erosion and sediment
control and that all responsible personnel involved in the construction
project will have a Certificate of Attendance at a Dept. of Natural
Resources Approved Training Program for the Control of Sediment and
Erosion before beginning the project. I also authorize periodic on-
site inspection by the Howard Soil Conservation District or their
authorized agents, as are deemed necessary."
[Signature] Date 10-7-86
Signature of Developer/Builder

OWNER: The Howard
Research & Development
Corporation
10275 Little Patuxent Pkwy
Columbia, Md. 21044

CLARK · FINEFROCK & SACKETT
ENGINEERS · PLANNERS · SURVEYORS
11315 LOCKWOOD DRIVE • SILVER SPRING, MARYLAND 20904 (301) 593-3400

DESIGNED: WHT, JLS
DRAWN: KIW, JTR
CHECKED: WHT, JLS
DATE: 10-7-86

SCALE: 1"=30'
DRAWING: 6 of 9
JOB NO.: 85-139
FILE NO.: 85139 SE

**SEDIMENT & EROSION CONTROL PLAN
AND DRAINAGE AREA MAP
PARCEL A-2
COLUMBIA**
VILLAGE OF DORSEY'S SEARCH
SECTION 3 AREA 1
5TH ELECTION DISTRICT
HOWARD COUNTY, MARYLAND

FOR: SHELTER DEVELOPMENT CORP
Suite 500 Park Charles Bldg., 218 N Charles St.
Baltimore, Maryland 21201
SDP-87-76

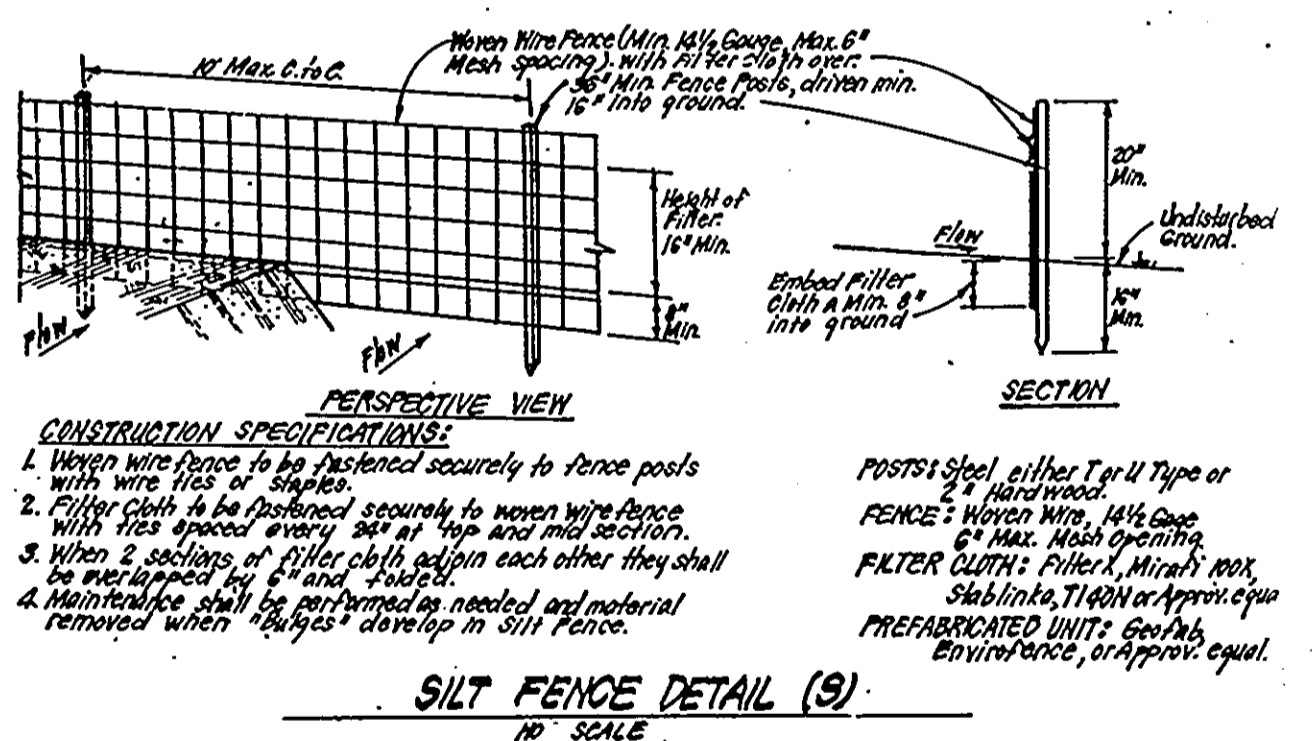
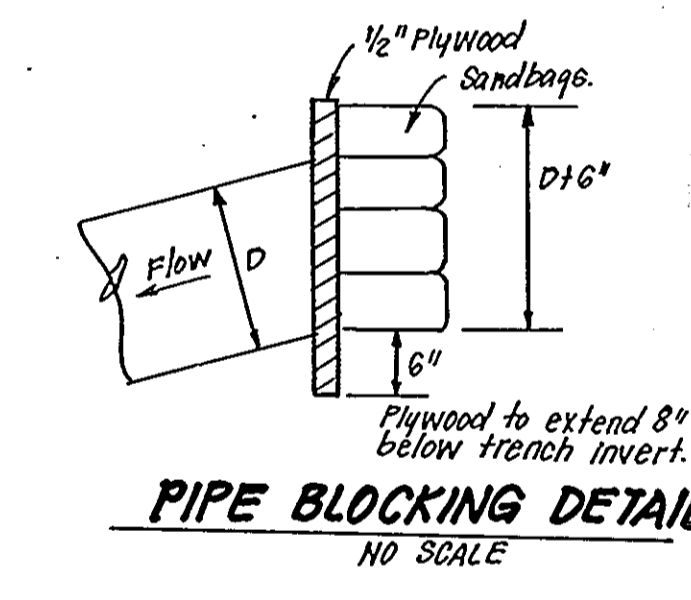
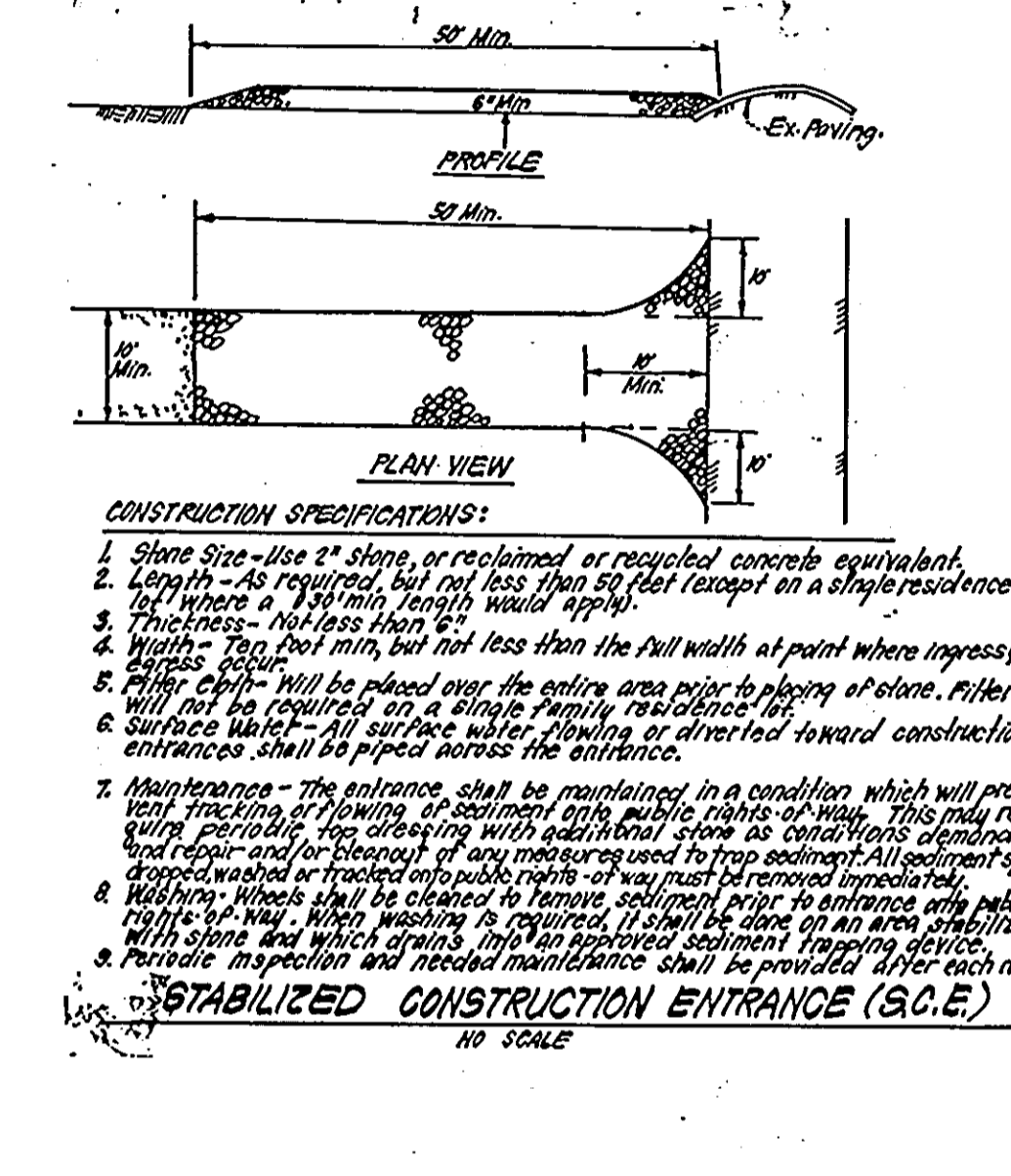
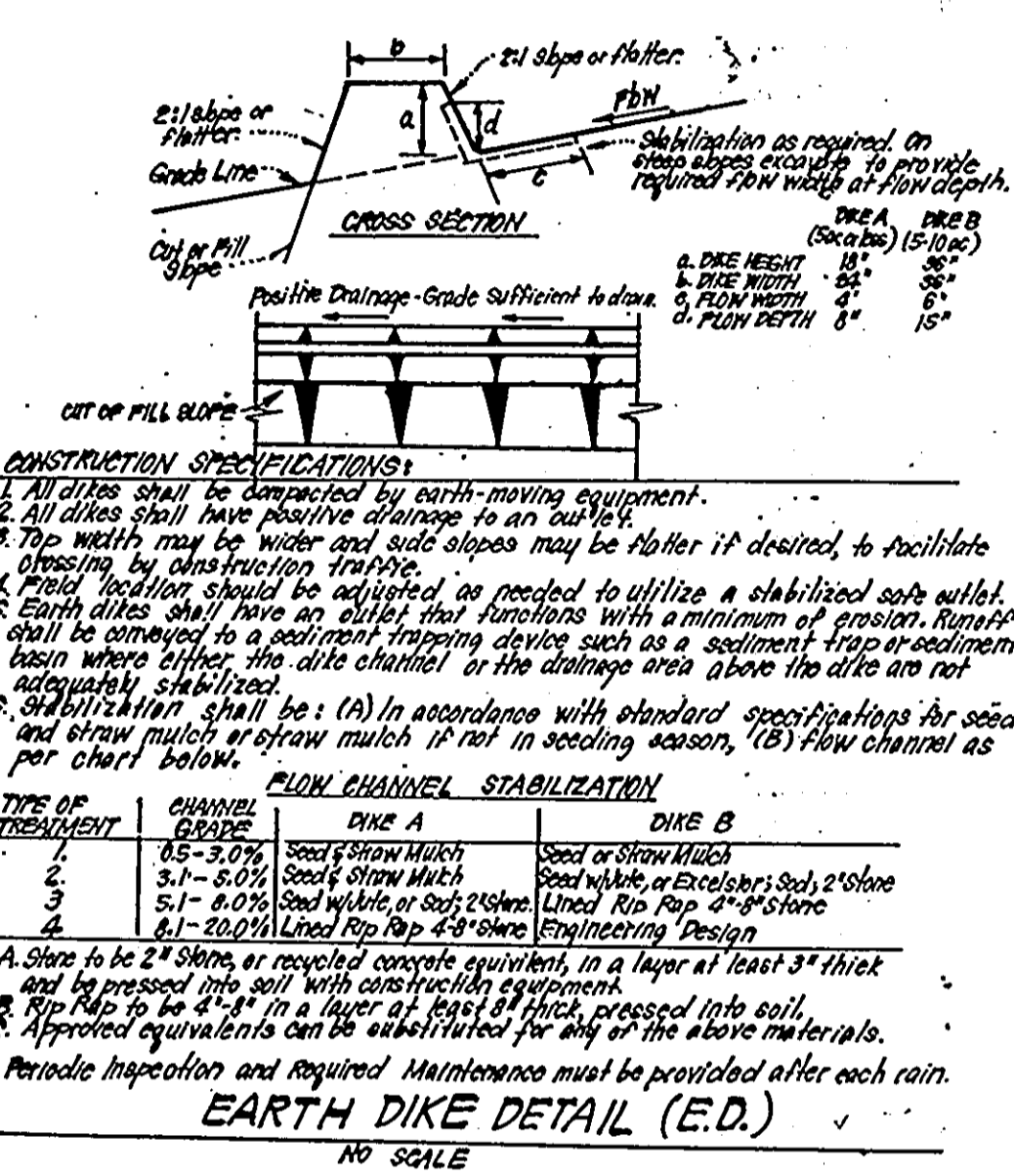
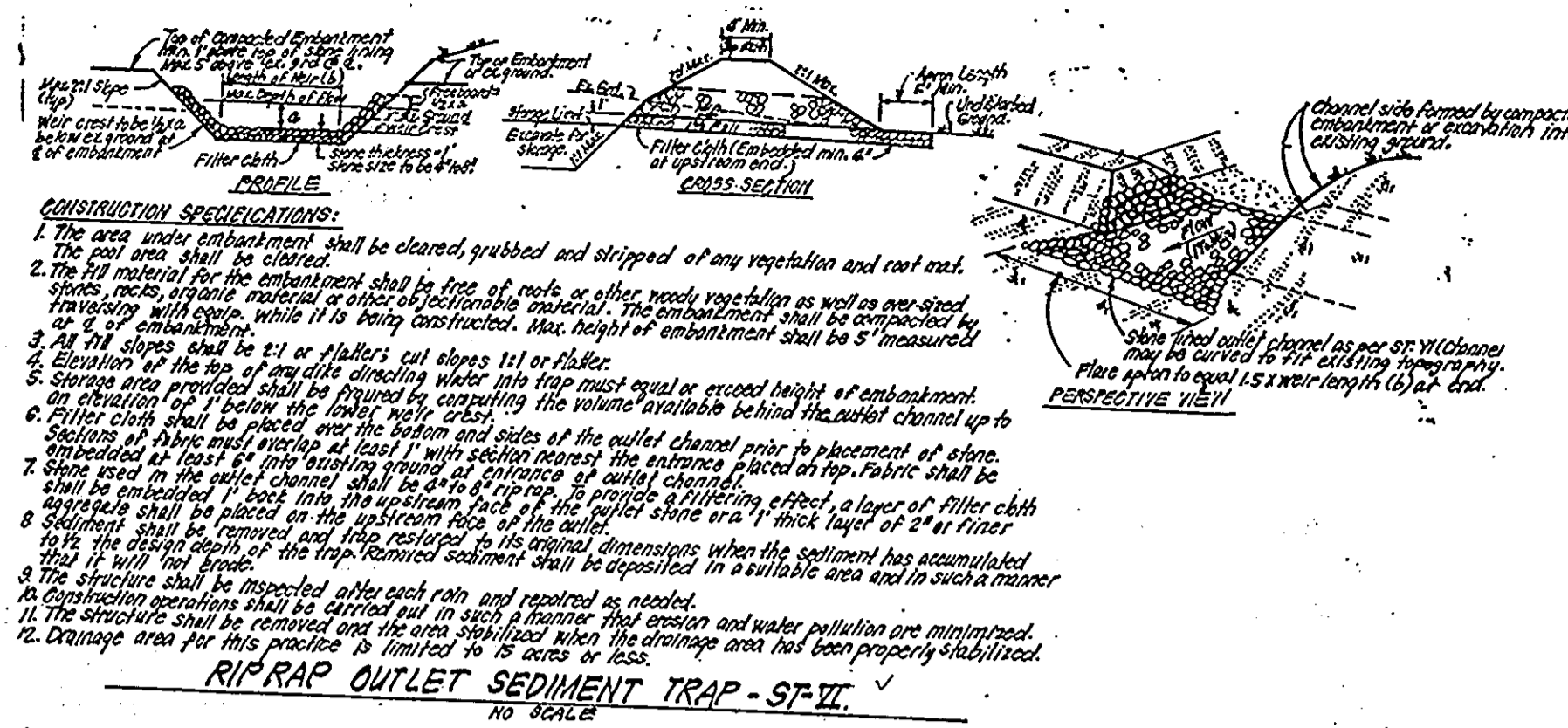
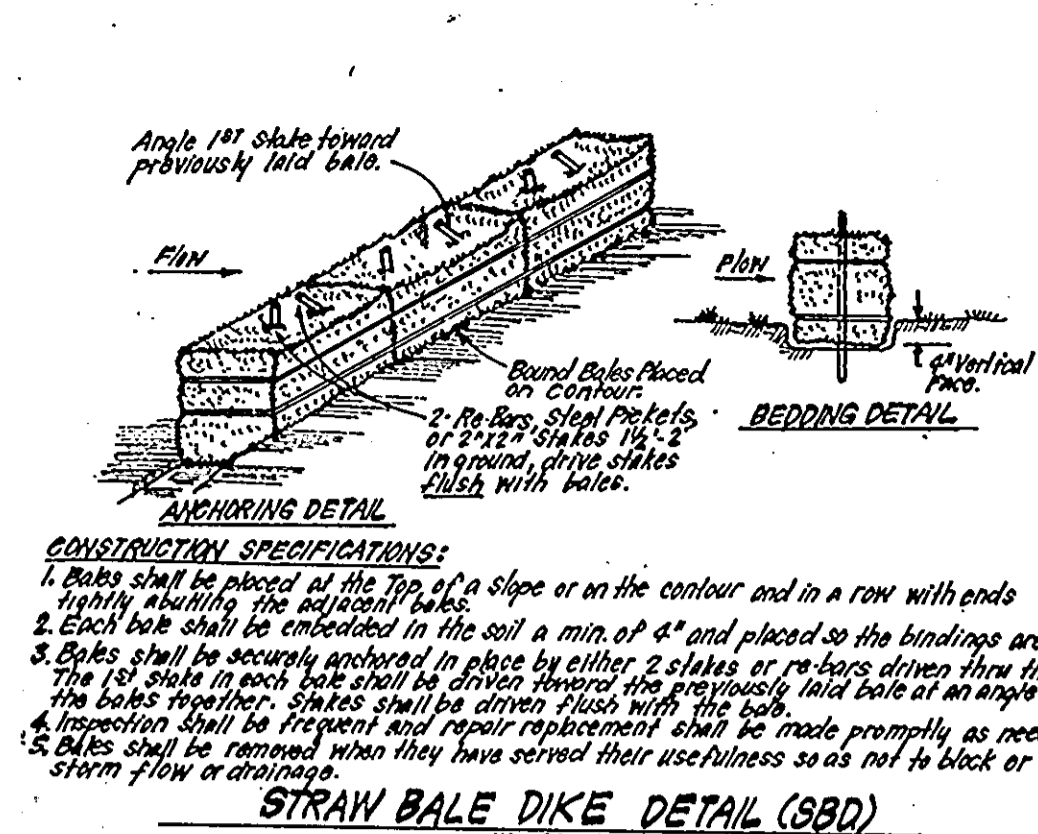

SEDMIMENT CONTROL NOTES:

- A minimum of 24 hours notice must be given to the Howard County Office of Inspection and Permitting prior to the start of any construction. (992-2437)
- All vegetative and structural practices are to be installed according to the provisions of this plan and are to be in conformance with the 1983 MARYLAND STANDARDS AND SPECIFICATIONS FOR SOIL EROSION AND SEDIMENT CONTROL.
- Following initial soil disturbance or redistribution, permanent or temporary stabilization shall be completed within: a) 7 calendar days for all perimeter sediment control structures, dikes, perimeter sediment control structures, dikes, perimeter slopes and all slopes greater than 2:1, b) 14 days as to all other disturbed or graded areas on the project site.
- All sediment traps/basins shown must be fenced and warning signs posted around their perimeter in accordance with Vol. 1, Chapter 12, of the HOWARD COUNTY DESIGN MANUAL, Storm Drainage.
- All disturbed areas must be stabilized within the time period specified above in accordance with the 1983 MARYLAND STANDARDS AND SPECIFICATIONS FOR SOIL EROSION AND SEDIMENT CONTROL for permanent seedings (Sec. 51) sod (Sec. 54), temporary seedings (Sec. 50) and mulching (Sec. 52). Temporary stabilization with mulch alone can only be done when recommended seeding dates do not allow for proper germination and establishment of grasses.
- All sediment control structures are to remain in place and are to be maintained in operative condition until permission for their removal has been obtained from the Howard County Sediment Control Inspector.
- Site Analysis:
 - Total Area of Site: 11.65 Acres
 - Area Disturbed: 11.36 Acres
 - Area to be roofed or paved: 4.30 Acres
 - Area to be vegetatively stabilized: 7.06 Acres
 - Total Cut: 38,270 Cu. Yds
 - Total Fill: 28,200 Cu. Yds
 - Offsite waste/borrow area location: N/A
- Any sediment control practice which is disturbed by grading activity for placement of utilities must be repaired on the same day of disturbance.
- Additional sediment control must be provided, if deemed necessary by the Howard County Sediment Control Inspector.
- On all sites with disturbed areas in excess of 2 acres, approval of the inspection agency shall be requested upon completion of installation of perimeter erosion and sediment controls, but before proceeding with any other earth disturbance or grading. Other building or grading inspection approvals may not be authorized until this initial approval by the inspection agency is made.
- If houses are to be constructed on an "As-Built" basis, at random, Single Lot Sediment Control as shown below shall be implemented. N/A
- All pipes to be blocked at the end of each day (see detail below).
- The total amount of straw bale dikes/silt fence equals 255 L.F.

PERMANENT SEEDING NOTES:

- Apply to graded or cleared areas not subject to immediate further disturbance where a permanent long-lived vegetative cover is needed.
- Seedbed Preparation:** Loosen upper three inches of soil by raking, discing or other acceptable means before seeding.
- Soil Amendments:** In lieu of soil test recommendations, use one of the following schedules:
- Preferred - Apply 2 tons per acre dolomitic limestone (92 lbs/1000 square ft) and 600 lbs per acre 10-10-10 fertilizer (14 lbs/1000 sq ft) before seeding. Harrow or disc into upper three inches of soil. At time of seeding, apply 400 lbs per acre 30-0-0 urethane fertilizer (9 lbs/1000 sq ft).
 - Acceptable - Apply 2 tons per acre dolomitic limestone (92 lbs/1000 sq ft) and 1000 lbs per acre 10-10-10 fertilizer (23 lbs/1000 sq ft) before seeding. Harrow or disc into upper three inches of soil.
- Seeding -** For the periods March 1 thru April 30, and August 1 thru October 15, seed with 60 lbs per acre (1.4 lbs/1000 sq ft) of Kentucky 31 Tall Fescue. For the period May 1 thru July 31, seed with 60 lbs Kentucky 31 Tall Fescue per acre and 2 lbs per acre (.05 lbs/1000 sq ft) of weeping lovegrass. During the period of October 16 thru February 28, protect site by: Option (1) 2 tons per acre of well anchored straw mulch and seed as soon as possible in the spring. Option (2) Use sod. Option (3) Seed with 60 lbs/acre Kentucky 31 Tall Fescue seed mulch with 2 tons/acre well anchored straw.
- Mulching -** Apply 1 1/2 to 2 tons per acre (70 to 90 lbs/1000 sq ft) of untreated small grain straw immediately after seeding. Anchor mulch immediately after application using mulch anchoring tool or 218 gallons per acre (5 gal/1000 sq ft) of emulsified asphalt on flat areas. On slopes 8 feet or higher, use 348 gallons per acre (8 gal/1000 sq ft) for anchoring.
- Maintenance -** Inspect all seeded areas and make needed repairs, replacements and reseeding.
- TEMPORARY SEEDING NOTES:**
- Apply to graded or cleared areas likely to be redistributed where a short-term vegetative cover is needed.
- Seedbed Preparation:** Loosen upper three inches of soil by raking, discing or other acceptable means before seeding.
- Soil Amendments:** Apply 600 lbs per acre 10-10-10 fertilizer (14 lbs/1000 sq ft)
- Seeding:** For periods March 1 thru April 30 and from August 15 thru November 15, seed with 24 bushels per acre of annual ryegrass (3.2 lbs/1000 sq ft). For the period May 1 thru August 14, seed with 3 lbs per acre of weeping lovegrass (.07 lbs/1000 sq ft). For the period November 16 thru February 28, protect site by applying 2 tons per acre of well anchored straw mulch and seed as soon as possible in the spring, or use sod.
- Mulching:** Apply 1 1/2 to 2 tons per acre (70 to 90 lbs/1000 sq ft) of untreated small grain straw immediately after seeding. Anchor mulch immediately after application using mulch anchoring tool or 218 gal per acre (5 gal/1000 sq ft) of emulsified asphalt on flat areas. On slopes, 8 ft or higher, use 348 gal per acre (8 gal/1000 sq ft) for anchoring.
- Refer to the 1983 MARYLAND STANDARDS AND SPECIFICATIONS FOR SOIL EROSION AND SEDIMENT CONTROL for rate and methods not covered.

CONSTRUCTION SEQUENCE:

	NO. OF DAYS
1. Obtain Grading Permit.	2
2. Construct Sediment & Erosion Control Measures.	14
3. Clear & Rough Grade Site.	14
4. Construct Storm Drainage System Temp End 18" RCP From Str. M-2A to S-1 Where Shown In Plan.	30
5. Construct Utilities.	12
6. Fine Grade and Construct Paving, Sidewalks and Buildings.	180
7. Fine Grade and Stabilize All Other Disturbed Areas Onsite In Accordance With Standards and Specs.	30
8. Upon Approval of the Sediment Control Inspector Remove Sediment & Erosion Control Measures and Stabilize and Construct Remaining Storm Drainage.	14

REVIEWED FOR HOWARD SOIL CONSERVATION DISTRICT AND MEETS TECHNICAL REQUIREMENT.

Signature: [Signature] DATE: 1-9-87

U.S. SOIL CONSERVATION SERVICE

This Development Plan is approved for Soil Erosion and Sediment Control by the Howard Soil Conservation District.

APPROVED: [Signature] DATE: 1/9/87

Howard S.C.D.

APPROVED FOR PUBLIC WATER AND PUBLIC SEWERAGE SYSTEMS, HOWARD COUNTY HEALTH DEPARTMENT

Signature: [Signature] DATE: 1-14-87

APPROVED: HOWARD COUNTY OFFICE OF PLANNING & ZONING

Signature: [Signature] DATE: 1-14-87

Signature: [Signature] DATE: 1-14-87

APPROVED FOR PUBLIC WATER AND PUBLIC SEWERAGE, STORM DRAINAGE SYSTEMS AND PUBLIC ROADS HOWARD COUNTY DEPARTMENT OF PUBLIC WORKS

Signature: [Signature] DATE: 1-13-87

Signature: [Signature] DATE: 1-13-87

APPROVED

PLANNING BOARD OF HOWARD COUNTY

DATE: 11-12-86

[Signature]

DEVELOPER'S/BUILDER'S CERTIFICATE

"I/We certify that all development and construction will be done according to this plan of development and plan for erosion and sediment control and that all responsible personnel involved in the construction project will have a Certificate of Attendance at a Dept. of Natural Resources Approved Training Program for the Control of Sediment and Erosion before beginning the project. I also authorize periodic on-site inspection by the Howard Soil Conservation District or their authorized agents, as are deemed necessary."

Signature: [Signature] DATE: 10-7-86

ENGINEER'S CERTIFICATE

I hereby certify that this plan for Erosion and Sediment Control represents a practical and workable plan based on my personal knowledge of the site conditions and that it was prepared in accordance with the requirements of the Howard Soil Conservation District.

Signature: [Signature] DATE: 10-7-86

OWNER: The Howard Research & Development Corporation
10275 Little Patuxent Parkway
Columbia, Md. 21044

CLARK • FINEFROCK & SACKETT
ENGINEERS • PLANNERS • SURVEYORS

13115 LOCKWOOD DRIVE SILVER SPRING, MARYLAND 20904 (301) 593-3400

DESIGNED: [Signature] DATE: 10-7-86

DRAWN: [Signature] DATE: 10-7-86

CHECKED: [Signature] DATE: 10-7-86

DATE: 10-7-86

SEDIMENT & EROSION CONTROL DETAILS
PARCEL A-2

COLUMBIA
VILLAGE OF DORSEY'S SEARCH SECTION 3 AREA 1
5TH ELECTION DISTRICT HOWARD COUNTY, MARYLAND

FOR: SHELTER DEVELOPMENT CORP.
Suite 500 Park Charles Bldg. 218 N. Charles St. Baltimore, Maryland 21201

SCALE: 1" = 30'

DRAWING: 70-9

JOB NO.: 85-139

FILE NO.: 85-139 SE

SDP-87-76c

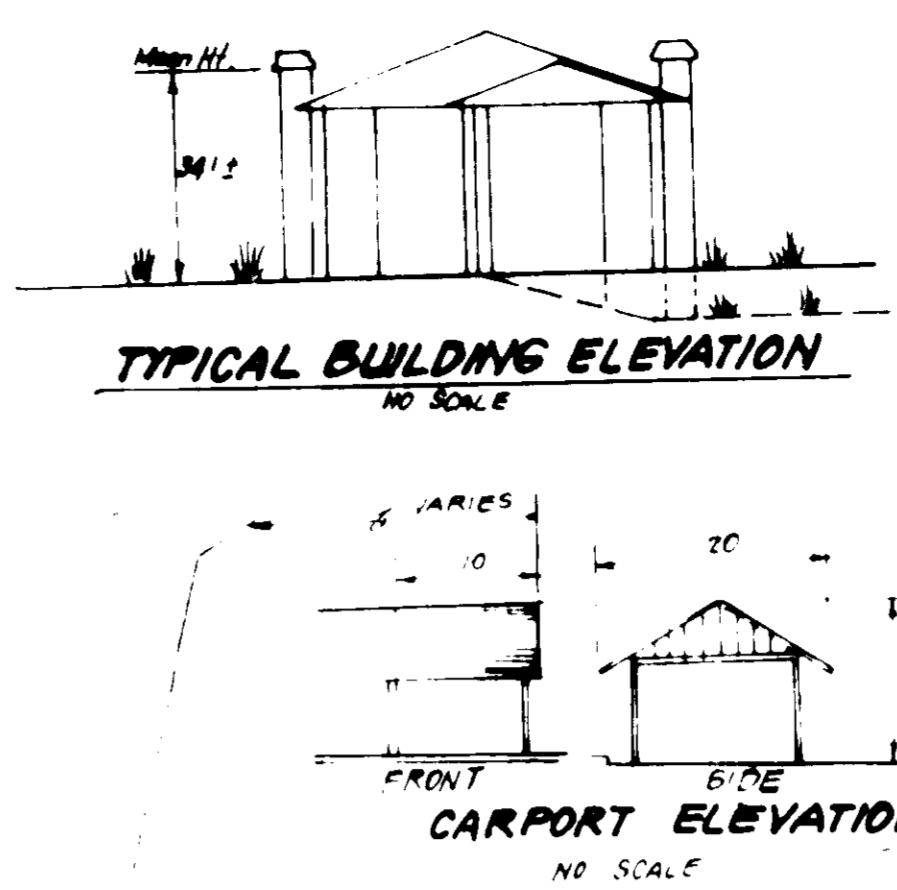
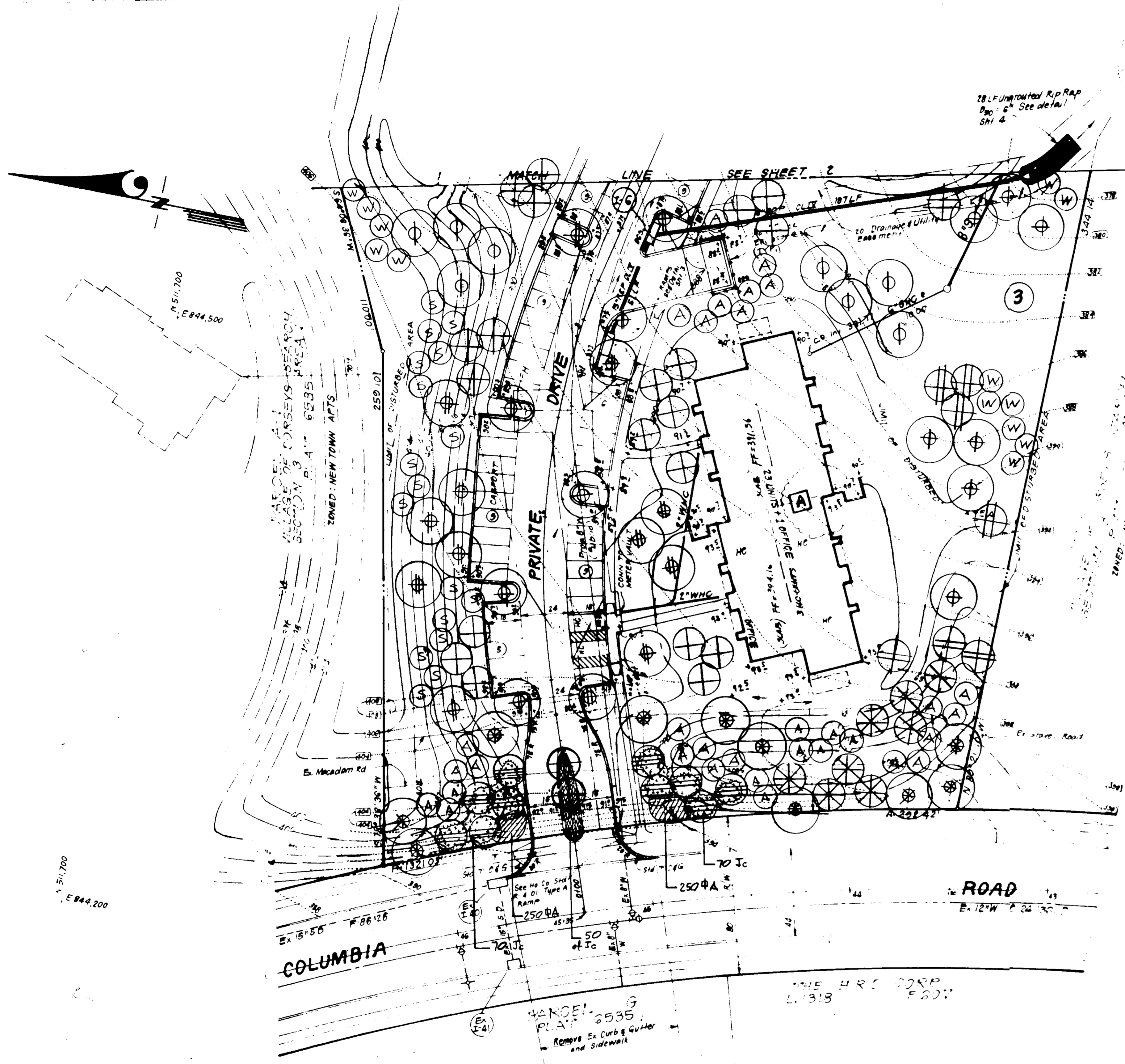

PLANT SCHEDULE

KEY	PLANT NAME	SIZE	QUANT	REMARKS
⊕	ACER RUBRUM 'RED SUNSET' RED SUNSET MAPLE	2 1/2-3" CAL 12-14' HT	54	B & B HEAVY HEADS
⊗	ZELKOVA SERR. 'VILLAGE GREEN' VILLAGE GREEN ZELKOVA		10	
⊕	QUERCUS PALUSTRIS PIN OAK		41	
⊕	ACER SACCHARUM 'GREEN MOUNTAIN' GREEN MOUNTAIN SUGAR MAPLE		108	
⊕	QUERCUS ACUTISSIMA SAWTOOTH OAK		12	
⊕	PRUNUS CER. 'THUNDERCLOUD' PURPLELEAF FLOWERING PLUM	2-2 1/2" CAL 8-10' HT	26	B & B HEAVY HEADS
⊕	MALUS 'PROFUSION' PROFUSION CRAB		35	
⊗	CRATAEGUS PHAEMOPYRUM WASHINGTON HAWTHORN		8	
⊕	PRUNUS SERR. 'KWANZAN' KWANZAN CHERRY		87	
⊕	AMELANCHIER CANDENSIS SHADBLOW SERVICEBERRY		29	B & B HEAVY CLUMPS
⊕	PINUS NIGRA AUSTRIAN PINE	6'-8' HT	107	B & B HEAVY HEADS
⊕	PICEA ECIELSA NORWAY SPRUCE	6'-8' HT	54	
⊕	PINUS STROBUS EASTERN WHITE PINE	6'-8' HT	67	
Ah	AZALEA HERSHEY RED HERSHEY RED AZALEA	15-18"	47	BIB HEAVY
Ad	AZALEA DELAWARE VALLEY WHITE DEL. VALLEY WHITE AZALEA	15-18"	7	
Bp	BERBERIS GADVINEUSIS 'WM. PENN' WM PENN BARBERRY	15-18"	16	
Ch	COTONEASTER APICULATA CRABAPPLE COTONEASTER	15-18"	255	
Cs	COTONEASTER SALIC. REPEHS PARK CARPET COTONEASTER	15-18"	82	
Ea	EUONYMUS ALATUS COMPACTUS COMPACT WINGED EUONYMUS	24-30"	29	
Es	EUONYMUS SIEBOLDIANUS SIEBOLD EUONYMUS	24-30"	35	
Fs	FORSYTHIA SUSPENSIA WEEPING FORSYTHIA	2-3'	68	
Ih	ILEX CRENATA HELLERI DWARF JAP. HOLLY	15-18"	24	
Jc	JUNIPERUS CONFERTA BLUE PACIFIC BLUE PACIFIC JUNIPER	15-18"	190	
Jpc	JUNIPERUS FITZGERIANA COMPACTA COMPACT FITZGER JUNIPER	24-30"	54	
Jgc	JUNIPERUS GOLD COAST GOLD COAST JUNIPER	18-24"	54	
Js	JUNIPERUS SARGENTI SARGENT JUNIPER	18-24"	78	
Td	TAXUS CUSPIDATA PENSIFORMIS DELISE SPREAD JAP. YEW	18-24"	56	
Tr	TAXUS S. REPANDANSE SPREADING ENGLISH YEW	18-24"	4	
Vr	VIBURNUM RHYTIDOPHYLLUM LEATHER LEAF VIBURNUM	3-4' HT.	73	
Ig	ILEX GREEN LUSTRE SPREADING JAPANESE HOLLY	15-18"	37	
A	ANNUALS		660*	TIGHTLY MASSES BEDS

NOTE: • ALL PLANTING SHALL COMPLY W/ COLUMBIA HRD PLANTING SPECS.
• CONTRACTOR SHALL VERIFY THE LOCATION OF UNDERGROUND UTILITIES BEFORE DIGGING.

APPROVED: FOR PUBLIC WATER AND PUBLIC SEWERAGE SYSTEMS,
HOWARD COUNTY HEALTH DEPARTMENT
[Signature] DATE 1-14-87

APPROVED: HOWARD COUNTY OFFICE OF PLANNING & ZONING
[Signature] DATE 1-14-87

APPROVED: FOR PUBLIC WATER AND PUBLIC SEWERAGE,
STORM DRAINAGE SYSTEMS AND PUBLIC ROADS
HOWARD COUNTY DEPARTMENT OF PUBLIC WORKS
[Signature] DATE 1-13-87

APPROVED
PLANNING BOARD
OF HOWARD COUNTY
DATE 11-12-86
[Signature]

CLARK • FINEFROCK & SACKETT
ENGINEERS • PLANNERS • SURVEYORS
11315 LOCKWOOD DRIVE SILVER SPRING, MARYLAND 20904

DESIGNED: KBN
DRAWN: KMF
CHECKED: WHT
DATE: 12-29-86

LANDSCAPE PLANTING PLAN
PARCEL A-2
COLUMBIA
VILLAGE OF DORSEY'S SEARCH
SECTION 3 AREA 1
5TH ELEC. DIST. HOWARD COUNTY MD.
FOR: SHELTER DEVELOPMENT CORP. LTD.
*500 PARK CHARLES BLVD., 218 CHARLES ST.
BALTIMORE MD. 21201

SCALE: 1"=30'
DRAWING: 8 of 9
JOB NO: 85-139
FILE NO: 85-139

SDP-87-76c

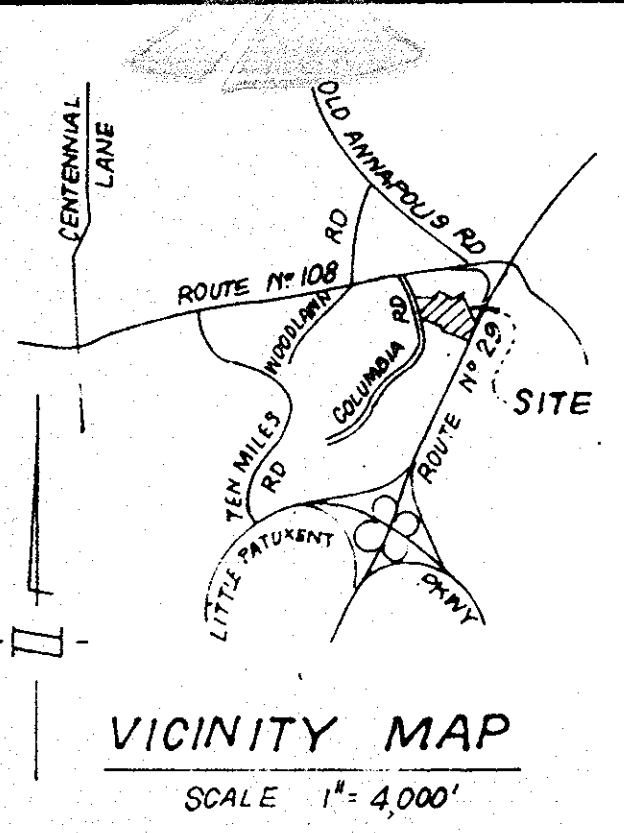

S.B. RAMP
ROUTE No 108
 MSHA PLAT # 34870 & 33871

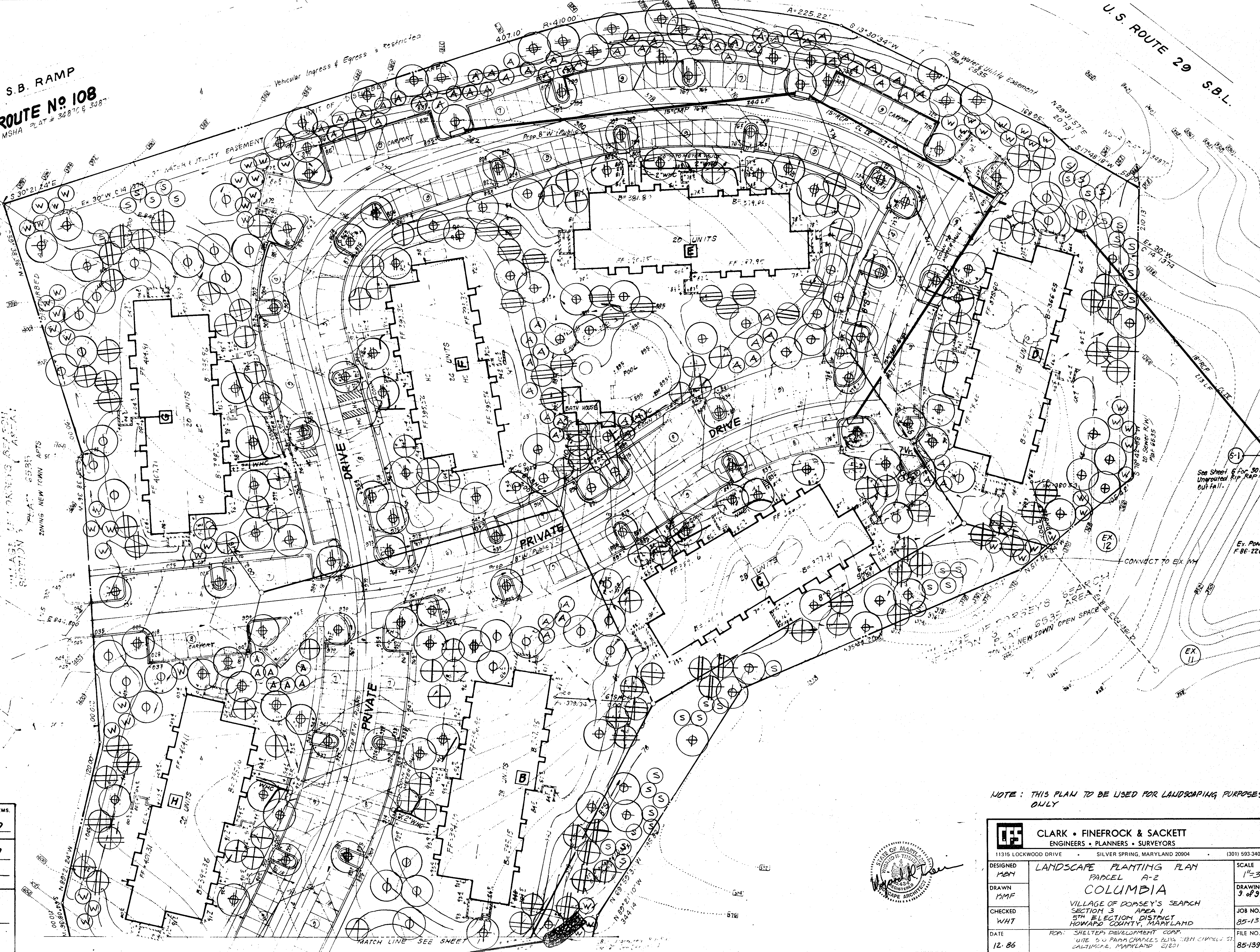
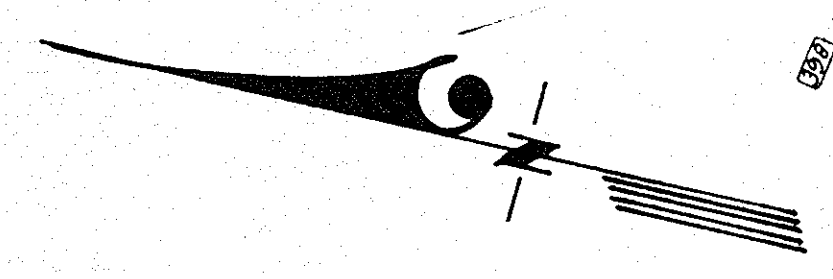

APPROVED
 PLANNING BOARD
 OF HOWARD COUNTY
 DATE **11-12-86**
[Signature]

APPROVED: FOR PUBLIC WATER AND PUBLIC SEWERAGE SYSTEMS. HOWARD COUNTY HEALTH DEPARTMENT	<i>[Signature]</i>	1-14-87
COUNTY HEALTH OFFICER		DATE
APPROVED: HOWARD COUNTY OFFICE OF PLANNING & ZONING	<i>[Signature]</i>	1-14-87
PLANNING DIRECTOR		DATE
APPROVED: CHIEF DIVISION OF LAND DEVELOPMENT AND ZONING ADMINISTRATION	<i>[Signature]</i>	1-14-87
		DATE
APPROVED: FOR PUBLIC WATER AND PUBLIC SEWERAGE, STORM DRAINAGE SYSTEMS AND PUBLIC ROADS HOWARD COUNTY DEPARTMENT OF PUBLIC WORKS	<i>[Signature]</i>	1-13-87
DIRECTOR		DATE
APPROVED: CHIEF ENGINEER	<i>[Signature]</i>	1-13-87
		DATE

NOTE: THIS PLAN TO BE USED FOR LANDSCAPING PURPOSES ONLY



CLARK • FINEROCK & SACKETT ENGINEERS • PLANNERS • SURVEYORS		(301) 593-3400
11315 LOCKWOOD DRIVE • SILVER SPRING, MARYLAND 20904		
DESIGNED BMH	LANDSCAPE PLANTING PLAN PARCEL A-2 COLUMBIA VILLAGE OF DOPSEY'S SEARCH SECTION 3 AREA 1 5TH ELECTION DISTRICT HOWARD COUNTY, MARYLAND POP: SHELTERS DEVELOPMENT CORP. UITE 50 PAPA CHARLES PLNS 1181 CHAMBERS ST. CALTICHOPE, MARYLAND 21011	SCALE 1"=30'
DRAWN DMF		DRAWING 3 of 3
CHECKED WHT		JOB NO. 85-139
DATE 12-86		FILE NO. 85-139 LS
SDP-87-76c		