

- SEQUENCE OF OPERATION**
1. NOTIFY HOWARD COUNTY DEPARTMENT OF NATURES, HERITAGE & FORESTRY 48 HOURS PRIOR TO BEGINNING WORK.
 2. CLEAR AND GRUB EXISTING EXISTING MEASURES.
 3. INSTALL STABILIZED CONSTRUCTION ENTRANCE AND STRAW BALE BARRIERS.
 4. REMOVE EXISTING CURB AND GUTTER AS SHOWN AND START GRADING.
 5. FINE GRADE AND INSTALL SUBBASE MATERIAL IN PARKING AREA AS SOON AS POSSIBLE.
 6. STABILIZE AREAS NOT RECEIVING DRAINAGE.
 7. AFTER DRAINAGE IS INSTALLED, PERFORM THE SEDIMENT CONTROL MEASURES AND STABILIZE.

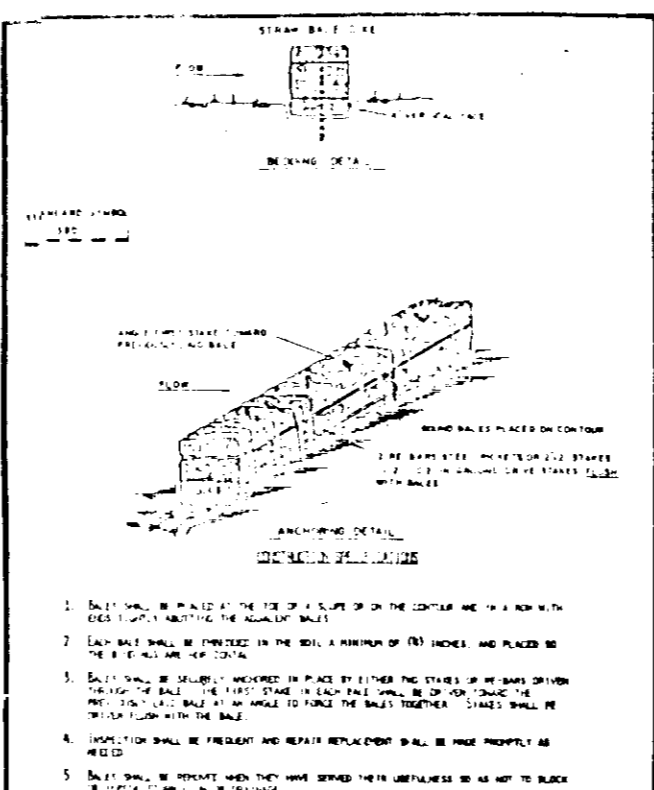

PERMANENT SEEDING NOTES

Apply to graded or cleared areas not subject to immediate further disturbance where a permanent vegetative cover is needed.

Seeding Preparation: Loosen upper three inches of soil by raking, disking or other acceptable means before seeding.

Soil Amendments: In lieu of soil test recommendations, use one of the following amendments:

1. Fertilizer - Apply 2 tons per acre of 10-10-10 fertilizer (10 lbs/1000 sq ft) with 90 lbs per acre of 10-10-10 fertilizer (10 lbs/1000 sq ft) before seeding.
2. Acceptable - Apply 2 tons per acre of 10-10-10 fertilizer (10 lbs/1000 sq ft) and 2000 lbs per acre of 10-10-10 fertilizer (10 lbs/1000 sq ft) before seeding.

Seeding: For periods March 1 thru April 30, and August 1 thru October 31, seed with 25 lbs/acre of 10-10-10 fertilizer (10 lbs/1000 sq ft) of Kentucky 31 Tall Fescue per acre and 2 lbs per acre of 10-10-10 fertilizer (10 lbs/1000 sq ft) of seeding legume. During the period of October 1 thru February 28, plant site by Option (1) 2 tons per acre of well-rotted straw mulch and seed with 25 lbs/acre of 10-10-10 fertilizer (10 lbs/1000 sq ft) of Kentucky 31 Tall Fescue and mulch with 1 ton/acre well-rotted straw.

Mulching: Apply 1/4 to 2 tons per acre (70 to 80 lbs/1000 sq ft) of untreated small grain straw immediately after seeding. Anchor mulch immediately after application using mulch anchoring tool of 210 gal per acre (5 gal/1000 sq ft) of mulch/anchoring liquid on flat areas. On slopes 8 feet or higher, use 1/2 gallon per sq ft (8 gal/1000 sq ft) for anchoring.

Maintenance: Inspect all seeded areas and make needed repairs, replacements and coverings.

TEMPORARY SEEDING NOTES

Apply to graded or cleared areas likely to be reburied where a short-term vegetative cover is needed.

Seeding Preparation: Loosen upper three inches of soil by raking, disking or other acceptable means before seeding.

Soil Amendments: Apply 600 lbs per acre 10-10-10 fertilizer (14 lbs/1000 sq ft).

Seeding: For periods March 1 thru April 30 and from August 15 thru November 15, seed with 25 lbs/acre of annual ryegrass (3.2 lbs/1000 sq ft). For the period May 1 thru August 14, seed with 3 lbs per acre of seeding legume (0.3 lbs/1000 sq ft). For the period November 15 thru February 28, plant site by applying 2 tons per acre of well-rotted straw mulch and seed as soon as possible in the spring of the next year.

Mulching: Apply 1/4 to 2 tons per acre (70 to 80 lbs/1000 sq ft) of untreated small grain straw immediately after seeding. Anchor mulch immediately after application using mulch anchoring tool of 210 gal per acre (5 gal/1000 sq ft) of mulch/anchoring liquid for anchoring. On slopes 8 ft or higher, use 3/4 gal per acre (8 gal/1000 sq ft) for anchoring.

Refer to the 1983 MARYLAND STANDARDS AND SPECIFICATIONS FOR SOIL EROSION AND SEDIMENT CONTROL for rates and methods not covered.

- GENERAL NOTES:**
1. All areas not being paved or receiving building coverage shall be stabilized in accordance with the plans approved by Howard Soil Conservation District.
 2. Any damage to public rights-of-way and/or adjacent properties shall be repaired immediately at the contractor's expense.
 3. The contractor shall maintain at least a 2" level bench behind all curb and gutter in fill areas.
 4. The contractor shall verify all existing utilities to his satisfaction before starting construction.
 5. All slopes shall be 2:1 or flatter.
 6. All work shall be done in accordance with Howard County Standard Specifications and Details for Construction, or as shown on these plans.
 7. The contractor shall notify the Gas Telephone Co. and the Gas and Electric Company five days prior to starting work shown on these plans as "Utility". Call collect 1-559-0100.
 8. For details of ramps and signs for the handicapped see the Maryland Building Code for the Handicapped and Aged and as shown hereon. See Sheet of the contractor shall maintain a minimum of 4' cover over all proposed utility lines.
 9. All tarp shall be placed on filter mat.
 10. The contractor or developer shall submit the Construction Inspection/Supervision Report 24 hours in advance of commencement of work at 992-2419 or 792-7272.
 11. The contractor shall remove all existing paving, curb and gutter, etc. that may interfere with proposed construction and shall be replaced in-kind as required.
 12. All utilities installed shall receive full trench completion.

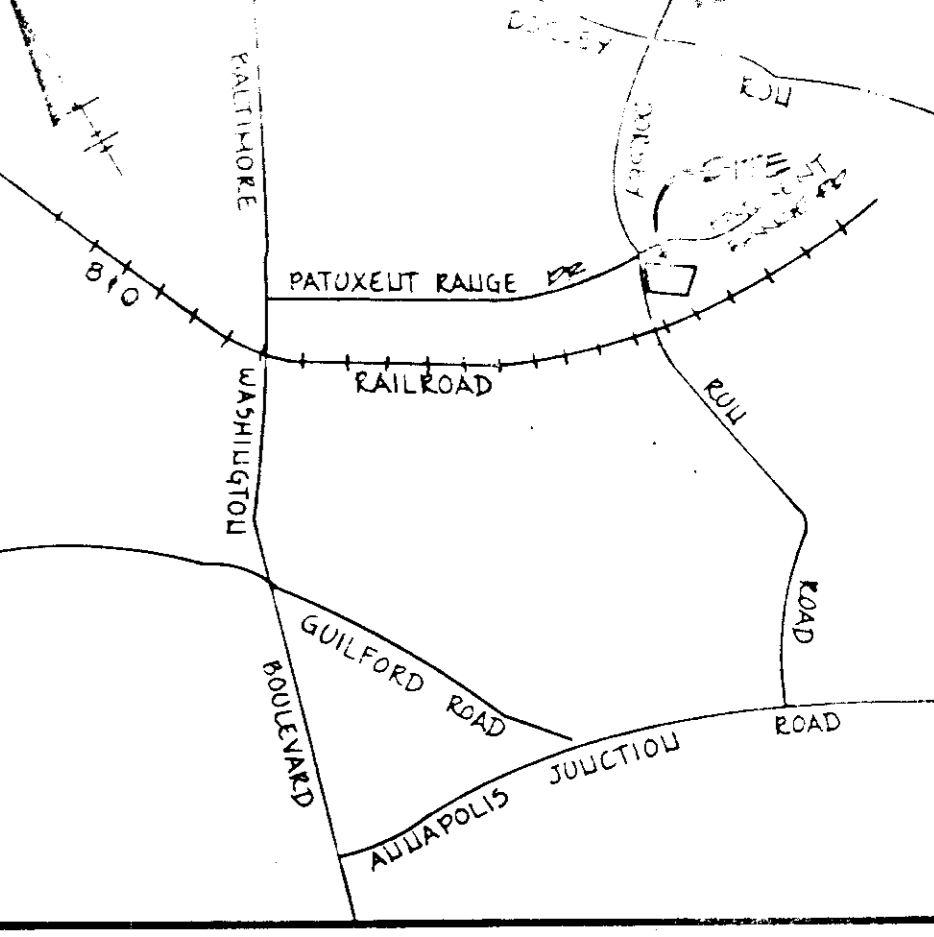

LOCATION MAP
SCALE: 1" = 2000'

- LEGEND**
- EX. EXISTING CURB AND GUTTER
 - EX. EXISTING DRIVE
 - EX. EXISTING SIDEWALK
 - EX. EXISTING BASEMENTS
 - EX. EXISTING FOUNDATION
 - EX. EXISTING UTILITY
 - EX. EXISTING FIRE HYDRANTS
 - PROP. NO. OF PARKING SPACES (7)
 - PROP. PAVING
 - UNIT OF DISTURBANCE
 - STRAW BALE BARRIERS
 - STABILIZED CONSTRUCTION ENTRANCE

SITE DATA

AREA OF SITE - 5876 AC
EX. FLOOR AREA - 87875 SFS
EX. USE - OFFICE/WAREHOUSE
PROPERTY REFERENCE - LOT #1, BLOCK 'D' PATUXENT PARK INDUSTRIAL AREA PLAT BOOK 5771

ADDITIONAL PARKING PROVIDED - 27 SP.
AREA TO BE DISTURBED - 35284 SF / 0.81 AC
AREA TO BE VEGETATIVELY STABILIZED - 6070 SF / 0.16 AC

AREA OF SUBMITTAL - 35284 SF / 0.81 AC
EX. ZONING - M-2
AREA OF PROP. PARKING (PAVING) - 13,500 SF
AREA OF PROP. LANDSCAPING FOR PARKING - 750 SF
PERCENTAGE OF LANDSCAPING - 750 / 13,500 = 5.56%
AREA OF BUILDING & PAVING - 4,932 AC
AREA OF OPEN SPACE - 1,401 AC
PERCENTAGE OF OPEN SPACE - 1,401 / 5876 = 23.84%

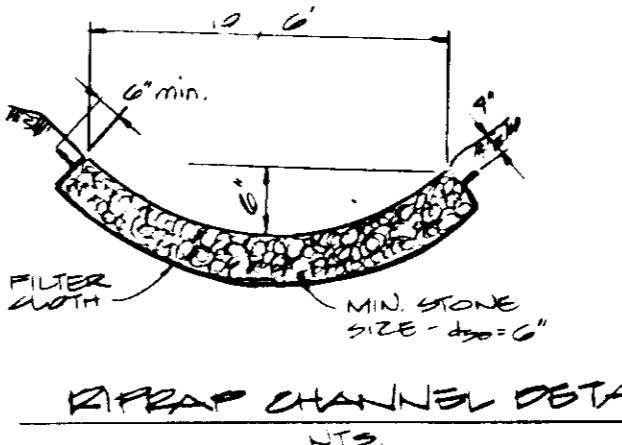

DETAIL OF RIPRAP CHANNEL

Relevant Width Indicated On Typical Street Sections To Be Measured To This Point.

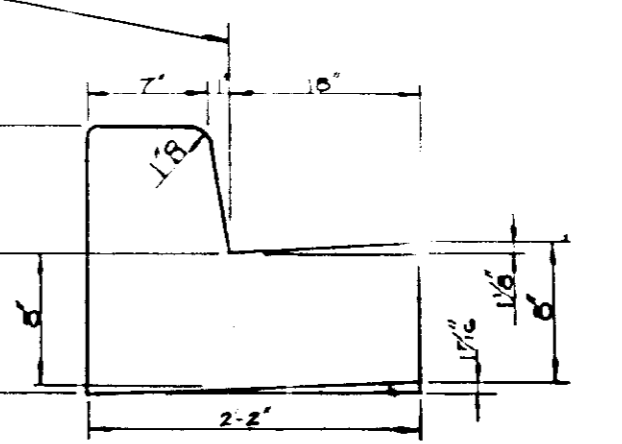

STANDARD T' COMBINATION CURB AND GUTTER HOWARD COUNTY STD. DETAIL R 301

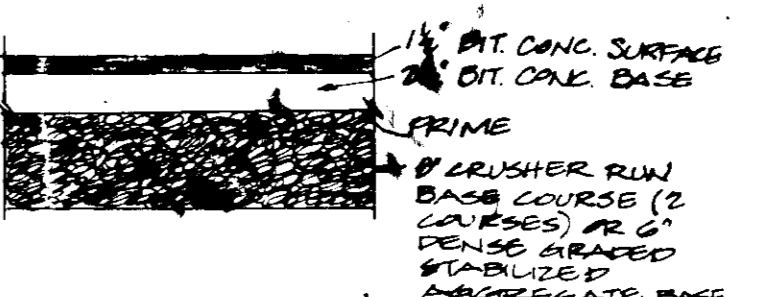

PAVING SECTION HOWARD COUNTY STD. DETAIL R 2.01 NOT TO SCALE

HOWARD SOIL CONSERVATION DISTRICT
THE DEVELOPMENT AND CONSTRUCTION OF THIS PROJECT SHALL BE IN ACCORDANCE WITH THE DISTRICT'S SOIL CONSERVATION DISTRICT PLAN.
Stephen R. Huber 8/29/86

REVIEWED PER HOWARD SOIL CONSERVATION DISTRICT MEETING TECHNICAL REQUIREMENTS.
James M. Velt 8/29/86

APPROVED: FOR PUBLIC WATER AND PUBLIC WASTE SYSTEMS AND PUBLIC USES.
James M. Velt 9-4-86

APPROVED: HOWARD COUNTY OFFICE OF PLANNING AND ZONING.
John W. Hunsicker 9-5-86
James F. Down 9-5-86

APPROVED: FOR PUBLIC WATER AND PUBLIC WASTE SYSTEMS AND PUBLIC USES.
John W. Hunsicker 9-5-86
James F. Down 9-5-86

SITE AND SEDIMENT & EROSION CONTROL PLAN
(PAVING AND OPENING EXPANSION)
TRANSIT STORAGE OFFICE / WAREHOUSE
8215 PROBERT RUN ROAD
LOT NO. 1, BLOCK 'D'
PATUXENT PARK INDUSTRIAL AREA
HOWARD COUNTY, MARYLAND
SCALE: 1" = 2000'
DATE: 7-30-86
BY: SDP

ADDRESS SHEET	LOT NUMBER	STREET ADDRESS
	1	8215 PROBERT RUN ROAD

GEORGE WILLIAM STEPHENS, JR. AND ASSOCIATES, INC.
CIVIL ENGINEERS & LAND SURVEYORS
303 ALLEGHENY AVENUE
TOWSON, MARYLAND 21204
(301) 825-8120

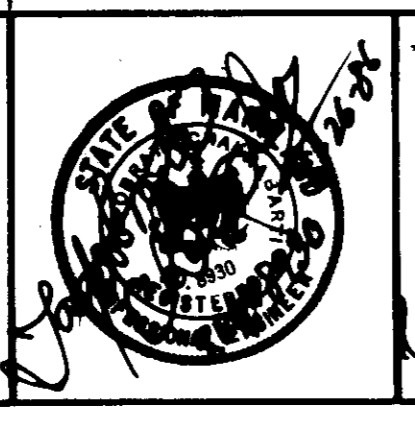

ENGINEER'S CERTIFICATE
I CERTIFY THAT THIS PLAN FOR SEDIMENT & EROSION CONTROL REPRESENTS A PRACTICAL AND WORKABLE PLAN BASED ON MY PERSONAL KNOWLEDGE OF THE SITE CONDITIONS. THIS PLAN WAS PREPARED IN ACCORDANCE WITH THE REQUIREMENTS OF THE SITE CONDITIONS THIS PLAN WAS PREPARED IN ACCORDANCE WITH THE REQUIREMENTS OF THE HOWARD SOIL CONSERVATION DISTRICT.
George William Stephens, Jr. 8930 6-26-86
STAMPED: TAPORATA CHAKRABARTI

OWNER/DEVELOPER
10215 PROBERT RUN RD LIMITED PARTNERSHIP
50 TRANSIT STORAGE CO.
3101 WASHINGTON BLVD
BETHESDA, MD 20830
301-644-7000

DEVELOPER'S CERTIFICATE
I CERTIFY THAT ALL DEVELOPMENT AND/OR CONSTRUCTION WILL BE DONE ACCORDING TO THESE PLANS AND THAT ANY RESPONSIBLE PERSONNEL INVOLVED IN THE CONSTRUCTION PROJECT WILL HAVE A CERTIFICATE OF ATTENDANCE AT A COURSE OF NATIONAL REQUIREMENTS APPROVED TRAINING PROGRAM FOR THE CONTROL OF SEDIMENT & EROSION BEFORE BEGINNING THE PROJECT. I ALSO AUTHORIZE PERSONNEL ON-SITE INSPECTION BY THE HOWARD SOIL CONSERVATION DISTRICT OR THEIR AUTHORIZED AGENTS AND ARE PROMISED NECESSARY DEVIATION FROM THIS PLAN WILL NOT BE MADE UNLESS AUTHORIZED BY HOWARD SOIL CONSERVATION DISTRICT.
John F. Down 8/29/86
DEVELOPER: JOHN F. DOWN, GENERAL MANAGER

DESIGNED: JWS
DRAWN: MD/CAB
CHECKED: JF
REV. SHEETS:

SDP-86-286