

LEGEND:

- 1. Contour Interval 2 Ft
- 2. Existing Contour 150'
- 3. Proposed Contour 130'
- 4. Spot Elevation 130.5
- 5. Direction of Drainage
- 6. Existing Trees to be saved
- 7. Walk Out Basement

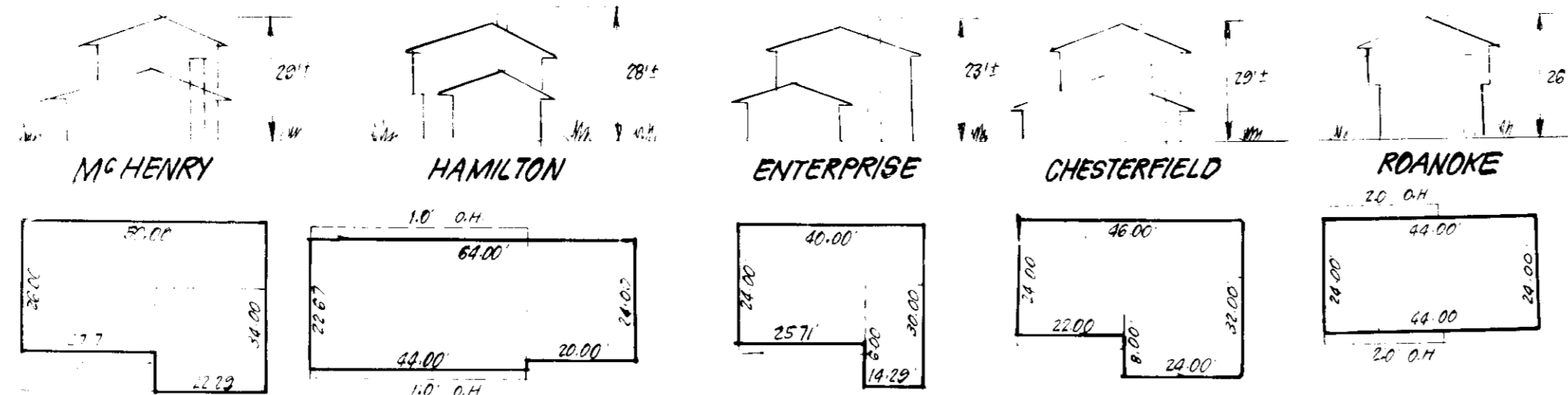

TYPICAL HOUSES
NO SCALE

GENERAL NOTES:

1. The land included in this plan is zoned New Town (SFMD)
2. The lots shown are covered by Final Development Plan Phase 178, Part II.
3. All coordinates are based on Howard County Geodetic Control Traverse which is based upon the Maryland State Plane Coordinate System.
4. The lots covered are located on Tax Map 42
5. The total area of this plan is 1.52 Acres
6. All roadways are public and existing.
7. Any damage to county owned rights-of-way or paving shall be corrected at the developer's expense.
8. For flag or pipeline lots, refuse collection, snow removal, and road maintenance are provided to the junction of the flag or pipeline and the road right-of-way line only, and not onto the flag or pipeline lot driveway.
9. The contractor or developer shall contact Construction Inspection Survey Division 24 hours in advance of commencement of work at 702-7272.

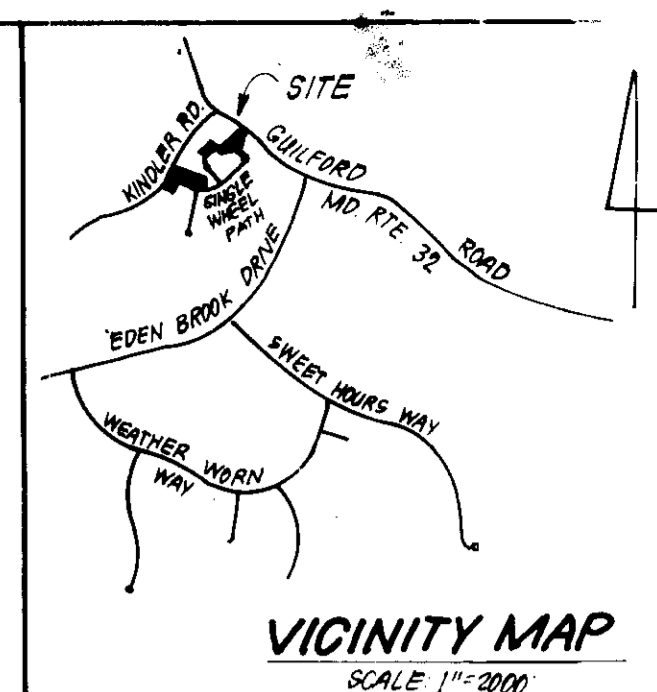

VICINITY MAP
SCALE 1"=200'

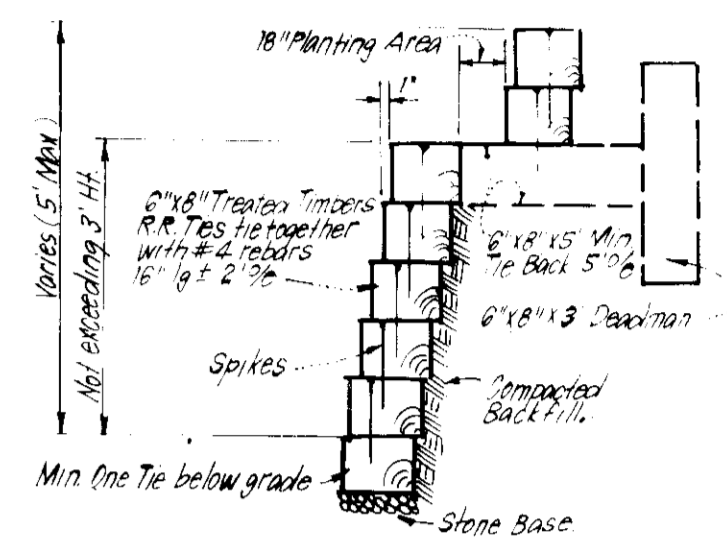

TYPICAL RETAINING WALL
NO SCALE

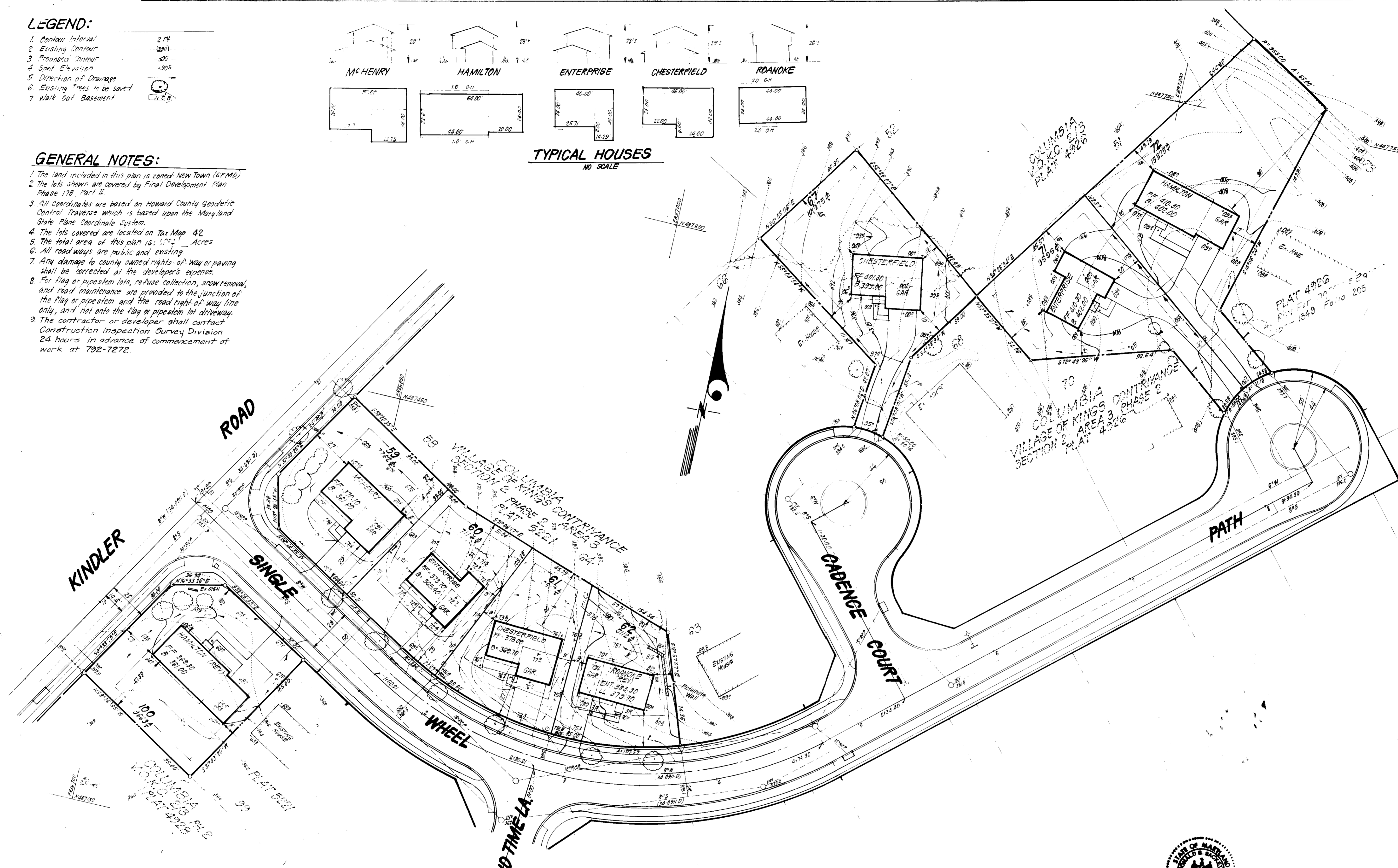

| Lot No | STREET ADDRESS |
|--------|------------------------|
| 59 | 7203 SINGLE WHEEL PATH |
| 60 | 7207 " " " " |
| 61 | 7211 " " " " |
| 62 | 7215 " " " " |
| 67 | 7228 CADENCE COURT |
| 71 | 7237 SINGLE WHEEL PATH |
| 72 | 7241 " " " " |
| 100 | 7202 " " " " |

| SUBDIVISION NAME | SECTION/AREA | LOT/PARCEL # |
|---------------------------|--------------|----------------------------|
| COLUMBIA V.O.K.C. PHASE 2 | 2/3 | 54, 62, 67, 71, 72 and 100 |
| PLAT 4926 & 5221 | 7 | W.E.M.D. 42 |
| WATER CODE | E/16 | ELEC. DIST. 6062 |
| | | SEWER CODE 635.0000 |

APPROVED FOR PUBLIC WATER AND PUBLIC SEWERAGE SYSTEMS
HOWARD COUNTY HEALTH DEPARTMENT
John P. Basso 6-4-85
DATE 6-4-85

APPROVED HOWARD COUNTY OFFICE OF PLANNING & ZONING
John Williams 6-5-85
DATE 6-5-85

APPROVED FOR PUBLIC WATER AND PUBLIC SEWERAGE
STORM DRAINAGE SYSTEMS AND PUBLIC ROADS
HOWARD COUNTY DEPARTMENT OF PUBLIC WORKS
John Williams 5-31-85
DATE 5-31-85

APPROVED
DIVISION OF LAND DEVELOPMENT & ZONING ADMINISTRATION
HOWARD COUNTY, MARYLAND
DATE 5-13-85
M. J. Mum

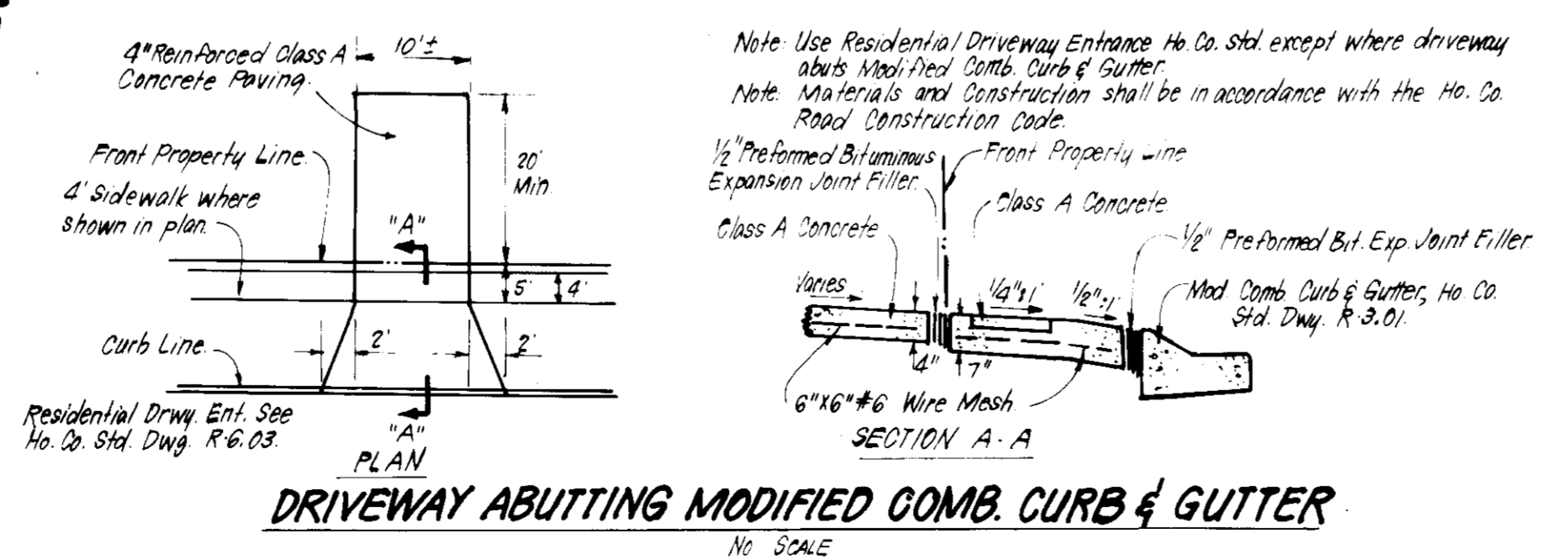

DRIVEWAY ABUTTING MODIFIED COMB. CURB & GUTTER
NO SCALE



CLARK · FINEFROCK & SACKETT
ENGINEERS · PLANNERS · SURVEYORS
11315 LOCKWOOD DRIVE · SILVER SPRING, MARYLAND 20904 · (301) 593-3400

DESIGNED: BAF
DRAWN: BAF
CHECKED: K/W
DATE: 5-12-85

SITE DEVELOPMENT PLAN
LOTS 59 THRU 62, 67, 71, 72, AND 100
COLUMBIA
VILLAGE OF KINGS CONTRIVANCE
SECTION 2 AREA 3 PHASE 2
6TH ELECTION DISTRICT
HOWARD COUNTY, MARYLAND

FOR: The Ryland Group, Inc.
One Kroll North, Suite 503
Columbia, Maryland 21045

SCALE: 1"=30'
DRAWING: 10F-3
JOB NO: 83-055
FILE NO: 83-055-X

LEGEND:

- 1. Contour Interval 2 Ft
- 2. Existing Contour
- 3. Proposed Contour
- 4. Spot Elevation
- 5. Direction of Drainage
- 6. Existing Trees to be saved
- 7. Walk Out Basement
- 8. Earth Dike
- 9. Straw Bale Dike/Silt Fence
- 10. Stabilized Construction Entrance

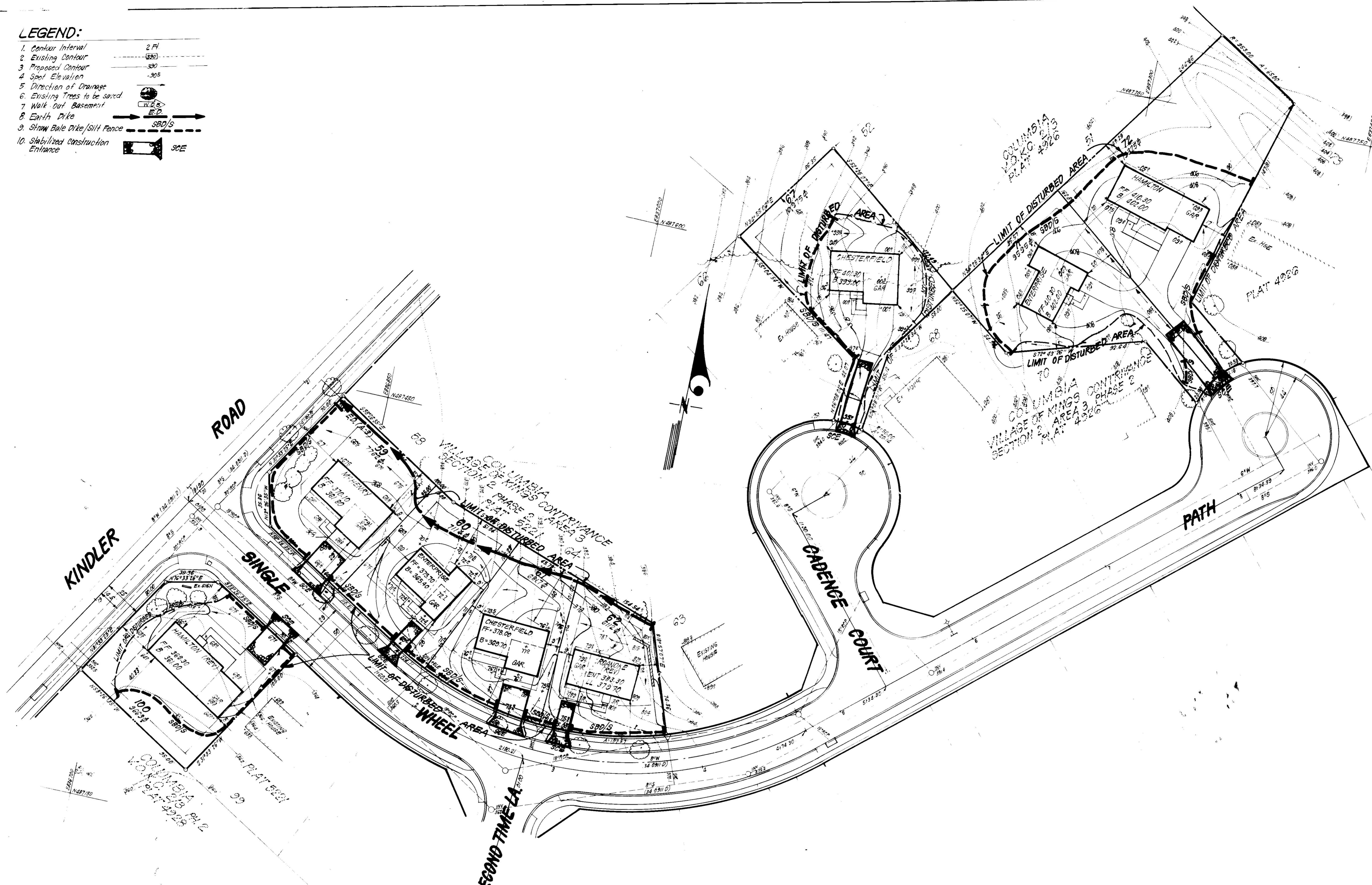
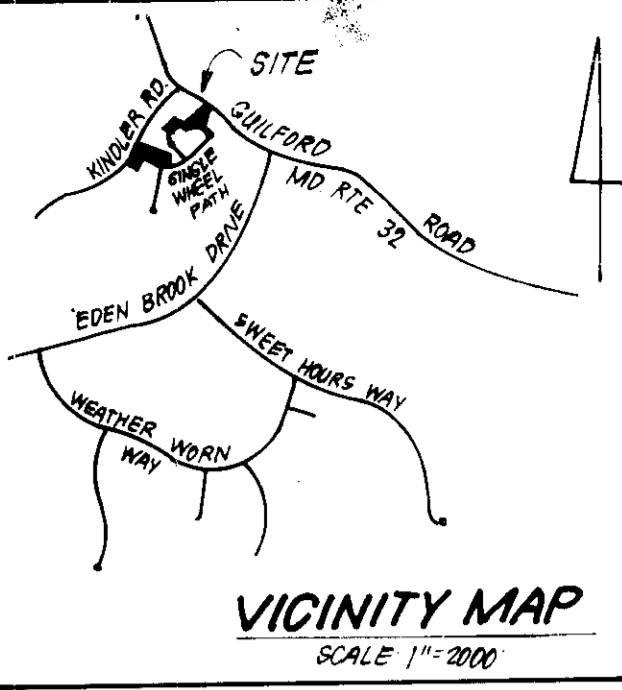

| LOT NO | STREET ADDRESS |
|--------|------------------------|
| 59 | 7203 SINGLE WHEEL PATH |
| 61 | 7207 |
| 62 | 7211 |
| 67 | 7215 |
| 71 | 7228 GADENCE COURT |
| 72 | 7237 SINGLE WHEEL PATH |
| 100 | 7241 |
| 100 | 7202 |

| SUBDIVISION NAME | SECTION/AREA | LOT/PARCELS |
|---------------------------|--------------|----------------------------|
| COLUMBIA V.O.K.C. PHASE 2 | 2/3 | 59, 61, 62, 71, 72 and 100 |

| PLAT | BLOCK | ZONE | TAX/DRAW MAP | ELEC DIST | CENSUS TR |
|-------------|-------|------|--------------|-----------|-----------|
| 4916 E 5221 | 7 | SEMD | 42 | 6TH | 6062 |

| WATER CODE | SEWER CODE |
|------------|------------|
| E-16 | 635 0100 |

APPROVED FOR PUBLIC WATER AND PUBLIC SEWERAGE SYSTEMS
 HOWARD COUNTY HEALTH DEPARTMENT
 COUNTY HEALTH OFFICER *James H. Egan* DATE **6-4-85**

APPROVED HOWARD COUNTY OFFICE OF PLANNING & ZONING
 PLANNING DIRECTOR *James H. Egan* DATE **5-8-85**

APPROVED DIVISION OF LAND DEVELOPMENT AND ZONING ADMINISTRATION
 CHIEF DIVISION OF LAND DEVELOPMENT AND ZONING ADMINISTRATION *James H. Egan* DATE **6-4-85**

APPROVED FOR PUBLIC WATER AND PUBLIC SEWERAGE
 STORM DRAINAGE SYSTEMS AND PUBLIC ROADS
 HOWARD COUNTY DEPARTMENT OF PUBLIC WORKS
 DIRECTOR *James H. Egan* DATE **5-13-85**

CHIEF BUREAU OF ENGINEERING *James H. Egan* DATE **5-31-85**

APPROVED
 DIVISION OF LAND DEVELOPMENT AND ZONING ADMINISTRATION
 HOWARD COUNTY, MARYLAND
 DATE **5-13-85**

Reviewed for *Howard* S.C.U. Name
 and meets Technical Requirements
James H. Egan DATE **5-27-85**
 U.S. Soil Conservation Service
 DEVELOPMENT PLANS APPROVED
 FOR EROSION AND SEDIMENT CONTROL BY THE HOWARD SOIL CONSERVATION DISTRICT
James H. Egan DATE **5/27/85**

DEVELOPER'S/BUILDER'S CERTIFICATE
 "I hereby certify that all development and construction will be done according to this plan of development and plan for erosion and sediment control and that all responsible personnel involved in the construction project will have a Certificate of Attendance at a Dept. of Natural Resources Approved Training Program for the Control of Sediment and Erosion before beginning the project. I also authorize periodic on-site inspection by the Howard Soil Conservation District or their authorized agents, as are deemed necessary."
 Signature of Developer/Builder *Maurice M. Simpkins* DATE **4-15-85**
 MAURICE M. SIMPKINS

ENGINEER'S CERTIFICATE
 I hereby certify that this plan for Erosion and Sediment Control represents a practical and workable plan based on my personal knowledge of the site conditions and that it was prepared in accordance with the requirements of the Howard Soil Conservation District.
 Signature of Engineer *Sheela G. Nelson* DATE **4-2-85**
 SHEELA G. NELSON, P.E.
 PROFESSIONAL ENGINEER
 STATE OF MARYLAND

CLARK · FINEFRÖCK & SACKETT
 ENGINEERS · PLANNERS · SURVEYORS
 11315 LOCKWOOD DRIVE SILVER SPRING, MARYLAND 20904 (301) 593-3400

DESIGNED *VLS BAF* SCALE **1"=30'**
 DRAWN *KIW* DRAWING **2 OF 3**
 CHECKED *VLS BAF* JOB NO. **83-055**
 DATE **5-12-85** FILE NO. **83-055 SE**

SEDIMENT & EROSION CONTROL PLAN
 LOTS 59 THROUGH 62, 67, 71, 72, AND 100
COLUMBIA
 VILLAGE OF KINGS CONTRIVANCE
 SECTION 2 AREA 3 PHASE 2
 6TH ELECTION DISTRICT
 HOWARD COUNTY, MARYLAND
 FOR: The Ryland Group Inc
 One King North, Suite 503
 Columbia, Maryland 21045

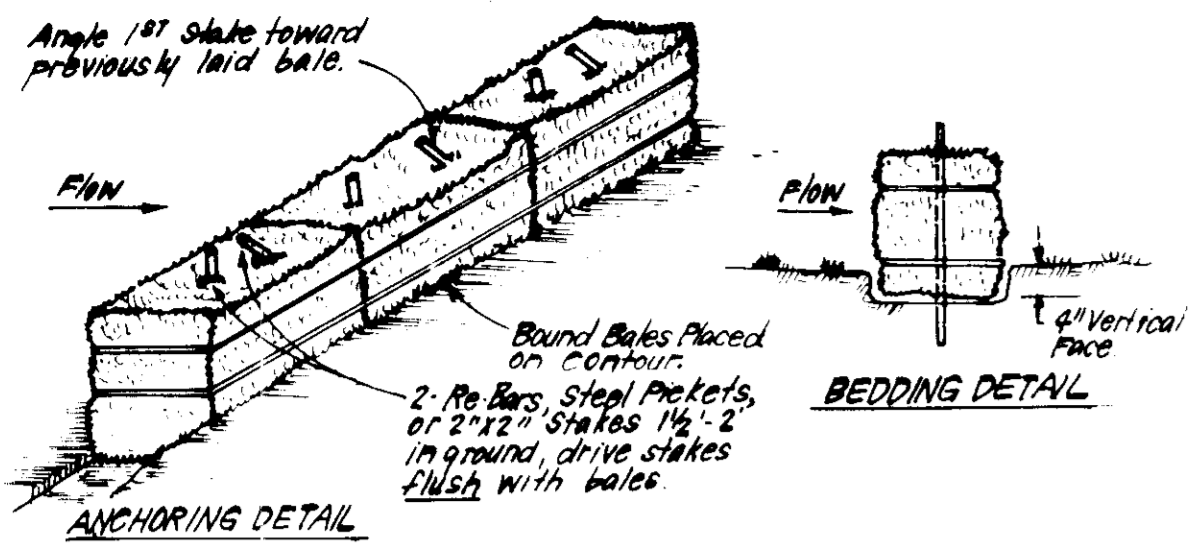

- CONSTRUCTION SPECIFICATIONS:**
- Bales shall be placed at the top of a slope or on the contour and in a row with ends tightly abutting the adjacent bales.
 - Each bale shall be embedded in the soil a min of 4" and placed so the bind-rings are horizontal.
 - Bales shall be securely anchored in place by either 2 stakes or rebar driven thru the bale. The 1st stake in each bale shall be driven toward the previously laid bale at an angle to force the bales together. Stakes shall be driven flush with the bale.
 - Inspection shall be frequent and repair/replacement shall be made promptly as needed.
 - Bales shall be removed when they have served their usefulness so as not to block or impede storm flow or drainage.

STRAW BALE DIKE DETAIL (SBD)
NO SCALE

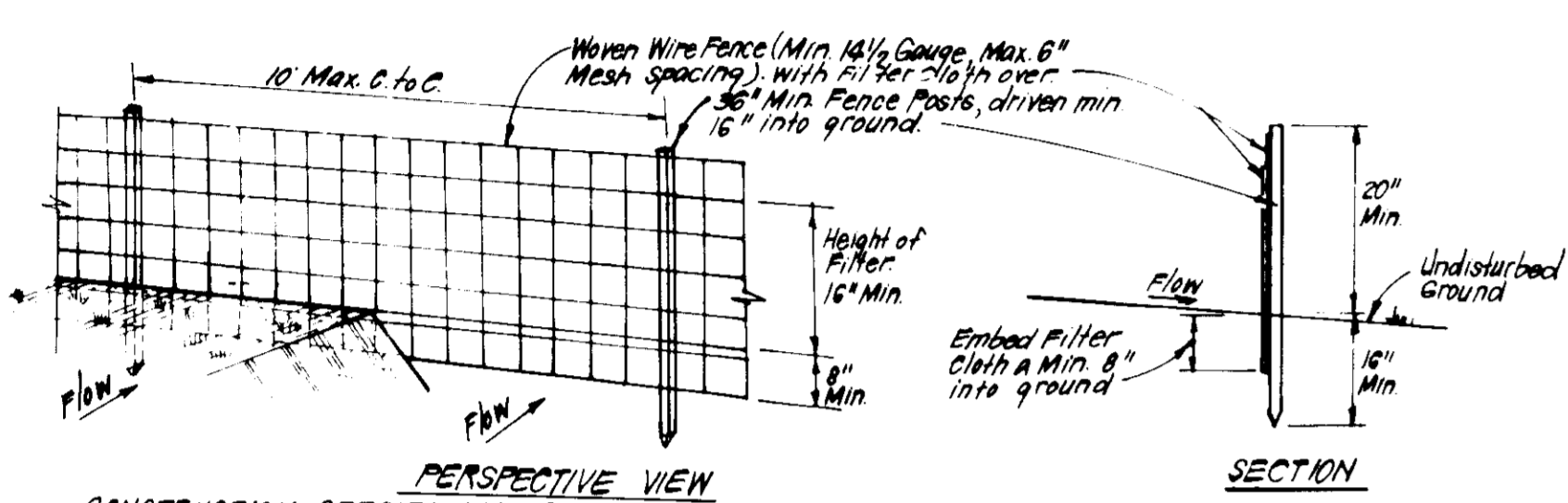

- CONSTRUCTION SPECIFICATIONS:**
- Woven wire fence to be fastened securely to fence posts with wire ties at intervals.
 - Filter cloth to be fastened securely to woven wire fence with ties spaced every 24" at top and mid section.
 - When 2 sections of filter cloth adjoin each other they shall be overlapped by 6" and folded.
 - Maintenance shall be performed as needed and material removed when debris develop in silty fence.
- POSTS: Steel, either T or U Type or 2" Hardwood
FENCE: Woven Wire, 1/4" Gauge, 6" Max. Mesh Opening
FILTER CLOTH: Filter Cloth, Miraflex, 100% Subirina, T140N or Approx. Equal
PREFABRICATED UNIT: GeoFab, Envirofence, or Approx. Equal

SILTY FENCE DETAIL (S)
NO SCALE

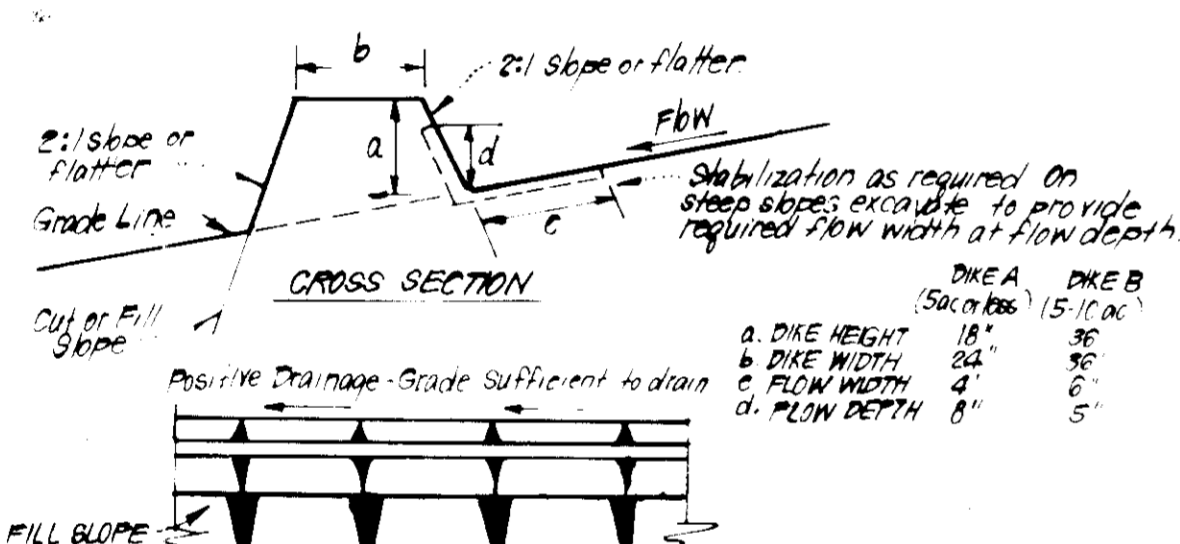

- CONSTRUCTION SPECIFICATIONS:**
- All dikes shall be constructed by earth-moving equipment.
 - All dikes shall have positive drainage to an outlet.
 - Top width may be wider and side slopes may be flatter if desired, to facilitate crossing by construction traffic.
 - Field location should be adjusted as needed to utilize a stabilized safe outlet.
 - Earth dikes shall have an outlet that functions with a minimum of erosion. Runoff shall be conveyed to a sediment trapping device such as a sediment trap or sediment basin where either the dike channel or the drainage area above the dike are not adequately stabilized.
 - Stabilization shall be: (A) in accordance with standard specifications for seed and straw mulch or straw mulch if not in seeding season, (B) flow channel as per chart below.

| TYPE OF TREATMENT | PERCENTAGE | DIKE A | DIKE B |
|-------------------|-------------|-------------------------------|--|
| 1 | 0.5 - 2.0% | Seed & Straw Mulch | Seed or Straw Mulch |
| 2 | 3.1 - 5.0% | Seed & Straw Mulch | Seed w/white or Excelsior; Sod, 2" Stone |
| 3 | 5.1 - 8.0% | Seed w/white or Sod; 2" Stone | Lined Rip Rap 4" - 8" Stone |
| 4 | 8.1 - 20.0% | Lined Rip Rap 4" - 8" Stone | Engineering Design |

A Stone to be 2" Stone, or recycled concrete equivalent, in a layer at least 3" thick and be pressed into soil with construction equipment.
B Rip Rap to be 4" - 8" in a layer at least 8" thick, pressed into soil.
C Approved equivalents can be substituted for any of the above materials.

EARTH DIKE DETAIL (E.D.)
NO SCALE

PERMANENT SEEDING NOTES

Apply to graded or cleared areas not subject to immediate further disturbance where a permanent long-lived vegetative cover is needed.

Seedbed Preparation: Loosen upper three inches of soil by raking, discing or other acceptable means before seeding.

Soil Amendments: In lieu of soil test recommendations, use one of the following schedules:

- Preferred - Apply 2 tons per acre dolomitic limestone (92 lbs/1000 sq ft) and 600 lbs per acre 10-10-10 fertilizer (14 lbs/1000 sq ft) before seeding. Harrow or disc into upper three inches of soil. At time of seeding, apply 400 lbs per acre 30-0-0 ureaform fertilizer (9 lbs/1000 sq ft).
- Acceptable - Apply 2 tons per acre dolomitic limestone (92 lbs/1000 sq ft) and 1000 lbs per acre 10-10-10 fertilizer (23 lbs/1000 sq ft) before seeding. Harrow or disc into upper three inches of soil.

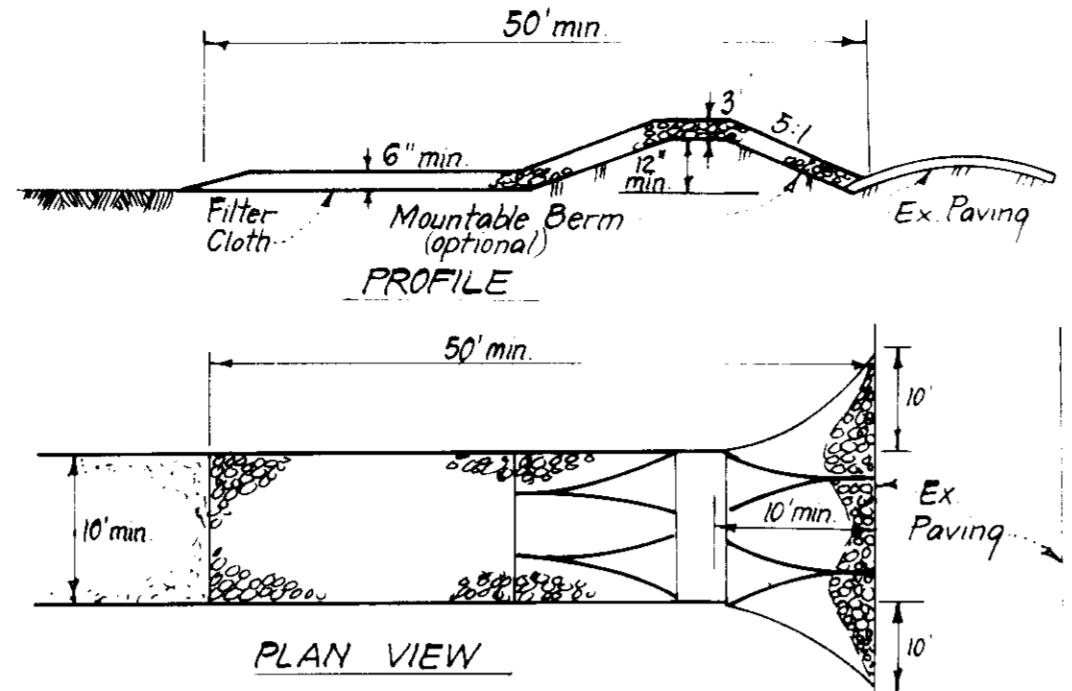

- CONSTRUCTION SPECIFICATIONS:**
- Stone size - Use 2" stone, or reclaimed or recycled concrete equivalent.
 - Length - As required, but not less than 50 feet (except on a single residence lot where a 30 foot minimum length would apply).
 - Thickness - Not less than six (6) inches.
 - Width - Ten (10) foot minimum, but not less than the full width at points where ingress or egress occurs.
 - Filter Cloth - Will be placed over the entire area prior to placing of stone. Filter will not be required on a single family residence lot.
 - Surface Water - All surface water flowing or diverted toward construction entrances shall be piped across the entrance. If piping is impractical, a mountable berm with 5:1 slopes will be permitted.
 - Maintenance - The entrance shall be maintained in a condition which will prevent tracking or flowing of sediment onto public rights-of-way. This may require periodic top dressing with additional stone as conditions demand and repair and/or cleanout of any measures used to trap sediment. All sediment soiled, dropped, washed or tracked onto public rights-of-way must be removed immediately.
 - Washing - Wheels shall be cleaned to remove sediment prior to entrance onto public rights-of-way. When washing is required, it shall be done on an area stabilized with stone and which drains into an approved sediment trapping device.
 - Periodic inspection and needed maintenance shall be provided after each rain.

STABILIZED CONSTRUCTION ENTRANCE (SCE)
NO SCALE

TEMPORARY SEEDING NOTES

Apply to graded or cleared areas likely to be redisturbed where a short-term vegetative cover is needed.

Seedbed Preparation: Loosen upper three inches of soil by raking, discing or other acceptable means before seeding.

Soil Amendments: Apply 600 lbs per acre 10-10-10 fertilizer (14 lbs/1000 sq ft)

Seeding: For periods March 1 thru April 30 and from August 15 thru November 15, seed with 25 bushel per acre of annual ryegrass (3.2 lbs/1000 sq ft). For the period May 1 thru August 14, seed with 3 lbs per acre of weeping lovegrass (.07 lbs/1000 sq ft). For the period November 16 thru February 28, protect site by applying 2 tons per acre of well anchored straw mulch and seed as soon as possible in the spring, or use sod.

Mulching: Apply 1 1/2 to 2 tons per acre (70 to 90 lbs/1000 sq ft) of rotted small grain straw immediately after seeding. Anchor mulch immediately after application using mulch anchoring tool or 218 gal per acre (5 gal/1000 sq ft) of emulsified asphalt on flat areas. On slopes, 8 ft or higher, use 348 gal per acre (8 gal/1000 sq ft) for anchoring.

Refer to the 1983 MARYLAND STANDARDS AND SPECIFICATIONS FOR SOIL EROSION AND SEDIMENT CONTROL for rate and methods not covered.

SEDIMENT CONTROL NOTES

- A statement of 24 hours notice must be given to the Howard County Office of Inspection and Permits prior to the start of any construction. (4992-2437)
- All best management practices are to be installed according to the provisions of this plan and are to be in accordance with the 1983 MARYLAND STANDARDS AND SPECIFICATIONS FOR SOIL EROSION AND SEDIMENT CONTROL.
- Following initial soil disturbance or redisturbance, permanent or temporary stabilization shall be completed within: a) 7 calendar days for all perimeter sediment control structures, dikes, perimeter slopes and all slopes greater than 3:1, b) 14 days as to all other disturbed or graded areas on the project site.
- All sediment traps/basins shown must be fenced and warning signs posted around their perimeter in accordance with Vol. 1, Chapter 12, of the HOWARD COUNTY DESIGN MANUAL, Storm Drainage.
- All disturbed areas must be stabilized within the time period specified above in accordance with the 1983 MARYLAND STANDARDS AND SPECIFICATIONS FOR SOIL EROSION AND SEDIMENT CONTROL for permanent seedings (Sec. 51) sod (Sec. 54), temporary seeding (Sec. 50) and mulching (Sec. 52.) Temporary stabilization with mulch alone can only be done when recommended seeding dates do not allow for proper germination and establishment of grasses.
- All sediment control structures are to remain in place and are to be maintained in operative condition until permission for their removal has been obtained from the Howard County Sediment Control Inspector.
- Site Analysis:

| | |
|------------------------------------|---------------|
| Total Area of Site | 1,684.2 Acres |
| Area Disturbed | 1,367.8 Acres |
| Area to be roofed or paved | 0.4040 Acres |
| Area to be vegetatively stabilized | 0.9733 Acres |
| Total Cut | 1785 Cu. yds |
| Total Fill | 1310 Cu. yds |
| Offsite waste/borrow area location | N/A |
- Any sediment control practice which is disturbed by grading activity for placement of utilities must be repaired on the same day of disturbance.
- Additional sediment control must be provided, if deemed necessary by the Howard County DWM sediment control inspector.
- On all sites with disturbed areas in excess of 2 acres, approval of the inspection agency shall be requested upon completion of installation of perimeter erosion and sediment controls, but before proceeding with any other earth disturbance or grading. Other building or grading inspection approvals may not be authorized until this initial approval by the inspection agency is made.
- If houses are to be constructed on an "As-Sold" basis, at random, Single Lot Sediment Control as shown below shall be implemented.
- All pipes to be blocked at the end of each day (see detail below), N/A
- The total amount of straw bale dikes/silty fence equals 300' L.F.

CONSTRUCTION SEQUENCE:

- Obtain Grading Permit and Install Sediment and Erosion Control Devices and Stabilize.
- Excavate for Foundations and Rough Grade.
- Construct Structures, Sidewalks and Driveways.
- Final Grade and stabilize in accordance with Stds. & Specs.
- Upon approval of the sediment control inspector, remove sediment and erosion control and stabilize.

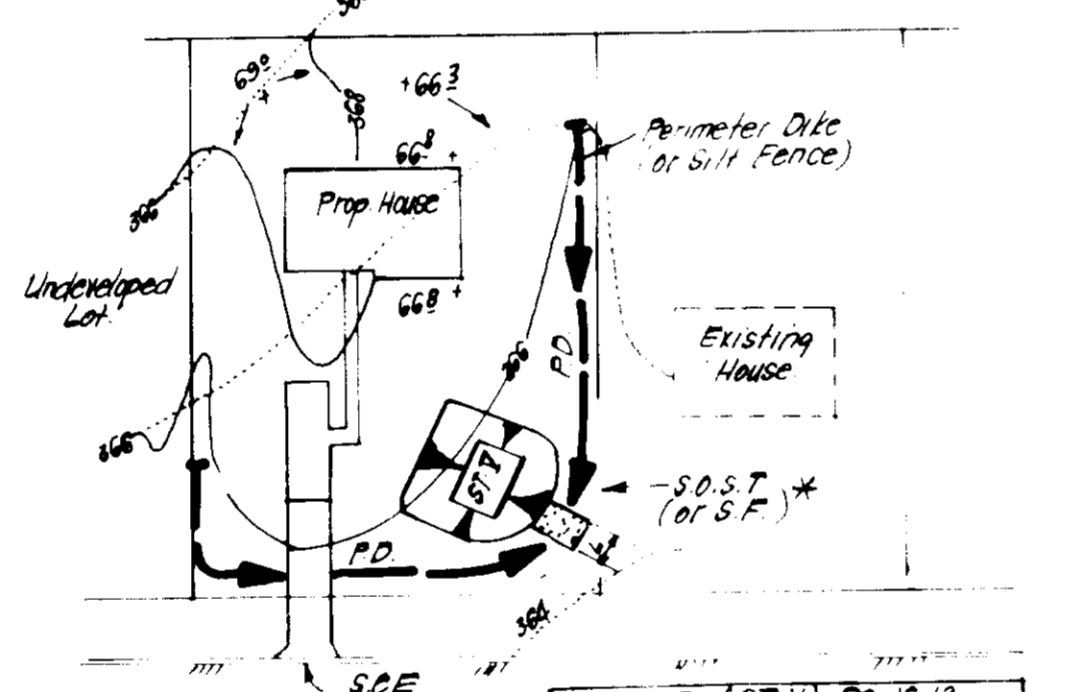

* NOTE: Single lot detail can not be utilized if any two lots sharing common property lines are to be disturbed at the same time or on any lots showing a sediment trap area must be as given or greater.

| SECTION | ST. V. | FR. | TO | AC. |
|---------|--------|-----|-----|-----|
| 1 | 1 | 2 | 3 | 0.1 |
| 2 | 2 | 3 | 4 | 0.1 |
| 3 | 3 | 4 | 5 | 0.1 |
| 4 | 4 | 5 | 6 | 0.1 |
| 5 | 5 | 6 | 7 | 0.1 |
| 6 | 6 | 7 | 8 | 0.1 |
| 7 | 7 | 8 | 9 | 0.1 |
| 8 | 8 | 9 | 10 | 0.1 |
| 9 | 9 | 10 | 11 | 0.1 |
| 10 | 10 | 11 | 12 | 0.1 |
| 11 | 11 | 12 | 13 | 0.1 |
| 12 | 12 | 13 | 14 | 0.1 |
| 13 | 13 | 14 | 15 | 0.1 |
| 14 | 14 | 15 | 16 | 0.1 |
| 15 | 15 | 16 | 17 | 0.1 |
| 16 | 16 | 17 | 18 | 0.1 |
| 17 | 17 | 18 | 19 | 0.1 |
| 18 | 18 | 19 | 20 | 0.1 |
| 19 | 19 | 20 | 21 | 0.1 |
| 20 | 20 | 21 | 22 | 0.1 |
| 21 | 21 | 22 | 23 | 0.1 |
| 22 | 22 | 23 | 24 | 0.1 |
| 23 | 23 | 24 | 25 | 0.1 |
| 24 | 24 | 25 | 26 | 0.1 |
| 25 | 25 | 26 | 27 | 0.1 |
| 26 | 26 | 27 | 28 | 0.1 |
| 27 | 27 | 28 | 29 | 0.1 |
| 28 | 28 | 29 | 30 | 0.1 |
| 29 | 29 | 30 | 31 | 0.1 |
| 30 | 30 | 31 | 32 | 0.1 |
| 31 | 31 | 32 | 33 | 0.1 |
| 32 | 32 | 33 | 34 | 0.1 |
| 33 | 33 | 34 | 35 | 0.1 |
| 34 | 34 | 35 | 36 | 0.1 |
| 35 | 35 | 36 | 37 | 0.1 |
| 36 | 36 | 37 | 38 | 0.1 |
| 37 | 37 | 38 | 39 | 0.1 |
| 38 | 38 | 39 | 40 | 0.1 |
| 39 | 39 | 40 | 41 | 0.1 |
| 40 | 40 | 41 | 42 | 0.1 |
| 41 | 41 | 42 | 43 | 0.1 |
| 42 | 42 | 43 | 44 | 0.1 |
| 43 | 43 | 44 | 45 | 0.1 |
| 44 | 44 | 45 | 46 | 0.1 |
| 45 | 45 | 46 | 47 | 0.1 |
| 46 | 46 | 47 | 48 | 0.1 |
| 47 | 47 | 48 | 49 | 0.1 |
| 48 | 48 | 49 | 50 | 0.1 |
| 49 | 49 | 50 | 51 | 0.1 |
| 50 | 50 | 51 | 52 | 0.1 |
| 51 | 51 | 52 | 53 | 0.1 |
| 52 | 52 | 53 | 54 | 0.1 |
| 53 | 53 | 54 | 55 | 0.1 |
| 54 | 54 | 55 | 56 | 0.1 |
| 55 | 55 | 56 | 57 | 0.1 |
| 56 | 56 | 57 | 58 | 0.1 |
| 57 | 57 | 58 | 59 | 0.1 |
| 58 | 58 | 59 | 60 | 0.1 |
| 59 | 59 | 60 | 61 | 0.1 |
| 60 | 60 | 61 | 62 | 0.1 |
| 61 | 61 | 62 | 63 | 0.1 |
| 62 | 62 | 63 | 64 | 0.1 |
| 63 | 63 | 64 | 65 | 0.1 |
| 64 | 64 | 65 | 66 | 0.1 |
| 65 | 65 | 66 | 67 | 0.1 |
| 66 | 66 | 67 | 68 | 0.1 |
| 67 | 67 | 68 | 69 | 0.1 |
| 68 | 68 | 69 | 70 | 0.1 |
| 69 | 69 | 70 | 71 | 0.1 |
| 70 | 70 | 71 | 72 | 0.1 |
| 71 | 71 | 72 | 73 | 0.1 |
| 72 | 72 | 73 | 74 | 0.1 |
| 73 | 73 | 74 | 75 | 0.1 |
| 74 | 74 | 75 | 76 | 0.1 |
| 75 | 75 | 76 | 77 | 0.1 |
| 76 | 76 | 77 | 78 | 0.1 |
| 77 | 77 | 78 | 79 | 0.1 |
| 78 | 78 | 79 | 80 | 0.1 |
| 79 | 79 | 80 | 81 | 0.1 |
| 80 | 80 | 81 | 82 | 0.1 |
| 81 | 81 | 82 | 83 | 0.1 |
| 82 | 82 | 83 | 84 | 0.1 |
| 83 | 83 | 84 | 85 | 0.1 |
| 84 | 84 | 85 | 86 | 0.1 |
| 85 | 85 | 86 | 87 | 0.1 |
| 86 | 86 | 87 | 88 | 0.1 |
| 87 | 87 | 88 | 89 | 0.1 |
| 88 | 88 | 89 | 90 | 0.1 |
| 89 | 89 | 90 | 91 | 0.1 |
| 90 | 90 | 91 | 92 | 0.1 |
| 91 | 91 | 92 | 93 | 0.1 |
| 92 | 92 | 93 | 94 | 0.1 |
| 93 | 93 | 94 | 95 | 0.1 |
| 94 | 94 | 95 | 96 | 0.1 |
| 95 | 95 | 96 | 97 | 0.1 |
| 96 | 96 | 97 | 98 | 0.1 |
| 97 | 97 | 98 | 99 | 0.1 |
| 98 | 98 | 99 | 100 | 0.1 |

APPROVED FOR PUBLIC WATER AND PUBLIC SEWERAGE SYSTEMS.
HOWARD COUNTY HEALTH DEPARTMENT

6-4-85

APPROVED FOR PUBLIC WATER AND PUBLIC SEWERAGE SYSTEMS AND ZONING
HOWARD COUNTY OFFICE OF PLANNING AND ZONING

6-5-85

APPROVED FOR PUBLIC WATER AND PUBLIC SEWERAGE SYSTEMS AND ZONING
HOWARD COUNTY DEPARTMENT OF PUBLIC WORKS

5-13-85

APPROVED
DIVISION OF LAND DEVELOPMENT
ZONING ADMINISTRATION
HOWARD COUNTY, MARYLAND
DATE 5-13-85
AM/14/UMI

Reviewed for Howard S.C.D.
and meets Technical Requirements
Signature: [Signature] Date: 5/27/85
U.S. Soil Conservation Service

DEVELOPER'S/BUILDER'S CERTIFICATE

"I/We certify that all development and construction will be done according to this plan of development and plan for erosion and sediment control and that all responsible personnel involved in the construction project will have a Certificate of Attendance at a Dept. of Natural Resources Approved Training Program for the Control of Sediment and Erosion before beginning the project. I also authorize periodic on-site inspection by the Howard Soil Conservation District or their authorized agents, as are deemed necessary."

Signature of Developer/Builder: Maurice M. Simpkins, U.P.
Date: 4-15-85

ENGINEER'S CERTIFICATE

I hereby certify that this plan for Erosion and Sediment Control represents a practical and workable plan based on my personal knowledge of the site conditions and that it was prepared in accordance with the requirements of the Howard Soil Conservation District.

Signature: G. Nelson Clark
Date: 5/27/85

CFS CLARK · FINEFROCK & SACKETT
ENGINEERS · PLANNERS · SURVEYORS

11317 LOCKWOOD DRIVE SILVER SPRING, MARYLAND 20904 (301) 593-3400

DESIGNED: JLS SCALE: As Shown

DRAWN: K/W DRAWING: 30F3

CHECKED: JLS JOB NO: 83-055

DATE: 5-12-85 FILE NO: 83-055 SE

SEDIMENT & EROSION CONTROL PLAN
LOTS 59 THRU 62, 67, 71, 72, AND 100

COLUMBIA
VILLAGE OF KINGS CONTRIVANCE
SECTION 2 AREA 3 PHASE 2
6TH ELECTION DISTRICT
HOWARD COUNTY, MARYLAND

FOR: The Ryland Group, Inc.
One Knoll North, Suite 503
Columbia, Md. 21045

SDP-85-183