

LOT NUMBER	STREET ADDRESS
412	7502 LILAC SEA
413	7506 " "
414	7510 " "
415	7514 " "
416	7518 " "
417	7518 " "
418	7509 " "
419	7505 " "
420	7501 " "

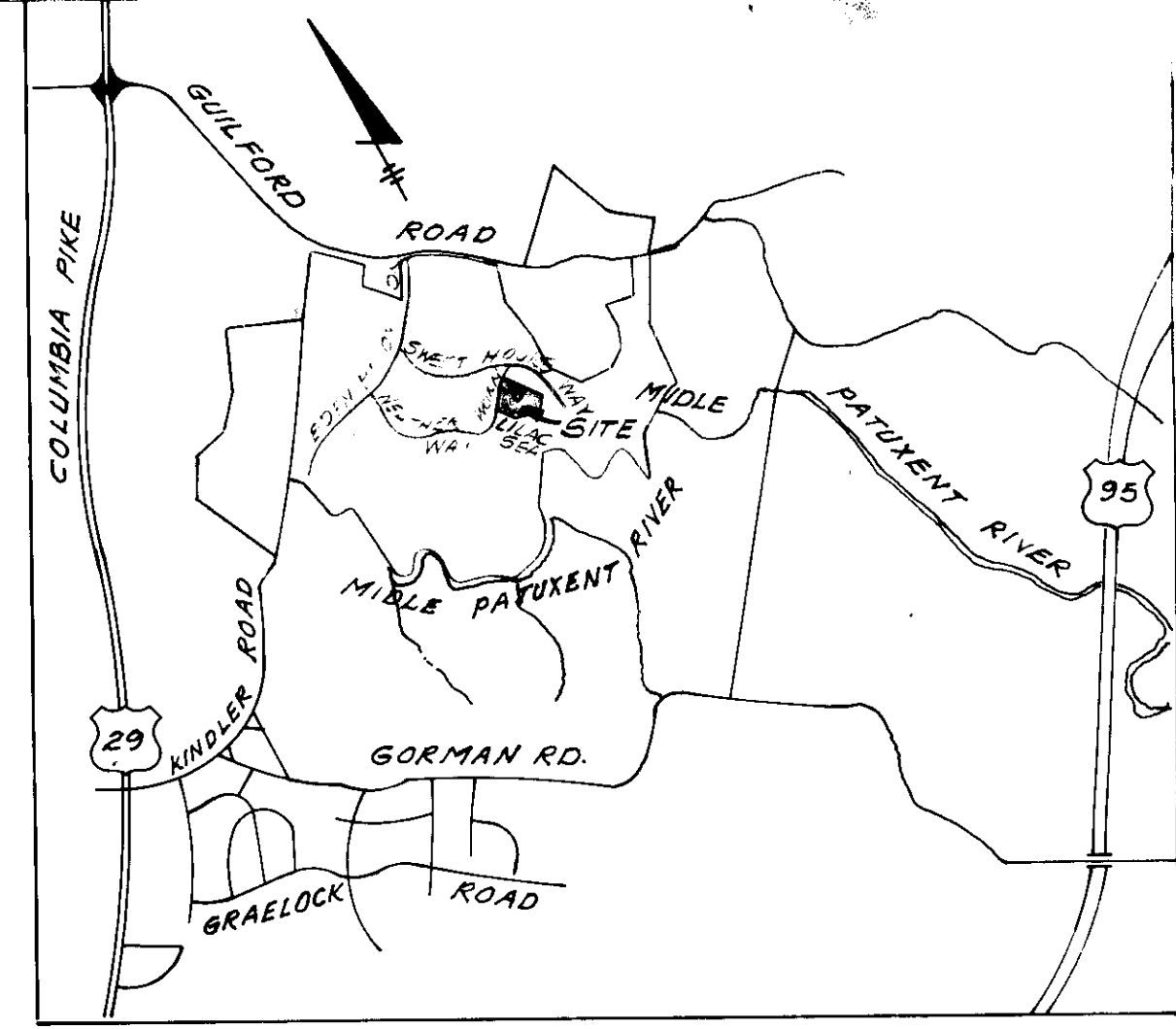

VICINITY MAP
SCALE: 1"=2000'

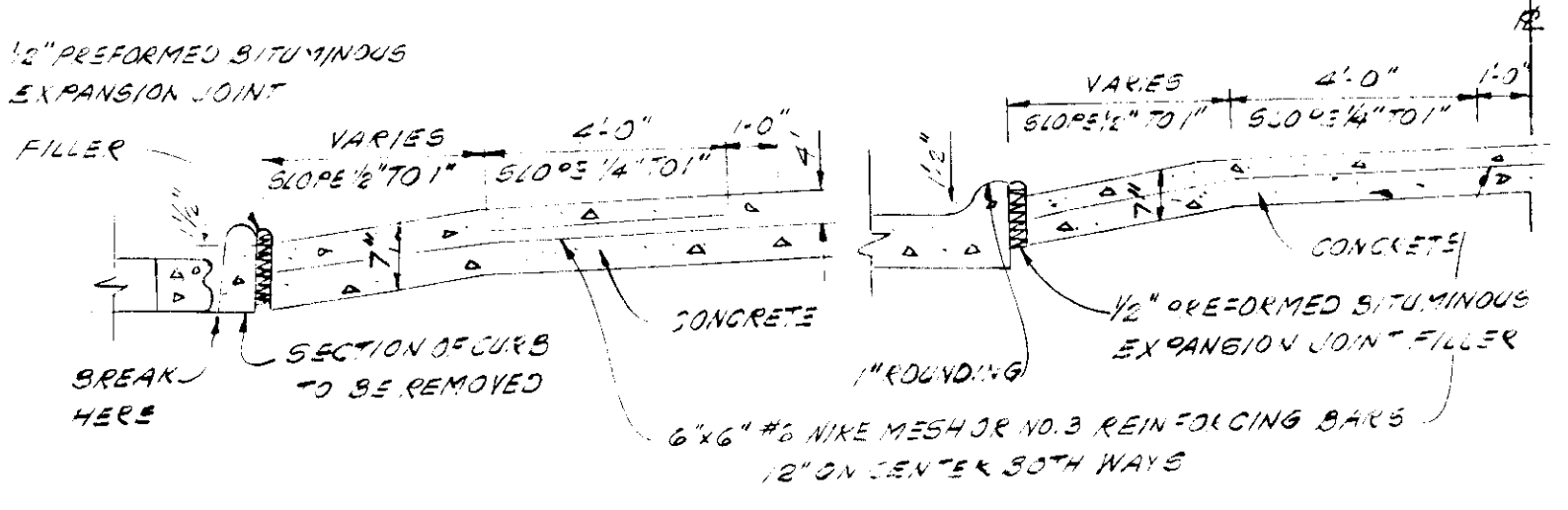
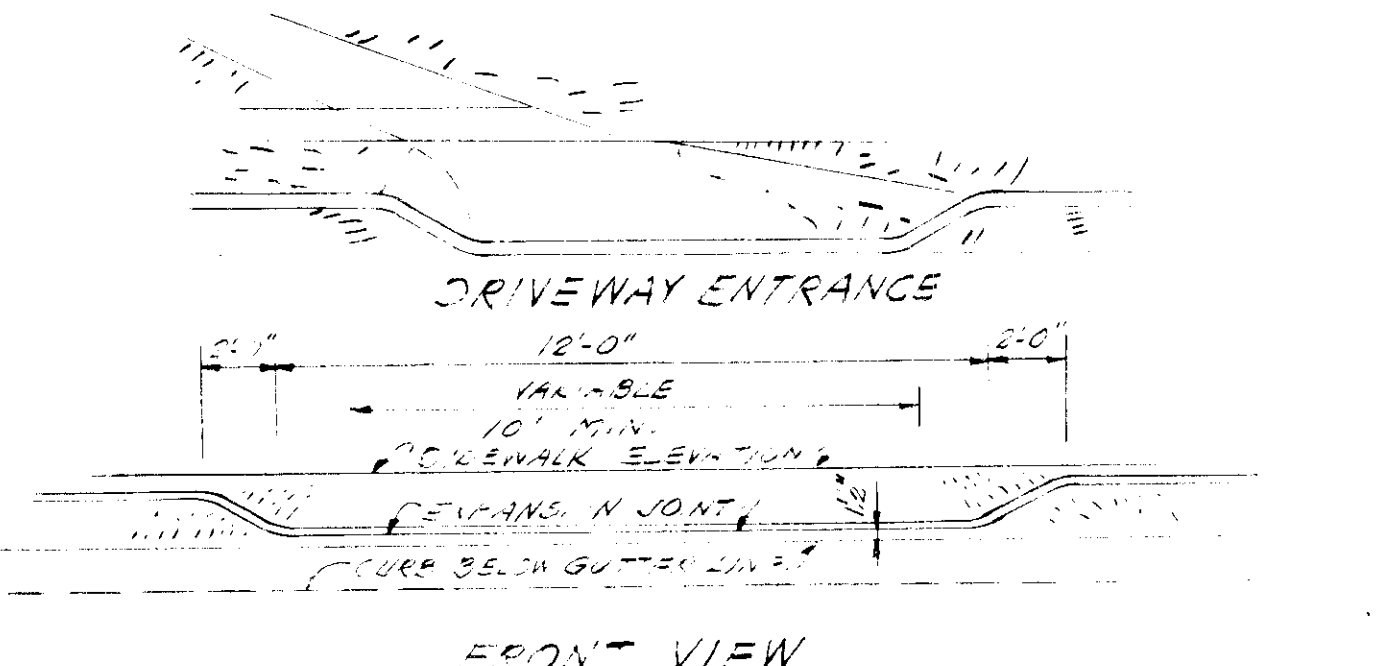

SECTION DRIVEWAY IN EXISTING CURBS / SECTION DRIVEWAY IN NEW CURBS

NOTE: ALL CONSTRUCTION SHALL CONFORM TO THE HOWARD COUNTY ROAD CONSTRUCTION CODE & STANDARD SPECIFICATIONS. USE THIS DRIVEWAY SECTION WITH THE EXISTING CONC. APRON CONFORMING WITH THE HOWARD CO. STD. DRAWING R-601

- SITE ANALYSIS**
1. PRESENT ZONING: NEWTOWN - PHASE 17B, PAR-B 11 & 11
 2. TOTAL NUMBER OF PARKING REQUIRED: 18 (TOTAL PROVIDED: 18) (18 OFF LILAC SEA DOUBLE DRIVEWAYS)
 3. TOTAL AREA OF LOTS OR PARCELS: 94,597 S.F. OR 2.17 AC.
 4. TOTAL AREA TO BE DISTURBED: 37,954 S.F. OR 0.86 AC.
 5. TOTAL AREA TO BE REVEGETATED: 45,493 S.F. OR 1.04 AC.
 6. TOTAL NUMBER OF LOTS: 9
 7. FLOOD CONTROL WATER MANAGEMENT DESIGN CRITERIA: SEE E-80-26C

THIS PLAN IS APPROVED FOR SOIL EROSION AND SEDIMENT CONTROL BY THE HOWARD S.C.D. HOWARD S.C.D. 4/27/85

REVIEWED FOR HOWARD S.C.D. AND MEETS TECHNICAL REQUIREMENTS. J. Helms 4/29/85 U.S. SOIL CONSERVATION SERVICE DATE

DIVISION OF LAND DEVELOPMENT & ZONING ADMINISTRATION
HOWARD COUNTY MAP LAND
DATE 4-16-85
[Signature]

APPROVED: HOWARD COUNTY OFFICE OF PLANNING & ZONING
[Signature] 5-7-85
PLANNING DIRECTOR DATE
[Signature] 5-6-85
CHIEF, DIVISION OF LAND DEVELOPMENT & ZONING ADMIN. DATE

APPROVED: FOR PUBLIC WATER & PUBLIC SEWERAGE SYSTEMS, HOWARD COUNTY HEALTH DEPARTMENT.
[Signature] 5-7-85
COUNTY HEALTH OFFICER DATE

APPROVED: FOR PUBLIC WATER, PUBLIC SEWER, STORM DRAINAGE SYSTEMS & PUBLIC ROADS. HOWARD COUNTY DEPT. OF PUBLIC WORKS.
[Signature] 5-1-85
DIRECTOR DATE

[Signature] 4-30-85
CHIEF BUREAU OF ENGINEERING DATE

CERTIFICATION BY DEVELOPER

I CERTIFY THAT ALL DEVELOPMENT AND/OR CONSTRUCTION WILL BE DONE ACCORDING TO THIS PLAN OF DEVELOPMENT AND PLAN FOR EROSION & SEDIMENT CONTROL & THAT ALL RESPONSIBLE PERSONNEL INVOLVED WITH THE CONSTRUCTION PROJECT WILL HAVE A CERTIFICATE OF ATTENDANCE AT A DEPT. OF NATURAL RESOURCES APPROVED TRAINING PROGRAM FOR THE CONTROL OF SEDIMENT & EROSION BEFORE BEGINNING THE PROJECT.

I ALSO AUTHORIZE PERIODIC ONSITE INSPECTIONS BY THE HOWARD SOIL CONSERVATION DISTRICT OR THEIR AUTHORIZED AGENTS AS ARE DEEMED NECESSARY.

[Signature] 4/1/85
SIGNATURE DATE

CERTIFICATION BY ENGINEER

I CERTIFY THAT THIS PLAN OF DEVELOPMENT & PLAN FOR EROSION & SEDIMENT CONTROL REPRESENTS A PRACTICAL & WORKABLE PLAN BASED ON MY KNOWLEDGE OF THE SITE CONDITIONS & THAT IT WAS PREPARED IN ACCORDANCE WITH THE REQUIREMENTS OF THE HOWARD COUNTY SOIL CONSERVATION DISTRICT.

[Signature] Jan 15, 1985
Walter Park DATE

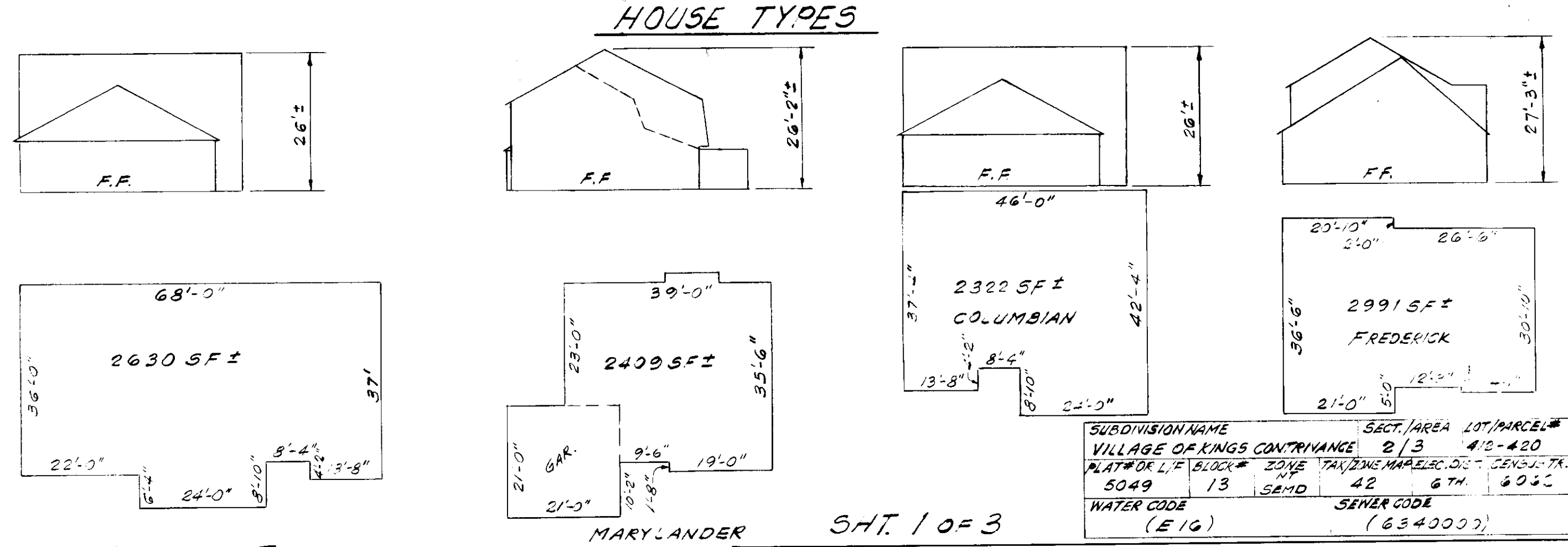

OWNER & DEVELOPER
CONSOLIDATED HOME BUILDING CORP.
SUITE 110 GORMAN PLAZA BLDG.
8950 RTE. 108 COLUMBIA, MD. 21045
995-0065

SURVEYORS & ENGINEERS
HUDKINS ASSOCIATES, INC.
200 EAST JOPPA ROAD
ROOM 101 SHELL BUILDING
TOWSON, MARYLAND 21284
828-9360

SHT. 10 of 3
SITE DEVELOPMENT PLAN
LOTS 412 THRU 420
COLUMBIA
VILLAGE OF KINGS CONTRIVANCE
SECTION 2 AREA 3 PHASE 3
6TH ELEC. DIST. HOWARD COUNTY, MARYLAND
SCALE: 1"=30'
JAN. 4, 1985
SOP-85-126c #6411

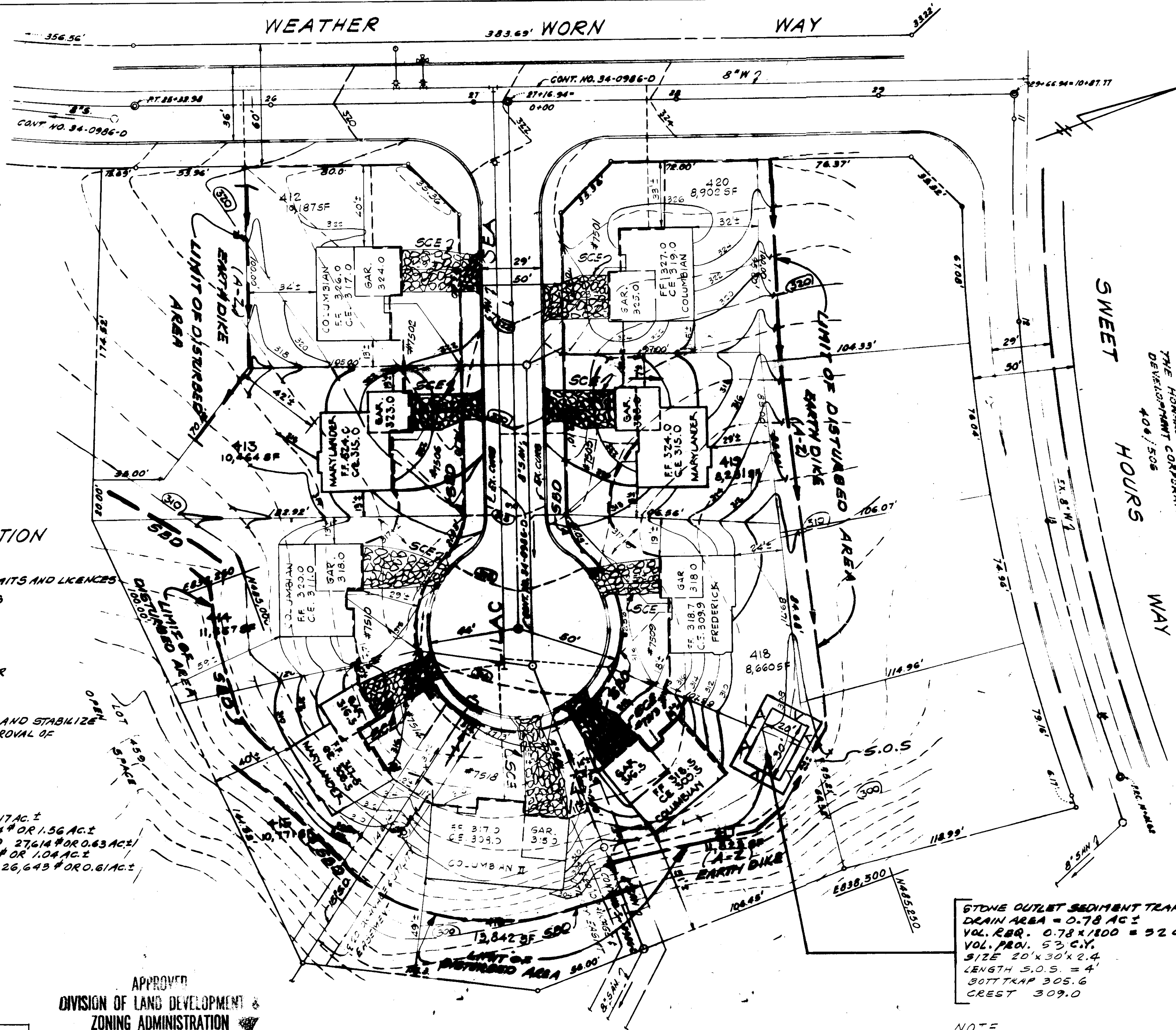

SEQUENCE OF CONSTRUCTION

1. OBTAIN GRADING PERMIT
2. NOTIFY HOWARD COUNTY DEPT. OF PERMITS AND LICENCES
3. INSTALL SEDIMENT CONTROL DEVICES
4. ROUGH GRADE SITE
5. BEGIN BUILDING CONSTRUCTION
6. FINE GRADE
7. STABILIZE AREAS TO BE SEEDED PER PERMANENT SEEDING PROCEDURES
8. PAVE AREAS TO BE PAVED
9. REMOVE SEDIMENT CONTROL DEVICES AND STABILIZE THOSE AREAS AFTER OBTAINING APPROVAL OF SEDIMENT CONTROL INSPECTOR.

- SITE**
1. TOTAL AREA 94,597[±] OR 2.17 AC.±
 2. AREA TO BE DISTURBED 67,954[±] OR 1.56 AC.±
 3. AREA TO BE PAVED OR ROOFED 27,614[±] OR 0.63 AC.±
 4. AREA TO BE SEEDED 45,490[±] OR 1.04 AC.±
 5. AREA TO REMAIN UNDISTURBED 26,645[±] OR 0.61 AC.±

THIS PLAN IS APPROVED FOR SOIL EROSION AND SEDIMENT CONTROL BY THE HOWARD S.C.P. 4/29/85
 HOWARD SCD DATE
 REVIEWED FOR HOWARD SCD AND MEETS TECHNICAL REQUIREMENTS
 U.S. SOIL CONSERVATION SERVICE DATE 4/29/85

APPROVED
 DIVISION OF LAND DEVELOPMENT & ZONING ADMINISTRATION
 HOWARD COUNTY, MARYLAND
 DATE 4-16-85

PLAN
 SCALE = 1" = 30'

STONE OUTLET SEDIMENT TRAP
 DRAIN AREA = 0.78 AC.±
 VOL. RBR. 0.78 x 100 = 78 C.Y.
 VOL. PRO. 53 C.Y.
 SIZE 20' x 30' x 2.4'
 LENGTH S.O.S. = 4'
 GOTT TRAP 305.6
 CREST 309.0

- NOTE**
- FOLLOWING INITIAL DISTURBANCE OR REDISTURBANCE PERMANENT OR TEMP. STABILIZATION SHALL BE COMPLETED WITHIN:
1. SEVEN CALENDAR DAYS FOR ALL PERIMETER SEDIMENT CONTROL STRUCTURES, DIKES, PERIMETER SLOPES AND ALL SLOPES GREATER THAN 3:1
 2. FOURTEEN DAYS AS TO ALL OTHER DISTURBED OR GRADED AREAS ON THE PROJECT SITE.

APPROVED: HOWARD COUNTY OFFICE OF PLANNING & ZONING
5-7-85
 PLANNING DIRECTOR DATE
 CHIEF, DIVISION OF LAND DEVELOPMENT & ZONING ADMIN. DATE 5-6-85

APPROVED: FOR PUBLIC WATER & PUBLIC SEWERAGE SYSTEMS, HOWARD COUNTY HEALTH DEPARTMENT.
5-7-85
 COUNTY HEALTH OFFICER DATE

APPROVED: FOR PUBLIC WATER, PUBLIC SEWER, STORM DRAINAGE SYSTEMS & PUBLIC ROADS. HOWARD COUNTY DEPT. OF PUBLIC WORKS
4-30-85
 DIRECTOR DATE
 CHIEF BUREAU OF ENGINEERING DATE

CERTIFICATION BY DEVELOPER

I CERTIFY THAT ALL DEVELOPMENT AND/OR CONSTRUCTION WILL BE DONE ACCORDING TO THIS PLAN OF DEVELOPMENT AND PLAN FOR EROSION & SEDIMENT CONTROL & THAT ALL RESPONSIBLE PERSONNEL INVOLVED WITH THE CONSTRUCTION PROJECT WILL HAVE A CERTIFICATE OF ATTENDANCE AT A DEPT. OF NATURAL RESOURCES APPROVED TRAINING PROGRAM FOR THE CONTROL OF SEDIMENT & EROSION BEFORE BEGINNING THE PROJECT.

I ALSO AUTHORIZE PERIODIC ONSITE INSPECTIONS BY THE HOWARD SOIL CONSERVATION DISTRICT OR THEIR AUTHORIZED AGENTS AS ARE DEEMED NECESSARY.

4/3/85
 SIGNATURE DATE

CERTIFICATION BY ENGINEER

I CERTIFY THAT THIS PLAN OF DEVELOPMENT & PLAN FOR EROSION & SEDIMENT CONTROL REPRESENTS A PRACTICAL & WORKABLE PLAN BASED ON MY KNOWLEDGE OF THE SITE CONDITIONS & THAT IT WAS PREPARED IN ACCORDANCE WITH THE REQUIREMENTS OF THE HOWARD COUNTY SOIL CONSERVATION DISTRICT.

Jan 15, 1986
 SIGNATURE DATE

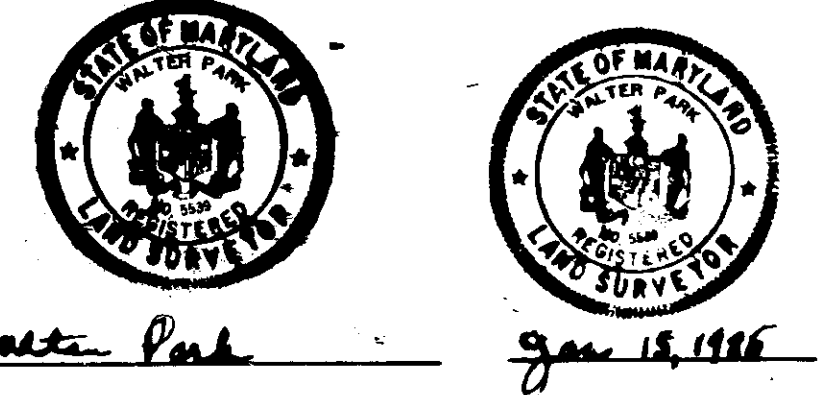

OWNER & DEVELOPER
 CONSOL. DATED HOME BUILDING CORP.
 SUITE 110 GORMAN PLAZA BLDG.
 8950 RTE. 108 COLUMBIA, MD. 21045
 993-0065

SURVEYORS & ENGINEERS
 HUDKINS ASSOCIATES, INC.
 200 5487 JOPPA ROAD
 RDUY 101, 5487 JOPPA ROAD
 TOWSON, MARYLAND 21204
 828-9060

SEDIMENT CONTROL PLAN
 LOTS 412 THRU 420
 COLUMBIA
 VILLAGE OF KINGS CONTRIVANCE
 SECTION 2 AREA 3 PHASE 3
 6TH. ELECT. DIST. HOWARD COUNTY, MARYLAND

- SEDIMENT CONTROL NOTES**
- (1) A minimum of 24 hours notice must be given to the Howard County Office of Inspections and Permits prior to the start of any construction (992-2437)
 - (2) All vegetative and structural practices are to be installed according to the provisions of this plan and are to be in conformance with the 1983 MARYLAND STANDARDS AND SPECIFICATIONS FOR SOIL EROSION AND SEDIMENT CONTROL.
 - (3) Following initial soil disturbance or redisturbance, permanent or temporary stabilization shall be completed within: (a) 7 calendar days for all perimeter sediment control structures, dikes, perimeter slopes and all slopes greater than 3:1, (b) 14 days as to all other disturbed or graded areas on the project site.
 - (4) All sediment traps/basins shown must be fenced and warning signs posted around their perimeter in accordance with Vol. 1, Chapter 12, of the HOWARD COUNTY DESIGN MANUAL, Storm Drainage.
 - (5) All disturbed areas must be stabilized within the time period specified above in accordance with the 1983 MARYLAND STANDARDS AND SPECIFICATIONS FOR SOIL EROSION AND SEDIMENT CONTROL for permanent seedings (Sec. 51) sod (Sec. 54), temporary seeding (Sec. 50) and mulching (Sec. 52). Temporary stabilization with mulch alone can only be done when recommended seeding rates do not allow for proper germination and establishment of grasses.
 - (6) All sediment control structures are to remain in place and are to be maintained in operative condition until permission for their removal has been obtained from the Howard County Sediment Control Inspector.
 - (7) Site Analysis:
 Total Area of Site 2.17 acres
 Area Disturbed 1.56 acres
 Area to be roofed or paved 0.63 acres
 Area to be vegetatively stabilized 1.04 acres
 - (8) Any sediment control practice is disturbed by grading activity for placement of utilities must be repaired on the same day of disturbance.
- Additional sediment controls must be provided, if deemed necessary by the Howard County DPW sediment control inspector.

- PERMANENT SEEDING NOTES**
- Apply to graded or cleared areas not subject to immediate further disturbance where permanent long-lived vegetative cover is needed.
- Soil Preparation: Loosen upper three inches of soil by raking, discing or other acceptable means before seeding.
- Soil Amendments: In lieu of soil test recommendations, use one of the following schedules
 (1) Preferred - Apply 2 tons per acre dolomitic limestone (92 lbs./1000 square ft.) and 600 lbs. per acre 10-10-10 fertilizer (14 lbs./1000 sq. ft.) before seeding. Harrow or disc into upper three inches of soil. At time of seeding apply 400 lbs. per acre 30-0-0 ureaform fertilizer (9 lbs./1000 sq ft.).
 (2) Acceptable - Apply 2 tons per acre dolomitic limestone (92 lbs./1000 sq ft.) and 1000 lbs. per acre 10-10-10 fertilizer (23 lbs./1000 sq ft.) before seeding. Harrow or disc into upper three inches of soil.
- Seeding - Doe rhw periods March 1 thru April 30, and August 1 thru October 15, seed with 60 lbs per acre (1.4 lbs./1000 sq ft) of Kentucky 31 Tall Fescue. For the period May 1 thru July 31, seed with 60 lbs Kentucky 31 Tall Fescue per acre and 2 lbs per acre (.05 lbs/1000 sq ft) of weeping lovegrass. During the period of October 16 thru February 28, protect site by: (1) 2 tons per acre of well anchored straw mulch and seed as soon as possible in the spring. Option (2) Use sod. Option (3) Seed with 60 lbs/acre Kentucky 31 Tall Fescue and mulch with 2 tons/acre well anchored straw.
- Mulching - Apply 1 1/2 to 2 tons per acre (70 to 90 lbs/1000 sq ft) of unrotted small grain straw immediately after seeding. Anchor mulch immediately after application using anchoring tool or 218 gallons per acre (5 gal./1000 sq ft) of emulsified asphalt on flat areas. On slopes 8 feet or higher, use 348 gallons per acre (8 gal/1000 sq ft) of anchoring.
- Maintenance - Inspect all seeded areas and make needed repairs, replacements and reseedings.

- TEMPORARY SEEDING NOTES**
- Apply to graded or cleared areas likely to be redisturbed where a short-term vegetative cover is needed.
- Soil Preparation: Loosen upper three inches of soil by raking, discing or other acceptable means before seeding.
- Soil Amendments: - Apply 600 lbs per acre 10-10-10 fertilizer (14 lbs/1000 sq ft).
- Seeding: For periods March 1 thru April 30 and from August 15 thru November 15, seed with 25 bushel per acre of annual rye (3.2 lbs/1000 sq ft). For the period May 1 thru August 14, seed with 3 lbs per acre of weeping lovegrass (.07 lbs/1000 sq ft). For the period November 16 thru February 28, protect site by applying 2 tons per acre of well anchored straw mulch and seed as soon as possible in the spring, or use sod.
- Mulching: Apply 1 1/2 to 2 tons per acre (70 to 90 lbs/1000 sq ft) of unrotted small grain straw immediately after seeding. Anchor mulch immediately after application using mulch anchoring tool or 218 gal per acre (5 gal/1000 sq ft) of emulsified asphalt on flat areas. On slopes, 8 ft or higher, use 348 gal per acre (8 gal/1000 sq ft) for anchoring.
- Refer to the 1983 MARYLAND STANDARDS AND SPECIFICATIONS FOR SOIL EROSION AND SEDIMENT CONTROL for rate and methods not covered.

STABILIZED CONSTRUCTION ENTRANCE

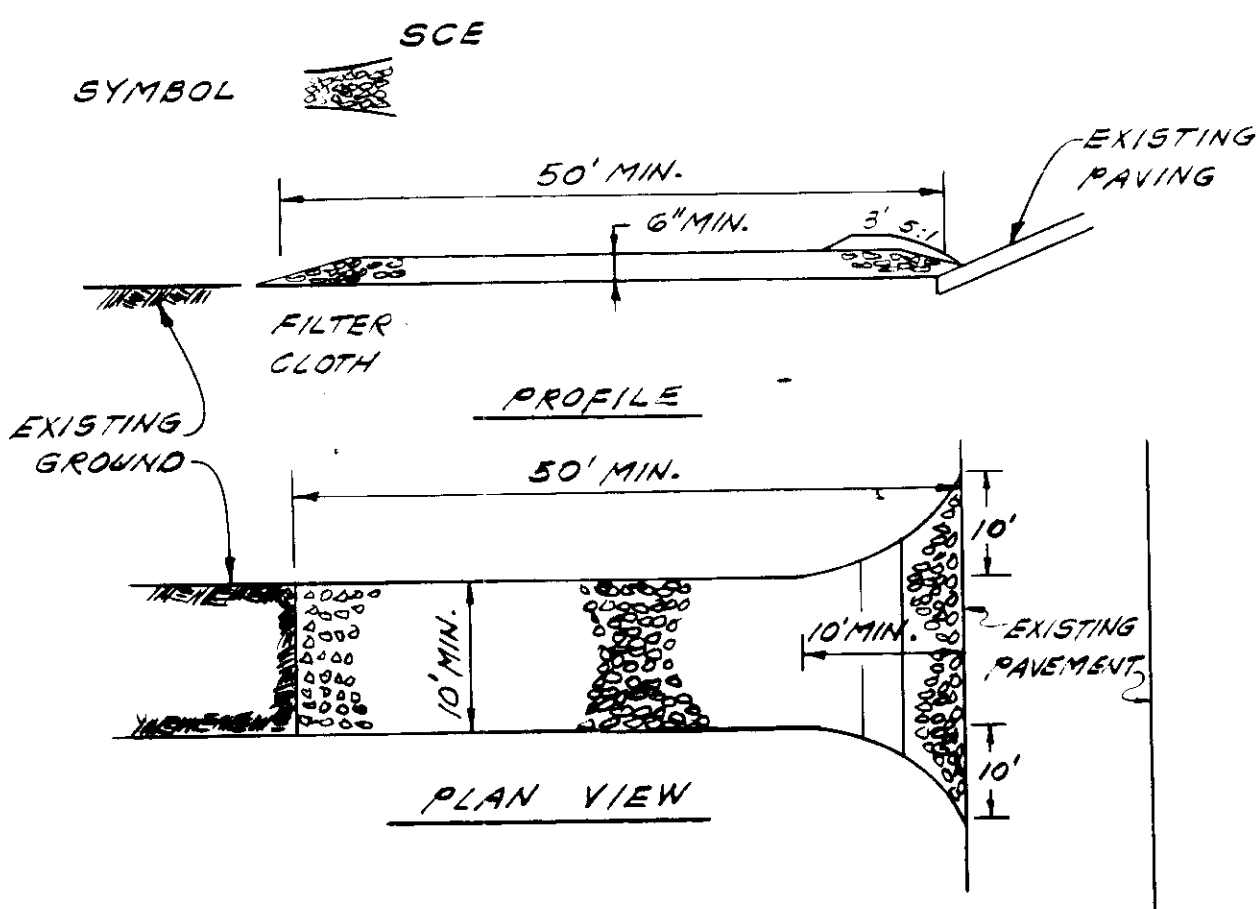

CONSTRUCTION SPECIFICATIONS

1. Stone sizes Use 2" stone, or reclaimed or recycled concrete equivalent.
2. Length - As required, but not less than 50 feet (except on a single residence lot where a 30 foot minimum length would apply).
3. Thickness - Not less than six (6) inches.
4. Width - Ten (10) feet minimum, but not less than the full width at point where ingress or egress occurs.
5. Filter Cloth - Will be placed over the entire area prior to placing of stone. Filler will not be required on a single family residence lot.
6. Surface Water - All surface water flowing or diverted toward construction entrance shall be piped across the entrance. If piping is impractical, a mountable beam with 50:1 slopes will be permitted.
7. Maintenance - The entrance shall be maintained in a condition which will prevent tracking or flowing of sediment onto public rights of way. This may require periodic top dressing with additional stone as conditions demand and repair and/or placement of any measure used to trap sediment. All sediment spilled, dropped, washed or tracked onto public rights of way must be removed immediately.
8. Washing wheels shall be cleaned to remove sediment prior to entrance onto public rights of way. When washing is required, it shall be done on an area stabilized with stone and which drains into an approved sediment trapping device.
9. Periodic inspection and needed maintenance shall be provided after each rain.

STRAW BALE DIKE

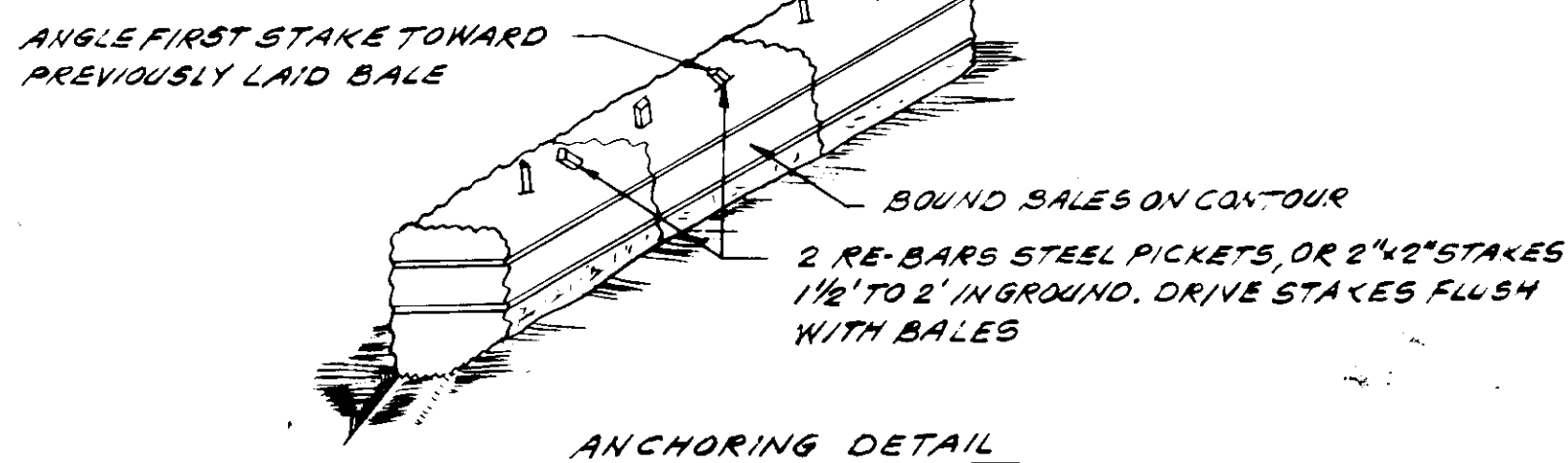
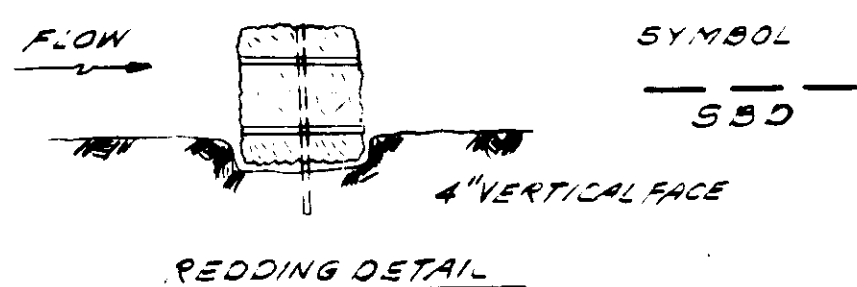

CONSTRUCTION SPECIFICATIONS

1. Bales shall be placed at the toe of a slope or on the contour and in a row with ends tightly abutting the adjacent bales.
2. Each bale shall be embedded in the soil a minimum of (4) inches, and placed so the bindings are horizontal.
3. Bales shall be securely anchored in place by either two stakes or rebar driven through the bale. The first stake in each bale shall be driven toward the previously laid bale at an angle to force the bales together. Stakes shall be driven flush with the bale.
4. Inspection shall be frequent and repair replacement shall be made promptly as needed.
5. Bales shall be removed when they have served their usefulness so as not to block or impede storm flow or drainage.

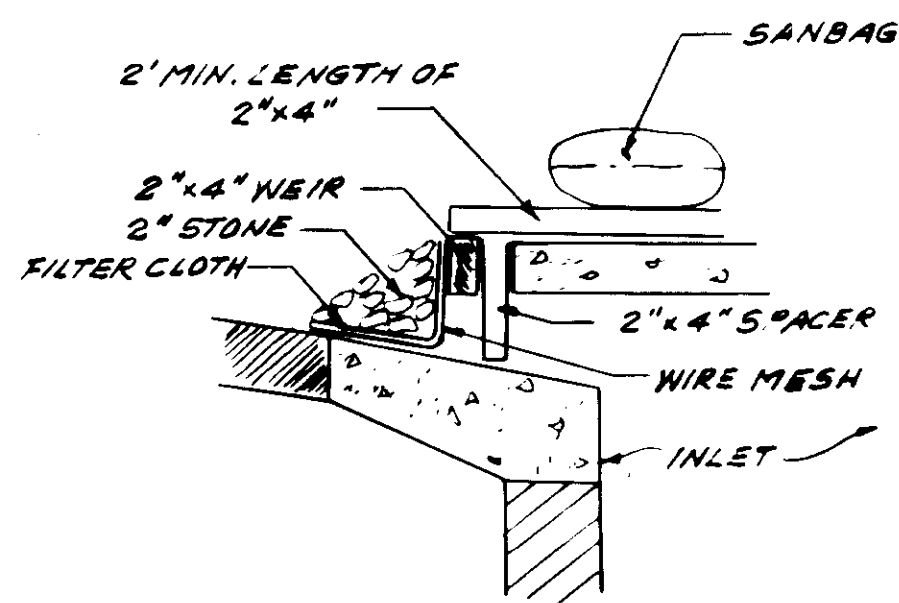

INLET PROTECTION DETAIL

STONE OUTLET SEDIMENT TRAP

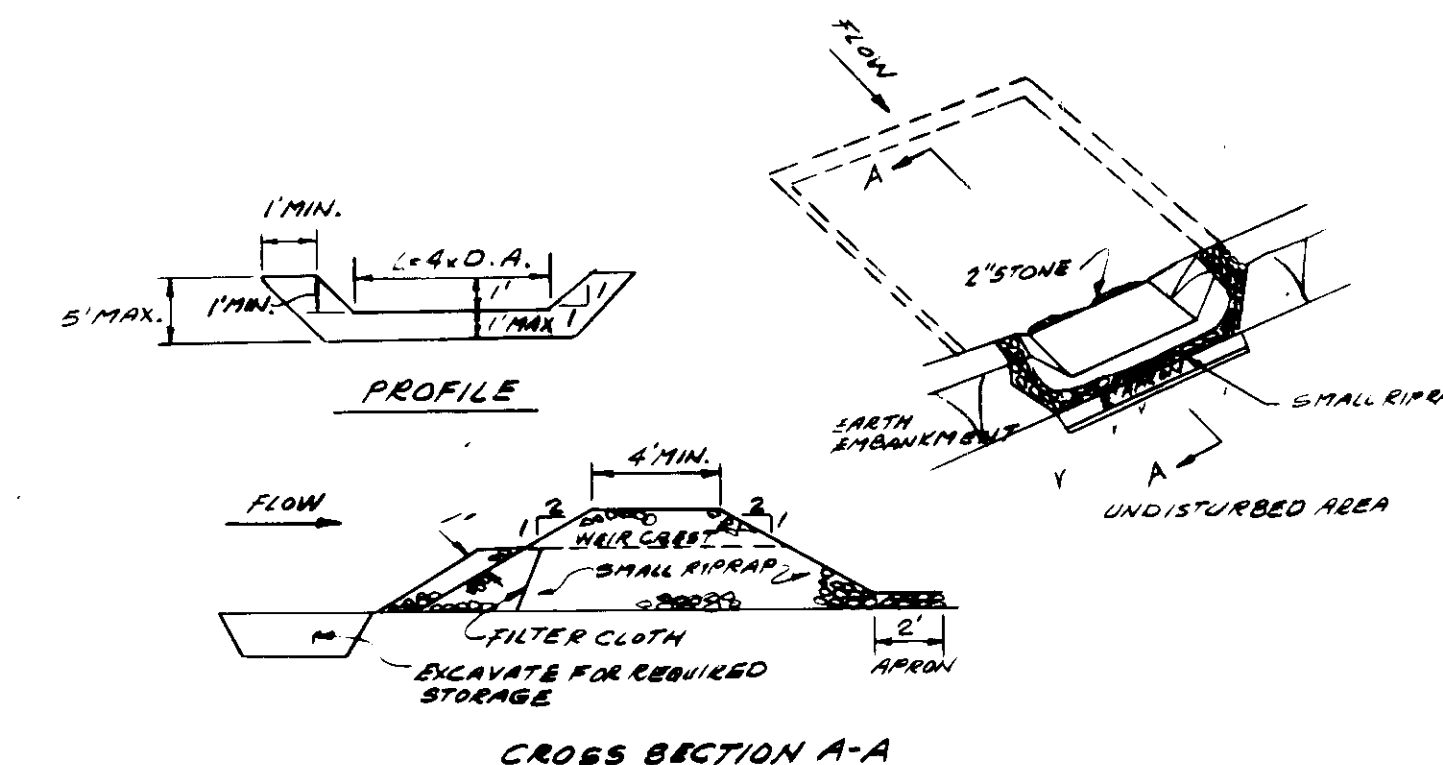

CONSTRUCTION SPECIFICATIONS FOR ST-V

1. Area under embankment shall be cleared, grubbed and stripped of any vegetation and root mat. The pool area shall be cleared.
2. The fill material of the embankment shall be free of roots and other woody vegetation as well as oversized stones, rocks, organic material or other objectionable material. The embankment shall be compacted by traversing with equipment while it is being constructed.
3. All cut and fill slopes shall be 2:1 or flatter.
4. The stone used in the outlet shall be small riprap 4"-8" along with a 1' thickness of 2" aggregate placed on the up-grade side on the small riprap or embedded filter cloth in the riprap.
5. Sediment shall be removed and trap restored to its original dimensions when the sediment has accumulated to 1/2 the design depth of the trap.
6. The structure shall be inspected after each rain and repairs made as needed.
7. Construction operations shall be carried out in such a manner that erosion and water pollution is minimized.
8. The structure shall be removed and the area stabilized when the drainage area has been properly stabilized.

EARTH DIKE

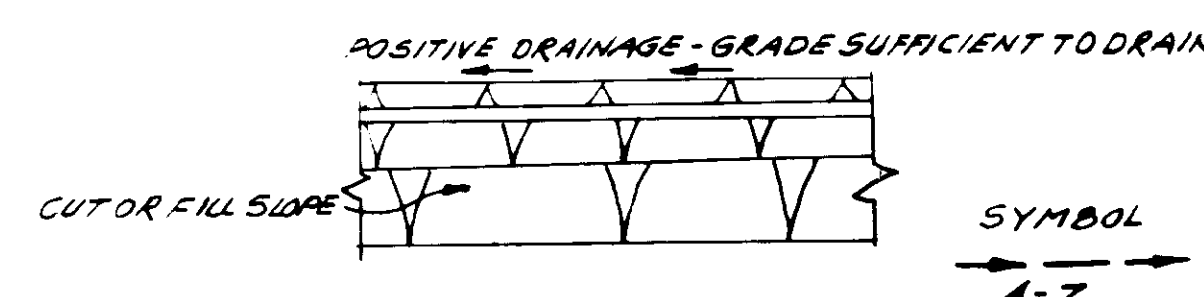
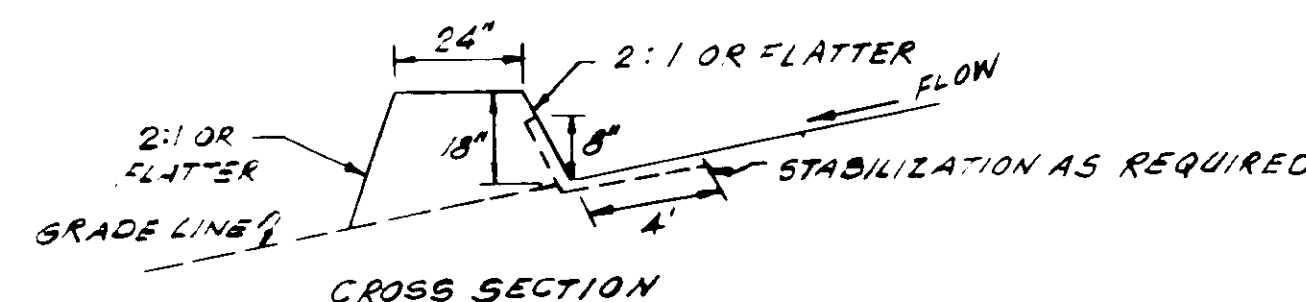

CONSTRUCTION SPECIFICATIONS

1. All dikes shall be compacted by earth-moving equipment.
2. All dikes shall have positive drainage to an outlet.
3. Top width may be wider and side slopes may be flatter if desired to facilitate crossing by construction traffic.
4. Field location should be adjusted as needed to utilize a stabilized safe outlet.
5. Earth dikes shall have an outlet that functions with a minimum of erosion. Runoff shall be conveyed to a sediment trapping device such as a sediment trap or sediment basin where either the dike channel or the drainage area above the dike are not adequately stabilized.
6. Stabilization shall be: (A) In accordance with standard specifications for seed and straw mulch or straw mulch if not in seeding season. (B) Flow channel as per the chart below.

Type of Treatment	Channel Grade	Dike A	Dike B
1	.5-3.0%	Seed and Straw Mulch	Seed and Straw Mulch
2	3.1-5.0%	Seed and Straw Mulch	Seed using dute or Excelsior; Sod; 2" Stone
3	5.1-8.0%	Seed with Jute, or Sod; 2" Stone	Lined Rip-Rap 4-8"
4.	8.1-20%	Lined Rip-Rap 4-8"	Engineering Design

- A. Stone to be 2 inch stone, or recycled concrete equivalent, in a layer at least 3 inches in thickness and be pressed into the soil with construction equipment.
 - B. Rip-Rap to be 4-8 inches in a layer at least 8 inches thickness and pressed into the soil.
 - C. Approved equivalents can be substituted for any of the above materials.
7. Periodic inspection and required maintenance must be provided after each rain event.

THIS PLAN IS APPROVED FOR SOIL EROSION AND SEDIMENT CONTROL BY THE HOWARD S.C.D.
 HOWARD S.C.D. DATE 4/29/85
 REVIEWED FOR HOWARD S.C.D. AND MEETS TECHNICAL REQUIREMENTS
 U.S. SOIL CONSERVATION SERVICE DATE 4/29/85

APPROVED
 DIVISION OF LAND DEVELOPMENT & ZONING ADMINISTRATION
 HOWARD COUNTY, MARYLAND
 DATE 4-16-85

APPROVED: HOWARD COUNTY OFFICE OF PLANNING & ZONING
 PLANNING DIRECTOR DATE 5-7-85
 CHIEF, DIVISION OF LAND DEVELOPMENT & ZONING ADMIN. DATE 5-6-85
 APPROVED: FOR PUBLIC WATER & PUBLIC SEWERAGE SYSTEMS. HOWARD COUNTY HEALTH DEPARTMENT.
 COUNTY HEALTH OFFICER DATE 5-7-85
 APPROVED: FOR PUBLIC WATER, PUBLIC SEWER, STORM DRAINAGE SYSTEMS & PUBLIC ROADS. HOWARD COUNTY DEPT. OF PUBLIC WORKS.
 DIRECTOR DATE 5-1-85
 CHIEF BUREAU OF ENGINEERING DATE 4-30-85

CERTIFICATION BY DEVELOPER
 I CERTIFY THAT ALL DEVELOPMENT AND/OR CONSTRUCTION WILL BE DONE ACCORDING TO THIS PLAN OF DEVELOPMENT AND PLAN FOR EROSION & SEDIMENT CONTROL & THAT ALL RESPONSIBLE PERSONNEL INVOLVED WITH THE CONSTRUCTION PROJECT WILL HAVE A CERTIFICATE OF ATTENDANCE AT A DEPT. OF NATURAL RESOURCES APPROVED TRAINING PROGRAM FOR THE CONTROL OF SEDIMENT & EROSION BEFORE BEGINNING THE PROJECT.
 I ALSO AUTHORIZE PERIODIC ONSITE INSPECTIONS BY THE HOWARD SOIL CONSERVATION DISTRICT OR THEIR AUTHORIZED AGENTS AS ARE DEEMED NECESSARY.
 SIGNATURE DATE 4/28/85

CERTIFICATION BY ENGINEER
 I CERTIFY THAT THIS PLAN OF DEVELOPMENT & PLAN FOR EROSION & SEDIMENT CONTROL REPRESENTS A PRACTICAL & WORKABLE PLAN BASED ON MY KNOWLEDGE OF THE SITE CONDITIONS & THAT IT HAS PREPARED IN ACCORDANCE WITH THE REQUIREMENTS OF THE HOWARD COUNTY SOIL CONSERVATION DISTRICT.
 STATE OF MARYLAND REGISTERED PROFESSIONAL LAND SURVEYOR
 Walter Paul DATE 4-15-1985

OWNER & DEVELOPER
 CONSOLIDATED HOME BUILDING CORP.
 SUITE 110 GORMAN PLAZA BLDG.
 8950 RTE. 108 COLUMBIA, MD. 21045
 935-0065

SURVEYORS & ENGINEERS
 HUDKINS ASSOCIATES, INC.
 200 EAST JOHNSA ROAD
 ROOM 101, SHELL BUILDING
 TOWSON, MARYLAND 21284
 828-9060

SEDIMENT CONTROL PLAN
 LOTS 412 THRU 420
 COLUMBIA
 VILLAGE OF KINGS CONTRIVANCE
 SECTION 2 AREA 3 PHASE 3
 6TH. ELECT. DIST. HOWARD COUNTY, MARYLAND