

SHEET INDEX

NO	DESCRIPTION
1	TITLE SHEET
2	SITE DEVELOPMENT PLAN
3	DRAINAGE AREA MAP, SEDIMENT CONTROL PLAN, & STORM WATER MANAGEMENT
4	SEDIMENT CONTROL DETAILS
5	DETAILS
6	PLANTING PLAN

GENERAL NOTES

- ALL WATER LINES SHALL BE CONSTRUCTED A MINIMUM OF 42" COVER BELOW FINISHED GRADE.
- CORRUGATED STEEL PIPE SECTIONS WILL BE JOINED WITH A SINGLE OR TWO PIECE CORRUGATED BAND WITH A WATERTIGHT NEOPRENE GASKET. DIMPLE BAND CONNECTORS WILL NOT BE PERMITTED.
- ALL WORK SHALL BE PERFORMED IN ACCORDANCE WITH THE HOWARD COUNTY DESIGN MANUAL, VOLUME IV, I.P.C., STANDARD SPECIFICATIONS AND DETAILS FOR CONSTRUCTION.
- APPROXIMATE LOCATION OF EXISTING UTILITIES ARE SHOWN. THE CONTRACTOR SHALL TAKE ALL NECESSARY PRECAUTIONS TO PROTECT THE EXISTING UTILITIES AND MAINTAIN UNINTERRUPTED SERVICE. ANY DAMAGE INCURRED DUE TO CONTRACTOR'S OPERATION SHALL BE REPAIRED IMMEDIATELY AT THE CONTRACTOR'S EXPENSE.
- THE CONTRACTOR SHALL TEST PIT EXISTING UTILITIES, WHERE DIRECTED BY THE ENGINEER, A MINIMUM OF TWO WEEKS IN ADVANCE OF CONSTRUCTION OPERATIONS.
- CONTRACTOR TO NOTIFY THE FOLLOWING UTILITIES OR AGENCIES AT LEAST FIVE DAYS BEFORE STARTING WORK SHOWN ON THESE DRAWINGS:

MISS UTILITY	559-0100
C & P TELEPHONE COMPANY	725-9976
HOWARD COUNTY BUREAU OF UTILITIES	992-2366
AT&T CABLE LOCATION DIVISION	393-3553
BALTIMORE GAS & ELECTRIC COMPANY	685-0123
STATE HIGHWAY ADMINISTRATION	531-5533
HOWARD COUNTY CONSTRUCTION/INSPECTION SURVEY DIVISION (24 HOURS NOTICE PRIOR TO COMMENCEMENT OF WORK)	792-7272
- ALL INLETS SHALL BE CONSTRUCTED IN ACCORDANCE WITH HOWARD COUNTY STANDARDS.
- ALL PIPE ELEVATIONS SHOWN ARE INVERT \bigcirc ELEVATIONS.
- THE CONTRACTOR SHALL PROVIDE A JOINT IN ALL SEWER MAINS WITHIN 2'-0" OF EXTERIOR MANHOLE WALLS.
- PROFILE STATIONS SHALL BE ADJUSTED AS NECESSARY TO CONFORM TO PLAN DIMENSIONS.
- NO PIPE SHALL BE LAID UNTIL LINES OF EXCAVATION HAVE BEEN BROUGHT TO SUBGRADE.
- TOPO TAKEN FROM FIELD RUN SURVEY DATED **DECEMBER**, 1984
- ALL PLAN DIMENSIONS ARE TO FACE OF CURB UNLESS OTHERWISE NOTED.
- ALL STORM DRAIN PIPE BEDDING SHALL BE AS SHOWN IN DETAIL G2.01 OF VOLUME IV OF HOWARD COUNTY DESIGN MANUAL UNLESS OTHERWISE DIRECTED BY THE ENGINEER.
- THE DEVELOPER IS RESPONSIBLE FOR THE ACQUISITION OF ALL EASEMENTS, RIGHTS AND/OR RIGHTS-OF-WAY THAT MAY BE REQUIRED FOR THE SEDIMENT AND EROSION CONTROL PRACTICES, STORM WATER MANAGEMENT PRACTICES AND THE DISCHARGE OF STORM WATER ONTO OR ACROSS ADJACENT OR DOWNSTREAM PROPERTIES INCLUDED IN THIS PLAN. HE IS ALSO RESPONSIBLE FOR THE ACQUISITION OF ALL EASEMENTS, RIGHTS AND/OR RIGHTS-OF-WAY THAT MAY BE REQUIRED FOR GRADING AND/OR WORK ON ADJACENT PROPERTIES INCLUDED IN THIS PLAN PRIOR TO CONSTRUCTION.
- SELECT FILL REFERS TO COMPACTION IN ACCORDANCE WITH ASTM 1587.

SITE TABULATION

ZONING	M-2
TOTAL AREA	4.552 Ac. (198,285.12 SF.)
BUILDING COVERAGE (150' x 402')	60,300 SF. (30%)
PARKING REQUIRED	121 SPACES
@ 1 CAR/500 SF	
PARKING PROVIDED	133 SPACES
HANDICAPPED SPACES PROVIDED	5 SPACES
OPEN SPACE REQUIRED	20,657 SF (20%)
OPEN SPACE PROVIDED	59,577 SF (30%)
EMPLOYEES & PARKING OFFICE	9,045 SF
@ 1 PERSON / 150 SF = 61 EMPLOYEES	
@ 7 CARS / 10 EMPLOYEES = 45 SPACES	
WAREHOUSE	51,255 SF
@ 1 PERSON / 1000 SF = 51 EMPLOYEES	
@ 1 CAR / 1 EMPLOYEE = 51 SPACES	
TOTAL REQUIRED PARKING	95 SPACES
BUILDING WILL BE A SINGLE STORY STRUCTURE WITH BUILDING COVERAGE OF 60,300 SF.	

SITE DEVELOPMENT PLAN

PARCEL M

BALTIMORE WASHINGTON INDUSTRIAL PARK

BLOCK E

6TH ELECTION DISTRICT

HOWARD COUNTY, MARYLAND

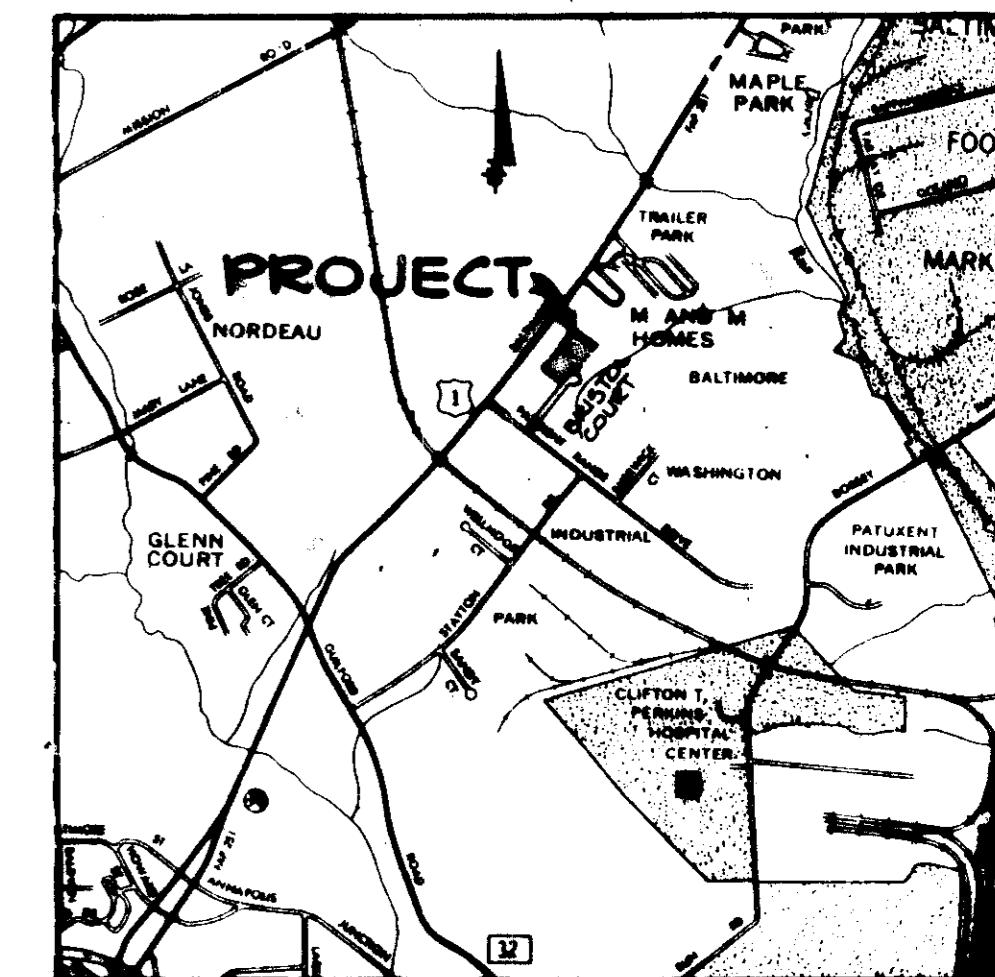

VICINITY MAP
SCALE 1"=2000'

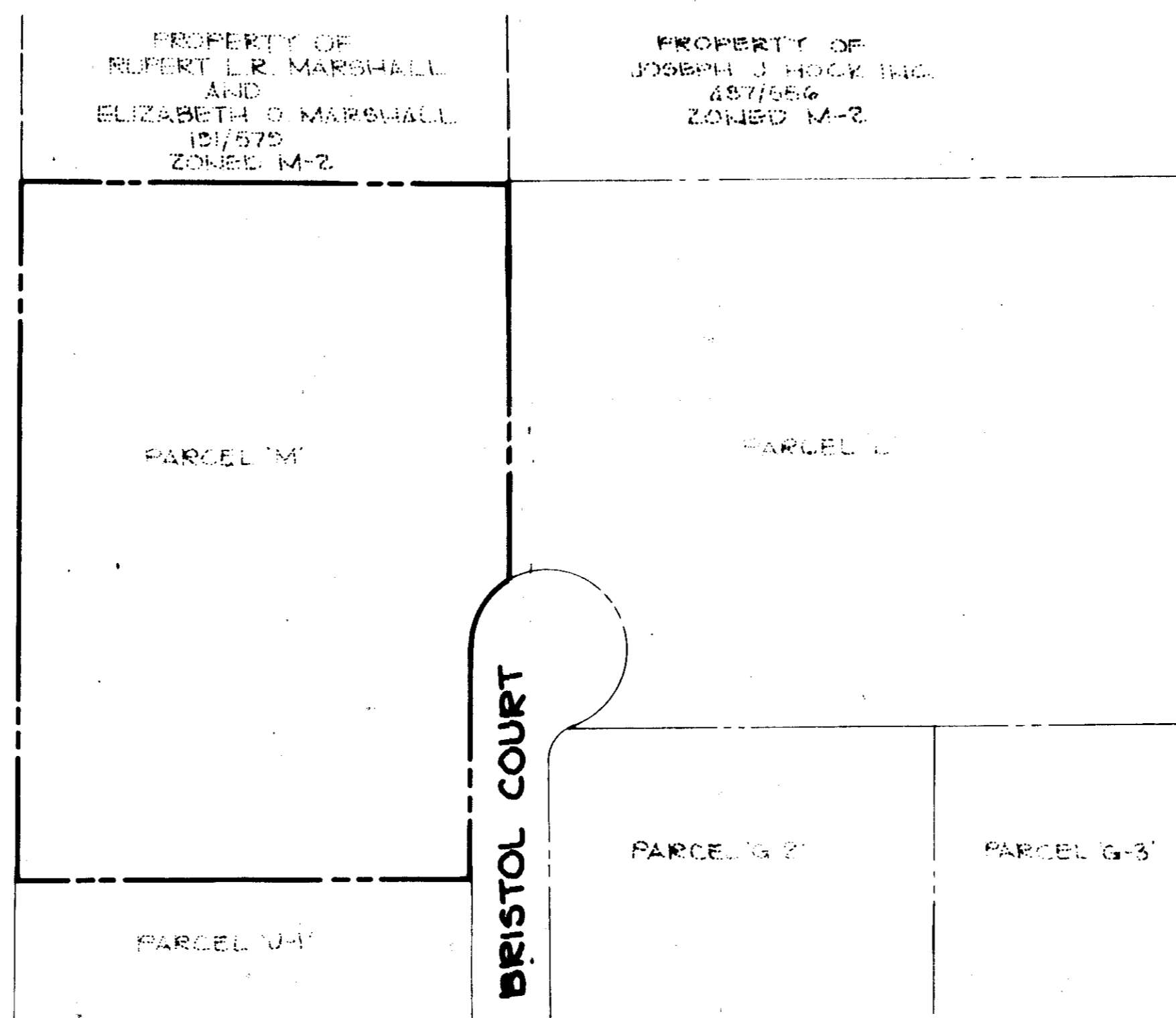

PLAN
SCALE 1"=100'

ADDRESS CHART	
NUMBER	OFFICE ADDRESS
PARCEL 'M'	8551 BRISTOL COURT

UNIVERSITY BLDG	BLOCK 'E'	PARCEL 'M'
DALT/WASH INDUSTRIAL PARK		
PLAT 1 BY 1	1	M-2
TAX MAP 48	6TH	6064
OWNER USE	802	3155000

APPROVED
DIVISION OF LAND DEVELOPMENT & ZONING ADMINISTRATION
HOWARD COUNTY, MARYLAND
DATE **3-26-85**

APPROVED: FOR PUBLIC WATER AND PUBLIC SEWERAGE SYSTEMS, HOWARD COUNTY HEALTH DEPARTMENT.
[Signature] / *[Signature]*
COUNTY HEALTH OFFICER / DATE

APPROVED: HOWARD COUNTY OFFICE OF PLANNING AND ZONING.
[Signature] / *[Signature]* 6-3-85
PLANNING DIRECTOR / DATE
[Signature] / *[Signature]* 6-3-85
CHIEF, DIVISION OF LAND DEVELOPMENT AND ZONING ADMINISTRATION / DATE

APPROVED: FOR PUBLIC WATER, PUBLIC SEWERAGE, STORM DRAINAGE SYSTEMS AND PUBLIC ROADS.
HOWARD COUNTY DEPARTMENT OF PUBLIC WORKS
[Signature] / *[Signature]* 5-28-85
DIRECTOR / DATE
[Signature] / *[Signature]* 6-28-85
CHIEF, BUREAU OF ENGINEERING / DATE

DATE	NO	REVISION

OWNER/DEVELOPER
CRYSEN B/WI WAREHOUSE #2, LTD PARTNERSHIP
710 AMERICAN CITY BUILDING
COLUMBIA, MARYLAND 21044

PROJECT
BWIP PARCEL 'M'

AREA TAX MAP NO 48 PARCEL 'M' BLOCK 'E'
BALTIMORE WASHINGTON INDUSTRIAL PARK
6TH ELECTION DISTRICT
HOWARD COUNTY, MARYLAND

TITLE
TITLE SHEET

THE RIEMER GROUP, INC.
A LAND PLANNING, DESIGN & CIVIL ENGINEERING FIRM
3105 HEALTH PARK DRIVE, ELLICOTT CITY, MD. 21043 301-481-2892

DESIGNED BY PCJ
DRAWN BY DAM
PROJECT NO 010000
DATE 1-10-85
SCALE AS SHOWN
DRAWING NO. 1 OF 6

BALTIMORE WASHINGTON INDUSTRIAL PARK
 PARCEL 'M-1'
 ZONED M-2
 PLAT NO. 4755

PROPERTY OF HARRY WALLER
 PARCEL 'M-1'

PROPOSED TIMBER
 RETAINING WALL
 (SEE DETAIL SHEET 5)

PROPOSED BUILDING
 F.P. ELEV. 250.0
 PARCEL 'M'
 4552 AC
 ZONED M-2

BRISTOL COURT
 BALTIMORE WASHINGTON INDUSTRIAL PARK
 PARCEL 'M-2'
 ZONED M-2
 PLAT NO. 4755

SOUTH ELEVATION

LEGEND
 CONTOUR INTERVALS 2'
 SPOT ELEVATION 250.0
 EXISTING CONTOURS -250
 PROPOSED CONTOURS -254
 P-1 PAVING
 P-3 PAVING

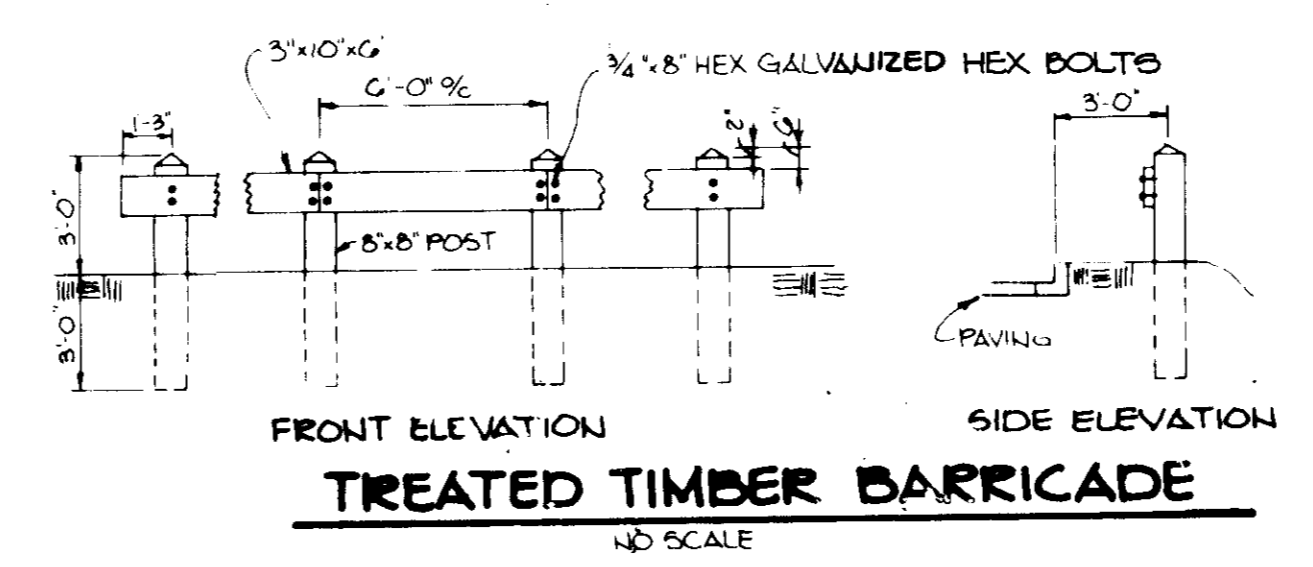

APPROVED
 DIVISION OF LAND DEVELOPMENT &
 ZONING ADMINISTRATION
 HOWARD COUNTY, MARYLAND
 DATE 3-26-85
 AS/AM

APPROVED FOR PUBLIC WATER AND PUBLIC SEWERAGE SYSTEMS, HOWARD COUNTY HEALTH DEPARTMENT.
 APPROVED DATE 5/21/85
 COUNTY HEALTH OFFICER

APPROVED HOWARD COUNTY OFFICE OF PLANNING AND ZONING.
 APPROVED DATE 6-3-85
 PLANNING DIRECTOR
 APPROVED DATE 6-3-85
 CHIEF, DIVISION OF LAND DEVELOPMENT AND ZONING ADMINISTRATION

APPROVED FOR PUBLIC WATER, PUBLIC SEWERAGE, STORM DRAINAGE SYSTEMS AND PUBLIC ROADS.
 HOWARD COUNTY DEPARTMENT OF PUBLIC WORKS
 APPROVED DATE 5-21-85
 DIRECTOR
 APPROVED DATE 5-23-85
 CHIEF, BUREAU OF ENGINEERING

OWNER/DEVELOPER
 CRYSTEN BWI WAREHOUSE #2
 LIMITED PARTNERSHIP
 710 AMERICAN CITY BUILDING
 COLUMBIA, MARYLAND 21044

PROJECT
 BW.I.P. PARCEL M
 AREA TAX MAP NO. 45 PARCEL 'M' BLOCK 'B'
 BALTIMORE WASHINGTON INDUSTRIAL PARK
 6TH ELECTION DISTRICT
 HOWARD COUNTY, MARYLAND

TITLE
SITE DEVELOPMENT PLAN

THE RIEMER GROUP, INC.
 A LAND PLANNING, DESIGN & CIVIL ENGINEERING FIRM
 3105 HEALTH PARK DRIVE, ELLICOTT CITY, MD. 21043 301 461-2690

DESIGNED BY JDP
 DRAWN BY PER
 PROJECT NO 010000
 DATE 1-10-85
 SCALE 1" = 30'
 DRAWING NO. 2 OF 2

SDP-85-117 FEB. 15. 1985

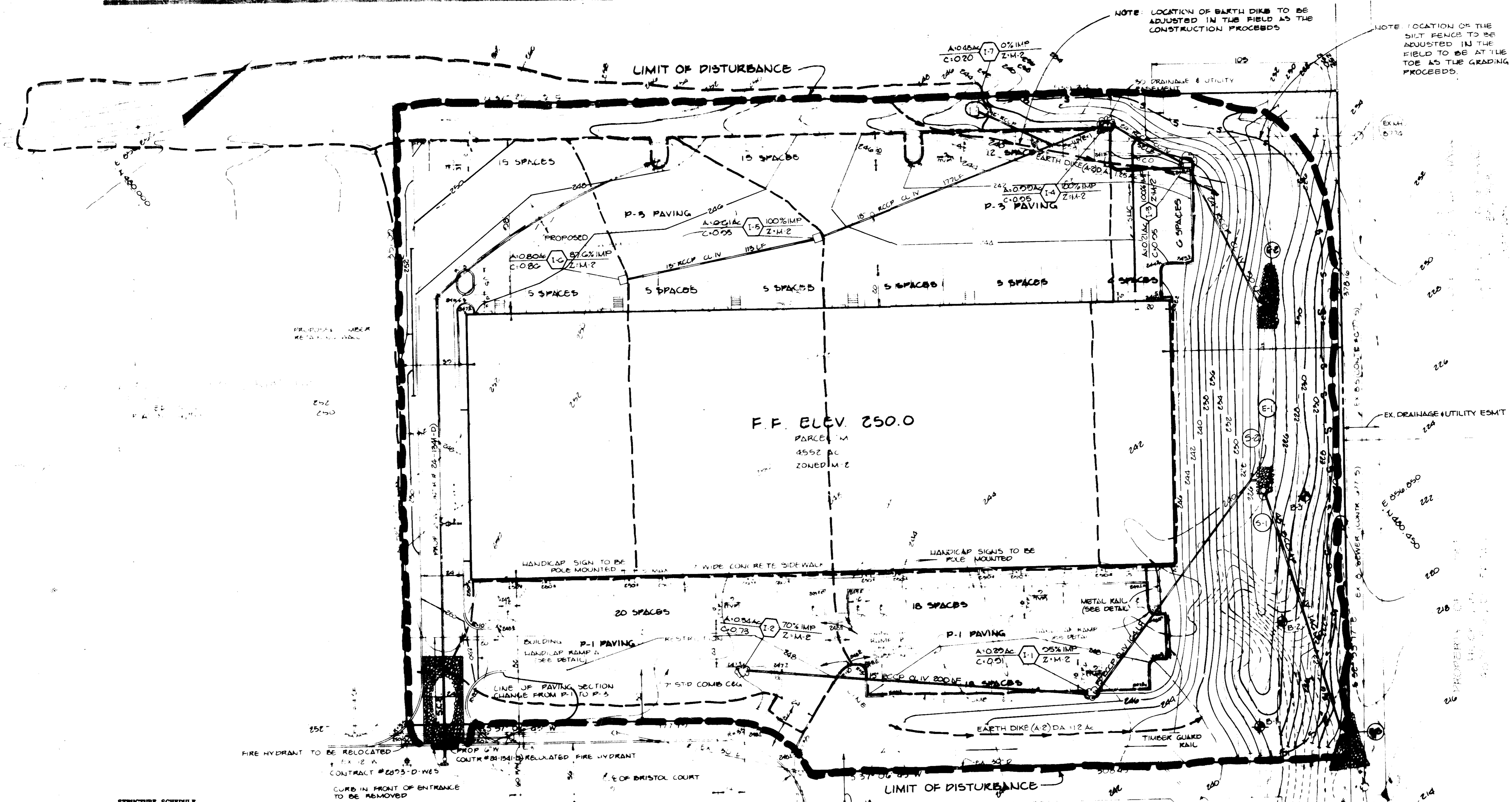

NOTE: LOCATION OF BARTH DIKE TO BE ADJUSTED IN THE FIELD AS THE CONSTRUCTION PROCEEDS

NOTE: LOCATION OF THE SILT FENCE TO BE ADJUSTED IN THE FIELD TO BE AT THE TOE AS THE GRADING PROCEEDS.

F.F. ELEV. 250.0
PARCEL M
4552 AC
ZONED IM-2

BRISTOL COURT

STRUCTURE	TYPE	INV. IN	INV. OUT	TOP ELEV	TOP OF CURB ELEV
I-1	No. Co. Std. A-5 Inlet SD 4.01	240.17	240.17	----	247.00
I-2	No. Co. Std. A-5 Inlet SD 4.01	----	245.06	----	248.10
I-3	No. Co. Std. A-5 Inlet SD 4.01	234.88	234.88	----	241.80
I-4	No. Co. Std. A-10 Inlet SD 4.02	235.80	235.30	----	240.80
I-5	No. Co. Std. Double 'S' Inlet SD 4.23	238.74	238.49	244.60	----
I-6	No. Co. Std. Double 'S' Inlet SD 4.23	----	241.00	245.30	----
I-7	No. Co. Std. Yard Inlet SD 4.14	----	236.96	239.50	----
E-1	No. Co. Std. 15" RCCP End Section SD 5.51	224.00	----	----	----
E-2	No. Co. Std. 24" RCCP End Section SD 5.51	224.88	----	----	----
E-3	No. Co. Std. 48" BUMP End Section SD 5.51	222.0	----	----	----
WYE-1	Prefabricated 45 Degree RCCP WYE	236.54	----	241.00	----
S-1	48" BUMP RISER PIPE	222.0	222.0	227.80	----
S-2	PREFABRICATED 15" 45 DEGREE RCCP BEND	223.13	223.13	----	----

- SEQUENCE OF CONSTRUCTION**
- OBTAIN GRADING PERMIT.
 - INSTALL STABILIZED CONSTRUCTION ENTRANCES, SILT FENCE.
 - CONSTRUCT STORM WATER MANAGEMENT FACILITY. INSTALL THE RISER PIPE, PLUG IS ORIFICE, CONSTRUCT THE EARTH DIKE AND ADJUST THE SILT FENCE.
 - INSTALL REMAINING STORM DRAINAGE UTILITIES, BURIAL ALL UTILITIES AND 6" STABILIZE ALL DISTURBED AREAS, IN ACCORDANCE WITH THE PERMANENT SEEDING NOTES.
 - UPON APPROVAL OF THE DEPARTMENT OF PUBLIC WORKS SEDIMENT CONTROL INSPECTOR, REMOVE ALL SEDIMENT CONTROL DEVICES AND CONVERT SEDIMENT TRAP TO STORM WATER MANAGEMENT AS FOLLOWS:
 - REMOVE AND IMPROVED WATER
 - REMOVE SEDIMENT AND PLANT AS DIRECTED BY THE DEPARTMENT OF PUBLIC WORKS SEDIMENT CONTROL INSPECTOR AND RESTORE BASED TO ORIGINAL DIMENSIONS AS SHOWN ON SITE PLAN
 - REMOVE BULKHEADS AT S1
 - PLACE RISE PIPE AT E1 AND E2
 - SEED ALL DISTURBED AREAS IN ACCORDANCE WITH THE PERMANENT SEEDING NOTES.

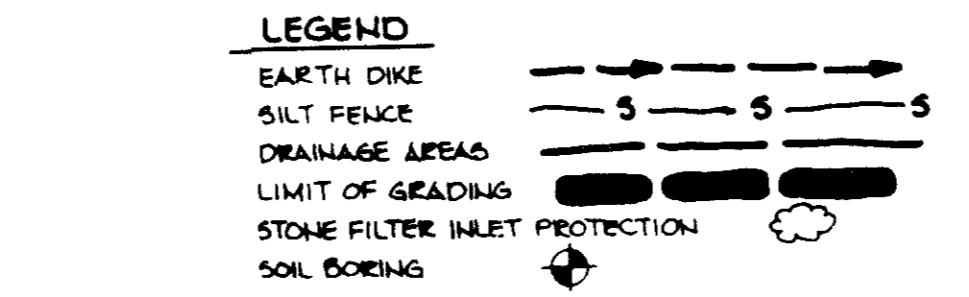

SEDIMENT BASIN DATA

DRAINAGE AREA	4.02 AC
STORAGE REQ'D	7300 CF
STORAGE PROVIDED	8500 CF
RISER CREST ELEV	226.5
BOTTOM ELEV	222.0
CLEANOUT ELEV	225.0

SITE ANALYSIS

DISTURBED AREA	4.18 AC
PAVED AREA	1.80 AC
ROOF AREA	1.38 AC
AREA TO BE RESEEDED	1.00 AC
EARTH QUANTITIES	
CUT	14,073 CY
FILL	0152 CY
TOPSOIL	000 CY

BY THE DEVELOPER:

"I CERTIFY THAT ALL DEVELOPMENT AND/OR CONSTRUCTION WILL BE DONE ACCORDING TO THESE PLANS, AND THAT ANY RESPONSIBLE PERSONNEL INVOLVED IN THE CONSTRUCTION PROJECT WILL HAVE A CERTIFICATE OF ATTENDANCE AT A DEPARTMENT OF NATURAL RESOURCES APPROVED TRAINING PROGRAM FOR THE CONTROL OF SEDIMENT AND EROSION BEFORE BEGINNING THE PROJECT. I WILL PROVIDE THE HOWARD SOIL CONSERVATION DISTRICT WITH AN 'AS-BUILT' PLAN OF THE POND WITHIN 30 DAYS OF COMPLETION."

CRYSSEN BVI LIMITED PARTNERSHIP BY SIENA CORPORATION
DEVELOPER (ALL) HOLY MANGANARO

BY THE ENGINEER:

"I CERTIFY THAT THIS PLAN FOR POND CONSTRUCTION, EROSION AND SEDIMENT CONTROL REPRESENTS A PRACTICAL AND WORKABLE PLAN BASED ON MY PERSONAL KNOWLEDGE OF THE SITE CONDITIONS. THIS PLAN WAS PREPARED IN ACCORDANCE WITH THE REQUIREMENTS OF THE HOWARD SOIL CONSERVATION DISTRICT. I HAVE NOTIFIED THE DEVELOPER THAT HE MUST PROVIDE THE HOWARD SOIL CONSERVATION DISTRICT WITH AN 'AS-BUILT' PLAN OF THE POND WITHIN 30 DAYS OF COMPLETION."

ENGINEER: PATRICK C. JELLIINGS II
DATE: 5/21/85

THESE PLANS HAVE BEEN REVIEWED FOR THE HOWARD SOIL CONSERVATION DISTRICT AND MEET THE TECHNICAL REQUIREMENTS FOR SMALL POND CONSTRUCTION, SOIL EROSION AND SEDIMENT CONTROL.

U.S. SOIL CONSERVATION SERVICE
DATE: 5/23/85

THESE PLANS FOR SMALL POND CONSTRUCTION, SOIL EROSION AND SEDIMENT CONTROL MEET THE REQUIREMENTS OF THE HOWARD SOIL CONSERVATION DISTRICT.

APPROVED: HOWARD COUNTY HEALTH DEPARTMENT
DATE: 5/23/85

APPROVED: FOR PUBLIC WATER AND PUBLIC SEWERAGE SYSTEMS, HOWARD COUNTY HEALTH DEPARTMENT.

COUNTY HEALTH OFFICER
DATE: 5/21/85

APPROVED: HOWARD COUNTY OFFICE OF PLANNING AND ZONING.

PLANNING DIRECTOR
DATE: 6-3-85

APPROVED: FOR PUBLIC WATER, PUBLIC SEWERAGE, STORM DRAINAGE SYSTEMS, AND PUBLIC ROADS.

HOWARD COUNTY DEPARTMENT OF PUBLIC WORKS
DATE: 5-21-85

APPROVED: CHIEF, BUREAU OF ENGINEERING

DATE: 5-23-85

7/16/85 REVISED I-G AND I-7
DATE NO. REVISION

OWNER DEVELOPER
CRYSSEN BVI WAREHOUSE #2
LIMITED PARTNERSHIP
710 AMERICAN CITY BUILDING
COLUMBIA, MARYLAND 21044

PROJECT: BW.I.P. PARCEL M, BLK. E.

AREA: TAX MAP NO 40
BALTIMORE WASHINGTON INDUSTRIAL PARK
6TH ELECTION DISTRICT
HOWARD COUNTY, MARYLAND

TITLE: DRAINAGE AREA MAP
SEDIMENT CONTROL PLAN
STORM WATER MANAGEMENT PLAN

THE RIEMER GROUP, INC.
A LAND PLANNING, DESIGN & CIVIL ENGINEERING FIRM
3000 HUNTER PARK DRIVE, ELLESMERE, MD. 21043

APPROVED
DIVISION OF LAND DEVELOPMENT &
ZONING ADMINISTRATION
HOWARD COUNTY, MARYLAND
DATE: 3-26-85
M/J

DESIGNED BY: JDF
DRAWN BY: PER
PROJECT NO: 010000
DATE: 1-16-85
SCALE: 1" = 30'
DRAWING NO: 3 OF 6

CONCRETE

1. All concrete shall be placed and finished in accordance with the specifications of the American Concrete Institute (ACI) and the Maryland Department of Public Works. The concrete shall be placed in a continuous operation and shall be finished with a float and trowel. The concrete shall be cured with a minimum of 7 days. The concrete shall be tested in accordance with the specifications of the American Concrete Institute (ACI) and the Maryland Department of Public Works. The concrete shall be placed in a continuous operation and shall be finished with a float and trowel. The concrete shall be cured with a minimum of 7 days. The concrete shall be tested in accordance with the specifications of the American Concrete Institute (ACI) and the Maryland Department of Public Works.

STEEL

1. All steel shall be placed and finished in accordance with the specifications of the American Institute of Steel Construction (AISC) and the Maryland Department of Public Works. The steel shall be placed in a continuous operation and shall be finished with a float and trowel. The steel shall be cured with a minimum of 7 days. The steel shall be tested in accordance with the specifications of the American Institute of Steel Construction (AISC) and the Maryland Department of Public Works.

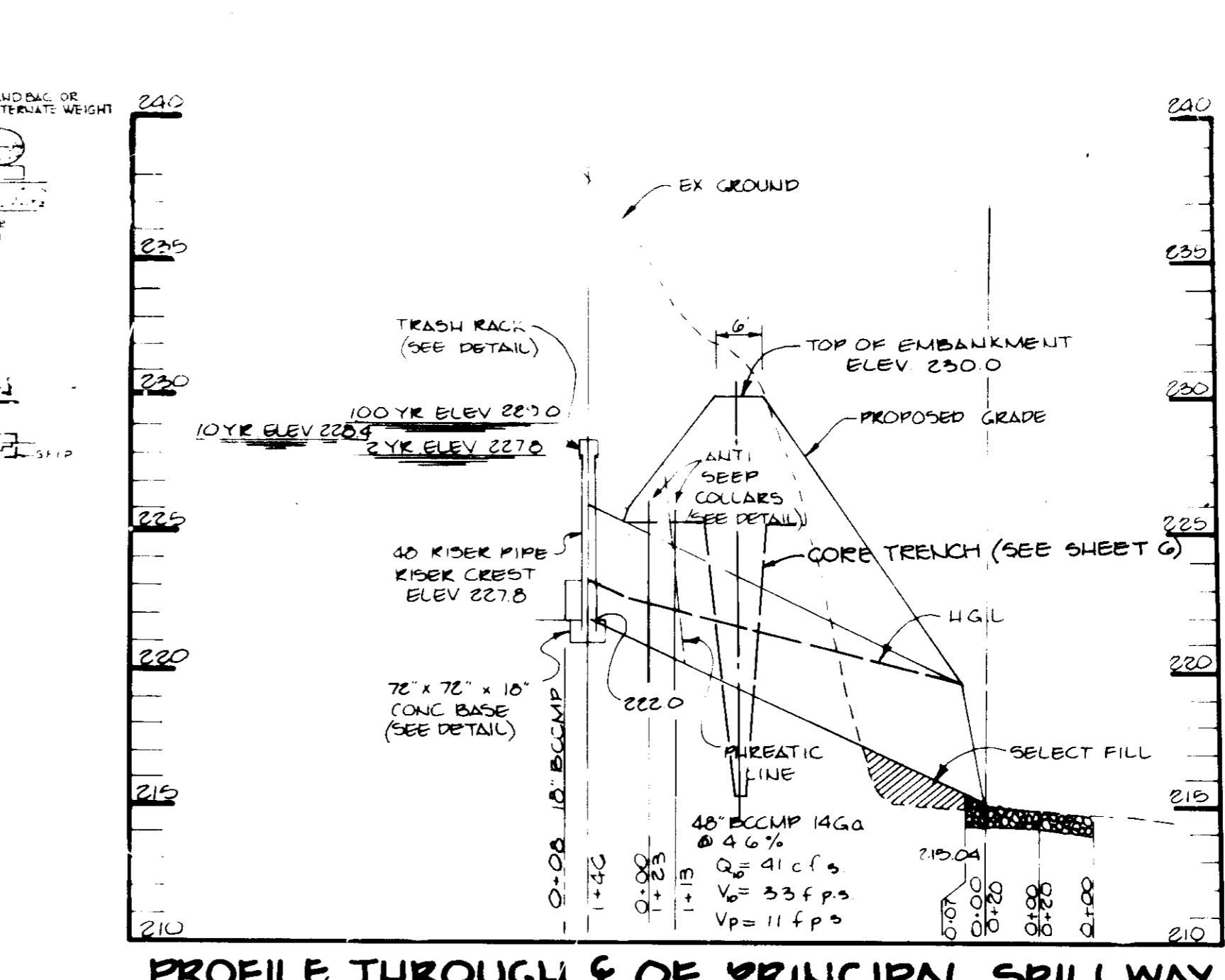
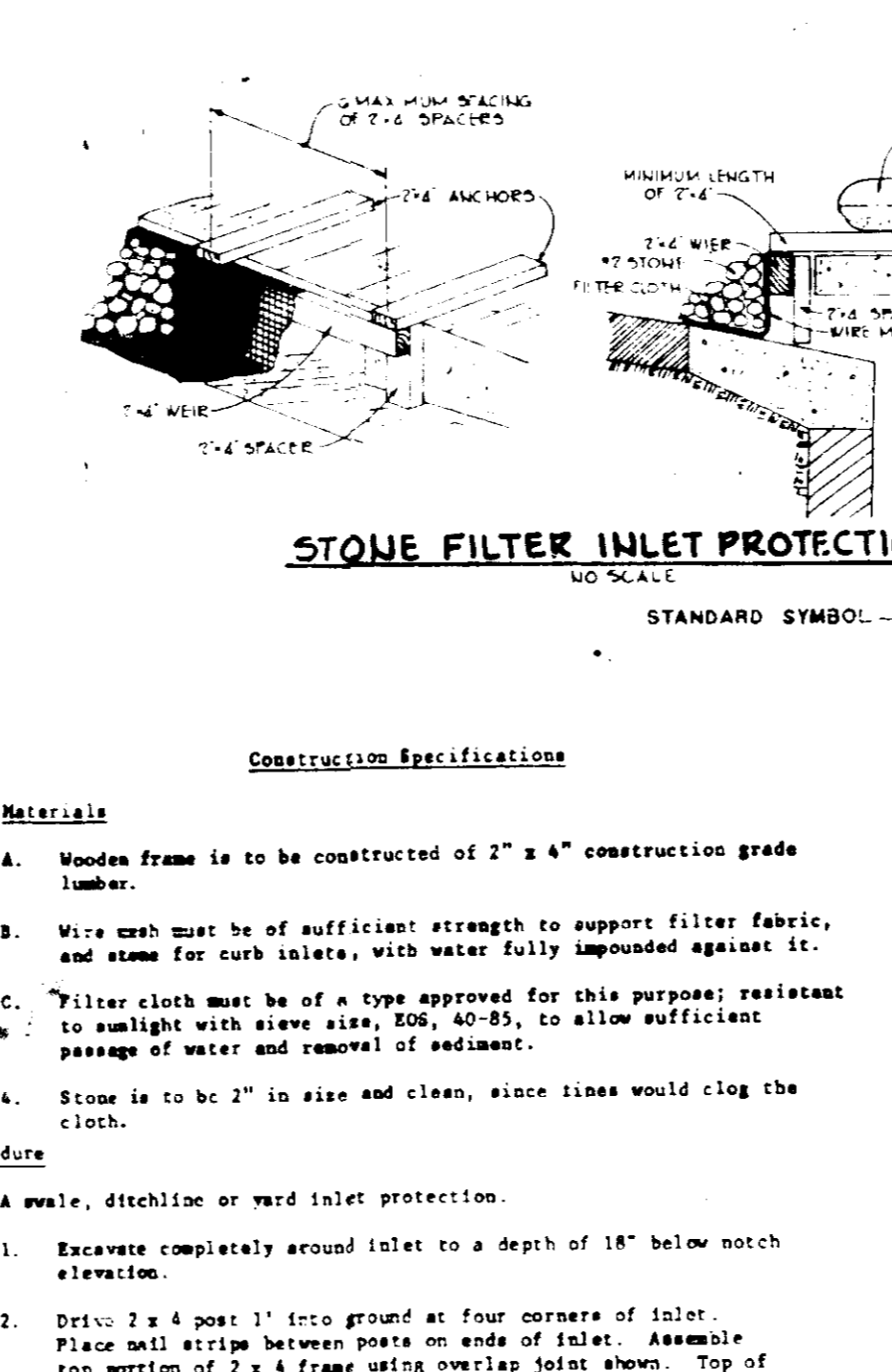
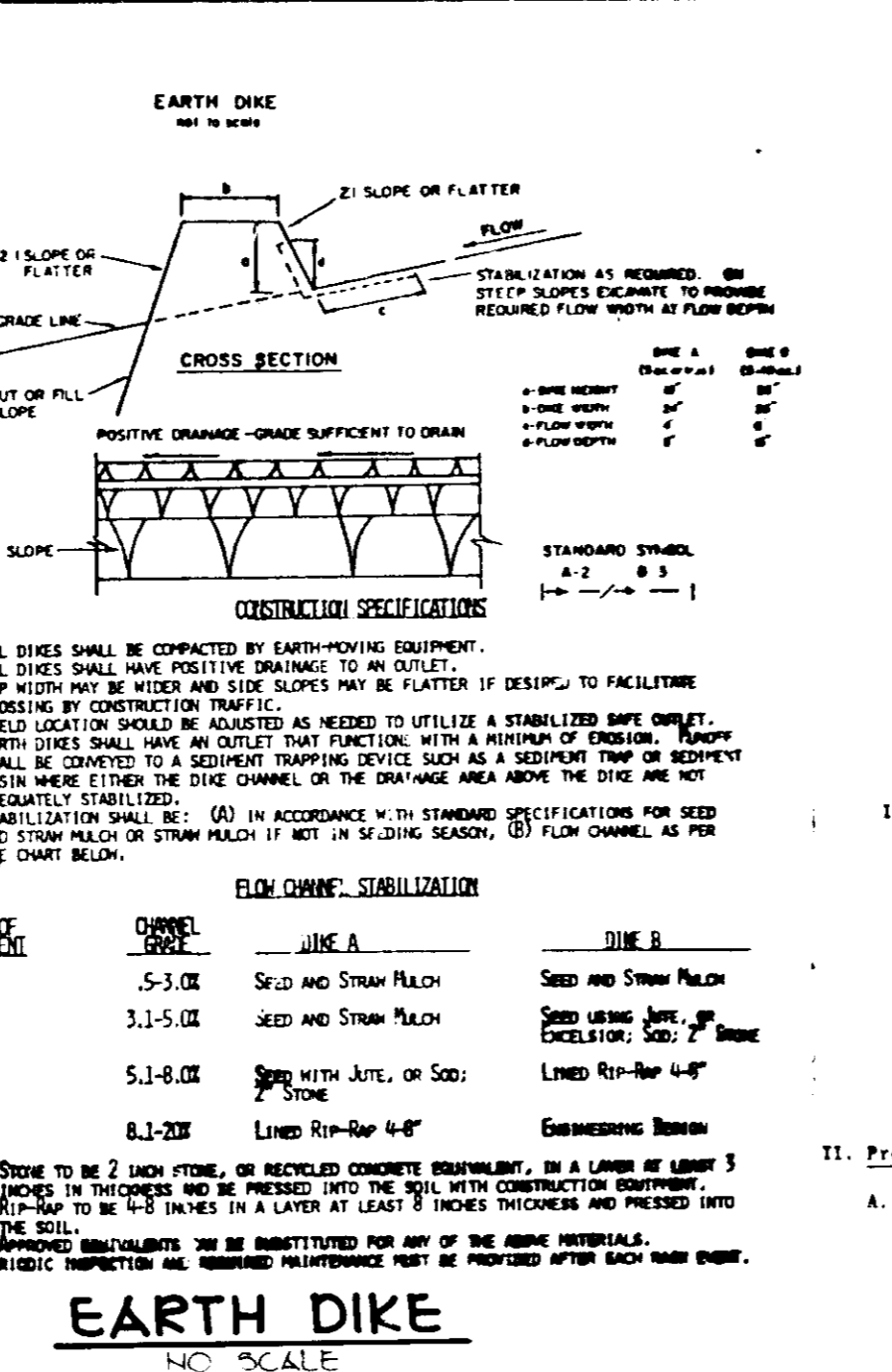

CONCRETE

1. All concrete shall be placed and finished in accordance with the specifications of the American Concrete Institute (ACI) and the Maryland Department of Public Works. The concrete shall be placed in a continuous operation and shall be finished with a float and trowel. The concrete shall be cured with a minimum of 7 days. The concrete shall be tested in accordance with the specifications of the American Concrete Institute (ACI) and the Maryland Department of Public Works.

STEEL

1. All steel shall be placed and finished in accordance with the specifications of the American Institute of Steel Construction (AISC) and the Maryland Department of Public Works. The steel shall be placed in a continuous operation and shall be finished with a float and trowel. The steel shall be cured with a minimum of 7 days. The steel shall be tested in accordance with the specifications of the American Institute of Steel Construction (AISC) and the Maryland Department of Public Works.

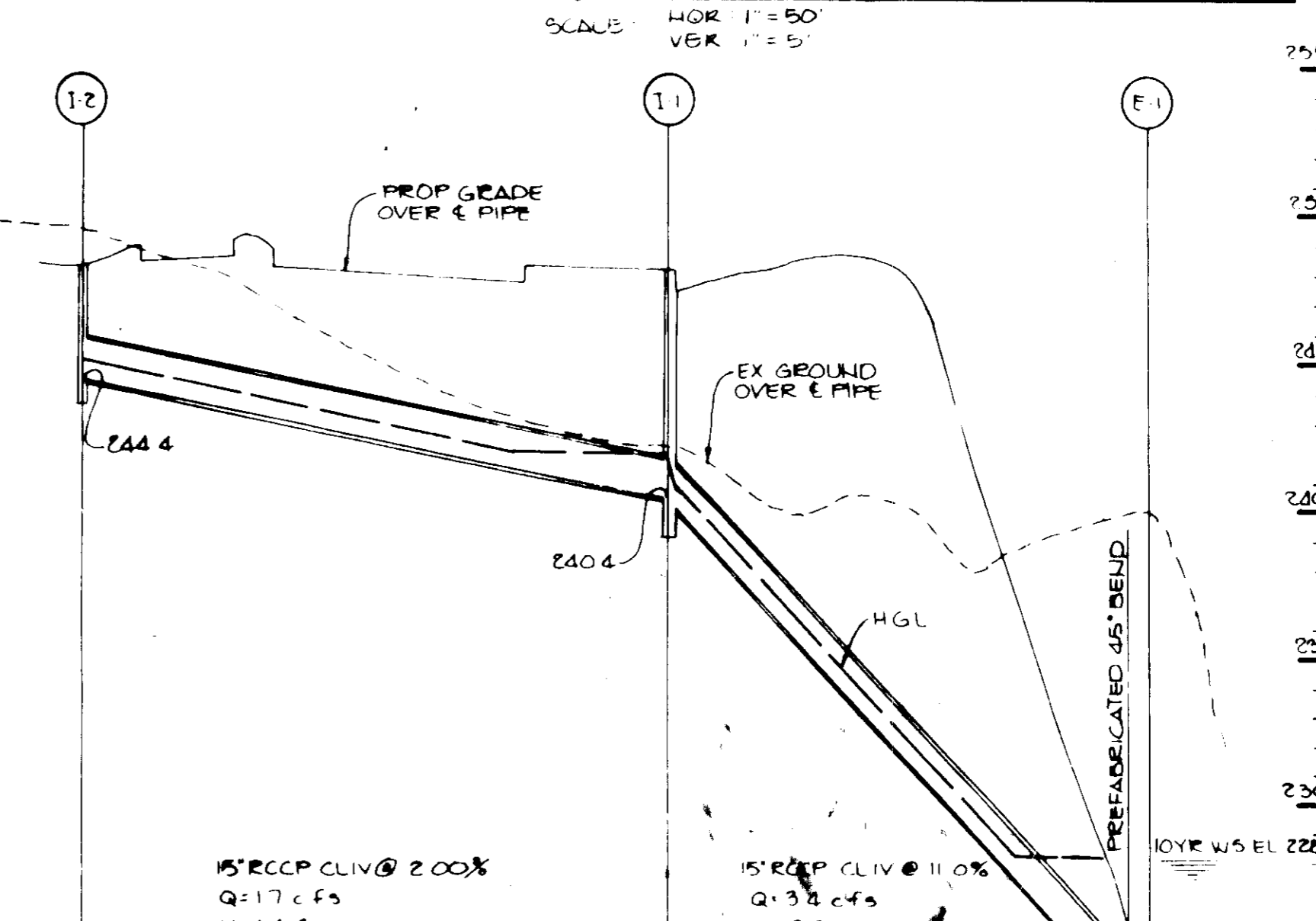
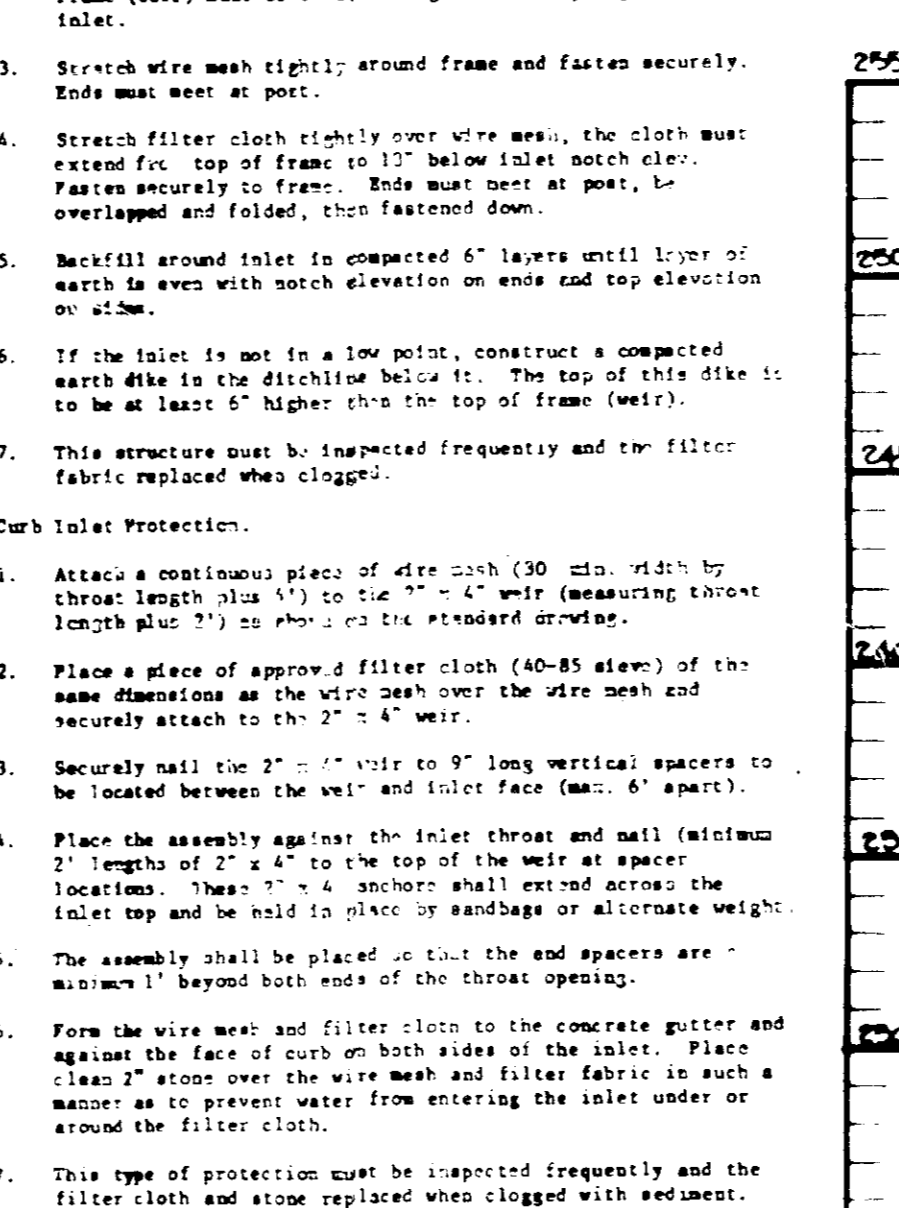
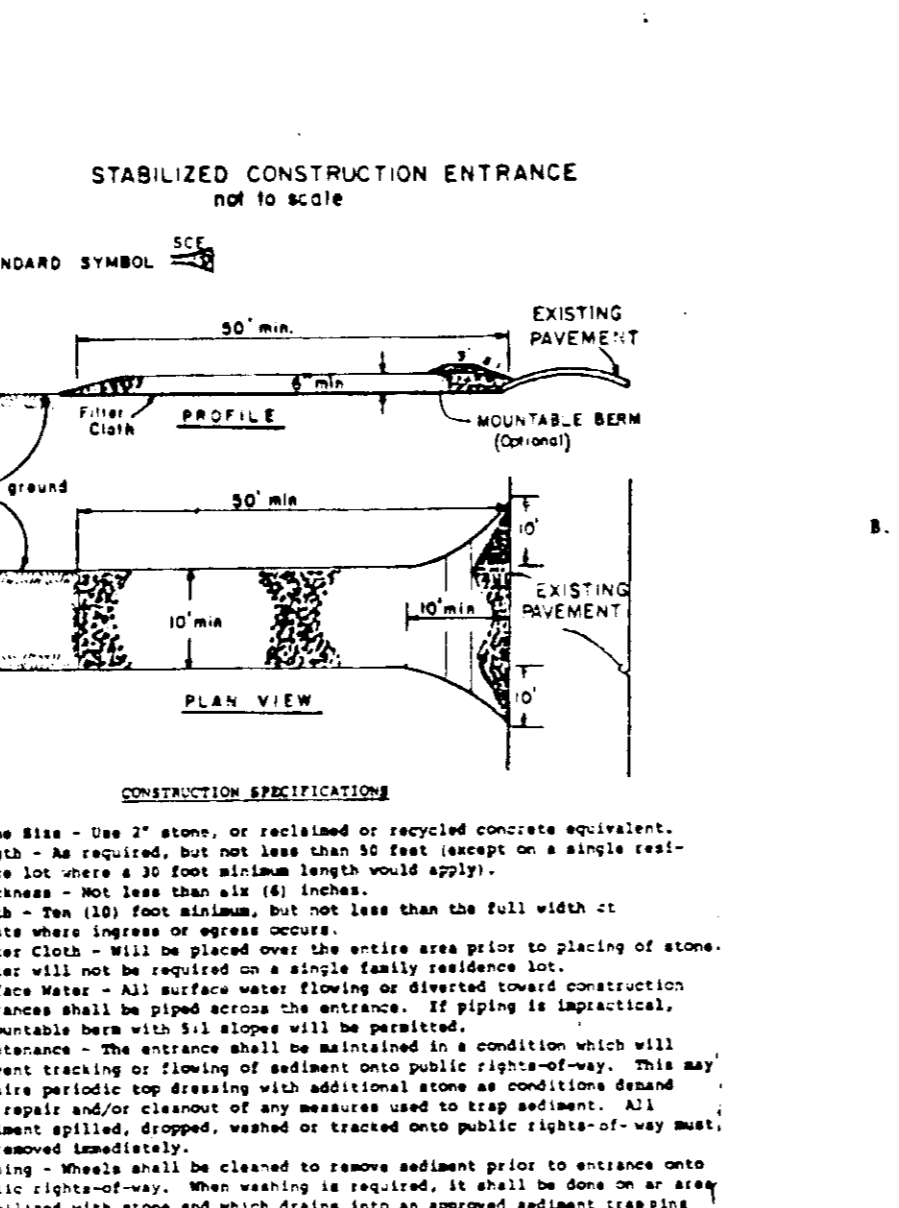

CONCRETE

1. All concrete shall be placed and finished in accordance with the specifications of the American Concrete Institute (ACI) and the Maryland Department of Public Works. The concrete shall be placed in a continuous operation and shall be finished with a float and trowel. The concrete shall be cured with a minimum of 7 days. The concrete shall be tested in accordance with the specifications of the American Concrete Institute (ACI) and the Maryland Department of Public Works.

STEEL

1. All steel shall be placed and finished in accordance with the specifications of the American Institute of Steel Construction (AISC) and the Maryland Department of Public Works. The steel shall be placed in a continuous operation and shall be finished with a float and trowel. The steel shall be cured with a minimum of 7 days. The steel shall be tested in accordance with the specifications of the American Institute of Steel Construction (AISC) and the Maryland Department of Public Works.

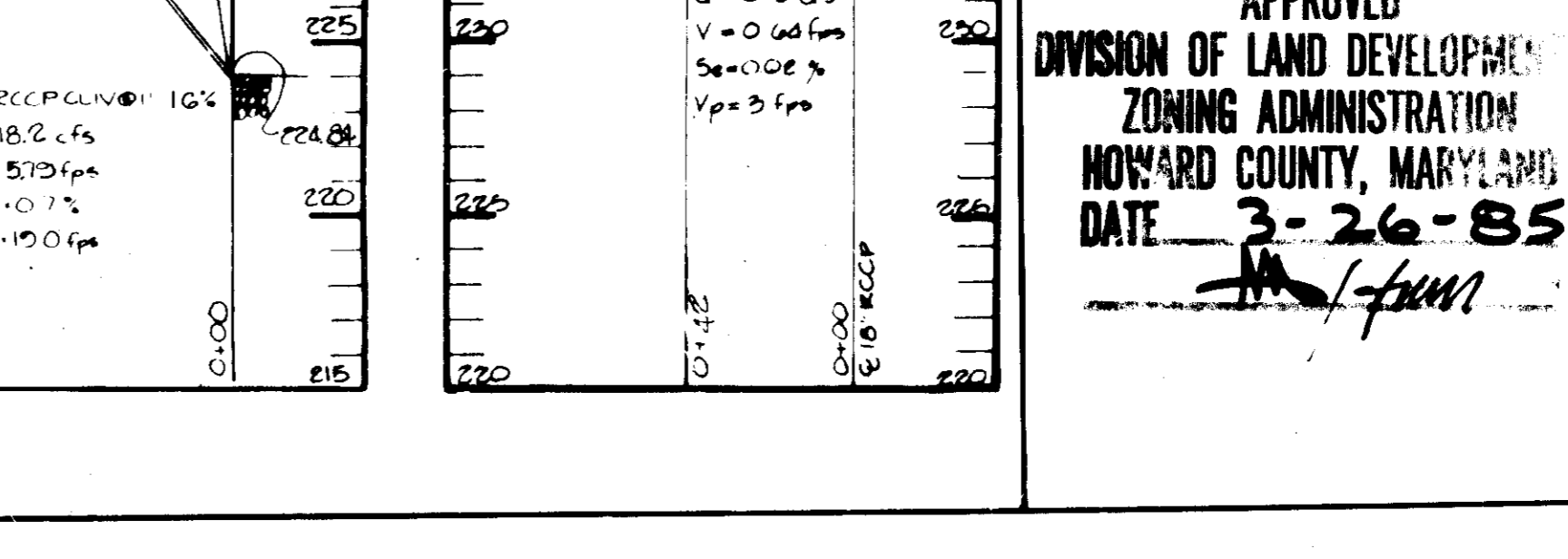
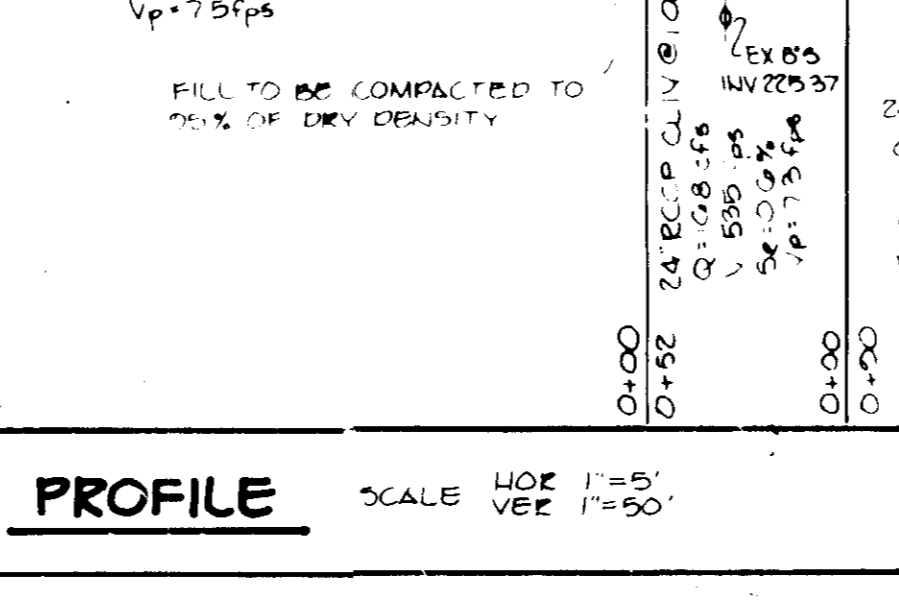
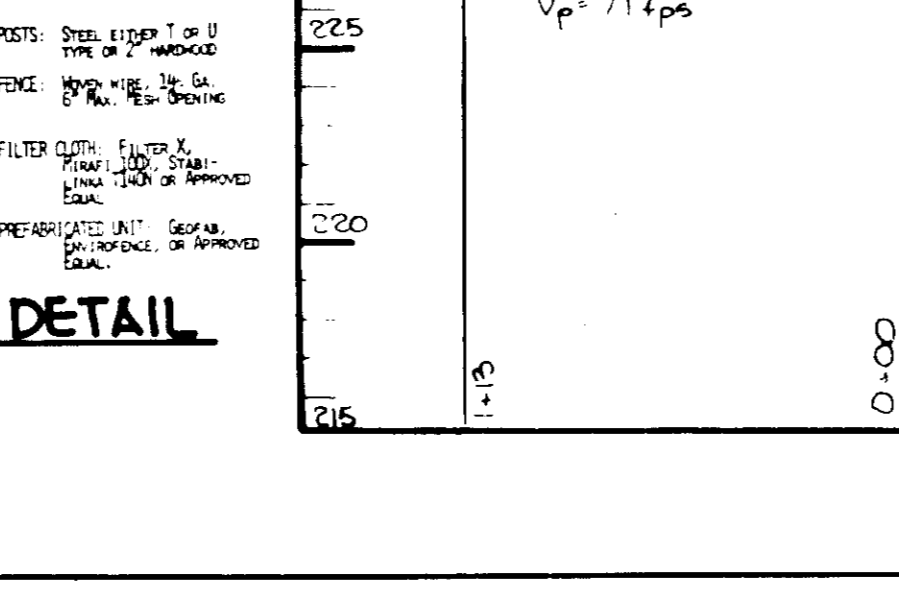
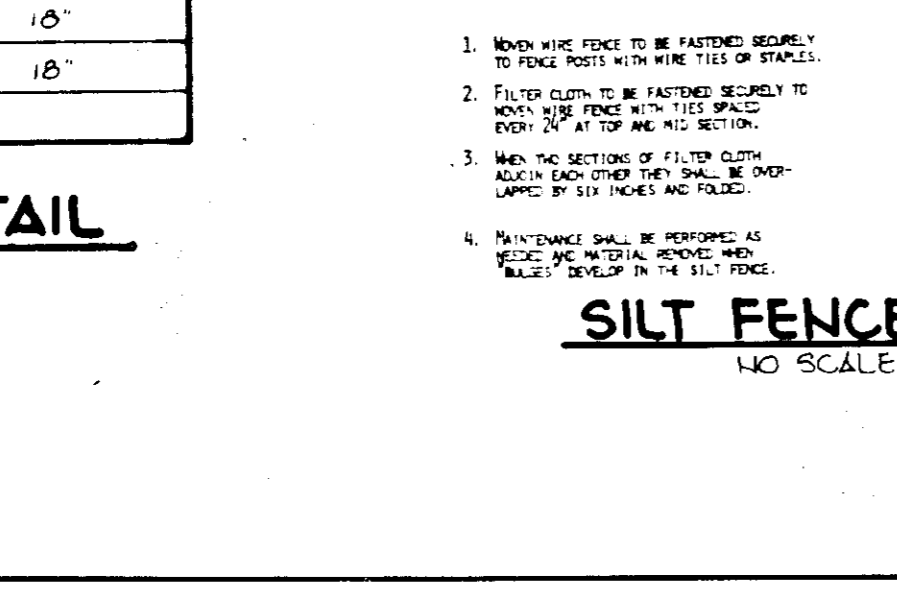
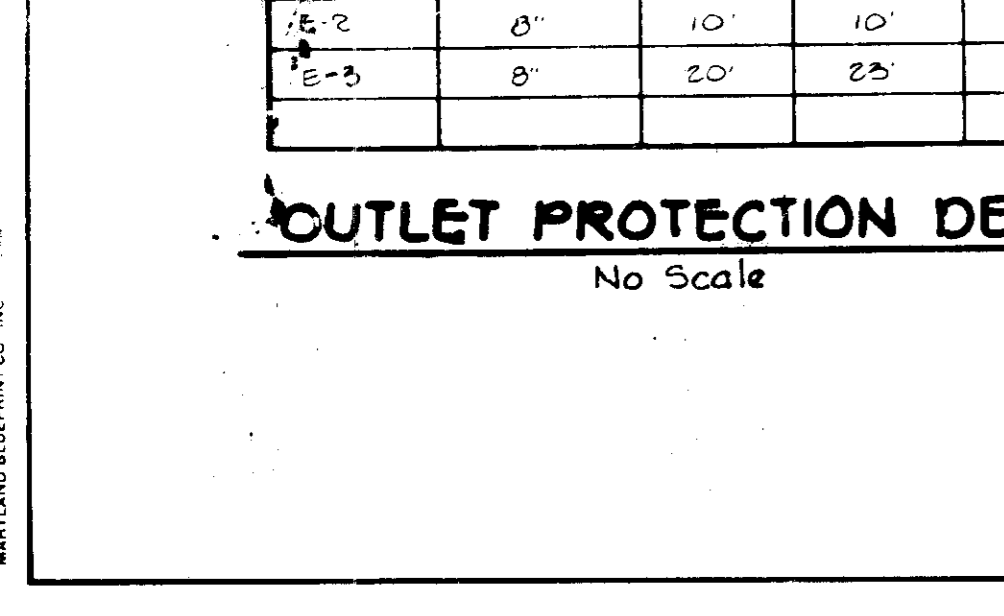
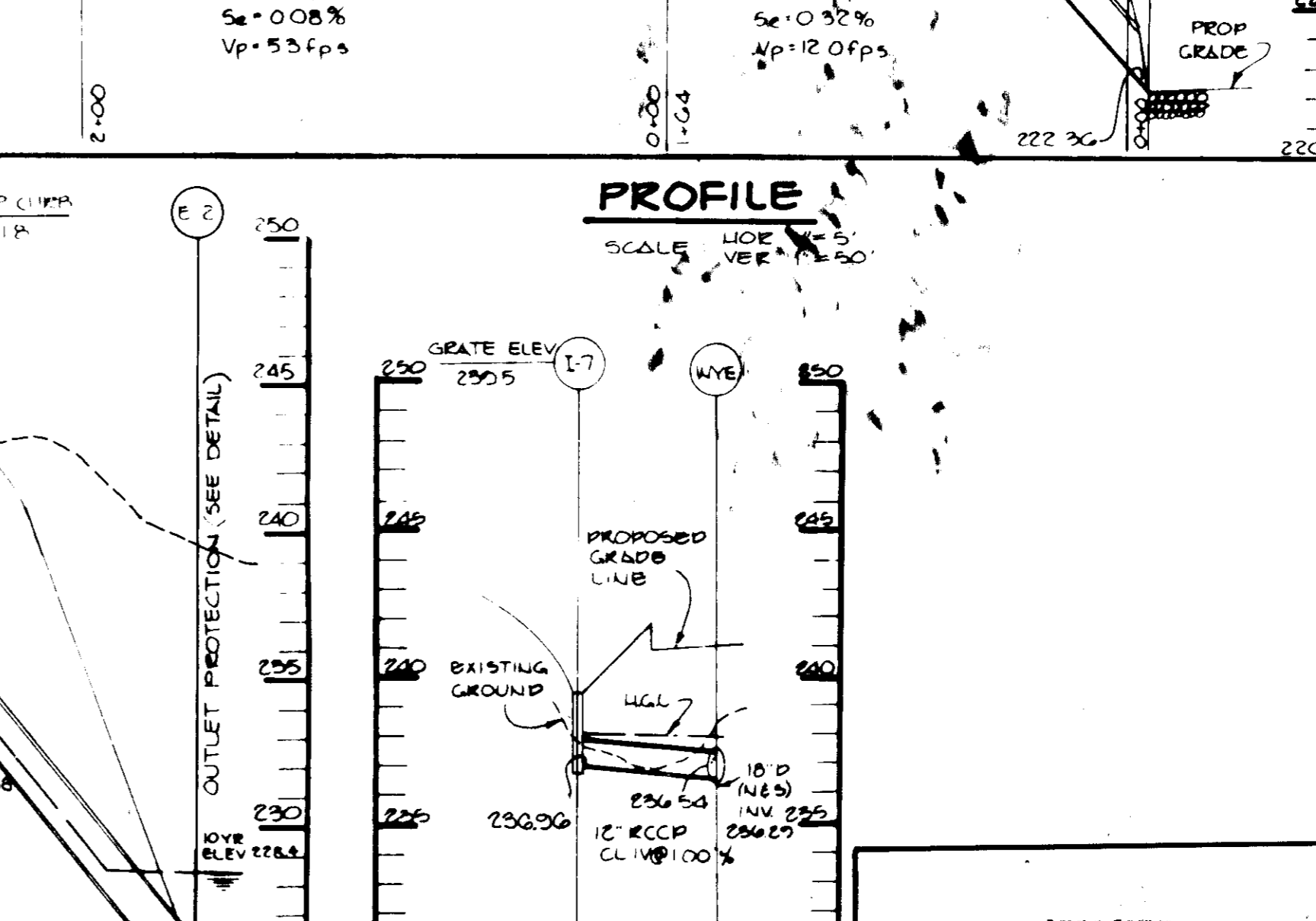
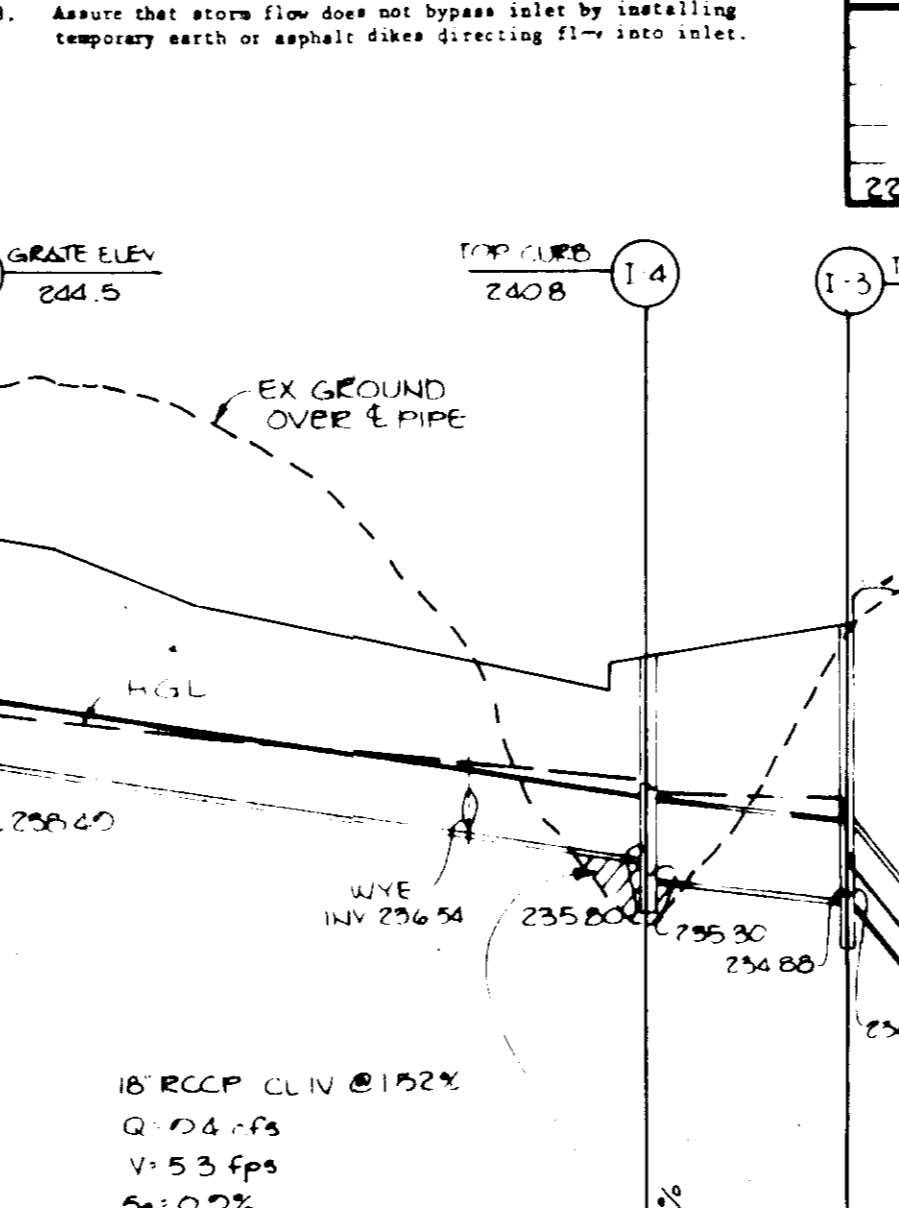
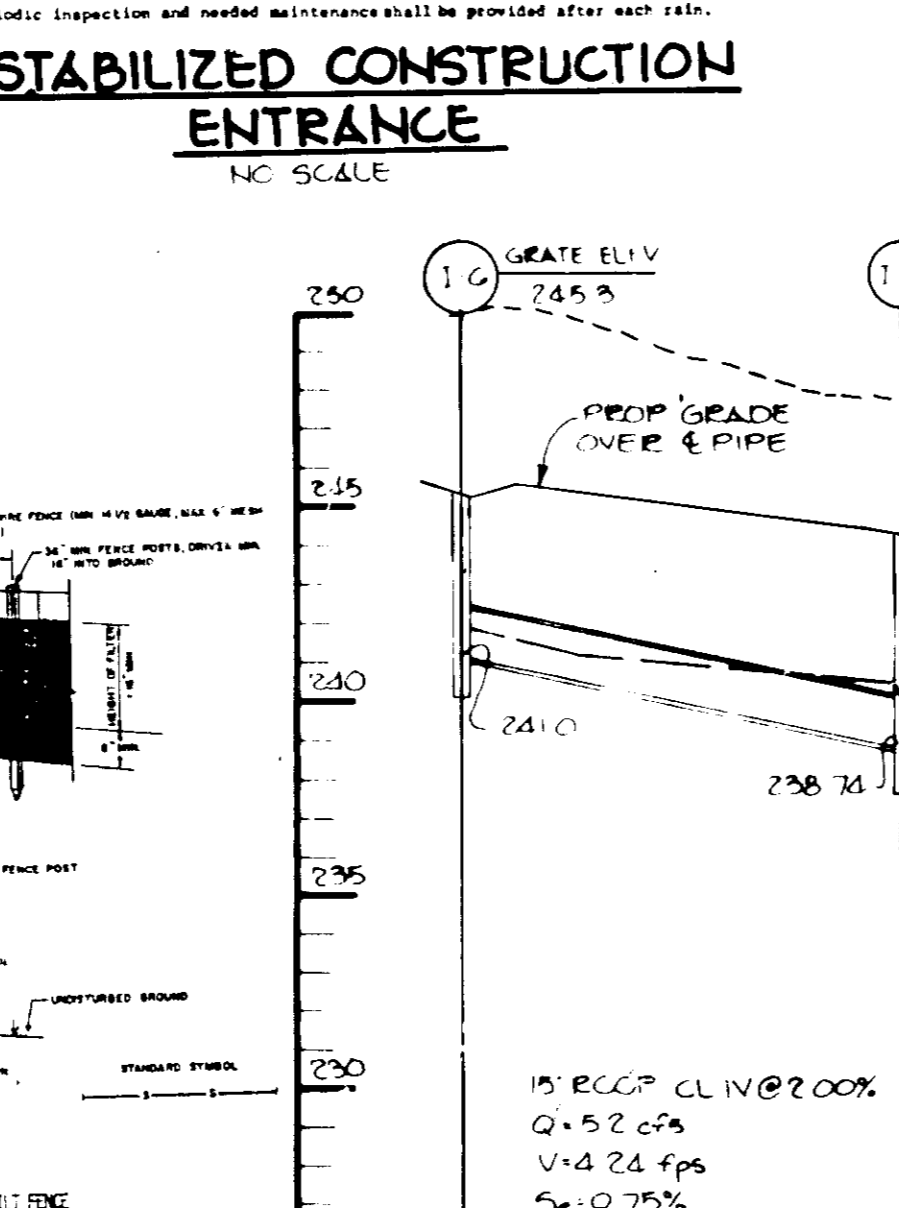

BY THE DEVELOPER:

I CERTIFY THAT ALL DEVELOPMENT AND/OR CONSTRUCTION WILL BE DONE ACCORDING TO THESE PLANS, AND THAT ANY RESPONSIBLE PERSONNEL INVOLVED IN THE CONSTRUCTION PROJECT WILL HAVE A CERTIFICATE OF ATTENDANCE AT A DEPARTMENT OF NATURAL RESOURCES APPROVED TRAINING PROGRAM FOR THE CONTROL OF SEDIMENT AND EROSION BEFORE BEGINNING THE PROJECT. I WILL PROVIDE THE HOWARD SOIL CONSERVATION DISTRICT WITH AN "AS-BUILT" PLAN OF THE POND WITHIN 30 DAYS OF COMPLETION.

DATE: 4/1/85
DEVELOPER: ANTHONY MANGIARNO

BY THE ENGINEER:

I CERTIFY THAT THIS PLAN FOR POND CONSTRUCTION, EROSION AND SEDIMENT CONTROL REPRESENTS A PRACTICAL AND WORKABLE PLAN BASED ON MY PERSONAL KNOWLEDGE OF THE SITE CONDITIONS. THIS PLAN WAS PREPARED IN ACCORDANCE WITH THE REQUIREMENTS OF THE HOWARD SOIL CONSERVATION DISTRICT. I HAVE NOTIFIED THE DEVELOPER THAT HE MUST PROVIDE THE HOWARD SOIL CONSERVATION DISTRICT WITH AN "AS-BUILT" PLAN OF THE POND WITHIN 30 DAYS OF COMPLETION.

DATE: 5/2/85
ENGINEER: PATRICK C. JENNINGS II

THESE PLANS HAVE BEEN REVIEWED FOR THE HOWARD SOIL CONSERVATION DISTRICT AND MEET THE TECHNICAL REQUIREMENTS FOR SMALL POND CONSTRUCTION, SOIL EROSION AND SEDIMENT CONTROL.

DATE: 5-23-85
APPROVED: HOWARD SOIL CONSERVATION SERVICE

THESE PLANS FOR SMALL POND CONSTRUCTION, SOIL EROSION AND SEDIMENT CONTROL MEET THE REQUIREMENTS OF THE HOWARD SOIL CONSERVATION DISTRICT.

DATE: 5-23-85
APPROVED: HOWARD SOIL CONSERVATION SERVICE

DATE: 5/31/85
APPROVED: COUNTY HEALTH OFFICER

DATE: 6-3-85
APPROVED: HOWARD COUNTY OFFICE OF PLANNING AND ZONING

DATE: 6-3-85
APPROVED: CHIEF, DIVISION OF LAND DEVELOPMENT AND ZONING ADMINISTRATION

DATE: 5-27-85
APPROVED: HOWARD COUNTY DEPARTMENT OF PUBLIC WORKS

DATE: 5-28-85
APPROVED: CHIEF, BUREAU OF ENGINEERING

REVISIONS:

NO.	REVISION
8-5-85	REVISED PROFILE
DATE NO.	REVISION

OWNER DEVELOPER:

ORPHEUS BAY ALPHABETIC #2 LTD PARTNERSHIP
710 AMERICAN CITY BUILDING
COLUMBIA, MARYLAND 21044

PROJECT:

B.W.I.P. PARCEL M

AREA TAX MAP NO. 43 PARCEL M BLOCK 'E'
BALTIMORE WASHINGTON INDUSTRIAL PARK
4TH ELECTION DISTRICT
HOWARD COUNTY, MARYLAND

TITLE:

STORM DRAIN PROFILES AND SEDIMENT CONTROL DETAILS

THE RIEMER GROUP, INC.

A LAND PLANNING, DESIGN & CIVIL ENGINEERING FIRM
3105 HEALTH PARK DRIVE, ELLENCOTT CITY, MD. 21043 301-413-2694

DATE: 3-26-85
DESIGNED BY: JDP
DRAWN BY: JEC
PROJECT NO: 10,000
DATE: 1-16-85
SCALE: AS SHOWN
DRAWING NO: 4 OF 6

SDP-85-117

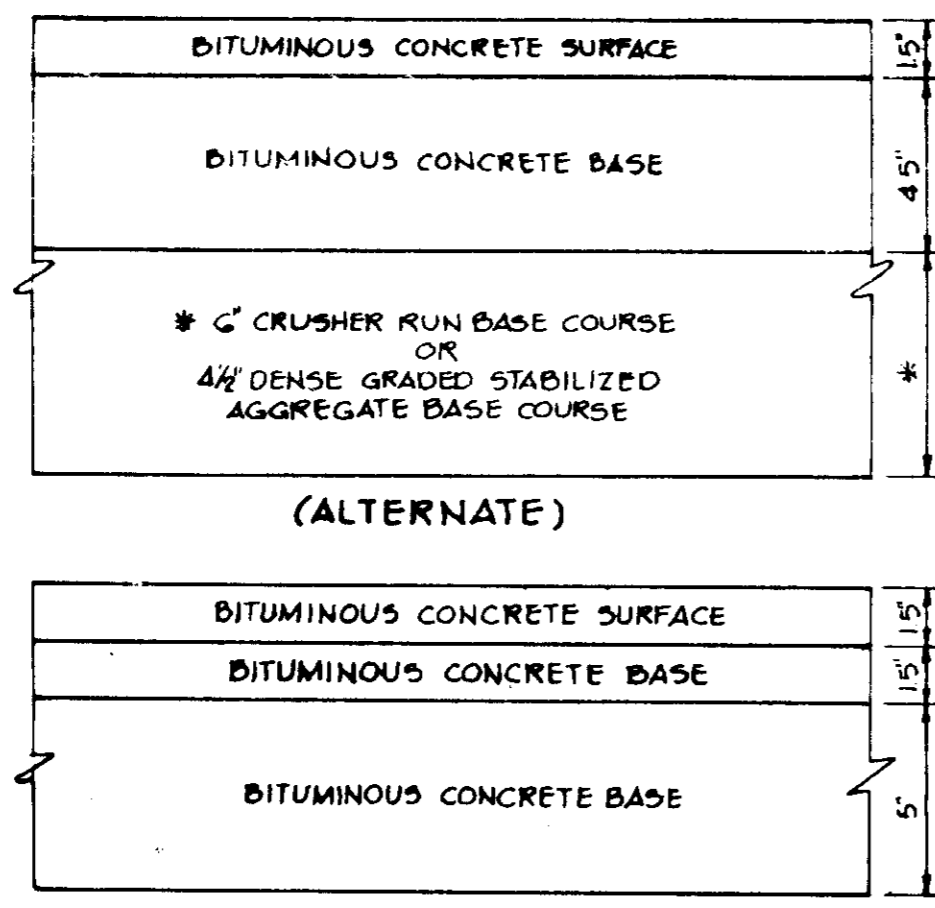
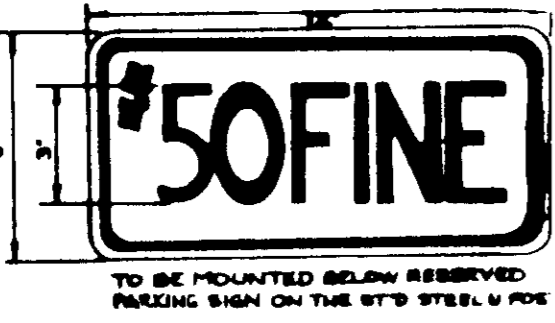

HOWARD COUNTY DESIGN MANUAL VOLUME III -
STANDARD SPECIFICATIONS AND DETAILS FOR
CONSTRUCTION (DRAWING R-201)

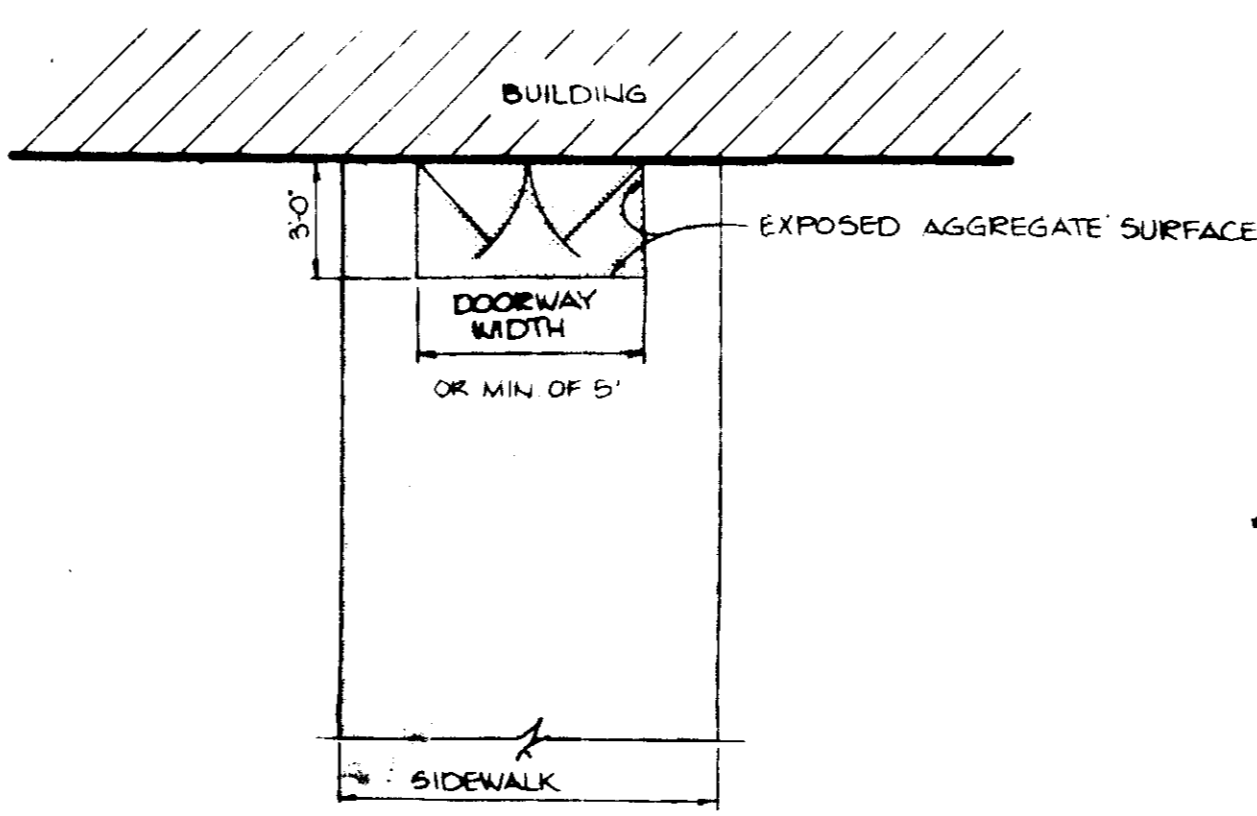

NOTE TO BE USED FOR ALL BUILDING ENTRANCES EXCEPT
THOSE THAT ARE EXCLUSIVELY FIRE EXITS

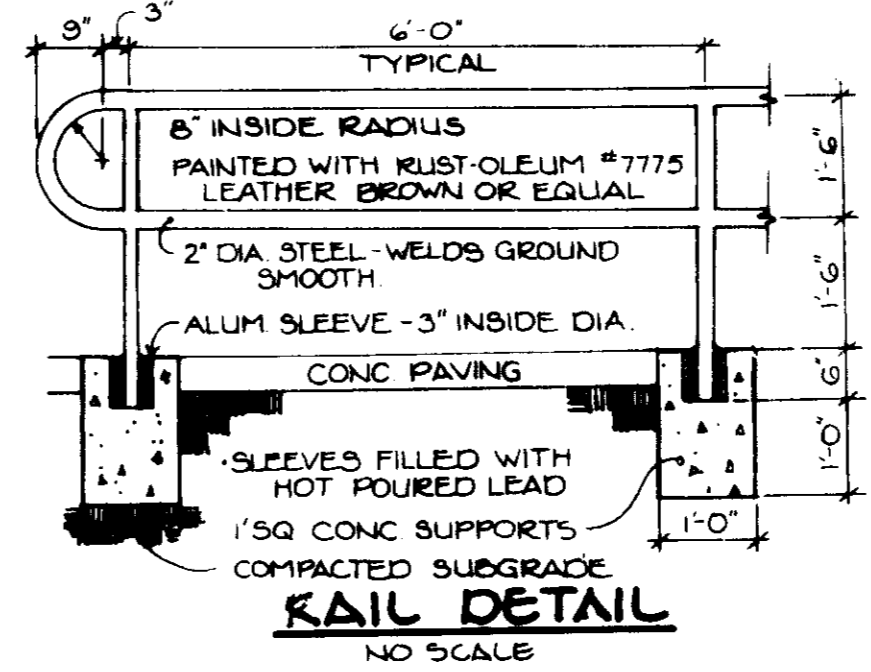
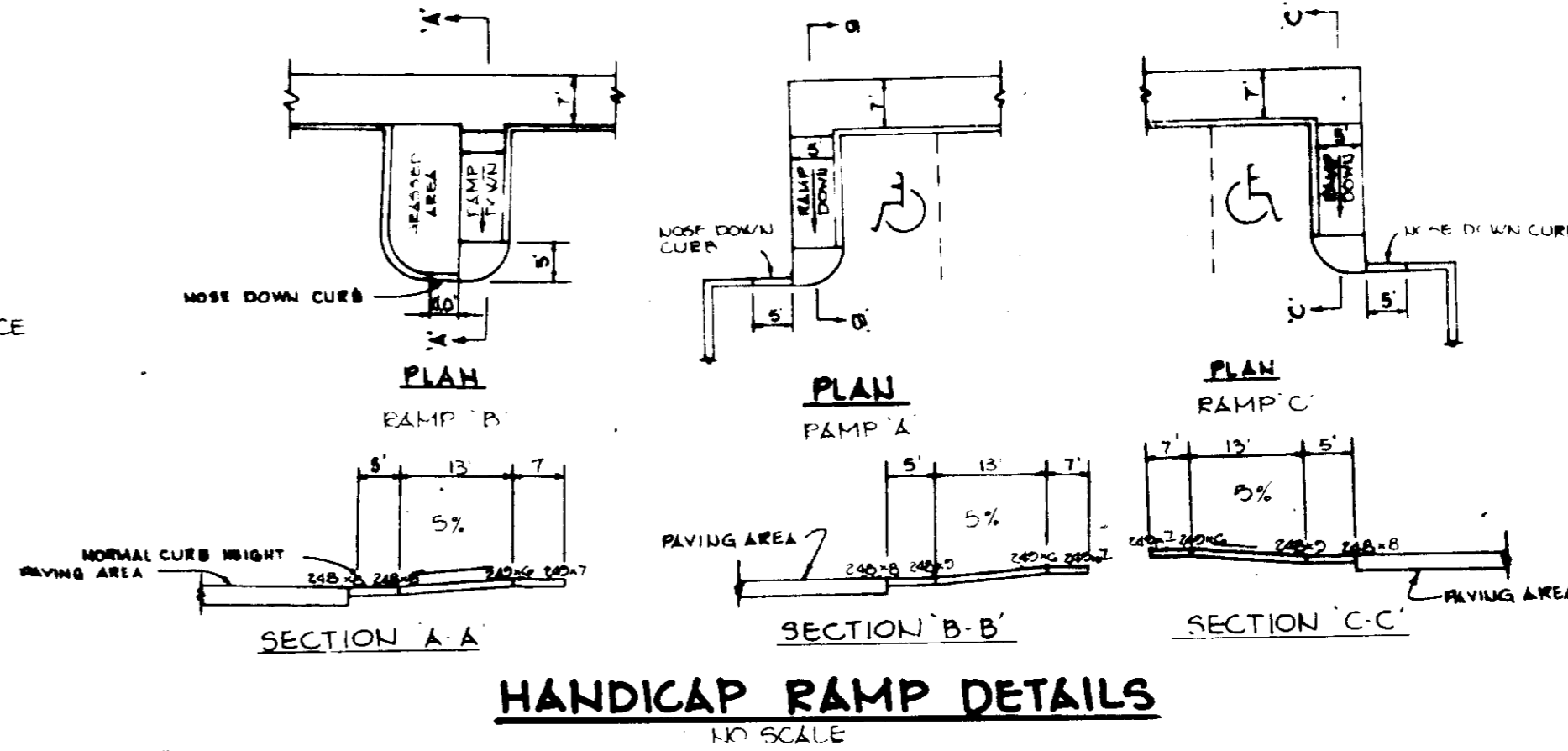

- NOTES**
- LONGITUDINAL JOINT BETWEEN SIDEWALK AND CURB SHALL BE CONTINUOUS AND TO A DEPTH OF 1/4" THE SIDEWALK THICKNESS OR 1" MAX. LATITUDINAL JOINTS SHALL RUN FROM BACK EDGE OF SIDEWALK, CONTINUOUS TO THE BOTTOM FACE OF CURB TO A DEPTH OF 1/4" AND SPACED 5' APART.
 - PROVIDE 1/2" EXPANSION JOINTS AT 15' INTERVALS IN LATITUDINAL JOINTS TO FULL CROSS-SECTION.

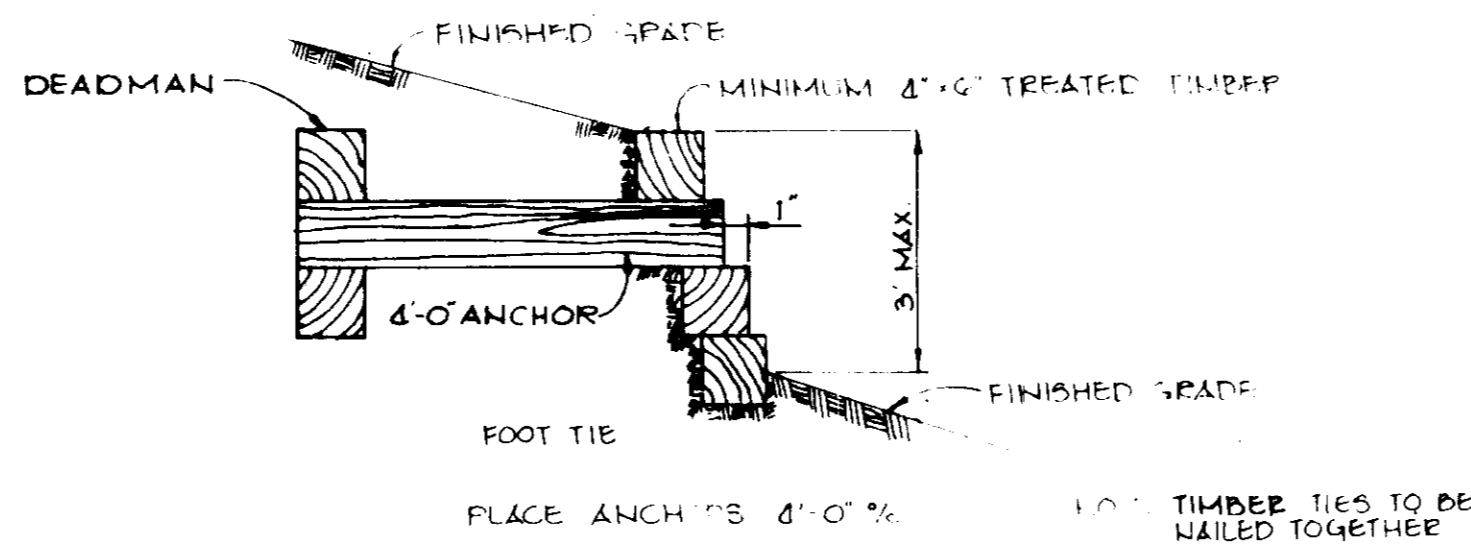
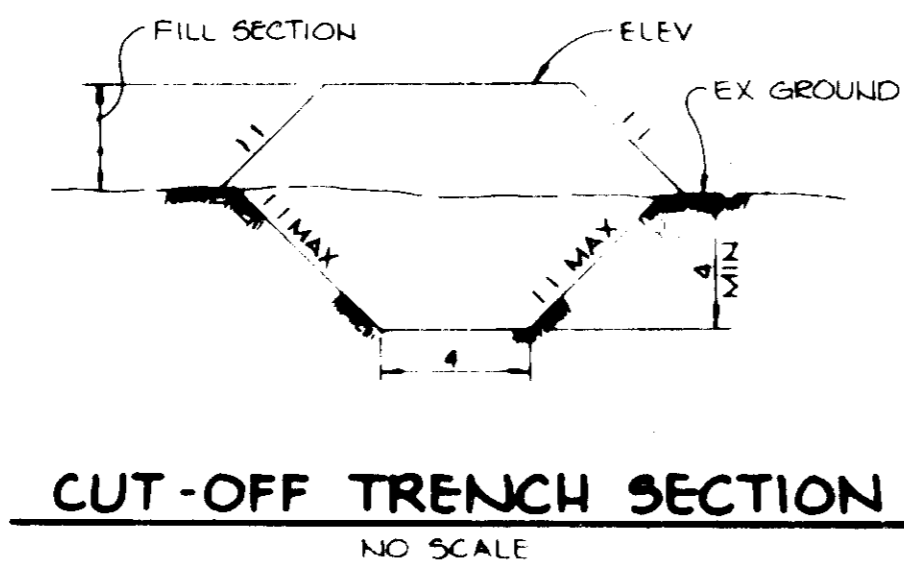
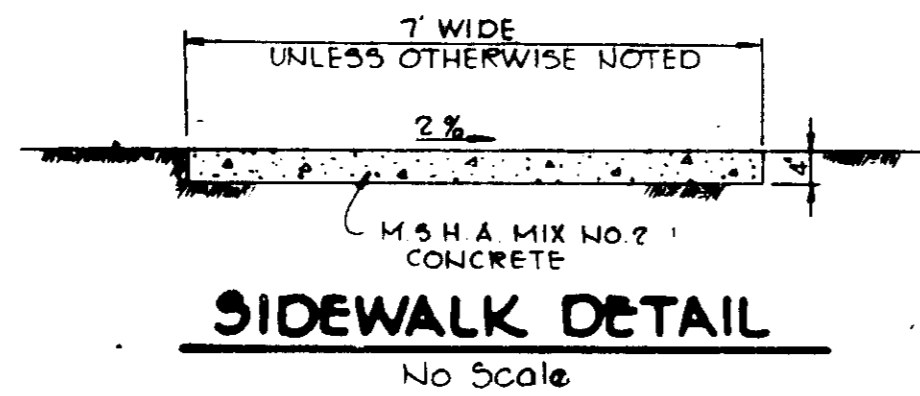
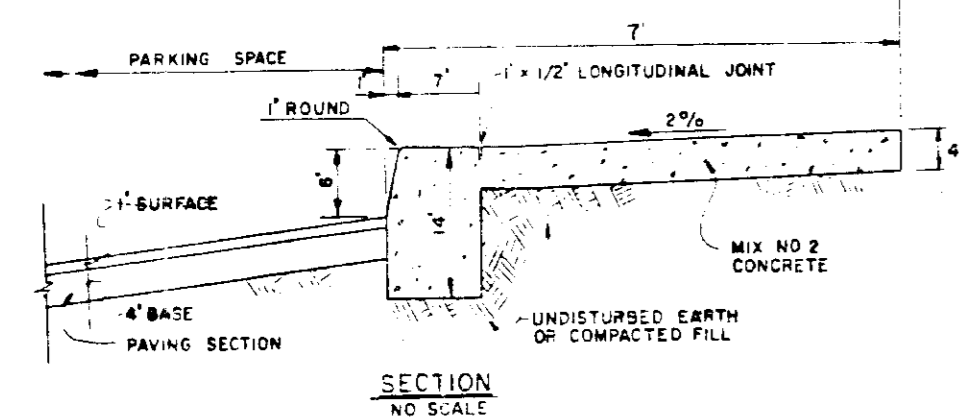

MONOLITHIC CURB & SIDEWALK
NO SCALE

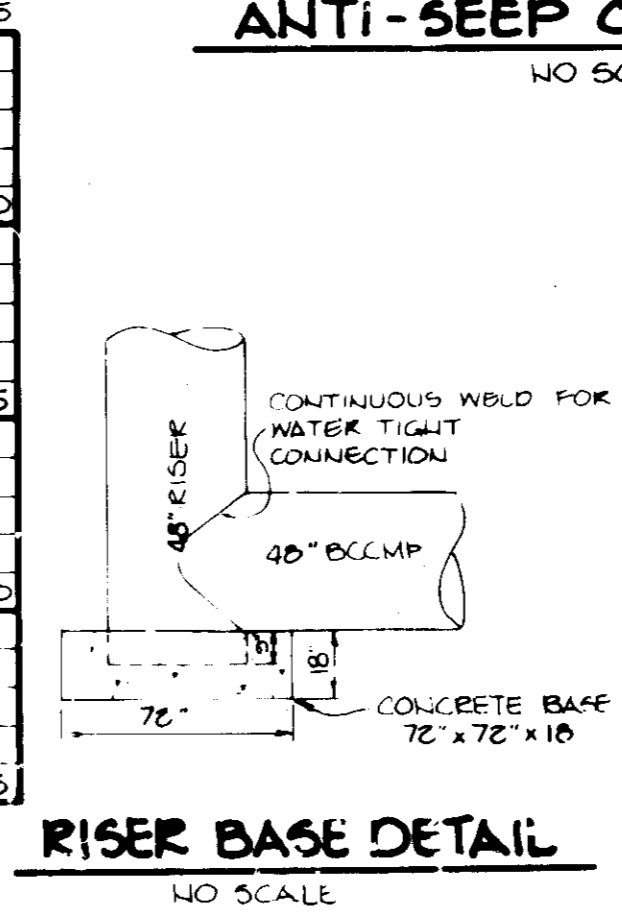
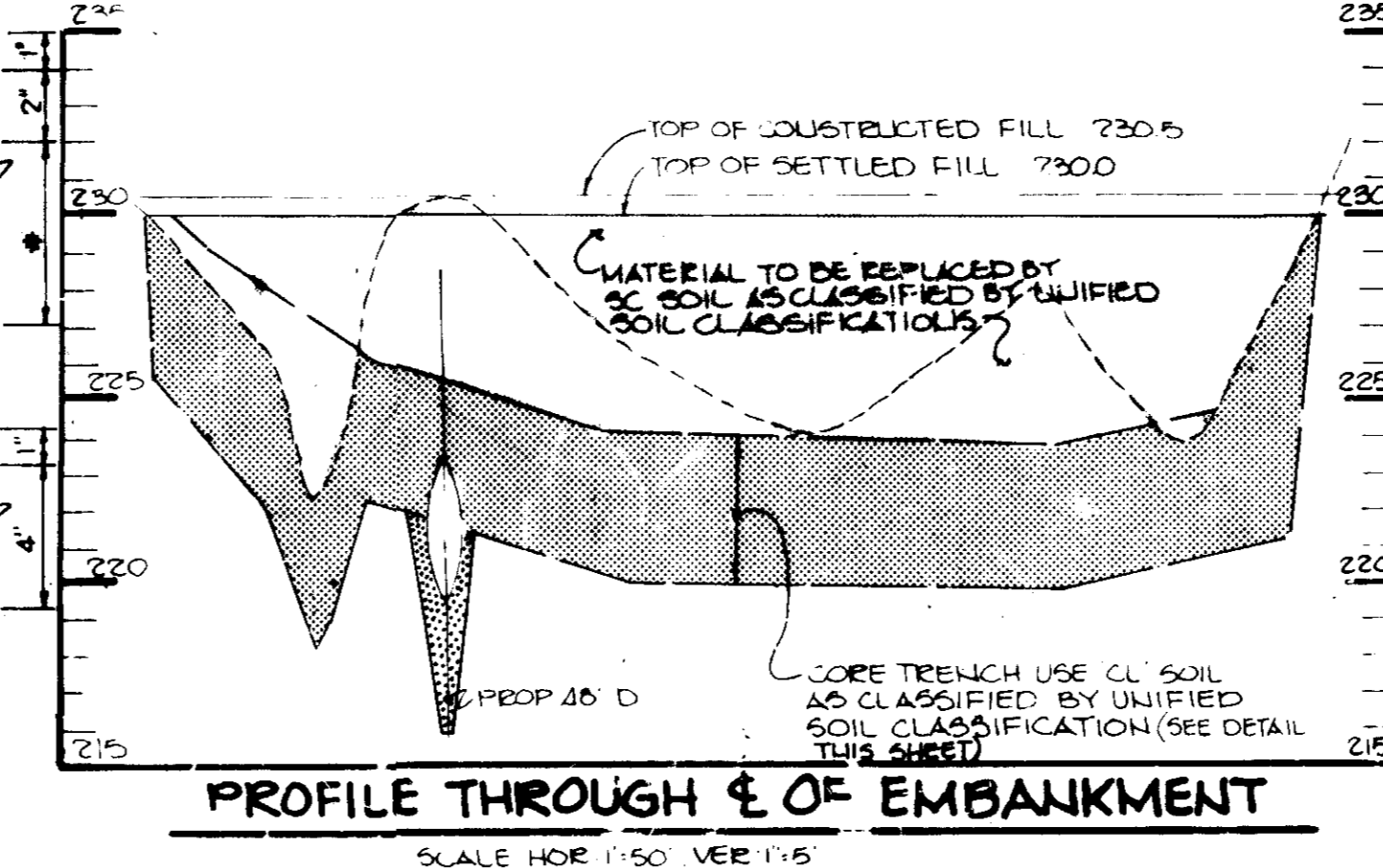
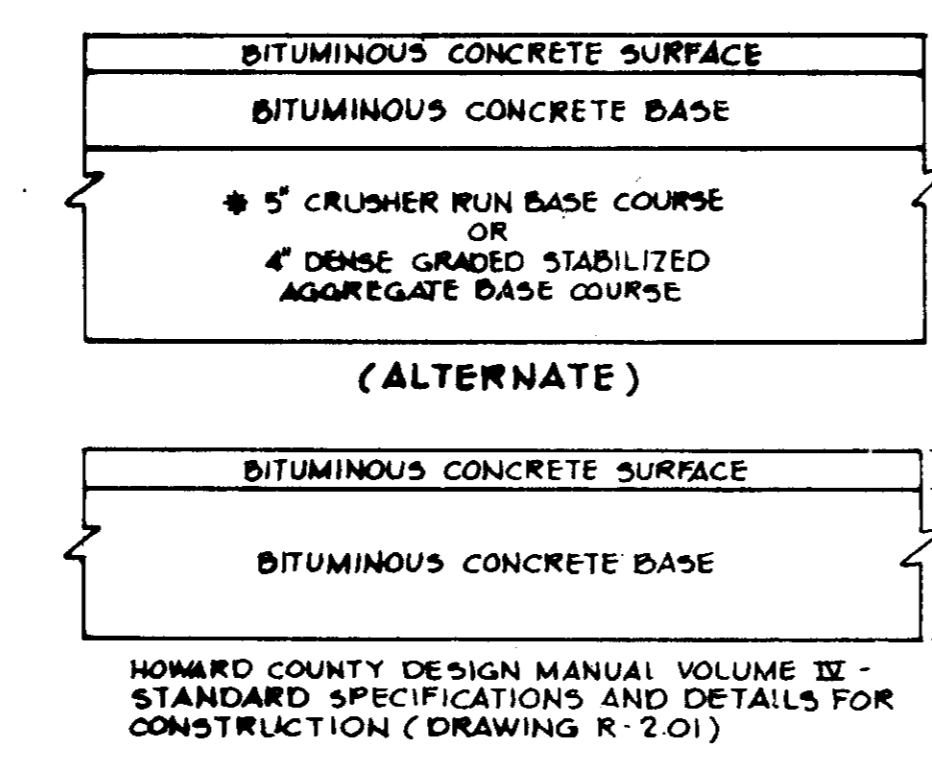
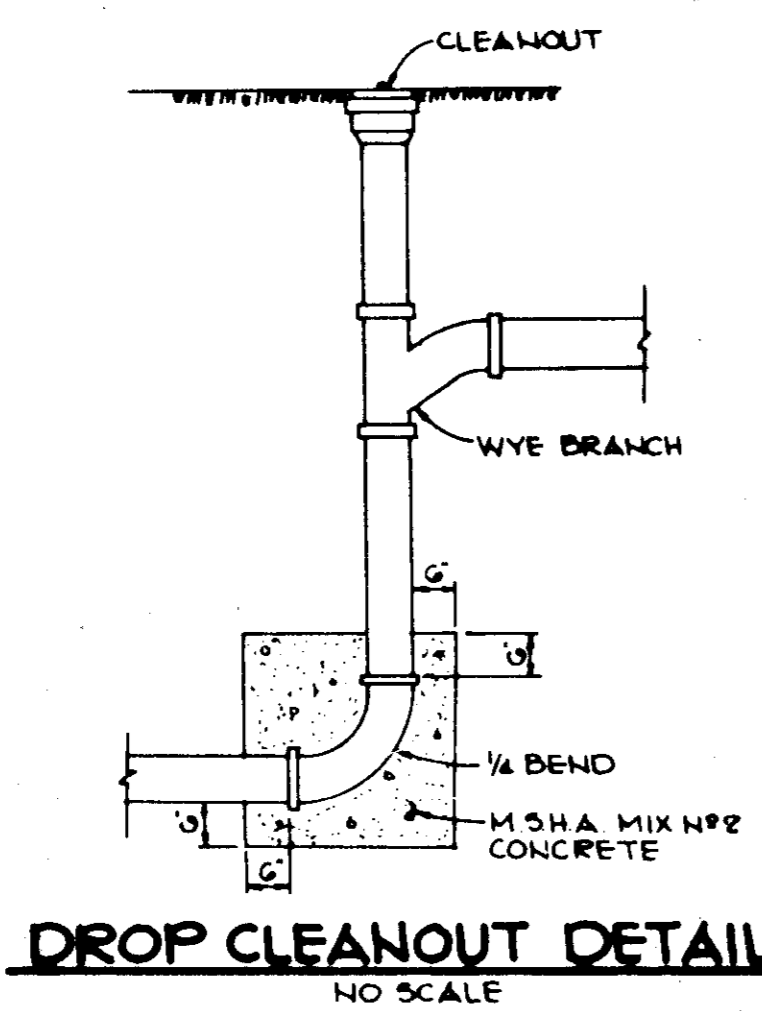
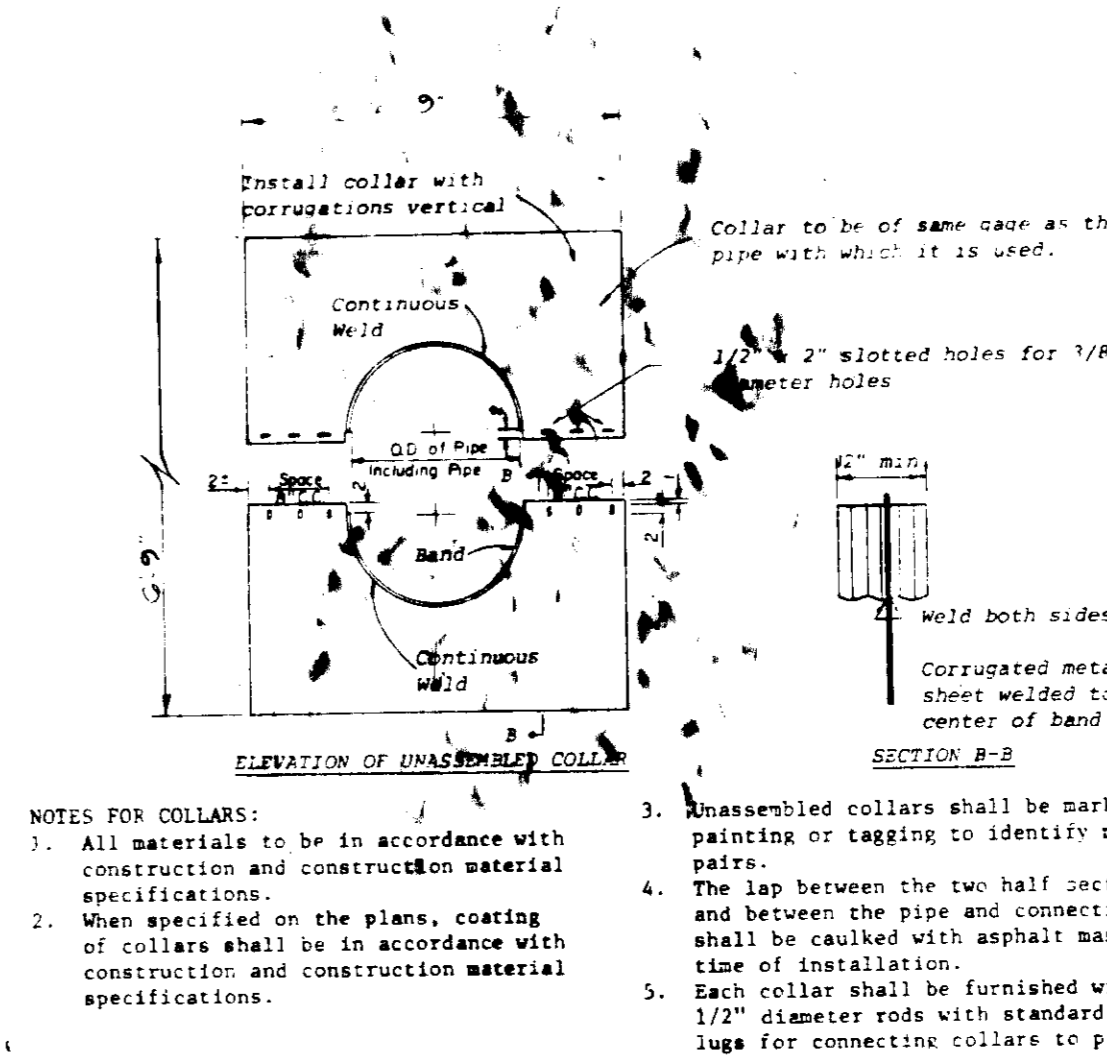
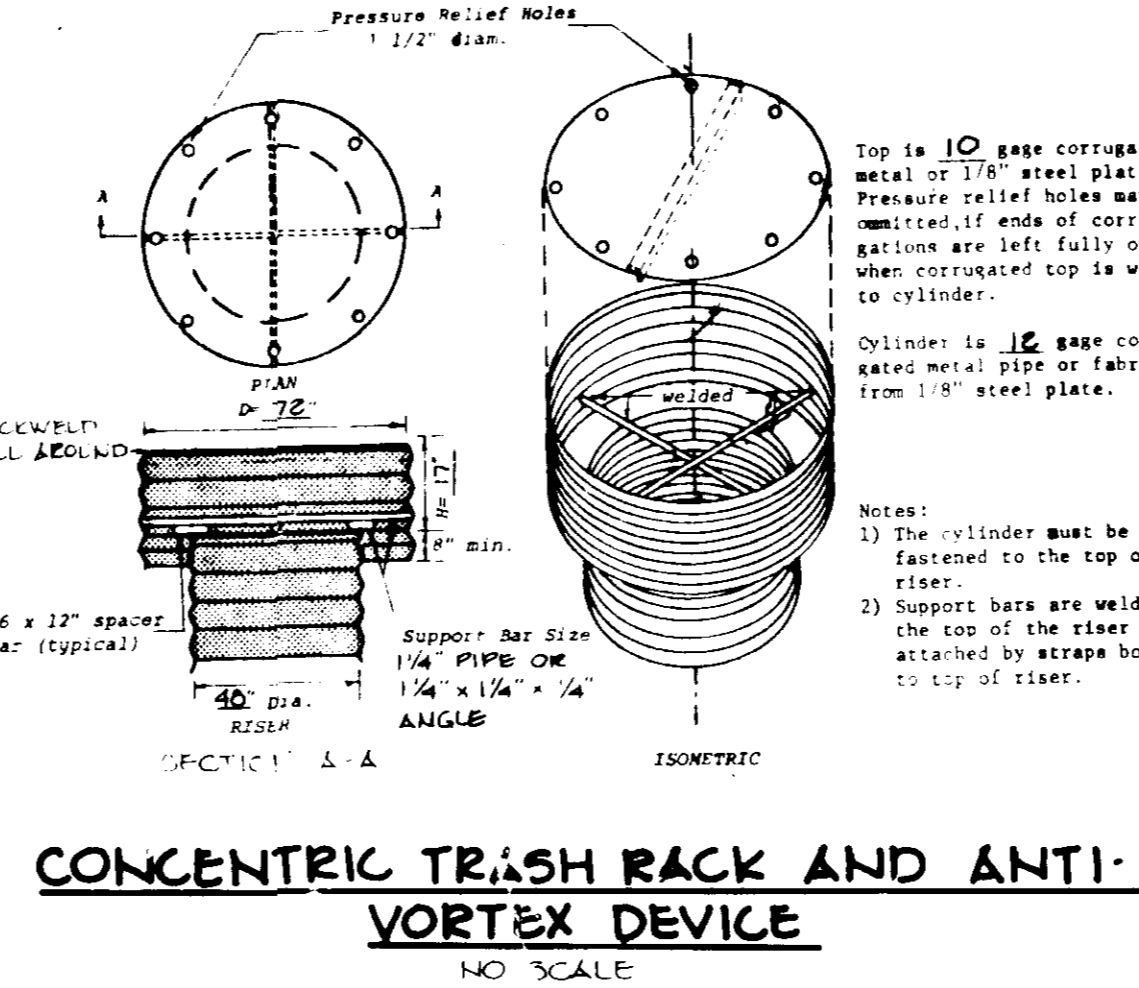
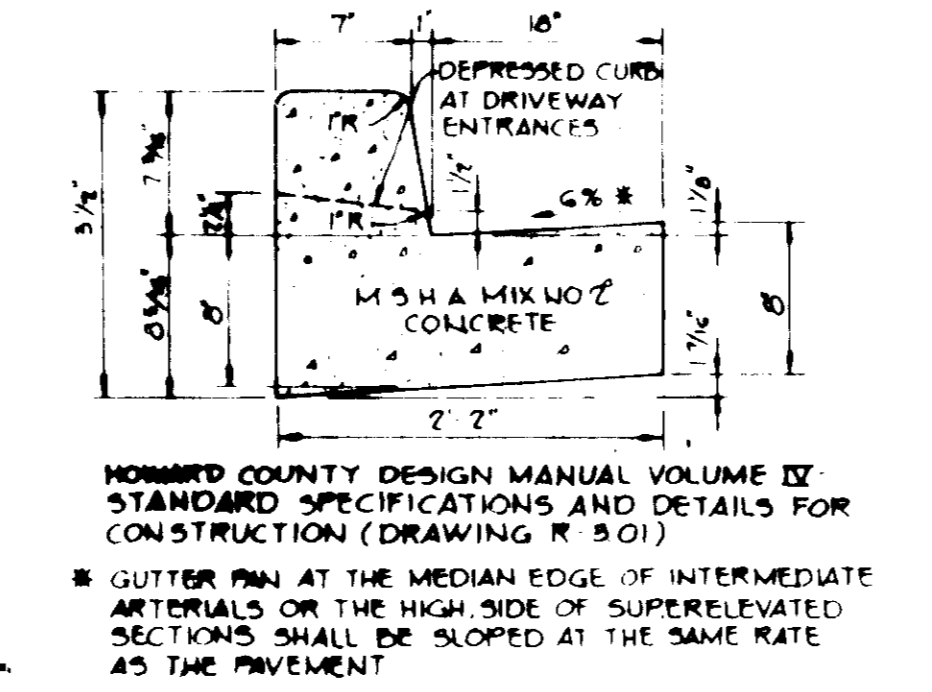
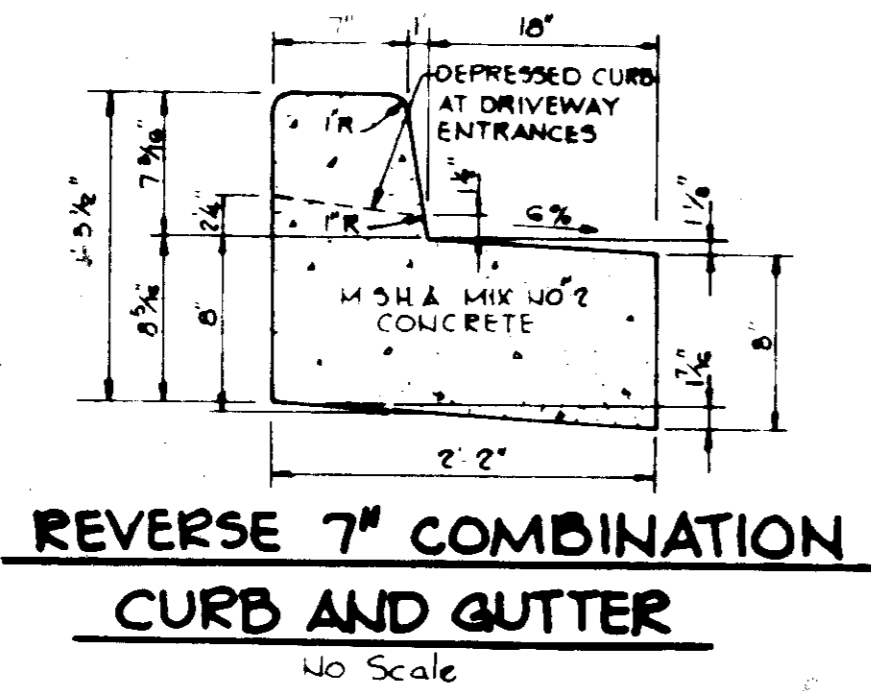
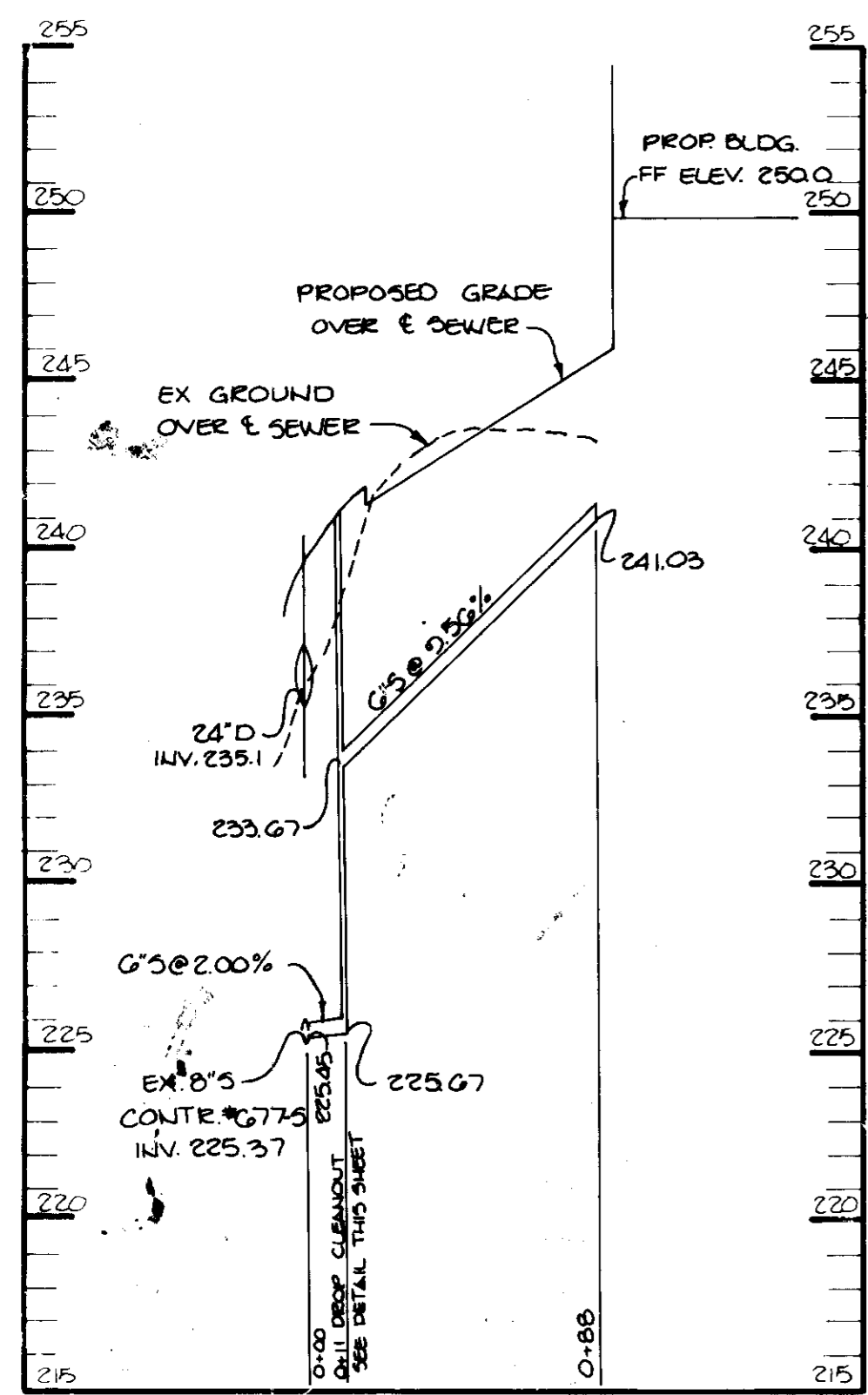

APPROVED
DIVISION OF LAND DEVELOPMENT &
ZONING ADMINISTRATION
HOWARD COUNTY, MARYLAND
DATE **3-26-85**

THESE PLANS HAVE BEEN REVIEWED FOR THE HOWARD
SOIL CONSERVATION DISTRICT AND MEET THE TECHNICAL
REQUIREMENTS FOR SMALL POND CONSTRUCTION, SOIL
EROSION AND SEDIMENT CONTROL.

APPROVED *John M. Helm* 5-23-85
U.S. SOIL CONSERVATION SERVICE DATE

BY THE DEVELOPER:
"I CERTIFY THAT ALL DEVELOPMENT AND/OR CON-
STRUCTION WILL BE DONE ACCORDING TO THESE
PLANS, AND THAT ANY RESPONSIBLE PERSONNEL
INVOLVED IN THE CONSTRUCTION PROJECT WILL
HAVE CERTIFICATE OF ATTENDANCE AT A DE-
PARTMENT OF NATURAL RESOURCES APPROVED
TRAINING PROGRAM FOR THE CONTROL OF SEDIMENT
AND EROSION BEFORE BEGINNING THE PROJECT. I
WILL PROVIDE THE HOWARD SOIL CONSERVATION
DISTRICT WITH AN "AS-BUILT" PLAN OF THE POND
WITHIN 30 DAYS OF COMPLETION."
(TYPE IN BUI WAREHOUSE #2 LIMITED PARTNERSHIP BY
SIA CONSULTING)
Joseph W. Ziehm 5/21/85
DEVELOPER SIA CONSULTING DATE

BY THE ENGINEER:
"I CERTIFY THAT THIS PLAN FOR POND CONSTRUCTION,
EROSION AND SEDIMENT CONTROL REPRESENTS A PRACTI-
CAL AND WORKABLE PLAN BASED ON MY PERSONAL
KNOWLEDGE OF THE SITE CONDITIONS. THIS PLAN WAS
PREPARED IN ACCORDANCE WITH THE REQUIREMENTS OF
THE HOWARD SOIL CONSERVATION DISTRICT. I HAVE
NOTIFIED THE DEVELOPER THAT HE MUST PROVIDE THE
HOWARD SOIL CONSERVATION DISTRICT WITH AN "AS-
BUILT" PLAN OF THE POND WITHIN 30 DAYS OF COM-
PLETION."
John M. Helm 5/21/85
ENGINEER SIA CONSULTING DATE

APPROVED: FOR PUBLIC WATER AND PUBLIC SEWERAGE
SYSTEMS, HOWARD COUNTY HEALTH DEPART-
MENT.

John M. Helm 5/21/85
COUNTY HEALTH OFFICER DATE

APPROVED: HOWARD COUNTY OFFICE OF PLANNING
AND ZONING.

John M. Helm 6-3-85
PLANNING DIRECTOR DATE
John M. Helm 6-3-85
CHIEF, DIVISION OF LAND
DEVELOPMENT AND
ZONING ADMINISTRATION DATE

APPROVED: FOR PUBLIC WATER, PUBLIC SEWERAGE,
STORM DRAINAGE SYSTEMS AND PUBLIC
ROADS.

HOWARD COUNTY DEPARTMENT OF PUBLIC WORKS
Ray E. Neuman 5-21-85
DIRECTOR DATE

John M. Helm 5-21-85
CHIEF, BUREAU OF ENGINEERING DATE

DATE	NO	REVISION

OWNER DEVELOPER
CE SEN BUI WAREHOUSE #2 LTD PARTNERSHIP
710 AMERICAN CITY BUILDING
COLUMBIA, MARYLAND 21044

PROJECT **B.W.I.P PARCEL M**

AREA TAX MAP NO 45 PARCEL M BLOCK 5
BALTIMORE WASHINGTON INDUSTRIAL PARK
218 ELECTION DISTRICT
HOWARD COUNTY, MARYLAND

TITLE **DETAILS & PROFILE**

THE RIEMER GROUP, INC.
A LAND PLANNING, DESIGN & CIVIL ENGINEERING FIRM
3105 HEALTH PARK DRIVE, ELLEGGOTT CITY, MD. 21043 301-451-2590

DESIGNED BY JDP
DRAWN BY JCK
PROJECT NO 010000
DATE 1-16-85
SCALE AS SHOWN
DRAWING NO **5 OF 6**

PLANT LIST

SYM	QUAN.	NAME	SIZE	REMARKS
AR	7	SEE SYMBOL PINE TREE	13" - 15" DBH 2 1/2" - 3" CAL.	R & B Full Root
PS	6	PINES Eastern White Pine	6" - 8" DBH 2 1/2" Cal.	R & B Unbearing
FI	71	KORNYTHIA INTERMEDIA HYDRANGEA	18" - 24" DBH	UNBEARING 100% DBH

NOTE FOR GRADING OF POND
SEE SITE DEVELOPMENT PLAN

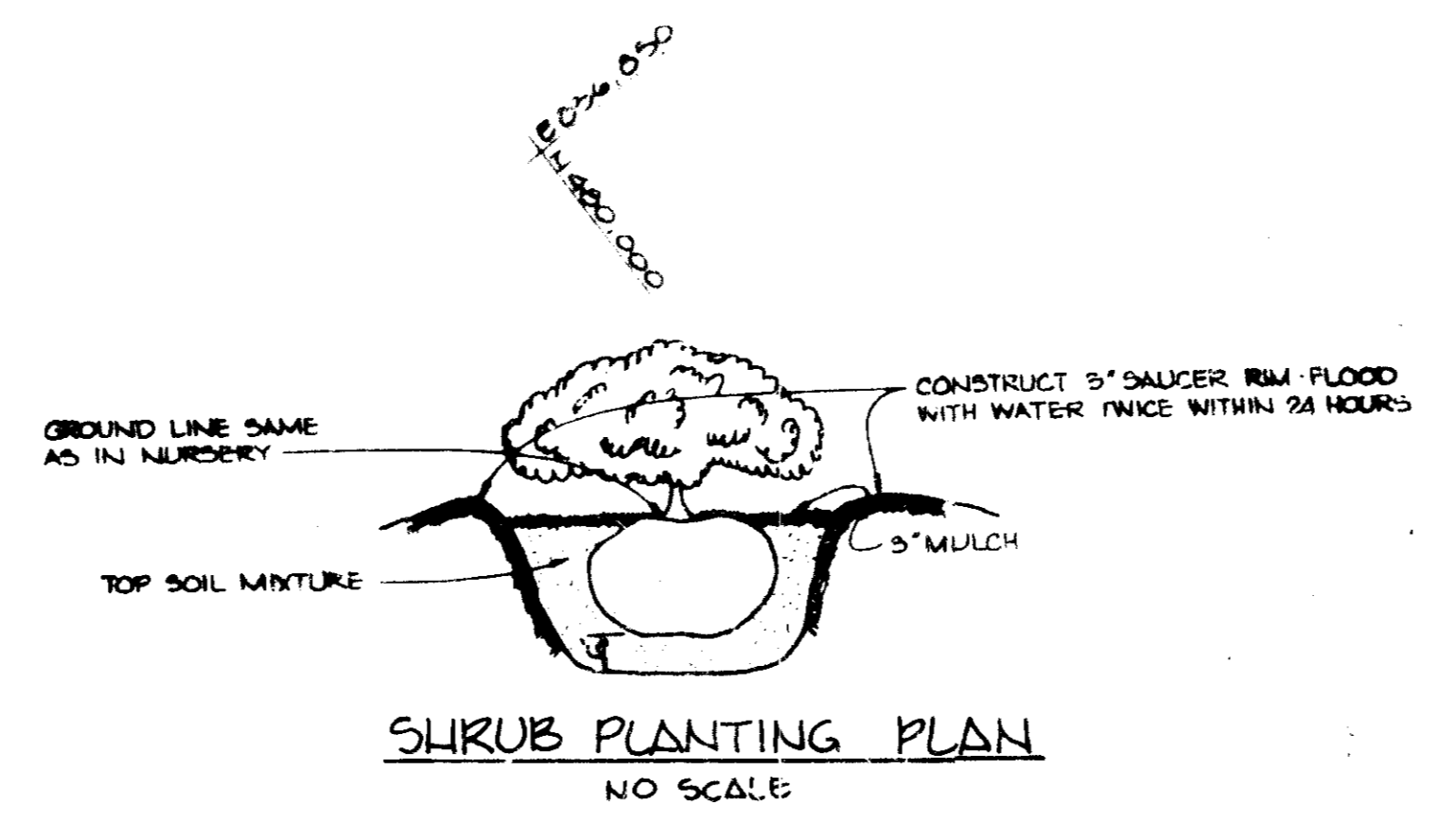
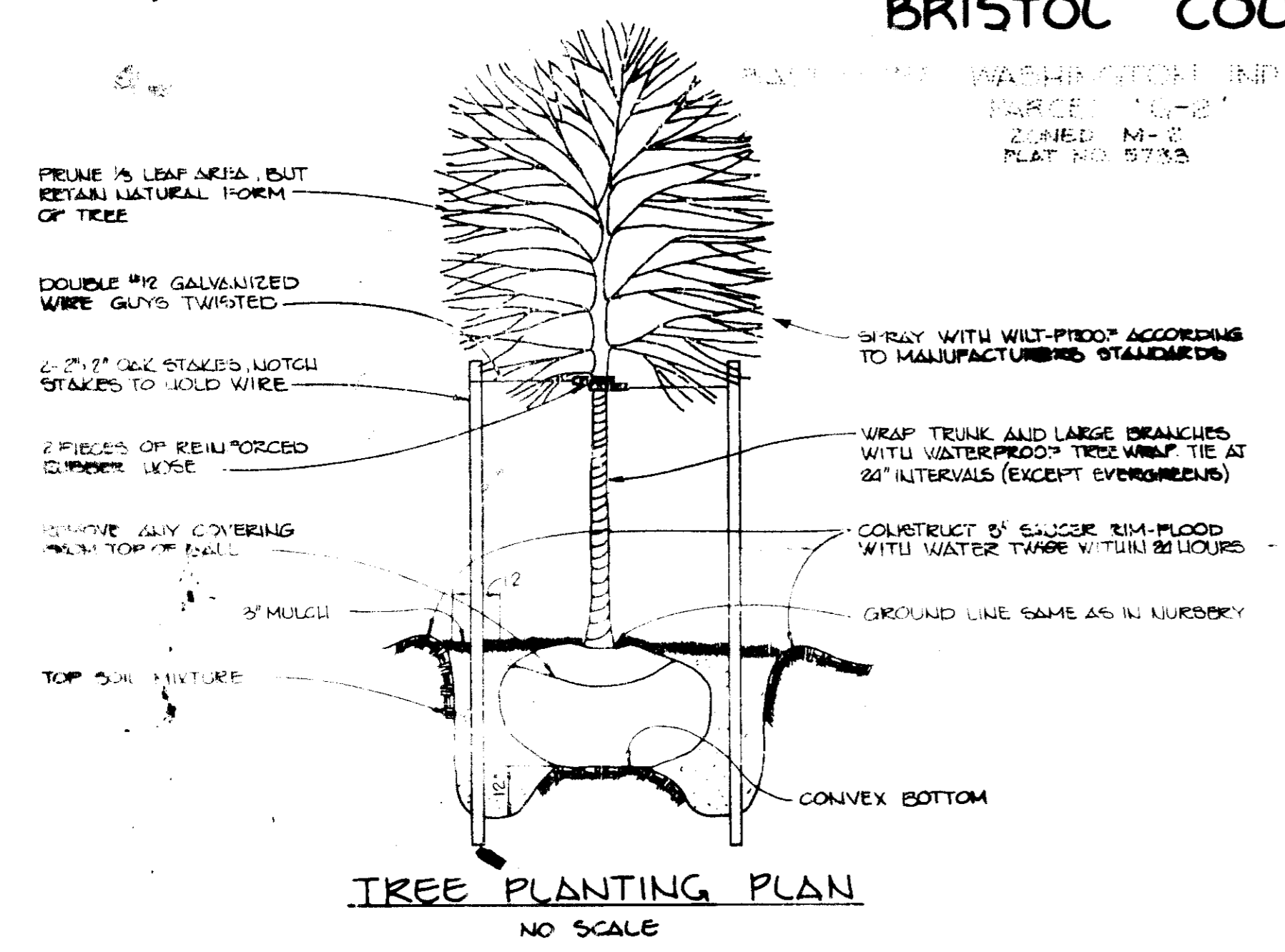
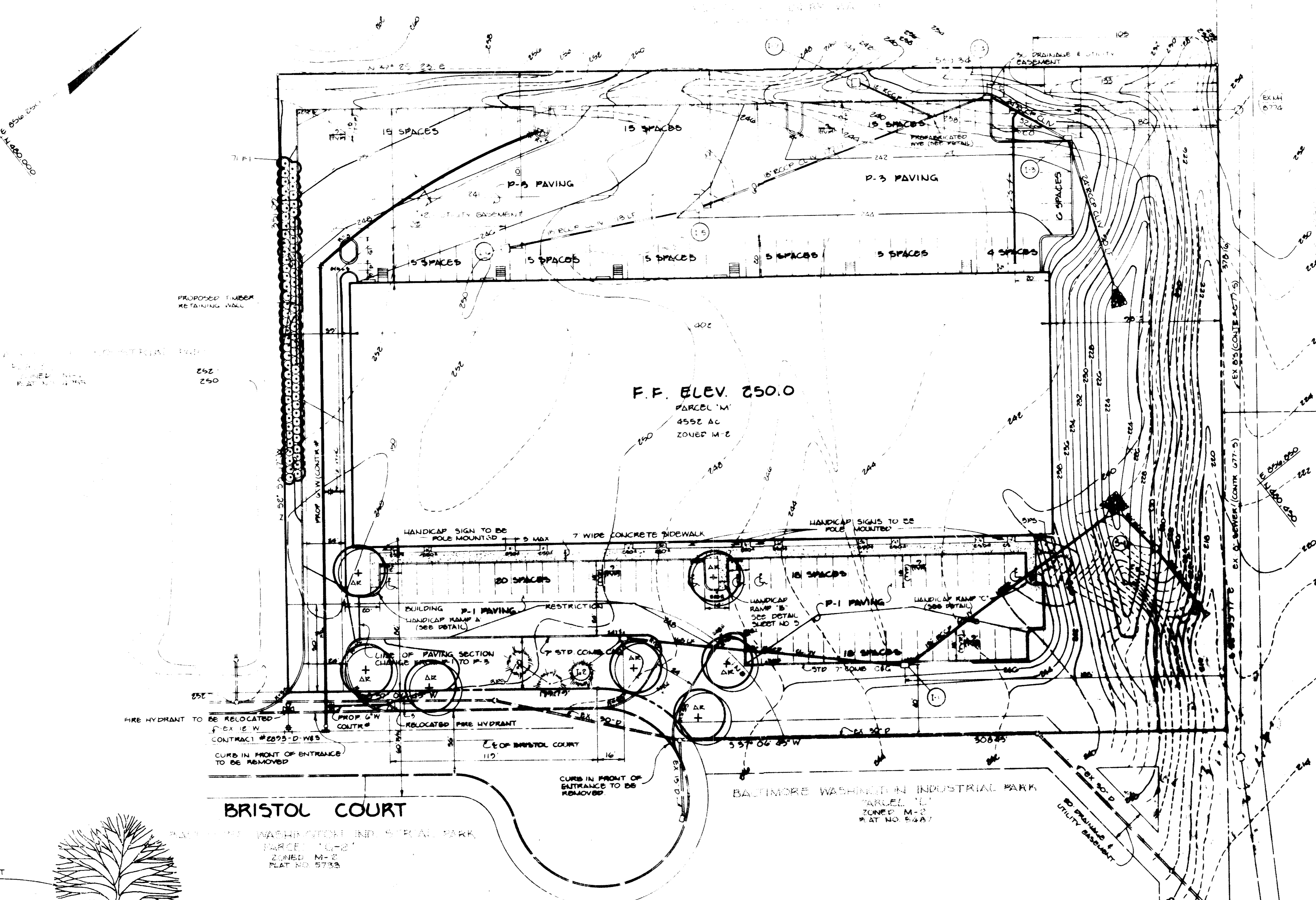

APPROVED: FOR PUBLIC WATER AND PUBLIC SEWER SYSTEMS, HOWARD COUNTY HEALTH DEPARTMENT.

Joseph F. Neer 5/1/85
COUNTY HEALTH OFFICER DATE

APPROVED: HOWARD COUNTY OFFICE OF PLANNING AND ZONING.

Michael J. Neer 6-3-85
PLANNING DIRECTOR DATE

Shirley M. Neer 6-3-85
CHIEF, DIVISION OF PLANNING AND ZONING DEVELOPMENT AND ZONING ADMINISTRATION DATE

APPROVED: FOR PUBLIC WATER, PUBLIC SEWER, STREET LIGHTING SYSTEMS AND STREET FLOODING.

Joseph F. Neer 5-28-85
HOWARD COUNTY GOVERNMENT OF PUBLIC WORKS DATE

Michael J. Neer 5-28-85
CHIEF, DIVISION OF PLANNING AND ZONING DEVELOPMENT AND ZONING ADMINISTRATION DATE

DATE	NO.	REVISION

OWNER/DEVELOPER
CRYSTAL BAY INDUSTRIES & C
LIMITED PARTNERSHIP
710 AMERICAN CITY BUILDING
COLUMBIA, MARYLAND 21044

PROJECT
D.W.I.P. PARCEL M

AREA
TAX MAP 138 25 PARCEL M, BLOCK 17
BALTIMORE WASHINGTON INDUSTRIAL PARK
6TH ELECTION DISTRICT
HOWARD COUNTY, MARYLAND

TITLE
PLANTING PLAN

THE RIEMER GROUP, INC.
A LAND PLANNING, DESIGN & CIVIL ENGINEERING FIRM
3105 HEALTH PARK DRIVE, ELLICOTT CITY, MD. 21043 301-581-9900

5-20-85
DATE

DESIGNED BY
DRAWN BY P.E.R.
PROJECT NO. 010000
DATE 1-16-85
SCALE 1" = 50'
DRAWING NO. 6 OF 6

Melanie Moser
MELANIE MOSER

ADP-26-17

APPROVED:
DIVISION OF LAND USE AND
ZONING ADMINISTRATION
HOWARD COUNTY
DATE 3-26-85
MJ