

SITE DATA

AREA OF SUBMITTAL : 15,588 AC. (67903.3 SF)
 AREA OF DISTURBANCE : 2.19 AC.
 AREA TO BE VEGETATIVELY STABILIZED = 1.06 AC.
 EXISTING BUILDING AREA : FIRST FLOOR 59,412 SF
 BASEMENT 25,634 SF
 TOTAL 85,046 SF

PROPOSED BUILDING ADDITION AREA : FIRST FLOOR = 30415 S.F.
 BASEMENT = 31930 S.F.
 TOTAL 62345 S.F.

AREA TO BE ROOFED : 31,500 S.F.
 AREA TO BE PAVED : 7,850 S.F. (SERVICE YARD)
 EXISTING ZONING : EMPLOYMENT CENTER INDUSTRIAL
 PER FDP No.36 PHASE 36

LEGAL REFERENCE : PLAT ENTITLED "COLUMBIA - OAKLAND RIDGE INDUSTRIAL PARK - SECTION 3 AND A PORTION OF PARCEL A - 2nd ELECTION DISTRICT" - RECORDED IN PLAT BOOK 15, FOLIO 1.

ORIGINAL SDP - 70-39C
 ALL DRIVES ON SITE ARE PRIVATE
 BUILDING TO OPEN SPACE PERCENTAGE = $\frac{91342}{67903.3} = 13.5\%$

PARKING TABULATION

EXISTING BUILDING : 160 EMPLOYEES
 PROPOSED BUILDING ADDITION : 50 EMPLOYEES (2 SHIFT @ 30/20)
 TOTAL : 210 EMPLOYEES
 PARKING REQ'D @ 7 SPACES PER 10 EMPLOYEES = 147 SPACES
 HANDICAPPED PARKING SPACES REQUIRED : 5 SPACES
 TOTAL EXISTING PARKING : 202 SPACES

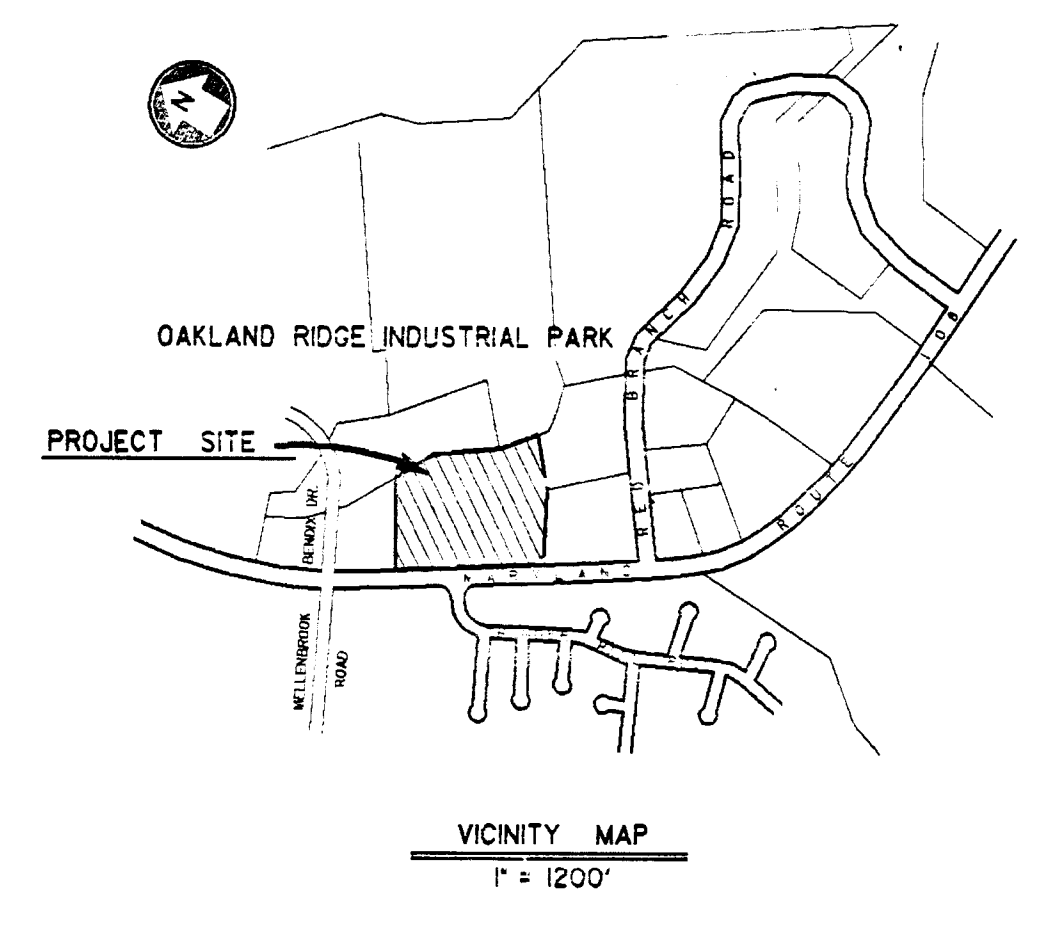

LEGEND

- EXISTING BUILDING
- NEW BUILDING
- EXISTING CONCRETE
- EXISTING GAS
- EXISTING WATER
- NEW WATER
- EXISTING SANITARY SEWER
- NEW SANITARY SEWER
- EXISTING FENCE
- EXISTING STORM DRAIN
- NEW STORM DRAIN
- PROPERTY LINE
- EXISTING FIRE HYDRANT
- NEW FIRE HYDRANT
- EXISTING MANHOLE
- NEW MANHOLE

PROPOSED BUILDING ADDITION USES

OFFICE AREA (3 EMPLOYEES/SHIFT) : 15,000 SF
 PRODUCTION AREA (17 EMPLOYEES/SHIFT) : 21,400 SF
 PRODUCTION SUPPORT AREA (NO EMPLOYEES) : 31,100 SF

HOWARD SOIL CONSERVATION DISTRICT
 THIS DEVELOPMENT IS APPROVED FOR SOIL EROSION AND SEDIMENT CONTROL BY THE HOWARD SOIL CONSERVATION DISTRICT

APPROVED : HOWARD SOIL CONSERVATION DISTRICT _____ DATE _____

REVIEWED FOR THE HOWARD SOIL CONSERVATION DISTRICT AND MEETS TECHNICAL REQUIREMENTS

SIGNATURE : *[Signature]* _____ DATE : 10-9-84

THE UNITED STATES SOIL CONSERVATION SERVICE

APPROVED : FOR PUBLIC WATER, PUBLIC SEWERAGE AND STORM DRAINAGE SYSTEMS AND ROADS
 HOWARD COUNTY DEPARTMENT OF PUBLIC WORKS

SIGNATURE : *[Signature]* _____ DATE _____
 DIRECTOR

APPROVED : FOR PUBLIC WATER, PUBLIC SEWERAGE AND STORM DRAINAGE SYSTEMS
 HOWARD COUNTY HEALTH DEPARTMENT

COUNTY HEALTH OFFICER _____ DATE _____

APPROVED : HOWARD COUNTY OFFICER OF PLANNING AND ZONING

SIGNATURE : *[Signature]* _____ DATE : 10-16-84
 CHIEF, DIVISION OF LAND DEVELOPMENT AND ZONING ADMINISTRATION

ADDRESS CHART	
LOT NUMBER	STREET ADDRESS
66 & 67	9140 OLD ANNAPOLIS RD. RT. 108
EQUESTRIAN CENTER	RUMSEY RD.
80	PIZZA HUT OFFICE 9170 MD. RT. 108
79	9150 MD. RT. 108
62	OPEN SPACE
1	PARCEL 'A' 9198 RED BRANCH RD.
2	9150 RED BRANCH RD.

9-19-84
[Signature]

SITE PLAN



LOCKWOOD GREENE
 Planners/Engineers/Architects/Managers
 P.O. Box 491
 Spartanburg, South Carolina 29304

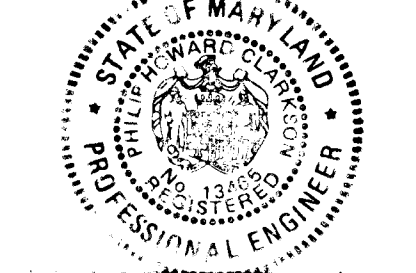

ENGINEER
Philip H. Clarkson
 15455 8-8-84
 DATE

OWNER - DEVELOPER
Bendix
 MICROELECTRONICS CENTER
 340 1/2 MILLERS RD. FT. BELLEVILLE, MD. 21055

OWNER
 BY : *[Signature]* DATE : 8/9/84

DESIGN : SD
 DRAWN : LMS
 CHECKED : DLS
 REVISIONS
 11/22/84 ADDS. PARALLEL SPACES AND LOTS NOTED TO SITE DATA

SITE AND STORM WATER MANAGEMENT PLAN
 SECTION 3 PLOTS 66 & 67
OAKLAND RIDGE INDUSTRIAL PARK
 PROPOSED IMPROVEMENTS : BUILDING ADDITION
 9140 OLD ANNAPOLIS RD. OAKLAND RIDGE
 HOWARD COUNTY, MD. 21055
 SCALE : 1" = 50'
 AUG. 11 - 14 TMB
 SHEET 1 OF 2
SDP-85-23c

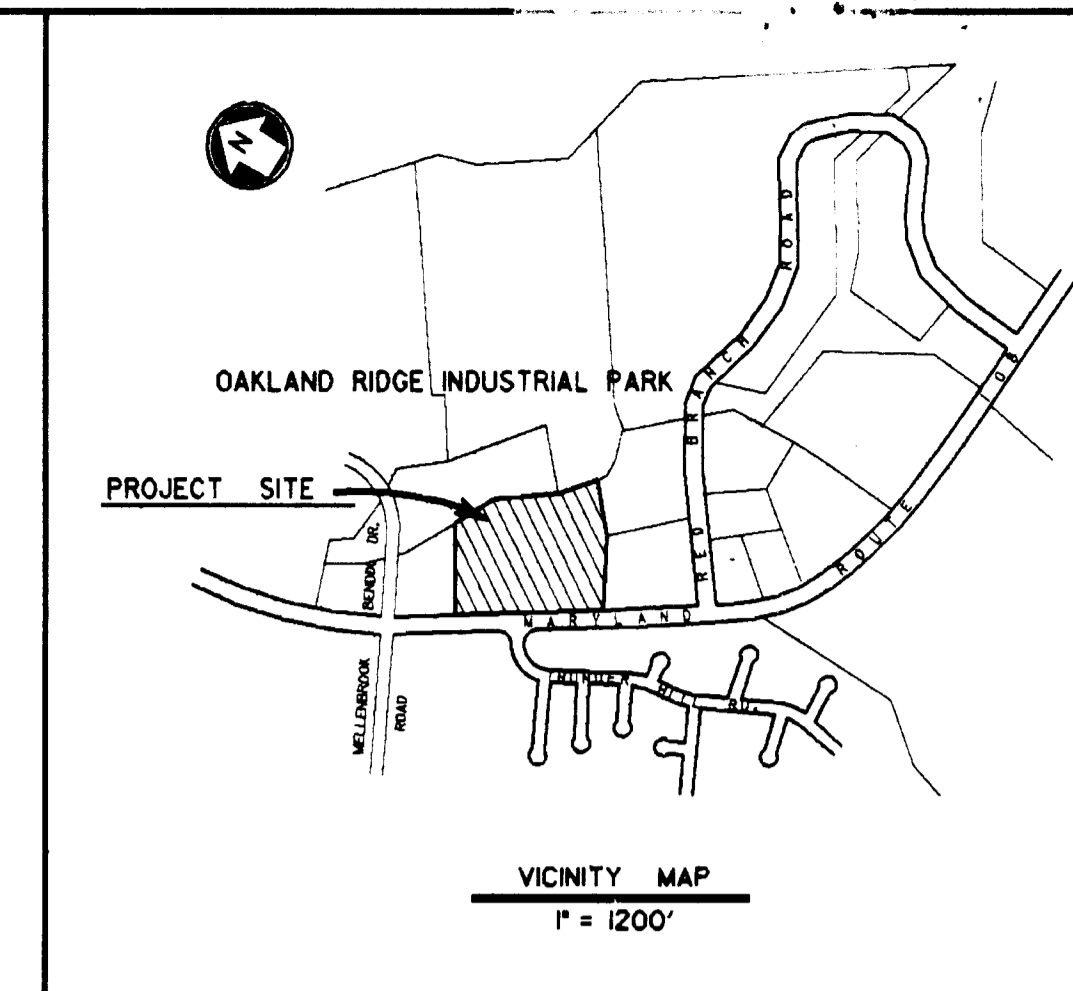
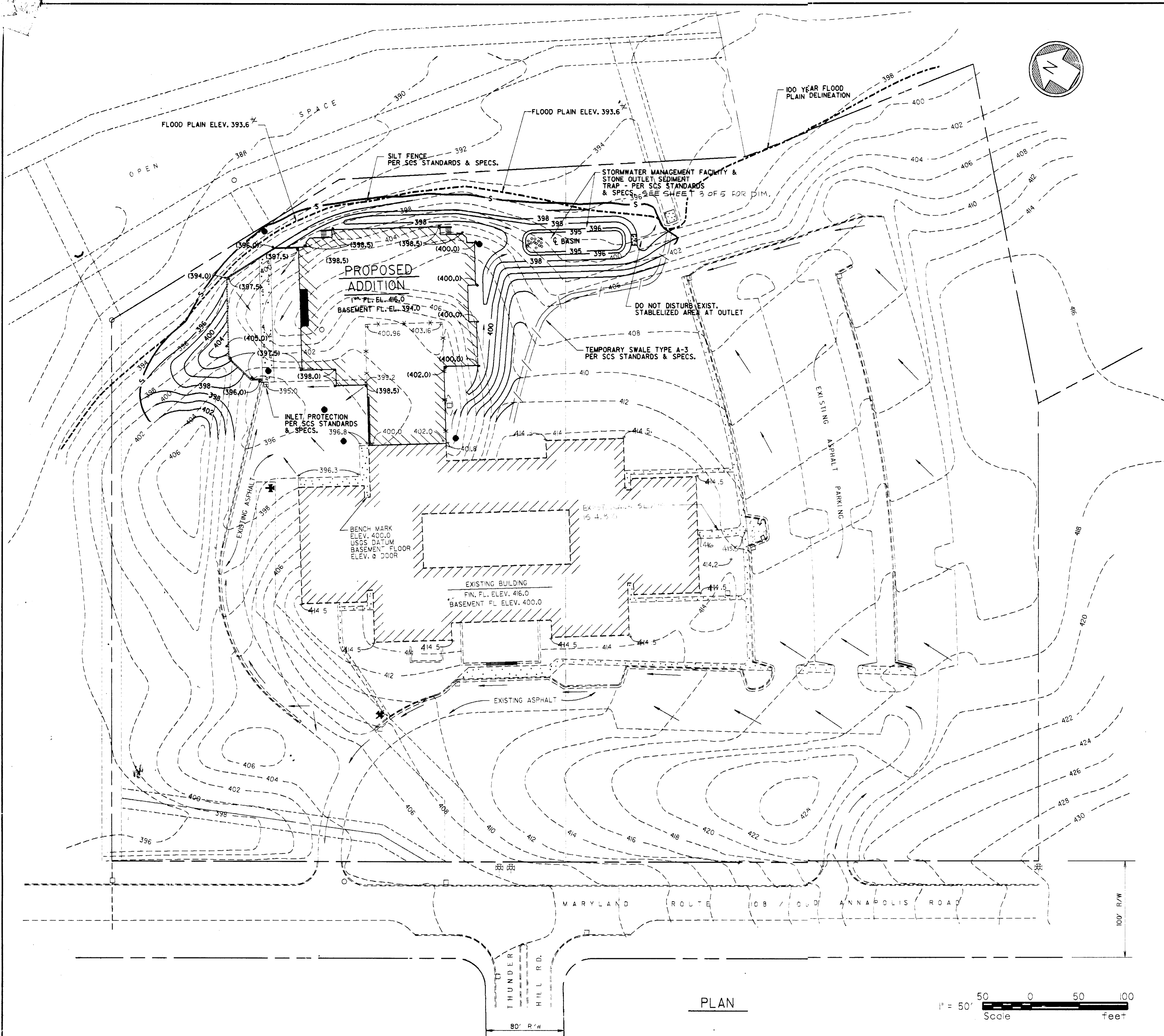

LEGEND

EXISTING		NEW
--- 400 ---	CONTOUR	--- 400 ---
--- 401.8 ---	SPOT ELEVATION	--- (402.0) ---
---	FLOW ARROWS	---

HOWARD SOIL CONSERVATION DISTRICT THIS DEVELOPMENT IS APPROVED FOR SOIL EROSION AND SEDIMENT CONTROL BY THE HOWARD SOIL CONSERVATION DISTRICT		DATE
APPROVED : HOWARD SOIL CONSERVATION DISTRICT		DATE
REVIEWED FOR THE HOWARD SOIL CONSERVATION DISTRICT AND MEETS TECHNICAL REQUIREMENTS		DATE
SIGNATURE : <i>M.M. Sully</i>		10-9-84 DATE
THE UNITED STATES SOIL CONSERVATION SERVICE		DATE
APPROVED : FOR PUBLIC WATER, PUBLIC SEWERAGE AND STORM DRAINAGE SYSTEMS AND ROADS HOWARD COUNTY DEPARTMENT OF PUBLIC WORKS		DATE
<i>[Signature]</i> DIRECTOR		10-10-84 DATE
<i>[Signature]</i> CHIEF, BUREAU OF ENGINEERING		DATE
APPROVED : FOR PUBLIC WATER AND PUBLIC SEWERAGE SYSTEMS HOWARD COUNTY HEALTH DEPARTMENT		DATE
COUNTY HEALTH OFFICER		DATE
APPROVED : HOWARD COUNTY OFFICE OF PLANNING AND ZONING		DATE
<i>[Signature]</i> PLANNING DIRECTOR		DATE
<i>[Signature]</i> CHIEF, DIVISION OF LAND DEVELOPMENT AND ZONING ADMINISTRATION		DATE

9-19-84
MS

PLAN

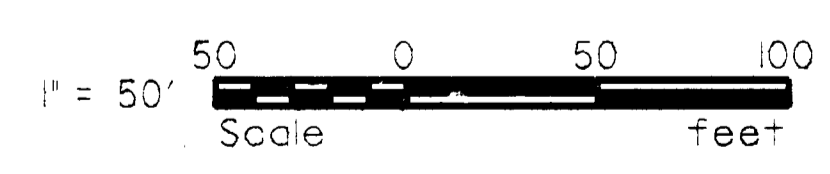

LOCKWOOD GREENE
Planners/Engineers/Architects/Managers
P.O. Box 491
Spartanburg, South Carolina 29304

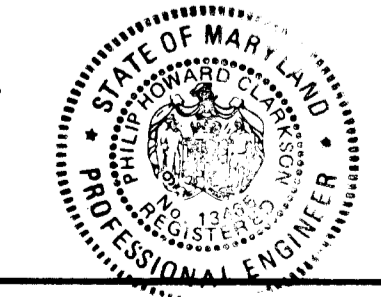

ENGINEER
Philip H. Clarkson
PHILIP HOWARD CLARKSON
13465
8-8-84
REG. No. DATE

OWNER - DEVELOPER
Bendix MICROELECTRONICS CENTER
940 OLD ANNAPOLIS RD., COLUMBIA, MD. 21045

OWNER
BY : *[Signature]* DATE : 8/19/84
TITLE : *Site Design Engineering*

DESIGN : SP
DRAWN : SP
CHECKED :
REVISIONS
9-13-84 ADD EROSION & SED. CONTROL & HANDICAPPED NOTES

SITE AND STORM WATER MANAGEMENT PLAN
SECTION 3 - LOTS 66 & 67
OAKLAND RIDGE INDUSTRIAL PARK
PROPOSED IMPROVEMENTS - BUILDING ADDITION
940 OLD ANNAPOLIS RD., COLUMBIA, MD.
HOWARD COUNTY, MD. TAX MAP # 30 ELECTION DISTRICT #2
SCALE - AS NOTED AUG. 6, 1984 SHEET 2 OF 5

SDP-85-23c

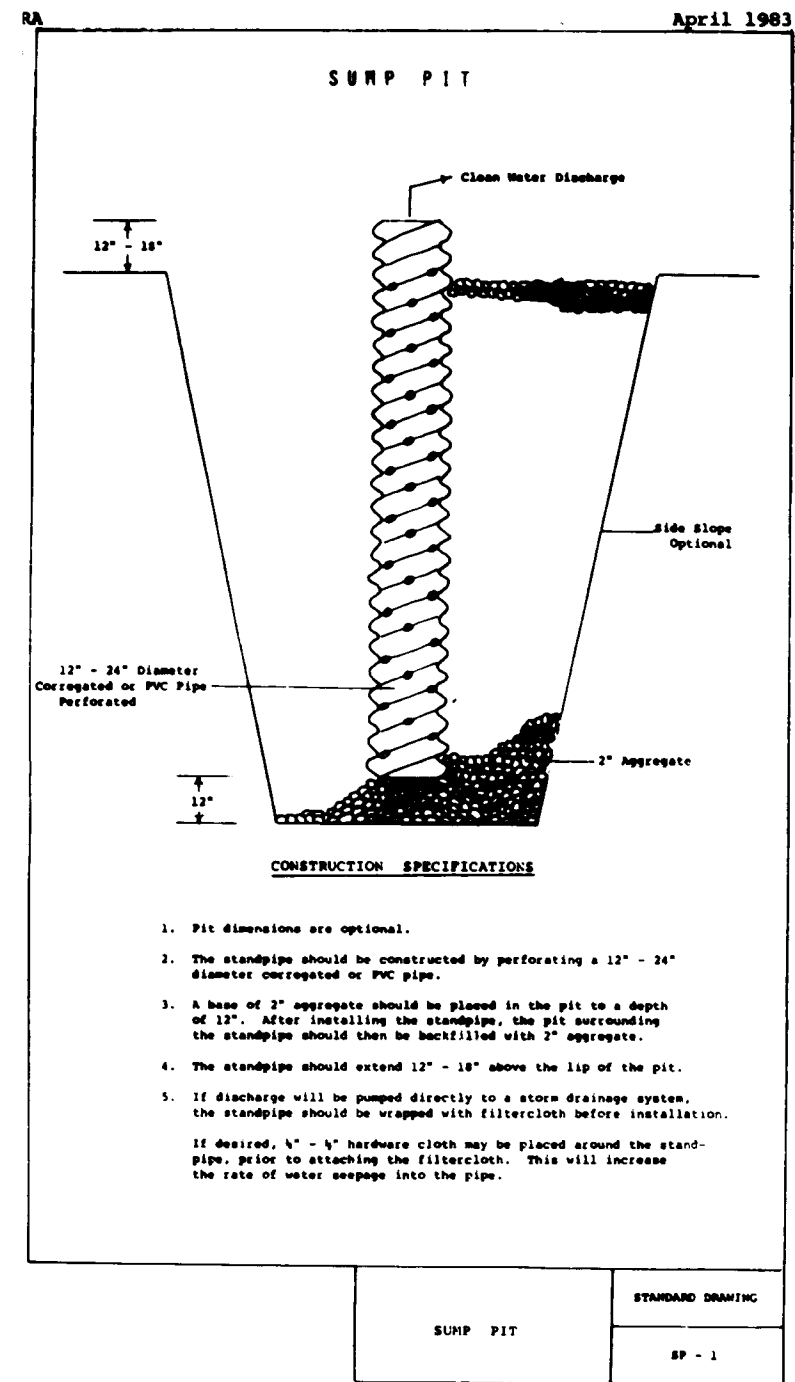
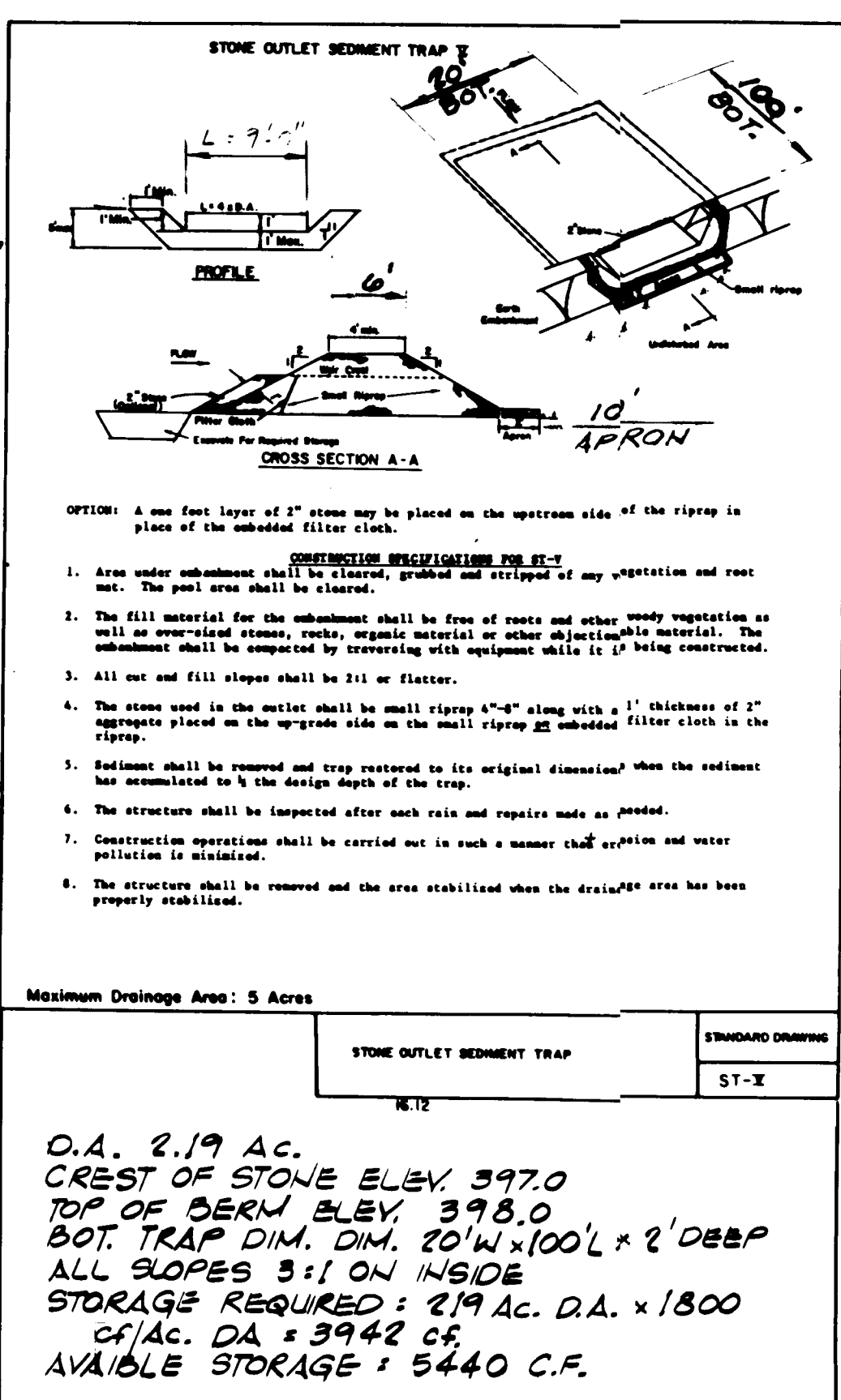
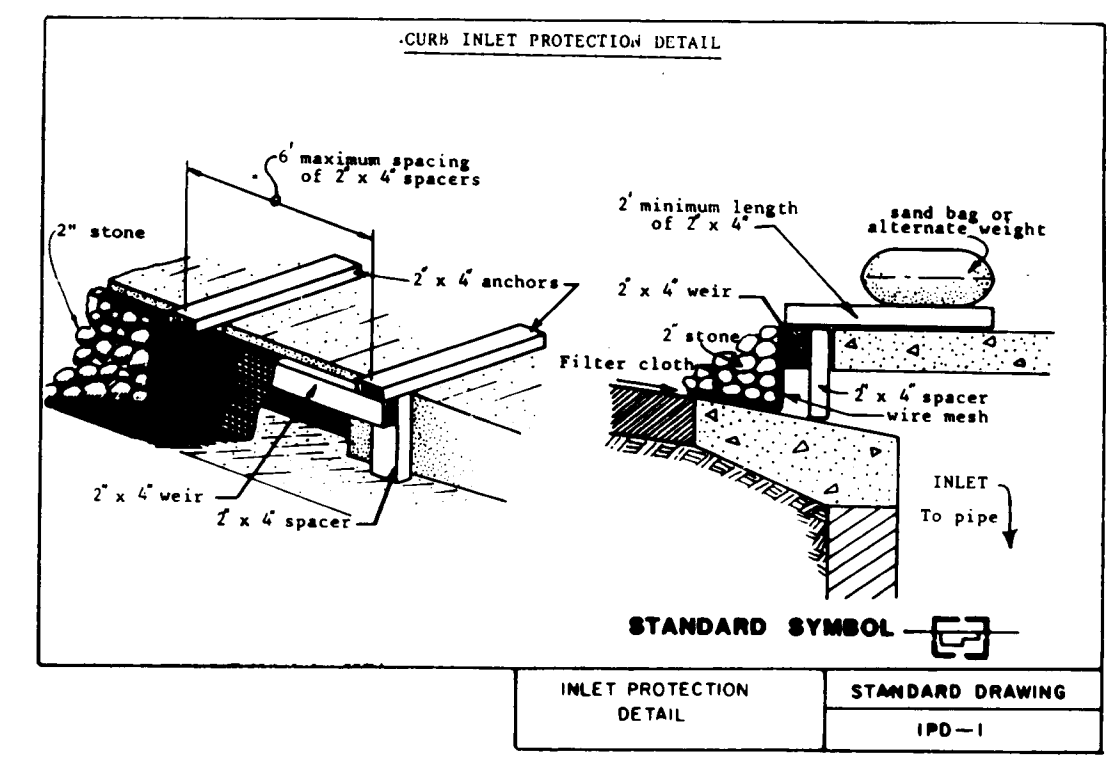
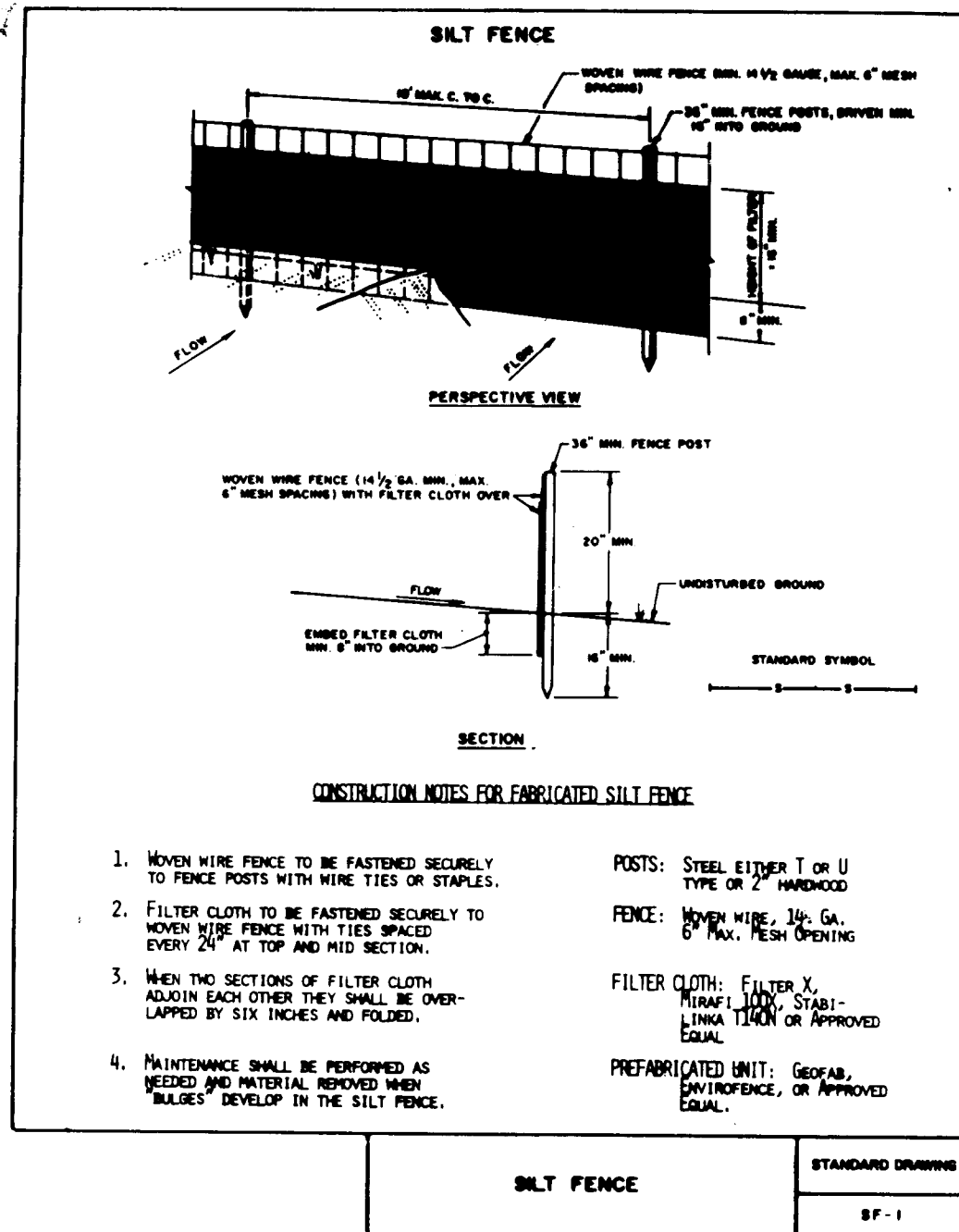

- CONSTRUCTION NOTES:**
- CONTRACTOR TO REFER TO "THE HOWARD COUNTY STANDARD SPECS. AND DETAILS FOR CONSTRUCTION MANUAL FOR DETAILS, MATERIALS SPECIFICATIONS AND CONSTRUCTION PROCEDURES."
 - THE FOLLOWING ITEMS REFER TO THE ABOVE MANUAL:

A. PAVEMENT CUT & REPAIR	G 4.01
B. PRECAST MANHOLE	G 5.11
C. BRICK	G 5.01
D. PAVEMENT SECTION	R 2.01 TYPE P-2
E. FIRE HYDRANT	W 1.11 & W 1.14
F. WATER MAIN BLOCKING	W 2.21 THRU W 2.24
G. FIRE SUPPLY & METERED WATER SERVICE - VAULT NOT REQ'D - SYSTEM INSTALLED IN BASEMENT	W 3.45

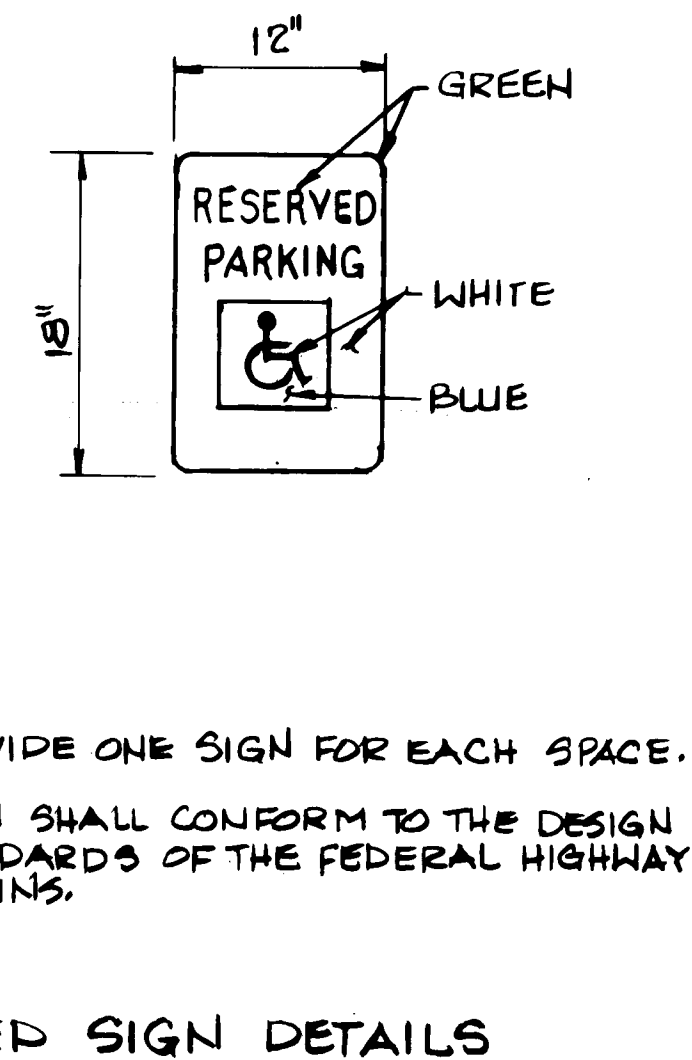
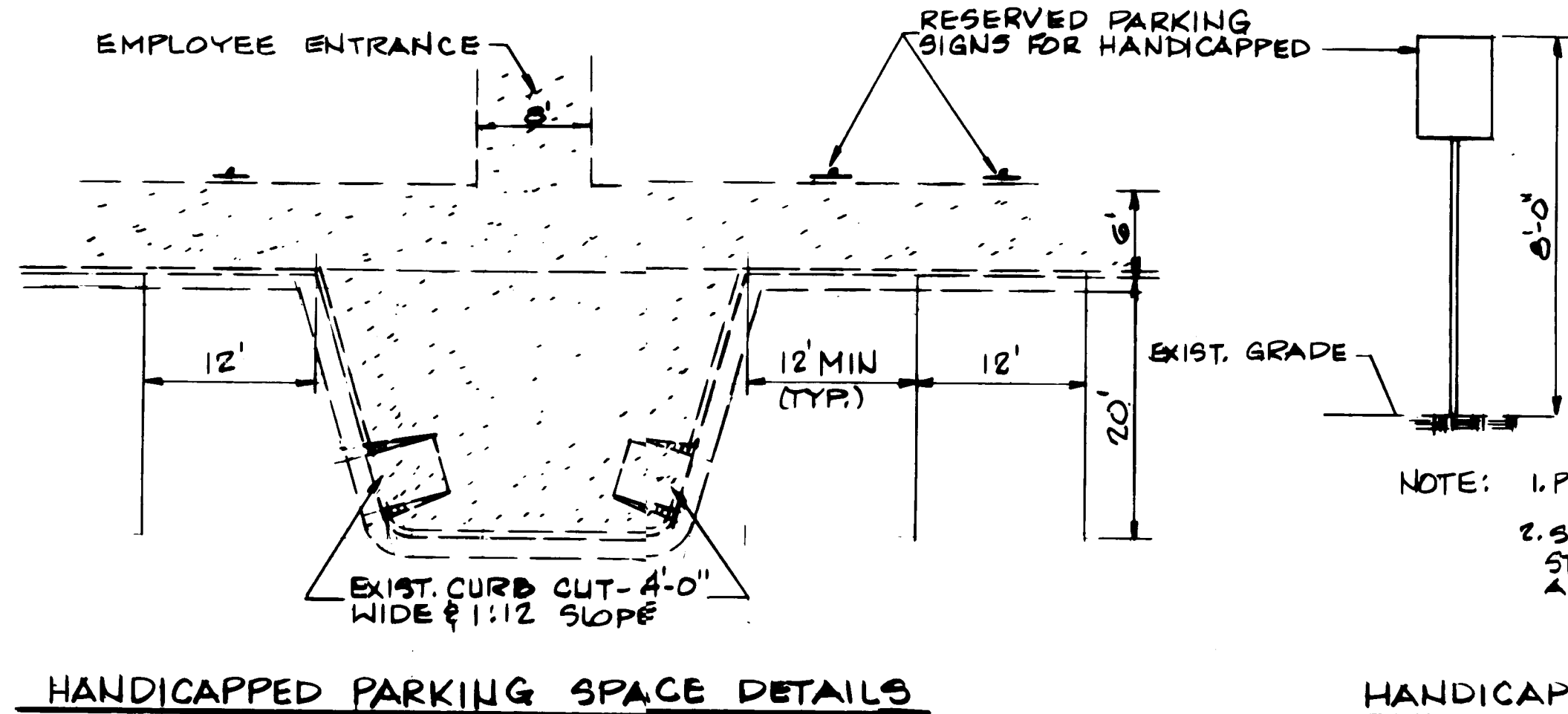
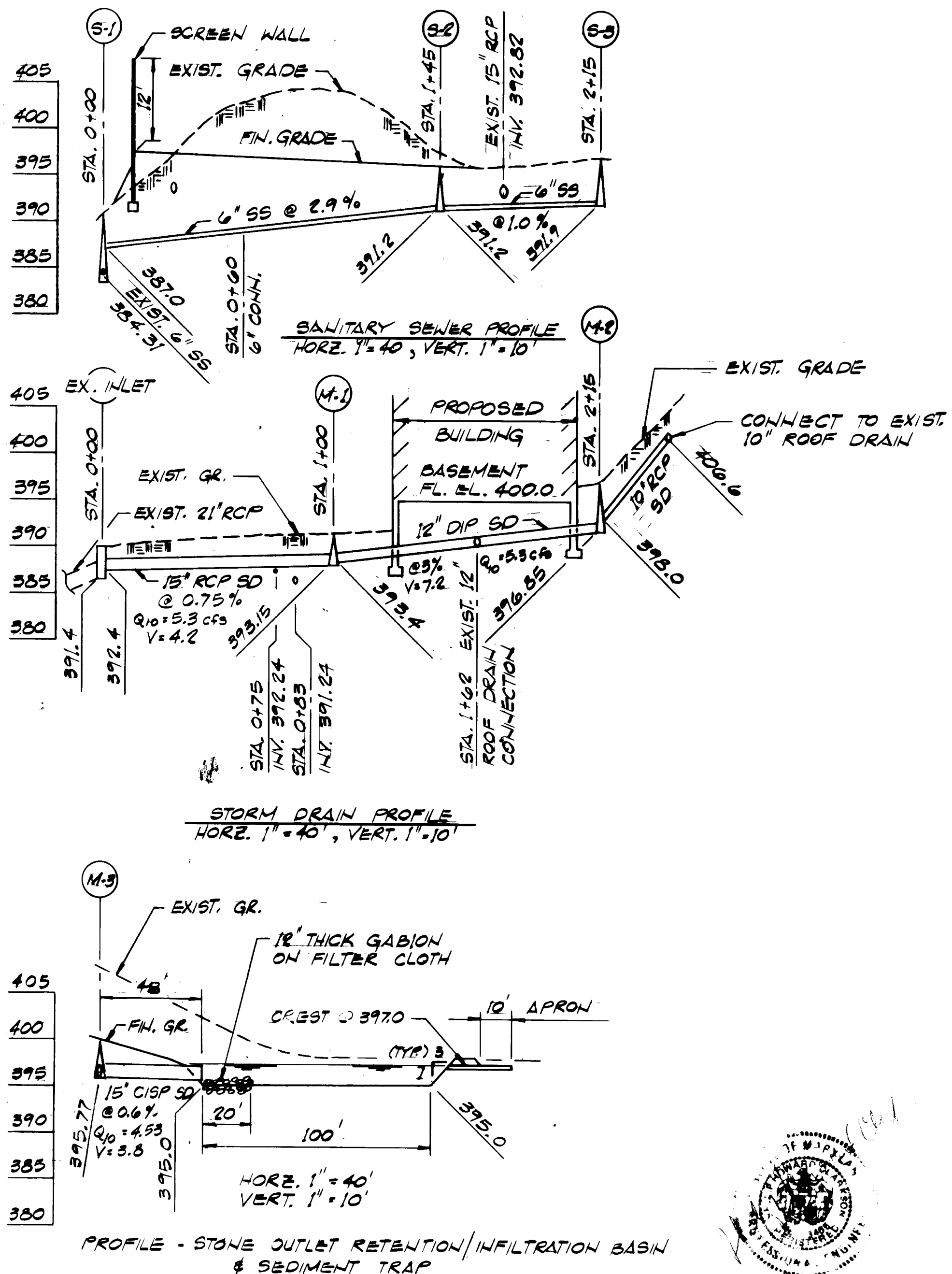

HOWARD SOIL CONSERVATION DISTRICT THIS DEVELOPMENT IS APPROVED FOR SOIL EROSION AND SEDIMENT CONTROL BY THE HOWARD SOIL CONSERVATION DISTRICT	
<i>Stephen L. Fisher</i>	10-9-84 DATE
APPROVED: HOWARD SOIL CONSERVATION DISTRICT	
REVIEWED FOR THE HOWARD SOIL CONSERVATION DISTRICT AND MEETS TECHNICAL REQUIREMENTS	
<i>Mark K. Selby</i>	10-9-84 DATE
THE UNITED STATES SOIL CONSERVATION SERVICE	
APPROVED: FOR PUBLIC WATER, PUBLIC SEWERAGE AND STORM DRAINAGE SYSTEMS AND ROADS	
HOWARD COUNTY DEPARTMENT OF PUBLIC WORKS	
<i>John F. Newman</i> DIRECTOR	10-10-84 DATE
APPROVED: FOR PUBLIC WATER AND PUBLIC SEWERAGE SYSTEMS	
HOWARD COUNTY HEALTH DEPARTMENT	
<i>John A. Boyd</i> COUNTY HEALTH OFFICER	10/15/84 DATE
APPROVED: HOWARD COUNTY OFFICER OF PLANNING AND ZONING	
<i>Thomas J. Amis</i> PLANNING DIRECTOR	10-16-84 DATE
<i>John M. Newman</i> CHIEF, DIVISION OF LAND DEVELOPMENT AND ZONING ADMINISTRATION	10-16-84 DATE

APPROVED
 PLANNING BOARD
 OF HOWARD COUNTY
 DATE: 9-19-84
M. J. ...

LOCKWOOD GREENE
 Planners/Engineers/Architects/Managers
 P.O. Box 491
 Spartanburg, South Carolina 29304

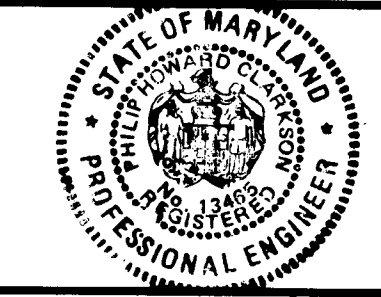

ENGINEER'S CERTIFICATION: I CERTIFY THAT THIS PLAN FOR EROSION AND SEDIMENT CONTROL REPRESENTS A PRACTICAL AND WORKABLE PLAN BASED ON MY PERSONAL KNOWLEDGE OF THE SITE CONDITIONS AND THAT IT WAS PREPARED IN ACCORDANCE WITH THE REQUIREMENTS OF THE HOWARD SOIL CONSERVATION DISTRICT.

Philip H. Clarkson
 PHILIP HOWARD CLARKSON
 13465
 REG. No. DATE: 8-8-84

OWNER - DEVELOPER
Bendix MICROELECTRONICS CENTER
 9140 OLD ANNAPOLIS RD. COLUMBIA, MD. 21045

OWNER'S CERTIFICATION: I CERTIFY THAT ALL DEVELOPMENT AND CONSTRUCTION WILL BE DONE ACCORDING TO THIS PLAN, AND THAT ANY RESPONSIBLE PERSONNEL INVOLVED IN THE CONSTRUCTION PROJECT WILL HAVE A CERTIFICATE OF ATTENDANCE AT A DEPARTMENT OF NATURAL RESOURCES APPROVED TRAINING PROGRAM FOR THE CONTROL OF SEDIMENT AND EROSION BEFORE BEGINNING THE PROJECT.

BY: *[Signature]* DATE: 8/6/84 TITLE: Director

DESIGN: SP
 DRAWN: LMS
 CHECKED: DEC
 REVISIONS:
 9-13-84 ADDED HANDICAPPED PARKING DET.

EROSION AND SEDIMENT CONTROL DETAILS
 SECTION 3: LOTS 66 & 67
OAKLAND RIDGE INDUSTRIAL PARK
 PROPOSED IMPROVEMENTS: BUILDING ADDITION
 9140 OLD ANNAPOLIS RD., COLUMBIA, MD.
 HOWARD COUNTY, MD. TAX MAP # 30 ELECTION DISTRICT #2
 SCALE - AS NOTED AUG. 6, 1984 SHEET 3 OF 5

C-8
 SDP-85-23

EROSION AND SEDIMENT CONTROL GENERAL NOTES

1. ANY CHANGE TO THE GRADING PROPOSED ON THIS PLAN REQUIRES IT TO BE RE-SUBMITTED TO THE SOIL CONSERVATION DISTRICT.
2. ALL SLOPES 3:1 ARE TO BE STABILIZED WITH "PERMANENT" SLOPE SEEDING IMMEDIATELY AFTER GRADING OPERATION (SEE NOTE #12).
3. ALL OTHER DISTURBED AREAS NOT INTENDED TO BE PAVED OR RECEIVE BUILDING COVERAGE SHALL BE STABILIZED WITH "PERMANENT" SEEDING (SEE NOTE #11).
4. ANY DAMAGE TO DIVERSION DIKES, SEDIMENT TRAP, ETC. DURING GRADING OPERATION OR UTILITY INSTALLATION SHALL BE REPAIRED IMMEDIATELY.
5. THE SEDIMENT TRAP SHALL BE CLEANED OUT WHEN SILT DEPOSITS REACH ELEVATION SHOWN ON THE PLAN.
6. NO SEDIMENT CONTROL MEASURE SHALL BE REMOVED WITHOUT PERMISSION FROM THE SEDIMENT CONTROL INSPECTOR.
7. UPON INSTALLATION OF STORM DRAINS, PROVIDE STONE FILTER PROTECTION AT EXISTING CURB INLET UNTIL SITE IS STABILIZED. POSITIVE DRAINAGE MUST BE MAINTAINED AT ALL TIMES.
8. DURING THE LAYOUT OF SEDIMENT CONTROL PRACTICES SHOWN HEREON, MINOR ADJUSTMENTS CAN AND WILL BE MADE TO ASSURE THE ARREST AND CONTROL OF ANY SEDIMENT BEFORE IT LEAVES THE CONSTRUCTION SITE. THESE SAID CHANGES REQUIRE APPROVAL FROM THE SEDIMENT CONTROL INSPECTOR AND/OR THE SOIL CONSERVATION DISTRICT.
9. ALL SITE WORK IS TO BE DONE IN ACCORDANCE WITH STANDARDS AND SPECIFICATIONS FOR SOIL EROSION AND SEDIMENT CONTROL, 1983, AND THIS PLAN OF SEDIMENT CONTROL APPROVED BY THE HOWARD COUNTY SOIL CONSERVATION DISTRICT AND THE DEPARTMENT OF PUBLIC WORKS.
10. AT THE END OF EACH WORKING DAY, ALL SEDIMENT CONTROL MEASURES WILL BE INSPECTED AND LEFT IN OPERATIONAL CONDITION.
11. PERMANENT SEEDING:
SEEDBED PREPARATION: LOOSEN UPPER 3 INCHES OF SOIL BY RAKING, DISCING OR OTHER ACCEPTABLE MEANS BEFORE SEEDING.
SOIL AMENDMENTS: APPLY 2 T./AC. (92 LBS./1,000 S.F.) DOLOMITIC LIMESTONE AND 600 LBS./AC. (14 LBS./1,000 S.F.) 10-20-20 FERTILIZER. HARROW OR DISC LIME AND FERTILIZER INTO UPPER 3 INCHES OF SOIL AT TIME OF SEEDING. APPLY 400 LBS./AC. (9.2 LBS./1,000 S.F.) OF 30-0-0 UREAFORM FERTILIZER.
SEEDING: FOR PERIODS MARCH 1 - APRIL 30 AND AUGUST 1 - OCTOBER 15, SEED WITH 60 LBS./AC. (1.4 LBS./1,000 S.F.) OF KENTUCKY 3 TALL FESCUE. FOR THE PERIOD MAY 1 - JULY 31 SEED WITH 60 LBS./AC. OF KENTUCKY 3 TALL FESCUE AND 2 LBS./AC. (0.5 LBS./1,000 S.F.) OF WEEPING LOVEGRASS. DURING THE PERIOD OF OCTOBER 16 - FEBRUARY 28, PROTECT SITE BY: OPTION (1) 2 T./AC. OF WELL ANCHORED STRAW MULCH AND SEED AS SOON AS POSSIBLE IN THE SPRING. OPTION (2) USE SOD. OPTION (3) SEED WITH 60 LBS./AC. OF KENTUCKY 3 TALL FESCUE AND MULCH WITH 2 T./AC. WELL ANCHORED STRAW.
MULCHING: APPLY 1.5-2 T./AC. (70-90 LBS./1,000 S.F.) OF UNROTTED, SMALL GRAIN STRAW IMMEDIATELY AFTER SEEDING. ANCHOR MULCH IMMEDIATELY AFTER APPLICATION USING 200 Gg./AC. (5 Gg./1,000 S.F.) OF EMULSIFIED ASPHALT ON FLAT AREAS. ON SLOPE 8 FEET OR HIGHER, USE 348 Gg./AC. (8 Gg./1,000 S.F.) FOR ANCHORING.
MAINTENANCE: INSPECT ALL SEEDED AREAS AND MAKE NEEDED REPAIRS, REPLACEMENTS AND RESEEDINGS.
12. PERMANENT SLOPE SEEDING: SPREAD 4 INCHES OF TOPSOIL. SEED SHALL BE A MIXTURE OF 30% INOCULATED CROWNFITCH AND 70% KENTUCKY 3 TALL FESCUE APPLIED AT A RATE OF 60 LBS./AC. FERTILIZER AND MULCHING SAME AS NOTE #12 ABOVE.
13. TEMPORARY SEEDING:
SEEDBED PREPARATION: SEE NOTE #11
SOIL AMENDMENTS: APPLY 600 LBS./AC. (6 LBS./1,000 S.F.) OF 10-20-20 FERTILIZER.
SEEDING: FOR PERIODS MARCH 1 - APRIL 30 AND FROM AUGUST 15 - NOVEMBER 15, SEED WITH 2.5 BU./AC. (3.2 LBS./1,000 S.F.) OF ANNUAL RYE. FOR THE PERIOD MAY 1 - AUGUST 14, SEED WITH 3 LBS./AC. (10.0 LBS./1,000 S.F.) OF WEEPING LOVEGRASS.
MULCHING: SEE NOTE #11
14. (DELETED)
15. SOD SPECIFICATION (USE WHERE SPECIFIED):
SOD SHALL BE #3 SOD WHICH HAS NOT BEEN CUT AND ROLLED MORE THAN 2 DAYS IN ADVANCE AND SOD SHALL BE FASTENED SECURELY WITH AT LEAST 2 STAKES NOT MORE THAN 2 FEET APART WITH THE FLAT SIDE AGAINST THE SLOPE AND STAKE FLUSH WITH TOP OF SOD. SOD BED PREPARATION AND SOIL AMENDMENTS SHALL BE IN ACCORDANCE WITH GENERAL NOTE #11.
16. SUMP PITS FOR DEWATERING DURING FOUNDATION EXCAVATION SHALL BE PROVIDED BY THE CONTRACTOR WITH MATERIALS AND CONSTRUCTION PER DOCUMENT NOTED IN NOTE #9. NUMBER AND LOCATION OF SUMPS TO BE DETERMINED BY THE CONTRACTOR. SUMP PUMP DISCHARGE TO STORM DRAINAGE SYSTEMS REQUIRES FILTER CLOTH TO BE WRAPPED AROUND STAND PIPE.
17. SILT FENCE CONSTRUCTION AND MATERIALS WILL BE IN ACCORDANCE WITH THESE PLANS AND THE HOWARD CO. SEDIMENT CONTROL FIELD ACCEPTANCE CRITERIA.
18. FOLLOWING INITIAL SOIL DISTURBANCE OR REDISTURBANCE PERMANENT OR TEMPORARY STABILIZATION SHALL BE COMPLETED WITHIN 17 CALENDAR DAYS FOR ALL PERIMETER SEDIMENT CONTROL STRUCTURES, DIKES, AWALENS, DITCHES, PERIMETER SLOPES AND ALL SLOPES GREATER THAN 3:1 21 DAYS AS TO ALL OTHER DISTURBED OR GRADED AREAS ON THE PROJECT SITE.

GENERAL NOTES

1. ALL AREAS NOT BEING PAVED OR RECEIVING BUILDING COVERAGE SHALL BE STABILIZED IN ACCORDANCE WITH THE PLANS APPROVED BY THE HOWARD SOIL CONSERVATION DISTRICT.
2. ANY DAMAGE TO PUBLIC RIGHTS-OF-WAY AND/OR ADJACENT PROPERTIES SHALL BE REPAIRED IMMEDIATELY AT THE CONTRACTOR'S EXPENSE.
3. THE CONTRACTOR SHALL VERIFY ALL EXISTING UTILITIES TO HIS OWN SATISFACTION BEFORE STARTING CONSTRUCTION.
4. ALL PERMANENT SLOPES SHALL BE 3:1 OR FLATTER.
5. ALL WORK SHALL BE DONE IN ACCORDANCE WITH HOWARD COUNTY STANDARD SPECIFICATIONS AND DETAILS FOR CONSTRUCTION, OR AS SHOWN ON THESE PLANS.
6. THE CONTRACTOR SHALL MAINTAIN A MINIMUM OF 3.5' COVER OVER ALL PROPOSED WATER LINES.
7. ALL RIP RAP SHALL BE PLACED ON FILTER CLOTH.
8. THE CONTRACTOR OR DEVELOPER SHALL CONTACT THE CONSTRUCTION INSPECTION/SURVEY DIVISION, 24 HOURS IN ADVANCE OF COMMENCEMENT OF WORK AT 992-2417 OR 792-1212.
9. THE CONTRACTOR SHALL REMOVE ALL EXISTING PAVING, CURB & GUTTER, ETC. THAT MAY INTERFERE WITH PROPOSED CONSTRUCTION.
10. TOPOGRAPHY SHOWN IS ACCORDING TO A 12-3-69 SURVEY BY PURDUM & HESCHKE ENGR. AND 4-28-70 CONSTRUCTION PLANS FOR DONOHUE CONSTRUCTION CO.

STORM WATER MANAGEMENT CONSTRUCTION SPECIFICATIONS

1. AREA UNDER EMBANKMENT SHALL BE CLEARED, GRUBBED AND STRIPPED OF ANY VEGETATION AND ROOT MAT. THE POOL AREA SHALL BE CLEARED.
2. THE FILL MATERIAL FOR THE EMBANKMENT SHALL BE FREE OF ROOTS AND OTHER WOODY VEGETATION AS WELL AS OVER-SIZED STONES, ROCKS, ORGANIC MATERIAL OR OTHER OBJECTIONABLE MATERIAL. THE EMBANKMENT SHALL BE COMPACTED BY TRAVERSING WITH EQUIPMENT WHILE IT IS BEING CONSTRUCTED.
3. ALL PERMANENT CUT AND FILL SLOPES SHALL BE 2:1 OR FLATTER.
4. THE STONE USED IN THE OUTLET SHALL BE SMALL RIPRAP 4"-8" ALONG WITH A 1" THICKNESS OF 2" AGGREGATE PLACED ON THE UP-GRADE SIDE ON THE SMALL RIPRAP OR EMBEDDED FILTER CLOTH IN THE RIPRAP.
5. THE STONE SHALL BE CRUSHED STONE. GRAVEL MAY BE USED IF CRUSHED STONE IS NOT AVAILABLE. THE STONE SHALL MEET MSHA SIZE NO. 2 OR AASHTO DESIGNATION M43 SIZE NO. 2 OR 24 UNLESS GABION IS REQUIRED ON PLAN.
6. THE CREST OF THE STONE DIKE SHALL BE ONE FOOT LOWER THAN THE LOWEST ELEVATION OF THE TOP OF THE EARTH DIKE AND SHALL BE LEVEL.
7. THE STONE OUTLET STRUCTURE SHALL BE EMBEDDED INTO THE SOIL A MINIMUM OF 12 INCHES.
8. THE MINIMUM LENGTH, IN FEET, OF THE CREST OF THE STONE OUTLET STRUCTURE SHALL BE EQUAL TO SIX TIMES THE NUMBER OF ACRES OF CONTRIBUTING DRAINAGE AREA.
9. THE STONE OUTLET STRUCTURE SHALL BE INSPECTED AFTER EACH RAIN, AND THE STONE SHALL BE REPLACED WHEN THE STRUCTURE CEASES TO FUNCTION AS INTENDED DUE TO SILT ACCUMULATION AMONG THE STONE, WASHOUT, CONSTRUCTION TRAFFIC DAMAGE, ETC.
10. THE STONE OUTLET STRUCTURE SHALL BE LOCATED SO AS TO DISCHARGE ONTO AN ALREADY STABILIZED AREA OR INTO A STABILIZED AREA OR INTO A STABLE WATERCOURSE. STABILIZATION SHALL CONSIST OF COMPLETE VEGETAL COVER, PAVING, ETC., SUFFICIENTLY ESTABLISHED TO BE EROSION RESISTANT.
11. SEDIMENT SHALL BE REMOVED AND TRAP RESTORED TO ITS ORIGINAL DIMENSIONS WHEN THE SEDIMENT HAS ACCUMULATED TO 1/2 THE DESIGN DEPTH OF THE TRAP.
12. THE STRUCTURE SHALL BE INSPECTED AFTER EACH RAIN AND REPAIRS MADE AS NEEDED.
13. CONSTRUCTION OPERATIONS SHALL BE CARRIED OUT IN SUCH A MANNER THAT EROSION AND WATER POLLUTION IS MINIMIZED.
14. THE SEDIMENT SHALL BE REMOVED AS DIRECTED BY THE SEDIMENT CONTROL INSPECTOR AND THE AREA STABILIZED WHEN THE SITE DRAINAGE AREA HAS BEEN PROPERLY STABILIZED AND APPROVED AND WILL BECOME PERMANENT STORMWATER MANAGEMENT BASIN. THE SIDE SLOPES AND BOTTOM WILL BE PREPARED TO RECEIVE SOD AS SPECIFIED. EARTH MATERIAL IN THE BOTTOM WILL BE WELL DISCED BEFORE PLACING SOD TO ENHANCE THE INFILTRATION RATE.
15. THE STORM WATER MANAGEMENT FACILITIES ARE PRIVATE AND SHALL BE MAINTAINED BY THE OWNER. THE OWNER SHALL BE RESPONSIBLE FOR ALL CONSTRUCTION ACCORDING TO COUNTY STANDARDS.
16. STABILIZATION: THE STORM WATER MANAGEMENT FACILITY SHALL BE STABILIZED IN ACCORDANCE WITH THE APPROVED EROSION AND SEDIMENT CONTROL PLAN.

SEQUENCE OF OPERATIONS

1. SECURE ALL PERMITS.
2. NOTIFY HOWARD COUNTY DEPARTMENT OF LICENSES AND PERMITS INSPECTOR AT LEAST 24 HOURS BEFORE BEGINNING ANY WORK.
3. INSTALL STONE OUTLET SEDIMENT TRAP.
4. INSTALL STORM DRAIN INLET PROTECTION SYSTEM.
5. INSTALL DIVERSION SWALE AND SILT FENCES.
6. MODIFY AND REROUTE EXISTING STORM DRAINS.
7. BEGIN MAJOR GRADING, MAINTAINING POSITIVE DRAINAGE TO SEDIMENT TRAP.
8. INSTALL OTHER UTILITIES.
9. INSTALL FOUNDATIONS AND FOUNDATION WALLS FOR BUILDING. LAY SUBBASE IN AREAS RECEIVING BUILDING COVERAGE AND PAVING.
10. PAVE AREAS RECEIVING PAVING.
11. FINE GRADE REMAINING AREAS AND STABILIZE.
12. REMOVE DIVERSION SWALES, SILT FENCE AND STORM DRAIN INLET PROTECTION AFTER OBTAINING PERMISSION FROM SEDIMENT CONTROL INSPECTOR. STABILIZE DISTURBED AREAS.
13. UPON FINAL APPROVAL OF SEDIMENT CONTROL INSPECTOR, CLEAN OUT SEDIMENT TRAP AND CONSTRUCT STORMWATER MANAGEMENT SYSTEM, BACKFILL AND STABILIZE.

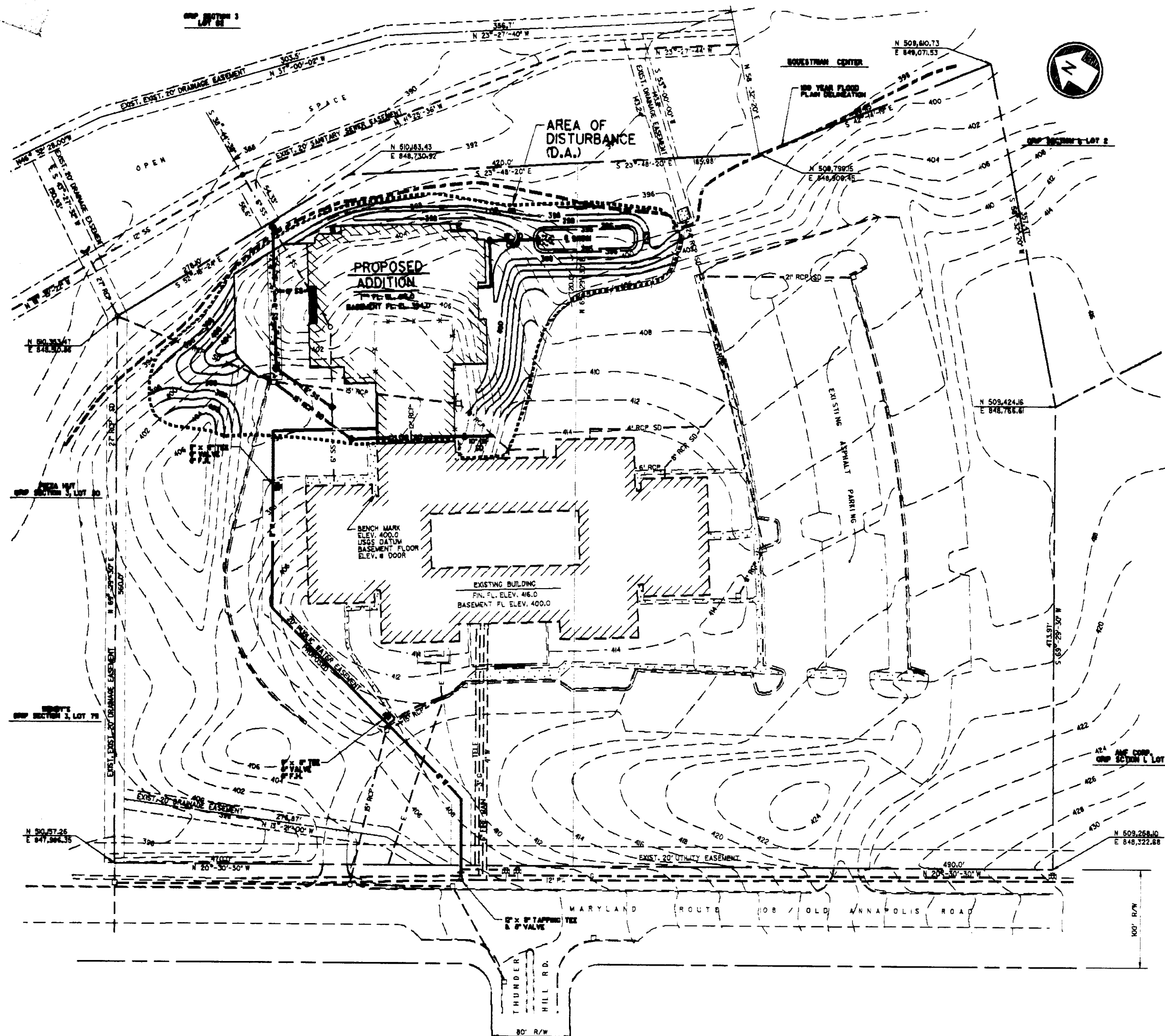

EROSION & SEDIMENT CONTROL DRAINAGE AREA PLAN

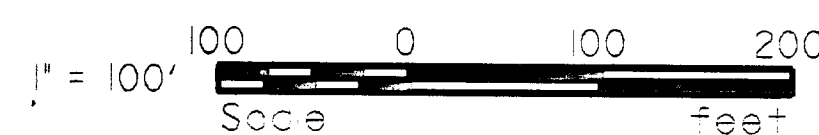

APPROXIMATE EARTH QUANTITIES

EXCAVATION:	20,820	CY.	±
LESS PAV. EX	245	CY.	±
LESS TOP SOIL	3,70	CY.	±
USEABLE MATERIAL	17,465	CY.	±
FILL REQUIRED	400	CY.	±
EXCESS MATERIAL	16,305	CY.	±

ALL EXCESS AND UNSUITABLE MATERIALS SHALL BE REMOVED FROM THE SITE AND DISPOSED OF ON A SITE WITH APPROVED SEDIMENT CONTROL MEASURES IN PRACTICE.

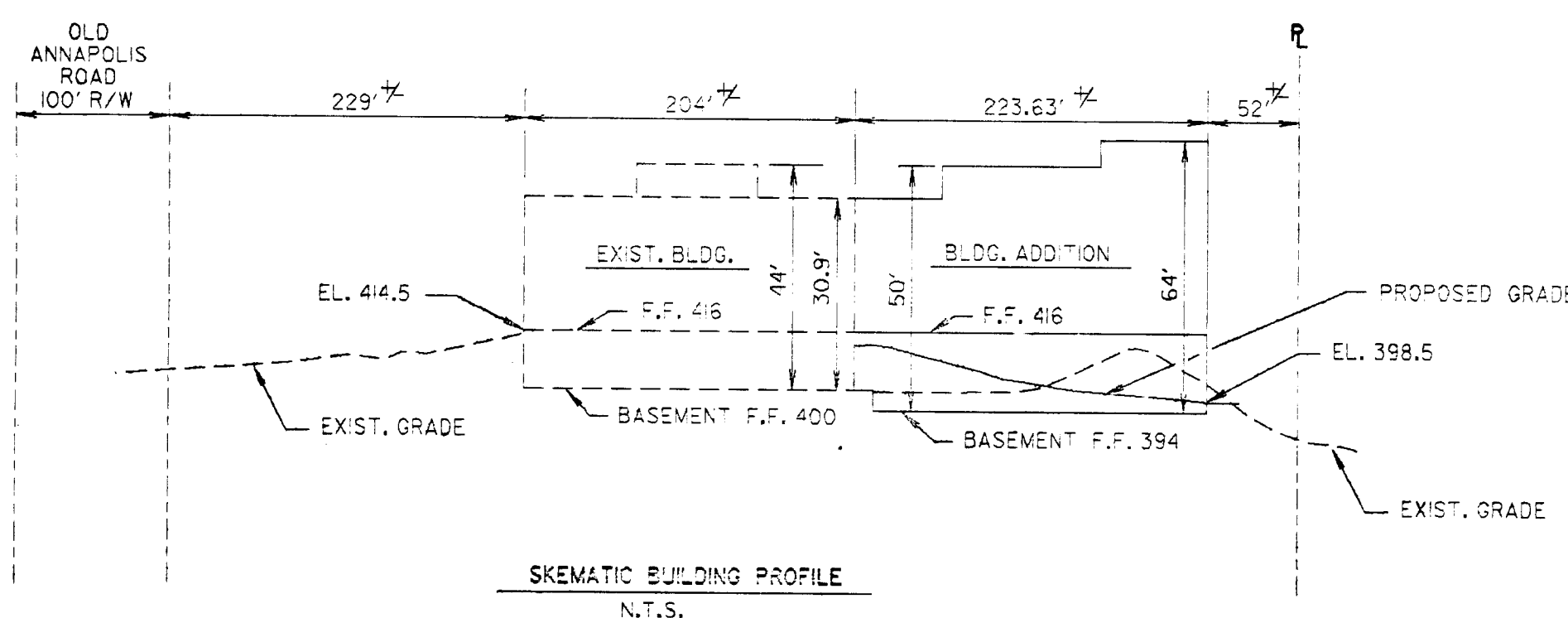

LOCKWOOD GREENE
Planners/Engineers/Architects/Managers
P.O. Box 491
Spartanburg, South Carolina 29304

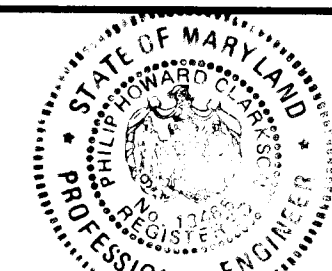

ENGINEER'S CERTIFICATION:
I CERTIFY THAT THIS PLAN FOR EROSION AND SEDIMENT CONTROL REPRESENTS A PRACTICAL AND WORKABLE PLAN BASED ON MY PERSONAL KNOWLEDGE OF THE SITE CONDITIONS AND THAT IT WAS PREPARED IN ACCORDANCE WITH THE REQUIREMENTS OF THE HOWARD SOIL CONSERVATION DISTRICT.
Philip H. Clarkson
PHILIP HOWARD CLARKSON 13465 REG. No. 8-8-84 DATE

OWNER - DEVELOPER
Bendix MICROELECTRONICS CENTER
940 OLD ANNAPOLIS RD., COLUMBIA, MD. 21045

OWNER'S CERTIFICATION:
I CERTIFY THAT THE DEVELOPMENT AND CONSTRUCTION WILL BE DONE ACCORDING TO THIS PLAN, AND THAT ANY RESPONSIBLE PERSONNEL INVOLVED IN THE CONSTRUCTION PROJECT WILL HAVE A CERTIFICATE OF ATTENDANCE AT A DEPARTMENT OF NATURAL RESOURCES APPROVED TRAINING PROGRAM FOR THE CONTROL OF SEDIMENT AND EROSION BEFORE BEGINNING THE PROJECT.
By: *[Signature]* DATE: 8/19/84 TITLE: *Director*

DESIGN: *[Signature]*
DRAWN: *[Signature]*
CHECKED: *[Signature]*
REVISIONS
4-13-84 REV. EROSION & SED. CONTROL NOTE.

EROSION AND SEDIMENT CONTROL DETAILS
SECTION 3; LOTS 66 & 67
OAKLAND RIDGE INDUSTRIAL PARK
PROPOSED IMPROVEMENTS: BUILDING ADDITION
940 OLD ANNAPOLIS RD., COLUMBIA, MD.
HOWARD COUNTY, MD. TAX MAP # 30 ELECTION DISTRICT # 2
SCALE: AS NOTED SHEET 4 OF 5
SDP-85-23

HOWARD SOIL CONSERVATION DISTRICT
THIS DEVELOPMENT IS APPROVED FOR SOIL EROSION AND SEDIMENT CONTROL BY THE HOWARD SOIL CONSERVATION DISTRICT

APPROVED: HOWARD SOIL CONSERVATION DISTRICT

REVIEWED FOR THE HOWARD SOIL CONSERVATION DISTRICT AND MEETS TECHNICAL REQUIREMENTS

SIGNATURE: *[Signature]* DATE: 8-9-84

THE UNITED STATES SOIL CONSERVATION SERVICE

APPROVED: FOR PUBLIC WATER, PUBLIC SEWERAGE AND STORM DRAINAGE SYSTEMS AND ROADS
HOWARD COUNTY DEPARTMENT OF PUBLIC WORKS
[Signature] DIRECTOR DATE: 8-11-84
[Signature] CHIEF, BUREAU OF ENGINEERING DATE:

APPROVED: FOR PUBLIC WATER AND PUBLIC SEWERAGE SYSTEMS
HOWARD COUNTY HEALTH DEPARTMENT
[Signature] COUNTY HEALTH OFFICER DATE:

APPROVED: HOWARD COUNTY OFFICER OF PLANNING AND ZONING
[Signature] PLANNING DIRECTOR DATE: 8-16-84
[Signature] CHIEF, DIVISION OF LAND DEVELOPMENT AND ZONING ADMINISTRATION DATE:

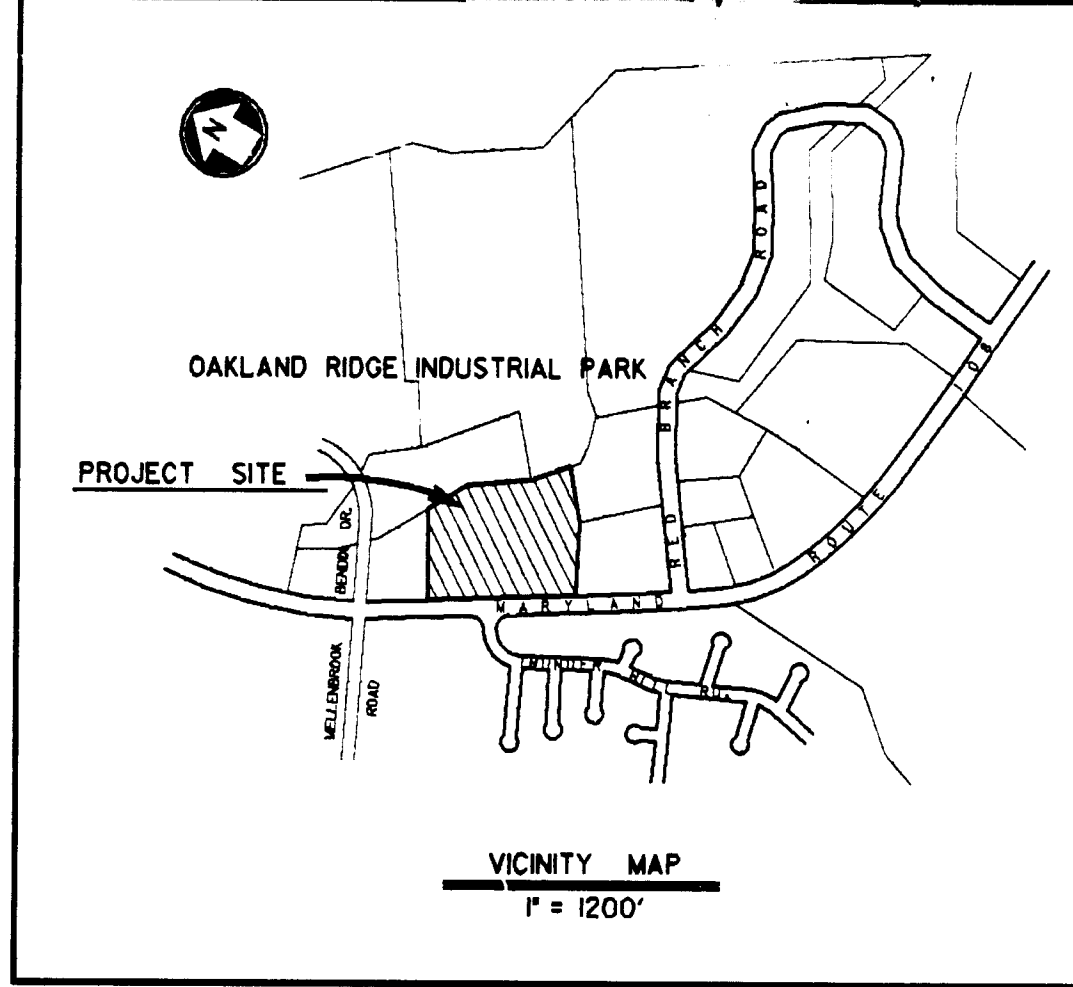
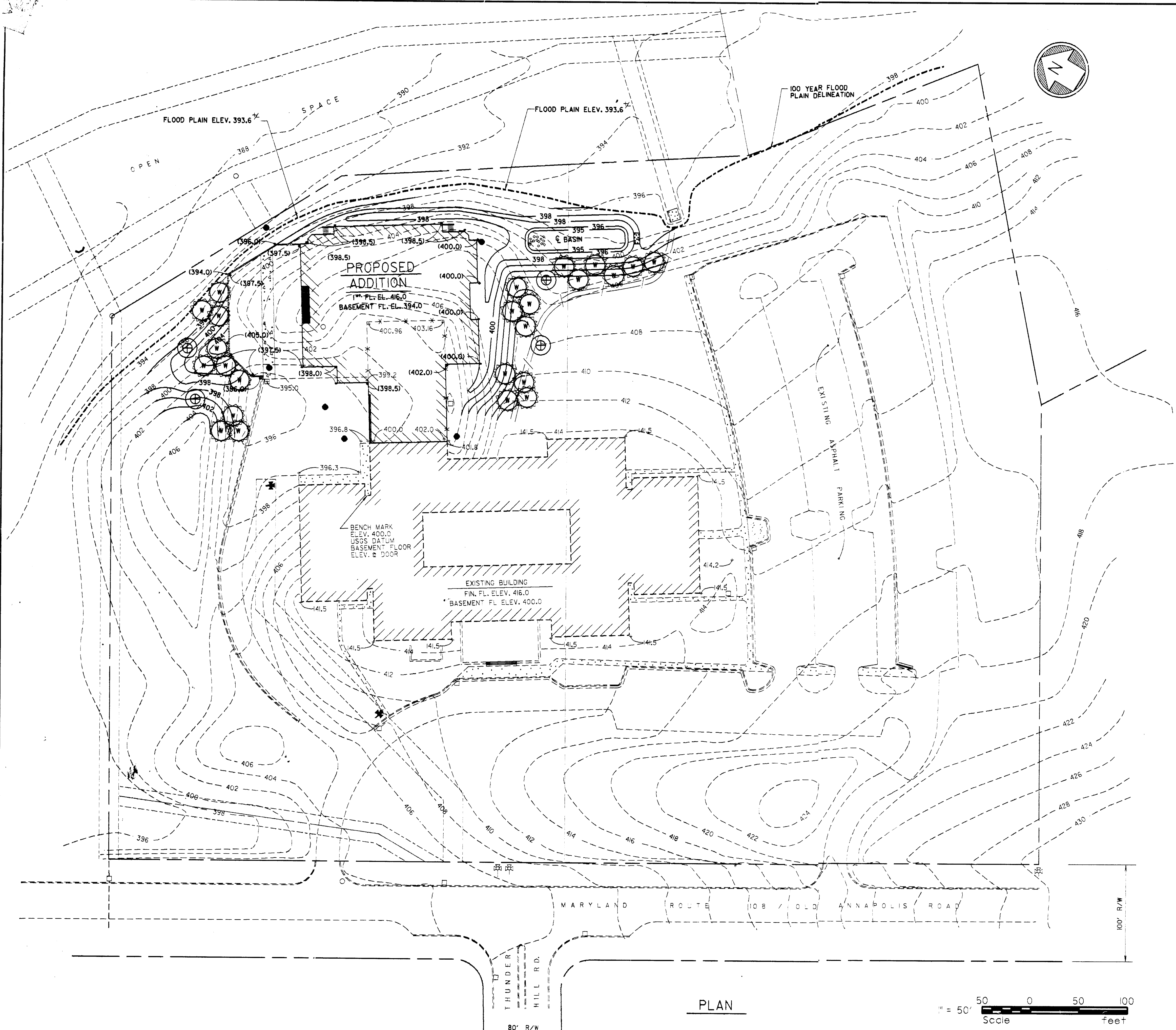

PLANT SCHEDULE

KEY	PLANT NAME	SIZE	QUANTITY	REMARKS
⊕	ACER RUBRUM OCTOBER GLORY MAPLE	2 1/2'-3' CAL 12-14' HT.	4	B & B HEAVY HEADS
⊗	PINUS STROBNS EASTERN WHITE PINE	8'-10' HT.	24	B & B HEAVY HEADS

NOTE: ALL PLANTING TO BE IN COMPLIANCE WITH STANDARD HRD PLANTING SPECIFICATIONS.
 CONTRACTOR TO VERIFY LOCATION OF UNDERGROUND UTILITIES BEFORE DIGGING.
 ALL PERMANENT SLOPES AND DISTURBED AREAS NOT TO RECEIVE PAVING OR STRUCTURES TO BE SODED OR SEEDDED.

APPROVED: For public water, Public Sewerage and Storm Drainage Systems and Roads
 HOWARD COUNTY DEPARTMENT OF PUBLIC WORKS
Philip H. Clarkson
 DIRECTOR 10-16-84
 DATE
 CHIEF, BUREAU OF ENGINEERING DATE

APPROVED: For public water and Public Sewerage Systems
 HOWARD COUNTY HEALTH DEPARTMENT
 COUNTY HEALTH OFFICER DATE

APPROVED: Howard County Office of Planning and Zoning
Thomas Hamrick
 PLANNING DIRECTOR 10-16-84
 DATE
Paul J. Williams
 CHIEF, DIVISION OF LAND DEVELOPMENT AND ZONING ADMINISTRATION 10-16-84
 DATE

9-19-84
M. Williams

PLAN

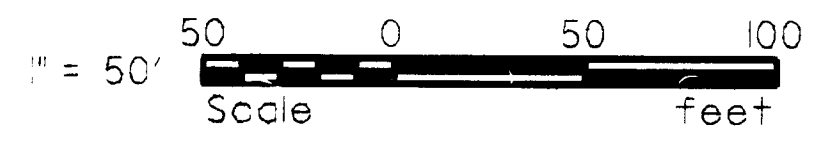

LOCKWOOD GREENE
 Planners/Engineers/Architects/Managers
 P.O. Box 491
 Spartanburg, South Carolina 29304

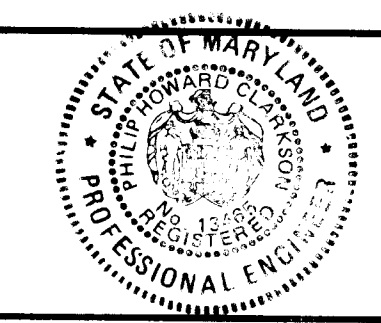

ENGINEER
Philip H. Clarkson
 PHILIP HOWARD CLARKSON 13465 8-8-84
 REG. NO. DATE

OWNER - DEVELOPER
Bendix MICROELECTRONICS CENTER
 9140 OLD ANNAPOLIS RD. COLLETSVILLE, MD. 21046

OWNER
 BY: *Thomas Hamrick* DATE: 8/9/84
 TITLE: *Senior Project Engineer*

DESIGN: *PHM*
 DRAWN: *PHM*
 CHECKED: *PHM*
 REVISIONS

LANDSCAPE PLAN
 SECTION 3: LOTS 66 & 67
OAKLAND RIDGE INDUSTRIAL PARK
 PROPOSED IMPROVEMENTS: BUILDING ADDITION
 9140 OLD ANNAPOLIS RD. COLUMBIA, MD.
 HOWARD COUNTY, MD. TAX MAP # 30 ELECTION DISTRICT # 2
 SCALE: AS NOTED AUG. 6, 1984 SHEET 5 OF 5

SDP-85-23c

C-10

B-8-84