

**SHEET INDEX**

DESCRIPTION
1 TITLE SHEET
2 SITE DEVELOPMENT PLAN
3 DETAILS
4 PLANTING PLAN
5 SEDIMENT CONTROL PLAN & DETAILS

# SITE DEVELOPMENT PLAN

## THOMPSONS PURCHASE

### SECTION 3 , AREA 2

### 1ST ELECTION DISTRICT

### HOWARD COUNTY , MARYLAND

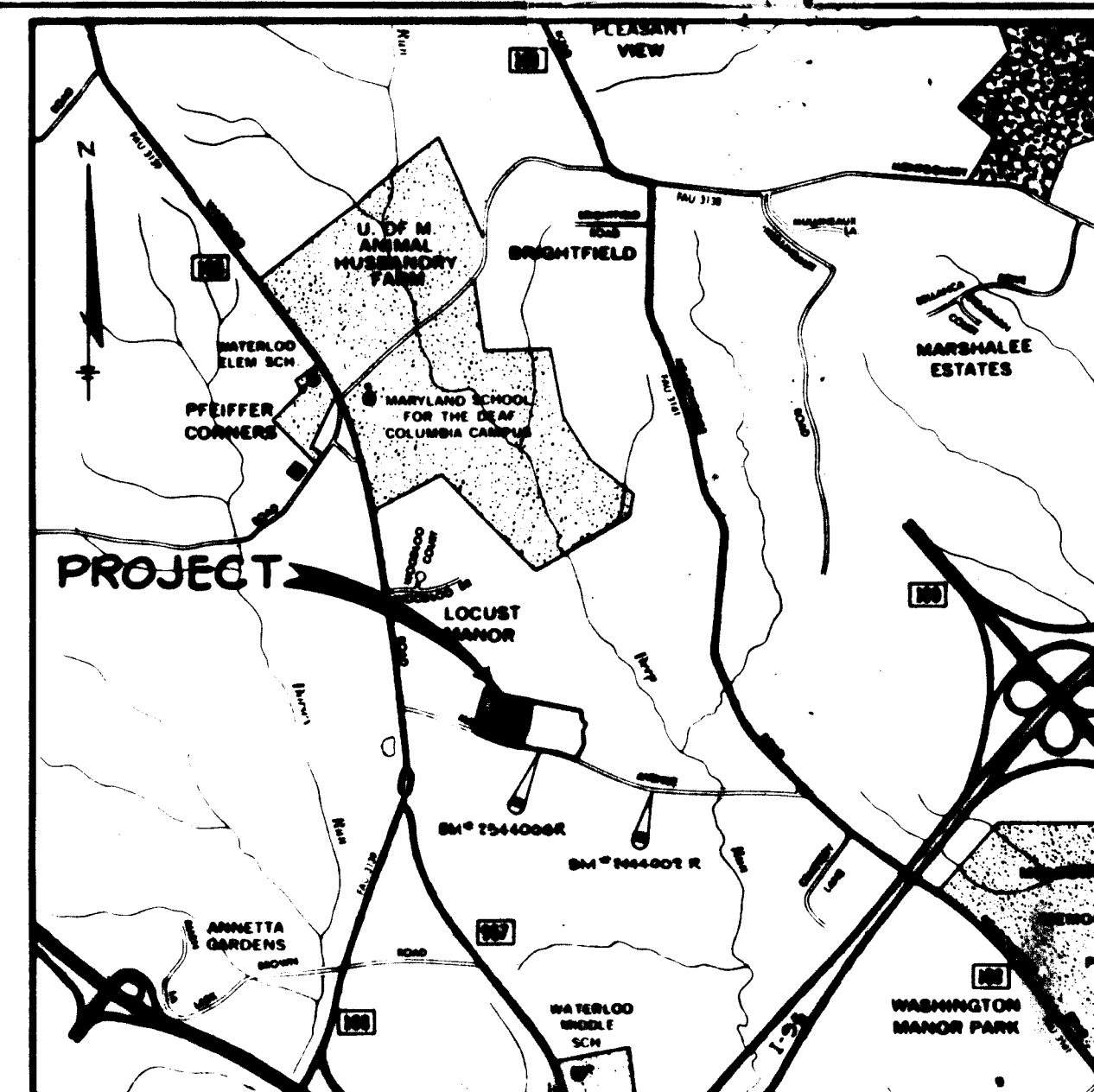

**VICINITY MAP**  
SCALE: 1" = 2000'

**BENCH MARKS**  
 HC BM # 2444002 R ELEV. 289.474  
 R.D. 03' BELOW SURFACE  
 HC BM # 2544006 R ELEV. 303.925  
 R.D. 02' BELOW SURFACE

GENERAL NOTES

- ALL WORK SHALL BE PERFORMED IN ACCORDANCE WITH THE HOWARD COUNTY DESIGN MANUAL, VOLUME IV, I.E., STANDARD SPECIFICATIONS AND DETAILS FOR CONSTRUCTION.
- APPROXIMATE LOCATION OF EXISTING UTILITIES ARE SHOWN. THE CONTRACTOR SHALL TAKE ALL NECESSARY PRECAUTIONS TO PROTECT THE EXISTING UTILITIES AND MAINTAIN UNINTERRUPTED SERVICE. ANY DAMAGE INCURRED DUE TO CONTRACTOR'S OPERATION SHALL BE REPAIRED IMMEDIATELY AT THE CONTRACTOR'S EXPENSE.
- THE CONTRACTOR SHALL TEST PIT EXISTING UTILITIES, WHERE DIRECTED BY THE ENGINEER, A MINIMUM OF TWO WEEKS IN ADVANCE OF CONSTRUCTION OPERATIONS.
- CONTRACTOR TO NOTIFY THE FOLLOWING UTILITIES OR AGENCIES AT LEAST FIVE DAYS BEFORE STARTING WORK SHOWN ON THIS/ THESE DRAWINGS:  

C & P TELEPHONE COMPANY	725-9976
HOWARD COUNTY BUREAU OF UTILITIES	992-2366
AT&T CABLE LOCATION DIVISION	393-3553
BALTIMORE GAS AND ELECTRIC COMPANY	685-0123
STATE HIGHWAY ADMINISTRATION	531-5533
HOWARD COUNTY CONSTRUCTION/INSPECTION SURVEY DIVISION	992-2417/2418
- TOPO TAKEN FROM FIELD RUN SURVEY BY: PURDUM & JESCHKE INC. DATED SEPT. 1983

SITE DATA

EXISTING ZONING	RSC
TOTAL AREA OF SITE	6.244 Ac
NO. OF RESIDENTIAL LOTS	36
AREA OF OPEN SPACE LOT 74	3.455 Ac
PARKING:	
REQUIRED - 2 SPACES/D.U.	72
PROVIDED	72
DISTURBED AREA	5.06 Ac
AREA TO BE RESEEDDED	3.70 Ac

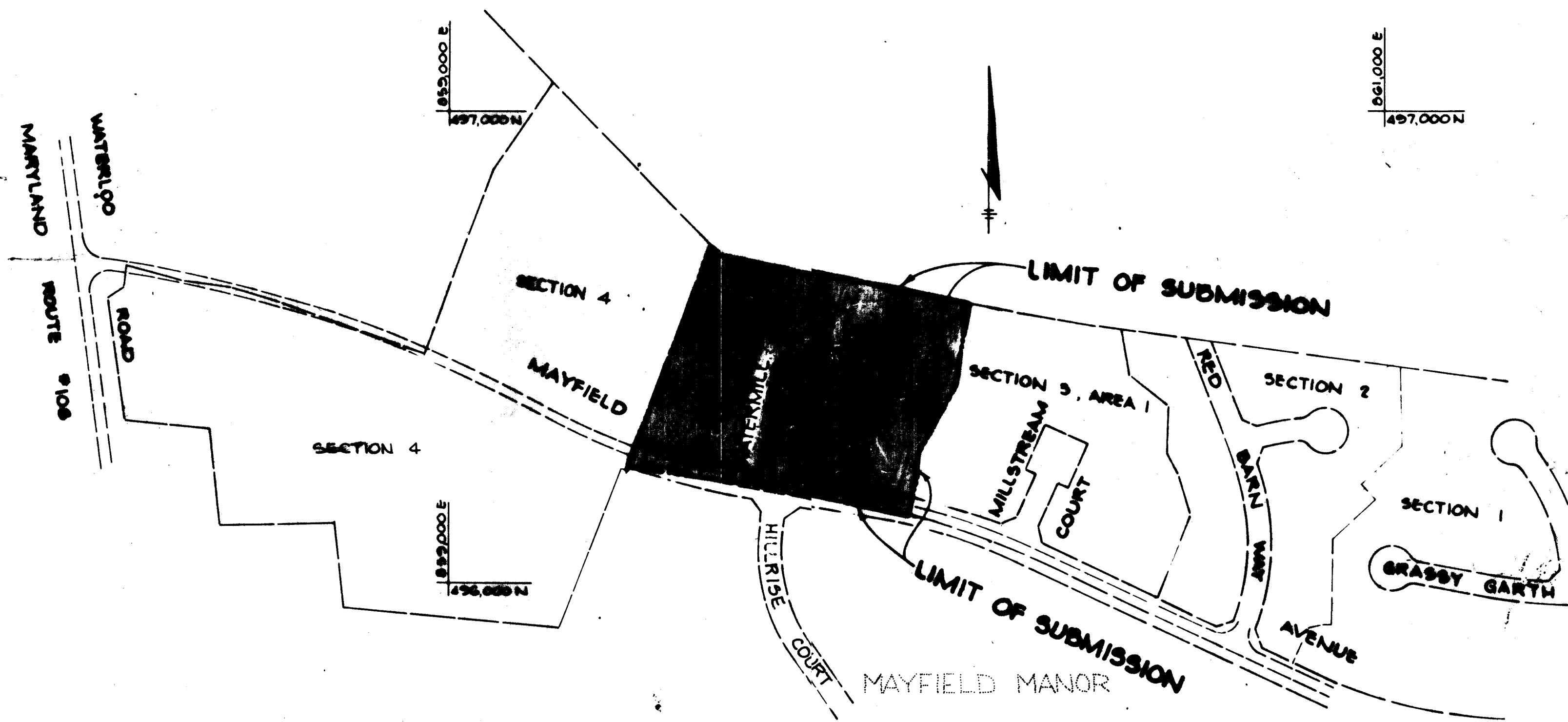

**PLAN**  
SCALE: 1" = 300'

APPROVED  
 DIVISION OF LAND DEVELOPMENT &  
 ZONING ADMINISTRATION  
 HOWARD COUNTY, MARYLAND  
 DATE **7-26-84**

ADDRESS CHART			
LOT NOS	STREET ADDRESS	LOT NOS	STREET ADDRESS
36	8000 WATERMILL COURT	57	8048 WATERMILL COURT
38	8007	58	8057
40	8004	59	8055
41	8000	60	8055
42	8010	61	8051
43	8012	62	8027
44	8014	63	8025
45	8016	64	8025
46	8020	65	8021
47	8022	66	8017
48	8024	67	8015
49	8026	68	8015
50	8030	69	8011
51	8032	70	8007
52	8034	71	8005
53	8036	72	8005
54	8040	73	8001
55	8042		
56	8044		

SUBDIVISION NAME	THOMPSONS PURCHASE	SECT/AREA	3/2	LOT/PARCEL #	36 THRU 74
PLAT # OR L/F	5092	BLOCK #	14	TAX/ZONE MAP/LEC DIST	1 6011
WATER CODE	14-1197-D	SEWER CODE	37		

APPROVED: FOR PUBLIC WATER AND PUBLIC SEWERAGE SYSTEMS, HOWARD COUNTY HEALTH DEPARTMENT.  
 DATE: 8/23/84

APPROVED: FOR PUBLIC WATER, PUBLIC SEWERAGE, STORM DRAINAGE SYSTEMS AND PUBLIC ROADS.  
 HOWARD COUNTY DEPARTMENT OF PUBLIC WORKS  
 DIRECTOR: [Signature] DATE: 8-28-84

CHIEF, BUREAU OF ENGINEERING: [Signature] DATE: 8-28-84

APPROVED: HOWARD COUNTY OFFICE OF PLANNING AND ZONING.  
 PLANNING DIRECTOR: [Signature] DATE: 9-10-84

CHIEF, DIVISION OF LAND DEVELOPMENT AND ZONING ADMINISTRATION: [Signature] DATE: 9-7-84

---

**TRACY, SCHULTE & ASSOCIATES INC.**  
 planning • architecture • engineering  
 8450 Baltimore National Pike • Suite 34 • Ellicott City, Maryland 21043 • (301) 456-6105

**PROJECT:** THOMPSONS PURCHASE SECTION THREE AREA TWO  
**LOCATION:** TAX MAP 57 PARCEL 154 1ST ELECTION DISTRICT HOWARD COUNTY, MARYLAND  
**TITLE SHEET**

DATE: JUNE 15, 1984 PROJECT NO: 1483 SDP  
 SCALE: AS SHOWN DRAWING 1 OF 5  
 SDP: J.R.S./J.K.T. DES: R.J.W. AUGUST 17, 1984 **SDP 84-305**



- NOTES:**
1. ALL PUBLIC ROADS AND PRIVATE COURTS, ALL BITUMINOUS PAVING, CONCRETE CURB AND GUTTER, BARRIER CURB, STORM DRAIN STRUCTURES, AND 6" - 0" AND 4" - 0" CONCRETE SIDEWALK, SHALL BE INSTALLED UNDER F 84-81. ALL PUBLIC WATER AND SEWER MAINS AND CONNECTIONS SHALL BE INSTALLED UNDER CONTRACT 14-1197-D.
  2. SEDIMENT CONTROL DEVICES SHALL BE INSTALLED UNDER F-84-81. FOR SUPPLEMENTAL SEDIMENT CONTROL SEE DRAWING 5 OF 5. NO WORK SHALL BEGIN ON SITE UNTIL ALL SEDIMENT CONTROL IS IN PLACE. ANY DAMAGE TO SEDIMENT CONTROL DEVICES SHALL BE REPAIRED AT THE END OF THE WORKING DAY.
  3. STORM WATER MANAGEMENT FOR THIS SITE IS PROVIDED UNDER F-81-43 AND IS IN PLACE.

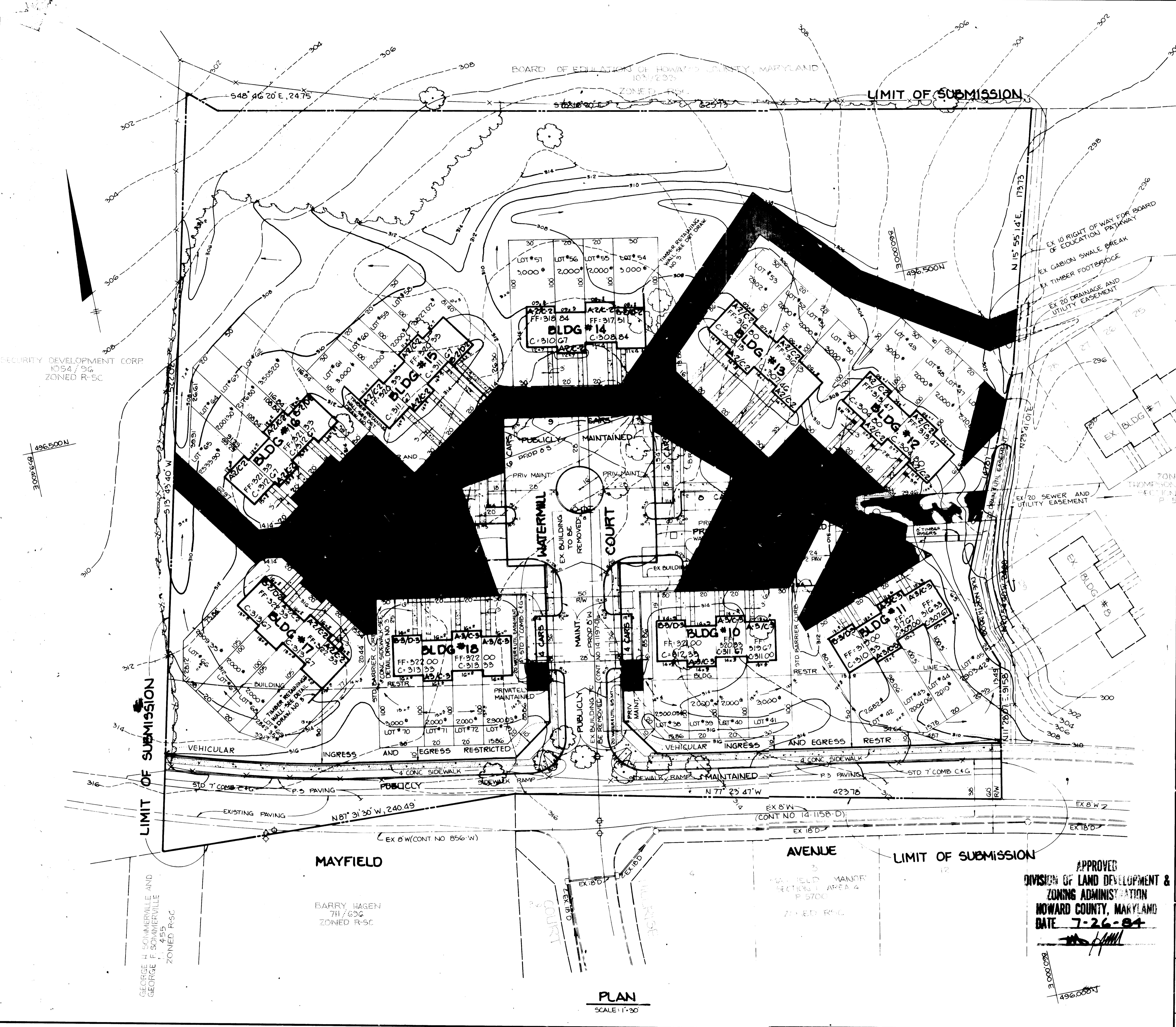

\* REVISED GRADING BETWEEN BUILDINGS 11 AND 12, SEPTEMBER 16, 1986.

APPROVED: FOR PUBLIC WATER AND PUBLIC SEWERAGE SYSTEMS, HOWARD COUNTY HEALTH DEPARTMENT	<i>Joseph M. Boyer</i> COUNTY HEALTH OFFICER	
APPROVED: FOR PUBLIC WATER, PUBLIC SEWERAGE, STORM DRAINAGE SYSTEMS AND PUBLIC ROADS, HOWARD COUNTY DEPARTMENT OF PUBLIC WORKS	<i>Gregory F. Nemey</i> DIRECTOR	8-28-84 DATE
	<i>William E. Reddy</i> CHIEF, BUREAU OF ENGINEERING	8-28-84 DATE
APPROVED: HOWARD COUNTY OFFICE OF PLANNING AND ZONING	<i>Thomas J. Harris</i> PLANNING DIRECTOR	9-10-84 DATE
	<i>William E. Reddy</i> CHIEF, DIVISION OF LAND DEVELOPMENT AND ZONING ADMINISTRATION	9-7-84 DATE
NO DATE		REVISION

TRACY, SCHULTE & ASSOCIATES INC.  
planning • architecture • engineering  
8450 Baltimore National Pike • Suite 34 • Ellicott City, Maryland 21043 • (301) 465-6105



APPROVED  
DIVISION OF LAND DEVELOPMENT &  
ZONING ADMINISTRATION  
HOWARD COUNTY, MARYLAND  
DATE 7-26-84

OWNER SECURITY DEVELOPMENT CORP 8450 BALTIMORE NATIONAL PIKE ELLICOTT CITY, MD 21043	PROJECT THOMPSONS PURCHASE SECTION THREE AREA TWO
DEVELOPER SECURITY DEVELOPMENT CORP 8450 BALTIMORE NATIONAL PIKE ELLICOTT CITY, MD 21043	LOCATION TAX MAP 37 PARCEL 154 1 <sup>ST</sup> ELECTION DISTRICT HOWARD COUNTY, MARYLAND
DES. JKT/JRS	TITLE SITE DEVELOPMENT PLAN LOTS 38-74
DRN KAM	DATE JUNE 15, 1984 PROJECT NO 1483 SDP
	SCALE 1" = 30' DRAWING 2 OF 5

PLAN  
SCALE: 1" = 30'





PLANT LIST			REMARKS
SYM	QUANT.	NAME	
SHADE TREES			
RM	10	ACER RUBRUM RED MAPLE	
PO	17	QUERCUS PALUSTRIS PIN OAK	1 1/2" - 2" CAL. 10' - 12' H. D+B FULL HEAD
JZ	1	ZELKOVA SERRATA JAPANESE ZELKOVA	
FLOWERING TREES			
BP	15	PYRUS CALLERYANA BRADFORD BRADFORD COLLERY PEAR	8' - 10' HEIGHT D+B FULL HEAD
EVERGREEN TREES			
JWP	12	PINUS PARVIFLORA JAPANESE WHITE PINE	
JBP	22	PINUS THUNDERGII JAPANESE BLACK PINE	5' - 6' HEIGHT D+B FULL HEAD
EVERGREEN SHRUBS			
MP	4	PINUS MUGO MUGO PINE	30' - 50' CONT. 24' - 30' CONT.
FTJ	10	JUNIPERUS COMMUNIS EFFUSA	
SEASONAL PLANTING			
42 PLANTS	5' O.C.	PELARGONIUM DOMESTICUM	(RED) SPRING - SUMMER
260 PLANTS	5' O.C.	GERANIUM	(WHITE) SUMMER
5' O.C.		PETUNIA HYBRIDA	
5' O.C.		PETUNIA	

NOTES:  
 1. PLACING OF PLANT MATERIAL SHOWN HERE IS JOINTLY AND SEVERALLY THE RESPONSIBILITY OF THE DEVELOPER AND THE BUILDER.  
 2. THE LOCATION OF TREES SHOWN HEREON IS SUBJECT TO FIELD MODIFICATION.

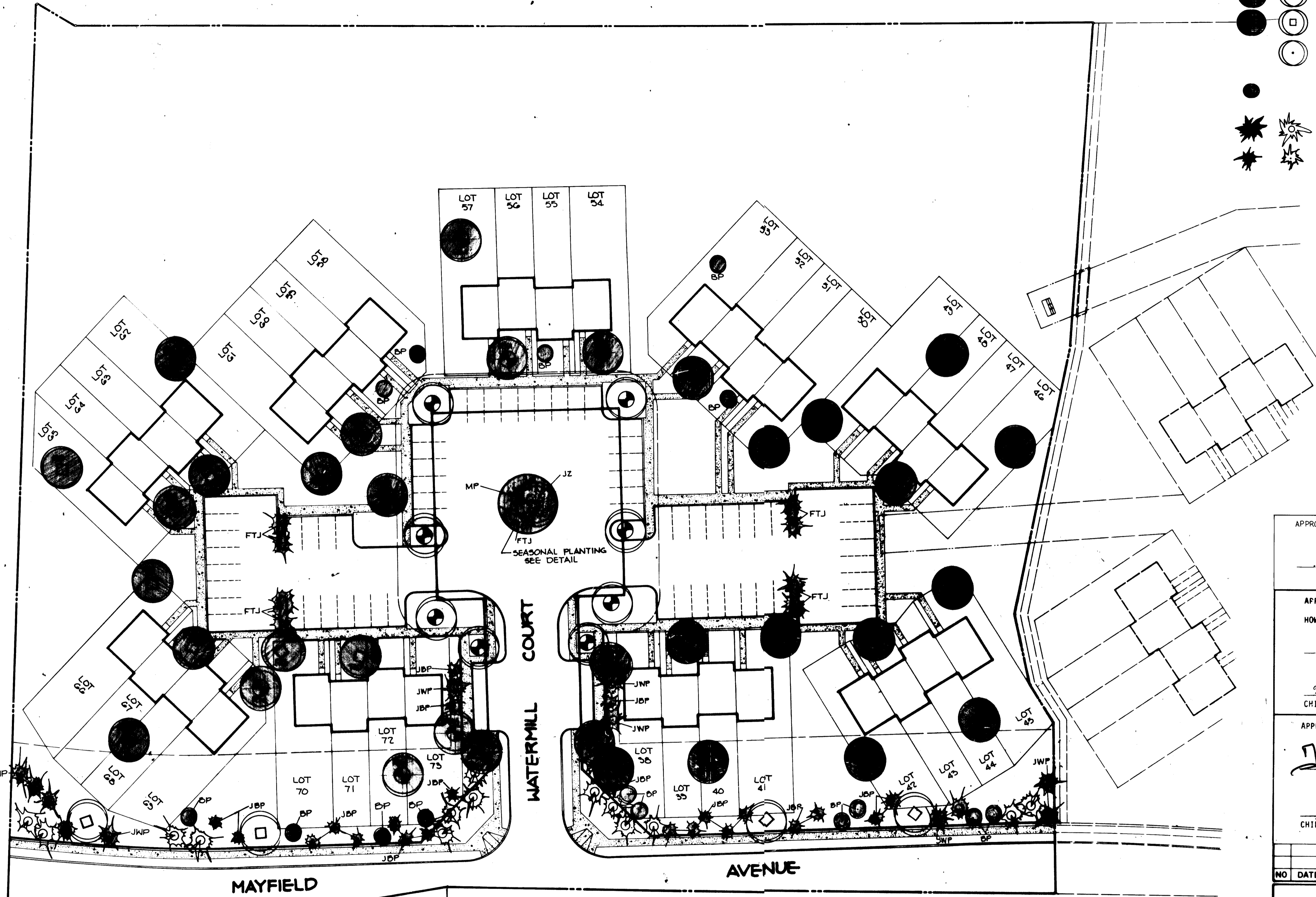

APPROVED: FOR PUBLIC WATER AND PUBLIC SEWERAGE SYSTEMS, HOWARD COUNTY HEALTH DEPARTMENT

*Jose M. Bond* 8/23/84  
 COUNTY HEALTH OFFICER DATE

APPROVED: FOR PUBLIC WATER, PUBLIC SEWERAGE, STORM DRAINAGE SYSTEMS AND PUBLIC ROADS.  
 HOWARD COUNTY DEPARTMENT OF PUBLIC WORKS

*George F. Henry* 8-28-84  
 DIRECTOR DATE

*William S. Ray* 8-28-84  
 CHIEF, BUREAU OF ENGINEERING DATE

APPROVED: HOWARD COUNTY OFFICE OF PLANNING AND ZONING.

*Thomas A. Harris* 9-10-84  
 PLANNING DIRECTOR DATE

*William S. Ray* 9-7-84  
 CHIEF, DIVISION OF LAND DEVELOPMENT AND ZONING ADMINISTRATION DATE

NO.	DATE	REVISION

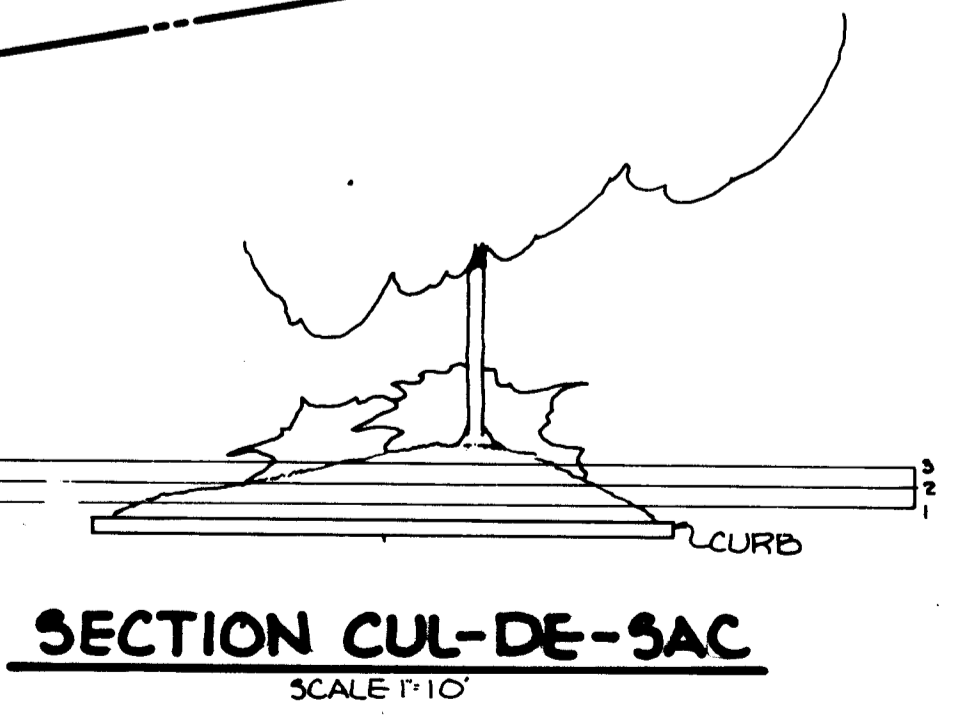
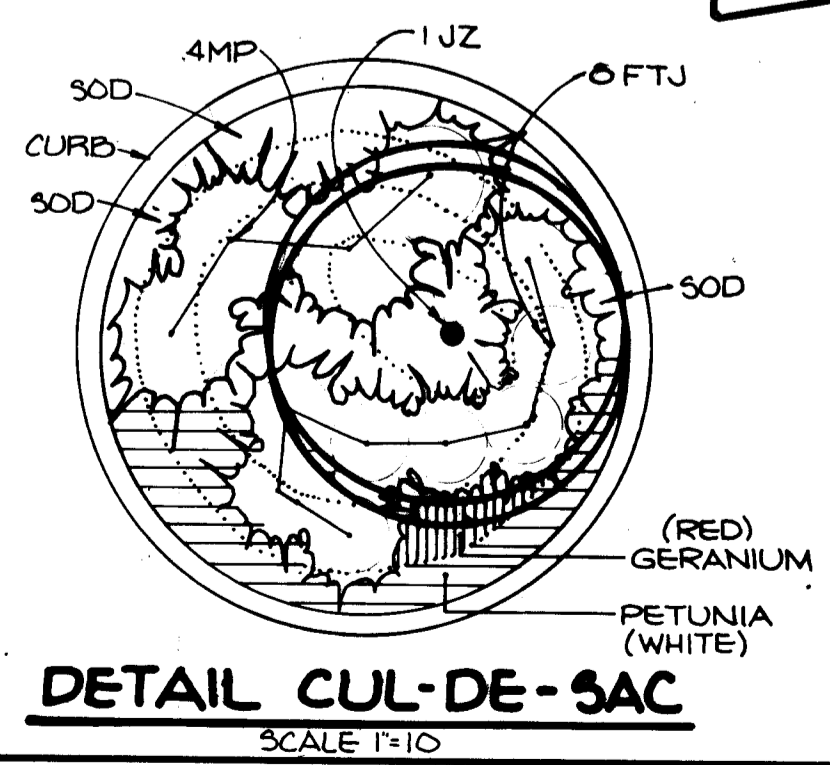

PLAN  
 1" = 30'

APPROVED  
 DIVISION OF LAND DEVELOPMENT &  
 ZONING ADMINISTRATION  
 HOWARD COUNTY, MARYLAND  
 DATE 7-26-84  
*MA*

TRACY, SCHULTE & ASSOCIATES INC.  
 planning • architecture • engineering  
 8450 Baltimore National Pike • Suite 34 • Ellicott City, Maryland 21043 • (301) 465-6105

OWNER: SECURITY DEVELOPMENT CORP  
 8450 BALTIMORE NATIONAL PIKE  
 ELLICOTT CITY, MD. 21043

DEVELOPER: SECURITY DEVELOPMENT CORP  
 8450 BALTIMORE NATIONAL PIKE  
 ELLICOTT CITY, MD. 21043

DES. JKT/JRS DRN KAM

PROJECT: THOMPSONS PURCHASE  
 SECTION THREE AREA TWO  
 LOCATION: TAX MAP 37  
 PARCEL 154  
 1<sup>ST</sup> ELECTION DISTRICT  
 HOWARD COUNTY, MARYLAND

TITLE: PLANTING PLAN  
 LOTS 38-74

DATE JUNE 15, 1984 PROJECT NO 1483 SDP  
 SCALE AS SHOWN DRAWING 4 OF 5



GENERAL NOTES

- 1. A MINIMUM OF 24 HOURS NOTICE MUST BE GIVEN TO THE HOWARD COUNTY OFFICE OF INSPECTION AND PERMITS PRIOR TO THE START OF ANY CONSTRUCTION (922-2070).
- 2. ALL SEDIMENT CONTROL STRUCTURES WILL BE INSTALLED IN ACCORDANCE WITH "THE STANDARDS AND SPECIFICATIONS FOR SOIL EROSION AND SEDIMENT CONTROL IN DEVELOPING AREAS" AS PREPARED BY THE U.S. DEPARTMENT OF AGRICULTURE SOIL CONSERVATION SERVICE.
- 3. SITE GRADING WILL BEGIN ONLY AFTER ALL PERIMETER SEDIMENT CONTROL MEASURES HAVE BEEN INSTALLED AND ARE IN A FUNCTIONING CONDITION.
- 4. ALL DISTURBED AREAS ARE TO BE DRESSED AND STABILIZED ACCORDING TO THE TEMPORARY OR PERMANENT SEEDING SCHEDULES AS SOON AS PROPER WEATHER CONDITIONS EXIST FOR THE ESTABLISHMENT OF A PERMANENT VEGETATIVE COVER.
- 5. SEDIMENT WILL BE REMOVED FROM TRAPS WHEN THE DEPTH REACHES THE CLEAN OUT ELEVATION SHOWN ON THE PLANS.
- 6. FERTILIZER AND LIME RATES MAY BE CHANGED THROUGH AUTHORIZATION BY THE HOWARD SOIL CONSERVATION DISTRICT IF SOIL TESTS DETERMINE A REDUCTION IN THE SPECIFIED RATES IS JUSTIFIED.
- 7. ALL SEDIMENT CONTROL STRUCTURES ARE TO REMAIN IN PLACE AND ARE TO BE MAINTAINED IN OPERATIVE CONDITION UNTIL PERMISSION FOR THEIR REMOVAL HAS BEEN OBTAINED FROM THE HOWARD COUNTY SEDIMENT CONTROL INSPECTOR.
- 8. REFERENCES CALLED FOR ON THE SEDIMENT CONTROL CONSTRUCTION PLAN AND DETAILS ARE MADE TO "THE STANDARDS AND SPECIFICATIONS FOR SOIL EROSION AND SEDIMENT CONTROL IN DEVELOPING AREAS".
- 9. SEDIMENT CONTROL WILL BE INSTALLED BEFORE CLEARING AND GRUBBING REMAINDER OF SITE.

TEMPORARY SEEDING

- AREA TO BE SEEDED SHALL BE RECENTLY LOOSENEED. IF THE GROUND IS PACKED, CRUSTED OR HARD, THE TOP LAYER OF SOIL SHALL BE LOOSENEED BY DISCING, RACKING OR OTHER ACCEPTABLE MEANS.
- A. APPLY 10-20-10 FERTILIZER (OR EQUIVALENT) AT THE RATE OF 600 LBS. PER ACRE OR 15 LBS. PER 1000 SQ. FT.
- B. WHERE SOIL IS KNOWN TO BE HIGHLY ACID, APPLY DOLOMITIC LIMESTONE AT THE RATE OF 1 TON PER ACRE.
- C. WORK BOTH SOIL AND SEED WITH CYCLONE SEEDER, DRILL, MULTIPAKER SEEDER OR HYDROSEEDER (SLURRY WILL INCLUDE SEED AND FERTILIZER) AT THE RATE OF 40 LBS. PER ACRE OF ITALIAN OR PERENNIAL RYEGRASS.
- D. MULCH WITH UNWEATHERED SMALL GRAIN STRAW AT THE RATE OF 1 1/2 TO 2 TONS, PER ACRE AND ANCHOR WITH CUTBACK ASPHALT OR EMULSIFIED ASPHALT AT THE RATE OF 5 GAL. PER 100 SQ. FT.

PERMANENT SEEDING

- FINAL STABILIZATION WILL TAKE PLACE AS SOON AS POSSIBLE AS WEATHER CONDITIONS PERMIT, AS FOLLOWS:
- A. APPLY DOLOMITIC LIMESTONE AT THE RATE OF 2 TONS PER ACRE (ONE TON PER ACRE IF APPLICATION OF TON PER ACRE WAS MADE FOR TEMPORARY SEEDING).
- B. APPLY 10-20-10 FERTILIZER AT THE RATE OF 600 LBS. PER ACRE HARROW OR DISC LIME AND FERTILIZER INTO THE SOIL TO A MINIMUM DEPTH OF 3" LAWNS OR HIGH MAINTENANCE AREAS WILL BE DRAGGED AND LEVELED WITH A YORK RAKE, AT THE TIME OF SEEDING APPLY 10 POUNDS OF 38-0-0 UREAFORM FERTILIZER AND 500 LBS. OF 10-20-20 OR EQUIVALENT FERTILIZER PER ACRE.
- C. SEED WITH A MIXTURE OF CERTIFIED "MERION" KENTUCKY BLUEGRASS - 40 LBS. PER ACRE; "MM" KENTUCKY BLUEGRASS @ 40 LBS. PER ACRE; RED FESCUE, PENNLAWN OR JAMESTOWN 15 LBS. PER ACRE.
- D. MULCH WITH UNWEATHERED SMALL GRAIN STRAW AT THE RATE OF 1 1/2 TO 2 TONS PER ACRE AND ANCHOR WITH A CUTBACK ASPHALT OR EMULSIFIED ASPHALT AT THE RATE OF 5 GAL. PER 100 SQ. FT.
- E. SEED ALL SLOPES WITH A MIXTURE OF CERTIFIED KENTUCKY 31 TALL FESCUE @ 50 LBS. PER ACRE AND PROCATULATED KOREAN LESPEDEZA @ 15 LBS. PER ACRE.

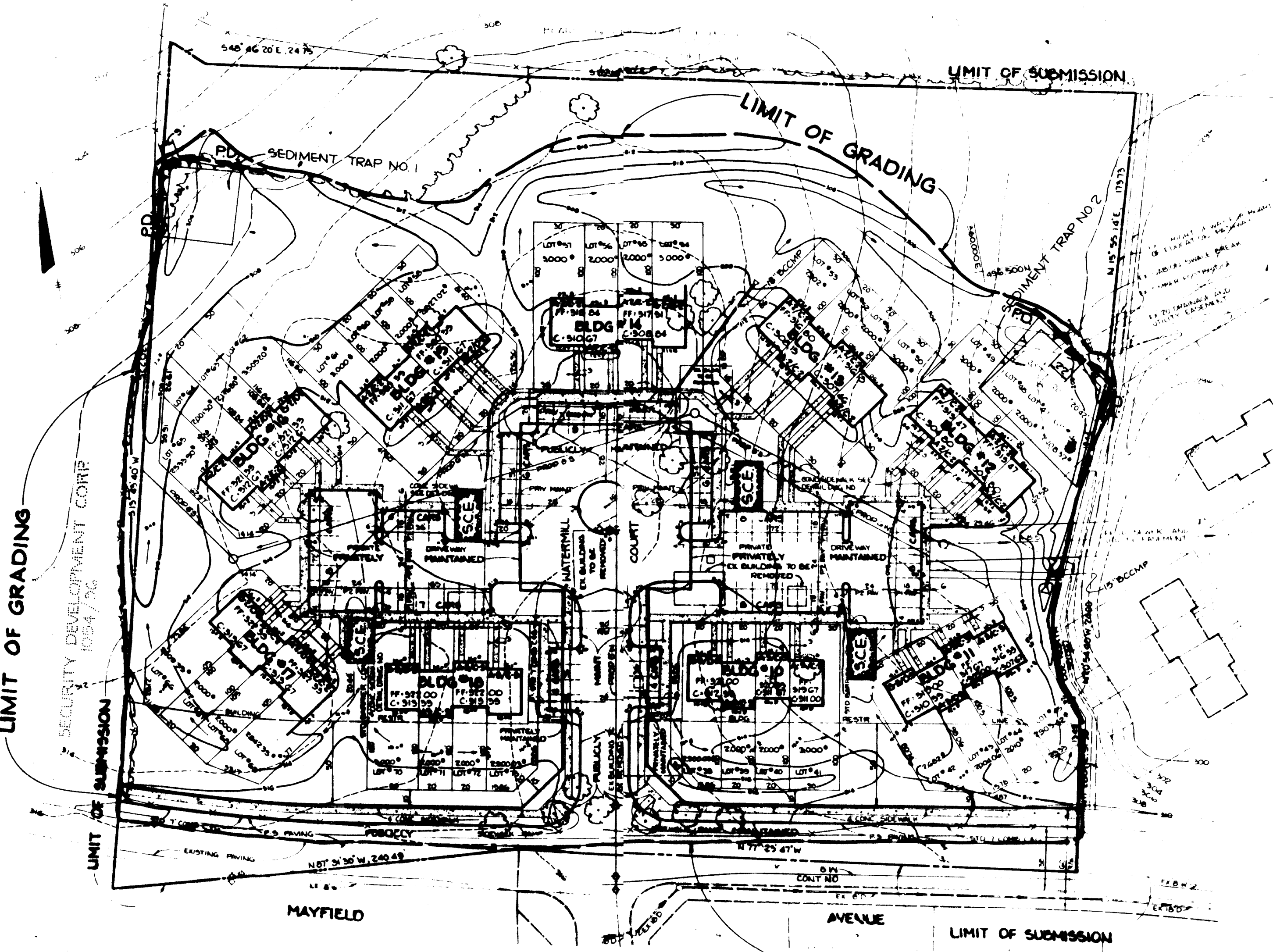

SEDIMENT CONTROL PLAN SCALE 1"=50'

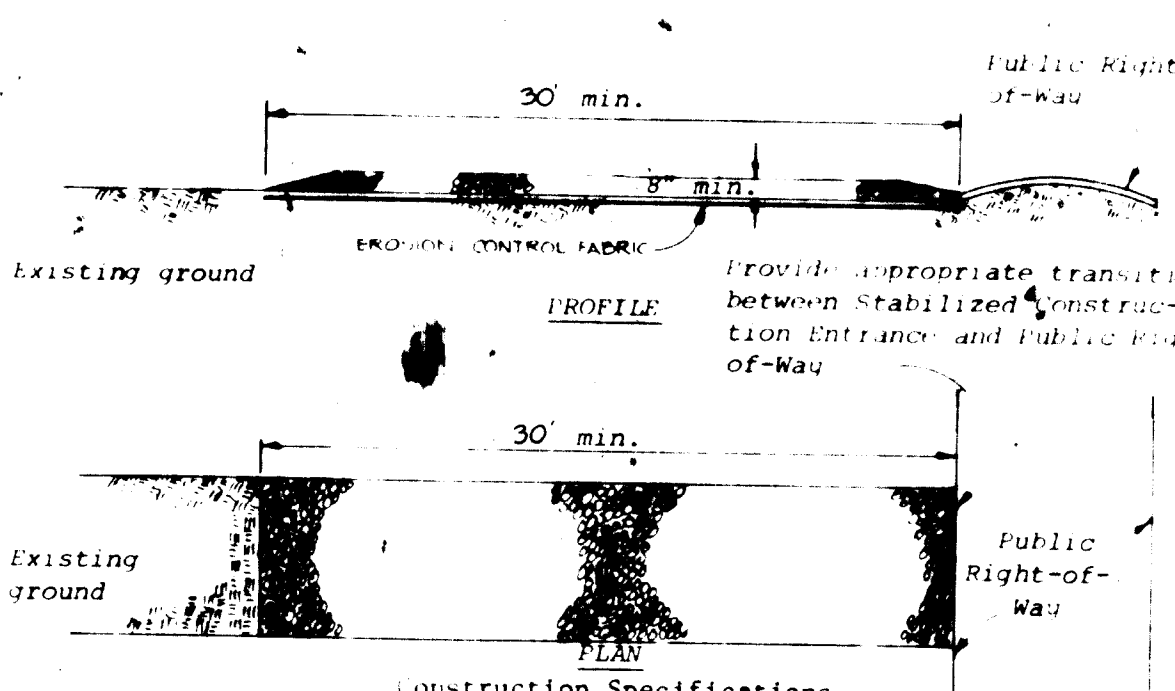

- 1. Stone size - Use MSHA size No. 2 (2-1/2" to 1") or AASHTO designation M43, size No. 2 (2-1/2" to 1-1/2"). Use crushed stone.
- 2. Length - As effective, but not less than 30 feet.
- 3. Thickness - Not less than eight (8) inches.
- 4. Width - Not less than full width of all points of ingress or egress.
- 5. Washing - When necessary, wheels shall be cleaned to remove sediment prior to entrance onto public right-of-way. When washing is required, it shall be done on an area stabilized with crushed stone which drains into an approved sediment trap or sediment basin. All sediment shall be prevented from entering any storm drain, ditch, or watercourse through use of sand bags, gravel, boards or other approved methods.
- 6. Maintenance - The entrance shall be maintained in a condition which will prevent tracking or flowing of sediment onto public right-of-way. This may require periodic top dressing with additional stone as conditions demand and repair and/or cleanout of any measures used to trap sediment. All sediment spilled, dropped, washed or tracked onto public right-of-way must be removed immediately.

STABILIZED CONSTRUCTION ENTRANCE NO SCALE

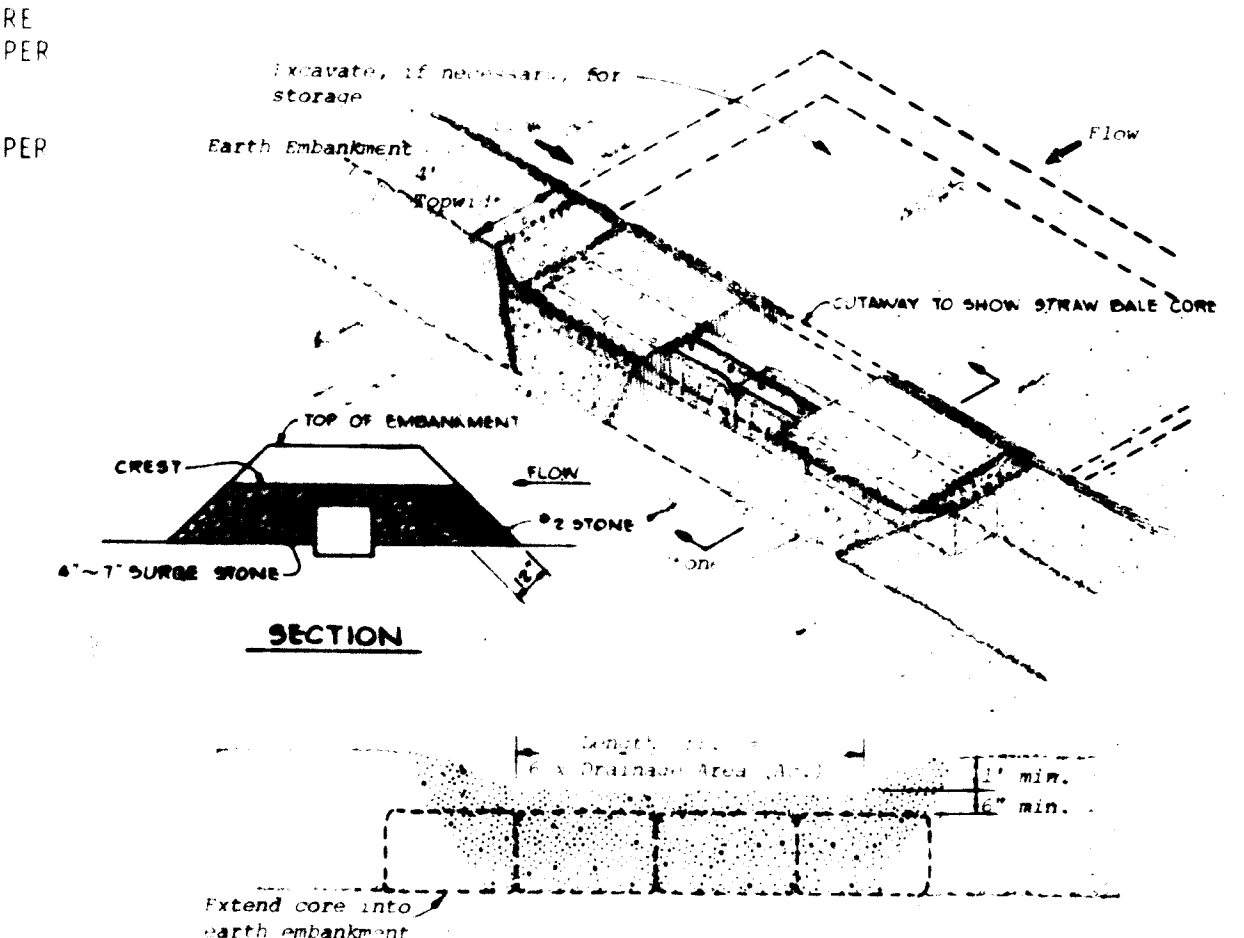

- NOTE - Drawings show straw bales used for core. Bales are anchored as per Standard and Specifications for Straw Bale Dike. Other materials (e.g., timber or concrete block) may also be used for core. Firmly anchor all core material to ground.
- 1. Area under embankment shall be cleared, grubbed and stripped of any vegetation and root mat. The pool area shall be cleared.
- 2. The fill material for the embankment shall be free of roots or other woody vegetation as well as over sized stones, rocks, organic material or other objectionable material. The embankment shall be compacted by traversing with equipment while it is being constructed.
- 3. Sediment shall be removed and trap restored to its original dimensions when the sediment has accumulated to 1/2 the design depth of the trap. Removed sediment shall be deposited in a suitable area and in such a manner that it will not erode.
- 4. The structure shall be inspected after each rain and repairs made as needed.
- 5. Construction operations shall be carried out in such a manner that erosion and water pollution is minimized.
- 6. The structure shall be removed and the area stabilized when the drainage area has been properly stabilized.
- 7. All cut and fill slopes shall be 2:1 or flatter.
- 8. The crushed stone used in the outlet shall meet AASHTO designation M43, Size No. 2 or 24 or its equivalent such as MSHA No. 2. Gravel meeting the above gradation, may be used if crushed stone is not available. Crusher run is not acceptable.

STONE OUTLET SEDIMENT TRAP

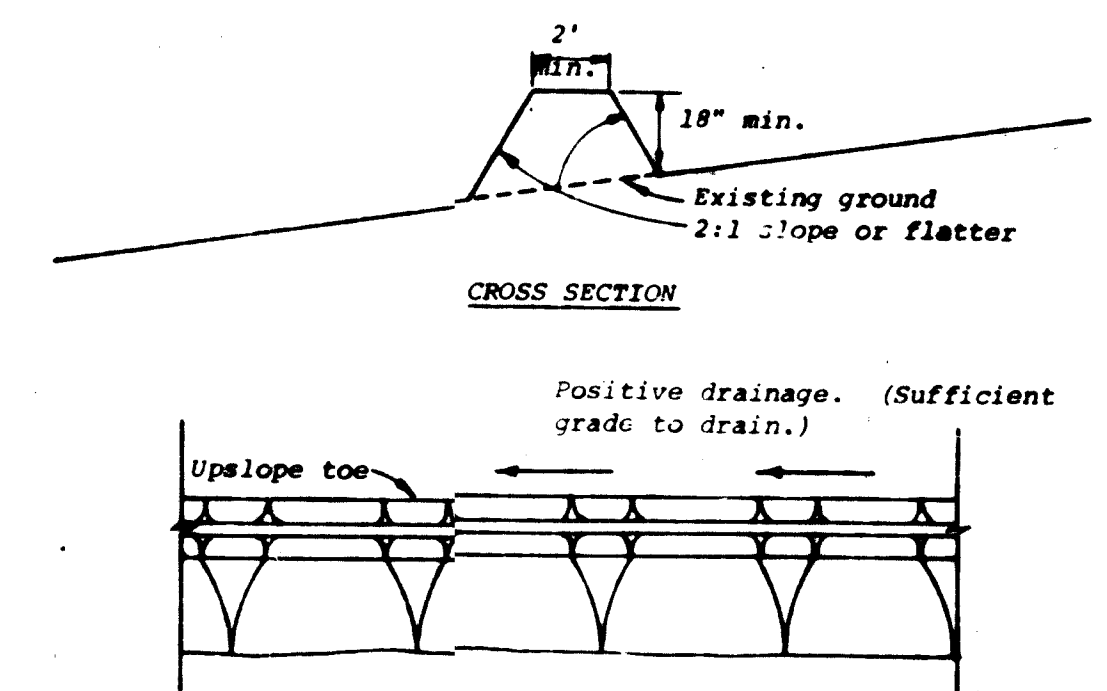

- 1. All dikes shall be machine compacted.
- 2. All perimeter dikes shall have positive drainage to an outlet.
- 3. A. Diverted runoff from a protected or stabilized upland area shall outlet directly onto an undisturbed or stabilized area or into a level spreader or grade stabilization structure.
- 3. B. Diverted runoff from a disturbed or exposed upland area shall be conveyed to a sediment trapping device such as sediment trap or a sediment basin or to an area protected by any of these practices.
- 4. Stabilization, when required, shall be done in accordance with Standard and Specifications for Grassed Waterway. The minimum area to be stabilized shall be the channel flow area.
- 5. Periodic inspection and required maintenance shall be provided.

PERIMETER DIKE

- SEQUENCE OF CONSTRUCTION
- 1. OBTAIN A GRADING PERMIT
- 2. INSTALL STABILIZED CONSTRUCTION ENTRANCE (SCE)
- 3. CLEAR AND GRUB AREAS FOR SEDIMENT CONTROL DEVICE INSTALLATION
- 4. INSTALL SEDIMENT TRAPS WITH STONE OUTLET STRUCTURES
- 5. COMPLETE CLEARING AND GRUBBING OPERATION
- 6. GRADE SITE
- 7. INSTALL UTILITIES (WATER, SEWER & STORM DRAIN)
- 8. STABILIZE ALL SLOPES BEYOND BUILDING PADS IN ACCORDANCE WITH "PERMANENT SEEDING NOTES"
- 9. COMPLETE ALL CONSTRUCTION AND STABILIZE ALL DISTURBED AREAS IN ACCORDANCE WITH "PERMANENT SEEDING NOTES"
- 10. UPON APPROVAL OF THE SOIL CONSERVATION DISTRICT, REMOVE ALL SEDIMENT CONTROL DEVICES AND STABILIZE DISTURBED AREAS IN ACCORDANCE WITH "PERMANENT SEEDING NOTES"

APPROVED DIVISION OF LAND DEVELOPMENT & ZONING ADMINISTRATION HOWARD COUNTY, MARYLAND DATE 7-26-84

Table with 2 columns: SEDIMENT TRAP NO. 1 and SEDIMENT TRAP NO. 2. Rows include DRAINAGE AREA, DISTURBED AREA, STORAGE VOLUME, REQUIRED/PROVIDED, CREST ELEVATION, BOTTOM ELEVATION, CLEANOUT ELEVATION, and TRAP DIMENSIONS.

THE DEVELOPER: I HEREBY CERTIFY THAT ALL DEVELOPMENT AND CONSTRUCTION WILL BE DONE ACCORDING TO THIS PLAN AND THAT ANY RESPONSIBLE PERSONNEL INVOLVED IN THE CONSTRUCTION PROJECT WILL HAVE PARTICIPATED IN ATTENDANCE AT A DEPARTMENT OF NATURAL RESOURCES APPLIED TRAINING PROGRAM FOR THE CONTROL OF SEDIMENT AND EROSION BEFORE BEGINNING THE PROJECT. James R. Moxley Jr. 6-15-84

BY THE ENGINEER: I CERTIFY THAT THIS PLAN FOR EROSION AND SEDIMENT CONTROL REPRESENTS A PRACTICAL AND WORKABLE PLAN BASED ON MY PERSONAL KNOWLEDGE OF THE SITE CONDITIONS AND THAT IT WAS PREPARED IN ACCORDANCE WITH THE REQUIREMENTS OF THE HOWARD SOIL CONSERVATION DISTRICT. James K. Tracy, P.E. 6-15-84

REVIEWED FOR HOWARD COUNTY, MARYLAND AND MEETS TECHNICAL REQUIREMENTS. J. Helm 7 9-7-84

THIS DEVELOPMENT PLAN IS APPROVED FOR SOIL EROSION AND SEDIMENT CONTROL BY THE HOWARD COUNTY SOIL CONSERVATION DISTRICT. Stephen L. Fisher 9-7-84

APPROVED FOR PUBLIC WATER AND PUBLIC SEWERAGE SYSTEMS, HOWARD COUNTY HEALTH DEPARTMENT. Joyce M. Boyd, M.P.H. 8/23/84

APPROVED FOR PUBLIC WATER, PUBLIC SEWERAGE, STORM DRAINAGE SYSTEMS AND EROSION CONTROL. Howard County Department of Public Works. Henry F. Nemoy 8-28-84

CHIEF, BUREAU OF ENGINEERING. William S. Ryan 8-28-84

APPROVED: HOWARD COUNTY OFFICE OF PLANNING AND ZONING. Thomas G. Harris, Jr. 9-10-84

CHIEF, DIVISION OF LAND DEVELOPMENT AND ZONING ADMINISTRATION. [Signature] 9-7-84

Table with 2 columns: NO. and DATE. Row 1: 1, 7-26-84. Row 2: 2, 7-26-84.

TRACY, SCHULTE & ASSOCIATES INC. planning • architecture • engineering 8450 Baltimore National Pike • Suite 44 • Ellicott City, Maryland 21043 • (301) 485-8300

OWNER: SECURITY DEVELOPMENT CORP. PROJECT: THOMPSONS PURCHASE SECTION THREE AREA TWO. LOCATION: TAX MAP 21 PARCEL 154 13<sup>th</sup> ELECTION DISTRICT HOWARD COUNTY, MARYLAND. DEVELOPER: SECURITY DEVELOPMENT CORP. TITLE: SEDIMENT CONTROL PLAN NOTES AND DETAILS LOTS 33-34. DATE: JUNE 15, 1984. PROJECT NO: 1483 SDP. DES: JKT. DRN: KAM. SCALE: AS SHOWN. DRAWING: 5 OF 5.

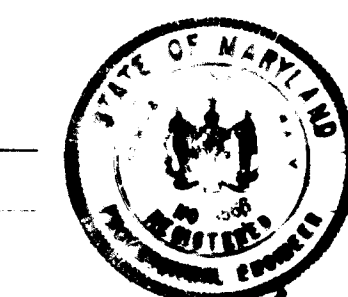

James K. Tracy