

**SITE ANALYSIS**

- TOTAL AREA: ± 10.00 ACRES
- ZONED: B-2
- USE: SHOPPING CENTER
- TOTAL NUMBER OF LOTS: 2
- TOTAL AREA OF PROJECT: 10,004 SF (GROSS)
- NUMBER OF PARKING SPACES REQUIRED: 384
  - A) TOTAL GROSS BUILDING AREA (WITHOUT FOOD STORE) 53,996 SF  
DIVIDED BY 200 SF PER SPACE EQUAL 270 SPACES
  - B) TOTAL FLOOR AREA AVAILABLE TO PUBLIC (FOOD STORE) 22,540 SF (15500 EXIST+ 7040 NEW)  
DIVIDED BY 150 SF PER SPACE EQUAL 150 SPACES
- NUMBER OF PARKING SPACES PROVIDED: 432  
(408 PREEXISTING PARKING SPACES LESS 36 SPACES FOR THE CONSTRUCTION ADDITION = 432 PARKING SPACES)
- PUBLIC WATER & SEWER FACILITIES WILL BE PROVIDED
- LOCATION OF EXISTING UTILITIES IS APPROXIMATE ONLY AND IS OBTAINED FROM RECORDED DRAWINGS. CONTRACTOR SHALL NOTIFY ALL UTILITY COMPANIES INVOLVED AND LOCATE ALL EXISTING UTILITIES TO HIS OWN SATISFACTION BEFORE ANY CONNECTIONS ARE MADE
- CONSTRUCTION SEQUENCE FOR SEDIMENT CONTROL
  - A OBTAIN BUILDING PERMIT
  - B PROVIDE SEDIMENT CONTROLS IF REQUIRED BY DPW INSPECTOR (STREAM BALE DIKE)
  - C BEGIN GRADING & FILLING
  - D CONTRACTOR WILL INSURE THAT SOIL & SEDIMENT DOES NOT LEAVE THE SITE OF ACTIVE CONSTRUCTION, & PROVIDE CLEANUP OF ANY SOIL IN THE IMMEDIATE AREA
  - E BEGIN BUILDING CONSTRUCTION
  - F STABILIZE ALL DISTURBED AREAS

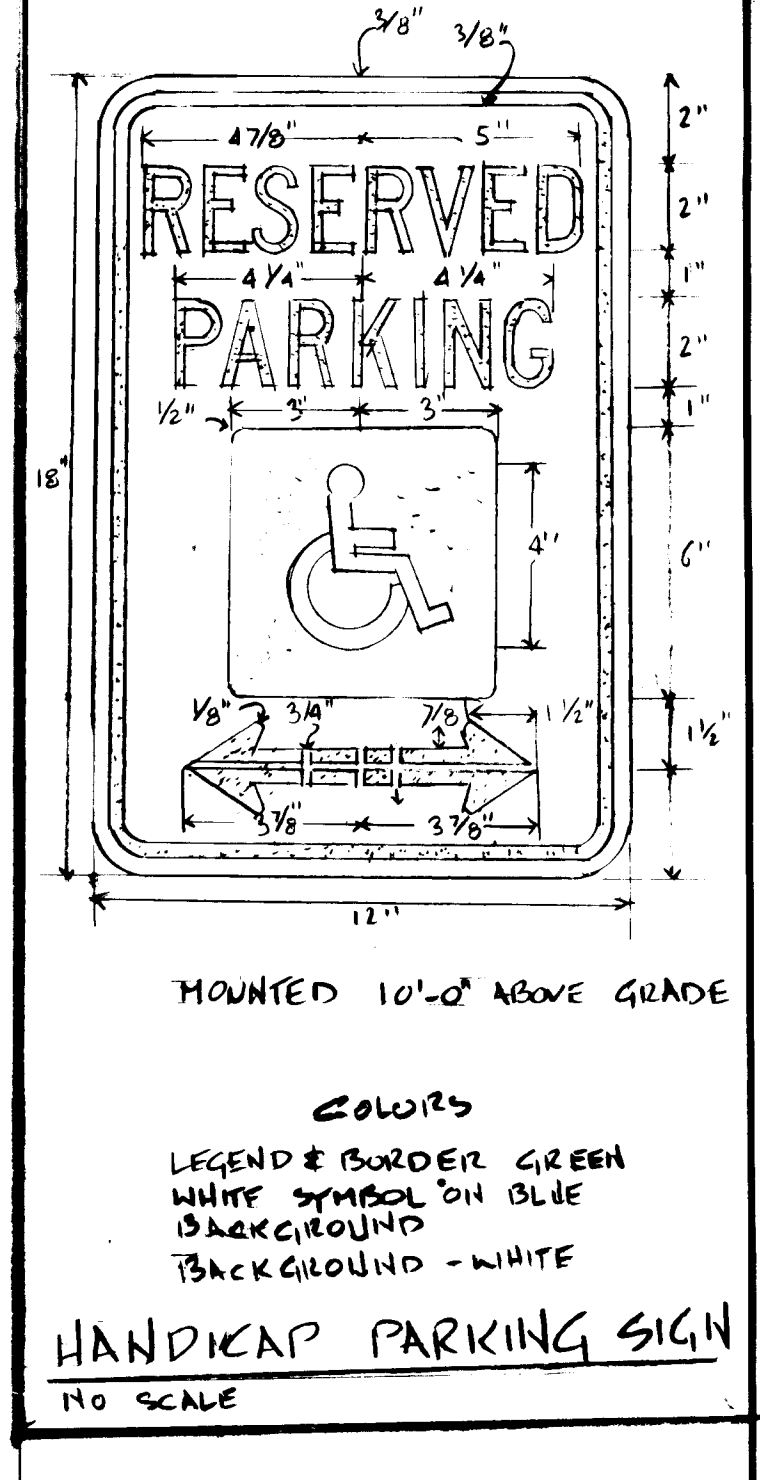
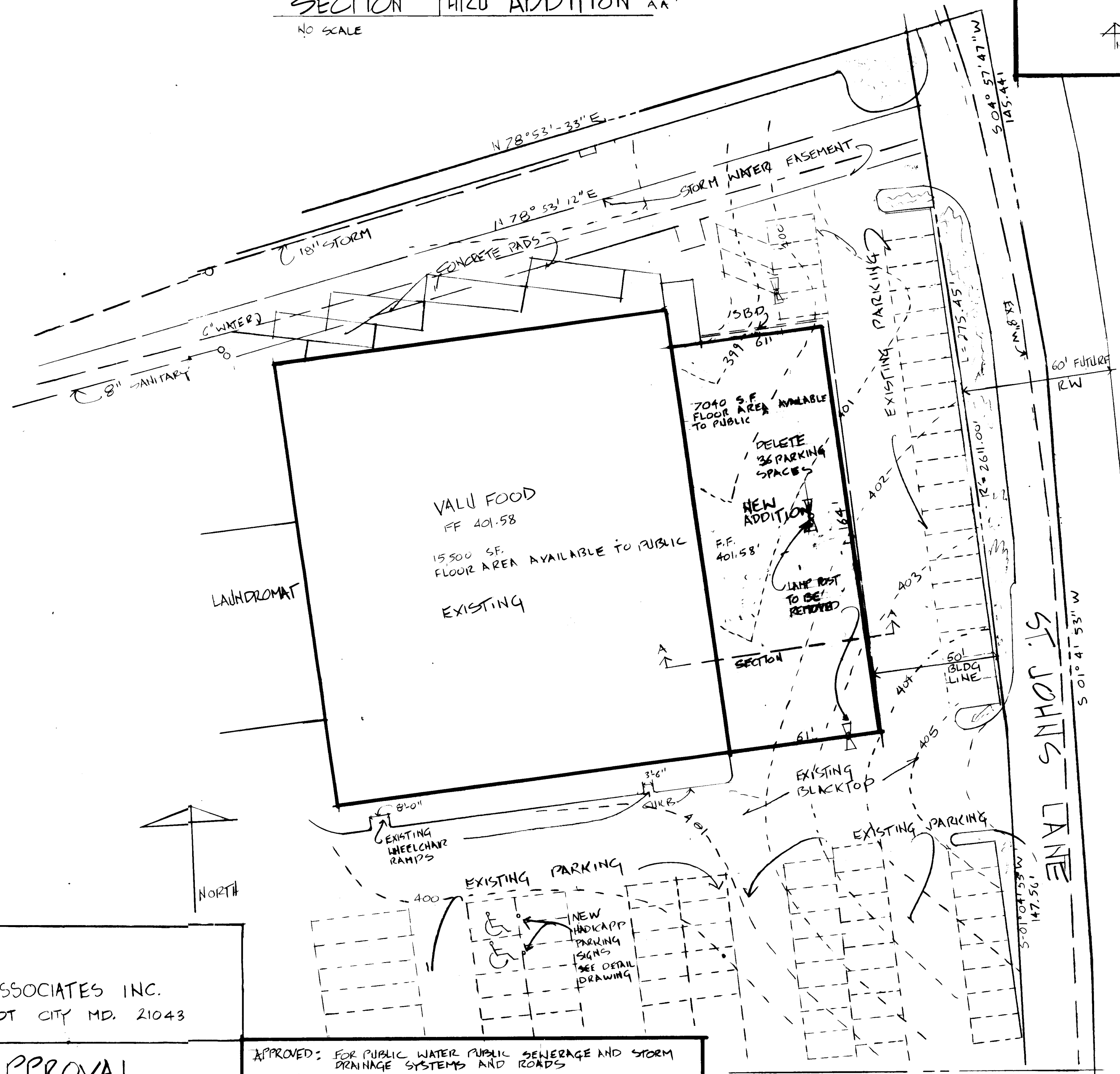

7-16-84  
MO

**BUILDING ADDITION TO SDP-76-84 ROUTE 40**

**OWNER**  
HARDMAN-MYERS ASSOCIATES INC.  
P.O. BOX 552 ELLICOTT CITY MD. 21043

**OWNER'S APPROVAL**  
I, J. GORDON MUELLER AM THE AUTHORIZED OWNER'S AGENT, AND GRANT PERMISSION FOR THE SITE IMPROVEMENT AS REPRESENTED BY THIS PLAN.

DATE \_\_\_\_\_

828 DULANEY VALLEY RD TOWSON MD. 21204

APPROVED: FOR PUBLIC WATER PUBLIC SEWERAGE AND STORM DRAINAGE SYSTEMS AND ROADS  
HOWARD COUNTY DEPARTMENT OF PUBLIC WORKS  
DIRECTOR \_\_\_\_\_ DATE 7-31-84  
CHIEF, BUREAU OF ENGINEERING \_\_\_\_\_ DATE 7-31-84

APPROVED: FOR PUBLIC WATER AND PUBLIC SEWERAGE SYSTEMS  
HOWARD COUNTY HEALTH DEPARTMENT  
HEALTH OFFICER \_\_\_\_\_ DATE 8-6-84

APPROVED: HOWARD COUNTY OFFICE OF PLANNING AND ZONING  
PLANNING DIRECTOR \_\_\_\_\_ DATE 7-31-84  
CHIEF, DIVISION OF LAND DEVELOPMENT AND ZONING ADMINISTRATION \_\_\_\_\_ DATE 8-7-84

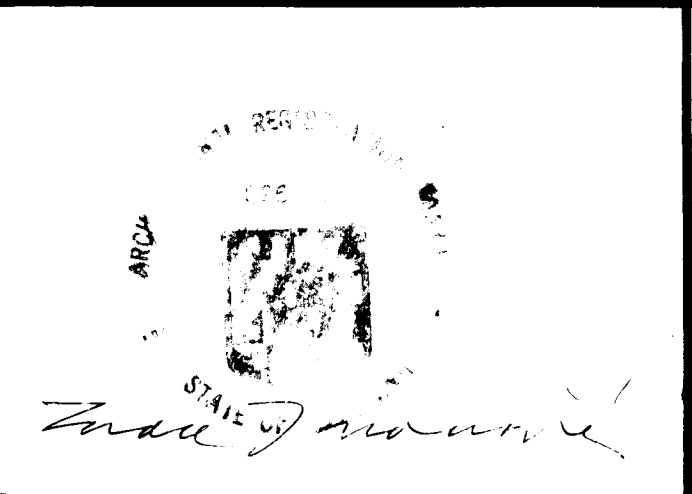

SUBMISSION NAME ST. JOHNS PLAZA		SECT/AREA P 1068 B-1	LOT/PARCEL # P 1068 B-1
PLAT # 3487	BLOCK # 5	ZONE B-2	TAX ZONE MAP 24
ELEC. DIST. 24R		CENSUS TR. 6022	
WATER CODE		SEWER CODE	

ADDRESS CHART	
LOT NUMBER	STREET ADDRESS
P 1068 B-1	9150 BALTIMORE NATIONAL PIKE

PLAT # 3487 TAX MAP 24  
PARCEL B-1 & C-1 A SUBDIVISION OF PARCELS B & C  
**BUILDING ADDITION TO ST. JOHNS PLAZA**  
SECOND ELECTION DISTRICT  
HOWARD COUNTY MARYLAND  
SCALE 1"=30'  
MAY 24 1984

**KRAUSE DESIGN & CONSTRUCTION**  
2410 HOMESTEAD DR. SILVER SPRING MD 20902  
MICHAEL KRAUSE 301-593-5373  
SDP-84-285

Reviewed for \_\_\_\_\_ S.C.D.  
and \_\_\_\_\_  
Signature  
U.S. Soil Conservation Service

THIS DEVELOPMENT PLAN IS FOR SOIL CONSERVATION CONTROL BY THE U.S. SOIL CONSERVATION SERVICE  
Approved: \_\_\_\_\_  
Howard S.C.D.