

LOT NO.	STREET ADDRESS
1	4001 ZUNI COURT
2	4005
3	4009
4	4013
5	4017
6	4021
7	4025
8	4029
9	4033
10	4037
11	4041
12	4045
13	4049 ZUNI COURT
14	4053 CHESTNUT DR
15	4057
16	4061
17	4065
18	4069
19	4073
20	4077
21	4081
22	4085
23	4089
24	4093
25	4097 HOPI COURT
26	4101
27	4105
28	4109
29	4113
30	4117
31	4121 HOPI COURT
32	4125 CHESTNUT DRIVE
33	4129
34	4133
35	4137

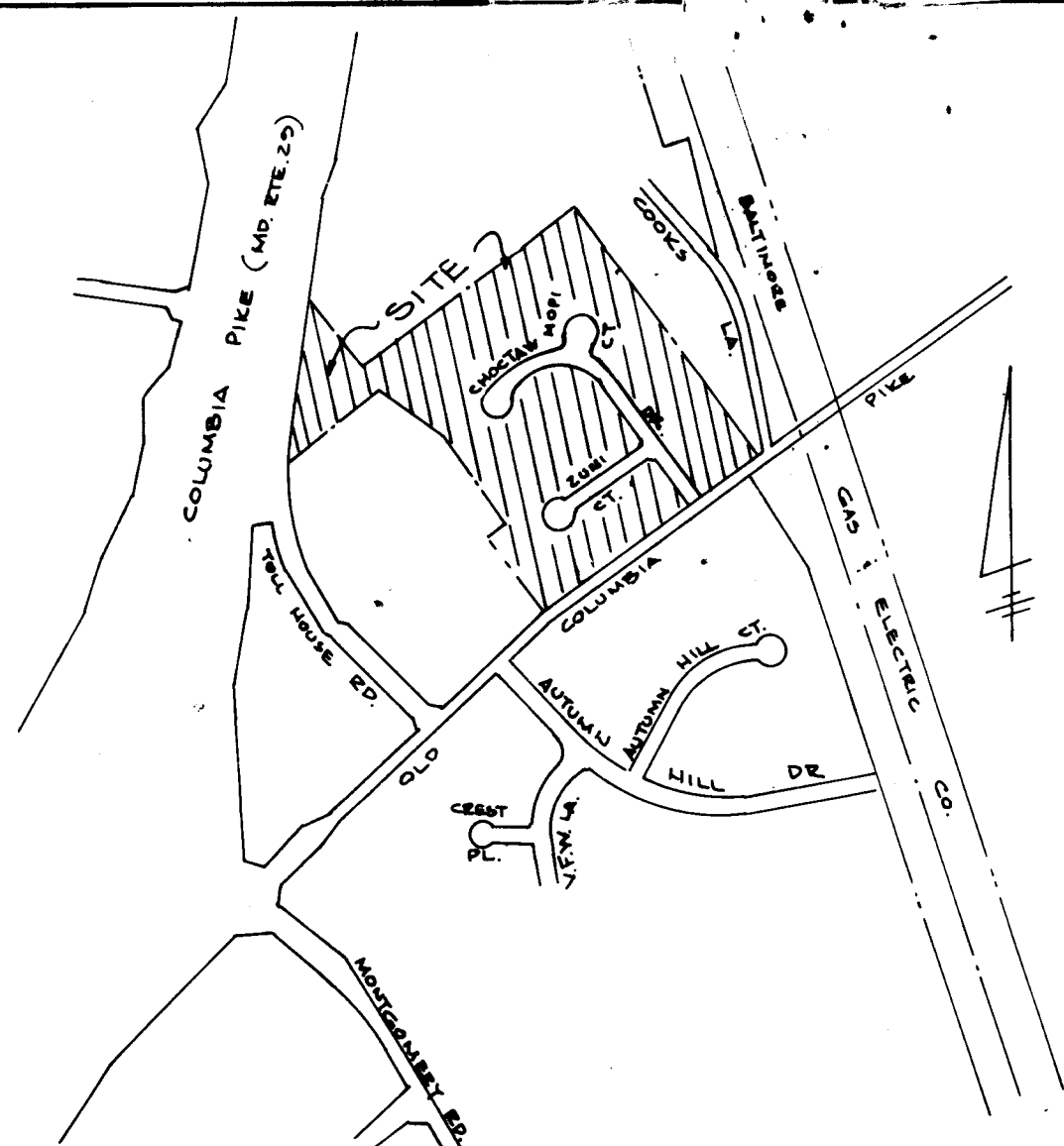

MARYLAND ROUTE 287 (OLD COLUMBIA PIKE)

**AREA OF UNITS:**

**HIGHLANDER**

- OPTION 1 - 12'x22' GAR (12'x12')
- OPTION 2 - 12'x22' CARPORT
- OPTION 3 - 22'x22' CARPORT
- OPTION 4 - 22'x22' GAR

**THE JAMESTOWN III**

- OPTION 1 - 12'x22' GAR
- OPTION 2 - 22'x22' CARPORT
- OPTION 3 - 12'x22' GAR
- OPTION 4 - 22'x22' GAR

**THE MILFORD I**

- OPTION 1 - 12'x22' CARPORT
- OPTION 2 - 22'x22' CARPORT
- OPTION 3 - 12'x22' GAR
- OPTION 4 - 22'x22' GAR

**THE ARDEN II**

- OPTION 1 - 12'x22' CARPORT
- OPTION 2 - 22'x22' CARPORT
- OPTION 3 - 12'x22' GAR
- OPTION 4 - 22'x22' GAR

20' WIDE LANDSCAPE EDGE WITH MIN. 2 1/2" INCH CALIPER TREES AT AN AVERAGE OF 30' ON CENTER AND MIN. 4'

SUBDIVISION NAME <b>KEYWAYDIN</b>	SECT./AREA N.A.	LOT/PARCEL # 1-35
PLAT # OR TRK 4003-4005	BLOCK # 18	ZONE R-ED
TAX/ZONE MAP 24	ELEC. DIST. 2 <sup>ND</sup>	CENSUS TR. 6025
WATER CODE 1-F04	SEWER CODE 1400530	

**ENGINEER**  
HUDKINS ASSOCIATES, INC.  
200 E. JOPPA ROAD  
TOWSON, MARYLAND 21204 TEL 828-9060

**DEVELOPER**  
POTOMAC BUILDING & DEVELOPMENT CORP.  
12805 MIDDLEVALE LANE  
SILVER SPRING, MARYLAND 20906

APPROVED: FOR PUBLIC WATER, SEWERAGE & STORM DRAINAGE SYSTEMS & PUBLIC ROADS.  
HOWARD COUNTY DEPT. OF PUBLIC WORKS.

*[Signature]* 2/23/84  
DIRECTOR DATE

*[Signature]* 2-23-84  
CHIEF, BUREAU OF ENGINEERING DATE

**KEYWAYDIN**  
SECOND ELECTION DISTRICT  
LOT 31 THRU 35  
HOWARD COUNTY, MARYLAND  
PLATS: 4003, 4004 & 4005 TAX MAP 24 PARCEL 261

**SITE DEVELOPMENT PLAN**

DATE: 1-20-83  
REVISIONS: AUG. 20, 1983

1 OF 3

**SITE ANALYSIS**

ZONING	R-ED
TOTAL AREA OF LOTS	19.78 AC.
TOTAL AREA OF SUBDIVISION	19.8 AC.
TOTAL DISTURBED AREA	10.2 AC.
TOTAL AREA TO BE PAVED OR ROOFED	1.8 AC.
AREA TO BE SEEDED OR SOODED	0.2 AC.
UNDISTURBED AREA	9.6 AC.

**ENGINEER'S CERTIFICATE**  
I CERTIFY THAT THIS PLAN FOR DEVELOPMENT AND EROSION AND SEDIMENT CONTROL REPRESENTS A PRACTICAL AND WORKABLE PLAN BASED ON MY PERSONAL KNOWLEDGE OF THE SITE CONDITIONS. THIS PLAN WAS PREPARED IN ACCORDANCE WITH THE REQUIREMENTS OF THE HOWARD SOIL CONSERVATION DISTRICT.

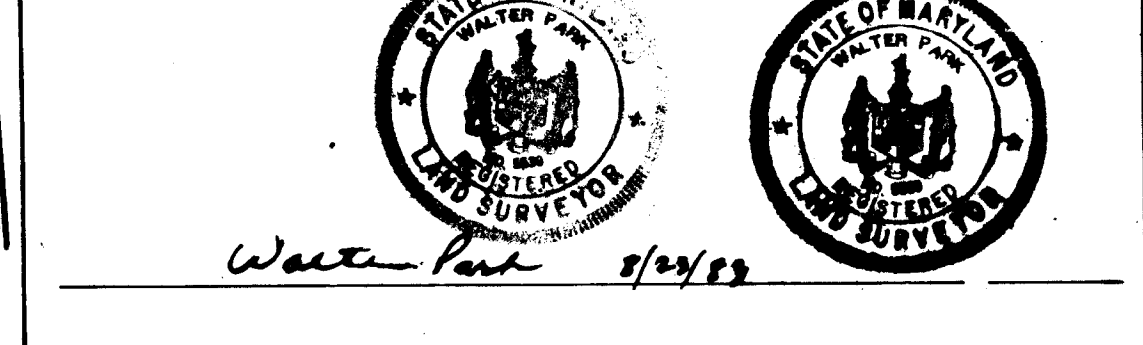

REVIEWED FOR THE HOWARD SOIL CONSERVATION DISTRICT & MEETS TECHNICAL REQUIREMENTS.

*[Signature]* 2-21-84  
US SOIL CONSERVATION DISTRICT DATE

**HOWARD SOIL CONSERVATION DISTRICT**  
THIS DEVELOPMENT PLAN IS APPROVED FOR SOIL EROSION & SEDIMENT CONTROL BY THE HOWARD SOIL CONSERVATION DISTRICT

*[Signature]* 2-21-84  
APPROVED: H.S.C.D. DATE

APPROVED: FOR PUBLIC WATER & PUBLIC SEWERAGE SYSTEMS.  
HOWARD COUNTY HEALTH DEPARTMENT

*[Signature]* 2-28-84  
HEALTH OFFICER DATE

APPROVED: HOWARD COUNTY OFFICE OF PLANNING & ZONING

*[Signature]* 2-29-84  
PLANNING OR DATE

*[Signature]* 2-29-84  
CHIEF DIVISION OF LAND DEVELOPMENT & ZONING ADMINISTRATION DATE

**DEVELOPER'S CERTIFICATE**  
I CERTIFY THAT ALL DEVELOPMENT AND/OR CONSTRUCTION WILL BE DONE ACCORDING TO THESE PLANS OF DEVELOPMENT AND EROSION AND SEDIMENT CONTROL. I ALSO AUTHORIZE PERIODIC ON SITE INSPECTION BY THE HOWARD SOIL CONSERVATION DISTRICT OR THEIR AUTHORIZED REPRESENTATIVES AS ARE DEEMED NECESSARY.

*[Signature]* 8/24/83



CLARK H. COOK DEVELOPMENT  
 LOT 3 LOT 2 LOT 1  
 JAMES MEADE 324/233  
 ROBERT VANWAGENER 284/233  
 EMILY ROBERTS 202/247

SEDIMENT TRAP No. 4  
 DRAINAGE AREA = 1.1 Acs  
 VOL. REQUIRED 11x7 = 77 CY  
 VOL. PROVIDED 280 CY  
 SIZE 60' x 4' x 3'  
 S.O.S. 6' x 4' x 2.5'  
 BOTTOM EL. 377.0  
 CREST EL. 380.0

SEDIMENT TRAP No. 3  
 DRAINAGE AREA 1.8 Acs  
 VOL. REQ. 67 x 1.8 = 120 CY  
 VOL. PROVIDED = 120 CY  
 SIZE 50' x 25' x 2'  
 S.O.S. 6' x 1.8' x 11'  
 BOTTOM EL. 399.9  
 CREST EL. 402.5

SEDIMENT TRAP No. 6  
 DRAINAGE AREA 3.8 Acs  
 VOL. REQ. 67 x 3.8 = 254 CY  
 VOL. PROVIDED 260 CY  
 SIZE 60' x 42' x 2.8'  
 S.O.S. 6' x 3.8' x 2.3'  
 BOTTOM EL. 377.2  
 CREST EL. 380.0

SEDIMENT TRAP No. 7  
 DRAINAGE AREA 1 Acs  
 VOL. REQ. 67 x 1 = 67 CY  
 VOL. PROVIDED 67 CY  
 SIZE 30' x 25' x 2'  
 S.O.S. 6' x 1' x 6'  
 BOTTOM ELEV. 385.6  
 CREST ELEV. 388.0

SEDIMENT TRAP No. 2  
 DRAINAGE AREA = 0.9 Acs  
 VOL. REQUIRED 67 x 0.9 = 60 CY  
 VOL. PROVIDED 61 CY  
 SIZE 30' x 25' x 2.2'  
 S.O.S. 6' x 0.9' x 5'  
 BOTTOM EL. 392.3  
 CREST EL. 394.5

SEDIMENT TRAP No. 1  
 DRAINAGE AREA = 2.0 Acs  
 VOL. REQUIRED 140' x 2 = 134 CY  
 VOL. PROVIDED 140' CY  
 SIZE 55' x 30' x 2.5'  
 S.O.S. 6' x 2.0' x 12'  
 BOTTOM EL. 387.7  
 CREST EL. 390.0

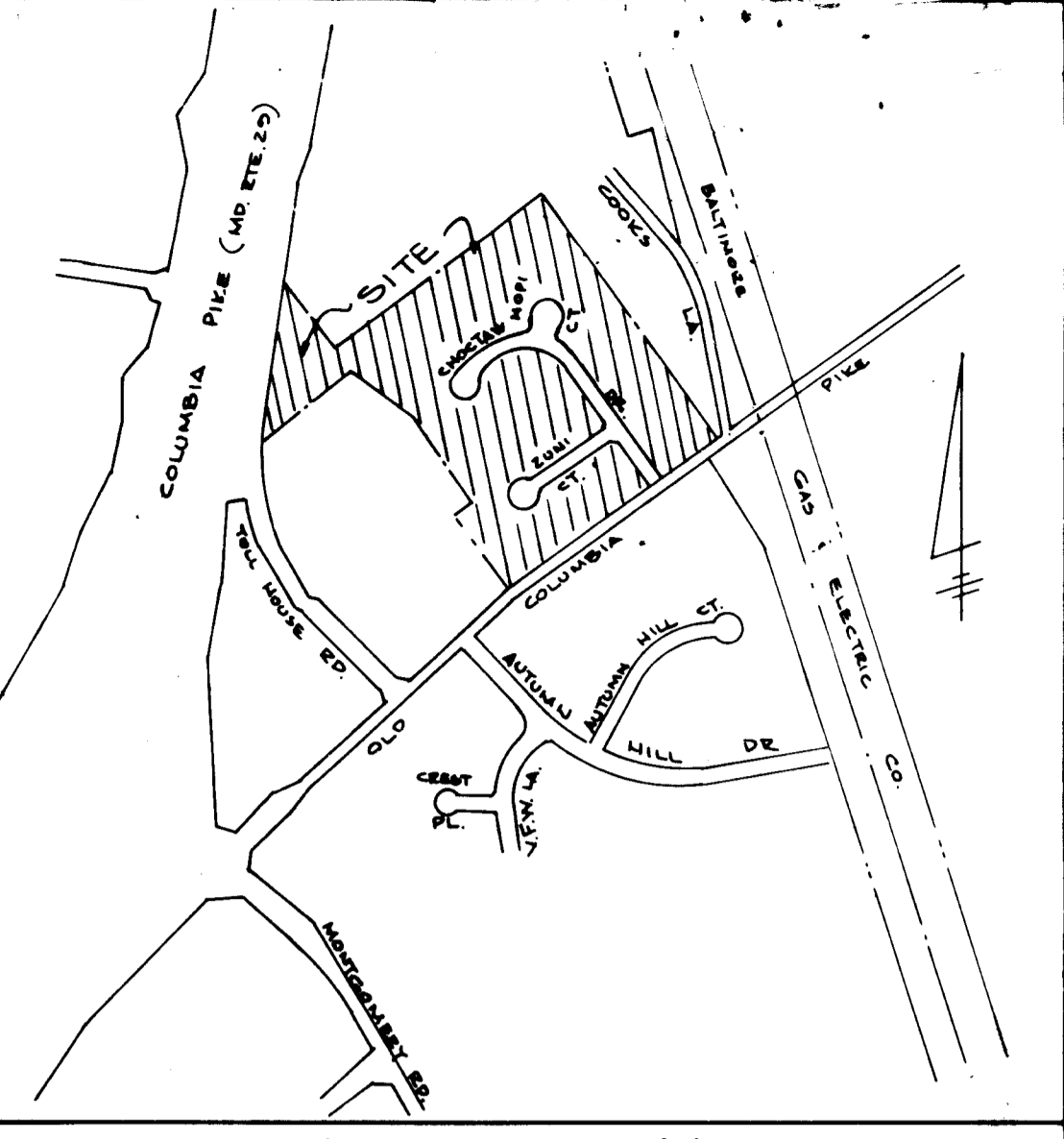

LOCATION MAP  
 SCALE: 1" = 600'

(OLD COLUMBIA PIKE)

MARYLAND ROUTE 2067

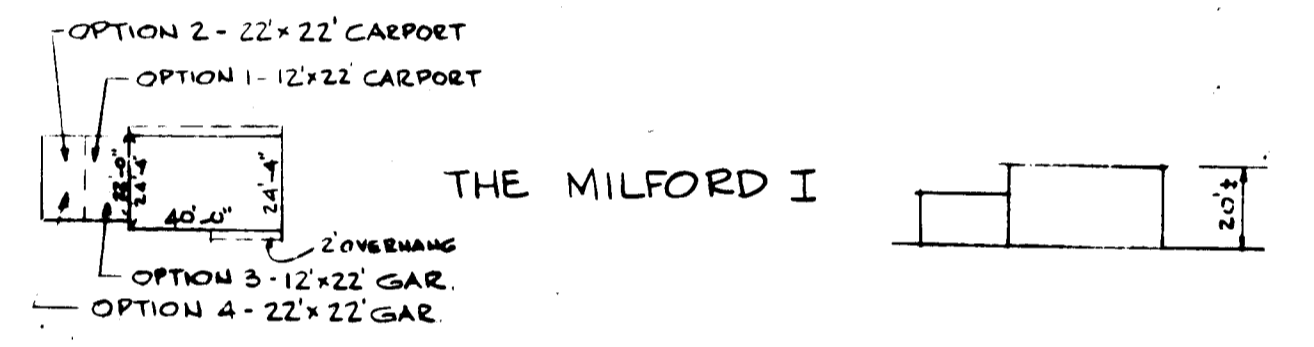
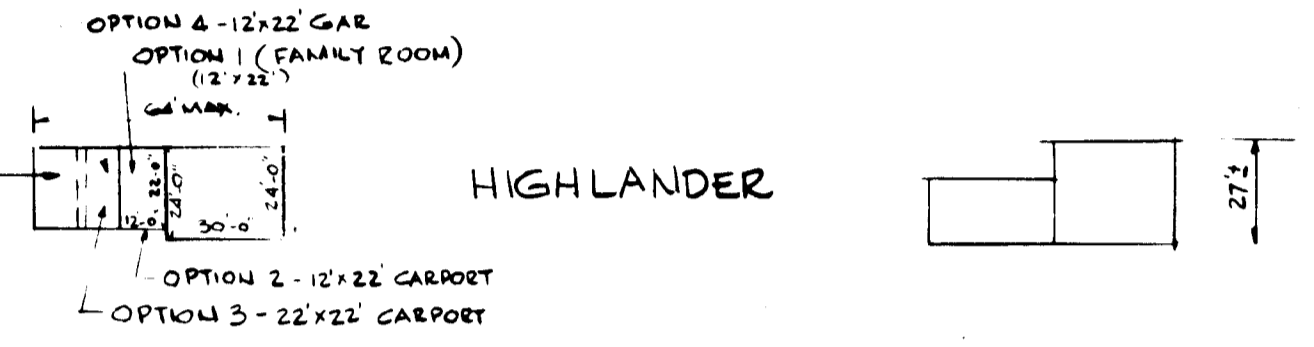

SEQUENCE OF CONSTRUCTION

1. OBTAIN GRADING PERMIT
2. NOTIFY HOWARD CO. DEPT. OF PERMITS AND LICENSES
3. INSTALL STONE CONSTRUCTION ENTRANCES, INTERCEPTOR DIKES & STRAW BALE DIKES.
4. EXCAVATE POND.
5. ROUGH GRADE SITE.
6. INSTALL STORM DRAINS
7. PROCEED WITH BUILDING & UTILITY CONST.
8. FINE GRADE SITE.
9. STABILIZE AREAS TO BE SEEDED PER PERMANENT SEEDING NOTES.
10. PLACE SUB-BASE MATERIAL IN AREAS TO BE PAVED.
11. REMOVE SEDIMENT CONTROL DEVICES & STABILIZE THESE AREAS
12. FLASH STORM DRAIN SYSTEM.
13. PAVE AREAS TO BE PAVED
14. OBTAIN FINAL APPROVAL FROM INSPECTOR TO INSURE OCCUPANCY.

ENGINEER  
 HUDKINS ASSOCIATES, INC.  
 200 E. JOPPA ROAD  
 TOWSON, MARYLAND 21204 TEL 828-0060

DEVELOPER  
 POTOMAC BUILDING & DEVELOPMENT CORP.  
 12808 MIDDLEVALE LANE  
 SILVER SPRING, MARYLAND 20906

APPROVED: FOR PUBLIC WATER, SEWERAGE & STORM DRAINAGE SYSTEMS & PUBLIC ROADS.  
 HOWARD COUNTY DEPT. OF PUBLIC WORKS

*James M. ...* 2/23/84  
 DIRECTOR DATE  
*William S. ...* 2-13-84  
 CHIEF, BUREAU OF ENGINEERING DATE

KEYWAYDIN  
 SECOND ELECTION DISTRICT  
 LOTS 1 THRU 36  
 HOWARD COUNTY, MARYLAND  
 PLATS: 4203, 4204 & 4205 TAX MAP 24 PARCEL 261

SEDIMENT CONTROL PLAN  
 DATE 7-20-83  
 REVISIONS Aug. 20, 1983  
 2 OF 3

APPROVED  
 DIVISION OF LAND DEVELOPMENT & ZONING ADMINISTRATION  
 HOWARD COUNTY, MARYLAND  
 DATE 2-21-84

SCALE: 1" = 50'

ENGINEER'S CERTIFICATE  
 I CERTIFY THAT THIS PLAN FOR DEVELOPMENT AND EROSION AND SEDIMENT CONTROL REPRESENTS A PRACTICAL AND WORKABLE PLAN BASED ON MY PERSONAL KNOWLEDGE OF THE SITE CONDITIONS. THIS PLAN WAS PREPARED IN ACCORDANCE WITH THE REQUIREMENTS OF THE HOWARD SOIL CONSERVATION DISTRICT.



REVIEWED FOR THE HOWARD SOIL CONSERVATION DISTRICT & MEETS TECHNICAL REQUIREMENTS.

*James M. ...* 2-21-84  
 US SOIL CONSERVATION DISTRICT DATE

HOWARD SOIL CONSERVATION DISTRICT  
 THIS DEVELOPMENT PLAN IS APPROVED FOR SOIL EROSION & SEDIMENT CONTROL BY THE HOWARD SOIL CONSERVATION DISTRICT

*W. V. ...* 2-21-84  
 APPROVED: H.C.D. DATE

APPROVED: FOR PUBLIC WATER & PUBLIC SEWERAGE SYSTEMS.  
 HOWARD COUNTY HEALTH DEPARTMENT

*James ...* 2-21-84  
 COUNTY HEALTH OFFICER DATE

APPROVED: HOWARD COUNTY OFFICE OF PLANNING & ZONING

*James ...* 2-29-84  
 PLANNING DIRECTOR DATE  
*James ...* 2-29-84  
 CHIEF OF DIVISION OF LAND DEVELOPMENT & ZONING ADMINISTRATION DATE

DEVELOPER'S CERTIFICATE  
 I CERTIFY THAT ALL DEVELOPMENT AND/OR CONSTRUCTION WILL BE DONE ACCORDING TO THESE PLANS OF DEVELOPMENT AND EROSION AND SEDIMENT CONTROL. I ALSO AUTHORIZE PERIODIC ON SITE INSPECTION BY THE HOWARD SOIL CONSERVATION DISTRICT OR THEIR AUTHORIZED REPRESENTATIVES AS ARE DEEMED NECESSARY.

*James ...* 8/26/83  
 DATE

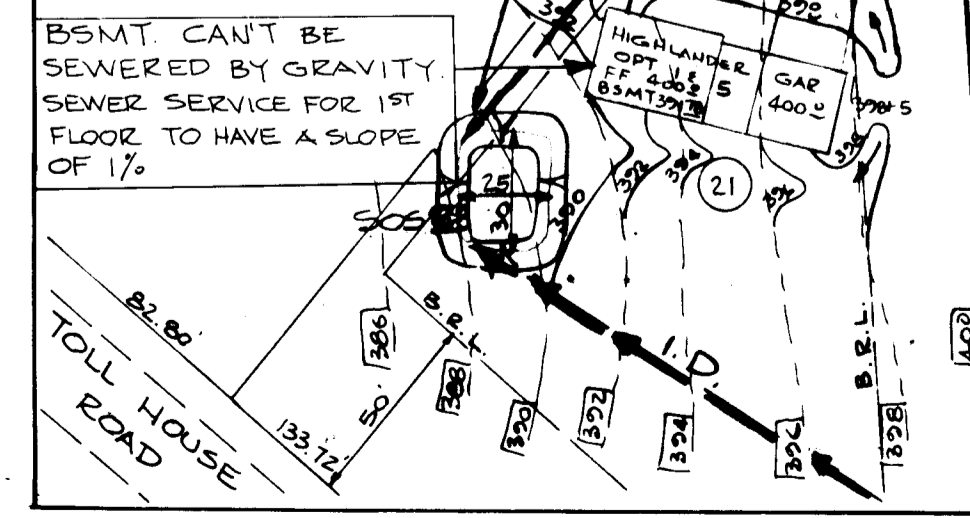

6' WIDE STONE APRON (EMBED 1' INTO EX. GR.)  
 2' STONE GRATE WIRE MESH  
 INLET PROTECTION NO SCALE

BSMT. CAN'T BE SEWERED BY GRAVITY. SEWER SERVICE FOR 1ST FLOOR TO HAVE A SLOPE OF 1%.

**SEDIMENT CONTROL SEEDING NOTES:**

1. Notify Howard County Bureau of Inspections 48 hrs. before starting work.
2. Install Sediment control measures in accordance with "Standards & Specifications for Soil Erosion & Sediment Control in developing areas" prior to any grading.
3. All Sediment control measures to remain in place until permission for their removal has been obtained from the Sediment Control Inspector.
4. Inspect & maintain all Sediment control measures to ensure proper functioning.
5. All graded areas not to be paved are to be stabilized as follows:
  - a. Spread 3" layer compacted topsoil to finished grade.
  - b. Spread 90 lbs./1000 s.f. Dolomitic limestone & 25 lbs./1000 s.f. 10x10x10 fertilizer.
  - c. Seed with 3 lbs./1000 s.f. of the following 40% Kentucky Blue, 20% Chewing Fescue, 20% Kentucky 31, & 20% Annual Rye. Rake with York Rake (Min. 2 passes), cover & compact with cultipacker or other approved method.
  - d. Mulch with 70 lbs./1000 s.f. small grain straw. Spray with 0.04 gal./sq. yd. emulsified asphalt.
  - e. If no germination within 4 weeks, then reseed.
6. Temporary seeding: Use 4 lbs./1000 s.f. of annual rye.

**NOTES:**

1. Notify the Howard Co. Bureau of Inspection & Permits @ least 24 hrs. before starting work.
2. All sediment control devices are to remain in place until permission for removal has been obtained from The Howard Co. Bureau of Inspections & Permits.
3. Structural measures such as berms, dikes, traps, basins, etc., will be installed & stabilized according to the plan prior to any disturbance of the existing surface of the site.
4. On site inspection and maintenance of all sediment control measure including cleanout of traps and berms and proper establishment of all planned vegetative measures will be the responsibility of the developer or his representative on the site on a continuing day to day basis.

**TEMPORARY SEEDING NOTES:**

1. Seed immediately upon construction with 1lb. rye grass per 1000 s.f.
2. Apply 46 lbs./1000 s.f. of pulverized dolomitic limestone and 115 lbs. to 18.4 lbs./1000 s.f. of 10x10x10 or equivalent fertilizer
3. Harrow or disc lime and fertilizer into the soil to a depth of at least 3 inch continue tillage until a resona by uniform fine firm seedbed the final harrowing or discing should be on the contour.
4. Mulch with straw @75 lbs./1000 s.f.

SEE SHEET 1 OF 3 FOR TREES REQUIRED.

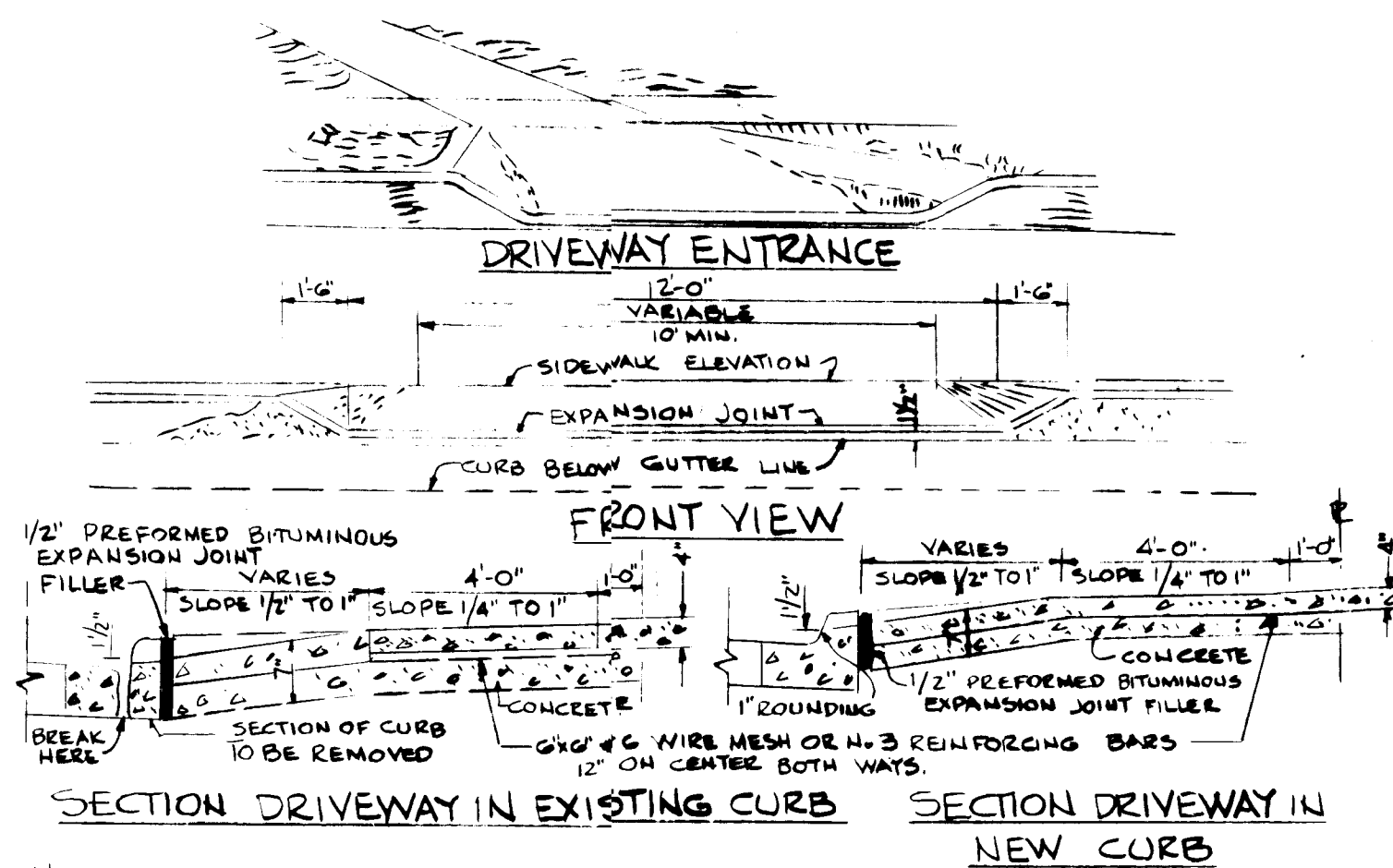
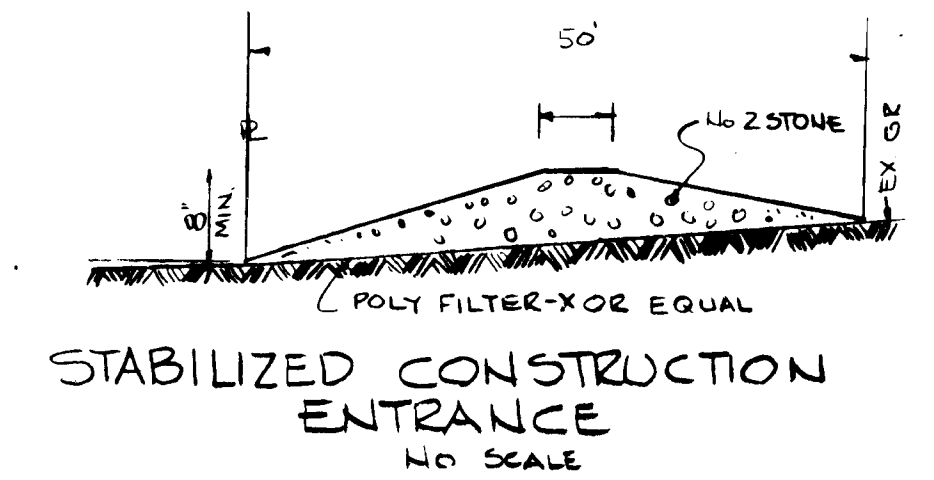
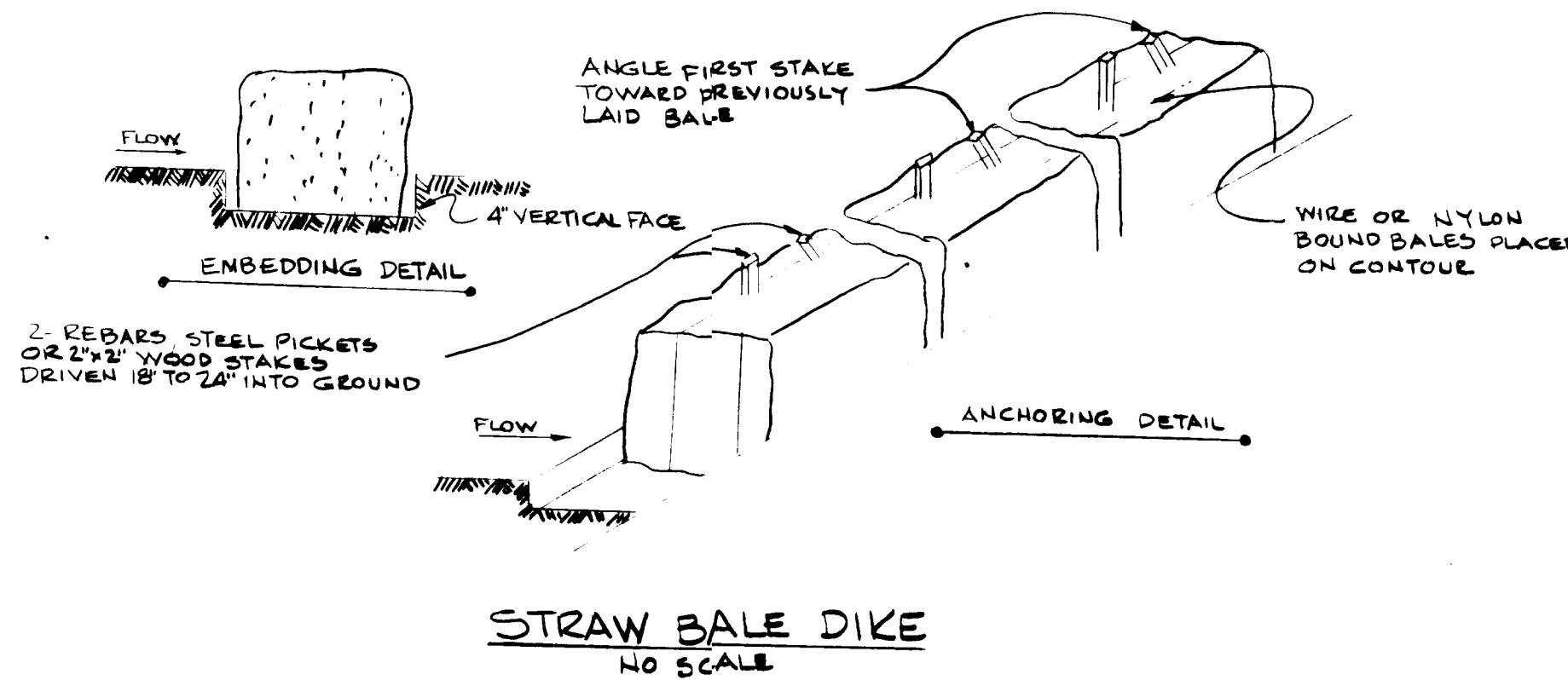
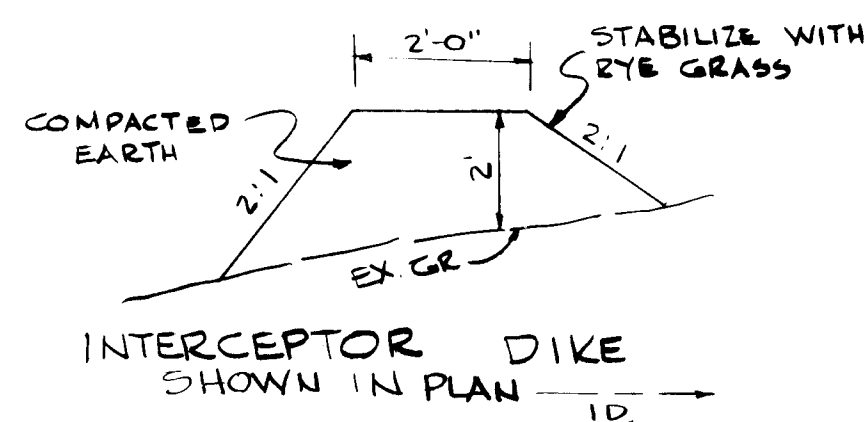
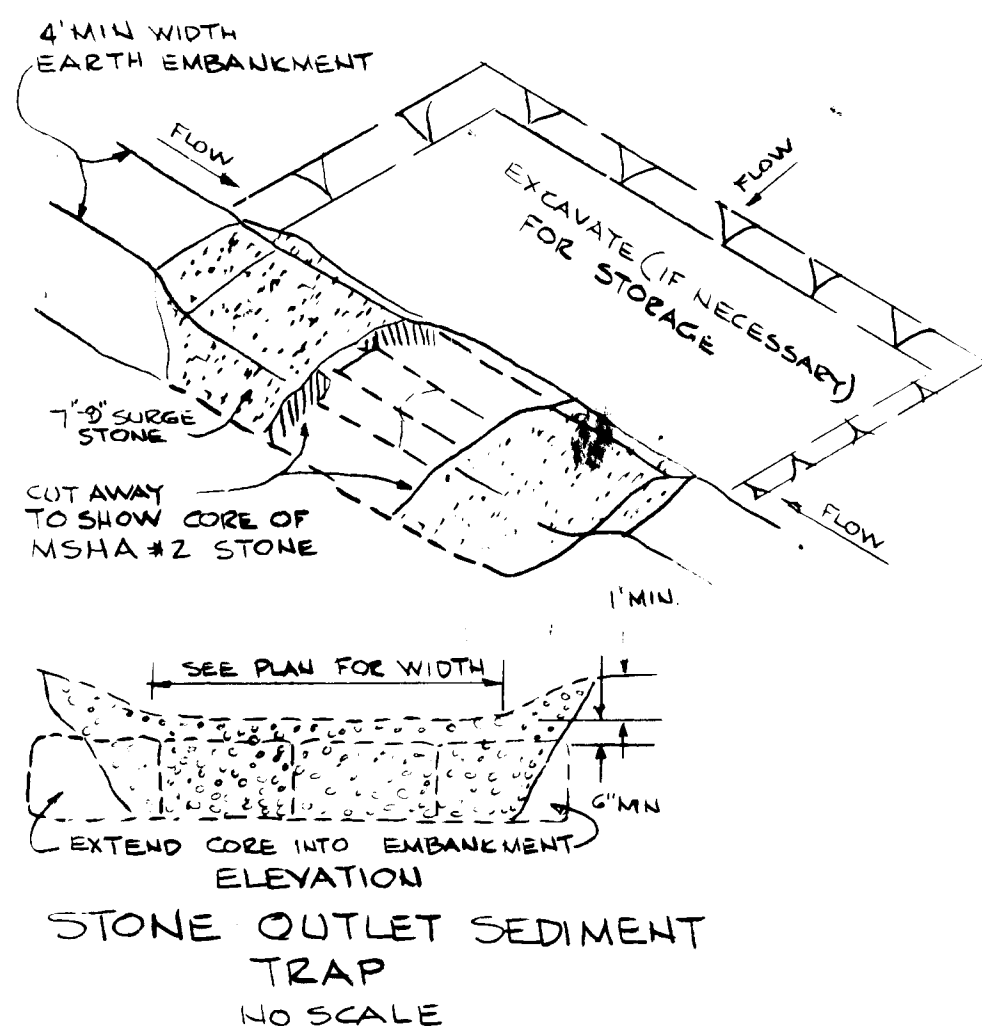

NOTE: ALL CONSTRUCTION SHALL CONFORM TO THE HOWARD COUNTY ROAD CONSTRUCTION CODE & STANDARD SPECIFICATIONS. USE THIS DRIVEWAY SECTION WITH THE EXISTING CONC APPROX CONFORMING WITH THE HOWARD CO. STD DRAWING D-34 PG 89

**SEDIMENT CONTROL NOTES**

1. The contractor shall notify the Howard County Department of Inspections & Permits at least 24 hours prior to beginning any construction shown hereon (992-2436).
2. All sediment control measures shall be installed in accordance with this plan and the "Standards and Specifications for Soil Erosion and Sediment Control in Developing Areas" (6/75) prior to any grading or disturbance to any surface materials.
3. All sediment control structures to remain in place until permission for their removal has been obtained from the Sediment Control Inspector.
4. Periodic inspection and required maintenance must be provided by the contractor or his representative control structures.
5. All graded areas, not to be paved shall be stabilized in accordance with the following:
  - a. Place 3" compacted layer of topsoil to finished grade.
  - b. Spread dolomitic limestone at the rate of 90 lbs./1000 sq. ft.
  - c. Spread 10x10x10 commercial grade fertilizer at the rate of 25 lbs./1000 sq. ft. and disc into soil to a 3" depth.
  - d. Seed prepared areas at the rate of 3 lbs./1000 sq. ft.
    - (1) 40% Merlon Kentucky Bluegrass, 40% common Kentucky Bluegrass, 20% Penn Lawn Creeping Red Fescue.
  - e. All seeding shall be raked with a York Rake (min. of 2 passes covered and compacted with a Cultipacker or other approved method.
  - f. Mulch all areas immediately after seeding with unweathered small grain straw at the rate of 70 lbs./1000 sq. ft. and spray with emulsified asphalt at the rate of 0.04 gal./sq. yd.
  - g. All seeded areas which do not show signs of germination within 4 weeks after seeding shall be reseeded.

**ENGINEER'S CERTIFICATE**  
I CERTIFY THAT THIS PLAN FOR DEVELOPMENT AND EROSION AND SEDIMENT CONTROL REPRESENTS A PRACTICAL AND WORKABLE PLAN BASED ON MY PERSONAL KNOWLEDGE OF THE SITE CONDITIONS. THIS PLAN WAS PREPARED IN ACCORDANCE WITH THE REQUIREMENTS OF THE HOWARD SOIL CONSERVATION DISTRICT.

*Walter Park* 9/1/83

REVIEWED FOR THE HOWARD SOIL CONSERVATION DISTRICT & MEETS TECHNICAL REQUIREMENTS

*James M. Vech* 8-21-84  
US SOIL CONSERVATION DISTRICT DATE

HOWARD SOIL CONSERVATION DISTRICT  
THIS DEVELOPMENT PLAN IS APPROVED FOR SOIL EROSION & SEDIMENT CONTROL BY THE HOWARD SOIL CONSERVATION DISTRICT

*John V. Roman* 2/21/84  
APPROVED: H.S.C.D. DATE

APPROVED  
DIVISION OF LAND DEVELOPMENT & ZONING ADMINISTRATION  
HOWARD COUNTY, MARYLAND  
DATE 2-9-84

APPROVED: FOR PUBLIC WATER & PUBLIC SEWERAGE SYSTEMS  
HOWARD COUNTY HEALTH DEPARTMENT  
*James Brown* 2-28-84  
COUNTY HEALTH OFFICER DATE

APPROVED: HOWARD COUNTY OFFICE OF PLANNING & ZONING  
*James H. Harris* 2-29-84  
PLANNING DIRECTOR DATE

*John A. Madenman* 2-29-84  
CHIEF DIVISION OF LAND DEVELOPMENT & ZONING ADMINISTRATION DATE

**DEVELOPER'S CERTIFICATE**  
I CERTIFY THAT ALL DEVELOPMENT AND/OR CONSTRUCTION WILL BE DONE ACCORDING TO THESE PLANS OF DEVELOPMENT AND EROSION AND SEDIMENT CONTROL. I ALSO AUTHORIZE PERIODIC ON SITE INSPECTION BY THE HOWARD SOIL CONSERVATION DISTRICT OR THEIR AUTHORIZED REPRESENTATIVES AS ARE DEEMED NECESSARY.

*Frederic D. Kennedy* 8/28/83

<b>ENGINEER</b> HUDKINS ASSOCIATES, INC. 200 E. JOPPA ROAD TOWSON, MARYLAND 21204 TEL 828-9060	
<b>DEVELOPER</b> POTOMAC BUILDING & DEVELOPMENT CORP. 12808 MIDDLEVALE LANE SILVER SPRING, MARYLAND 20906	
APPROVED: FOR PUBLIC WATER, SEWERAGE & STORM DRAINAGE SYSTEMS & PUBLIC ROADS. HOWARD COUNTY DEPT. OF PUBLIC WORKS	
<i>James M. Vech</i> DIRECTOR	2-23-84 DATE
<i>William E. Riley</i> CHIEF, BUREAU OF ENGINEERING	2-23-84 DATE
<b>KEYWAYDIN</b> SECOND ELECTION DISTRICT LOTS 1 THRU 35 HOWARD COUNTY, MARYLAND PLATS 14903, 4904 & 4905 TAX MAP 24 PARCEL 261	
<b>SEDIMENT CONTROL PLAN</b>	DATE 2-22-83 REVISIONS 3 OF 3