

- LEGEND:**
- 1 Contour Interval 2 Ft.
 - 2 Existing Contour 350
 - 3 Proposed Contour 350
 - 4 Spot Elevation +.50'
 - 5 Direction of Drainage
 - 6 100 Yr. Flood Plain Elevation EL: 320.2'
 - 7 Exist. Trees to be retained: (Symbol)
 - 8 Walk-Out Basement (Symbol)
 - 9 Retaining Wall (Symbol)

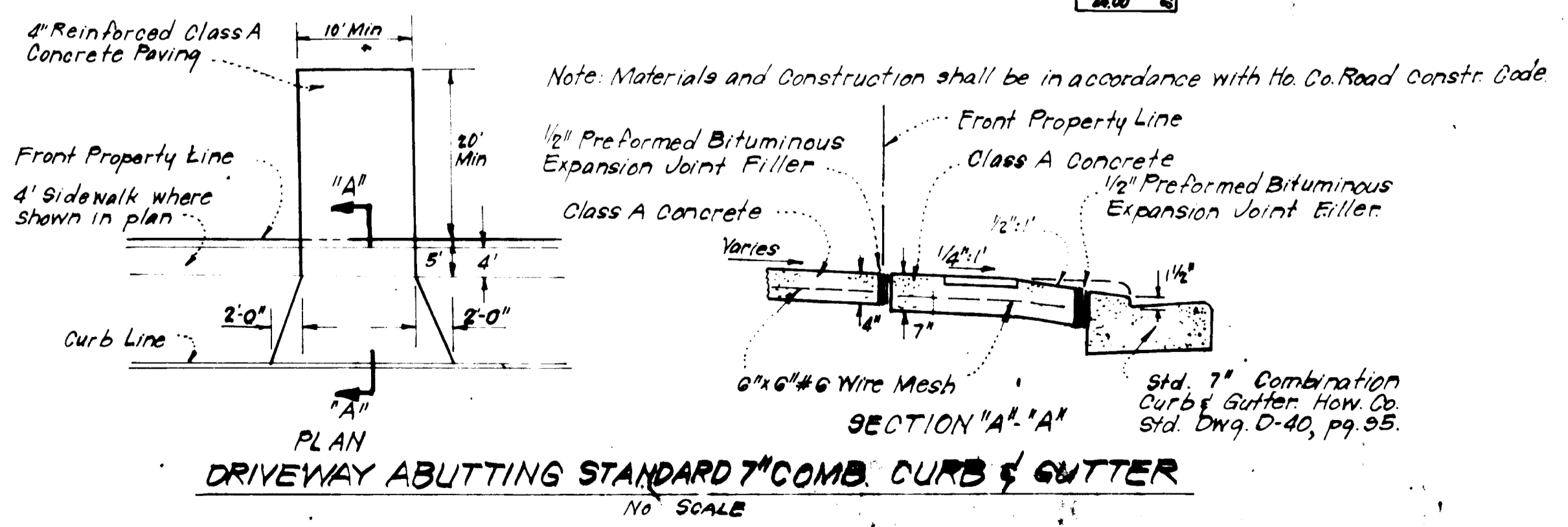
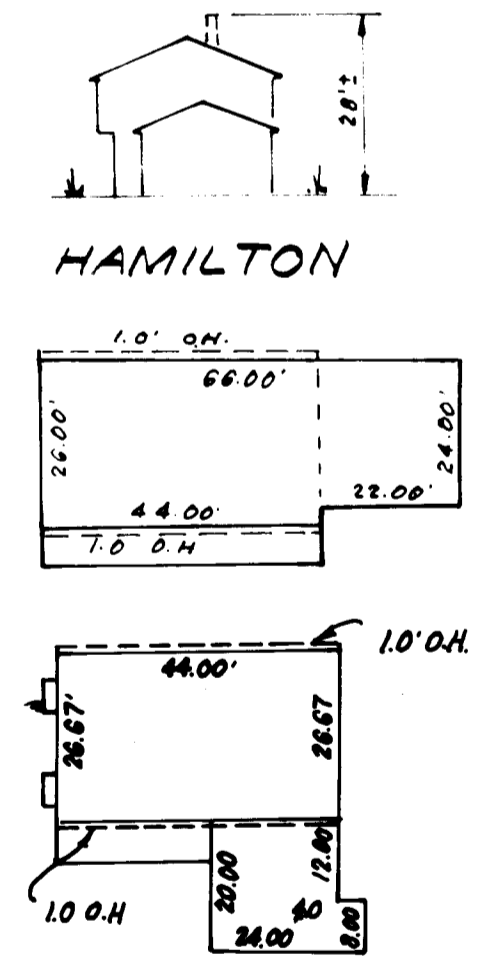

APPROVED:
 DIVISION OF LAND DEVELOPMENT &
 ZONING ADMINISTRATION
 HOWARD COUNTY, MARYLAND
 DATE 6-9-83
 [Signature]

The contractor or developer shall contact the Construction Inspection/Survey Division, 24 hours in advance of commencement of work at 792-7272.

- GENERAL NOTES**
1. The Land included in this plan is zoned: R-20
 2. The Lots shown on this plan are covered by Final Development Plan Phase
 3. All coordinates are based on traverse controls for Columbia established by Maps, Inc. in 1968 by Purdum & Veschte in 1968, which controls were tied to Maryland Bureau of Control Survey monuments and to U.S. Coast & Geodetic Survey monuments in the Columbia area.
 4. The area shown in this submission is located on Tax Map # 24
 5. The total area included on this plan is 0.813 Acres.
 6. All roadways are public & existing.
 7. Any damage to county owned rights of way shall be corrected at the developer's expense.
 8. Total Number of Lots: 2

SURVEYOR'S CERTIFICATE

I hereby certify that the information contained hereon is the same as shown on previously approved S.D.P. 80-83 with the following exceptions:

1. House Types and Grading has been revised on Lots 3 and 89

I further certify that the Sediment & Erosion control measures, as previously approved, will not be affected, the grading is substantially the same as originally approved, the building setbacks comply with Howard County Zoning and Subdivision Regulations, and the lot has the same geometric configuration as shown on the respective recorded subdivision Plat.

5-19-83
 Date

[Signature]
 DONALD B. SACKETT
 Registered Land Surveyor
 Md. No. 6059

APPROVED FOR PUBLIC WATER AND PUBLIC SEWERAGE SYSTEMS,
 HOWARD COUNTY HEALTH DEPARTMENT
 COUNTY HEALTH OFFICER [Signature] DATE 6-21-83

APPROVED HOWARD COUNTY OFFICE OF PLANNING & ZONING
 PLANNING DIRECTOR [Signature] DATE 6-23-83

CHIEF DIVISION OF LAND DEVELOPMENT & ZONING ADMIN. DATE 6-23-83

APPROVED FOR PUBLIC WATER AND PUBLIC SEWERAGE,
 STORM DRAINAGE SYSTEMS AND PUBLIC ROADS
 HOWARD COUNTY DEPARTMENT OF PUBLIC WORKS
 DIRECTOR [Signature] DATE 6-20-83

CHIEF BUREAU OF ENGINEERING [Signature] DATE 6-17-83

| | | |
|----------|-------------------------------|------------------|
| | | |
| DESIGNED | REVISED SITE DEVELOPMENT PLAN | SCALE 1/8"=1'-0" |
| DRAWN | LOT 3 (1/2) | DRAWING 1041 |
| CHECKED | LOT 89 (1/2) | JOB NO 79-092 |
| DATE | DORSEY HALL | DATE NO 79-092-X |
| | SECTION 1 AREA 2 & 3 | |
| | 2ND ELECTION DISTRICT | |
| | HOWARD COUNTY, MARYLAND | |
| | FOR THE RYLAND GROUP, INC. | |
| | One Knoll North, Suite 503 | |
| | Columbia, Md. 21045 | |
| | May, 1983 | |

SDP-83-199