

**PLANT SCHEDULE**

| KEY | PLANT NAME                                   | SIZE              | QUAN. | REMARKS           |
|-----|--|-------------------|-------|-------------------|
| Ar  | Acer rubrum<br>'October Glory' Maple         | 2 1/2" cal<br>min | 6     | B & B Heavy Heads |
| Qb  | Quercus borealis<br>Northern Red Oak         | 2 1/2" cal<br>min | 5     | B & B Heavy Heads |
| Wo  | Quercus phellos<br>Willow Oak                | 2 1/2" cal<br>min | 10    | B & B Heavy Heads |
| Mr  | Malus Dojo<br>Dodge Crabapple                | 6-8' Ht           | 5     | B & B Heavy Heads |
| Pc  | Pyrus calleryana 'Bradford'<br>Bradford Pear | 6-8' Ht           | 4     | B & B Heavy Heads |
| Pk  | Prunus serrulata 'Kwanzan'<br>Kwanzan Cherry | 6-8' Ht           | 3     | B & B Heavy Heads |
| Ps  | Pinus strobus<br>Eastern White Pine          | 6-8' Ht           | 6     | B & B Heavy Heads |

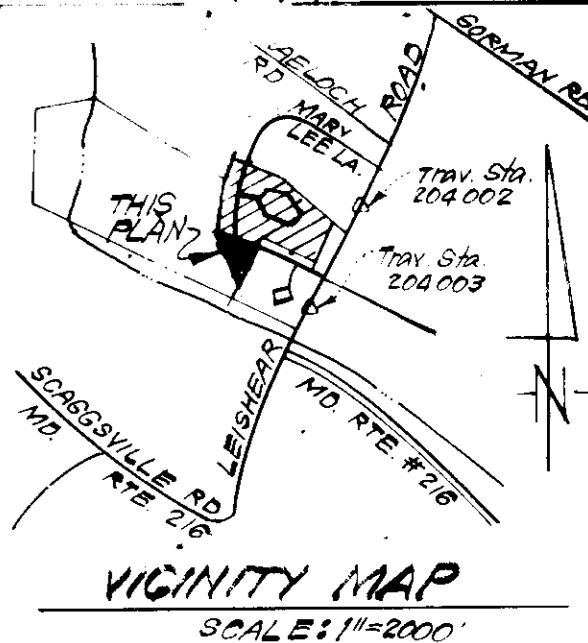

**GENERAL NOTES**

- The land included in this plan is zoned RSC
- All coordinates shown are based on Maryland State Grid System, Traverse Sta. 204.003 & 204.002
- The area covered is located on Tax Map # 46, Parcel # 3
- The total area included in this plan is 2.187 Acres
- All roadways are public and existing
- Any damage to county owned right of ways shall be corrected at the developer's expense
- No. of Units shown: 12
- No. of Parking Spaces shown: 30
- Total No. of Lots: 12
- Building Coverage: 35%

**LEGEND:**

- Contour Interval 2 Ft.
- Existing Contour 3.0
- Proposed Contour 3.0
- Spot Elevation +105
- Direction of Drainage
- Walk Out Basement
- Retaining Wall
- 100 Yr. Flood Plain Elevation
- Exist. Trees to be retained

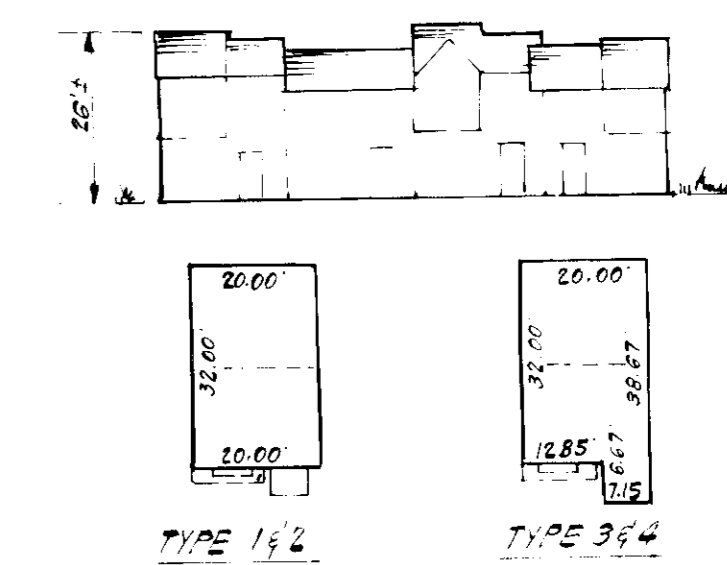

**TYPICAL UNITS**

NO SCALE

APPROVED  
DIVISION OF LAND DEVELOPMENT &  
ZONING ADMINISTRATION  
HOWARD COUNTY, MARYLAND  
DATE 9-2-82

*JMM*

PLAT REF: PLAT 5302

|   |  |          |
|---|--|----------|
| <b>CLARK • FINEROCK &amp; SACKETT</b><br>ENGINEERS • PLANNERS • SURVEYORS<br>11315 LOKWOOD DRIVE SILVER SPRING, MARYLAND 20904 (301) 591-1400 |  |          |
| DESIGNED  | SITE DEVELOPMENT PLAN<br>LOTS 1 THRU 12<br><br><b>MURRAY HILL</b><br>SECTION 3 AREA 1<br>6TH ELECTION DISTRICT<br>HOWARD COUNTY, MARYLAND<br><br>FOR: Diversified Housing Corp.<br>Suite 211 American City Bldg.<br>Columbia, Maryland 21044 | SCALE    |
| DRAWN   |  | 1" = 30' |
| CHECKED   |  | DRAWING  |
| DATE  |  | JOB NO.  |
|   |  | 82-045   |
|   |  | FILE NO. |
|   |  | 82-045-K |

SDP-83-13

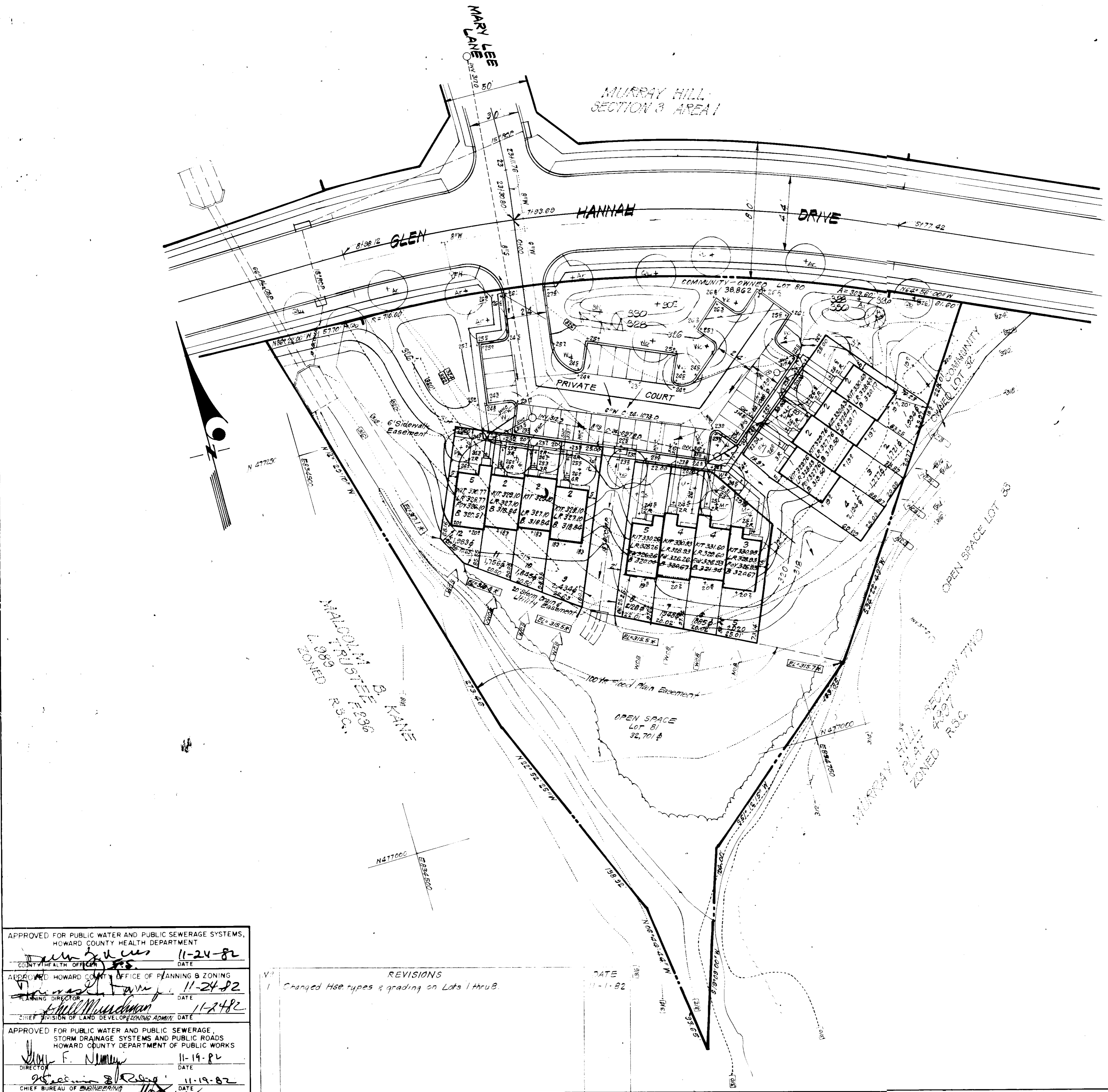

APPROVED FOR PUBLIC WATER AND PUBLIC SEWERAGE SYSTEMS,  
HOWARD COUNTY HEALTH DEPARTMENT

*[Signature]* 11-24-82  
COUNTY HEALTH OFFICER DATE

APPROVED HOWARD COUNTY OFFICE OF PLANNING & ZONING

*[Signature]* 11-24-82  
PLANNING DIRECTOR DATE

*[Signature]* 11-24-82  
CHIEF DIVISION OF LAND DEVELOPMENT & ZONING ADMIN. DATE

APPROVED FOR PUBLIC WATER AND PUBLIC SEWERAGE,  
STORM DRAINAGE SYSTEMS AND PUBLIC ROADS  
HOWARD COUNTY DEPARTMENT OF PUBLIC WORKS

*[Signature]* 11-19-82  
DIRECTOR DATE

*[Signature]* 11-19-82  
CHIEF BUREAU OF ENGINEERING DATE

REVISIONS

1 Changed Hse types & grading on Lots 1 thru 8

DATE 11-1-82

**GENERAL NOTES**

- Grading Permits shall be obtained prior to installation of Sediment Control & Grading
- All Sediment and Erosion Control Measures will be installed and stabilized according to this plan prior to any other grading, clearing or disturbance of the existing surface of the site. See note #6 for stabilization except that the seed mixture will be annual rye applied at a rate of 14 lbs/1000 sf.
- Notify the Bureau of Inspections and Permits at least 24 hrs before starting any work
- All Sediment Control Practices to conform to the Standards and Specifications for Sediment and Sediment Control in Developing Areas and shall be adjusted to meet actual field conditions
- Stabilization of Disturbed ground to be done as soon after construction as possible
- All disturbed area to be stabilized in accordance with the following Specifications:
  - Seed - certified 85% germination applied at the rate of 3.55/1000 sf. Mixture - 40% Kentucky Blue, 20% Chewina Fescue, 20% Kentucky 3' and 20% annual rye
  - Fertilizer - 10-10-10 applied at a rate of 23 lbs/1000 sf. Ground Agricultural Lime or Dolomite - Lime applied at a rate of 30 lbs/1000 sf
  - Mulch - Weed free grain straw applied at a rate of 70-90 lbs/1000 sf. Mulch shall be secured to the ground by any approved method e.g. asphalt tacks, chemical brooms etc.
  - All Sod used shall be Maryland State Certified
- All structural Sediment Control Measures are to remain in place until permission for their removal has been obtained from the Bureau of Inspections and Permits
- On-Site Inspection and Maintenance of all Sediment Control Measures including clean out of Sediment Traps and Dikes, and proper establishment of all planned vegetative measures will be the responsibility of the developer or his representative on the site, on a continuing day to day basis
- It will be the developer's responsibility to provide additional Sediment & Erosion Control Devices to protect stabilized areas during construction
- The Contractor shall keep all public roads free of sediment deposits left from traffic leaving construction site
- Approval of this plan is conditional upon the approval of Sediment Control Plan for the off-site waste or borrow area prior to the import of any borrow or export of waste to or from this site
- All pipes to be blocked at the end of each day. See detail this sheet
- Total Amount of Straw Bales or Silt Fence shown = None =
- SITE ANALYSIS:**
  - Total Area = 2.187 Acres
  - Area to be Seeded = 0.506 Acres
  - Area to be Paved = 0.857 Acres
  - Area to be Seeded = 0.837 Acres
  - Area Undisturbed = \_\_\_\_\_ Acres
- CONSTRUCTION SEQUENCE:**
  - Install Sediment & Erosion Control Devices and Stabilize Diversion Dike
  - Excavate for Foundations and Rough Grade
  - Erect Structures, Driveways and Sidewalks
  - Final Grade and Stabilize in accordance with note #6

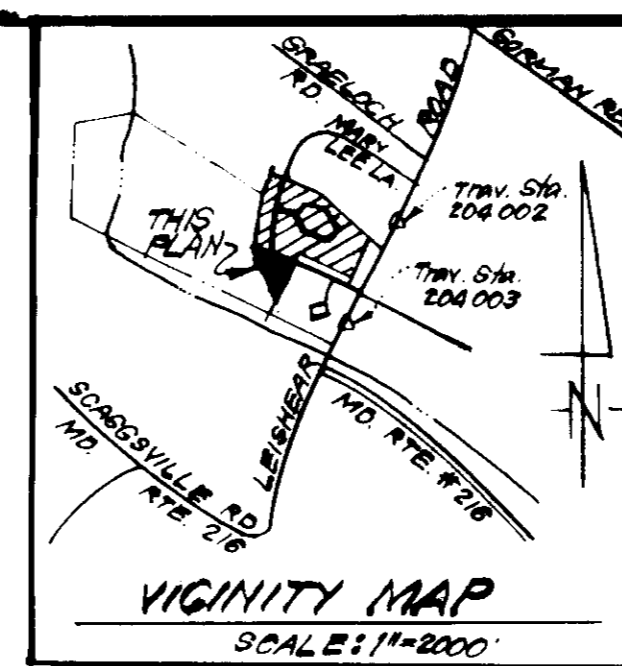

Reviewed for: **HOWARD** SCD  
 Name: **Howard**  
 Technical Requirements  
 Signature: *James H. Nels* 11-17-82  
 Date: 11-17-82  
 U.S. Soil Conservation Service

Approved: *Ann T. Rowe* 11-17-82  
 Date: 11-17-82

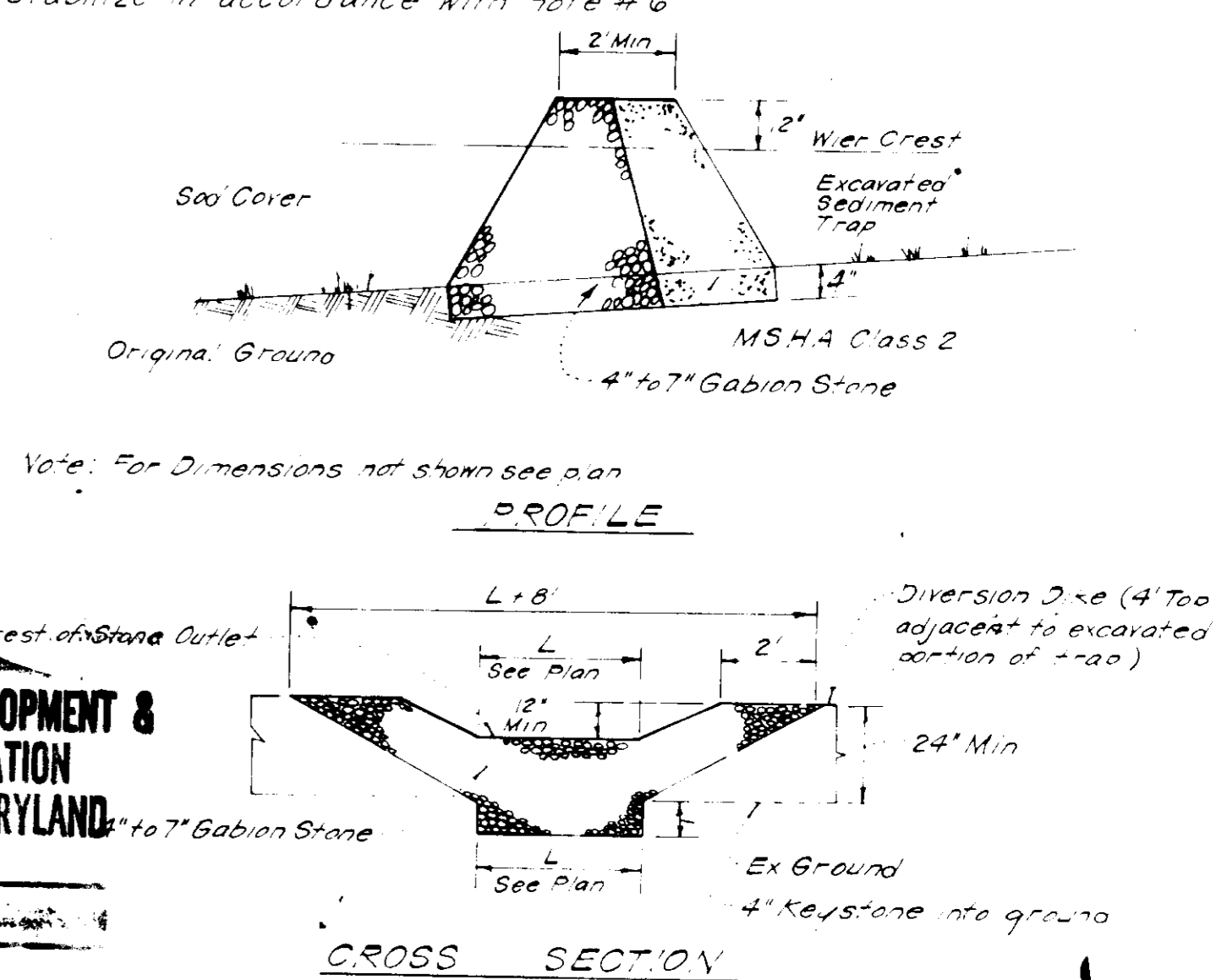
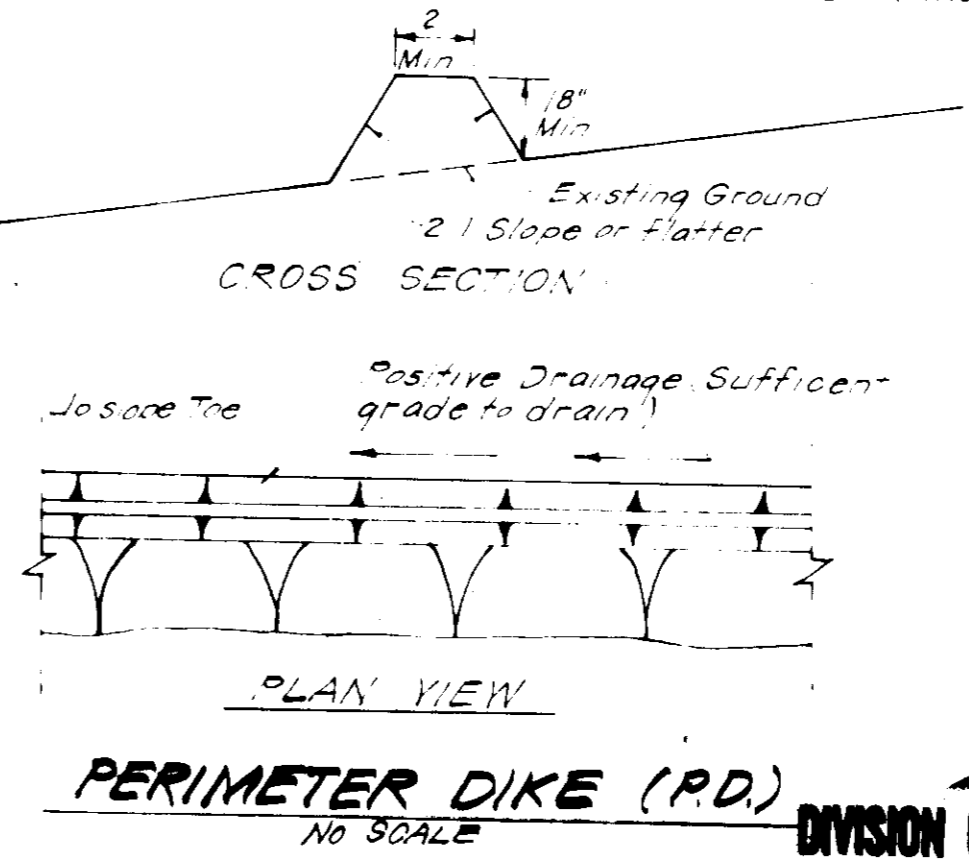

- LEGEND:**
- Existing Contour (2 ft Interval) - ---
  - Proposed Contour - - - - -
  - Spot Elevation - +205
  - Direction of Drainage - →
  - Exist. Perimeter Dike - ———
  - Perimeter Dike - ———
  - Exist. Stone Filter Inlet Protection - SFIP
  - Sediment Trap - [Symbol]

**NOTES:**

- Sediment Trap to be cleaned out when sediment reaches a level or below crest of stone outlet
- Bottom of Sediment Trap to be level and constructed to the dimensions shown on plan
- Stone Outlet to be constructed through diversion dike adjacent to excavated

**DETAILS OF STONE FILTER OUTLET FOR STONE OUTLET SEDIMENT TRAP**  
 NO SCALE

**NOTE: SEE PREVIOUSLY APPROVED PD CONSTRUCTION PLANS FOR MURRAY HILL, SECTION 3 AREA 1, F-82-72**

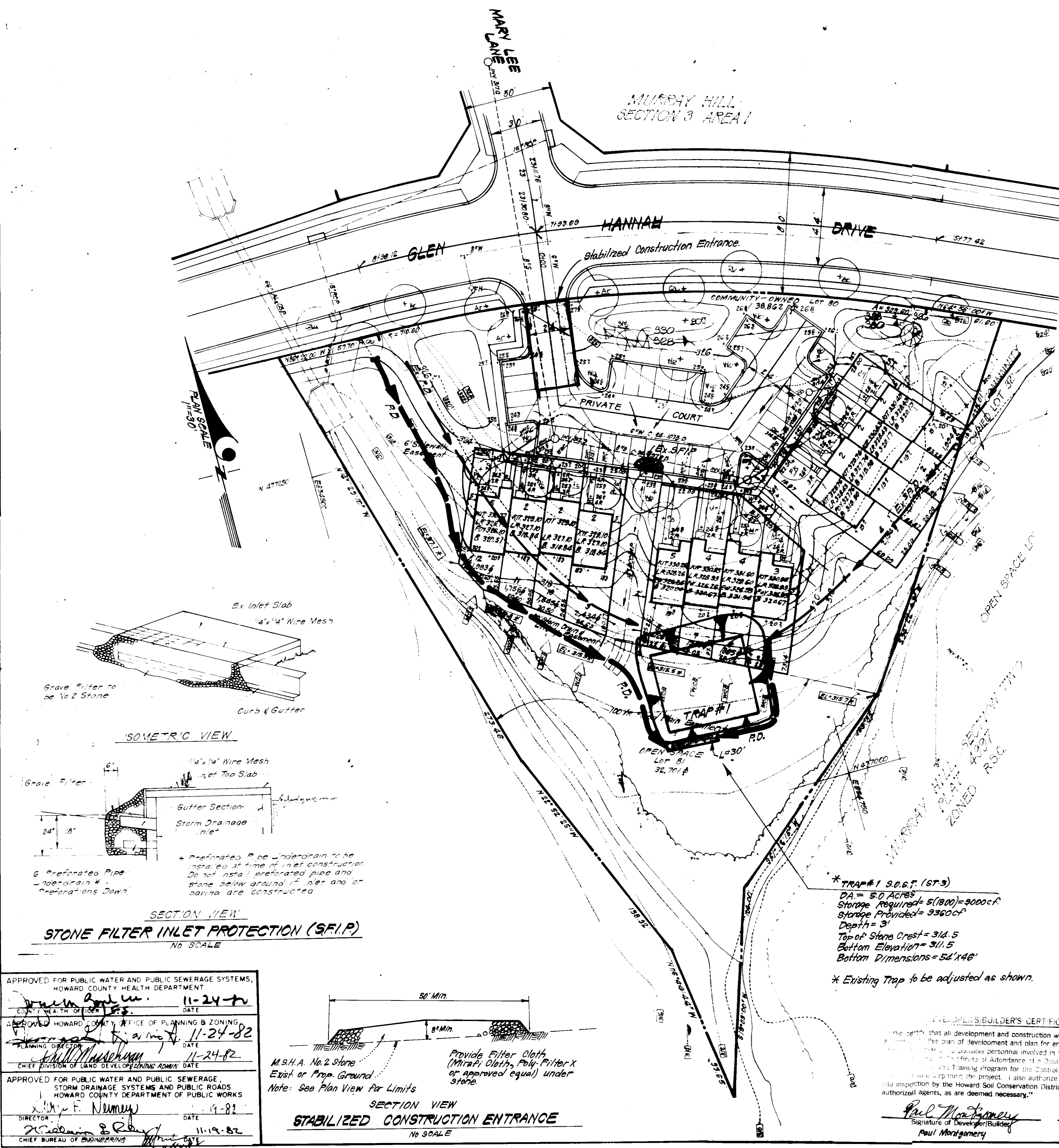

APPROVED FOR PUBLIC WATER AND PUBLIC SEWERAGE SYSTEMS, HOWARD COUNTY HEALTH DEPARTMENT  
 DATE: 11-24-82

APPROVED HOWARD COUNTY OFFICE OF PLANNING & ZONING  
 DATE: 11-24-82

APPROVED FOR PUBLIC WATER AND PUBLIC SEWERAGE, STORM DRAINAGE SYSTEMS AND PUBLIC ROADS  
 HOWARD COUNTY DEPARTMENT OF PUBLIC WORKS  
 DATE: 11-19-82

**DEVELOPER'S/BUILDER'S CERTIFICATE**  
 I hereby certify that all development and construction will be done in accordance with this plan of development and plan for erosion and sediment control and that I am a duly licensed professional engineer and a member in good standing of the State of Maryland. I also certify that I am a member of the National Society of Professional Engineers and a member in good standing of the International Brotherhood of Professional Engineers.

*Paul Montgomery* 8/5/82  
 Signature of Developer/Builder Date

**ENGINEER'S CERTIFICATE**  
 I hereby certify that this plan for Erosion and Sediment Control is a practical and workable plan and that I am a duly licensed professional engineer and a member in good standing of the State of Maryland. I also certify that it was prepared in accordance with the requirements of the Howard Soil Conservation District or their authorized agents, as are deemed necessary.

*G. Nelson Clark* 8-5-82  
 Signature Date

|  |   |   |
|--|---|---|
| <b>CLARK &amp; FINEFROCK &amp; SACKETT</b><br>ENGINEERS • PLANNERS • SURVEYORS<br>11315 LOCKWOOD DRIVE, VER SPRING, MARYLAND 21084 |   | SCALE: 1" = 30'   |
| DESIGNED: J.M.E.   | <b>SEDIMENT &amp; EROSION CONTROL PLAN</b><br>LOTS 1 THRU 12                                |   |
| DRAWN: K.J.W.  | <b>MURRAY HILL SECTION 3 AREA 1</b>   |   |
| CHECKED: J.M.E.  | 6TH ELECTION DISTRICT<br>HOWARD COUNTY, MARYLAND  |   |
| DATE: 8-5-82   | FOR: Diversified Housing Corp.<br>Suite 211 American City Bldg.<br>Columbia, Maryland 21044 |   |
|  |   | DRAWING: 2 OF 2<br>JOB NO: 82-045<br>FILE NO: 82-045-5E |