

SCALE: 1" = 20'-0"

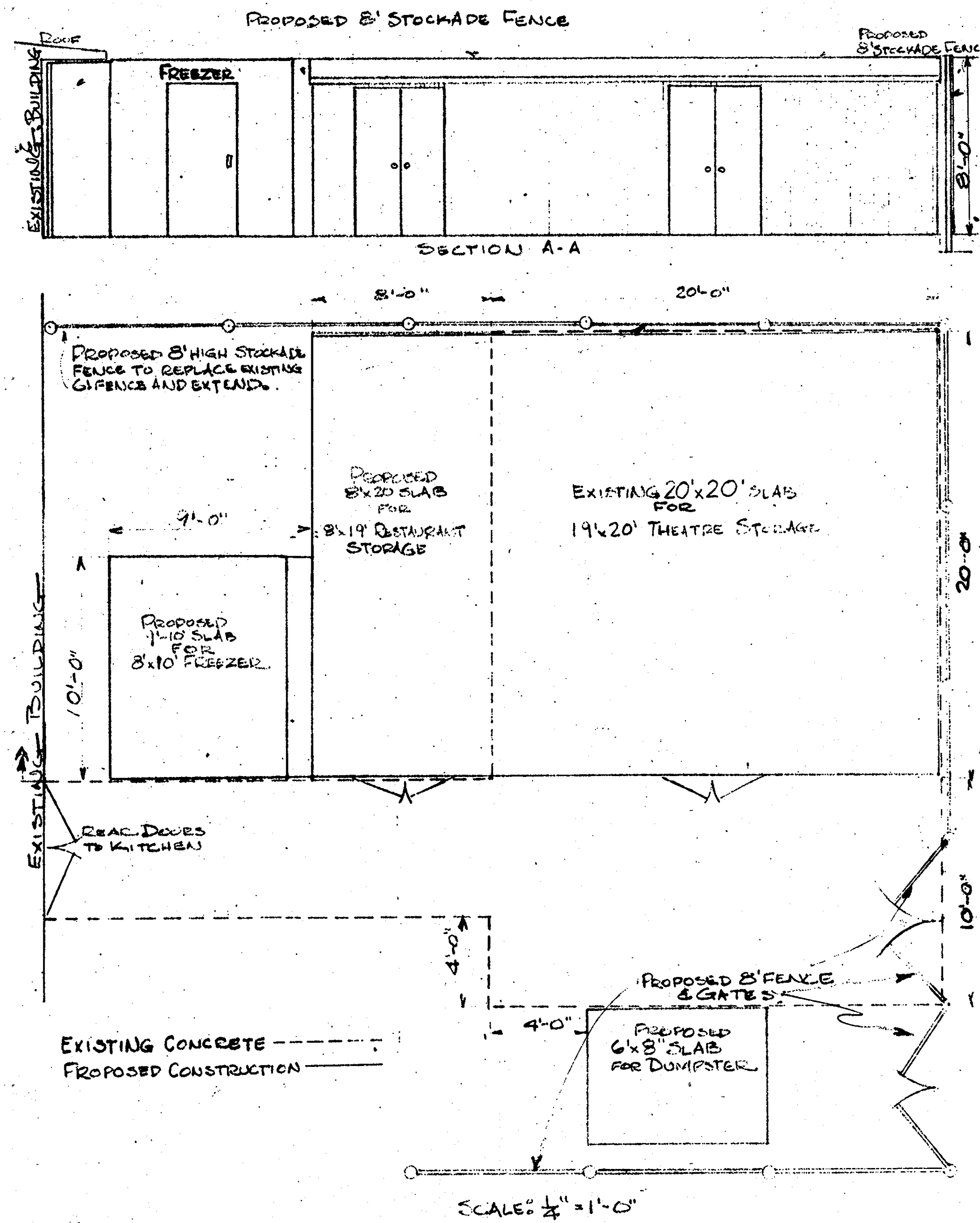

SCALE: 1/4" = 1'-0"

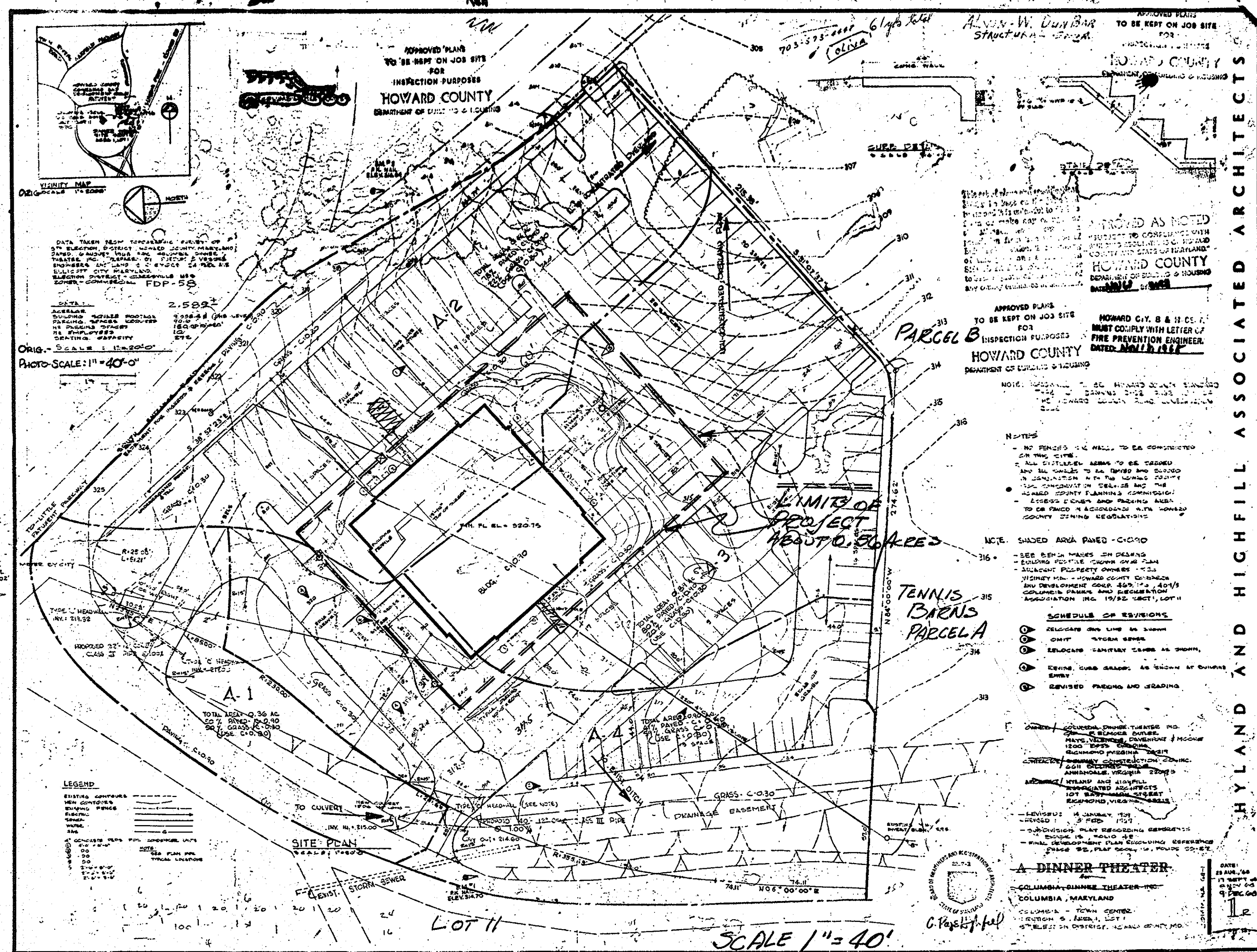

SCALE 1" = 40'

HYLAND AND HIGHFILL ASSOCIATED ARCHITECTS

APPROVED
PLANNING BOARD
OF HOWARD COUNTY
DATE: 7-30-80



George W. ...
REGISTERED PROFESSIONAL ENGINEER

APPROVED: For Public Water, Public Sewerage and Storm Drainage Systems and Roads	
HOWARD COUNTY DEPARTMENT OF PUBLIC WORKS	
<i>Henry F. Nummy</i> DIRECTOR	8-11-80 DATE
<i>William S. ...</i> CHIEF, BUREAU OF ENGINEERING	8-11-80 DATE
APPROVED: For Public Water and Public Sewerage Systems	
HOWARD COUNTY HEALTH DEPARTMENT	
<i>James ...</i> COUNTY HEALTH OFFICER	8-11-80 DATE
APPROVED: Howard County Office of Planning and Zoning	
<i>John ...</i> PLANNING DIRECTOR	8-22-80 DATE
<i>Joseph ...</i> CHIEF, DIVISION OF LAND DEVELOPMENT	8/21/80 DATE

TOBY'S DINNER THEATRE OF COLUMBIA, INC.
5900 Symphony Woods, Columbia, Md. 21045

ADDITION TO EXISTING BUILDING

Plat Book 16, Folio 26, Phase 52
Election District No. 5, Howard County, Md.
COLUMBIA TOWN CENTER
Section 5, Area 1, Lot 1

JERRY J. WORTH, P.E. June 25, 1980
1002 W. HOLCROFT DR.
SILVER SPRING, MD.
20903