

PROPERTY OF
STANLEY NASIATKA AND WIFE
354 / 81

M-2

PROPERTY OF
STANLEY NASIATKA
709 / 223

M-2

M-2

M-2

PROPERTY OF
DALLAS F WALLACE AND WIFE
491 / 178

PLAN

Scale: 1"=30'

BIT. CONC.	SURFACE (BAND C-3)	1 1/2"
	BINDER (BAND C-2)	3"
	BANK RUN GRAVEL BASE	5"

BIT. CONC.	SURFACE (BAND C-3)	1 1/2"
	BINDER (GRAVEL MIX)	10"
	CRUSHER RUN BASE	9"

- NOTES:
- THE BASE WILL BE PRIMED IN ACCORDANCE WITH SECTION C-30-3 AS PROVIDED IN THE HOWARD COUNTY ROAD CONSTRUCTION CODE AND STANDARD SPECIFICATIONS
 - A TACK COAT IS REQUIRED, IN ACCORDANCE WITH SECTION C-31-4 OF THE HOWARD COUNTY ROAD CONSTRUCTION CODE AND STANDARD SPECIFICATIONS.
 - ALL CONSTRUCTION SHALL BE IN ACCORDANCE WITH THE HOWARD COUNTY ROAD CONSTRUCTION CODE AND STANDARD SPECIFICATIONS.

ITEM	SEC.
CLEARING AND GRUBBING	C-1
SUBGRADE	C-2
BASE COURSE	C-25
BINDER COURSE	C-31 OR 35
SURFACE COURSE	C-31

(PUBLIC ROAD)
13 1/2" PAVING
No Scale

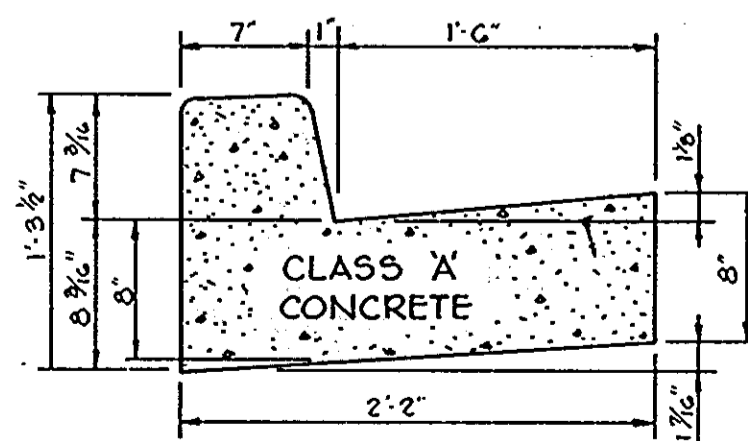

HOWARD COUNTY STANDARD (DRAWING D-40, PAGE 25)

STANDARD 7" COMBINATION
CURB AND GUTTER
No Scale

- NOTES:
- THE BASE WILL BE PRIMED IN ACCORDANCE WITH SECTION C-30-3 AS PROVIDED IN THE HOWARD COUNTY ROAD CONSTRUCTION CODE AND STANDARD SPECIFICATIONS
 - A TACK COAT IS REQUIRED, IN ACCORDANCE WITH SECTION C-31-4 OF THE HOWARD COUNTY ROAD CONSTRUCTION CODE AND STANDARD SPECIFICATIONS.
 - ALL CONSTRUCTION SHALL BE IN ACCORDANCE WITH THE HOWARD COUNTY ROAD CONSTRUCTION CODE AND STANDARD SPECIFICATIONS.

ITEM	SEC.
CLEARING AND GRUBBING	C-1
SUBGRADE	C-2
BASE COURSE	C-25
BINDER COURSE	C-31 OR 35
SURFACE COURSE	C-31

(PRIVATE DRIVE/PARKING)
12 1/2" PAVING
No Scale

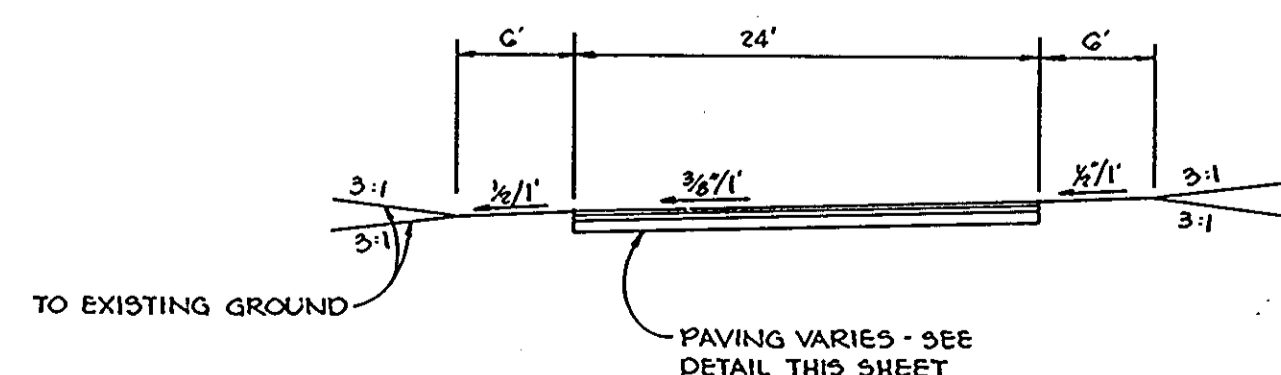

TYPICAL
ROAD SECTION
No Scale

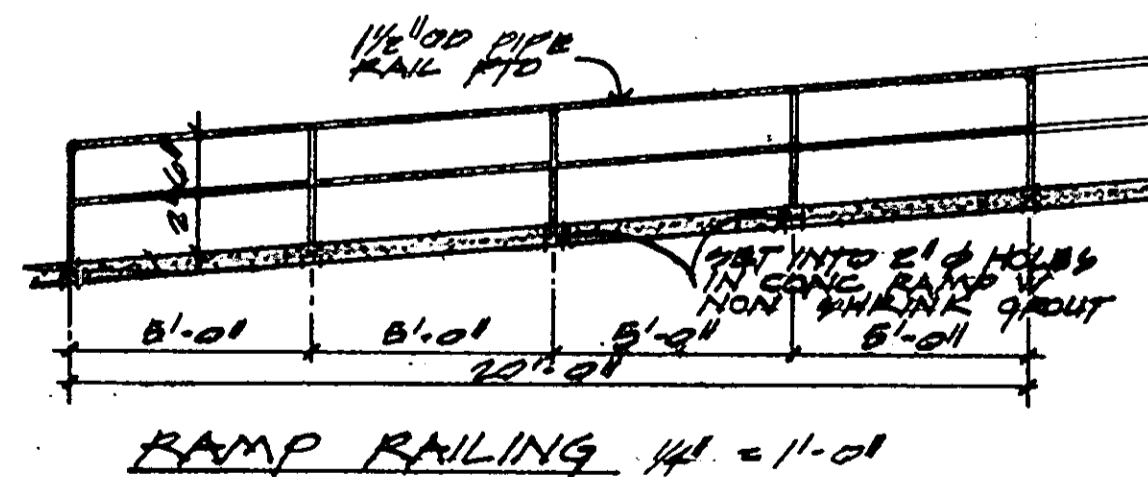

SIDEWALK DETAIL
No Scale

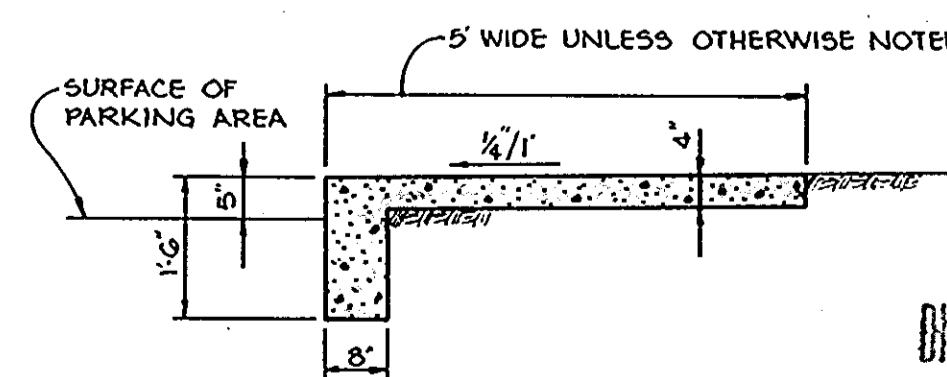

SOUTH ELEVATION
No Scale

APPROVED
DIVISION OF LAND DEVELOPMENT

HOWARD COUNTY, MARYLAND
DATE: 9-6-79

Note:
Water service for the Proposed Warehouse
is by interconnection with Existing Building.

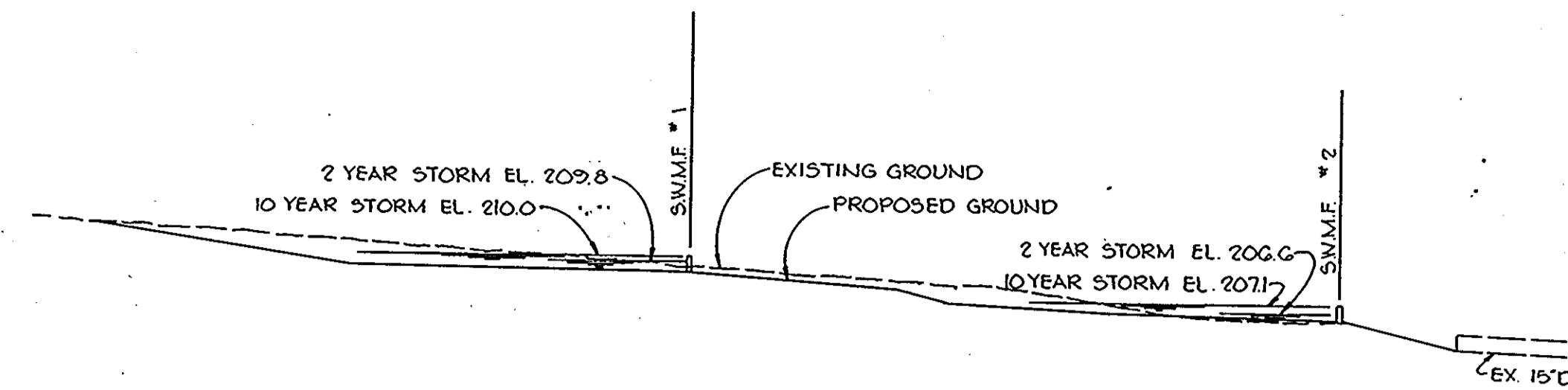

SECTION THROUGH SW.M.F.

Scale: H: 1"=30'
V: 1"=10'

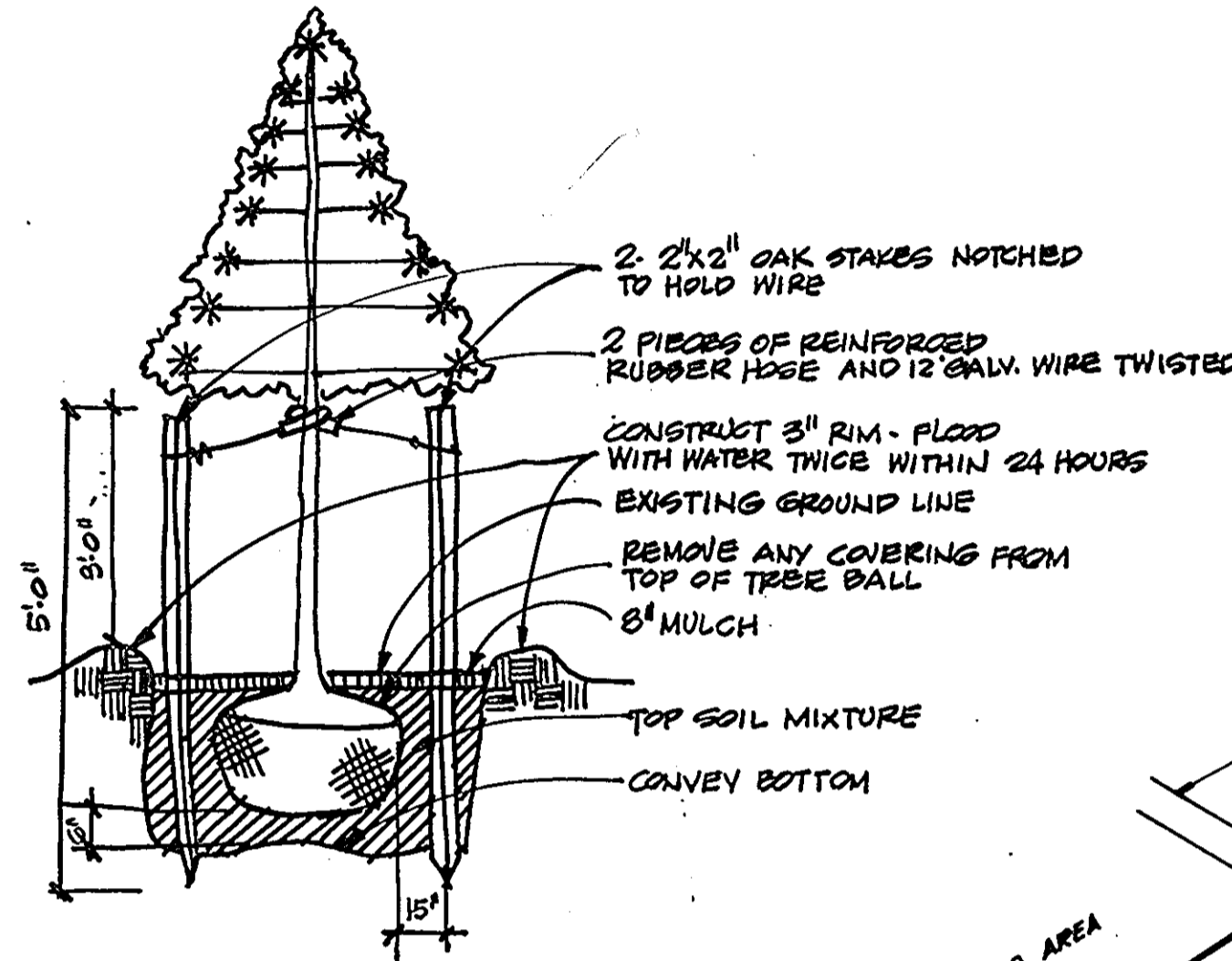

PLANTING DETAIL
NO SCALE

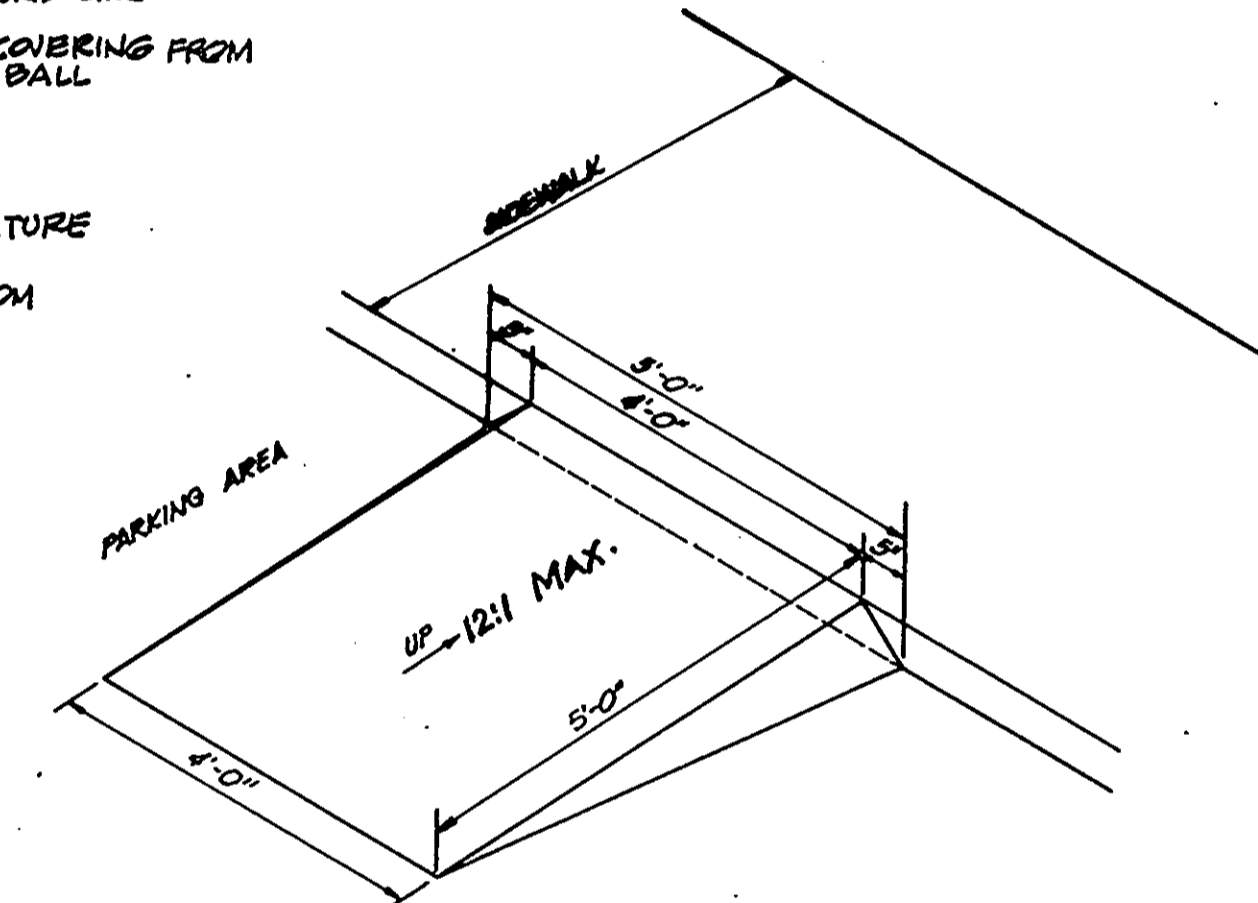

TYPICAL HANDICAPPED RAMP

No Scale

SITE ANALYSIS

- ZONING: M-2 (MANUFACTURING - HEAVY)
- AREA: 1.57 ACRES,
- NO. OF PARKING SPACES:
OFFICE (EXISTING STRUCTURE) - REQUIRED: 77
PROVIDED: 8 } EMPLOYEES (MAX)
- WAREHOUSE - REQUIRED: 0 }
PROVIDED: 0 } EMPLOYEES (MAX)
- MAXIMUM BUILDING COVERAGE PERMITTED: NONE REQUIRED.
- BUILDING COVERAGE SHOWN: (20% = 3443 SQ. FT.)
- TOPOGRAPHY AND BOUNDARY SURVEY DATA BY HUDKINS ASSOCIATES, INC.
- PUBLIC WATER AND PUBLIC SEWER TO BE UTILIZED
- ALL ROADWAYS AND PARKING TO BE PRIVATELY OWNED AND MAINTAINED.
- OPEN SPACE: 70% OF TOTAL SITE

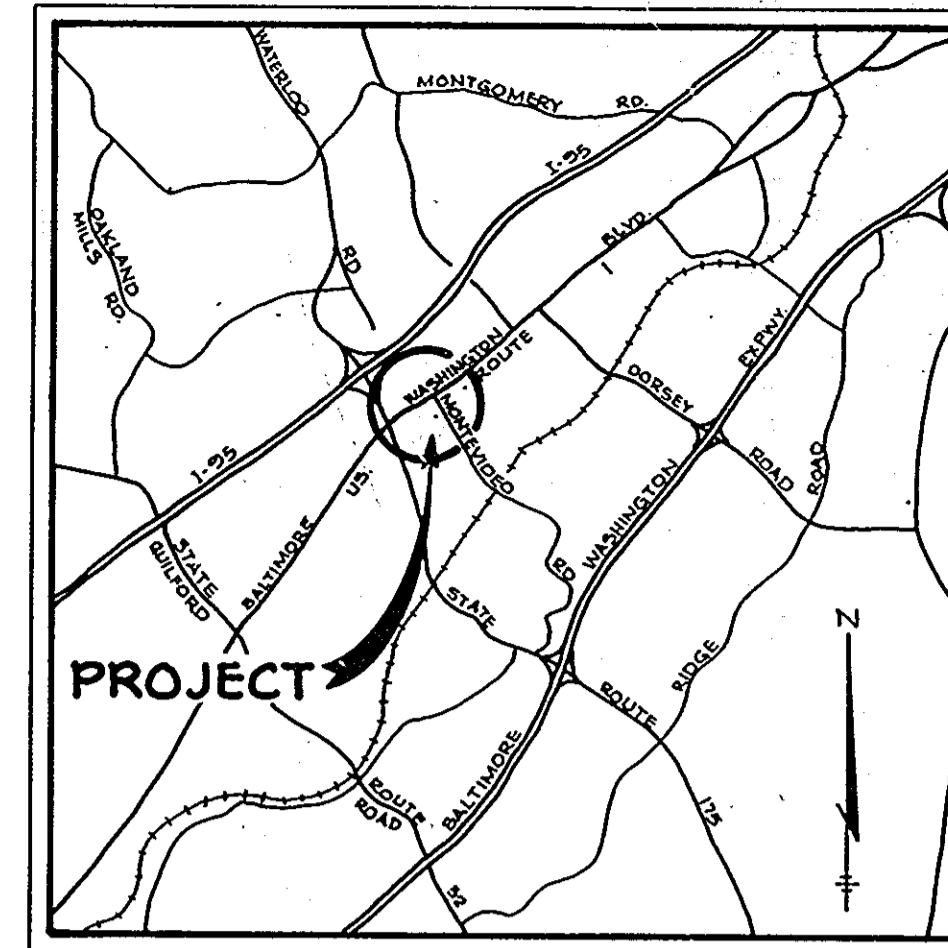

VICINITY MAP

Scale: 1"=1.75 Mi.

APPROVED: FOR PUBLIC WATER AND PUBLIC SEWERAGE,
STORM DRAINAGE SYSTEMS AND PUBLIC ROADS.

HOWARD COUNTY DEPARTMENT OF PUBLIC WORKS

George F. Neuman 10-10-79
DIRECTOR DATE

William J. Peltier 10-10-79
CHIEF, BUREAU OF ENGINEERING DATE

APPROVED: HOWARD COUNTY OFFICE OF PLANNING
AND ZONING

Donald L. Harris 10-23-79
PLANNING DIRECTOR DATE

William J. Peltier 10-23-79
CHIEF, DIVISION OF LAND DEVELOPMENT DATE

APPROVED: FOR PUBLIC WATER AND PUBLIC
SEWERAGE SYSTEMS, HOWARD COUNTY
HEALTH DEPARTMENT

Joseph M. Boyles 10-18-79
COUNTY HEALTH OFFICER DATE

10-23-79 ADDED CONFERENCE ROOM

8-31-79 ADDED PUBLIC SEWER CONNECTION

DATE NO. REVISION

OWNER/DEVELOPER

W. RICHARD SMITH
9512 WANDERING WAY
COLUMBIA, MARYLAND 21045

PROJECT: WAREHOUSE -
SALES AND MARKETING SERVICE INC.
7136 MONTEVIDEO ROAD

AREA TAX MAP NO. 43
1ST ELECTION DISTRICT
HOWARD COUNTY, MARYLAND

TITLE: SITE PLAN

TR Riemer - Tracy & Associates, Inc.
8659 Baltimore National Pike
Encino City, Maryland 21043
(301) 461-2690
Land Planning, Design & Civil Engineering

DATE 9-17-79 DEED NO. 204/93

DESIGNED BY: J.K.T.

DRAWN BY: R.J.W.

PROJECT NO: 1579

DATE: SEPTEMBER 10, 1979

SCALE: 1"=30'

DRAWING NO. 1 OF 2
PROFESSIONAL ENGR. NO. 9666

SDP-80-22

	DRAINAGE AREA	DISTURBED AREA	VOLUME REQ'D	PROV.	CREST ELEVATION	BOTTOM ELEVATION	CLEANOUT ELEV.	TRAP DIMENSIONS
S.O.S. #1	0.819 Ac.	0.660 Ac.	54.3 CY	55.5 CY	207.0	204.3	205.7	80" x 20"

PROPERTY OF
STANLEY NASIATKA AND WIFE
304 / 01

PROPERTY OF
STANLEY NASIATKA
709 / 223

PROPERTY OF
DALLAS F. WALLACE AND WIFE
401 / 178

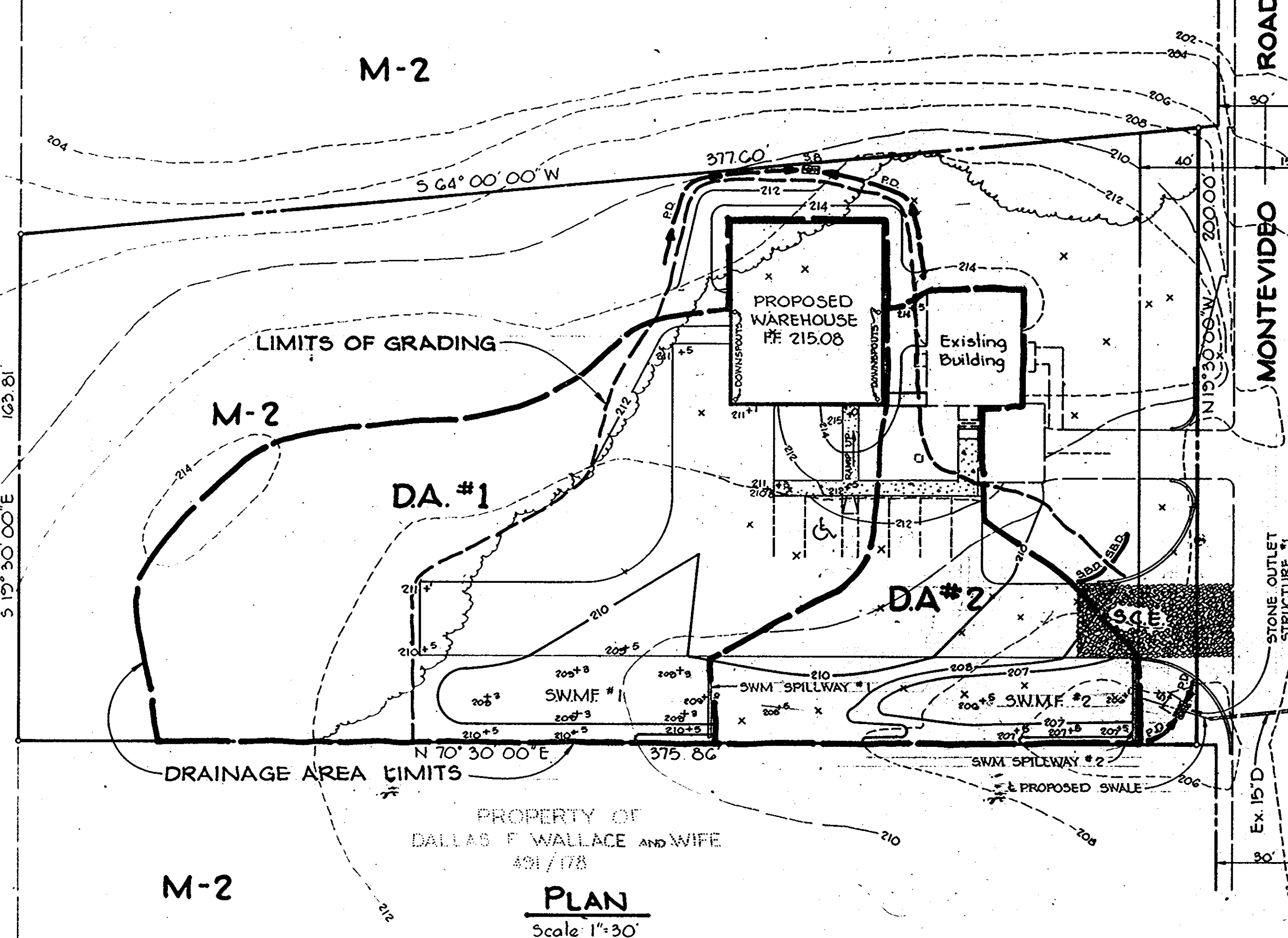

PLAN
Scale 1"=30'

SEDIMENT CONTROL CONSTRUCTION NOTES
GENERAL NOTES

- A MINIMUM OF 24 HOURS NOTICE MUST BE GIVEN TO THE HOWARD COUNTY OFFICE OF INSPECTION AND PERMITS PRIOR TO THE START OF ANY CONSTRUCTION (922-2070).
- ALL SEDIMENT CONTROL STRUCTURES WILL BE INSTALLED IN ACCORDANCE WITH THE STANDARDS AND SPECIFICATIONS FOR SOIL EROSION AND SEDIMENT CONTROL IN DEVELOPING AREAS AS PREPARED BY THE U.S. DEPARTMENT OF AGRICULTURE SOIL CONSERVATION SERVICE.
- SITE GRADING WILL BEGIN ONLY AFTER ALL PERIMETER SEDIMENT CONTROL MEASURES HAVE BEEN INSTALLED AND ARE IN A FUNCTIONING CONDITION.
- ALL DISTURBED AREAS ARE TO BE DRESSED AND STABILIZED ACCORDING TO THE TEMPORARY OR PERMANENT SEEDING SCHEDULES AS SOON AS PROPER WEATHER CONDITIONS EXIST FOR THE ESTABLISHMENT OF A PERMANENT VEGETATIVE COVER.
- SEDIMENT WILL BE REMOVED FROM TRAPS WHEN THE DEPTH REACHES THE CLEAN OUT ELEVATION SHOWN ON THE PLANS.
- FERTILIZER AND LIME RATES MAY BE CHANGED THROUGH AUTHORIZATION BY THE HOWARD SOIL CONSERVATION DISTRICT IF SOIL TESTS DETERMINE A REDUCTION IN THE SPECIFIED RATES IS JUSTIFIED.
- ALL SEDIMENT CONTROL STRUCTURES ARE TO REMAIN IN PLACE AND ARE TO BE MAINTAINED IN OPERATIVE CONDITION UNTIL PERMISSION FOR THEIR REMOVAL HAS BEEN OBTAINED FROM THE HOWARD COUNTY SEDIMENT CONTROL INSPECTOR.
- REFERENCES CALLED FOR ON THE SEDIMENT CONTROL CONSTRUCTION PLAN AND DETAILS ARE MADE TO "THE STANDARDS AND SPECIFICATIONS FOR SOIL EROSION AND SEDIMENT CONTROL IN DEVELOPING AREAS".
- NO STORM DRAINS SHALL BE INSTALLED UNDER THIS CONTRACT.
- SEDIMENT CONTROL WILL BE INSTALLED BEFORE CLEARING AND GRUBBING REMAINDER OF SITE.

TEMPORARY SEEDING

- AREA TO BE SEEDED SHALL BE RECENTLY LOOSENEED. IF THE GROUND IS PACKED, CRUSTED OR HARD, THE TOP LAYER OF SOIL SHALL BE LOOSENEED BY DISCING, RACKING OR OTHER ACCEPTABLE MEANS.
- APPLY 10-20-10 FERTILIZER (OR EQUIVALENT) AT THE RATE OF 600 LBS. PER ACRE OR 15 LBS. PER 1000 SQ. FT.
 - WHERE SOIL IS KNOWN TO BE HIGHLY ACID, APPLY DOLOMITIC LIMESTONE AT THE RATE OF 1 TON PER ACRE.
 - WORK BOTH INTO SOIL AND SEED WITH CYCLONE SEEDER, DRILL, CULTIPAKER SEEDER OR HYDROSEEDER (SLURRY WILL INCLUDE SEED AND FERTILIZER) AT THE RATE OF 40 LBS. PER ACRE OF ITALIAN OR PERENNIAL RYEGRASS.
 - MULCH WITH UNWEATHERED SMALL GRAIN STRAW AT THE RATE OF 1 1/2 TO 2 TONS PER ACRE AND ANCHOR WITH A CUTBACK ASPHALT OR EMULSIFIED ASPHALT AT THE RATE OF 5 GAL. PER 1000 SQ. FT.

PERMANENT SEEDING

FINAL STABILIZATION WILL TAKE PLACE AS SOON AS POSSIBLE AS WEATHER CONDITIONS PERMIT, AS FOLLOWS:

- APPLY DOLOMITIC LIMESTONE AT THE RATE OF 2 TONS PER ACRE (ONE TON PER ACRE IF APPLICATION OF TON PER ACRE WAS MADE FOR TEMPORARY SEEDING).
- APPLY 0-20-20 FERTILIZER AT THE RATE OF 600 LBS. PER ACRE HARROW OR DISC LINE AND 0-20-20 FERTILIZER INTO THE SOIL TO A MINIMUM DEPTH OF 3" LAHNS OR HIGH MAINTENANCE AREAS WILL BE DRAGGED AND LEVELED WITH A YORK RAKE. AT THE TIME OF SEEDING APPLY 400 POUNDS OF 38-0-0 UREAFORM FERTILIZER AND 500 LBS. OF 10-20-20 OR EQUIVALENT FERTILIZER PER ACRE.
- SEED WITH A MIXTURE OF CERTIFIED "MERION" KENTUCKY BLUEGRASS - 40 LBS. PER ACRE; COMMON KENTUCKY BLUEGRASS @ 40 LBS. PER ACRE; RED FESCUE, PENNLAWN OR JAMESTOWN @ 20 LBS. PER ACRE.
- MULCH WITH UNWEATHERED SMALL GRAIN STRAW AT THE RATE OF 1 1/2 TO 2 TONS PER ACRE AND ANCHOR WITH A CUTBACK ASPHALT OR EMULSIFIED ASPHALT AT THE RATE OF 5 GAL. PER 1000 SQ. FT.
- SEED ALL SLOPES WITH A MIXTURE OF CERTIFIED KENTUCKY 31 TALL FESCUE @ 50 LBS. PER ACRE AND INOCULATED KOREAN LESPEDEZA @ 15 LBS. PER ACRE.

SEQUENCE OF CONSTRUCTION

- OBTAIN A GRADING PERMIT.
- INSTALL STABILIZED CONSTRUCTION ENTRANCE.
- INSTALL STRAW BALE DIKE.
- INSTALL SEDIMENT TRAP NO. 1 WITH STONE OUTLET STRUCTURE AND SEED PER TEMPORARY SEEDING NOTES.
- ROUGH GRADE SITE WITHIN LIMIT OF GRADING AND SEED PER TEMPORARY SEEDING NOTES.
- BACKFILL SHALL BE STABILIZED AS PER SEEDING NOTES AS SOON AS WEATHER PERMITS.
- COMPLETE EXCAVATION AND BACKFILL AROUND BUILDING AND STABILIZED PER TEMPORARY SEEDING NOTES.
- FINE GRADE AND PAVE ROADWAY.
- UPON APPROVAL BY THE SOIL CONSERVATION DISTRICT ALL SEDIMENT CONTROL FACILITIES SHALL BE REMOVED.

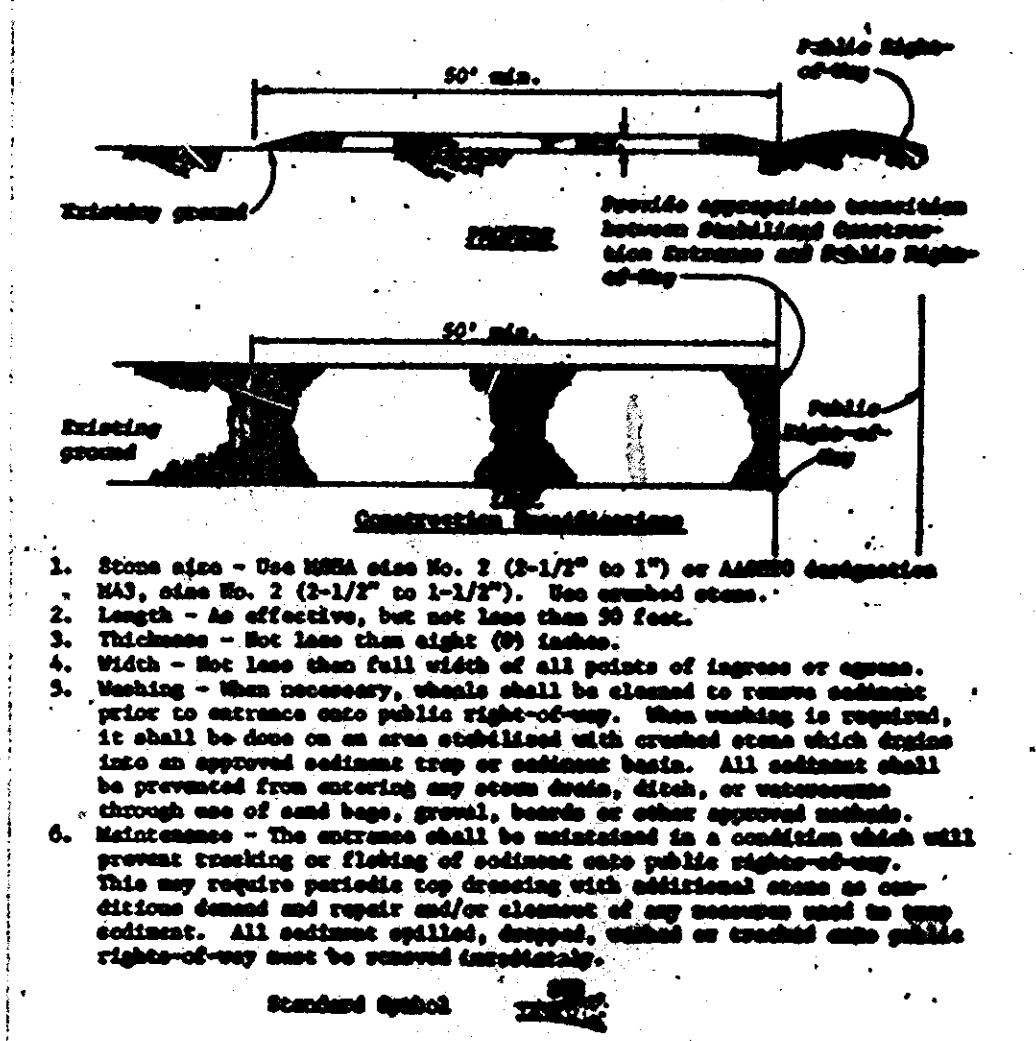

STABILIZED CONSTRUCTION ENTRANCE
No Scale

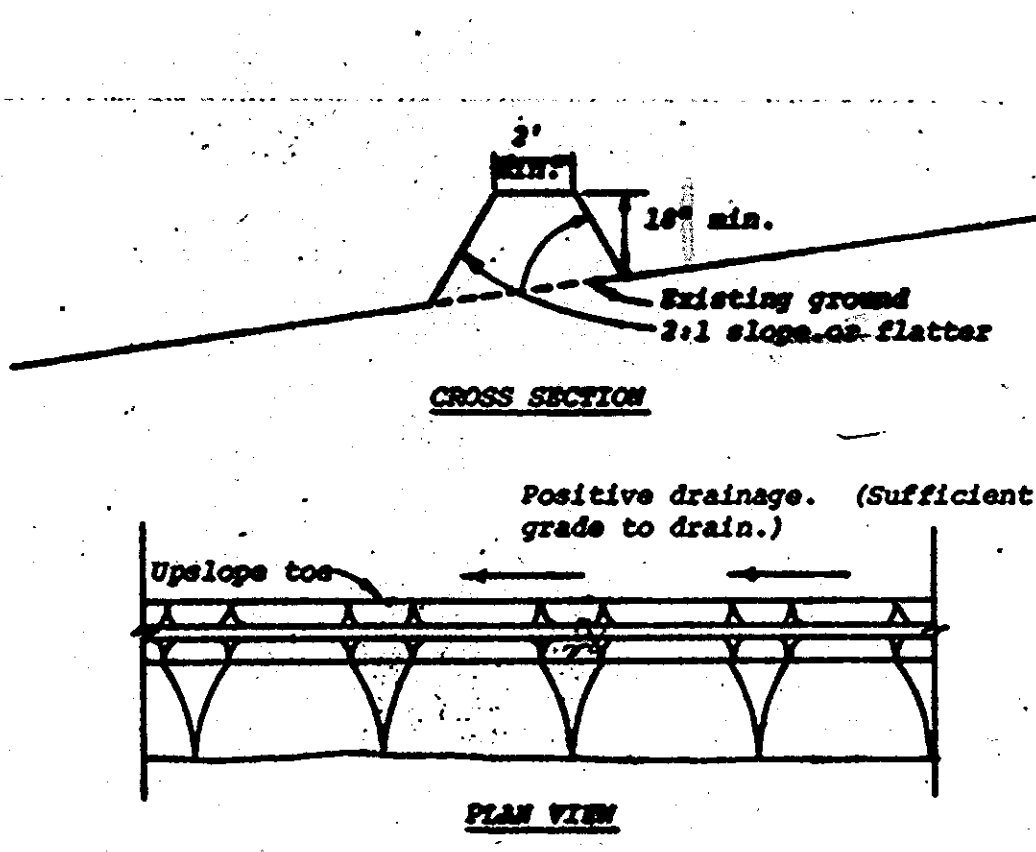

STONE OUTLET STRUCTURE
No Scale

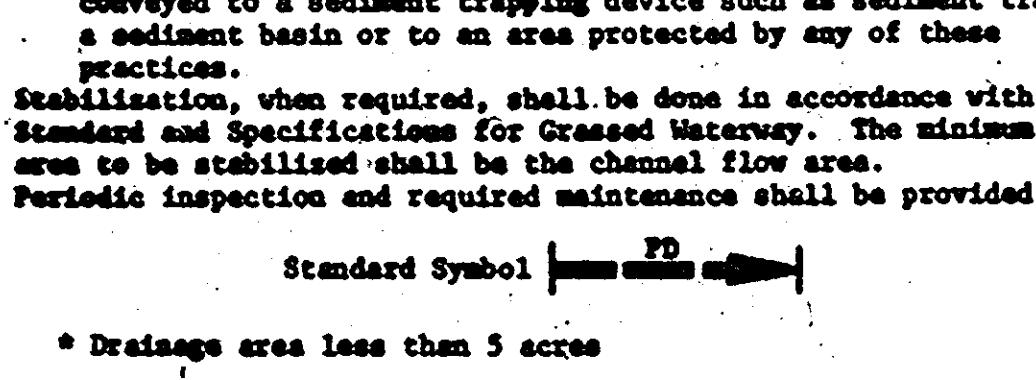

PERIMETER DIKE
No Scale

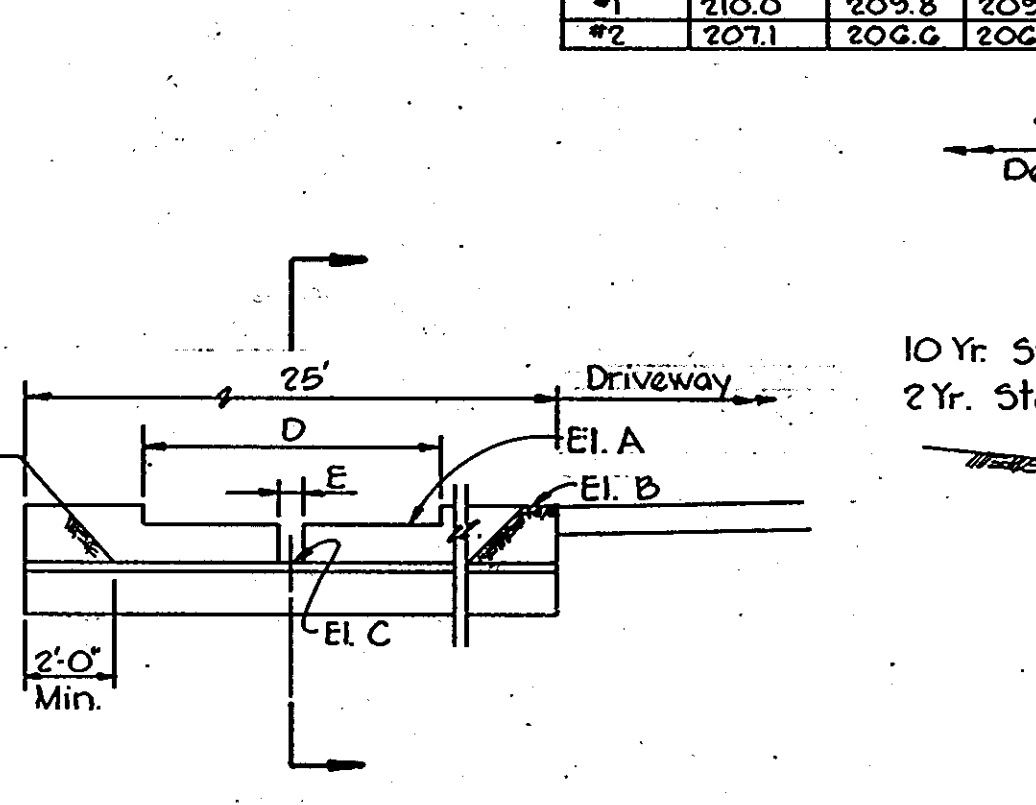

SPILLWAY ELEVATION

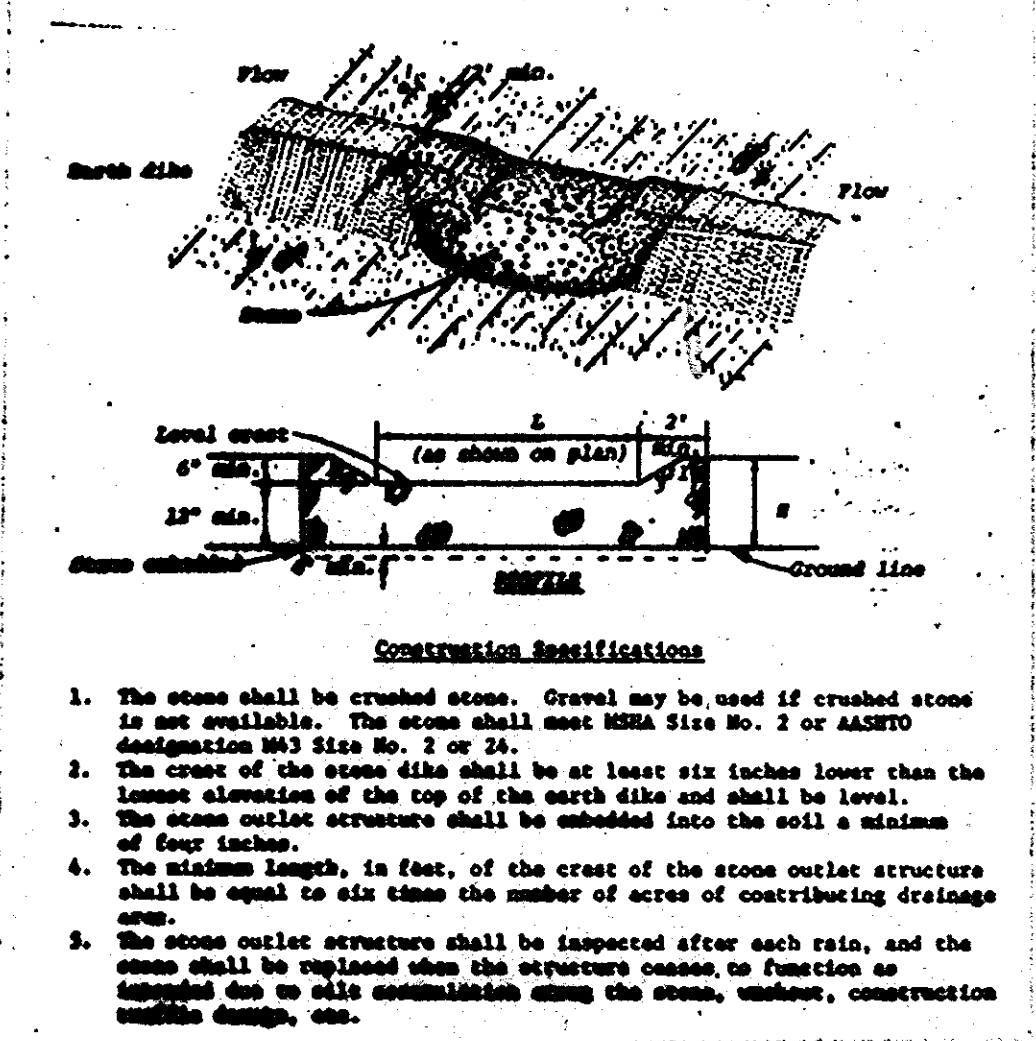

STONE OUTLET STRUCTURE
No Scale

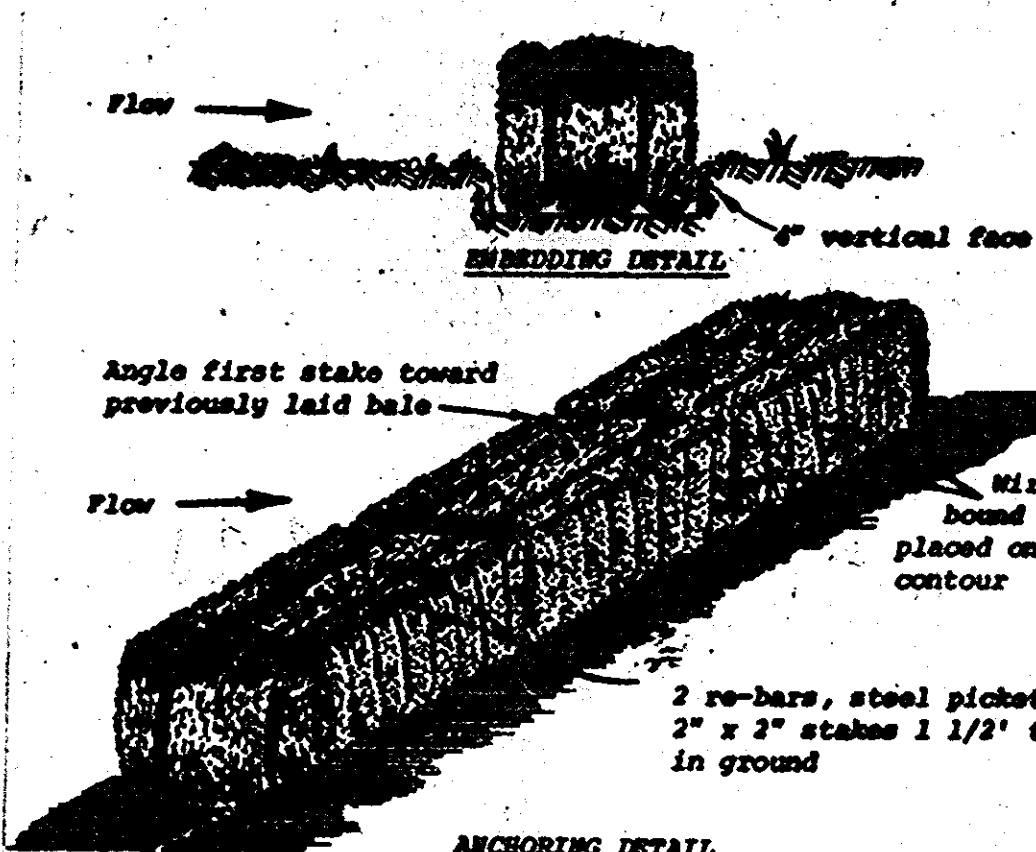

STRAW BALE DIKE
No Scale

SWMF	A	B	C	D	E
#1	210.0	209.8	209.0	3'0"	2'
#2	207.1	206.6	206.1	11"	5'

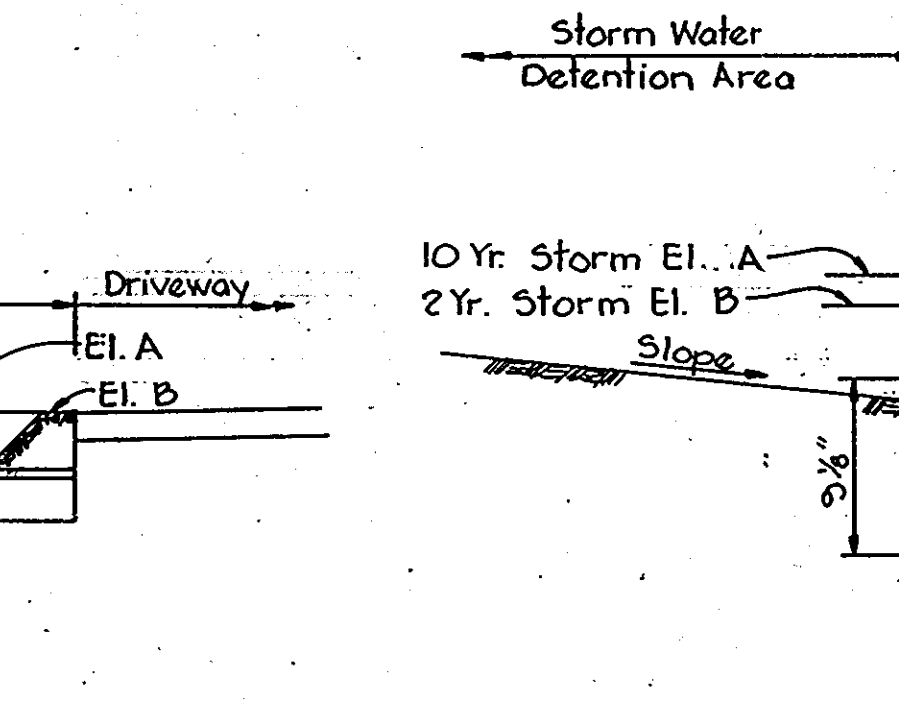

SPILLWAY SECTION

BY THE DEVELOPER:
"I CERTIFY THAT ALL DEVELOPMENT AND/OR CONSTRUCTION WILL BE DONE ACCORDING TO THESE PLANS OF DEVELOPMENT, POND CONSTRUCTION AND EROSION AND SEDIMENT CONTROL. I ALSO AUTHORIZE PERIODIC ON-SITE INSPECTION BY THE HOWARD SOIL CONSERVATION DISTRICT OR THEIR AUTHORIZED AGENTS, AS ARE DEEMED NECESSARY. DEVIATION FROM THIS PLAN WILL NOT BE MADE UNLESS AUTHORIZED BY THE HOWARD SOIL CONSERVATION DISTRICT. I WILL PROVIDE THE HOWARD SOIL CONSERVATION DISTRICT WITH A RED-LINED "AS-BUILT" OF THE POND WITHIN 30 DAYS OF COMPLETION."
W. Richard Smith 9/6/79
SIGNATURE OF DEVELOPER DATE

BY THE ENGINEER:
"I CERTIFY THAT THIS PLAN FOR POND CONSTRUCTION, EROSION, AND SEDIMENT CONTROL REPRESENTS A PRACTICAL AND WORKABLE PLAN BASED ON MY PERSONAL KNOWLEDGE OF THE SITE CONDITIONS. THIS PLAN WAS PREPARED IN ACCORDANCE WITH THE REQUIREMENTS OF THE HOWARD SOIL CONSERVATION DISTRICT. I HAVE NOTIFIED THE DEVELOPER THAT HE MUST PROVIDE THE HOWARD SOIL CONSERVATION DISTRICT WITH A RED-LINED "AS-BUILT" OF THE POND WITHIN 30 DAYS OF COMPLETION."
James K. Jolly 9-17-79
SIGNATURE OF ENGINEER DATE

THESE PLANS HAVE BEEN REVIEWED FOR THE HOWARD SOIL CONSERVATION DISTRICT AND MEET THE TECHNICAL REQUIREMENTS FOR SMALL POND CONSTRUCTION, SOIL EROSION AND SEDIMENT CONTROL.

U.S. SOIL CONSERVATION SERVICE DATE

THIS DEVELOPMENT PLAN IS APPROVED FOR SOIL EROSION AND SEDIMENT CONTROL BY THE HOWARD SOIL CONSERVATION DISTRICT

APPROVED William V. Rouse 9/2/79
HOWARD S.C.D. DATE

APPROVED: HOWARD COUNTY OFFICE OF PLANNING AND ZONING.

Thomas A. Smith 10-23-79
PLANNING DIRECTOR DATE

Shawn M. ... 10-22-79
CHIEF, DIVISION OF LAND DEVELOPMENT DATE

THESE PLANS FOR SMALL POND CONSTRUCTION, SOIL EROSION AND SEDIMENT CONTROL MEET THE REQUIREMENTS OF THE HOWARD SOIL CONSERVATION DISTRICT.

APPROVED: HOWARD S.C.D. DATE

PLAN NUMBER

REVIEWED FOR Howard NAME S.C.D.

AND MEETS TECHNICAL REQUIREMENTS

James M. ... 9-27-79
SIGNATURE DATE
U.S. SOIL CONSERVATION SERVICE

DATE NO. REVISION

OWNER/DEVELOPER
W. RICHARD SMITH
9512 WANDERING WAY
COLUMBIA, MARYLAND 21045

PROJECT: WAREHOUSE SALES AND MARKETING SERVICE INC. 7136 MONTEVIDEO ROAD

AREA: TAX MAP NO. 43 1ST ELECTION DISTRICT HOWARD COUNTY, MARYLAND

TITLE: DRAINAGE AREA MAP STORM WATER MANAGEMENT AND SEDIMENT CONTROL PLAN

Riemer Tracy & Associates, Inc.
6659 Baltimore National Pike
Epcott City, Maryland 21043
(301) 461-2690
Land Planning, Design & Civil Engineering

9-17-79 DATE
DEED NO. 204/93
DESIGNED BY: J.K.T.
DRAWN BY: R.J.W.
PROJECT NO: 1579
DATE: SEPTEMBER 18, 1979
SCALE: 1"=30'
DRAWING NO. 2 OF 2

APPROVED: FOR PUBLIC WATER AND PUBLIC SEWERAGE, STORM DRAINAGE SYSTEMS AND PUBLIC GOODS.
HOWARD COUNTY DEPARTMENT OF PUBLIC WORKS
James F. ... 10-16-79
DIRECTOR DATE
W. O. ... 10-18-79
CHIEF, BUREAU OF ENGINEERING DATE

APPROVED: FOR PUBLIC WATER AND PUBLIC SEWERAGE SYSTEMS; HOWARD COUNTY HEALTH DEPARTMENT
James ... 10-18-79
COUNTY HEALTH OFFICER DATE

