

PREPARED SUBGRADE 95% COMP. DENSITY  
 4" BIT. CONC. BASE COURSE (BAND C-2)  
 1" BIT. CONC. SURFACE COURSE (BAND C-3)  
 5" BIT. PRIME TACK COAT (SECTS. C30-35/C31-4)  
**HOWARD COUNTY BITUMINOUS PAVING**

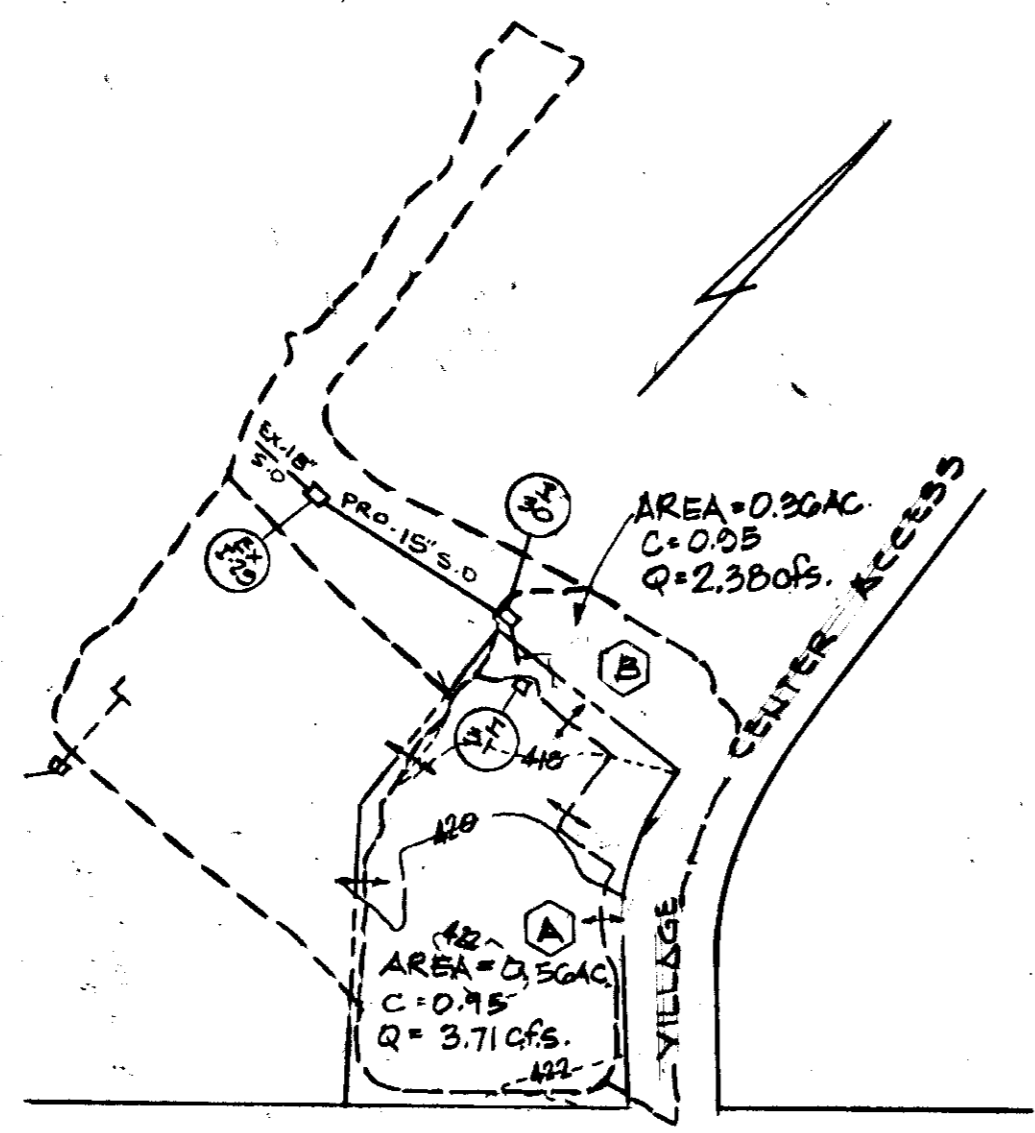

**DRAINAGE AREA MAP**  
 SCALE: 1"=100'

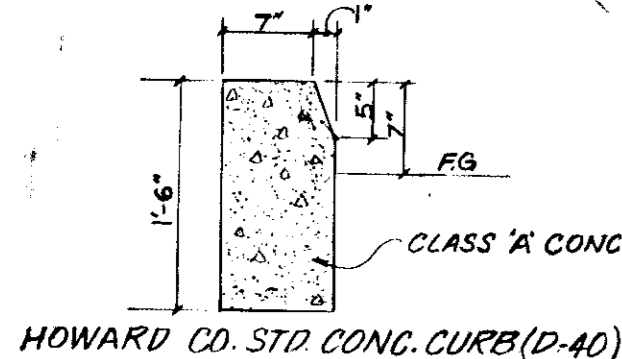
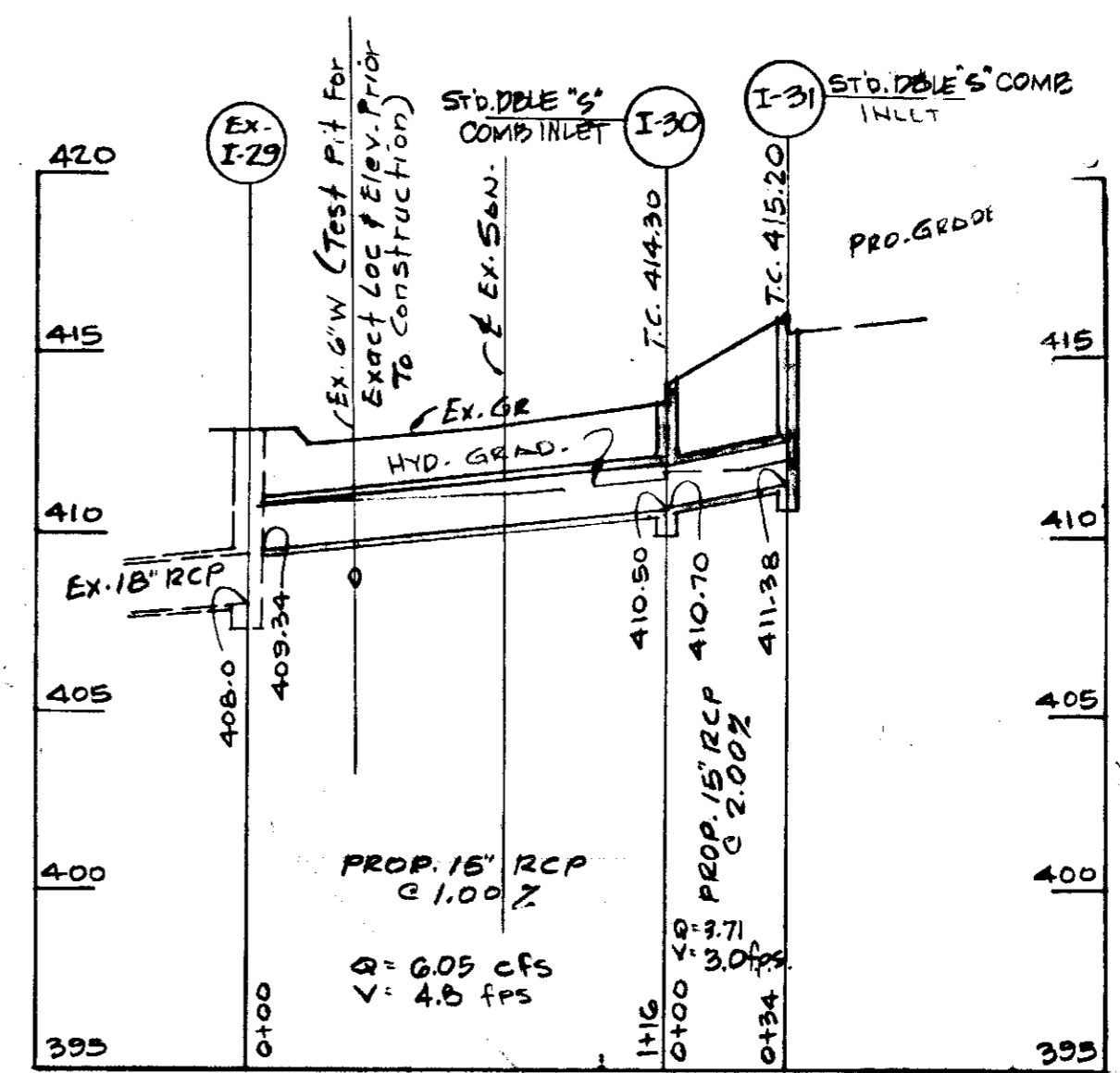

**PROFILE**  
 Scale: Hor. 1"=80', Vert. 1"=10'

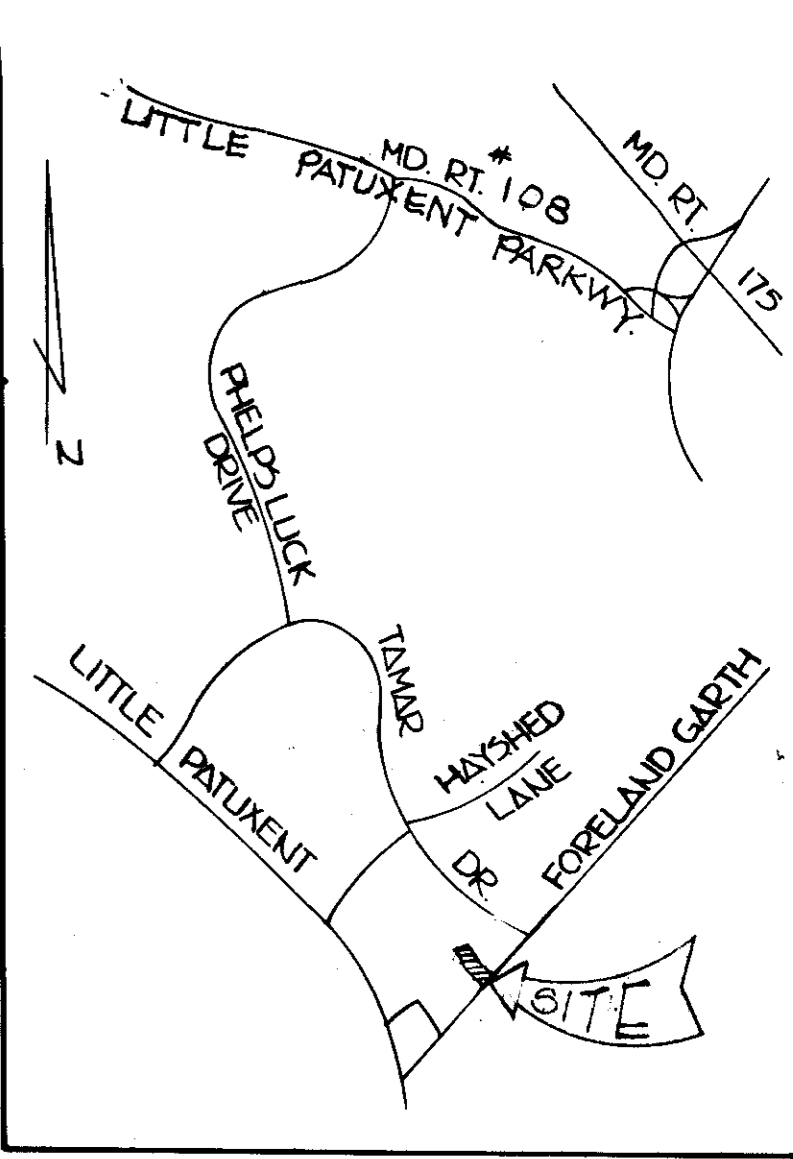

**LOCATION MAP**  
 SCALE: 1"=2000'

**BENCH MARK:**  
 PAINTED BONNET BOLT ON FIRE HYDRANT LOCATED WEST OF VILLAGE CENTER ELEV. 402.65

REVIEWED FOR HOWARD COUNTY SOIL CONSERVATION DISTRICT AND MEETS TECHNICAL REQUIREMENTS.

USE: SOIL CONSERVATION SERVICE DATE:

THIS DEVELOPMENT PLAN IS APPROVED FOR SOIL EROSION AND SEDIMENT CONTROL BY THE HOWARD COUNTY SOIL CONSERVATION DISTRICT.

APPROVED: HOWARD COUNTY SOIL CONSERVATION DIST. DATE:

**ENGINEER'S CERTIFICATE**  
 I CERTIFY THAT THIS PLAN FOR EROSION AND SEDIMENT CONTROL REPRESENTS A PRACTICAL AND WORKABLE PLAN BASED ON MY PERSONAL KNOWLEDGE OF THE SITE CONDITIONS AND THAT IT WAS PREPARED IN ACCORDANCE WITH THE REQUIREMENTS OF THE HOWARD COUNTY SOIL CONSERVATION DISTRICT.

*J. Carroll Hagan* 1-26-79  
 ENGINEER SEAL

**DEVELOPER'S CERTIFICATE & OWNER'S CERTIFICATE**  
 I CERTIFY THAT ALL DEVELOPMENT AND/OR CONSTRUCTION WILL BE DONE IN ACCORDANCE TO THIS PLAN OF DEVELOPMENT AND PLAN FOR EROSION AND SEDIMENT CONTROL, AND I ALSO AUTHORIZE PERIODIC ON-SITE INSPECTION BY THE HOWARD COUNTY SOIL CONSERVATION DISTRICT OR THEIR AUTHORIZED AGENTS, AS MAY BE DEEMED NECESSARY.

*Sparks & Taves* 1-26-79  
 DEVELOPER DATE

APPROVED: FOR PUBLIC WATER, PUBLIC SEWERAGE AND STORM DRAINAGE SYSTEMS AND EREDS

HOWARD COUNTY DEPARTMENT OF PUBLIC WORKS  
*W. F. Newmyer* 3-2-79  
 DIRECTOR DATE

*W. O. Gilbert* 3-1-79  
 CHIEF, BUREAU OF ENGINEERING DATE

APPROVED: FOR PUBLIC WATER AND PUBLIC SEWERAGE SYSTEMS

HOWARD COUNTY HEALTH DEPARTMENT  
*John W. Ford* 3-5-79  
 COUNTY HEALTH OFFICER DATE

APPROVED: HOWARD COUNTY OFFICE OF PLANNING & ZONING  
*Thomas A. Amis* 3-6-79  
 PLANNING DIRECTOR DATE

*John W. Murrellman* 3-6-79  
 CHIEF, DIVISION OF LAND DEVELOPMENT DATE

- TAX MAP: COLUMBIA, VILLAGE OF LONGREACH, SEC. 1, AREA 5, PARCEL 'D' 21/84
- TOTAL LAND AREA - 30,241 ± 0.69 AC.
- EXISTING ZONING - New Town, COMMERCIAL FDR 106
- TOTAL EMPLOYEES - 10
- TOTAL PARKING SPACES REQUIRED - 35 SPACES
- TOTAL PARKING SPACES PROVIDED - 35 SPACES
- TOTAL BUILDING AREA - 2470 Sq. Ft.
- DEED REFERENCE - LIBER 22 FOLIO 84
- MAX. HEIGHT OF ANY STRUCTURE - NONE
- No. OF PROPOSED SEATS - 20

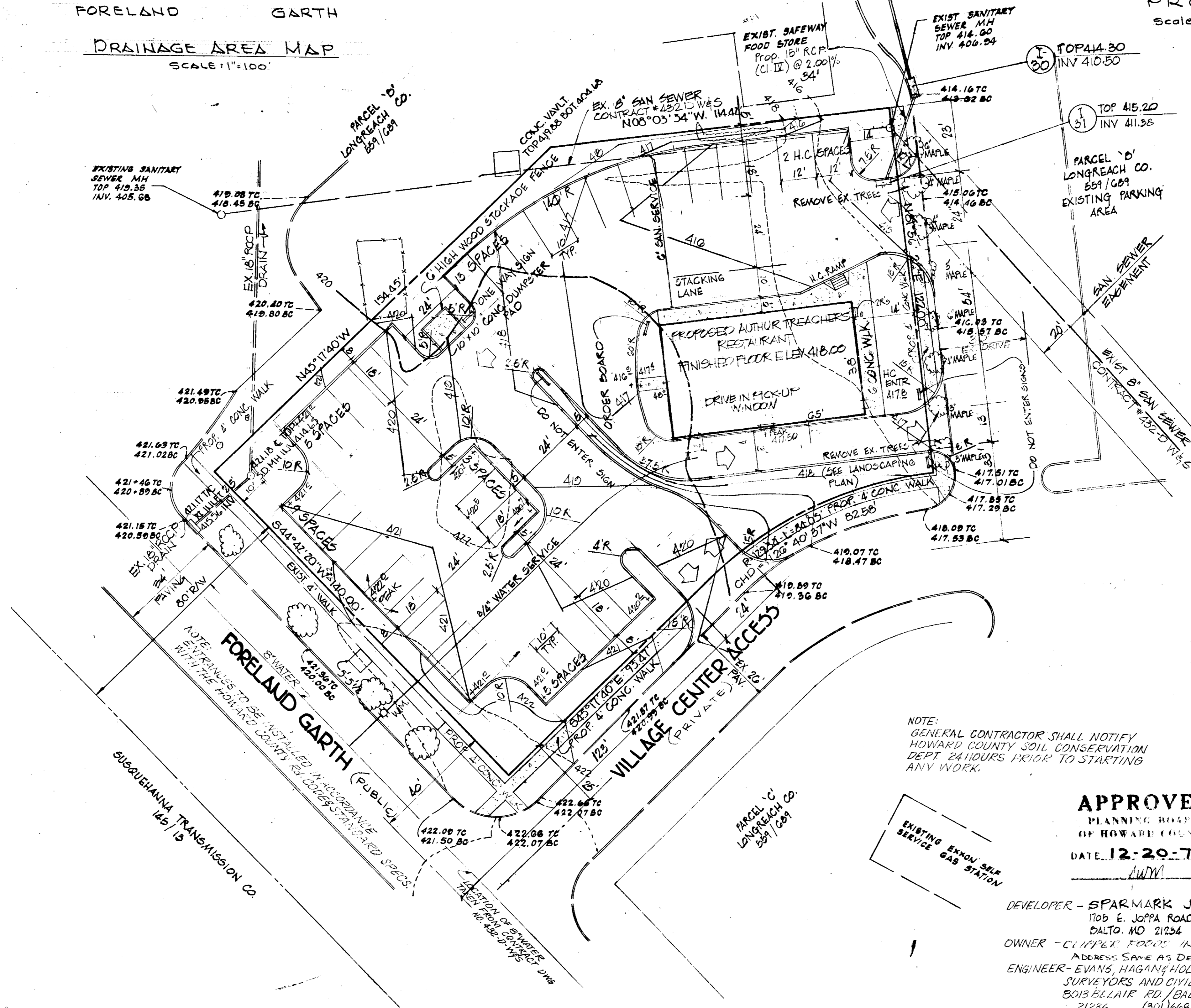

NOTE: SEE LANDSCAPING PLAN FOR PLANTING TYPES AND LOCATIONS

**GENERAL NOTES:**  
 1. ANY DAMAGE TO THE COUNTY-OWNED RIGHT-OF-WAY OR PAVING SHALL BE CORRECTED AT DEVELOPER'S EXPENSE.  
 2. ALL MATERIALS & CONSTRUCTION SHALL BE INSTALLED IN ACCORDANCE WITH THE HOWARD COUNTY CONSTRUCTION CODE & SPECIFICATIONS

NOTE: GENERAL CONTRACTOR SHALL NOTIFY HOWARD COUNTY SOIL CONSERVATION DEPT 24 HOURS PRIOR TO STARTING ANY WORK.

**SITE PLAN**  
**VILLAGE OF LONGREACH**

SECTION 1 AREA 5 PARCEL 'D'  
**PROPOSED ARTHUR TREACHERS**

FOR  
**CLIPPER FOODS INC.**  
 COLUMBIA, HOWARD COUNTY, MARYLAND  
 6TH ELECTION DISTRICT

**APPROVED**  
 PLANNING BOARD  
 OF HOWARD COUNTY  
 DATE: 12-20-78

DEVELOPER - SPARKMARK JOINT VENTURE  
 1705 E. JOPPA ROAD  
 DALTO, MO 21234

OWNER - CLIPPER FOODS INC.  
 ADDRESS SAME AS DEVELOPER

ENGINEER - EVANS, HAGAN & HOLDEFER, INC.  
 SURVEYORS AND CIVIL ENGINEERS  
 8013 BELAIR RD / BALTIMORE MD.  
 21236 (301) 668-1501

REV. DEC. 19, 1978 BLDG. LOG.  
 REV. DEC. 14, 1978 PER COMMENTS  
 REV. DEC. 6, 1978 PER COUNTY COMMENTS  
 REV. NOV. 20, 1978 ADD S.D. DESIGN INFO



**EVANS, HAGAN & HOLDEFER, INC.**  
 Surveyors & Civil Engineers  
 8013 BELAIR ROAD  
 BALTIMORE, MD. 21236

*J. Carroll Hagan*  
 10-19-78 1"=20'

**SEQUENCE OF OPERATIONS**

1. Obtain Grading Permit and notify Howard County Department of Inspection and Permits 24 hrs. prior to start - Phone 992-2435
2. Notify Howard County Soil Conservation District 24 hrs. prior to beginning any work - Phone 465-3180
3. Install and stabilize all sediment control devices
4. Rough grade site and install utilities
5. Building construction
6. Fine grade and stabilize site
7. Remove sediment control devices

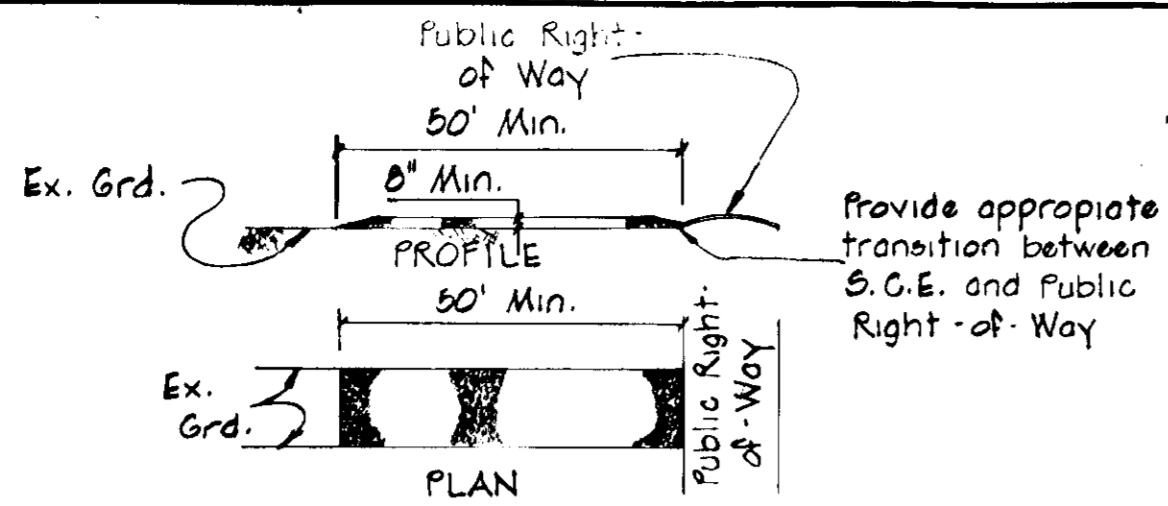

**CONSTRUCTION SPECIFICATIONS**

1. Stone Size - Use MSHA size No 2 (2 1/4" to 1") or AASHTO designation M 43, size No 2 (2 1/2" to 1 1/4"). Use crushed stone.
2. Length - As effective, but not less than 50 feet.
3. Thickness - Not less than eight (8) inches.
4. Width - Not less than full width of all points of ingress or egress.
5. Washing - When necessary, wheels shall be cleaned to remove sediment prior to entrance onto public right-of-way. When washing is required, it shall be done on an area stabilized with crushed stone which drains into an approved sediment trap or sediment basin. All sediment shall be prevented from entering any storm drain, ditch, or watercourse through use of sand bags, gravel, boards or other approved methods.
6. Maintenance - The entrance shall be maintained in a condition which will prevent tracking or flowing of sediment onto public rights-of-way. This may require periodic top dressing with additional stone as conditions demand and repair and/or cleanup of any measures used to trap sediment. All sediment spilled, dropped, washed or tracked onto public rights-of-way must be removed immediately.

**ANCHORING DETAIL**

- CONSTRUCTION SPECIFICATIONS**
1. Bales shall be placed in a row with ends tightly abutting the adjacent bales.
  2. Each bale shall be embedded in the soil a minimum of 4"
  3. Bales shall be securely anchored in place by stakes or re-bars angled toward previously laid bale to force bales together.
  4. Inspection shall be frequent and repair or replacement shall be made promptly as needed.
  5. Bales shall be removed when they served their usefulness so as not to block or impede storm flow or drainage.

**STRAW DALE DIKE**  
Not to Scale

**STABILIZED CONSTRUCTION ENTRANCE**  
Not to Scale

REVIEWED FOR HOWARD COUNTY SOIL CONSERVATION DISTRICT AND MEETS TECHNICAL REQUIREMENTS.

*C. Wayne Ray* 2-13-79  
S.C. SOIL CONSERVATION SERVICE DATE

THIS DEVELOPMENT PLAN IS APPROVED FOR SOIL EROSION AND SEDIMENT CONTROL BY THE HOWARD SOIL CONSERVATION DISTRICT.

*APPROVED* 2-18-79  
HOWARD SOIL CONSERVATION DIST. DATE

ENGINEER'S CERTIFICATE  
I CERTIFY THAT THIS PLAN FOR EROSION AND SEDIMENT CONTROL REPRESENTS A PRACTICAL AND WORKABLE PLAN BASED ON MY PERSONAL KNOWLEDGE OF THE SITE CONDITIONS AND THAT IT WAS PREPARED IN ACCORDANCE WITH THE REQUIREMENTS OF THE HOWARD SOIL CONSERVATION DISTRICT.

*J. Carroll Hagan* 12/6/79  
ENGINEER SEAL



DEVELOPER'S CERTIFICATE & OWNER'S CERTIFICATE  
I CERTIFY THAT ALL DEVELOPMENT AND/OR CONSTRUCTION WILL BE DONE AS SHOWN ON THIS PLAN OF DEVELOPMENT AND PLAN FOR EROSION AND SEDIMENT CONTROL, AND I ALSO AUTHORIZE PERIODIC ON SITE INSPECTION BY THE HOWARD SOIL CONSERVATION DISTRICT FOR THEIR AUTHORIZED AGENTS, AS MAY BE DEEMED NECESSARY.

*APPROVED* 1-26-79  
DEVELOPER DATE

APPROVED: FOR PUBLIC WATER, PUBLIC SEWERAGE AND STORM DRAINAGE SYSTEMS AND ROADS

*APPROVED* 3/2/77  
HOWARD COUNTY DEPARTMENT OF PUBLIC WORKS DIRECTOR DATE

*APPROVED* 3-1-77  
CHIEF BUREAU OF ENGINEERING DATE

APPROVED: FOR PUBLIC WATER AND PUBLIC SEWERAGE SYSTEMS

*APPROVED* 3-5-77  
HOWARD COUNTY HEALTH DEPARTMENT COUNTY HEALTH OFFICER DATE

*APPROVED* 3-6-77  
HOWARD COUNTY OFFICE OF PLANNING AND ZONING PLANNING DIRECTOR DATE

*APPROVED* 3-6-77  
CHIEF, DIVISION OF LAND DEVELOPMENT DATE

1. TAX MAP - COLUMBIA, VILLAGE OF LONGREACH, SEC. 1, AREA 5, PARCEL 'D', 22/84
2. TOTAL LAND AREA - 30,241 +/- 0.694 AC.
3. EXISTING ZONING - NEW TOWN, COMMERCIAL F.D.R. 10G
4. TOTAL EMPLOYEES - 10
5. TOTAL PARKING SPACES REQUIRED - 35 SPACES
6. TOTAL PARKING SPACES PROVIDED - 35 SPACES
7. TOTAL BUILDING AREA - 1470 SQ. FT.
8. DEED REFERENCE - LIBER 22 FOLIO 84
9. MAX. HEIGHT OF ANY STRUCTURE - NONE
10. No. OF PROPOSED SETS - 90

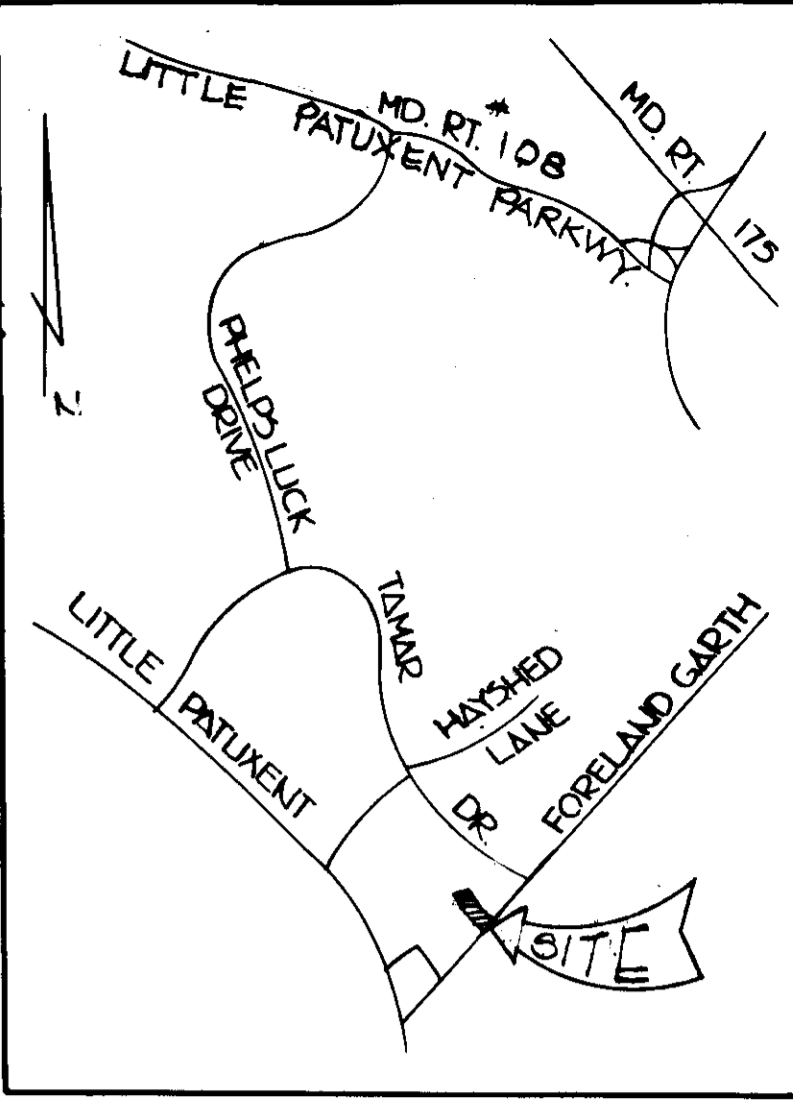

LOCATION MAP  
SCALE 1" = 2000'

**BENCH MARK:**  
PAINTED BONNET BOLT ON FIRE HYDRANT LOCATED WEST OF VILLAGE CENTER ELEV. 402.68

**SEDIMENT CONTROL NOTES**

1. Refer to U.S.D.A. Soil Conservation Standards and Specifications for Soil Erosion and Sediment Control in Developing Areas, for standard details and detailed specifications of each practice specified herein.
2. During the layout of Sediment Control Practices required on this plan, minor field adjustments can and will be made to insure the arrest and control of any sediment before it leaves the construction site. Sediment Control Practices changes require prior approval of the Sediment Control Inspector in the Howard County Soil Conservation District.
3. At the end of each working day, Sediment Control Practices will be inspected and left in operational condition.
4. On graded or cleared areas which are not stabilized within 6 months the contractor must seed and mulch in accordance with Section III - Standards and Specifications for Soil Erosion and Sediment Control in Developing Areas.

TOTAL AREA OF SITE = 0.69 +/- Acres  
TOTAL DISTURBED AREA = 0.69 +/- Acres

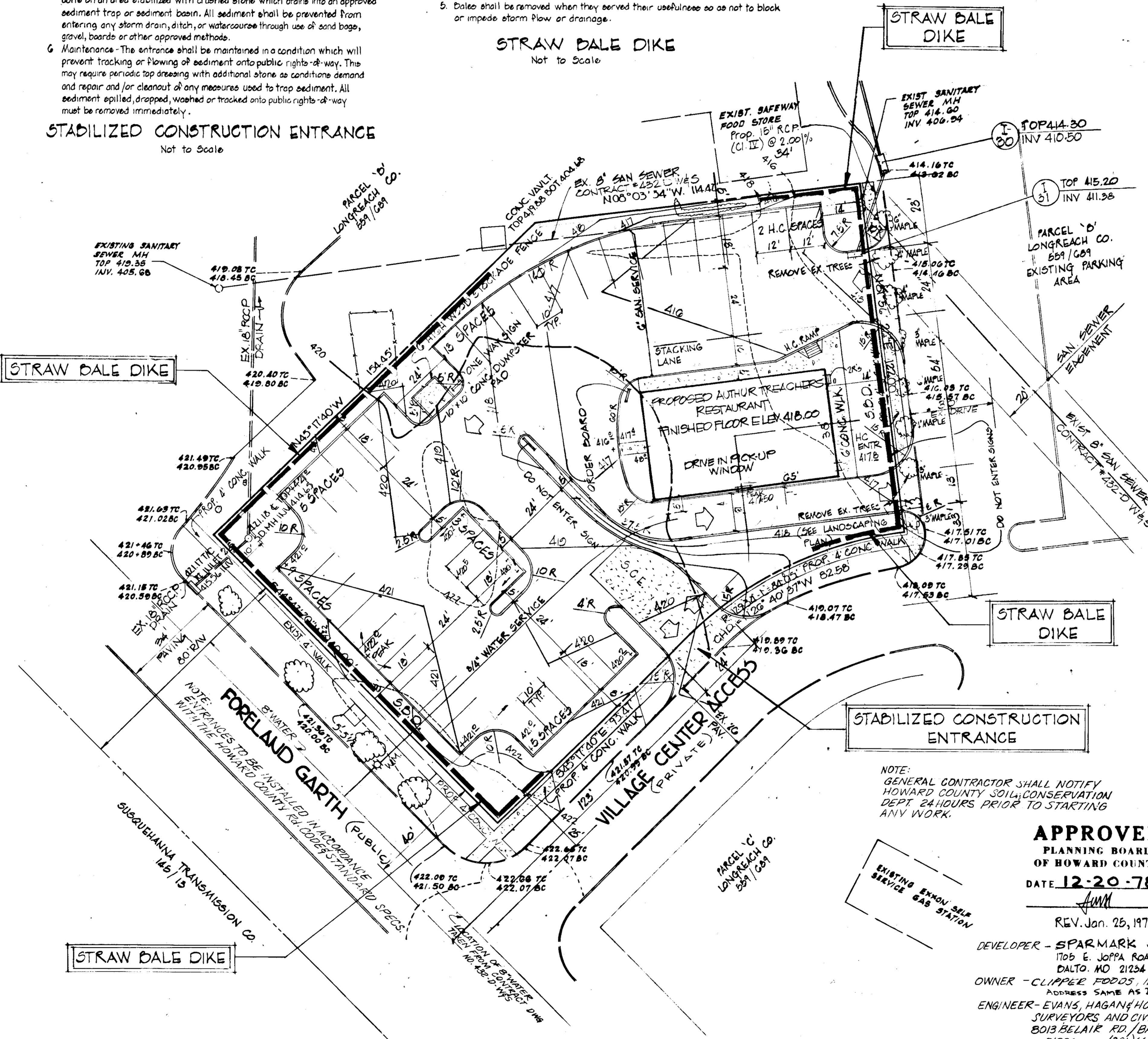

**STRAW DALE DIKE**

**STABILIZED CONSTRUCTION ENTRANCE**

NOTE:  
GENERAL CONTRACTOR SHALL NOTIFY HOWARD COUNTY SOIL CONSERVATION DEPT. 24 HOURS PRIOR TO STARTING ANY WORK.

**APPROVED**  
PLANNING BOARD OF HOWARD COUNTY  
DATE 12-20-78

REV. Jan. 25, 1979 Grading & Sediment Cont.

DEVELOPER - SPARKMARK JOINT VENTURE  
1705 E. JOFFA ROAD  
DALTO, MD 21254  
OWNER - CLIPPER FOODS, INC.  
ADDRESS SAME AS DEVELOPER  
ENGINEER - EVANS, HAGAN & HOLDEFER, INC.  
SURVEYORS AND CIVIL ENGINEERS  
8013 BELAIR RD., BALTIMORE MD.  
21236 (301) 668-1501

**SEDIMENT CONTROL PLAN**  
**VILLAGE OF LONGREACH**

**SECTION 1 AREA 5 PARCEL 'D'**  
**PROPOSED ARTHUR TREACHERS**

FOR  
**CLIPPER FOODS INC.**  
COLUMBIA, HOWARD COUNTY, MARYLAND  
6TH ELECTION DISTRICT

REV. DEC. 19, 1978 BLDG. LOG.  
REV. DEC. 14, 1978 PER COMMENTS  
REV. DEC. 6, 1978 PER COUNTY COMMENTS  
REV. Nov. 20, 1978 ADD S.D. DESIGN INFO

EVANS, HAGAN & HOLDEFER, INC.  
SURVEYORS AND CIVIL ENGINEERS  
8013 BELAIR ROAD / BALTIMORE, MD. 21236  
(301) 668-1501  
*J. Carroll Hagan*  
DATE 10-19-78 SCALE 1" = 20'



PREPARED SUBGRADE 95% COMP DENSITY  
 4 BIT CONG. BASE COURSE (BAND C-2)  
 1 BIT CONG. SURFACE COURSE (BAND C-3)  
 BIT PRIMER TACK COAT (SECTS. C30-3234)  
 HOWARD COUNTY BITUMINOUS PAVING

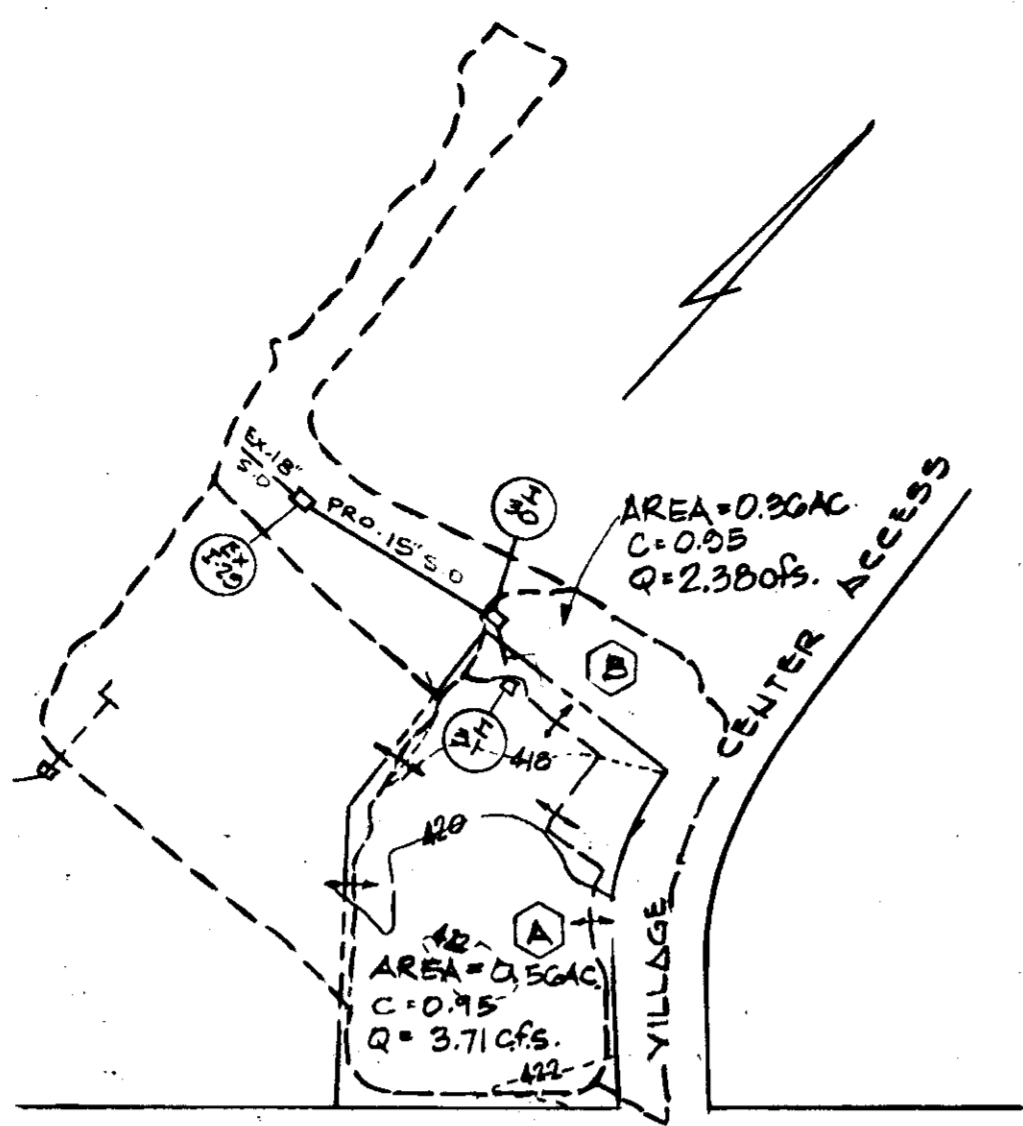
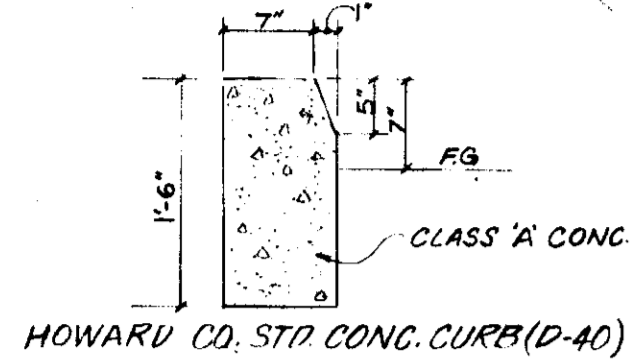

FORELAND GARTH  
 DRAINAGE AREA MAP  
 SCALE: 1"=100'

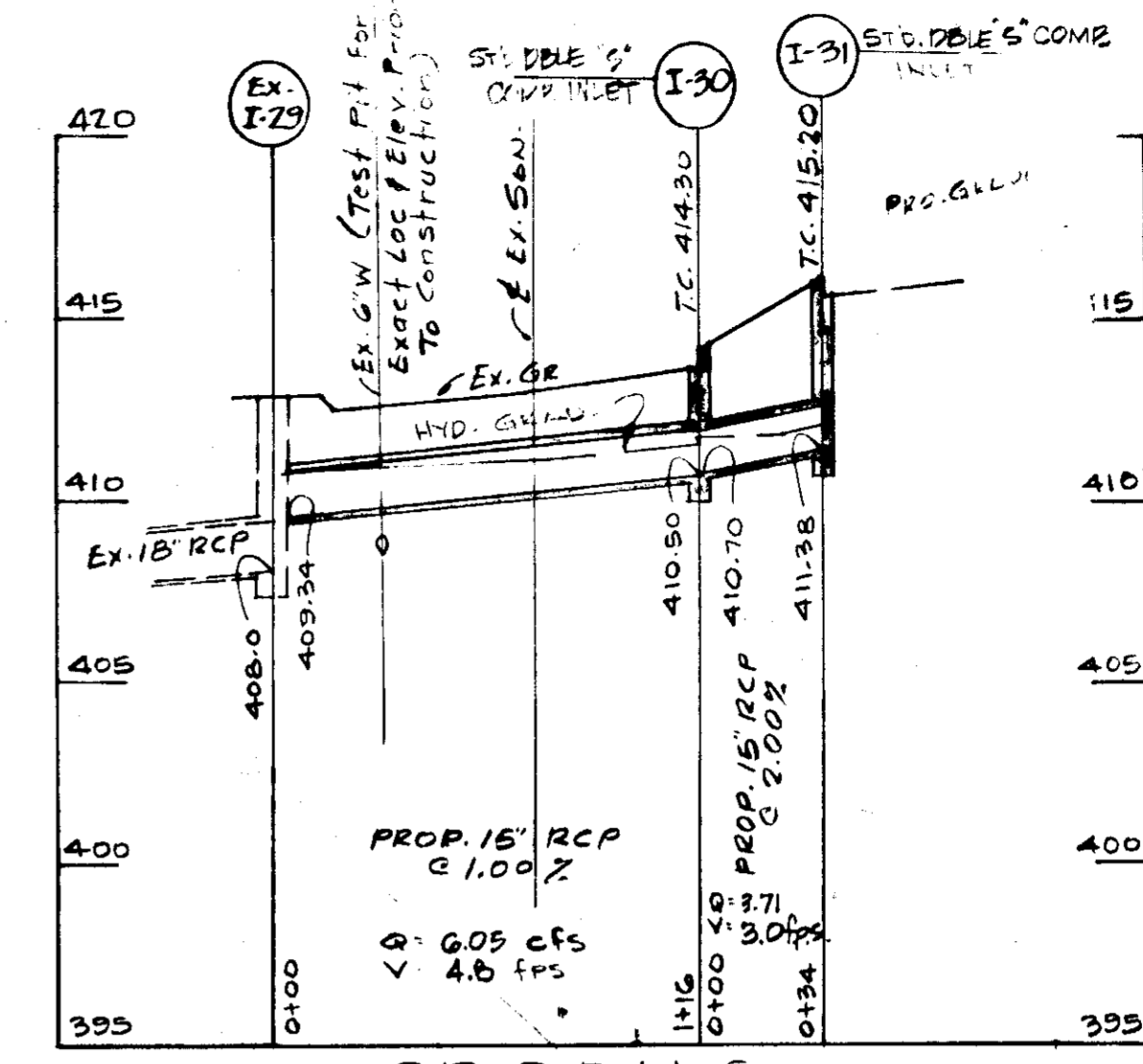

PROFILE  
 Scale: Hor. 1"=50'  
 Vert. 1"=5'

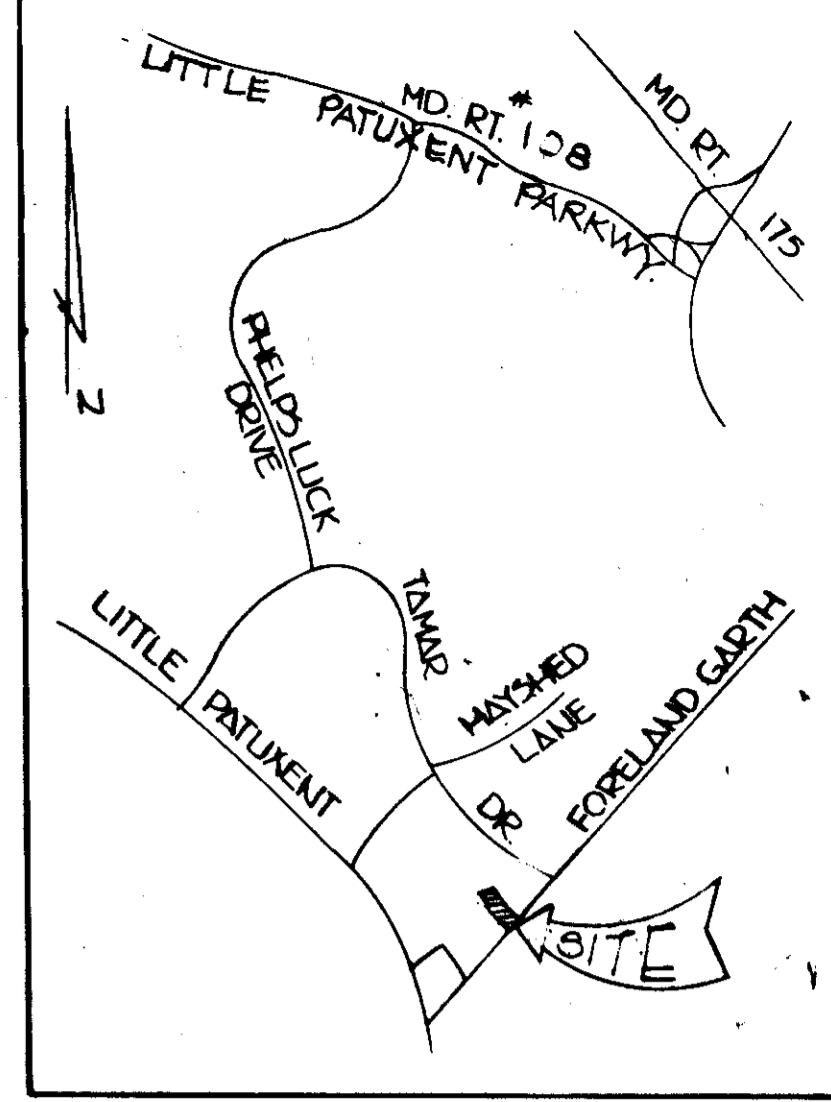

LOCATION MAP  
 SCALE: 1"=2000'

**BENCH MARK:**  
 PAINTED BONNET BOLT ON FIRE  
 HYDRANT LOCATED WEST OF  
 VILLAGE CENTER  
 ELEV. 402.68

REVIEWED FOR HOWARD COUNTY SOIL CONSERVATION DISTRICT  
 AND MEETS TECHNICAL REQUIREMENTS.

BY SOIL CONSERVATION SERVICE DATE

THIS DEVELOPMENT PLAN IS APPROVED FOR SOIL  
 EROSION AND SEDIMENT CONTROL BY THE  
 HOWARD COUNTY SOIL CONSERVATION DISTRICT.

APPROVED  
 HOWARD COUNTY SOIL CONSERVATION DIST. DATE

**ENGINEER'S CERTIFICATE**  
 I CERTIFY THAT THIS PLAN FOR EROSION AND SEDIMENT  
 CONTROL REPRESENTS A PRACTICAL AND WORKABLE  
 PLAN BASED ON MY PERSONAL KNOWLEDGE OF THE  
 SITE CONDITIONS AND THAT IT WAS PREPARED IN  
 ACCORDANCE WITH THE REQUIREMENTS OF THE  
 HOWARD COUNTY SOIL CONSERVATION DISTRICT.

*Harold Hagan* 1-26-79  
 ENGINEER SEAL DATE

**DEVELOPER'S CERTIFICATE & OWNER'S CERTIFICATE**  
 I CERTIFY THAT ALL DEVELOPMENT AND/OR  
 CONSTRUCTION WILL BE DONE ACCORDING TO  
 THIS PLAN OF DEVELOPMENT AND PLAN FOR EROSION  
 AND SEDIMENT CONTROL, AND I ALSO AUTHORIZE  
 PERIODIC ON SITE INSPECTION BY THE HOWARD  
 COUNTY SOIL CONSERVATION DISTRICT OR THEIR AUTHORIZED  
 AGENTS, AS ADE QUERED NECESSARY.

*James L. Davis* 1-26-79  
 DEVELOPER DATE

APPROVED: FOR PUBLIC WATER, PUBLIC SEWERAGE AND  
 STORM DRAINAGE SYSTEMS AND ROADS

HOWARD COUNTY DEPARTMENT OF PUBLIC WORKS

*George F. Nummy* 3-2-79  
 DIRECTOR DATE

*W. O. LaMont* 3-1-79  
 CHIEF, BUREAU OF ENGINEERING DATE

APPROVED: FOR PUBLIC WATER AND PUBLIC  
 SEWERAGE SYSTEMS

HOWARD COUNTY HEALTH DEPARTMENT

*Sam Bogdans* 3-5-79  
 CHIEF, HEALTH OFFICE DATE

APPROVED: HOWARD COUNTY OFFICE OF  
 PLANNING AND ZONING

*Donald Harris* 3-6-79  
 PLANNING DIRECTOR DATE

*John W. Munneman* 3-6-79  
 CHIEF, DIVISION OF LAND DEVELOPMENT DATE

1. SITE: LITTLE PATUXENT, VILLAGE OF LONGREACH, SEC. AREA 5, PARCEL 'D', C-34
2. TOTAL LAND AREA - 30,241 sq. ft. = 0.694 AC.
3. EXISTING ZONING - New Town, Commercial EDR 100
4. TOTAL EMPLOYEES - 10
5. TOTAL PARKING SPACES REQUIRED - 35 Spaces
6. TOTAL PARKING SPACES PROVIDED - 35 SPACES
7. TOTAL BUILDING AREA - 2410 sq. ft.
8. D.S.D. REFERENCE - 1984 22 FOLIO B-1
9. MAX HEIGHT OF ANY STRUCTURE - NONE
10. No. OF PROPOSED TREES - 90

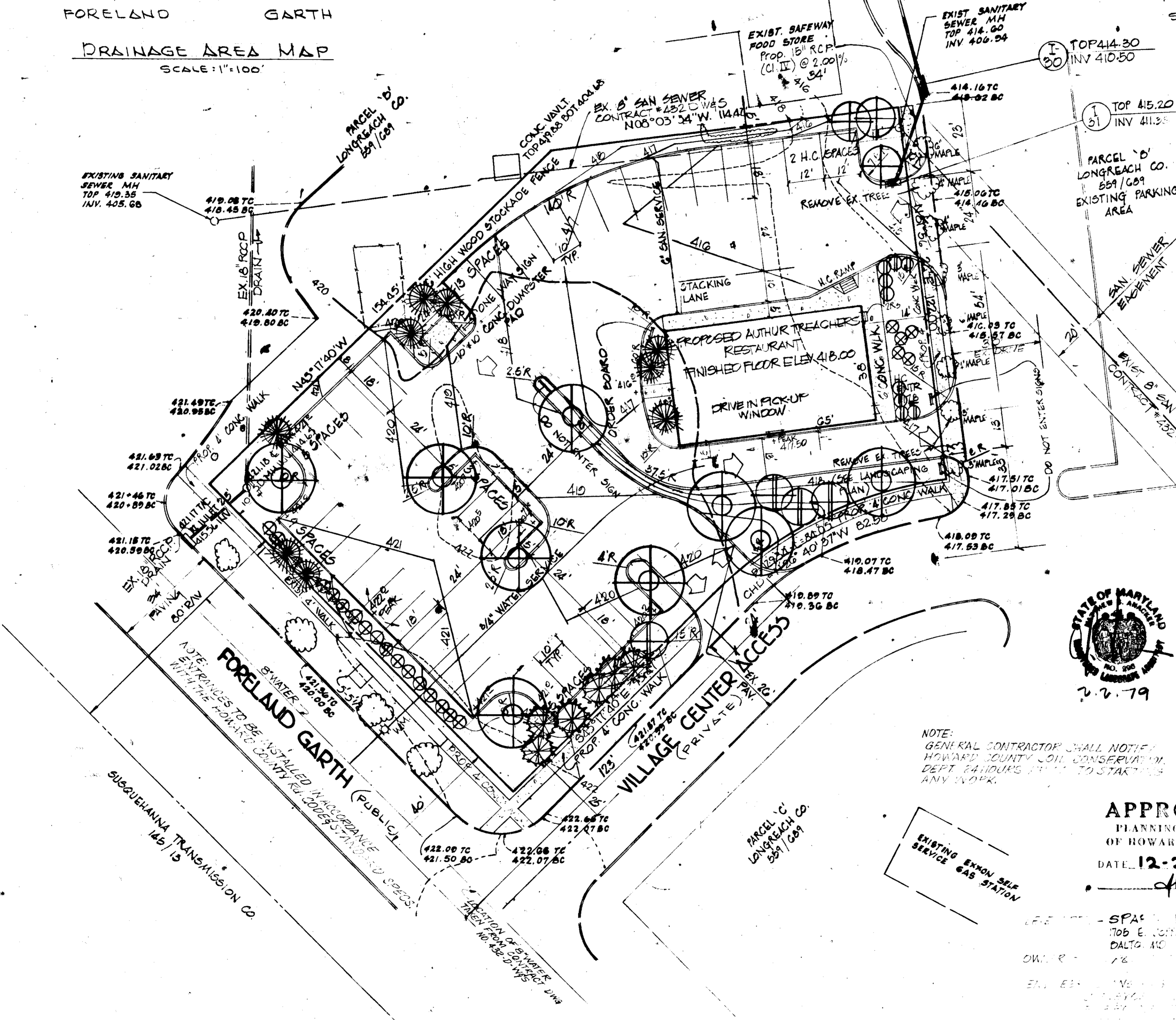

- PLANT LIST**
- 5 ACER RUBRUM 10-12' HT. 2 1/2" - 3" CAL. 12-14" HT. B&B FULL HEADS
  - 4 PLATANUS ACERIFOLIA 10-12' HT. 2 1/2" - 3" CAL. 12-14" HT. B&B FULL HEADS
  - 3 MALUS EPIPICTA 8-10' HT. B&B FULL HEADS
  - 4 MALUS ROYALTY 8-10' HT. B&B FULL HEADS
  - 6 PINUS NIRA 6-8' HT. B&B FULL HEADS
  - 9 PINUS STROBUS 6-8' HT. B&B FULL HEADS
  - 7 EUONYMUS ALATUS 15-18' HT. B&B FULL HEADS
  - 9 EUONYMUS ALATUS 15-18' HT. B&B FULL HEADS

**NOTE:**  
 CONTRACTOR RESERVES THE RIGHT TO SUBSTITUTE PLANT MATERIAL  
 BASED ON AVAILABILITY.  
 CONTRACTOR RESERVES THE RIGHT TO RELOCATE ALL PROPOSED  
 PLANT MATERIAL BASED ON FIELD CONDITIONS, I.E. UNDERGROUND  
 UTILITIES, ETC.

**GENERAL NOTES:**  
 1. ANY DAMAGE TO THE COUNTY OWNED RIGHT-OF-WAY  
 OR PAVING SHALL BE CORRECTED AT DEVELOPER'S  
 EXPENSE.  
 2. ALL MATERIALS & CONSTRUCTION SHALL BE INSTALLED  
 IN ACCORDANCE WITH THE HOWARD COUNTY CONSTRUCTION  
 CODE & SPECIFICATIONS

**NEU-VALEY NURSERY**  
 6280 WASHINGTON BLVD., ELK RIDGE, MD. 21227. TEL: 301-796-4195



# PLANTING PLAN VILLAGE OF LONGREACH

SECTION 1 AREA 5 PARCEL 'D'  
**PROPOSED ARTHUR TREACHERS**

FOR  
**CLIPPER FOODS INC.**  
 COLUMBIA, HOWARD COUNTY, MARYLAND  
 6<sup>TH</sup> ELECTION DISTRICT

APPROVED  
 PLANNING BOARD  
 OF HOWARD COUNTY  
 DATE: 12-20-78  
*AMM*

REV. DEC. 19, 1978 BLDG. LOC.  
 REV. DEC. 14, 1978 PER COMMENTS  
 REV. DEC. 6, 1978 PER COUNTY COMMENTS  
 REV. Nov 20, 1978 ALL S.D. DESIGN INF.

EVANS, HAGAN & HOLDEFER, INC.  
 Surveyors & Civil Engineers  
 8013 BELAIR ROAD  
 BALTIMORE, MD. 21236



OWNER: CLIPPER FOODS INC. JOINT VENTURE  
 706 E. COLTIA ROAD  
 DALTON, MD. 21034

DATE: 12-20-78

DESIGNER: EVANS, HAGAN & HOLDEFER, INC.  
 8013 BELAIR ROAD  
 BALTIMORE, MD. 21236