

Note: Use Residential Driveway Entrance, Howard Co. Std. Dwg. D-34, pg. 89, except where driveway abuts Modified Comb. Curb & Gutter.

Note: Materials and Construction shall be in accordance with Howard Co. Road Construction Code.

EDWARD J. WERTZ
F 110
L 386

DRIVEWAY ABUTTING MODIFIED COMB CURB & GUTTER

No Scale

LEGEND:

- 1 Contour Interval 2 Ft.
- 2 Existing Contour
- 3 Proposed Contour
- 4 Spot Elevation
- 5 Direction of Drainage
- 6 Walk out Basement

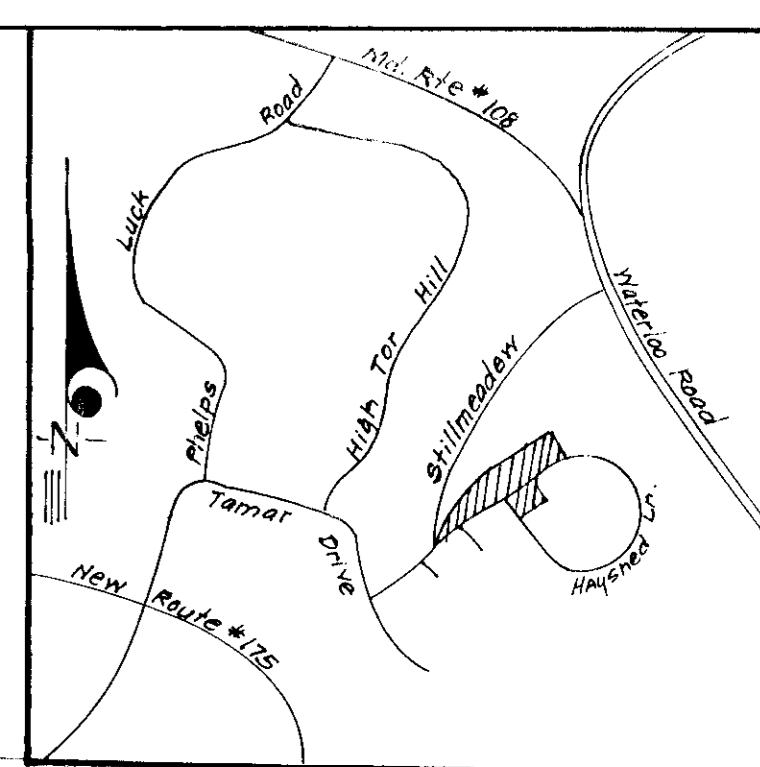

VICINITY MAP
Scale: 1"=2000'

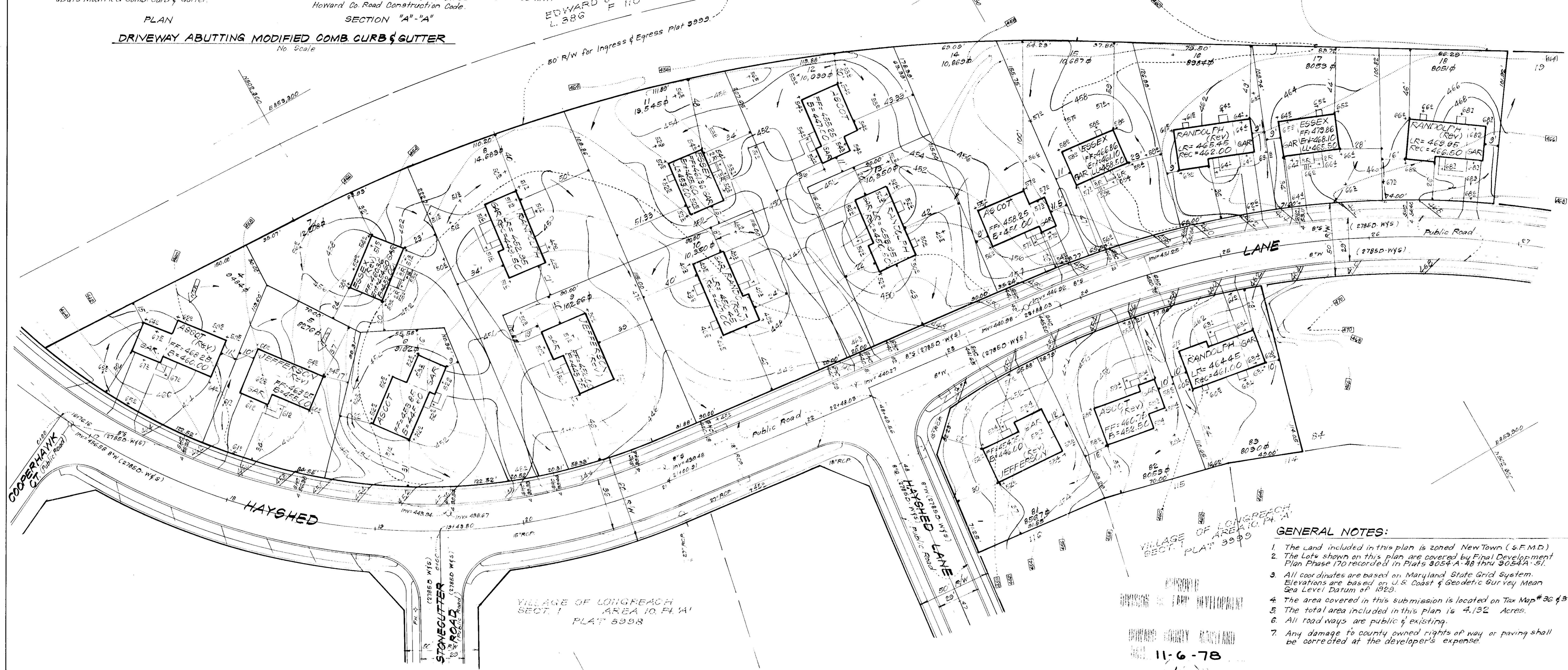

GENERAL NOTES:

1. The land included in this plan is zoned New Town (S.F.M.D).
2. The Lots shown on this plan are covered by Final Development Plan Phase 170 recorded in Plats 3054-A, B thru 3054-A-51.
3. All coordinates are based on Maryland State Grid System. Elevations are based on U.S. Coast & Geodetic Survey Mean Sea Level Datum of 1929.
4. The area covered in this submission is located on Tax Map # 36 & 37.
5. The total area included in this plan is 4.132 Acres.
6. All road ways are public & existing.
7. Any damage to county owned rights of way or paving shall be corrected at the developer's expense.

VILLAGE OF LONGREACH
SECTION I AREA 10 PLAT 3999

11-6-78

Note: For Bearings and Distances for Individual Lot Lines, See Record Plat Recorded as Plats 3998 & 3999

APPROVED FOR PUBLIC WATER AND PUBLIC SEWERAGE SYSTEMS,
HOWARD COUNTY HEALTH DEPARTMENT
James Jones 12-11-78
DATE

APPROVED HOWARD COUNTY OFFICE OF PLANNING & ZONING
PLANNING DIRECTOR
Richard E. Freudenberger 12/5/78
DATE

APPROVED FOR PUBLIC WATER AND PUBLIC SEWERAGE,
STORM DRAINAGE SYSTEMS AND PUBLIC ROADS
HOWARD COUNTY DEPARTMENT OF PUBLIC WORKS
Richard E. Freudenberger 12/5/78
DATE

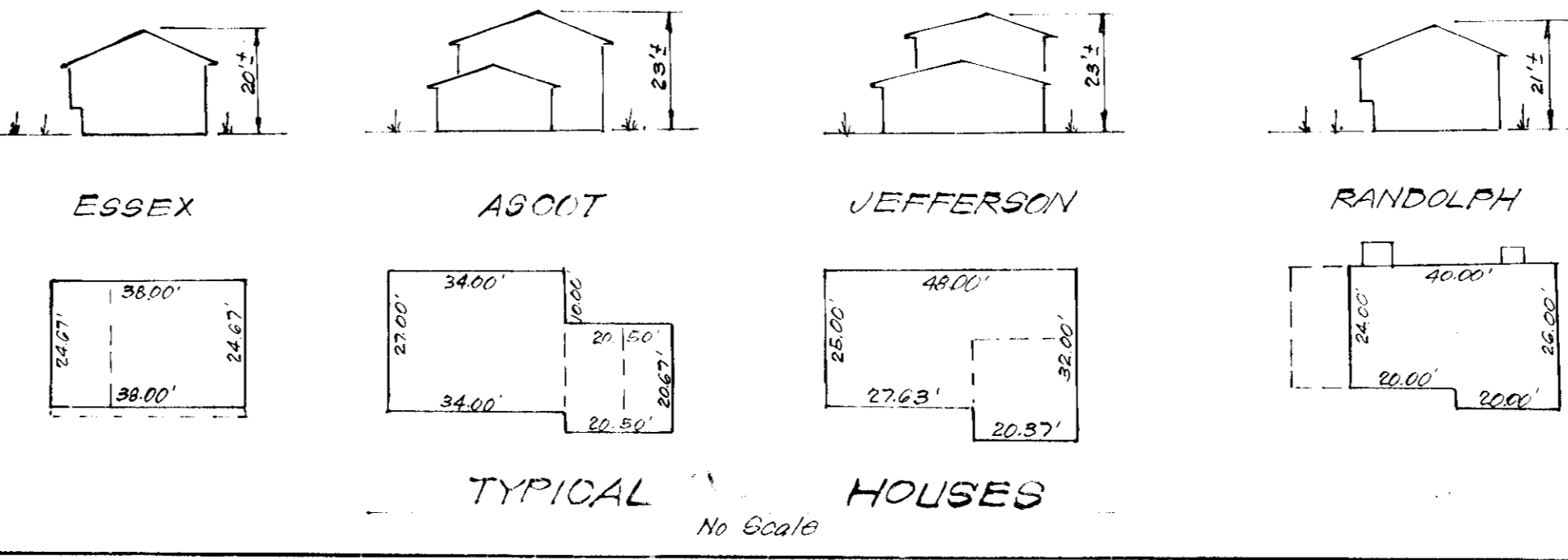

Donald R. Sackett

CLARK • FINEROCK & SACKETT
ENGINEERS • PLANNERS • SURVEYORS
3315 LARKWOOD DRIVE SILVER SPRING, MARYLAND 20904 (301) 595-4500

DESIGNED: SITE DEVELOPMENT PLAN LOTS 4 THRU 16 AND LOTS 81 THRU 83
DRAWN: W.F.M.C.
CHECKED: S.J.K.
DATE: 12/1/78

COLUMBIA
VILLAGE OF LONGREACH
SECTION I AREA 10 PLAT 3999
6th ELECTION DISTRICT
HOWARD COUNTY, MARYLAND
FOR: WASHINGTON HOMES INC.
5102 Oxon Hill Road Suite 400
Oxon Hill, Maryland 20021

SCALE: 1"=30'
DRAWING: 1 of 3
JOB NO.:
FILE NO.: 1349 X

SDP-79-48C

- LEGEND:**
- 1 Contour Interval 2 Ft.
 - 2 Existing Contour
 - 3 Proposed Contour 470
 - 4 Spot Elevation +705
 - 5 Direction of Drainage
 - 6 Walk out Basement
 - 7 Diverion Dike
 - 8 Straw Bale Dike or Silt Fence S.B.D. or S.F.
 - 9 Stone Filter Inlet Protection S.F.I.P.
 - 10 Stone Construction Entrance S.C.E.
 - 11 Sediment Trap

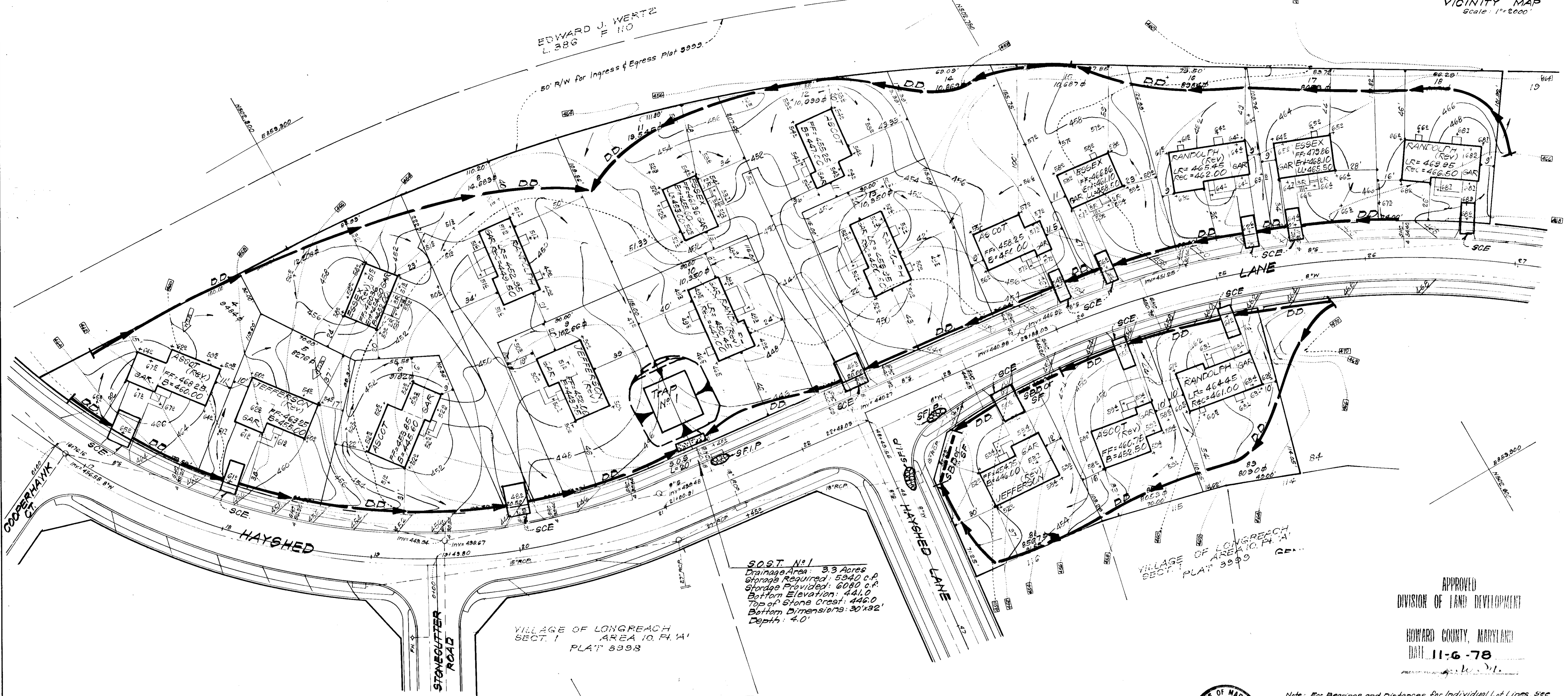
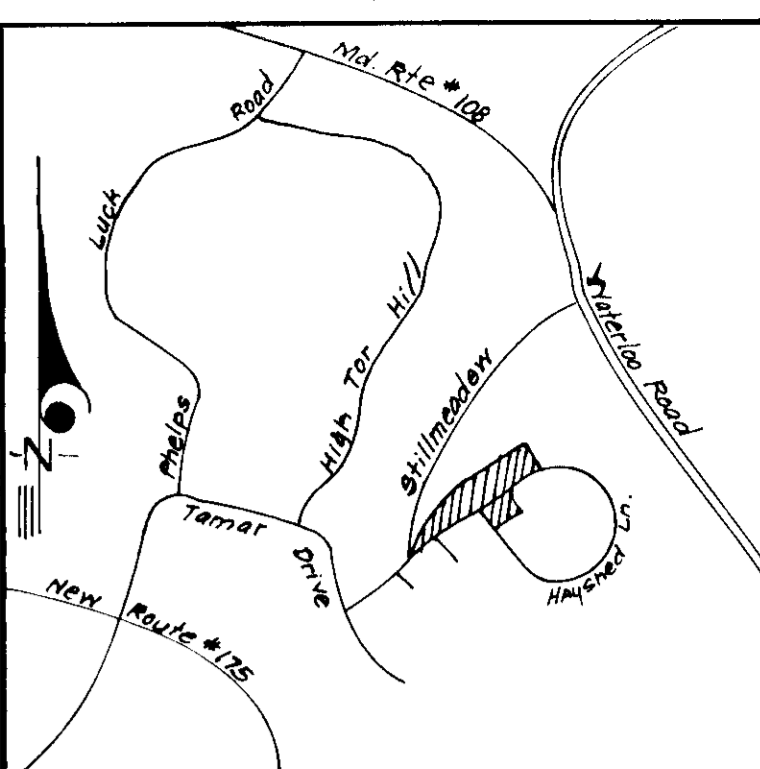

S.O.S.T. No. 1
 Drainage Area: 3.3 Acres
 Storage Required: 5940 c.f.
 Storage Provided: 6080 c.f.
 Bottom Elevation: 441.0
 Top of Stone Crest: 442.0
 Bottom Dimensions: 30'x32'
 Depth: 4.0'

VILLAGE OF LONGREACH
 SECT. I AREA 10. PL. 1A
 PLAT 3993

APPROVED
 DIVISION OF LAND DEVELOPMENT
 HOWARD COUNTY, MARYLAND
 DATE 11-6-78

APPROVED FOR PUBLIC WATER AND PUBLIC SEWERAGE SYSTEMS,
 HOWARD COUNTY HEALTH DEPARTMENT
Jay D. Bryan 12-11-78
 CITY HEALTH OFFICER DATE
 APPROVED HOWARD COUNTY OFFICE OF PLANNING & ZONING
 PLANNING DIRECTOR DATE
Richard E. Brudenburg 12/5/78
 DIRECTOR DATE
 CHIEF BUREAU OF ENGINEERING DATE

Reviewed for Howard S.C.D.
 Name
 and meets Technical Requirements
C. Wayne Key 11-24-78
 Signature Date
 U.S. Soil Conservation Service
 THIS DEVELOPMENT PLAN IS APPROVED
 FOR SOIL EROSION AND SEDIMENT
 CONTROL BY THE HOWARD SOIL
 CONSERVATION DISTRICT.

DEVELOPER'S CERTIFICATE
 I certify that all development and/or construction
 will be done according to this plan of development
 and plan for Erosion and Sediment Control, and I also
 a license periodic on-site inspection by the Howard
 Soil Conservation District or their authorized agents
 as are deemed necessary. Deviation from this plan
 will not be made unless authorized by the Howard
 Soil Conservation District.

ENGINEER'S CERTIFICATE
 I hereby certify that this plan for Erosion and
 Sediment Control represents a practical and workable
 plan based on my personal knowledge of the site
 conditions and that it was prepared in accordance
 with the requirements of the Howard Soil Conserva-
 tion District.



Note: For Bearings and Distances for Individual Lot Lines, See
 Record Plat Recorded as Plats 3998 & 3999

CLARK • FINEROCK & SACKETT
 ENGINEERS • PLANNERS • SURVEYORS
 11315 LOCKWOOD DRIVE SILVER SPRING, MARYLAND 20904 (301) 593-3400

DESIGNED *JLS* **SEDIMENT & EROSION CONTROL PLAN** SCALE 1"=30'
 DRAWN *JLS* **LOTS 81 THRU 83 AND** DRAWING 2043
 CHECKED *K.W.* **COLUMBIA** JOB NO.
 DATE *JLS* **VILLAGE OF LONGREACH** FILE NO.
 6th ELECTION DISTRICT **SECTION I AREA 10, PL. 1A'** 1313-SE
 HOWARD COUNTY, MARYLAND
 FOR: WASHINGTON HOMES INC.
 6102 Oxon Hill Road Suite 400
 6100 Hill, Maryland 20021
 5DP-79-48c

Robert W. Ziehm 11/24/78 Date
 Approved
Montee Sandberg 11/24/78 Date
 Signature
Montee Sandberg
Robert W. Ziehm 11/24/78 Date
 Signature
Montee Sandberg
Robert W. Ziehm 11/24/78 Date
 Signature
Montee Sandberg

GENERAL NOTES

- Grading Permits shall be obtained prior to installation of Sediment Control & Grading.
- All Sediment and Erosion Control Measures will be installed and stabilized according to this plan prior to any other grading, clearing or disturbance of the existing surface of the site. See Note # 6 for stabilization except that the seed mixture will be annual rye applied at a rate of 1.4 lbs/1000 s.f.
- Notify the Bureau of Inspections and Permits at least 24 hours before starting any work.
- All Sediment Control Practices to conform to the "Standards and Specifications for Soil Erosion and Sediment Control in Developing Areas" and shall be adjusted to meet actual field conditions.
- Stabilization of Disturbed Ground to be done as soon after construction as possible.
- All Grading shall be treated in accordance with the following Specifications:
 - Seed - certified 85% germination applied at the rate of 3 lbs/1000 s.f. mixture - 40% Kentucky Blue, 20% Chewing Fescue, 20% Kentucky 31, and 20% annual rye.
 - Fertilizer - 10-10-10 applied at the rate of 23 lbs/1000 sq. ft. Ground.
 - Agricultural Lime or Dolomitic Lime applied at the rate of 46 lbs/1000 s.f.
 - Mulch - Weed free grain straw applied at the rate of 70 lbs/1000 s.f. Mulch shall be secured to the ground by any approved method i.e. asphalt tacks, chemical binder, wood chips, etc.
- All Structural Sediment Control Measures are to remain in place until permission for their removal has been obtained from the Bureau of Inspections and Permits.
- On Site Inspection and Maintenance of all Sediment Control Measures including clean out of sediment traps and dikes, and proper establishment of all planned vegetative measures will be the responsibility of the Developer or his representative on the site, on a continuing day to day basis.
- Protection of stabilized area from sediment runoff shall be provided by the use of an approved sediment Control Device, i.e. straw bale, diversion dike, etc.
- The Contractor shall keep all public roads free of sediment deposits left from traffic leaving construction site.
- Stabilized Construction Entrances shall be placed at all construction entrances.
- SITE ANALYSIS:**
 - Total Area = 4.132 Acres
 - Area to be Roofed = 0.470 Acres
 - Area to be Paved = 0.345 Acres
 - Area to be Seeded = 2.784 Acres
 - Area Undisturbed = 0.533 Acres
- CONSTRUCTION SEQUENCE:**
 - Install Sediment & Erosion Control Devices and stabilize Diversion Dikes.
 - Excavate for Foundations and Rough Grade.
 - Erect Structures, Drive ways and Side walks.
 - Final Grade and stabilize in accordance with Note # 6.
- If Houses are to be constructed on an "As Sold" basis at random, Single Lot Sediment Control, as shown on this sht, shall be implemented.
- It will be the Developer's responsibility to provide additional Sediment & Erosion Control Devices to protect stabilized areas during construction.
- Total Amount of Straw Bales or Silt Fence shown = 60 L.F.

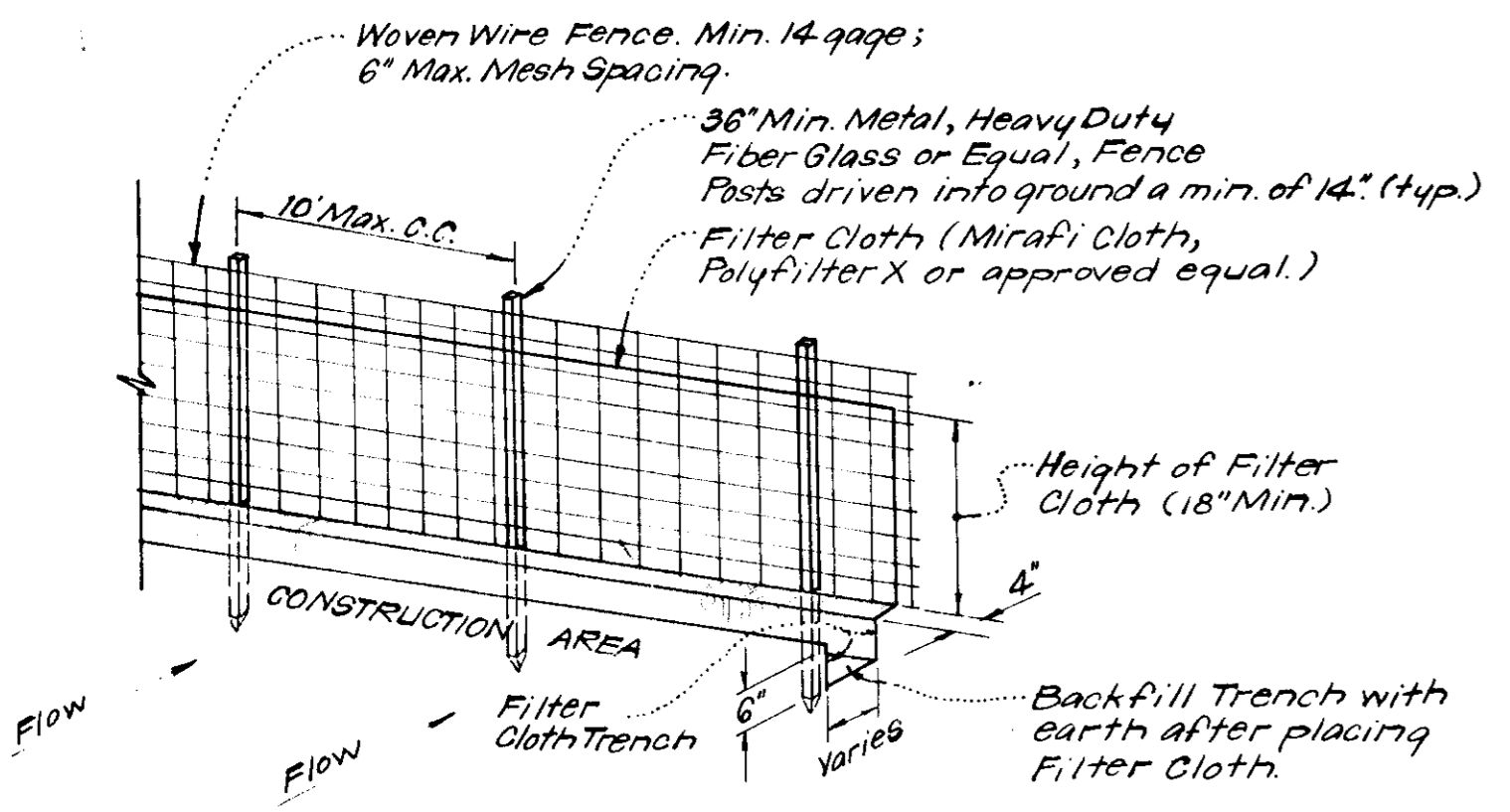

NOTES:
 1. Woven Wire Fence to be fastened securely to fence posts by use of wire ties.
 2. Filter Cloth to be fastened securely to woven wire fence by use of wire ties spaced every 24" x 24".

SILT FENCE DETAIL (S.F.)
 No Scale

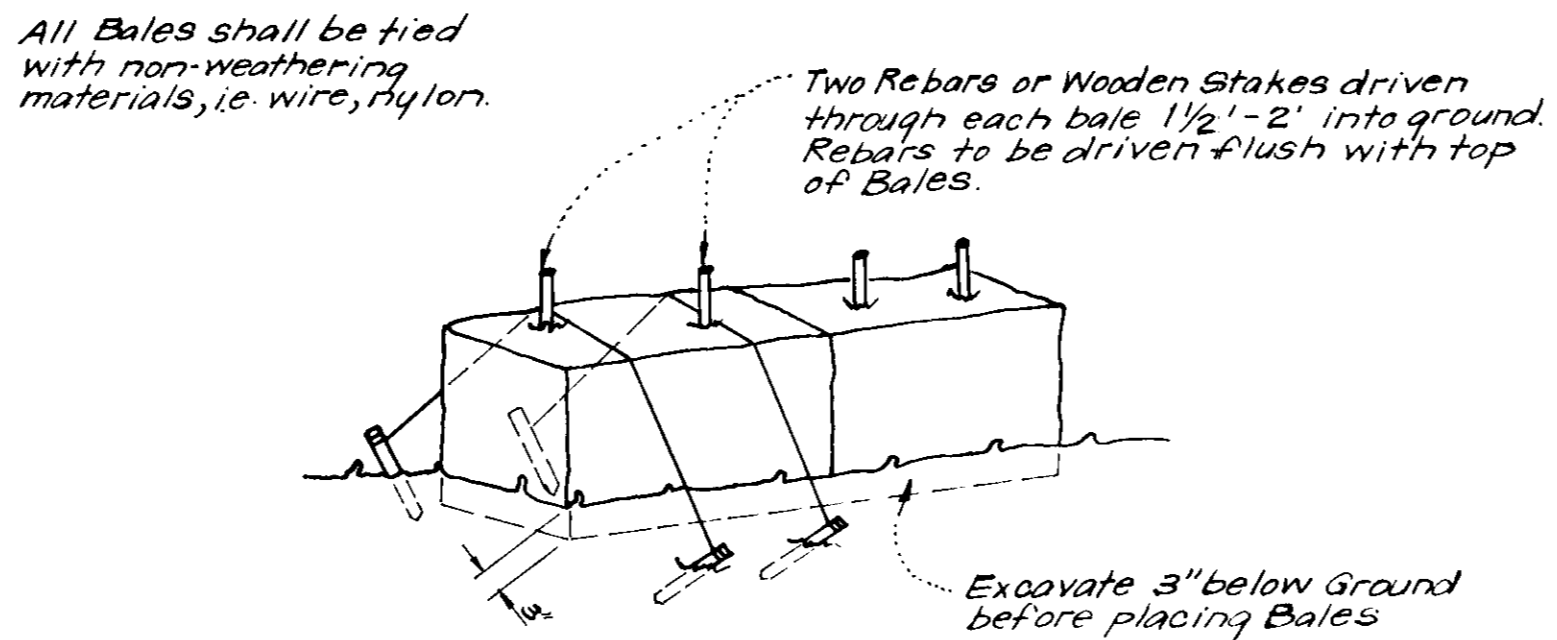

NOTE:
 1. In lieu of the use of rebar each Straw Bale may be fastened to ground with pegs (4 per bale and wire or nylon as shown above).

TYPICAL STRAW BALE DETAIL (S.B.D.)
 No Scale

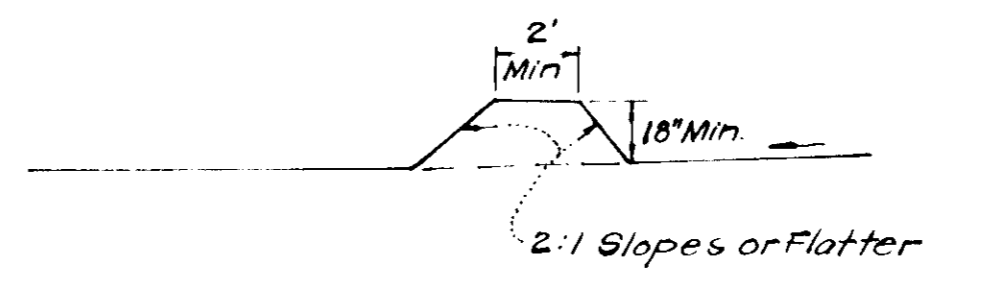

CROSS SECTION

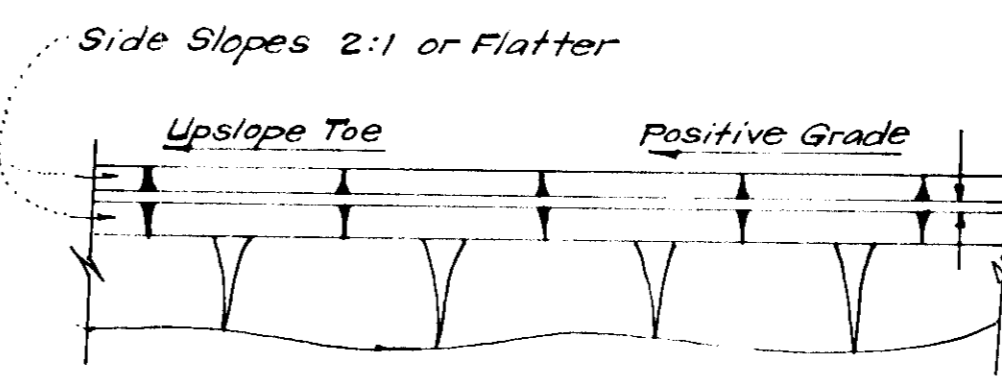

PLAN VIEW
DIVERSION DIKE (D.D.)
 No Scale

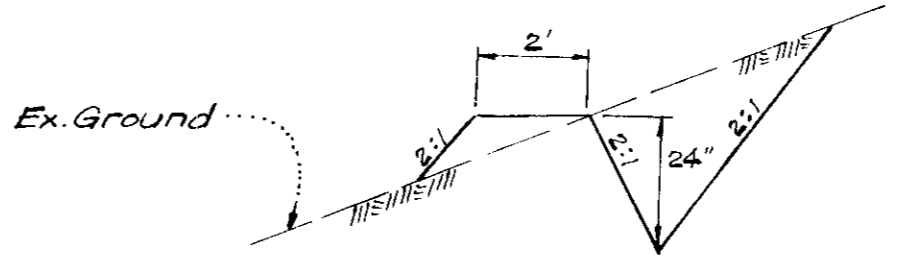

CUT DIVERSION DIKE
 No Scale

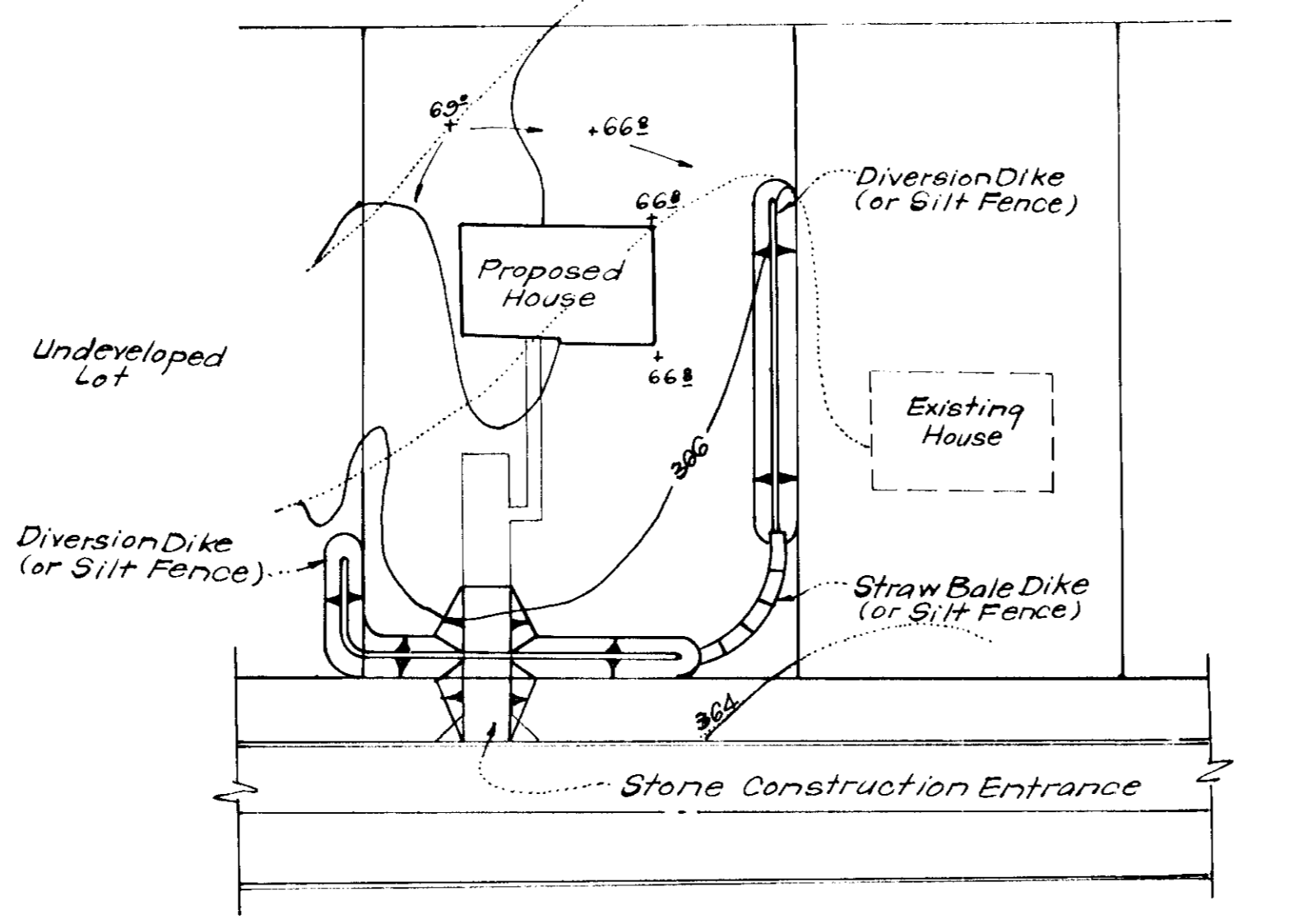

TYPICAL SINGLE LOT SEDIMENT CONTROL PLAN
 No Scale

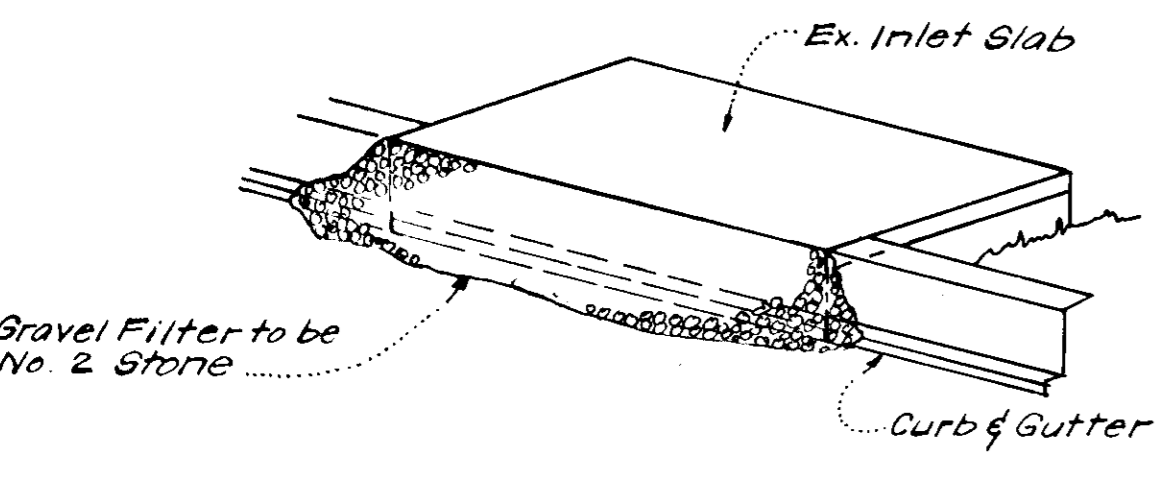

ISOMETRIC VIEW

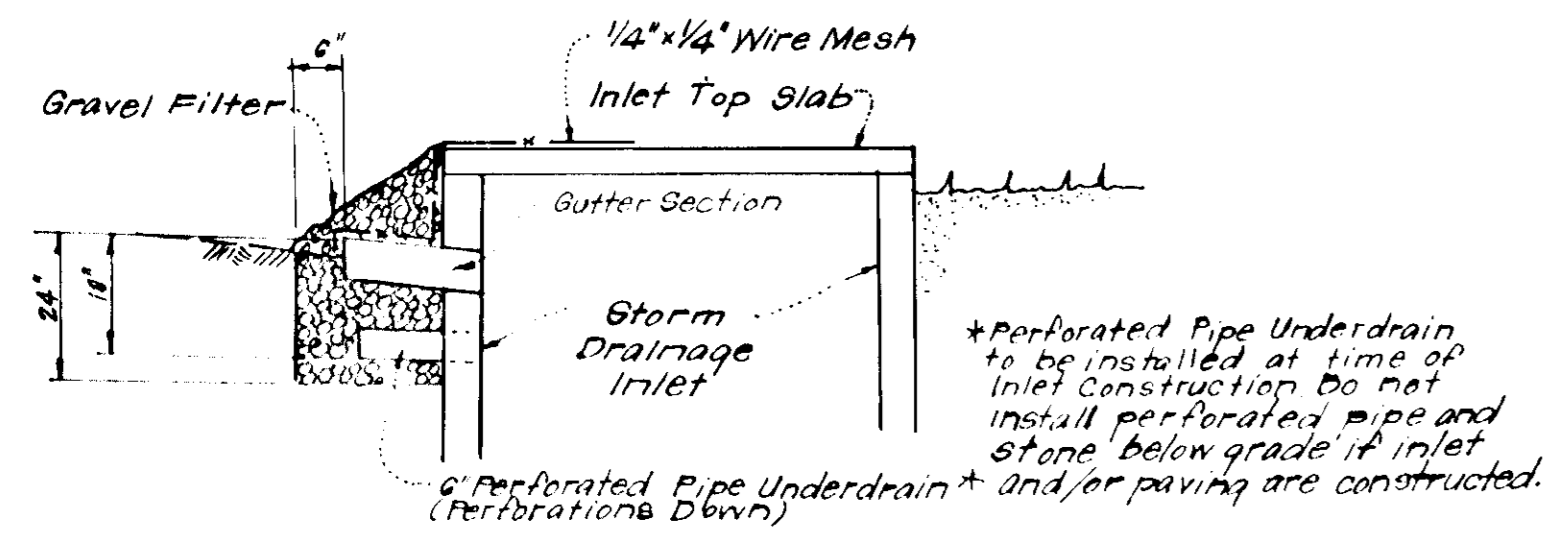

SECTION VIEW

STONE FILTER INLET PROTECTION DETAIL (S.F.I.P.)
 No Scale

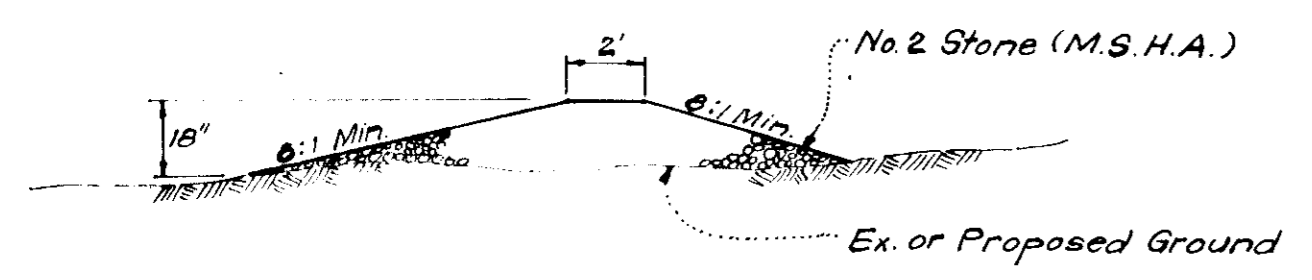

SECTION VIEW

STONE CONSTRUCTION ENTRANCE DETAIL (S.C.E.)
 No Scale

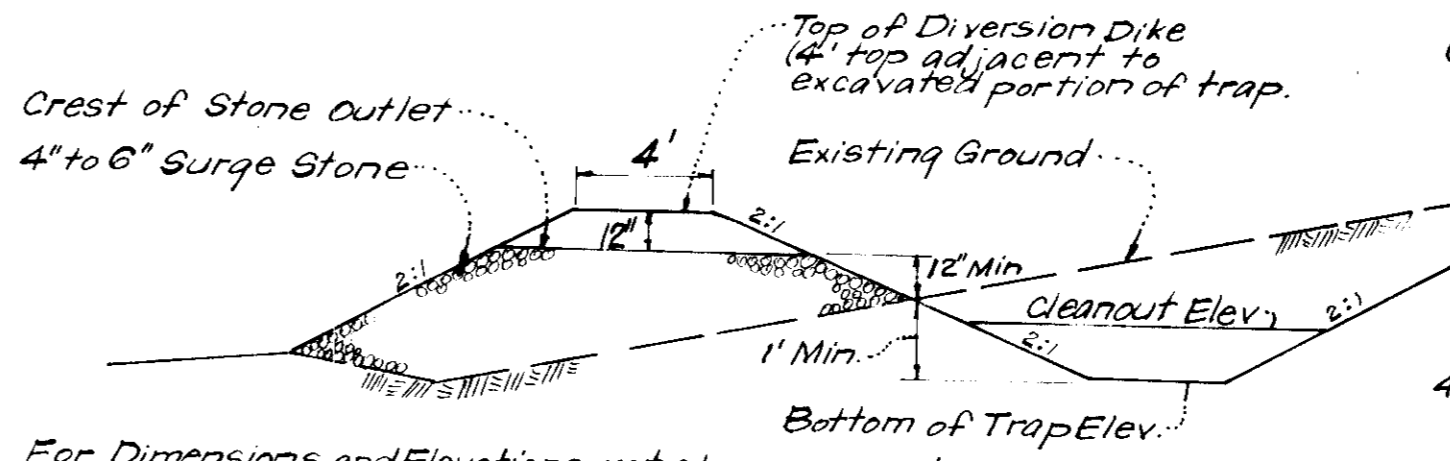

TYPICAL PROFILE

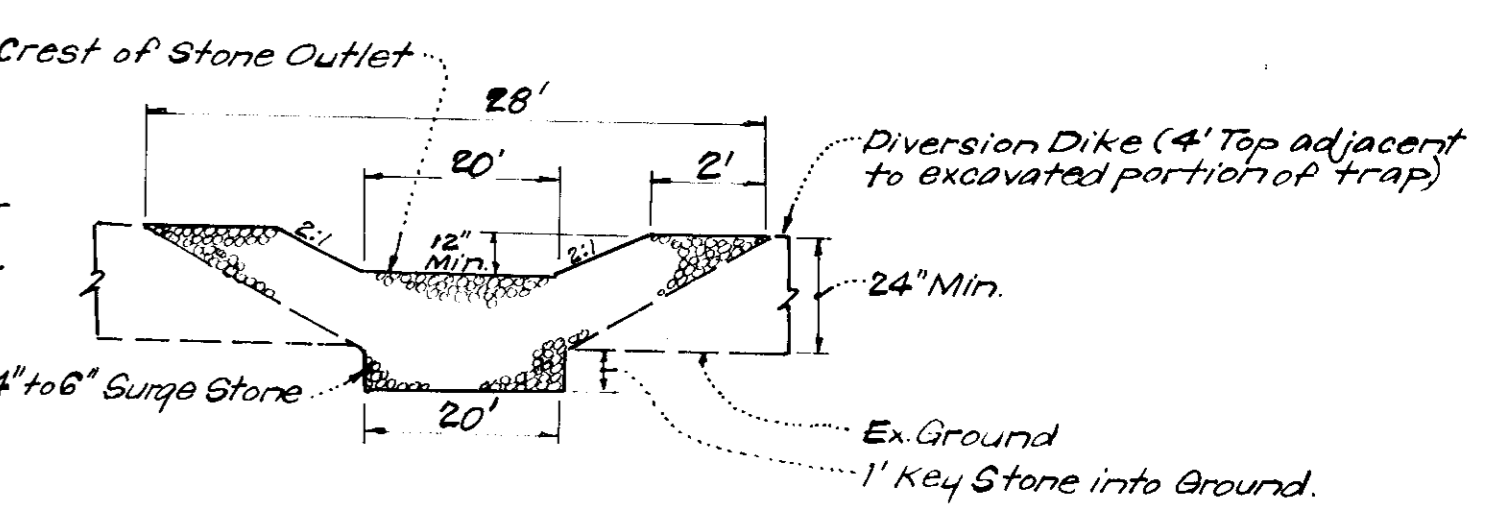

TYPICAL CROSS SECTION

DETAILS OF STONE FILTER OUTLET (FOR STONE OUTLET SEDIMENT TRAP)
 No Scale

STONE FILTER OUTLET NOTES:
 1. Sediment Trap to be cleaned out when sediment reaches a level of 1 ft. below the Crest of Stone Outlet.
 2. Bottom of Sediment Trap to be level and constructed to the dimensions shown on plan.
 3. Stone Outlet to be constructed through diversion dike adjacent to excavated portion of Sediment Trap.

APPROVED
 DIVISION OF LAND DEVELOPMENT
 HOWARD COUNTY, MARYLAND
 DATE 11-6-78

APPROVED FOR PUBLIC WATER AND PUBLIC SEWERAGE SYSTEMS,
 HOWARD COUNTY HEALTH DEPARTMENT
 [Signature] 12-11-78
 PLANNING DIRECTOR
 APPROVED FOR PUBLIC WATER AND PUBLIC SEWERAGE,
 STORM DRAINAGE SYSTEMS AND PUBLIC ROADS
 HOWARD COUNTY DEPARTMENT OF PUBLIC WORKS
 [Signature] 12/5/78
 CHIEF ENGINEER

Reviewed for Howard S.C.D.
 [Signature] 11-24-78
 U.S. Soil Conservation Service

THIS DEVELOPMENT PLAN IS APPROVED
 FOR SOIL EROSION AND SEDIMENT
 CONTROL BY THE HOWARD SOIL
 CONSERVATION DISTRICT.

[Signature] 11-24-78
 Approved

DEVELOPER'S CERTIFICATE
 I certify that all development and/or construction will be done according to this plan of development and plan for Erosion and Sediment Control, and I also authorize periodic on-site inspection by the Howard Soil Conservation District or their authorized agents, as are deemed necessary. Deviation from this plan will not be made unless authorized by the Howard Soil Conservation District.

[Signature] 11-24-78
 Monroe Sandberg

ENGINEER'S CERTIFICATE
 I hereby certify that this plan for Erosion and Sediment Control represents a practical and workable plan based on my personal knowledge of the site conditions and that it was prepared in accordance with the requirements of the Howard Soil Conservation District.

[Signature] 11-24-78
 H. Nelson Cook



CLARK • FINEFROCK & SACKETT ENGINEERS • PLANNERS • SURVEYORS 11315 LOCKWOOD DRIVE SILVER SPRING, MARYLAND 20904 (301) 593 3400		
DESIGNED J.L.S.	SEDIMENT & EROSION CONTROL PLAN LOTS 4 THRU 18 AND LOTS 81 THRU 83 COLUMBIA VILLAGE OF LONGBEACH SECTION 1, AREA 10 P.L. A 6TH ELECTION DISTRICT HOWARD COUNTY, MARYLAND FOR: WASHINGTON HOMES, INC. 6132 Oxon Hill Road Suite 400 Oxon Hill, Maryland 20746	SCALE As Shown
DRAWN K.I.W.		3 of 3 JOB NO.
CHECKED J.L.S.		FILE NO. 1313 SE
DATE Oct, 1978		55P-79-48 22A/50-1362-X