

THE PURPOSE OF THIS REVISED PLAN IS TO SHOW THE REMOVAL AND REPLACEMENT OF THE EXISTING GENERATOR AND PAD WITH TWO PROPOSED 12'x24'x8' GENERATOR PADS THAT WILL SUPPORT TWO 10'x21'x8' GENERATORS. BOTH ARE SITUATED ON THE SOUTHWEST SIDE OF THE BUILDING. THE NEW GENERATORS DO NOT EXCEED (24') IN HEIGHT.

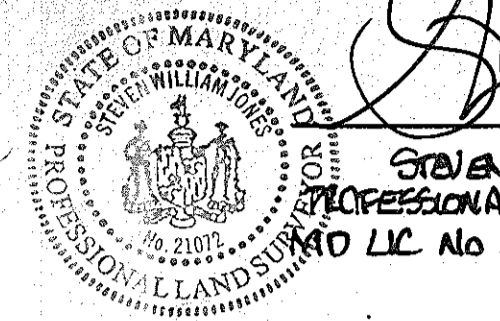

STEVEN W. JONES  
PROFESSIONAL LAND SURVEYOR  
MD LIC. NO. 21072 EXP. 2/8/2015

5 ADDITIONS AND REVISIONS WERE MADE TO THE SITE PLAN INCLUDING REVISIONS GENERAL NOTE 8, THE ASPHALT PARKING AREA AND STRIPING HAVE BEEN UPDATED. A PROPOSED ELECTRIC SLIDING GATE HAS BEEN ADDED TO THE NORTH AND WEST OF THE BUILDING. THE EXISTING GENERATOR ON THE NORTH SIDE OF THE BUILDING IS SHOWN RELOCATED TO THE SOUTH OF THE BUILDING. A PROPOSED PROPANE LINE FROM THE PROPANE TANK TO THE ANTENNA PAD ON THE EAST SIDE OF THE PARKING LOT HAS ALSO BEEN ADDED. ALL CHANGES ARE MINOR IN NATURE AND CONSISTENT WITH THE RED-LINE REVISION PROCESS AND APPROVED BY THE DEPARTMENT OF PLANNING AND ZONING ON AUGUST 26, 2008.

STEVEN W. JONES  
PROFESSIONAL LAND SURVEYOR  
MD LICENSE NO. 21072



LUMINARE & POLE DETAIL

| TYPE | MANUFACTURER & CAT. NO.   | LAMP          | VOLTS | MOUNTING                           | REMARKS                                    |
|------|---------------------------|---------------|-------|------------------------------------|--|
| A    | LIGHTOLIER #A08553        | 1137KC 250/DX | 120 V | SINGLE ARM BLE LIGHTOWER SITE 2216 | 15' HIGH POLE ON BITUMINOUS CONCRETE B-3SE |
| B    | VERAFLOOBY G.E. 767836016 | 83-22 H175/DX | 120 V | SURFACE MOUNTED                    | SECURITY LIGHTING                          |



STEVEN W. JONES  
PROFESSIONAL LAND SURVEYOR  
MD LICENSE NO. 21072

NOTES (cont'd)

4. ADDITIONS AND REVISIONS WERE MADE TO THE SITE PLAN INCLUDING REVISIONS GENERAL NOTES 4, 7, 8, 9 AND ADDING NOTE 13. THE OWNER HAS BEEN UPDATED, PARCEL TAX MAP AND GRID INFO HAVE BEEN UPDATED. THE OLD NORTHWESTERN PROPERTY LINE FOR PARCEL E HAS BEEN REMOVED. STRIPED PARKING SPACES HAVE BEEN ADDED. THE PROPOSED CONCRETE PAD SOUTH AND EAST OF THE LOADING DOCK HAS BEEN ADDED WITH TIES TO THE PROPERTY LINES AND TWO ANTENNA DETAILS HAVE BEEN ADDED. ALL CHANGES ARE CONSISTENT WITH AGENCY COMMENTS AND WERE ADDED MARCH 8, 2007. (S.W.)

REVIEWED FOR HOWARD S.C.D. AND MEETS TECHNICAL REQUIREMENTS.

C. Wayne Ray  
US SOIL CONSERVATION SERVICE  
DATE: 4/14/19

THIS DEVELOPMENT PLAN IS APPROVED SOIL EROSION AND SEDIMENT CONTROL BY THE HOWARD SOIL CONSERVATION DISTRICT.

Robert Ziehm  
HOWARD SOIL CONSERVATION DISTRICT  
DATE: 4/10/19

CHARLES R. JOHNSON & ASSOC.  
FARMERS, JOHNSON, McCORDIC & THOMPSON  
1751 ELTON ROAD SILVER SPRING MD 20903  
301 434 7000

APPROVED: FOR PUBLIC WATER AND PUBLIC SEWERAGE SYSTEMS, HOWARD COUNTY HEALTH DEPARTMENT.

Joyce Zepher  
COUNTY HEALTH OFFICER  
DATE: 4-26-19

APPROVED: HOWARD COUNTY OFFICE OF PLANNING AND ZONING  
Doreen Hamilton  
PLANNING DIRECTOR  
DATE: 4-30-19

APPROVED: FOR PUBLIC WATER, PUBLIC SEWERAGE AND STORM DRAINAGE SYSTEMS AND ROADS  
HOWARD COUNTY DEPARTMENT OF PUBLIC WORKS  
DATE: 4-27-19

APPROVED: FOR PUBLIC WATER, PUBLIC SEWERAGE AND STORM DRAINAGE SYSTEMS AND ROADS  
HOWARD COUNTY DEPARTMENT OF PUBLIC WORKS  
DATE: 4-25-19

APPROVED: FOR PUBLIC WATER, PUBLIC SEWERAGE AND STORM DRAINAGE SYSTEMS AND ROADS  
HOWARD COUNTY DEPARTMENT OF PUBLIC WORKS  
DATE: 4-25-19

APPROVED: FOR PUBLIC WATER, PUBLIC SEWERAGE AND STORM DRAINAGE SYSTEMS AND ROADS  
HOWARD COUNTY DEPARTMENT OF PUBLIC WORKS  
DATE: 4-25-19

NOTES:  
1. BASED ON A LETTER DATED APRIL 13, 2004 FROM CINDY HAMILTON CHIEF, DIVISION OF LAND DEVELOPMENT...  
2. THE PERMIT APPLICATION DEADLINE SHALL EXPIRE ON AUGUST 10, 2007...  
3. THESE REVISION NOTICE AND PLAN REVISIONS WERE ADDED ON OCTOBER 31, 2006... AND AGAIN ON 11-15-06 SWJ

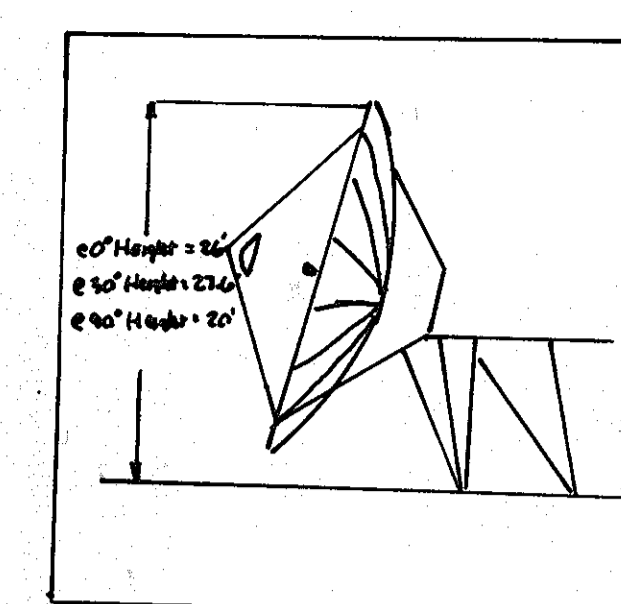
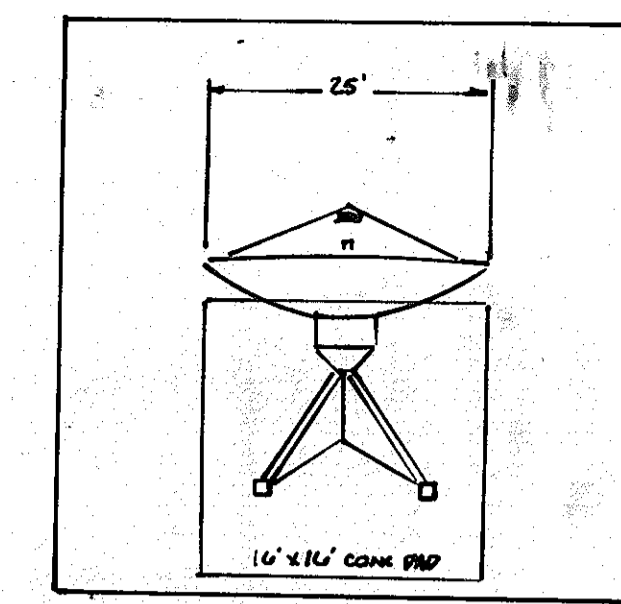
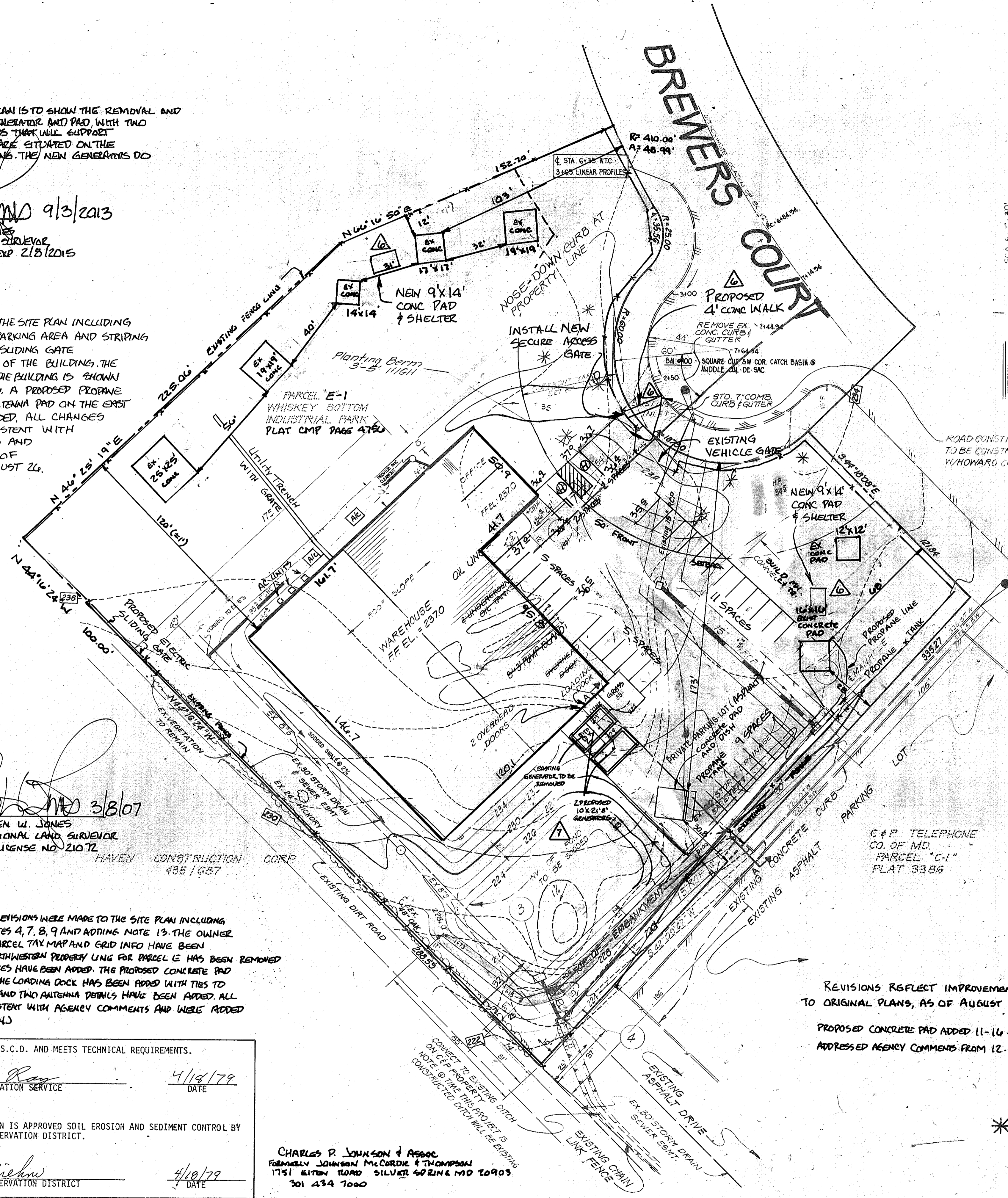

STEVEN W. JONES  
PROFESSIONAL LAND SURVEYOR  
MD LIC. NO. 21072  
EXPIRES 2-8-2013

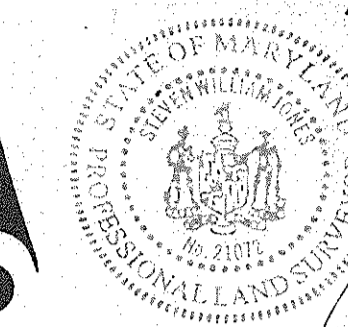

THE PURPOSE OF THIS PLAN IS TO SHOW THE ADDITION OF TWO 9'x14' CONCRETE PADS THAT WILL SUPPORT ONE PRECAST COMMUNICATIONS STRUCTURE EACH. THE FIRST IS SITUATED ALONG THE NORTH PROPERTY LINE AND THE SECOND NEAR THE EAST CORNER. A 4' CONNECTING SIDEWALK IS ALSO PROPOSED BY THIS PLAN EXTENDING WEST FROM BREWERS COURT TO THE EXISTING PARKING LOT. A NEW SECURITY GATE WILL BE INSTALLED IN THE EXISTING FENCE.

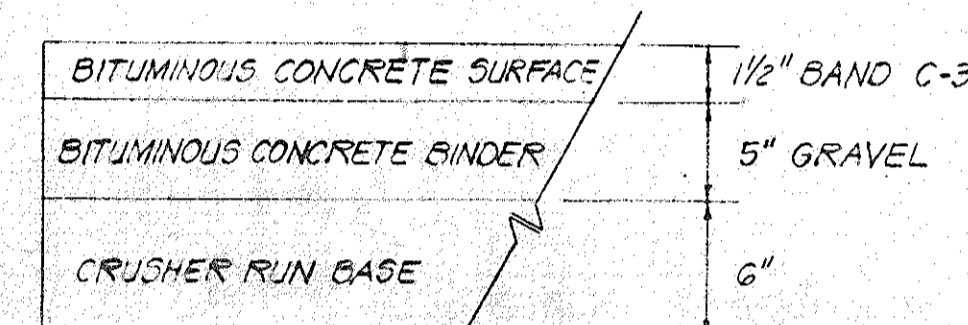

NO SCALE  
1. 12" & 18" PAVES SHALL BE CONSTRUCTED IN ACCORDANCE WITH THE HOWARD COUNTY ROAD CONSTRUCTION CODE AND SPECIFICATIONS.  
2. BASE SHALL BE PLACED IN ACCORDANCE WITH SECTION C-30-3 AS PROVIDED IN THE HOWARD COUNTY ROAD CONSTRUCTION CODE AND STANDARD SPECIFICATIONS.  
3. THE CURB IS REQUIRED IN ACCORDANCE WITH SECTION C-31-4 OF THE HOWARD COUNTY ROAD CONSTRUCTION CODE AND STANDARD SPECIFICATIONS.  
4. TYPICAL PAVING SECTION FOR DRIVEWAYS AND PARKING AREA.

GENERAL NOTES:

- ZONING CE-CU1
- BUILDING DIMENSIONS - 120'-0" x 146'-8"
- BUILDING HEIGHT 13'-0" TO PEAK
- TELECOMMUNICATIONS TELEPORT WITH 10 EMPLOYEES - NO ON-SITE FOOD SERVICE OR RETAIL SALES
- ALL OPEN AREA W/IN PROPERTY BOUNDARY TO BE MAINTAINED BY OWNER
- ALL 2:1 SLOPES SHALL BE SEEDED AS NOTED ON SEDIMENT PLAN
- RECORDING REFERENCE PLAT 3715 F.81-025 PARCELS PLAT NO. 4750
- PARKING REQUIRED SHOWN 10/34 SEC 133D.5a
- TOTAL LOT AREA PARCELE-1 2.753 ACRES
- HANDICAPPED STALLS
- MIN. GREEN SPACE SHOWN 10%
- \* INDICATES WHITE PINE - MIN 2 1/2" CAL. (NUMBER SHOWN 8)
- ALL EXISTING CONCRETE PADS ARE BASE FOUNDATIONS FOR SATELLITE COMMUNICATIONS DISH ANTENNAS.

REVISIONS REFLECT IMPROVEMENTS TO ORIGINAL PLANS, AS OF AUGUST 27, 2004

PROPOSED CONCRETE PAD ADDED 11-16-05

ADDRESSED AGENCY COMMENTS FROM 12-28-06

\* REVISED ENTRANCE, PARKING & PAVEMENT LOCATIONS  
OWNER: GLOBECOMM SERVICES MD LLC  
9895 BREWERS COURT  
LAUREL MD 20713 301.490.6644

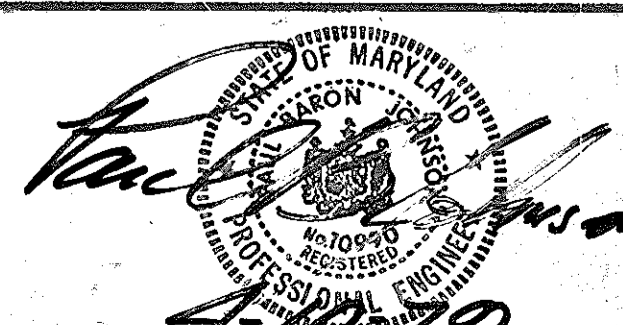

JOHNSON - McCORDIC - THOMPSON, P.A.  
ENGINEERS PLANNERS SURVEYORS  
1620 ELTON ROAD SILVER SPRING, MD.  
434-7000 20863

SITE DEVELOPMENT AND STORM DRAINAGE PLAN  
PARCEL E-1  
**WHISKEY BOTTOM INDUSTRIAL PARK**  
6TH ELECTION DISTRICT TAX MAP 50 GRID A P. 489  
HOWARD COUNTY MARYLAND

OWNER: LHMARLAND PROPERTIES INC.  
ATTN: MARSHALL LYMAN  
10280 SOUTH BROADWAY SUITE 200  
SOUTH BROADWAY SUITE 200 SA 9000

DESIGN: LHMARLAND PROPERTIES INC.  
DRAWN: O.M.C.  
APPROVED: R.D.C.  
SHEET 1 OF 4  
DATE: 1/17/19  
SCALE: 1"=30'  
JOB NO: 7-085-20-21-20  
FILE NO: 7-085-21-B

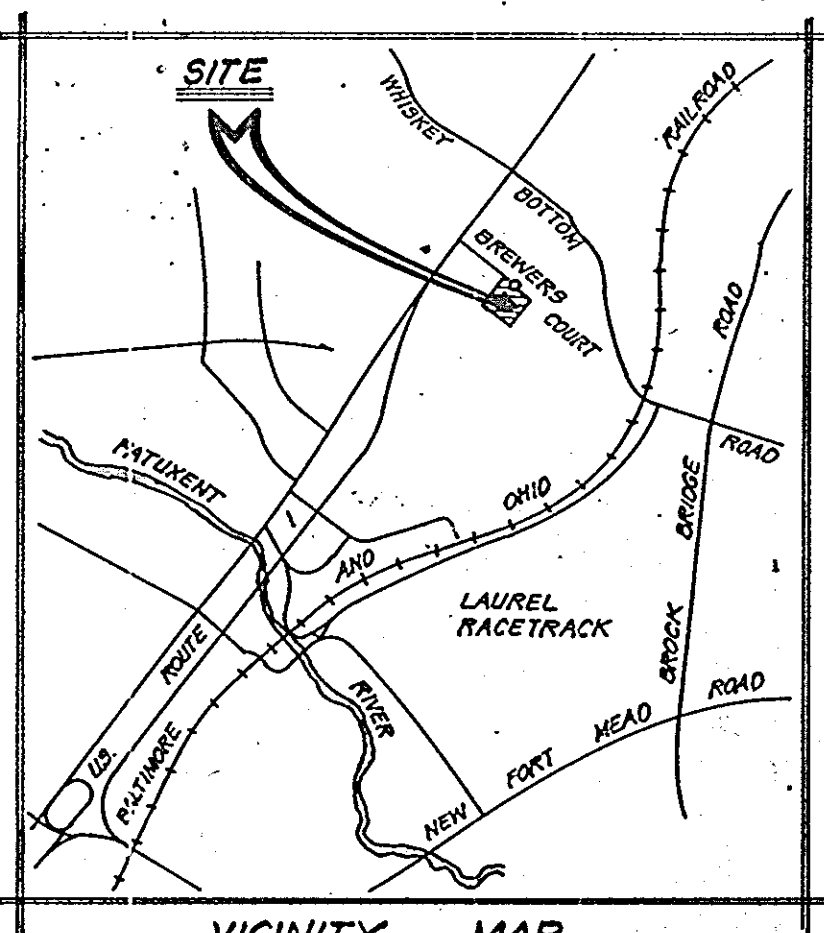

VICINITY MAP  
SCALE: 1" = 2000'

SECTION A-A  
HORIZONTAL SCALE: 1" = 10' 0"  
VERTICAL SCALE: 1" = 10' 0"

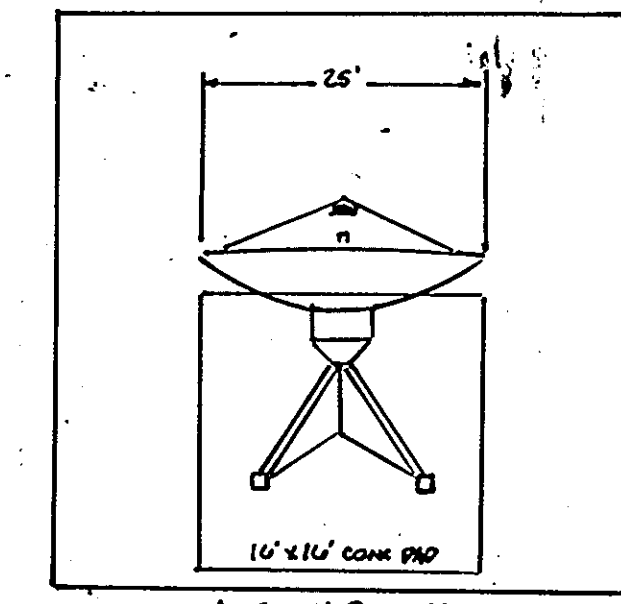

ANTENNA PLAN VIEW  
NOT TO SCALE

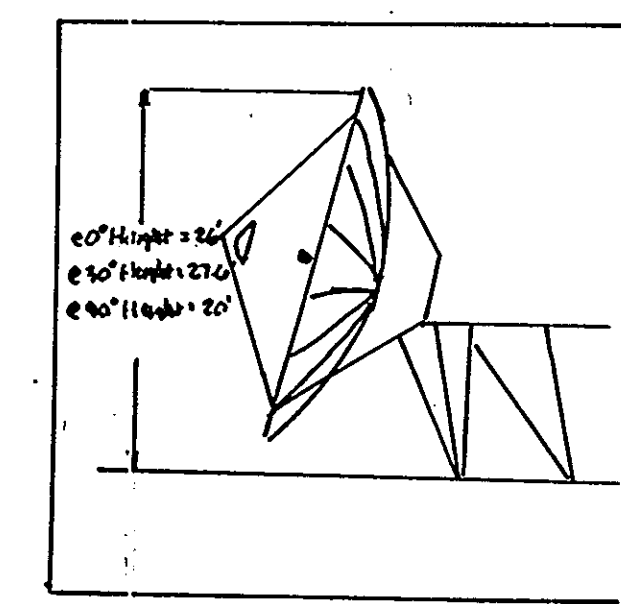

ANTENNA PROFILE VIEW  
NOT TO SCALE

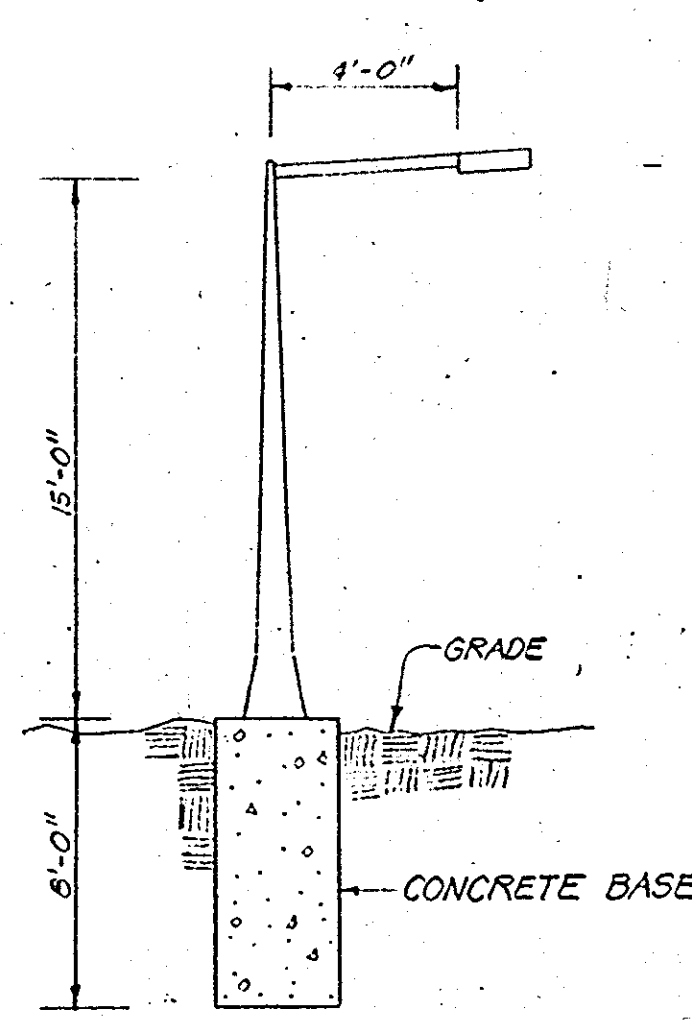

LUMINARE & POLE DETAIL

| TYPE | MANUFACTURER & CAT. NO.     | LAMP           | VOLTS | MOUNTING        | REMARKS                             |
|------|-----------------------------|----------------|-------|-----------------|-------------------------------------|
| A    | LIGHTOLIER #A0855H          | 1H37K C 250/DX | 120 V | SINGLE ARM BLE  | 15' HIGH POLE ON LIGHTOWER STE 2306 |
| B    | VERAFLOOD I BY GE #08736016 | 39-22 H175/DX  | 120 V | SURFACE MOUNTED | SECURITY LIGHTING                   |

*Steven W. Jones*  
STEVEN W. JONES  
PROFESSIONAL LAND SURVEYOR  
MD LICENSE NO. 21072

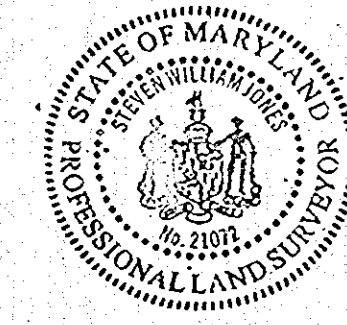

NOTES (CONT'D)

4. ADDITIONS AND REVISIONS WERE MADE TO THE SITE PLAN INCLUDING REVISING GENERAL NOTES 4, 7, 8, 9 AND ADDING NOTE 13. THE OWNER HAS BEEN UPDATED, PARCEL TAX MAP AND GRID INFO HAVE BEEN UPDATED, THE OUTNORTHWESTERN PROPERTY LINE FOR PARCEL E HAS BEEN REMOVED, STRIPED PARKING SPACES HAVE BEEN ADDED, THE PROPOSED CONCRETE PAD SOUTH AND EAST OF THE LOADING DOCK HAS BEEN ADDED WITH TIES TO THE PROPERTY LINES AND TWO ANTENNA DETAILS HAVE BEEN ADDED. ALL CHANGES ARE CONSISTENT WITH AGENCY COMMENTS AND WERE ADDED MARCH 8, 2007. (SW)

REVIEWED FOR HOWARD S.C.D. AND MEETS TECHNICAL REQUIREMENTS.  
*C. Wainwright*  
US SOIL CONSERVATION SERVICE  
DATE: 4/18/79

THIS DEVELOPMENT PLAN IS APPROVED SOIL EROSION AND SEDIMENT CONTROL BY THE HOWARD SOIL CONSERVATION DISTRICT.  
*Robert Ziehn*  
HOWARD SOIL CONSERVATION DISTRICT  
DATE: 4/18/79

APPROVED: FOR PUBLIC WATER AND PUBLIC SEWERAGE SYSTEMS, HOWARD COUNTY HEALTH DEPARTMENT.  
*Joyce Boyd*  
COUNTY HEALTH OFFICER  
DATE: 4-26-79

APPROVED: HOWARD COUNTY OFFICE OF PLANNING AND ZONING  
*D. Daniels*  
PLANNING DIRECTOR  
DATE: 4-30-79

*William Williams*  
CHIEF, DIVISION OF LAND DEVELOPMENT  
DATE: 4-27-79

APPROVED: FOR PUBLIC WATER, PUBLIC SEWERAGE AND STORM DRAINAGE SYSTEMS AND ROADS  
HOWARD COUNTY DEPARTMENT OF PUBLIC WORKS  
*Frank F. Nunn*  
DIRECTOR  
DATE: 4-25-79

*W. O. Gilbert*  
CHIEF, BUREAU OF HIGHWAYS  
DATE: 4-25-79

NOTES:  
1. BASED ON A LETTER DATED APRIL 13, 2004, FROM CINDY HAMILTON CHIEF, DIVISION OF LAND DEVELOPMENT WAIVER PETITION WP-02-0112 WAS APPROVED. IT HAD SECTION 10.105A(1), WHICH REQUIRES APPROVAL OF A SITE DEVELOPMENT PLAN FOR CONVERSION OF NON-RESIDENTIAL USES TO ALLOW INSTALLATION OF TWO 9" DIAMETER STORM DRAINS AND TWO 6" DIAMETER DRAINS ON THIS SITE. 1) SUBJECT TO REVISIONS THIS PLAN TO INCLUDE THE NEW BOUNDARY OF PARCELS B-1, AND TO REVISE ALL NOTES AND LABELS ACCORDINGLY; 2) NEW DRAINS MUST COMPLY WITH SO PLUMBING CODE; AND 3) APPLY AND OBTAIN ALL NECESSARY PERMITS.

2. THE PERMIT APPLICATION DEADLINE SHALL EXPIRE ON AUGUST 10, 2007 (WHICH IS ONE YEAR FROM THE DATE OF THE DEVELOPMENT ENGINEERING DIVISION'S LETTER APPROVING THE 220'-LINE SIGNED BY CHARLES P. JOHNSON, CHIEF DEVELOPMENT ENGINEERING DIVISION. ITEMS MARKED HEREBY AS PROPOSED ARE THE INTENDED LOCATIONS OF THE GRID DISHES.

3. THESE REVISION NOTES AND PLAN REVISIONS WERE ADDED ON OCTOBER 31, 2006. (SW) AND AGAIN ON 11-15-06 SW

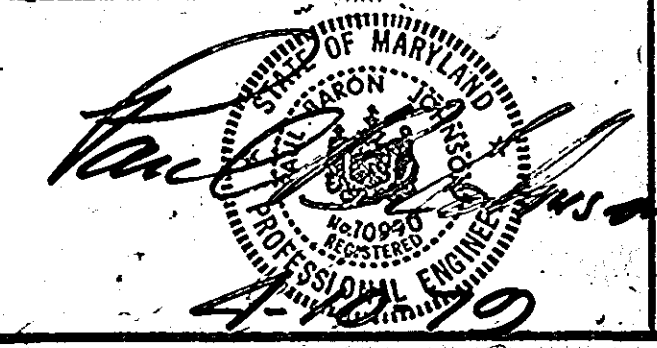

JOHNSON - McCORDIC - THOMPSON, P.A.  
ENGINEERS PLANNERS SURVEYORS  
1820 ELTON ROAD  
434-7000  
SILVER SPRING, MD.  
20863

SITE DEVELOPMENT AND STORM DRAINAGE PLAN  
PARCEL E-1  
**WHISKEY BOTTOM INDUSTRIAL PARK**  
6TH ELECTION DISTRICT  
HOWARD COUNTY MARYLAND  
TAX MAP, 50 GRID A P. 489

OWNER: LESMAN MARYLAND PROPERTIES INC.  
ATTN: MATTHEW LYMAN  
1088 SOUTH JORDAN GARDEN SUITE 8  
SOUTH JORDAN UT 84085 BOX 501 9090

DESIGN: R.A.J. & O.M.L.  
DATE: AUG. 1977  
SCALE: 1" = 30'

SHEET 1 OF 4  
JOB NO: 7-005-20-21-20  
FILED: 7-085-21 B

GENERAL NOTES:

- ZONING: M-2
- BUILDING DIMENSIONS: 120'-0" x 146'-8"
- BUILDING HEIGHT: 13'-0" TO PEAK
- TELECOMMUNICATIONS TELEPORT, WITH 10 EMPLOYEES - NO ON-SITE FOOD SERVICE OR RETAIL SALES
- ALL OPEN AREA WITHIN PROPERTY BOUNDARY TO BE MAINTAINED BY OWNER
- ALL 2:1 SLOPES SHALL BE SEED AS NOTED ON SEDIMENT PLAN
- RECORDING REFERENCE PLAT 3715 P.81-025 PARCELS PLAT NO. 4754
- PARKING REQUIRED/SHOWN 10/16 SEC 133.0.5A
- TOTAL LOT AREA PARCELS-1 2.753 ACRES
- HANDICAPPED STALLS
- MIN. GREEN SPACE SHOWN 10%
- \* INDICATES WHITE PINE - MIN 2 1/2" COIL. (NUMBER SHOWN IN)
- ALL EXISTING CONCRETE PADS ARE BASE FOUNDATIONS FOR SATELLITE COMMUNICATIONS DISH ANTENNAS

\* REVISIONS APPROVED  
DIVISION OF LAND DEVELOPMENT

\* REVISED ENTRANCE, PARKING & PAVEMENT LOCATIONS

HOWARD COUNTY, MARYLAND  
DATE: 4-17-79

REVISIONS REFLECT IMPROVEMENTS TO ORIGINAL PLANS, AS OF AUGUST 27, 2004

PROPOSED CONCRETE PAD ADDED 11-14-05  
ADDRESSED AGENCY COMMENTS FROM 12-28-06

C&P TELEPHONE CO. OF MD.  
PARCEL "C-1"  
PLAT 3386

ROAD CONSTRUCTION CODE TO BE CONSTRUCTED IN ACCORDANCE WITH HOWARD CO. STANDARDS & SPECS.

| TYPICAL PAVING SECTION FOR DRIVEWAYS & PARKING LOTS |                 |
|---|-----------------|
| BITUMINOUS CONCRETE SURFACE                         | 1 1/2" BAND C-3 |
| BITUMINOUS CONCRETE BINDER                          | 5" GRAVEL       |
| CRUSHER RUN BASE                                    | 6"              |

NO SCALE:  
1. 310' x 8" DIA. 63" TO BE CONSTRUCTED IN ACCORDANCE WITH THE HOWARD COUNTY ROAD CONSTRUCTION CODE AND SPECIFICATIONS  
2. BASE WILL BE GRADED IN ACCORDANCE WITH SECTION C-50-3 AS PROVIDED IN THE HOWARD COUNTY ROAD CONSTRUCTION CODE AND STANDARD SPECIFICATIONS.  
3. TAKE CARE TO BE CONSTRUCTED IN ACCORDANCE WITH SECTION C-31-4 OF THE HOWARD COUNTY ROAD CONSTRUCTION CODE AND STANDARD SPECIFICATIONS.  
4. TYPICAL PAVING SECTION FOR DRIVEWAYS AND PARKING AREA.

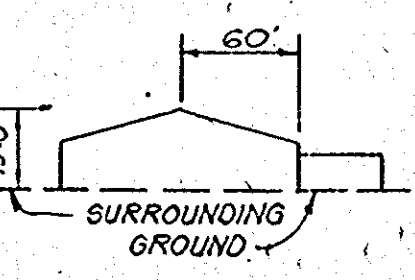

\* REVISIONS APPROVED

DATE: 4-17-79

REVIEWED FOR HOWARD S.C.D. AND MEETS TECHNICAL REQUIREMENTS.  
 C. Wayne Ray  
 US SOIL CONSERVATION SERVICE  
 1-3-78  
 DATE  
 THIS DEVELOPMENT PLAN IS APPROVED SOIL EROSION AND SEDIMENT CONTROL BY THE HOWARD SOIL CONSERVATION DISTRICT.  
 Wes Emer  
 HOWARD SOIL CONSERVATION DISTRICT  
 1-3-78  
 DATE

APPROVED FOR PUBLIC UTILITIES AND PUBLIC SEWERAGE SYSTEMS, HOWARD COUNTY HEALTH DEPARTMENT.  
 [Signature]  
 COUNTY HEALTH OFFICER  
 1-24-78  
 DATE  
 APPROVED FOR HOWARD COUNTY OFFICE OF PLANNING AND ZONING  
 [Signature]  
 PLANNING DIRECTOR  
 DATE  
 CHIEF DIVISION OF LAND DEVELOPMENT  
 DATE  
 APPROVED FOR PUBLIC WATER, PUBLIC SEWERAGE AND STORM DRAINAGE SYSTEMS AND ROADS  
 HOWARD COUNTY DEPARTMENT OF PUBLIC WORKS  
 [Signature]  
 DATE  
 CHIEF BUREAU OF HIGHWAYS  
 DATE

CONSTRUCTION SPECIFICATIONS

- I. SITE PREPARATION  
 AREAS UNDER THE EMBANKMENT AND STRUCTURAL WORKS SHALL BE CLEARED GRUBBED AND THE TOPSOIL STRIPPED TO REMOVE ALL TREES, VEGETATION, ROOTS OR OTHER OBJECTIONABLE MATERIAL. TO FACILITATE CLEAN OUT AND RESTORATION, IT IS RECOMMENDED THAT THE PERMANENT POOL AREA BE CLEARED OF ALL BRUSH AND TREES.
- II. EARTH FILL  
 MATERIAL  
 THE FILL MATERIAL SHALL BE TAKEN FROM APPROVED DESIGNATED BORROW AREA OR AREAS. IT SHALL BE FREE FROM ROOTS, STUMPS, WOOD, RUBBISH, OVERSIZE STONES, FROZEN OR OTHER OBJECTIONABLE MATERIALS. THE EMBANKMENT SHALL BE CONSTRUCTED TO AN ELEVATION WHICH PROVIDES FOR ANTICIPATED SETTLEMENT TO THE DESIGN ELEVATION. THE FILL HEIGHT ALL ALONG THE LENGTH OF THE EMBANKMENT SHALL BE INCREASED AT LEAST TO PERCENT ABOVE THE DESIGN ELEVATION (INCLUDING FREEBOARD) UNLESS OTHERWISE SHOWN ON THE PLANS.  
 PLACEMENT  
 AREAS ON WHICH FILL IS TO BE PLACES SHALL BE SCARIFIED PRIOR TO PLACEMENT OF FILL. FILL MATERIALS SHALL BE PLACED IN 8-INCH MAXIMUM THICKNESS (BEFORE COMPACTION) LAYERS WHICH ARE TO BE CONTINUOUS OVER THE ENTIRE LENGTH OF THE FILL. THE MOST POROUS BORROW MATERIAL SHALL BE PLACED IN THE DOWNSTREAM OF THE EMBANKMENT.  
 COMPACTION  
 WHEN EACH LAYER OF MATERIAL HAS BEEN CONDITIONED TO HAVE THE SPECIFIED MOISTURE, IT SHALL BE COMPACTED BY PASSING THE TAMPING ROLLER OVER IT 6 TIMES, AND WHEN COMPACTED THE DENSITY SHALL BE ESSENTIALLY UNIFORM THROUGHOUT THE LAYER. IF THE UNCOMPACTED EARTH/FILL MATERIAL IS TOO WET FOR PROPER COMPACTION, THE EARTH/FILL MATERIAL SHALL BE WORKED WITH HARROW, SCARIFIER, OR OTHER SUITABLE EQUIPMENT TO REDUCE THE MOISTURE CONTENT TO THE AMOUNT SPECIFIED; SHALL BE ALLOWED TO DRY UNTIL SUCH TIME AS THE MATERIAL CONTAINS ONLY THE SPECIFIED MOISTURE CONTENT; OR THE MATERIAL SHALL BE REMOVED FROM THE EMBANKMENT. COMPACTED EARTH MATERIAL HAVING A MOISTURE CONTENT OR DRY DENSITY THAT DO NOT MEET THE CRITERIA SPECIFIED SHALL BE REMOVED AND REOLDED. TO OBTAIN THE SPECIFIED MOISTURE CONTENT AND DRY DENSITY OF EMBANKMENT IN PLACE.

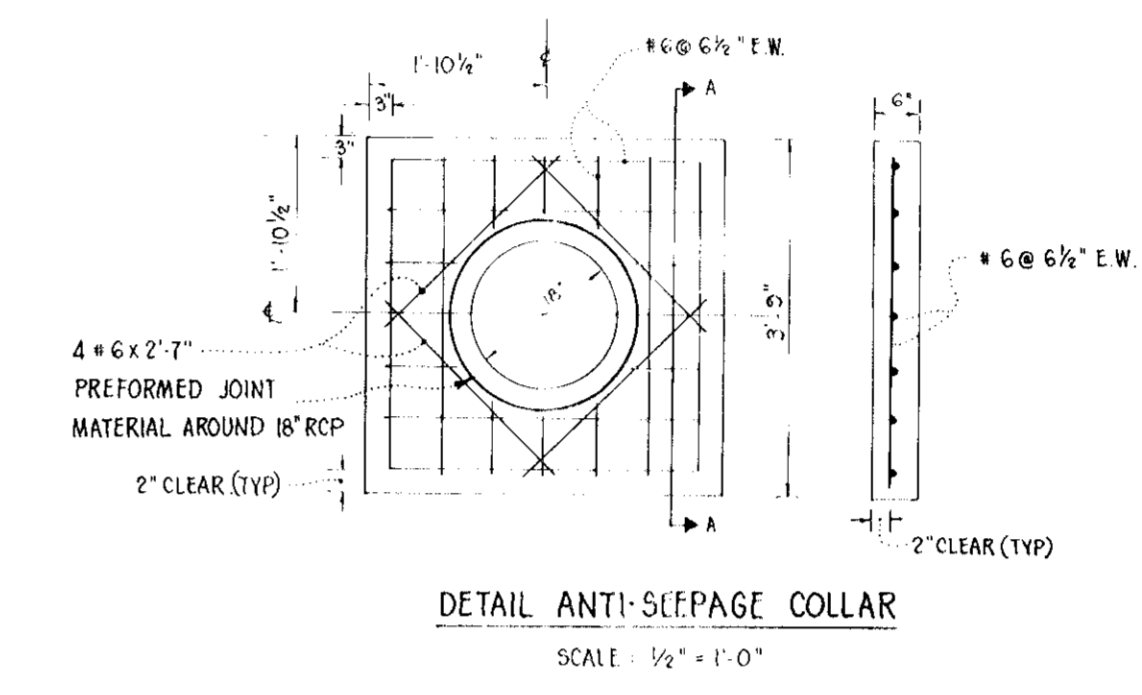
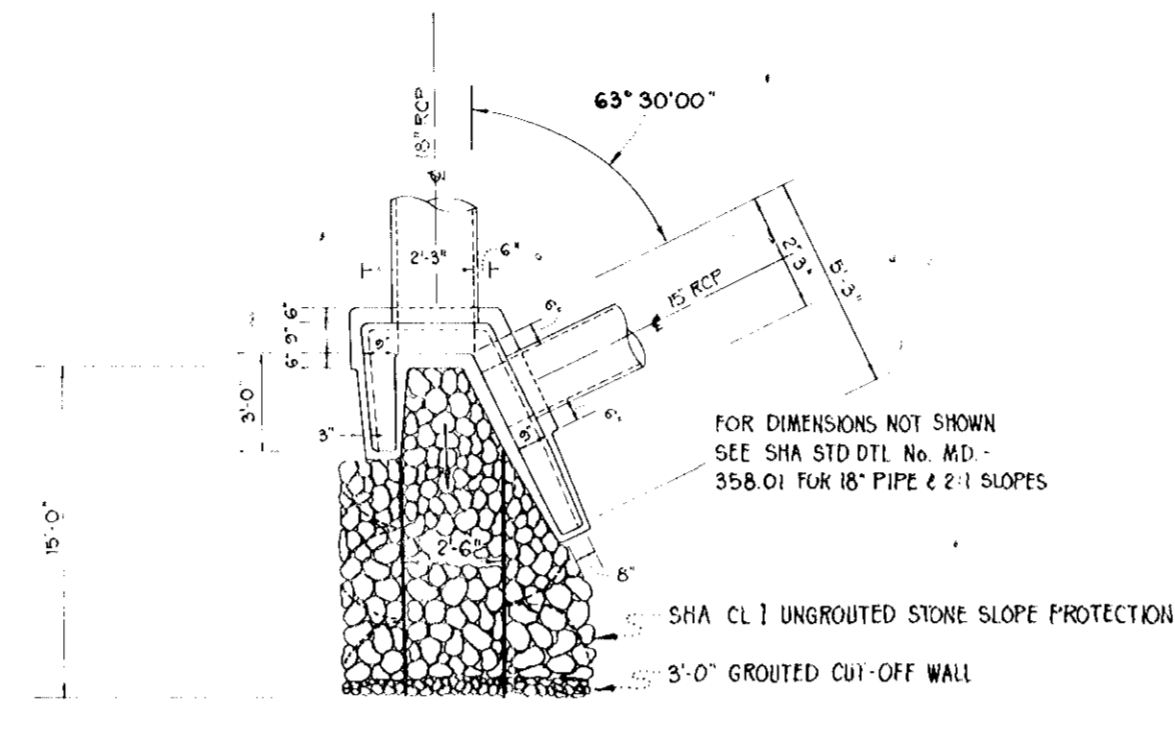
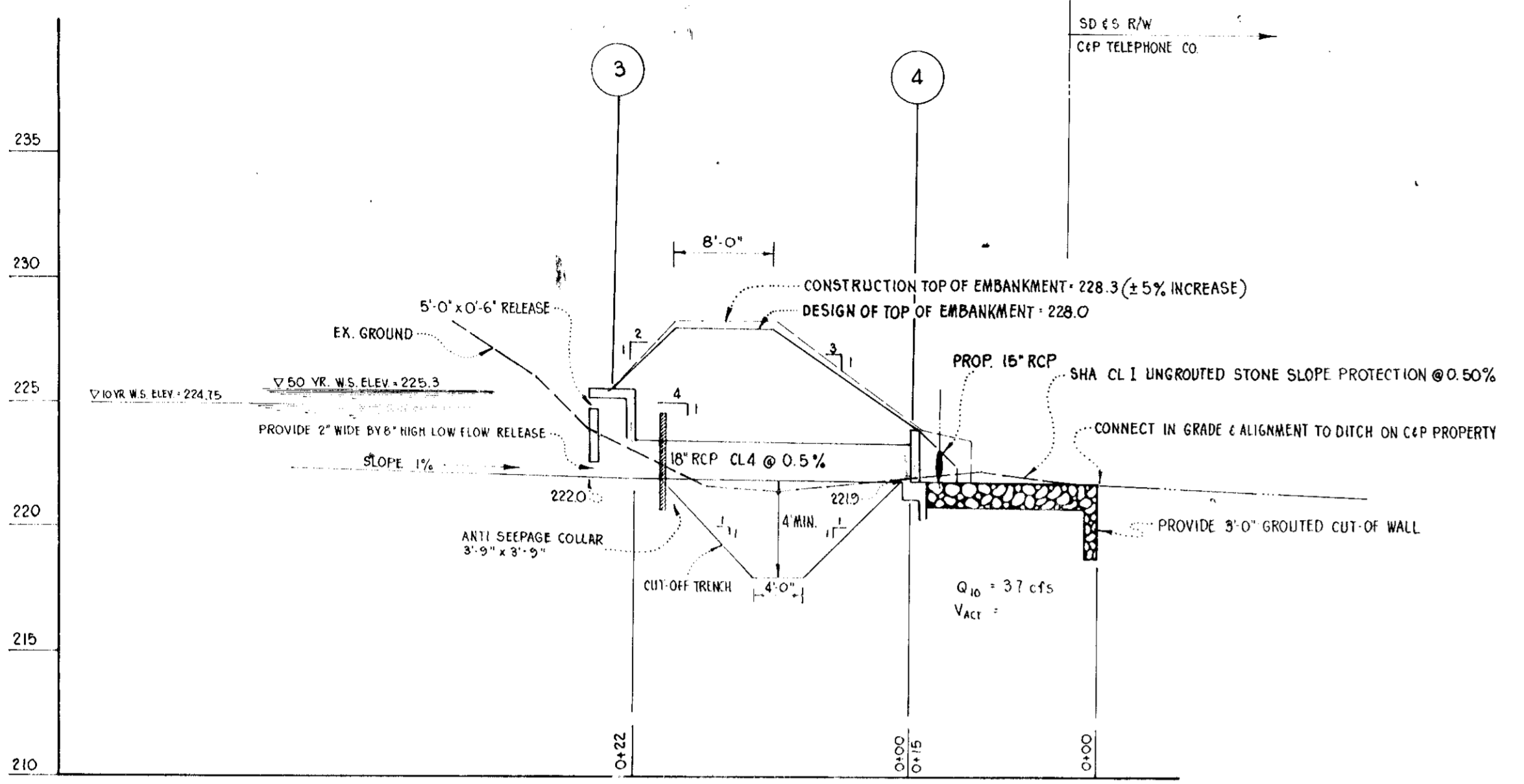

SWM\_POND HYDROLOGIC CRITERIA  
 1 DESIGN STORM: 2 YR EXISTING RELEASE / 10 YR DEVELOPED STORAGE  
 2 EX. 2 YR. Q = 0.8 cfs  
 3 DEVELOPED 10 YR Q = 15.7 cfs / V<sub>s</sub> = 24,500 cf → V<sub>s</sub> = 11,660 cf  
 4 DEVELOPED 50 YR Q = 21.2 cfs / V<sub>s</sub> = 33,220 cf → V<sub>s</sub> = 15,100 cf

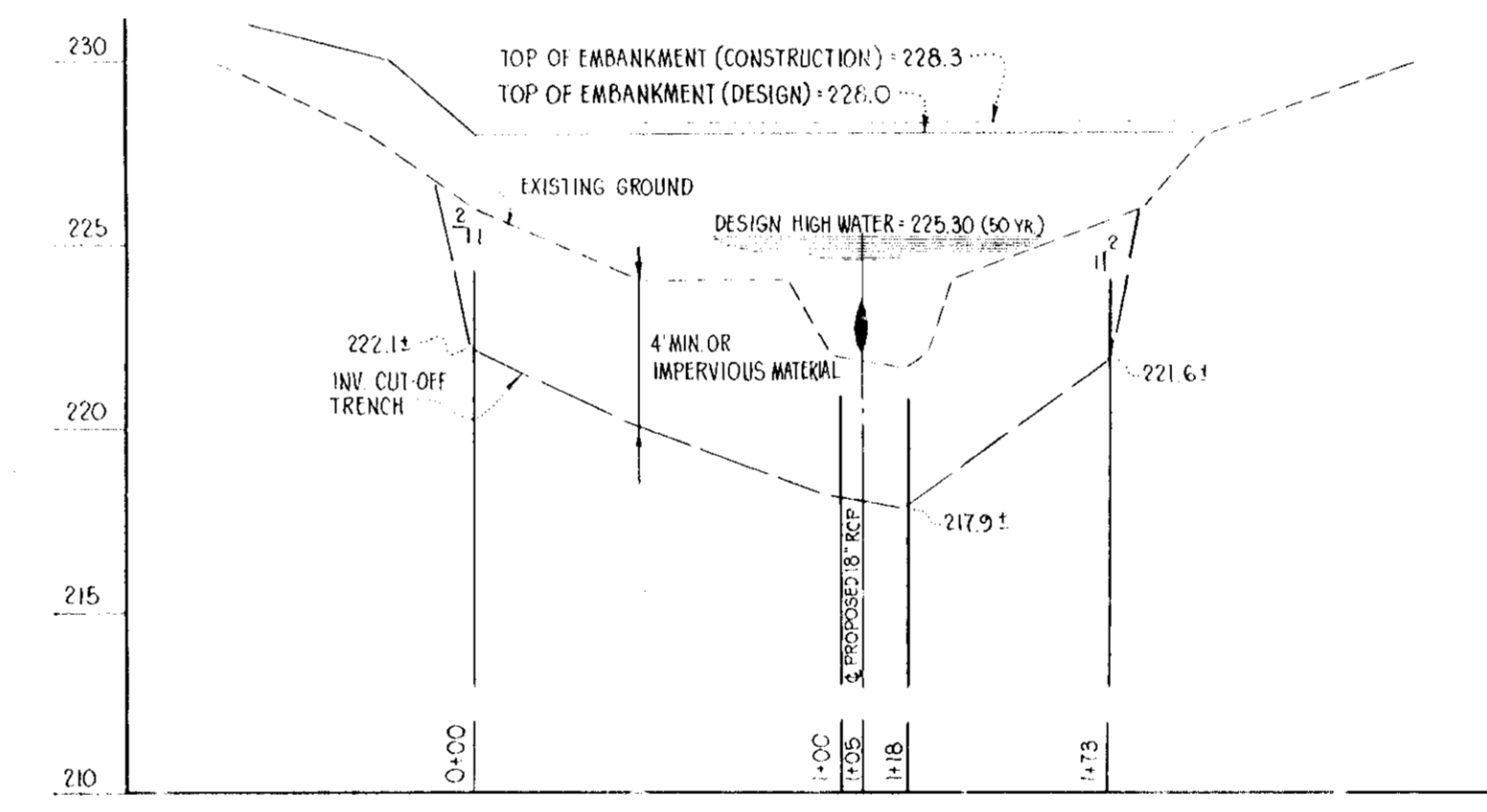
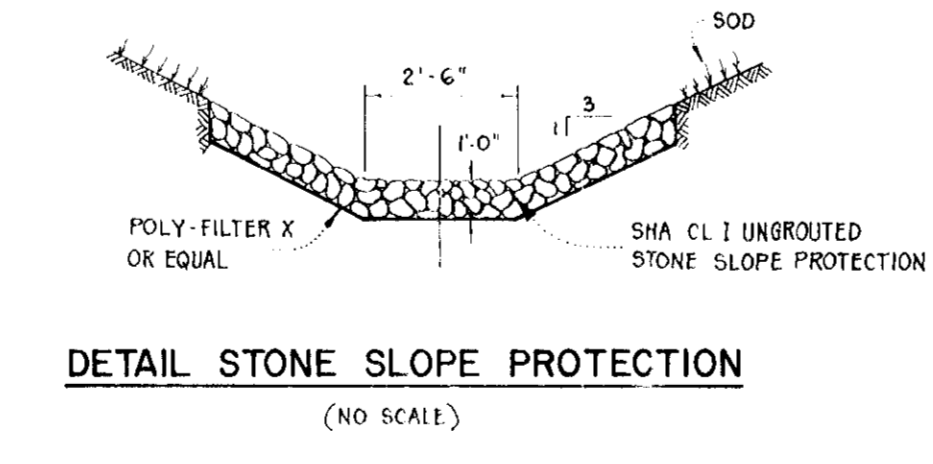
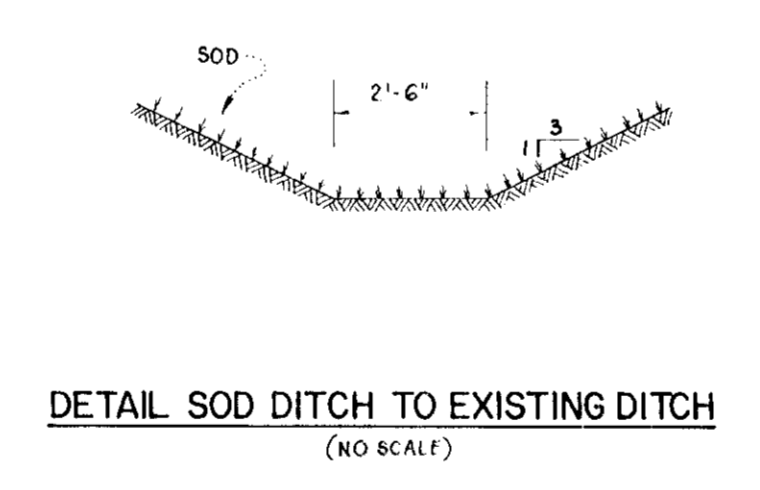
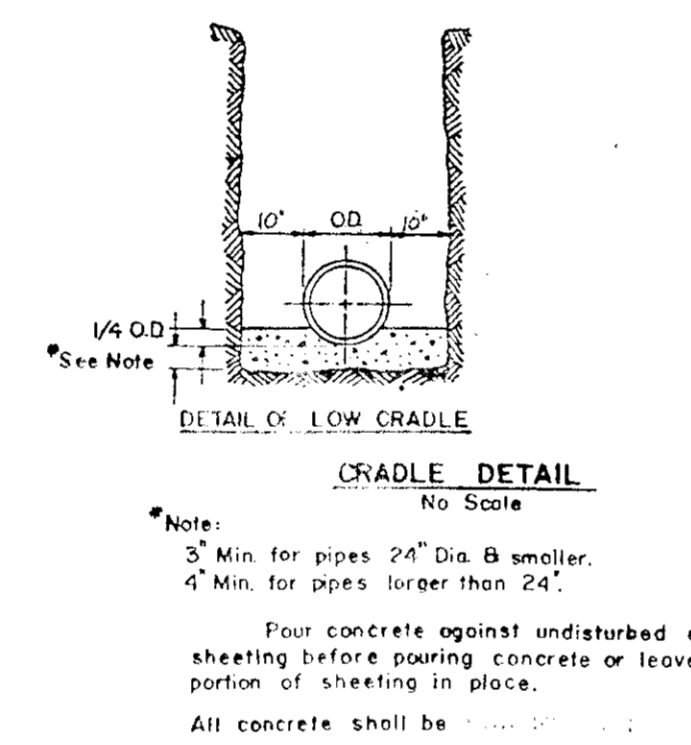
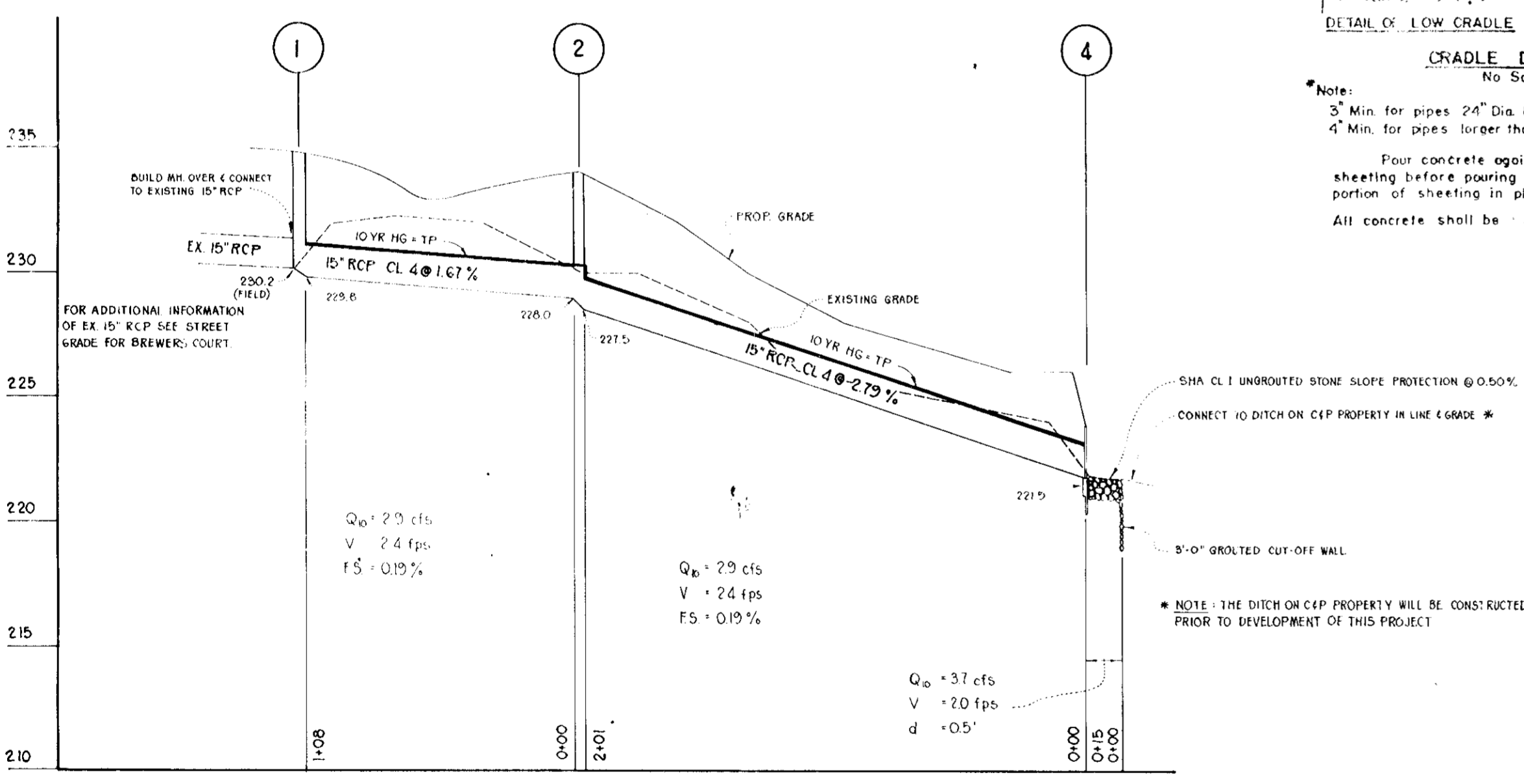

| NO. | TYPE            | TOP ELEVATION | STRUCTURE                                    | SCHEDULE | INLET | INLET |
|-----|-----------------|---------------|--|----------|-------|-------|
| 1   | 18" MANHOLE     | 235.7         | HOWARD CO. STD. DTL. 55D/9                   |          | 230.2 | 229.8 |
| 2   | 18" MANHOLE     | 234.0         | HOWARD CO. STD. DTL. 55D/9                   |          | 228.0 | 227.6 |
| 3   | A-S INLET       | 225.58        | HOWARD CO. STD. DTL. 64-A * PG 119-A         |          | 222.2 | 222.2 |
| 4   | SHA TYPE "E" EW | 224.07        | MODIFIED SHA STD. DTL. MD 356 OF (SEE ABOVE) |          | 221.9 | 221.9 |

\* PROVIDE 2" WIDE BY 8" HIGH OPENING IN STRUCTURE No. 3, INVERT OF OPENING TO BE 222.0

| PIPE SCHEDULE | DESCRIPTION | LENGTH |
|---------------|-------------|--------|
| 18" RCP CL 4  |             | 309    |
| 18" RCP CL 4  |             | 26     |

LANDOWNERS CERTIFICATION  
 I HEREBY CERTIFY THAT ALL WORK WILL BE COMPLETED PURSUANT TO THIS PLAN.  
 SIGNED: [Signature]

MAINTENANCE CERTIFICATION  
 I HEREBY AGREE TO ASSUME MAINTENANCE RESPONSIBILITIES FOR ALL STORM WATER MANAGEMENT STRUCTURES SHOWN HEREON. IF MAINTENANCE ANGE RESPONSIBILITY IS LEGALLY TRANSFERRED, I AGREE TO SUPPLY THE M.S.C.D WITH A COPY OF THE DOCUMENT (SIGNED BY BOTH PARTIES) TRANSFERRING SAID RESPONSIBILITY.  
 OWNER: [Signature] Sobel DATE: 11/1/77

| NO. | BY | DATE | REVISIONS |
|-----|----|------|-----------|
|     |    |      |           |

JOHNSON - McCORDIC - THOMPSON, P.A.  
 ENGINEERS • PLANNERS • SURVEYORS  
 1620 ELTON ROAD SILVER SPRING, MD. 20903  
 434-7000

STORM DRAINAGE DETAILS  
 PARCEL "E"  
**WHISKEY INDUSTRIAL PARK BOTTOM**  
 6TH ELECTION DISTRICT TAX MAP  
 HOWARD COUNTY MARYLAND

OWNER: RALPH SOBEL  
 1406 OLD BALTIMORE PIKE  
 BELTSVILLE, MARYLAND 20705  
 DESIGN: WAJ & DNL SHEET 13 OF 14  
 DRAFT: [Signature] DATE: AUG 1977 JOB NO: 7-085-2071-24  
 APPROVED: [Signature] SCALE: AS NOTED FILE NO: 7-085-21b

PLAN CERTIFICATION  
 I hereby certify that the plans and specifications for the proposed small pond were prepared under my supervision, and meet the minimum standards of the Howard Soil Conservation District.  
 I have also informed the owner of his responsibility to have the construction supervised and certified by a registered professional engineer within thirty (30) days of completion.  
 Signed: [Signature] P.E. Seal  
 NOTE: CONTRACTOR CONSTRUCTING THE EARTH/FILL EMBANKMENT SHALL INSURE THAT THE MATERIAL USED WILL PROVIDE ADEQUATE RESULTS WHEN TESTED IN ACCORDANCE WITH ASTM DESIGNATION: D-698-70. COMPACTION SHALL BE 95% AT OPTIMUM MOISTURE CONTENT.

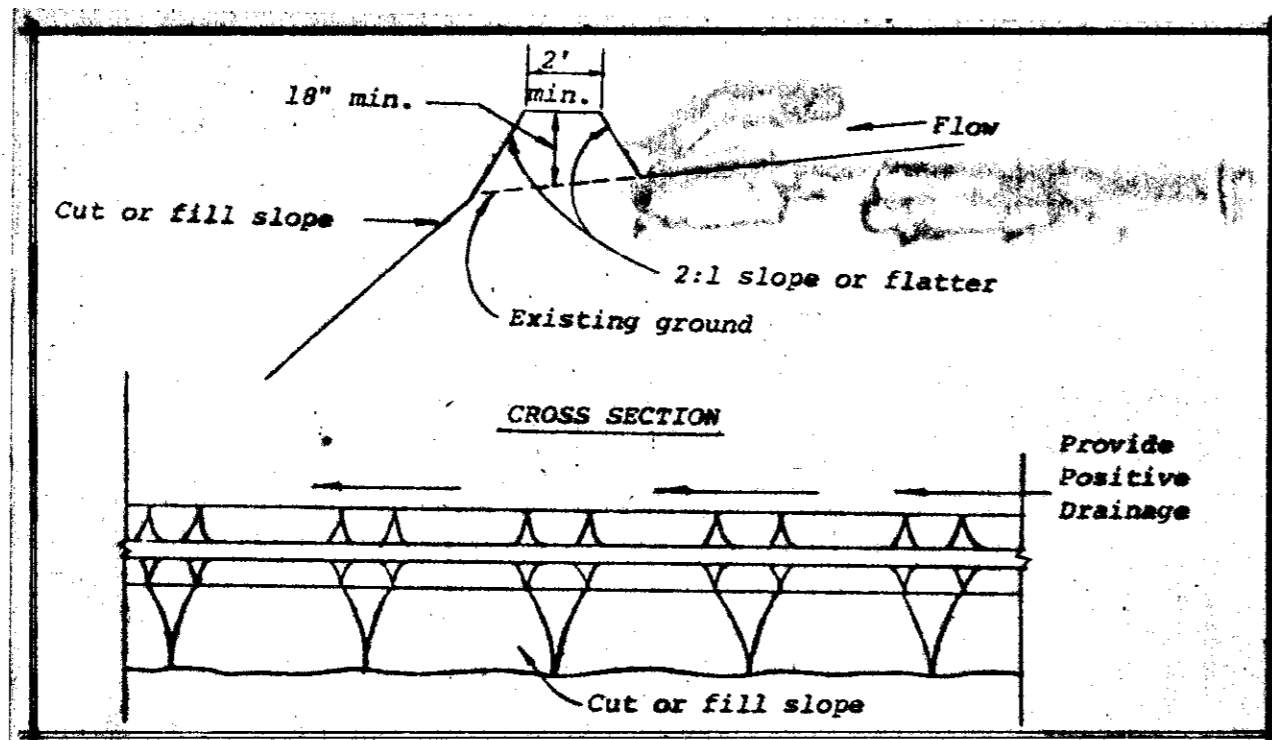
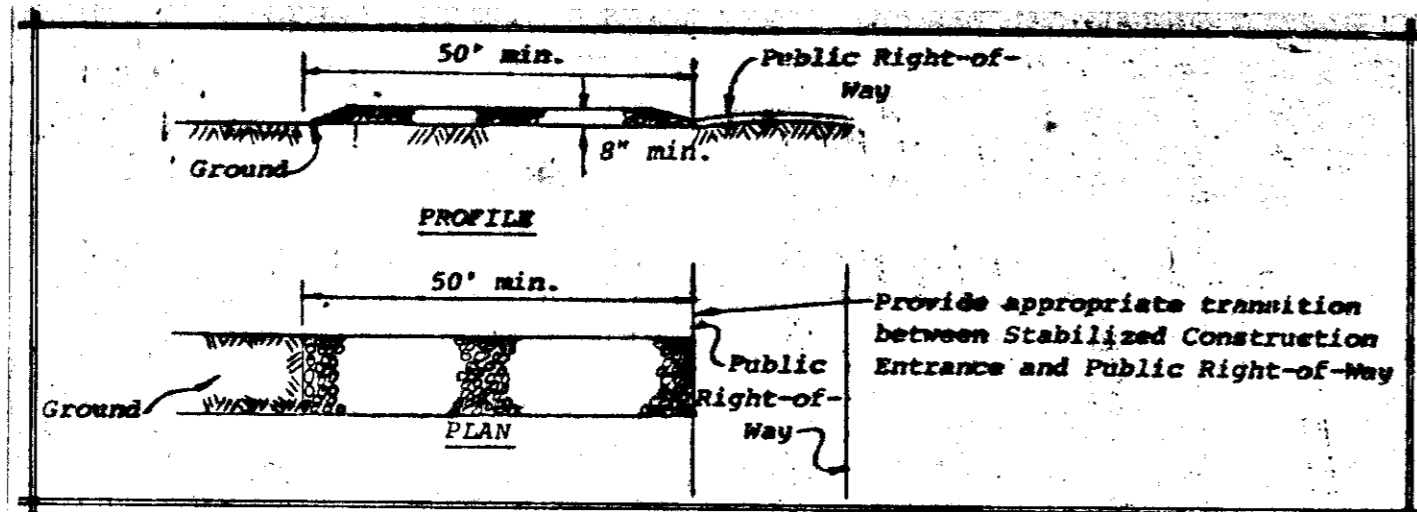
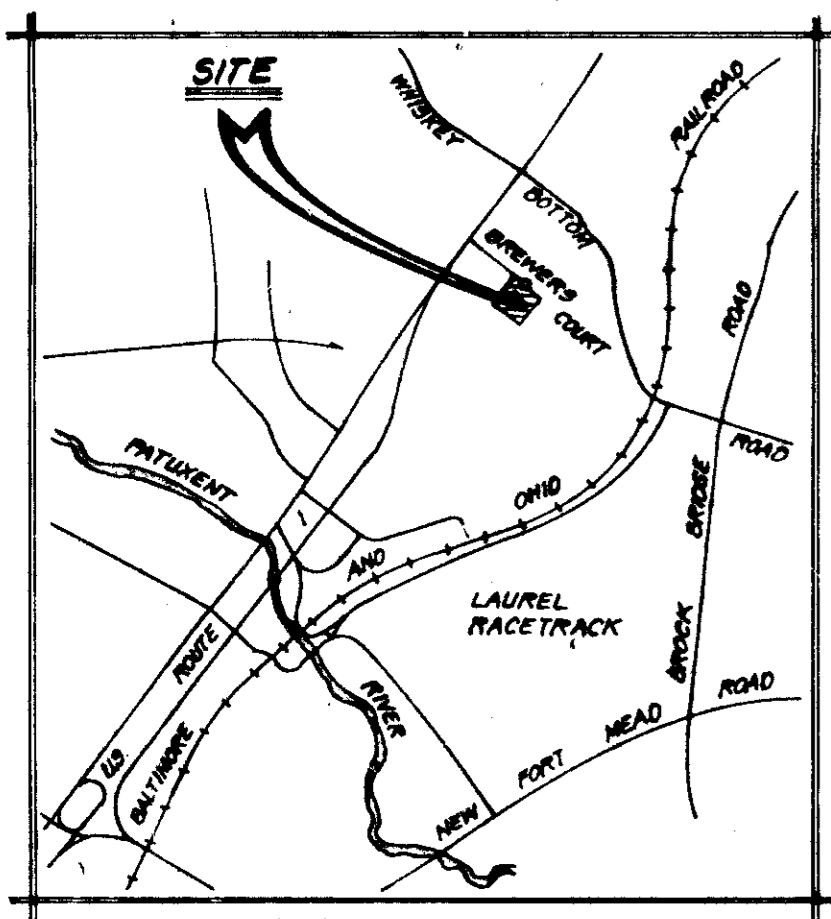

SEQUENCE OF CONSTRUCTION

|  |               |
|--|---------------|
| 1. INSTALL SEDIMENT CONTROL STRUCTURES                           | OCTOBER 1977  |
| 2. ROUGH GRADE SITE  | OCTOBER 1977  |
| 3. INSTALL UTILITIES   | NOVEMBER 1977 |
| 4. START BUILDING CONSTRUCTION                                   | DECEMBER 1977 |
| 5. FINE GRADE ENTRANCE & PARKING LOT                             | JANUARY 1978  |
| 6. PAVE PARKING LOT  | FEBRUARY 1978 |
| 7. REMOVE SEDIMENT TRAP & FINE GRADE POND                        | FEBRUARY 1978 |
| 8. STABILIZE REMAINING AREAS & REMOVE REMAINING SEDIMENT CONTROL | MARCH 1978    |

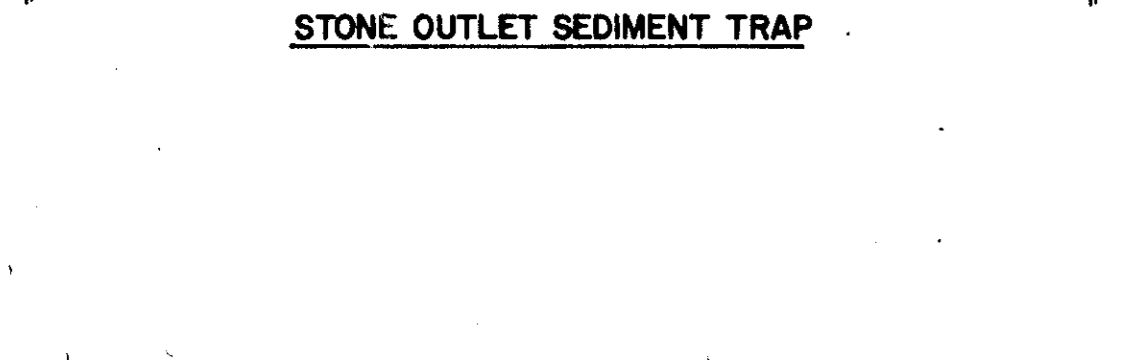
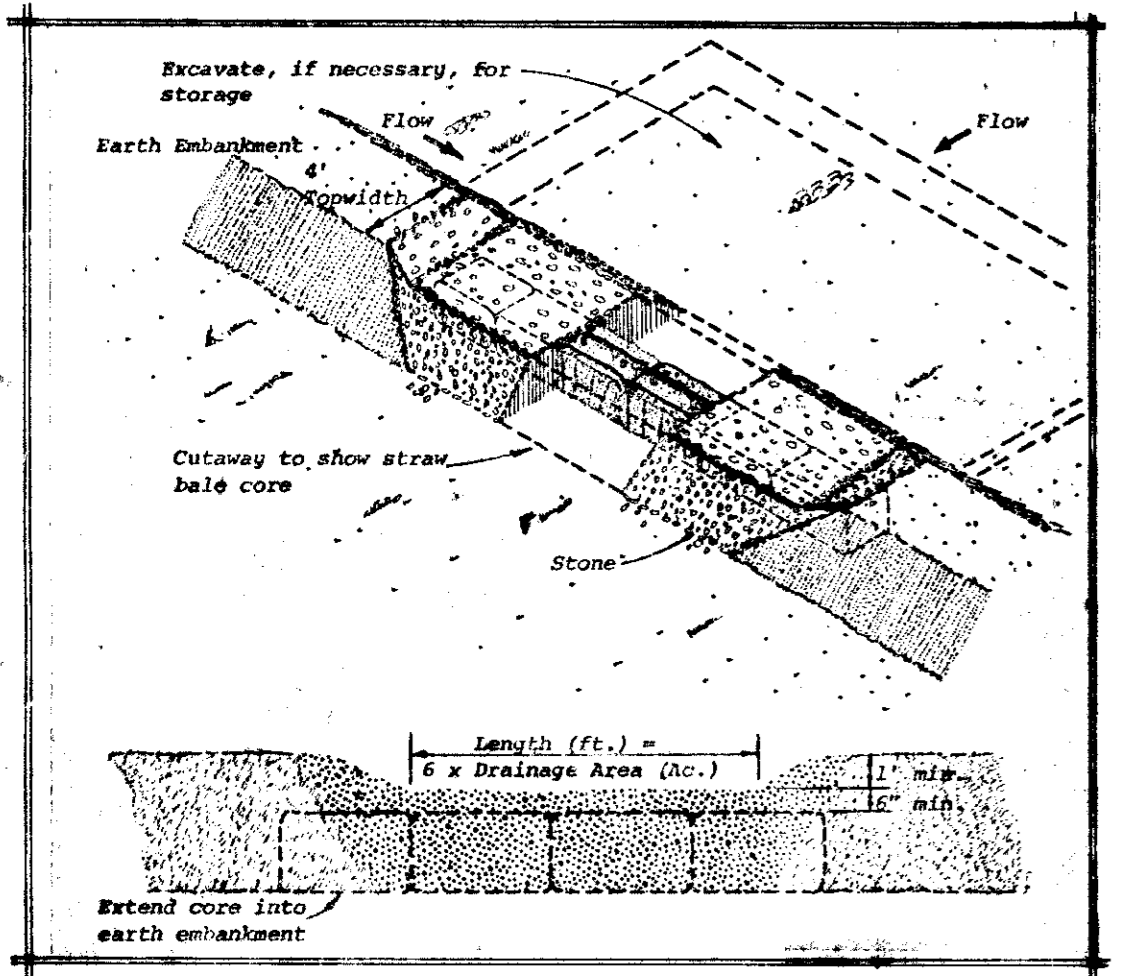

REVIEWED FOR HOWARD S.C.D. AND MEETS TECHNICAL REQUIREMENTS.

*D. Wayne Ray* 11/3/78  
US SOIL CONSERVATION SERVICE DATE

THIS DEVELOPMENT PLAN IS APPROVED SOIL EROSION AND SEDIMENT CONTROL BY THE HOWARD SOIL CONSERVATION DISTRICT.

*John F. Furr* 1-5-78  
HOWARD SOIL CONSERVATION DISTRICT DATE

APPROVED FOR PUBLIC WATER, PUBLIC SEWERAGE AND STORM DRAINAGE SYSTEMS AND ROADS  
HOWARD COUNTY DEPARTMENT OF PUBLIC WORKS

*M. Regard* 1 15 78  
DIRECTOR DATE

*W.O. Pickett* 1-13-77  
CHIEF, BUREAU OF ENGINEERING DATE

NOTE: THE H.S.C.D. AND BUREAU OF LICENSE & INSPECTION SHALL BE NOTIFIED AT LEAST 24 HOURS PRIOR TO GRADING OPERATIONS. SEDIMENT CONTROL STRUCTURE SHALL BE REMOVED ONLY WITH PERMISSION OF THE H.S.C.D.

DEVELOPER'S CERTIFICATION:

I CERTIFY THAT ALL DEVELOPMENT AND/OR CONSTRUCTION WILL BE ACCORDING TO THIS PLAN OF DEVELOPMENT AND PLAN FOR EROSION AND SEDIMENT CONTROL AND I ALSO AUTHORIZE PERIODIC ON-SITE INSPECTION BY THE HOWARD SOIL CONSERVATION DISTRICT OR THEIR AUTHORIZED AGENTS AS ARE DEEMED NECESSARY. DEVIATION FROM THIS PLAN WILL NOT BE MADE UNLESS AUTHORIZED BY THE HOWARD SOIL CONSERVATION DISTRICT.

*Ralph Sobel* 11/1/77  
DEVELOPER DATE

ENGINEER'S CERTIFICATION:

I CERTIFY THAT THIS PLAN FOR EROSION AND SEDIMENT CONTROL REPRESENTS A PRACTICAL AND WORKABLE PLAN BASED ON MY PERSONAL KNOWLEDGE OF THE SITE CONDITIONS AND THAT IT WAS PREPARED IN ACCORDANCE WITH THE REQUIREMENTS OF THE HOWARD SOIL CONSERVATION DISTRICT.

*Michael B. McCordic* 12/22/77  
MICHAEL B. MCCORDIC, MD P.E. #5251 DATE

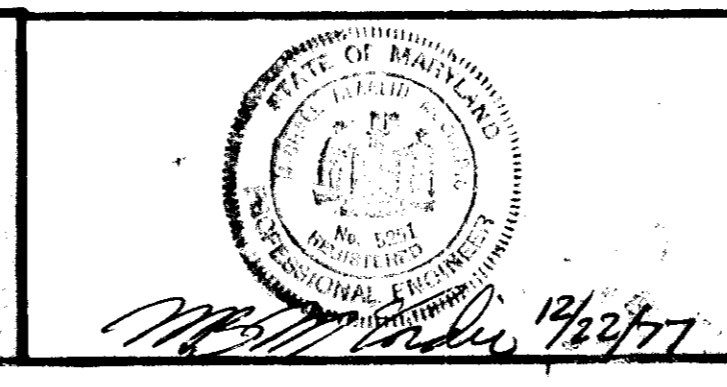

JOHNSON - McCORDIC - THOMPSON, P.A.  
ENGINEERS PLANNERS SURVEYORS  
1820 ELTON ROAD SILVER SPRING, MD. 20903  
434-7000

APPROVED  
DIVISION OF LAND DEVELOPMENT  
HOWARD COUNTY, MARYLAND  
DATE 12-7-77

SEDIMENT TRAP DESIGN DATA  
D.A. 1.7 ACRES  
REQUIRED STORAGE 3075 CF  
STORAGE PROVIDED 3168 CF  
DIMENSIONS 8' x 30' x 50'

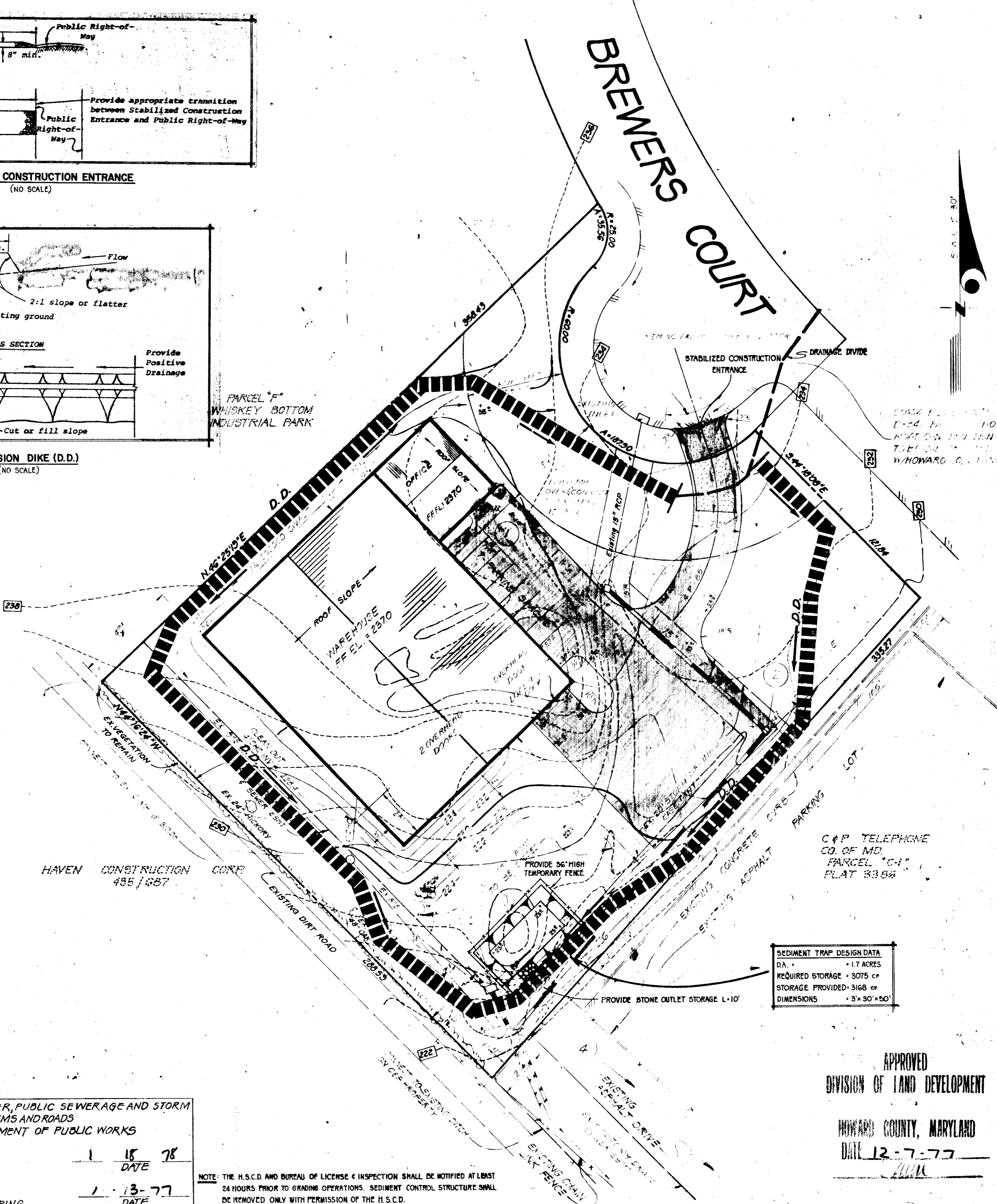

- SEDIMENT CONTROL NOTES
1. ALL REFERENCES TO STANDARDS & SPECIFICATIONS SHALL MEAN "STANDARDS & SPECIFICATIONS FOR SOIL EROSION AND SEDIMENT CONTROL IN DEVELOPING AREAS," DATED JULY, 1975.
  2. ALL SEDIMENT CONTROL MEASURES ARE TO BE ADJUSTED TO MEET FIELD CONDITIONS.
  3. ALL SEDIMENT CONTROL MEASURES TO REMAIN IN PLACE UNTIL PERMISSION FOR THEIR REMOVAL HAS BEEN OBTAINED FROM THE HOWARD COUNTY BUREAU OF INSPECTIONS.
  4. CONTRACTOR INSTALLING THE SEDIMENT AND EROSION CONTROL FACILITIES SHALL OBTAIN AND FOLLOW THE SPECIFICATIONS FOR SILT AND SEDIMENT CONTROL AS DISTRIBUTED BY THE HOWARD COUNTY SOIL CONSERVATION DISTRICT.
  5. ALL DISTURBED AREAS ARE TO BE DIRECTED TO DRAIN TO THE SEDIMENT DEVICES PROVIDED. NO DISTURBED AREAS ARE TO BE ALLOWED TO DRAIN DIRECTLY OFF THE SITE.
  6. THE CONTRACTOR SHALL BE RESPONSIBLE FOR ASSURING THAT THE SEDIMENT CONTROL MEASURES ARE FUNCTIONAL AT THE END OF EACH DAY.
  7. ALL DIVERSION DIKES DESTROYED DURING INSTALLATION OF UTILITIES SHALL BE REPLACED IMMEDIATELY.
  8. THE OPENING OF THE STORM DRAINAGE INLETS SHALL BE PROTECTED AND KEPT FREE OF ANY DEPOSITS OF SEDIMENT, SOD, THROUGH USE OF SANDBAGS, GRAVEL OR OTHER APPLICABLE METHOD UNTIL ALL THE UPHILL AREAS HAVE BEEN STABILIZED.
  9. ALL DISTURBED AREAS BELOW STORM DRAIN OUTFALLS SHOULD BE STABILIZED IMMEDIATELY AFTER THEY ARE GRADED.
  10. ALL STRUCTURES UTILIZING COMPACTED EARTH FILL ARE TO BE COMPOSED OF MATERIAL TAKEN FROM APPROVED BORROW AREAS AND SHALL BE FREE OF ROOTS, WOODY VEGETATION, ROCKS AND OTHER OBJECTIONABLE MATERIAL. A MINIMUM OF 10% SHALL BE ALLOWED FOR SETTLEMENT FILLS TO BE PLACED IN 6" LIFTS AND COMPACTED AS LAID.
  11. ALL AREAS OF INGRESS-EGRESS ARE TO BE PROTECTED FROM TRACKING MUD ONTO PUBLIC RIGHTS OF WAY.
  12. PERIODIC INSPECTION AND MAINTENANCE ARE TO BE PROVIDED TO INSURE EFFICIENCY OF ALL FACILITIES.
  13. A TEMPORARY FENCE, 36" MIN. HEIGHT, SHALL BE INSTALLED AROUND ALL SEDIMENT TRAPS. FENCE POSTS SHALL BE 10'-0" O/C.
  14. ALL SEDIMENT CONTROL MEASURES ARE TO BE CONSTRUCTED PRIOR TO GRADING AND SHALL BE FUNCTIONAL BEFORE GRADING CONSTRUCTION BEGINS.
  15. FOR SOIL TYPES SEE: "SOIL SURVEY OF HOWARD COUNTY, MARYLAND," SHEET 31.
  16. ALL SEDIMENT TRAPS DESTROYED DURING UTILITY INSTALLATION SHALL BE RESTORED AT THE END OF EACH DAY.

- SODDING AND SEEDING NOTES
1. SEDIMENT TRAPS, DIVERSION DIKES AND INTERCEPTOR DIKES ARE TO BE TEMPORARY SEEDED WITH KENTUCKY 31 FESCUE 5-7 LBS. PER 1,000 FT<sup>2</sup> IMMEDIATELY AFTER THEY ARE CONSTRUCTED.
    - A. ALL TEMPORARY SEEDED AREAS SHALL BE MULCHED IMMEDIATELY AFTER SEEDING. MULCH MATERIALS SHOULD BE UNWEATHERED, UNCHOPPED, SMALL GRAIN STRAW SPREAD AT A RATE OF 1-1/2 TO 2 TONS PER ACRE. THE MULCH SHALL BE ANCHORED IMMEDIATELY AFTER PLACEMENT WITH ASPHALT, PEG AND TWINE, PLASTIC NETTINGS OR BY A MULCH ANCHORING TOOL.
    - B. LIME AND FERTILIZER SHALL BE REQUIRED FOR TEMPORARY SEEDINGS IN ACCORDANCE WITH THE FOLLOWING PROCEDURE:
      - (1) PULVERIZED DOLOMITIC LIMESTONE IS TO BE APPLIED AT THE RATE OF 46 LBS PER 1000 SQ. FT.
      - (2) FERTILIZER SHALL BE 10-10-10 OR EQUIVALENT AND APPLIED AT THE RATE OF 12 TO 18 LBS PER 1000 SQ. FT.
  2. ALL DISTURBED AREAS SHALL BE FINALLY STABILIZED WITH SEED OR SOD IMMEDIATELY UPON COMPLETION OF FINE GRADING IN ACCORDANCE WITH THE FOLLOWING PROCEDURE.
    - A. TOPSOIL SHALL BE UNIFORMLY DISTRIBUTED ON THE DESIGNED AREAS AND SHALL BE A MINIMUM DEPTH OF 3-INCHES AFTER FIRING.
    - B. DOLOMITIC LIMESTONE IS TO BE APPLIED AT THE RATE OF 75 LBS PER 1000 SQ. FT.
    - C. FERTILIZER SHALL BE 10-10-10 AND APPLIED AT THE RATE OF 23 LBS. PER 1000 SQ. FT.
    - D. SOD IS TO BE APPROVED OR BETTER KENTUCKY 31 FESCUE.
    - E. LIME AND FERTILIZER SHALL BE UNIFORMLY MIXED INTO THE TOP 4-INCHES OF SOIL BY DISCING, HARROWING OR OTHER APPROVED METHODS.
    - F. SEED SHALL BE 0-20% KENTUCKY BLUEGRASS, 80-100% KENTUCKY 31 TALL FESCUE AT THE RATE OF 6 TO 8 LBS. PER 1000 SQ. FT.
    - G. ALL DISTURBED AREAS NOT SODDED, SHALL BE SEEDED.
    - H. SOD SHALL BE PLACED ON ALL ON-SITE WELL DEFINED SWALES.