

HOUSE TYPES

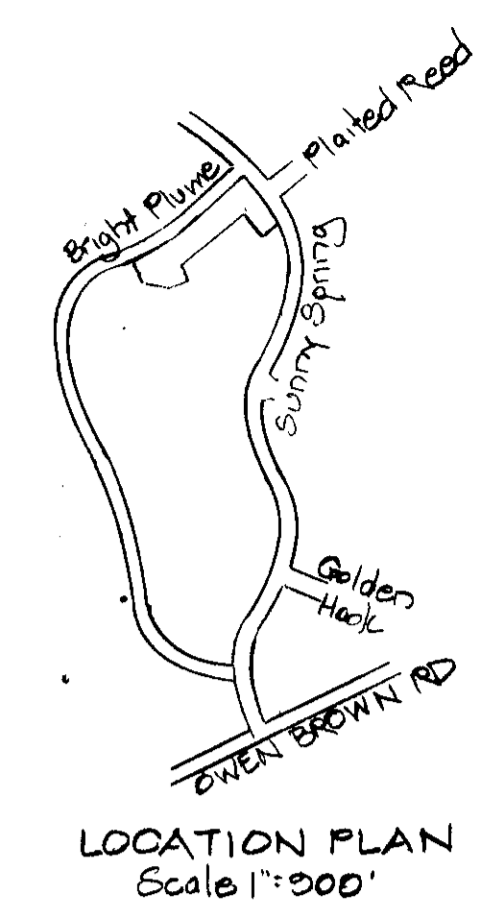
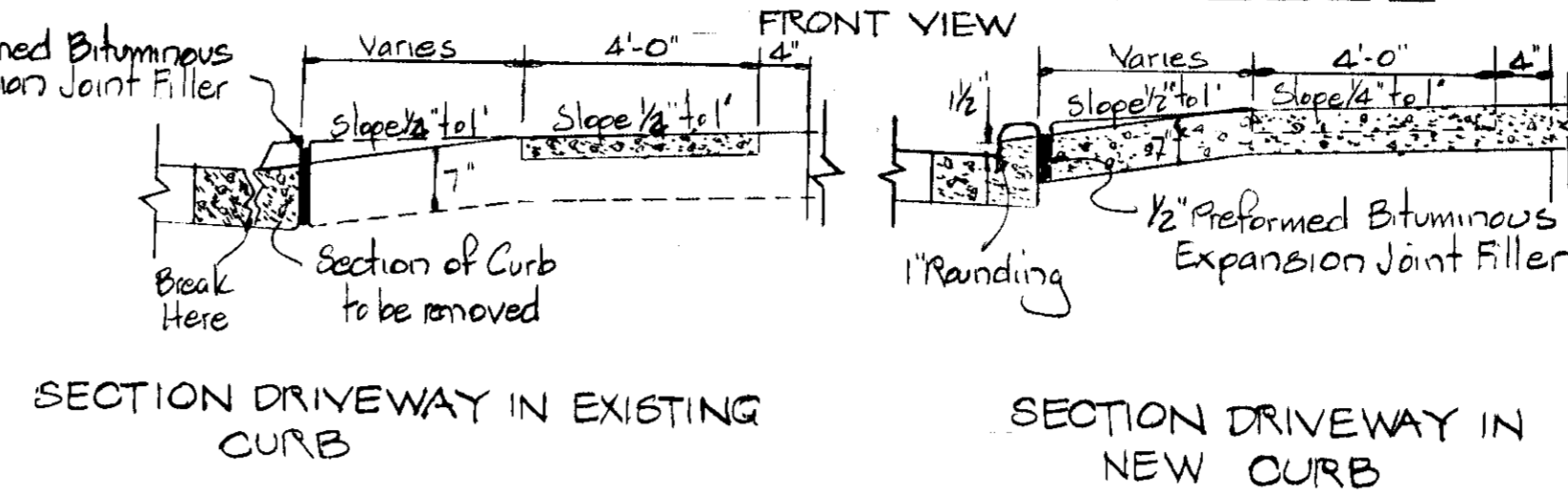
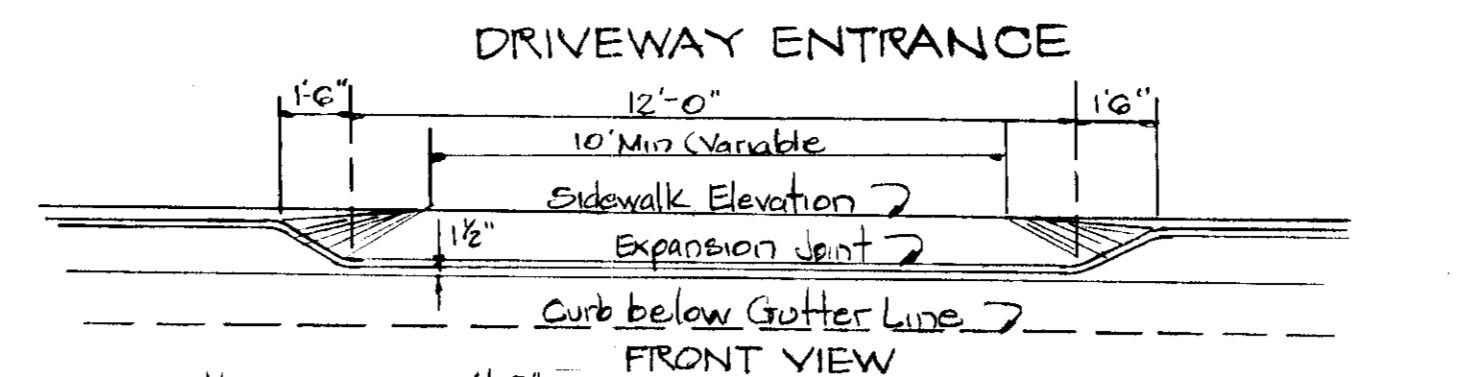

GENERAL NOTES

1. Tax Map No. 35
2. Total Area - 2.12 Ac.
3. Public water & sewer to be utilized
4. All coordinates are based on Maryland State Grid System. Elevations are based on the U.S. Coast & Geodetic Survey Mean Sea Level Datum 1929.
5. All driveways to be built as per Howard Co. Road Construction Code D-34 page 83
6. For bearings & distances of individual lot lines see record plat recorded as plats \*3552 & \*3555
7. All houses off of the main street shall have signs posted on the main street with numbers indicating their location
8. Note all house dimensions from roof eaves, all houses have no overhangs or decks

SITE ANALYSIS

1. Zoning New Town
2. Number of Lots shown: 10
3. Area included in this submission: 2.12 Ac.

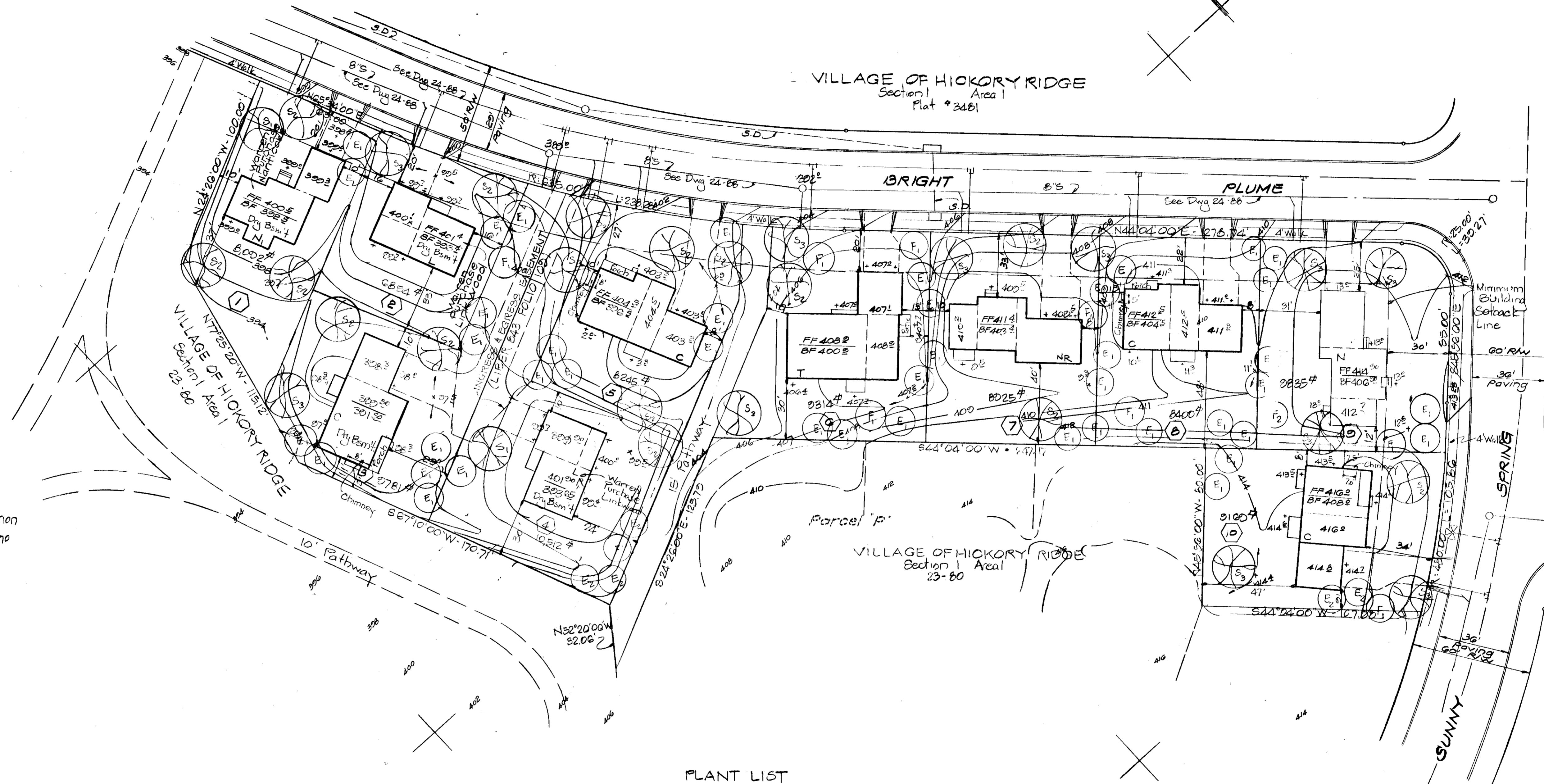

PLANT LIST

| SPECIES  | SIZE        | QUANTITY |
|--|-------------|----------|
| S <sub>1</sub> NYSSA SYLVATICA (Black Gum)         | 2 1/2" - 3" | 2        |
| S <sub>2</sub> TILIA CORDATA (European Linden)     | 2 1/2" - 3" | 14       |
| S <sub>3</sub> ACER SACCHARUM (Sugar Maple)        | 2 1/2" - 3" | 13       |
| F <sub>1</sub> CORNUS FLORIDA (White Dogwood)      | 8' - 10'    | 11       |
| F <sub>2</sub> MALUS 'ARNOLDIANA' (Arnold Crab)    | 8' - 10'    | 1        |
| E <sub>1</sub> PINUS STROBUS (White Pine)          | 0' - 8"     | 41       |
| E <sub>2</sub> TSUGA CANADENSIS (Canadian Hemlock) | 0' - 8"     | 5        |

OWNER  
The Stefanowicz Corp.  
10854 York Road  
Cockeysville, Md 21030

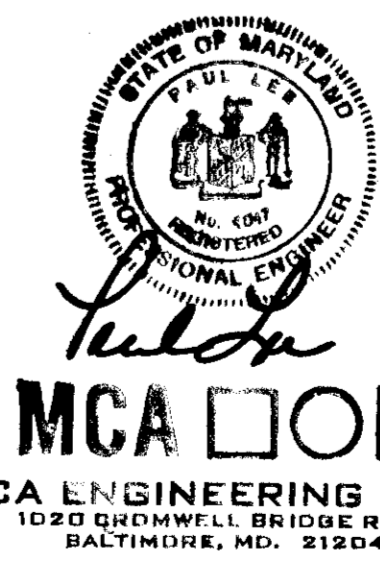

SITE DEVELOPMENT PLAN  
Lots P1 to P10  
Section 1 Area 1  
"VILLAGE OF HICKORY RIDGE"  
COLUMBIA, MARYLAND  
Scale: 1"=30'  
Election District 5  
June 21, 1977  
Rev Aug 3, 1977  
Rev Sept 1, 1977

APPROVED  
DIVISION OF LAND DEVELOPMENT  
HOWARD COUNTY, MARYLAND  
DATE 9-13-77

APPROVED: For Public Water & Public Sewerage Systems, Howard County Health Department.  
Joseph A. Bogdans 9-17-77  
County Health Officer Date  
APPROVED: Howard County Office of Planning & Zoning  
Thomas L. Harris 9-27-77  
Planning Director Date  
APPROVED: For Public Water, Public Sewerage & Storm Drainage System & Roads  
Howard County Department of Public Works  
P. J. Regan Jr 9-22-77  
Director Date  
G. M. McElreath 9/22/77  
Chief, Bureau of Highways Date

**SITE DATA**

1. Tax Map 35 Parcel 283
2. Existing Zoning New Town.
3. Total site area 2.20 Ac<sup>±</sup>
4. Disturbed area 2.20 Ac<sup>±</sup>:  
 Impervious area 0.73Ac Vegetatively stabilized 1.47Ac

**SEDIMENT CONTROL NOTES**

1. Howard County Bureau of Licenses, Inspections & Permits to be notified 24 hrs in advance of any construction start.
2. Before general grading operation, contractor to construct straw bale dikes (SBD) & stone driveway filters as shown on plan.
3. Contractor to direct all surface runoff to perimeter dike & stone filters & no silt is to be allowed to enter street R/W or leave property.
4. Contributing area to each stone filter is less than 0.6 Ac<sup>±</sup>.
5. Contractor to maintain sediment control measures on a daily basis. Inspections shall be performed after rains and as frequently as needed to fulfill above maintenance req't.
6. All disturbed areas to be seeded as follows:  
 Creeping Red fescue (50%) & certified Kentucky Bluegrass (50%) @ 130% acre  
 Prepare Surface:  
 Ground Limestone @ 2 tons/ac  
 Commercial Fertilizer (10-10-10) @ 1/2 tons/ac  
 Superphosphate @ 600#/Ac
7. Removal of any sediment control measure only with approval from Howard County & only after site according to note #6 above.
8. All sediment control measures to be constructed according to the Standards & Specifications for Soil Erosion & Sediment Control in Developing Areas.
9. All dirt which is tracked or washed into existing street shall be returned to the site on a weekly basis.

**ENGINEER'S CERTIFICATION**

I certify that this plan for erosion & sediment control represents a practical & workable plan based on my personal knowledge of the site conditions and that it was prepared in accordance with the requirements of the Howard County Soil Conservation District.

*Paul Lee* DATE 7-11-77  
 MCA ENGINEERING CORP  
 1020 CROMWELL BR ROAD  
 BALTIMORE, MD 21204

**DEVELOPER'S CERTIFICATION**

I certify that all development and/or construction will be done according to this plan of development and plan of erosion & sediment control and I also authorize periodic on-site inspection by Howard Co. Soil Conservation District or their authorized agents, as are deemed necessary. Dev't on this plan only if authorized by Howard County Soil Conservation District.

*Sheta Stephens, Jr.* DATE 7-11-77  
 The Stephens Corp.  
 1084 York Road  
 Cockeysville, Md 21030

Reviewed for Howard County S.C.D. meets technical requirements

*Wendell Boudette* DATE 9-19-77  
 U.S. Soil Conservation Service

The development plan is approved for soil erosion & sediment control by the Howard County Soil Conservation District

Approved *John D. Wilgus* DATE 9-19-77  
 Howard County E.O.D.

**SEQUENCE OF CONSTRUCTION**

1. Notify proper county agencies before work begins at least 48hrs.
2. Clearing & construction of sediment control measures Aug '77
3. Rough grading of site Aug '77
4. Construction of houses & utilities Sept '77
5. Final grading & stabilization of disturbed areas Nov '77
6. Maintenance: immediately upon completion
7. Lots 344 houses to be built @ same time.

APPROVED: For Public Water & Public Sewerage Systems Howard County Health Department

*Joseph Borden* DATE 9-27-77  
 County Health Officer

APPROVED: Howard County Office of Planning & Zoning

*Thomas A. Smith* DATE 9-27-77  
 Planning Director

Chief, Division of Land Development Date

APPROVED: For Public Water, Public Sewerage & Storm Drainage Systems & Roads  
 Howard County Department of Public Works

Director DATE 9/1/77  
 Chief, Bureau of Highways Date

**LEGEND**

- 380- Existing Ground Elev
- 380- Proposed Grade Elev
- SPD Straw bale dike
- SCE Stabilized Construction Entrance

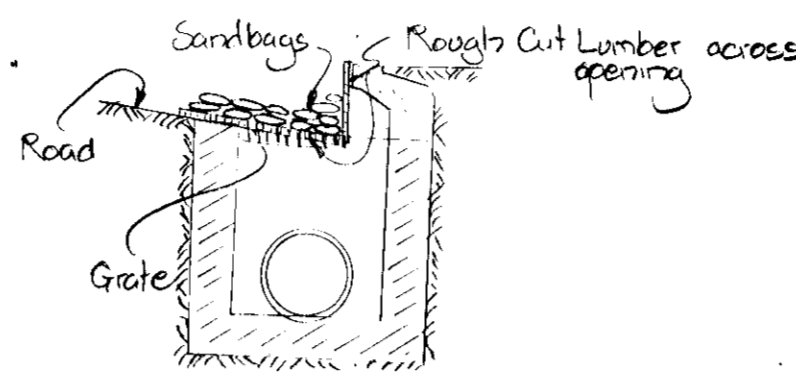
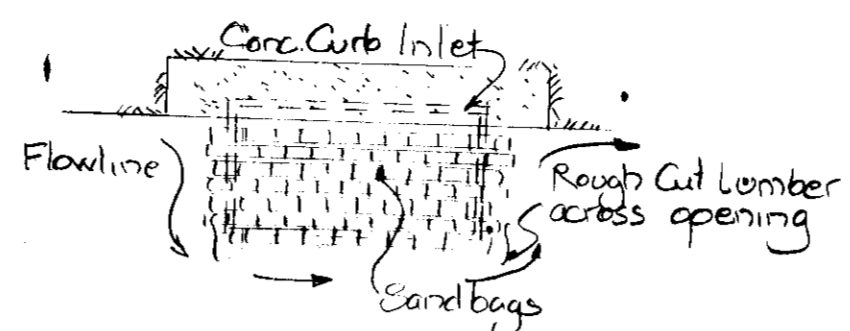

INOPERATIVE INLET  
 DETAIL  
 No Scale

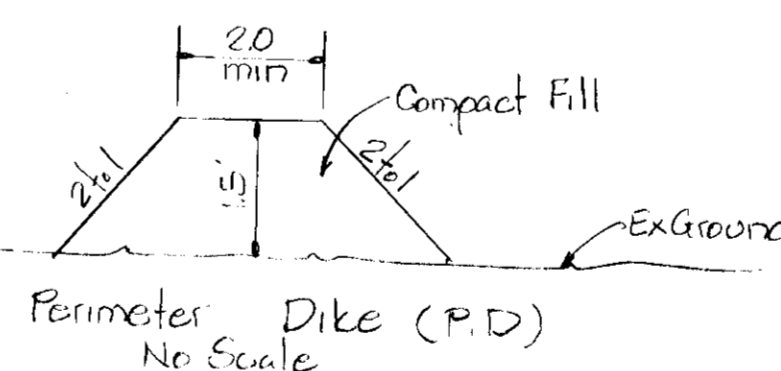
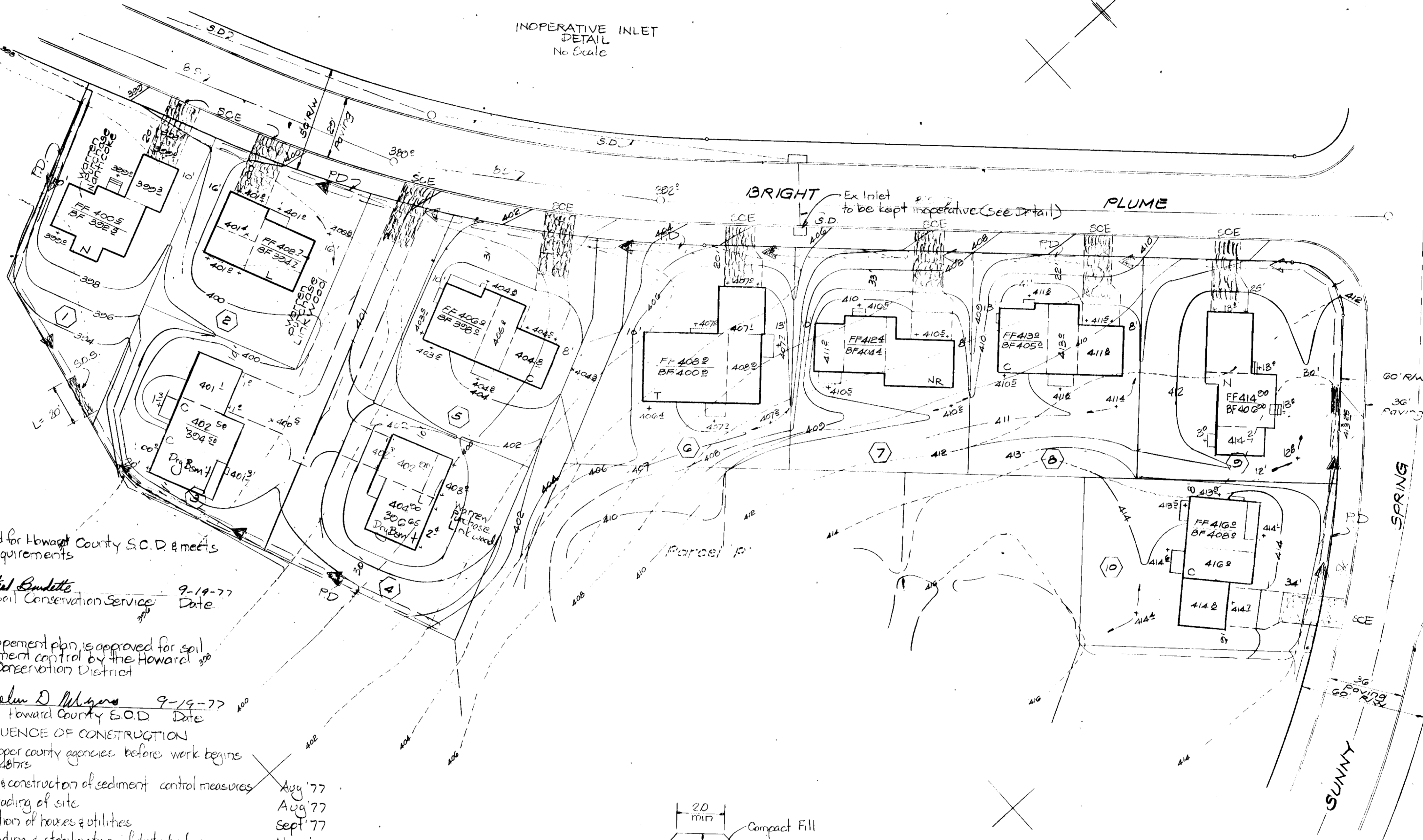

Perimeter Dike (P.D.)  
 No Scale

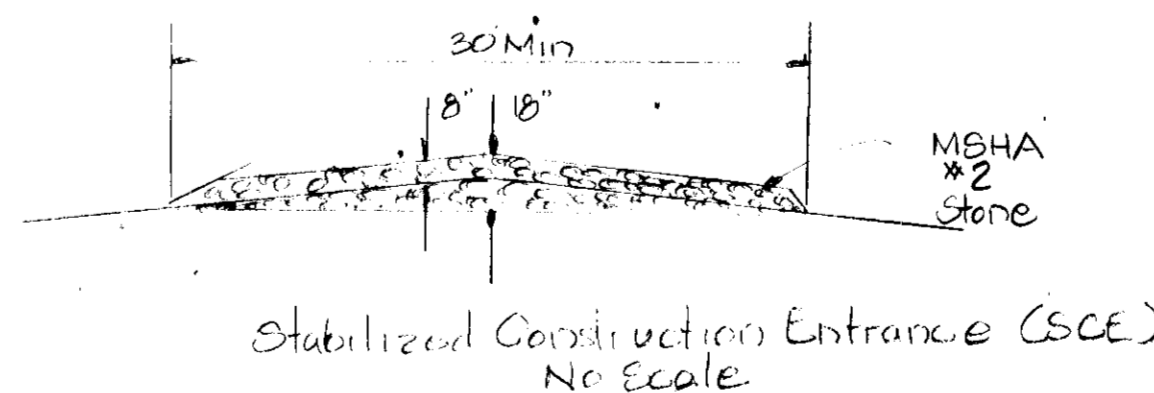

Stabilized Construction Entrance (SCE)  
 No Scale

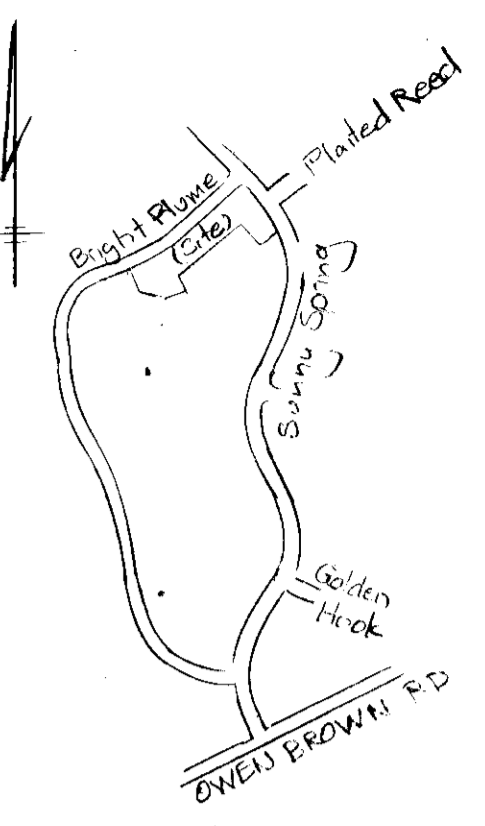

LOCATION PLAN  
 Scale 1"=200'



**MCA**  
 MCA ENGINEERING CORP.  
 1020 CROMWELL BR ROAD  
 BALTIMORE, MD 21204

SITE AND SEDIMENT CONTROL PLAN  
 Lots P1 to P10  
 Section 1, Area 1  
 "VILLAGE OF HICKORY RIDGE"  
 COLUMBIA, MARYLAND  
 July 11, 1977  
 Rev July 19, 1977  
 Scale: 1"=30'

9-13-77