

VEGETATIVE COVER OPTIONS

11.6.1 TO MAY 1
 1. SOE
 2. SEED & MULCH

MAY 1 TO AUG 15
 1. SOE
 2. MULCH, ANCHOR, TOOL THEN SEED DURING NEXT PERIOD

AUG. 15 TO NOV. 1
 1. SOE
 2. SEED & MULCH

NOV. 1 TO 11.6.1
 1. SOE DELAY UNTIL NEXT PERIOD IF GROUND IS FROZEN
 2. MULCH, ANCHOR, TOOL, THEN SEED DURING NEXT SEED PERIOD

TEMPORARY SEEDING PROCEDURES

1. SEED IMMEDIATELY UPON CONSTRUCTION WITH 1 LB. RYE GRASS / 1000 SF
2. APPLY 46 LBS / 1000 SF OF PULVULIZED DOLOMITIC LIMESTONE @ 11.5 LBS TO 18.4 LBS / 1000 SF
3. HARKON OR DISC LIME & FERTILIZER INTO THE SOIL TO A DEPTH OF AT LEAST 3 IN. CONTINUE TILLAGE UNTIL AREA IS FULLY FINE FIRM SEEDBED HAS BEEN PREPARED. ON SLOPING LAND THE FINAL HARKONING SHOULD BE ON THE CONTOUR.
4. MULCH WITH STRAW @ 15 # / 1000 SF.

PERMANENT SEEDING PROCEDURES

1. APPLY 50 LBS / 1000 SF OF LIME STONE
2. APPLY FERTILIZERS @ RATE OF 25 LBS OF 10-10-10 PER 1000 SF DEPENDING ON SOIL TESTS.
3. HARKON OR DISC FERTILIZER INTO SOIL TO A DEPTH OF 3 IN.
4. SEED WITH RY 31 TALL FESCUE @ RATE OF 5 LBS / 1000 SF OF OTHER SCS APPROVED PLAN.
5. MULCH WITH SMALL GRAIN STRAW 15 TO 20 TONS / ACRE (75 # 50 # / 1000 SF)
6. ANCHOR, MULCH W/ STRAW @ ASPHALT @ 0.1 GAL / SQ. YD.

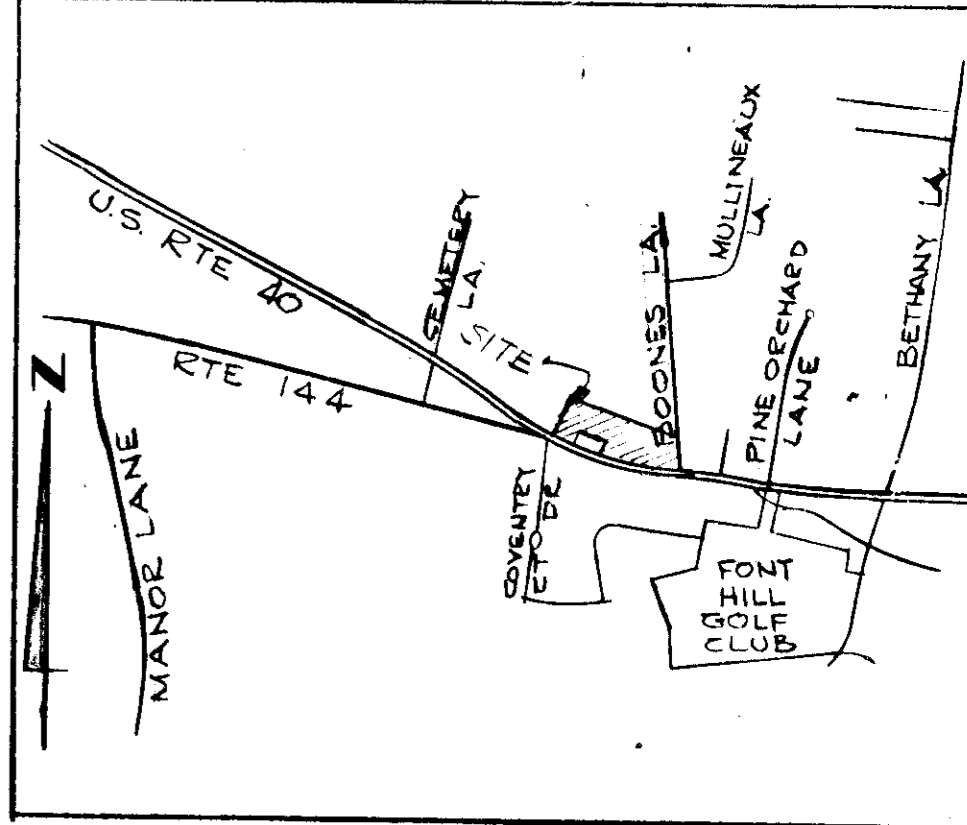

1. EX. ZONING R-20
 2. NO. OF ENTICEMTS 10-
 3. NO. OF PARKING SPACES REQ.
 4. NO. OF PARKING SPACES PROV.
 5. THERE IS TO BE NO VISUAL BARRIER BETWEEN AREA UNLESS APPROVED BY HOWARD CO. OFFICE OF PLANNING
 NOTE: * DENOTES EXTERIOR LIGHTING
 250 WATT MERCURY LUMINAIRE (E=11' HIGH)

NOTES:

1. THE CONCRETE PAD FOR THE FUEL TANK 17'-4" x 6'-8" THICK. REINFORCING SHALL BE #5 REBAR EACH WAY WITH 3500 PSI CONCRETE.
2. THE CONCRETE PAD FOR THE FUELING AREA IS 11' x 24' x 8" THICK. REINFORCING SHALL BE #5 REBAR EACH WAY WITH 3500 PSI CONCRETE.
3. OUTDOOR LIGHTING SHALL BE IN ACCORDANCE WITH SECTION 134 OF THE HOWARD COUNTY ZONING REGULATIONS. THE LIGHTING WILL BE LOCATED WITHIN THE OVERHEAD CANOPY. THE LIGHTING WILL BE (2) TWO JET PHILIPS 400 WATT DMM CANOPY LIGHTS.

SEDIMENT CONTROL NOTES

1. NOTIFY THE HOWARD CO. BUREAU OF INSPECTION & PERMITS AT LEAST 24 HRS. BEFORE STARTING WORK 465-3000
2. ALL SEDIMENT CONTROL DEVICES ARE TO REMAIN IN PLACE UNTIL PERMITS FOR REMOVAL HAS BEEN OBTAINED FROM THE HOWARD CO. BUREAU OF INSPECTION & PERMITS
3. STRUCTURAL MEASURES SUCH AS BERMS, DUNES, TRAPS, BASINS, ETC. WILL BE INSTALLED & STABILIZED ACCORDING TO THE PLAN PRIOR TO ANY DISTURBANCE OF THE EXISTING SURFACE OF THE SITE.
4. ON SITE INSPECTION MAINTENANCE OF ALL SEDIMENT CONTROL MEASURES INCLUDING CLEANOUT OF SEDIMENT TRAPS & BERMS & PROPER ESTABLISHMENT OF ALL PLANNED VEGETATIVE MEASURES WILL BE THE RESPONSIBILITY OF DEVELOPER OR HIS REPRESENTATIVE ON THE SITE ON A CONTINUING DAY TO DAY BASIS.

ENGINEER:
 HUDKINS ASSOC., INC.
 200 E. JOPPA RD.
 TOWSON, MD. 21204
 828-9060

APPROVED: FOR TRAVEL WATER AND PRIVATE SEWAGE SYSTEMS
 HOWARD CO. HEALTH DEPT.
 COUNTY HEALTH OFFICE
 8-16-77
 DATE

ENGINEER
 I CERTIFY THAT THE PLAN FOR EROSION AND SEDIMENT CONTROL REPRESENTS A PRACTICAL AND WORKABLE PLAN BASED ON MY PROFESSIONAL KNOWLEDGE OF THE SITE CONDITIONS AND THAT IT WAS PREPARED IN ACCORDANCE WITH THE REQUIREMENTS OF THE HOWARD SOIL CONSERVATION DISTRICT

Signature: Howard K. K...
 DATE: 3/22/77

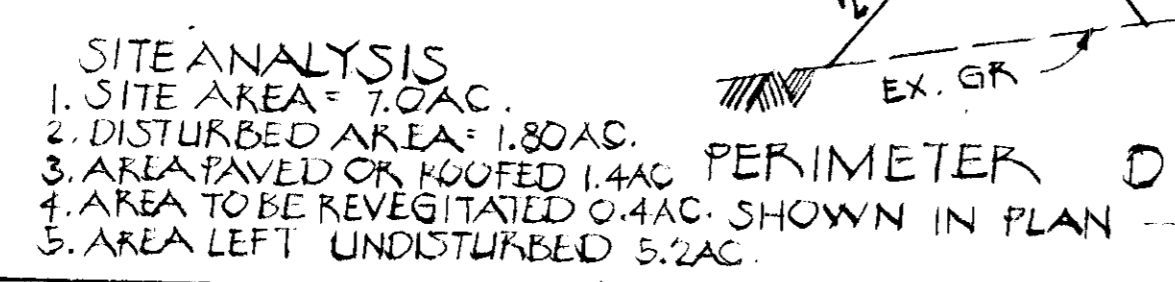

SEQUENCE OF CONSTRUCTION

1. OBTAIN GRADING PERMIT
2. NOTIFY HOWARD CO. BUREAU OF INSPECTION & PERMITS (465-3000)
3. INSTALL SEDIMENT CONTROL DEVICES
4. ROUGH GRADE SITE
5. PROCEED WITH BUILDING & UTILITY CONSTRUCTION
6. REPAIR DEVICES AS REQUIRED
7. FINE GRADE SITE & PROCEED WITH PAVING
8. STABILIZE DISTURBED AREAS ACCORDING TO SEDIMENT CONTROL MANUAL & THIS PLAN
9. REMOVE SEDIMENT CONTROL DEVICES AFTER OBTAINING HOWARD CO. APPROVAL

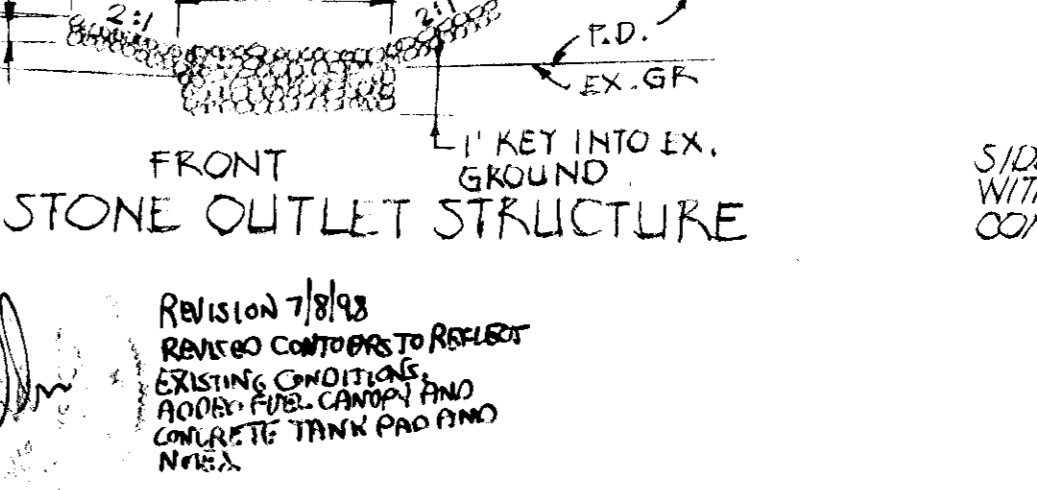
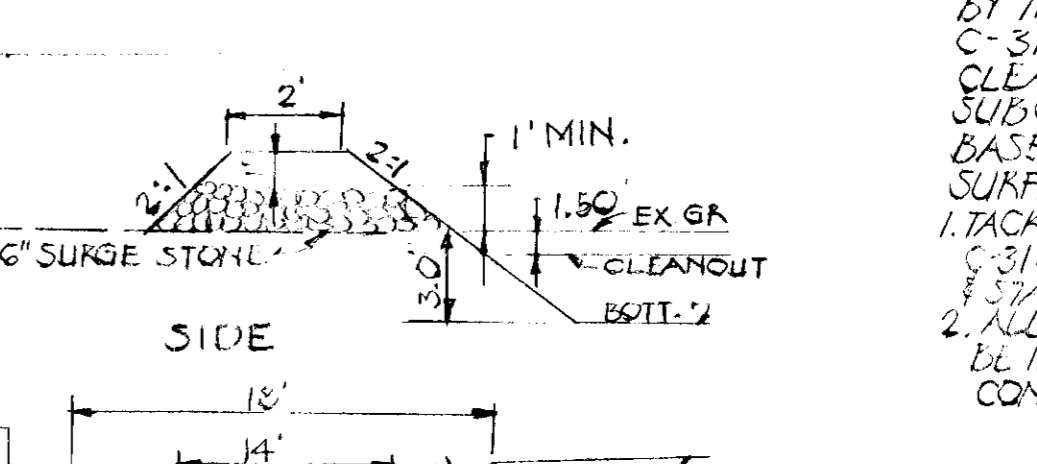
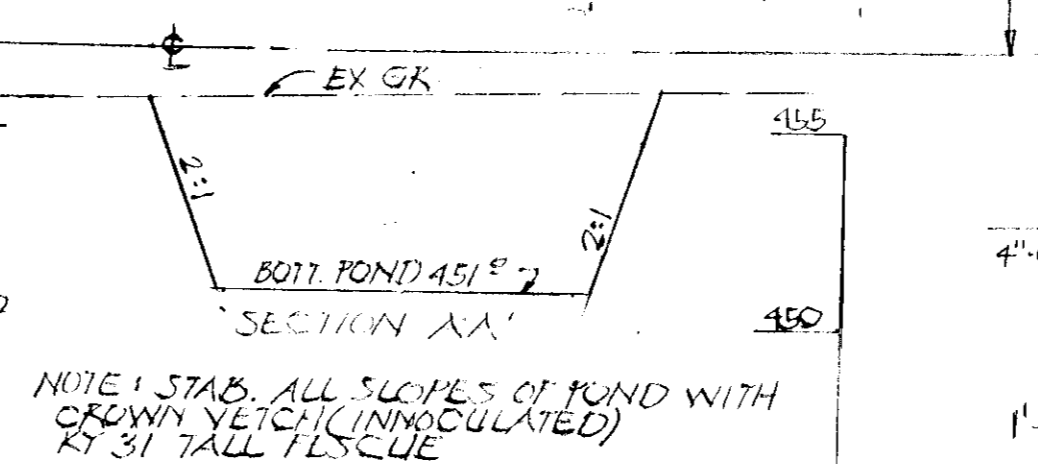
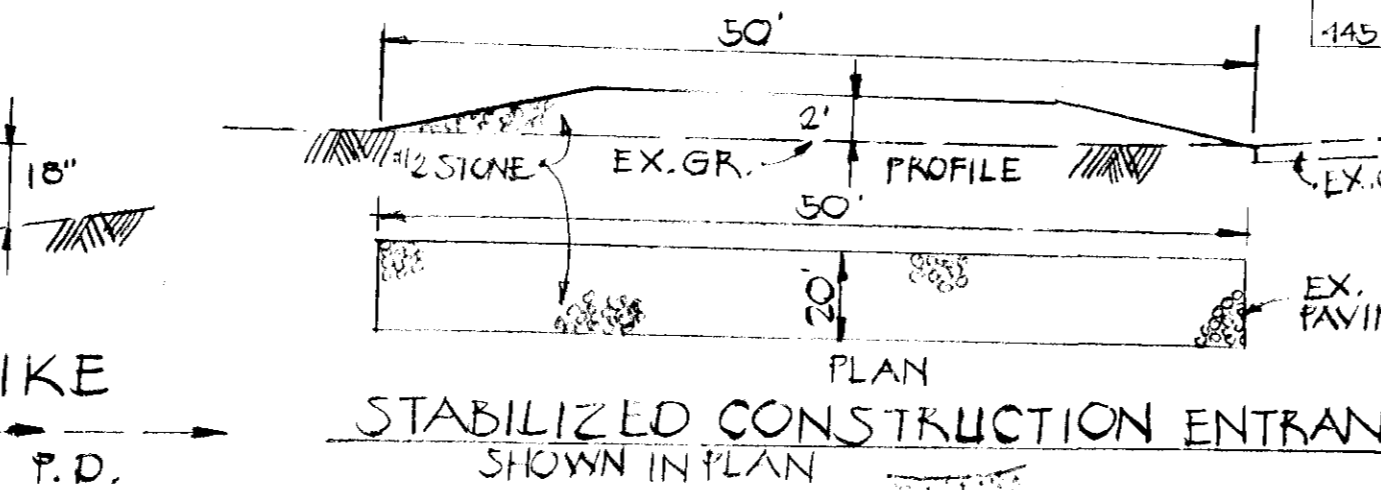

PAVEMENT SECTION D-13

BASE COURSE WILL BE IN ACCORDANCE WITH HOWARD CO. ROAD CONSTRUCTION CODE & STANDARD SPECS. SEE C-30-3. TACK COAT SHALL BE APPLIED BY THE HO. CO. ROAD CODE & STD. SPECS. C-31-4 ROAD CODE 1 & 4

CLASS 'X' CONC.

1" BIT. CONC. SURFACE
 2" BIT. CONC. BASE

DEVELOPER

I CERTIFY THAT ALL DEVELOPMENT AND/OR CONSTRUCTION WILL BE DONE ACCORDING TO THIS PLAN OF DEVELOPMENT AND PLAN FOR EROSION AND SEDIMENT CONTROL AND I AUTHORIZE PERIODIC ONSITE INSPECTION BY THE HOWARD COUNTY SOIL CONSERVATION DISTRICT OR THEIR AUTHORIZED AGENTS AS ARE DEEMED NECESSARY. DEVIATION FROM THIS PLAN WILL NOT BE MADE UNLESS AUTHORIZED BY THE HOWARD COUNTY SOIL CONSERVATION DISTRICT.

Signature: Fred All...
 DATE: 3-22-77

APPROVED: HOWARD COUNTY OFFICE OF PLANNING & ZONING
 8-30-77
 DATE

Signature: John D. M...
 DATE: 2-27-77

APPROVED FOR SYSTEMS DRAINAGE SYSTEMS AND ROADS: HOWARD COUNTY DEPARTMENT OF PUBLIC WORKS
 8-26-77
 DATE

Signature: Howard K. K...
 DATE: 8/25/77

THIS DEVELOPMENT PLAN IS APPROVED FOR SOIL EROSION AND SEDIMENT CONTROL BY THE HOWARD SOIL CONSERVATION DISTRICT.

Signature: Howard K. K...
 DATE: 2-27-77

Signature: Howard K. K...
 DATE: 8-26-77

SITE DEVELOPMENT PLAN
 PROPOSED CONSTRUCTION EQUIPMENT STORAGE & REPAIR FACILITY
 ELECTION DISTRICT 2
 HOWARD COUNTY, MARYLAND
 SCALE 1" = 50' FEB. 17, 1977
 SHEET 1 OF 1
 TAX MAP 24 PARCEL 695
 TITLE REF: 337-504
 OWNER & DEVELOPER
 HORIZON, INC.
 901 FRED ALLNUTT
 1300 HIGHLAND RD.
 HIGHLAND, MD. 20777